

QUARTERLY SUMMARY REPORT
Alameda County
January 1990

ARCO Service Station No. 2112
1260 Park Street/Encinal Avenue
Alameda, California

Brief History

- May 14, 1987, a waste-oil tank was removed from the site by Crosby and Overton Environmental, Inc. The former location of the tank is shown on Plate P-1. Two soil samples were collected from the soil beneath the waste-oil tank. Results of soil analyses by Anatec Laboratories, Inc., (letters dated May 19, 1987 and May 27, 1987) are presented in Table 1.
- May 21, 1987, additional contaminated soil was removed from the excavation and was hauled to a Class I landfill. One soil sample was collected at a depth of 6 feet at the bottom of the excavation, and laboratory results of the soil sample indicated no detectable levels of total extractable hydrocarbons as motor oil (Table 1). The excavation was backfilled with clean sand.

Work Performed - Fourth Quarter 1989

- November 14, 1989, mailed copies of file information on behalf of ARCO to Mr. Ariu Levi of the Alameda County Health Agency, as requested by Mr. Levi.

Future Work

- ARCO plans no further work at this site at this time, as indicated in a telephone conversation with Mr. Gerow of the Alameda County Department of Health Services and Brown and Caldwell, on September 28, 1987.

TABLE 1
RESULTS OF CHEMICAL ANALYSES
ON SOIL SAMPLES
ARCO Service Station No. 2112
1260 Park Street/Encinal Avenue
Alameda, California

Sample Number	Date Sampled	TEH (as diesel fuel)	TEH (as motor oil)
9310-1 (bottom of tank)	5/14/87	430	2,400
9310-2 (west side of tank)	5/15/87	<10	<10
9347-1 (6-foot depth)	5/21/87	NA	<10

Results in milligrams/kilogram (mg/kg) = parts per million (ppm)

TEH: Total extractable hydrocarbons

NA: Not analyzed

Sampled by Crosby and Overton Environmental Management, Inc.

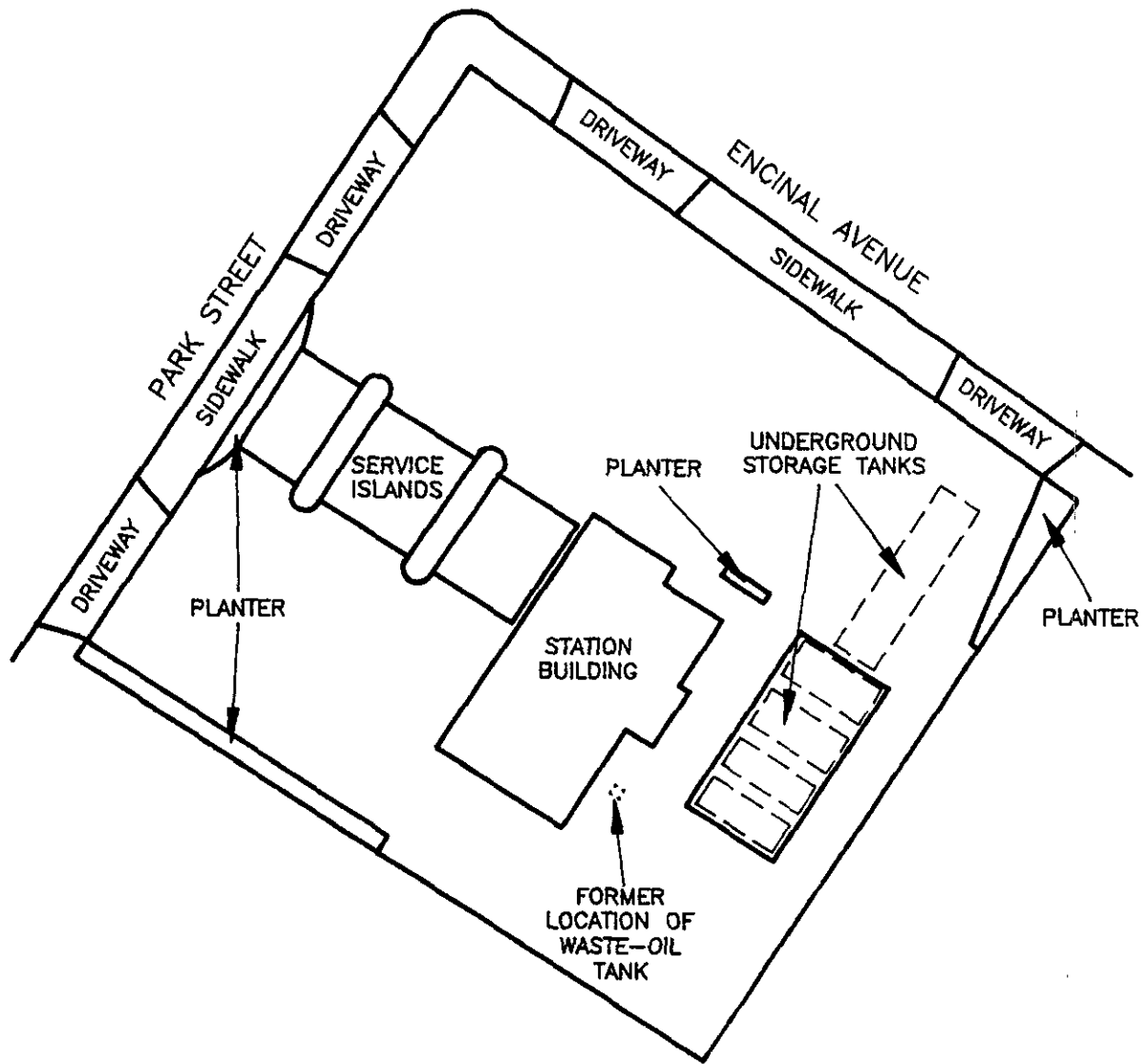

Source: Based on ARCO site plan dated 1983

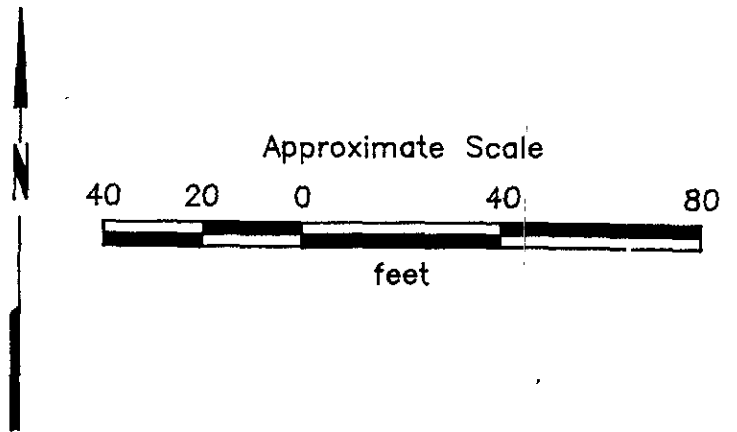

PROJECT NO. 19011-1

**GENERALIZED SITE PLAN
ARCO Station No. 2112
1260 Park Street
Alameda, California**

**PLATE
P-1**