



Atlantic Richfield Company
(a BP affiliated company)

P.O. Box 1257
San Ramon, California 94583
Phone: (925) 275-3801
Fax: (925) 275-3815

18 April 2007

Re: First Quarter 2007 Status Report
Atlantic Richfield Company Station #2112
1260 Park Street
Alameda, California
ACEH Case #RO0000044

RECEIVED

1:09 pm, May 01, 2007

Alameda County
Environmental Health



"I declare, that to the best of my knowledge at the present time, that the information and/or recommendations contained in the attached document are true and correct."

Submitted by:

Paul Supple
Environmental Business Manager

Broadbent & Associates, Inc.
1324 Mangrove Ave., Suite 212
Chico, CA 95926
Voice (530) 566-1400
Fax (530) 566-1401



18 April 2007

Project No. 06-08-616

Atlantic Richfield Company
P.O. Box 1257
San Ramon, California 94583
Submitted via ENFOS

Attn.: Mr. Paul Supple

Re: First Quarter 2007 Status Report, Atlantic Richfield Company (a BP affiliated company)
Station #2112, 1260 Park Street, Alameda, Alameda County, California;
ACEH Case No.RO0000044

Dear Mr. Supple:

Provided herein is the *First Quarter 2007 Status Report* for Atlantic Richfield Company Station #2112 (herein referred to as Station #2112) located at 1260 Park Street, Alameda, Alameda County, California (Site). This report presents a summary of recent developments at the site during First Quarter of 2007.

Should you have questions regarding this submission, please do not hesitate to contact us at (530) 566-1400.

Sincerely,

BROADBENT & ASSOCIATES, INC.

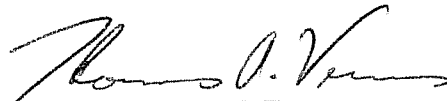
Thomas A. Venus, P.E.
Senior Engineer

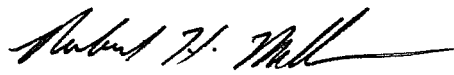
Robert H. Miller, P.G., C.H.G.
Principal Hydrogeologist

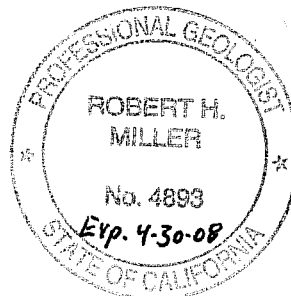

Enclosures

cc: Mr. Stephen Plunkett, Alameda County Environmental Health (Submitted via ACEH ftp Site)
Electronic copy uploaded to GeoTracker

STATION #2112 QUARTERLY STATUS REPORT

Facility: #2112	Address:	1260 Park Street, Alameda, California
Environmental Business Manager:		Mr. Paul Supple
Consulting Company/Contact Person:		Broadbent & Associates, Inc./Rob Miller & Tom Venus, (530)566-1400
Consultant Project No.:		06-08-616
Primary Agency/Regulatory ID No.:		Alameda County Environmental Health (ACEH) ACEH Case No. RO0000044

WORK PERFORMED THIS QUARTER (First Quarter 2007):

1. Prepared and submitted the Fourth Quarter 2006 Ground-Water Monitoring Report.
2. No environmental work was conducted at the site during the First Quarter 2007.

WORK PROPOSED FOR NEXT QUARTER (Second Quarter 2007):

1. Prepared and submitted this Fourth Quarter 2006 Status Report (contained herein).
2. No environmental work is scheduled to be conducted at the Site during the First Quarter of 2007.

DISCUSSION:

Case closure was requested by BP on 4 June 2004 from ACEH. In a letter dated 20 June 2006, ACEH requested rehabilitation, redevelopment, ground-water monitoring and sampling of the onsite monitoring wells to resume the site closure process. A summary of well rehabilitation/redevelopment, and ground-water monitoring and sampling results were presented in the Third Quarter 2006 Ground-Water Monitoring Report. BP is awaiting a response from the ACEH to the closure request in light of the Third Quarter 2006 monitoring results. A Ground-Water Elevation Contour and Analytical Summary Map from Third Quarter 2006 is provided as Drawing 1.

ATTACHMENTS:

Drawing 1. Ground-Water Elevation Contour and Analytical Summary Map, 17 July 2006, Station #2112, 1260 Park Street, Alameda, California

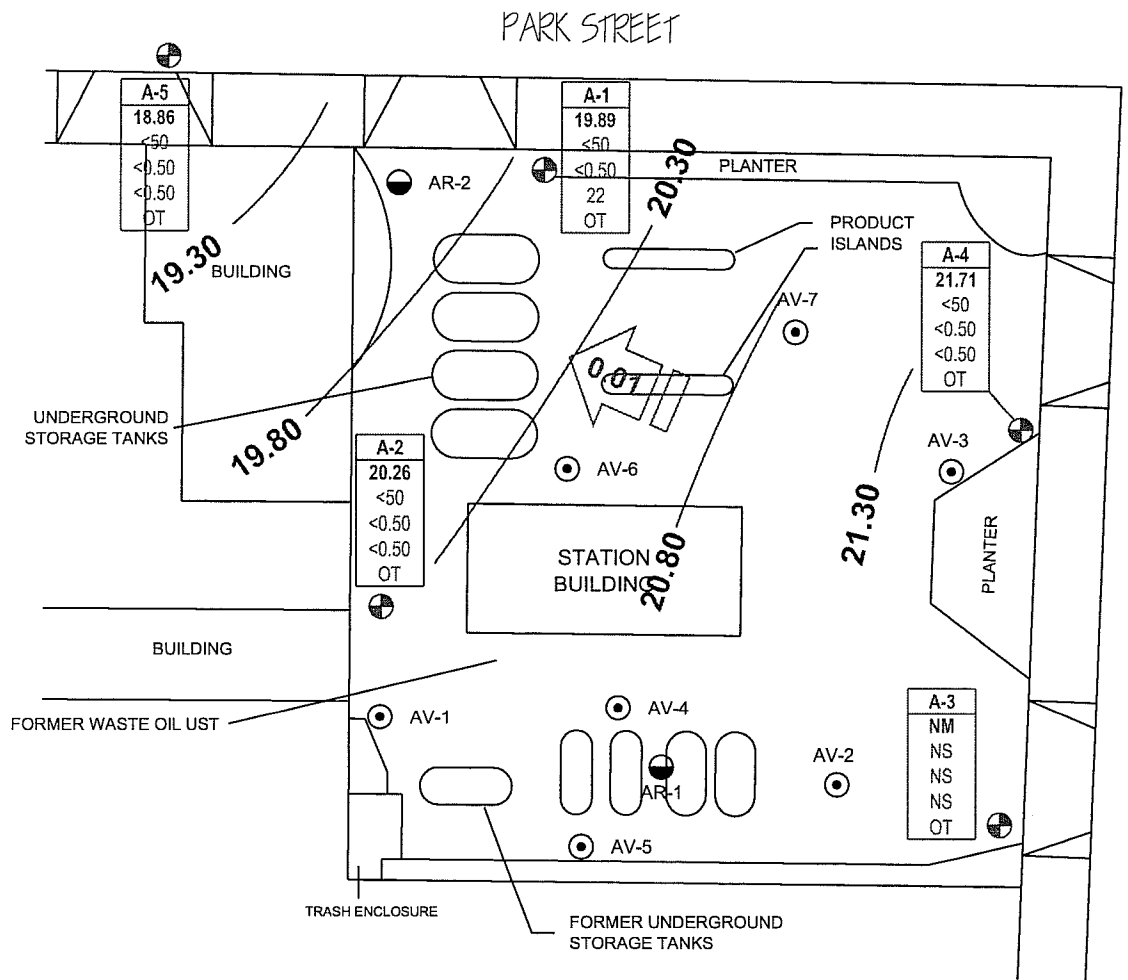

LEGEND:

- A-1 MONITORING WELL LOCATION
 - AR-1 GROUND-WATER EXTRACTION WELL LOCATION
 - AV-1 VAPOR EXTRACTION WELL LOCATION
 - 20.30 GROUND-WATER ELEVATION CONTOURS (FT MSL)
 - 0.01 GROUND-WATER FLOW DIRECTION AND GRADIENT (FT/FT)
- | Well | WELL DESIGNATION |
|------|---|
| ELEV | GROUND-WATER ELEVATION (FT MSL) |
| GRO | GRO, BENZENE AND MTBE CONCENTRATIONS IN GROUND WATER (µg/L) |
| MTBE | |
| OT | SAMPLING FREQUENCY |
- NM/MS NOT MEASURED/NOT SAMPLED
 - < NOT DETECTED AT OR ABOVE LABORATORY REPORTING LIMITS
 - OT ONE TIME, PER ACEH REQUEST OF 6/20/2006

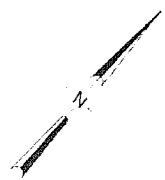

NOTE: SITE MAP ADAPTED FROM URS FIGURES. SITE DIMENSIONS AND FACILITY LOCATIONS NOT VERIFIED.

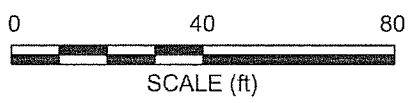

BROADBENT & ASSOCIATES, INC.
 ENGINEERING, WATER RESOURCES & ENVIRONMENTAL
 1324 Mangrove Ave. Suite 212, Chico, California 95926
 Project No.: 06-08-616 Date: 09/11/06

Station #2112
 1260 Park Street
 Alameda, California

Ground-Water Elevation Contour
 and Analytical Summary Map
 17 July 2006