

BLAINE
TECH SERVICES INC.



1680 ROGERS AVENUE
SAN JOSE, CALIFORNIA 95112-1105
(408) 573-7771 FAX
(408) 573-0555 PHONE

ENVIRONMENTAL
PROTECTION
99 JUN 14 PM 3:50

May 27, 1999

Phil Briggs
Chevron U.S.A. Products Company
P.O. Box 6004
San Ramon, CA 94583-0904

1st Quarter 1999 Monitoring at 9-4587

First Quarter 1999 Groundwater Monitoring at
Former Chevron Service Station Number 9-4587
609 Oak Street
Oakland, CA

Monitoring Performed on March 25, 1999

Groundwater Sampling Report 990325-H-1

This report covers the routine monitoring of groundwater wells at this Chevron facility. Blaine Tech Services, Inc.'s work at the site includes inspection, gauging, evacuation, purgewater containment, sample collection and sample handling in accordance with standard procedures that conform to Regional Water Quality Control Board requirements.

Routine field data collection includes depth to water, total well depth, thickness of any separate immiscible layer, water column volume, calculated volume of a three-case volume purge, elapsed evacuation time, total volume of water removed, and standard water parameter instrument readings. Sample material is collected, contained, stored, and transported to the laboratory in conformance with EPA standards. Purgewater is, likewise, collected and transported to McKittrick Waste Treatment Site for disposal.

Basic field information is presented alongside analytical values excerpted from the laboratory report in the cumulative table of **WELL DATA AND ANALYTICAL RESULTS**. The full analytical report for the most recent samples is located in the **Analytical Appendix**. The table also contains new groundwater elevation calculations taken from the computer plotted gradient

map which is located in the **Professional Engineering Appendix**.

At a minimum, Blaine Tech Services, Inc. field personnel are certified upon completion of a forty-hour Hazardous Materials and Emergency Response training course per 29 CFR 1910.120. Field personnel are also enrolled in annual eight hour refresher courses.

Blaine Tech Services, Inc. conducts sampling and documentation assignments of this type as an independent third party. In order to avoid compromising the objectivity necessary for the proper and disinterested performance of this work, Blaine Tech Services, Inc. concentrates on objective data collection and does not participate in the interpretation of analytical results, the definition of geological or hydrological conditions, the formulation of recommendations, or the marketing of remedial systems.

Please call if you have any questions.

Yours truly,

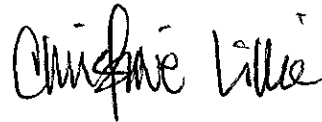

Christine Lillie
Project Coordinator

CAL/sb

attachments: Professional Engineering Appendix
Cumulative Table of Well Data and Analytical Results
Analytical Appendix
Field Data Sheets

Professional Engineering Appendix

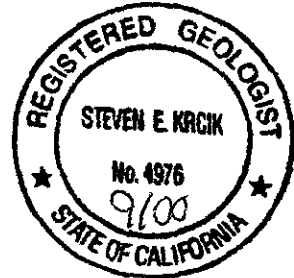
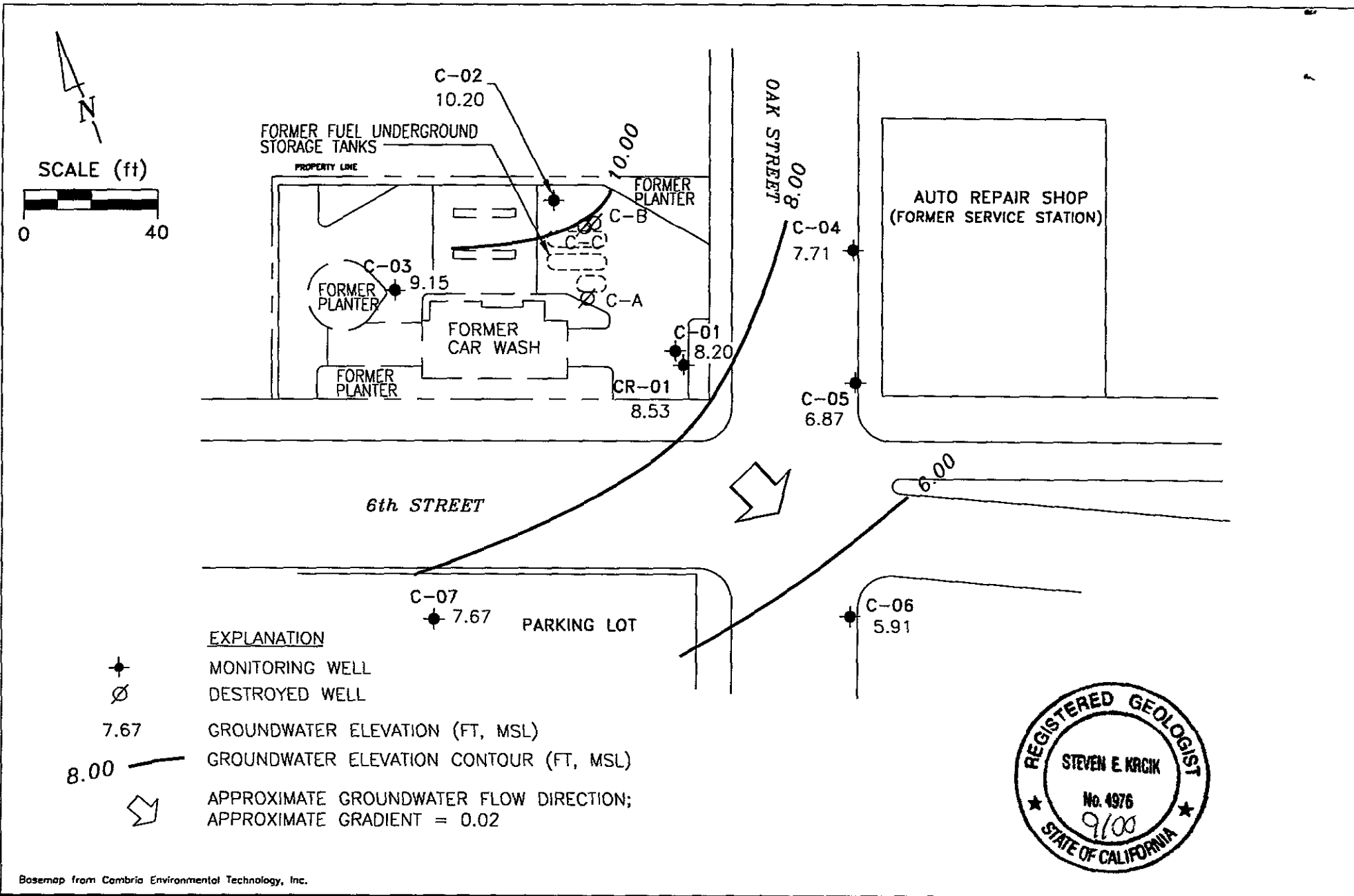

Basemap from Cambria Environmental Technology, Inc.

<p>PREPARED BY</p> <p>RRM engineering contracting firm</p>	<p>Former Chevron Station 9-4587 609 Oak Street Oakland, California</p>	<p>GROUNDWATER ELEVATION CONTOUR MAP, MARCH 25, 1999</p>	<p>FIGURE: 1 PROJECT: DAC04</p>
---	--	---	--

Table of Well Data and Analytical Results

Cumulative Table of Well Data and Analytical Results

Vertical Measurements are in feet.			Volumetric Measurements are in gallons.				Analytical results are in parts per billion (ppb)						
DATE	Well Head Elev.	Ground Water Elev.	Depth To Water	SPH Thickness	SPH Removed	Total SPH Removed	Notes	TPH-Gasoline	Benzene	Toluene	Ethyl-Benzene	Xylene	MTBE
C-A													
12/06/89	--	--	--	--	--	--	--	44,000	20,000	66	1600	2220	--
10/30/90	--	--	11.20	--	--	--	Sheen	31,000	23,000	110	1100	160	--
10/30/90	--	--	11.20	--	--	--	Sheen	30,000	23,000	150	1000	180	--
01/14/91	--	--	11.25	--	--	--	--	12,000	30,000	540	1400	560	--
04/03/91	--	--	9.82	--	--	--	--	59,000	33,000	2400	2200	3100	--
07/17/91	--	--	10.93	--	--	--	--	52,000	38,000	380	1300	500	--
10/07/91	--	--	--	--	--	--	--	--	--	--	--	--	--
06/25/92	--	--	--	--	--	--	--	--	--	--	--	--	--
09/17/92	--	--	--	--	--	--	--	--	--	--	--	--	--
12/16/92	--	--	--	--	--	--	--	--	--	--	--	--	--
03/18/93	--	--	--	--	--	--	--	--	--	--	--	--	--
06/11/93	--	--	--	--	--	--	--	--	--	--	--	--	--
09/08/93	--	--	--	--	--	--	--	--	--	--	--	--	--
09/17/93	--	--	10.02	--	--	--	--	--	--	--	--	--	--
12/23/93	--	--	--	--	--	--	--	--	--	--	--	--	--
03/07/94	--	--	--	--	--	--	--	--	--	--	--	--	--
06/17/94	--	--	10.05	--	--	--	--	77,000	32,000	3600	3200	14,000	--
09/12/94	--	--	11.75	--	--	--	--	270	170	1.0	13	24	--
06/29/95	--	--	--	--	--	--	Destroyed	--	--	--	--	--	--

Cumulative Table of Well Data and Analytical Results

Vertical Measurements are in feet.			Volumetric Measurements are in gallons.				Analytical results are in parts per billion (ppb)						
DATE	Well Head Elev.	Ground Water Elev.	Depth To Water	SPH Thickness	SPH Removed	Total SPH Removed	Notes	TPH-Gasoline	Benzene	Toluene	Ethyl-Benzene	Xylene	MTBE
C-B													
12/06/89	--	--	--	0.01	--	--	--	--	--	--	--	--	--
10/30/90	--	--	11.19	0.01	--	--	--	--	--	--	--	--	--
01/14/91	--	--	11.40	0.01	--	--	--	--	--	--	--	--	--
04/03/91	--	--	9.55	1.00	--	--	--	--	--	--	--	--	--
04/04/91	--	--	10.54	1.06	--	--	--	--	--	--	--	--	--
07/17/91	--	--	10.84	0.03	--	--	--	--	--	--	--	--	--
10/07/91	--	--	11.10	0.04	--	--	--	--	--	--	--	--	--
02/04/92	--	--	10.78	0.01	--	--	--	--	--	--	--	--	--
03/06/92	--	--	--	--	--	--	--	--	--	--	--	--	--
04/01/92	--	--	10.33	1.02	--	--	--	--	--	--	--	--	--
06/25/92	--	--	11.20	0.68	--	--	--	--	--	--	--	--	--
09/17/92	--	--	11.07	0.13	--	--	--	--	--	--	--	--	--
12/16/92	--	--	10.41	0.38	--	--	--	--	--	--	--	--	--
03/18/93	--	--	9.19	0.05	--	--	--	--	--	--	--	--	--
06/11/93	--	--	9.54	0.70	--	--	--	--	--	--	--	--	--
09/08/93	--	--	--	--	--	--	--	--	--	--	--	--	--
09/17/93	--	--	9.85	0.52	--	--	--	--	--	--	--	--	--
12/23/93	--	--	9.37	0.20	--	--	--	--	--	--	--	--	--
03/07/94	--	--	9.24	0.85	--	--	--	--	--	--	--	--	--
06/17/94	--	--	9.38	0.02	--	--	--	--	--	--	--	--	--
09/12/94	--	--	11.13	0.49	--	--	--	--	--	--	--	--	--
06/29/95	--	--	--	--	--	--	Destroyed	--	--	--	--	--	--

Cumulative Table of Well Data and Analytical Results

Vertical Measurements are in feet.			Volumetric Measurements are in gallons.				Analytical results are in parts per billion (ppb)						
DATE	Well Head Elev.	Ground Water Elev.	Depth To Water	SPH Thickness	SPH Removed	Total SPH Removed	Notes	TPH-Gasoline	Benzene	Toluene	Ethyl-Benzene	Xylene	MTBE
C-C													
12/06/89	--	--	--	0.15	--	--	--	--	--	--	--	--	--
10/30/90	--	--	10.84	0.03	--	--	--	--	--	--	--	--	--
01/14/91	--	--	11.01	0.11	--	--	--	--	--	--	--	--	--
04/03/91	--	--	9.19	0.02	--	--	--	--	--	--	--	--	--
07/17/91	--	--	10.53	0.03	--	--	--	--	--	--	--	--	--
10/07/91	--	--	10.98	0.08	--	--	--	--	--	--	--	--	--
02/04/92	--	--	10.45	0.09	--	--	--	--	--	--	--	--	--
03/06/92	--	--	8.83	0.09	--	--	--	--	--	--	--	--	--
04/01/92	--	--	9.23	0.16	--	--	--	--	--	--	--	--	--
06/25/92	--	--	10.40	0.12	--	--	--	--	--	--	--	--	--
09/17/92	--	--	10.84	0.12	--	--	--	--	--	--	--	--	--
12/16/92	--	--	10.02	0.12	--	--	--	--	--	--	--	--	--
03/18/93	--	--	8.70	0.15	--	--	--	--	--	--	--	--	--
06/11/93	--	--	9.25	0.13	--	--	--	--	--	--	--	--	--
09/08/93	--	--	--	--	--	--	--	--	--	--	--	--	--
09/17/93	--	--	9.83	--	--	--	Sheen	--	--	--	--	--	--
12/23/93	--	--	9.66	0.07	--	--	--	--	--	--	--	--	--
03/07/94	--	--	8.93	0.28	--	--	--	--	--	--	--	--	--
06/17/94	--	--	10.13	0.03	--	--	--	--	--	--	--	--	--
09/12/94	--	--	11.20	0.13	--	--	--	--	--	--	--	--	--
06/29/95	--	--	--	--	--	--	Destroyed	--	--	--	--	--	--

Cumulative Table of Well Data and Analytical Results

Vertical Measurements are in feet.

Volumetric Measurements are in gallons.

Analytical results are in parts per billion (ppb)

DATE	Vertical Measurements are in feet.			Volumetric Measurements are in gallons.			Notes	Analytical results are in parts per billion (ppb)						
	Well Head Elev.	Ground Water Elev.	Depth To Water	SPH Thickness	SPH Removed	Total SPH Removed		TPH-Gasoline	Benzene	Toluene	Ethyl-Benzene	Xylene	MTBE	
C-1														
12/06/89	16.07	--	--	0.20	--	--	--	--	--	--	--	--	--	--
10/30/90	16.07	5.30	10.79	0.02	--	--	--	--	--	--	--	--	--	--
01/14/91	16.07	4.70	11.39	0.02	--	--	--	--	--	--	--	--	--	--
04/03/91	16.07	6.66	9.43	0.02	--	--	--	--	--	--	--	--	--	--
07/17/91	16.07	5.64	10.46	0.04	--	--	--	--	--	--	--	--	--	--
10/07/91	16.07	5.36	10.74	0.04	--	--	--	--	--	--	--	--	--	--
02/04/92	16.07	5.71	10.37	0.01	--	--	--	--	--	--	--	--	--	--
03/06/92	16.07	6.87	9.20	--	--	--	--	--	--	--	--	--	--	--
04/01/92	16.07	6.79	9.28	--	--	--	--	--	--	--	--	--	--	--
06/25/92	16.07	6.10	9.98	0.01	--	--	--	100,000	8800	7000	2800	19,000	--	--
09/17/92	16.07	5.56	10.51	--	--	--	Sheen	--	--	--	--	--	--	--
12/16/92	16.07	6.26	9.81	--	--	--	Sheen	--	--	--	--	--	--	--
03/18/93	16.07	7.19	8.88	--	--	--	Sheen	--	--	--	--	--	--	--
06/11/93	16.07	6.78	9.31	0.02	--	--	--	--	--	--	--	--	--	--
09/08/93	16.07	--	--	--	--	--	--	--	--	--	--	--	--	--
09/17/93	16.07	6.37	9.72	0.02	--	--	--	--	--	--	--	--	--	--
12/23/93	16.07	6.58	9.49	--	--	--	--	41,000	5400	590	710	5600	--	--
03/07/94	16.07	7.32	8.96	0.26	--	--	--	--	--	--	--	--	--	--
06/17/94	16.07	6.39	9.70	0.02	--	--	--	--	--	--	--	--	--	--
09/12/94	16.07	3.66	12.42	0.01	--	--	--	--	--	--	--	--	--	--
06/29/95	16.07	7.29	8.78	--	--	--	--	220,000	11,000	3600	3500	19,000	--	--
09/13/95	16.07	6.54	9.56	0.04	0.21	0.21	--	--	--	--	--	--	--	--
12/19/95	16.07	6.76	9.31	--	--	0.21	--	14,000	180	81	240	2200	440	--
03/26/96	16.07	7.14	8.93	--	--	0.21	--	790	22	5.3	21	96	<12	--
06/10/96	16.07	7.84	8.23	--	--	0.21	Insufficient water	--	--	--	--	--	--	--
09/13/96	16.07	6.55	9.52	--	--	0.21	--	110	0.85	<0.5	0.95	1.9	3.6	--
12/19/96	16.07	7.36	8.71	--	--	0.21	--	51	<0.5	<0.5	0.69	1.3	<2.5	--
03/12/98	15.48*	8.67	6.81	--	--	0.21	--	61	1.2	1.6	0.69	6.5	<2.5	--
08/20/98	15.48	6.61	8.87	--	--	0.21	--	120	3.5	<0.5	<0.5	3.2	2.7	--
03/25/99	15.48	8.20	7.28	--	--	0.21	--	<50	<0.5	<0.5	<0.5	<0.5	<2.5	--

* Site resurveyed on May 8, 1998.

Cumulative Table of Well Data and Analytical Results

Vertical Measurements are in feet.

Volumetric Measurements are in gallons.

Analytical results are in parts per billion (ppb)

DATE	Well Head Elev.	Ground Water Elev.	Depth To Water	Total			Notes	TPH-Gasoline	Benzene	Toluene	Ethyl-Benzene	Xylene	MTBE
				SPH Thickness	SPH Removed	SPH Removed							
C-2													
12/06/89	16.84	--	--	--	--	--	--	16,000	250	1200	550	1400	--
10/30/90	16.84	5.68	11.16	--	--	--	--	28,000	3700	1900	1200	4300	--
01/14/91	16.84	5.73	11.11	--	--	--	--	24,000	3300	1200	1100	4100	--
01/14/91	16.84	5.73	11.11	--	--	--	--	30,000	3900	1500	1500	5000	--
04/03/91	16.84	7.31	9.53	--	--	--	--	12,000	1100	840	650	1800	--
04/03/91	16.84	7.31	9.53	--	--	--	--	14,000	1100	990	680	1800	--
07/17/91	16.84	6.16	10.68	--	--	--	--	13,000	1700	560	650	1700	--
07/17/91	16.84	6.16	10.68	--	--	--	--	14,000	1700	640	720	1900	--
10/07/91	16.84	5.82	11.02	--	--	--	--	25,000	3700	1300	1400	3800	--
02/04/92	16.84	6.24	10.60	--	--	--	--	16,000	2600	300	880	1900	--
04/01/92	16.84	7.54	9.30	--	--	--	--	15,000	1900	300	700	1500	--
06/25/92	16.84	6.39	10.45	--	--	--	--	23,000	3400	740	1300	3400	--
09/17/92	16.84	6.06	10.78	--	--	--	--	18,000	3500	550	1400	3900	--
12/16/92	16.84	6.90	9.94	--	--	--	--	12,000	1200	120	460	1100	--
03/18/93	16.84	8.04	8.80	--	--	--	--	5200	990	130	290	430	--
06/11/93	16.84	7.41	9.43	--	--	--	--	34,000	8200	910	2400	6600	--
09/08/93	16.84	--	--	--	--	--	--	3400	690	26	190	330	--
09/17/93	16.84	6.93	9.91	--	--	--	--	--	--	--	--	--	--
12/23/93	16.84	7.15	9.69	--	--	--	--	2500	830	26	130	260	--
03/07/94	16.84	7.87	8.97	--	--	--	--	1100	420	6.5	110	69	--
06/17/94	16.84	6.98	9.86	--	--	--	--	1400	290	8.6	60	63	--
09/12/94	16.84	5.74	11.10	--	--	--	--	370	96	1.3	9.4	16	--
06/29/95	16.84	7.84	9.00	--	--	--	--	4100	400	96	250	500	--
09/13/95	16.84	7.10	9.74	--	--	--	--	3500	200	50	57	290	--
12/19/95	16.84	7.74	9.10	--	--	--	--	<50	<0.5	<0.5	<0.5	<0.5	<2.5
03/26/96	16.84	9.46	7.38	--	--	--	Insufficient water	--	--	--	--	--	--
06/10/96	16.84	9.00	7.84	--	--	--	Insufficient water	--	--	--	--	--	--
09/13/96	16.84	8.44	8.40	--	--	--	--	<50	<0.5	<0.5	<0.5	<0.5	<2.5
12/19/96	16.84	8.46	8.38	--	--	--	--	<50	<0.5	<0.5	<0.5	<0.5	<2.5
03/12/98	16.39*	10.75	5.64	--	--	--	--	<50	<0.5	<0.5	<0.5	<0.5	4.8
08/20/98	16.39	7.55	8.84	--	--	--	--	<50	<0.5	<0.5	<0.5	<0.5	<2.5
03/25/99	16.39	10.20	6.19	--	--	--	--	<50	<0.5	<0.5	<0.5	<0.5	<2.5

* Site resurveyed on May 8, 1998.

Cumulative Table of Well Data and Analytical Results

Vertical Measurements are in feet.				Volumetric Measurements are in gallons.			Analytical results are in parts per billion (ppb)						
DATE	Well Head Elev.	Ground Water Elev.	Depth To Water	SPH Thickness	SPH Removed	Total SPH Removed	Notes	TPH-Gasoline	Benzene	Toluene	Ethyl-Benzene	Xylene	MTBE
C-3													
12/06/89	16.48	--	--	--	--	--	--	<500	<0.5	<0.5	<0.5	0.74	--
10/30/90	16.48	6.04	10.44	--	--	--	--	410	4.0	4.0	2.0	9.0	--
01/14/91	16.48	6.14	10.34	--	--	--	--	80	<0.5	<0.5	<0.5	1.0	--
04/03/91	16.48	7.47	9.01	--	--	--	--	53	<0.5	<0.5	<0.5	2.0	--
07/17/91	16.48	6.48	10.00	--	--	--	--	<50	5.9	<0.5	<0.5	<0.5	--
10/07/91	16.48	6.10	10.38	--	--	--	--	<50	<0.5	<0.5	<0.5	<0.5	--
02/04/92	16.48	6.48	10.00	--	--	--	--	<50	<0.5	<0.5	<0.5	<0.5	--
04/01/92	16.48	7.65	8.83	--	--	--	--	<50	<0.5	<0.5	<0.5	<0.5	--
06/25/92	16.48	6.63	9.85	--	--	--	--	<50	<0.5	<0.5	<0.5	<0.5	--
09/17/92	16.48	6.28	10.20	--	--	--	--	<50	<0.5	<0.5	<0.5	<0.5	--
12/16/92	16.48	7.08	9.40	--	--	--	--	<50	<0.5	<0.5	<0.5	<0.5	--
03/18/93	16.48	8.36	8.12	--	--	--	--	<50	<0.5	<0.5	<0.5	<1.5	--
06/11/93	16.48	7.89	8.59	--	--	--	--	<50	<0.5	<0.5	<0.5	<0.5	--
09/08/93	16.48	--	--	--	--	--	--	<50	<0.5	<0.5	<0.5	<1.5	--
09/17/93	16.48	7.48	9.00	--	--	--	--	--	--	--	--	--	--
12/23/93	16.48	7.65	8.83	--	--	--	--	<50	<0.5	0.8	<0.5	2.9	--
03/07/94	16.48	8.29	8.19	--	--	--	--	<50	<0.5	<0.5	<0.5	<0.5	--
06/17/94	16.48	7.43	9.05	--	--	--	--	<50	<0.5	<0.5	<0.5	<0.5	--
09/12/94	16.48	--	--	--	--	--	Inaccessible	--	--	--	--	--	--
06/29/95	16.48	8.18	8.30	--	--	--	--	<50	<0.5	<0.5	<0.5	<0.5	--
09/13/95	16.48	7.64	8.84	--	--	--	--	<50	<0.5	<0.5	<0.5	<0.5	--
12/19/95	16.48	8.02	8.46	--	--	--	--	<50	<0.5	<0.5	<0.5	<0.5	--
03/26/96	16.48	9.01	7.47	--	--	--	--	<50	<0.5	<0.5	<0.5	<0.5	<2.5
06/10/96	16.48	8.23	8.25	--	--	--	--	<50	<0.5	<0.5	<0.5	<0.5	<2.5
09/13/96	16.48	7.46	9.02	--	--	--	Sampled annually	--	--	--	--	--	--
12/19/96	16.48	8.44	8.04	--	--	--	--	--	--	--	--	--	--
03/12/98	16.13*	9.90	6.23	--	--	--	--	<50	<0.5	<0.5	<0.5	<0.5	3.5
08/20/98	16.13	7.93	8.20	--	--	--	--	--	--	--	--	--	--
03/25/99	16.13	7.93	6.98	--	--	--	--	<50	<0.5	<0.5	<0.5	<0.5	<2.5

* Site resurveyed on May 8, 1998.

Cumulative Table of Well Data and Analytical Results

Vertical Measurements are in feet.			Volumetric Measurements are in gallons.				Analytical results are in parts per billion (ppb)						
DATE	Well Head Elev.	Ground Water Elev.	Depth To Water	SPH Thickness	SPH Removed	Total SPH Removed	Notes	TPH-Gasoline	Benzene	Toluene	Ethyl-Benzene	Xylene	MTBE
C-4													
12/06/89	16.53	--	--	--	--	--	--	--	--	--	--	--	--
10/30/90	16.53	4.97	11.56	--	--	--	--	<50	<0.5	<0.5	<0.5	<0.5	--
01/14/91	16.53	5.09	11.44	--	--	--	--	<50	<0.5	<0.5	<0.5	<0.5	--
04/03/91	16.53	6.53	10.00	--	--	--	--	150	3.0	<0.5	12	9.0	--
07/17/91	16.53	5.37	11.16	--	--	--	--	290	2.3	0.4	52	0.4	--
10/07/91	16.53	5.14	11.39	--	--	--	--	<50	<0.5	<0.5	4.6	<0.5	--
02/04/92	16.53	5.51	11.02	--	--	--	--	<50	<0.5	<0.5	2.8	<0.5	--
02/04/92	16.53	5.51	11.02	--	--	--	--	<50	<0.5	<0.5	2.5	0.5	--
04/01/92	16.53	6.70	9.83	--	--	--	--	480	4.9	<0.5	64	4.3	--
06/25/92	16.53	5.65	10.88	--	--	--	--	<50	<0.5	<0.5	<0.5	<0.5	--
09/17/92	16.53	5.29	11.24	--	--	--	--	<50	<0.5	<0.5	<0.5	<0.5	--
12/16/92	16.53	6.13	10.40	--	--	--	--	56	<0.5	<0.5	1.0	<0.5	--
03/18/93	16.53	7.05	9.48	--	--	--	--	<50	<0.5	<0.5	<0.5	<1.5	--
06/11/93	16.53	6.92	9.61	--	--	--	--	<50	<0.5	<0.5	<0.5	<1.5	--
09/08/93	16.53	--	--	--	--	--	--	<50	<0.5	<0.5	<0.5	<1.5	--
09/17/93	16.53	6.46	10.07	--	--	--	--	--	--	--	--	--	--
12/23/93	16.53	6.70	9.83	--	--	--	--	<50	1.2	1.5	<0.5	3.2	--
03/07/94	16.53	7.33	9.20	--	--	--	--	60	0.7	1.1	6.7	1.8	--
06/17/94	16.53	6.56	9.97	--	--	--	--	<50	<0.5	<0.5	<0.5	<0.5	--
09/12/94	16.53	5.32	11.21	--	--	--	--	<50	<0.5	<0.5	<0.5	<0.5	--
06/29/95	16.53	7.18	9.35	--	--	--	--	<50	<0.5	<0.5	1.4	<0.5	--
09/13/95	16.53	6.60	9.93	--	--	--	--	<50	<0.5	<0.5	<0.5	<0.5	--
12/19/95	16.53	6.98	9.55	--	--	--	--	<50	<0.5	<0.5	<0.5	<0.5	<2.5
03/26/96	16.53	7.99	8.54	--	--	--	--	<50	<0.5	<0.5	<0.5	<0.5	<2.5
06/10/96	16.53	7.23	9.30	--	--	--	--	<50	<0.5	<0.5	<0.5	<0.5	4.1
09/13/96	16.53	6.71	9.82	--	--	--	Sampled annually	--	--	--	--	--	--
12/19/96	16.53	7.50	9.03	--	--	--	--	--	--	--	--	--	--
03/12/98	15.83*	8.53	7.30	--	--	--	--	<50	<0.5	<0.5	<0.5	<0.5	<2.5
03/12/98	15.83	6.38	9.45	--	--	--	--	--	--	--	--	--	--
03/25/99	15.83	7.71	8.12	--	--	--	--	<50	<0.5	<0.5	<0.5	<0.5	<2.5

* Site resurveyed on May 8, 1998.

Cumulative Table of Well Data and Analytical Results

Vertical Measurements are in feet.			Volumetric Measurements are in gallons.				Analytical results are in parts per billion (ppb)						
DATE	Well Head Elev.	Ground Water Elev.	Depth To Water	SPH Thickness	SPH Removed	Total SPH Removed	Notes	TPH-Gasoline	Benzene	Toluene	Ethyl-Benzene	Xylene	MTBE
C-5													
12/06/89	14.70	4.73	9.97	--	--	--	--	--	--	--	--	--	--
10/30/90	14.70	--	--	--	--	--	--	<50	0.8	<0.5	<0.5	0.5	--
01/14/91	14.70	4.83	9.87	--	--	--	--	54	<0.5	<0.5	<0.5	<0.5	--
04/03/91	14.70	5.98	8.72	--	--	--	--	1800	330	200	52	170	--
07/17/91	14.70	5.07	9.63	--	--	--	--	170	120	5.3	12	20	--
10/07/91	14.70	4.87	9.83	--	--	--	--	<50	1.1	<0.5	<0.5	<0.5	--
02/04/92	14.70	5.17	9.53	--	--	--	--	91	16	<0.5	2.4	2.0	--
04/01/92	14.70	6.13	8.57	--	--	--	--	960	200	5.4	21	33	--
06/25/92	14.70	5.26	9.44	--	--	--	--	800	2.5	<0.5	1.3	7.3	--
09/17/92	14.70	4.98	9.72	--	--	--	--	<50	<0.5	<0.5	<0.5	<0.5	--
12/16/92	14.70	5.63	9.07	--	--	--	--	81	5.4	1.2	1.5	4.3	--
03/18/93	14.70	6.26	8.44	--	--	--	--	<50	<0.5	<0.5	<0.5	<1.5	--
06/11/93	14.70	6.17	8.53	--	--	--	--	<50	1.6	<0.5	<0.5	<1.5	--
09/08/93	14.70	--	--	--	--	--	--	<50	<0.5	<0.5	<0.5	<1.5	--
09/17/93	14.70	5.81	8.89	--	--	--	--	--	--	--	--	--	--
12/23/93	14.70	6.02	8.68	--	--	--	--	<50	5.5	1.3	0.7	4.0	--
03/07/94	14.70	6.52	8.18	--	--	--	--	460	180	21	27	70	--
06/17/94	14.70	5.89	8.81	--	--	--	--	<50	10	0.5	1.4	3.3	--
09/12/94	14.70	4.83	9.87	--	--	--	--	<50	6.4	<0.5	<0.5	<0.5	--
06/29/95	14.70	6.33	8.37	--	--	--	--	65	10	<0.5	2.3	9.1	--
09/13/95	14.70	5.90	8.80	--	--	--	--	370	41	0.76	17	50	--
12/19/95	14.70	6.22	8.48	--	--	--	--	<50	<0.5	<0.5	<0.5	<0.5	<2.5
03/26/96	14.70	6.97	7.73	--	--	--	--	<50	<0.5	<0.5	<0.5	<0.5	<2.5
06/10/96	14.70	6.40	8.30	--	--	--	--	<50	<0.5	<0.5	<0.5	<0.5	3.9
09/13/96	14.70	5.95	8.75	--	--	--	--	<50	<0.5	<0.5	<0.5	<0.5	<2.5
12/19/96	14.70	6.65	8.05	--	--	--	--	<50	4.2	<0.5	<0.5	<0.5	<2.5
03/12/98	14.22*	7.41	6.81	--	--	--	--	<50	<0.5	<0.5	<0.5	<0.5	<2.5
08/20/98	14.22	5.81	8.41	--	--	--	--	<50	<0.5	<0.5	<0.5	<0.5	<2.5
03/25/99	14.22	6.87	7.35	--	--	--	--	<50	<0.5	<0.5	<0.5	<0.5	<2.5

* Site resurveyed on May 8, 1998.

Cumulative Table of Well Data and Analytical Results

Vertical Measurements are in feet.			Volumetric Measurements are in gallons.				Analytical results are in parts per billion (ppb)						
DATE	Well Head Elev.	Ground Water Elev.	Depth To Water	SPH Thickness	SPH Removed	Total SPH Removed	Notes	TPH-Gasoline	Benzene	Toluene	Ethyl-Benzene	Xylene	MTBE
C-6													
12/06/89	13.87	--	--	--	--	--	--	--	--	--	--	--	--
10/30/90	13.87	4.44	9.43	--	--	--	--	<50	<0.5	<0.5	<0.5	<0.5	--
01/14/91	13.87	4.46	9.41	--	--	--	--	<0.5	<0.5	<0.5	<0.5	<0.5	--
04/03/91	13.87	5.21	8.66	--	--	--	--	<0.5	<0.5	<0.5	<0.5	<0.5	--
07/17/91	13.87	4.62	9.25	--	--	--	--	<0.5	<0.5	<0.5	<0.5	<0.5	--
10/07/91	13.87	4.53	9.34	--	--	--	--	67	<0.5	0.6	<0.5	0.6	--
02/04/92	13.87	4.71	9.16	--	--	--	--	<50	<0.5	<0.5	<0.5	<0.5	--
04/01/92	13.87	5.28	8.59	--	--	--	--	<50	<0.5	<0.5	<0.5	<0.5	--
06/25/92	13.87	4.76	9.11	--	--	--	--	<50	<0.5	<0.5	<0.5	<0.5	--
09/17/92	13.87	4.59	9.28	--	--	--	--	<50	<0.5	<0.5	<0.5	<0.5	--
12/16/92	13.87	4.99	8.88	--	--	--	--	120	9.3	1.9	2.7	7.4	--
03/18/93	13.87	5.52	8.35	--	--	--	--	<50	<0.5	<0.5	<0.5	<1.5	--
06/11/93	13.87	5.66	8.21	--	--	--	--	<50	<0.5	0.7	<0.5	<1.5	--
09/08/93	13.87	--	--	--	--	--	--	<50	<0.5	<0.5	<0.5	<1.5	--
09/17/93	13.87	5.50	8.37	--	--	--	--	--	--	--	--	--	--
12/23/93	13.87	5.58	8.29	--	--	--	--	<50	1.4	1.0	<0.5	3.5	--
03/07/94	13.87	5.87	8.00	--	--	--	--	<50	0.8	<0.5	<0.5	<0.5	--
06/17/94	13.87	5.46	8.41	--	--	--	--	<50	<0.5	<0.5	<0.5	<0.5	--
09/12/94	13.87	4.99	8.88	--	--	--	--	<50	<0.5	<0.5	<0.5	<0.5	--
06/29/95	13.87	5.79	8.08	--	--	--	--	<50	<0.5	<0.5	<0.5	<0.5	--
09/13/95	13.87	5.56	8.31	--	--	--	--	<50	<0.5	<0.5	<0.5	<0.5	--
12/19/95	13.87	5.75	8.12	--	--	--	--	<50	<0.5	<0.5	<0.5	<0.5	--
03/26/96	13.87	6.19	7.68	--	--	--	--	<50	<0.5	<0.5	<0.5	<0.5	<2.5
06/10/96	13.87	5.69	8.18	--	--	--	--	<50	<0.5	<0.5	<0.5	<0.5	<2.5
09/13/96	13.87	5.01	8.86	--	--	--	Sampled annually	<50	<0.5	<0.5	<0.5	<0.5	<2.5
12/19/96	13.87	6.04	7.83	--	--	--	--	--	--	--	--	--	--
03/12/98	13.23*	6.13	7.10	--	--	--	--	--	--	--	--	--	--
08/20/98	13.23	5.14	8.09	--	--	--	--	<50	<0.5	<0.5	<0.5	<0.5	<2.5
03/25/99	13.23	5.91	7.32	--	--	--	--	<50	<0.5	<0.5	<0.5	<0.5	<2.5

* Site resurveyed on May 8, 1998.

Cumulative Table of Well Data and Analytical Results

Vertical Measurements are in feet.			Volumetric Measurements are in gallons.				Analytical results are in parts per billion (ppb)						
DATE	Well Head Elev.	Ground Water Elev.	Depth To Water	SPH Thickness	SPH Removed	Total SPH Removed	Notes	TPH-Gasoline	Benzene	Toluene	Ethyl-Benzene	Xylene	MTBE
C-7													
02/07/91	15.78	5.90	9.88	--	--	--	--	<50	<0.5	0.8	<0.5	<0.5	--
04/03/91	15.78	6.74	9.04	--	--	--	--	<50	<0.5	<0.5	<0.5	<0.5	--
07/17/91	15.78	5.92	9.86	--	--	--	--	<50	<0.5	<0.5	<0.5	<0.5	--
10/07/91	15.78	5.68	10.10	--	--	--	--	<50	<0.5	<0.5	<0.5	<0.5	--
02/04/92	15.78	6.04	9.74	--	--	--	--	<50	<0.5	<0.5	<0.5	<0.5	--
04/01/92	15.78	6.82	8.96	--	--	--	--	<50	<0.5	<0.5	<0.5	<0.5	--
06/25/92	15.78	6.16	9.62	--	--	--	--	<50	<0.5	<0.5	<0.5	<0.5	--
09/17/92	15.78	6.03	9.75	--	--	--	--	<50	<0.5	<0.5	<0.5	<0.5	--
12/16/92	15.78	6.37	9.41	--	--	--	--	--	--	--	--	<0.5	--
03/18/93	15.78	7.33	8.45	--	--	--	--	<50	<0.5	<0.5	<0.5	<1.5	--
06/11/93	15.78	7.07	8.71	--	--	--	--	<50	<0.5	<0.5	<0.5	<1.5	--
09/08/93	15.78	--	--	--	--	--	--	<50	<0.5	<0.5	<0.5	<1.5	--
09/17/93	15.78	6.73	9.05	--	--	--	--	--	--	--	--	--	--
12/23/93	15.78	6.93	8.85	--	--	--	--	<50	1.9	1.4	<0.5	3.6	--
03/07/94	15.78	7.35	8.43	--	--	--	--	<50	2.4	1.3	<0.5	0.6	--
06/17/94	15.78	6.71	9.07	--	--	--	--	<50	<0.5	<0.5	<0.5	1.2	--
09/12/94	15.78	5.98	9.80	--	--	--	--	<50	<0.5	<0.5	<0.5	<0.5	--
06/29/95	15.78	7.14	8.64	--	--	--	--	<50	<0.5	<0.5	<0.5	<0.5	--
09/13/95	15.78	6.86	8.92	--	--	--	--	<50	<0.5	<0.5	<0.5	<0.5	--
12/19/95	15.78	7.06	8.72	--	--	--	--	<50	<0.5	<0.5	<0.5	<0.5	--
03/26/96	15.78	7.86	7.92	--	--	--	--	<50	<0.5	<0.5	<0.5	<0.5	<2.5
06/10/96	15.78	7.26	8.52	--	--	--	--	<50	<0.5	<0.5	<0.5	<0.5	<2.5
09/13/96	15.78	6.66	9.12	--	--	--	Sampled annually	<50	<0.5	<0.5	<0.5	<0.5	<2.5
12/19/96	15.78	7.39	8.39	--	--	--	--	--	--	--	--	--	--
03/12/98	15.36*	8.64	6.72	--	--	--	--	--	--	--	--	--	--
08/20/98	15.36	6.11	9.25	--	--	--	--	<50	<0.5	<0.5	<0.5	<0.5	<2.5
03/25/99	15.36	7.67	7.69	--	--	--	--	<50	<0.5	<0.5	<0.5	<0.5	<2.5

* Site resurveyed on May 8, 1998.

Cumulative Table of Well Data and Analytical Results

Vertical Measurements are in feet.

Volumetric Measurements are in gallons.

Analytical results are in parts per billion (ppb)

DATE	Well	Ground	Depth	Total			Notes	TPH- Gasoline	Benzene	Toluene	Ethyl- Benzene	Xylene	MTBE
	Head Elev.	Water Elev.	To Water	SPH Thickness	SPH Removed	SPH Removed							
CR-1													
10/30/90	--	--	10.51	--	--	--	--	9600	7100	65	610	190	--
01/14/91	--	--	10.29	--	--	--	--	1500	3200	52	190	77	--
07/17/91	--	--	10.19	--	--	--	--	15,000	9300	220	680	530	--
10/07/91	--	--	10.46	--	--	--	--	17,000	7600	50	440	68	--
10/07/91	--	--	10.46	--	--	--	--	14,000	9400	52	430	110	--
02/04/92	--	--	10.12	--	--	--	--	19,000	6100	32	350	100	--
04/01/92	--	--	9.24	--	--	--	--	29,000	5300	820	380	1200	--
06/25/92	--	--	10.03	--	--	--	--	12,000	3300	280	210	460	--
09/17/92	--	--	10.30	--	--	--	--	--	--	--	--	--	--
12/16/92	--	--	9.59	--	--	--	Sheen	--	--	--	--	--	--
03/18/93	--	--	8.82	0.05	--	--	--	--	--	--	--	--	--
06/11/93	--	--	9.58	0.87	--	--	--	--	--	--	--	--	--
09/08/93	--	--	--	--	--	--	--	--	--	--	--	--	--
09/17/93	--	--	--	--	--	--	--	--	--	--	--	--	--
12/23/93	--	--	9.02	0.02	--	--	--	--	--	--	--	--	--
03/07/94	--	--	8.41	0.04	--	--	--	--	--	--	--	--	--
06/17/94	--	--	--	--	--	--	--	--	--	--	--	--	--
09/12/94	--	--	15.32	0.02	--	--	--	--	--	--	--	--	--
06/29/95	--	--	8.67	--	--	--	--	49,000	9400	310	2400	7200	--
09/13/95	--	--	9.93	0.03	0.13	0.13	--	--	--	--	--	--	--
12/19/95	--	--	8.75	--	--	0.13	--	19,000	880	48	1600	3100	4000
03/26/96	--	--	7.50	--	--	0.13	--	60	2.6	<0.5	0.86	6.3	67
06/10/96	--	--	8.15	--	--	0.13	--	1100	38	30	9.7	190	54
09/13/96	--	--	9.27	--	--	0.13	--	77	1.1	<0.5	<0.5	<0.5	33
12/19/96	--	--	7.96	--	--	0.13	--	<50	0.86	<0.5	<0.5	0.62	<2.5
03/12/98	15.33*	9.29	6.04	--	--	0.13	--	55	1.1	<0.5	<0.5	<0.5	6.0
08/20/98	15.33	7.28	8.05	--	--	0.13	--	110	4.1	0.90	0.94	<0.5	5.5
03/25/99	15.33	8.53	6.80	--	--	0.13	--	<50	<0.5	<0.5	<0.5	<0.5	2.9

* Site resurveyed on May 8, 1998.

Cumulative Table of Well Data and Analytical Results

Vertical Measurements are in feet.

Volumetric Measurements are in gallons.

Analytical results are in parts per billion (ppb)

DATE	Well Head Elev.	Ground Water Elev.	Depth To Water	SPH Thickness	SPH Removed	Total SPH Removed	Notes	TPH-Gasoline	Benzene	Toluene	Ethyl-Benzene	Xylene	MTBE
TRIP BLANK													
10/30/90	--	--	--	--	--	--	--	--	--	--	--	--	--
01/14/91	--	--	--	--	--	--	--	<50	<0.5	<0.5	<0.5	<0.5	--
02/07/91	--	--	--	--	--	--	--	<50	<0.5	<0.5	<0.5	<0.5	--
04/03/91	--	--	--	--	--	--	--	<50	<0.5	<0.5	<0.5	<0.5	--
07/17/91	--	--	--	--	--	--	--	<50	<0.5	<0.5	<0.5	<0.5	--
10/07/91	--	--	--	--	--	--	--	<50	<0.5	<0.5	<0.5	<0.5	--
02/04/92	--	--	--	--	--	--	--	<50	<0.5	<0.5	<0.5	<0.5	--
04/01/92	--	--	--	--	--	--	--	<50	<0.5	<0.5	<0.5	<0.5	--
06/25/92	--	--	--	--	--	--	--	<50	<0.5	<0.5	<0.5	<0.5	--
09/17/92	--	--	--	--	--	--	--	<50	<0.5	<0.5	<0.5	<0.5	--
12/16/92	--	--	--	--	--	--	--	<50	<0.5	<0.5	<0.5	<0.5	--
03/18/93	--	--	--	--	--	--	--	<50	<0.5	<0.5	<0.5	<1.5	--
06/11/93	--	--	--	--	--	--	--	<50	<0.5	<0.5	<0.5	<0.5	--
09/08/93	--	--	--	--	--	--	--	<50	<0.5	<0.5	<0.5	<1.5	--
09/17/93	--	--	--	--	--	--	--	--	--	--	--	--	--
12/23/93	--	--	--	--	--	--	--	<50	<0.5	<0.5	<0.5	<0.5	--
03/07/94	--	--	--	--	--	--	--	<50	<0.5	<0.5	<0.5	<0.5	--
06/17/94	--	--	--	--	--	--	--	<50	<0.5	<0.5	<0.5	<0.5	--
09/12/94	--	--	--	--	--	--	--	<50	<0.5	<0.5	<0.5	<0.5	--
06/29/95	--	--	--	--	--	--	--	<50	<0.5	<0.5	<0.5	<0.5	--
09/13/95	--	--	--	--	--	--	--	<50	<0.5	<0.5	<0.5	<0.5	--
12/19/95	--	--	--	--	--	--	--	<50	<0.5	<0.5	<0.5	<0.5	--
03/26/96	--	--	--	--	--	--	--	<50	<0.5	<0.5	<0.5	<0.5	<2.5
06/10/96	--	--	--	--	--	--	--	<50	<0.5	<0.5	<0.5	<0.5	<2.5
09/13/96	--	--	--	--	--	--	--	<50	<0.5	<0.5	<0.5	<0.5	<2.5
12/19/96	--	--	--	--	--	--	--	<50	<0.5	<0.5	<0.5	<0.5	<2.5

CONTINUED ON NEXT PAGE

Cumulative Table of Well Data and Analytical Results

Vertical Measurements are in feet.			Volumetric Measurements are in gallons.				Analytical results are in parts per billion (ppb)						
DATE	Well Head Elev.	Ground Water Elev.	Depth To Water	SPH Thickness	SPH Removed	Total SPH Removed	Notes	TPH-Gasoline	Benzene	Toluene	Ethyl-Benzene	Xylene	MTBE
TRIP BLANK (CONT'D)													
03/12/98	--	--	--	--	--	--	--	<50	<0.5	<0.5	<0.5	<0.5	<2.5
08/20/98	--	--	--	--	--	--	--	<50	<0.5	<0.5	<0.5	<0.5	<2.5
03/25/99	--	--	--	--	--	--	--	<50	<0.5	<0.5	<0.5	<0.5	<2.5

Note: Blaine Tech Services, Inc. began routine monitoring of the groundwater wells at this site on June 29, 1995.
 Earlier field data and analytical results are drawn from the October 14, 1994 Groundwater Technology, Inc. report.

ABBREVIATIONS:

TPH = Total Petroleum Hydrocarbons
 SPH = Separate Phase Hydrocarbons
 MTBE = Methyl t-Butyl Ether

Analytical Appendix



Sequoia Analytical

680 Chesapeake Drive
404 N. Wiget Lane
819 Striker Avenue, Suite 8
1455 McDowell Blvd. North, Ste. D

Redwood City, CA 94063
Walnut Creek, CA 94598
Sacramento, CA 95834
Petaluma, CA 94954

(650) 364-9600
(925) 988-9600
(916) 921-9600
(707) 792-1865

FAX (650) 364-9233
FAX (925) 988-9673
FAX (916) 921-0100
FAX (707) 792-0342

Blaine Tech Services 1680 Rogers Avenue San Jose, CA 95112 Attention: Christine Lillie	Client Project ID: Chevron #9-4587, Oakland Sample Matrix: Water Analysis Method: EPA 5030/8015 Mod./8020 First Sample #: 903-2618	Sampled: Mar 25, 1999 Received: Mar 26, 1999 Reported: Apr 12, 1999
---	---	---

QC Batch Number:	GC040799	GC040799	GC040799	GC040799	GC040799	GC040799
	802005A	802005A	802005A	802005A	802005A	802005A

TOTAL PURGEABLE PETROLEUM HYDROCARBONS with BTEX / MTBE

Analyte	Reporting Limit µg/L	Sample I.D. 903-2618 C-1	Sample I.D. 903-2619 C-2	Sample I.D. 903-2620 C-3	Sample I.D. 903-2621 C-4	Sample I.D. 903-2622 C-5	Sample I.D. 903-2623 C-6
Purgeable Hydrocarbons	50	N.D.	N.D.	N.D.	N.D.	N.D.	N.D.
Benzene	0.50	N.D.	N.D.	N.D.	N.D.	N.D.	N.D.
Toluene	0.50	N.D.	N.D.	N.D.	N.D.	N.D.	N.D.
Ethyl Benzene	0.50	N.D.	N.D.	N.D.	N.D.	N.D.	N.D.
Total Xylenes	0.50	N.D.	N.D.	N.D.	N.D.	N.D.	N.D.
MTBE	2.5	N.D.	N.D.	N.D.	N.D.	N.D.	N.D.
Chromatogram Pattern:		--	--	--	--	--	--

Quality Control Data

Report Limit Multiplication Factor:	1.0	1.0	1.0	1.0	1.0	1.0
Date Analyzed:	4/7/99	4/7/99	4/7/99	4/7/99	4/7/99	4/7/99
Instrument Identification:	HP-5	HP-5	HP-5	HP-5	HP-5	HP-5
Surrogate Recovery, %: (QC Limits = 70-130%)	89	104	100	87	89	89

Purgeable Hydrocarbons are quantitated against a fresh gasoline standard.
Analytes reported as N.D. were not detected above the stated reporting limit.

SEQUOIA ANALYTICAL, #1271

Melissa A. Brewer
Project Manager





Sequoia Analytical

680 Chesapeake Drive
404 N. Wiget Lane
819 Striker Avenue, Suite 8
1455 McDowell Blvd. North, Ste. D

Redwood City, CA 94063
Walnut Creek, CA 94598
Sacramento, CA 95834
Petaluma, CA 94954

(650) 364-9600 FAX (650) 364-9233
(925) 988-9600 FAX (925) 988-9673
(916) 921-9600 FAX (916) 921-0100
(707) 792-1865 FAX (707) 792-0342

Blaine Tech Services 1680 Rogers Avenue San Jose, CA 95112 Attention: Christine Lillie	Client Project ID: Chevron #9-4587, Oakland Sample Matrix: Water Analysis Method: EPA 5030/8015 Mod./8020 First Sample #: 903-2624	Sampled: Mar 25, 1999 Received: Mar 26, 1999 Reported: Apr 12, 1999
---	---	---

QC Batch Number:	GC040799	GC040799	GC040799
	802005A	802005A	802005A

TOTAL PURGEABLE PETROLEUM HYDROCARBONS with BTEX / MTBE

Analyte	Reporting Limit µg/L	Sample I.D. 903-2624 C-7	Sample I.D. 903-2625 CR-1	Sample I.D. 903-2626 TB
Purgeable Hydrocarbons	50	N.D.	N.D.	N.D.
Benzene	0.50	N.D.	N.D.	N.D.
Toluene	0.50	N.D.	N.D.	N.D.
Ethyl Benzene	0.50	N.D.	N.D.	N.D.
Total Xylenes	0.50	N.D.	N.D.	N.D.
MTBE	2.5	N.D.	2.9	N.D.
Chromatogram Pattern:		--	--	--

Quality Control Data

Report Limit Multiplication Factor:	1.0	1.0	1.0
Date Analyzed:	4/7/99	4/7/99	4/7/99
Instrument Identification:	HP-5	HP-5	HP-5
Surrogate Recovery, %: (QC Limits = 70-130%)	88	90	89

Purgeable Hydrocarbons are quantitated against a fresh gasoline standard.
Analytes reported as N.D. were not detected above the stated reporting limit.

SEQUOIA ANALYTICAL, #1271

Melissa A. Brewer

Melissa A. Brewer
Project Manager





Sequoia Analytical

680 Chesapeake Drive
404 N. Wiget Lane
819 Striker Avenue, Suite 8
1455 McDowell Blvd. North, Ste. D

Redwood City, CA 94063
Walnut Creek, CA 94598
Sacramento, CA 95834
Petaluma, CA 94954

(650) 364-9600
(925) 988-9600
(916) 921-9600
(707) 792-1865

FAX (650) 364-9233
FAX (925) 988-9673
FAX (916) 921-0100
FAX (707) 792-0342

Blaine Tech Services
1680 Rogers Avenue
San Jose, CA 95112
Attention: Christine Lillie

Client Project ID: Chevron #9-4587, Oakland
Matrix: Liquid

QC Sample Group: 9032618-626

Reported: Apr 12, 1999

QUALITY CONTROL DATA REPORT

Analyte:	Benzene	Toluene	Ethyl Benzene	Xylenes
QC Batch#:	GC040799 802005A	GC040799 802005A	GC040799 802005A	GC040799 802005A
Analy. Method:	EPA 8020	EPA 8020	EPA 8020	EPA 8020
Prep. Method:	EPA 5030	EPA 5030	EPA 5030	EPA 5030
Analyst:	J. Minkel	J. Minkel	J. Minkel	J. Minkel
MS/MSD #:	9032719	9032719	9032719	9032719
Sample Conc.:	N.D.	N.D.	N.D.	N.D.
Prepared Date:	4/7/99	4/7/99	4/7/99	4/7/99
Analyzed Date:	4/7/99	4/7/99	4/7/99	4/7/99
Instrument I.D.#:	HP-5	HP-5	HP-5	HP-5
Conc. Spiked:	20 µg/L	20 µg/L	20 µg/L	60 µg/L
Result:	17	18	18	56
MS % Recovery:	85	90	90	93
Dup. Result:	20	20	20	61
MSD % Recov.:	100	100	100	102
RPD:	16	11	11	8.5
RPD Limit:	0-20	0-20	0-20	0-20

LCS #:	5LCS040799	5LCS040799	5LCS040799	5LCS040799
Prepared Date:	4/7/99	4/7/99	4/7/99	4/7/99
Analyzed Date:	4/7/99	4/7/99	4/7/99	4/7/99
Instrument I.D.#:	HP-5	HP-5	HP-5	HP-5
Conc. Spiked:	20 µg/L	20 µg/L	20 µg/L	60 µg/L
LCS Result:	18	19	18	56
LCS % Recov.:	90	95	90	93

MS/MSD LCS Control Limits	70-130	70-130	70-130	70-130
---------------------------	--------	--------	--------	--------

Please Note:
The LCS is a control sample of known, interferent-free matrix that is analyzed using the same reagents, preparation, and analytical methods employed for the samples. The matrix spike is an aliquot of sample fortified with known quantities of specific compounds and subjected to the entire analytical procedure. If the recovery of analytes from the matrix spike does not fall within specified control limits due to matrix interference, the LCS recovery is to be used to validate the batch.

** MS= Matrix Spike, MSD=MS Duplicate, RPD=Relative % Difference

SEQUOIA ANALYTICAL, #1271

Melissa A. Brewer

Melissa A. Brewer
Project Manager



Field Data Sheets

CHEVRON WELL MONITORING DATA SHEET

Project #: <u>990325-H1</u>	Station #: <u>9-4587</u>
Sampler: <u>MH</u>	Date: <u>3/25/99</u>
Well I.D.: <u>C-1</u>	Well Diameter: <u>2</u> <u>3</u> 4 6 8
Total Well Depth: <u>15.44</u>	Depth to Water: <u>7.28</u>
Depth to Free Product:	Thickness of Free Product (feet):
Referenced to: <u>PVC</u> Grade	D.O. Meter (if req'd): YSI HACH

Well Diameter	Multiplier	Well Diameter	Multiplier
2"	0.16	5"	1.02
3"	0.37	6"	1.47
4"	0.65	Other	radius ² * 0.163

Purge Method: Bailer Sampling Method: Bailer

Disposable Bailer Disposable Bailer

Middleburg Extraction Port

Electric Submersible Other: _____

Extraction Pump

Other: _____

<u>3.0</u>	x	<u>3</u>	=	<u>9.0</u>	Gals.
1 Case Volume (Gals.)		Specified Volumes		Calculated Volume	

Time	Temp (°F)	pH	Cond.	Gals. Removed	Observations
1508	61.7	7.2	640	3	Turbid
1511	62.0	7.0	658	6	↓
1514	62.5	7.1	659	9	↓

Did well dewater? Yes No Gallons actually evacuated: 9

Sampling Time: 1518 Sampling Date: 3/25

Sample I.D.: C-1 Laboratory: Sequoia CORE N. Creek Assoc. Labs

Analyzed for: TPH-G BTEX MTBE TPH-D . Other:

Duplicate I.D.: Analyzed for: TPH-G BTEX MTBE TPH-D Other:

D.O. (if req'd):	Pre-purge:	mg/L	Post-purge:	mg/L
R.P. (if req'd):	Pre-purge:	mV	Post-purge:	mV

CHEVRON WELL MONITORING DATA SHEET

Project #: <u>990325-121</u>	Station #: <u>9-4587</u>
Sampler: <u>MA</u>	Date: <u>3/25/99</u>
Well I.D.: <u>C-2</u>	Well Diameter: <u>2</u> <u>3</u> 4 6 8
Total Well Depth: <u>12.28</u>	Depth to Water: <u>6.19</u>
Depth to Free Product:	Thickness of Free Product (feet):
Referenced to: <u>PVC</u> Grade	D.O. Meter (if req'd): YSI HACH

Well Diameter	Multiplier	Well Diameter	Multiplier
2"	0.16	5"	1.02
3"	0.37	6"	1.47
4"	0.65	Other	radius ² * 0.163

Purge Method: Bailer
 Disposable Bailer
 Middleburg
 Electric Submersible
 Extraction Pump
 Other: _____

Sampling Method: Bailer
 Disposable Bailer
 Extraction-Port
 Other: _____

<u>2.2</u>	X	<u>5</u>	=	<u>6.6</u>	Gals.
1 Case Volume (Gals.)		Specified Volumes		Calculated Volume	

Time	Temp (°F)	pH	Cond.	Gals. Removed	Observations
<u>1439</u>	<u>65.1</u>	<u>6.6</u>	<u>908</u>	<u>2</u>	
<u>1436</u>	<u>64.9</u>	<u>6.6</u>	<u>896</u>	<u>4</u>	
<u>1440</u>	<u>65.3</u>	<u>6.6</u>	<u>891</u>	<u>7</u>	

Did well dewater? Yes No Gallons actually evacuated: 7

Sampling Time: 1442 Sampling Date: 3/25

Sample I.D.: C-2 Laboratory: Sequoia CORE N. Creek Assoc. Labs

Analyzed for: TPH-G BTEX MTBE TPH-D . Other:

Duplicate I.D.: Analyzed for: TPH-G BTEX MTBE TPH-D Other:

D.O. (if req'd):	Pre-purge:	mg/L	Post-purge:	mg/L
	R.P. (if req'd):	mV	Post-purge:	mV

CHEVRON WELL MONITORING DATA SHEET

Project #: 990327-141	Station #: 9-4587
Sampler: MUA	Date: 3/25/99
Well I.D.: C-3	Well Diameter: 2 (3) 4 6 8
Total Well Depth: 18.40	Depth to Water: 6.98
Depth to Free Product:	Thickness of Free Product (feet):
Referenced to: PVC Grade	D.O. Meter (if req'd): YSI HACH

Well Diameter	Multiplier	Well Diameter	Multiplier
2"	0.16	5"	1.02
3"	0.37	6"	1.47
4"	0.65	Other	radius ² * 0.163

Purge Method: Bailer
 Disposable Bailer
 Middleburg
~~Electric Submersible~~
 Extraction Pump
 Other: _____

Sampling Method: Bailer
~~Disposable Bailer~~
 Extraction Port
 Other: _____

1.8 4.2	x	<u>3</u>	=	<u>5.4</u> 12.6	Gals.
1 Case Volume (Gals.)		Specified Volumes		Calculated Volume	

Time	Temp (°F)	pH	Cond.	Gals. Removed	Observations
1422	64.5	6.7	1421	5	Turbid
1423	65.3	6.7	1466	10	↓
1424	65.9	6.7	1479	15	↓

Did well dewater? Yes No Gallons actually evacuated: 15

Sampling Time: 1426 Sampling Date: 3/25

Sample I.D.: 6.9 C3 Laboratory: Sequoia CORE N. Creek Assoc. Labs

Analyzed for: IPH-G BTEX MTBE TPH-D Other: _____

Duplicate I.D.: _____ Analyzed for: TPH-G BTEX MTBE TPH-D Other: _____

D.O. (if req'd):	Pre-purge:	mg/L	Post-purge:	mg/L
	D.R.P. (if req'd):	Pre-purge:	mV	Post-purge:

CHEVRON WELL MONITORING DATA SHEET

Project #: 990325-41	Station #: 9-4587
Sampler: MA	Date: 3/25/99
Well I.D.: C-4	Well Diameter: <u>2</u> 3 4 6 8
Total Well Depth: 29.25	Depth to Water: 8.12
Depth to Free Product:	Thickness of Free Product (feet):
Referenced to: <u>PVC</u> Grade	D.O. Meter (if req'd): YSI HACH

Well Diameter	Multiplier	Well Diameter	Multiplier
2"	0.16	5"	1.02
3"	0.37	6"	1.47
4"	0.65	Other	radius ² * 0.163

Purge Method: Bailer
 Disposable Bailer
Middleburg
 Electric Submersible
 Extraction Pump
 Other: _____

Sampling Method: Bailer
Disposable Bailer
 Extraction Port
 Other: _____

<u>3.3</u>	x	<u>5</u>	=	<u>7.9</u>	Gals.
1 Case Volume (Gals.)		Specified Volumes		Calculated Volume	

Time	Temp (°F)	pH	Cond.	Gals. Removed	Observations
1408	68.7	6.7	473	4	
1411	68.8	6.6	483	7	
1414	69.0	6.6	489	10	

Did well dewater? Yes No Gallons actually evacuated: 10

Sampling Time: 1416 Sampling Date: 3/25

Sample I.D.: C-4 Laboratory: Sequoia CORE N. Creek Assoc. Labs

Analyzed for: TPH-G BTEX MTBE TPH-D Other: _____

Duplicate I.D.: _____ Analyzed for: TPH-G BTEX MTBE TPH-D Other: _____

D.O. (if req'd):	Pre-purge:	mg/L	Post-purge:	mg/L
D.R.P. (if req'd):	Pre-purge:	mV	Post-purge:	mV

CHEVRON WELL MONITORING DATA SHEET

Project #: 990325-41	Station #: 9-4587
Sampler: MB	Date: 3/25/99
Well I.D.: C-5	Well Diameter: <u>2</u> 3 4 6 8
Total Well Depth: 28.70	Depth to Water: 7.35
Depth to Free Product:	Thickness of Free Product (feet):
Referenced to: <u>PVC</u> Grade	D.O. Meter (if req'd): YSI HACH

Well Diameter	Multiplier	Well Diameter	Multiplier
2"	0.16	5"	1.02
3"	0.37	6"	1.47
4"	0.65	Other	radius ² * 0.163

Purge Method: Bailer Sampling Method: Bailer
 Disposable Bailer Disposable Bailer
 Middleburg Extraction Port
 Electric Submersible Other: _____
 Extraction Pump

<u>3.4</u>	x	<u>3</u>	=	<u>10.2</u>	Gals.
1 Case Volume (Gals.)		Specified Volumes		Calculated Volume	

Time	Temp (°F)	pH	Cond.	Gals. Removed	Observations
1346	67.9	6.8	543	4	Brown / slightly turbid
1550	68.3	6.8	574	8	" "
1353	68.5	6.8	519	11	Cleaned up

Did well dewater? Yes No Gallons actually evacuated: 11

Sampling Time: 1355 Sampling Date: 3/25

Sample I.D.: C-5 Laboratory: Sequoia CORE N. Creek Assoc. Labs

Analyzed for: TPH-G BTEX MTBE TPH-D Other: _____

Duplicate I.D.: _____ Analyzed for: TPH-G BTEX MTBE TPH-D Other: _____

D.O. (if req'd):	Pre-purge:	mg/L	Post-purge:	mg/L
	D.R.P. (if req'd):	Pre-purge:	mV	Post-purge:

CHEVRON WELL MONITORING DATA SHEET

Project #: 4903 25-H1	Station #: 9-4587
Sampler: MIA	Date: 3/25/99
Well I.D.: C-6	Well Diameter: <u>2</u> 3 4 6 8
Total Well Depth: 28.60	Depth to Water: 7.32
Depth to Free Product:	Thickness of Free Product (feet):
Referenced to: <u>PVC</u> Grade	D.O. Meter (if req'd): YSI HACH

Well Diameter	Multiplier	Well Diameter	Multiplier
2"	0.16	5"	1.02
3"	0.37	6"	1.47
4"	0.65	Other	radius ² * 0.163

Purge Method: Bailer
 Disposable Bailer
Middleburg
 Electric Submersible
 Extraction Pump
 Other: _____

Sampling Method: Bailer
Disposable Bailer
 Extraction Port
 Other: _____

<u>3.4</u>	x	<u>3</u>	=	<u>10.2</u>	Gals.
1 Case Volume (Gals.)		Specified Volumes		Calculated Volume	

Time	Temp (°F)	pH	Cond.	Gals. Removed	Observations
1328	65.9	6.8	559	4	
1332	66.3	6.8	507	8	
1335	66.4	6.8	471	11	

Did well dewater? Yes No Gallons actually evacuated: 11

Sampling Time: 1338 Sampling Date: 3/25

Sample I.D.: C-6 Laboratory: Sequoia CORE N. Creek Assoc. Labs

Analyzed for: TPH-G BTEX MTBE TPH-D Other: _____

Duplicate I.D.: _____ Analyzed for: TPH-G BTEX MTBE TPH-D Other: _____

D.O. (if req'd):	Pre-purge:	mg/L	Post-purge:	mg/L
	D.R.P. (if req'd):	Pre-purge:	mV	Post-purge:

CHEVRON WELL MONITORING DATA SHEET

Project #: 990325-41	Station #: 9-4587
Sampler: MHA	Date: 3/25/89
Well I.D.: C-7	Well Diameter: (2) 3 4 6 8
Total Well Depth: 27.04	Depth to Water: 7.69
Depth to Free Product:	Thickness of Free Product (feet):
Referenced to: (PVC) Grade	D.O. Meter (if req'd): YSI HACH

Well Diameter	Multiplier	Well Diameter	Multiplier
2"	0.16	5"	1.02
3"	0.37	6"	1.47
4"	0.65	Other	radius ² * 0.163

Purge Method: Bailer Disposable Bailer Middleburg Electric Submersible Extraction Pump

Other: _____

Sampling Method: Bailer Disposable Bailer Extraction Port

Other: _____

3.0	x	3	=	7.0	Gals.
1 Case Volume (Gals.)		Specified Volumes		Calculated Volume	

Time	Temp (°F)	pH	Cond.	Gals. Removed	Observations
1309	66.7	6.7	595	3	Turbid
312	66.8	6.7	588	6	
1315	66.0	6.7	586	9	↓

Did well dewater? Yes No Gallons actually evacuated: 9

Sampling Time: 1318 Sampling Date: 3/25

Sample I.D.: C-7 Laboratory: Sequoia CORE N. Creek ~~Assoc. Labs~~

Analyzed for: TPH-G BTEX MTBE TPH-D Other:

Duplicate I.D.: Analyzed for: TPH-G BTEX MTBE TPH-D Other:

D.O. (if req'd):	Pre-purge:	mg/L	Post-purge:	mg/L
	R.P. (if req'd):	mV	Post-purge:	mV

CHEVRON WELL MONITORING DATA SHEET

Project #: 990325-H1	Station #: 9-4587
Sampler: MHA	Date: 3/25/99
Well I.D.: CR-01	Well Diameter: 2 3 4 <u>6</u> 8
Total Well Depth: 27.25	Depth to Water: 6.80
Depth to Free Product:	Thickness of Free Product (feet):
Referenced to: <u>PVC</u> Grade	D.O. Meter (if req'd): YSI HACH

Well Diameter	Multiplier	Well Diameter	Multiplier
2"	0.16	5"	1.02
3"	0.37	6"	1.47
4"	0.65	Other	radius ² * 0.163

Purge Method: Bailer Disposable Bailer Middleburg Electric Submersible Extraction Pump

Other: _____

Sampling Method: Bailer Disposable Bailer Extraction Port

Other: _____

<u>30.0</u>	x	<u>3</u>	=	<u>90.0</u>	Gals.
1 Case Volume (Gals.)		Specified Volumes		Calculated Volume	

Time	Temp (°F)	pH	Cond.	Gals. Removed	Observations
1450	67.2	6.9	802	30	Faint odor
1454	66.4	7.0	680	60	
1458	66.8	7.0	619	90	↓

Did well dewater? Yes No

Gallons actually evacuated: 90

Sampling Time: 1500 Sampling Date: 3/25

Sample I.D.: CR-01 Laboratory: Sequoia CORE N. Creek Assoc. Labs

Analyzed for: TPH-G BTEX MTBE TPH-D Other: _____

Duplicate I.D.: _____ Analyzed for: TPH-G BTEX MTBE TPH-D Other: _____

D.O. (if req'd):	Pre-purge:	mg/L	Post-purge:	mg/L
	D.R.P. (if req'd):	Pre-purge:	mV	Post-purge: