



Chevron U.S.A. Products Company

2410 Camino Ramon, San Ramon, California • Phone (510) 842-9500
Mail Address: P.O. Box 5004, San Ramon, CA 94583-0804

92 AUG 11 11:47

Marketing Department

August 9, 1992

Mr. Dennis Byrne
Alameda County Health Care Services
80 Swan Way, Room 200
Oakland, CA 94621

STID 4037

**Re: Chevron Service Station #9-4587
609 Oak Street, Oakland**

94607

Dear Mr. Byrne:

+8,800 ppb
in C-1

Enclosed we are forwarding the Quarterly Ground Water Monitoring Report dated August 4, 1992, prepared by our consultant Alton Geoscience for the above referenced site. As indicated in the report, groundwater samples collected were analyzed for total petroleum hydrocarbons as gasoline and BTEX. Benzene was detected in monitor wells C-2, C-5 and CR-1 at concentrations of 3,400, 2.5 and 3,300 ppb, respectively. Separate-phase hydrocarbons were observed in monitor well C-1 and tank pit backfill wells B and C at measured thicknesses of .01, .68 and .12-feet, respectively. Approximately .80 gallons of separate-phase hydrocarbons were removed during this quarter. Purging of the separate-phase hydrocarbons will continue on a monthly basis until a dedicated recovery system can be installed.

Our consultant is currently preparing a corrective action work plan for your review and concurrence. Chevron will continue to examine all monitor wells for the presence of separate-phase hydrocarbons on a monthly basis and perform quarterly chemical analysis. Monitor wells which exhibit separate-phase hydrocarbons will be bailed during these inspections.

If you have any questions or comments, please do not hesitate to contact me at (510) 842-9581.

Very truly yours,
CHEVRON U.S.A. PRODUCTS COMPANY

Nancy Vukelich
Site Assessment and Remediation Engineer

Enclosure

cc: Mr. Rich Hiatt, RWQCB
Mr. S.A. Willer
File (9-4587Q3)



August 4, 1992

Ms. Nancy Vukelich
Chevron U.S.A. Products Company
Post Office Box 5004
San Ramon, California 94583-0804

31-0564

Subject: Quarterly Ground Water Monitoring Report
Chevron Station No. 9-4587
609 Oak Street
Oakland, California

Dear Ms. Vukelich:

In accordance with our agreement, Alton Geoscience transmits this Quarterly Ground Water Monitoring and Sampling Report for Chevron Station No. 9-4587, located at 609 Oak Street, Oakland, California. Figure 1 shows the site location.

Monitoring and sampling of the ground water monitoring wells was performed on June 25, 1992, in accordance with the requirements and procedures of the California Regional Water Quality Control Board (RWQCB) and local regulatory agencies.

FIELD PROCEDURES

Prior to purging and sampling the wells, each well was checked for liquid-phase hydrocarbons or sheen. The depth to ground water and, if present, free product was measured in each well from the top of casing using an electronic interface probe with 0.01 foot tolerance.

Ground water samples were collected after more than 3 casing volumes of ground water was purged from each well. Each sample was collected using a clean bailer. Ground water samples were then decanted into the appropriate clean sample containers for delivery to a California-certified laboratory following proper preservation and chain of custody procedures. Purged ground water was transferred to a 600 gallon, trailer-mounted, steel tank (California Department of Health Services registered), and transported, as non-hazardous, to the Chevron Richmond Terminal for treatment.

Ms. Nancy Vukelich
August 4, 1992
Page 2

31-0564

SAMPLING AND ANALYTICAL RESULTS

The results of the monitoring and laboratory analyses of ground water samples for this quarter, as well as the results of previous monitoring and sampling events, are summarized in Table 1. Based on the previous wellhead elevation survey data and depth to water measurements collected during this monitoring event, ground water elevations and the general ground water gradient direction at this site are presented in Figure 2.

Free product was observed in monitoring wells C-1, C-B, C-C, and CR-1. Since September 1991, Alton Geoscience has been removing free product from these wells on a monthly basis. Approximately .80 gallons of free product, in total, has been manually recovered from the wells since the previous sampling event on April 1, 1992. Table 2 illustrates the ongoing ground water monitoring at the site. The official laboratory reports and chain of custody records are included in Appendix A.

Please call Dale P. Swain at (510) 734-8134 if you have any questions regarding this report.

Sincerely,

ALTON GEOSCIENCE,



Dale P. Swain
Staff Scientist

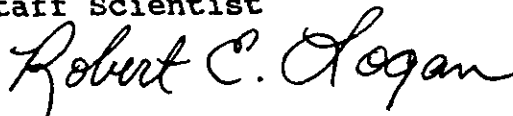

Robert E. Logan R. G. 5088
Manager, Northern California Operations

wp94587ds

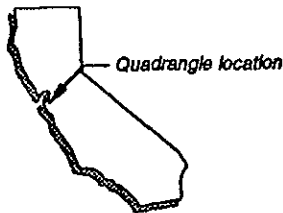
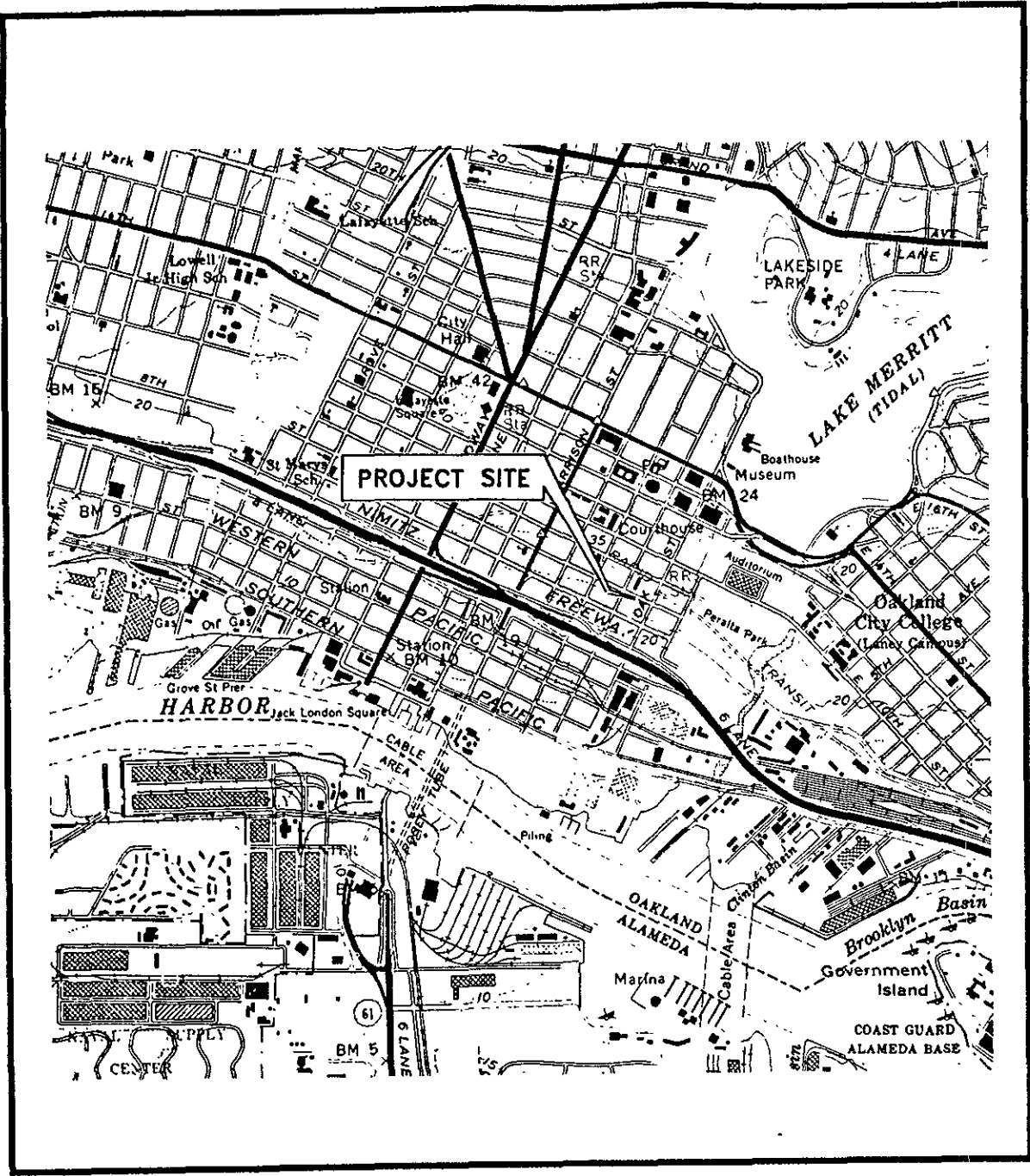

Source: U.S.G.S. Map
Oakland West Quadrangle
California
7.5 Minute Series

SITE VICINITY MAP

Chevron Station No. 9-4587
609 Oak Street
Oakland, California

FIGURE 1



Project No. 31-0564

LEGEND

- ⊕ C-7 Ground water monitoring well
- 6.16 Ground water elevation, feet above mean sea level [NGVD-1929]
- Ground water elevation contour line
- ➔ General direction of ground water gradient
- P/L Property line

where is w.o. tank?
 where are C-B + C-C? + C-A? - see 4-92 report.

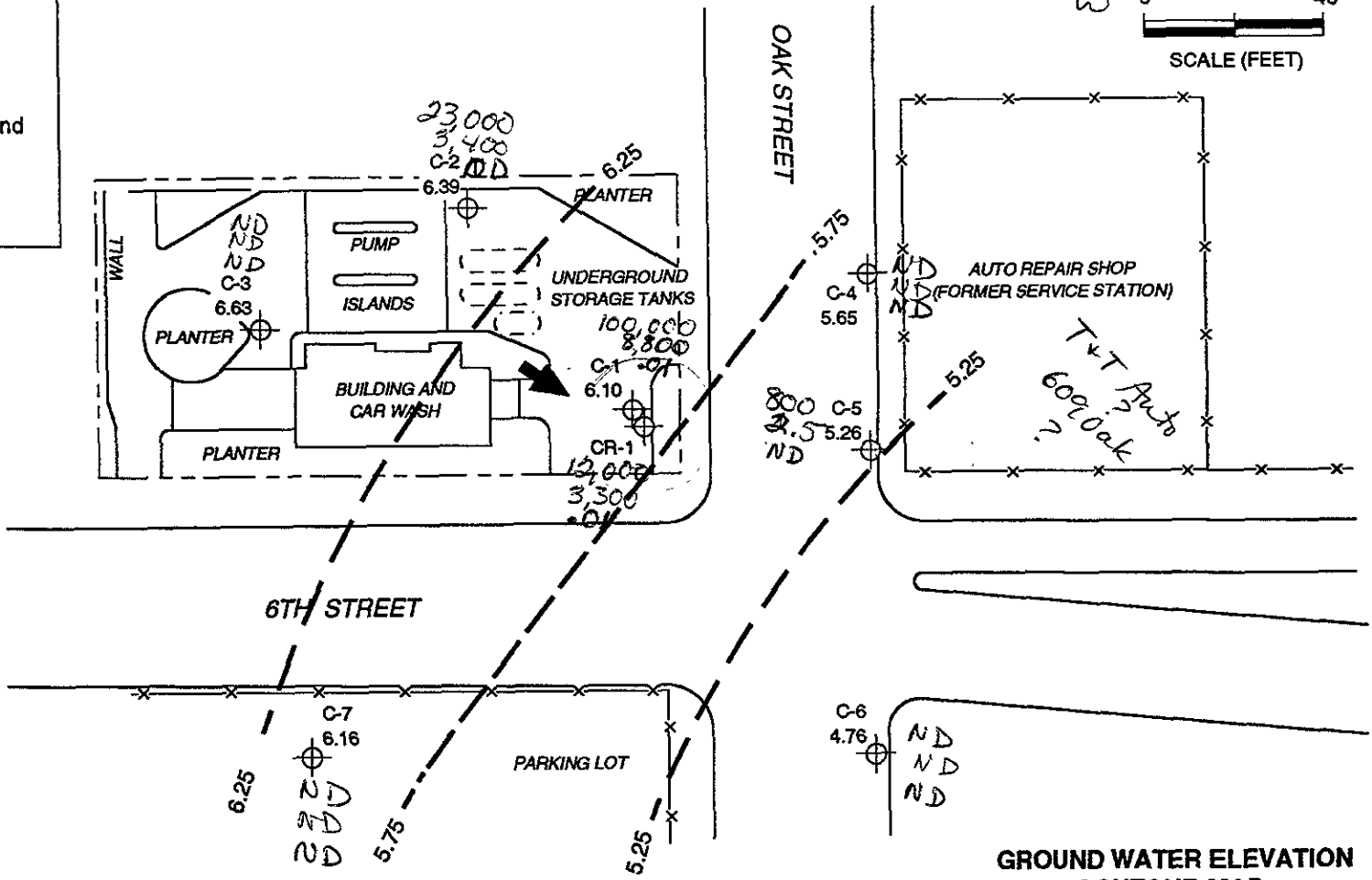
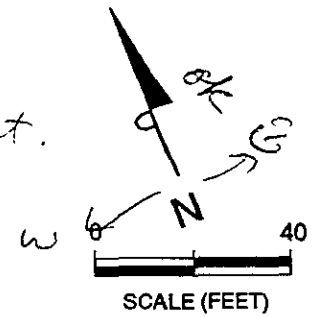

TPH-g (ppb)
 Benz (ppb)
 Free Product (ft.)

NOTES:
 Contour lines are interpretive based on fluid levels collected June 25, 1992.
 Contour interval = 0.25 foot.

$$\text{gradient} = \frac{6.39 - 5.26}{2.5 \frac{1}{8}''} = \frac{1.13}{2 \frac{1}{8}} = \frac{1.13}{2.625''} = \frac{1.13'}{105'} = 0.011 \text{ ft/ft}$$

$$2.625'' \times \frac{40'}{\text{inch}} = 105'$$

GROUND WATER ELEVATION CONTOUR MAP

Chevron Station No. 9-4587
 609 Oak Street
 Oakland, California

FIGURE 2



Table 1
 Summary of Results of Ground Water Sampling
 Chevron Station No. 9-4587
 609 Oak Street, Oakland, California

Concentrations in parts per billion (ppb)

WELL ID	DATE OF SAMPLING/ MONITORING	TOP OF WELL BOX ELEVATION	DEPTH TO WATER	FREE PRODUCT THICKNESS	FREE PRODUCT BAILED (GALLONS)	GROUND WATER ELEVATION	TPH-G	B	T	E	X	LAB
C-A	12/06/89	---	---	0.00	0.00	---	44000	20000	66	1600	2220	NA
C-A	10/30/90	---	11.20	SHEEN	0.00	---	31000	23000	110	1100	160	SAL
C-AD	10/30/90	---	11.20	SHEEN	0.00	---	30000	23000	150	1000	180	SAL
C-A	01/14/91	---	11.25	0.00	0.00	---	12000	30000	540	1400	560	SAL
C-A	04/03/91	---	9.82	0.00	0.00	---	59000	33000	2400	2200	3100	SAL
C-A	07/17/91	---	10.93	0.00	0.00	---	52000	38000	380	1300	500	SAL
C-A***	10/07/91	---	---	---	---	---	---	---	---	---	---	NA
C-A***	06/25/92	---	---	---	---	---	---	---	---	---	---	NA
C-B	12/06/89	---	---	0.01	---	---	---	---	---	---	---	NA
C-B	10/30/90	---	11.19	0.01	---	---	---	---	---	---	---	NA
C-B	01/14/91	---	11.40	0.01	---	---	---	---	---	---	---	NA
C-B	04/03/91	---	9.55	1.00	---	---	---	---	---	---	---	NA
C-B	04/04/91	---	10.54	1.06	0.75	---	---	---	---	---	---	NA
C-B	07/17/91	---	10.84	0.03	---	---	---	---	---	---	---	NA
C-B	10/07/91	---	11.10	0.04	0.01	---	---	---	---	---	---	NA
C-B	02/04/92	---	10.78	0.01	0.01	---	---	---	---	---	---	NA
C-B	03/06/92	---	---	---	---	---	---	---	---	---	---	NA
C-B	04/01/92	---	10.33	1.02	0.15	---	---	---	---	---	---	NA
C-B	06/25/92	---	11.20	0.68	0.10	---	---	---	---	---	---	NA
C-C	12/06/89	---	---	0.15	---	---	---	---	---	---	---	NA
C-C	10/30/90	---	10.84	0.03	---	---	---	---	---	---	---	NA
C-C	01/14/91	---	11.01	0.11	---	---	---	---	---	---	---	NA
C-C	04/03/91	---	9.19	0.02	---	---	---	---	---	---	---	NA
C-C	07/17/91	---	10.53	0.03	---	---	---	---	---	---	---	NA
C-C	10/07/91	---	10.98	0.08	0.01	---	---	---	---	---	---	NA
C-C	02/04/92	---	10.45	0.09	0.10	---	---	---	---	---	---	NA
C-C	03/06/92	---	8.83	0.09	0.10	---	---	---	---	---	---	NA
C-C	04/01/92	---	9.23	0.16	0.10	---	---	---	---	---	---	NA
C-C	06/25/92	---	10.40	0.12	0.06	---	---	---	---	---	---	NA

What happened to C-A? location? & monitoring?

Table 1
 Summary of Results of Ground Water Sampling
 Chevron Station No. 9-4587
 609 Oak Street, Oakland, California
 Concentrations in parts per billion (ppb)

WELL ID	DATE OF SAMPLING/ MONITORING	TOP OF WELL BOX ELEVATION	DEPTH TO WATER	FREE PRODUCT THICKNESS	FREE PRODUCT BAILED (GALLONS)	GROUND WATER ELEVATION	TPH-G	B	T	E	X	LAB
C-1	12/06/89	16.07	---	0.20	---	---	---	---	---	---	---	NA
C-1	10/30/90	16.07	10.79	0.02	---	5.30	---	---	---	---	---	NA
C-1	01/14/91	16.07	11.39	0.02	---	4.70	---	---	---	---	---	NA
C-1	04/03/91	16.07	9.43	0.02	---	6.66	---	---	---	---	---	NA
C-1	07/17/91	16.07	10.46	0.04	---	5.64	---	---	---	---	---	NA
C-1	10/07/91	16.07	10.74	0.04	0.01	5.36	---	---	---	---	---	NA
C-1	02/04/92	16.07	10.37	0.01	0.01	5.71	---	---	---	---	---	NA
C-1	03/06/92	16.07	9.20	0.00	0.00	6.87	---	---	---	---	---	NA
C-1	04/01/92	16.07	9.28	0.00	0.00	6.79	---	---	---	---	---	NA
C-1	06/25/92	16.07	9.98	0.01	0.01	6.10	100000	8800	7000	2800	19000	SAL
C-2	12/06/89	16.84	---	0.00	0.00	---	16000	250	1200	550	1400	NA
C-2	10/30/90	16.84	11.16	0.00	0.00	5.68	28000	3700	1900	1200	4300	SAL
C-2	01/14/91	16.84	11.11	0.00	0.00	5.73	24000	3300	1200	1100	4100	SAL
C-20	01/14/91	16.84	11.11	0.00	0.00	5.73	30000	3900	1500	1500	5000	SAL
C-2	04/03/91	16.84	9.53	0.00	0.00	7.31	12000	1100	840	650	1800	SAL
C-20	04/03/91	16.84	9.53	0.00	0.00	7.31	14000	1100	990	680	1800	SAL
C-2	07/17/91	16.84	10.68	0.00	0.00	6.16	13000	1700	560	650	1700	SAL
C-20	07/17/91	16.84	10.68	0.00	0.00	6.16	14000	1700	640	720	1900	SAL
C-2	10/07/91	16.84	11.02	0.00	0.00	5.82	25000	3700	1300	1400	3800	SAL
C-2	02/04/92	16.84	10.60	0.00	0.00	6.24	16000	2600	300	880	1900	SAL
C-2	04/01/92	16.84	9.30	0.00	0.00	7.54	15000	1900	300	700	1500	SAL
C-2	06/25/92	16.84	10.45	0.00	0.00	6.39	23000	3400	740	1300	3400	SAL
C-3	12/06/89	16.48	---	0.00	0.00	---	ND<500	ND<0.5	ND<0.5	ND<0.5	0.74	NA
C-3	10/30/90	16.48	10.44	0.00	0.00	6.04	410	4	4	2	9	SAL
C-3	01/14/91	16.48	10.34	0.00	0.00	6.14	80	ND<0.5	ND<0.5	ND<0.5	1	SAL
C-3	04/03/91	16.48	9.01	0.00	0.00	7.47	53	ND<0.5	ND<0.5	ND<0.5	2	SAL
C-3	07/17/91	16.48	10.00	0.00	0.00	6.48	ND<50	5.9	ND<0.5	ND<0.5	ND<0.5	SAL
C-3	10/07/91	16.48	10.38	0.00	0.00	6.10	ND<50	ND<0.5	ND<0.5	ND<0.5	ND<0.5	SAL
C-3	02/04/92	16.48	10.00	0.00	0.00	6.48	ND<50	ND<0.5	ND<0.5	ND<0.5	ND<0.5	SAL
C-3	04/01/92	16.48	8.83	0.00	0.00	7.65	ND<50	ND<0.5	ND<0.5	ND<0.5	ND<0.5	SAL
C-3	06/25/92	16.48	9.85	0.00	0.00	6.63	ND<50	ND<0.5	ND<0.5	ND<0.5	ND<0.5	SAL

Table 1
 Summary of Results of Ground Water Sampling
 Chevron Station No. 9-4587
 609 Oak Street, Oakland, California
 Concentrations in parts per billion (ppb)

WELL ID	DATE OF SAMPLING/ MONITORING	TOP OF WELL BOX ELEVATION	DEPTH TO WATER	FREE PRODUCT THICKNESS	FREE PRODUCT BAILED (GALLONS)	GROUND WATER ELEVATION	TPH-G	B	T	E	X	LAB
C-4	12/06/89	16.53	---	0.00	0.00	---	---	---	---	---	---	NA
C-4	10/30/90	16.53	11.56	0.00	0.00	4.97	ND<50	ND<0.5	ND<0.5	ND<0.5	ND<0.5	SAL
C-4	01/14/91	16.53	11.44	0.00	0.00	5.09	ND<50	ND<0.5	ND<0.5	ND<0.5	ND<0.5	SAL
C-4	04/03/91	16.53	10.00	0.00	0.00	6.53	150	3	ND<0.5	12	9	SAL
C-4	07/17/91	16.53	11.16	0.00	0.00	5.37	290	2.3	0.4	52	0.4	SAL
C-4	10/07/91	16.53	11.39	0.00	0.00	5.14	ND<50	ND<0.5	ND<0.5	4.6	ND<0.5	SAL
C-4	02/04/92	16.53	11.02	0.00	0.00	5.51	ND<50	ND<0.5	ND<0.5	2.8	ND<0.5	SAL
C-4D	02/04/92	16.53	11.02	0.00	0.00	5.51	ND<50	ND<0.5	ND<0.5	2.5	0.5	SAL
C-4	04/01/92	16.53	9.83	0.00	0.00	6.70	480	4.9	ND<0.5	64	4.3	SAL
C-4	06/25/92	16.53	10.88	0.00	0.00	5.65	ND<50	ND<0.5	ND<0.5	ND<0.5	ND<0.5	SAL
C-5	12/06/89	14.70	9.97	0.00	0.00	4.73	---	---	---	---	---	NA
C-5	10/30/90	14.70	---	0.00	0.00	---	ND<50	0.8	ND<0.5	ND<0.5	0.5	SAL
C-5	01/14/91	14.70	9.87	0.00	0.00	4.83	54	ND<0.5	ND<0.5	ND<0.5	ND<0.5	SAL
C-5	04/03/91	14.70	8.72	0.00	0.00	5.98	1800	330	200	52	170	SAL
C-5	07/17/91	14.70	9.63	0.00	0.00	5.07	170	120	5.3	12	20	SAL
C-5	10/07/91	14.70	9.83	0.00	0.00	4.87	ND<50	1.1	ND<0.5	ND<0.5	ND<0.5	SAL
C-5	02/04/92	14.70	9.53	0.00	0.00	5.17	91	16	ND<0.5	2.4	2.0	SAL
C-5	04/01/92	14.70	8.57	0.00	0.00	6.13	960	200	5.4	21	33	SAL
C-5	06/25/92	14.70	9.44	0.00	0.00	5.26	800	2.5	ND<0.5	1.3	7.3	SAL
C-6	12/06/89	13.87	---	0.00	0.00	---	---	---	---	---	---	NA
C-6	10/30/90	13.87	9.43	0.00	0.00	4.44	ND<50	ND<0.5	ND<0.5	ND<0.5	ND<0.5	SAL
C-6	01/14/91	13.87	9.41	0.00	0.00	4.46	ND<0.5	ND<0.5	ND<0.5	ND<0.5	ND<0.5	SAL
C-6	04/03/91	13.87	8.66	0.00	0.00	5.21	ND<0.5	ND<0.5	ND<0.5	ND<0.5	ND<0.5	SAL
C-6	07/17/91	13.87	9.25	0.00	0.00	4.62	ND<0.5	ND<0.5	ND<0.5	ND<0.5	ND<0.5	SAL
C-6	10/07/91	13.87	9.34	0.00	0.00	4.53	67	ND<0.5	0.6	ND<0.5	0.6	SAL
C-6	02/04/92	13.87	9.16	0.00	0.00	4.71	ND<50	ND<0.5	ND<0.5	ND<0.5	ND<0.5	SAL
C-6	04/01/92	13.87	8.59	0.00	0.00	5.28	ND<50	ND<0.5	ND<0.5	ND<0.5	ND<0.5	SAL
C-6	06/25/92	13.87	9.11	0.00	0.00	4.76	ND<50	ND<0.5	ND<0.5	ND<0.5	ND<0.5	SAL

Table 1
 Summary of Results of Ground Water Sampling
 Chevron Station No. 9-4587
 609 Oak Street, Oakland, California

Concentrations in parts per billion (ppb)

WELL ID	DATE OF SAMPLING/ MONITORING	TOP OF WELL BOX ELEVATION	DEPTH TO WATER	FREE PRODUCT THICKNESS	FREE PRODUCT BAILED (GALLONS)	GROUND WATER ELEVATION	TPH-G	B	T	E	X	LAB
C-7	02/07/91	15.78	9.88	0.00	0.00	5.90	ND<50	ND<0.5	0.8	ND<0.5	ND<0.5	SAL
C-7	04/03/91	15.78	9.04	0.00	0.00	6.74	ND<50	ND<0.5	ND<0.5	ND<0.5	ND<0.5	SAL
C-7	07/17/91	15.78	9.86	0.00	0.00	5.92	ND<50	ND<0.5	ND<0.5	ND<0.5	ND<0.5	SAL
C-7	10/07/91	15.78	10.10	0.00	0.00	5.68	ND<50	ND<0.5	ND<0.5	ND<0.5	ND<0.5	SAL
C-7	02/04/92	15.78	9.74	0.00	0.00	6.04	ND<50	ND<0.5	ND<0.5	ND<0.5	ND<0.5	SAL
C-7	04/01/92	15.78	8.96	0.00	0.00	6.82	ND<50	ND<0.5	ND<0.5	ND<0.5	ND<0.5	SAL
C-7	06/25/92	15.78	9.62	0.00	0.00	6.16	ND<50	ND<0.5	ND<0.5	ND<0.5	ND<0.5	SAL
CR-1**	10/30/90	---	10.51	---	---	---	9600	7100	65	610	190	SAL
CR-1	01/14/91	---	10.29	0.00	0.00	---	1500	3200	52	190	77	SAL
CR-1	07/17/91	---	10.19	0.00	0.00	---	15000	9300	220	680	530	SAL
CR-1	10/07/91	---	10.46	0.00	0.00	---	17000	7600	50	440	68	SAL
CR-1D	10/07/91	---	10.46	0.00	0.00	---	14000	9400	52	430	110	SAL
CR-1	02/04/92	---	10.12	0.00	0.00	---	19000	6100	32	350	100	SAL
CR-1	04/01/92	---	9.24	0.00	0.00	---	29000	5300	820	380	1200	SAL
CR-1	06/25/92	---	10.03	0.01	0.02	---	12000	3300	280	210	460	SAL
TB*	10/30/90	---	---	---	---	---	---	---	---	---	---	NA
TB	01/14/91	---	---	---	---	---	ND<50	ND<0.5	ND<0.5	ND<0.5	ND<0.5	SAL
TB	02/07/91	---	---	---	---	---	ND<50	ND<0.5	ND<0.5	ND<0.5	ND<0.5	SAL
TB	04/03/91	---	---	---	---	---	ND<50	ND<0.5	ND<0.5	ND<0.5	ND<0.5	SAL
TB	07/17/91	---	---	---	---	---	ND<50	ND<0.5	ND<0.5	ND<0.5	ND<0.5	SAL
TB	10/07/91	---	---	---	---	---	ND<50	ND<0.5	ND<0.5	ND<0.5	ND<0.5	SAL
TB	02/04/92	---	---	---	---	---	ND<50	ND<0.5	ND<0.5	ND<0.5	ND<0.5	SAL
TB	04/01/92	---	---	---	---	---	ND<50	ND<0.5	ND<0.5	ND<0.5	ND<0.5	SAL
TB	06/25/92	---	---	---	---	---	ND<50	ND<0.5	ND<0.5	ND<0.5	ND<0.5	SAL

Table 1
 Summary of Results of Ground Water Sampling
 Chevron Station No. 9-4587
 609 Oak Street, Oakland, California

Concentrations in parts per billion (ppb)

WELL ID	DATE OF SAMPLING/ MONITORING	TOP OF WELL BOX ELEVATION	DEPTH TO WATER	FREE PRODUCT THICKNESS	FREE PRODUCT BAILED (GALLONS)	GROUND WATER ELEVATION	TPH-G	B	T	E	X	LAB
RINSATE	10/30/90	---	---	---	---	---	ND<50	ND<0.5	0.6	ND<0.5	ND<0.5	SAL
RINSATE	10/07/91	---	---	---	---	---	ND<50	ND<0.5	0.5	ND<0.5	ND<0.5	SAL
RINSATE	02/04/92	---	---	---	---	---	ND<50	ND<0.5	ND<0.5	ND<0.5	ND<0.5	SAL
RINSATE	04/01/92	---	---	---	---	---	ND<50	ND<0.5	ND<0.5	ND<0.5	ND<0.5	SAL
RINSATE	06/25/92	---	---	---	---	---	ND<50	ND<0.5	ND<0.5	ND<0.5	ND<0.5	SAL

EXPLANATION OF ABBREVIATIONS:

TPH-G :Total Petroleum Hydrocarbons as Gasoline (EPA method 8015 modified)
 B :Benzene (EPA method 8020 or 8240)
 T :Toluene (EPA method 8020 or 8240)
 E :Ethylbenzene (EPA method 8020 or 8240)
 X :Xylenes (EPA method 8020 or 8240)
 --- :Not Analyzed/Not Measured
 NA :Not Applicable/Not Available
 ND :Not Detected
 TB :Trip Blank
 D :Duplicate
 SAL :Superior Analytical Laboratory
 * :TB on 10/30/90 was broken
 *** :Unable to locate well.

** :The following constituents were detected in one ground water sample collected from well CR-1 on October 30, 1990:

:1,2-Dichloroethane -EPA Method 8240 60 ppb
 :Di-n-octylphthalate EPA Method 8270 13 ppb
 :2-MethylnaphthaleneEPA Method 8270 10 ppb
 :Naphthalene - EPA Method 8270 47 ppb
 :2,4-Dimethylphenol -EPA Method 8270 16 ppb
 :4-Nitrophenol - EPA Method 8270 9 ppb
 :Phenol - EPA Method 8270 47 ppb
 :Arsenic - EPA Method 206.2 22 ppb
 :Chromium - EPA Method 200.7 15 ppb
 :Copper - EPA Method 200.7 8 ppb
 :Lead - EPA Method 239.2 61 ppb
 :Mercury - EPA Method 245.1 0.6 ppb
 :Nickel - EPA Method 200.7 20 ppb
 :Zinc - EPA Method 200.7 13 ppb

Note :Top of well box and ground water elevations are expressed as feet above mean sea level (NGVD - 1229).

Table 2
 Summary of Results of Ground Water Monitoring
 Chevron Station No. 9-4587
 609 Oak Street, Oakland, California

Concentrations in parts per billion (ppb)

WELL ID	DATE OF MONITORING	TOP OF WELL BOX ELEV.	DEPTH TO WATER	FREE PRODUCT THICKNESS	FREE PRODUCT BAILED (GALLONS)	GROUND WATER ELEV.
C-A	12/06/89	---	---	0.00	0.00	---
C-A	10/30/90	---	11.20	SHEEN	0.00	---
C-A	12/06/90	---	11.27	0.00	0.00	---
C-A	12/13/90	---	11.25	0.00	0.00	---
C-A	12/20/90	---	11.20	0.00	0.00	---
C-A	12/27/90	---	11.15	0.00	0.00	---
C-A	01/03/91	---	11.16	0.00	0.00	---
C-A	01/10/91	---	11.09	0.00	0.00	---
C-A	01/14/91	---	11.25	0.00	0.00	---
C-A	01/17/91	---	11.04	0.00	0.00	---
C-A	01/24/91	---	11.14	0.00	0.00	---
C-A	01/31/91	---	11.18	0.00	0.00	---
C-A	02/07/91	---	10.90	0.00	0.00	---
C-A	02/14/91	---	10.80	0.00	0.00	---
C-A	02/21/91	---	10.92	0.00	0.00	---
C-A	02/28/91	---	10.82	0.00	0.00	---
C-A	03/07/91	---	10.32	SHEEN	0.00	---
C-A	03/14/91	---	10.26	0.00	0.00	---
C-A	03/21/91	---	10.27	0.00	0.00	---
C-A	03/28/91	---	9.90	0.00	0.00	---
C-A	04/03/91	---	9.82	0.00	0.00	---
C-A	04/04/91	---	9.58	0.00	0.00	---
C-A	04/11/91	---	9.87	0.00	0.00	---
C-A	04/18/91	---	10.02	0.00	0.00	---
C-A	04/25/91	---	10.06	0.00	0.00	---
C-A	05/02/91	---	10.28	0.00	0.00	---
C-A	05/09/91	---	10.30	0.00	0.00	---
C-A	05/16/91	---	10.44	0.00	0.00	---
C-A	05/23/91	---	10.58	0.00	0.00	---
C-A	05/30/91	---	10.64	0.00	0.00	---
C-A	06/06/91	---	10.65	0.00	0.00	---
C-A	06/13/91	---	10.77	0.00	0.00	---
C-A	07/17/91	---	10.93	0.00	0.00	---
C-A	09/20/91	---	---	---	---	---
C-A***	10/07/91	---	---	---	---	---

Table 2
 Summary of Results of Ground Water Monitoring
 Chevron Station No. 9-4587
 609 Oak Street, Oakland, California

Concentrations in parts per billion (ppb)

WELL ID	DATE OF MONITORING	TOP OF WELL BOX ELEV.	DEPTH TO WATER	FREE PRODUCT THICKNESS	FREE PRODUCT BAILED (GALLONS)	GROUND WATER ELEV.
C-B	12/06/89	---	---	0.01	---	---
C-B	10/30/90	---	11.19	0.01	---	---
C-B	12/06/90	---	11.27	0.00	0.00	---
C-B	12/13/90	---	11.19	0.00	0.00	---
C-B	12/20/90	---	11.08	0.00	0.00	---
C-B	12/27/90	---	11.08	SHEEN	0.00	---
C-B	01/03/91	---	11.09	SHEEN	0.00	---
C-B	01/10/91	---	11.14	SHEEN	0.00	---
C-B	01/14/91	---	11.40	0.01	---	---
C-B	01/17/91	---	11.12	SHEEN	0.00	---
C-B	01/24/91	---	11.14	SHEEN	0.00	---
C-B	01/31/91	---	11.15	SHEEN	0.00	---
C-B	02/07/91	---	10.82	SHEEN	0.00	---
C-B	02/14/91	---	10.82	0.00	0.00	---
C-B	02/21/91	---	10.80	SHEEN	0.00	---
C-B	02/28/91	---	10.82	SHEEN	0.00	---
C-B	03/07/91	---	10.35	0.03	0.10	---
C-B	03/14/91	---	9.74	0.20	0.25	---
C-B	03/21/91	---	10.08	0.14	0.10	---
C-B	03/28/91	---	9.56	0.03	0.10	---
C-B	04/03/91	---	9.55	1.00	---	---
C-B	04/04/91	---	10.54	1.06	0.75	---
C-B	04/11/91	---	10.65	1.00	0.50	---
C-B	04/18/91	---	10.57	0.67	0.75	---
C-B	04/25/91	---	10.44	0.50	0.10	---
C-B	05/02/91	---	10.45	0.35	0.75	---
C-B	05/09/91	---	10.35	0.25	0.10	---
C-B	05/16/91	---	10.54	0.20	0.50	---
C-B	05/23/91	---	10.51	0.15	0.10	---
C-B	05/30/91	---	10.57	0.10	0.25	---
C-B	06/06/91	---	10.54	0.05	0.10	---
C-B	06/13/91	---	10.65	0.03	0.25	---
C-B	07/17/91	---	10.84	0.03	---	---
C-B	09/20/91	---	11.10	0.05	0.02	---
C-B	10/07/91	---	11.10	0.04	0.01	---
C-B	11/22/91	---	11.23	0.01	0.01	---
C-B	12/19/91	---	11.17	0.01	0.01	---
C-B	01/07/92	---	10.73	0.00	0.00	---
C-B	02/04/92	---	10.78	0.01	0.01	---
C-B	03/06/92	---	---	---	---	---
C-B	04/01/92	---	10.33	1.02	0.15	---
C-B	04/24/92	---	10.84	1.01	0.05	---
C-B	05/05/92	---	10.74	0.68	0.10	---
C-B	06/25/92	---	11.20	0.68	0.10	---

Table 2
 Summary of Results of Ground Water Monitoring
 Chevron Station No. 9-4587
 609 Oak Street, Oakland, California

Concentrations in parts per billion (ppb)

WELL ID	DATE OF MONITORING	TOP OF WELL BOX ELEV.	DEPTH TO WATER	FREE PRODUCT THICKNESS	FREE PRODUCT BAILED (GALLONS)	GROUND WATER ELEV.
C-C	12/06/89	---	---	0.15	---	---
C-C	10/30/90	---	10.84	0.03	---	---
C-C	12/06/90	---	11.24	0.23	0.50	---
C-C	12/13/90	---	11.09	0.13	0.50	---
C-C	12/20/90	---	11.00	0.11	0.00	---
C-C	12/27/90	---	10.91	0.04	0.00	---
C-C	01/03/91	---	11.02	0.14	0.25	---
C-C	01/10/91	---	11.01	0.13	0.50	---
C-C	01/14/91	---	11.01	0.11	---	---
C-C	01/17/91	---	11.02	0.12	0.25	---
C-C	01/24/91	---	11.05	0.13	0.10	---
C-C	01/31/91	---	11.03	0.08	0.25	---
C-C	02/07/91	---	10.86	0.06	0.50	---
C-C	02/14/91	---	10.80	0.06	0.25	---
C-C	02/21/91	---	10.84	0.12	0.50	---
C-C	02/28/91	---	10.72	0.13	0.25	---
C-C	03/07/91	---	10.51	0.20	0.50	---
C-C	03/14/91	---	10.18	0.15	0.25	---
C-C	03/21/91	---	9.88	0.15	0.50	---
C-C	03/28/91	---	9.15	0.21	0.25	---
C-C	04/03/91	---	9.19	0.02	---	---
C-C	04/04/91	---	9.43	0.25	0.75	---
C-C	04/11/91	---	9.61	0.19	0.50	---
C-C	04/18/91	---	9.72	0.11	0.25	---
C-C	04/25/91	---	9.72	0.17	0.20	---
C-C	05/02/91	---	9.88	0.16	0.25	---
C-C	05/09/91	---	10.00	0.13	0.50	---
C-C	05/16/91	---	10.01	0.10	0.25	---
C-C	05/23/91	---	10.10	0.09	0.20	---
C-C	05/30/91	---	10.27	0.17	0.50	---
C-C	06/06/91	---	10.34	0.16	0.50	---
C-C	06/13/91	---	10.43	0.15	0.25	---
C-C	07/17/91	---	10.53	0.03	---	---
C-C	09/20/91	---	10.80	0.35	2.00	---
C-C	10/07/91	---	10.98	0.08	0.01	---
C-C	11/22/91	---	10.98	0.11	0.25	---
C-C	12/19/91	---	10.96	0.03	0.05	---
C-C	01/07/92	---	10.41	0.08	1.50	---
C-C	02/04/92	---	10.45	0.09	0.10	---
C-C	03/06/92	---	8.83	0.09	0.10	---
C-C	04/01/92	---	9.23	0.16	0.10	---
C-C	04/24/92	---	9.69	0.13	0.30	---
C-C	05/05/92	---	9.87	0.08	0.06	---

Table 2
 Summary of Results of Ground Water Monitoring
 Chevron Station No. 9-4587
 609 Oak Street, Oakland, California

Concentrations in parts per billion (ppb)

WELL ID	DATE OF MONITORING	TOP OF WELL BOX ELEV.	DEPTH TO WATER	FREE PRODUCT THICKNESS	FREE PRODUCT BAILED (GALLONS)	GROUND WATER ELEV.
C-C	06/25/92	---	10.40	0.12	0.01	---
C-1	12/06/89	16.07	---	0.20	---	---
C-1	10/30/90	16.07	10.79	0.02	---	5.30
C-1	12/06/90	16.07	10.89	0.01	0.10	5.19
C-1	12/13/90	16.07	10.80	0.01	0.10	5.28
C-1	12/20/90	16.07	10.69	0.01	0.00	5.39
C-1	12/27/90	16.07	10.66	0.02	0.00	5.43
C-1	01/03/91	16.07	10.74	0.02	0.10	5.35
C-1	01/10/91	16.07	10.73	0.01	0.10	5.35
C-1	01/14/91	16.07	11.39	0.02	---	4.70
C-1	01/17/91	16.07	10.74	SHEEN	0.00	5.33
C-1	01/24/91	16.07	10.76	SHEEN	0.00	5.31
C-1	01/31/91	16.07	10.76	SHEEN	0.00	5.31
C-1	02/07/91	16.07	10.46	SHEEN	0.00	5.61
C-1	02/14/91	16.07	---	---	---	---
C-1	02/21/91	16.07	10.49	SHEEN	0.00	5.58
C-1	02/28/91	16.07	9.69	0.00	0.00	6.38
C-1	03/07/91	16.07	10.05	SHEEN	0.00	6.02
C-1	03/14/91	16.07	9.94	SHEEN	0.00	6.13
C-1	03/21/91	16.07	9.82	SHEEN	0.00	6.25
C-1	03/28/91	16.07	9.27	0.00	0.00	6.80
C-1	04/03/91	16.07	9.43	0.02	---	6.66
C-1	04/04/91	16.07	9.44	0.04	0.25	6.66
C-1	04/11/91	16.07	9.62	0.04	0.10	6.48
C-1	04/18/91	16.07	9.77	0.06	0.25	6.35
C-1	04/25/91	16.07	9.97	0.17	0.10	6.24
C-1	05/02/91	16.07	9.89	0.04	0.25	6.21
C-1	05/09/91	16.07	9.97	0.03	0.10	6.12
C-1	05/16/91	16.07	10.00	SHEEN	0.00	6.07
C-1	05/23/91	16.07	10.11	0.02	0.10	5.98
C-1	05/30/91	16.07	10.13	SHEEN	0.00	5.94
C-1	06/06/91	16.07	10.23	0.01	0.10	5.85
C-1	06/13/91	16.07	10.28	SHEEN	---	5.79
C-1	07/17/91	16.07	10.46	0.04	---	5.64
C-1	09/20/91	16.07	10.68	0.01	0.01	5.40
C-1	10/07/91	16.07	10.74	0.04	0.01	5.36
C-1	11/22/91	16.07	10.75	SHEEN	0.00	5.32
C-1	12/19/91	16.07	10.74	0.01	0.01	5.34
C-1	01/07/92	16.07	9.97	0.00	0.00	6.10
C-1	02/04/92	16.07	10.37	0.01	0.01	5.71
C-1	03/06/92	16.07	9.20	0.00	0.00	6.87
C-1	04/01/92	16.07	9.28	0.00	0.00	6.79
C-1	04/24/92	16.07	9.73	SHEEN	0.01	6.34

.01 ft = .12 in

Table 2
Summary of Results of Ground Water Monitoring
Chevron Station No. 9-4587
609 Oak Street, Oakland, California

Concentrations in parts per billion (ppb)

WELL ID	DATE OF MONITORING	TOP OF WELL BOX ELEV.	DEPTH TO WATER	FREE PRODUCT THICKNESS	FREE PRODUCT BAILED (GALLONS)	GROUND WATER ELEV.
C-1	05/05/92	16.07	9.88	0.00	0.05	6.19
C-1	06/25/92	16.07	9.98	0.01	0.02	6.10
C-2	12/06/89	16.84	---	0.00	0.00	---
C-2	10/30/90	16.84	11.16	0.00	0.00	5.68
C-2	12/06/90	16.84	11.23	0.00	0.00	5.61
C-2	12/13/90	16.84	11.14	0.00	0.00	5.70
C-2	12/20/90	16.84	11.03	0.00	0.00	5.81
C-2	12/27/90	16.84	11.02	0.00	0.00	5.82
C-2	01/03/91	16.84	11.08	0.00	0.00	5.76
C-2	01/10/91	16.84	11.09	0.00	0.00	5.75
C-2	01/14/91	16.84	11.11	0.00	0.00	5.73
C-2	01/17/91	16.84	11.09	0.00	0.00	5.75
C-2	01/24/91	16.84	11.12	0.00	0.00	5.72
C-2	01/31/91	16.84	11.12	0.00	0.00	5.72
C-2	02/07/91	16.84	10.75	0.00	0.00	6.09
C-2	02/14/91	16.84	10.77	0.00	0.00	6.07
C-2	02/21/91	16.84	10.82	0.00	0.00	6.02
C-2	02/28/91	16.84	10.73	0.00	0.00	6.11
C-2	03/07/91	16.84	10.27	0.00	0.00	6.57
C-2	03/14/91	16.84	10.14	0.00	0.00	6.70
C-2	03/21/91	16.84	9.48	0.00	0.00	7.36
C-2	03/28/91	16.84	9.33	0.00	0.00	7.51
C-2	04/03/91	16.84	9.53	0.00	0.00	7.31
C-2	04/04/91	16.84	9.50	0.00	0.00	7.34
C-2	04/11/91	16.84	9.73	0.00	0.00	7.11
C-2	04/18/91	16.84	9.89	0.00	0.00	6.95
C-2	04/25/91	16.84	9.95	0.00	0.00	6.89
C-2	05/02/91	16.84	10.05	0.00	0.00	6.79
C-2	05/09/91	16.84	10.15	0.00	0.00	6.69
C-2	05/16/91	16.84	10.20	0.00	0.00	6.64
C-2	05/23/91	16.84	10.31	0.00	0.00	6.53
C-2	05/30/91	16.84	10.37	0.00	0.00	6.47
C-2	06/06/91	16.84	10.46	0.00	0.00	6.38
C-2	06/13/91	16.84	10.52	0.00	0.00	6.32
C-2	07/17/91	16.84	10.68	0.00	0.00	6.16
C-2	09/20/91	16.84	10.99	0.00	0.00	5.85
C-2	10/07/91	16.84	11.02	0.00	0.00	5.82
C-2	11/22/91	16.84	11.07	0.00	0.00	5.77
C-2	12/19/91	16.84	11.05	0.00	0.00	5.79
C-2	01/07/92	16.84	10.55	0.00	0.00	6.29
C-2	02/04/92	16.84	10.60	0.00	0.00	6.24
C-2	03/06/92	16.84	9.22	0.00	0.00	7.62
C-2	04/01/92	16.84	9.30	0.00	0.00	7.54

Table 2
 Summary of Results of Ground Water Monitoring
 Chevron Station No. 9-4587
 609 Oak Street, Oakland, California

Concentrations in parts per billion (ppb)

WELL ID	DATE OF MONITORING	TOP OF WELL BOX ELEV.	DEPTH TO WATER	FREE PRODUCT THICKNESS	FREE PRODUCT BAILED (GALLONS)	GROUND WATER ELEV.
C-2	04/24/92	16.84	8.96	0.00	0.00	7.88
C-2	05/05/92	16.84	9.98	0.00	0.00	6.86
C-2	06/25/92	16.84	10.45	0.00	0.00	6.39
C-3	12/06/89	16.48	---	0.00	0.00	---
C-3	10/30/90	16.48	10.44	0.00	0.00	6.04
C-3	12/06/90	16.48	10.56	0.00	0.00	5.92
C-3	12/13/90	16.48	---	0.00	0.00	---
C-3	12/20/90	16.48	10.33	0.00	0.00	6.15
C-3	12/27/90	16.48	10.30	0.00	0.00	6.18
C-3	01/03/91	16.48	10.36	0.00	0.00	6.12
C-3	01/10/91	16.48	10.37	0.00	0.00	6.11
C-3	01/14/91	16.48	10.34	0.00	0.00	6.14
C-3	01/17/91	16.48	10.37	0.00	0.00	6.11
C-3	01/24/91	16.48	10.42	0.00	0.00	6.06
C-3	01/31/91	16.48	10.43	0.00	0.00	6.05
C-3	02/07/91	16.48	10.05	0.00	0.00	6.43
C-3	02/14/91	16.48	---	0.00	0.00	---
C-3	02/21/91	16.48	10.12	0.00	0.00	6.36
C-3	02/28/91	16.48	9.98	0.00	0.00	6.50
C-3	03/07/91	16.48	---	0.00	0.00	---
C-3	03/14/91	16.48	---	0.00	0.00	---
C-3	03/21/91	16.48	9.40	0.00	0.00	7.08
C-3	03/28/91	16.48	---	0.00	0.00	---
C-3	04/03/91	16.48	9.01	0.00	0.00	7.47
C-3	04/04/91	16.48	---	0.00	0.00	---
C-3	04/11/91	16.48	9.15	0.00	0.00	7.33
C-3	04/18/91	16.48	9.26	0.00	0.00	7.22
C-3	04/25/91	16.48	9.30	0.00	0.00	7.18
C-3	05/02/91	16.48	9.40	0.00	0.00	7.08
C-3	05/09/91	16.48	9.51	0.00	0.00	6.97
C-3	05/16/91	16.48	9.53	0.00	0.00	6.95
C-3	05/23/91	16.48	9.66	0.00	0.00	6.82
C-3	05/30/91	16.48	---	0.00	0.00	---
C-3	06/06/91	16.48	---	0.00	0.00	---
C-3	06/13/91	16.48	---	0.00	0.00	---
C-3	07/17/91	16.48	10.00	0.00	0.00	6.48
C-3	09/20/91	16.48	10.36	0.00	0.00	6.12
C-3	10/07/91	16.48	10.38	0.00	0.00	6.10
C-3	11/22/91	16.48	10.47	0.00	0.00	6.01
C-3	12/19/91	16.48	10.40	0.00	0.00	6.08
C-3	01/07/92	16.48	9.94	0.00	0.00	6.54
C-3	02/04/92	16.48	10.00	0.00	0.00	6.48
C-3	03/06/92	16.48	8.70	0.00	0.00	7.78

Table 2
 Summary of Results of Ground Water Monitoring
 Chevron Station No. 9-4587
 609 Oak Street, Oakland, California

Concentrations in parts per billion (ppb)

WELL ID	DATE OF MONITORING	TOP OF WELL BOX ELEV.	DEPTH TO WATER	FREE PRODUCT THICKNESS	FREE PRODUCT BAILED (GALLONS)	GROUND WATER ELEV.
C-3	04/01/92	16.48	8.83	0.00	0.00	7.65
C-3	04/24/92	16.48	9.28	0.00	0.00	7.20
C-3	05/05/92	16.48	9.39	0.00	0.00	7.09
C-3	06/25/92	16.48	9.85	0.00	0.00	6.63
C-4	12/06/89	16.53	---	0.00	0.00	---
C-4	10/30/90	16.53	11.56	0.00	0.00	4.97
C-4	12/06/90	16.53	11.60	0.00	0.00	4.93
C-4	12/13/90	16.53	11.52	0.00	0.00	5.01
C-4	12/20/90	16.53	11.42	0.00	0.00	5.11
C-4	12/27/90	16.53	11.40	0.00	0.00	5.13
C-4	01/03/91	16.53	11.43	0.00	0.00	5.10
C-4	01/10/91	16.53	11.43	0.00	0.00	5.10
C-4	01/14/91	16.53	11.44	0.00	0.00	5.09
C-4	01/17/91	16.53	11.56	0.00	0.00	4.97
C-4	01/24/91	16.53	11.56	0.00	0.00	4.97
C-4	01/31/91	16.53	11.51	0.00	0.00	5.02
C-4	02/07/91	16.53	11.35	0.00	0.00	5.18
C-4	02/14/91	16.53	11.27	0.00	0.00	5.26
C-4	02/21/91	16.53	11.27	0.00	0.00	5.26
C-4	02/28/91	16.53	11.13	0.00	0.00	5.40
C-4	03/07/91	16.53	10.82	0.00	0.00	5.71
C-4	03/14/91	16.53	10.68	0.00	0.00	5.85
C-4	03/21/91	16.53	10.61	0.00	0.00	5.92
C-4	03/28/91	16.53	9.43	0.00	0.00	7.10
C-4	04/03/91	16.53	10.00	0.00	0.00	6.53
C-4	04/04/91	16.53	10.02	0.00	0.00	6.51
C-4	04/11/91	16.53	10.24	0.00	0.00	6.29
C-4	04/18/91	16.53	10.36	0.00	0.00	6.17
C-4	04/25/91	16.53	10.44	0.00	0.00	6.09
C-4	05/02/91	16.53	10.51	0.00	0.00	6.02
C-4	05/09/91	16.53	10.62	0.00	0.00	5.91
C-4	05/16/91	16.53	10.67	0.00	0.00	5.86
C-4	05/23/91	16.53	10.73	0.00	0.00	5.80
C-4	05/30/91	16.53	10.78	0.00	0.00	5.75
C-4	06/06/91	16.53	10.92	0.00	0.00	5.61
C-4	06/13/91	16.53	10.93	0.00	0.00	5.60
C-4	07/17/91	16.53	11.16	0.00	0.00	5.37
C-4	09/20/91	16.53	11.35	0.00	0.00	5.18
C-4	10/07/91	16.53	11.39	0.00	0.00	5.14
C-4	11/22/91	16.53	11.42	0.00	0.00	5.11
C-4	12/19/91	16.53	11.43	0.00	0.00	5.10
C-4	01/07/92	16.53	10.96	0.00	0.00	5.57
C-4	02/04/92	16.53	11.02	0.00	0.00	5.51

Table 2
 Summary of Results of Ground Water Monitoring
 Chevron Station No. 9-4587
 609 Oak Street, Oakland, California

Concentrations in parts per billion (ppb)

WELL ID	DATE OF MONITORING	TOP OF WELL BOX ELEV.	DEPTH TO WATER	FREE PRODUCT THICKNESS	FREE PRODUCT BAILED (GALLONS)	GROUND WATER ELEV.
C-4	03/06/92	16.53	9.77	0.00	0.00	6.76
C-4	04/01/92	16.53	9.83	0.00	0.00	6.70
C-4	04/24/92	16.53	10.36	0.00	0.00	6.17
C-4	05/05/92	16.53	10.48	0.00	0.00	6.05
C-4	06/25/92	16.53	10.88	0.00	0.00	5.65
C-5	12/06/89	14.70	9.97	0.00	0.00	4.73
C-5	10/30/90	14.70	---	0.00	0.00	---
C-5	12/06/90	14.70	9.97	0.00	0.00	4.73
C-5	12/13/90	14.70	9.89	0.00	0.00	4.81
C-5	12/20/90	14.70	9.80	0.00	0.00	4.90
C-5	12/27/90	14.70	9.79	0.00	0.00	4.91
C-5	01/03/91	14.70	9.83	0.00	0.00	4.87
C-5	01/10/91	14.70	9.85	0.00	0.00	4.85
C-5	01/14/91	14.70	9.87	0.00	0.00	4.83
C-5	01/17/91	14.70	9.84	0.00	0.00	4.86
C-5	01/24/91	14.70	9.90	0.00	0.00	4.80
C-5	01/31/91	14.70	---	0.00	0.00	---
C-5	02/07/91	14.70	9.62	0.00	0.00	5.08
C-5	02/14/91	14.70	9.62	0.00	0.00	5.08
C-5	02/21/91	14.70	9.66	0.00	0.00	5.04
C-5	02/28/91	14.70	9.57	0.00	0.00	5.13
C-5	03/07/91	14.70	9.23	0.00	0.00	5.47
C-5	03/14/91	14.70	9.13	0.00	0.00	5.57
C-5	03/21/91	14.70	9.05	0.00	0.00	5.65
C-5	03/28/91	14.70	8.56	0.00	0.00	6.14
C-5	04/03/91	14.70	8.72	0.00	0.00	5.98
C-5	04/04/91	14.70	8.72	0.00	0.00	5.98
C-5	04/11/91	14.70	8.87	0.00	0.00	5.83
C-5	04/18/91	14.70	9.01	0.00	0.00	5.69
C-5	04/25/91	14.70	9.05	0.00	0.00	5.65
C-5	05/02/91	14.70	9.14	0.00	0.00	5.56
C-5	05/09/91	14.70	9.20	0.00	0.00	5.50
C-5	05/16/91	14.70	9.25	0.00	0.00	5.45
C-5	05/23/91	14.70	9.31	0.00	0.00	5.39
C-5	05/30/91	14.70	9.35	0.00	0.00	5.35
C-5	06/06/91	14.70	9.44	0.00	0.00	5.26
C-5	06/13/91	14.70	9.45	0.00	0.00	5.25
C-5	07/17/91	14.70	9.63	0.00	0.00	5.07
C-5	09/20/91	14.70	9.81	0.00	0.00	4.89
C-5	10/07/91	14.70	9.83	0.00	0.00	4.87
C-5	11/22/91	14.70	9.84	0.00	0.00	4.86
C-5	12/19/91	14.70	9.84	0.00	0.00	4.86
C-5	01/07/92	14.70	9.47	0.00	0.00	5.23

Table 2
 Summary of Results of Ground Water Monitoring
 Chevron Station No. 9-4587
 609 Oak Street, Oakland, California

Concentrations in parts per billion (ppb)

WELL ID	DATE OF MONITORING	TOP OF WELL BOX ELEV.	DEPTH TO WATER	FREE PRODUCT THICKNESS	FREE PRODUCT BAILED (GALLONS)	GROUND WATER ELEV.
C-5	02/04/92	14.70	9.53	0.00	0.00	5.17
C-5	03/06/92	14.70	8.48	0.00	0.00	6.22
C-5	04/01/92	14.70	8.57	0.00	0.00	6.13
C-5	04/24/92	14.70	9.01	0.00	0.00	5.69
C-5	05/05/92	14.70	9.12	0.00	0.00	5.58
C-5	06/25/92	14.70	9.44	0.00	0.00	5.26
C-6	12/06/89	13.87	---	0.00	0.00	---
C-6	10/30/90	13.87	9.43	0.00	0.00	4.44
C-6	12/06/90	13.87	9.47	0.00	0.00	4.40
C-6	12/13/90	13.87	9.43	0.00	0.00	4.44
C-6	12/20/90	13.87	9.32	0.00	0.00	4.55
C-6	12/27/90	13.87	9.36	0.00	0.00	4.51
C-6	01/03/91	13.87	9.36	0.00	0.00	4.51
C-6	01/10/91	13.87	9.38	0.00	0.00	4.49
C-6	01/14/91	13.87	9.41	0.00	0.00	4.46
C-6	01/17/91	13.87	9.36	0.00	0.00	4.51
C-6	01/24/91	13.87	9.42	0.00	0.00	4.45
C-6	01/31/91	13.87	---	0.00	0.00	---
C-6	02/07/91	13.87	9.25	0.00	0.00	4.62
C-6	02/14/91	13.87	9.25	0.00	0.00	4.62
C-6	02/21/91	13.87	9.24	0.00	0.00	4.63
C-6	02/28/91	13.87	9.20	0.00	0.00	4.67
C-6	03/07/91	13.87	9.03	0.00	0.00	4.84
C-6	03/14/91	13.87	8.97	0.00	0.00	4.90
C-6	03/21/91	13.87	8.91	0.00	0.00	4.96
C-6	03/28/91	13.87	8.64	0.00	0.00	5.23
C-6	04/03/91	13.87	8.66	0.00	0.00	5.21
C-6	04/04/91	13.87	8.66	0.00	0.00	5.21
C-6	04/11/91	13.87	8.74	0.00	0.00	5.13
C-6	04/18/91	13.87	8.82	0.00	0.00	5.05
C-6	04/25/91	13.87	8.85	0.00	0.00	5.02
C-6	05/02/91	13.87	8.88	0.00	0.00	4.99
C-6	05/09/91	13.87	8.95	0.00	0.00	4.92
C-6	05/16/91	13.87	8.99	0.00	0.00	4.88
C-6	05/23/91	13.87	9.02	0.00	0.00	4.85
C-6	05/30/91	13.87	9.07	0.00	0.00	4.80
C-6	06/06/91	13.87	9.10	0.00	0.00	4.77
C-6	06/13/91	13.87	9.15	0.00	0.00	4.72
C-6	07/17/91	13.87	9.25	0.00	0.00	4.62
C-6	09/20/91	13.87	8.97	0.00	0.00	4.90
C-6	10/07/91	13.87	9.34	0.00	0.00	4.53
C-6	11/22/91	13.87	9.35	0.00	0.00	4.52
C-6	12/19/91	13.87	9.39	0.00	0.00	4.48

Table 2
 Summary of Results of Ground Water Monitoring
 Chevron Station No. 9-4587
 609 Oak Street, Oakland, California

Concentrations in parts per billion (ppb)

WELL ID	DATE OF MONITORING	TOP OF WELL BOX ELEV.	DEPTH TO WATER	FREE PRODUCT THICKNESS	FREE PRODUCT BAILED (GALLONS)	GROUND WATER ELEV.
C-6	01/07/92	13.87	9.14	0.00	0.00	4.73
C-6	02/04/92	13.87	9.16	0.00	0.00	4.71
C-6	03/06/92	13.87	8.58	0.00	0.00	5.29
C-6	04/01/92	13.87	8.59	0.00	0.00	5.28
C-6	04/24/92	13.87	8.88	0.00	0.00	4.99
C-6	05/05/92	13.87	8.92	0.00	0.00	4.95
C-6	06/25/92	13.87	9.11	0.00	0.00	4.76
C-7	02/07/91	15.78	9.88	0.00	0.00	5.90
C-7	04/03/91	15.78	9.04	0.00	0.00	6.74
C-7	04/04/91	15.78	9.04	0.00	0.00	6.74
C-7	04/11/91	15.78	9.19	0.00	0.00	6.59
C-7	04/18/91	15.78	---	0.00	0.00	---
C-7	04/25/91	15.78	9.28	0.00	0.00	6.50
C-7	05/02/91	15.78	---	0.00	0.00	---
C-7	05/09/91	15.78	9.46	0.00	0.00	6.32
C-7	05/16/91	15.78	9.47	0.00	0.00	6.31
C-7	05/23/91	15.78	9.55	0.00	0.00	6.23
C-7	05/30/91	15.78	---	0.00	0.00	---
C-7	06/06/91	15.78	9.71	0.00	0.00	6.07
C-7	06/13/91	15.78	9.77	0.00	0.00	6.01
C-7	07/17/91	15.78	9.86	0.00	0.00	5.92
C-7	09/20/91	15.78	10.13	0.00	0.00	5.65
C-7	10/07/91	15.78	10.10	0.00	0.00	5.68
C-7	11/22/91	15.78	9.66	0.00	0.00	6.12
C-7	12/19/91	15.78	9.94	0.00	0.00	5.84
C-7	01/07/92	15.78	9.71	0.00	0.00	6.07
C-7	02/04/92	15.78	9.74	0.00	0.00	6.04
C-7	03/06/92	15.78	8.95	0.00	0.00	6.83
C-7	04/01/92	15.78	8.96	0.00	0.00	6.82
C-7	04/24/92	15.78	9.35	0.00	0.00	6.43
C-7	05/05/92	15.78	9.48	0.00	0.00	6.30
C-7	06/25/92	15.78	9.62	0.00	0.00	6.16

Table 2
 Summary of Results of Ground Water Monitoring
 Chevron Station No. 9-4587
 609 Oak Street, Oakland, California

Concentrations in parts per billion (ppb)

WELL ID	DATE OF MONITORING	TOP OF WELL BOX ELEV.	DEPTH TO WATER	FREE PRODUCT THICKNESS	FREE PRODUCT BAILED (GALLONS)	GROUND WATER ELEV.
CR-1	10/30/90	---	10.51	---	---	---
CR-1	12/06/90	---	10.59	0.00	0.00	---
CR-1	12/13/90	---	10.54	0.00	0.00	---
CR-1	12/20/90	---	10.43	0.00	0.00	---
CR-1	12/27/90	---	10.43	0.00	0.00	---
CR-1	01/03/91	---	10.42	0.00	0.00	---
CR-1	01/10/91	---	10.46	0.00	0.00	---
CR-1	01/14/91	---	10.29	0.00	0.00	---
CR-1	01/17/91	---	10.44	0.00	0.00	---
CR-1	01/24/91	---	10.52	0.00	0.00	---
CR-1	01/31/91	---	10.30	0.00	0.00	---
CR-1	02/07/91	---	10.22	0.00	0.00	---
CR-1	02/14/91	---	10.21	0.00	0.00	---
CR-1	02/21/91	---	10.25	0.00	0.00	---
CR-1	02/28/91	---	10.15	0.00	0.00	---
CR-1	03/07/91	---	9.80	0.00	0.00	---
CR-1	03/14/91	---	9.68	0.00	0.00	---
CR-1	03/21/91	---	9.57	0.00	0.00	---
CR-1	03/28/91	---	9.20	0.00	0.00	---
CR-1	04/03/91	---	---	---	---	---
CR-1	04/04/91	---	9.35	0.00	0.00	---
CR-1	04/11/91	---	9.49	0.00	0.00	---
CR-1	04/18/91	---	9.60	0.00	0.00	---
CR-1	04/25/91	---	9.60	0.00	0.00	---
CR-1	05/02/91	---	9.42	0.00	0.00	---
CR-1	05/09/91	---	9.72	0.00	0.00	---
CR-1	05/16/91	---	9.77	0.00	0.00	---
CR-1	05/23/91	---	9.84	0.00	0.00	---
CR-1	05/30/91	---	9.90	0.00	0.00	---
CR-1	06/06/91	---	9.98	0.00	0.00	---
CR-1	06/13/91	---	10.02	0.00	0.00	---
CR-1	07/17/91	---	10.19	0.00	0.00	---
CR-1	09/20/91	---	10.43	0.00	0.00	---
CR-1	10/07/91	---	10.46	0.00	0.00	---
CR-1	11/22/91	---	10.49	0.00	0.00	---
CR-1	12/19/91	---	10.50	0.00	0.00	---
CR-1	01/07/92	---	10.10	0.00	0.00	---
CR-1	02/04/92	---	10.12	0.00	0.00	---
CR-1	03/06/92	---	9.24	0.00	0.00	---
CR-1	04/01/92	---	9.24	0.00	0.00	---
CR-1	04/24/92	---	9.50	0.00	0.00	---
CR-1	05/05/92	---	9.67	0.03 = .36 in	0.06	---
CR-1	06/25/92	---	10.03	0.01 = .12 in	0.02	---

*** :Unable to locate well.

Note: Top of well box and Ground Water Elevations are expressed as feet above mean sea level (NGVD - 1929).

APPENDIX A
OFFICIAL LABORATORY RESULTS
AND
CHAIN OF CUSTODY FORMS



Alton Geoscience
Attn: DALE SWAIN

Project 31-0564
Reported 07/07/92

TOTAL PETROLEUM HYDROCARBONS

Lab #	Sample Identification	Sampled	Analyzed Matrix
86083- 1	TB-LB	06/25/92	07/01/92 Water
86083- 2	RIN	06/25/92	07/01/92 Water
86083- 3	C-3	06/25/92	07/01/92 Water
86083- 4	C-6	06/25/92	07/01/92 Water
86083- 5	C-7	06/25/92	07/02/92 Water
86083- 6	C-4	06/25/92	07/02/92 Water
86083- 7	C-5	06/25/92	07/01/92 Water
86083- 8	C-2	06/25/92	07/02/92 Water
86083- 9	CR-1	06/25/92	07/02/92 Water
86083-10	C-1	06/25/92	07/02/92 Water

RESULTS OF ANALYSIS

Laboratory Number:	86083- 1	86083- 2	86083- 3	86083- 4	86083- 5
--------------------	----------	----------	----------	----------	----------

	<i>C-3</i>	<i>C-6</i>	<i>C-7</i>		
Gasoline:	ND<50	ND<50	ND<50	ND<50	ND<50
Benzene:	ND<0.5	ND<0.5	ND<0.5	ND<0.5	ND<0.5
Toluene:	ND<0.5	ND<0.5	ND<0.5	ND<0.5	ND<0.5
Ethyl Benzene:	ND<0.5	ND<0.5	ND<0.5	ND<0.5	ND<0.5
Xylenes:	ND<0.5	ND<0.5	ND<0.5	ND<0.5	ND<0.5
Concentration:	ug/L	ug/L	ug/L	ug/L	ug/L

Laboratory Number:	86083- 6	86083- 7	86083- 8	86083- 9	86083-10
--------------------	----------	----------	----------	----------	----------

	<i>C-4</i>	<i>C-5</i>	<i>C-2</i>	<i>CR-1</i>	<i>C-1</i>
Gasoline:	ND<50	800	23000	12000	100000
Benzene:	ND<0.5	2.5	3400	3300	8800
Toluene:	ND<0.5	ND<0.5	740	280	7000
Ethyl Benzene:	ND<0.5	1.3	1300	210	2800
Xylenes:	ND<0.5	7.3	3400	460	19000
Concentration:	ug/L	ug/L	ug/L	ug/L	ug/L