

## **Detterman, Mark, Env. Health**

---

**From:** Mathew Rosman <mrosman@gribiassociates.com>  
**Sent:** Wednesday, August 30, 2017 4:24 PM  
**To:** Yoo, James  
**Cc:** david.watson@gmail.com; Detterman, Mark, Env. Health  
**Subject:** Unable to Locate Well for Abandonment - 1035 7th Street, Oakland  
**Attachments:** WP\_20170822\_12\_28\_02\_Pro.jpg; WP\_20170822\_12\_28\_15\_Pro.jpg; Cal Trans\_Site Plan\_December 1998.pdf; Geo Resource Consultants\_Site Plan\_July 1992.pdf; David Watson - 1035 7th St Oakland\_Figures.pdf

**Follow Up Flag:** Follow up  
**Flag Status:** Flagged

James-

We are working on behalf of Mr. David Watson, the current owner of the former Vend Mart UST Site located at 1035 7<sup>th</sup> Street in Oakland (Alameda County Case No. RO0000036, RWQCB Case No. 01-1778). Mr. Watson has received letters from Alameda County requesting abandonment of site well MW-1. Gribi Associates has conducted a visit of the site and was unable to visually locate the well. It is likely that the well is located in a new landscaped area of the property and is now buried. Gribi Associates previously sampled the well approximately 10 years ago, and at the time we documented that it was a 2-inch diameter well with a total depth of approximately 27.4 feet. Given the well's proximity to San Francisco Bay, I don't believe it would be in an area considered have beneficial groundwater use.

I have attached the following for your reference:

- Gribi Associate site figure: 1) Site Vicinity Map; and 2) Site Plan showing the approximate well location within the landscaped area in question
- Two figures based on survey data that were created for the re-construction of Interstate 880 following the 1989 earthquake.
  - The scales for the figures are approximately 1" = 40 feet for the Geo Resource Consultants figure, and 1"=80' for the Caltrans figure.
- Two Site Photos that provide a general idea of the landscape area.

I believe with ACPWs' blessing, we were previously able to obtain closure at another site in which we were unable to locate a well that needed to be abandoned. I believe it came with the condition that the well be abandoned in the future if it is ever located. Please advise if that is suitable in this case. Thank you for your input.

--Matt

Matthew Rosman  
Project Engineer  
Gribi Associates

ph: 707-748-7743

fax: 707-748-7763  
cell: 707-718-8613

TOPO! map printed on 09/15/06 from "California.tpo" and "Untitled.tpg"

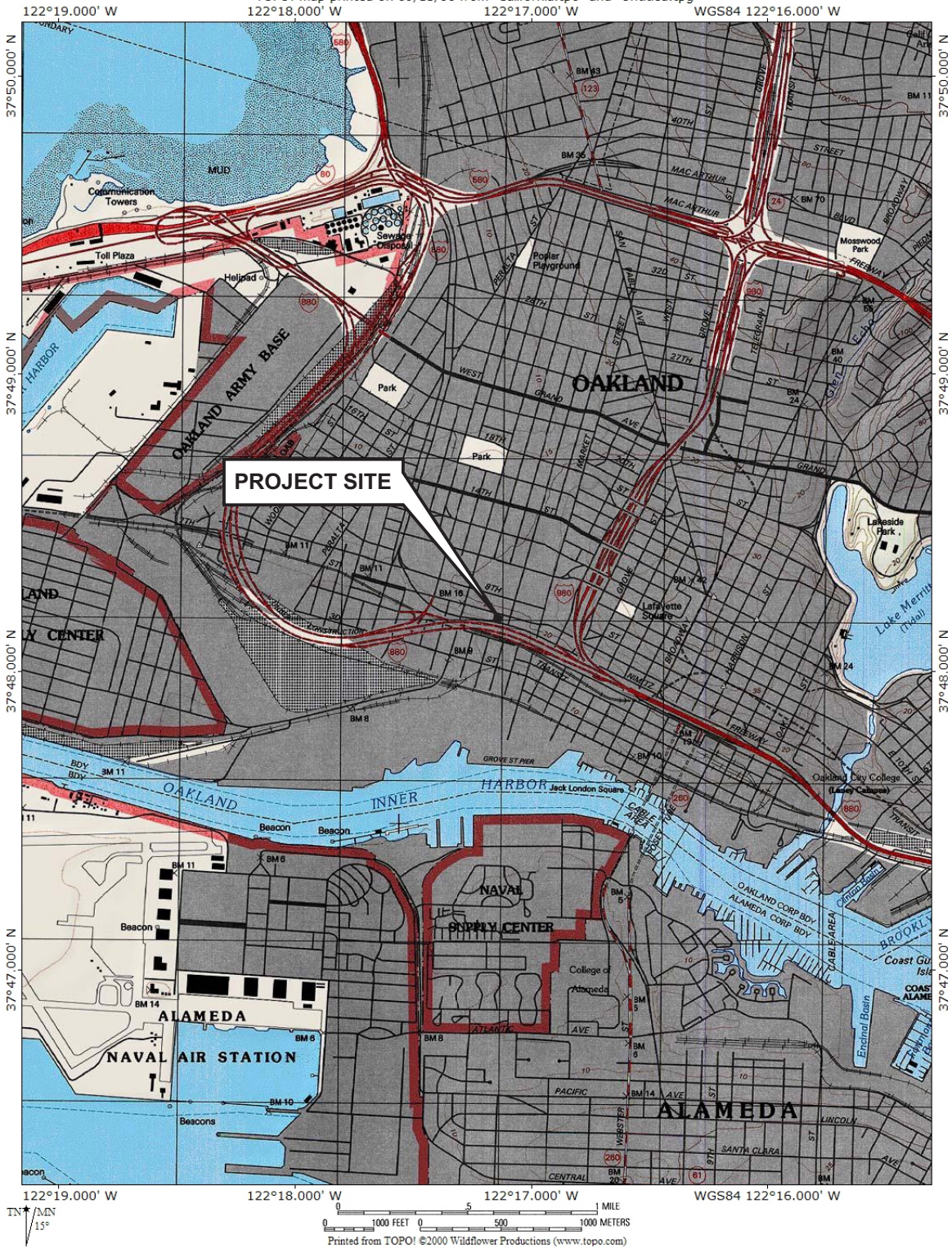

DESIGNED BY:	CHECKED BY:	<b>SITE VICINITY MAP</b>	DATE: 08/30/2017	FIGURE: 1
DRAWN BY: JG	SCALE:			
PROJECT NO:				
		1035 7TH STREET OAKLAND, CALIFORNIA		

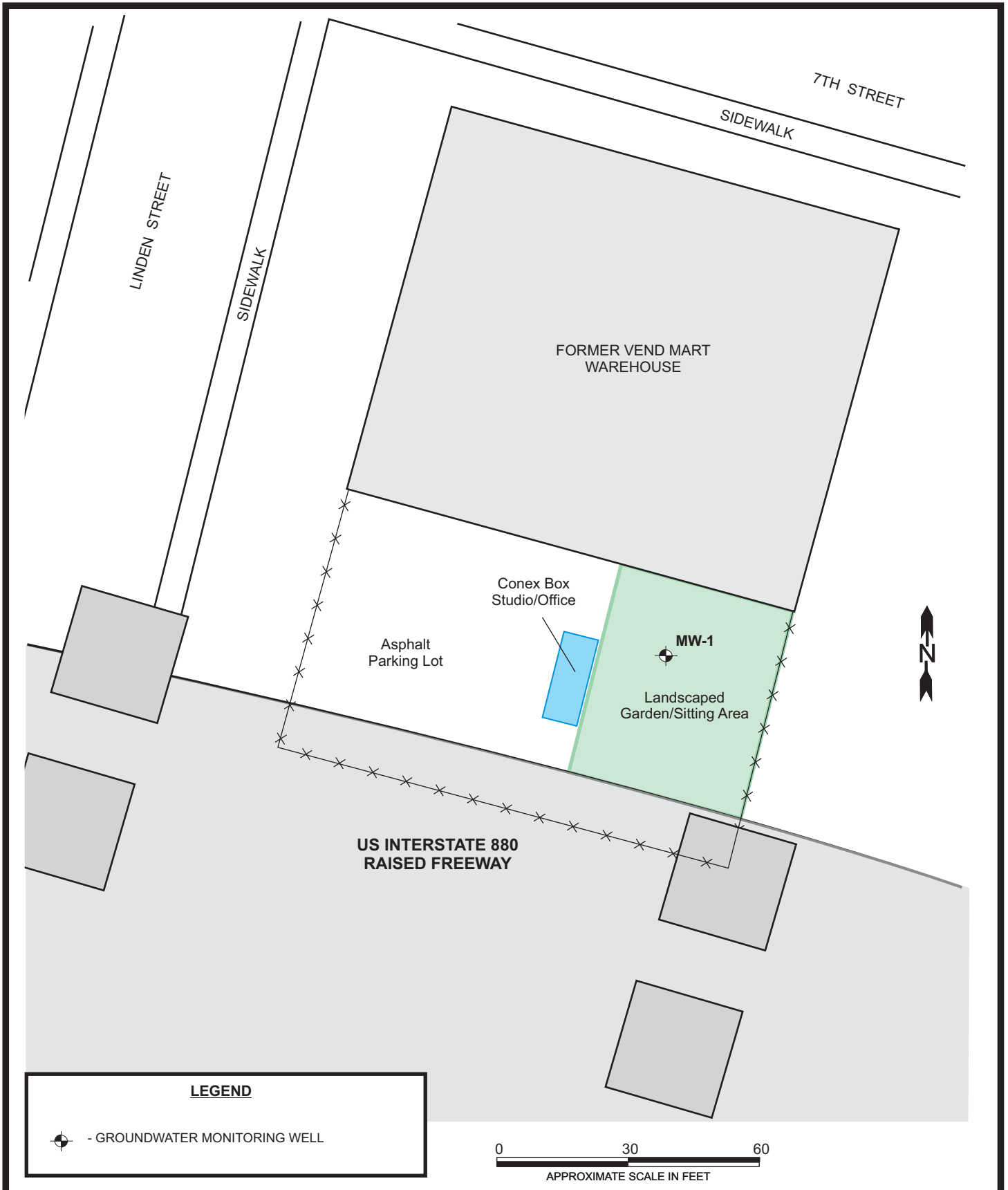

DESIGNED BY:	CHECKED BY:	<b>SITE PLAN</b>	DATE: 08/30/2017	FIGURE: 2
DRAWN BY: JG	SCALE:			
PROJECT NO:	1035 7TH STREET OAKLAND, CALIFORNIA			



EXPLANATION  
 MTW/B-1 ● Boring Location  
 MT/W-1 ⊕ Monitoring Well Location

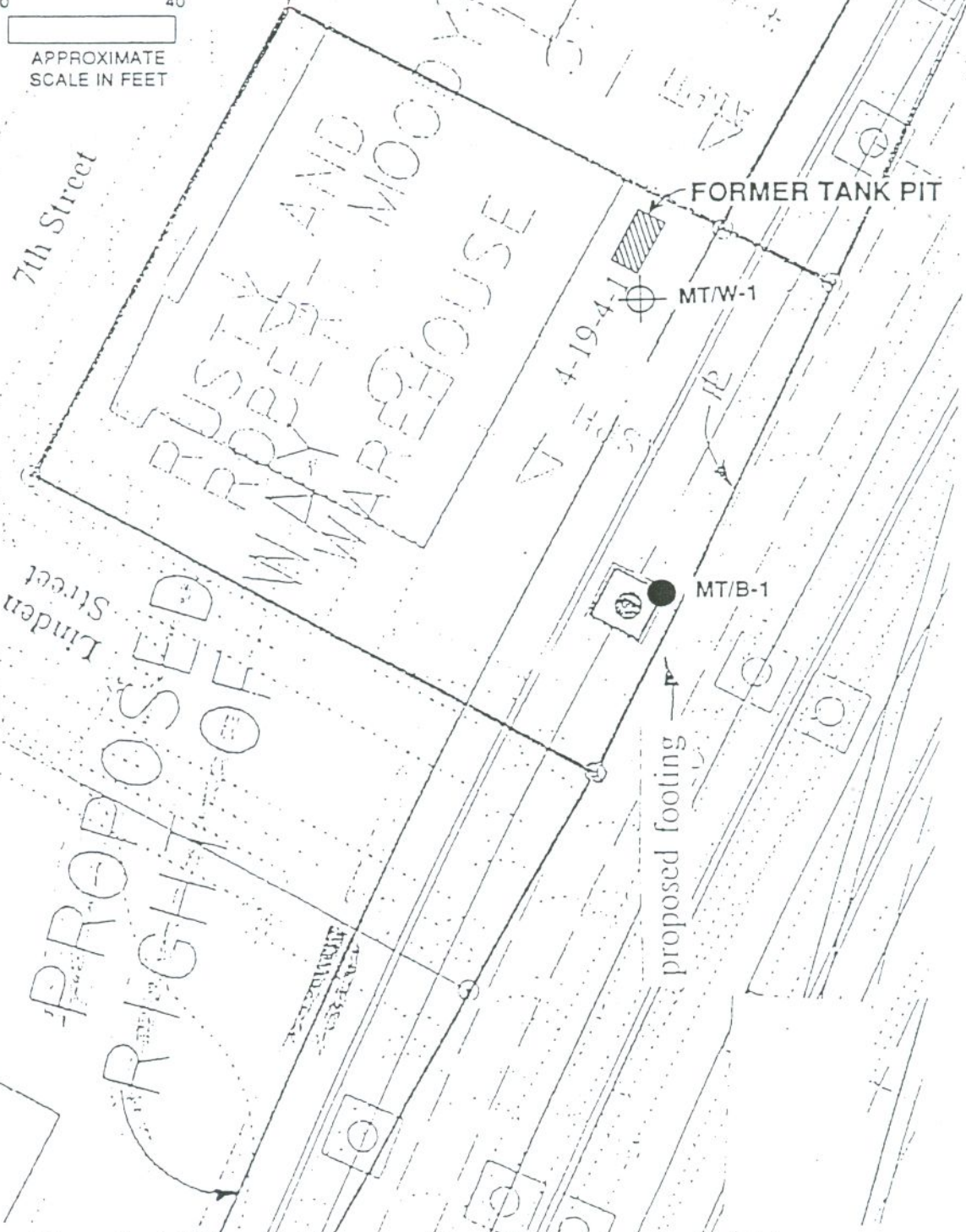
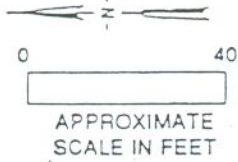

Reference : Caltrans, May 4, 1992



**Geo/Resource Consultants, Inc.**  
 GEOLOGISTS / ENGINEERS / ENVIRONMENTAL SCIENTISTS  
 505 BEACH STREET, SAN FRANCISCO, CALIFORNIA 94133

**SITE PLAN - AREA 3**  
**MARBLE TECHNICS WEST - PARCEL No.3**  
 D.O.T. - INTERSTATE 880  
 CYPRESS STRUCTURE RECONSTRUCTION  
 OAKLAND, CALIFORNIA

FIGURE

**4**

Job No. 1689-019-00 Appr. \_\_\_\_\_ Date 7/20/92

# FIGURE 3 EXCAVATION AREAS CHANG'S AUTO & MARBLE TECHNICS COMPLETION REPORT

SCALE: 1" = 50'

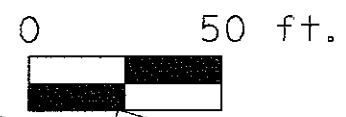

### LEGEND

- New Footing Location and Name
- Env. Solutions Boring Location, 1994
- Geo/Resource Boring Location, 1992
- Monitoring Well, Installed 1988

