



RECEIVED
 By Alameda County Environmental Health 9:42 am, Jul 14, 2015

nsmittal

Date: July 13, 2015 Reference No.: 240483

To: Jerry Wickham
 Alameda County Environmental Health
 1131 Harbor Bay Parkway, Suite 250
 Alameda, California 94502 6577

Subject: 5755 Broadway, Oakland

| No. of Copies | Description/Title | Drawing No./ Document Ref. | Issue |
|---------------|-------------------------|----------------------------|-------|
| 1 | Well Destruction Report | | |
| | | | |
| | | | |
| | | | |

Issued for: Your information As requested Construction Quotation
 Your approval/comments Returned to you For re-submission

Sent by: Overnight courier Same day courier Mailed under separate cover Mail enclosed
 Other: GeoTracker and Alameda County FTP

Remarks:

If you have any questions regarding the contents of this document, please call the GHD project manager Peter Schaefer at (510) 420-3319 or the Shell program manager Perry Pineda at (425) 413-1164.

Copy to: Perry Pineda, Shell Oil Products US
 (electronic copy)

Clint Mercer, SC Fuels (lessee), 1800 West
 Katella Avenue, Suite 400, Orange, CA 92867

Orkin, Inc. (property owner), PO Box 2128,
 Santa Fe Springs, CA 90670

Bruce Millar (adjacent property owner),
 PO Box 11165, Oakland, California 94611

Completed by: Peter Schaefer
 [Please Print]

Signed: *Peter Schaefer*

Filing: Correspondence File



Mr. Jerry Wickham
Alameda County Environmental Health
1131 Harbor Bay Parkway, Suite 250
Alameda, California 94502-6577

Shell Oil Products US
Soil and Groundwater Focus Delivery Group
20945 S. Wilmington Avenue
Carson, CA 90810
Tel (425) 413 1164
Fax (425) 413 0988
Email perry.pineda@shell.com
Internet <http://www.shell.com>

Re: 5755 Broadway
Oakland, California
SAP Code 135699
Incident No. 98995756
ACEH Case No. RO0000026

Dear Mr. Wickham:

The attached document is provided for your review and comment. Upon information and belief, I declare, under penalty of perjury, that the information contained in the attached document is true and correct.

As always, please feel free to contact me directly at (425) 413-1164 with any questions or concerns.

Sincerely,
Shell Oil Products US

A handwritten signature in black ink, appearing to read 'Perry Pineda', is located below the typed name.

Perry Pineda
Senior Environmental Program Manager



Well Destruction Report

Shell-branded Service Station

5755 Broadway

Oakland, California

PlaNNet Project ID 38574
PlaNNet Site ID 10008102
Agency No. RO0000026

Shell Oil Products US

July 13, 2015

5900 Hollis Street Suite A Emeryville California 94608 USA
240483 | 15.10 | Report No 25

Table of Contents

| | | |
|-----|-------------------------|---|
| 1. | Introduction..... | 1 |
| 2. | Well Destructions | 1 |
| 2.1 | Field Dates..... | 1 |
| 2.2 | Personnel Present | 1 |
| 2.3 | Destruction Method..... | 1 |
| 2.4 | Waste Disposal | 1 |

Figure Index

- Figure 1 Vicinity Map
- Figure 2 Site Plan

Appendices

- Appendix A Permit

1. Introduction

GHD Services, Inc. (GHD) prepared this report on behalf of Equilon Enterprises LLC dba Shell Oil Products US (Shell) to document the recent well destructions at the referenced site.

The wells were properly destroyed to facilitate case closure as requested by Alameda County Environmental Health in their April 13, 2015 letter.

2. Well Destructions

2.1 Field Dates

June 22 through June 23, 2015.

2.2 Personnel Present

Geologist Bob Siegfried directed the well destructions under the supervision of California Professional Geologist Peter Schaefer.

2.3 Destruction Method

After removing the well boxes, wells S-1 through S-3, H-1, and T-3 were destroyed by pressure grouting. Soil vapor probes VP-1 and VP-2 were drilled out with an air knife drilling rig. Near sub slab soil vapor probes VP-3 and VP-4 were drilled out with a hammer drill. A copy of the Alameda County Public Works Agency well destruction permit is included in Appendix A.

2.4 Waste Disposal

No waste was generated during the well destructions.

All of Which is Respectfully Submitted,

GHD Services Inc.



Peter Schaefer, CEG, CHG



Aubrey K. Cool, PG



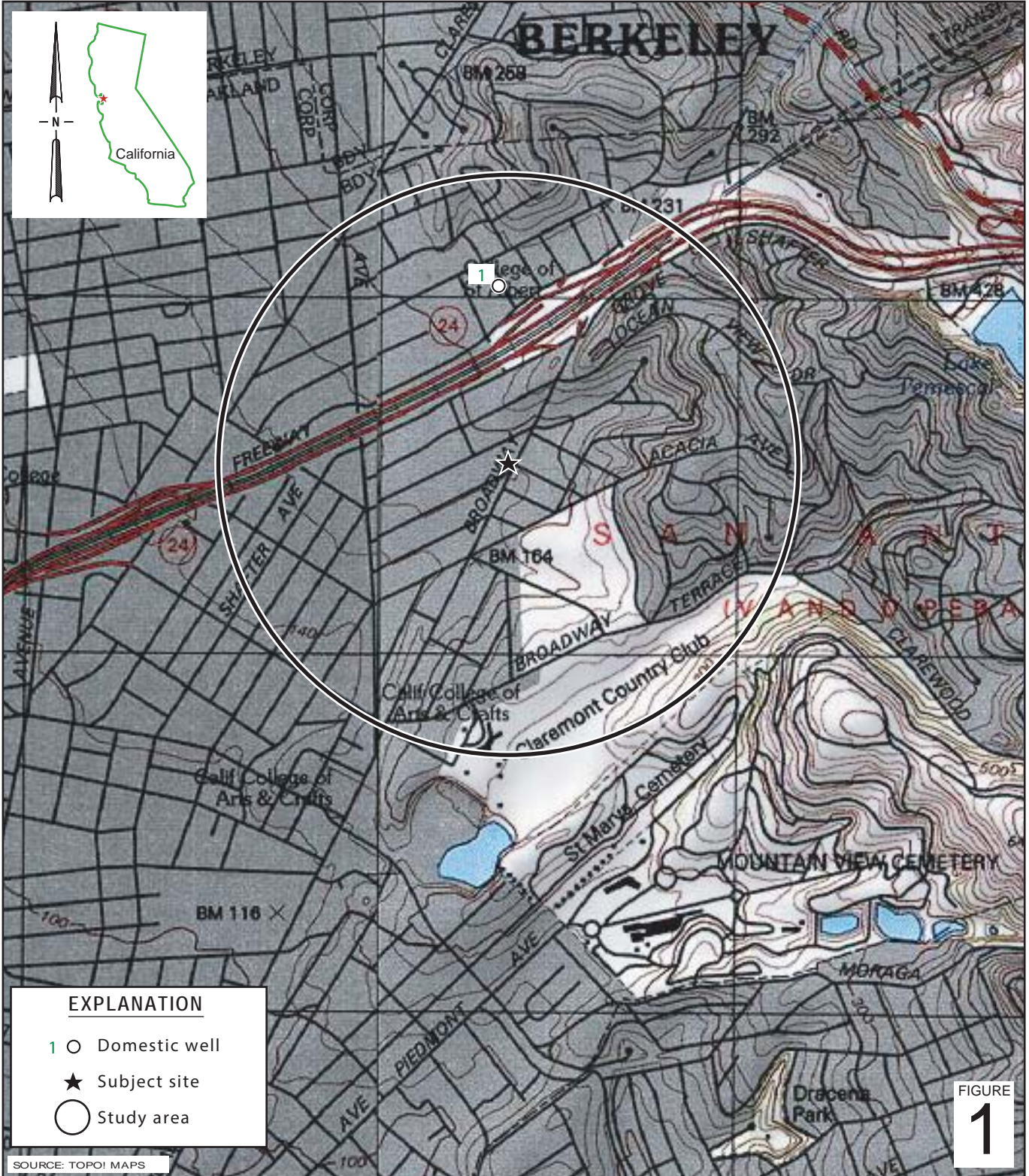
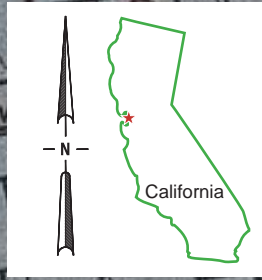

I:\6-chars\2404--\240483-Oakland 5755 Broadway\240483-FIGURES\240483 VICINITY.AI

FIGURE 1

Shell-branded Service Station
5755 Broadway
Oakland, California



Vicinity Map

- VP-1 ☒ Destroyed soil vapor probe
- S-1 ☒ Destroyed monitoring well
- S-2 ☒ Destroyed groundwater monitoring well previously used for extraction
- T-1 ▲ Destroyed tank backfill well
- T-3 ☒ Destroyed pre-pack monitoring well
- H-1 ☒ Destroyed horizontal extraction well
- OE — Overhead electrical line (OE)
- E — Electrical line (E)
- T — Telecommunication line (T)
- STM — Storm drain line (STM)
- SAN — Sanitary sewer line (SAN)
- W — Water line (W)
- ? — Unknown utility line (?)
- ▶ Flow direction
- Manhole

EXPLANATION

- SB-12 ● Soil boring location (Cambria, 2005)
- B-1 ○ Soil boring location (Cambria, 2002)
- S-A ● Soil boring location (EMCON, 1985)
- DS-1-4' ◆ Soil sample location (Cambria, 2005)
- TP-5-14 ▲ Soil sample location (Cambria, 2005)
- SP-5 ● Soil sample location (Cambria, 2005)
- TP-1-14 ■ Soil sample location (Cambria, 2005)
- D-2 ▲ Soil sample location (Cambria, 1998)
- S-C ○ Soil sample location (G-R, 1993)
- ▨ Approximate soil over-excavation area, ~4-6 fbg

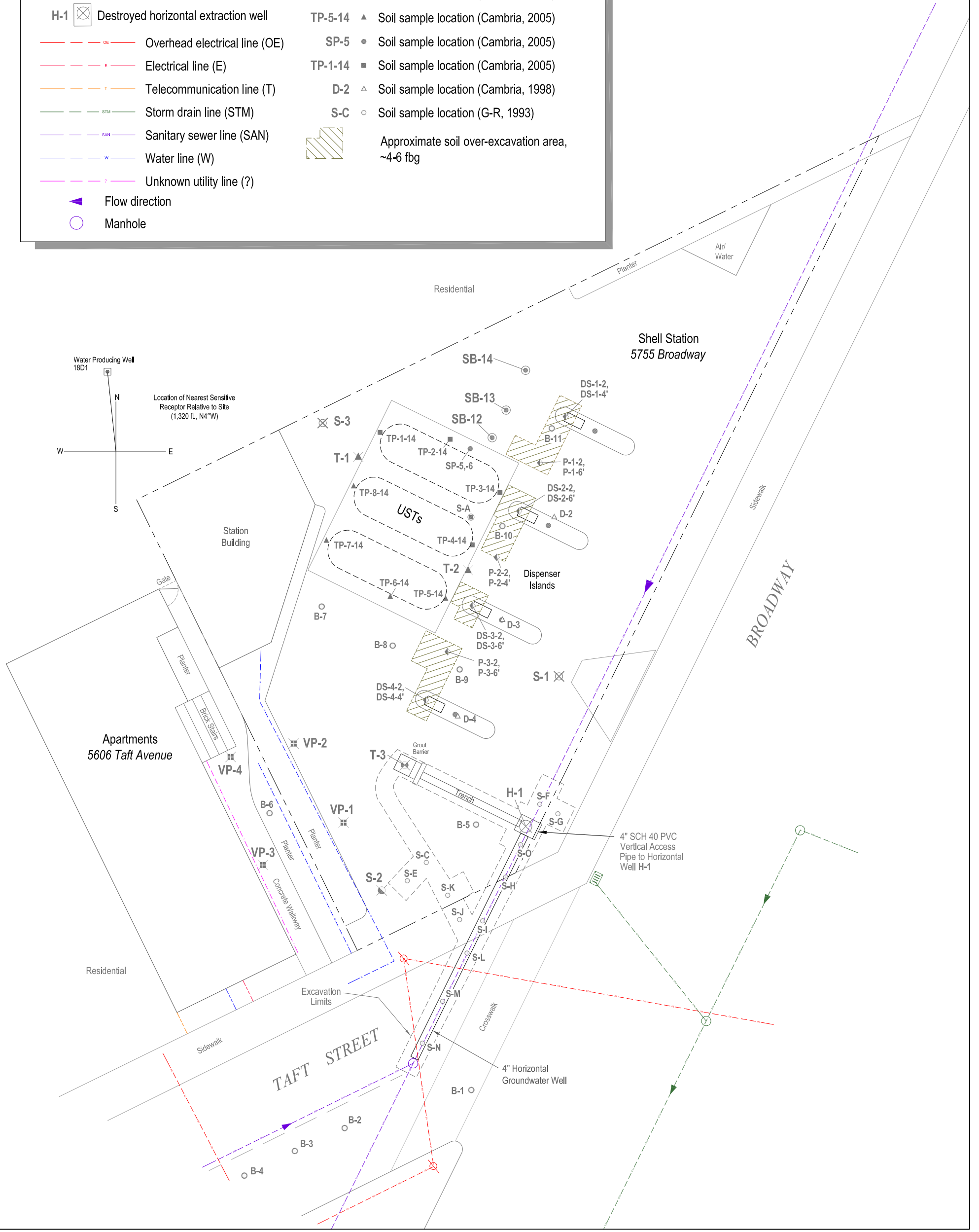

0 10 20ft

SHELL-BRANDED SERVICE STATION
 5755 BROADWAY, OAKLAND, CALIFORNIA
 WELL DESTRUCTION REPORT
 SITE PLAN

240483
 Jul 6, 2015

FIGURE 2

CAD File: I:\Shell\6-chars\2404-240483-Oakland 5755 Broadway\240483-FIGURES\240483 site plan.dwg

Appendices

Appendix A Permit

Alameda County Public Works Agency - Water Resources Well Permit

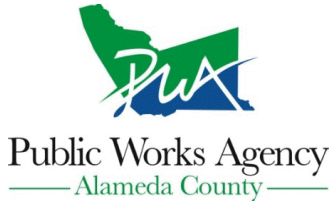

399 Elmhurst Street
Hayward, CA 94544-1395
Telephone: (510)670-6633 Fax:(510)782-1939

Application Approved on: 06/16/2015 By jamesy

Permit Numbers: W2015-0524 to W2015-0529
Permits Valid from 06/22/2015 to 06/26/2015

Application Id: 1432680794862
Site Location: 5755 Broadway, Oakland

City of Project Site: Oakland

Project Start Date: 06/22/2015
Assigned Inspector: Contact Steve Miller at (510) 670-5517 or stevem@acpwa.org

Completion Date: 06/26/2015

Applicant: Conestoga-Rovers and Associates - Cristina Alcon

Phone: 916-889-8915

Property Owner: 10969 Trade Center Drive, Suite 107, Rancho Cordova, CA 95670
Southern Counties Oil CO.

Phone: --

Client: P.O. Box 4159, Orange, CA 92863
(Perry Pineda) Equilon Enterprises dba Shell

Phone: --

Contact: Oil Products US
20945 South Wilmington Ave, Carson, CA 90815
Cristina Alcon

Phone: 916-889-8915
Cell: 707-758-1660

| | | |
|---|---------------------------|---------------------|
| | Total Due: | \$2250.00 |
| Receipt Number: WR2015-0294 | Total Amount Paid: | \$2250.00 |
| Payer Name : Conestoga-Rovers and Assocaites, Inc. | Paid By: CHECK | PAID IN FULL |

Works Requesting Permits:

Well Destruction-Monitoring - 5 Wells
Driller: Cascade Drilling - Lic #: 938110 - Method: press

Work Total: \$1985.00

Specifications

| Permit # | Issued Date | Expire Date | Owner Well Id | Hole Diam. | Casing Diam. | Seal Depth | Max. Depth | State Well # | Orig. Permit # | DWR # |
|------------|-------------|-------------|---------------|------------|--------------|------------|------------|--------------|----------------|------------|
| W2015-0524 | 06/16/2015 | 09/20/2015 | H-1 | 10.00 in. | 4.00 in. | 1.25 ft | 12.00 ft | 1S/4W13H | No Records | No Records |
| W2015-0525 | 06/16/2015 | 09/20/2015 | S-1 | 8.00 in. | 3.00 in. | 1.25 ft | 11.50 ft | 1S/4W13H | No Records | No Records |
| W2015-0526 | 06/16/2015 | 09/20/2015 | S-2 | 10.00 in. | 4.00 in. | 1.25 ft | 11.50 ft | 1S/4W13H | No Records | No Records |
| W2015-0527 | 06/16/2015 | 09/20/2015 | S-3 | 10.00 in. | 4.00 in. | 1.25 ft | 10.50 ft | 1S/4W13H | No Records | No Records |
| W2015-0528 | 06/16/2015 | 09/20/2015 | T-3 | 10.00 in. | 4.00 in. | 1.25 ft | 9.00 ft | 1S/4W13H | No Records | No Records |

Specific Work Permit Conditions

1. Drilling Permit(s) can be voided/ cancelled only in writing. It is the applicant's responsibility to notify Alameda County Public Works Agency, Water Resources Section in writing for an extension or to cancel the drilling permit application. No drilling permit application(s) shall be extended beyond ninety (90) days from the original start date. Applicants may not cancel a drilling permit application after the completion date of the permit issued has passed.

2. Prior to any drilling activities, it shall be the applicant's responsibility to contact and coordinate an Underground Service Alert (USA), obtain encroachment permit(s), excavation permit(s) or any other permits or agreements required for that Federal, State, County or City, and follow all City or County Ordinances. No work shall begin until all the permits and requirements have been approved or obtained. It shall also be the applicants responsibilities to provide to the Cities

Alameda County Public Works Agency - Water Resources Well Permit

or to Alameda County an Traffic Safety Plan for any lane closures or detours planned. No work shall begin until all the permits and requirements have been approved or obtained.

3. Compliance with the well-sealing specifications shall not exempt the well-sealing contractor from complying with appropriate State reporting-requirements related to well construction or destruction (Sections 13750 through 13755 (Division 7, Chapter 10, Article 3) of the California Water Code). Contractor must complete State DWR Form 188 and mail original to the Alameda County Public Works Agency, Water Resources Section, within 60 days. Include permit number and site map.

4. Permittee shall assume entire responsibility for all activities and uses under this permit and shall indemnify, defend and save the Alameda County Public Works Agency, its officers, agents, and employees free and harmless from any and all expense, cost and liability in connection with or resulting from the exercise of this Permit including, but not limited to, property damage, personal injury and wrongful death.

5. Applicant shall contact assigned inspector listed on the top of the permit at least five (5) working days prior to starting, once the permit has been approved. Confirm the scheduled date(s) at least 24 hours prior to drilling.

6. Remove the Christy box or similar structure.

Destroy well by grouting neat cement with a tremie pipe or pressure grouting (25 psi for 5min.) to the bottom of the well and by filling with neat cement to three (3-5) feet below surface grade. Allow the sealing material to spill over the top of the casing to fill any annular space between casing and soil.

After the seal has set, backfill the remaining hole with concrete or compacted material to match existing conditions.

7. Copy of approved drilling permit must be on site at all times. Failure to present or show proof of the approved permit application on site shall result in a fine of \$500.00.

Well Destruction-Vapor monitoring well - 2 Wells

Driller: Cascade Drilling - Lic #: 938110 - Method: other

Work Total: \$265.00

Specifications

| Permit # | Issued Date | Expire Date | Owner Well Id | Hole Diam. | Casing Diam. | Seal Depth | Max. Depth | State Well # | Orig. Permit # | DWR # |
|------------|-------------|-------------|---------------|------------|--------------|------------|------------|--------------|----------------|------------|
| W2015-0529 | 06/16/2015 | 09/20/2015 | VP-1 | 1.00 in. | 0.25 in. | 2.80 ft | 3.50 ft | 1S/4W13H | W2013-0749 | No Records |
| W2015-0529 | 06/16/2015 | 09/20/2015 | VP-2 | 1.00 in. | 0.25 in. | 2.80 ft | 3.50 ft | 1S/4W13H | W2013-0749 | No Records |

Specific Work Permit Conditions

1. Drilling Permit(s) can be voided/ cancelled only in writing. It is the applicant's responsibility to notify Alameda County Public Works Agency, Water Resources Section in writing for an extension or to cancel the drilling permit application. No drilling permit application(s) shall be extended beyond ninety (90) days from the original start date. Applicants may not cancel a drilling permit application after the completion date of the permit issued has passed.

2. Compliance with the above well-sealing specifications shall not exempt the well-sealing contractor from complying with appropriate state reporting-requirements related to well destruction (Sections 13750 through 13755 (Division 7, Chapter 10, Article 3) of the California Water Code). Contractor must complete State DWR Form 188 and mail original to the Alameda County Public Works Agency, Water Resources Section, within 60 days, including permit number and site map.

Alameda County Public Works Agency - Water Resources Well Permit

3. Permittee shall assume entire responsibility for all activities and uses under this permit and shall indemnify, defend and save the Alameda County Public Works Agency, its officers, agents, and employees free and harmless from any and all expense, cost, liability in connection with or resulting from the exercise of this Permit including, but not limited to, properly damage, personal injury and wrongful death.
4. Permittee, permittee's contractors, consultants or agents shall be responsible to assure that all material or waters generated during drilling, boring destruction, and/or other activities associated with this Permit will be safely handled, properly managed, and disposed of according to all applicable federal, state, and local statutes regulating such. In no case shall these materials and/or waters be allowed to enter, or potentially enter, on or off-site storm sewers, dry wells, or waterways or be allowed to move off the property where work is being completed.
5. Prior to any drilling activities, it shall be the applicant's responsibility to contact and coordinate an Underground Service Alert (USA), obtain encroachment permit(s), excavation permit(s) or any other permits or agreements required for that Federal, State, County or City, and follow all City or County Ordinances. No work shall begin until all the permits and requirements have been approved or obtained. It shall also be the applicants responsibilities to provide to the Cities or to Alameda County an Traffic Safety Plan for any lane closures or detours planned. No work shall begin until all the permits and requirements have been approved or obtained.
6. No changes in construction procedures or well type shall change, as described on this permit application. This permit may be voided if it contains incorrect information.
7. Applicant shall contact assigned inspector listed on the top of the permit at least five (5) working days prior to starting, once the permit has been approved. Confirm the scheduled date(s) at least 24 hours prior to drilling.
8. Remove the Christy box or similar structure. Overdrill or clean out to original depth. After the seal has set, backfill the remaining hole with concrete or compacted material to match existing.
9. Copy of approved drilling permit must be on site at all times. Failure to present or show proof of the approved permit application on site shall result in a fine of \$500.00.
10. Vapor monitoring wells constructed with tubing shall be decomissioned by complete removal of tubing, grout seal, and fill material of sand or bentonite. Fill material may be removed by hand auger if material can be removed completely.

Vapor monitoring wells constructed with pvc pipe less than 2" shall be overdrilled to total depth.

Vapor monitoring wells constructed with 2" pvc pipe or larger may be grouted by tremie pipe (any depth) or pressure grouted (less than 30', 25 psi for 5 min).
