

R0216

C A M B R I A

February 10, 2005

Keith L. Matthews
Oakland Fire Department
Office of Emergency Services
1605 Martin Luther King Jr. Way
Oakland, California 94612

Re: **Underground Storage Tank Replacement and Over-Excavation Activities**
Shell-branded Service Station
5755 Broadway
Oakland, California
Incident #98995756
Cambria Project #206-0483-005



Alameda County
FEB 15 2005
Environmental Health

Dear Mr. Matthews:

On behalf of Equilon Enterprises LLC dba Shell Oil Products US (Shell), Cambria Environmental Technology, Inc. (Cambria) is submitting this letter pursuant to the conference call held on February 4, 2005 between you and representatives from Shell, Cambria, and Fillner Construction Inc. (Fillner). The subject site location is shown on Figure 1, and the proposed final tank pit dimensions are shown on Figure 2.

PROPOSED OVER-EXCAVATION ACTIVITIES

On January 31, 2005, Fillner uncovered visibly hydrocarbon-impacted soil or fill material in the northeast corner of the tank pit. This was encountered while digging in the tank pit with an excavator. Based on the soil type, this material appears to be non-native fill. On February 1, 2005, Cambria collected two samples of the impacted soil/fill directly from Fillner's backhoe bucket, and submitted them to Severn Trent Laboratories Inc. of Pleasanton, California for analysis. The samples were analyzed for total petroleum hydrocarbons as gasoline (TPHg), benzene, ethylbenzene, toluene and xylenes by EPA method 8260B, for total petroleum hydrocarbons as diesel (TPHd) by EPA method 8015M, for total lead by EPA method 6010B, and for hexane extractable material (oil and grease) by EPA method 1664A M. The certified analytical report is included as Attachment A.

The laboratory results for samples SP-5 and SP-6 indicated TPHd concentrations of 130 and 100 milligrams per kilogram (mg/kg), TPHg concentrations of 560 and 1,500 mg/kg, benzene concentrations of <2.5 and <0.50 mg/kg, lead concentrations of 4.2 and 8.7 mg/kg, and oil and

**Cambria
Environmental
Technology, Inc.**

5900 Hollis Street
Suite A
Emeryville, CA 94608
Tel (510) 420-0700
Fax (510) 420-9170

grease concentrations of 200 and 61 mg/kg, respectively. The laboratory's notes on the lab reports also indicated that the diesel-range hydrocarbons were in the early diesel range and did not match the laboratory's standard for diesel. Cambria believes this is likely due to the contamination being weathered gasoline, not fuel oil or kerosene, which would be reported as late diesel range hydrocarbons.

As discussed in our February 4, 2005 conference call, Shell will investigate and/or remediate the impacted soil to the extent feasible. In particular, once the new underground storage tanks (USTs) are set and the tank pit is at least partially filled, Fillner will remove the impacted soil to the extent feasible, working under the direction of Cambria and Shell.



To understand the possible sources of the impacted soil/fill, Cambria reviewed the site's environmental investigation history. The site has been under investigation since 1985. In 1992, a release of approximately 200 gallons of gasoline from an unleaded gasoline pipe fitting was reported. Groundwater recovery from the tank backfill well was implemented, removed approximately 40,000 gallons of water, and reportedly reduced the product presence to a sheen. Cambria believes that the observed soil/fill material may have been impacted by this 1992 fuel release. This knowledge, combined with the current laboratory data, suggests to Cambria that the impacted fill/soil is likely due to this prior fuel release, and that it is likely unrelated to fuel oil or kerosene storage tanks.

Cambria anticipates that removal of the impacted soil will largely address your concerns regarding investigating the possible existence of unidentified USTs. During the soil removal activity, Cambria anticipates that additional portions of the paving will be removed and that additional fill/soil will be excavated. Cambria anticipates that this work will indicate the extent of the non-native fill/soil material present, and Cambria will collect soil samples using excavation equipment and/or hand-auger sampling tools to characterize the extent of impacted soils during the soil removal activity.

In addition, Cambria (or a hired subcontractor) will investigate, using a metal detector, the possibility that an abandoned tank is located in the vicinity of the impacted soil. It is our professional opinion that this, combined with investigation during excavation, will be more comprehensive than advancing soil borings in evaluating the possible existence of additional USTs at the site.

DISPOSAL ACTIVITIES

Shell will dispose of soil from the site at Forward Landfill in Manteca, California, based on the laboratory results for stockpile samples collected at the site that meet Forward's non-hazardous waste criteria. Because there was not enough room to stockpile the soil on site, soil removed from the site is transported as non-hazardous material and is currently being held by Forward under a temporary stockpile agreement. Once Cambria submits a waste profile application with all applicable analytical results, the soil will enter the landfill as non-hazardous waste. Forward's acceptance criteria and the temporary stockpile agreement letter are included as Attachment B.



Shell will continue to transport groundwater from the tank pit to the Shell Martinez Refinery for recovery, using vacuum trucks supplied by Philip Services Corporation and/or Onyx Industrial Services, Inc. This water is transported as "non-hazardous" groundwater. For your reference, several bills of lading for water that has already been removed from the site are included as Attachment C. All applicable soil and groundwater laboratory results and disposal documentation will be submitted with the final report documenting the fuel system upgrade, UST replacement, sampling, and over-excavation activities.

CLOSING

On behalf of Shell, Cambria will verbally update you of the project's schedule of activities, including the start and finish of soil excavation, the metal detection investigation, and any additional soil sampling events. Fillner will contact you regarding the schedule for UST, piping, and dispenser replacements and inspections. We appreciate your assistance with this project. Please call Cynthia Vasko at (510) 420-3344 if you have any questions or comments.



Sincerely,
Cambria Environmental Technology, Inc

Matthew W. Derby

Cynthia Vasko
Project Engineer

Matthew W. Derby

Matthew W. Derby, P.E.
Senior Project Engineer

Alameda County
Environmental Health
FEB 15 2005

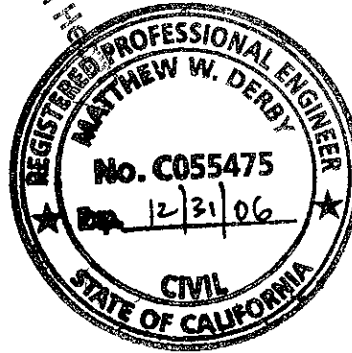

Figures: 1 - Vicinity/Well Survey Map
2 - Site Plan

Attachments: A - Certified Analytical Report
B - Forward Landfill Acceptance Criteria and Temporary Stockpile Agreement
C - Non-hazardous Groundwater Bills of Lading

cc: Karen Petryna, Shell Oil Products US, 20945 S. Wilmington Ave., Carson, CA 90810
William Merchant, Shell Oil Products US, 9141 E. Stockton Blvd., Suite #250-321, Elk Grove, CA 95624
Thrifty Oil Company, c/o Mr. Raymond Fredricksen, PO Box 2128, Santa Fe Springs, CA 90670
Roseanna Garcia-La Grille, Alameda County Health Care Services Agency, 1131 Harbor Bay Parkway, Suite 250, Alameda, CA 94502-6577
Jeff Scott, Fillner Construction Inc., 4470 Yankee Hill Rd., Suite 200, Rocklin, CA 95677

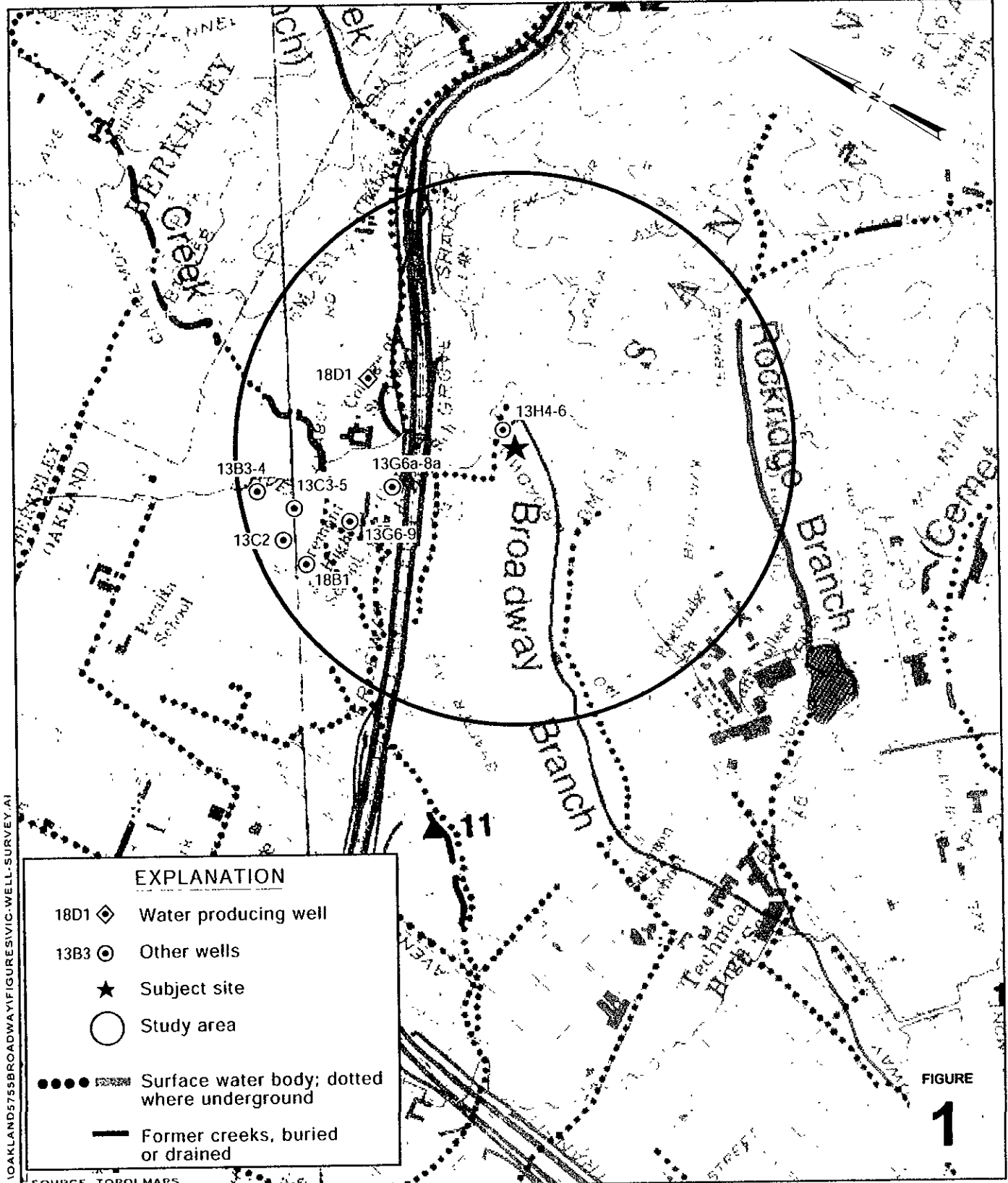

G:\OAKLAND\5755BROADWAY\FIGURES\VIC-WELL-SURVEY.A1

FIGURE 1

Shell-branded Service Station
 5755 Broadway
 Oakland, California
 Incident #98995756



C A M B R I A

Vicinity / Well Survey Map
 (1/2-Mile Radius)

G:\04\1 AND 5755 BROADWAY\FIGURES\SITE PLAN 2-05.A1

EXPLANATION

- S-1 ◆ Monitoring well location
- S-2 ◆ Groundwater monitoring well used for extraction
- T-1 ◆ Tank backfill well location
- T-3 ◆ Pre-pack monitoring well location
- H-1 ◆ Horizontal extraction well location
- B-1 ◆ Soil boring location (Miller-Brooks, 8/6-7/02)
- Sanitary sewer line (SS)
- Storm drain (SD)
- - - Overhead powerline (E)
- ▲ Flow direction
- Manhole
- 4.5 fbg Feet below grade

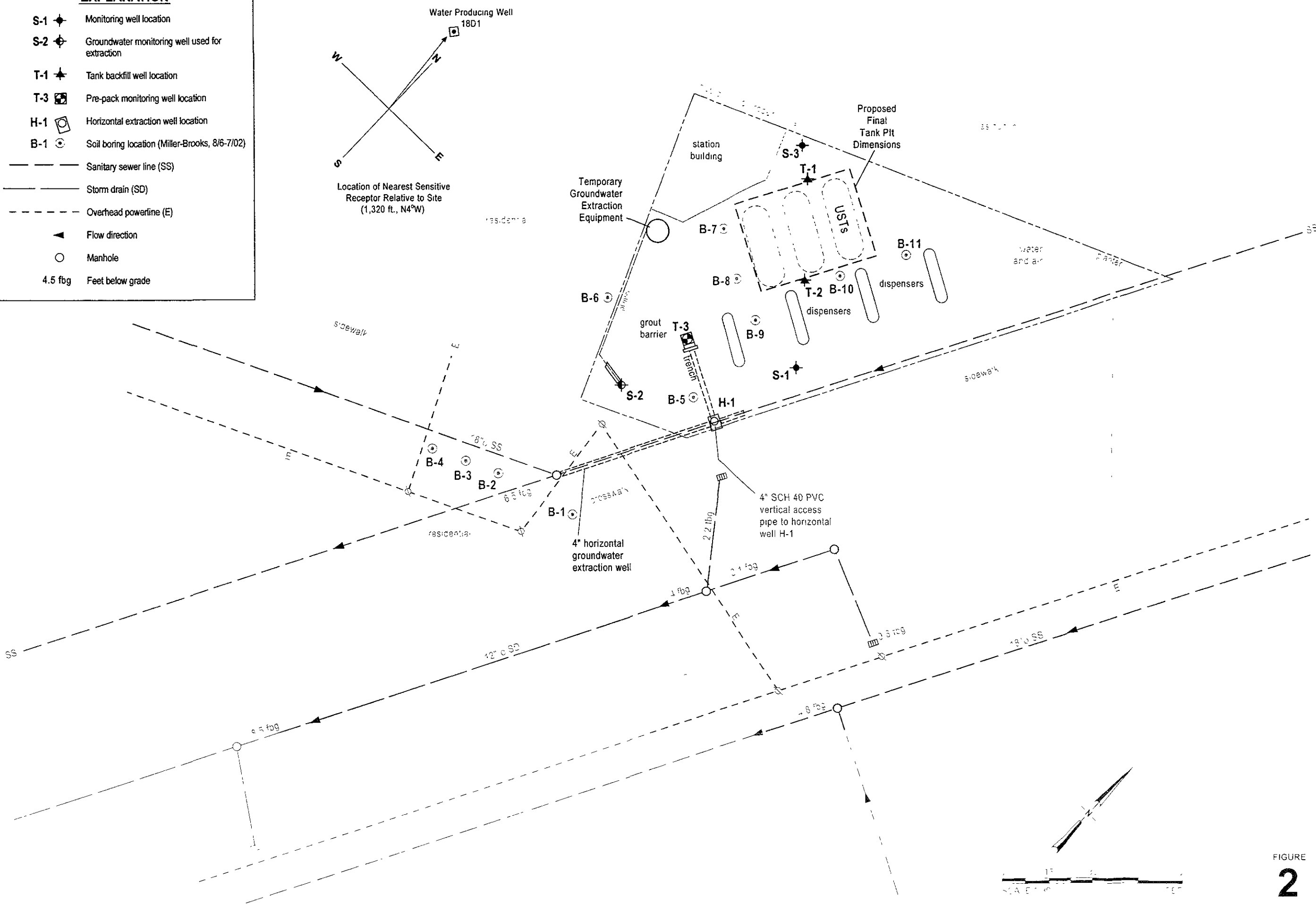

Site Plan



C A M B R I A

FIGURE 2

Shell-branded Service Station

5755 Broadway
Oakland California
Incident #98995756

ATTACHMENT A
Certified Analytical Report

Cambria Environmental Emeryville

February 02, 2005

5900 Hollis Street, Ste. A
Emeryville, CA 94608

Attn.: Cynthia Vasko

Project#: 206-0483-005

Project: 98995756

Site: 5755 Broadway, Oakland, CA

Dear Ms. Vasko:

Attached is our report for your samples received on 02/01/2005 16:10

This report has been reviewed and approved for release. Reproduction of this report is permitted only in its entirety.

Please note that any unused portion of the samples will be discarded after 03/18/2005 unless you have requested otherwise.

We appreciate the opportunity to be of service to you. If you have any questions,

You can also contact me via email. My email address is: mbrewer@stl-inc.com

Sincerely,



Melissa Brewer
Project Manager

Severn Trent Laboratories, Inc.

STL San Francisco * 1220 Quarry Lane, Pleasanton, CA 94566

Tei 925 484 1919 Fax 925 484 1096 * www.stl-inc.com * CA DHS ELAP# 2496

Diesel (C9-C24)

Cambria Environmental Emeryville

Attn.: Cynthia Vasko

5900 Hollis Street, Ste. A
Emeryville, CA 94608
Phone: (510) 420-3344 Fax: (510) 420-9170Project: 206-0483-005
98995756

Received: 02/01/2005 16:10

Site: 5755 Broadway, Oakland, CA

Samples Reported

Sample Name	Date Sampled	Matrix	Lab #
SP-5 A-D	02/01/2005 10:45	Soil	1
SP-6 A-D	02/01/2005 11:05	Soil	2

Diesel (C9-C24)

Cambria Environmental Emeryville

Attn.: Cynthia Vasko

5900 Hollis Street, Ste. A
Emeryville, CA 94608
Phone: (510) 420-3344 Fax: (510) 420-9170

Project: 206-0483-005
98995756

Received: 02/01/2005 16:10

Site: 5755 Broadway, Oakland, CA

Prep(s): 3550/8015M	Test(s): 8015M
Sample ID: SP-5 A-D	Lab ID: 2005-02-0017 - 1
Sampled: 02/01/2005 10:45	Extracted: 2/1/2005 17:28
Matrix: Soil	QC Batch#: 2005/02/01-4A.10

Compound	Conc.	RL	Unit	Dilution	Analyzed	Flag
Diesel	130	2.0	mg/Kg	2.00	02/02/2005 09:52	edr
Surrogate(s)						
o-Terphenyl	104.3	60-130	%	2.00	02/02/2005 09:52	

Diesel (C9-C24)

Cambria Environmental Emeryville

Attn.: Cynthia Vasko

5900 Hollis Street, Ste. A
Emeryville, CA 94608
Phone: (510) 420-3344 Fax: (510) 420-9170

Project: 206-0483-005
98995756

Received: 02/01/2005 16:10

Site: 5755 Broadway, Oakland, CA

Prep(s):	3550/8015M	Test(s):	8015M
Sample ID:	SP-6 A-D	Lab ID:	2005-02-0017 - 2
Sampled:	02/01/2005 11:05	Extracted:	2/1/2005 17:28
Matrix:	Soil	QC Batch#:	2005/02/01-4A.10

Compound	Conc.	RL	Unit	Dilution	Analyzed	Flag
Diesel	100	1.0	mg/Kg	1.00	02/02/2005 09:10	edr
Surrogate(s) o-Terphenyl	100.5	60-130	%	1.00	02/02/2005 09:10	

Diesel (C9-C24)

Cambria Environmental Emeryville

Attn.: Cynthia Vasko

5900 Hollis Street, Ste. A
Emeryville, CA 94608
Phone: (510) 420-3344 Fax: (510) 420-9170

Project: 206-0483-005
98995756

Received: 02/01/2005 16:10

Site: 5755 Broadway, Oakland, CA

Batch QC Report

Prep(s): 3550/8015M

Method Blank

MB: 2005/02/01-4A.10-001

Soil

Test(s): 8015M

QC Batch # 2005/02/01-4A.10

Date Extracted: 02/01/2005 17:28

Compound	Conc.	RL	Unit	Analyzed	Flag
Diesel	ND	1	mg/Kg	02/02/2005 11:11	
Surrogates(s) o-Terphenyl	81.0	60-130	%	02/02/2005 11:11	

Diesel (C9-C24)

Cambria Environmental Emeryville

Attn.: Cynthia Vasko

5900 Hollis Street, Ste. A
Emeryville, CA 94608
Phone: (510) 420-3344 Fax: (510) 420-9170

Project: 206-0483-005
98995756

Received: 02/01/2005 16:10

Site: 5755 Broadway, Oakland, CA

Batch QC Report

Prep(s): 3550/8015M

Test(s): 8015M

Laboratory Control Spike

Soil

QC Batch # 2005/02/01-4A.10

LCS 2005/02/01-4A.10-002

Extracted: 02/01/2005

Analyzed: 02/02/2005 10:19

LCSD 2005/02/01-4A.10-003

Extracted: 02/01/2005

Analyzed: 02/02/2005 10:45

Compound	Conc. mg/Kg		Exp.Conc.	Recovery %		RPD	Ctrl.Limits %		Flags	
	LCS	LCSD		LCS	LCSD		%	Rec.	RPD	LCS
Diesel	32.7	32.9	41.4	79.0	79.5	0.6	60-130	25		
Surrogates(s) o-Terphenyl	18.3	18.1	20.0	91.6	90.5		60-130			

Diesel (C9-C24)

Cambria Environmental Emeryville

Attn.: Cynthia Vasko

5900 Hollis Street, Ste. A

Emeryville, CA 94608

Phone: (510) 420-3344 Fax: (510) 420-9170

Project: 206-0483-005
98995756

Received: 02/01/2005 16:10

Site: 5755 Broadway, Oakland, CA

Legend and Notes

Result Flag

edr

Hydrocarbon reported is in the early Diesel range, and does not match our Diesel standard

Total Lead

Cambria Environmental Emeryville

Attn.: Cynthia Vasko

5900 Hollis Street, Ste. A
Emeryville, CA 94608
Phone: (510) 420-3344 Fax: (510) 420-9170Project: 206-0483-005
98995756

Received: 02/01/2005 16:10

Site: 5755 Broadway, Oakland, CA

Samples Reported

Sample Name	Date Sampled	Matrix	Lab #
SP-5 A-D	02/01/2005 10:45	Soil	1
SP-6 A-D	02/01/2005 11:05	Soil	2

Total Lead

Cambria Environmental Emeryville

Attn.: Cynthia Vasko

5900 Hollis Street, Ste. A

Emeryville, CA 94608

Phone: (510) 420-3344 Fax: (510) 420-9170

Project: 206-0483-005

98995756

Received: 02/01/2005 16:10

Site: 5755 Broadway, Oakland, CA

Prep(s):	3050B	Test(s):	6010B
Sample ID:	SP-5 A-D	Lab ID:	2005-02-0017 - 1
Sampled:	02/01/2005 10:45	Extracted:	2/2/2005 05:19
Matrix:	Soil	QC Batch#:	2005/02/02-01.15

Compound	Conc.	RL	Unit	Dilution	Analyzed	Flag
Lead	4.2	1.0	mg/Kg	1.00	02/02/2005 10:53	

Total Lead

Cambria Environmental Emeryville

Attn.: Cynthia Vasko

5900 Hollis Street, Ste. A

Emeryville, CA 94608

Phone: (510) 420-3344 Fax: (510) 420-9170

Project: 206-0483-005

98995756

Received: 02/01/2005 16:10

Site: 5755 Broadway, Oakland, CA

Prep(s): 3050B	Test(s): 6010B
Sample ID: SP-6 A-D	Lab ID: 2005-02-0017 - 2
Sampled: 02/01/2005 11:05	Extracted: 2/2/2005 05:19
Matrix: Soil	QC Batch#: 2005/02/02-01.15

Compound	Conc.	RL	Unit	Dilution	Analyzed	Flag
Lead	8.7	1.0	mg/Kg	1.00	02/02/2005 11:08	

Total Lead

Cambria Environmental Emeryville
Attn.: Cynthia Vasko

5900 Hollis Street, Ste. A
Emeryville, CA 94608
Phone: (510) 420-3344 Fax: (510) 420-9170

Project: 206-0483-005
98995756

Received: 02/01/2005 16:10

Site: 5755 Broadway, Oakland, CA

Batch QC Report

Prep(s): 3050B

Test(s): 6010B

Method Blank

Soil

QC Batch # 2005/02/02-01.15

MB: 2005/02/02-01.15-065

Date Extracted: 02/02/2005 05:19

Compound	Conc.	RL	Unit	Analyzed	Flag
Lead	ND	1.0	mg/Kg	02/02/2005 10:38	

Total Lead

Cambria Environmental Emeryville

Attn.: Cynthia Vasko

5900 Hollis Street, Ste. A
Emeryville, CA 94608
Phone: (510) 420-3344 Fax: (510) 420-9170

Project: 206-0483-005
98995756

Received: 02/01/2005 16:10

Site: 5755 Broadway, Oakland, CA

Batch QC Report

Prep(s): 3050B

Test(s): 6010B

Laboratory Control Spike

Soil

QC Batch # 2005/02/02-01.15

LCS 2005/02/02-01.15-066

Extracted: 02/02/2005

Analyzed: 02/02/2005 10:48

LCSD 2005/02/02-01.15-067

Extracted: 02/02/2005

Analyzed: 02/02/2005 10:50

Compound	Conc. mg/Kg		Exp.Conc.	Recovery %		RPD	Ctrl.Limits %			Flags	
	LCS	LCSD		LCS	LCSD		%	Rec.	RPD	LCS	LCSD
Lead	98.8	99.2	100.0	98.8	99.2	0.1	80-120	20			

Gas/BTEXFuel Oxygenates by 8260B (High Level)

Cambria Environmental Emeryville

Attn.: Cynthia Vasko

5900 Hollis Street, Ste. A

Emeryville, CA 94608

Phone: (510) 420-3344 Fax: (510) 420-9170

Project: 206-0483-005
98995756

Received: 02/01/2005 16:10

Site: 5755 Broadway, Oakland, CA

Samples Reported

Sample Name	Date Sampled	Matrix	Lab #
SP-5 A-D	02/01/2005 10:45	Soil	1
SP-6 A-D	02/01/2005 11:05	Soil	2

Severn Trent Laboratories, Inc.

STL San Francisco * 1220 Quarry Lane, Pleasanton, CA 94566

Tel 925 484 1919 Fax 925 484 1096 * www.stl-inc.com * CA DHS ELAP# 2496

02/02/2005 16:48

Gas/BTEXFuel Oxygenates by 8260B (High Level)

Cambria Environmental Emeryville

Attn.: Cynthia Vasko

5900 Hollis Street, Ste. A
Emeryville, CA 94608
Phone: (510) 420-3344 Fax: (510) 420-9170

Project: 206-0483-005
98995756

Received: 02/01/2005 16:10

Site: 5755 Broadway, Oakland, CA

Prep(s): 5030B Test(s): 8260B
Sample ID: **SP-6 A-D** Lab ID: 2005-02-0017 - 2
Sampled: 02/01/2005 11:05 Extracted: 2/2/2005 16:17
Matrix: Soil QC Batch#: 2005/02/02-3A.66
Analysis Flag: L2 (See Legend and Note Section)

Compound	Conc.	RL	Unit	Dilution	Analyzed	Flag
Gasoline [Shell]	1500	50	mg/Kg	1.00	02/02/2005 16:17	
Benzene	ND	0.50	mg/Kg	1.00	02/02/2005 16:17	
Toluene	ND	0.50	mg/Kg	1.00	02/02/2005 16:17	
Ethyl benzene	4.2	0.50	mg/Kg	1.00	02/02/2005 16:17	
Total xylenes	12	0.50	mg/Kg	1.00	02/02/2005 16:17	
Surrogate(s)						
1,2-Dichloroethane-d4	96.0	53-129	%	1.00	02/02/2005 16:17	
Toluene-d8	94.8	47-136	%	1.00	02/02/2005 16:17	

Gas/BTEXFuel Oxygenates by 8260B (High Level)

Cambria Environmental Emeryville

Attn.: Cynthia Vasko

5900 Hollis Street, Ste. A
Emeryville, CA 94608
Phone: (510) 420-3344 Fax: (510) 420-9170

Project: 206-0483-005
98995756

Received: 02/01/2005 16:10

Site: 5755 Broadway, Oakland, CA

Batch QC Report

Prep(s): 5030B

Test(s): 8260B

Method Blank

Soil

QC Batch # 2005/02/02-3A.66

MB: 2005/02/02-3A.66-033

Date Extracted: 02/02/2005 15:33

Compound	Conc.	RL	Unit	Analyzed	Flag
Gasoline [Shell]	ND	50	mg/Kg	02/02/2005 15:33	
Benzene	ND	0.50	mg/Kg	02/02/2005 15:33	
Toluene	ND	0.50	mg/Kg	02/02/2005 15:33	
Ethyl benzene	ND	0.50	mg/Kg	02/02/2005 15:33	
Total xylenes	ND	0.50	mg/Kg	02/02/2005 15:33	
Surrogates(s)					
1,2-Dichloroethane-d4	94.8	53-129	%	02/02/2005 15:33	
Toluene-d8	98.0	47-136	%	02/02/2005 15:33	

Gas/BTEXFuel Oxygenates by 8260B (High Level)

Cambria Environmental Emeryville

Attn.: Cynthia Vasko

5900 Hollis Street, Ste. A
Emeryville, CA 94608
Phone: (510) 420-3344 Fax: (510) 420-9170

Project: 206-0483-005
98995756

Received: 02/01/2005 16:10

Site: 5755 Broadway, Oakland, CA

Batch QC Report

Prep(s): 5030B

Test(s): 8260B

Laboratory Control Spike

Soil

QC Batch # 2005/02/02-3A.66

LCS 2005/02/02-3A.66-048

Extracted: 02/02/2005

Analyzed: 02/02/2005 14:48

LCSD 2005/02/02-3A.66-011

Extracted: 02/02/2005

Analyzed: 02/02/2005 15:11

Compound	Conc. mg/Kg		Exp.Conc.	Recovery %		RPD	Ctrl.Limits %		Flags	
	LCS	LCSD		LCS	LCSD		%	Rec.	RPD	LCS
Benzene	8.92	8.81	10	89.2	88.1	1.2	69-129	20		
Toluene	11.5	10.5	10	115.0	105.0	9.1	70-130	20		
Surrogates(s)										
1,2-Dichloroethane-d4	253	245	250	101.2	98.0		53-129			
Toluene-d8	284	255	250	113.6	102.0		47-136			

Severn Trent Laboratories, Inc.

STL San Francisco * 1220 Quarry Lane, Pleasanton, CA 94566

Tel 925 484 1919 Fax 925 484 1096 * www.stl-inc.com * CA DHS ELAP# 2496

02/02/2005 16.48

Gas/BTEXFuel Oxygenates by 8260B (High Level)

Cambria Environmental Emeryville

Attn.: Cynthia Vasko

5900 Hollis Street, Ste. A

Emeryville, CA 94608

Phone: (510) 420-3344 Fax: (510) 420-9170

Project: 206-0483-005

98995756

Received: 02/01/2005 16:10

Site: 5755 Broadway, Oakland, CA

Legend and Notes

Analysis Flag

L2

Reporting limits were raised due to high level of analyte present in the sample.

Result Flag

S3

Surrogate recovery not reportable due to required dilution.

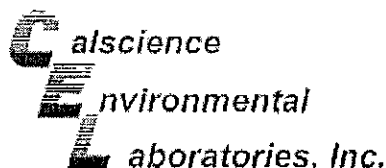

February 04, 2005

Melissa Brewer
Severn Trent Laboratories, Inc.
1220 Quarry Lane
Pleasanton, CA 94566-4756

Subject: **Calscience Work Order No.:** 05-02-0162
Client Reference: 2005-02-0017 / 206-0483-005 / 98995756

Dear Client:

Enclosed is an analytical report for the above-referenced project. The samples included in this report were received 2/3/2005 and analyzed in accordance with the attached chain-of-custody.

Unless otherwise noted, all analytical testing was accomplished in accordance with the guidelines established in our Quality Assurance Program Manual, applicable standard operating procedures, and other related documentation. The original report of any subcontracted analysis is provided herein, and follows the standard Calscience data package. The results in this analytical report are limited to the samples tested and any reproduction thereof must be made in its entirety.

If you have any questions regarding this report, please do not hesitate to contact the undersigned.

Sincerely,

A handwritten signature in black ink that reads "Ranjit K. Clarke". The signature is written in a cursive style with a large, prominent "R" and "C".

Calscience Environmental
Laboratories, Inc.
Ranjit Clarke
Project Manager

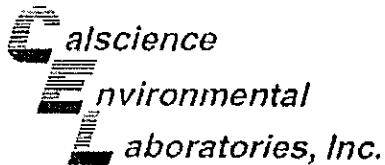

Analytical Report

Severn Trent Laboratories, Inc.
1220 Quarry Lane
Pleasanton, CA 94566-4756

Date Received: 02/03/05
Work Order No.: 05-02-0162
Preparation: N/A
Method: EPA 1664A M (SGT)

Project: 2005-02-0017 / 206-0483-055 / 98995756

Page 1 of 1

Quality Control Sample ID	Lab Sample Number	Date Collected	Matrix	Date Prepared	Date Analyzed	QC Batch ID
SP-5 A-D	05-02-0162-1	02/01/05	Solid	02/03/05	02/03/05	50203HEML2

Parameter	Result	RL	DF	Qual	Units
Hexane Extractable Material	200	10	1		mg/kg

Quality Control Sample ID	Lab Sample Number	Date Collected	Matrix	Date Prepared	Date Analyzed	QC Batch ID
SP-6 A-D	05-02-0162-2	02/01/05	Solid	02/03/05	02/03/05	50203HEML2

Parameter	Result	RL	DF	Qual	Units
Hexane Extractable Material	51	10	1		mg/kg

Quality Control Sample ID	Lab Sample Number	Date Collected	Matrix	Date Prepared	Date Analyzed	QC Batch ID
Method Blank	099-05-021-52	N/A	Solid	02/03/05	02/03/05	50203HEML2

Parameter	Result	RL	DF	Qual	Units
Hexane Extractable Material	ND	10	1		mg/kg

RL - Reporting Limit DF - Dilution Factor Qual - Qualifiers

7440 Lincoln Way, Garden Grove, CA 92841-1427 • TEL: (714) 895-5494 • FAX: (714) 894-7501

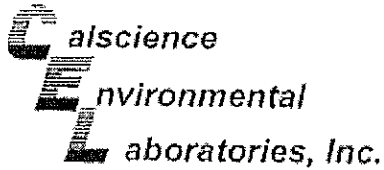

Quality Control - LCS/LCS Duplicate



Severn Trent Laboratories, Inc.
 1220 Quarry Lane
 Pleasanton, CA 94568-4756

Date Received: N/A
 Work Order No: 05-02-0162
 Preparation: N/A
 Method: EPA 1664A M

Project: 2005-02-0017 / 206-0483-005 / 98995756

Quality Control Sample ID	Matrix	Instrument	Date Prepared	Date Analyzed	LCS/LCSD Batch Number
099-05-021-52	Solid	N/A	02/03/05	02/03/05	50203HEML2

Parameter	LCS %REC	LCSD %REC	%REC CL	RPD	RPD CL	Qualifiers
Hexane Extractable Material	83	83	80-120	0	0-20	

RPD - Relative Percent Difference CL - Control Limit



Work Order Number: 05-02-0162

Qualifier	Definition
.	See applicable analysis comment.
1	Surrogate compound recovery was out of control due to a required sample dilution, therefore, the sample data was reported without further clarification.
2	Surrogate compound recovery was out of control due to matrix interference. The associated method blank surrogate spike compound was in control and, therefore, the sample data was reported without further clarification.
3	Recovery of the Matrix Spike or Matrix Spike Duplicate compound was out of control due to matrix interference. The associated LCS and/or LCSD was in control and, therefore, the sample data was reported without further clarification.
4	The MS/MSD RPD was out of control due to matrix interference. The LCS/LCSD RPD was in control and, therefore, the sample data was reported without further clarification.
5	The PDS/PDSD associated with this batch of samples was out of control due to a matrix interference effect. The associated batch LCS/LCSD was in control and, hence, the associated sample data was reported with no further corrective action required.
A	Result is the average of all dilutions, as defined by the method.
B	Analyte was present in the associated method blank.
C	Analyte presence was not confirmed on primary column.
E	Concentration exceeds the calibration range.
H	Sample received and/or analyzed past the recommended holding time.
J	Analyte was detected at a concentration below the reporting limit and above the laboratory method detection limit. Reported value is estimated.
N	Nontarget Analyte.
ND	Parameter not detected at the indicated reporting limit.
O	Spike recovery and RPD control limits do not apply resulting from the parameter concentration in the sample exceeding the spike concentration by a factor of four or greater.
U	Undetected at the laboratory method detection limit.
X	% Recovery and/or RPD out-of-range.
Z	Analyte presence was not confirmed by second column or GC/MS analysis.

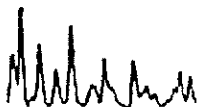



STL

Chain of Custody

Date Shipped: 2/2/2005

2005-02-0017 - 2

From	STL San Francisco (CL) 1220 Quarry Lane Pleasanton CA 94566-4756	To	CalScience Analytical Laboratory 7440 Lincoln Way Garden Grove, CA 92841
Project Manager:	Melissa Brewer	Phone:	(714) 895-5494
Phone:	Ext:	Fax:	() -
Fax:	(925) 484-1096	Contact:	Sample
Email:	mbrewer@stl-inc.com	Phone:	(714) 895-5494
		Control:	Ext:

CL Submission #:	2005-02-0017	Project #:	206-0483-005
CL PO #:		Project Name:	98995756

Client Sample ID	Analysis	Sample ID	Time	Matrix	Retention
SP-5 A-D	Subcontract - Organic Lead /* 24 HR TAT see Ranjit */	1	2/1/2005 10:45:00AM	Soil LUFT	1 Day
	Subcontract - Others /* EPA 1664 HEM (Oil & Grease) with "SGT" */ /* 24 HR TAT see Ranjit */				1 Day
SP-6 A-D	Subcontract - Organic Lead /* 24 HR TAT see Ranjit */	2	2/1/2005 11:05:00AM	Soil LUFT	1 Day
	Subcontract - Others /* EPA 1664 HEM (Oil & Grease) with "SGT" */ /* 24 HR TAT see Ranjit */				1 Day

PLEASE INCLUDE QC WITH FAXED AND HARD-COPY RESULTS

RUSH

RELINQUISHED BY:	1
<i>Bryan Thomas</i>	15:30
Signature	Time
Bryan Thomas	2/2/05
Printed Name	Date
STL-SF	
Company	

RELINQUISHED BY:	2.
Signature	Time
Printed Name	Date
FED EX	
Company	

RELINQUISHED BY:	3.
Signature	Time
Printed Name	Date
Company	

RECEIVED BY:	1.
Signature	Time
Printed Name	Date
Company	

RECEIVED BY:	2.
<i>MARLOW CONTRERAS</i>	10:50
Signature	Time
MARLOW CONTRERAS	2/2/05
Printed Name	Date
CEL	
Company	

RECEIVED BY:	3
Signature	Time
Printed Name	Date
Company	

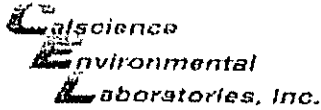

WORK ORDER #:

05 - 62 - 0162

Cooler 1 of 1

SAMPLE RECEIPT FORM

CLIENT: SEVERN TRENT

DATE: 2/3/05

TEMPERATURE - SAMPLES RECEIVED BY:

CALSCIENCE COURIER:

- Chilled, cooler with temperature blank provided
- Chilled, cooler without temperature blank.
- Chilled and placed in cooler with wet ice.
- Ambient and placed in cooler with wet ice.
- Ambient temperature.
- °C Temperature blank.

LABORATORY (Other than Calscience Courier):

- °C Temperature blank.
- °C IR thermometer.
- Ambient temperature.

Initial: MC

CUSTODY SEAL INTACT:

Sample(s): Cooler: No (Not Intact): Not Applicable (N/A):

Initial: MC

SAMPLE CONDITION:

	Yes	No	N/A
Chain-Of-Custody document(s) received with samples.....	<input checked="" type="checkbox"/>	<input type="checkbox"/>	<input type="checkbox"/>
Sample container label(s) consistent with custody papers.....	<input checked="" type="checkbox"/>	<input type="checkbox"/>	<input type="checkbox"/>
Sample container(s) intact and good condition.....	<input checked="" type="checkbox"/>	<input type="checkbox"/>	<input type="checkbox"/>
Correct containers for analyses requested.....	<input checked="" type="checkbox"/>	<input type="checkbox"/>	<input type="checkbox"/>
Proper preservation noted on sample label(s).....	<input type="checkbox"/>	<input type="checkbox"/>	<input checked="" type="checkbox"/>
VOA vial(s) free of headspace.....	<input type="checkbox"/>	<input type="checkbox"/>	<input checked="" type="checkbox"/>
Tedlar bag(s) free of condensation.....	<input type="checkbox"/>	<input type="checkbox"/>	<input checked="" type="checkbox"/>

Initial: MC

COMMENTS:

Brewer, Melissa

From: Vasko, Cynthia [cvasko@cambria-env.com]
Sent: Wednesday, February 02, 2005 5:26 PM
To: Brewer, Melissa
Cc: 'Barone, Ron'; 'Martin Wills'; 'Derby, Matt'
Subject: RE: 5755 Broadway, Oakland, CA' 2005-02-0017

Melissa.

Please cancel TCLP benzene analysis and the aquatic bioassay. Continue with Oil & Grease analysis only. Let me know if you have any questions.

Thanks!

Cynthia Vasko
Project Engineer
Cambria Environmental Technology, Inc.
5900 Hollis Street, Suite A, Emeryville, CA 94608
phone: 510-420-3344
fax: 510-420-9170

-----Original Message-----

From: Brewer, Melissa [mailto:MBrewer@stl-inc.com]
Sent: Wednesday, February 02, 2005 5:10 PM
To: Cynthia Vasko
Cc: Barone, Ron; Martin Wills
Subject: 5755 Broadway, Oakland, CA: 2005-02-0017

From: Melissa Brewer <mbrewer@stl-inc.com>

Project# . 206-0483-005
Project Name: 98995756

This email includes reports for the following tests:

- Cover Letter

File: STLSF2005020017-Finalreport-FRP0000426606.PDF

Please let me know if you have any questions.

Melissa Brewer
Project Manager

STL San Francisco
1220 Quarry Lane
Pleasanton, CA 94566-4756

2/3/2005

STL-San Francisco

SHELL Chain Of Custody Record

97937

1220 Quarry Lane

Pleasanton, CA 94586

(925) 484-1919 (925) 484-1086 fax

Shell Project Manager to be involved:

- SCHOOL & ENGINEERING
- TECHNICAL SERVICES
- CORP HOUSTON

Bill Merchant
2005-02-0017

INCIDENT NUMBER (S&E ONLY)

9 8 9 9 5 7 5 6

SAP or CRMT NUMBER (TS/CRMT)

1 3 5 9 6 3

DATE 2/1/05

PAGE 1 of 1

CLIENT COMPANY: CAMBRIA ENVIRONMENTAL TECHNOLOGY INC
 ADDRESS: 5755 Broadway, Oakland, California
 PHONE: T0607571586

NAME: 3900 HOLLIS ST, Suite A, Emeryville, CA 94608
 SHELL PROJECT CONTACT: Cynthia Vasko
 TEL: 510-420-3342 FAX: 510-420-9170
 PROJECT CONTACT (Shell Approval Report): Cynthia Vasko
 SHELL PROJECT CONTACT: shellasklander@cambria-env.com

TURNAROUND TIME (BUSINESS DAYS): 24 HOURS (8:30pm 2/1/05)
 10 DAYS 5 DAYS 72 HOURS 48 HOURS LESS THAN 24 HOURS

LAB USE ONLY: REQUESTED ANALYSIS

LA - ANALYST REPORT FORMAT LIST AGENCY
 GEMS MTRC CONFIRMATION: HIGHEST HIGHEST pH BORING ALL
 SPECIAL INSTRUCTIONS OR NOTES: CC: rbarone@cambriaenv.com
 -Begin analysis for All Contingents in protocol
 Report to Cynthia Vasko at cvasko@cambria-env.com

LAB USE ONLY	Field Sample Identification	SAMPLING		MATRIX	NO OF CONT	TPH - fugentile	TPH - Extractable (8015m)	BTEX	MTBE	TBA	S Oxygenates	1,2 DCA nhl EOB	Ethanol	Methanol	VOCs by 8260B	Semi-Volatiles by 8270C	Lead <input type="checkbox"/> Ion <input type="checkbox"/> Ni <input type="checkbox"/> TOLP	LUFFS <input type="checkbox"/> Total <input type="checkbox"/> STP <input type="checkbox"/> TOLP	CAMP <input type="checkbox"/> Total <input type="checkbox"/> STP <input type="checkbox"/> TOLP	Test for Disposal (See Attached)	TANK	AGUATIC BIOASSAY	TCLP RUNZ-ENG	FIELD NOTES: Container/Preservative or PID Readings or Laboratory Notes	TEMPERATURE ON RECEIPT LY		
		DATE	TIME																								
✓	SP-5-A	2/1	1045	SO	1																						
✓	SP-5-B		1050																								
✓	SP-5-C		1055																								
✓	SP-5-D		1100																								
✓	SP-6-A	2/1	1108	SO	1																						
✓	SP-6-B		1110																								
✓	SP-6-C		1115																								
✓	SP-6-D		1120																								

DATE: 2/1/05
 TIME: 11:30
 LOCATION: Santa Lucia
 ANALYST: [Signature]
 TIME: 4:10
 TIME: 17:20

8260 TCLP

This information is business proprietary and confidential and must not be divulged or shared outside the company. The use of this information is strictly for the purpose of doing business with the Centralized Residual Management Team (CRMT). Upon termination of the relationship with the CRMT this information is not to be forwarded, duplicated, shared or used for any purpose other than for the documentation of past actions.

RESIDUAL MANAGEMENT PROCEDURE

ISSUED DATE: 08/01/01
CANCELS ISSUE
ISSUED BY: LRR

RESIDUAL STREAM: SOIL WITH UNLEADED GASOLINE + DIESEL
VENDOR: ALLIED BH
LOCATION: ALLIED WASTE - MAN: PCA
3999 SOUTH AUSTIN ROAD
MANTECA, CA 95336

CALIFORNIA - TRANSPORTATION AND RETAIL

BTEX - EPA 816-1B/8260B (IF BENZENE IS > OR = TO 10 MG/KG THEN TCLP BENZENE IS REQUIRED)

GM METALS - TTLC METALS - *lead only*

STLC ON ALL TTLC METALS 10 TIMES STLC MAXIMUM

TTLC LEAD > 13 MG/KG REQUIRES ORGANIC LEAD ANALYSIS

IF ANY TTLC TOTAL METAL IS > OR = TO 20 TIMES TCLP REGULATORY LEVELS, TCLP IS REQUIRED.

TOTAL PETROLEUM HYDROCARBONS, METHOD 418.1 OR 8015 - GASOLINE AND DIESEL

~~41-85 METHOD 8260B (TCMS)~~

AQUATIC BIOASSAY (FISH TOX) IS ONLY TO BE RUN ON SAMPLES > OR = TO 5000 PPM TPH. AQUATIC BIOASSAY (FISH TOX) = PART 800 OF STANDARD METHODS FOR THE EXAMINATION OF WATER AND WASTEWATER (19TH EDITION)

LABORATORY INSTRUCTIONS (MINIMUM GUIDELINES ONLY)

-ALTERNATE APPROVED TEST METHODS PER SW846 ARE ALSO ACCEPTABLE

-ALL REQUIRED TESTS ON COMPOSITE (MAX 411)

-LABORATORY IS TO SUPPLY QA/QC INFORMATION WITH ALL ANALYTICAL REPORTS

~~ALL OR FAX ALL ANALYSIS TO THE CENTRALIZED RESIDUAL MANAGEMENT TEAM~~

PROCEDURE ORIGINAL DATE: 08/01/01
PROCEDURE REVISED DATE: 06/01/01

Brewer, Melissa

2005-02-0016

From: Wills, Martin [mwills@cambria-env.com]
 Sent: Wednesday February 02, 2005 10:27 AM
 To: Brewer, Melissa
 Subject: 5755 Broadway Soil and Stockpile Sample confirmation

\$

2005-02-0017

Melissa, here's the scoop:

- My mistake on COC dated 2/1/05 - SP-4C should be SP-3D
- All SP samples on this chain should be analyzed for TPHg, BTEX, and lead and are for 5-day TAT. *4 composite per Marty 2/2*
- TP samples should also be analyzed for 5 oxygenates and are for 24-hour TAT.
- For composite stockpile samples SP-4 and SP-5, please add Oil & Grease analysis to that requested on the COC. *6 per Marty 2/2*
- Just confirming that STLC, FHE, and Organic lead have been started. *per Marty 2/2*
TCP per Marty 2/2

If you have any more questions or I have missed something from our phone conversation, please let me know. Thanks.

Great Day!

Martin Wills, M.Sc.
 Project Geologist
 Cambria Environmental Technology
 Phone: 510.420.3342
 FAX: 510.420.9170

Confidentiality Notice: The information contained in this message is intended only for the use of the addressee, and may be confidential and/or privileged. If the reader of this message is not the intended recipient, or the employee or agent responsible to deliver it to the intended recipient, you are hereby notified that any dissemination, distribution or copying of this communication is strictly prohibited. If you have received this communication in error, please notify the sender immediately.

Brewer, Melissa

From: Wills, Martin [mwills@cambria-env.com]
Sent: Wednesday, February 02, 2005 3:46 PM
To: Brewer, Melissa
Cc: 'Vasko, Cynthia'
Subject: Lead Analysis, 5755 Broadway, Oakland

2005-02-0017

Melissa, please cancel all further lead analyses for the samples SP-5 and SP-6.

Great Day!

Martin Wills, M.Sc.
Project Geologist
Cambria Environmental Technology
Phone: 510.420.3342
FAX: 510.420.9170

Confidentiality Notice: The information contained in this message is intended only for the use of the addressee, and may be confidential and/or privileged. If the reader of this message is not the intended recipient, or the employee or agent responsible to deliver it to the intended recipient, you are hereby notified that any dissemination, distribution or copying of this communication is strictly prohibited. If you have received this communication in error, please notify the sender immediately.

ATTACHMENT B
Forward Landfill Acceptance Criteria
and Temporary Stockpile Agreement

KELLER CANYON AND FORWARD LANDFILLS

Keller Canyon and Forward Landfill are Class II landfills. The acceptance levels for both landfills are Title 22 levels (CCR 66261.24). The California levels are outlined below.

Organic Constituents:

Petroleum Hydrocarbon Thresholds: No Limit.

	TCLP mg/L	STLC mg/L	TTLIC mg/kg
Aldrin	N/A	0.14	1.4
Benzene	0.5		
Carbon Tetrachloride	0.5		
Chlordane	0.03	0.25	2.5
Chlorobenzene	100.0		
Chloroform	6.0		
Cresols	200.0		
2,4 D	10.0	10.0	100.0
DDT, DDE, DDD	N/A	0.10	1.0
1,4 Dichlorobenzene	7.5		
1,2 Dichloroethane	0.5		
1,1 Dichloroethylene	0.7		
2,4 Dinitrotoluene	0.13		
Dieldrin	N/A	0.8	8.0
Dioxin	N/A	0.001	0.01
Endrin	0.02	0.02	0.2
Heptachlor	0.008	0.47	4.7
Hexachlorobenzene	0.13		
Hexachlorobutadiene	0.5		
Hexachloroethane	3.0		
Kepon	N/A	2.1	21.0
Lindane	0.4	0.4	4.0
Methoxychlor	10.0	10.0	100.0
Methyl Ethyl Ketone	200.0		
Mirex	N/A	2.1	21.0
Nitrobenzene	2.0		
Pentachlorophenol	100.0	1.7	17.0
Polychlorinated Biphenyls	N/A	5.0	50.0
Pyridine	5.0		
Tetrachloroethylene	0.7		
Toxaphene	0.5	0.5	5.0
Trichloroethylene	0.5	204.0	2040.0
2,4,5 TP (Silvex)	1.0	1.0	10.0
2,4,5 Trichlorophenol	400.0		
2,4,6, Trichlorophenol	2.0		
Vinyl Chloride	0.2		

Inorganic Constituents:

	Soluble Threshold STLC: mg/L	Trigger Level** mg/kg	Total Threshold TTLC: mg/kg
Antimony	15.0	150.0	500.0
Arsenic	5.0	50.0	500.0
Barium	100.0	1,000.0	10,000.0
Beryllium	0.75	7.5	75.0
Cadmium	1.0	10.0	100.0
Chromium	5.0	50.0	500.0
Cobalt	80.0	800.0	8,000.0
Copper	25.0	250.0	2,500.0
Lead	5.0	50.0	350.0
Mercury	0.2	2.0	20.0
Molybdenum	350.0	3,500.0	3,500.0
Nickel	20.0	200.0	2,000.0
Selenium	1.0	10.0	100.0
Silver	5.0	50.0	500.0
Thallium	7.0	70.0	700.0
Vanadium	24.0	240.0	2,400.0
Zinc	250.0	2,500.0	5,000.0

***** Results over these thresholds do not necessarily disqualify the acceptance of the waste material. However, the STLC test for metals must be conducted.***

ATTACHMENT C

Non-hazardous Groundwater Bills of Lading

ATTENTION SHIPPERS!

FREIGHT CHARGES ARE PREPAID ON THIS BILL OF LADING UNLESS MARKED COLLECT.

STRAIGHT BILL OF LADING

ORIGINAL — NOT NEGOTIABLE

Shipper No GRW 1197

Carrier No _____

Page 1 of 1

Onyx Industrial Serv
(Name of carrier) (SCAC)

Date 11-17-04

On Collect on Delivery shipments the letters "COD" must appear before consignee's name or as otherwise provided in Item 430 Sec 1

TO: **Shell Oil Products US**
Consignee **MARTINEZ REFINERY**

Street **1801 MARINA VISTA**

City **MARTINEZ** State **CA** Zip Code **94553**

FROM: Shipper Shell Station

Street 5755 Broadway

City OAKland State CA Zip Code _____

24 hr. Emergency Contact Tel. No **CHEMTREC 800-424-9300**

Route		Vehicle Number <u>2897</u>				
No. of Units & Container Type	HM	BASIC DESCRIPTION Proper Shipping Name, Hazard Class, Identification Number (UN or NA), Packing Group, per 172.101, 172.202, 172.203	TOTAL QUANTITY (Weight, Volume, Gallons, etc.)	WEIGHT (Subject to Correction)	RATE	CHARGES (For Carrier Use Only)
<u>1 TT</u>		NON-HAZARDOUS GROUNDWATER	<u>5500 G</u> <u>2773</u>			
		Contains water with < 10% oil bearing materials and may include extracted groundwater from service station facilities that would be non-hazardous under federal and state waste classification criteria.				
		SOP US Martinez Refinery Receiving Gate to direct driver to the Effluent Treatment Plant Operator (x3202) for off loading directions.				
		SAP/INCIDENT #: 135669/98995756				
		RIPR #: 40025				

PLACARDS TENDERED: YES NO

Note—(1) Where the rate is dependent on value, shippers are required to state specifically in writing the agreed or declared value of the property, as follows: "The agreed or declared value of the property is hereby specifically stated by the shipper to be not exceeding _____ per _____"

(2) Where the applicable tariff provisions specify a limitation of the carrier's liability absent a release or a value declaration by the shipper and the shipper does not release the carrier's liability or declare a value, the carrier's liability shall be limited to the extent provided by such provisions. See NMFC item 172

(3) Commodities requiring special or additional care or attention in handling or stowing must be so marked and packaged as to ensure safe transportation. See Section 2(e) of item 360, Bills of Lading, Freight Bills and Statements of Charges and Section 1(a) of the Contract Terms and Conditions for a list of such articles

I hereby declare that the contents of this consignment are fully and accurately described above by the proper shipping name and are classified, packaged, marked and labelled/placarded, and are in all respects in proper condition for transport according to applicable international and national governmental regulations

Raymond Paul Signature

REMIT C.O.D. TO ADDRESS

COD Amt: \$ _____

Subject to Section 7 of the conditions, if this shipment is to be delivered to the consignee without recourse on the consignor the consignor shall sign the following statement
The carrier shall not make delivery of this shipment without payment of freight and all other lawful charges

C.O.D. FEE. PREPAID COLLECT \$ _____

TOTAL CHARGES \$ _____

FREIGHT CHARGES
FREIGHT PREPAID except when box at right is checked Check box if charges are to be collect

RECEIVED subject to the classifications and tariffs in effect on the date of issue of this Bill of Lading, the property described above in apparent good order except as noted (contents and condition of contents of packages unknown), marked, consigned and destined as indicated above which said carrier (the word carrier being understood throughout the contract as meaning any person or corporation in possession of the property under the contract) agrees to carry to its usual place of delivery at said destination if on its route, otherwise to deliver to another carrier on the route to said destination. It is mutually agreed as to each carrier of all or any portion of said property over all or any portion of said route to

destination and as to each party at any time interested in all or any said property that every service to be performed hereunder shall be subject to all the bill of lading terms and conditions in the governing classification on the date of shipment

Shipper hereby certifies that he is familiar with all the lading terms and conditions in the governing classification and the said terms and conditions are hereby agreed to by the shipper and accepted for himself and his assigns

SHIPPER **Shell Oil Products US**

BY *Raymond Paul*
ON BEHALF OF SHELL / EQUILON

CARRIER *Raymond Paul*

PER Onyx Industrial Service

RECEIVING SITE SIGNATURE / DATE:

DATE 11-17-04

1

STRAIGHT BILL OF LADING

ORIGINAL — NOT NEGOTIABLE

Shipper No. GRW 1100

Carrier No. _____

Page 1 of 1

OUYx
(Name of carrier)

(SCAC)

Date 1/17/04

On Collect on Delivery shipments, the letters "COD" must appear before consignee's name or as otherwise provided in Item 430 Sec 1

TO: Shell Oil Products US
Consignee: MARTINEZ REFINERY
 Street 1801 MARINA VISTA
 City MARTINEZ State CA Zip Code 94553

FROM: Shipper SHELL BRANDED SERV.
 Street 5755 BROWN way
 City OAKLAND State CA Zip Code _____
 24 hr Emergency Contact Tel No CHEMTREC 800-424-9300

Route _____ Vehicle Number _____

No. of Units & Container Type	HM	BASIC DESCRIPTION Proper Shipping Name, Hazard Class, Identification Number (UN or NA), Packing Group, per 172 101 172 202, 172 203	TOTAL QUANTITY (Weight, Volume, Gallons, etc.)	WEIGHT (Subject to Correction)	RATE	CHARGES (For Carrier Use Only)
<u>ITT</u>		NON-HAZARDOUS GROUNDWATER	<u>3005 gal.</u>			
		Contains water with < 10% oil bearing materials and may include extracted groundwater from service station facilities that would be non-hazardous under federal and state waste classification criteria.				
		SOP US Martinez Refinery Receiving Gate to direct driver to the Effluent Treatment Plant Operator (x3202) for off loading directions.				
		SAP/INCIDENT #: <u>98995756</u>				
		RIPR #: <u>13F699 / 40025</u>				

PLACARDS TENDERED: YES NO

Note—(1) Where the rate is dependent on value, shippers are required to state specifically in writing the agreed or declared value of the property, as follows: "The agreed or declared value of the property is hereby specifically stated by the shipper to be not exceeding _____ per _____"
 (2) Where the applicable tariff provisions specify a limitation of the carrier's liability and a release or a value declaration by the shipper and the shipper does not release the carrier's liability or declare a value, the carrier's liability shall be limited to the extent provided by such provisions. See NMFC Item 172
 (3) Commodities requiring special or additional care or attention in handling or packing must be so marked and packaged as to ensure safe transportation. See Section 2(e) of item 360 Bills of Lading, Freight Bills and Statements of Charges and Section 1(a) of the Contract Terms and Conditions for a list of such articles

I hereby declare that the contents of this consignment are fully and accurately described above by the proper shipping name and are classified, packaged, marked and labelled/placarded, and are in all respects in proper condition for transport according to applicable international and national governmental regulations

Pamela Signature

REMIT C.O.D. TO ADDRESS _____

COD Amt: \$ _____

Subject to Section 7 of the conditions, if this shipment is to be delivered to the consignee without recourse on the consignor, the consignor shall sign the following statement:
 The carrier shall not make delivery of this shipment without payment of freight and all other lawful charges

C.O.D. FEE: PREPAID COLLECT \$ _____

TOTAL CHARGES \$ _____

FREIGHT CHARGES
 FREIGHT PREPAID except when box at night is checked Check box if charges are to be collect

(Signature of Consignor)

RECEIVED, subject to the classifications and tariffs in effect on the date of issue of this Bill of Lading the property described above in apparent good order, except as noted (contents and condition of contents of packages unknown) marked, re-signed, and delivered as indicated above which said carrier (the word carrier being understood throughout this contract as meaning any person or corporation in possession of the property under the contract) agrees to carry to its usual place of delivery at said destination, it or its agent, otherwise to deliver to another carrier on the route to said destination. It is mutually agreed as to each carrier of all or any of said property over all or any portion of said route to

destination and as to each party at any time interested in all or any said property that every service to be performed hereunder shall be subject to all the bill of lading terms and conditions in the governing classification on the date of shipment
 Shipper hereby certifies that he is familiar with all the lading terms and conditions in the governing classification and the said terms and conditions are hereby agreed to by the shipper and accepted for himself and his assigns

SHIPPER Shell Oil Products US
 PER [Signature] ON BEHALF OF SHELL/EQUILON
 RECEIVING SITE SIGNATURE / DATE: _____

CARRIER OUYx
 PER [Signature]
 DATE 1/17/04

STRAIGHT BILL OF LADING

ORIGINAL - NOT NEGOTIABLE

Shipper No GRW 4386

Carrier No. 1

Date 11/17/04

Page 1 of 1

ONYX (Name of carrier)

(SCAC)

TO: Shell Oil Products US
Consignee MARTINEZ REFINERY
Street 1801 MARINA VISTA
City MARTINEZ State CA Zip Code 94553

FROM: Shipper Shell BRANDS SEW STA.
Street 5755 Broadway
City OAKLAND State CA Zip Code
24 hr. Emergency Contact Tel No. CHEMTREC 800-424-9300

Route Vehicle Number 125

Table with columns: No of Units & Container Type, HM, BASIC DESCRIPTION, TOTAL QUANTITY, WEIGHT, RATE, CHARGES. Includes handwritten entries for 'NON-HAZARDOUS GROUNDWATER', 'SOP US Martinez Refinery', and 'SAP/INCIDENT #'.

PLACARDS TENDERED: YES [] NO [X]

Note: (1) Where the rate is dependent on value, shippers are required to state specifically in writing the agreed or declared value of the property... (2) Where the applicable tariff provisions specify a limitation of the carrier's liability... (3) Commodities requiring special or additional care or attention in handling or towing must be so marked and packaged as to ensure safe transportation.

REMIT C.O.D. TO ADDRESS COD Amt: \$ C.O.D. FEE PREPAID [] COLLECT [] \$ TOTAL CHARGES \$ FREIGHT CHARGES FREIGHT PREPAID [] except when box at right is checked Check box if charges are to be collect

RECEIVED subject to the classifications and tariffs in effect on the date of issue of this Bill of Lading the property described above in apparent good order except as noted contents and condition of contents of packages unknown, marked consigned and destined as indicated above which said carrier (the word carrier being understood throughout this contract as meaning any person or corporation in possession of the property under the contract) agrees to carry to its usual place of delivery at said destination, if on its route otherwise to deliver to another carrier on the route to said destination. It is mutually agreed as to each carrier of all or any of said property over all or any portion of said route to

destination and as to each party at any time interested in all or any said property, that every service to be performed hereunder shall be subject to all the bill of lading terms and conditions in the governing classification on the date of shipment. Shipper hereby certifies that he is familiar with all the lading terms and conditions in the governing classification and the said terms and conditions are hereby agreed to by the shipper and accepted for himself and his assigns

SHIPPER Shell Oil Products US
PER ON BEHALF OF SHELL / EQUILON
RECEIVING SITE SIGNATURE / DATE:

CARRIER ONYX
PER [Signature]
DATE 11/17/04

1

ATTENTION SHIPPERS!

FREIGHT CHARGES ARE PREPAID ON THIS BILL OF LADING UNLESS MARKED COLLECT.

STRAIGHT BILL OF LADING

ORIGINAL — NOT NEGOTIABLE

Shipper No. GRW 1165

Carrier No. _____

Page 1 of 1

ONYX INDUSTRIAL SERVICES

(Name of carrier)

(SCAC)

Date 11-27-04

On Collect on Delivery shipments, the letters "COD" must appear before consignee's name or as otherwise provided in Item 430 Sec 1

TO: **Shell Oil Products US**
 Consignee **MARTINEZ REFINERY**
 Street **1801 MARINA VISTA**
 City **MARTINEZ** State **CA** Zip Code **94553**

FROM: Shipper SERVICE STATION
 Street 5755 BROADWAY
 City OAKLAND State CA Zip Code _____
 24 hr. Emergency Contact Tel No **CHEMTREC 800-424-9300**

Route _____ Vehicle Number 2896-2890

No of Units & Container Type	HM	BASIC DESCRIPTION Proper Shipping Name, Hazard Class, Identification Number (UN or NA), Packing Group, per 172.101, 172.202, 172.203	TOTAL QUANTITY (Weight, Volume, Gallons, etc.)	WEIGHT (Subject to Correction)	RATE	CHARGES (For Carrier Use Only)
<u>1 T.T.</u>		NON-HAZARDOUS GROUNDWATER	<u>4300 GALS</u> <u>4748 cu</u>			
		Contains water with < 10% oil bearing materials and may include extracted groundwater from service station facilities that would be non-hazardous under federal and state waste classification criteria.				
		SOP US Martinez Refinery Receiving Gate to direct driver to the Effluent Treatment Plant Operator (x3202) for off loading directions.				
		SAP/INCIDENT #: 135699/98995756				
		RIPR #: 40025				

PLACARDS TENDERED: YES NO

Note—(1) Where the rate is dependent on value, shippers are required to state specifically in writing the agreed or declared value of the property, as follows: "The agreed or declared value of the property is hereby specifically stated by the shipper to be not exceeding _____ per _____"
 2) Where the applicable tariff provisions specify a limitation of the carrier's liability based on a release or a value declaration by the shipper and the shipper does not release the carrier's liability or declare a value, the carrier's liability shall be limited to the extent provided by such provisions. See NMFC Item 172.
 3) Commodities requiring special or additional care or attention in handling or towing must be so marked and packaged as to ensure safe transportation. See Section 2(e) of item 360 Bills of Lading, Freight Bills and Statements of Charges and Section 1(a) of the Contract Terms and Conditions for a list of such articles.

I hereby declare that the contents of this consignment are fully and accurately described above by the proper shipping name and are classified, packaged, marked and labelled/placarded, and are in all respects in proper condition for transport according to applicable international and national governmental regulations.

[Signature] Signature

REMIT C O D. TO ADDRESS

COD

Amt: \$

Subject to Section 7 of the conditions if this shipment is to be delivered to the consignee without recourse on the consignor, the consignor shall sign the following statement:
 The carrier shall not make delivery of this shipment without payment of freight and all other lawful charges.

(Signature of Consignor)

C O D. FEE:
 PREPAID
 COLLECT \$

TOTAL CHARGES \$

FREIGHT CHARGES

FREIGHT PREPAID except when box at right is checked Check box if charges are to be collect

RECEIVED, subject to the classifications and tariffs in effect on the date of issue of this Bill of Lading, the property described above in apparent good order, except as noted (contents and condition of contents of packages unknown) marked, consigned, and destined as indicated above which said carrier (the word carrier being understood throughout this contract as meaning any person or corporation in possession of the property under the contract) agrees to carry to its usual place of delivery at said destination if on its route, otherwise to deliver to another carrier on the route to said destination if it is mutually agreed as to each carrier of all or any of said property over all or any portion of said route to

destination and as to each party at any time interested in all or any said property that every service to be performed hereunder shall be subject to all the bill of lading terms and conditions in the governing classification on the date of shipment.

Shipper hereby certifies that he is familiar with all the lading terms and conditions in the governing classification and the said terms and conditions are hereby agreed to by the shipper and accepted for himself and his assigns.

SHIPPER **Shell Oil Products US**
 BY *[Signature]* ON BEHALF OF SHELL / EQUILON

CARRIER ONYX IND. SERV.

PER *[Signature]*

DATE 11-27-04

RECEIVING SITE SIGNATURE / DATE:

1

STRAIGHT BILL OF LADING

ORIGINAL — NOT NEGOTIABLE

Shipper No. GRW 1164

Carrier No. _____

Page 1 of 1

QUIX INDUSTRIAL SERVICES
(Name of carrier) (SCAC)

Date 11-28-04

On Collect on Delivery shipments the letters "COD" must appear before consignee's name or as otherwise provided in Item 430, Sec 1

TO: **Shell Oil Products US**
 Consignee **MARTINEZ REFINERY**

Street **1801 MARINA VISTA**

City **MARTINEZ** State **CA** Zip Code **94553**

FROM: Shipper SERVICE STATION

Street 5755 BROADWAY

City OAKLAND State CA Zip Code _____

24 hr. Emergency Contact Tel No. **CHEMTREC 800-424-9300**

Route _____ Vehicle Number 2897-2891

No. of Units & Container Type	HM	BASIC DESCRIPTION Proper Shipping Name, Hazard Class, Identification Number (UN or NA), Packing Group, per 172.101, 172.202, 172.203	TOTAL QUANTITY (Weight, Volume, Gallons, etc.)	WEIGHT (Subject to Correction)	RATE	CHARGES (For Carrier Use Only)
<u>1 T.T.</u>		NON-HAZARDOUS GROUNDWATER	<u>4000 GALS</u> <u>4264 u</u> <u>4269</u>			
		Contains water with < 10% oil bearing materials and may include extracted groundwater from service station facilities that would be non-hazardous under federal and state waste classification criteria.				
		SOP US Martinez Refinery Receiving Gate to direct driver to the Effluent Treatment Plant Operator (x3202) for off loading directions.				
		SAP/INCIDENT #: 135699/98995758				
		RIPR #: 40025				

PLACARDS TENDERED: YES NO

Note—(1) Where the rate is dependent on value, shippers are required to state specifically in writing the agreed or declared value of the property as follows: "The agreed or declared value of the property is hereby specifically stated by the shipper to be not exceeding _____ per _____"

2) Where the applicable tariff provisions specify a limitation of the carrier's liability absent a release or a value declaration by the shipper and the shipper does not elect the carrier's liability or declare a value, the carrier's liability shall be limited to the extent provided by such provisions. See NMFC Item 172

3) Commodities requiring special or additional care or attention in handling or stowage must be so marked and packaged as to ensure safe transportation. See Section 2(e) of Item 360, Bills of Lading, Freight Bills and Statements of Charges and Section 1(a) of the Contract Terms and Conditions for a list of such articles

I hereby declare that the contents of this consignment are fully and accurately described above by the proper shipping name and are classified, packaged, marked and labelled/placarded, and are in all respects in proper condition for transport according to applicable international and national governmental regulations

W. Wohl Signature

REMIT C.O.D TO ADDRESS _____

COD Amt. \$ _____

Subject to Section 7 of the conditions, if this shipment is to be delivered to the consignee without recourse on the consignor, the consignor shall sign the following statement:
The carrier shall not make delivery of this shipment without payment of freight and all other lawful charges

C.O.D. FEE: PREPAID COLLECT \$ _____

TOTAL CHARGES \$ _____

FREIGHT CHARGES: FREIGHT PREPAID except when box at right is checked Check box if charges are to be collect

RECEIVED, subject to the classifications and tariffs in effect on the date of issue of this Bill of Lading, the property described above in apparent good order except as noted (contents and condition of contents if packages unknown), this contract as meaning any person or corporation in possession of the property under the contract agrees to carry to its usual place of delivery at said destination, if on its route, or to deliver to another carrier on the route to said destination. It is mutually agreed as to each carrier of all or any of said property over all or any portion of said route to

destination and as to each party at any time interested in all or any said property, that every service to be performed hereunder shall be subject to all the bill of lading terms and conditions in the governing classification on the date of shipment.

Shipper hereby certifies that he is familiar with all the lading terms and conditions in the governing classification and the said terms and conditions are hereby agreed to by the shipper and accepted for himself and his assigns

SHIPPER **Shell Oil Products US**

BY *[Signature]*
ON BEHALF OF SHELL / EQUILON

CARRIER QUIX IND. SERV.

PER *W. Wohl*

DATE 11-28-04

RECEIVING SITE SIGNATURE / DATE: _____

Permanent post-office address of shipper _____

1

ATTENTION SHIPPERS!

FREIGHT CHARGES ARE PREPAID ON THIS BILL OF LADING UNLESS MARKED COLLECT

STRAIGHT BILL OF LADING

ORIGINAL — NOT NEGOTIABLE

Shipper No GRW 1145

Carrier No _____

Page 1 of 1

ONPX INDUSTRIAL SERVICES

Date 12-1-04

(Name of carrier)

(SCAC)

On Collect on Delivery shipments the letters "COD" must appear before consignee's name or as otherwise provided in Item 430, Sec 1

TO: **Shell Oil Products US**
 Consignee **MARTINEZ REFINERY**

Street **1801 MARINA VISTA**

City **MARTINEZ** State **CA** Zip Code **94553**

FROM: Shipper **SERVICE STATION**

Street **5755 BROADWAY**

City **OAKLAND** State **CA** Zip Code _____

24 hr Emergency Contact Tel. No **CHEMTREC 800-424-9300**

Route _____ Vehicle Number **2896-2890**

No. of Units & Container Type	HM	BASIC DESCRIPTION Proper Shipping Name, Hazard Class, Identification Number (UN or NA), Packing Group, per 172.101, 172.202, 172.203	TOTAL QUANTITY (Weight, Volume, Gallons, etc.)	WEIGHT (Subject to Correction)	RATE	CHARGES (For Carrier Use Only)
<u>1 T.T.</u>		NON-HAZARDOUS GROUNDWATER	<u>2500 GALS</u> <u>2312 "</u>			
		Contains water with < 10% oil bearing materials and may include extracted groundwater from service station facilities that would be non-hazardous under federal and state waste classification criteria.				
		SOP US Martinez Refinery Receiving Gate to direct driver to the Effluent Treatment Plant Operator (x3202) for off loading directions.				
		SAP/INCIDENT #: 135699/98995756				
		RIPR #: 40025				

PLACARDS TENDERED: YES NO

Note: (1) Where the rate is dependent on value, shippers are required to state specifically in writing the agreed or declared value of the property, as follows: "The agreed or declared value of the property is hereby specifically stated by the shipper to be not exceeding _____ per _____"

(2) Where the applicable tariff provisions specify a limitation of the carrier's liability absent a release or a value declaration by the shipper and the shipper does not release the carrier's liability or declare a value, the carrier's liability shall be limited to the extent provided by such provisions. See NMFC Item 177

(3) Commodities requiring special or additional care or attention in handling or stowing must be so marked and packaged as to ensure safe transportation. See Section 2(c) of item 360, Bills of Lading, Freight Bills and Statements of Charges and Section 1(a) of the Contract Terms and Conditions for a list of such articles

I hereby declare that the contents of this consignment are fully and accurately described above by the proper shipping name and are classified, packaged, marked and labelled/placarded, and are in all respects in proper condition for transport according to applicable international and national governmental regulations

W. Webb Signature

REMIT C.O.D. TO: ADDRESS

COD Amt: \$ _____

Subject to Section 7 of the conditions, if this shipment is to be delivered to the consignee without recourse on the consignor, the consignor shall sign the following statement: The carrier shall not make delivery of this shipment without payment of freight and all other lawful charges

C.O.D. FEE PREPAID COLLECT \$ _____

TOTAL CHARGES \$ _____

FREIGHT CHARGES

FREIGHT PREPAID except when box at right is checked Check box if charges are to be collect

RECEIVED subject to the regulations and tariffs in effect on the date of issue of this Bill of Lading, the property described above in apparent good order except as noted (contents and condition of contents of packages unknown), marked, consigned, and detained as indicated above which said carrier (the first carrier being understood throughout this contract as meaning any person or corporation in possession of the property under the contract) agrees to carry to its usual place of delivery at said destination, if on its route, otherwise to deliver to another carrier on the route to said destination. It is mutually agreed as to each carrier of all or any of said property over all or any portion of said route to

destination and as to each party at any time interested in all or any said property that every service to be performed hereunder shall be subject to all the bill of lading terms and conditions in the governing classification on the date of shipment

Shipper hereby certifies that he is familiar with all the lading terms and conditions in the governing classification and the said terms and conditions are hereby agreed to by the shipper and accepted for himself and his assigns

SHIPPER **Shell Oil Products US**

PER **ON BEHALF OF SHELL / EQUILON**

CARRIER **ONPX IND. SERV.**

PER *W. Webb*

RECEIVING SITE SIGNATURE / DATE:

DATE 12-1-04

1

ATTENTION SHIPPERS!

FREIGHT CHARGES ARE PREPAID ON THIS BILL OF LADING UNLESS MARKED COLLECT.

STRAIGHT BILL OF LADING

ORIGINAL — NOT NEGOTIABLE

Shipper No. GRW 1134

Carrier No. _____

Page 1 of 1

Onyx Industrial Svs
(Name of carrier)

(SCAC)

Date 12-2-04

On Collect on Delivery shipments the letters "COD" must appear before consignee's name or as otherwise provided in Item 430, Sec 1

TO: **Shell Oil Products US**
 Consignee **MARTINEZ REFINERY**

Street **1801 MARINA VISTA**

City **MARTINEZ** State **CA** Zip Code **94553**

FROM: Shipper Shell Station

Street 5755 Broadway

City Oakland State CA Zip Code _____

24 hr Emergency Contact Tel. No. **CHEMTREC 800-424-9300**

No of Units & Container Type	HM	BASIC DESCRIPTION Proper Shipping Name, Hazard Class, Identification Number (UN or NA), Packing Group, per 172.101, 172.202, 172.203	TOTAL QUANTITY (Weight, Volume, Gallons, etc.)	WEIGHT (Subject to Correction)	RATE	CHARGES (For Carrier Use Only)
<u>1 TT</u>		NON-HAZARDOUS GROUNDWATER	<u>3000</u> <u>3474</u>			
		Contains water with < 10% oil bearing materials and may include extracted groundwater from service station facilities that would be non-hazardous under federal and state waste classification criteria.				
		SOP US Martinez Refinery Receiving Gate to direct driver to the Effluent Treatment Plant Operator (x3202) for off loading directions.				
		SAP/INCIDENT #: <u>135699/98995756</u>				
		RIPR #: <u>40025</u>				

Vehicle Number 2896/2890

PLACARDS TENDERED: YES NO

Note—(1) Where the rate is dependent on value, shippers are required to state specifically in writing the agreed or declared value of the property, as follows: "The agreed or declared value of the property is hereby specifically stated by the shipper to be not exceeding _____ per _____"

(2) Where the applicable tariff provisions specify a limitation of the carrier's liability absent a release or a value declaration by the shipper and the shipper does not release the carrier's liability or declare a value, the carrier's liability shall be limited to the extent provided by such provisions. See NMFC Item 172

(3) Commodities requiring special or additional care or attention in handling or stowing must be so marked and packaged as to ensure safe transportation. See Section 2(e) of item 360 Bills of Lading, Freight Bills and Statements of Charges and Section 1(a) of the Contract Terms and Conditions for a list of such articles

I hereby declare that the contents of this consignment are fully and accurately described above by the proper shipping name and are classified, packaged, marked and labeled/placarded, and are in all respects in proper condition for transport according to applicable international and national governmental regulations

Raymond Paul Signature

REMIT C.O.D. TO ADDRESS

COD Amt \$ _____

Subject to Section 7 of the conditions, if this shipment is to be delivered to the consignee without recourse on the consignor, the consignor shall sign the following statement
The carrier shall not make delivery of this shipment without payment of freight and all other lawful charges

C.O.D. FEE
PREPAID
COLLECT \$ _____

TOTAL CHARGES \$ _____

FREIGHT CHARGES
FREIGHT PREPAID except when box at right is checked Check box if charges are to be collect

RECEIVED subject to the classifications and tariffs in effect on the date of issue of this Bill of Lading the property described above in apparent good order except as noted (contents and condition of contents of packages unknown) marked, consigned and delivered as indicated above which said carrier (the word carrier being understood throughout this contract as meaning any person or corporation in possession of the property under the contract) agrees to carry to its usual place of delivery at said destination, if on its route, otherwise to deliver to another carrier on the route to said destination. It is mutually agreed as to each carrier of all or any of said property over all or any portion of said route to

destination and as to each party at any time interested in all or any said property, that every service to be performed hereunder shall be subject to all the bill of lading terms and conditions in the governing classification on the date of shipment

Shipper hereby certifies that he is familiar with all the lading terms and conditions in the governing classification and the said terms and conditions are hereby agreed to by the shipper and accepted for himself and his assigns

SHIPPER **Shell Oil Products US**

PER **ON BEHALF OF SHELL / EQUILON**

RECEIVING SITE SIGNATURE / DATE: _____

CARRIER Raymond Paul

PER Onyx Industrial Service

DATE 12-2-04

1

ATTENTION SHIPPERS!

FREIGHT CHARGES ARE PREPAID ON THIS BILL OF LADING UNLESS MARKED COLLECT.

STRAIGHT BILL OF LADING

ORIGINAL — NOT NEGOTIABLE

Shipper No. GRW 1376

Carrier No. _____

Page 1 of 1

ONYX INC
(Name of carrier)

(SCAC)

Date 12-7-04

On Collect on Delivery shipments the letters 'COD' must appear before consignee's name or as otherwise provided in Item 430 Sec. 1

TO: **Shell Oil Products US**
 Consignee **MARTINEZ REFINERY**

Street **1801 MARINA VISTA**

City **MARTINEZ** State **CA** Zip Code **94553**

FROM: Shipper SHELL SERVICE STATION

Street 5755 BROADWAY

City OKLAND State CA Zip Code _____

24 hr Emergency Contact Tel. No. **CHEMTREC 800-424-9300**

No of Units & Container Type	HM	BASIC DESCRIPTION Proper Shipping Name, Hazard Class, Identification Number (UN or NA), Packing Group, per 172 101, 172 202, 172 203	TOTAL QUANTITY (Weight, Volume, Gallons, etc)	WEIGHT (Subject to Correction)	RATE	CHARGES (For Carrier Use Only)
		NON-HAZARDOUS GROUNDWATER	<u>5000</u>			
		<u>SAP CODE 135 699</u>	<u>4934 gallons</u>			
		<u>RIPR 40025</u>				
		Contains water with < 10% oil bearing materials and may include extracted groundwater from service station facilities that would be non-hazardous under federal and state waste classification criteria.				
		SOP US Martinez Refinery Receiving Gate to direct driver to the Effluent Treatment Plant Operator (x3202) for off loading directions.				
		<u>SAP/INCIDENT #: 135 699</u>				
		<u>RIPR #: 400 25</u>				

PLACARDS TENDERED: YES NO

Note --(1) Where the rate is dependent on value shippers are required to state specifically in writing the agreed or declared value of the property, as follows: The agreed or declared value of the property is hereby specifically stated by the shipper to be not exceeding _____ per _____

(2) Where the applicable tariff provisions specify a limitation of the carrier's liability absent a release or a value declaration by the shipper and the shipper does not release the carrier's liability or declare a value, the carrier's liability shall be limited to the extent provided by such provisions. See NMFC Item 177

(3) Commodities requiring special or additional care or attention in handling or stowing must be so marked and packaged as to ensure safe transportation. See Section 2(e) of item 360 Bills of Lading, Freight Bills and Statements of Charges and Section 1(a) of the Contract Terms and Conditions for a list of such articles

REMIT COD TO ADDRESS

COD Amt: \$ _____

Subject to Section 7 of the conditions, if this shipment is to be delivered to the consignee without recourse on the consignor, the consignor shall sign the following statement: The carrier shall not make delivery of this shipment without payment of freight and all other lawful charges

C.O.D. FEE PREPAID COLLECT \$ _____

TOTAL CHARGES \$ _____

FREIGHT CHARGES
 FREIGHT PREPAID except when box at right is checked Check box if charges are to be collect

Signature _____ (Signature of Consignor)

IF RECEIVED subject to the classifications and tariffs in effect on the date of issue of this Bill of Lading, the property described above in apparent good order, except as noted (contents and condition of contents of packages unknown) marked, consigned and delivered as indicated above which said carrier (the word carrier being understood throughout this contract as meaning any person or corporation in possession of the property under the contract) agrees to carry to its usual place of delivery at said destination if on its route; otherwise to deliver to another carrier on the route to said destination. It is mutually agreed as to each carrier of all or any of said property over all or any portion of said route to

destination and as to each party at any time interested in all or any said property, that every service to be performed hereunder shall be subject to all the bill of lading terms and conditions in the governing classification on the date of shipment

Shipper hereby certifies that he is familiar with all the lading terms and conditions in the governing classification and the said terms and conditions are hereby agreed to by the shipper and accepted for himself and his assigns

SHIPPER **Shell Oil Products US**

PER [Signature] ON BEHALF OF SHELL / EQUILON

RECEIVING SITE SIGNATURE / DATE: _____

CARRIER ONYX INC

PER [Signature]

DATE 12-7-04

1