



**Denis L. Brown**

Jerry Wickham  
Alameda County Health Care Services Agency  
1131 Harbor Bay Parkway, Suite 250  
Alameda, California 94502-6577

Re: Shell-branded Service Station  
5755 Broadway  
Oakland, California  
SAP Code 135699  
Incident No. 98995756  
ACHCSA Case No. RO-0026

Dear Mr. Wickham:

The attached document is provided for your review and comment. Upon information and belief, I declare, under penalty of perjury, that the information contained in the attached document is true and correct.

If you have any questions or concerns, please call me at (707) 865-0251.

Sincerely,

A handwritten signature in black ink, appearing to read "Denis Brown", is located below the "Sincerely," text.

Denis L. Brown  
Project Manager

**RECEIVED**

2:59 pm, Jan 14, 2008

Alameda County  
Environmental Health

**Shell Oil Products US**

HSE – Environmental Services  
20945 S. Wilmington Ave.  
Carson, CA 90810-1039  
Tel (707) 865 0251  
Fax (707) 865 2542

Email [denis.l.brown@shell.com](mailto:denis.l.brown@shell.com)



**CONESTOGA-ROVERS  
& ASSOCIATES**

19449 Riverside Drive, Suite 230, Sonoma, California 95476  
Telephone: 707-935-4850 Facsimile: 707-935-6649  
www.CRAworld.com

January 14, 2008

Mr. Jerry Wickham  
Alameda County Health Care Services Agency  
1131 Harbor Bay Parkway, Suite 250  
Alameda, California 94502-6577

Re: **Groundwater Monitoring Report –Fourth Quarter 2007**  
Shell-branded Service Station  
5755 Broadway  
Oakland, California  
SAP Code 135699  
Incident No. 98995756  
ACHCSA Case No. RO-0026

Dear Mr. Wickham:

Conestoga-Rovers and Associates (CRA) prepared this report on behalf of Equilon Enterprises LLC dba Shell Oil Products US (Shell) in accordance with the quarterly reporting requirements of 23 CCR 2652d.

If you have any questions regarding the contents of this document, please call Ana Friel at (707) 268-3812.

Sincerely,  
**Conestoga-Rovers and Associates**

Ana Friel, PG  
Project Manager

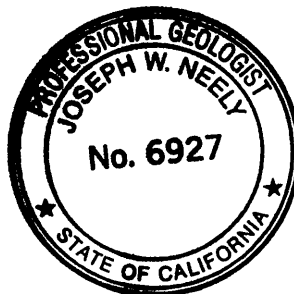

cc: Denis Brown, Shell Oil Products US, 20945 S. Wilmington Ave., Carson, CA 90810  
Thrifty Oil Company, c/o Mr. Raymond Fredricksen, PO Box 2128, Santa Fe Springs, CA  
90670 (property owner)

Equal  
Employment  
Opportunity Employer



**CONESTOGA-ROVERS  
& ASSOCIATES**

Mr. Jerry Wickham  
January 14, 2008

## **GROUNDWATER MONITORING REPORT – FOURTH QUARTER 2007**

<b>Site Address</b>	<u>5755 Broadway, Oakland</u>
<b>Site Use</b>	<u>Shell-branded Service Station</u>
<b>Shell Project Manager</b>	<u>Denis Brown</u>
<b>Consultant and Contact Person</b>	<u>CRA, Ana Friel</u>
<b>Lead Agency and Contact</b>	<u>ACHCSA, Jerry Wickham</u>
<b>Agency Case No.</b>	<u>RO 0026</u>
<b>Shell SAP Code</b>	<u>135699</u>
<b>Shell Incident No.</b>	<u>98995756</u>
<b>Date of Most Recent Agency Correspondence</b>	<u>August 9, 2006</u>

### **Current Quarter's Activities**

1. Blaine Tech Services, Inc. (Blaine) gauged and sampled wells according to the established monitoring program for this site.
2. CRA prepared a vicinity map (Figure 1) and a groundwater contour and chemical concentration map (Figure 2). The Blaine report, presenting the analytical data, is included in Attachment A.

### **Current Quarter's Findings**

<b>Groundwater Flow Direction</b>	<u>South-Southwest</u>
<b>Hydraulic Gradient</b>	<u>0.05</u>
<b>Depth to Water</b>	<u>0.55 to 2.31 feet below top of well casing</u>



**CONESTOGA-ROVERS  
& ASSOCIATES**

Mr. Jerry Wickham  
January 14, 2008

### **Proposed Activities for Next Quarter**

1. Blaine will gauge and sample wells during the second month of the quarter, according to the established monitoring program for this site.

Figures:        1 - Vicinity Map  
                  2 - Groundwater Contour and Chemical Concentration Map

Attachments:    A - Blaine Tech Services, Inc. - Groundwater Monitoring Report

Conestoga-Rovers and Associates (CRA) prepared this document for use by our client and appropriate regulatory agencies. It is based partially on information available to CRA from outside sources and/or in the public domain, and partially on information supplied by CRA and its subcontractors. CRA makes no warranty or guarantee, expressed or implied, included or intended in this document, with respect to the accuracy of information obtained from these outside sources or the public domain, or any conclusions or recommendations based on information that was not independently verified by CRA. This document represents the best professional judgment of CRA. None of the work performed hereunder constitutes or shall be represented as a legal opinion of any kind or nature.

I:\Sonoma.Shell\Oakland 5755 Broadway\QM\2007\4Q07\4Q07 0483 text.doc

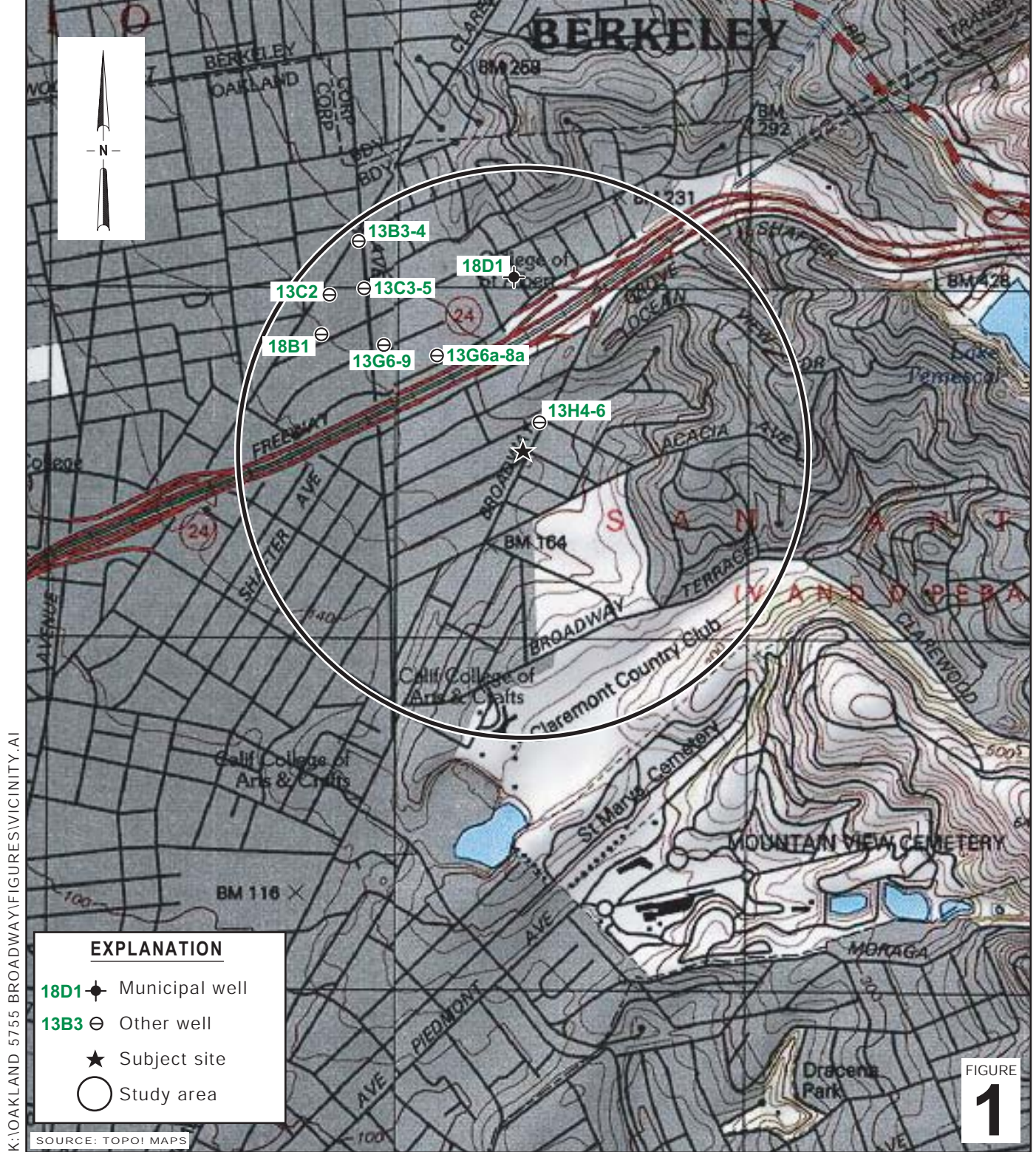

**Shell-branded Service Station**  
 5755 Broadway  
 Oakland, California

**Vicinity Map**



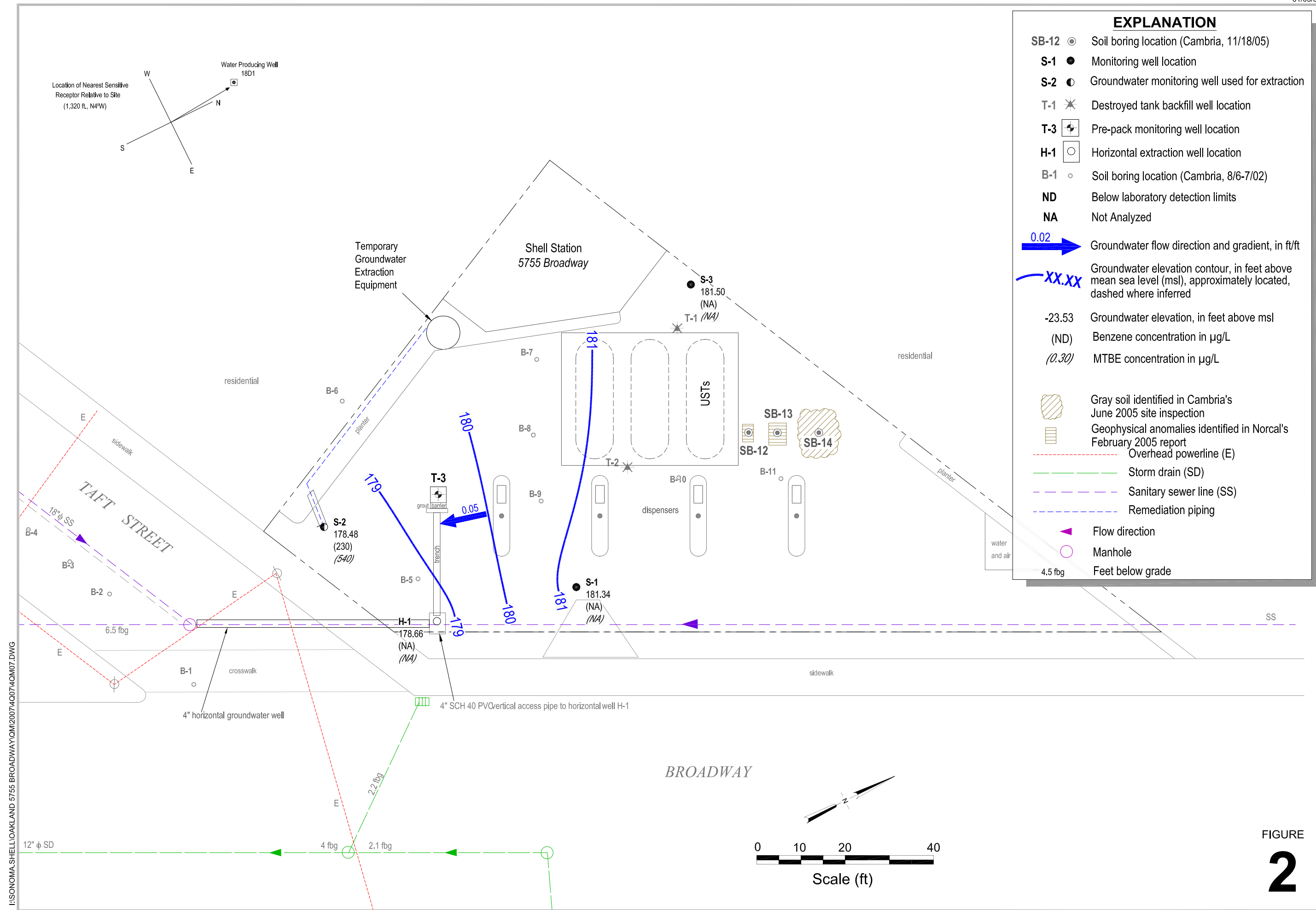
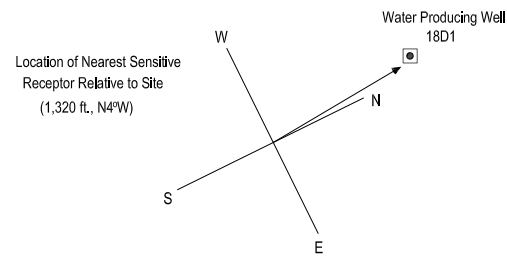

### EXPLANATION

- SB-12 ● Soil boring location (Cambria, 11/18/05)
- S-1 ● Monitoring well location
- S-2 ● Groundwater monitoring well used for extraction
- T-1 ✱ Destroyed tank backfill well location
- T-3 ◻ Pre-pack monitoring well location
- H-1 ◯ Horizontal extraction well location
- B-1 ○ Soil boring location (Cambria, 8/6-7/02)
- ND Below laboratory detection limits
- NA Not Analyzed
- 0.02 → Groundwater flow direction and gradient, in ft/ft
- XX.XX — Groundwater elevation contour, in feet above mean sea level (msl), approximately located, dashed where inferred
- 23.53 Groundwater elevation, in feet above msl
- (ND) Benzene concentration in µg/L
- (0.30) MTBE concentration in µg/L
- ▨ Gray soil identified in Cambria's June 2005 site inspection
- ▨ Geophysical anomalies identified in Norcal's February 2005 report
- - - Overhead powerline (E)
- - - Storm drain (SD)
- - - Sanitary sewer line (SS)
- - - Remediation piping
- ◀ Flow direction
- Manhole
- 4.5 fbg Feet below grade

I:\SONOMA-SHELL\OAKLAND 5755 BROADWAY\QM200740074QIM07.DWG

Groundwater Contour and Chemical Concentration Map

November 13, 2007



Shell-branded Service Station

5755 Broadway  
Oakland, California

FIGURE  
**2**

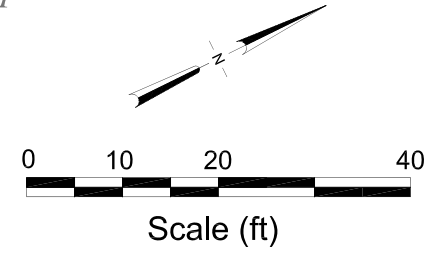

**Attachment A**

**Blaine Tech Services, Inc.  
Groundwater Monitoring Report**

---

**BLAINE**  
TECH SERVICES INC.

---

GROUNDWATER SAMPLING SPECIALISTS  
SINCE 1985

November 30, 2007

Denis Brown  
Shell Oil Products US  
20945 South Wilmington Avenue  
Carson, CA 90810

Fourth Quarter 2007 Groundwater Monitoring at  
Shell-branded Service Station  
5755 Broadway  
Oakland, CA

Monitoring performed on November 13, 2007

---

Groundwater Monitoring Report **071113-MP-2**

This report covers the routine monitoring of groundwater wells at this Shell-branded facility. In accordance with standard procedures that conform to Regional Water Quality Control Board requirements, routine field data collection includes depth to water, total well depth, thickness of any separate immiscible layer, water column volume, calculated purge volume (if applicable), elapsed evacuation time (if applicable), total volume of water removed (if applicable), and standard water parameter instrument readings. Sample material is collected, contained, stored, and transported to the laboratory in conformance with EPA standards. Purgewater (if applicable) is, likewise, collected and transported to the Martinez Refining Company.

Basic field information is presented alongside analytical values excerpted from the laboratory report in the cumulative table of **WELL CONCENTRATIONS**. The full analytical report for the most recent samples and the field data sheets are attached to this report.

At a minimum, Blaine Tech Services, Inc. field personnel are certified on completion of a forty-hour Hazardous Materials and Emergency Response training course per 29 CFR 1910.120. Field personnel are also enrolled in annual eight-hour refresher courses.



Blaine Tech Services, Inc. conducts sampling and documentation assignments of this type as an independent third party. Our activities at this site consisted of objective data and sample collection only. No interpretation of analytical results, defining of hydrological conditions or formulation of recommendations was performed.

Please call if you have any questions.

Yours truly,

Mike Ninokata  
Project Manager

MN/ks

attachments: Cumulative Table of WELL CONCENTRATIONS  
Certified Analytical Report  
Field Data Sheets

cc: Ana Friel  
Conestoga-Rovers & Associates  
19449 Riverside Dr., Suite 230  
Sonoma, CA 95476

**WELL CONCENTRATIONS**  
**Shell-branded Service Station**  
**5755 Broadway**  
**Oakland, CA**

Well ID	Date	TPPH (ug/L)	B (ug/L)	T (ug/L)	E (ug/L)	X (ug/L)	MTBE 8020 (ug/L)	MTBE 8260 (ug/L)	DIPE (ug/L)	ETBE (ug/L)	TAME (ug/L)	TBA (ug/L)	TOC (MSL)	Depth to Water (ft.)	GW Elevation (MSL)	DO Reading (ppm)
S-1	01/25/1991	<30	<0.3	<0.3	<0.3	<0.3	NA	NA	NA	NA	NA	NA	100.00	3.88	96.12	NA
S-1	06/03/1991	<30	<0.3	<0.3	<0.3	<0.3	NA	NA	NA	NA	NA	NA	100.00	3.51	96.49	NA
S-1	08/30/1991	<30	<0.3	<0.3	<0.3	<0.3	NA	NA	NA	NA	NA	NA	100.00	4.24	95.76	NA
S-1	11/22/1991	<30	2.3	<0.46	0.3	<0.65	NA	NA	NA	NA	NA	NA	100.00	4.29	95.71	NA
S-1	03/13/1992	<30	<0.52	<0.3	<0.3	<0.3	NA	NA	NA	NA	NA	NA	100.00	2.87	97.13	NA
S-1	05/28/1992	<50	<0.5	<0.5	<0.5	<0.5	NA	NA	NA	NA	NA	NA	100.00	3.79	96.21	NA
S-1	08/19/1992	<50	<0.5	<0.5	<0.5	<0.5	NA	NA	NA	NA	NA	NA	100.00	4.43	95.57	NA
S-1	11/18/1992	<50	<0.5	<0.5	<0.5	<0.5	NA	NA	NA	NA	NA	NA	100.00	4.34	95.66	NA
S-1	02/10/1993	51	1.4	<0.5	<0.5	<0.5	NA	NA	NA	NA	NA	NA	100.00	4.20	95.80	NA
S-1 (D)	02/10/1993	<50	1.2	<0.5	<0.5	<0.5	NA	NA	NA	NA	NA	NA	100.00	4.20	95.80	NA
S-1	06/11/1993	<50	<0.5	<0.5	<0.5	<0.5	NA	NA	NA	NA	NA	NA	100.00	3.39	96.61	NA
S-1	08/03/1993	<50	<0.5	<0.5	<0.5	<0.5	NA	NA	NA	NA	NA	NA	100.00	3.69	96.31	NA
S-1	11/02/1993	70a	<0.5	<0.5	<0.5	<0.5	NA	NA	NA	NA	NA	NA	100.00	4.26	95.74	NA
S-1	12/16/1993	NA	NA	NA	NA	NA	NA	NA	NA	NA	NA	NA	100.00	2.73	97.27	NA
S-1	02/01/1994	60a	<0.5	<0.5	<0.5	<0.5	NA	NA	NA	NA	NA	NA	100.00	3.38	96.62	NA
S-1	05/04/1994	<50	1.1	<0.5	<0.5	<0.5	NA	NA	NA	NA	NA	NA	100.00	3.00	97.00	NA
S-1	08/18/1994	<50	0.6	<0.5	<0.5	<0.5	NA	NA	NA	NA	NA	NA	100.00	3.70	96.30	NA
S-1 (D)	08/18/1994	60a	0.5	<0.5	<0.5	<0.5	NA	NA	NA	NA	NA	NA	100.00	3.70	96.30	NA
S-1	11/09/1994	<50	4	<0.5	<0.5	<0.5	NA	NA	NA	NA	NA	NA	100.00	2.52	97.48	NA
S-1	02/22/1995	50	0.8	0.7	<0.5	1.3	NA	NA	NA	NA	NA	NA	100.00	4.08	95.92	NA
S-1	05/02/1995	<50	<0.5	<0.5	<0.5	<0.5	NA	NA	NA	NA	NA	NA	100.00	2.58	97.42	NA
S-1	08/30/1995	<50	1.7	<0.5	<0.5	<0.5	NA	NA	NA	NA	NA	NA	100.00	3.48	96.52	NA
S-1	11/28/1995	<50	<0.5	<0.5	<0.5	<0.5	NA	NA	NA	NA	NA	NA	100.00	3.99	96.01	NA
S-1	02/02/1996	<50	11	<0.5	0.9	<0.5	NA	NA	NA	NA	NA	NA	100.00	2.00	98.00	NA
S-1	03/09/1996	<50	<0.5	<0.5	<0.5	<0.5	NA	NA	NA	NA	NA	NA	100.00	3.38	99.62	NA
S-1	08/22/1996	<50	1.5	<0.5	<0.5	<0.5	130	NA	NA	NA	NA	NA	100.00	3.43	96.57	NA
S-1	11/07/1996	<50	<0.5	<0.5	<0.5	<0.5	57	NA	NA	NA	NA	NA	100.00	3.70	96.30	4.33
S-1	02/20/1997	<50	0.64	<0.50	<0.50	1.6	6.5	NA	NA	NA	NA	NA	100.00	3.60	96.40	2

**WELL CONCENTRATIONS**  
**Shell-branded Service Station**  
**5755 Broadway**  
**Oakland, CA**

Well ID	Date	TPPH (ug/L)	B (ug/L)	T (ug/L)	E (ug/L)	X (ug/L)	MTBE 8020 (ug/L)	MTBE 8260 (ug/L)	DIPE (ug/L)	ETBE (ug/L)	TAME (ug/L)	TBA (ug/L)	TOC (MSL)	Depth to Water (ft.)	GW Elevation (MSL)	DO Reading (ppm)
S-1	05/30/1997	<50	<0.50	<0.50	<0.50	<0.50	46	NA	NA	NA	NA	NA	100.00	3.47	96.53	7
S-1 (D)	05/30/1997	<50	<0.50	<0.50	<0.50	<0.50	47	NA	NA	NA	NA	NA	100.00	3.47	96.53	7
S-1	08/21/1997	<50	<0.50	<0.50	<0.50	0.84	26	NA	NA	NA	NA	NA	100.00	3.01	96.99	3.1
S-1	11/03/1997	<50	<0.50	1.1	<0.50	1.3	190	NA	NA	NA	NA	NA	100.00	3.66	96.34	2
S-1	01/20/1998	110	7.9	2.8	4.4	13	53	NA	NA	NA	NA	NA	100.00	1.84	98.16	4.6
S-1 (D)	01/20/1998	130	9.2	6.9	5.2	15	93	NA	NA	NA	NA	NA	100.00	1.84	98.16	4.6
S-1	02/16/1999	<50	<0.50	<0.50	<0.50	<0.50	8.6	NA	NA	NA	NA	NA	100.00	2.43	97.57	2.2
S-1	09/07/1999	NA	NA	NA	NA	NA	NA	NA	NA	NA	NA	NA	100.00	2.84	97.16	NA
S-1	02/02/2000	<50.0	<0.500	<0.500	<0.500	<0.500	202	NA	NA	NA	NA	NA	100.00	3.10	96.90	2.1
S-1	04/26/2000	NA	NA	NA	NA	NA	NA	NA	NA	NA	NA	NA	100.00	2.91	97.09	NA
S-1	07/25/2000	<50.0	<0.500	<0.500	<0.500	<0.500	811	NA	NA	NA	NA	NA	100.00	3.21	96.79	1.8
S-1	11/15/2000	NA	NA	NA	NA	NA	NA	NA	NA	NA	NA	NA	100.00	3.18	96.82	NA
S-1	02/12/2001	<50.0	<0.500	<0.500	<0.500	<0.500	209	NA	NA	NA	NA	NA	100.00	1.34	98.66	2.2
S-1	06/07/2001	NA	NA	NA	NA	NA	NA	NA	NA	NA	NA	NA	100.00	1.27	98.73	NA
S-1	08/31/2001	<50	<0.50	<0.50	<0.50	<0.50	NA	<5.0	NA	NA	NA	NA	100.00	3.16	96.84	4.0
S-1	12/05/2001	NA	NA	NA	NA	NA	NA	2.6	NA	NA	NA	NA	100.00	1.90	98.10	NA
S-1	01/31/2002	<50	<0.50	<0.50	<0.50	<0.50	NA	<5.0	NA	NA	NA	NA	100.00	2.67	97.33	NA
S-1	06/04/2002	NA	NA	NA	NA	NA	NA	NA	NA	NA	NA	NA	100.00	1.87	98.13	NA
S-1	07/25/2002	<50	<0.50	<0.50	<0.50	<0.50	NA	<5.0	NA	NA	NA	NA	100.00	2.01	97.99	NA
S-1	11/07/2002	NA	NA	NA	NA	NA	NA	NA	NA	NA	NA	NA	181.89	3.01	178.88	NA
S-1	11/14/2002	NA	NA	NA	NA	NA	NA	NA	NA	NA	NA	NA	181.89	3.40	178.49	NA
S-1	01/30/2003	<50	<0.50	<0.50	<0.50	<0.50	NA	27	NA	NA	NA	NA	181.89	2.12	179.77	NA
S-1	06/03/2003	NA	NA	NA	NA	NA	NA	NA	NA	NA	NA	NA	181.89	1.83	180.06	NA
S-1	08/27/2003	<50	0.50	1.5	<0.50	2.0	NA	130	NA	NA	NA	NA	181.89	3.32	178.57	NA
S-1	11/25/2003	NA	NA	NA	NA	NA	NA	NA	NA	NA	NA	NA	181.89	3.28	178.61	NA
S-1	02/05/2004	270	2.4	6.4	5.8	19	NA	8.3	NA	NA	NA	NA	181.89	2.09	179.80	NA
S-1	04/21/2004	NA	NA	NA	NA	NA	NA	NA	NA	NA	NA	NA	181.89	2.61	179.28	NA
S-1	08/12/2004	<500	<5.0	<5.0	<5.0	<10	NA	1,100	<20	<20	<20	<50	181.89	3.70	178.19	NA

**WELL CONCENTRATIONS**  
**Shell-branded Service Station**  
**5755 Broadway**  
**Oakland, CA**

Well ID	Date	TPPH (ug/L)	B (ug/L)	T (ug/L)	E (ug/L)	X (ug/L)	MTBE 8020 (ug/L)	MTBE 8260 (ug/L)	DIPE (ug/L)	ETBE (ug/L)	TAME (ug/L)	TBA (ug/L)	TOC (MSL)	Depth to Water (ft.)	GW Elevation (MSL)	DO Reading (ppm)
---------	------	----------------	-------------	-------------	-------------	-------------	------------------------	------------------------	----------------	----------------	----------------	---------------	--------------	----------------------------	--------------------------	------------------------

S-1	11/08/2004	NA	NA	NA	NA	NA	NA	NA	NA	NA	NA	NA	181.89	3.04	178.85	NA
S-1	05/16/2005	<50	<0.50	<0.50	<0.50	<1.0	NA	4.9	NA	NA	NA	NA	181.89	3.10	178.79	NA
S-1	08/16/2005	<50	<0.50	<0.50	<0.50	<1.0	NA	64	<2.0	<2.0	<2.0	52	181.89	0.73	181.16	NA
S-1	11/03/2005	NA	NA	NA	NA	NA	NA	NA	NA	NA	NA	NA	181.89	3.49	178.40	NA
S-1	02/16/2006	<50.0	<0.500	<0.500	<0.500	<0.500	NA	22.7	NA	NA	NA	NA	181.89	0.73	181.16	NA
S-1	05/05/2006	NA	NA	NA	NA	NA	NA	NA	NA	NA	NA	NA	181.89	0.71	181.18	NA
S-1	08/21/2006	<50.0	0.630	<0.500	<0.500	1.71	NA	44.6	<0.500	<0.500	<0.500	<10.0	181.89	3.34	178.55	NA
S-1	11/13/2006	NA	NA	NA	NA	NA	NA	NA	NA	NA	NA	NA	181.89	2.55	179.34	NA
S-1	01/30/2007	<50	<0.50	<0.50	<0.50	<1.0	NA	24	NA	NA	NA	NA	181.89	0.91	180.98	NA
S-1	05/23/2007	NA	NA	NA	NA	NA	NA	NA	NA	NA	NA	NA	181.89	2.50	179.39	NA
S-1	08/09/2007	<50 h	0.35 i	<1.0	<1.0	<1.0	NA	33	<2.0	<2.0	<2.0	<10	181.89	0.81	181.08	NA
<b>S-1</b>	<b>11/13/2007</b>	<b>NA</b>	<b>NA</b>	<b>NA</b>	<b>NA</b>	<b>NA</b>	<b>NA</b>	<b>NA</b>	<b>NA</b>	<b>NA</b>	<b>NA</b>	<b>NA</b>	<b>181.89</b>	<b>0.55</b>	<b>181.34</b>	<b>NA</b>

S-2	01/25/1991	450	140	1.8	6.2	15	NA	NA	NA	NA	NA	NA	98.92	4.52	94.40	NA
S-2	06/03/1991	490	150	2.7	8.2	7	NA	NA	NA	NA	NA	NA	98.92	4.02	94.90	NA
S-2	08/30/1991	70	0.37	<0.3	<0.3	<0.3	NA	NA	NA	NA	NA	NA	98.92	4.70	94.22	NA
S-2	11/22/1991	1,600	110	9.3	29	150	NA	NA	NA	NA	NA	NA	98.92	4.72	94.20	NA
S-2	03/13/1992	1,300	210	5.7	34	79	NA	NA	NA	NA	NA	NA	98.92	3.47	95.45	NA
S-2	05/28/1992	100	28	<0.5	<0.5	<0.5	NA	NA	NA	NA	NA	NA	98.92	4.45	94.45	NA
S-2	08/19/1992	470	42	<0.5	8.3	4	NA	NA	NA	NA	NA	NA	98.92	4.84	94.08	NA
S-2	11/18/1992	490	43	39	17	29	NA	NA	NA	NA	NA	NA	98.92	4.73	94.19	NA
S-2	02/10/1993	19,000	710	760	80	370	NA	NA	NA	NA	NA	NA	98.92	4.83	94.09	NA
S-2	06/11/1993	33,000	3,100	1,600	370	1,100	NA	NA	NA	NA	NA	NA	98.92	3.74	95.18	NA
S-2	08/03/1993	18,000	1,400	130	81	130	NA	NA	NA	NA	NA	NA	98.92	4.23	94.69	NA
S-2 (D)	08/03/1993	19,000	1,400	140	86	150	NA	NA	NA	NA	NA	NA	98.92	4.23	94.69	NA
S-2	11/02/1993	12,000 a	470	47	31	92	NA	NA	NA	NA	NA	NA	98.92	4.72	94.20	NA
S-2 (D)	11/02/1993	13,000 a	530	47	35	96	NA	NA	NA	NA	NA	NA	98.92	4.72	94.20	NA
S-2	12/16/1993	NA	NA	NA	NA	NA	NA	NA	NA	NA	NA	NA	98.92	3.00	95.92	NA

**WELL CONCENTRATIONS**  
**Shell-branded Service Station**  
**5755 Broadway**  
**Oakland, CA**

Well ID	Date	TPPH (ug/L)	B (ug/L)	T (ug/L)	E (ug/L)	X (ug/L)	MTBE 8020 (ug/L)	MTBE 8260 (ug/L)	DIPE (ug/L)	ETBE (ug/L)	TAME (ug/L)	TBA (ug/L)	TOC (MSL)	Depth to Water (ft.)	GW Elevation (MSL)	DO Reading (ppm)
S-2	02/01/1994	31,000 a	430	46	50	130	NA	NA	NA	NA	NA	NA	98.92	3.48	95.44	NA
S-2 (D)	02/01/1994	31,000 a	300	33	30	100	NA	NA	NA	NA	NA	NA	98.92	3.48	95.44	NA
S-2	05/04/1994	3,900	1,200	31	53	71	NA	NA	NA	NA	NA	NA	98.92	3.26	95.66	NA
S-2 (D)	05/04/1994	4,500	1,200	37	57	110	NA	NA	NA	NA	NA	NA	98.92	3.26	95.66	NA
S-2	08/18/1994	24,000	600	8.3	15	27	NA	NA	NA	NA	NA	NA	98.92	3.98	94.94	NA
S-2	11/09/1994	1,400 a	240	9.3	13	20	NA	NA	NA	NA	NA	NA	98.92	3.10	95.82	NA
S-2 (D)	11/09/1994	1,800	260	8.5	13	21	NA	NA	NA	NA	NA	NA	98.92	3.10	95.82	NA
S-2	02/22/1995	29,000	550	18	12	63	NA	NA	NA	NA	NA	NA	98.92	4.02	94.90	NA
S-2 (D)	02/22/1995	28,000	530	17	10	60	NA	NA	NA	NA	NA	NA	98.92	4.02	94.90	NA
S-2	05/02/1995	4,400	1,000	25	38	77	NA	NA	NA	NA	NA	NA	98.92	2.86	96.06	NA
S-2 (D)	05/02/1995	4,400	1,000	26	41	83	NA	NA	NA	NA	NA	NA	98.92	2.86	96.06	NA
S-2	08/30/1995	800	350	20	6.7	16	NA	NA	NA	NA	NA	NA	98.92	4.06	94.86	NA
S-2 (D)	08/30/1995	960	220	22	12	48	NA	NA	NA	NA	NA	NA	98.92	4.06	94.86	NA
S-2	11/28/1995	2,000	230	220	50	230	NA	NA	NA	NA	NA	NA	98.92	4.48	94.44	NA
S-2 (D)	11/28/1995	2,100	240	230	51	230	NA	NA	NA	NA	NA	NA	98.92	4.48	94.44	NA
S-2	02/02/1996	18,000	540	18	12	22	NA	NA	NA	NA	NA	NA	98.92	1.99	96.93	NA
S-2 (D)	02/02/1996	11,000	600	18	13	28	NA	NA	NA	NA	NA	NA	98.92	1.99	96.93	NA
S-2	03/09/1996	3,800	1,500	27	30	58	NA	NA	NA	NA	NA	NA	98.92	3.27	95.65	NA
S-2 (D)	03/09/1996	3,500	1,300	24	21	53	NA	NA	NA	NA	NA	NA	98.92	3.27	95.65	NA
S-2	08/22/1996	<20,000	490	<200	<200	<200	43,000	NA	NA	NA	NA	NA	98.92	3.85	95.07	NA
S-2 (D)	08/22/1996	<20,000	570	<200	<200	<200	59,000	51,000	NA	NA	NA	NA	98.92	3.85	95.07	NA
S-2	11/07/1996	<5,000	290	<50	<50	<50	32,000	NA	NA	NA	NA	NA	98.92	4.00	94.92	3.51
S-2 (D)	11/07/1996	<5,000	290	<50	<50	<50	32,000	NA	NA	NA	NA	NA	98.92	4.00	94.92	3.51
S-2	02/20/1997	<10,000	520	<100	<100	<100	28,000	NA	NA	NA	NA	NA	98.92	3.20	95.72	1
S-2 (D)	02/20/1997	<10,000	520	<100	<100	<100	35,000	NA	NA	NA	NA	NA	98.92	3.20	95.72	1
S-2	05/30/1997	150	15	11	3.5	15	11	NA	NA	NA	NA	NA	98.92	3.87	95.05	6
S-2	08/21/1997	1,600	220	<10	20	<10	18,000	NA	NA	NA	NA	NA	98.92	3.29	95.63	3.3
S-2 (D)	08/21/1997	1,500	180	<10	16	<10	21,000	NA	NA	NA	NA	NA	98.92	3.29	95.63	3.3

**WELL CONCENTRATIONS**  
**Shell-branded Service Station**  
**5755 Broadway**  
**Oakland, CA**

Well ID	Date	TPPH (ug/L)	B (ug/L)	T (ug/L)	E (ug/L)	X (ug/L)	MTBE 8020 (ug/L)	MTBE 8260 (ug/L)	DIPE (ug/L)	ETBE (ug/L)	TAME (ug/L)	TBA (ug/L)	TOC (MSL)	Depth to Water (ft.)	GW Elevation (MSL)	DO Reading (ppm)
S-2	11/03/1997	1,000	94	<10	<10	<10	<50	NA	NA	NA	NA	NA	98.92	4.02	94.90	1.8
S-2	01/20/1998	590	110	8.3	18	23	7,800	NA	NA	NA	NA	NA	98.92	1.54	97.38	3.2
S-2	07/23/1998	2,600	840	<10	44	22	15,000	NA	NA	NA	NA	NA	98.92	2.89	96.03	NA
S-2	02/16/1999	680	140	6.1	10	18	19,000	NA	NA	NA	NA	NA	98.92	1.86	97.06	2.0
S-2	09/07/1999	<2,000	248	<20.0	<20.0	<20.0	22,800	NA	NA	NA	NA	NA	98.92	3.66	95.26	1.8
S-2	02/02/2000	103	0.825	<0.500	<0.500	<0.500	11,700	10,500	NA	NA	NA	NA	98.92	4.02	94.90	2.0
S-2	04/26/2000	4,040	799	<20.0	40.9	255	19,000	17,100 b	NA	NA	NA	NA	98.92	2.63	96.29	2.3
S-2	07/25/2000	1,120	195	5.94	5.62	11.3	26,600	21,100	NA	NA	NA	NA	98.92	3.42	95.50	0.6
S-2 b	11/15/2000	613	35.6	<5.00	<5.00	7.36	18,100	17,800	NA	NA	NA	NA	98.92	3.31	95.61	1.8
S-2	02/12/2001	9,010	1,430	<20.0	219	848	28,300	17,000	NA	NA	NA	NA	98.92	1.47	97.45	2.0
S-2	06/07/2001	31,000	1,000	<25	630	3,200	NA	17,000	NA	NA	NA	NA	98.92	3.43	95.49	10.4
S-2	08/31/2001	50,000	950	<20	1,500	6,000	NA	17,000	NA	NA	NA	NA	98.92	4.72	94.20	0.9
S-2	12/05/2001	49,000	590	7.2	1,400	4,900	NA	11,000	NA	NA	NA	NA	98.92	1.53	97.39	NA
S-2	01/31/2002	37,000	860	<25	1,100	4,000	NA	14,000	NA	NA	NA	NA	98.92	2.13	96.79	NA
S-2	06/04/2002	150,000	800	<20	1,200	4,000	NA	9,200	NA	NA	NA	NA	98.92	2.24	96.68	NA
S-2	07/25/2002	37,000	350	<20	660	2,400	NA	10,000	NA	NA	NA	NA	98.92	2.03	96.89	NA
S-2	11/14/2002	25,000	510	<25	590	2,000	NA	10,000	NA	NA	NA	NA	180.79	3.17	177.62	NA
S-2	01/02/2003	NA	710	<25	560	2,074	NA	NA	NA	NA	NA	NA	180.79	2.15	178.64	NA
S-2	01/30/2003	21,000	670	<20	360	1,200	NA	9,300	NA	NA	NA	NA	180.79	2.09	178.70	NA
S-2	06/03/2003	42,000	800	<50	660	1,500	NA	9,600	NA	NA	NA	NA	180.79	3.08	177.71	NA
S-2	08/27/2003	31,000	630	<100	510	1,200	NA	15,000	NA	NA	NA	NA	180.79	2.55	178.24	NA
S-2	11/25/2003 d	8,400 a	<50	<50	<50	<100	NA	4,500	NA	NA	NA	NA	180.79	NA	NA	NA
S-2	02/05/2004	Well inaccessible		NA	NA	NA	NA	NA	NA	NA	NA	NA	180.79	NA	NA	NA
S-2	02/10/2004 d	<2,500	130	<25	<25	<50	NA	3,800	NA	NA	NA	NA	180.79	NA	NA	NA
S-2	04/21/2004	4,700	100	<25	<25	<50	NA	2,900	NA	NA	NA	NA	180.79	7.38	173.41	NA
S-2	08/12/2004	2,600	63	<13	<13	<25	NA	1,400	<50	<50	<50	1,200	180.79	e	NA	NA
S-2	11/08/2004	3,600	<25	<25	<25	<50	NA	1,300	NA	NA	NA	NA	180.79	f	NA	NA
S-2	05/16/2005	73 g	<0.50	<0.50	<0.50	<1.0	NA	3.3	NA	NA	NA	NA	180.79	3.33	177.46	NA



**WELL CONCENTRATIONS**  
**Shell-branded Service Station**  
**5755 Broadway**  
**Oakland, CA**

Well ID	Date	TPPH (ug/L)	B (ug/L)	T (ug/L)	E (ug/L)	X (ug/L)	MTBE 8020 (ug/L)	MTBE 8260 (ug/L)	DIPE (ug/L)	ETBE (ug/L)	TAME (ug/L)	TBA (ug/L)	TOC (MSL)	Depth to Water (ft.)	GW Elevation (MSL)	DO Reading (ppm)
---------	------	----------------	-------------	-------------	-------------	-------------	------------------------	------------------------	----------------	----------------	----------------	---------------	--------------	----------------------------	--------------------------	------------------------

S-2	08/16/2005	10,000	370	<13	60	63	NA	1,300	<50	<50	<50	2,900	180.79	4.03	176.76	NA
S-2	11/03/2005	1,010	31.4	<0.500	2.81	31.4	NA	349	NA	NA	NA	880	180.79	NA	NA	NA
S-2	02/16/2006	5,350	79.0	<0.500	2.90	59.5	NA	687	NA	NA	NA	690	180.79	5.86	174.93	NA
S-2	05/05/2006	5,240	148	<0.500	17.1	48.8	NA	815	NA	NA	NA	478	180.79	NA	NA	NA
S-2	08/21/2006	4,640	162	0.910	25.8	27.2	NA	519	<0.500	<0.500	0.780	711	180.79	4.72	176.07	NA
S-2	11/13/2006	2,100	200	<5.0	58	21	NA	820	NA	NA	NA	1,300	180.79	3.44	177.35	NA
S-2	01/30/2007	3,300	250	<5.0	59	17	NA	1,100	NA	NA	NA	1,600	180.79	2.32	178.47	NA
S-2	05/23/2007	4,600 h	410	2.3 i	92	24.8 i	NA	890	NA	NA	NA	620	180.79	2.61	178.18	NA
S-2	08/09/2007	4,100 h	320	<10	30	11	NA	650	<20	<20	<20	1,400	180.79	3.72	177.07	NA
<b>S-2</b>	<b>11/13/2007</b>	<b>4,900 h</b>	<b>230</b>	<b>&lt;10</b>	<b>33</b>	<b>12</b>	<b>NA</b>	<b>540</b>	<b>&lt;20</b>	<b>&lt;20</b>	<b>&lt;20</b>	<b>590</b>	<b>180.79</b>	<b>2.31</b>	<b>178.48</b>	<b>NA</b>

S-3	01/25/1991	<30	<0.3	<0.3	<0.3	<0.3	NA	NA	NA	NA	NA	NA	101.67	3.84	97.83	NA
S-3	06/03/1991	<30	<0.3	0.3	0.3	0.3	NA	NA	NA	NA	NA	NA	101.67	3.25	98.42	NA
S-3	08/03/1991	<30	<0.3	<0.3	<0.3	<0.3	NA	NA	NA	NA	NA	NA	101.67	4.73	96.94	NA
S-3	11/22/1991	<30	<0.3	<0.3	<0.3	<0.3	NA	NA	NA	NA	NA	NA	101.67	4.81	96.86	NA
S-3	03/13/1992	<30	<0.3	0.3	0.3	0.3	NA	NA	NA	NA	NA	NA	101.67	2.29	99.38	NA
S-3	05/28/1992	<50	<0.5	<0.5	<0.5	<0.5	NA	NA	NA	NA	NA	NA	101.67	3.62	98.05	NA
S-3	08/19/1992	<50	<0.5	<0.5	<0.5	0.5	NA	NA	NA	NA	NA	NA	101.67	4.66	97.01	NA
S-3	11/18/1992	<50	<0.5	<0.5	<0.5	<0.5	NA	NA	NA	NA	NA	NA	101.67	4.51	97.16	NA
S-3	02/10/1993	30	1.9	3.2	2.4	5.6	NA	NA	NA	NA	NA	NA	101.67	4.36	97.31	NA
S-3	06/11/1993	<50	<0.5	<0.5	<0.5	<0.5	NA	NA	NA	NA	NA	NA	101.67	2.91	98.76	NA
S-3 (D)	06/11/1993	<50	<0.5	<0.5	<0.5	<0.5	NA	NA	NA	NA	NA	NA	101.67	2.91	98.76	NA
S-3	08/03/1993	<50	<0.5	<0.5	<0.5	<0.5	NA	NA	NA	NA	NA	NA	101.67	3.70	97.97	NA
S-3	11/02/1993	Well inaccessible		NA	NA	NA	NA	NA	NA	NA	NA	NA	101.67	NA	NA	NA
S-3	12/16/1993	NA	NA	NA	NA	NA	NA	NA	NA	NA	NA	NA	101.67	2.12	99.55	NA
S-3	02/01/1994	<50	<0.5	<0.5	<0.5	<0.5	NA	NA	NA	NA	NA	NA	101.67	2.90	98.77	NA
S-3	05/04/1994	<50	<0.5	<0.5	<0.5	<0.5	NA	NA	NA	NA	NA	NA	101.67	2.54	99.13	NA
S-3	08/18/1994	<50	<0.5	<0.5	<0.5	<0.5	NA	NA	NA	NA	NA	NA	101.67	3.51	98.16	NA

**WELL CONCENTRATIONS**  
**Shell-branded Service Station**  
**5755 Broadway**  
**Oakland, CA**

Well ID	Date	TPPH (ug/L)	B (ug/L)	T (ug/L)	E (ug/L)	X (ug/L)	MTBE 8020 (ug/L)	MTBE 8260 (ug/L)	DIPE (ug/L)	ETBE (ug/L)	TAME (ug/L)	TBA (ug/L)	TOC (MSL)	Depth to Water (ft.)	GW Elevation (MSL)	DO Reading (ppm)
S-3	11/09/1994	<50	<0.5	<0.5	<0.5	<0.5	NA	NA	NA	NA	NA	NA	101.67	2.44	99.23	NA
S-3	02/22/1995	80	<0.5	0.5	<0.5	0.5	NA	NA	NA	NA	NA	NA	101.67	4.12	97.55	NA
S-3	05/02/1995	<50	<0.5	<0.5	<0.5	<0.5	NA	NA	NA	NA	NA	NA	101.67	2.83	98.84	NA
S-3	08/30/1995	<50	0.5	<0.5	<0.5	<0.5	NA	NA	NA	NA	NA	NA	101.67	3.16	98.51	NA
S-3	11/28/1995	<50	<0.5	<0.5	<0.5	<0.5	NA	NA	NA	NA	NA	NA	101.67	3.87	97.80	NA
S-3	02/02/1996	<50	<0.5	<0.5	<0.5	<0.5	NA	NA	NA	NA	NA	NA	101.67	2.24	99.43	NA
S-3	03/09/1996	<50	<0.5	<0.5	<0.5	<0.5	NA	NA	NA	NA	NA	NA	101.67	3.05	98.62	NA
S-3	08/22/1996	<50	0.8	<0.5	<0.5	<0.5	<2.5	NA	NA	NA	NA	NA	101.67	2.85	98.82	4.6
S-3	11/07/1996	<50	<0.5	<0.5	<0.5	<0.5	<2.5	NA	NA	NA	NA	NA	101.67	3.35	98.32	4.6
S-3	02/20/1997	<50	<0.50	<0.50	<0.50	<0.50	<2.5	NA	NA	NA	NA	NA	101.67	3.00	98.67	1
S-3	05/30/1997	140	14	10	3.3	14	8.6	NA	NA	NA	NA	NA	101.67	3.00	98.67	8
S-3	08/21/1997	<50	<0.50	<0.50	<0.50	<0.50	<2.5	NA	NA	NA	NA	NA	101.67	2.94	98.73	3.3
S-3	11/03/1997	<50	<0.50	<0.50	<0.50	<0.50	<2.5	NA	NA	NA	NA	NA	101.67	3.36	98.31	2.4
S-3 (D)	11/03/1997	<50	<0.50	<0.50	<0.50	<0.50	<2.5	NA	NA	NA	NA	NA	101.67	3.36	98.31	2.4
S-3	01/20/1998	Well inaccessible		NA	NA	NA	NA	NA	NA	NA	NA	NA	101.67	NA	NA	NA
S-3	07/23/1998	NA	NA	NA	NA	NA	NA	NA	NA	NA	NA	NA	101.67	2.69	98.98	NA
S-3	02/16/1999	<50	<0.50	0.92	0.59	3.9	3.7	NA	NA	NA	NA	NA	101.67	2.20	99.47	2.8
S-3	09/07/1999	NA	NA	NA	NA	NA	NA	NA	NA	NA	NA	NA	101.67	2.81	98.86	NA
S-3	02/02/2000	<50.0	<0.500	<0.500	<0.500	<0.500	<5.00	NA	NA	NA	NA	NA	101.67	3.97	97.70	2.7
S-3	04/26/2000	NA	NA	NA	NA	NA	NA	NA	NA	NA	NA	NA	101.67	2.96	98.71	NA
S-3	07/25/2000	<50.0	<0.500	<0.500	<0.500	<0.500	<2.50	NA	NA	NA	NA	NA	101.67	3.00	98.67	0.8
S-3	11/15/2000	NA	NA	NA	NA	NA	NA	NA	NA	NA	NA	NA	101.67	2.86	98.81	NA
S-3	02/12/2001	<50.0	<0.500	<0.500	<0.500	<0.500	<2.50	NA	NA	NA	NA	NA	101.67	2.47	99.20	2.3
S-3	06/07/2001	NA	NA	NA	NA	NA	NA	NA	NA	NA	NA	NA	101.67	2.78	98.89	NA
S-3	08/31/2001	<50	<0.50	<0.50	<0.50	<0.50	NA	<5.0	NA	NA	NA	NA	101.67	3.94	97.73	0.5
S-3	12/05/2001	NA	NA	NA	NA	NA	NA	NA	NA	NA	NA	NA	101.67	2.05	99.62	NA
S-3	01/31/2002	<50	<0.50	<0.50	<0.50	<0.50	NA	<5.0	NA	NA	NA	NA	101.67	2.29	99.38	NA
S-3	06/04/2002	NA	NA	NA	NA	NA	NA	NA	NA	NA	NA	NA	101.67	2.56	99.11	NA

**WELL CONCENTRATIONS**  
**Shell-branded Service Station**  
**5755 Broadway**  
**Oakland, CA**

Well ID	Date	TPPH (ug/L)	B (ug/L)	T (ug/L)	E (ug/L)	X (ug/L)	MTBE 8020 (ug/L)	MTBE 8260 (ug/L)	DIPE (ug/L)	ETBE (ug/L)	TAME (ug/L)	TBA (ug/L)	TOC (MSL)	Depth to Water (ft.)	GW Elevation (MSL)	DO Reading (ppm)
S-3	07/25/2002	<50	<0.50	<0.50	<0.50	<0.50	NA	<5.0	NA	NA	NA	NA	101.67	2.70	98.97	NA
S-3	11/14/2002	NA	NA	NA	NA	NA	NA	NA	NA	NA	NA	NA	183.54	3.43	180.11	NA
S-3	01/30/2003	<50	<0.50	<0.50	<0.50	<0.50	NA	<5.0	NA	NA	NA	NA	183.54	2.16	181.38	NA
S-3	01/30/2003	NA	NA	NA	NA	NA	NA	NA	NA	NA	NA	NA	183.54	2.65	180.89	NA
S-3	08/27/2003	<50	<0.50	<0.50	<0.50	<1.0	NA	0.55	NA	NA	NA	NA	183.54	2.75	180.79	NA
S-3	11/25/2003	NA	NA	NA	NA	NA	NA	NA	NA	NA	NA	NA	183.54	2.85	180.69	NA
S-3	02/05/2004	<50	<0.50	<0.50	<0.50	<1.0	NA	<0.50	NA	NA	NA	NA	183.54	2.04	181.50	NA
S-3	04/21/2004	NA	NA	NA	NA	NA	NA	NA	NA	NA	NA	NA	183.54	2.50	181.04	NA
S-3	08/12/2004	<50	<0.50	<0.50	<0.50	<1.0	NA	<0.50	<2.0	<2.0	<2.0	<5.0	183.54	3.91	179.63	NA
S-3	11/08/2004	NA	NA	NA	NA	NA	NA	NA	NA	NA	NA	NA	183.54	2.84	180.70	NA
S-3	05/16/2005	<50	<0.50	<0.50	<0.50	<1.0	NA	<0.50	NA	NA	NA	NA	183.54	3.05	180.49	NA
S-3	08/16/2005	<100	<1.0	<1.0	<1.0	<2.0	NA	<1.0	<4.0	<4.0	<4.0	<10	183.54	3.42	180.12	NA
S-3	11/03/2005	NA	NA	NA	NA	NA	NA	NA	NA	NA	NA	NA	183.54	4.09	179.45	NA
S-3	02/16/2006	<50.0	<0.500	<0.500	<0.500	<0.500	NA	<0.500	NA	NA	NA	NA	183.54	2.25	181.29	NA
S-3	05/05/2006	NA	NA	NA	NA	NA	NA	NA	NA	NA	NA	NA	183.54	2.27	181.27	NA
S-3	08/21/2006	<50.0	<0.500	<0.500	<0.500	<0.500	NA	<0.500	<0.500	<0.500	0.570	36.4	183.54	3.17	180.37	NA
S-3	11/13/2006	NA	NA	NA	NA	NA	NA	NA	NA	NA	NA	NA	183.54	3.42	180.12	NA
S-3	01/30/2007	<50	<0.50	<0.50	<0.50	<1.0	NA	<0.50	NA	NA	NA	NA	183.54	2.36	181.18	NA
S-3	05/23/2007	NA	NA	NA	NA	NA	NA	NA	NA	NA	NA	NA	183.54	2.65	180.89	NA
S-3	08/09/2007	<50 h	<0.50	<1.0	<1.0	<1.0	NA	<1.0	<2.0	<2.0	<2.0	<10	183.54	2.93	180.61	NA
<b>S-3</b>	<b>11/13/2007</b>	<b>NA</b>	<b>NA</b>	<b>NA</b>	<b>NA</b>	<b>NA</b>	<b>NA</b>	<b>NA</b>	<b>NA</b>	<b>NA</b>	<b>NA</b>	<b>NA</b>	<b>183.54</b>	<b>2.04</b>	<b>181.50</b>	<b>NA</b>

H-1	12/05/2001	150	<0.50	8.3	1.6	16	NA	52	NA	NA	NA	NA	NA	1.43	NA	NA
H-1	01/31/2002	3,200	12	<0.50	5.7	3.7	NA	650	NA	NA	NA	NA	NA	2.34	NA	NA
H-1	06/04/2002	280,000	<10	150	62	9,500	NA	<100	NA	NA	NA	NA	NA	2.56	NA	NA
H-1	07/25/2002	8,200	2.2	46	5.3	99	NA	<10	NA	NA	NA	NA	NA	2.83	NA	NA
H-1	11/14/2002	1,700	2.1	2.6	1.5	14	NA	380	NA	NA	NA	NA	180.63	3.74	176.89	NA
H-1	01/02/2003	NA	1.1	<0.50	<0.50	3.6	NA	NA	NA	NA	NA	NA	180.63	1.45	179.18	NA

**WELL CONCENTRATIONS**  
**Shell-branded Service Station**  
**5755 Broadway**  
**Oakland, CA**

Well ID	Date	TPPH (ug/L)	B (ug/L)	T (ug/L)	E (ug/L)	X (ug/L)	MTBE 8020 (ug/L)	MTBE 8260 (ug/L)	DIPE (ug/L)	ETBE (ug/L)	TAME (ug/L)	TBA (ug/L)	TOC (MSL)	Depth to Water (ft.)	GW Elevation (MSL)	DO Reading (ppm)
---------	------	----------------	-------------	-------------	-------------	-------------	------------------------	------------------------	----------------	----------------	----------------	---------------	--------------	----------------------------	--------------------------	------------------------

H-1	01/30/2003	630	0.99	2.0	1.6	12	NA	21	NA	NA	NA	NA	180.63	2.10	178.53	NA
H-1	06/03/2003	55	<0.50	1.3	<0.50	2.4	NA	2.6	NA	NA	NA	NA	180.63	3.38	177.25	NA
H-1	08/27/2003	<50	0.55	<0.50	<0.50	1.2	NA	2.8	NA	NA	NA	NA	180.63	4.10	176.53	NA
H-1	11/25/2003	77 a	9.7	<0.50	<0.50	<1.0	NA	21	NA	NA	NA	NA	180.63	3.72	176.91	NA
H-1	02/05/2004	380	41	1.2	5.1	8.0	NA	21	NA	NA	NA	NA	180.63	1.69	178.94	NA
H-1	04/21/2004	640	27	0.63	2.0	2.3	NA	33	NA	NA	NA	NA	180.63	2.14	178.49	NA
H-1	08/12/2004	340	18	0.75	<0.50	1.7	NA	43	NA	NA	NA	NA	180.63	4.78	175.85	NA
H-1	11/08/2004	1,500	29	<1.0	1.7	<2.0	NA	57	NA	NA	NA	NA	180.63	4.17	176.46	NA
H-1	05/16/2005	150 g	<0.50	<0.50	<0.50	<1.0	NA	48	NA	NA	NA	NA	180.63	4.16	176.47	NA
H-1	08/16/2005	100 g	<0.50	<0.50	<0.50	<1.0	NA	57	NA	NA	NA	NA	180.63	4.66	175.97	NA
H-1	11/03/2005	<50.0	<0.500	<0.500	<0.500	<0.500	NA	12.1	NA	NA	NA	NA	180.63	5.13	175.50	NA
H-1	02/16/2006	4,230	<0.500	<0.500	37.7	80.5	NA	7.12	NA	NA	NA	NA	180.63	1.87	178.76	NA
H-1	05/05/2006	368	<0.500	<0.500	2.56	<0.500	NA	22.2	NA	NA	NA	NA	180.63	2.21	178.42	NA
H-1	08/21/2006	NA	NA	NA	NA	NA	NA	NA	NA	NA	NA	NA	180.63	4.62	176.01	NA
H-1	11/13/2006	NA	NA	NA	NA	NA	NA	NA	NA	NA	NA	NA	180.63	3.89	176.74	NA
H-1	01/30/2007	NA	NA	NA	NA	NA	NA	NA	NA	NA	NA	NA	180.63	3.04	177.59	NA
H-1	05/23/2007	330 h	7.9	0.32 i	0.48 i	0.61 i	NA	74	NA	NA	NA	NA	180.63	3.38	177.25	NA
H-1	08/09/2007	NA	NA	NA	NA	NA	NA	NA	NA	NA	NA	NA	180.63	4.30	176.33	NA
<b>H-1</b>	<b>11/13/2007</b>	<b>NA</b>	<b>NA</b>	<b>NA</b>	<b>NA</b>	<b>NA</b>	<b>NA</b>	<b>NA</b>	<b>NA</b>	<b>NA</b>	<b>NA</b>	<b>NA</b>	<b>180.63</b>	<b>1.97</b>	<b>178.66</b>	<b>NA</b>

T-1	05/30/1997	NA	NA	NA	NA	NA	NA	NA	NA	NA	NA	NA	NA	2.65	NA	NA
T-1	08/21/1997	NA	NA	NA	NA	NA	NA	NA	NA	NA	NA	NA	NA	2.69	NA	NA
T-1	11/03/1997	NA	NA	NA	NA	NA	NA	NA	NA	NA	NA	NA	NA	3.09	NA	NA
T-1	01/20/1998	NA	NA	NA	NA	NA	NA	NA	NA	NA	NA	NA	NA	0.61	NA	NA
T-1	07/23/1998	NA	NA	NA	NA	NA	NA	NA	NA	NA	NA	NA	NA	2.32	NA	NA
T-1	02/16/1999	NA	NA	NA	NA	NA	NA	NA	NA	NA	NA	NA	NA	1.95	NA	NA
T-1	09/07/1999	NA	NA	NA	NA	NA	NA	NA	NA	NA	NA	NA	NA	2.48	NA	NA
T-1	02/02/2000	<50.0	<0.500	<0.500	<0.500	<0.500	<5.00	NA	NA	NA	NA	NA	NA	2.66	NA	2.5

**WELL CONCENTRATIONS**  
**Shell-branded Service Station**  
**5755 Broadway**  
**Oakland, CA**

Well ID	Date	TPPH (ug/L)	B (ug/L)	T (ug/L)	E (ug/L)	X (ug/L)	MTBE 8020 (ug/L)	MTBE 8260 (ug/L)	DIPE (ug/L)	ETBE (ug/L)	TAME (ug/L)	TBA (ug/L)	TOC (MSL)	Depth to Water (ft.)	GW Elevation (MSL)	DO Reading (ppm)
---------	------	----------------	-------------	-------------	-------------	-------------	------------------------	------------------------	----------------	----------------	----------------	---------------	--------------	----------------------------	--------------------------	------------------------

T-1	04/26/2000	NA	NA	NA	NA	NA	NA	NA	NA	NA	NA	NA	NA	2.56	NA	NA
T-1	07/25/2000	NA	NA	NA	NA	NA	NA	NA	NA	NA	NA	NA	NA	2.60	NA	NA
T-1	11/15/2000	NA	NA	NA	NA	NA	NA	NA	NA	NA	NA	NA	NA	2.47	NA	NA
T-1	02/12/2001	NA	NA	NA	NA	NA	NA	NA	NA	NA	NA	NA	NA	1.20	NA	NA
T-1	06/07/2001	NA	NA	NA	NA	NA	NA	NA	NA	NA	NA	NA	NA	2.36	NA	NA
T-1	08/31/2001	NA	NA	NA	NA	NA	NA	NA	NA	NA	NA	NA	NA	3.45	NA	NA
T-1	01/09/2002 c	NA	NA	NA	NA	NA	NA	NA	NA	NA	NA	NA	183.08	NA	NA	NA

T-2	05/30/1997	NA	NA	NA	NA	NA	NA	NA	NA	NA	NA	NA	NA	1.81	NA	NA
T-2	08/21/1997	NA	NA	NA	NA	NA	NA	NA	NA	NA	NA	NA	NA	1.89	NA	NA
T-2	11/03/1997	NA	NA	NA	NA	NA	NA	NA	NA	NA	NA	NA	NA	2.25	NA	NA
T-2	01/20/1998	NA	NA	NA	NA	NA	NA	NA	NA	NA	NA	NA	NA	0.55	NA	NA
T-2	07/23/1998	NA	NA	NA	NA	NA	NA	NA	NA	NA	NA	NA	NA	1.21	NA	NA
T-2	02/16/1999	NA	NA	NA	NA	NA	NA	NA	NA	NA	NA	NA	NA	1.08	NA	NA
T-2	09/07/1999	NA	NA	NA	NA	NA	NA	NA	NA	NA	NA	NA	NA	0.72	NA	NA
T-2	02/02/2000	1,540	53.4	20.8	11.4	21.8	1,330	NA	NA	NA	NA	NA	NA	0.98	NA	3.0
T-2	04/26/2000	NA	NA	NA	NA	NA	NA	NA	NA	NA	NA	NA	NA	1.02	NA	NA
T-2	07/25/2000	815	17.6	10.8	1.63	3.47	133	NA	NA	NA	NA	NA	NA	1.80	NA	0.8
T-2	11/15/2000	NA	NA	NA	NA	NA	NA	NA	NA	NA	NA	NA	NA	1.68	NA	NA
T-2	02/12/2001	310	7.48	7.76	0.693	2.28	301	NA	NA	NA	NA	NA	NA	1.45	NA	1.6
T-2	06/07/2001	NA	NA	NA	NA	NA	NA	NA	NA	NA	NA	NA	NA	1.57	NA	NA
T-2	08/31/2001	720	30	0.67	<0.50	2.3	NA	540	NA	NA	NA	NA	NA	2.69	NA	0.8
T-2	12/05/2001	NA	NA	NA	NA	NA	NA	NA	NA	NA	NA	NA	NA	0.58	NA	NA
T-2	01/31/2002	NA	NA	NA	NA	NA	NA	NA	NA	NA	NA	NA	NA	1.32	NA	NA
T-2	02/04/2002	1,000	41	30	4.6	20	NA	1,200	NA	NA	NA	NA	NA	1.46	NA	NA
T-2	06/04/2002	NA	NA	NA	NA	NA	NA	NA	NA	NA	NA	NA	NA	1.50	NA	NA
T-2	07/25/2002	660	11	0.59	<0.50	2.6	NA	97	NA	NA	NA	NA	NA	1.53	NA	NA
T-2	11/14/2002	NA	NA	NA	NA	NA	NA	NA	NA	NA	NA	NA	182.30	2.39	179.91	NA

**WELL CONCENTRATIONS**  
**Shell-branded Service Station**  
**5755 Broadway**  
**Oakland, CA**

Well ID	Date	TPPH (ug/L)	B (ug/L)	T (ug/L)	E (ug/L)	X (ug/L)	MTBE 8020 (ug/L)	MTBE 8260 (ug/L)	DIPE (ug/L)	ETBE (ug/L)	TAME (ug/L)	TBA (ug/L)	TOC (MSL)	Depth to Water (ft.)	GW Elevation (MSL)	DO Reading (ppm)
---------	------	----------------	-------------	-------------	-------------	-------------	------------------------	------------------------	----------------	----------------	----------------	---------------	--------------	----------------------------	--------------------------	------------------------

T-2	01/30/2003	560	11	<0.50	<0.50	0.53	NA	160	NA	NA	NA	NA	182.30	1.01	181.29	NA
T-2	06/03/2003	NA	NA	NA	NA	NA	NA	NA	NA	NA	NA	NA	182.30	1.55	180.75	NA
T-2	08/27/2003	180 a	1.6	<0.50	<0.50	<1.0	NA	10	NA	NA	NA	NA	182.30	1.60	180.70	NA
T-2	11/25/2003	NA	NA	NA	NA	NA	NA	NA	NA	NA	NA	NA	182.30	1.64	180.66	NA
T-2	02/05/2004	940	110	10	2.4	14	NA	67	NA	NA	NA	NA	182.30	0.66	181.64	NA
T-2	04/21/2004	NA	NA	NA	NA	NA	NA	NA	NA	NA	NA	NA	182.30	1.50	180.80	NA
T-2	08/12/2004	450	<0.50	<0.50	<0.50	<1.0	NA	33	NA	NA	NA	NA	182.30	2.72	179.58	NA
T-2	11/08/2004	NA	NA	NA	NA	NA	NA	NA	NA	NA	NA	NA	182.30	1.72	180.58	NA

T-3	05/30/1997	NA	NA	NA	NA	NA	NA	NA	NA	NA	NA	NA	NA	2.31	NA	NA
T-3	08/21/1997	NA	NA	NA	NA	NA	NA	NA	NA	NA	NA	NA	NA	1.57	NA	NA
T-3	11/03/1997	NA	NA	NA	NA	NA	NA	NA	NA	NA	NA	NA	NA	3.50	NA	NA
T-3	01/20/1998	NA	NA	NA	NA	NA	NA	NA	NA	NA	NA	NA	NA	0.76	NA	NA
T-3	07/23/1998	NA	NA	NA	NA	NA	NA	NA	NA	NA	NA	NA	NA	0.82	NA	NA
T-3	02/16/1999	NA	NA	NA	NA	NA	NA	NA	NA	NA	NA	NA	NA	0.55	NA	NA
T-3	09/07/1999	NA	NA	NA	NA	NA	NA	NA	NA	NA	NA	NA	NA	2.89	NA	NA
T-3	02/02/2000	<50.0	<0.500	<0.500	<0.500	<0.500	<5.00	NA	NA	NA	NA	NA	NA	3.02	NA	2.9
T-3	04/26/2000	NA	NA	NA	NA	NA	NA	NA	NA	NA	NA	NA	NA	2.81	NA	NA
T-3	07/25/2000	NA	NA	NA	NA	NA	NA	NA	NA	NA	NA	NA	NA	3.00	NA	NA
T-3	11/15/2000	NA	NA	NA	NA	NA	NA	NA	NA	NA	NA	NA	NA	1.70	NA	NA
T-3	02/12/2001	NA	NA	NA	NA	NA	NA	NA	NA	NA	NA	NA	NA	2.11	NA	NA
T-3	06/07/2001	NA	NA	NA	NA	NA	NA	NA	NA	NA	NA	NA	NA	1.68	NA	NA
T-3	08/31/2001	NA	NA	NA	NA	NA	NA	NA	NA	NA	NA	NA	NA	3.14	NA	NA
T-3	01/09/2002 c	NA	NA	NA	NA	NA	NA	NA	NA	NA	NA	NA	180.95	NA	NA	NA



**WELL CONCENTRATIONS**  
**Shell-branded Service Station**  
**5755 Broadway**  
**Oakland, CA**

<b>Well ID</b>	<b>Date</b>	<b>TPPH</b> (ug/L)	<b>B</b> (ug/L)	<b>T</b> (ug/L)	<b>E</b> (ug/L)	<b>X</b> (ug/L)	<b>MTBE</b> <b>8020</b> (ug/L)	<b>MTBE</b> <b>8260</b> (ug/L)	<b>DIPE</b> (ug/L)	<b>ETBE</b> (ug/L)	<b>TAME</b> (ug/L)	<b>TBA</b> (ug/L)	<b>TOC</b> (MSL)	<b>Depth to</b> <b>Water</b> (ft.)	<b>GW</b> <b>Elevation</b> (MSL)	<b>DO</b> <b>Reading</b> (ppm)
----------------	-------------	-----------------------	--------------------	--------------------	--------------------	--------------------	--------------------------------------	--------------------------------------	-----------------------	-----------------------	-----------------------	----------------------	---------------------	--	--	--------------------------------------

Abbreviations:

TPPH = Total petroleum hydrocarbons as gasoline by EPA Method 8260B; prior to June 7, 2001, analyzed by EPA Method 8015.

BTEX = Benzene, toluene, ethylbenzene, xylenes by EPA Method 8260B; prior to June 7, 2001, analyzed by EPA Method 8020.

MTBE = Methyl tertiary butyl ether

DIPE = Di-isopropyl ether, analyzed by EPA Method 8260B

ETBE = Ethyl tertiary butyl ether, analyzed by EPA Method 8260B

TAME = Tertiary amyl methyl ether, analyzed by EPA Method 8260B

TBA = Tertiary butyl alcohol, analyzed by EPA Method 8260B

TOC = Top of Casing Elevation

SPH = Separate-Phase Hydrocarbons

GW = Groundwater

DO = Dissolved Oxygen

ug/L = Parts per billion

ppm = Parts per million

MSL = Mean sea level

ft. = Feet

<n = Below detection limit

(D) = Duplicate sample

NA = Not applicable

**WELL CONCENTRATIONS**  
**Shell-branded Service Station**  
**5755 Broadway**  
**Oakland, CA**

<b>Well ID</b>	<b>Date</b>	<b>TPPH</b> (ug/L)	<b>B</b> (ug/L)	<b>T</b> (ug/L)	<b>E</b> (ug/L)	<b>X</b> (ug/L)	<b>MTBE</b> <b>8020</b> (ug/L)	<b>MTBE</b> <b>8260</b> (ug/L)	<b>DIPE</b> (ug/L)	<b>ETBE</b> (ug/L)	<b>TAME</b> (ug/L)	<b>TBA</b> (ug/L)	<b>TOC</b> (MSL)	<b>Depth to</b> <b>Water</b> (ft.)	<b>GW</b> <b>Elevation</b> (MSL)	<b>DO</b> <b>Reading</b> (ppm)
----------------	-------------	-----------------------	--------------------	--------------------	--------------------	--------------------	--------------------------------------	--------------------------------------	-----------------------	-----------------------	-----------------------	----------------------	---------------------	--	--	--------------------------------------

Notes:

- a = Chromatogram pattern indicated an unidentified hydrocarbon/Hydrocarbon does not match pattern of laboratory's standard.
- b = This sample analyzed outside of EPA recommended hold time.
- c = Survey date only.
- d = Sampled by client; Cambria Environmental.
- e = Unable to gauge depth to water due to extraction tubing.
- f = Unable to gauge.
- g = Quantity of unknown hydrocarbon(s) in sample based on gasoline.
- h = Analyzed by EPA Method 8015B (M).
- i = Analyte was detected at a concentration below the reporting limit and above the laboratory method detection limit. Reported value is estimated.

Site surveyed January 9, 2002 by Virgil Chavez Land Surveying of Vallejo, CA.

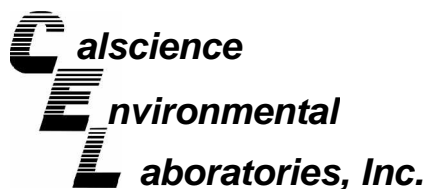

November 21, 2007

Michael Ninokata  
Blaine Tech Services, Inc.  
1680 Rogers Avenue  
San Jose, CA 95112-1105

Subject: **Calscience Work Order No.: 07-11-0997**  
**Client Reference: 5755 Broadway, Oakland, CA**

Dear Client:

Enclosed is an analytical report for the above-referenced project. The samples included in this report were received 11/14/2007 and analyzed in accordance with the attached chain-of-custody.

Unless otherwise noted, all analytical testing was accomplished in accordance with the guidelines established in our Quality Systems Manual, applicable standard operating procedures, and other related documentation. The original report of subcontracted analysis, if any, is provided herein, and follows the standard Calscience data package. The results in this analytical report are limited to the samples tested and any reproduction thereof must be made in its entirety.

If you have any questions regarding this report, please do not hesitate to contact the undersigned.

Sincerely,

A handwritten signature in black ink, appearing to read 'Danielle Gonsman', with a long horizontal flourish extending to the right.

Calscience Environmental  
Laboratories, Inc.  
Danielle Gonsman  
Project Manager

## Analytical Report



Blaine Tech Services, Inc.  
 1680 Rogers Avenue  
 San Jose, CA 95112-1105

Date Received: 11/14/07  
 Work Order No: 07-11-0997  
 Preparation: EPA 5030B  
 Method: EPA 8015B (M)

Project: 5755 Broadway, Oakland, CA

Page 1 of 1

Client Sample Number	Lab Sample Number	Date Collected	Matrix	Instrument	Date Prepared	Date Analyzed	QC Batch ID
S-2	07-11-0997-1	11/13/07	Aqueous	GC 22	11/14/07	11/15/07	071114B01

Parameter	Result	RL	DF	Qual	Units
TPH as Gasoline	4900	50	1		ug/L
<u>Surrogates:</u>	<u>REC (%)</u>	<u>Control Limits</u>		<u>Qual</u>	
1,4-Bromofluorobenzene	112	38-134			

<b>Method Blank</b>	<b>099-12-436-1,130</b>	<b>N/A</b>	<b>Aqueous</b>	<b>GC 22</b>	<b>11/14/07</b>	<b>11/14/07</b>	<b>071114B01</b>
---------------------	-------------------------	------------	----------------	--------------	-----------------	-----------------	------------------

Parameter	Result	RL	DF	Qual	Units
TPH as Gasoline	ND	50	1		ug/L
<u>Surrogates:</u>	<u>REC (%)</u>	<u>Control Limits</u>		<u>Qual</u>	
1,4-Bromofluorobenzene	86	38-134			

RL - Reporting Limit , DF - Dilution Factor , Qual - Qualifiers

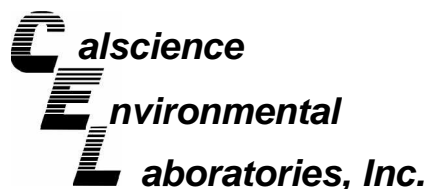

## Analytical Report



Blaine Tech Services, Inc.  
1680 Rogers Avenue  
San Jose, CA 95112-1105

Date Received: 11/14/07  
Work Order No: 07-11-0997  
Preparation: EPA 5030B  
Method: EPA 8260B  
Units: ug/L

Project: 5755 Broadway, Oakland, CA

Page 1 of 1

Client Sample Number	Lab Sample Number	Date Collected	Matrix	Instrument	Date Prepared	Date Analyzed	QC Batch ID
S-2	07-11-0997-1	11/13/07	Aqueous	GC/MS EE	11/14/07	11/14/07	071114L01

Comment(s): -Results were evaluated to the MDL, concentrations  $\geq$  to the MDL but  $<$  RL, if found, are qualified with a "J" flag.

Parameter	Result	RL	MDL	DF	Qual	Parameter	Result	RL	MDL	DF	Qual
Benzene	230	5.0	1.4	10		Methyl-t-Butyl Ether (MTBE)	540	10	2.6	10	
Ethylbenzene	33	10	2.3	10		Tert-Butyl Alcohol (TBA)	590	100	54	10	
Toluene	ND	10	2.7	10		Diisopropyl Ether (DIPE)	ND	20	3.3	10	
p/m-Xylene	12	10	5.4	10		Ethyl-t-Butyl Ether (ETBE)	ND	20	1.8	10	
o-Xylene	ND	10	1.7	10		Tert-Amyl-Methyl Ether (TAME)	ND	20	11	10	
<u>Surrogates:</u>	<u>REC (%)</u>	<u>Control Limits</u>			<u>Qual</u>	<u>Surrogates:</u>	<u>REC (%)</u>	<u>Control Limits</u>			<u>Qual</u>
Dibromofluoromethane	117	74-140				1,2-Dichloroethane-d4	119	74-146			
Toluene-d8	99	88-112				1,4-Bromofluorobenzene	98	74-110			

Method Blank	099-10-006-23,447	N/A	Aqueous	GC/MS EE	11/14/07	11/14/07	071114L01
--------------	-------------------	-----	---------	----------	----------	----------	-----------

Comment(s): -Results were evaluated to the MDL, concentrations  $\geq$  to the MDL but  $<$  RL, if found, are qualified with a "J" flag.

Parameter	Result	RL	MDL	DF	Qual	Parameter	Result	RL	MDL	DF	Qual
Benzene	ND	0.50	0.14	1		Methyl-t-Butyl Ether (MTBE)	ND	1.0	0.26	1	
Ethylbenzene	ND	1.0	0.23	1		Tert-Butyl Alcohol (TBA)	ND	10	5.4	1	
Toluene	1.0	1.0	0.27	1		Diisopropyl Ether (DIPE)	ND	2.0	0.33	1	
p/m-Xylene	ND	1.0	0.54	1		Ethyl-t-Butyl Ether (ETBE)	ND	2.0	0.18	1	
o-Xylene	ND	1.0	0.17	1		Tert-Amyl-Methyl Ether (TAME)	ND	2.0	1.1	1	
<u>Surrogates:</u>	<u>REC (%)</u>	<u>Control Limits</u>			<u>Qual</u>	<u>Surrogates:</u>	<u>REC (%)</u>	<u>Control Limits</u>			<u>Qual</u>
Dibromofluoromethane	115	74-140				1,2-Dichloroethane-d4	118	74-146			
Toluene-d8	101	88-112				1,4-Bromofluorobenzene	93	74-110			

RL - Reporting Limit , DF - Dilution Factor , Qual - Qualifiers

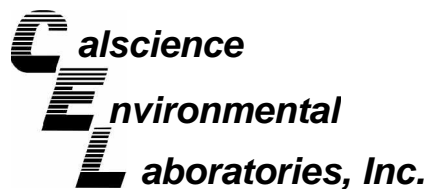

## Quality Control - Spike/Spike Duplicate



Blaine Tech Services, Inc.  
1680 Rogers Avenue  
San Jose, CA 95112-1105

Date Received: 11/14/07  
Work Order No: 07-11-0997  
Preparation: EPA 5030B  
Method: EPA 8015B (M)

Project 5755 Broadway, Oakland, CA

Quality Control Sample ID	Matrix	Instrument	Date Prepared	Date Analyzed	MS/MSD Batch Number
07-11-0996-1	Aqueous	GC 22	11/14/07	11/14/07	071114S01

Parameter	MS %REC	MSD %REC	%REC CL	RPD	RPD CL	Qualifiers
TPH as Gasoline	114	113	68-122	1	0-18	

RPD - Relative Percent Difference , CL - Control Limit



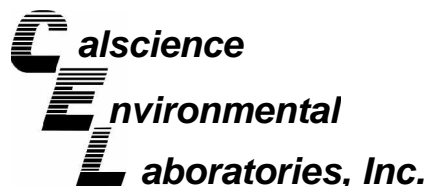

## Quality Control - Spike/Spike Duplicate



Blaine Tech Services, Inc.  
1680 Rogers Avenue  
San Jose, CA 95112-1105

Date Received: 11/14/07  
Work Order No: 07-11-0997  
Preparation: EPA 5030B  
Method: EPA 8260B

Project 5755 Broadway, Oakland, CA

Quality Control Sample ID	Matrix	Instrument	Date Prepared	Date Analyzed	MS/MSD Batch Number
07-11-0996-1	Aqueous	GC/MS EE	11/14/07	11/14/07	071114S01

Parameter	MS %REC	MSD %REC	%REC CL	RPD	RPD CL	Qualifiers
Benzene	101	99	88-118	2	0-7	
Carbon Tetrachloride	105	99	67-145	5	0-11	
Chlorobenzene	109	108	88-118	0	0-7	
1,2-Dibromoethane	113	116	70-130	2	0-30	
1,2-Dichlorobenzene	109	110	86-116	1	0-8	
1,1-Dichloroethene	106	106	70-130	0	0-25	
Ethylbenzene	107	108	70-130	1	0-30	
Toluene	109	108	87-123	1	0-8	
Trichloroethene	107	105	79-127	2	0-10	
Vinyl Chloride	99	96	69-129	3	0-13	
Methyl-t-Butyl Ether (MTBE)	108	101	71-131	3	0-13	
Tert-Butyl Alcohol (TBA)	90	85	36-168	5	0-45	
Diisopropyl Ether (DIPE)	109	104	81-123	5	0-9	
Ethyl-t-Butyl Ether (ETBE)	108	108	72-126	0	0-12	
Tert-Amyl-Methyl Ether (TAME)	108	110	72-126	1	0-12	
Ethanol	85	89	53-149	4	0-31	

RPD - Relative Percent Difference , CL - Control Limit

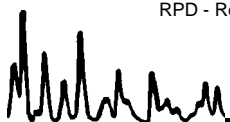

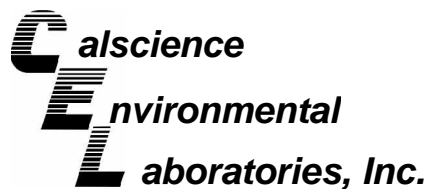

## Quality Control - LCS/LCS Duplicate



Blaine Tech Services, Inc.  
1680 Rogers Avenue  
San Jose, CA 95112-1105

Date Received: N/A  
Work Order No: 07-11-0997  
Preparation: EPA 5030B  
Method: EPA 8015B (M)

Project: 5755 Broadway, Oakland, CA

Quality Control Sample ID	Matrix	Instrument	Date Prepared	Date Analyzed	LCS/LCSD Batch Number
099-12-436-1,130	Aqueous	GC 22	11/14/07	11/14/07	071114B01

<u>Parameter</u>	<u>LCS %REC</u>	<u>LCSD %REC</u>	<u>%REC CL</u>	<u>RPD</u>	<u>RPD CL</u>	<u>Qualifiers</u>
TPH as Gasoline	114	111	78-120	2	0-10	

RPD - Relative Percent Difference , CL - Control Limit

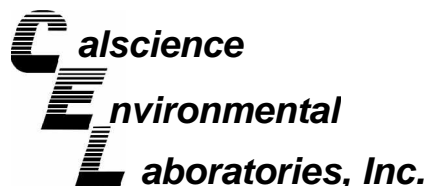

## Quality Control - LCS/LCS Duplicate



Blaine Tech Services, Inc.  
1680 Rogers Avenue  
San Jose, CA 95112-1105

Date Received: N/A  
Work Order No: 07-11-0997  
Preparation: EPA 5030B  
Method: EPA 8260B

Project: 5755 Broadway, Oakland, CA

Quality Control Sample ID	Matrix	Instrument	Date Prepared	Date Analyzed	LCS/LCSD Batch Number
099-10-006-23,447	Aqueous	GC/MS EE	11/14/07	11/14/07	071114L01

Parameter	LCS %REC	LCSD %REC	%REC CL	RPD	RPD CL	Qualifiers
Benzene	100	103	84-120	3	0-8	
Carbon Tetrachloride	103	109	63-147	5	0-10	
Chlorobenzene	112	107	89-119	5	0-7	
1,2-Dibromoethane	122	113	80-120	8	0-20	X
1,2-Dichlorobenzene	111	113	89-119	1	0-9	
1,1-Dichloroethene	108	112	77-125	3	0-16	
Ethylbenzene	113	109	80-120	3	0-20	
Toluene	112	113	83-125	1	0-9	
Trichloroethene	108	112	89-119	3	0-8	
Vinyl Chloride	92	101	63-135	9	0-13	
Methyl-t-Butyl Ether (MTBE)	107	108	82-118	0	0-13	
Tert-Butyl Alcohol (TBA)	96	105	46-154	9	0-32	
Diisopropyl Ether (DIPE)	108	110	81-123	2	0-11	
Ethyl-t-Butyl Ether (ETBE)	104	108	74-122	4	0-12	
Tert-Amyl-Methyl Ether (TAME)	109	109	76-124	0	0-10	
Ethanol	99	99	60-138	0	0-32	

RPD - Relative Percent Difference , CL - Control Limit

Work Order Number: 07-11-0997
 

---

<u>Qualifier</u>	<u>Definition</u>
*	See applicable analysis comment.
1	Surrogate compound recovery was out of control due to a required sample dilution, therefore, the sample data was reported without further clarification.
2	Surrogate compound recovery was out of control due to matrix interference. The associated method blank surrogate spike compound was in control and, therefore, the sample data was reported without further clarification.
3	Recovery of the Matrix Spike (MS) or Matrix Spike Duplicate (MSD) compound was out of control due to matrix interference. The associated LCS and/or LCSD was in control and, therefore, the sample data was reported without further clarification.
4	The MS/MSD RPD was out of control due to matrix interference. The LCS/LCSD RPD was in control and, therefore, the sample data was reported without further clarification.
5	The PDS/PDSD associated with this batch of samples was out of control due to a matrix interference effect. The associated batch LCS/LCSD was in control and, hence, the associated sample data was reported with no further corrective action required.
A	Result is the average of all dilutions, as defined by the method.
B	Analyte was present in the associated method blank.
C	Analyte presence was not confirmed on primary column.
E	Concentration exceeds the calibration range.
H	Sample received and/or analyzed past the recommended holding time.
J	Analyte was detected at a concentration below the reporting limit and above the laboratory method detection limit. Reported value is estimated.
N	Nontarget Analyte.
ND	Parameter not detected at the indicated reporting limit.
Q	Spike recovery and RPD control limits do not apply resulting from the parameter concentration in the sample exceeding the spike concentration by a factor of four or greater.
U	Undetected at the laboratory method detection limit.
X	% Recovery and/or RPD out-of-range.
Z	Analyte presence was not confirmed by second column or GC/MS analysis.

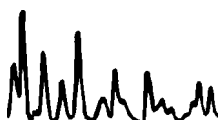



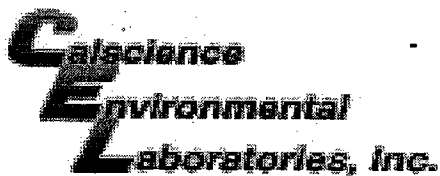

WORK ORDER #: 07 - 11 - 0997

Cooler 1 of 1

SAMPLE RECEIPT FORM

CLIENT: Blaine Tech

DATE: 11/14/07

TEMPERATURE - SAMPLES RECEIVED BY:

CALSCIENCE COURIER:

- Chilled, cooler with temperature blank provided.
Chilled, cooler without temperature blank.
Chilled and placed in cooler with wet ice.
Ambient and placed in cooler with wet ice.
Ambient temperature.
C Temperature blank.

LABORATORY (Other than Calscience Courier):

- 3.9 C Temperature blank.
C IR thermometer.
Ambient temperature.

Initial: [Signature]

CUSTODY SEAL INTACT:

Sample(s): Cooler: No (Not Intact): Not Present: [check]

Initial: [Signature]

SAMPLE CONDITION:

Table with 4 columns: Description, Yes, No, N/A. Rows include Chain-Of-Custody document(s), Sampler's name, Sample container label(s), Sample container(s) intact, Correct containers and volume, Proper preservation, VOA vial(s) free of headspace, Tedlar bag(s) free of condensation.

Initial: [Signature]

COMMENTS:

Blank lines for handwritten comments.







## SHELL WELL MONITORING DATA SHEET

BTS #: 071113-mp2	Site: 5755 Broadway, Oakland, CA
Sampler: mp	Date: 11/13/07
Well I.D.: S-2	Well Diameter: 2 3 <b>(4)</b> 6 8
Total Well Depth (TD): 9.51	Depth to Water (DTW): 2.31
Depth to Free Product:	Thickness of Free Product (feet):
Referenced to: <u>PVC</u> Grade	D.O. Meter (if req'd): YSI HACH
DTW with 80% Recharge [(Height of Water Column x 0.20) + DTW]: 03.34	

Purge Method:  Bailer       Waterra      Sampling Method:  Bailer  
 Disposable Bailer       Peristaltic       Disposable Bailer  
 Positive Air Displacement       Extraction Pump       Extraction Port  
 Electric Submersible      Other \_\_\_\_\_       Dedicated Tubing  
 Other: \_\_\_\_\_

$4.7$ (Gals.) X $3$ = $14.1$ Gals. <small>1 Case Volume      Specified Volumes      Calculated Volume</small>	<table border="1" style="width: 100%; border-collapse: collapse; font-size: small;"> <tr> <th>Well Diameter</th> <th>Multiplier</th> <th>Well Diameter</th> <th>Multiplier</th> </tr> <tr> <td>1"</td> <td>0.04</td> <td>4"</td> <td>0.65</td> </tr> <tr> <td>2"</td> <td>0.16</td> <td>6"</td> <td>1.47</td> </tr> <tr> <td>3"</td> <td>0.37</td> <td>Other</td> <td>radius<sup>2</sup> * 0.163</td> </tr> </table>	Well Diameter	Multiplier	Well Diameter	Multiplier	1"	0.04	4"	0.65	2"	0.16	6"	1.47	3"	0.37	Other	radius <sup>2</sup> * 0.163
Well Diameter	Multiplier	Well Diameter	Multiplier														
1"	0.04	4"	0.65														
2"	0.16	6"	1.47														
3"	0.37	Other	radius <sup>2</sup> * 0.163														

Time	Temp (°F)	pH	Cond. (mS or $\mu$ S)	Turbidity (NTUs)	Gals. Removed	Observations
1220	71.7	6.72	789	79	4.7	Clear, odor
1222	well dewatered		$\text{E}$	6 gallons	DTW $\Rightarrow$	5.91
<del>1225</del>		6.85				
1307	72.6	6.85	728	29	—	Clear, odor

Did well dewater?  Yes    No      Gallons actually evacuated: 6.0

Sampling Date: 11/13/07    Sampling Time: 1311    Depth to Water: 3.15

Sample I.D.: S-2      Laboratory: STL    Other: Cal Seis

Analyzed for: TPH-G    BTEX    MTBE    TPH-D    Other: See COC

EB I.D. (if applicable): @ Time      Duplicate I.D. (if applicable):

Analyzed for: TPH-G    BTEX    MTBE    TPH-D    Other:

D.O. (if req'd):	Pre-purge:	mg/L	Post-purge:	mg/L
O.R.P. (if req'd):	Pre-purge:	mV	Post-purge:	mV