

R026



Shell Oil Products US

February 5, 2004

Don Hwang
Alameda County Health Care Services Agency
1131 Harbor Bay Parkway, Suite 250
Alameda, California 94502-6577

Alameda County
FEB 10 2004
Environmental Health

Subject: Shell-branded Service Station
5755 Broadway
Oakland, California

Dear Mr. Hwang:

Attached for your review and comment is a copy of the *Fourth Quarter 2003 Monitoring Report* for the above referenced site. Upon information and belief, I declare, under penalty of perjury, that the information contained in the attached document is true and correct.

As always, please feel free to contact me directly at (559) 645-9306 with any questions or concerns.

Sincerely,

Shell Oil Products US

Karen Petryna
Sr. Environmental Engineer

February 5, 2004

Don Hwang
Alameda County Health Care Services Agency
1131 Harbor Bay Parkway, Suite 250
Alameda, California 94502-6577

Re: **Fourth Quarter 2003 Monitoring Report**
Shell-branded Service Station
5755 Broadway
Oakland, California
Incident #98995756
Cambria Project #246-0483-002

Alameda County
FEB 10 2004
Environmental Health



Dear Mr. Hwang:

On behalf of Equilon Enterprises LLC dba Shell Oil Products US, Cambria Environmental Technology, Inc. (Cambria) is submitting this groundwater monitoring report in accordance with the reporting requirements of 23 CCR 2652d.

HISTORICAL REMEDIATION SUMMARY

The site location is shown on Figures 1 and 2. Mobile groundwater extraction (GWE) using a vacuum truck was conducted periodically at the site from April to November 2000. A single dual-phase vacuum extraction (DVE) event was performed at the site on February 7, 2001, and monthly mobile DVE was conducted at the site from May to November 2001. GWE and DVE have collectively extracted approximately 20,038 gallons of groundwater from wells S-2, H-1, and T-2, and removed 0.46 pounds of methyl tertiary-butyl ether (MTBE). Subsequent to notification of the Alameda County Health Care Services Agency in our November 7, 2001 *Third Quarter 2001 Monitoring Report*, Cambria suspended monthly DVE from wells S-2 and H-1 due to the low influent volume of groundwater from S-2 and the low influent MTBE concentrations from H-1.

**Cambria
Environmental
Technology, Inc.**

5900 Hollis Street
Suite A
Emeryville, CA 94608
Tel (510) 420-0700
Fax (510) 420-9170

FOURTH QUARTER 2003 ACTIVITIES

Groundwater Monitoring: Blaine Tech Services, Inc. (Blaine) of San Jose, California gauged and sampled scheduled site wells, calculated groundwater elevations, and compiled the analytical data. Cambria prepared a vicinity map that includes previously submitted well survey information (Figure 1) and a groundwater elevation contour map (Figure 2). Blaine's report, presenting the laboratory reports and supporting field documents, is included as Attachment A.

Temporary GWE System Installation: As described in our second quarter 2003 monitoring report, plans for installing a fixed GWE system were put on hold due to the localized nature of the groundwater impact, and plans for installing a temporary GWE system pumping from well S-2 were initiated. Installation of this temporary system was completed, and operation began on October 28, 2003.

A pump is installed in well S-2, and extracted water is stored on site in a Baker tank. Water is periodically offhauled from the tank using a vacuum truck. Measurements of transported water are used to assess system production. Through December 19, 2003, a total of 3664 gallons of water had been produced, equating to a flow rate of approximately 0.05 gallons per minute since system operation began. A total of 0.37 pounds of MTBE has been recovered. Table 1 summarizes mass removal data from the temporary GWE system.

ANTICIPATED FIRST QUARTER 2004 ACTIVITIES

Groundwater Monitoring: Blaine will gauge and sample selected site wells, including the horizontal well (without purging), and tabulate the data. A groundwater monitoring report will be prepared.

Temporary GWE System: Cambria will continue to operate the temporary GWE system. Data from subsequent sampling events will be evaluated to determine whether installation of the permanent GWE system is warranted. Should future data indicate that installation of the fixed system is warranted, we will proceed with the permitting process for this system.

CLOSING

We appreciate the opportunity to work with you on this project. Please call Diane Lundquist at (510) 420-3334 if you have any questions or comments.

Sincerely,
Cambria Environmental Technology, Inc



Diane Lundquist, P.E.
Principal Engineer



Figures: 1 - Vicinity/Well Survey Map
 2 - Groundwater Elevation Contour Map

Table: 1 - Groundwater Extraction System Mass Removal Data

Attachment: A - Blaine Groundwater Monitoring Report and Field Notes

cc: Karen Petryna, Shell Oil Products US, 20945 S. Wilmington Ave., Carson, CA 90810
 Thrifty Oil Company, c/o Mr. Raymond Fredricksen, PO Box 2128, Santa Fe Springs,
 CA 90670

\\loakdc\shell\Oakland 5755 Broadway\QM\4q03\4q03qm.doc

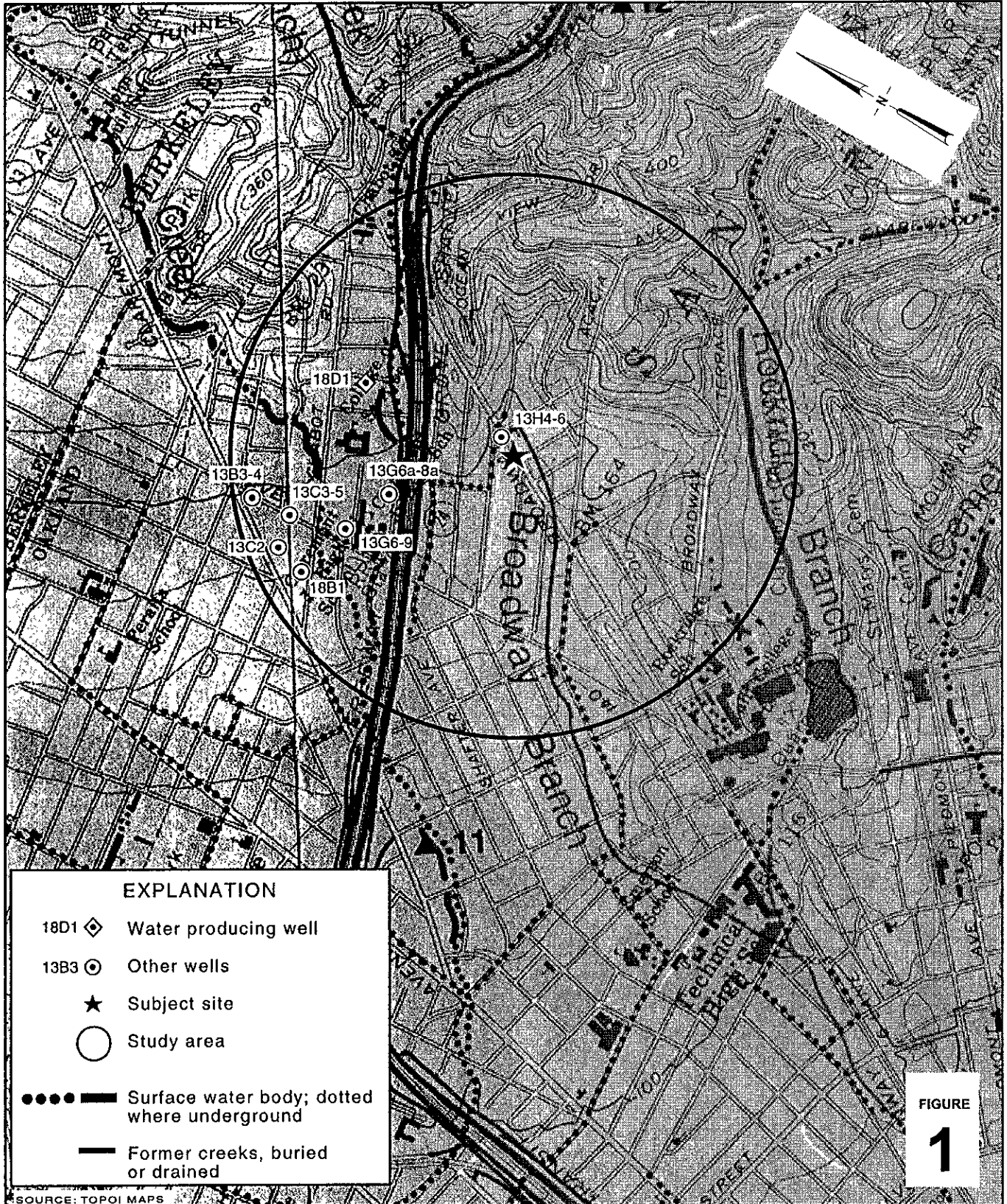

G:\OAKLAND\5755BROADWAY\FIGURES\VIC-WELL-SURVEY.A1

SOURCE: TOPOI MAPS

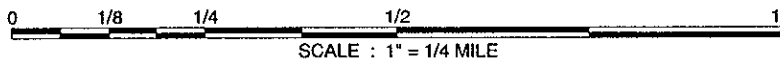

FIGURE 1

Shell-branded Service Station
 5755 Broadway
 Oakland, California
 Incident #98995756



C A M B R I A

Vicinity / Well Survey Map
 (1/2-Mile Radius)

02/05/04
G:\OAKI AND 575 BROADWAY\FIGURES\FIG03 AI

EXPLANATION

- S-1 ◆ Monitoring well location
- S-2 ◆ Groundwater monitoring well used for extraction
- T-1 ★ Tank backfill well location
- T-3 □ Pre-pack monitoring well location
- H-1 □ Horizontal extraction well location
- B-1 ○ Soil boring location (Miller-Brooks, 8/6-7/02)
- NA Not available
- Groundwater flow direction
- XX.XX Groundwater elevation contour, in feet above mean sea level (msl), approximately located

Well	Well designation
ELEV	Groundwater elevation, in feet above msl
Benzene MTBE	Benzene and MTBE concentrations are in parts per billion and are analyzed by EPA Method 8260.

- Sanitary sewer line (SS)
- Storm drain (SD)
- Overhead powerline (E)
- ▲ Flow direction
- Manhole
- 4.5 fbg Feet below grade

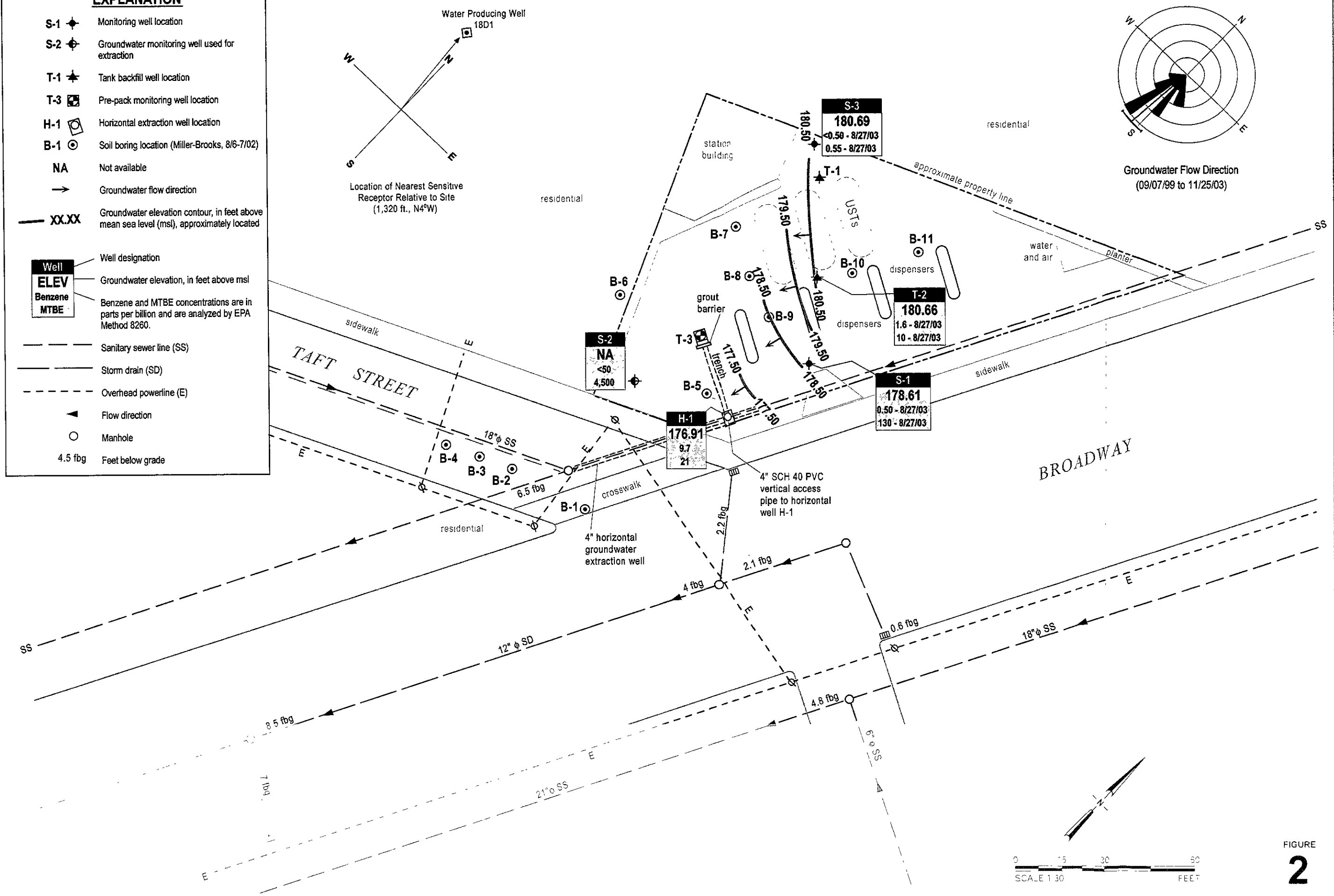

FIGURE
2

Table 1. Groundwater Extraction System Mass Removal Data, Shell-branded Service Station, Incident #98995756, 5755 Broadway, California

Date	Period	Cumulative Volume Pumped	Estimated System Flow Rate	Sample Date	TPHg Concentration (ppb)	TPHg Removed (pounds)	Cumulative TPHg Removed (pounds)	Benzene Concentration (ppb)	Benzene Removed (pounds)	Cumulative Benzene Removed (pounds)	MTBE Concentration (ppb)	MTBE Removed (pounds)	Cumulative MTBE Removed (pounds)
10/28/03	0	0	0.00	08/27/03	31,000	0.000	0.000	630	0.000	0.000	15,000	0.000	0.000
11/25/03	2,701	2,701	0.07	11/25/03	8,400	0.699	0.699	<50	0.007	0.007	4,500	0.338	0.338
12/19/03	963	3,664	0.03	12/19/03	<5,000	0.034	0.732	<50	0.000	0.007	2,600	0.036	0.374
Not Purged	0	3,664	NM	01/08/04	<2,500	0.000	0.732	180	0.000	0.007	3,000	0.000	0.374
Not Purged	0	3,664	NM	01/20/04	<5,000	0.000	0.732	<50	0.000	0.007	2,600	0.000	0.374
Total Gallons Extracted:		3,664			Total Pounds Removed:		0.732			0.007			0.374
Average Flow Rate:		0.05			Total Gallons Removed:		0.120			0.001			0.061

Abbreviations & Notes:

TPHg = Total purgeable hydrocarbons as gasoline

MTBE = Methyl tertiary butyl ether

ppb = Parts per billion, equivalent to µg/L

Not Purged = The baker tank is emptied as needed when full. Volume is measured based on periodic baker tank pumpouts. Tank is not pumped during every sampling event.

NM = If baker tank is not emptied, no new period volume is calculated. Therefore, period flow rate is not calculated for every sampling event.

µg = Micrograms

L = Liter

gal = Gallon

g = Gram

TPHg and benzene analyzed by EPA Method 8015/8020 or equivalent.

MTBE analyzed by EPA Method 8260.

When constituents are not detected, the concentration is assumed to be equal to half the detection limit in subsequent calculations.

Mass removed (pounds) based on the formula: volume(gal) x concentration(µg/L) x (g/10⁶µg) x (pound/453.6g) x (3.785 L/gal)

Volume removed (gallons) based on the formula: [mass(pounds) x 453.6(g/pound) x (gal/3.785L) x (L/1000cm³)] / density(g/cm³)

Density inputs: TPHg = 0.73 g/cm³, benzene = 0.88 g/cm³, MTBE = 0.74 g/cm³

Note: Groundwater is extracted from well S-2 using a submersible groundwater pump, and contained in a 6,500 gallon baker tank. The baker tank is periodically emptied using vacuum trucks provided by Onyx Industrial. The water is disposed of at Shell's Martinez refinery.

Note: Concentrations based on most recent groundwater monitoring results for well S-2.

ATTACHMENT A

Blaine Groundwater Monitoring Report and Field Notes

BLAINE
TECH SERVICES INC.



1680 ROGERS AVENUE
SAN JOSE, CA 95112-1105
(408) 573-7771 FAX
(408) 573-0555 PHONE
CONTRACTOR'S LICENSE #746684
www.blainetech.com

December 15, 2003

Karen Petryna
Shell Oil Products US
P.O. Box 7869
Burbank, CA 91510-7869

Fourth Quarter 2003 Groundwater Monitoring at
Shell-branded Service Station
5755 Broadway
Oakland, CA

Monitoring performed on November 25, 2003

Groundwater Monitoring Report **031125-JP-2**

This report covers the routine monitoring of groundwater wells at this Shell-branded facility. In accordance with standard procedures that conform to Regional Water Quality Control Board requirements, routine field data collection includes depth to water, total well depth, thickness of any separate immiscible layer, water column volume, calculated purge volume (if applicable), elapsed evacuation time (if applicable), total volume of water removed (if applicable), and standard water parameter instrument readings. Sample material is collected, contained, stored, and transported to the laboratory in conformance with EPA standards. Purgewater (if applicable) is, likewise, collected and transported to the Martinez Refining Company.

Basic field information is presented alongside analytical values excerpted from the laboratory report in the cumulative table of **WELL CONCENTRATIONS**. The full analytical report for the most recent samples and the field data sheets are attached to this report.

At a minimum, Blaine Tech Services, Inc. field personnel are certified on completion of a forty-hour Hazardous Materials and Emergency Response training course per 29 CFR 1910.120. Field personnel are also enrolled in annual eight-hour refresher courses.

Blaine Tech Services, Inc. conducts sampling and documentation assignments of this type as an independent third party. Our activities at this site consisted of objective data and sample collection only. No interpretation of analytical results, defining of hydrological conditions or formulation of recommendations was performed.

Please call if you have any questions.

Yours truly,

Leon Gearhart
Project Coordinator

LG/jt

attachments: Cumulative Table of WELL CONCENTRATIONS
Certified Analytical Report
Field Data Sheets

cc: Anni Kreml
Cambria Environmental Technology, Inc.
5900 Hollis Street, Suite A
Oakland, CA 94608

WELL CONCENTRATIONS
Shell-branded Service Station
5755 Broadway
Oakland, CA

Well ID	Date	TPPH (ug/L)	B (ug/L)	T (ug/L)	E (ug/L)	X (ug/L)	MTBE 8020 (ug/L)	MTBE 8260 (ug/L)	TOC (MSL)	Depth to Water (ft)	GW Elevation (MSL)	DO Reading (ppm)
S-1	01/25/1991	<30	<0.3	<0.3	<0.3	<0.3	NA	NA	100.00	3.88	96.12	NA
S-1	06/03/1991	<30	<0.3	<0.3	<0.3	<0.3	NA	NA	100.00	3.51	96.49	NA
S-1	08/30/1991	<30	<0.3	<0.3	<0.3	<0.3	NA	NA	100.00	4.24	95.76	NA
S-1	11/22/1991	<30	2.3	<0.46	0.3	<0.65	NA	NA	100.00	4.29	95.71	NA
S-1	03/13/1992	<30	<0.52	<0.3	<0.3	<0.3	NA	NA	100.00	2.87	97.13	NA
S-1	05/28/1992	<50	<0.5	<0.5	<0.5	<0.5	NA	NA	100.00	3.79	96.21	NA
S-1	08/19/1992	<50	<0.5	<0.5	<0.5	<0.5	NA	NA	100.00	4.43	95.57	NA
S-1	11/18/1992	<50	<0.5	<0.5	<0.5	<0.5	NA	NA	100.00	4.34	95.66	NA
S-1	02/10/1993	51	1.4	<0.5	<0.5	<0.5	NA	NA	100.00	4.20	95.80	NA
S-1 (D)	02/10/1993	<50	1.2	<0.5	<0.5	<0.5	NA	NA	100.00	4.20	95.80	NA
S-1	06/11/1993	<50	<0.5	<0.5	<0.5	<0.5	NA	NA	100.00	3.39	96.61	NA
S-1	08/03/1993	<50	<0.5	<0.5	<0.5	<0.5	NA	NA	100.00	3.69	96.31	NA
S-1	11/02/1993	70a	<0.5	<0.5	<0.5	<0.5	NA	NA	100.00	4.26	95.74	NA
S-1	12/16/1993	NA	NA	NA	NA	NA	NA	NA	100.00	2.73	97.27	NA
S-1	02/01/1994	60a	<0.5	<0.5	<0.5	<0.5	NA	NA	100.00	3.38	96.62	NA
S-1	05/04/1994	<50	1.1	<0.5	<0.5	<0.5	NA	NA	100.00	3.00	97.00	NA
S-1	08/18/1994	<50	0.6	<0.5	<0.5	<0.5	NA	NA	100.00	3.70	96.30	NA
S-1 (D)	08/18/1994	60a	0.5	<0.5	<0.5	<0.5	NA	NA	100.00	3.70	96.30	NA
S-1	11/09/1994	<50	4	<0.5	<0.5	<0.5	NA	NA	100.00	2.52	97.48	NA
S-1	02/22/1995	50	0.8	0.7	<0.5	1.3	NA	NA	100.00	4.08	95.92	NA
S-1	05/02/1995	<50	<0.5	<0.5	<0.5	<0.5	NA	NA	100.00	2.58	97.42	NA
S-1	08/30/1995	<50	1.7	<0.5	<0.5	<0.5	NA	NA	100.00	3.48	96.52	NA
S-1	11/28/1995	<50	<0.5	<0.5	<0.5	<0.5	NA	NA	100.00	3.99	96.01	NA
S-1	02/02/1996	<50	11	<0.5	0.9	<0.5	NA	NA	100.00	2.00	98.00	NA
S-1	03/09/1996	<50	<0.5	<0.5	<0.5	<0.5	NA	NA	100.00	3.38	99.62	NA
S-1	08/22/1996	<50	1.5	<0.5	<0.5	<0.5	130	NA	100.00	3.43	96.57	NA
S-1	11/07/1996	<50	<0.5	<0.5	<0.5	<0.5	57	NA	100.00	3.70	96.30	4.33

WELL CONCENTRATIONS
Shell-branded Service Station
5755 Broadway
Oakland, CA

Well ID	Date	TPPH (ug/L)	B (ug/L)	T (ug/L)	E (ug/L)	X (ug/L)	MTBE 8020 (ug/L)	MTBE 8260 (ug/L)	TOC (MSL)	Depth to Water (ft.)	GW Elevation (MSL)	DO Reading (ppm)
S-1	02/20/1997	<50	0.64	<0.50	<0.50	1.6	6.5	NA	100.00	3.60	96.40	2
S-1	05/30/1997	<50	<0.50	<0.50	<0.50	<0.50	46	NA	100.00	3.47	96.53	7
S-1 (D)	05/30/1997	<50	<0.50	<0.50	<0.50	<0.50	47	NA	100.00	3.47	96.53	7
S-1	08/21/1997	<50	<0.50	<0.50	<0.50	0.84	26	NA	100.00	3.01	96.99	3.1
S-1	11/03/1997	<50	<0.50	1.1	<0.50	1.3	190	NA	100.00	3.66	96.34	2
S-1	01/20/1998	110	7.9	2.8	4.4	13	53	NA	100.00	1.84	98.16	4.6
S-1 (D)	01/20/1998	130	9.2	6.9	5.2	15	93	NA	100.00	1.84	98.16	4.6
S-1	02/16/1999	<50	<0.50	<0.50	<0.50	<0.50	8.6	NA	100.00	2.43	97.57	2.2
S-1	09/07/1999	NA	NA	NA	NA	NA	NA	NA	100.00	2.84	97.16	NA
S-1	02/02/2000	<50.0	<0.500	<0.500	<0.500	<0.500	202	NA	100.00	3.10	96.90	2.1
S-1	04/26/2000	NA	NA	NA	NA	NA	NA	NA	100.00	2.91	97.09	NA
S-1	07/25/2000	<50.0	<0.500	<0.500	<0.500	<0.500	811	NA	100.00	3.21	96.79	1.8
S-1	11/15/2000	NA	NA	NA	NA	NA	NA	NA	100.00	3.18	96.82	NA
S-1	02/12/2001	<50.0	<0.500	<0.500	<0.500	<0.500	209	NA	100.00	1.34	98.66	2.2
S-1	06/07/2001	NA	NA	NA	NA	NA	NA	NA	100.00	1.27	98.73	NA
S-1	08/31/2001	<50	<0.50	<0.50	<0.50	<0.50	NA	<5.0	100.00	3.16	96.84	4.0
S-1	12/05/2001	NA	NA	NA	NA	NA	NA	2.6	100.00	1.90	98.10	NA
S-1	01/31/2002	<50	<0.50	<0.50	<0.50	<0.50	NA	<5.0	100.00	2.67	97.33	NA
S-1	06/04/2002	NA	NA	NA	NA	NA	NA	NA	100.00	1.87	98.13	NA
S-1	07/25/2002	<50	<0.50	<0.50	<0.50	<0.50	NA	<5.0	100.00	2.01	97.99	NA
S-1	11/07/2002	NA	NA	NA	NA	NA	NA	NA	181.89	3.01	178.88	NA
S-1	11/14/2002	NA	NA	NA	NA	NA	NA	NA	181.89	3.40	178.49	NA
S-1	01/30/2003	<50	<0.50	<0.50	<0.50	<0.50	NA	27	181.89	2.12	179.77	NA
S-1	06/03/2003	NA	NA	NA	NA	NA	NA	NA	181.89	1.83	180.06	NA
S-1	08/27/2003	<50	0.50	1.5	<0.50	2.0	NA	130	181.89	3.32	178.57	NA
S-1	11/25/2003	NA	NA	NA	NA	NA	NA	NA	181.89	3.28	178.61	NA
S-2	01/25/1991	450	140	1.8	6.2	15	NA	NA	98.92	4.52	94.40	NA

WELL CONCENTRATIONS
Shell-branded Service Station
5755 Broadway
Oakland, CA

Well ID	Date	TPPH (ug/L)	B (ug/L)	T (ug/L)	E (ug/L)	X (ug/L)	MTBE 8020 (ug/L)	MTBE 8260 (ug/L)	TOC (MSL)	Depth to Water (ft)	GW Elevation (MSL)	DO Reading (ppm)
S-2	06/03/1991	490	150	27	8.2	7	NA	NA	98.92	4.02	94.90	NA
S-2	08/30/1991	70	0.37	<0.3	<0.3	<0.3	NA	NA	98.92	4.70	94.22	NA
S-2	11/22/1991	1,600	110	9.3	29	150	NA	NA	98.92	4.72	94.20	NA
S-2	03/13/1992	1,300	210	5.7	34	79	NA	NA	98.92	3.47	95.45	NA
S-2	05/28/1992	100	28	<0.5	<0.5	<0.5	NA	NA	98.92	4.45	94.45	NA
S-2	08/19/1992	470	42	<0.5	8.3	4	NA	NA	98.92	4.84	94.08	NA
S-2	11/18/1992	490	43	39	17	29	NA	NA	98.92	4.73	94.19	NA
S-2	02/10/1993	19,000	710	760	80	370	NA	NA	98.92	4.83	94.09	NA
S-2	06/11/1993	33,000	3,100	1,600	370	1,100	NA	NA	98.92	3.74	95.18	NA
S-2	08/03/1993	18,000	1,400	130	81	130	NA	NA	98.92	4.23	94.69	NA
S-2 (D)	08/03/1993	19,000	1,400	140	86	150	NA	NA	98.92	4.23	94.69	NA
S-2	11/02/1993	12,000a	470	47	31	92	NA	NA	98.92	4.72	94.20	NA
S-2 (D)	11/02/1993	13,000a	530	47	35	96	NA	NA	98.92	4.72	94.20	NA
S-2	12/16/1993	NA	NA	NA	NA	NA	NA	NA	98.92	3.00	95.92	NA
S-2	02/01/1994	31,000a	430	46	50	130	NA	NA	98.92	3.48	95.44	NA
S-2 (D)	02/01/1994	31,000a	300	33	30	100	NA	NA	98.92	3.48	95.44	NA
S-2	05/04/1994	3,900	1,200	31	53	71	NA	NA	98.92	3.26	95.66	NA
S-2 (D)	05/04/1994	4,500	1,200	37	57	110	NA	NA	98.92	3.26	95.66	NA
S-2	08/18/1994	24,000	600	8.3	15	27	NA	NA	98.92	3.98	94.94	NA
S-2	11/09/1994	1,400a	240	9.3	13	20	NA	NA	98.92	3.10	95.82	NA
S-2 (D)	11/09/1994	1,800	260	8.5	13	21	NA	NA	98.92	3.10	95.82	NA
S-2	02/22/1995	29,000	550	18	12	63	NA	NA	98.92	4.02	94.90	NA
S-2 (D)	02/22/1995	28,000	530	17	10	60	NA	NA	98.92	4.02	94.90	NA
S-2	05/02/1995	4,400	1,000	25	38	77	NA	NA	98.92	2.86	96.06	NA
S-2 (D)	05/02/1995	4,400	1,000	26	41	83	NA	NA	98.92	2.86	96.06	NA
S-2	08/30/1995	800	350	20	6.7	16	NA	NA	98.92	4.06	94.86	NA
S-2 (D)	08/30/1995	960	220	22	12	48	NA	NA	98.92	4.06	94.86	NA
S-2	11/28/1995	2,000	230	220	50	230	NA	NA	98.92	4.48	94.44	NA

WELL CONCENTRATIONS
Shell-branded Service Station
5755 Broadway
Oakland, CA

Well ID	Date	TPPH (ug/L)	B (ug/L)	T (ug/L)	E (ug/L)	X (ug/L)	MTBE 8020 (ug/L)	MTBE 8260 (ug/L)	TOC (MSL)	Depth to Water (ft)	GW Elevation (MSL)	DO Reading (ppm)
S-2 (D)	11/28/1995	2,100	240	230	51	230	NA	NA	98.92	4.48	94.44	NA
S-2	02/02/1996	18,000	540	18	12	22	NA	NA	98.92	1.99	96.93	NA
S-2 (D)	02/02/1996	11,000	600	18	13	28	NA	NA	98.92	1.99	96.93	NA
S-2	03/09/1996	3,800	1,500	27	30	58	NA	NA	98.92	3.27	95.65	NA
S-2 (D)	03/09/1996	3,500	1,300	24	21	53	NA	NA	98.92	3.27	95.65	NA
S-2	08/22/1996	<20,000	490	<200	<200	<200	43,000	NA	98.92	3.85	95.07	NA
S-2 (D)	08/22/1996	<20,000	570	<200	<200	<200	59,000	51,000	98.92	3.85	95.07	NA
S-2	11/07/1996	<5,000	290	<50	<50	<50	32,000	NA	98.92	4.00	94.92	3.51
S-2 (D)	11/07/1996	<5,000	290	<50	<50	<50	32,000	NA	98.92	4.00	94.92	3.51
S-2	02/20/1997	<10,000	520	<100	<100	<100	28,000	NA	98.92	3.20	95.72	1
S-2 (D)	02/20/1997	<10,000	520	<100	<100	<100	35,000	NA	98.92	3.20	95.72	1
S-2	05/30/1997	150	15	11	3.5	15	11	NA	98.92	3.87	95.05	6
S-2	08/21/1997	1,600	220	<10	20	<10	18,000	NA	98.92	3.29	95.63	3.3
S-2 (D)	08/21/1997	1,500	180	<10	16	<10	21,000	NA	98.92	3.29	95.63	3.3
S-2	11/03/1997	1,000	94	<10	<10	<10	<50	NA	98.92	4.02	94.90	1.8
S-2	01/20/1998	590	110	8.3	18	23	7,800	NA	98.92	1.54	97.38	3.2
S-2	07/23/1998	2,600	840	<10	44	22	15,000	NA	98.92	2.89	96.03	NA
S-2	02/16/1999	680	140	6.1	10	18	19,000	NA	98.92	1.86	97.06	2.0
S-2	09/07/1999	<2,000	248	<20.0	<20.0	<20.0	22,800	NA	98.92	3.66	95.26	1.8
S-2	02/02/2000	103	0.825	<0.500	<0.500	<0.500	11,700	10,500	98.92	4.02	94.90	2.0
S-2	04/26/2000	4,040	799	<20.0	40.9	255	19,000	17,100b	98.92	2.63	96.29	2.3
S-2	07/25/2000	1,120	195	5.94	5.62	11.3	26,600	21,100	98.92	3.42	95.50	0.6
S-2b	11/15/2000	613	35.6	<5.00	<5.00	7.36	18,100	17,800	98.92	3.31	95.61	1.8
S-2	02/12/2001	9,010	1,430	<20.0	219	848	28,300	17,000	98.92	1.47	97.45	2.0
S-2	06/07/2001	31,000	1,000	<25	630	3,200	NA	17,000	98.92	3.43	95.49	10.4
S-2	08/31/2001	50,000	950	<20	1,500	6,000	NA	17,000	98.92	4.72	94.20	0.9
S-2	12/05/2001	49,000	590	7.2	1,400	4,900	NA	11,000	98.92	1.53	97.39	NA
S-2	01/31/2002	37,000	860	<25	1,100	4,000	NA	14,000	98.92	2.13	96.79	NA

WELL CONCENTRATIONS
Shell-branded Service Station
5755 Broadway
Oakland, CA

Well ID	Date	TPPH (ug/L)	B (ug/L)	T (ug/L)	E (ug/L)	X (ug/L)	MTBE 8020 (ug/L)	MTBE 8260 (ug/L)	TOC (MSL)	Depth to Water (ft)	GW Elevation (MSL)	DO Reading (ppm)
---------	------	----------------	-------------	-------------	-------------	-------------	------------------------	------------------------	--------------	---------------------------	--------------------------	------------------------

S-2	06/04/2002	150,000	800	<20	1,200	4,000	NA	9,200	98.92	2.24	96.68	NA
S-2	07/25/2002	37,000	350	<20	660	2,400	NA	10,000	98.92	2.03	96.89	NA
S-2	11/14/2002	25,000	510	<25	590	2,000	NA	10,000	180.79	3.17	177.62	NA
S-2	01/02/2003	NA	710	<25	560	2,074	NA	NA	180.79	2.15	178.64	NA
S-2	01/30/2003	21,000	670	<20	360	1,200	NA	9,300	180.79	2.09	178.70	NA
S-2	06/03/2003	42,000	800	<50	660	1,500	NA	9,600	180.79	3.08	177.71	NA
S-2	08/27/2003	31,000	630	<100	510	1,200	NA	15,000	180.79	2.55	178.24	NA
S-2	11/25/2003 d	8,400 a	<50	<50	<50	<100	NA	4,500	180.79	NA	NA	NA

S-3	01/25/1991	<30	<0.3	<0.3	<0.3	<0.3	NA	NA	101.67	3.84	97.83	NA
S-3	06/03/1991	<30	<0.3	0.3	0.3	0.3	NA	NA	101.67	3.25	98.42	NA
S-3	08/03/1991	<30	<0.3	<0.3	<0.3	<0.3	NA	NA	101.67	4.73	96.94	NA
S-3	11/22/1991	<30	<0.3	<0.3	<0.3	<0.3	NA	NA	101.67	4.81	96.86	NA
S-3	03/13/1992	<30	<0.3	0.3	0.3	0.3	NA	NA	101.67	2.29	99.38	NA
S-3	05/28/1992	<50	<0.5	<0.5	<0.5	<0.5	NA	NA	101.67	3.62	98.05	NA
S-3	08/19/1992	<50	<0.5	<0.5	<0.5	0.5	NA	NA	101.67	4.66	97.01	NA
S-3	11/18/1992	<50	<0.5	<0.5	<0.5	<0.5	NA	NA	101.67	4.51	97.16	NA
S-3	02/10/1993	30	1.9	3.2	2.4	5.6	NA	NA	101.67	4.36	97.31	NA
S-3	06/11/1993	<50	<0.5	<0.5	<0.5	<0.5	NA	NA	101.67	2.91	98.76	NA
S-3 (D)	06/11/1993	<50	<0.5	<0.5	<0.5	<0.5	NA	NA	101.67	2.91	98.76	NA
S-3	08/03/1993	<50	<0.5	<0.5	<0.5	<0.5	NA	NA	101.67	3.70	97.97	NA
S-3	11/02/1993	Well inaccessible		NA	NA	NA	NA	NA	101.67	NA	NA	NA
S-3	12/16/1993	NA	NA	NA	NA	NA	NA	NA	101.67	2.12	99.55	NA
S-3	02/01/1994	<50	<0.5	<0.5	<0.5	<0.5	NA	NA	101.67	2.90	98.77	NA
S-3	05/04/1994	<50	<0.5	<0.5	<0.5	<0.5	NA	NA	101.67	2.54	99.13	NA
S-3	08/18/1994	<50	<0.5	<0.5	<0.5	<0.5	NA	NA	101.67	3.51	98.16	NA
S-3	11/09/1994	<50	<0.5	<0.5	<0.5	<0.5	NA	NA	101.67	2.44	99.23	NA
S-3	02/22/1995	80	<0.5	0.5	<0.5	0.5	NA	NA	101.67	4.12	97.55	NA

WELL CONCENTRATIONS
Shell-branded Service Station
5755 Broadway
Oakland, CA

Well ID	Date	TPPH (ug/L)	B (ug/L)	T (ug/L)	E (ug/L)	X (ug/L)	MTBE 8020 (ug/L)	MTBE 8260 (ug/L)	TOC (MSL)	Depth to Water (ft)	GW Elevation (MSL)	DO Reading (ppm)
S-3	05/02/1995	<50	<0.5	<0.5	<0.5	<0.5	NA	NA	101.67	2.83	98.84	NA
S-3	08/30/1995	<50	0.5	<0.5	<0.5	<0.5	NA	NA	101.67	3.16	98.51	NA
S-3	11/28/1995	<50	<0.5	<0.5	<0.5	<0.5	NA	NA	101.67	3.87	97.80	NA
S-3	02/02/1996	<50	<0.5	<0.5	<0.5	<0.5	NA	NA	101.67	2.24	99.43	NA
S-3	03/09/1996	<50	<0.5	<0.5	<0.5	<0.5	NA	NA	101.67	3.05	98.62	NA
S-3	08/22/1996	<50	0.8	<0.5	<0.5	<0.5	<2.5	NA	101.67	2.85	98.82	4.6
S-3	11/07/1996	<50	<0.5	<0.5	<0.5	<0.5	<2.5	NA	101.67	3.35	98.32	4.6
S-3	02/20/1997	<50	<0.50	<0.50	<0.50	<0.50	<2.5	NA	101.67	3.00	98.67	1
S-3	05/30/1997	140	14	10	3.3	14	8.6	NA	101.67	3.00	98.67	8
S-3	08/21/1997	<50	<0.50	<0.50	<0.50	<0.50	<2.5	NA	101.67	2.94	98.73	3.3
S-3	11/03/1997	<50	<0.50	<0.50	<0.50	<0.50	<2.5	NA	101.67	3.36	98.31	2.4
S-3 (D)	11/03/1997	<50	<0.50	<0.50	<0.50	<0.50	<2.5	NA	101.67	3.36	98.31	2.4
S-3	01/20/1998	Well inaccessible		NA	NA	NA	NA	NA	101.67	NA	NA	NA
S-3	07/23/1998	NA	NA	NA	NA	NA	NA	NA	101.67	2.69	98.98	NA
S-3	02/16/1999	<50	<0.50	0.92	0.59	3.9	3.7	NA	101.67	2.20	99.47	2.8
S-3	09/07/1999	NA	NA	NA	NA	NA	NA	NA	101.67	2.81	98.86	NA
S-3	02/02/2000	<50.0	<0.500	<0.500	<0.500	<0.500	<5.00	NA	101.67	3.97	97.70	2.7
S-3	04/26/2000	NA	NA	NA	NA	NA	NA	NA	101.67	2.96	98.71	NA
S-3	07/25/2000	<50.0	<0.500	<0.500	<0.500	<0.500	<2.50	NA	101.67	3.00	98.67	0.8
S-3	11/15/2000	NA	NA	NA	NA	NA	NA	NA	101.67	2.86	98.81	NA
S-3	02/12/2001	<50.0	<0.500	<0.500	<0.500	<0.500	<2.50	NA	101.67	2.47	99.20	2.3
S-3	06/07/2001	NA	NA	NA	NA	NA	NA	NA	101.67	2.78	98.89	NA
S-3	08/31/2001	<50	<0.50	<0.50	<0.50	<0.50	NA	<5.0	101.67	3.94	97.73	0.5
S-3	12/05/2001	NA	NA	NA	NA	NA	NA	NA	101.67	2.05	99.62	NA
S-3	01/31/2002	<50	<0.50	<0.50	<0.50	<0.50	NA	<5.0	101.67	2.29	99.38	NA
S-3	06/04/2002	NA	NA	NA	NA	NA	NA	NA	101.67	2.56	99.11	NA
S-3	07/25/2002	<50	<0.50	<0.50	<0.50	<0.50	NA	<5.0	101.67	2.70	98.97	NA
S-3	11/14/2002	NA	NA	NA	NA	NA	NA	NA	183.54	3.43	180.11	NA

WELL CONCENTRATIONS
Shell-branded Service Station
5755 Broadway
Oakland, CA

Well ID	Date	TPPH (ug/L)	B (ug/L)	T (ug/L)	E (ug/L)	X (ug/L)	MTBE 8020 (ug/L)	MTBE 8260 (ug/L)	TOC (MSL)	Depth to Water (ft)	GW Elevation (MSL)	DO Reading (ppm)
S-3	01/30/2003	<50	<0.50	<0.50	<0.50	<0.50	NA	<5.0	183.54	2.16	181.38	NA
S-3	01/30/2003	NA	NA	NA	NA	NA	NA	NA	183.54	2.65	180.89	NA
S-3	08/27/2003	<50	<0.50	<0.50	<0.50	<1.0	NA	0.55	183.54	2.75	180.79	NA
S-3	11/25/2003	NA	NA	NA	NA	NA	NA	NA	183.54	2.85	180.69	NA
H-1	12/05/2001	150	<0.50	8.3	1.6	16	NA	52	NA	1.43	NA	NA
H-1	01/31/2002	3,200	12	<0.50	5.7	3.7	NA	650	NA	2.34	NA	NA
H-1	06/04/2002	280,000	<10	150	62	9,500	NA	<100	NA	2.56	NA	NA
H-1	07/25/2002	8,200	2.2	46	5.3	99	NA	<10	NA	2.83	NA	NA
H-1	11/14/2002	1,700	2.1	2.6	1.5	14	NA	380	180.63	3.74	176.89	NA
H-1	01/02/2003	NA	1.1	<0.50	<0.50	3.6	NA	NA	180.63	1.45	179.18	NA
H-1	01/30/2003	630	0.99	2.0	1.6	12	NA	21	180.63	2.10	178.53	NA
H-1	06/03/2003	55	<0.50	1.3	<0.50	2.4	NA	2.6	180.63	3.38	177.25	NA
H-1	08/27/2003	<50	0.55	<0.50	<0.50	1.2	NA	2.8	180.63	4.10	176.53	NA
H-1	11/25/2003	77 a	9.7	<0.50	<0.50	<1.0	NA	21	180.63	3.72	176.91	NA
T-1	05/30/1997	NA	NA	NA	NA	NA	NA	NA	NA	2.65	NA	NA
T-1	08/21/1997	NA	NA	NA	NA	NA	NA	NA	NA	2.69	NA	NA
T-1	11/03/1997	NA	NA	NA	NA	NA	NA	NA	NA	3.09	NA	NA
T-1	01/20/1998	NA	NA	NA	NA	NA	NA	NA	NA	0.61	NA	NA
T-1	07/23/1998	NA	NA	NA	NA	NA	NA	NA	NA	2.32	NA	NA
T-1	02/16/1999	NA	NA	NA	NA	NA	NA	NA	NA	1.95	NA	NA
T-1	09/07/1999	NA	NA	NA	NA	NA	NA	NA	NA	2.48	NA	NA
T-1	02/02/2000	<50.0	<0.500	<0.500	<0.500	<0.500	<5.00	NA	NA	2.66	NA	2.5
T-1	04/26/2000	NA	NA	NA	NA	NA	NA	NA	NA	2.56	NA	NA
T-1	07/25/2000	NA	NA	NA	NA	NA	NA	NA	NA	2.60	NA	NA
T-1	11/15/2000	NA	NA	NA	NA	NA	NA	NA	NA	2.47	NA	NA
T-1	02/12/2001	NA	NA	NA	NA	NA	NA	NA	NA	1.20	NA	NA

WELL CONCENTRATIONS
Shell-branded Service Station
5755 Broadway
Oakland, CA

Well ID	Date	TPPH (ug/L)	B (ug/L)	T (ug/L)	E (ug/L)	X (ug/L)	MTBE 8020 (ug/L)	MTBE 8260 (ug/L)	TOC (MSL)	Depth to Water (ft)	GW Elevation (MSL)	DO Reading (ppm)
T-1	06/07/2001	NA	NA	NA	NA	NA	NA	NA	NA	2.36	NA	NA
T-1	08/31/2001	NA	NA	NA	NA	NA	NA	NA	NA	3.45	NA	NA
T-1	01/09/2002 c	NA	NA	NA	NA	NA	NA	NA	183.08	NA	NA	NA
T-2	05/30/1997	NA	NA	NA	NA	NA	NA	NA	NA	1.81	NA	NA
T-2	08/21/1997	NA	NA	NA	NA	NA	NA	NA	NA	1.89	NA	NA
T-2	11/03/1997	NA	NA	NA	NA	NA	NA	NA	NA	2.25	NA	NA
T-2	01/20/1998	NA	NA	NA	NA	NA	NA	NA	NA	0.55	NA	NA
T-2	07/23/1998	NA	NA	NA	NA	NA	NA	NA	NA	1.21	NA	NA
T-2	02/16/1999	NA	NA	NA	NA	NA	NA	NA	NA	1.08	NA	NA
T-2	09/07/1999	NA	NA	NA	NA	NA	NA	NA	NA	0.72	NA	NA
T-2	02/02/2000	1,540	53.4	20.8	11.4	21.8	1,330	NA	NA	0.98	NA	3.0
T-2	04/26/2000	NA	NA	NA	NA	NA	NA	NA	NA	1.02	NA	NA
T-2	07/25/2000	815	17.6	10.8	1.63	3.47	133	NA	NA	1.80	NA	0.8
T-2	11/15/2000	NA	NA	NA	NA	NA	NA	NA	NA	1.68	NA	NA
T-2	02/12/2001	310	7.48	7.76	0.693	2.28	301	NA	NA	1.45	NA	1.6
T-2	06/07/2001	NA	NA	NA	NA	NA	NA	NA	NA	1.57	NA	NA
T-2	08/31/2001	720	30	0.67	<0.50	2.3	NA	540	NA	2.69	NA	0.8
T-2	12/05/2001	NA	NA	NA	NA	NA	NA	NA	NA	0.58	NA	NA
T-2	01/31/2002	NA	NA	NA	NA	NA	NA	NA	NA	1.32	NA	NA
T-2	02/04/2002	1,000	41	30	4.6	20	NA	1,200	NA	1.46	NA	NA
T-2	06/04/2002	NA	NA	NA	NA	NA	NA	NA	NA	1.50	NA	NA
T-2	07/25/2002	660	11	0.59	<0.50	2.6	NA	97	NA	1.53	NA	NA
T-2	11/14/2002	NA	NA	NA	NA	NA	NA	NA	182.30	2.39	179.91	NA
T-2	01/30/2003	560	11	<0.50	<0.50	0.53	NA	160	182.30	1.01	181.29	NA
T-2	06/03/2003	NA	NA	NA	NA	NA	NA	NA	182.30	1.55	180.75	NA
T-2	08/27/2003	180 a	1.6	<0.50	<0.50	<1.0	NA	10	182.30	1.60	180.70	NA
T-2	11/25/2003	NA	NA	NA	NA	NA	NA	NA	182.30	1.64	180.66	NA

WELL CONCENTRATIONS
Shell-branded Service Station
5755 Broadway
Oakland, CA

Well ID	Date	TPPH (ug/L)	B (ug/L)	T (ug/L)	E (ug/L)	X (ug/L)	MTBE 8020 (ug/L)	MTBE 8260 (ug/L)	TOC (MSL)	Depth to Water (ft)	GW Elevation (MSL)	DO Reading (ppm)
---------	------	----------------	-------------	-------------	-------------	-------------	------------------------	------------------------	--------------	---------------------------	--------------------------	------------------------

T-3	05/30/1997	NA	NA	NA	NA	NA	NA	NA	NA	2.31	NA	NA
T-3	08/21/1997	NA	NA	NA	NA	NA	NA	NA	NA	1.57	NA	NA
T-3	11/03/1997	NA	NA	NA	NA	NA	NA	NA	NA	3.50	NA	NA
T-3	01/20/1998	NA	NA	NA	NA	NA	NA	NA	NA	0.76	NA	NA
T-3	07/23/1998	NA	NA	NA	NA	NA	NA	NA	NA	0.82	NA	NA
T-3	02/16/1999	NA	NA	NA	NA	NA	NA	NA	NA	0.55	NA	NA
T-3	09/07/1999	NA	NA	NA	NA	NA	NA	NA	NA	2.89	NA	NA
T-3	02/02/2000	<50.0	<0.500	<0.500	<0.500	<0.500	<5.00	NA	NA	3.02	NA	2.9
T-3	04/26/2000	NA	NA	NA	NA	NA	NA	NA	NA	2.81	NA	NA
T-3	07/25/2000	NA	NA	NA	NA	NA	NA	NA	NA	3.00	NA	NA
T-3	11/15/2000	NA	NA	NA	NA	NA	NA	NA	NA	1.70	NA	NA
T-3	02/12/2001	NA	NA	NA	NA	NA	NA	NA	NA	2.11	NA	NA
T-3	06/07/2001	NA	NA	NA	NA	NA	NA	NA	NA	1.68	NA	NA
T-3	08/31/2001	NA	NA	NA	NA	NA	NA	NA	NA	3.14	NA	NA
T-3	01/09/2002 c	NA	NA	NA	NA	NA	NA	NA	180.95	NA	NA	NA

WELL CONCENTRATIONS
Shell-branded Service Station
5755 Broadway
Oakland, CA

Well ID	Date	TPPH (ug/L)	B (ug/L)	T (ug/L)	E (ug/L)	X (ug/L)	MTBE 8020 (ug/L)	MTBE 8260 (ug/L)	TOC (MSL)	Depth to Water (ft)	GW Elevation (MSL)	DO Reading (ppm)
---------	------	----------------	-------------	-------------	-------------	-------------	------------------------	------------------------	--------------	---------------------------	--------------------------	------------------------

Abbreviations:

TPPH = Total petroleum hydrocarbons as gasoline by EPA Method 8260B; prior to June 7, 2001, analyzed by EPA Method 8015.

BTEX = Benzene, toluene, ethylbenzene, xylenes by EPA Method 8260B; prior to June 7, 2001, analyzed by EPA Method 8020.

MTBE = Methyl-tertiary-butyl ether

TOC = Top of Casing Elevaton

SPH = Separate-Phase Hydrocarbons

GW = Groundwater

DO = Dissolved Oxygen

ug/L = Parts per billion

ppm = Parts per million

MSL = Mean sea level

ft = Feet

<n = Below detection limit

D = Duplicate sample

NA = Not applicable

Notes:

a = Chromatogram pattern indicated an unidentified hydrocarbon/Hydrocarbon does not match pattern of laboratory's standard.

b = This sample analyzed outside of EPA recommended hold time.

c = Survey date only.

d = Sampled by client, Cambria Environmental.

Site surveyed January 9, 2002, by Virgil Chavez Land Surveying of Vallejo, California.

Cambria Environmental Emeryville

December 12, 2003

5900 Hollis Street, Ste. A
Emeryville, CA 94608

Attn.: Cynthia Vasko

Project#: 245-0483

Project: 98995756

Site: 5755 Broadway, Oakland

Dear Ms. Vasko:

Attached is our report for your samples received on 11/26/2003 15:15

This report has been reviewed and approved for release. Reproduction of this report is permitted only in its entirety.

Please note that any unused portion of the samples will be discarded after 01/10/2004 unless you have requested otherwise.

We appreciate the opportunity to be of service to you. If you have any questions, please call me at (925) 484-1919.

You can also contact me via email. My email address is: vvancil@stl-inc.com

Sincerely,

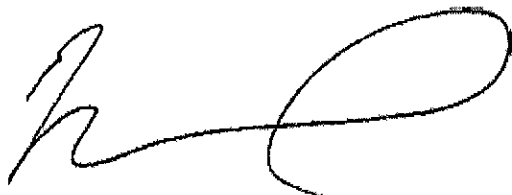

Vincent Vancil
Project Manager

Gas/BTEX/MTBE by 8260B (C6-C12)

Cambria Environmental Emeryville

Attn.: Cynthia Vasko

5900 Hollis Street, Ste. A

Emeryville, CA 94608

Phone: (510) 420-3344 Fax: (510) 420-9170

Project: 245-0483

98995756

Received: 11/26/2003 15:15

Site: 5755 Broadway, Oakland

Samples Reported

Sample Name	Date Sampled	Matrix	Lab #
S-2	11/25/2003 14:00	Water	1

Gas/BTEX/MTBE by 8260B (C6-C12)

Cambria Environmental Emeryville

Attn.: Cynthia Vasko

5900 Hollis Street, Ste. A
Emeryville, CA 94608
Phone: (510) 420-3344 Fax: (510) 420-9170

Project: 245-0483
98995756

Received: 11/26/2003 15:15

Site: 5755 Broadway, Oakland

Prep(s):	6030B	Test(s):	8260B
Sample ID:	S-2	Lab ID:	2003-11-0944 - 1
Sampled:	11/25/2003 14:00	Extracted:	12/4/2003 03:39
Matrix:	Water	QC Batch#:	2003/12/03-2B.66
Analysis Flag: 0 (See Legend and Note Section)			

Compound	Conc.	RL	Unit	Dilution	Analyzed	Flag
Gasoline	8400	5000	ug/L	100.00	12/04/2003 03:39	g
Benzene	ND	50	ug/L	100.00	12/04/2003 03:39	
Toluene	ND	50	ug/L	100.00	12/04/2003 03:39	
Ethylbenzene	ND	50	ug/L	100.00	12/04/2003 03:39	
Total xylenes	ND	100	ug/L	100.00	12/04/2003 03:39	
Methyl tert-butyl ether (MTBE)	4500	50	ug/L	100.00	12/04/2003 03:39	
Surrogate(s)						
1,2-Dichloroethane-d4	109.2	76-130	%	100.00	12/04/2003 03:39	
Toluene-d8	103.2	78-115	%	100.00	12/04/2003 03:39	

Gas/BTEX/MTBE by 8260B (C6-C12)

Cambria Environmental Emeryville

Attn.: Cynthia Vasko

5900 Hollis Street, Ste. A
Emeryville, CA 94608
Phone: (510) 420-3344 Fax: (510) 420-9170

Project: 245-0483
98995756

Received: 11/26/2003 15:15

Site: 5755 Broadway, Oakland

Batch QC Report

Prep(s): 5030B
Method Blank
MB: 2003/12/03-2B.66-039

Water

Test(s): 8260B
QC Batch # 2003/12/03-2B.66
Date Extracted: 12/03/2003 18:39

Compound	Conc.	RL	Unit	Analyzed	Flag
Gasoline	ND	50	ug/L	12/03/2003 18:39	
Methyl tert-butyl ether (MTBE)	ND	0.5	ug/L	12/03/2003 18:39	
Benzene	ND	0.5	ug/L	12/03/2003 18:39	
Toluene	ND	0.5	ug/L	12/03/2003 18:39	
Ethylbenzene	ND	0.5	ug/L	12/03/2003 18:39	
Total xylenes	ND	1.0	ug/L	12/03/2003 18:39	
Surrogates(s)					
1,2-Dichloroethane-d4	98.6	76-130	%	12/03/2003 18:39	
Toluene-d8	96.6	78-115	%	12/03/2003 18:39	

Gas/BTEX/MTBE by 8260B (C6-C12)

Cambria Environmental Emeryville
Attn.: Cynthia Vasko

5900 Hollis Street, Ste. A
Emeryville, CA 94608
Phone: (510) 420-3344 Fax: (510) 420-9170

Project: 245-0483
98995756

Received: 11/26/2003 15:15

Site: 5755 Broadway, Oakland

Batch QC Report			
Prep(s): 5030B			Test(s): 8260B
Laboratory Control Spike	Water	QC Batch # 2003/12/03-2B.66	
LCS 2003/12/03-2B.66-051	Extracted: 12/03/2003	Analyzed: 12/03/2003 17:51	
LCSD 2003/12/03-2B.66-015	Extracted: 12/03/2003	Analyzed: 12/03/2003 18:15	

Compound	Conc. ug/L		Exp. Conc.	Recovery %		RPD	Ctrl. Limits %		Flags	
	LCS	LCSD		LCS	LCSD		%	Rec.	RPD	LCS
Methyl tert-butyl ether (MTBE)	21.1	19.2	25	84.4	76.8	9.4	65-165	20		
Benzene	21.2	20.8	25	84.8	83.2	1.9	69-129	20		
Toluene	19.7	20.4	25	78.8	81.6	3.5	70-130	20		
Surrogates(s)										
1,2-Dichloroethane-d4	516	501	500	103.2	100.2		76-130			
Toluene-d8	470	484	500	94.0	96.8		78-115			

Gas/BTEX/MTBE by 8260B (C6-C12)

Cambria Environmental Emeryville

Attn.: Cynthia Vasko

5900 Hollis Street, Ste. A

Emeryville, CA 94608

Phone: (510) 420-3344 Fax: (510) 420-9170

Project: 245-0483

98995756

Received: 11/26/2003 15:15

Site: 5755 Broadway, Oakland

Legend and Notes

Analysis Flag

o

Reporting limits were raised due to high level of analyte present in the sample.

Result Flag

g

Hydrocarbon reported in the gasoline range does not match our gasoline standard.

STL-San Francisco

SHELL Chain Of Custody Record

80637

1220 Quarry Lane
Pleasanton, CA 94566

(925) 484-1918 (925) 484-1096 fax

Shell Project Manager to be Invoiced:

- SCIENCE & ENGINEERING
- TECHNICAL SERVICES
- CRMT/ROUSTON

KAREN PEIRYNA

2003-11-0944

INCIDENT NUMBER (S&E ONLY)

98995756

SAP or CRMT NUMBER (TS/CRMT)

DATE: 11/25/03

PAGE: 1 of 1

SAMPLING COMPANY: CAMBRIA ENVIRONMENTAL TECHNOLOGY INC

EDS CODE:

SITE ADDRESS (Route and City):

5765 BROADWAY, OAKLAND

GLOBAL ID NO:

T0600101270

ADDRESS: 5900 HOLLIS ST, Suite A, Emeryville, CA 94608

EDS DELIVERABLE TO (Responsible Party or Designator):

Anni Kreml

PHONE NO:

(510) 420-3335

EMAIL:

ShellOaklandEDF@cambria-env.com

CONSULTANT PROJECT NO:

245-0483

PROJECT CONTACT (Indicate by PDF Report to):

CYNTHIA VASKO

SAMPLER NAME(S) (Print):

D. VESICURE

TELEPHONE:

(510) 420-3344

FAX:

(510) 420-9170

EMAIL:

CVASKO@cambria-env.com

LAB USE ONLY

TURNAROUND TIME (BUSINESS DAYS):

10 DAYS 5 DAYS 72 HOURS 48 HOURS 24 HOURS LESS THAN 24 HOURS

REQUESTED ANALYSIS

LA - RWQCS REPORT FORMAT LIST AGENCY:

SCMS MTBE CONFIRMATION: HIGHEST _____ HIGHEST PER BORINGS _____ ALL _____

SPECIAL INSTRUCTIONS OR NOTES: CHECK BOX IF EDD IS NOT NEEDED

CC: LEON GEARHART @ BLAINE TECH

LGEARHART@BLAINETECH.COM

CC: ANNI KREML @ CAMBRIA ENVIRONMENTAL

AKREML@CAMBRIA-ENV.COM

FIELD NOTES:

Container/Preservative
or PID Readings
or Laboratory Notes:

3.0°C

TEMPERATURE ON RECEIPT, C°

Exp. Use Only

Field Sample Identification

SAMPLING

MATRIX

NO. OF CONT.

TPH - Purgeable

TPH - Extractable (8015m)

BTEX

MTBE

IPA

5 Drybenzites

1,2-DCA and EDB

Ethanol

Methanol

VOCs by 8260B

Semi-Volatiles by 8270C

Lead Total STC TSLA

LUFTS Total STC TSLA

CA/M17 Total STC TSLA

Test for Disposal

S-2

11/25

200

AWD

3

X

X

X

VOCs n/REL

Requested by (Signature)

[Signature]

Received by (Signature)

[Signature]

Date: 11/25/03

Time: 1:50 PM

Relinquished by (Signature)

[Signature]

Received by (Signature)

[Signature]

Date: 11/26/03

Time: 13:45

Relinquished by (Signature)

[Signature]

Received by (Signature)

[Signature]

Date: 11/24/03

Time: 15:15

Blaine Tech Services, Inc.

December 10, 2003

1680 Rogers Avenue
San Jose, CA 95112-1105
Attn.: Leon Gearhart
Project#: 031125-JP2
Project: 98995756
Site: 5755 Broadway, Oakland

Dear Mr. Gearhart,

Attached is our report for your samples received on 11/26/2003 17:43
This report has been reviewed and approved for release. Reproduction of this report
is permitted only in its entirety.

Please note that any unused portion of the samples will be discarded after
01/10/2004 unless you have requested otherwise.

We appreciate the opportunity to be of service to you. If you have any questions,
please call me at (925) 484-1919.

You can also contact me via email. My email address is: vvancil@stl-inc.com

Sincerely,



Vincent Vancil
Project Manager



STL

Submission #: 2003-11-0928

Gas/BTEX/MTBE by 8260B (C6-C12)

Blaine Tech Services, Inc.

Attn.: Leon Gearhart

1680 Rogers Avenue
San Jose, CA 95112-1105
Phone: (408) 573-0555 Fax: (408) 573-7771

Project: 031125-JP2
98995756

Received: 11/26/2003 17:43

Site: 5755 Broadway, Oakland

Samples Reported

Sample Name	Date Sampled	Matrix	Lab #
H-1	11/25/2003 15:10	Water	1

Gas/BTEX/MTBE by 8260B (C6-C12)

Blaine Tech Services, Inc.

Attn.: Leon Gearhart

1680 Rogers Avenue
San Jose, CA 95112-1105
Phone: (408) 573-0555 Fax: (408) 573-7771

Project: 031125-JP2
98995756

Received: 11/26/2003 17:43

Site: 5755 Broadway, Oakland

Prep(s):	5030B	Test(s):	8260B
Sample ID:	H-1	Lab ID:	2003-11-0928-1
Sampled:	11/25/2003 15:10	Extracted:	12/3/2003 15:55
Matrix:	Water	QC Batch#:	2003/12/03-1A.64

Compound	Conc.	RL	Unit	Dilution	Analyzed	Flag
Gasoline	77	50	ug/L	1.00	12/03/2003 15:55	g
Benzene	9.7	0.50	ug/L	1.00	12/03/2003 15:55	
Toluene	ND	0.50	ug/L	1.00	12/03/2003 15:55	
Ethylbenzene	ND	0.50	ug/L	1.00	12/03/2003 15:55	
Total xylenes	ND	1.0	ug/L	1.00	12/03/2003 15:55	
Methyl tert-butyl ether (MTBE)	21	0.50	ug/L	1.00	12/03/2003 15:55	
Surrogate(s)						
1,2-Dichloroethane-d4	96.3	76-130	%	1.00	12/03/2003 15:55	
Toluene-d8	93.9	78-115	%	1.00	12/03/2003 15:55	

Gas/BTEX/MTBE by 8260B (C6-C12)

Blaine Tech Services, Inc.

Attn.: Leon Gearhart

1680 Rogers Avenue
San Jose, CA 95112-1105
Phone: (408) 573-0555 Fax: (408) 573-7771

Project: 031125-JP2
98995756

Received: 11/26/2003 17:43

Site: 5755 Broadway, Oakland

Batch QC Report			
Prep(s): 5030B			Test(s): 8260B
Method Blank	Water		QC Batch # 2003/12/03-1A.64
MB: 2003/12/03-1A.64-008			Date Extracted: 12/03/2003 10:08

Compound	Conc.	RL	Unit	Analyzed	Flag
Gasoline	ND	50	ug/L	12/03/2003 10:08	
Methyl tert-butyl ether (MTBE)	ND	0.5	ug/L	12/03/2003 10:08	
Benzene	ND	0.5	ug/L	12/03/2003 10:08	
Toluene	ND	0.5	ug/L	12/03/2003 10:08	
Ethylbenzene	ND	0.5	ug/L	12/03/2003 10:08	
Total xylenes	ND	1 0	ug/L	12/03/2003 10:08	
Surrogates(s)					
1,2-Dichloroethane-d4	103.2	76-130	%	12/03/2003 10:08	
Toluene-d8	101.6	78-115	%	12/03/2003 10:08	

Gas/BTEX/MTBE by 8260B (C6-C12)

Blaine Tech Services, Inc.

Attn.: Leon Gearhart

1680 Rogers Avenue
San Jose, CA 95112-1105
Phone: (408) 573-0555 Fax: (408) 573-7771

Project: 031125-JP2
98995756

Received: 11/26/2003 17:43

Site: 5755 Broadway, Oakland

Batch QC Report

Prep(s): 5030B

Test(s): 8260B

Laboratory Control Spike

Water

QC Batch # 2003/12/03-1A.64

LCS 2003/12/03-1A.64-046

Extracted: 12/03/2003

Analyzed: 12/03/2003 09:23

LCSD 2003/12/03-1A.64-045

Extracted: 12/03/2003

Analyzed: 12/03/2003 09:45

Compound	Conc. ug/L		Exp. Conc.	Recovery %		RPD	Ctrl. Limits %		Flags	
	LCS	LCSD		LCS	LCSD		%	Rec.	RPD	LCS
Methyl tert-butyl ether (MTBE)	23.8	23.3	25	95.2	93.2	2.1	65-165	20		
Benzene	25.4	24.8	25	101.6	99.2	2.4	69-129	20		
Toluene	25.4	25.4	25	101.6	101.6	0.0	70-130	20		
Surrogates(s)										
1,2-Dichloroethane-d4	513	499	500	102.6	99.8		76-130			
Toluene-d8	501	502	500	100.2	100.4		78-115			

Severn Trent Laboratories, Inc.

STL San Francisco * 1220 Quarry Lane, Pleasanton, CA 94566

Tel 925 484 1919 Fax 925 484 1096 * www.stl-inc.com * CA DHS ELAP# 2496

12/06/2003 14:35

Gas/BTEX/MTBE by 8260B (C6-C12)

Blaine Tech Services, Inc.

Attn.: Leon Gearhart

1680 Rogers Avenue

San Jose, CA 95112-1105

Phone: (408) 573-0555 Fax: (408) 573-7771

Project: 031125-JP2
98995756

Received: 11/26/2003 17:43

Site: 5755 Broadway, Oakland

Legend and Notes

Result Flag

g

Hydrocarbon reported in the gasoline range does not match our gasoline standard.

Severn Trent Laboratories, Inc.

STL San Francisco * 1220 Quarry Lane, Pleasanton, CA 94566

Tel 925 484 1919 Fax 925 484 1096 * www.stl-inc.com * CA DHS ELAP# 2496

12/06/2003 14:35

LAB: STL

SHELL Chain Of Custody Record

80667

Lab Identification (if necessary):

Address

City, State, Zip

Shell Project Manager to be invoiced:

- SCIENCE & ENGINEERING
- TECHNICAL SERVICES
- CRMT HOUSTON

Karen Petryna

2003-11-0928

INCIDENT NUMBER (S&E ONLY):

9 8 9 9 5 7 5 6

SAP or CRMT NUMBER (TS/CRMT):

DATE: *11/25/03*

PAGE: *1* of *1*

SAMPLING COMPANY Blaine Tech Services		LOG CODE BTSS	SITE ADDRESS (Street and City): 5755 Broadway, Oakland		LOCAL ID NO. T0600101270
ADDRESS 1680 Rogers Avenue, San Jose, CA 95112		EDF DELIVERABLE TO (Responsible Party or Designee) Ann Kremi		PHONE NO. (510) 420-3335	E-MAIL ShellOaklandEDF@cambria-env.com
PROJECT CONTRACT (Handcopy of PCH Report Int) Leon Gearhart		CONSULTANT PROJECT NO. 03025-SP02		BTS #	
TELEPHONE 408-573-0555	FAX 408-573-7771	E-MAIL lgearhart@blainetech.com			LAB USE ONLY

Matthew Pynch

TURNAROUND TIME (BUSINESS DAYS):
 30 DAYS 5 DAYS 72 HOURS 48 HOURS 24 HOURS LESS THAN 24 HOURS

REQUESTED ANALYSIS

LA - RWQCB REPORT FORMAT LIST AGENCY: _____
 GC/MS/MTBE CONFIRMATION: HIGHEST _____ HIGHEST per BORING _____ ALL _____
 SPECIAL INSTRUCTIONS OR NOTES: CHECK BOX IF EDD IS NOT NEEDED.

TPH - Gas, Purgeable	BTEX	MTBE (8021B - 5ppb RL)	MTBE (8260B - 0.5ppb RL)	Oxygenates (5) by (8260B)	Ethanol (8260B)	Methanol	1,2-DCA (8260B)	EDB (8260B)	TPH - Diesel, Extractable (8015m)
----------------------	------	------------------------	--------------------------	---------------------------	-----------------	----------	-----------------	-------------	-----------------------------------

FIELD NOTES:
 Container/Preservative
 or PID Readings
 or Laboratory Notes
2.6

LAB USE ONLY	Field Sample Identification			MATRIX	NO. OF CONT.	TPH - Gas, Purgeable	BTEX	MTBE (8021B - 5ppb RL)	MTBE (8260B - 0.5ppb RL)	Oxygenates (5) by (8260B)	Ethanol (8260B)	Methanol	1,2-DCA (8260B)	EDB (8260B)	TPH - Diesel, Extractable (8015m)	TEMPERATURE ON RECEIPT, C*
	DATE	TIME														
	<i>H-1</i>	<i>11/25/03</i>	<i>1540</i>	<i>W</i>	<i>3</i>	<i>X</i>	<i>X</i>	<i>X</i>								

Released by: (Signature) <i>[Signature]</i>	Received by: (Signature) <i>[Signature]</i>	Date: <i>11/26/03</i>	Time: <i>1544</i>
Released by: (Signature) <i>[Signature]</i>	Received by: (Signature) <i>[Signature]</i>	Date: <i>11/26/03</i>	Time: <i>1743</i>

WELL GAUGING DATA

Project # 03/125-482 Date 11/25/03 Client Shell

Site 5755 Broadway, Oakland

Well ID	Well Size (in.)	Sheen / Odor	Depth to Immiscible Liquid (ft.)	Thickness of Immiscible Liquid (ft.)	Volume of Immiscibles Removed (ml)	Depth to water (ft.)	Depth to well bottom (ft.)	Survey Point: TOB or TOC		
S-1	3					3.28	11.68	TOC	GO	
S-2	4		no sample per client			---	9.63	↓		
S-3	4	0				2.85	9.71		GO	
H-1	4	0	*			3.72	12.04		no-purge	
T-2	12		no free product detected			1.64	13.02 16.12		↓	GO (Free Pro.)

* - Gauged w/ stringer in well

SHELL WELL MONITORING DATA SHEET

BTS #: 031125-JP2	Site: 5755 Broadway, Oakland
Sampler: M. Poyrch	Date: 11/25/03
Well I.D.: H-1	Well Diameter: 2 3 (4) 6 8
Total Well Depth (TD): 12.04	Depth to Water (DTW): 3.72
Depth to Free Product:	Thickness of Free Product (feet):
Referenced to: (PVC) Grade	D.O. Meter (if req'd): YSI HACH
DTW with 80% Recharge [(Height of Water Column x 0.20) + DTW]:	

Purge Method: Bailer Water Sampling Method: (Bailer)
 Disposable Bailer Peristaltic Disposable Bailer
 Positive Air Displacement Extraction Pump Extraction Port
 Electric Submersible Other _____ Dedicated Tubing

_____ (Gals.) X <u>no Purge</u> = _____ Gals. I Case Volume Specified Volumes Calculated Volume	<table border="1" style="width: 100%; border-collapse: collapse;"> <tr> <th>Well Diameter</th> <th>Multiplier</th> <th>Well Diameter</th> <th>Multiplier</th> </tr> <tr> <td>1"</td> <td>0.04</td> <td>4"</td> <td>0.65</td> </tr> <tr> <td>2"</td> <td>0.16</td> <td>6"</td> <td>1.47</td> </tr> <tr> <td>3"</td> <td>0.37</td> <td>Other</td> <td>radius² * 0.163</td> </tr> </table>	Well Diameter	Multiplier	Well Diameter	Multiplier	1"	0.04	4"	0.65	2"	0.16	6"	1.47	3"	0.37	Other	radius ² * 0.163
Well Diameter	Multiplier	Well Diameter	Multiplier														
1"	0.04	4"	0.65														
2"	0.16	6"	1.47														
3"	0.37	Other	radius ² * 0.163														

Time	Temp (°F)	pH	Cond. (mS or <u>µS</u>)	Turbidity (NTUs)	Gals. Removed	Observations
1510	67.3	7.0	751	18	—	clear

Did well dewater? Yes No Gallons actually evacuated: —

Sampling Date: 11/25/03 Sampling Time: 1510 Depth to Water: —

Sample I.D.: H-1 Laboratory: (STL) Other _____

Analyzed for: (TPH-G) (BTEX) (MTBE) TPH-D Other: _____

EB I.D. (if applicable): _____ @ _____ Time Duplicate I.D. (if applicable): _____

Analyzed for: TPH-G BTEX MTBE TPH-D Other: _____

D.O. (if req'd):	Pre-purge:	mg/L	Post-purge:	mg/L
O.R.P. (if req'd):	Pre-purge:	mV	Post-purge:	mV