



12023

Solving environment-related business problems worldwide

www.deltaenv.com

3164 Gold Camp Drive • Suite 200
Rancho Cordova, California 95670 USA

916.638.2085 800.477 7411
Fax 916.638.8385

August 18, 2005

Amir Gholami
Alameda County
Department of Environmental Health
1131 Harbor Bay Park Way
Alameda, CA 94502

Alameda County
AUG 24 2005
Environmental Health

Re: Case Number # 3580
Quarterly Groundwater Monitoring Report Second Quarter 2005
Former RPMS (E-Z Serve) Location 100877
525 West A Street
Hayward, California
Delta Project RPMS0-877

Dear Mr. Gholami:

Delta Environmental Consultants, Inc. is pleased to submit this Quarterly Groundwater Monitoring Report presenting groundwater monitoring results for the subject site. Recommendations for future work are also included.

If you have any questions regarding this report please contact me at (916) 638-2765.

Sincerely,

DELTA ENVIRONMENTAL CONSULTANTS, INC.

Jim Brownell

James R. Brownell
California Registered Geologist No. 5078

Enc: Quarterly Groundwater Monitoring Report

cc: Jack Ceccarelli, RPMS of CA
Vinod Bansal, Site Owner

**QUARTERLY GROUNDWATER MONITORING REPORT
SECOND QUARTER 2005**

Former RPMS (E-Z Serve) Location 100877
525 West A Street
Hayward, California

Case Number # 3580
Delta Project RPMS0-877

August 18, 2005

Prepared for:

Jack Ceccarelli
Restructure Petroleum Marketing Services of California
205 S. Hoover Boulevard, Suite 101
Tampa, Florida 33609-9905

Submitted to:

Amir Gholami
Alameda County
Department of Environmental Health
1131 Harbor Bay Park Way
Alameda, CA 94502



Prepared by:

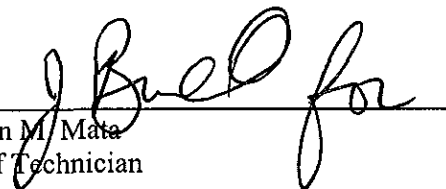

Jason M. Mata
Staff Technician

Reviewed by:

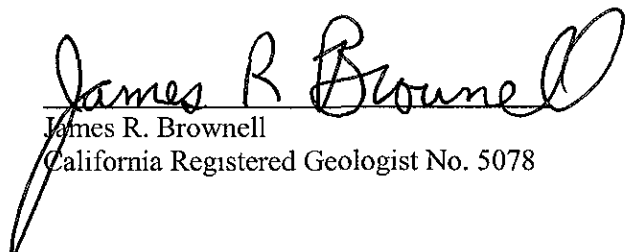

James R. Brownell
California Registered Geologist No. 5078



Delta Environmental Consultants, Inc.
3164 Gold Camp Drive, Suite 200, Rancho Cordova, California 95670
916 638 2765 1 800 477 7411

TABLE OF CONTENTS

1.0 INTRODUCTION.....1
1.1 Purpose.....1
1.2 Scope of Services1
1.3 Site Location.....1
2.0 GROUNDWATER MONITORING DATA.....2
2.1 Groundwater Gauging and Sampling2
2.2 Analytical Data.....2
3.0 CONCLUSIONS AND RECOMMENDATIONS4
3.1 Conclusions4
3.2 Recommendations4
4.0 REMARKS5

List of Tables

Table 1 Groundwater Data Summary

List of Figures

Figure 1 Site Location Map
Figure 2 Site Map
Figure 3 Groundwater Contour Map
Figure 4 Groundwater Analytical Data Map

List of Appendices

Appendix A Field Notes
Appendix B Groundwater Laboratory Analytical Data

Alameda County
AUG. 24 2005
Environmental Health

QUARTERLY GROUNDWATER MONITORING REPORT
SECOND QUARTER 2005

FORMER RPMS (E-Z SERVE) LOCATION 100877
525 WEST A STREET
HAYWARD, CALIFORNIA

1.0 INTRODUCTION

1.1 Purpose

The purpose of this Quarterly Groundwater Monitoring Report (QGMR) is to present the groundwater monitoring results completed by Delta Environmental Consultants, Inc. (Delta) at former RPMS (E-Z Serve) Location 100877 located at 525 West A Street in Hayward, California (Figures 1 and 2).

1.2 Scope of Services

The scope of services provided by Delta on the project consisted of the following:

- Gauged groundwater monitoring wells.
- Sampled groundwater monitoring wells.
- Analyzed groundwater samples for selected hydrocarbon constituents.
- Prepared this Quarterly Groundwater Monitoring Report.

1.3 Site Location

The site is a former E-Z Serve convenience store and retail gasoline station located at 525 West A Street in Hayward, California. The site is located in an area of commercial and residential properties.

2.0 GROUNDWATER MONITORING DATA

2.1 Groundwater Gauging and Sampling

On May 19, 2005, Delta personnel mobilized to the site to conduct groundwater monitoring activities. Prior to purging, the monitoring wells were gauged for liquid phase hydrocarbons (LPH) and depth to water utilizing an oil water interface probe. Groundwater ranged from 12.27 feet to 13.80 feet below top of casing. No LPH was detected in any of the monitoring wells during the May 19, 2005 gauging activities. Monitoring wells MW-8 and MW-13 were not gauged or sampled during the May 19, 2005 gauging event due to the inability to locate the monitoring wells. Depths to groundwater and groundwater elevations are presented in Table 1, Groundwater Analytical Data.

Prior to sampling, three well volumes were purged utilizing a submersible pump. After purging, wells were sampled utilizing disposable polyurethane bailers. The groundwater samples collected were decanted into properly labeled, laboratory prepared sample containers and placed on ice for storage prior to transporting to the laboratory. The samples were transported, under strict chain-of-custody protocols, to *Kiff Analytical LLC of Davis, California*, for analysis for benzene, toluene, ethyl-benzene, total xylenes (BTEX), total petroleum hydrocarbons (TPH) in the gasoline range, methyl tert butyl ether (MTBE), diisopropyl ether (DIPE), ethyl tert butyl ether (ETBE), tert-amyl methyl ether (TAME) and tert butyl alcohol (TBA) by EPA Method 8260B.

2.2 Analytical Data

Laboratory chemical analyses on the groundwater samples collected on during the first and second quarters of 2005 indicate that benzene concentrations have increased in monitoring wells MW-4, MW-6, and EX-1, and have decreased in monitoring wells MW-1, MW-1A, MW-2, MW-3, MW-5 and MW-7. Benzene concentrations ranged from below reporting limits to 610 µg/L in monitoring well MW-1. MTBE concentrations have remained below laboratory reporting limits in monitoring wells MW-1A, MW-3, MW-7, MW-12 and MW-14; meanwhile, MTBE concentrations have decreased in monitoring wells MW-1 and MW-3, and have increased in monitoring wells MW-1A, MW-2, MW-4, MW-5, MW-6 and EX-1. MTBE concentrations ranged from Below Reporting Limits (BRL) to 20 µg/L in monitoring well MW-1.

Quarterly Groundwater Monitoring Report

Former E-Z Serve Location 100877

525 West A Street

Hayward, California

Delta Project No. RPMS0-877

Page 3

The analytical data for the May 19, 2005 sampling event are presented in Table 1, Groundwater Analytical Data. Field sampling information sheets are presented in Appendix A. Laboratory analytical results, chain-of-custody documentation and graphs are presented in Appendix B.

3.0 CONCLUSIONS AND RECOMMENDATIONS

3.1 Conclusions

Groundwater table elevation data were used to approximate the flow direction and gradient across the site on May 19, 2005 by contouring. Based on the contours presented on Figure 3 – Groundwater Contour Map, the flow direction was toward the west-northwest at a hydraulic gradient of approximately 0.006.

Figure 4 – Groundwater Analytical Data Map, presents the concentration data for benzene, MTBE, and TPH in the gasoline range for each monitoring well sampled this quarter. Concentrations of benzene and MTBE have changed only slightly from the previous quarter. Reported analytical data for the groundwater samples collected on May 19, 2005 indicate that benzene concentrations have increased in two of the ten monitoring wells sampled. Reported MTBE concentrations have increased in four monitoring wells. The three upgradient monitoring wells have remained below laboratory reporting limits.

3.2 Recommendations

Delta recommends continued quarterly groundwater monitoring and sampling. Delta also recommends attempting to locate well heads of monitoring wells MW-8 through MW-11.

4.0 REMARKS

The recommendations contained in this report represent Delta's professional opinions based upon the currently available information and are arrived at in accordance with currently acceptable professional standards. This report is based upon a specific scope of work requested by the client. The Contract between Delta and its client outlines the scope of work, and only those tasks specifically authorized by that contract or outlined in this report were performed. This report is intended only for the use of Delta's Client and anyone else specifically listed on this report. Delta will not and cannot be liable for unauthorized reliance by any other third party. Other than as contained in this paragraph, Delta makes no express or implied warranty as to the contents of this report.

This report was prepared by **DELTA ENVIRONMENTAL CONSULTANTS, INC.**

If you have any questions, please call Jim Brownell at (916) 638-2765.

Table 1
Groundwater Analytical Data
Former EZ Serve Location #100877
Delta Project No. RPMS-877-A

Well	Sample Collection Date	Casing Elevation (msl)	Depth to Water (feet)	Depth to Product (feet)	Water Table Elevation (msl)	TPHg (µg/L)	Benzene (µg/L)	Toluene (µg/L)	Ethyl-benzene (µg/L)	Total Xylenes (µg/L)	MTBE (µg/L)	DIPE (µg/L)	ETBE (µg/L)	TBA (µg/L)	TAME (µg/L)
MW-1	2/5/1992	41.75	20.82	0.00	20.93	46000	7600	2300	2400	6500	--	--	--	--	--
MW-1	9/11/1992	41.75	20.08	0.00	21.67	48000	9000	1200	1800	4600	--	--	--	--	--
MW-1	12/22/1992	41.75	19.79	0.00	21.96	84000	22000	1600	4800	17000	--	--	--	--	--
MW-1	3/3/1993	41.75	16.23	0.00	25.52	54000	16000	1600	1900	4300	--	--	--	--	--
MW-1	6/23/1993	41.75	16.86	0.00	24.89	30000	18000	1100	1400	3700	--	--	--	--	--
MW-1	9/30/1993	41.75	18.04	0.00	23.71	33000	10000	440	940	1700	--	--	--	--	--
MW-1	2/6/1994	41.75	18.15	0.00	23.60	64000	18000	1600	4700	12000	--	--	--	--	--
MW-1	5/2/1994	41.75	17.26	0.00	24.49	7200	2100	29	490	520	--	--	--	--	--
MW-1	7/1/1994	41.75	17.60	0.00	24.15	13000	3700	150	550	12000	--	--	--	--	--
MW-1	9/20/1994	41.75	20.59	0.00	21.16	10000	3100	75	440	870	--	--	--	--	--
MW-1	12/5/1994	41.75	17.83	0.00	23.92	8700	3700	87	520	950	--	--	--	--	--
MW-1	3/10/1995	41.75	14.67	0.00	27.08	--	--	--	--	--	--	--	--	--	--
MW-1	3/15/1995	41.75	14.43	0.00	27.32	290	56	2	12	47	--	--	--	--	--
MW-1	9/23/1996	41.75	14.92	0.00	26.83	20000	5200	860	700	1100	270	--	--	--	--
MW-1	12/4/1996	41.75	15.61	0.00	26.14	17000	3100	64	610	1200	280	--	--	--	--
MW-1	4/8/1997	41.75	13.25	0.00	28.50	2100	430	15	52	85	100	--	--	--	--
MW-1	6/30/1997	41.75	14.68	0.00	27.07	10000	2100	<	<	320	<	--	--	--	--
MW-1	11/25/1997	41.75	15.99	0.00	25.76	16000	2100	23	76	240	<	--	--	--	--
MW-1	6/1/1998	41.75	9.98	0.00	31.77	19000	6100	430	1100	2300	420	--	--	--	--
MW-1	6/14/2001	41.75	15.05	0.00	26.70	6000	380	8	260	180	<25	--	--	--	--
MW-1	11/7/2001	41.75	16.31	0.00	25.44	12000	1000	30	1000	740	11	<5.0	<5.0	<50	<5.0
MW-1	1/30/2002	41.75	14.15	0.00	27.60	8800	690	16	480	270	14	<5.0	<5.0	<50	<5.0
MW-1	5/29/2002	41.75	14.55	0.00	27.20	6400	330	13	250	260	12	3	<2.0	<20	<2.0
MW-1	8/14/2002	41.75	15.56	0.00	26.19	5500	470	14	360	160	10	<10	<10	<100	<10
MW-1	11/15/2002	41.75	16.10	0.00	25.65	10000	440	16	310	150	15	<10	<10	<100	<10
MW-1	10/25/2004	41.75	15.99	0.00	25.76	4300	260	3	150	32	14	<0.90	<0.90	6	<0.90
MW-1	12/23/2004	41.75	15.64	0.00	26.11	11000	860	6	880	280	16	<0.90	<0.90	11	<0.90
MW-1	2/25/2005	41.75	12.79	0.00	28.96	11000	710	7	720	330	24	<1.5	<1.5	11	<1.5
MW-1	5/19/2005	41.75	12.27	0.00	29.48	7500	610	12	370	140	20	<1.5	<1.5	11	<1.5

Table 1
Groundwater Analytical Data
Former EZ Serve Location #100877
Delta Project No. RPMS-877-A

Well	Sample Collection Date	Casing Elevation (msl)	Depth to Water (feet)	Depth to Product (feet)	Water Table Elevation (msl)	TPHg (µg/L)	Benzene (µg/L)	Toluene (µg/L)	Ethyl- benzene (µg/L)	Total Xylenes (µg/L)	MTBE (µg/L)	DIPE (µg/L)	ETBE (µg/L)	TBA (µg/L)	TAME (µg/L)
------	----------------------------------	----------------------------------	---------------------------------	-----------------------------------	--	--------------------	-----------------------	-----------------------	---------------------------------	--------------------------------	--------------------	--------------------	--------------------	-------------------	--------------------

Table 1
Groundwater Analytical Data
Former EZ Serve Location #100877
Delta Project No. RPMS-877-A

Well	Sample Collection Date	Casing Elevation (msl)	Depth to Water (feet)	Depth to Product (feet)	Water Table Elevation (msl)	TPHg (µg/L)	Benzene (µg/L)	Toluene (µg/L)	Ethyl-benzene (µg/L)	Total Xylenes (µg/L)	MTBE (µg/L)	DIPE (µg/L)	ETBE (µg/L)	TBA (µg/L)	TAME (µg/L)
MW-1A	6/23/1993	43.40	17.80	17.59	25.75	--	--	--	--	--	--	--	--	--	--
MW-1A	9/30/1993	43.40	--	--	--	--	--	--	--	--	--	--	--	--	--
MW-1A	2/6/1994	43.40	18.89	0.00	24.51	8900	1700	42	1000	400	--	--	--	--	--
MW-1A	5/2/1994	43.40	18.35	0.09	25.05	--	--	--	--	--	--	--	--	--	--
MW-1A	7/1/1994	43.40	18.45	0.00	24.95	12000	1100	<1	920	1100	--	--	--	--	--
MW-1A	9/20/1994	43.40	21.72	21.50	21.84	--	--	--	--	--	--	--	--	--	--
MW-1A	12/5/1994	43.40	18.87	18.80	24.58	--	--	--	--	--	--	--	--	--	--
MW-1A	3/10/1995	43.40	15.83	0.00	27.57	--	--	--	--	--	--	--	--	--	--
MW-1A	3/15/1995	43.40	15.55	15.50	27.89	--	--	--	--	--	--	--	--	--	--
MW-1A	9/23/1996	43.40	16.00	15.99	27.41	--	--	--	--	--	--	--	--	--	--
MW-1A	12/4/1996	43.40	16.55	0.00	26.85	52000	420	140	1000	3500	130	--	--	--	--
MW-1A	4/8/1997	43.40	14.15	SHEEN	29.25	--	--	--	--	--	--	--	--	--	--
MW-1A	6/30/1997	43.40	15.57	0.00	27.83	17000	180	<	140	1100	<	--	--	--	--
MW-1A	11/25/1997	43.40	16.91	0.00	26.49	19000	110	37	290	910	<	--	--	--	--
MW-1A	6/1/1998	43.40	10.78	0.00	32.62	18000	200	17	230	820	91	--	--	--	--
MW-1A	6/14/2001	43.40	15.93	15.92	27.48	27000	29	<5.0	620	520	<50	--	--	--	--
MW-1A	11/7/2001	43.40	17.32	0.00	26.08	21000	51	<5.0	700	510	<5.0	<5.0	<5.0	<50	<5.0
MW-1A	1/30/2002	43.40	15.05	0.00	28.35	24000	22	<5.0	390	330	<5.0	<5.0	<5.0	<50	<5.0
MW-1A	5/29/2002	43.40	15.49	0.00	27.91	12000	32	<5.0	550	270	<5.0	<5.0	<5.0	<50	<5.0
MW-1A	8/14/2002	43.40	16.50	0.00	26.90	14000	22	<2.0	510	240	<2.0	<2.0	<2.0	<20	<2.0
MW-1A	11/15/2002	43.40	17.04	0.00	26.36	17000	59	2	630	250	<2.0	<2.0	<2.0	<20	<2.0
MW-1A	10/25/2004	43.40	16.90	0.00	26.50	2200	1	<0.50	58	4	<0.50	<0.50	<0.50	<5.0	<0.50
MW-1A	12/23/2004	43.40	16.60	0.00	26.80	3100	2	<0.50	96	5	<0.50	<0.50	<0.50	<5.0	<0.50
MW-1A	2/25/2005	43.40	13.75	0.00	29.65	7300	4.7	1.1	140	24	<0.50	<0.50	<0.50	<5.0	<0.50
MW-1A	5/19/2005	43.40	13.12	0.00	30.28	13000	3.1	1.7	190	50	<1.5	<1.5	<1.5	<7.0	<1.5

Table 1
Groundwater Analytical Data
Former EZ Serve Location #100877
Delta Project No. RPMS-877-A

Well	Sample Collection Date	Casing Elevation (msl)	Depth to Water (feet)	Depth to Product (feet)	Water Table Elevation (msl)	TPHg (µg/L)	Benzene (µg/L)	Toluene (µg/L)	Ethyl-benzene (µg/L)	Total Xylenes (µg/L)	MTBE (µg/L)	DIPE (µg/L)	ETBE (µg/L)	TBA (µg/L)	TAME (µg/L)
MW-2	2/5/1992	43.26	22.35	0.00	20.91	67000	13000	4700	820	1300	--	--	--	--	--
MW-2	9/11/1992	43.26	21.67	0.00	21.59	57000	9000	1400	1200	8400	--	--	--	--	--
MW-2	12/22/1992	43.26	21.39	0.00	21.87	31000	9900	350	2000	4100	--	--	--	--	--
MW-2	3/3/1993	43.26	17.75	0.00	25.51	17000	5100	1300	720	1900	--	--	--	--	--
MW-2	6/23/1993	43.26	18.42	0.00	24.84	60000	23000	1500	4500	17000	--	--	--	--	--
MW-2	9/30/1993	43.26	19.63	0.00	23.63	38000	12000	780	1500	6500	--	--	--	--	--
MW-2	2/6/1994	43.26	19.61	0.00	23.65	34000	8900	450	2000	5500	--	--	--	--	--
MW-2	5/2/1994	43.26	19.84	0.00	23.42	18000	3800	260	1100	3500	--	--	--	--	--
MW-2	7/1/1994	43.26	19.18	0.00	24.08	18000	3700	510	870	2600	--	--	--	--	--
MW-2	9/20/1994	43.26	22.17	0.00	21.09	19000	4500	300	1200	4000	--	--	--	--	--
MW-2	12/6/1994	43.26	19.37	0.00	23.89	22000	4700	340	1400	4500	--	--	--	--	--
MW-2	3/10/1995	43.26	16.33	0.00	26.93	--	--	--	--	--	--	--	--	--	--
MW-2	3/15/1995	43.26	16.89	0.00	26.37	29000	5600	350	1900	6300	--	--	--	--	--
MW-2	9/23/1996	43.26	16.61	0.00	26.65	29000	3700	150	1000	4300	860	--	--	--	--
MW-2	12/4/1996	43.26	17.19	0.00	26.07	31000	3800	140	2000	5100	690	--	--	--	--
MW-2	4/8/1997	43.26	14.86	0.00	28.40	20000	2500	80	1300	3400	880	--	--	--	--
MW-2	6/30/1997	43.26	16.28	0.00	26.98	41000	2700	130	1200	4000	890	--	--	--	--
MW-2	11/25/1997	43.26	17.56	0.00	25.70	51000	2900	140	1800	7000	1200	--	--	--	--
MW-2	6/1/1998	43.26	11.58	0.00	31.68	33000	2700	130	1800	5700	610	--	--	--	--
MW-2	6/14/2001	43.26	16.63	0.00	26.63	18000	860	14	1100	2200	<100	--	--	--	--
MW-2	11/7/2001	43.26	17.85	0.00	25.41	20000	880	20	1100	2600	21	<5.0	<5.0	<50	<5.0
MW-2	1/30/2002	43.26	15.65	0.00	27.61	19000	880	19	1100	2400	56	<5.0	<5.0	<50	<5.0
MW-2	5/29/2002	43.26	16.12	0.00	27.14	8100	390	16	560	1400	32	<5.0	<5.0	<50	<5.0
MW-2	8/14/2002	43.26	17.20	0.00	26.06	19000	820	21	1200	2600	29	<20	<20	<200	<20
MW-2	11/15/2002	43.26	17.63	0.00	25.63	34000	910	31	1000	1400	39	<20	<20	<200	<20
MW-2	10/25/2004	43.26	17.53	0.00	25.73	9300	280	4	500	980	8	<2.0	<2.0	<9.0	<2.0
MW-2	12/23/2004	43.26	17.15	0.00	26.11	10000	310	4	470	840	10	<2.0	<2.0	<9.0	<2.0
MW-2	2/25/2005	43.26	14.30	0.00	28.96	15000	320	4.8	860	1600	7.7	<2.0	<2.0	<9.0	<2.0
MW-2	5/19/2005	43.26	13.81	0.00	29.45	15000	300	3.6	770	1200	9.2	<2.5	<2.5	<15	<2.5

Table 1
Groundwater Analytical Data
Former EZ Serve Location #100877
Delta Project No. RPMS-877-A

Well	Sample Collection Date	Casing Elevation (msl)	Depth to Water (feet)	Depth to Product (feet)	Water Table Elevation (msl)	TPHg (µg/L)	Benzene (µg/L)	Toluene (µg/L)	Ethyl- benzene (µg/L)	Total Xylenes (µg/L)	MTBE (µg/L)	DIPE (µg/L)	ETBE (µg/L)	TBA (µg/L)	TAME (µg/L)
------	------------------------------	------------------------------	-----------------------------	-------------------------------	--------------------------------------	----------------	-------------------	-------------------	-----------------------------	----------------------------	----------------	----------------	----------------	---------------	----------------

Table 1
Groundwater Analytical Data
Former EZ Serve Location #100877
Delta Project No. RPMS-877-A

Well	Sample Collection Date	Casing Elevation (msl)	Depth to Water (feet)	Depth to Product (feet)	Water Table Elevation (msl)	TPHg (µg/L)	Benzene (µg/L)	Toluene (µg/L)	Ethyl-benzene (µg/L)	Total Xylenes (µg/L)	MTBE (µg/L)	DIPE (µg/L)	ETBE (µg/L)	TBA (µg/L)	TAME (µg/L)
MW-3	2/5/1992	43.89	21.85	0.00	22.04	16000	2700	410	<1	3400	--	--	--	--	--
MW-3	9/11/1992	43.89	21.13	0.00	22.76	43000	7600	1600	1400	4100	--	--	--	--	--
MW-3	12/22/1992	43.89	20.88	0.00	23.01	29000	8800	1200	1500	3700	--	--	--	--	--
MW-3	3/3/1993	43.89	17.29	0.00	26.60	17000	5000	1500	680	1700	--	--	--	--	--
MW-3	6/23/1993	43.89	17.88	0.00	26.01	5700	3000	120	560	790	--	--	--	--	--
MW-3	9/30/1993	43.89	19.18	0.00	24.71	21000	7000	2100	970	2600	--	--	--	--	--
MW-3	2/6/1994	43.89	19.21	0.00	24.68	24000	7200	1600	990	3200	--	--	--	--	--
MW-3	5/2/1994	43.89	18.30	0.00	25.59	10000	2200	440	470	1200	--	--	--	--	--
MW-3	7/1/1994	43.89	18.63	0.00	25.26	8200	2000	370	350	930	--	--	--	--	--
MW-3	9/20/1994	43.89	21.64	0.00	22.25	7200	2000	360	380	1000	--	--	--	--	--
MW-3	12/6/1994	43.89	19.15	0.00	24.74	9000	2300	400	440	1100	--	--	--	--	--
MW-3	3/10/1995	43.89	16.33	0.00	27.56	--	--	--	--	--	--	--	--	--	--
MW-3	3/15/1995	43.89	16.89	0.00	27.00	4300	980	47	370	780	--	--	--	--	--
MW-3	9/23/1996	43.89	16.11	0.00	27.78	10000	950	20	700	780	80	--	--	--	--
MW-3	12/4/1996	43.89	16.63	0.00	27.26	13000	1100	25	1000	1100	67	--	--	--	--
MW-3	4/8/1997	43.89	14.25	0.00	29.64	3800	210	5	270	280	56	--	--	--	--
MW-3	6/30/1997	43.89	15.70	0.00	28.19	3500	280	<	32	180	<	--	--	--	--
MW-3	11/25/1997	43.89	16.99	0.00	26.90	6800	230	<	370	290	130	--	--	--	--
MW-3	6/1/1998	43.89	--	--	--	--	--	--	--	--	--	--	--	--	--
MW-3	6/14/2001	43.89	16.02	0.00	27.87	2100	9	<0.5	78	43	<5.0	--	--	--	--
MW-3	11/7/2001	43.89	17.33	0.00	26.56	7700	75	<5.0	410	150	<5.0	<5.0	<5.0	<5.0	<5.0
MW-3	1/30/2002	43.89	15.10	0.00	28.79	3600	27	<5.0	120	34	<5.0	<5.0	<5.0	<5.0	<5.0
MW-3	5/29/2002	43.89	15.63	0.00	28.26	2000	18	<5.0	53	13	<5.0	<5.0	<5.0	<5.0	<5.0
MW-3	8/14/2002	43.89	16.63	0.00	27.26	2400	19	<0.5	50	7	<0.5	<0.5	<0.5	<5.0	<0.5
MW-3	11/15/2002	43.89	17.10	0.00	26.79	4300	8	<0.5	22	1	1	<0.5	<0.5	<5.0	<0.5
MW-3	10/25/2004	43.89	17.01	0.00	26.88	460	1	<0.50	10	2	<0.50	<0.50	<0.50	<5.0	<0.50
MW-3	12/20/2004	43.89	16.64	0.00	27.25	5400	9	<0.50	280	74	<0.50	<0.50	<0.50	<5.0	<0.50
MW-3	2/25/2005	43.89	13.68	0.00	30.21	90	1.1	<0.50	0.70	1.3	1.4	<0.50	<0.50	<5.0	<0.50
MW-3	5/19/2005	43.89	13.11	0.00	30.78	<50	<0.50	<0.50	<0.50	<0.50	<0.50	<0.50	<0.50	<5.0	<0.50

Table 1
Groundwater Analytical Data
Former EZ Serve Location #100877
Delta Project No. RPMS-877-A

Well	Sample Collection Date	Casing Elevation (msl)	Depth to Water (feet)	Depth to Product (feet)	Water Table Elevation (msl)	TPHg (µg/L)	Benzene (µg/L)	Toluene (µg/L)	Ethyl- benzene (µg/L)	Total Xylenes (µg/L)	MTBE (µg/L)	DIPE (µg/L)	ETBE (µg/L)	TBA (µg/L)	TAME (µg/L)
------	----------------------------------	----------------------------------	---------------------------------	-----------------------------------	--	--------------------	-----------------------	-----------------------	---------------------------------	--------------------------------	--------------------	--------------------	--------------------	-------------------	--------------------

Table 1
Groundwater Analytical Data
Former EZ Serve Location #100877
Delta Project No. RPMS-877-A

Well	Sample Collection Date	Casing Elevation (msl)	Depth to Water (feet)	Depth to Product (feet)	Water Table Elevation (msl)	TPHg (µg/L)	Benzene (µg/L)	Toluene (µg/L)	Ethyl-benzene (µg/L)	Total Xylenes (µg/L)	MTBE (µg/L)	DIPE (µg/L)	ETBE (µg/L)	TBA (µg/L)	TAME (µg/L)
MW-4	2/5/1992	42.76	21.31	0.00	21.45	16000	2700	410	<1	3400	--	--	--	--	--
MW-4	9/11/1992	42.76	20.62	0.00	22.14	43000	7600	1600	1400	4100	--	--	--	--	--
MW-4	12/22/1992	42.76	20.37	0.00	22.39	29000	8800	1200	1500	3700	--	--	--	--	--
MW-4	3/3/1993	42.76	16.78	0.00	25.98	17000	5000	1500	680	1700	--	--	--	--	--
MW-4	6/23/1993	42.76	17.45	0.00	25.31	5700	3000	120	560	790	--	--	--	--	--
MW-4	9/30/1993	42.76	18.64	0.00	24.12	21000	7000	2100	970	2600	--	--	--	--	--
MW-4	2/6/1994	42.76	18.59	0.00	24.17	24000	7200	1600	990	3200	--	--	--	--	--
MW-4	5/2/1994	42.76	17.81	0.00	24.95	10000	2200	440	470	1200	--	--	--	--	--
MW-4	7/1/1994	42.76	18.13	0.00	24.63	8200	2000	370	350	930	--	--	--	--	--
MW-4	9/20/1994	42.76	21.13	0.00	21.63	7200	2000	360	380	1000	--	--	--	--	--
MW-4	12/6/1994	42.76	18.36	0.00	24.40	9000	2300	400	440	1100	--	--	--	--	--
MW-4	3/10/1995	42.76	15.25	0.00	27.51	--	--	--	--	--	--	--	--	--	--
MW-4	3/15/1995	42.76	14.89	0.00	27.87	15000	4400	600	770	2660	--	--	--	--	--
MW-4	9/23/1996	42.76	15.56	0.00	27.20	32000	7400	540	1500	2800	2100	--	--	--	--
MW-4	12/4/1996	42.76	16.11	0.00	26.65	23000	7800	140	1200	1200	1900	--	--	--	--
MW-4	4/8/1997	42.76	13.73	0.00	29.03	16000	3900	680	850	2300	980	--	--	--	--
MW-4	6/30/1997	42.76	15.19	0.00	27.57	63000	7000	430	1400	4400	1700	--	--	--	--
MW-4	11/25/1997	42.76	16.49	0.00	26.27	30000	4300	61	810	1500	880	--	--	--	--
MW-4	6/1/1998	42.76	10.42	0.00	32.34	33000	5700	710	1700	2900	720	--	--	--	--
MW-4	6/14/2001	42.76	15.55	0.00	27.21	9500	690	45	560	600	<50	--	--	--	--
MW-4	11/7/2001	42.76	16.81	0.00	25.95	6000	710	20	630	190	27	<5.0	<5.0	<50	<5.0
MW-4	1/30/2002	42.76	14.60	0.00	28.16	4800	830	16	600	61	42	<5.0	<5.0	<50	<5.0
MW-4	5/29/2002	42.76	15.14	0.00	27.62	5300	720	57	600	200	35	<20	<20	<200	<20
MW-4	8/14/2002	42.76	16.07	0.00	26.69	5000	640	15	550	35	28	<2.0	<2.0	<20	<2.0
MW-4	11/15/2002	42.76	16.61	0.00	26.15	3700	330	10	260	200	20	<2.0	<2.0	<20	<2.0
MW-4	10/25/2004	42.76	16.50	0.00	26.26	4000	180	15	200	190	4	<0.50	<0.50	<5.0	<0.50
MW-4	12/23/2004	42.76	16.20	0.00	26.56	7400	280	24	340	340	8	<0.90	<0.90	<5.0	<0.90
MW-4	2/25/2005	42.76	13.30	0.00	29.46	4200	160	15	280	420	6	<0.90	<0.90	<5.0	<0.90
MW-4	5/19/2005	42.76	12.74	0.00	30.02	15000	480	76	1100	1600	14	<4.0	<4.0	<20	<4.0

Table 1
Groundwater Analytical Data
Former EZ Serve Location #100877
Delta Project No. RPMS-877-A

Well	Sample Collection Date	Casing Elevation (msl)	Depth to Water (feet)	Depth to Product (feet)	Water Table Elevation (msl)	TPHg (µg/L)	Benzene (µg/L)	Toluene (µg/L)	Ethyl- benzene (µg/L)	Total Xylenes (µg/L)	MTBE (µg/L)	DIPE (µg/L)	ETBE (µg/L)	TBA (µg/L)	TAME (µg/L)
------	----------------------------------	----------------------------------	---------------------------------	-----------------------------------	--	--------------------	-----------------------	-----------------------	---------------------------------	--------------------------------	--------------------	--------------------	--------------------	-------------------	--------------------

Table 1
Groundwater Analytical Data
Former EZ Serve Location #100877
Delta Project No. RPMS-877-A

Well	Sample Collection Date	Casing Elevation (msl)	Depth to Water (feet)	Depth to Product (feet)	Water Table Elevation (msl)	TPHg (µg/L)	Benzene (µg/L)	Toluene (µg/L)	Ethyl-benzene (µg/L)	Total Xylenes (µg/L)	MTBE (µg/L)	DIPE (µg/L)	ETBE (µg/L)	TBA (µg/L)	TAME (µg/L)
MW-5	2/5/1992	42.10	20.93	0.00	21.17	78000	7900	5000	2900	1800	--	--	--	--	--
MW-5	9/11/1992	42.10	20.27	0.00	21.83	49000	4700	400	1400	4100	--	--	--	--	--
MW-5	12/22/1992	42.10	19.99	0.00	22.11	34000	8600	340	2200	4800	--	--	--	--	--
MW-5	3/3/1993	42.10	16.49	0.00	25.61	22000	7500	640	1300	3400	--	--	--	--	--
MW-5	6/23/1993	42.10	17.02	0.00	25.08	15000	5800	120	1100	2100	--	--	--	--	--
MW-5	9/30/1993	42.10	18.25	0.00	23.85	25000	7600	410	1000	4400	--	--	--	--	--
MW-5	2/6/1994	42.10	18.26	0.00	23.84	23000	6000	180	2000	5900	--	--	--	--	--
MW-5	5/2/1994	42.10	17.50	0.00	24.60	8000	1300	29	440	770	--	--	--	--	--
MW-5	7/1/1994	42.10	17.79	0.00	24.31	10000	1700	97	600	1400	--	--	--	--	--
MW-5	9/20/1994	42.10	20.77	0.00	21.33	8400	1600	54	650	1400	--	--	--	--	--
MW-5	12/5/1994	42.10	18.02	0.00	24.08	10000	1800	<50	620	1400	--	--	--	--	--
MW-5	3/10/1995	42.10	14.93	0.00	27.17	--	--	--	--	--	--	--	--	--	--
MW-5	3/15/1995	42.10	14.70	0.00	27.40	5300	1100	11	180	320	--	--	--	--	--
MW-5	9/23/1996	42.10	15.19	0.00	26.91	9800	1800	11	470	510	100	--	--	--	--
MW-5	12/4/1996	42.10	15.78	0.00	26.32	10000	2200	9	550	430	70	--	--	--	--
MW-5	4/8/1997	42.10	13.39	0.00	28.71	11000	1300	15	450	720	180	--	--	--	--
MW-5	6/30/1997	42.10	14.83	0.00	27.27	3800	500	<	75	84	<	--	--	--	--
MW-5	11/25/1997	42.10	16.14	0.00	25.96	8200	1300	14	310	220	<	--	--	--	--
MW-5	6/1/1998	42.10	10.10	0.00	32.00	3600	290	12	52	52	81	--	--	--	--
MW-5	6/14/2001	42.10	15.19	0.00	26.91	5100	44	1	110	23	<5.0	--	--	--	--
MW-5	11/7/2001	42.10	16.47	0.00	25.63	7600	220	<5.0	550	30	<5.0	<5.0	<5.0	<50	<5.0
MW-5	1/30/2002	42.10	14.27	0.00	27.83	6200	180	<20	310	130	<20	<20	<20	<200	<20
MW-5	5/29/2002	42.10	14.73	0.00	27.37	3900	66	1	110	7	1	2	<0.5	<5.0	<0.5
MW-5	8/14/2002	42.10	15.73	0.00	26.37	4300	80	1	150	12	1	<0.5	<0.5	<5.0	<0.5
MW-5	11/15/2002	42.10	16.27	0.00	25.83	7000	99	<5.0	250	500	<5.0	<5.0	<5.0	<50	<5.0
MW-5	10/25/2004	42.10	16.15	0.00	25.95	4800	27	1	50	4	1	<0.50	<0.50	<5.0	<0.50
MW-5	12/23/2004	42.10	15.88	0.00	26.22	6300	55	<0.90	140	6	<0.90	<0.90	<0.90	<5.0	<0.90
MW-5	2/25/2005	42.10	12.97	0.00	29.13	4700	44	0.59	110	4.8	0.85	<0.50	<0.50	<5.0	<0.50
MW-5	5/19/2005	42.10	12.48	0.00	29.62	3800	32	0.61	66	4.4	1.00	<0.50	<0.50	<5.0	<0.50

Table 1
Groundwater Analytical Data
Former EZ Serve Location #100877
Delta Project No. RPMS-877-A

Well	Sample Collection Date	Casing Elevation (msl)	Depth to Water (feet)	Depth to Product (feet)	Water Table Elevation (msl)	TPHg (µg/L)	Benzene (µg/L)	Toluene (µg/L)	Ethyl- benzene (µg/L)	Total Xylenes (µg/L)	MTBE (µg/L)	DIPE (µg/L)	ETBE (µg/L)	TBA (µg/L)	TAME (µg/L)
------	----------------------------------	----------------------------------	---------------------------------	-----------------------------------	--	--------------------	-----------------------	-----------------------	---------------------------------	--------------------------------	--------------------	--------------------	--------------------	-------------------	--------------------

Table 1
Groundwater Analytical Data
Former EZ Serve Location #100877
Delta Project No. RPMS-877-A

Well	Sample Collection Date	Casing Elevation (msl)	Depth to Water (feet)	Depth to Product (feet)	Water Table Elevation (msl)	TPHg (µg/L)	Benzene (µg/L)	Toluene (µg/L)	Ethyl-benzene (µg/L)	Total Xylenes (µg/L)	MTBE (µg/L)	DIPE (µg/L)	ETBE (µg/L)	TBA (µg/L)	TAME (µg/L)
MW-6	2/5/1992	42.33	21.29	0.00	21.04	51000	5400	3500	3600	10000	--	--	--	--	--
MW-6	9/11/1992	42.33	20.56	0.00	21.77	24000	2500	830	1400	2300	--	--	--	--	--
MW-6	12/22/1992	42.33	20.31	0.00	22.02	23000	5100	630	2000	3100	--	--	--	--	--
MW-6	3/3/1993	42.33	16.83	0.00	25.50	18000	4400	820	1400	2400	--	--	--	--	--
MW-6	6/23/1993	42.33	17.30	0.00	25.03	18000	4600	850	2700	3400	--	--	--	--	--
MW-6	9/30/1993	42.33	19.05	0.00	23.28	--	--	--	--	--	--	--	--	--	--
MW-6	2/6/1994	42.33	18.55	0.00	23.78	20000	4600	690	2100	2500	--	--	--	--	--
MW-6	5/2/1994	42.33	17.74	0.00	24.59	5300	930	54	610	240	--	--	--	--	--
MW-6	7/1/1994	42.33	18.09	0.00	24.24	10000	1500	160	850	690	--	--	--	--	--
MW-6	9/20/1994	42.33	21.05	0.00	21.28	11000	2000	140	1200	760	--	--	--	--	--
MW-6	12/6/1994	42.33	18.33	0.00	24.00	8600	1300	87	980	610	--	--	--	--	--
MW-6	3/10/1995	42.33	15.35	0.00	26.98	--	--	--	--	--	--	--	--	--	--
MW-6	3/15/1995	42.33	14.91	0.00	27.42	9800	1600	110	1000	1000	--	--	--	--	--
MW-6	9/23/1996	42.33	15.50	0.00	26.83	12000	520	55	930	350	51	--	--	--	--
MW-6	12/4/1996	42.33	16.06	0.00	26.27	11000	390	25	680	170	130	--	--	--	--
MW-6	4/8/1997	42.33	13.64	0.00	28.69	17000	700	92	1400	900	2700	--	--	--	--
MW-6	6/30/1997	42.33	15.08	0.00	27.25	11000	270	37	590	450	<	--	--	--	--
MW-6	11/25/1997	42.33	16.40	0.00	25.93	9100	130	26	500	150	310	--	--	--	--
MW-6	6/1/1998	42.33	10.31	0.00	32.02	14000	190	50	680	400	160	--	--	--	--
MW-6	6/14/2001	42.33	15.46	0.00	26.87	6400	29	6	200	55	<20	--	--	--	--
MW-6	11/7/2001	42.33	16.71	0.00	25.62	7200	34	9	180	31	<5.0	<5.0	<5.0	<5.0	<5.0
MW-6	1/30/2002	42.33	14.60	0.00	27.73	6600	32	7	130	28	<5.0	<5.0	<5.0	<5.0	<5.0
MW-6	5/29/2002	42.33	14.99	0.00	27.34	5200	26	7	150	27	<5.0	<5.0	<5.0	<5.0	<5.0
MW-6	8/14/2002	42.33	16.03	0.00	26.30	5300	24	7	120	22	<2.0	<2.0	<2.0	<2.0	<2.0
MW-6	11/15/2002	42.33	16.53	0.00	25.80	5000	19	5	70	38	<0.5	<0.5	<0.5	<5.0	<0.5
MW-6	10/25/2004	42.33	16.43	0.00	25.90	3600	10	2	83	16	2	<0.50	<0.50	<5.0	<0.50
MW-6	12/23/2004	42.33	16.12	0.00	26.21	2100	8	1	10	2	2	<0.50	<0.50	<5.0	<0.50
MW-6	2/25/2005	42.33	13.13	0.00	29.20	2500	6.6	1.4	29	5.2	0.74	<0.50	<0.50	<5.0	<0.50
MW-6	5/19/2005	42.33	12.61	0.00	29.72	3800	7.5	2.2	54	12.0	3.10	<0.50	<0.50	<5.0	<0.50

Table 1
Groundwater Analytical Data
Former EZ Serve Location #100877
Delta Project No. RPMS-877-A

Well	Sample Collection Date	Casing Elevation (msl)	Depth to Water (feet)	Depth to Product (feet)	Water Table Elevation (msl)	TPHg (µg/L)	Benzene (µg/L)	Toluene (µg/L)	Ethyl- benzene (µg/L)	Total Xylenes (µg/L)	MTBE (µg/L)	DIPE (µg/L)	ETBE (µg/L)	TBA (µg/L)	TAME (µg/L)
------	----------------------------------	----------------------------------	---------------------------------	-----------------------------------	--	--------------------	-----------------------	-----------------------	---------------------------------	--------------------------------	--------------------	--------------------	--------------------	-------------------	--------------------

Table 1
Groundwater Analytical Data
Former EZ Serve Location #100877
Delta Project No. RPMS-877-A

Well	Sample Collection Date	Casing Elevation (msl)	Depth to Water (feet)	Depth to Product (feet)	Water Table Elevation (msl)	TPHg (µg/L)	Benzene (µg/L)	Toluene (µg/L)	Ethyl-benzene (µg/L)	Total Xylenes (µg/L)	MTBE (µg/L)	DIPE (µg/L)	ETBE (µg/L)	TBA (µg/L)	TAME (µg/L)	
MW-7	6/23/1993	42.70	17.87	0.00	24.83	29000	4200	71	4400	5600	--	--	--	--	--	
MW-7	9/30/1993	42.70	18.94	0.00	23.76	30000	3200	71	2800	3400	--	--	--	--	--	
MW-7	2/6/1994	42.70	19.11	19.05	23.63	--	--	--	--	--	--	--	--	--	--	
MW-7	5/2/1994	42.70	18.11	0.00	24.59	5700	630	13	660	400	--	--	--	--	--	
MW-7	7/1/1994	42.70	18.72	0.00	23.98	3100	180	99	160	520	--	--	--	--	--	
MW-7	9/20/1994	42.70	21.41	0.00	21.29	6100	540	6	750	730	--	--	--	--	--	
MW-7	12/5/1994	42.70	18.66	0.00	24.04	3700	280	<10	430	350	--	--	--	--	--	
MW-7	3/10/1995	42.70	15.72	0.00	26.98	3900	310	<10	540	540	--	--	--	--	--	
MW-7	3/14/1995	42.70	15.23	0.00	27.47	1900	290	4	26	296	--	--	--	--	--	
MW-7	9/23/1996	42.70	15.94	0.00	26.76	6300	76	<	420	270	15	--	--	--	--	
MW-7	12/4/1996	42.70	16.43	0.00	26.27	7800	67	<	600	350	22	--	--	--	--	
MW-7	4/8/1997	42.70	14.10	0.00	28.60	5600	42	<	240	96	<	--	--	--	--	
MW-7	6/30/1997	42.70	15.51	0.00	27.19	5500	<	79	<	44	280	--	--	--	--	
MW-7	11/25/1997	42.70	16.80	0.00	25.90	2400	23	5	<	54	120	--	--	--	--	
MW-7	6/1/1998	42.70	10.31	0.00	32.39	14000	190	50	680	400	160	--	--	--	--	
MW-7	6/14/2001	42.70	15.46	0.00	27.24	6400	29	6	200	55	<20	--	--	--	--	
MW-7	11/7/2001	42.70	--	--	--	--	--	--	--	--	--	--	--	--	--	
MW-7	1/30/2002	42.70	14.97	0.00	27.73	6200	2	<0.5	96	5	<0.5	<5.0	<5.0	<5.0	<5.0	
MW-7	5/29/2002	42.70	15.49	0.00	27.21	1600	1	<0.5	3	2	<0.5	<0.5	<0.5	<5.0	<0.5	
MW-7	8/14/2002	42.70	16.44	0.00	26.26	4100	1	<0.5	74	1	<0.5	<0.5	<0.5	<5.0	<0.5	
MW-7	11/15/2002	42.70	16.91	0.00	25.79	1000	1	<0.5	<0.5	1	<0.5	<0.5	<0.5	<5.0	<0.5	
MW-7	10/25/2004															
					well not sampled, can't locate well											
MW-7	5/19/2005	42.70	13.06	0.00	29.64	660.00	<0.50	<0.50	1.8	<0.50	<0.50	<0.50	<0.50	<5.0	<0.50	

Table 1
Groundwater Analytical Data
Former EZ Serve Location #100877
Delta Project No. RPMS-877-A

Well	Sample Collection Date	Casing Elevation (msl)	Depth to Water (feet)	Depth to Product (feet)	Water Table Elevation (msl)	TPHg (µg/L)	Benzene (µg/L)	Toluene (µg/L)	Ethyl-benzene (µg/L)	Total Xylenes (µg/L)	MTBE (µg/L)	DIPE (µg/L)	ETBE (µg/L)	TBA (µg/L)	TAME (µg/L)
MW-8	6/23/1993	97.61	17.64	0.00	79.97	350	43	9	35	67	--	--	--	--	--
MW-8	9/30/1993	97.61	18.85	0.00	78.76	2700	190	340	170	720	--	--	--	--	--
MW-8	2/6/1994	97.61	18.91	0.00	78.70	<100	<1	1	1	2	--	--	--	--	--
MW-8	5/2/1994	97.61	18.11	0.00	79.50	<100	<1	3	<1	7	--	--	--	--	--
MW-8	7/1/1994	97.61	18.43	0.00	79.18	300	18	48	19	37	--	--	--	--	--
MW-8	9/20/1994	97.61	21.43	0.00	76.18	<100	<1	<1	<1	<1	--	--	--	--	--
MW-8	12/5/1994	97.61	18.72	0.00	78.89	<50	<0.5	<0.5	<0.5	<0.5	--	--	--	--	--
MW-8	3/10/1995	97.61	18.69	0.00	78.92	--	--	--	--	--	--	--	--	--	--
MW-8	3/14/1995	97.61	14.83	0.00	82.78	<50	<0.5	<0.5	<0.5	1	--	--	--	--	--
MW-8	9/23/1996	97.61	15.83	0.00	81.78	<	<	<	<	<	<	<	<	<	<
MW-8	Not Sampled, well inaccessible since 4th Quarter, 1996.														
MW-9	6/23/1993	95.41	15.94	0.00	79.47	45000	14000	1200	2800	12000	--	--	--	--	--
MW-9	9/30/1993	95.41	17.05	0.00	78.36	86000	22000	1100	3300	15000	--	--	--	--	--
MW-9	2/6/1994	95.41	17.07	0.00	78.34	43000	10000	460	2100	7500	--	--	--	--	--
MW-9	5/2/1994	95.41	16.24	0.00	79.17	17000	5400	270	1300	4700	--	--	--	--	--
MW-9	7/1/1994	95.41	16.59	0.00	78.82	10000	2100	120	450	1300	--	--	--	--	--
MW-9	9/20/1994	95.41	19.61	0.00	75.80	7500	2200	97	400	1200	--	--	--	--	--
MW-9	12/5/1994	95.41	16.85	0.00	78.56	10000	2700	130	530	1600	--	--	--	--	--
MW-9	3/10/1995	95.41	--	--	--	--	--	--	--	--	--	--	--	--	--
MW-9	3/14/1995	95.41	14.18	0.00	81.23	18000	5900	270	1200	3680	--	--	--	--	--
MW-9	Not Sampled, well inaccessible since 1st Quarter, 1995.														

Table 1
Groundwater Analytical Data
Former EZ Serve Location #100877
Delta Project No. RPMS-877-A

Well	Sample Collection Date	Casing Elevation (msl)	Depth to Water (feet)	Depth to Product (feet)	Water Table Elevation (msl)	TPHg (µg/L)	Benzene (µg/L)	Toluene (µg/L)	Ethyl-benzene (µg/L)	Total Xylenes (µg/L)	MTBE (µg/L)	DIPE (µg/L)	ETBE (µg/L)	TBA (µg/L)	TAME (µg/L)
MW-10	6/23/1993	97.11	17.39	0.00	79.72	35000	980	640	3500	12000	--	--	--	--	--
MW-10	9/30/1993	97.11	18.58	0.00	78.53	4000	230	12	100	680	--	--	--	--	--
MW-10	2/6/1994	97.11	18.61	0.00	78.50	2000	69	12	220	120	--	--	--	--	--
MW-10	5/2/1994	97.11	17.83	0.00	79.28	710	16	6	85	62	--	--	--	--	--
MW-10	7/1/1994	97.11	18.17	0.00	78.94	2000	52	43	120	210	--	--	--	--	--
MW-10	9/20/1994	97.11	21.15	0.00	75.96	2800	34	16	270	560	--	--	--	--	--
MW-10	12/5/1994	97.11	18.43	0.00	78.68	2700	30	13	260	430	--	--	--	--	--
MW-10	3/10/1995	97.11	15.37	0.00	81.74	--	--	--	--	--	--	--	--	--	--
MW-10	3/14/1995	97.11	15.93	0.00	81.18	1400	18	6	200	239	--	--	--	--	--
MW-10	9/23/1996	97.11	15.59	0.00	81.52	3800	4	3	220	170	397	--	--	--	--
MW-10	12/4/1996	97.11	16.15	0.00	80.96	4600	2	8	260	150	20	--	--	--	--
MW-10					Not Sampled, well inaccessible since 4th Quarter, 1996.										
MW-11	2/10/1995	92.68	11.80	0.00	80.88	7000	140	22	600	1000	--	--	--	--	--
MW-11	3/10/1995	92.68	11.58	0.00	81.10	--	--	--	--	--	--	--	--	--	--
MW-11	3/14/1995	92.68	13.96	0.00	78.72	6000	200	17	750	1276	--	--	--	--	--
MW-11	9/23/1996	92.68	12.29	0.00	80.39	27000	55	81	300	3500	40	--	--	--	--
MW-11	12/4/1996	92.68	--	--	--	--	--	--	--	--	--	--	--	--	--
MW-11	4/8/1997	92.68	10.51	0.00	82.17	24000	280	130	3000	3700	<	--	--	--	--
MW-11					Not Sampled, well inaccessible since 2nd Quarter, 1997										

Table 1
Groundwater Analytical Data
Former EZ Serve Location #100877
Delta Project No. RPMS-877-A

Well	Sample Collection Date	Casing Elevation (msl)	Depth to Water (feet)	Depth to Product (feet)	Water Table Elevation (msl)	TPHg (µg/L)	Benzene (µg/L)	Toluene (µg/L)	Ethyl-benzene (µg/L)	Total Xylenes (µg/L)	MTBE (µg/L)	DIPE (µg/L)	ETBE (µg/L)	TBA (µg/L)	TAME (µg/L)
MW-12	2/10/1995	43.25	16.30	0.00	26.95	<50	<0.5	<0.5	<0.5	<0.5	--	--	--	--	--
MW-12	3/10/1995	43.25	16.37	0.00	26.88	--	--	--	--	--	--	--	--	--	--
MW-12	3/14/1995	43.25	15.69	0.00	27.56	<50	<0.5	<0.5	<0.5	1	--	--	--	--	--
MW-12	9/23/1996	43.25	16.67	0.00	26.58	<	<	2	<	<	<	--	--	--	--
MW-12	12/4/1996	43.25	17.16	0.00	26.09	<	3	<	2	3	<	--	--	--	--
MW-12	4/8/1997	43.25	14.88	0.00	28.37	<	<	<	<	<	<	--	--	--	--
MW-12	6/30/1997	43.25	16.33	0.00	26.92	--	--	--	--	--	--	--	--	--	--
MW-12	11/25/1997	43.25	17.61	0.00	25.64	--	--	--	--	--	--	--	--	--	--
MW-12	6/1/1998	43.25	11.58	0.00	31.67	--	--	--	--	--	--	--	--	--	--
MW-12	6/14/2001	43.25	16.62	0.00	26.63	<50	<0.50	<0.50	<0.50	<0.50	<5.0	--	--	--	--
MW-12	11/7/2001	43.25	17.91	0.00	25.34	<50	<0.5	<0.5	<0.5	<0.5	<0.5	<0.5	<0.5	<5.0	<0.5
MW-12	1/30/2002	43.25	15.60	0.00	27.65	<50	<0.5	<0.5	<0.5	<0.5	<0.5	<0.5	<0.5	<5.0	<0.5
MW-12	5/29/2002	43.25	16.24	0.00	27.01	<50	<0.5	<0.5	<0.5	<0.5	<0.5	<0.5	<0.5	<5.0	<0.5
MW-12	8/14/2002	43.25	17.20	0.00	26.05	<50	<0.5	<0.5	<0.5	<0.5	<0.5	<0.5	<0.5	<5.0	<0.5
MW-12	11/15/2002	43.25	17.62	0.00	25.63	<50	<0.5	<0.5	<0.5	<0.5	<0.5	<0.5	<0.5	<5.0	<0.5
MW-12	10/25/2004				well not sampled, cars parked on well										
MW-12	2/25/2005	43.25	14.72	0.00	28.53	<50	<0.5	<0.5	<0.5	<0.5	<0.5	<0.5	<0.5	<5.0	<0.5
MW-12	5/19/2005	43.25	13.80	0.00	29.45	<50	<0.5	<0.5	<0.5	<0.5	<0.5	<0.5	<0.5	<5.0	<0.5

Table 1
Groundwater Analytical Data
Former EZ Serve Location #100877
Delta Project No. RPMS-877-A

Well	Sample Collection Date	Casing Elevation (msl)	Depth to Water (feet)	Depth to Product (feet)	Water Table Elevation (msl)	TPHg (µg/L)	Benzene (µg/L)	Toluene (µg/L)	Ethyl-benzene (µg/L)	Total Xylenes (µg/L)	MTBE (µg/L)	DIPE (µg/L)	ETBE (µg/L)	TBA (µg/L)	TAME (µg/L)
MW-13	2/10/1995	40.97	14.45	0.00	26.52	<50	<0.5	<0.5	<0.5	<0.5	--	--	--	--	--
MW-13	3/10/1995	40.97	14.30	0.00	26.67	--	--	--	--	--	--	--	--	--	--
MW-13	3/14/1995	40.97	15.81	0.00	25.16	<50	<0.5	<0.5	<0.5	1	--	--	--	--	--
MW-13	9/23/1996	40.97	14.60	0.00	26.37	<	<	1	1	<	<	--	--	--	--
MW-13	12/4/1996	40.97	--	--	--	--	--	--	--	--	--	--	--	--	--
MW-13	4/8/1997	40.97	12.75	0.00	28.22	<	<	<	<	<	<	--	--	--	--
MW-13	6/30/1997	40.97	14.13	0.00	26.84	--	--	--	--	--	--	--	--	--	--
MW-13	11/25/1997	40.97	15.48	0.00	25.49	--	--	--	--	--	--	--	--	--	--
MW-13	6/1/1998	40.97	9.58	0.00	31.39	--	--	--	--	--	--	--	--	--	--
MW-13	6/14/2001	40.97	14.51	0.00	26.46	<50	<0.50	<0.50	<0.50	<0.50	<5.0	--	--	--	--
MW-13	11/7/2001	40.97	15.85	0.00	25.12	<50	<0.5	<0.5	<0.5	<0.5	<0.5	<0.5	<0.5	<5.0	<0.5
MW-13	1/30/2002	40.97	13.65	0.00	27.32	<50	<0.5	<0.5	<0.5	<0.5	<0.5	<0.5	<0.5	<5.0	<0.5
MW-13	5/29/2002	40.97	14.10	0.00	26.87	<50	<0.5	<0.5	<0.5	<0.5	<0.5	<0.5	<0.5	<5.0	<0.5
MW-13	8/14/2002	40.97	15.13	0.00	25.84	<50	<0.5	<0.5	<0.5	<0.5	<0.5	<0.5	<0.5	<5.0	<0.5
MW-13	11/15/2002	40.97	--	--	--	--	--	--	--	--	--	--	--	--	--
MW-13	10/25/2004														

well not sampled, can't locate well

Table 1
Groundwater Analytical Data
Former EZ Serve Location #100877
Delta Project No. RPMS-877-A

Well	Sample Collection Date	Casing Elevation (msl)	Depth to Water (feet)	Depth to Product (feet)	Water Table Elevation (msl)	TPHg (µg/L)	Benzene (µg/L)	Toluene (µg/L)	Ethyl-benzene (µg/L)	Total Xylenes (µg/L)	MTBE (µg/L)	DIPE (µg/L)	ETBE (µg/L)	TBA (µg/L)	TAME (µg/L)
MW-14	2/10/1995	43.19	16.28	0.00	26.91	12000	42	8	740	2100	--	--	--	--	--
MW-14	3/10/1995	43.19	16.33	0.00	26.86	--	--	--	--	--	--	--	--	--	--
MW-14	3/14/1995	43.19	14.87	0.00	28.32	1400	6	2	36	298	--	--	--	--	--
MW-14	9/23/1996	43.19	16.67	0.00	26.52	6400	3	<	690	96	10	--	--	--	--
MW-14	12/4/1996	43.19	17.06	0.00	26.13	9500	6	<	1100	400	30	--	--	--	--
MW-14	4/8/1997	43.19	14.77	0.00	28.42	2900	<	3	220	21	<	--	--	--	--
MW-14	6/30/1997	43.19	16.22	0.00	26.97	74	1	<	1	1	<	--	--	--	--
MW-14	11/25/1997	43.19	17.52	0.00	25.67	<	<	<	<	<	<	--	--	--	--
MW-14	6/1/1998	43.19	11.46	0.00	31.73	<50	<0.5	<0.5	<0.5	<0.5	<5	--	--	--	--
MW-14	6/14/2001	43.19	16.53	0.00	26.66	470	<0.5	<0.5	3	1	<5	--	--	--	--
MW-14	11/7/2001	43.19	17.84	0.00	25.35	<50	<0.5	<0.5	<0.5	<0.5	<0.5	<0.5	<0.5	<5.0	<0.5
MW-14	1/30/2002	43.19	15.55	0.00	27.64	<50	<0.5	<0.5	<0.5	<0.5	<0.5	<0.5	<0.5	<5.0	<0.5
MW-14	5/29/2002	43.19	16.14	0.00	27.05	<50	<0.5	<0.5	<0.5	<0.5	<0.5	<0.5	<0.5	<5.0	<0.5
MW-14	8/14/2002	43.19	17.12	0.00	26.07	<50	<0.5	<0.5	<0.5	<0.5	<0.5	<0.5	<0.5	<5.0	<0.5
MW-14	11/15/2002	43.19	17.56	0.00	25.63	<50	<0.5	<0.5	<0.5	<0.5	<0.5	<0.5	<0.5	<5.0	<0.5
MW-14	10/25/2004		well not sampled, can't locate well / cars parked on well												
MW-14	2/25/2005	43.19	14.20	0.00	28.99	210.00	<0.5	<0.5	0.56	<0.5	<0.5	<0.5	<0.5	<5.0	<0.5
MW-14	5/19/2005	43.19	13.71	0.00	29.48	230.00	<0.5	<0.5	0.72	<0.5	<0.5	<0.5	<0.5	<0.5	<0.5

Table 1
Groundwater Analytical Data
Former EZ Serve Location #100877
Delta Project No. RPMS-877-A

Well	Sample Collection Date	Casing Elevation (msl)	Depth to Water (feet)	Depth to Product (feet)	Water Table Elevation (msl)	TPHg (µg/L)	Benzene (µg/L)	Toluene (µg/L)	Ethyl- benzene (µg/L)	Total Xylenes (µg/L)	MTBE (µg/L)	DIPE (µg/L)	ETBE (µg/L)	TBA (µg/L)	TAME (µg/L)
EX-1	11/15/2002	--	17.02	0.00	--	67	4	<0.5	<0.5	<0.5	1	<0.5	<0.5	<5.0	<0.5
EX-1	10/25/2004	--	16.91	0.00	--	96	2	<0.50	5	2	<0.5	<0.5	<0.5	<5.0	<0.50
EX-1	12/23/2004	--	16.60	0.00	--	<50	<0.50	<0.50	1	<0.50	<0.50	<0.50	<0.50	<5.0	<0.50
EX-1	2/25/2005	--	13.72	0.00	--	59	1.4	<0.50	2.0	0.87	<0.50	<0.50	<0.50	<5.0	<0.50
EX-1	5/19/2005	--	13.13	0.00	--	200	3.4	<0.50	3.7	1.80	1	<0.50	<0.50	<5.0	<0.50

Notes: No known groundwater monitoring or sampling was conducted between June 1, 1998 and June 14, 2001 and June 14, 2001 and November 7, 2001. Wellhead elevations resurveyed on January 30, 2002.

Explanations:

- msl = mean seal level
- (µg/L) = micrograms per liter
- TBA = Tertiary butyl alcohol
- MTBE = Methyl tertiary butyl ether
- DIPE = Di-isopropyl ether
- ETBE = Ethyl tertiary butyl ether
- TAME = Tertiary amyl methyl ether
- EDB = 1,2-Dibromoethane
- = Not measured, or analyzed
- DRY = Insufficient water to sample
- TPHg = Total Petroleum Hydrocarbons as gasoline (EPA Method 8015).
- SHEEN = Discontinuous, non-measurable thickness of PSH.
- < = Sample reported as "not detected," in previous tables, reporting limit not known.

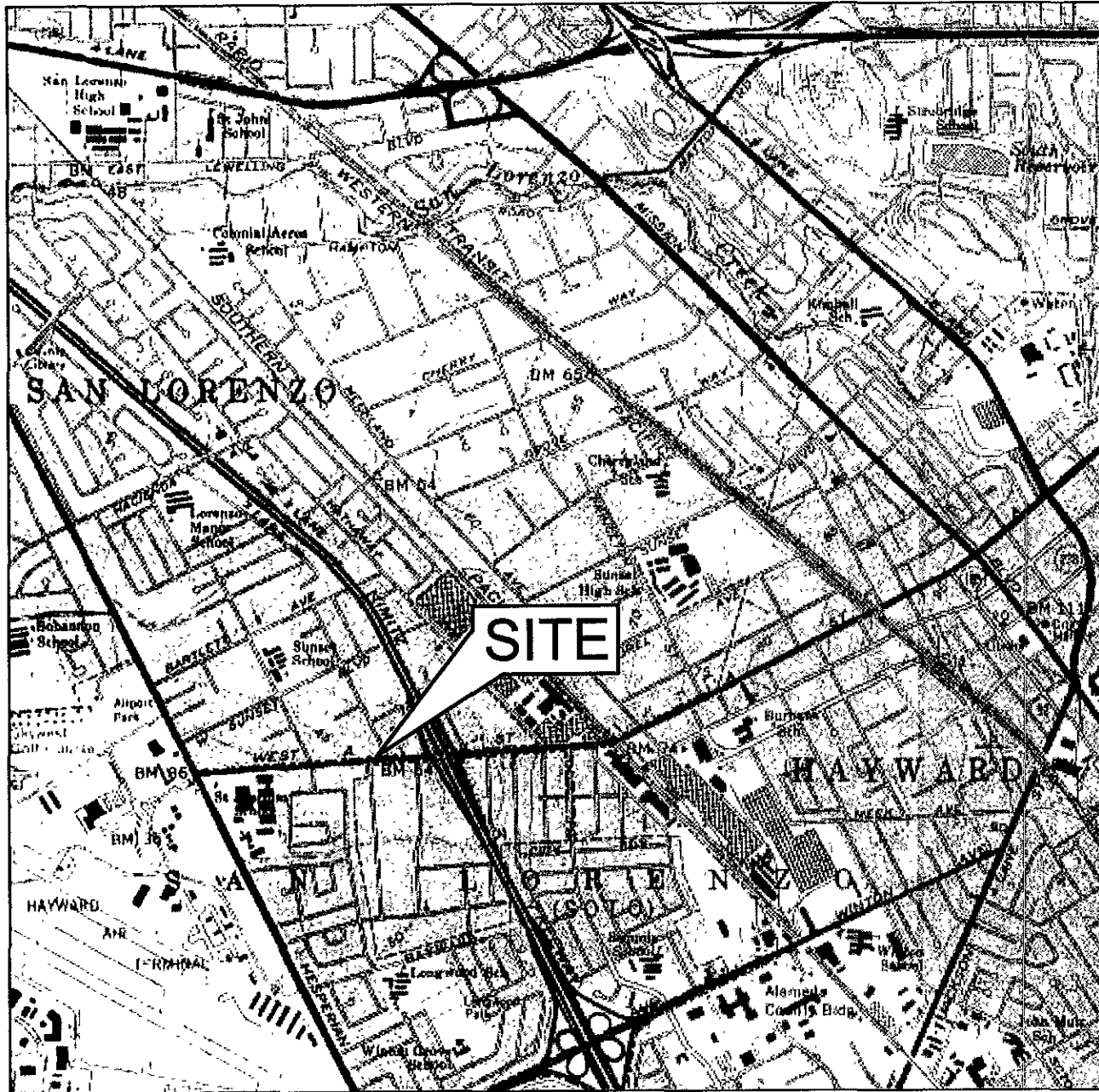

0 1000 FT 2000 FT
SCALE: 1 : 24,000



FIGURE 1

SITE LOCATION MAP

FORMER E-Z SERVE NO. 100877
525 WEST A STREET
HAYWARD, CALIFORNIA

PROJECT NO. RPMS-0877	DRAWN BY MC 11/10/04
FILE NO. EZ-100877-F1	PREPARED BY JS
REVISION NO. 1	REVIEWED BY



- MW-11 MONITORING WELLS
- ◆ EX-1 PROPOSED GROUNDWATER EXTRACTION WELL LOCATION

WEST "A" AVENUE

FORMER FUEL ISLANDS

FORMER UST EXCAVATION

TRAILER PARK

GARDEN STREET

LUPINE ST

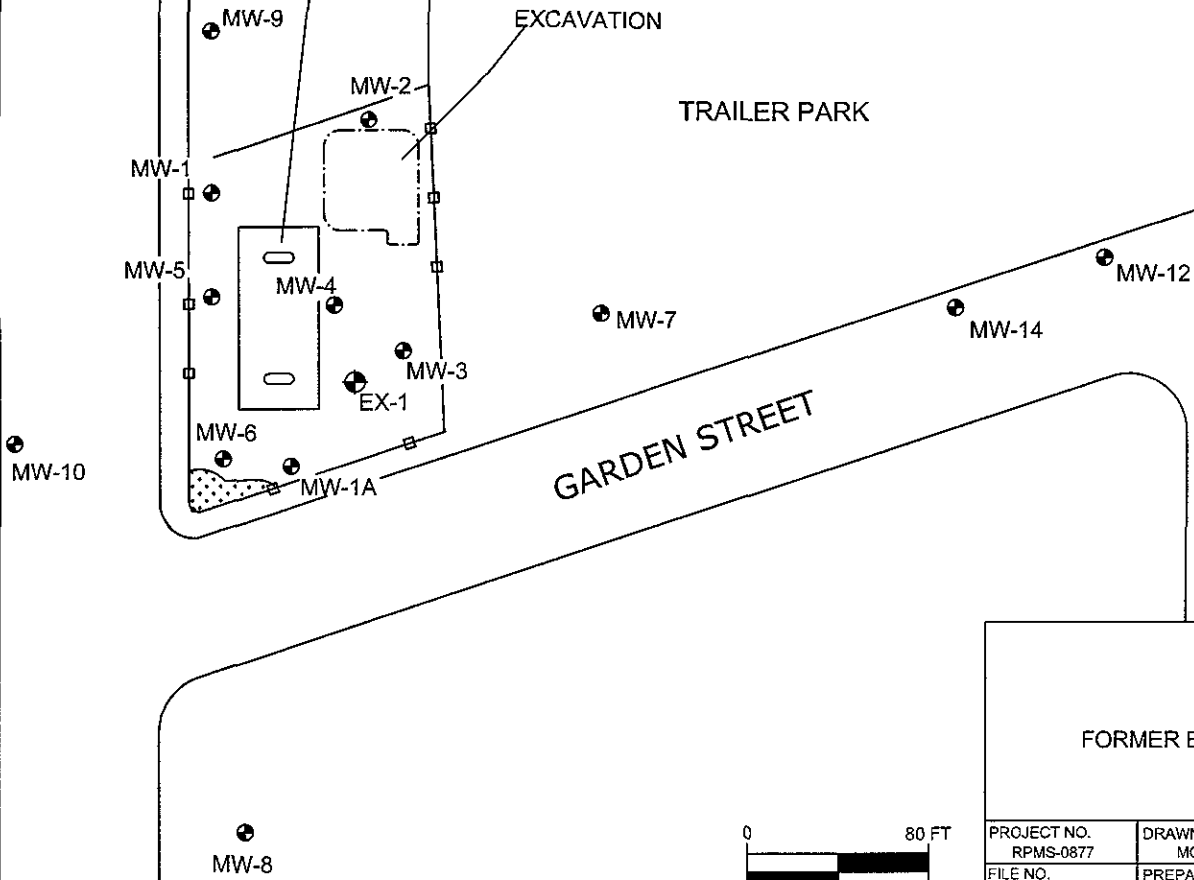

FIGURE 2
SITE MAP

FORMER EZ-SERVE LOCATION NO. 100877
525 WEST A STREET
HAYWARD, CA

PROJECT NO. RPMS-0877	DRAWN BY MC 8/1/05
FILE NO. EZ-100877	PREPARED BY DS
REVISION NO.	REVIEWED BY



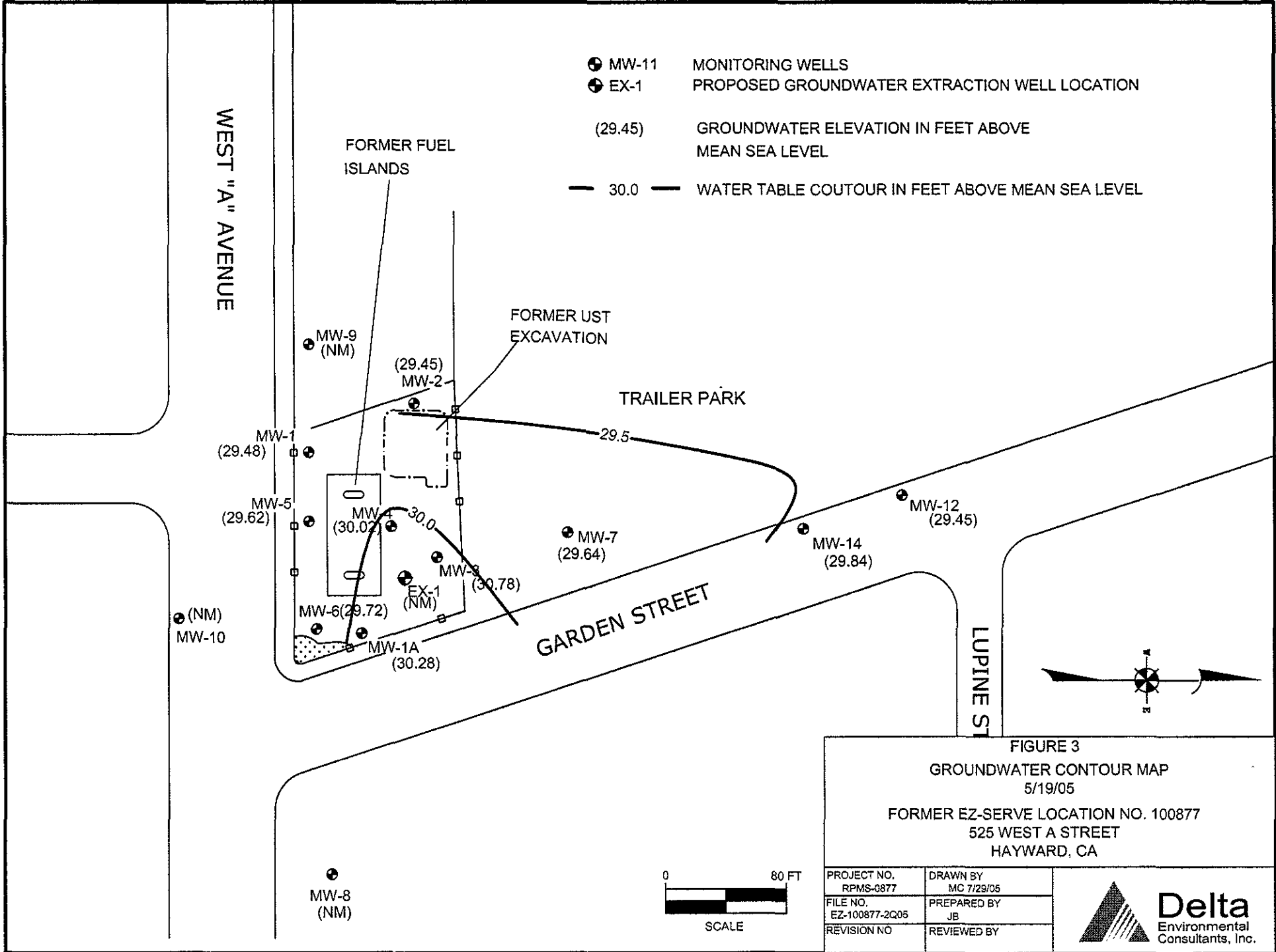



FIGURE 3
GROUNDWATER CONTOUR MAP
 5/19/05
 FORMER EZ-SERVE LOCATION NO. 100877
 525 WEST A STREET
 HAYWARD, CA

PROJECT NO. RPMS-0877	DRAWN BY MC 7/29/05
FILE NO. EZ-100877-2Q05	PREPARED BY JB
REVISION NO	REVIEWED BY



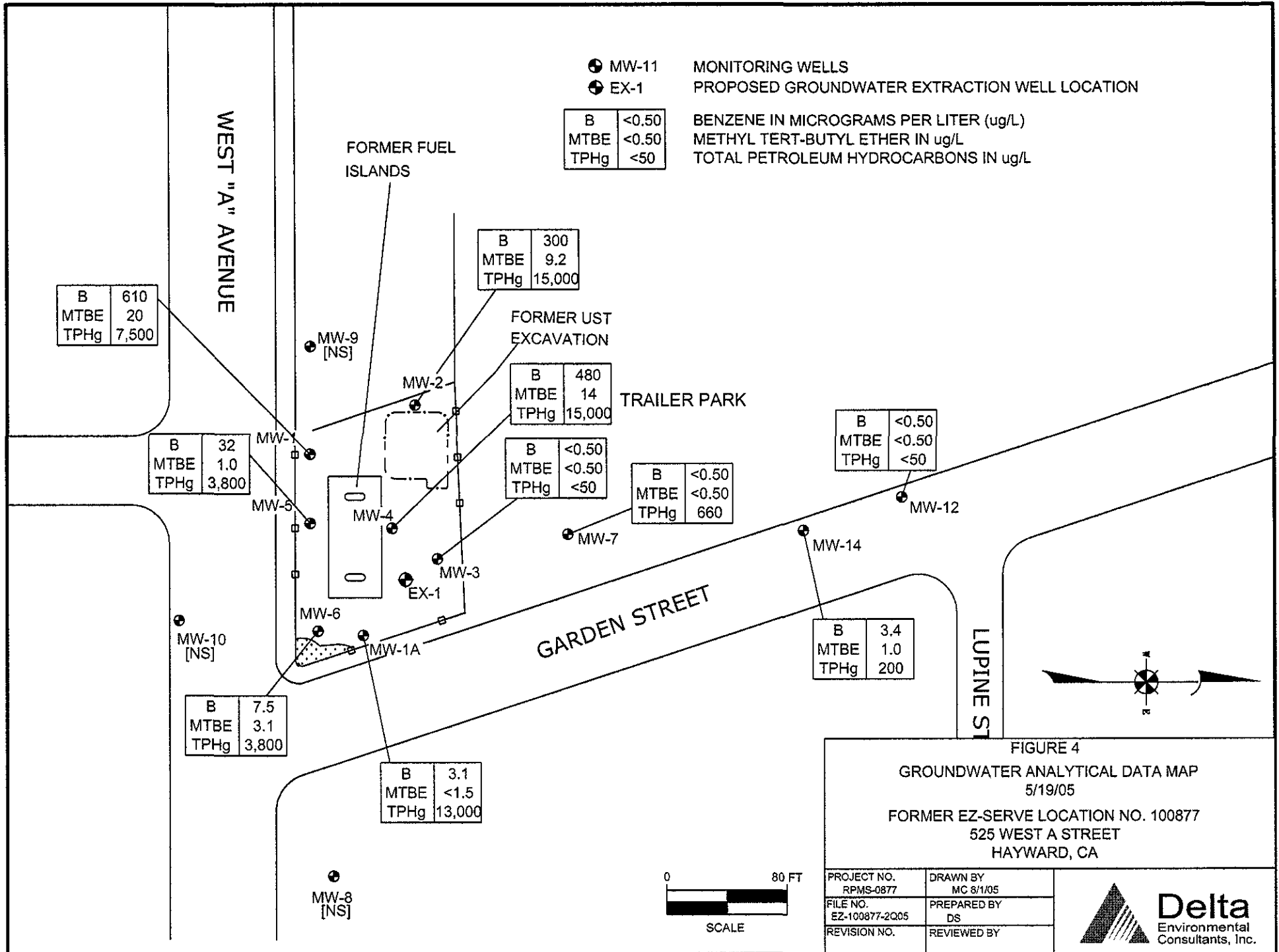

FIGURE 4
GROUNDWATER ANALYTICAL DATA MAP
 5/19/05
 FORMER EZ-SERVE LOCATION NO. 100877
 525 WEST A STREET
 HAYWARD, CA

PROJECT NO. RPMS-0877	DRAWN BY MC 8/1/05
FILE NO. EZ-100877-2Q05	PREPARED BY DS
REVISION NO.	REVIEWED BY

Delta
Environmental Consultants, Inc.

Delta Environmental Consultants, Inc.
Groundwater/Liquid Level Data
(measurements in feet)

Project Address: 525 West A St.
Hayward, CA
Recorded By: Jason Mata

Date: 5/19/05
Project No: RPMSO-877-B-GWMS02
Weather: _____

Well No.	Time	Depth to Groundwater	Measured Total Depth	Diameter	Total Volume	Depth to Product	Product Description	Comments
MW-1		12.27	30	4"	34			
MW-1A		13.12	30	2"	8			
MW-2		13.81	30	4"	32			
MW-3		13.11	14.9	4"	34			
MW-4		12.74	30	4"	34			
MW-5		12.48	30	4"	34			
MW-6		12.61	30	4"	34			
MW-7		13.06	28.5	2"	6			
MW-8								Couldn't locate
MW-12		13.80	29.7	2"	8			
MW-14		13.71	30.1	2"	8			
EX-1		13.13	35.00	4"	95			

Notes:

Waste: _____
Drums _____ Date _____ Contents _____



SAMPLING INFORMATION SHEET

Well No. MW-14 Project Name RPMS 100877, Hayward Client Restructure Petroleum Marketing Services

Location (address) 525 West A Street, Hayward, California

Date Sampled 5/19/5

Well Depth 30 ft below top of casing Casing diameter 4 inches

DTW (below top of casing) 12.27 ft. Time: _____

DTP _____ ft.

Purging Method: Submersible pump Bailer Centrifugal pump Other _____

Sampling Method: Disposable bailer Sampling port Samples collected _____

GROUND WATER EVACUATION/STABILIZATION DATA

Time	Temperature(°F)	pH units	Conductance (umnos/cm)	DTW (Nearest 0.01 ft)	Cumulative Volume of Water Removed From Well (gallons)
2:27	21.5	7.06	1171		1
2:32	20.1	6.65	1257		1 17
2:37	20.0	6.69	1246		17 34

Comments: _____

Transportation(thermal preservation) _____

Form Completed By _____ Sampled By _____



SAMPLING INFORMATION SHEET

Well No. MW-1A Project Name RPMS 100877, Hayward Client Restructure Petroleum Marketing Services

Location (address) 525 West A Street, Hayward, California

Date Sampled 5/19/5

Well Depth 30 ft below top of casing Casing diameter 2 inches

DTW (below top of casing) 13.12 ft. Time: _____

DTP _____ ft.

Purging Method: Submersible pump Bailer Centrifugal pump Other _____

Sampling Method: Disposable bailer Sampling port Samples collected _____

GROUND WATER EVACUATION/STABILIZATION DATA

Time	Temperature(°F)	pH units	Conductance (umhos/cm)	DTW (Nearest 0.01 ft)	Cumulative Volume of Water Removed From Well (gallons)
2:01	22.9	6.87	1151		1
2:03	20.8	6.80	1158		4
2:05	20.6	6.76	1148		8

Comments: Strong odor, Slight Sheen

Transportation(thermal preservation) _____

Form Completed By _____ Sampled By _____



SAMPLING INFORMATION SHEET

Well No. MW-2 Project Name RPMS 100877, Hayward Client Restructure Petroleum Marketing Services

Location (address) 525 West A Street, Hayward, California

Date Sampled 5/19/5

Well Depth 30 ft below top of casing Casing diameter 4 inches

DTW (below top of casing) 13.81 ft. Time: _____

DTP _____ ft.

Purging Method: Submersible pump Bailer Centrifugal pump Other _____

Sampling Method: Disposable bailer Sampling port Samples collected _____

GROUND WATER EVACUATION/STABILIZATION DATA

Time	Temperature(°F)	pH units	Conductance (umhos/cm)	DTW (Nearest 0.01 ft)	Cumulative Volume of Water Removed From Well (gallons)
2:57	22.1	6.67	1241		1
3:01	19.7	6.78	1164		16
3:05	19.6	7.43	1175		32

Comments: _____

Transportation(thermal preservation) _____

Form Completed By _____ Sampled By _____



SAMPLING INFORMATION SHEET

Well No. MW-3 Project Name RPMS 100877, Hayward Client Restructure Petroleum Marketing Services

Location (address) 525 West A Street, Hayward, California

Date Sampled 5/19/5

Well Depth ~~30~~ 14.9 ft below top of casing Casing diameter _____ inches

DTW (below top of casing) 13.11 ft. Time: _____

DTP _____ ft.

Purging Method: Submersible pump Bailer Centrifugal pump Other _____

Sampling Method: Disposable bailer Sampling port Samples collected _____

GROUND WATER EVACUATION/STABILIZATION DATA

Time	Temperature(°F)	pH units	Conductance (umnos/cm)	DTW (Nearest 0.01 ft)	Cumulative Volume of Water Removed From Well (gallons)
					1
					17
					34

Comments: Obstruction @ 14.9 feet, could not purge. Grab sample

Transportation(thermal preservation) _____

Form Completed By _____ Sampled By _____



SAMPLING INFORMATION SHEET

Well No. MW-4 Project Name RPMS 100877, Hayward Client Restructure Petroleum Marketing Services

Location (address) 525 West A Street, Hayward, California

Date Sampled 5/19/5

Well Depth 30 ft below top of casing Casing diameter 4 inches

DTW (below top of casing) 12.74 ft. Time: _____

DTP _____ ft.

Purging Method: Submersible pump Bailer Centrifugal pump Other _____

Sampling Method: Disposable bailer Sampling port Samples collected _____

GROUND WATER EVACUATION/STABILIZATION DATA

Time	Temperature(°F)	pH units	Conductance (umnos/cm)	DTW (Nearest 0.01 ft)	Cumulative Volume of Water Removed From Well (gallons)
12:54	19.4	6.84	1234		1
1259	19.1	6.86	1218		17
1:04	19.2	6.88	1215		34

Comments: _____

Transportation(thermal preservation) _____

Form Completed By _____ Sampled By _____



SAMPLING INFORMATION SHEET

Well No. MW-5 Project Name RPMS 100877, Hayward Client Restructure Petroleum Marketing Services

Location (address) 525 West A Street, Hayward, California

Date Sampled 5/19/15

Well Depth 30 ft below top of casing Casing diameter 4 inches

DTW (below top of casing) 12.48 ft. Time: _____

DTP _____ ft.

Purging Method: Submersible pump Bailer Centrifugal pump Other _____

Sampling Method: Disposable bailer Sampling port Samples collected _____

GROUND WATER EVACUATION/STABILIZATION DATA

Time	Temperature(°F)	pH units	Conductance (umnos/cm)	DTW (Nearest 0.01 ft)	Cumulative Volume of Water Removed From Well (gallons)
1:15	19.5	6.73	1202		1
1:20	19.9	6.70	1202		17
					34

Comments: _____

Transportation(thermal preservation) _____

Form Completed By _____ Sampled By _____



SAMPLING INFORMATION SHEET

Well No. MW-6 Project Name RPMS 100877, Hayward Client Restructure Petroleum Marketing Services

Location (address) 525 West A Street, Hayward, California

Date Sampled 5/19/05

Well Depth 30 ft below top of casing Casing diameter 4 inches

DTW (below top of casing) 12.61 ft. Time: _____

DTP _____ ft.

Purging Method: Submersible pump Bailer Centrifugal pump Other _____

Sampling Method: Disposable bailer Sampling port Samples collected _____

GROUND WATER EVACUATION/STABILIZATION DATA

Time	Temperature(°F)	pH units	Conductance (umnos/cm)	DTW (Nearest 0.01 ft)	Cumulative Volume of Water Removed From Well (gallons)
12:32	20.2	6.74	1277		1
12:37	20.5	6.68	1271		17
12:42	20.5	6.71	1267		34

Comments: _____

Transportation(thermal preservation) _____

Form Completed By _____ Sampled By _____



SAMPLING INFORMATION SHEET

Well No. MW-7 Project Name RPMS 100877, Hayward Client Restructure Petroleum Marketing Services

Location (address) 525 West A Street, Hayward, California

Date Sampled 5/19/05

Well Depth ~~33~~ 28.5 ft below top of casing Casing diameter 2 inches

DTW (below top of casing) 13.06 ft. Time: _____

DTP _____ ft.

Purging Method: Submersible pump Bailer Centrifugal pump Other _____

Sampling Method: Disposable bailer Sampling port Samples collected _____

GROUND WATER EVACUATION/STABILIZATION DATA

Time	Temperature(°F)	pH units	Conductance (umhos/cm)	DTW (Nearest 0.01 ft)	Cumulative Volume of Water Removed From Well (gallons)
	18.9	7.17	1102		1
	19.2	7.23	1227		3
	19.2	7.43	1227		6

Comments:

Well located behind lattice @ Trailer #13

Transportation(thermal preservation) _____

Form Completed By _____ Sampled By _____



SAMPLING INFORMATION SHEET

Well No. MW-8 Project Name RPMS 100877, Hayward Client Restructure Petroleum Marketing Services

Location (address) 525 West A Street, Hayward, California

Date Sampled / /

Well Depth ft below top of casing Casing diameter inches

DTW (below top of casing) ft. Time:

DTP ft.

Purging Method: Submersible pump Bailer Centrifugal pump Other

Sampling Method: Disposable bailer Sampling port Samples collected

GROUND WATER EVACUATION/STABILIZATION DATA

Time	Temperature(°F)	pH units	Conductance (umnos/cm)	DTW (Nearest 0.01 ft)	Cumulative Volume of Water Removed From Well (gallons)

Comments: Cannot locate. Paved Over?

Transportation(thermal preservation)

Form Completed By Sampled By



SAMPLING INFORMATION SHEET

Well No. MW-12 Project Name RPMS 100877, Hayward Client Restructure Petroleum Marketing Services

Location (address) 525 West A Street, Hayward, California

Date Sampled 5 / 19 / 05

Well Depth 29.7 ft below top of casing Casing diameter 2 inches

DTW (below top of casing) 13.80 ft. Time: _____

DTP _____ ft.

Purging Method: Submersible pump Baller Centrifugal pump Other _____

Sampling Method: Disposable bailer Sampling port Samples collected _____

GROUND WATER EVACUATION/STABILIZATION DATA

Time	Temperature(°F)	pH units	Conductance (umnos/cm)	DTW (Nearest 0.01 ft)	Cumulative Volume of Water Removed From Well (gallons)
10:55	20.5	6.71	727		1
10:57	19.7	6.73	733		4
10:59	19.5	6.71	733		8

Comments: _____

Transportation(thermal preservation) _____

Form Completed By _____ Sampled By _____



SAMPLING INFORMATION SHEET

Well No. MW-14 Project Name RPMS 100877, Hayward Client Restructure Petroleum Marketing Services

Location (address) 525 West A Street, Hayward, California

Date Sampled 5/19/05

Well Depth 30.1 ft below top of casing Casing diameter 2 inches

DTW (below top of casing) 13.71 ft. Time: _____

DTP _____ ft.

Purging Method: Submersible pump Bailer Centrifugal pump Other _____

Sampling Method: Disposable bailer Sampling port Samples collected _____

GROUND WATER EVACUATION/STABILIZATION DATA

Time	Temperature(°F)	pH units	Conductance (umhos/cm)	DTW (Nearest 0.01 ft)	Cumulative Volume of Water Removed From Well (gallons)
11:18	19.4	6.88	809		1
11:20	19.0	6.78	795		4
11:22	19.1	6.85	805		8

Comments: _____

Transportation(thermal preservation) _____

Form Completed By _____ Sampled By _____



SAMPLING INFORMATION SHEET

Well No. EX-1 Project Name RPMS 100877, Hayward Client Restructure Petroleum Marketing Services

Location (address) 525 West A Street, Hayward, California

Date Sampled 5/19/05

Well Depth 35.00 ft below top of casing Casing diameter 4 inches

DTW (below top of casing) 13.13 ft. Time: _____

DTP _____ ft.

Purging Method: Submersible pump Bailer Centrifugal pump Other _____

Sampling Method: Disposable bailer Sampling port Samples collected _____

GROUND WATER EVACUATION/STABILIZATION DATA

Time	Temperature(°F)	pH units	Conductance (umnos/cm)	DTW (Nearest 0.01 ft)	Cumulative Volume of Water Removed From Well (gallons)
11:51	21.0	6.74	1185		1
11:56	20.0	6.75	1143		25
12:01	20.0	6.77	1140		50
12:06	20.3	6.73	1151		75
12:11					95

Comments: _____

Transportation(thermal preservation) _____

Form Completed By _____ Sampled By _____



2795 2nd Street, Suite 300
 Davis, CA 95616
 Lab: 530.297.4800
 Fax: 530.297.4808

Lab No. _____

Page 1 of 2

Project Contact (Hardcopy or PDF To): Jim Brownell
 California EDF Report? Yes No

Company/Address: Delta Environmental
 Recommended but not mandatory to complete this section:
 Sampling Company Log Code: _____

Phone No.: _____ FAX No.: _____
(916) 638-2765 (916) 638-8385
 Project Number: _____ P.O. No.: _____
RPMS0877

Project Name: Restructure Petroleum - Hayward
 Project Address: 525 West A St. Hayward, CA
 EDF Deliverable To (Email Address): jmata@deltaenv.com
 Sampler Signature: Jason Mata

Chain-of-Custody Record and Analysis Request

Analysis Request

Sample Designation	Sampling		Container		Preservative				Matrix		BTEX (8021B)	BTEX/TPH Gas/MTBE (8021B/M8015)	TPH as Diesel (M8015)	TPH as Motor Oil (M8015)	TPH Gas/BTEX/MTBE (8260B)	5 Oxygenates/TPH Gas/BTEX (8260B)	7 Oxygenates/TPH Gas/BTEX (8260B)	5 Oxygenates (8260B)	7 Oxygenates (8260B)	Lead Scav. (1,2 DCA & 1,2 EDB - 8260B)	EPA 8260B (Full List)	Volatile Halocarbons (EPA 8260B)	Lead (7421/239.2) TOTAL (X) W.E.T. (X)	TAT	For Lab Use Only
	Date	Time	40 ml VOA	SLEEVE	HCl	HNO ₃	ICE	NONE	WATER	SOIL															
MW-1	5/19/05		3		X	X			X					X	DM									X	
MW-1A																									
MW-2																									
MW-3																									
MW-4																									
MW-5																									
MW-6																									
MW-7																									
MW-12																									
MW-14																									

Relinquished by: <u>Jason Mata</u>	Date: <u>5/20/05</u>	Time: <u>0900</u>	Received by: _____	Remarks:
Relinquished by: _____	Date: _____	Time: _____	Received by: _____	
Relinquished by: _____	Date: <u>052005</u>	Time: <u>0900</u>	Received by Laboratory: <u>Wesley W. Schannus</u> <u>1549 Main St. Davis, CA</u>	
Bill to:				



2795 2nd Street, Suite 300
 Davis, CA 95616
 Lab: 530.297.4800
 Fax: 530.297.4808

Lab No. _____

Page 2 of 2

Project Contact (Hardcopy or PDF To): Jim Brownell
 California EDF Report? Yes No

Chain-of-Custody Record and Analysis Request

Company/Address: Delta Environmental
 Recommended but not mandatory to complete this section:
 Sampling Company Log Code: _____

Phone No.: (916) 638-2765 FAX No.: (916) 638-8385
 Project Number: RPMS0877 P.O. No.: _____
 Global ID: _____
 EDF Deliverable To (Email Address): j.mata@deltaenv.com

Project Name: RPMS - Hayward
 Project Address: 525 West A St
 Hayward, CA
 Sampler Signature: Jason Mata

Analysis Request

Sample Designation	Sampling		40 ml VOA	Container				Preservative				Matrix		BTEX (8021B)	BTEX/TPH Gas/MTBE (8021B/M8015)	TPH as Diesel (M8015)	TPH as Motor Oil (M8015)	TPH Gas/BTEX/MTBE (8260B)	5 Oxygenates/TPH Gas/BTEX (8260B)	7 Oxygenates/TPH Gas/BTEX (8260B)	5 Oxygenates (8260B)	7 Oxygenates (8260B)	Lead Scav. (1,2 DCA & 1,2 EDB - 8260B)	EPA 8260B (Full List)	Volatile Halocarbons (EPA 8260B)	Lead (7421/239.2) TOTAL (X) W.E.T. (X)	TAT	For Lab Use Only		
	Date	Time		SLEEVE		HCl	HNO ₃	ICE	NONE	WATER	SOIL																			
EX-1	5/19/05		3			X	X			X								X										X		

Relinquished by: Jason Mata Date: 5/20/05 Time: 0900 Received by: _____
 Relinquished by: _____ Date: _____ Time: _____ Received by: _____
 Relinquished by: _____ Date: 052005 Time: 0900 Received by Laboratory: MELAN WILKINSON
KIFF ANALYTICAL LLC Bill to: _____



Report Number : 43909

Date : 5/27/2005

Jim Brownell
Delta Environmental Consultants, Inc.
3164 Gold Camp Drive, Suite 200
Rancho Cordova, CA 95670

Subject : 11 Water Samples
Project Name : Restructure Petroleum - Hayward
Project Number : RPMS0877

Dear Mr. Brownell,

Chemical analysis of the samples referenced above has been completed. Summaries of the data are contained on the following pages. Sample(s) were received under documented chain-of-custody. US EPA protocols for sample storage and preservation were followed.

Kiff Analytical is certified by the State of California (# 2236). If you have any questions regarding procedures or results, please call me at 530-297-4800.

Sincerely,

A handwritten signature in black ink, appearing to read "Joel Kiff".

Joel Kiff



Report Number : 43909

Date : 5/27/2005

Subject : 11 Water Samples
Project Name : Restructure Petroleum - Hayward
Project Number : RPMS0877

Case Narrative

Matrix Spike/Matrix Spike Duplicate Results associated with sample MW-1 for the analyte Methyl-t-butyl ether were affected by the analyte concentrations already present in the un-spiked sample.

Approved By:

Joel Kiff



Report Number : 43909

Date : 5/27/2005

Project Name : **Restructure Petroleum - Hayward**

Project Number : **RPMS0877**

Sample : **MW-1**

Matrix : Water

Lab Number : 43909-01

Sample Date :5/19/2005

Parameter	Measured Value	Method Reporting Limit	Units	Analysis Method	Date Analyzed
Benzene	610	1.5	ug/L	EPA 8260B	5/27/2005
Toluene	12	1.5	ug/L	EPA 8260B	5/27/2005
Ethylbenzene	370	1.5	ug/L	EPA 8260B	5/27/2005
Total Xylenes	140	1.5	ug/L	EPA 8260B	5/27/2005
Methyl-t-butyl ether (MTBE)	20	1.5	ug/L	EPA 8260B	5/27/2005
Dilsopropyl ether (DIPE)	< 1.5	1.5	ug/L	EPA 8260B	5/27/2005
Ethyl-t-butyl ether (ETBE)	< 1.5	1.5	ug/L	EPA 8260B	5/27/2005
Tert-amyl methyl ether (TAME)	< 1.5	1.5	ug/L	EPA 8260B	5/27/2005
Tert-Butanol	11	7.0	ug/L	EPA 8260B	5/27/2005
TPH as Gasoline	7500	150	ug/L	EPA 8260B	5/27/2005
Toluene - d8 (Surr)	99.6		% Recovery	EPA 8260B	5/27/2005
4-Bromofluorobenzene (Surr)	105		% Recovery	EPA 8260B	5/27/2005

Approved By:

Joel Kiff



Report Number : 43909

Date : 5/27/2005

Project Name : **Restructure Petroleum - Hayward**

Project Number : **RPMS0877**

Sample : **MW-1A**

Matrix : Water

Lab Number : 43909-02

Sample Date :5/19/2005

Parameter	Measured Value	Method Reporting Limit	Units	Analysis Method	Date Analyzed
Benzene	3.1	1.5	ug/L	EPA 8260B	5/26/2005
Toluene	1.7	1.5	ug/L	EPA 8260B	5/26/2005
Ethylbenzene	190	1.5	ug/L	EPA 8260B	5/26/2005
Total Xylenes	50	1.5	ug/L	EPA 8260B	5/26/2005
Methyl-t-butyl ether (MTBE)	< 1.5	1.5	ug/L	EPA 8260B	5/26/2005
Diisopropyl ether (DIPE)	< 1.5	1.5	ug/L	EPA 8260B	5/26/2005
Ethyl-t-butyl ether (ETBE)	< 1.5	1.5	ug/L	EPA 8260B	5/26/2005
Tert-amyl methyl ether (TAME)	< 1.5	1.5	ug/L	EPA 8260B	5/26/2005
Tert-Butanol	< 7.0	7.0	ug/L	EPA 8260B	5/26/2005
TPH as Gasoline	13000	250	ug/L	EPA 8260B	5/27/2005
Toluene - d8 (Surr)	99.7		% Recovery	EPA 8260B	5/26/2005
4-Bromofluorobenzene (Surr)	98.3		% Recovery	EPA 8260B	5/26/2005

Approved By:

Joel Kiff



Report Number : 43909

Date : 5/27/2005

Project Name : **Restructure Petroleum - Hayward**

Project Number : **RPMS0877**

Sample : **MW-2**

Matrix : Water

Lab Number : 43909-03

Sample Date :5/19/2005

Parameter	Measured Value	Method Reporting Limit	Units	Analysis Method	Date Analyzed
Benzene	300	2.5	ug/L	EPA 8260B	5/26/2005
Toluene	3.6	2.5	ug/L	EPA 8260B	5/26/2005
Ethylbenzene	770	2.5	ug/L	EPA 8260B	5/26/2005
Total Xylenes	1200	2.5	ug/L	EPA 8260B	5/26/2005
Methyl-t-butyl ether (MTBE)	9.2	2.5	ug/L	EPA 8260B	5/26/2005
Diisopropyl ether (DIPE)	< 2.5	2.5	ug/L	EPA 8260B	5/26/2005
Ethyl-t-butyl ether (ETBE)	< 2.5	2.5	ug/L	EPA 8260B	5/26/2005
Tert-amyl methyl ether (TAME)	< 2.5	2.5	ug/L	EPA 8260B	5/26/2005
Tert-Butanol	< 15	15	ug/L	EPA 8260B	5/26/2005
TPH as Gasoline	15000	250	ug/L	EPA 8260B	5/26/2005
Toluene - d8 (Surr)	106		% Recovery	EPA 8260B	5/26/2005
4-Bromofluorobenzene (Surr)	97.7		% Recovery	EPA 8260B	5/26/2005

Approved By:

Joel Kiff



Report Number : 43909

Date : 5/27/2005

Project Name : **Restructure Petroleum - Hayward**

Project Number : **RPMS0877**

Sample : **MW-3**

Matrix : Water

Lab Number : 43909-04

Sample Date :5/19/2005

Parameter	Measured Value	Method Reporting Limit	Units	Analysis Method	Date Analyzed
Benzene	< 0.50	0.50	ug/L	EPA 8260B	5/25/2005
Toluene	< 0.50	0.50	ug/L	EPA 8260B	5/25/2005
Ethylbenzene	< 0.50	0.50	ug/L	EPA 8260B	5/25/2005
Total Xylenes	< 0.50	0.50	ug/L	EPA 8260B	5/25/2005
Methyl-t-butyl ether (MTBE)	< 0.50	0.50	ug/L	EPA 8260B	5/25/2005
Diisopropyl ether (DIPE)	< 0.50	0.50	ug/L	EPA 8260B	5/25/2005
Ethyl-t-butyl ether (ETBE)	< 0.50	0.50	ug/L	EPA 8260B	5/25/2005
Tert-amyl methyl ether (TAME)	< 0.50	0.50	ug/L	EPA 8260B	5/25/2005
Tert-Butanol	< 5.0	5.0	ug/L	EPA 8260B	5/25/2005
TPH as Gasoline	< 50	50	ug/L	EPA 8260B	5/25/2005
Toluene - d8 (Surr)	106		% Recovery	EPA 8260B	5/25/2005
4-Bromofluorobenzene (Surr)	92.9		% Recovery	EPA 8260B	5/25/2005

Approved By:

Joel Kiff



Report Number : 43909

Date : 5/27/2005

Project Name : **Restructure Petroleum - Hayward**

Project Number : **RPMS0877**

Sample : **MW-4**

Matrix : Water

Lab Number : 43909-05

Sample Date :5/19/2005

Parameter	Measured Value	Method Reporting Limit	Units	Analysis Method	Date Analyzed
Benzene	480	4.0	ug/L	EPA 8260B	5/26/2005
Toluene	76	4.0	ug/L	EPA 8260B	5/26/2005
Ethylbenzene	1100	4.0	ug/L	EPA 8260B	5/26/2005
Total Xylenes	1600	4.0	ug/L	EPA 8260B	5/26/2005
Methyl-t-butyl ether (MTBE)	14	4.0	ug/L	EPA 8260B	5/26/2005
Diisopropyl ether (DIPE)	< 4.0	4.0	ug/L	EPA 8260B	5/26/2005
Ethyl-t-butyl ether (ETBE)	< 4.0	4.0	ug/L	EPA 8260B	5/26/2005
Tert-amyl methyl ether (TAME)	< 4.0	4.0	ug/L	EPA 8260B	5/26/2005
Tert-Butanol	< 20	20	ug/L	EPA 8260B	5/26/2005
TPH as Gasoline	15000	400	ug/L	EPA 8260B	5/26/2005
Toluene - d8 (Surr)	105		% Recovery	EPA 8260B	5/26/2005
4-Bromofluorobenzene (Surr)	95.3		% Recovery	EPA 8260B	5/26/2005

Approved By:

Joel Kiff



Report Number : 43909

Date : 5/27/2005

Project Name : **Restructure Petroleum - Hayward**

Project Number : **RPMS0877**

Sample : **MW-5**

Matrix : Water

Lab Number : 43909-06

Sample Date :5/19/2005

Parameter	Measured Value	Method Reporting Limit	Units	Analysis Method	Date Analyzed
Benzene	32	0.50	ug/L	EPA 8260B	5/24/2005
Toluene	0.61	0.50	ug/L	EPA 8260B	5/24/2005
Ethylbenzene	66	0.50	ug/L	EPA 8260B	5/24/2005
Total Xylenes	4.4	0.50	ug/L	EPA 8260B	5/24/2005
Methyl-t-butyl ether (MTBE)	1.0	0.50	ug/L	EPA 8260B	5/24/2005
Diisopropyl ether (DIPE)	< 0.50	0.50	ug/L	EPA 8260B	5/24/2005
Ethyl-t-butyl ether (ETBE)	< 0.50	0.50	ug/L	EPA 8260B	5/24/2005
Tert-amyl methyl ether (TAME)	< 0.50	0.50	ug/L	EPA 8260B	5/24/2005
Tert-Butanol	< 5.0	5.0	ug/L	EPA 8260B	5/24/2005
TPH as Gasoline	3800	50	ug/L	EPA 8260B	5/24/2005
Toluene - d8 (Surr)	96.5		% Recovery	EPA 8260B	5/24/2005
4-Bromofluorobenzene (Surr)	103		% Recovery	EPA 8260B	5/24/2005

Approved By:

Joel Kiff



Report Number : 43909

Date : 5/27/2005

Project Name : **Restructure Petroleum - Hayward**

Project Number : **RPMS0877**

Sample : **MW-6**

Matrix : Water

Lab Number : 43909-07

Sample Date :5/19/2005

Parameter	Measured Value	Method Reporting Limit	Units	Analysis Method	Date Analyzed
Benzene	7.5	0.50	ug/L	EPA 8260B	5/26/2005
Toluene	2.2	0.50	ug/L	EPA 8260B	5/26/2005
Ethylbenzene	54	0.50	ug/L	EPA 8260B	5/26/2005
Total Xylenes	12	0.50	ug/L	EPA 8260B	5/26/2005
Methyl-t-butyl ether (MTBE)	3.1	0.50	ug/L	EPA 8260B	5/26/2005
Diisopropyl ether (DIPE)	< 0.50	0.50	ug/L	EPA 8260B	5/26/2005
Ethyl-t-butyl ether (ETBE)	< 0.50	0.50	ug/L	EPA 8260B	5/26/2005
Tert-amyl methyl ether (TAME)	< 0.50	0.50	ug/L	EPA 8260B	5/26/2005
Tert-Butanol	< 5.0	5.0	ug/L	EPA 8260B	5/26/2005
TPH as Gasoline	3800	50	ug/L	EPA 8260B	5/26/2005
Toluene - d8 (Surr)	97.6		% Recovery	EPA 8260B	5/26/2005
4-Bromofluorobenzene (Surr)	106		% Recovery	EPA 8260B	5/26/2005

Approved By:

Joel Kiff



Report Number : 43909

Date : 5/27/2005

Project Name : **Restructure Petroleum - Hayward**

Project Number : **RPMS0877**

Sample : **MW-7**

Matrix : Water

Lab Number : 43909-08

Sample Date :5/19/2005

Parameter	Measured Value	Method Reporting Limit	Units	Analysis Method	Date Analyzed
Benzene	< 0.50	0.50	ug/L	EPA 8260B	5/26/2005
Toluene	< 0.50	0.50	ug/L	EPA 8260B	5/26/2005
Ethylbenzene	1.8	0.50	ug/L	EPA 8260B	5/26/2005
Total Xylenes	< 0.50	0.50	ug/L	EPA 8260B	5/26/2005
Methyl-t-butyl ether (MTBE)	< 0.50	0.50	ug/L	EPA 8260B	5/26/2005
Diisopropyl ether (DIPE)	< 0.50	0.50	ug/L	EPA 8260B	5/26/2005
Ethyl-t-butyl ether (ETBE)	< 0.50	0.50	ug/L	EPA 8260B	5/26/2005
Tert-amyl methyl ether (TAME)	< 0.50	0.50	ug/L	EPA 8260B	5/26/2005
Tert-Butanol	< 5.0	5.0	ug/L	EPA 8260B	5/26/2005
TPH as Gasoline	660	50	ug/L	EPA 8260B	5/26/2005
Toluene - d8 (Surr)	97.9		% Recovery	EPA 8260B	5/26/2005
4-Bromofluorobenzene (Surr)	103		% Recovery	EPA 8260B	5/26/2005

Approved By:

Joel Kiff



Report Number : 43909

Date : 5/27/2005

Project Name : **Restructure Petroleum - Hayward**

Project Number : **RPMS0877**

Sample : **MW-12**

Matrix : Water

Lab Number : 43909-09

Sample Date :5/19/2005

Parameter	Measured Value	Method Reporting Limit	Units	Analysis Method	Date Analyzed
Benzene	< 0.50	0.50	ug/L	EPA 8260B	5/26/2005
Toluene	< 0.50	0.50	ug/L	EPA 8260B	5/26/2005
Ethylbenzene	< 0.50	0.50	ug/L	EPA 8260B	5/26/2005
Total Xylenes	< 0.50	0.50	ug/L	EPA 8260B	5/26/2005
Methyl-t-butyl ether (MTBE)	< 0.50	0.50	ug/L	EPA 8260B	5/26/2005
Diisopropyl ether (DIPE)	< 0.50	0.50	ug/L	EPA 8260B	5/26/2005
Ethyl-t-butyl ether (ETBE)	< 0.50	0.50	ug/L	EPA 8260B	5/26/2005
Tert-amyl methyl ether (TAME)	< 0.50	0.50	ug/L	EPA 8260B	5/26/2005
Tert-Butanol	< 5.0	5.0	ug/L	EPA 8260B	5/26/2005
TPH as Gasoline	< 50	50	ug/L	EPA 8260B	5/26/2005
Toluene - d8 (Surr)	96.6		% Recovery	EPA 8260B	5/26/2005
4-Bromofluorobenzene (Surr)	103		% Recovery	EPA 8260B	5/26/2005

Approved By:

Joel Kiff



Report Number : 43909

Date : 5/27/2005

Project Name : **Restructure Petroleum - Hayward**

Project Number : **RPMS0877**

Sample : **MW-14**

Matrix : Water

Lab Number : 43909-10

Sample Date :5/19/2005

Parameter	Measured Value	Method Reporting Limit	Units	Analysis Method	Date Analyzed
Benzene	< 0.50	0.50	ug/L	EPA 8260B	5/26/2005
Toluene	< 0.50	0.50	ug/L	EPA 8260B	5/26/2005
Ethylbenzene	0.72	0.50	ug/L	EPA 8260B	5/26/2005
Total Xylenes	< 0.50	0.50	ug/L	EPA 8260B	5/26/2005
Methyl-t-butyl ether (MTBE)	< 0.50	0.50	ug/L	EPA 8260B	5/26/2005
Diisopropyl ether (DIPE)	< 0.50	0.50	ug/L	EPA 8260B	5/26/2005
Ethyl-t-butyl ether (ETBE)	< 0.50	0.50	ug/L	EPA 8260B	5/26/2005
Tert-amyl methyl ether (TAME)	< 0.50	0.50	ug/L	EPA 8260B	5/26/2005
Tert-Butanol	< 5.0	5.0	ug/L	EPA 8260B	5/26/2005
TPH as Gasoline	230	50	ug/L	EPA 8260B	5/26/2005
Toluene - d8 (Surr)	97.4		% Recovery	EPA 8260B	5/26/2005
4-Bromofluorobenzene (Surr)	103		% Recovery	EPA 8260B	5/26/2005

Approved By:

Joel Kiff



Report Number : 43909

Date : 5/27/2005

Project Name : **Restructure Petroleum - Hayward**

Project Number : **RPMS0877**

Sample : **EX-1**

Matrix : **Water**

Lab Number : **43909-11**

Sample Date : **5/19/2005**

Parameter	Measured Value	Method Reporting Limit	Units	Analysis Method	Date Analyzed
Benzene	3.4	0.50	ug/L	EPA 8260B	5/26/2005
Toluene	< 0.50	0.50	ug/L	EPA 8260B	5/26/2005
Ethylbenzene	3.7	0.50	ug/L	EPA 8260B	5/26/2005
Total Xylenes	1.8	0.50	ug/L	EPA 8260B	5/26/2005
Methyl-t-butyl ether (MTBE)	1.3	0.50	ug/L	EPA 8260B	5/26/2005
Diisopropyl ether (DIPE)	< 0.50	0.50	ug/L	EPA 8260B	5/26/2005
Ethyl-t-butyl ether (ETBE)	< 0.50	0.50	ug/L	EPA 8260B	5/26/2005
Tert-amyl methyl ether (TAME)	< 0.50	0.50	ug/L	EPA 8260B	5/26/2005
Tert-Butanol	< 5.0	5.0	ug/L	EPA 8260B	5/26/2005
TPH as Gasoline	200	50	ug/L	EPA 8260B	5/26/2005
Toluene - d8 (Surr)	97.4		% Recovery	EPA 8260B	5/26/2005
4-Bromofluorobenzene (Surr)	104		% Recovery	EPA 8260B	5/26/2005

Approved By:

Joel Kiff

QC Report : Method Blank Data

Project Name : **Restructure Petroleum - Hayward**

Project Number : **RPMS0877**

Parameter	Measured Value	Method Reporting Limit	Units	Analysis Method	Date Analyzed
Benzene	< 0.50	0.50	ug/L	EPA 8260B	5/25/2005
Toluene	< 0.50	0.50	ug/L	EPA 8260B	5/25/2005
Ethylbenzene	< 0.50	0.50	ug/L	EPA 8260B	5/25/2005
Total Xylenes	< 0.50	0.50	ug/L	EPA 8260B	5/25/2005
Methyl-t-butyl ether (MTBE)	< 0.50	0.50	ug/L	EPA 8260B	5/25/2005
Diisopropyl ether (DIPE)	< 0.50	0.50	ug/L	EPA 8260B	5/25/2005
Ethyl-t-butyl ether (ETBE)	< 0.50	0.50	ug/L	EPA 8260B	5/25/2005
Tert-amyl methyl ether (TAME)	< 0.50	0.50	ug/L	EPA 8260B	5/25/2005
Tert-Butanol	< 5.0	5.0	ug/L	EPA 8260B	5/25/2005
TPH as Gasoline	< 50	50	ug/L	EPA 8260B	5/25/2005
Toluene - d8 (Surr)	107		%	EPA 8260B	5/25/2005
4-Bromofluorobenzene (Surr)	94.3		%	EPA 8260B	5/25/2005
Benzene	< 0.50	0.50	ug/L	EPA 8260B	5/24/2005
Toluene	< 0.50	0.50	ug/L	EPA 8260B	5/24/2005
Ethylbenzene	< 0.50	0.50	ug/L	EPA 8260B	5/24/2005
Total Xylenes	< 0.50	0.50	ug/L	EPA 8260B	5/24/2005
Methyl-t-butyl ether (MTBE)	< 0.50	0.50	ug/L	EPA 8260B	5/24/2005
Diisopropyl ether (DIPE)	< 0.50	0.50	ug/L	EPA 8260B	5/24/2005
Ethyl-t-butyl ether (ETBE)	< 0.50	0.50	ug/L	EPA 8260B	5/24/2005
Tert-amyl methyl ether (TAME)	< 0.50	0.50	ug/L	EPA 8260B	5/24/2005
Tert-Butanol	< 5.0	5.0	ug/L	EPA 8260B	5/24/2005
TPH as Gasoline	< 50	50	ug/L	EPA 8260B	5/24/2005
Toluene - d8 (Surr)	101		%	EPA 8260B	5/24/2005
4-Bromofluorobenzene (Surr)	102		%	EPA 8260B	5/24/2005

Parameter	Measured Value	Method Reporting Limit	Units	Analysis Method	Date Analyzed
Benzene	< 0.50	0.50	ug/L	EPA 8260B	5/26/2005
Toluene	< 0.50	0.50	ug/L	EPA 8260B	5/26/2005
Ethylbenzene	< 0.50	0.50	ug/L	EPA 8260B	5/26/2005
Total Xylenes	< 0.50	0.50	ug/L	EPA 8260B	5/26/2005
Methyl-t-butyl ether (MTBE)	< 0.50	0.50	ug/L	EPA 8260B	5/26/2005
Diisopropyl ether (DIPE)	< 0.50	0.50	ug/L	EPA 8260B	5/26/2005
Ethyl-t-butyl ether (ETBE)	< 0.50	0.50	ug/L	EPA 8260B	5/26/2005
Tert-amyl methyl ether (TAME)	< 0.50	0.50	ug/L	EPA 8260B	5/26/2005
Tert-Butanol	< 5.0	5.0	ug/L	EPA 8260B	5/26/2005
TPH as Gasoline	< 50	50	ug/L	EPA 8260B	5/26/2005
Toluene - d8 (Surr)	101		%	EPA 8260B	5/26/2005
4-Bromofluorobenzene (Surr)	103		%	EPA 8260B	5/26/2005
Benzene	< 0.50	0.50	ug/L	EPA 8260B	5/26/2005
Toluene	< 0.50	0.50	ug/L	EPA 8260B	5/26/2005
Ethylbenzene	< 0.50	0.50	ug/L	EPA 8260B	5/26/2005
Total Xylenes	< 0.50	0.50	ug/L	EPA 8260B	5/26/2005
Methyl-t-butyl ether (MTBE)	< 0.50	0.50	ug/L	EPA 8260B	5/26/2005
Diisopropyl ether (DIPE)	< 0.50	0.50	ug/L	EPA 8260B	5/26/2005
Ethyl-t-butyl ether (ETBE)	< 0.50	0.50	ug/L	EPA 8260B	5/26/2005
Tert-amyl methyl ether (TAME)	< 0.50	0.50	ug/L	EPA 8260B	5/26/2005
Tert-Butanol	< 5.0	5.0	ug/L	EPA 8260B	5/26/2005
TPH as Gasoline	< 50	50	ug/L	EPA 8260B	5/26/2005
Toluene - d8 (Surr)	97.3		%	EPA 8260B	5/26/2005
4-Bromofluorobenzene (Surr)	103		%	EPA 8260B	5/26/2005

Approved By:  Joel Kiff

KIFF ANALYTICAL, LLC

2795 2nd St, Suite 300 Davis, CA 95616 530-297-4800

Report Number : 43909

Date : 5/27/2005

QC Report : Matrix Spike/ Matrix Spike Duplicate

Project Name : Restructure Petroleum -

Project Number : RPMS0877

Parameter	Spiked Sample	Sample Value	Spike Level	Spike Dup. Level	Spiked Sample Value	Duplicate Spiked Sample Value	Units	Analysis Method	Date Analyzed	Spiked Sample Percent Recov.	Duplicate Spiked Sample Percent Recov.	Relative Percent Diff.	Spiked Sample Recov. Limit	Relative Percent Diff. Limit
Benzene	43909-04	<0.50	39.8	39.7	44.5	44.0	ug/L	EPA 8260B	5/25/05	112	111	0.990	70-130	25
Toluene	43909-04	<0.50	39.8	39.7	46.5	46.2	ug/L	EPA 8260B	5/25/05	117	116	0.460	70-130	25
Tert-Butanol	43909-04	<5.0	199	198	208	205	ug/L	EPA 8260B	5/25/05	105	104	1.23	70-130	25
Methyl-t-Butyl Ether	43909-04	<0.50	39.8	39.7	34.9	35.4	ug/L	EPA 8260B	5/25/05	87.8	89.3	1.71	70-130	25
Benzene	43909-06	32	40.0	40.0	68.2	66.8	ug/L	EPA 8260B	5/25/05	90.5	87.1	3.89	70-130	25
Toluene	43909-06	0.61	40.0	40.0	38.6	38.3	ug/L	EPA 8260B	5/25/05	95.0	94.2	0.825	70-130	25
Tert-Butanol	43909-06	<5.0	200	200	197	202	ug/L	EPA 8260B	5/25/05	98.6	101	2.30	70-130	25
Methyl-t-Butyl Ether	43909-06	1.0	40.0	40.0	35.2	34.8	ug/L	EPA 8260B	5/25/05	85.5	84.5	1.15	70-130	25
Benzene	43949-01	<0.50	40.0	40.0	41.9	40.0	ug/L	EPA 8260B	5/27/05	105	100	4.61	70-130	25
Toluene	43949-01	<0.50	40.0	40.0	36.3	34.9	ug/L	EPA 8260B	5/27/05	90.7	87.4	3.74	70-130	25
Tert-Butanol	43949-01	73	200	200	280	281	ug/L	EPA 8260B	5/27/05	103	104	0.382	70-130	25
Methyl-t-Butyl Ether	43949-01	240	40.0	40.0	267	260	ug/L	EPA 8260B	5/27/05	76.5	60.2	23.9	70-130	25
Benzene	43887-03	<0.50	40.0	40.0	38.3	37.7	ug/L	EPA 8260B	5/26/05	95.8	94.2	1.66	70-130	25
Toluene	43887-03	4.6	40.0	40.0	41.6	40.6	ug/L	EPA 8260B	5/26/05	92.5	90.1	2.66	70-130	25
Tert-Butanol	43887-03	<5.0	200	200	187	186	ug/L	EPA 8260B	5/26/05	93.7	92.8	0.954	70-130	25
Methyl-t-Butyl Ether	43887-03	<0.50	40.0	40.0	38.0	38.1	ug/L	EPA 8260B	5/26/05	94.9	95.2	0.236	70-130	25

KIFF ANALYTICAL, LLC

2795 2nd St, Suite 300 Davis, CA 95616 530-297-4800

Approved By:  Joel Kiff

Report Number : 43909

Date : 5/27/2005

QC Report : Laboratory Control Sample (LCS)

Project Name : **Restructure Petroleum -**

Project Number : **RPMS0877**

Parameter	Spike Level	Units	Analysis Method	Date Analyzed	LCS Percent Recov.	LCS Percent Recov. Limit
Benzene	40.0	ug/L	EPA 8260B	5/25/05	111	70-130
Toluene	40.0	ug/L	EPA 8260B	5/25/05	116	70-130
Tert-Butanol	200	ug/L	EPA 8260B	5/25/05	104	70-130
Methyl-t-Butyl Ether	40.0	ug/L	EPA 8260B	5/25/05	89.6	70-130
Benzene	40.0	ug/L	EPA 8260B	5/24/05	99.2	70-130
Toluene	40.0	ug/L	EPA 8260B	5/24/05	101	70-130
Tert-Butanol	200	ug/L	EPA 8260B	5/24/05	98.9	70-130
Methyl-t-Butyl Ether	40.0	ug/L	EPA 8260B	5/24/05	98.2	70-130
Benzene	40.0	ug/L	EPA 8260B	5/26/05	95.2	70-130
Toluene	40.0	ug/L	EPA 8260B	5/26/05	86.4	70-130
Tert-Butanol	200	ug/L	EPA 8260B	5/26/05	96.3	70-130
Methyl-t-Butyl Ether	40.0	ug/L	EPA 8260B	5/26/05	93.0	70-130
Benzene	40.0	ug/L	EPA 8260B	5/26/05	99.2	70-130
Toluene	40.0	ug/L	EPA 8260B	5/26/05	99.6	70-130
Tert-Butanol	200	ug/L	EPA 8260B	5/26/05	101	70-130
Methyl-t-Butyl Ether	40.0	ug/L	EPA 8260B	5/26/05	102	70-130

KIFF ANALYTICAL, LLC

Approved By:



 Joel Kiff

2795 2nd St, Suite 300 Davis, CA 95616 530-297-4800



2795 2nd Street, Suite 300
 Davis, CA 95616
 Lab: 530.297.4800
 Fax: 530.297.4808

Lab No. 43909 Page 1 of 2

Project Contact (Hardcopy or PDF To): Jim Brownell California EDF Report? Yes No

Chain-of-Custody Record and Analysis Request

Company/Address: Delta Environmental
 Recommended but not mandatory to complete this section:
 Sampling Company Log Code: _____

Phone No.: (916) 638-2765 FAX No.: (916) 638-8385 Global ID: _____

Project Number: RPMS0817 P.O. No.: _____ EDF Deliverable To (Email Address): jmata@deltabenv.com

Project Name: Restructure Petroleum - Hayward Sampler Signature: Joson Mata

Project Address: 525 West A St. Hayward, CA

Sample Designation	Sampling		Container				Preservative				Matrix		BTEX (8021B)	BTEX/TPH Gas/MTBE (8021B/M8015)	TPH as Diesel (M8015)	TPH as Motor Oil (M8015)	TPH Gas/BTEX/MTBE (8260B)	6 Oxygenates/TPH Gas/BTEX (8260B)	7 Oxygenates/TPH Gas/BTEX (8260B)	5 Oxygenates (8260B)	7 Oxygenates (8260B)	Lead Scav. (1,2 DCA & 1,2 EDB - 8260B)	EPA 8260B (Full List)	Volatile Halocarbons (EPA 8260B)	Lead (7421/239.2) TOTAL (X) WET (X)	TAT	For Lab Use Only		
	Date	Time	40 ml VOA	SLEEVE	ICI	HNO ₃	ICE	NONE	WATER	SOIL																			
MW-1	5/19/05		3		X	X				X							X											X	01
MW-1A																													02
MW-2																													03
MW-3																													04
MW-4																													05
MW-5																													06
MW-6																													07
MW-7																													08
MW-12																													09
MW-14																													10

Relinquished by: <u>Joson Mata</u>	Date: <u>5/20/05</u>	Time: <u>0900</u>	Received by:
Relinquished by: /	Date: _____	Time: _____	Received by: /
Relinquished by: /	Date: <u>052005</u>	Time: <u>0900</u>	Received by Laboratory: <u>Melissa W. Schannus 1577 Analytical Co</u>

Remarks: _____
 Bill to: _____

Distribution: White - Lab, Pink - Originator

Sample Receipt: - 0^c mlw 052005 0900 12.4 coolant present
 mlw



2795 2nd Street, Suite 300
 Davis, CA 95616
 Lab: 530.297.4800
 Fax: 530.297.4808

Lab No. ~~43958 RT~~ ⁴³⁹⁰⁹ ₀₅₂₀₀₅ Page 2 of 2

Project Contact (Hardcopy or PDF To): Jim Brownell California EDF Report? Yes No

Chain-of-Custody Record and Analysis Request

Company/Address: Delta Environmental Recommended but not mandatory to complete this section: Sampling Company Log Code:

Analysis Request

Phone No.: (916) 638-2765 FAX No.: (916) 638-8385 Global ID:
 Project Number: RPMS0877 P.O. No: EDF Deliverable To (Email Address): jmata@deltaenv.com

Project Name: RPMS- Hayward Sampler Signature: Jason Mata

Project Address: 525 West A St Hayward, CA

Sample Designation: EX-1

Date	Time	Sampling				Container				Preservative				Matrix		BTEX (8021B)	BTEX/TPH Gas/MTBE (8021B/M8015)	TPH as Diesel (M8015)	TPH as Motor Oil (M8015)	TPH Gas/BTEX/MTBE (8260B)	5 Oxygenates/TPH Gas/BTEX (8260B)	7 Oxygenates/TPH Gas/BTEX (8260B)	5 Oxygenates (8260B)	7 Oxygenates (8260B)	Lead Scav. (1,2 DCA & 1,2 EOB - 8260B)	EPA 8260B (Full List)	Volatile Halocarbons (EPA 8260B)	Lead (7421/239.2) TOTAL (X) W.E.T. (X)	TAT	12 hr / 24 hr / 48 hr / 72 hr / 96 hr	For Lab Use Only						
		40 ml VOA	SLEEVE			HCl	HNO ₃	ICE	NONE	WATER	SOIL																										
5/19/05		3								X	X			X					X																X		

Relinquished by: Jason Mata Date: 5/20/05 Time: 0900 Received by: [Signature]
 Relinquished by: [Signature] Date: Time: Received by: [Signature]
 Relinquished by: [Signature] Date: 052005 Time: 0900 Received by Laboratory: Maxim W. Vachanis KIFF Analytical LLC

Remarks:
 Bill to:

Distribution: White - Lab, Pink - Originator

Sample Receipt: -0°C min 052005 ¹²⁻⁴ ₀₉₀₀ ~~0900~~ coolant present