

STID 357C

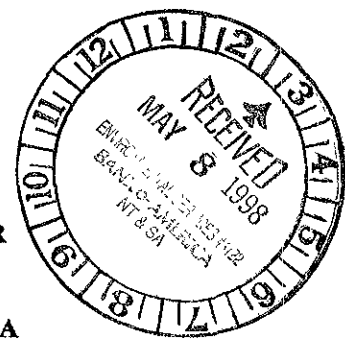

SOIL AND GROUNDWATER
CHARACTERIZATION
2585 NICHOLSON ST
SAN LEANDRO, CALIFORNIA

May 1, 1998

Prepared for:
Bank of America, NT&SA
ES# 305582

Prepared by:
McLaren/Hart Incorporated
~~1135 Atlantic Avenue~~
Alameda, California 94501
(510) 521-5200

132-0 Harbor Bay
Alameda

Project No. 04.0602457001.001

Prepared by:

Scott Allin
Senior Geoscientist

Reviewed by:

Brad Wright, R.G.
Supervising Geoscientist

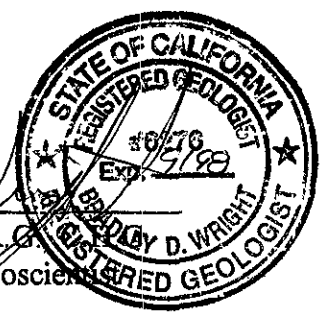

Any Unauthorized Dissemination Or Reuse Of This Document Will Be At The User's Sole Risk And With The Condition That McLaren/Hart Be Held Harmless From Any And All Claims For Losses Or Damages And Expenses Arising Out Of Or Resulting From Such Unauthorized Disclosure Or Reuse.



TABLE OF CONTENTS

1.0	INTRODUCTION	1-1
1.1	Background	1-1
2.0	SOIL AND GROUNDWATER CHARACTERIZATION	2-1
2.1	Methodology	2-1
2.2	Initial Characterization (HA Work Plan)	2-1
2.3	Supplemental Characterization (MH Work Plan)	2-2
3.0	CONCLUSIONS	3-1

LIST OF FIGURES

- FIGURE 1: SITE LOCATION MAP
- FIGURE 2: BENZENE ISOCONCENTRATION CONTOURS

LIST OF TABLES

- TABLE 1: SOIL ANALYTICAL RESULTS
- TABLE 2: GROUNDWATER ANALYTICAL RESULTS

LIST OF APPENDICES

- APPENDIX A: HISTORICAL SAMPLING LOCATIONS AND ANALYTICAL RESULTS
- APPENDIX B: LABORATORY ANALYTICAL DATA SHEETS AND CHAIN-OF-CUSTODY RECORDS

1.0 INTRODUCTION

This report presents soil and groundwater characterization data for the property located at 2585 Nicholson Street, San Leandro, California (the Site). The data presented herein was collected in accordance with two work plans: 1) "Revised Proposed Workplan for Soil and Water Investigation" prepared by Hageman-Aguiar, Inc. dated September 20, 1995 (HA Work Plan); and 2) "Work Plan for Additional Groundwater Characterization" prepared by McLaren/Hart dated December 18, 1997 (MH Work Plan). Both work plans were approved by the Alameda County Health Care Services (ACHCS), the Site regulatory agency.

The characterization activities were performed to investigate an unauthorized release from former underground storage tanks. The objectives of the characterization activities were to: 1) collect supplemental soil data to determine current concentrations of contaminants in soil; 2) delineate the extent of contaminants in groundwater; and 3) determine the direction of groundwater flow.

1.1 Background

According to the HA Work Plan, two underground storage tanks were removed from the property by Scott-Broadway in 1991. Soil and groundwater samples collected during the UST removal activities identified total petroleum hydrocarbons (TPH) as diesel and gasoline in both media.

In 1992, Hageman-Aguiar, Incorporated (Hageman-Aquiar) performed an on-site soil and groundwater investigation which included collecting soil and groundwater samples from nineteen soil borings. The activities performed during the 1992 investigation are presented in the Hageman-Aquiar document "Report of Subsurface Investigation" dated July 29, 1992. The results of the investigation identified elevated levels of petroleum hydrocarbons apparently migrating in a southerly direction. In addition to the soil and groundwater investigation, Hageman-Aquiar backfilled the Site excavation and installed one monitoring well (MW-1) on the central portion of the Site in 1992. Between 1992 and 1995, ten groundwater samples were collected from MW-1. Free floating product was present during some of the sampling events at a maximum thickness of 1.25 inches. A boring location map and tabulated analytical results from the 1992 investigation are included in Appendix A.

2.0 SOIL AND GROUNDWATER CHARACTERIZATION

The soil and groundwater characterization conducted by McLaren/Hart was performed in two phases: 1) the first (initial characterization) was performed in accordance with the HA Work Plan (dated September 20, 1995); and 2) the second (supplemental characterization) was performed in accordance with the MH Work Plan (dated December 18, 1997). Soil and groundwater analytical results from the characterization activities are presented in Tables 1 and 2, respectively. Sampling locations and isoconcentration contours for benzene in groundwater are presented on Figure 2. The methodology used and results from each of the investigations are presented below.

2.1 Methodology

Soil borings were advanced using a Geoprobe sampling rig. Each boring was advanced to a total depth of approximately 10 feet below ground surface (bgs). Soil samples were collected in clear acetate tubes and immediately capped. Once the total depth of boring was reached, 0.75 inch PVC slotted pipe was placed in each borehole to prevent native material from sloughing into the borehole. Groundwater was retrieved from boreholes using 0.5 inch disposable bailers. Following completion of sampling, boreholes were backfilled with neat cement. All reusable equipment was decontaminated between boreholes and samples were immediately placed on ice and shipped to the laboratory using chain-of-custody procedures. All generated wastes were stored on-site pending receipt of analytical results and were subsequently recycled.

Drilling permits were obtained from the Alameda County Flood Control and Water Conservation District (Zone 7) for the borings. An encroachment permit was obtained from the City of San Leandro for borings located on Nicholson Street. Underground Service Alert (USA) was contacted at least 48 hours prior to initiating sampling activities.

Samples were analyzed for: 1) fuel fingerprint scan by Environmental Protection Agency (EPA) Method 8015 Modified; 2) benzene, toluene, ethylbenzene and xylenes (BTEX) and methyl-tert-butyl ether (MTBE) by EPA Method 8020. Analyses were performed by California Laboratory Services (CLS) in Rancho Cordova, California. CLS is certified by the state of California to perform the above listed analyses.

2.2 Initial Characterization (HA Work Plan)

In June 1997 McLaren/Hart implemented the scope of work outlined in the HA Work Plan (dated September 20, 1995). The scope of work consisted of performing soil and groundwater sampling at eight locations (M-1 through M-8) and measuring potentiometric surface elevations from temporary well points at each location. In addition, a groundwater sample was collected from the on-site monitoring well (MW-1).

The initial boring (M-1) was continuously sampled to determine hydrogeologic conditions beneath the Site and identify sampling depths. Subsequent borings were advanced directly to sample depths.

The geology encountered beneath the Site consisted of a dark brown stiff sandy clay (CL) with saturated conditions occurring at approximately 7.0 feet bgs. Soil samples were collected from the capillary fringe (5.0 to 6.0 feet bgs) for laboratory analysis.

Upon completion of all borings and prior to backfilling activities, the top of casing of each temporary well point was surveyed to a relative benchmark. Depth to water measurements were collected for calculating the potentiometric surface elevation at each location. The results indicated significant differences in groundwater elevations and were inconclusive at providing a groundwater flow direction. It is suspected that the fine grained lithologic material and low groundwater yield encountered in the boreholes resulted in incomplete hydraulic communication within the temporary well points.

As identified in Table 1, TPH as gasoline (TPH-G) and BTEX compounds were detected in each of the on-site soil samples (M-1 through M-4), but were not detected in off-site samples from borings M-5 and M-8. Soil samples from M-6 and M-7 were not analyzed based on the soil results from M-5 and M-8. A low level of motor oil (1.5 milligrams per kilogram (mg/kg)) was detected in the soil sample from M-5. While these results indicate petroleum hydrocarbon contaminated soil exists on-site, a comparison of soil and groundwater analytical results indicates that benzene concentrations are higher in groundwater samples. Consequently, hydrocarbon contamination present in soil is likely the result of upward migration from groundwater, either through capillary or vadose migration, or temporal variations in groundwater elevations.

Groundwater analytical results (see Table 2) identified TPH-G and BTEX compounds in each of the on-site borings (M-1 through M-4), and two of the off-site borings (M-5 and M-8). The highest concentrations of petroleum hydrocarbon constituents were reported in the on-site samples. No free-floating product was encountered in monitoring well MW-1. Analytical results from borings M-6, M-7 and M-8 defined the relative extent of petroleum hydrocarbon contamination to the west and southwest. Potential lateral migration in other directions was not completely defined. Consequently, additional groundwater sampling was required to complete groundwater characterization.

2.3 Supplemental Characterization (MH Work Plan)

The supplemental characterization activities consisted of collecting groundwater samples from seven additional borings (M-9 through M-15) in accordance with the MH Work Plan (dated December 18, 1997). Groundwater samples were collected and analyzed using the methodology described in Section 2.1. The objective of the supplemental characterization was to delineate off-site migration of petroleum hydrocarbon contaminants in areas undefined by the initial characterization. All samples were collected on March 18, 1998.

As shown in Table 2, diesel and motor oil were detected in groundwater samples from the supplemental borings. Low levels of diesel (0.26 to 0.27 milligrams per liter (mg/l)) were detected in the presumed upgradient borings M-10 and M-11. Motor oil was detected in all samples at concentrations ranging from 0.29 to 4.0 mg/l. Based on the fact that diesel was only detected in

borings located in the presumed upgradient groundwater flow direction, diesel appears to be associated with an off-site source. Given the widespread distribution of motor oil in groundwater, motor oil appears to be a regional issue.

Groundwater analytical results for BTEX and MTBE were below laboratory detection limits in all samples with the exception of M-9 and M-14. Analytical results from M-9, located in the presumed upgradient flow direction, revealed low levels of benzene (0.43 micrograms per liter (ug/l)) and MTBE (12 ug/l). Similarly, analytical results from M-14, located in the presumed crossgradient flow direction, also revealed low levels of benzene and MTBE (0.75 and 18 ug/l, respectively).

The benzene isoconcentration contours depicted on Figure 2 illustrate benzene results from the initial and supplemental groundwater characterization activities. The data suggests that petroleum hydrocarbons originating from the Site are migrating in a southwest direction. The presence of benzene in samples from M-5, M-8 and M-14 indicates that limited off-site migration has occurred. Given the high levels of benzene detected on-site versus the low levels of benzene detected off-site, the plume appears to be relatively stable. In addition, the lack of significant off-site migration suggests that natural attenuation is occurring beneath the Site.

The results of the characterization activities indicates that the lateral extent of petroleum hydrocarbons in groundwater is adequately defined. Additional monitoring wells will be required to confirm the groundwater flow direction and to identify the groundwater gradient.

3.0 CONCLUSIONS

The results of the characterization activities have provided adequate definition of petroleum hydrocarbon contamination in soil and groundwater on and in the vicinity of the Site. While the highest concentrations of petroleum hydrocarbons were detected on-site, the low levels detected immediately off-site indicate the plume is relatively stable. In addition, the lack of significant off-site migration suggests that natural attenuation is occurring beneath the Site.

The groundwater characterization data suggests that petroleum hydrocarbons originating from the Site are migrating in a southwest direction. However, a minimum of two additional monitoring wells will be required to confirm the groundwater flow direction and identify a groundwater gradient. Bank of America NT&SA is currently evaluating options for additional activities at the Site. A work plan describing those activities will be forthcoming.

TABLES

TABLE 1
SOIL ANALYTICAL RESULTS
2585 NICHOLSON STREET
SAN LEANDRO, CA

Boring Location: Sample Depth (ft.):	M-1 6	M-2 5	M-3 5	M-4 5	M-5 5	M-8 5
<i>TPH (mg/kg)</i>						
Gasoline	1100	330	790	210	<1.0	<1.0
Motor oil	<500	<1000	<200	<100	1.5	<1.0
<i>Purgeable Aromatics (ug/kg)</i>						
Benzene	4500	2100	1300	2500	<5.0	<5.0
Toluene	45000	16000	23000	18000	<5.0	<5.0
Ethylbenzene	4100	7100	17000	6900	<5.0	<5.0
Xylenes, Total	110000	37000	97000	36000	<10.0	<10.0
MTBE	<40000	<8000	<8000	<8000	<80	<80

TPH

Purgeble Aromatics

mg/kg

ug/kg

- Total petroleum hydrocarbons by Modified EPA Method 8015.

- By EPA Method 8020.

- Milligrams per kilogram.

- Micrograms per kilogram.

TABLE 2
GROUNDWATER ANALYTICAL RESULTS
2585 NICHOLSON STREET
SAN LEANDRO, CA

Sampling Location:	M-1	M-2	M-3	M-4	M-5	M-6	M-7	M-8	M-9	M-10	M-11	M-12	M-13	M-14	M-15	MW-1	
Sample Date:	Jun-97	Jun-97	Jun-97	Jun-97	Jun-97	Jun-97	Jun-97	Jun-97	Mar-98	Mar-98	Mar-98	Mar-98	Mar-98	Mar-98	Mar-98	Jun-97	
TPH (mg/l)																	
Gasoline	47	1300	67	79	1.5	<0.05	<0.05	0.36	<0.05	<0.05	<0.05	<0.05	<0.05	<0.05	<0.05	20	
Motor oil	<12	<22	<70	<2.8	<1.0	<2.8	3.4	0.51	0.29	0.97	0.68	4.0	0.11	1.8	2.2	<0.25	
Diesel	<12	<22	<70	<2.8	<1.0	<2.8	<1.6	<0.25	<0.05	0.26	0.27	<0.5	<0.05	<0.25	<0.5	<0.25	
		<i>Detection Limits were very high</i>															
Purgeable Aromatics (ug/l)																	
Benzene	4800	39000	27000	26000	350	<0.5	<0.5	10	0.43	<0.3	<0.3	<0.3	<0.3	0.75	<0.3	1400	
Toluene	17000	100000	22000	22000	17	<0.5	<0.5	1.8	<0.3	<0.3	<0.3	<0.3	<0.3	<0.3	<0.3	2800	
Ethylbenzene	2200	40000	2200	2000	150	<0.5	<0.5	1.1	<0.3	<0.3	<0.3	<0.3	<0.3	<0.3	<0.3	530	
Xylenes, Total	12000	200000	12000	11000	37	<1.5	<1.5	2.5	<0.6	<0.6	<0.6	<0.6	<0.6	<0.6	<0.6	6900	
MTBE	<500	14000	<1000	<1000	19	<1.0	<1.0	12	12	<1.0	<1.0	<1.0	<1.0	18	<1.0	270	

- TPH - Total petroleum hydrocarbons by Modified EPA Method 8015.
- Purgeble Aromatics - By EPA Method 8020.
- MTBE - Methyl Tert-Butyl Ether.
- mg/l - Milligrams per liter.
- ug/l - Micrograms per liter.

FIGURES

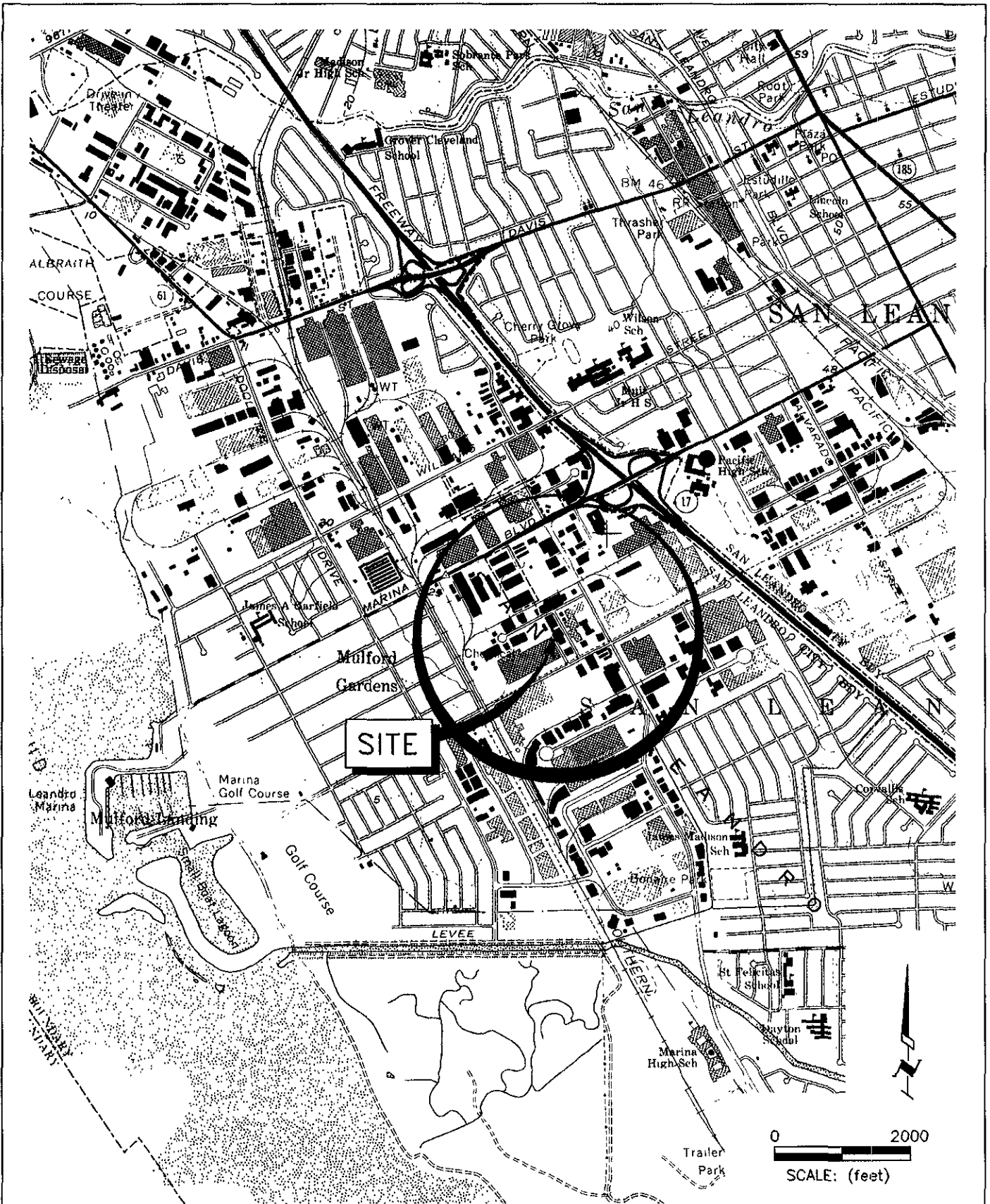

SOURCE: USGS 7.5 Minute Series (topographic), San Leandro Quadrangle, California.



FIGURE 1
SITE LOCATION MAP
2585 NICHOLSON STREET
SAN LEANDRO, CALIFORNIA

APPENDIX A
HISTORICAL SAMPLING LOCATIONS
AND ANALYTICAL RESULTS

TABLE 1.
Soil Sampling Results

EPA Method 418.1 (Infrared Spectroscopy)

Boring	Depth (feet)	Total Recoverable Hydrocarbons (mg/kg)
B-1	4	100
	6	5,800
B-2	4	250
	6	11,000
B-3	4	ND
	6	5,600
B-4	4	260
	6	9,500
B-5	4	ND
	6	4,200
B-6	4	59
	6	1,800
B-7	4	280
	6	1,300
DETECTION LIMIT		50

TABLE 1 (continued)
Soil Sampling Results

Boring	Depth (feet)	Total Recoverable Hydrocarbons (mg/kg)
B-8	4 6	170 7,100
B-9	4 6	230 6,600
B-10	4 6	ND 9,900
B-11	4 6	490 3,800
B-12	4 6	ND 1,800
B-13	4 6	ND 16,000
B-14	4 6	ND 7,500
DETECTION LIMIT		50

TABLE 1 (continued)
Soil Sampling Results

Boring	Depth (feet)	Total Recoverable Hydrocarbons (mg/kg)
B-15	4 6	ND 4,200
B-16	4 6	ND 3,400
B-17	4 6	ND 2,900
B-18	4 6	ND 2,800
B-19	4 6	300 2,000
DETECTION LIMIT		50

TABLE 2.

Shallow Groundwater Sampling Results

Well	Date	TPH as Gasoline (ug/L)	Benzene (ug/L)	Toluene (ug/L)	Ethyl-benzene (ug/L)	Total Xylenes (ug/L)	TPH as Kerosene (ug/L)	TPH as Diesel (ug/L)	TPH as Stoddard Solvent (ug/L)	TPH as Motor Oil (mg/L)
MW-1	06-08-92	10,000	110	81	62	280	---	ND	---	---
	11-09-92	9,800	23	14	22	96	---	ND	---	---
	04-23-93	18,000	42	47	50	190	ND	560	370	ND
	07-28-93	27,000	40	45	63	190	ND	ND	ND	ND
	12-10-93	7,800	13	16	20	77	ND	3,800	ND	ND
	03-14-94	280,000	970	880	620	1,700	ND	620	3,300	ND
	06-30-94	8,500	23	13	8.5	19	ND	ND	ND	ND
	09-14-94	2,400	5.3	2.6	2.5	6.0	ND	52	ND	ND
	12-14-94	4,800	32	32	16	50	ND	1,300	1,000	ND
	04-20-95	74,000	320	350	350	940	ND	3,700	570	ND
09-05-95	33,000	140	270	260	1,100	ND	46,000	4,900	ND	
Detection Limit		50	0.5	0.5	0.5	0.5	50	50	50	0.5

ND = not detected

TABLE 2.

Analysis by Gas Chromatography (EPA method 8015 and 8020)

Boring	Depth (feet)	Total Recoverable Petroleum Hydrocarbons (mg/Kg)	TPH as Gasoline (mg/Kg)	TPH as Kerosene (mg/Kg)	TPH as Diesel (mg/Kg)	Benzene (ug/Kg)	Toluene (ug/Kg)	Ethylbenzene (ug/Kg)	Total Xylenes (ug/Kg)	Motor Oil (mg/Kg)
B-2	4	250	270	ND	8.6	1,300	1,700	1,800	4,900	ND
B-6	4	59	280	ND	ND	780	1,000	1,000	3,900	ND
B-7	4	280	340	ND	280	1,500	1,900	1,600	6,200	ND
B-8	4	170	240	ND	ND	950	1,200	1,300	4,700	ND
B-9	4	230	230	ND	17	1,200	1,600	1,700	6,200	ND
B-11	4	490	360	ND	86	600	1,200	1,500	5,100	ND
B-19	4	300	440	ND	40	680	1,200	1,600	6,300	ND
Detection Limit		50	1.0	1.0	1.0	5.0	5.0	5.0	5.0	10

ND = Not Detected

TABLE 3.

Soil Sampling Results

(Monitoring Well Installation)

Boring	Depth (feet)	TPH as Gasoline (mg/Kg)	TPH as Kerosene (mg/Kg)	TPH as Diesel (mg/Kg)	Benzene (ug/Kg)	Toluene (ug/Kg)	Ethyl- benzene (ug/Kg)	Total Xylenes (ug/Kg)	Motor Oil (mg/Kg)	Oil & Grease (mg/Kg)
MW-1	4 6	18 11,000	ND ND	ND 190	200 32,000	180 59,000	22 44,000	760 17,000	ND ND	ND ND
Detection Limit		1.0	1.0	1.0	5.0	5.0	5.0	5.0	10	10

ND = Not Detected

TABLE 4.

Shallow Groundwater Sampling Results

Well	Date	TPH as Diesel (ug/L)	TPH as Gasoline (ug/L)	Benzene (ug/L)	Toluene (ug/L)	Ethyl-benzene (ug/L)	Total Xylenes (ug/L)
MW-1	06-08-92	ND	10,000	110	81	62	280
Detection Limit		50	0.5	0.5	0.5	0.5	0.5

ND = not detected

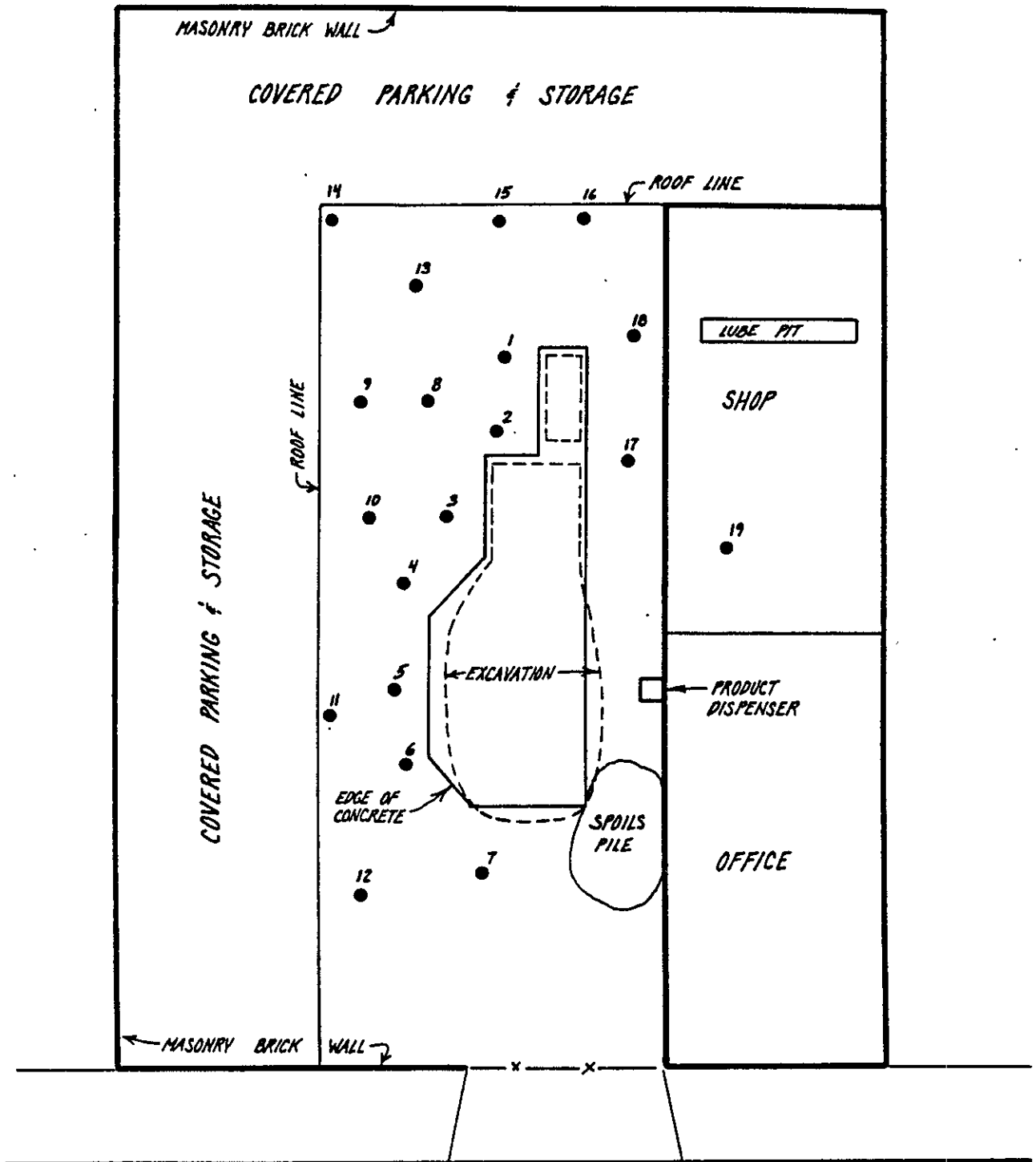
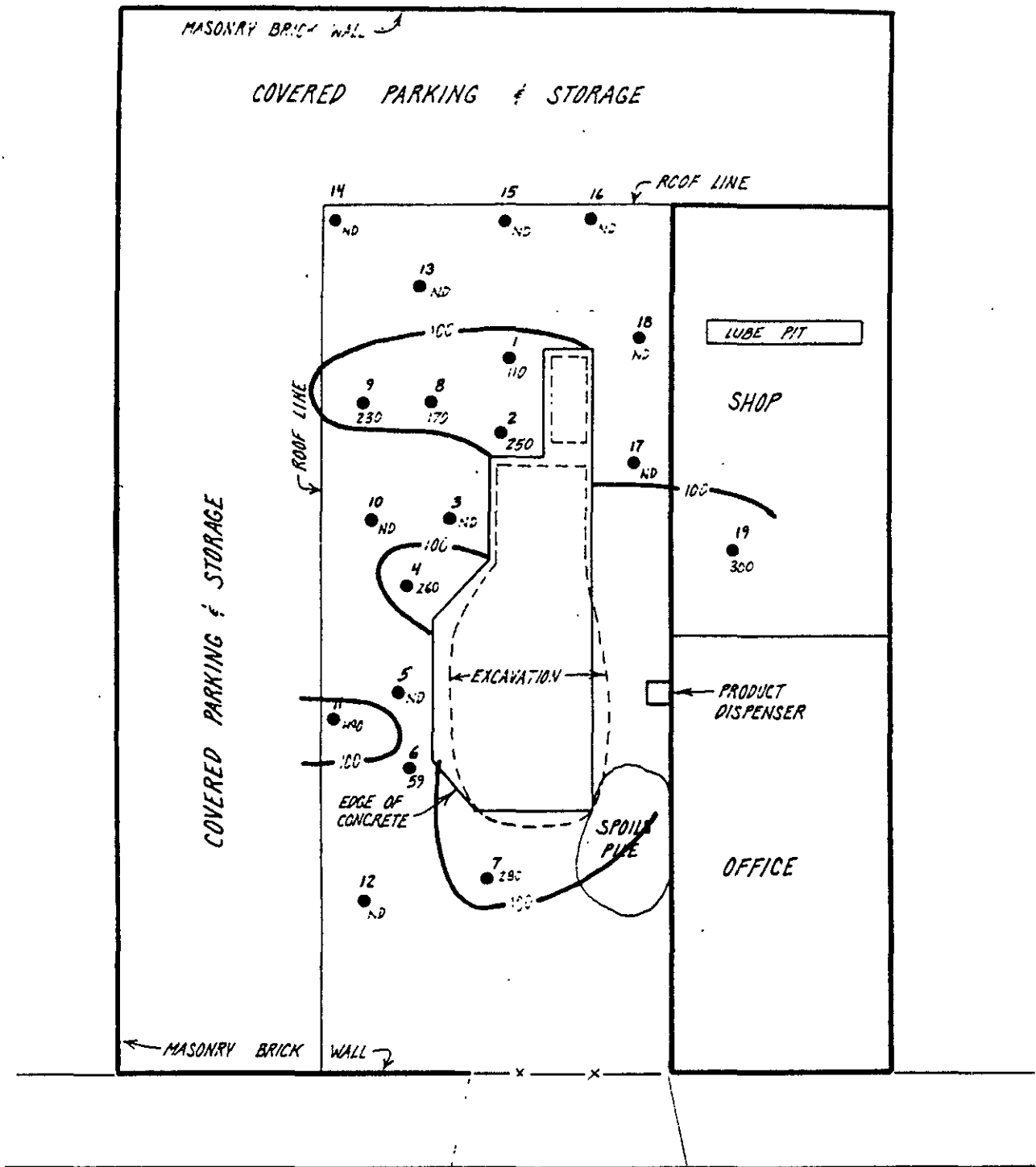

FIGURE 4.
Locations of Soil Borings.



NORTH
1" = 20'

NICHOLSON STREET

FIGURE 5. Lines of Equal Concentration of Total Recoverable Hydrocarbons in mg/Kg (ppm) in the Soil at 4-foot Depth.

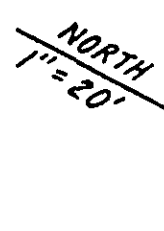
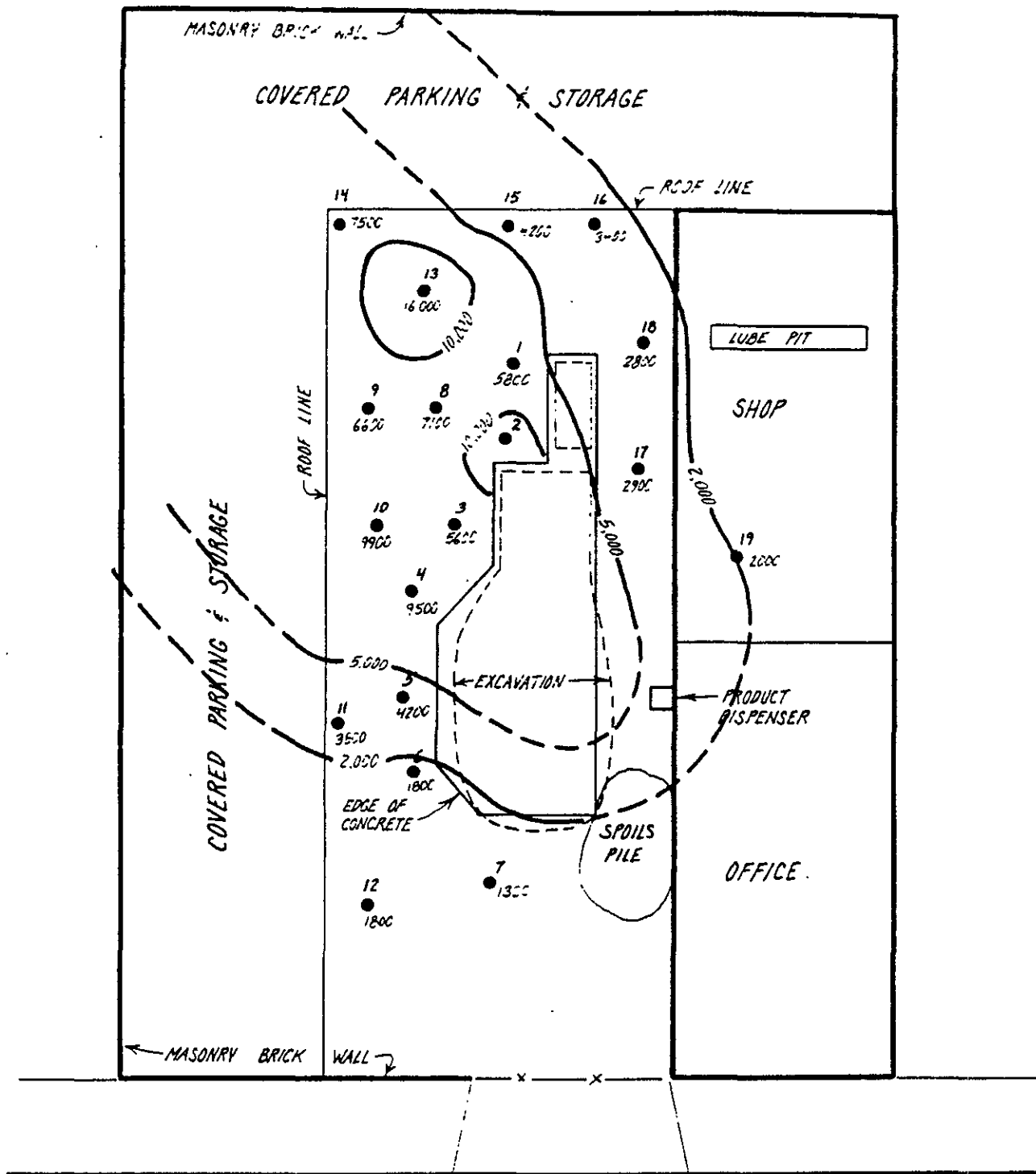

NICHOLSON STREET

FIGURE 6. Lines of Equal Concentration of Total Recoverable Hydrocarbons in mg/Kg (ppm) in the Soil at 6-foot Depth.

APPENDIX B

**LABORATORY ANALYTICAL DATA SHEETS
AND CHAIN-OF-CUSTODY RECORDS**

CLS Labs

McLaren/Hart-Alameda
1135 Atlantic Avenue
Alameda, CA 94501

07/09/97

Attention: Scott Allin

Reference: Analytical Results

Project Name: Bank of America
Project No.: 04.0602457.001.001
Date Received: 06/23/97
Chain Of Custody: 28543,26,03126

CLS ID No.: N8120A
CLS Job No.: 808120

The following analyses were performed on the above referenced project:

<u>No. of Samples</u>	<u>Turnaround Time</u>	<u>Analysis Description</u>
2	10 Days	TPH Fingerprint, EPA m-8015
2	2 Days	TPH as Gasoline, BTEX and MTBE

These samples were received by CLS Labs in a chilled, intact state and accompanied by a valid chain of custody document.

Calibrations for analytical testing have been performed in accordance to and pass the EPA's criteria for acceptability.

Modified EPA 8015 - Motor Oil:

Although Sample M-5 45364 was found to contain compounds in the retention time range generally associated with motor oil, the chromatogram for this sample was not consistent with the expected chromatographic pattern or "fingerprint." However, the reported concentration is based on motor oil calibration.

Analytical results are attached to this letter. Please call if we can provide additional assistance.

Sincerely,

George Hampton
Laboratory Director

3249 Fitzgerald Road
Rancho Cordova, CA 95742
(916) 638-7301
Fax (916) 638-4510

3083 Gold Canal Drive
Rancho Cordova, CA 95670
(916) 852-6600
Fax (916) 852-7292

CLS Labs

Analysis Report: Total Petroleum Hydrocarbons, EPA Method 8015
Purge and Trap, EPA Method 5030

Client: McLaren/Hart-Alameda
1135 Atlantic Avenue
Alameda, CA 94501

Project No.: 04.0602457.001.001
Contact: Scott Allin
Phone: (510)748-5694

Project: Bank of America

Date Sampled: 06/19/97
Date Received: 06/23/97
Date Extracted: 07/02/97
Date Analyzed: 07/08/97
Date Reported: 07/09/97
Client ID No.: M-8 45362 5.0'-6.0'

Lab Contact: George Hampton
Lab ID No.: N8120A-13A
Job No.: 808120
COC Log No.: 28543,26,03126
Batch No.: 19995
Instrument ID: GC018
Analyst ID: JENNDC
Matrix: SOIL

SURROGATE

Analyte	CAS No.	Surr Conc. (mg/kg)	Surrogate Recovery (percent)
o-Chlorotoluene	95-49-8	0.100	109

M-8 45362 5.0'-6.0'

Analyte	CAS No.	Results (mg/kg)	Rep. Limit (mg/kg)	Dilution (factor)
TPH as Gasoline	N/A	ND	1.0	1.0

ND = Not detected at or above indicated Reporting Limit

CA DOHS ELAP Accreditation/Registration Number 1233

3249 Fitzgerald Road
Rancho Cordova, CA 95742
(916) 638-7301
Fax (916) 638-4510

3083 Gold Canal Drive
Rancho Cordova, CA 95670
(916) 852-6600
Fax (916) 852-7292

CLS Labs

Analysis Report: Total Petroleum Hydrocarbons, EPA Method 8015
Purge and Trap, EPA Method 5030

Client: McLaren/Hart-Alameda
1135 Atlantic Avenue
Alameda, CA 94501

Project No.: 04.0602457.001.001
Contact: Scott Allin
Phone: (510)748-5694

Project: Bank of America

Date Extracted: 07/02/97
Date Analyzed: 07/08/97
Date Reported: 07/09/97

Lab Contact: George Hampton
Lab ID No.: N8120A
Job No.: 808120
COC Log No.: 28543,26,03126
Batch No.: 19995
Instrument ID: GC018
Analyst ID: JENNDC
Matrix: SOIL

MB SURROGATE

Analyte	CAS No.	Surr Conc. (mg/kg)	MB Surrogate Recovery (percent)
o-Chlorotoluene	95-49-8	0.100	113

METHOD BLANK

Analyte	CAS No.	Results (mg/kg)	Reporting Limit (mg/kg)
TPH as Gasoline	N/A	ND	1.0

ND = Not detected at or above indicated Reporting Limit

CA DOHS ELAP Accreditation/Registration Number 1233

3249 Fitzgerald Road
Rancho Cordova, CA 95742
(916) 638-7301
Fax (916) 638-4510

3083 Gold Canal Drive
Rancho Cordova, CA 95670
(916) 852-6600
Fax (916) 852-7292

CLS Labs

Analysis Report: TPH as Gasoline, BTEX and MTBE
Purge and Trap, EPA Method 5030

Client: McLaren/Hart-Alameda
1135 Atlantic Avenue
Alameda, CA 94501

Project No.: 04.0602457.001.001
Contact: Scott Allin
Phone: (510) 748-5694

Project: Bank of America

Date Sampled: 06/19/97
Date Received: 06/23/97
Date Extracted: 07/02/97
Date Analyzed: 07/08/97
Date Reported: 07/09/97
Client ID No.: M-5 45364 5.0' -6.0'

Lab Contact: George Hampton
Lab ID No.: N8120A-11A
Job No.: 808120
COC Log No.: 28543,26,03126
Batch No.: 19995
Instrument ID: GC018
Analyst ID: JENNDNC
Matrix: SOIL

SURROGATE

Analyte	CAS No.	Surr Conc. (ug/kg)	Surrogate Recovery (percent)
o-Chlorotoluene	95-49-8	100	103
M-5 45364 5.0' -6.0'			

Analyte	CAS No.	Results (ug/kg)	Rep. Limit (ug/kg)	Dilution (factor)
Methyl t-butyl ether	1634-04-4	ND	80	1.0
Benzene	71-43-2	ND	5.0	1.0
Toluene	108-88-3	ND	5.0	1.0
Ethylbenzene	100-41-4	ND	5.0	1.0
Xylenes, total	1330-20-7	ND	10	1.0

ND = Not detected at or above indicated Reporting Limit

CA DOHS ELAP Accreditation/Registration Number 1233

3249 Fitzgerald Road
Rancho Cordova, CA 95742
(916) 638-7301
Fax (916) 638-4510

3083 Gold Canal Drive
Rancho Cordova, CA 95670
(916) 852-6600
Fax (916) 852-7292

CLS Labs

Analysis Report: TPH as Gasoline, BTEX and MTBE
Purge and Trap, EPA Method 5030

Client: McLaren/Hart-Alameda
1135 Atlantic Avenue
Alameda, CA 94501

Project No.: 04.0602457.001.001
Contact: Scott Allin
Phone: (510)748-5694

Project: Bank of America

Date Sampled: 06/19/97
Date Received: 06/23/97
Date Extracted: 07/02/97
Date Analyzed: 07/08/97
Date Reported: 07/09/97
Client ID No.: M-8 45362 5.0'-6.0'

Lab Contact: George Hampton
Lab ID No.: N8120A-13A
Job No.: 808120
COC Log No.: 28543,26,03126
Batch No.: 19995
Instrument ID: GC018
Analyst ID: JENNDC
Matrix: SOIL

SURROGATE

Analyte	CAS No.	Surr Conc. (ug/kg)	Surrogate Recovery (percent)
o-Chlorotoluene	95-49-8	100	102

M-8 45362 5.0'-6.0'

Analyte	CAS No.	Results (ug/kg)	Rep. Limit (ug/kg)	Dilution (factor)
Methyl t-butyl ether	1634-04-4	ND	80	1.0
Benzene	71-43-2	ND	5.0	1.0
Toluene	108-88-3	ND	5.0	1.0
Ethylbenzene	100-41-4	ND	5.0	1.0
Xylenes, total	1330-20-7	ND	10	1.0

ND = Not detected at or above indicated Reporting Limit

CA DOHS ELAP Accreditation/Registration Number 1233

3249 Fitzgerald Road
Rancho Cordova, CA 95742
(916) 638-7301
Fax (916) 638-4510

3083 Gold Canal Drive
Rancho Cordova, CA 95670
(916) 852-6600
Fax (916) 852-7292

CLS Labs

Analysis Report: TPH as Gasoline, BTEX and MTBE
Purge and Trap, EPA Method 5030

Client: McLaren/Hart-Alameda
1135 Atlantic Avenue
Alameda, CA 94501

Project No.: 04.0602457.001.001
Contact: Scott Allin
Phone: (510)748-5694

Project: Bank of America

Date Extracted: 07/02/97
Date Analyzed: 07/08/97
Date Reported: 07/09/97

Lab Contact: George Hampton
Lab ID No.: N8120A
Job No.: 808120
COC Log No.: 28543,26,03126
Batch No.: 19995
Instrument ID: GC018
Analyst ID: JENNDC
Matrix: SOIL

MB SURROGATE

Analyte	CAS No.	Surr Conc. (ug/kg)	MB Surrogate Recovery (percent)
o-Chlorotoluene	95-49-8	100	107

METHOD BLANK

Analyte	CAS No.	Results (ug/kg)	Reporting Limit (ug/kg)
Methyl t-butyl ether	1634-04-4	ND	80
Benzene	71-43-2	ND	5.0
Toluene	108-88-3	ND	5.0
Ethylbenzene	100-41-4	ND	5.0
Xylenes, total	1330-20-7	ND	10

ND = Not detected at or above indicated Reporting Limit

CA DOHS ELAP Accreditation/Registration Number 1233

3249 Fitzgerald Road
Rancho Cordova, CA 95742
(916) 638-7301
Fax (916) 638-4510

3083 Gold Canal Drive
Rancho Cordova, CA 95670
(916) 852-6600
Fax (916) 852-7292

CLS Labs

*Analysis Report: TPH as Gasoline, BTEX and MTBE
Purge and Trap, EPA Method 5030*

*Client: McLaren/Hart-Alameda
1135 Atlantic Avenue
Alameda, CA 94501*

*Project No.: 04.0602457.001.001
Contact: Scott Allin
Phone: (510) 748-5694*

Project: Bank of America

*Date Extracted: 07/02/97
Date Analyzed: 07/08/97
Date Reported: 07/09/97*

*Lab Contact: George Hampton
Lab ID No.: N8120A
Job No.: 808120
COC Log No.: 28543,26,03126
Batch No.: 19995
Instrument ID: GC018
Analyst ID: JENNDC
Matrix: SOIL*

MS SURROGATE

Analyte	CAS No.	MS Surr. Conc. (ug/kg)	MS Surrogate Recovery (percent)
o-Chlorotoluene	95-49-8	100	104

MATRIX SPIKE

Analyte	CAS No.	MS Conc. (ug/kg)	MS Recovery (percent)
Benzene	71-43-2	100	99
Toluene	108-88-3	100	105
Ethylbenzene	100-41-4	100	102
Xylenes, total	1330-20-7	300	102

MSD SURROGATE

Analyte	CAS No.	Surr. Conc. (ug/kg)	MSD Surrogate Recovery (percent)
o-Chlorotoluene	95-49-8	100	102

MATRIX SPIKE DUPLICATE

Analyte	CAS No.	MSD Conc. (ug/kg)	MSD Recovery (percent)
Benzene	71-43-2	100	100
Toluene	108-88-3	100	104
Ethylbenzene	100-41-4	100	102
Xylenes, total	1330-20-7	300	102

CA DOHS ELAP Accreditation/Registration Number 1233

3249 Fitzgerald Road
Rancho Cordova, CA 95742
(916) 638-7301
Fax (916) 638-4510

3083 Gold Canal Drive
Rancho Cordova, CA 95670
(916) 852-6600
Fax (916) 852-7292

CLS Labs

Analysis Report: TPH as Gasoline, BTEX and MTBE
Purge and Trap, EPA Method 5030

Client: McLaren/Hart-Alameda
1135 Atlantic Avenue
Alameda, CA 94501

Project No.: 04.0602457.001.001
Contact: Scott Allin
Phone: (510)748-5694

Project: Bank of America

Date Extracted: 07/02/97
Date Analyzed: 07/08/97
Date Reported: 07/09/97

Lab Contact: George Hampton
Lab ID No.: N8120A
Job No.: 808120
COC Log No.: 28543,26,03126
Batch No.: 19995
Instrument ID: GC018
Analyst ID: JENNDG
Matrix: SOIL

RELATIVE % DIFFERENCE

Analyte	CAS No.	Relative Percent Difference (percent)
Benzene	71-43-2	1
Toluene	108-88-3	1
Ethylbenzene	100-41-4	0
Xylenes, total	1330-20-7	0

CA DOHS ELAP Accreditation/Registration Number 1233

3249 Fitzgerald Road
Rancho Cordova, CA 95742
(916) 638-7301
Fax (916) 638-4510

3083 Gold Canal Drive
Rancho Cordova, CA 95670
(916) 852-6600
Fax (916) 852-7000

CLS Labs

Analysis Report: TPH as Gasoline, BTEX and MTBE
Purge and Trap, EPA Method 5030

Client: McLaren/Hart-Alameda
1135 Atlantic Avenue
Alameda, CA 94501

Project No.: 04.0602457.001.001
Contact: Scott Allin
Phone: (510) 748-5694

Project: Bank of America

Date Extracted: 07/02/97
Date Analyzed: 07/08/97
Date Reported: 07/09/97

Lab Contact: George Hampton
Lab ID No.: N8120A
Job No.: 808120
COC Log No.: 28543,26,03126
Batch No.: 19995
Instrument ID: GC018
Analyst ID: JENNDNC
Matrix: SOIL

LCS SURROGATE

Analyte	CAS No.	LCS Conc. (ug/kg)	LCS Surrogate Recovery (percent)
o-Chlorotoluene	95-49-8	100	100

LAB CONTROL SAMPLE

Analyte	CAS No.	LCS Conc. (ug/kg)	LCS Recovery (percent)
Benzene	71-43-2	100	107
Toluene	108-88-3	100	108
Ethylbenzene	100-41-4	100	111
Xylenes, total	1330-20-7	300	107

CA DOHS ELAP Accreditation/Registration Number 1233

3249 Fitzgerald Road
Rancho Cordova, CA 95742
(916) 638-7301
Fax (916) 638-4510

3083 Gold Canal Drive
Rancho Cordova, CA 95670
(916) 852-6600
Fax (916) 852-7292

CLS Labs

Analysis Report: Fuel Fingerprinting, EPA 8015 Modified
Sonication, EPA Method 3550

Client: McLaren/Hart-Alameda
1135 Atlantic Avenue
Alameda, CA 94501

Project No.: 04.0602457.001.001
Contact: Scott Allin
Phone: (510)748-5694

Project: Bank of America

Date Sampled: 06/19/97
Date Received: 06/23/97
Date Extracted: 07/02/97
Date Analyzed: 07/02/97
Date Reported: 07/08/97
Client ID No.: M-5 45364 5.0'-6.0'

Lab Contact: George Hampton
Lab ID No.: N8120A-11A
Job No.: 808120
COC Log No.: 28543,26,03126
Batch No.: B19976
Instrument ID: PGC06
Analyst ID: SEPIDEHS
Matrix: SOIL

M-5 45364 5.0'-6.0'

Analyte	CAS No.	Results (mg/kg)	Rep. Limit (mg/kg)	Dilution (factor)
Motor Oil (C22-C32)	N/A	1.5	1.0	1.0

ND = Not detected at or above indicated Reporting Limit

CLS Labs

Analysis Report: Fuel Fingerprinting, EPA 8015 Modified
Sonication, EPA Method 3550

Client: McLaren/Hart-Alameda
1135 Atlantic Avenue
Alameda, CA 94501

Project No.: 04.0602457.001.001
Contact: Scott Allin
Phone: (510)748-5694

Project: Bank of America

Date Sampled: 06/19/97
Date Received: 06/23/97
Date Extracted: 07/02/97
Date Analyzed: 07/02/97
Date Reported: 07/08/97
Client ID No.: M-8 45362 5.0'-6.0'

Lab Contact: George Hampton
Lab ID No.: N8120A-13A
Job No.: 808120
COC Log No.: 28543,26,03126
Batch No.: B19976
Instrument ID: PGC06
Analyst ID: SEPIDEHS
Matrix: SOIL

M-8 45362 5.0'-6.0'

Analyte	CAS No.	Results (mg/kg)	Rep. Limit (mg/kg)	Dilution (factor)
Petroleum Hydrocarbons (C7-C32)	N/A	ND	1.0	1.0

ND = Not detected at or above indicated Reporting Limit

CLS Labs

Analysis Report: Fuel Fingerprinting, EPA 8015 Modified
Sonication, EPA Method 3550

Client: McLaren/Hart-Alameda
1135 Atlantic Avenue
Alameda, CA 94501

Project No.: 04.0602457.001.001
Contact: Scott Allin
Phone: (510)748-5694

Project: Bank of America

Date Extracted: 07/02/97
Date Analyzed: 07/02/97
Date Reported: 07/08/97

Lab Contact: George Hampton
Lab ID No.: N8120A
Job No.: 808120
COC Log No.: 28543,26,03126
Batch No.: B19976
Instrument ID: PGC06
Analyst ID: SEPIDEHS
Matrix: SOIL

METHOD BLANK

Analyte	CAS No.	Results (mg/kg)	Reporting Limit (mg/kg)
Petroleum Hydrocarbons (C7-C32)	N/A	ND	1.0

ND = Not detected at or above indicated Reporting Limit

CLS Labs

Analysis Report: Fuel Fingerprinting, EPA 8015 Modified
Sonication, EPA Method 3550

Client: McLaren/Hart-Alameda
1135 Atlantic Avenue
Alameda, CA 94501

Project No.: 04.0602457.001.001
Contact: Scott Allin
Phone: (510)748-5694

Project: Bank of America

Date Extracted: 07/02/97
Date Analyzed: 07/02/97
Date Reported: 07/08/97

Lab Contact: George Hampton
Lab ID No.: N8120A
Job No.: 808120
COC Log No.: 28543,26,03126
Batch No.: B19976
Instrument ID: PGC06
Analyst ID: SEPIDEHS
Matrix: SOIL

LAB CONTROL SAMPLE

Analyte	CAS No.	LCS Conc. (mg/kg)	LCS Recovery (percent)
Diesel (C12-C22)	N/A	5.00	72

LAB CONTROL SAMPLE DUPLICATE

Analyte	CAS No.	LCS Conc. (mg/kg)	LCSD Recovery (percent)
Diesel (C12-C22)	N/A	5.00	77

LCS RPD

Analyte	CAS No.	LCS Relative Percent Difference (percent)
Diesel (C12-C22)	N/A	7

REPORT TO:		CLIENT JOB NUMBER		ANALYSIS REQUESTED				FIELD CONDITIONS:			
ADDRESS <u>Melaron/Hart</u>		<u>04-0602457.001.001</u>		PRESERVATIVES							
<u>1135 Atlantic Ave.</u>		DESTINATION LABORATORY									
<u>Hameda CA 94501</u>		<input checked="" type="checkbox"/> CLS (916) 638-7301									
PROJECT MANAGER <u>Scott Allin</u> PHONE <u>746-5694</u>		3249 FITZGERALD RD. RANCHO CORDOVA, CA 95742									
PROJECT NAME <u>Bank of America</u>		<input type="checkbox"/> OTHER						COMPOSITE:			
SAMPLED BY <u>Steve Carson</u>								TURN AROUND TIME			
JOB DESCRIPTION <u>Dropiche</u>								SPECIAL INSTRUCTIONS			
SITE LOCATION <u>San Leandro, Nicholson</u>								<u>Depths of Soil Samples</u>			

DATE	TIME	SAMPLE IDENTIFICATION	MATRIX	CONTAINER			TPH-G (8015)	FFP (8015)	BTEX (8020)	8020 (MTBE)	TURN AROUND TIME				SPECIAL INSTRUCTIONS
				NO.	TYPE						1 DAY	2 DAY	5 DAY	10 DAY	
6/19/97	0900	M-1 46101	Soil	1	tube	NP	X	X	X	X				X	Sampled @ 5.0'-6.5'
		519701-4	Water	4	V	HCl	X		X	X					
		519705-0		2	A	NP		X							
	0945	M-2 46102	Soil	1	tube	NP	X	X	X	X					5-6.0
	0950	M-2 519707-10	Water	4	V	HCl	X		X	X					
		M-2 519711		1	A	NP		X							
	1045	M-4 46103	Soil	1	tube	NP	X	X	X	X					5-6.0
	1055	M-4 519712-5	Water	4	V	HCl	X		X	X					
		519716		1	A	NP		X							INVOICE TO:
	1135	M-3 46104	Soil	1	tube	NP	X	X	X	X					5-6.0
		519717-20	Water	4	V	HCl	X		X	X					PO. #
		519721		1	A	NP		X							QUOTE #

SUSPECTED CONSTITUENTS: _____ SAMPLE RETENTION TIME: _____ PRESERVATIVES: (1) HCL (2) HNO3 (3) = COLD (4) = _____

RELINQUISHED BY (SIGN)	PRINT NAME / COMPANY	DATE / TIME	RECEIVED BY (SIGN)	PRINT NAME / COMPANY
<u>[Signature]</u>	Steve Carson	6/23/97 1015	<u>[Signature]</u>	CONTRACTOR / M/H
<u>[Signature]</u>	CONTRACTOR / M/H	6/23/97 1340	<u>[Signature]</u>	Elbert Hallmark
<u>[Signature]</u>	Elbert Hallmark	6/23/97 1830	<u>[Signature]</u>	Elbert Hallmark/CLS

REC'D AT LAB BY: [Signature] DATE / TIME: 6/23/97 1830 CONDITIONS / COMMENTS: _____

SHIPPED VIA: FED X UPS OTHER CLS Express AIR BILL # _____

REPORT TO:			CLIENT JOB NUMBER			ANALYSIS REQUESTED				FIELD CONDITIONS					
ADDRESS <u>MCLAREN/HART (ALAMEDA)</u>			<u>04.0602457.001.001</u>			PRESERVATIVES TPH-G (80'S) FFP (80'S) BTEX (8020) 8020 (MTBE)				*PLEASE HOLD SOIL SAMPLES FOR M-5, 6, 7, & 8 PENDING PH NOTIFICATION					
PROJECT MANAGER <u>SCOTT ALLIN</u> PHONE# <u>748-5694</u>			DESTINATION LABORATORY											COMPOSITE:	
PROJECT NAME <u>BANK OF AMERICA</u>			<input checked="" type="checkbox"/> CLS (916) 638-7301 3249 FITZGERALD RD. RANCHO CORDOVA, CA 95742												
SAMPLED BY <u>STEVE CARSON</u>			<input type="checkbox"/> OTHER							TURN AROUND TIME				SPECIAL INSTRUCTIONS	
JOB DESCRIPTION <u>GEO PROBE</u>										DEPTH OF SOIL SAMPLES					
SITE LOCATION <u>SAN LEANDRO / NIENHUIS</u>															
DATE	TIME	SAMPLE IDENTIFICATION	MATRIX	CONTAINER						1 DAY	2 DAY	5 DAY	10 DAY		
				NO.	TYPE	NP	X	X	X	X					
<u>6/19/97</u>	<u>1520</u>	<u>M-6 45365</u>	<u>SOIL*</u>	<u>1</u>	<u>TUBE</u>	<u>NP</u>	<u>X</u>	<u>X</u>	<u>X</u>	<u>X</u>			<u>X</u>		<u>5.0'-6.0'</u>
		<u>519732-35</u>	<u>WATER</u>	<u>4</u>	<u>V</u>	<u>HCl</u>	<u>X</u>		<u>X</u>	<u>X</u>					
		<u>519736</u>	<u>↓</u>	<u>1</u>	<u>A</u>	<u>NP</u>		<u>X</u>							
	<u>1535</u>	<u>M-5 45364</u>	<u>SOIL*</u>	<u>1</u>	<u>TUBE</u>	<u>NP</u>	<u>X</u>	<u>X</u>	<u>X</u>	<u>X</u>					<u>5.0'-6.0'</u>
		<u>519737-40</u>	<u>WATER</u>	<u>4</u>	<u>V</u>	<u>HCl</u>	<u>X</u>		<u>X</u>	<u>X</u>					
		<u>519741</u>	<u>↓</u>	<u>1</u>	<u>A</u>	<u>NP</u>		<u>X</u>							
	<u>1440</u>	<u>M-8 45362</u>	<u>SOIL*</u>	<u>1</u>	<u>TUBE</u>	<u>NP</u>	<u>X</u>	<u>X</u>	<u>X</u>	<u>X</u>					<u>5.0'-6.0'</u>
		<u>519722-25</u>	<u>WATER</u>	<u>4</u>	<u>V</u>	<u>HCl</u>	<u>X</u>		<u>X</u>	<u>X</u>					
		<u>519726</u>	<u>↓</u>	<u>1</u>	<u>A</u>	<u>NP</u>		<u>X</u>							INVOICE TO:
<u>6/19/97</u>		<u>M-7 45363</u>	<u>SOIL*</u>	<u>1</u>	<u>TUBE</u>	<u>NP</u>	<u>X</u>	<u>X</u>	<u>X</u>	<u>X</u>					<u>5.0'-6.0'</u>
<u>6/20/97</u>	<u>1520</u>	<u>517820-23</u>	<u>WATER</u>	<u>4</u>	<u>V</u>	<u>HCl</u>	<u>X</u>		<u>X</u>	<u>X</u>					PO #
		<u>517824</u>	<u>↓</u>	<u>1</u>	<u>A</u>	<u>NP</u>		<u>X</u>					<u>↓</u>		QUOTE #
SUSPECTED CONSTITUENTS						SAMPLE RETENTION TIME				PRESERVATIVES: (1) HCL (2) HNO3 (3) = COLD					
RELINQUISHED BY (SIGN)			PRINT NAME / COMPANY			DATE / TIME			RECEIVED BY (SIGN)			PRINT NAME / COMPANY			
<u>[Signature]</u>			<u>Steve Carson</u>			<u>6/23/97 1815</u>			<u>[Signature]</u>			<u>CGILANTORI / M/H</u>			
<u>[Signature]</u>			<u>CGILANTORI / M/H</u>			<u>6/23/97 1340</u>			<u>[Signature]</u>			<u>Elbert Hallmark</u>			
<u>[Signature]</u>			<u>Elbert Hallmark</u>			<u>6/23/97 1830</u>									
REC'D AT LAB BY <u>[Signature]</u>						DATE / TIME: <u>6/23/97 1830</u>				CONDITIONS / COMMENTS:					
SHIPPED VIA <input type="checkbox"/> FED X <input type="checkbox"/> UPS <input checked="" type="checkbox"/> OTHER <u>US Carrier</u>												AIR BILL #			



M&E Environmental Laboratories
 3083 Gold Canal Drive
 Rancho Cordova
 CA 95670
 Phone 916/852-6600
 Fax 916/852-7292

W 8120 3015

CHAIN OF CUSTODY RECORD

SEE SIDE 2 FOR COMPLETE INSTRUCTIONS

Ship To: _____ Project Name: Bank of America San Leandro

Address: _____ Project Number: 04.0602457.001.001

Project Location: (State) San Leandro CA

FOR LABORATORY USE ONLY

Laboratory Project #: _____
 Storage Refrigerator ID: _____
 Storage Freezer ID: _____

Sampler Name: Clayton Gonzalez Signature: Clayton Gonzalez PPE Worn in Field:

Retinquished By: Clayton Gonzalez Date/Time: 6-14-97 1400 Received By or Method of Shipment/shipment I.D.: NS - J. Clark Date/Time: 6/19/97 1400

Retinquished By: Elbert Hallmark Date/Time: 6/23/97 1345 Received By or Method of Shipment/shipment I.D.: Elbert Hallmark Date/Time: 6/23/97 1345

Retinquished By: Elbert Hallmark Date/Time: 6/23/97 1340 Received By or Method of Shipment/shipment I.D.: Elbert Hallmark Date/Time: 6/23/97 1340

Sample Disposal (check one): Laboratory Standard Other

Level of QC (see Side 2): 1 2 3 4 5 6A 6B 6C 6D 6E 7

Write in Analysis Method: None

ANALYSES REQUESTED

Analysis Method	Requested
8015 TPH-G	X
8020 Benz-ArBE	X
8015 FFP	X

SAMPLE INFORMATION

FOR LABORATORY USE ONLY Lab ID	Sample ID Number	Date	Time	Description		Container(s)		Matrix Type	Pres. Type	TAT	8015 TPH-G	8020 Benz-ArBE	8015 FFP
				Locator	Depth	#	Type						
1	519612-15	6-14-97	1330	MW-1	-	4	VGAS	H ₂ O	HCL	5 day	X	X	
2	519610-11	↓	↓	↓	-	2	liters	↓	None	↓			X
3													
4													
5													
6													
7													
8													
9													
10													

Special Instructions/Comments: 5 day turn around

Container Types: A=1 Liter Amber TAT (Analytical Turn Around Time)
 B=Brass Tube C=Cassette 1 = 24 hours 2 = 48 hours
 G=Glass Jar P=Polyethylene 3 = 1 week 4 = 2 weeks
 O=Other V=Voa Vial 0 = Other

FOR LABORATORY USE ONLY Sample Condition Upon Receipt: _____

SEND DOCUMENTATION AND RESULTS TO (Check one):
 Project Manager/Office: SCOTTALLIN / ALAMBUJA
 Client Name: _____
 Company: _____
 Address: _____
 Phone: _____ FAX: _____

- Common Analytical Methods
- 413.1
 - 413.2 Long Method
 - 413.2 Short Method
 - 418.1 Long Method
 - 418.1 Short Method
 - 420.1
 - 502.2
 - 503E
 - 503.1
 - 524.2
 - 601
 - 602
 - 604
 - 608
 - 610
 - 624
 - 625
 - 8010
 - 8015
 - 8015 Mod.
 - 8020
 - 8021
 - 8040
 - 8080
 - 8100
 - 8150
 - 8240
 - 8270
 - 8310
 - Acidity
 - Alkalinity
 - BTEX
 - Chloride
 - CLP (see Side 2)
 - COD
 - Color
 - Conductivity
 - Corrosivity
 - Cyanide
 - Flashpoint
 - Fluoride
 - General Mineral
 - Hex. Chromium
 - Ion Balance
 - Metals (write specific metal & method #)*
 - Metals 6010*
 - Metals PP*
 - Metals Title 22:
 - TLC Level
 - STLC Level (see Side 2)
 - Nitrate
 - Nitrite
 - Odor
 - Org. Lead
 - Org. Mercury
 - Percent Moisture
 - Percent Solid
 - Perchlorate
 - pH
 - Phosphates
 - Phosphorus
 - Sulfate
 - Sulfides
 - TCLP:
 - VOA
 - Semvova
 - Metals
 - Pesticide
 - TDS
 - Total Hardness
 - Total Solids
 - TPHD
 - TPHG
 - TSS
 - Turbidity
- * Specify Total or Dissolved

CLS Labs

McLaren/Hart-Alameda
1135 Atlantic Avenue
Alameda, CA 94501

06/30/97

Attention: Scott Allin

Reference: Analytical Results

Project Name: Bank of America
Project No.: 04.0602457.001.001
Date Received: 06/23/97
Chain Of Custody: 28543,26,03126

CLS ID No.: N8120
CLS Job No.: 808120

The following analyses were performed on the above referenced project:

<u>No. of Samples</u>	<u>Turnaround Time</u>	<u>Analysis Description</u>
4	5 Days	Hold for subsequent analyses
13	5 Days	TPH Fingerprint, EPA m-8015
13	5 Days	TPH Volatiles by DHS Method M8015 (soil)
13	5 Days	Purgeable Aromatics by EPA 8020

These samples were received by CLS Labs in a chilled, intact state and accompanied by a valid chain of custody document.

Calibrations for analytical testing have been performed in accordance to and pass the EPA's criteria for acceptability.

Analytical results are attached to this letter. Please call if we can provide additional assistance.

Sincerely,

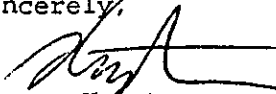

George Hampton
Laboratory Director

3249 Fitzgerald Road
Rancho Cordova, CA 95742
(916) 638-7301
Fax (916) 638-4510

3083 Gold Canal Drive
Rancho Cordova, CA 95670
(916) 852-6600
Fax (916) 852-7292

CLS Labs

Analysis Report: Aromatic Volatile Organics, EPA Method 602

Client: McLaren/Hart-Alameda
1135 Atlantic Avenue
Alameda, CA 94501

Project No.: 04.0602457.001.001
Contact: Scott Allin
Phone: (510)748-5694

Project: Bank of America

Lab Contact: George Hampton
Lab ID No.: N8120-2A
Job No.: 808120
COC Log No.: 28543,26,03126
Batch No.: 19911
Instrument ID: GC018
Analyst ID: JENNDG
Matrix: WATER

Date Sampled: 06/19/97
Date Received: 06/23/97
Date Extracted: 06/24/97
Date Analyzed: 06/24/97
Date Reported: 06/27/97
Client ID No.: M-1 519701-4

SURROGATE

Analyte	CAS No.	Surr Conc. (ug/L)	Surrogate Recovery (percent)
o-Chlorotoluene	95-49-8	10000	103

Sample: M-1 519701-4

Analyte	CAS No.	Results (ug/L)	Rep. Limit (ug/L)	Dilution (factor)
Methyl t-butyl ether	1634-04-4	ND	500	500
Benzene	71-43-2	4800	250	500
Toluene	108-88-3	17000	250	500
Ethylbenzene	100-41-4	2200	250	500
Xylenes, total	1330-20-7	12000	750	500

ND = Not detected at or above indicated Reporting Limit

CA DOHS ELAP Accreditation/Registration Number 1233

3249 Fitzgerald Road
Rancho Cordova, CA 95742
(916) 638-7301

3083 Gold Canal Drive
Rancho Cordova, CA 95670
(916) 852-6600

CLS Labs

Analysis Report: Aromatic Volatile Organics, EPA Method 602

Client: McLaren/Hart-Alameda
1135 Atlantic Avenue
Alameda, CA 94501

Project No.: 04.0602457.001.001
Contact: Scott Allin
Phone: (510) 748-5694

Project: Bank of America

Date Sampled: 06/19/97
Date Received: 06/23/97
Date Extracted: 06/24/97
Date Analyzed: 06/25/97
Date Reported: 06/27/97
Client ID No.: M-2 519707-10

Lab Contact: George Hampton
Lab ID No.: N8120-4A
Job No.: 808120
COC Log No.: 28543,26,03126
Batch No.: 19911
Instrument ID: GC018
Analyst ID: JENNDNC
Matrix: WATER

SURROGATE

Analyte	CAS No.	Surr Conc. (ug/L)	Surrogate Recovery (percent)
o-Chlorotoluene	95-49-8	100000	99

Sample: M-2 519707-10

Analyte	CAS No.	Results (ug/L)	Rep. Limit (ug/L)	Dilution (factor)
Methyl t-butyl ether	1634-04-4	14000	5000	5000
Benzene	71-43-2	39000	2500	5000
Toluene	108-88-3	100000	2500	5000
Ethylbenzene	100-41-4	40000	2500	5000
Xylenes, total	1330-20-7	200000	7500	5000

ND = Not detected at or above indicated Reporting Limit

CA DOHS ELAP Accreditation/Registration Number 1233

3249 Fitzgerald Road
Rancho Cordova, CA 95742
(916) 638-7301
Fax (916) 638-4510

3083 Gold Canal Drive
Rancho Cordova, CA 95670
(916) 852-6600
Fax (916) 852-7262

CLS Labs

Analysis Report: Aromatic Volatile Organics, EPA Method 602

Client: McLaren/Hart-Alameda
1135 Atlantic Avenue
Alameda, CA 94501

Project No.: 04.0602457.001.001
Contact: Scott Allin
Phone: (510)748-5694

Project: Bank of America

Date Sampled: 06/19/97
Date Received: 06/23/97
Date Extracted: 06/24/97
Date Analyzed: 06/25/97
Date Reported: 06/27/97
Client ID No.: M-4 519712-15

Lab Contact: George Hampton
Lab ID No.: N8120-6A
Job No.: 808120
COC Log No.: 28543,26,03126
Batch No.: 19911
Instrument ID: GC018
Analyst ID: JENNDC
Matrix: WATER

SURROGATE

Analyte	CAS No.	Surr Conc. (ug/L)	Surrogate Recovery (percent)
o-Chlorotoluene	95-49-8	20000	105

Sample: M-4 519712-15

Analyte	CAS No.	Results (ug/L)	Rep. Limit (ug/L)	Dilution (factor)
Methyl t-butyl ether	1634-04-4	ND	1000	1000
Benzene	71-43-2	26000	500	1000
Toluene	108-88-3	22000	500	1000
Ethylbenzene	100-41-4	2000	500	1000
Xylenes, total	1330-20-7	11000	1500	1000

ND = Not detected at or above indicated Reporting Limit

CA DOHS ELAP Accreditation/Registration Number 1233

3249 Fitzgerald Road
Rancho Cordova, CA 95742
(916) 638-7301

3083 Gold Canal Drive
Rancho Cordova, CA 95670
(916) 852-6600
Fax (916) 852-7200

CLS Labs

Analysis Report: Aromatic Volatile Organics, EPA Method 602

Client: McLaren/Hart-Alameda
1135 Atlantic Avenue
Alameda, CA 94501

Project No.: 04.0602457.001.001
Contact: Scott Allin
Phone: (510)748-5694

Project: Bank of America

Lab Contact: George Hampton
Lab ID No.: N8120-8A
Job No.: 808120
COC Log No.: 28543,26,03126
Batch No.: 19911
Instrument ID: GC018
Analyst ID: JENNDG
Matrix: WATER

Date Sampled: 06/19/97
Date Received: 06/23/97
Date Extracted: 06/24/97
Date Analyzed: 06/25/97
Date Reported: 06/27/97
Client ID No.: M-3 519717-20

SURROGATE

Analyte	CAS No.	Surr Conc. (ug/L)	Surrogate Recovery (percent)
o-Chlorotoluene	95-49-8	20000	105

Sample: M-3 519717-20

Analyte	CAS No.	Results (ug/L)	Rep. Limit (ug/L)	Dilution (factor)
Methyl t-butyl ether	1634-04-4	ND	1000	1000
Benzene	71-43-2	27000	500	1000
Toluene	108-88-3	22000	500	1000
Ethylbenzene	100-41-4	2200	500	1000
Xylenes, total	1330-20-7	12000	1500	1000

ND = Not detected at or above indicated Reporting Limit

CA DOHS ELAP Accreditation/Registration Number 1233

3249 Fitzgerald Road
Rancho Cordova, CA 95742
(916) 838-7301
Fax (916) 838-4510

3083 Gold Canal Drive
Rancho Cordova, CA 95670
(916) 852-6600
Fax (916) 952-7292

CLS Labs

Analysis Report: Aromatic Volatile Organics, EPA Method 602

Client: McLaren/Hart-Alameda
1135 Atlantic Avenue
Alameda, CA 94501

Project No.: 04.0602457.001.001
Contact: Scott Allin
Phone: (510) 748-5694

Project: Bank of America

Lab Contact: George Hampton
Lab ID No.: N8120-10A
Job No.: 808120
COC Log No.: 28543,26,03126
Batch No.: 19911
Instrument ID: GC018
Analyst ID: JENNDNC
Matrix: WATER

Date Sampled: 06/19/97
Date Received: 06/23/97
Date Extracted: 06/24/97
Date Analyzed: 06/24/97
Date Reported: 06/27/97
Client ID No.: M-6 519732-35

SURROGATE

Analyte	CAS No.	Surr Conc. (ug/L)	Surrogate Recovery (percent)
o-Chlorotoluene	95-49-8	20.0	105

Sample: M-6 519732-35

Analyte	CAS No.	Results (ug/L)	Rep. Limit (ug/L)	Dilution (factor)
Methyl t-butyl ether	1634-04-4	ND	1.0	1.0
Benzene	71-43-2	ND	0.50	1.0
Toluene	108-88-3	ND	0.50	1.0
Ethylbenzene	100-41-4	ND	0.50	1.0
Xylenes, total	1330-20-7	ND	1.5	1.0

ND = Not detected at or above indicated Reporting Limit

CA DOHS ELAP Accreditation/Registration Number 1233

3249 Fitzgerald Road
Rancho Cordova, CA 95742
(916) 638-7301
Fax (916) 638-4310

3083 Gold Canal Drive
Rancho Cordova, CA 95670
(916) 852-6600
Fax (916) 852-7292

CLS Labs

Analysis Report: Aromatic Volatile Organics, EPA Method 602

Client: McLaren/Hart-Alameda
1135 Atlantic Avenue
Alameda, CA 94501

Project No.: 04.0602457.001.001
Contact: Scott Allin
Phone: (510)748-5694

Project: Bank of America

Date Sampled: 06/19/97
Date Received: 06/23/97
Date Extracted: 06/24/97
Date Analyzed: 06/24/97
Date Reported: 06/27/97
Client ID No.: M-5 519737-40

Lab Contact: George Hampton
Lab ID No.: N8120-12A
Job No.: 808120
COC Log No.: 28543,26,03126
Batch No.: 19911
Instrument ID: GC018
Analyst ID: JENNDNC
Matrix: WATER

SURROGATE

Analyte	CAS No.	Surr Conc. (ug/L)	Surrogate Recovery (percent)
o-Chlorotoluene	95-49-8	20.0	103

Sample: M-5 519737-40

Analyte	CAS No.	Results (ug/L)	Rep. Limit (ug/L)	Dilution (factor)
Methyl t-butyl ether	1634-04-4	19	1.0	1.0
Benzene	71-43-2	350	5.0	10
Toluene	108-88-3	17	0.50	1.0
Ethylbenzene	100-41-4	150	5.0	10
Xylenes, total	1330-20-7	37	1.5	1.0

ND = Not detected at or above indicated Reporting Limit

CA DOHS ELAP Accreditation/Registration Number 1233

3249 Fitzgerald Road
Rancho Cordova, CA 95742
(916) 638-7301
Fax (916) 638-4510

3083 Gold Canal Drive
Rancho Cordova, CA 95670
(916) 852-6800
Fax (916) 852-7292

CLS Labs

Analysis Report: Aromatic Volatile Organics, EPA Method 602

Client: McLaren/Hart-Alameda
1135 Atlantic Avenue
Alameda, CA 94501

Project No.: 04.0602457.001.001
Contact: Scott Allin
Phone: (510) 748-5694

Project: Bank of America

Date Sampled: 06/19/97
Date Received: 06/23/97
Date Extracted: 06/24/97
Date Analyzed: 06/24/97
Date Reported: 06/27/97
Client ID No.: M-8 519722-25

Lab Contact: George Hampton
Lab ID No.: N8120-14A
Job No.: 808120
COC Log No.: 28543,26,03126
Batch No.: 19911
Instrument ID: GC018
Analyst ID: JENND C
Matrix: WATER

SURROGATE

Analyte	CAS No.	Surr Conc. (ug/L)	Surrogate Recovery (percent)
o-Chlorotoluene	95-49-8	20.0	103

Sample: M-8 519722-25

Analyte	CAS No.	Results (ug/L)	Rep. Limit (ug/L)	Dilution (factor)
Methyl t-butyl ether	1634-04-4	12	1.0	1.0
Benzene	71-43-2	10	0.50	1.0
Toluene	108-88-3	1.8	0.50	1.0
Ethylbenzene	100-41-4	1.1	0.50	1.0
Xylenes, total	1330-20-7	2.5	1.5	1.0

ND = Not detected at or above indicated Reporting Limit

CA DOHS ELAP Accreditation/Registration Number 1233

3249 Fitzgerald Road
Rancho Cordova, CA 95742
(916) 638-7301
Fax (916) 638-7302

3083 Gold Canal Drive
Rancho Cordova, CA 95670
(916) 852-6600
Fax (916) 852-7292

CLS Labs

Analysis Report: Aromatic Volatile Organics, EPA Method 602

Client: McLaren/Hart-Alameda
1135 Atlantic Avenue
Alameda, CA 94501

Project No.: 04.0602457.001.001
Contact: Scott Allin
Phone: (510) 748-5694

Project: Bank of America

Date Sampled: 06/20/97
Date Received: 06/23/97
Date Extracted: 06/24/97
Date Analyzed: 06/25/97
Date Reported: 06/27/97
Client ID No.: M-7 517820-23

Lab Contact: George Hampton
Lab ID No.: N8120-16A
Job No.: 808120
COC Log No.: 28543,26,03126
Batch No.: 19911
Instrument ID: GC018
Analyst ID: JENNDG
Matrix: WATER

SURROGATE

Analyte	CAS No.	Surr Conc. (ug/L)	Surrogate Recovery (percent)
o-Chlorotoluene	95-49-8	20.0	103

Sample: M-7 517820-23

Analyte	CAS No.	Results (ug/L)	Rep. Limit (ug/L)	Dilution (factor)
Methyl t-butyl ether	1634-04-4	ND	1.0	1.0
Benzene	71-43-2	ND	0.50	1.0
Toluene	108-88-3	ND	0.50	1.0
Ethylbenzene	100-41-4	ND	0.50	1.0
Xylenes, total	1330-20-7	ND	1.5	1.0

ND = Not detected at or above indicated Reporting Limit

CA DOHS ELAP Accreditation/Registration Number 1233

3249 Fitzgerald Road
Rancho Cordova, CA 95742
(916) 638-7301
Fax (916) 638-4512

3083 Gold Canal Drive
Rancho Cordova, CA 95670
(916) 852-6600
Fax (916) 852-7292

CLS Labs

Analysis Report: Aromatic Volatile Organics, EPA Method 602

Client: McLaren/Hart-Alameda
1135 Atlantic Avenue
Alameda, CA 94501

Project No.: 04.0602457.001.001
Contact: Scott Allin
Phone: (510) 748-5694

Project: Bank of America

Date Sampled: 06/19/97
Date Received: 06/23/97
Date Extracted: 06/24/97
Date Analyzed: 06/25/97
Date Reported: 06/27/97
Client ID No.: MW-1 519612-15

Lab Contact: George Hampton
Lab ID No.: N8120-17A
Job No.: 808120
COC Log No.: 28543,26,03126
Batch No.: 19911
Instrument ID: GC018
Analyst ID: JENNDG
Matrix: WATER

SURROGATE

Analyte	CAS No.	Surr Conc. (ug/L)	Surrogate Recovery (percent)
o-Chlorotoluene	95-49-8	5000	104

Sample: MW-1 519612-15

Analyte	CAS No.	Results (ug/L)	Rep. Limit (ug/L)	Dilution (factor)
Methyl t-butyl ether	1634-04-4	270	250	250
Benzene	71-43-2	1400	130	250
Toluene	108-88-3	2800	130	250
Ethylbenzene	100-41-4	530	130	250
Xylenes, total	1330-20-7	6900	380	250

ND = Not detected at or above indicated Reporting Limit

CA DOHS ELAP Accreditation/Registration Number 1233

3249 Fitzgerald Road
Rancho Cordova, CA 95742
(916) 638-7301
Fax (916) 638-4510

3083 Gold Canal Drive
Rancho Cordova, CA 95670
(916) 852-6600
Fax (916) 852-7292

CLS Labs

Analysis Report: Aromatic Volatile Organics, EPA Method 602

Client: McLaren/Hart-Alameda
1135 Atlantic Avenue
Alameda, CA 94501

Project No.: 04.0602457.001.001
Contact: Scott Allin
Phone: (510)748-5694

Project: Bank of America

Lab Contact: George Hampton

Date Extracted: 06/24/97
Date Analyzed: 06/24/97
Date Reported: 06/27/97

Lab ID No.: N8120
Job No.: 808120
COC Log No.: 28543,26,03126
Batch No.: 19911
Instrument ID: GC018
Analyst ID: JENNDG
Matrix: WATER

MB SURROGATE

Analyte	CAS No.	Surr Conc. (ug/L)	MB Surrogate Recovery (percent)
o-Chlorotoluene	95-49-8	20.0	102

METHOD BLANK

Analyte	CAS No.	Results (ug/L)	Reporting Limit (ug/L)
Methyl t-butyl ether	1634-04-4	ND	1.0
Benzene	71-43-2	ND	0.50
Toluene	108-88-3	ND	0.50
Ethylbenzene	100-41-4	ND	0.50
Xylenes, total	1330-20-7	ND	1.5

ND = Not detected at or above indicated Reporting Limit

CA DOHS ELAP Accreditation/Registration Number 1233

3249 Fitzgerald Road
Rancho Cordova, CA 95742
(916) 638-7301
Fax (916) 852-4510

3083 Gold Canal Drive
Rancho Cordova, CA 95670
(916) 852-6600

CLS Labs

Analysis Report: Aromatic Volatile Organics, EPA Method 602

Client: McLaren/Hart-Alameda
1135 Atlantic Avenue
Alameda, CA 94501

Project No.: 04.0602457.001.001
Contact: Scott Allin
Phone: (510) 748-5694

Project: Bank of America

Lab Contact: George Hampton
Lab ID No.: N8120
Job No.: 808120
COC Log No.: 28543,26,03126
Batch No.: 19911
Instrument ID: GC018
Analyst ID: JENNDNC
Matrix: WATER

Date Extracted: 06/24/97
Date Analyzed: 06/24/97
Date Reported: 06/27/97

MS SURROGATE			
Analyte	CAS No.	MS Surr. Conc. (ug/L)	MS Surrogate Recovery (percent)
o-Chlorotoluene	95-49-8	20.0	103
MATRIX SPIKE			
Analyte	CAS No.	MS Conc. (ug/L)	MS Recovery (percent)
Benzene	71-43-2	20.0	102
Toluene	108-88-3	20.0	99
MSD SURROGATE			
Analyte	CAS No.	Surr. Conc. (ug/L)	MSD Surrogate Recovery (percent)
o-Chlorotoluene	95-49-8	20.0	103
MATRIX SPIKE DUPLICATE			
Analyte	CAS No.	MSD Conc. (ug/L)	MSD Recovery (percent)
Benzene	71-43-2	20.0	106
Toluene	108-88-3	20.0	102
RELATIVE % DIFFERENCE			
Analyte	CAS No.		Relative Percent Difference (percent)
Benzene	71-43-2		4

CA DOHS ELAP Accreditation/Registration Number 1233

3249 Fitzgerald Road
Rancho Cordova, CA 95742
(916) 638-7301
Fax (916) 638-4510

3083 Gold Canal Drive
Rancho Cordova, CA 95670
(916) 852-6600
Fax (916) 852-7292

CLS Labs

Analysis Report: Aromatic Volatile Organics, EPA Method 602

Client: McLaren/Hart-Alameda
1135 Atlantic Avenue
Alameda, CA 94501

Project No.: 04.0602457.001.001
Contact: Scott Allin
Phone: (510) 748-5694

Project: Bank of America

Date Extracted: 06/24/97
Date Analyzed: 06/24/97
Date Reported: 06/27/97

Lab Contact: George Hampton
Lab ID No.: N8120
Job No.: 808120
COC Log No.: 28543,26,03126
Batch No.: 19911
Instrument ID: GC018
Analyst ID: JENNDK
Matrix: WATER

RELATIVE % DIFFERENCE (cont.)

Analyte	CAS No.	Relative Percent Difference (percent)
Toluene	108-88-3	3

CA DOHS ELAP Accreditation/Registration Number 1233

3249 Fitzgerald Road
Rancho Cordova, CA 95742
(916) 838-7301
Fax: (916) 838-4510

3083 Gold Canal Drive
Rancho Cordova, CA 95670
(916) 852-6600
Fax: (916) 852-7000

CLS Labs

Analysis Report: Aromatic Volatile Organics, EPA Method 602

Client: McLaren/Hart-Alameda
1135 Atlantic Avenue
Alameda, CA 94501

Project No.: 04.0602457.001.001
Contact: Scott Allin
Phone: (510) 748-5694

Project: Bank of America

Date Extracted: 06/24/97
Date Analyzed: 06/24/97
Date Reported: 06/27/97

Lab Contact: George Hampton
Lab ID No.: N8120
Job No.: 808120
COC Log No.: 28543,26,03126
Batch No.: 19911
Instrument ID: GC018
Analyst ID: JENNDG
Matrix: WATER

LCS SURROGATE

Analyte	CAS No.	LCS Conc. (ug/L)	LCS Surrogate Recovery (percent)
o-Chlorotoluene	95-49-8	20.0	101

LAB CONTROL SAMPLE

Analyte	CAS No.	LCS Conc. (ug/L)	LCS Recovery (percent)
Benzene	71-43-2	20.0	106
Toluene	108-88-3	20.0	102

CA DOHS ELAP Accreditation/Registration Number 1233

3249 Fitzgerald Road
Rancho Cordova, CA 95742
(916) 638-7301
Fax (916) 638-4510

3083 Gold Canal Drive
Rancho Cordova, CA 95670
(916) 852-6600
Fax (916) 852-7292

CLS Labs

Analysis Report: Total Petroleum Hydrocarbons, EPA Method 8015
Purge and Trap, EPA Method 5030

Client: McLaren/Hart-Alameda
1135 Atlantic Avenue
Alameda, CA 94501

Project No.: 04.0602457.001.001
Contact: Scott Allin
Phone: (510)748-5694

Project: Bank of America

Lab Contact: George Hampton
Lab ID No.: N8120-2A
Job No.: 808120
COC Log No.: 28543,26,03126
Batch No.: 19911
Instrument ID: GC018
Analyst ID: JENNDG
Matrix: WATER

Date Sampled: 06/19/97
Date Received: 06/23/97
Date Extracted: 06/24/97
Date Analyzed: 06/24/97
Date Reported: 06/27/97
Client ID No.: M-1 519701-4

SURROGATE

Analyte	CAS No.	Surr Conc. (mg/L)	Surrogate Recovery (percent)
o-Chlorotoluene	95-49-8	1.00	99

Sample: M-1 519701-4

Analyte	CAS No.	Results (mg/L)	Rep. Limit (mg/L)	Dilution (factor)
TPH as Gasoline	N/A	47	2.5	50

ND = Not detected at or above indicated Reporting Limit

CA DOHS ELAP Accreditation/Registration Number 1233

3249 Fitzgerald Road
Rancho Cordova, CA 95742
(916) 638-7301
Fax (916) 638-7301

3083 Gold Canal Drive
Rancho Cordova, CA 95670
(916) 852-6600
Fax (916) 852-7292

CLS Labs

Analysis Report: Total Petroleum Hydrocarbons, EPA Method 8015
Purge and Trap, EPA Method 5030

Client: McLaren/Hart-Alameda
1135 Atlantic Avenue
Alameda, CA 94501

Project No.: 04.0602457.001.001
Contact: Scott Allin
Phone: (510) 748-5694

Project: Bank of America

Date Sampled: 06/19/97
Date Received: 06/23/97
Date Extracted: 06/24/97
Date Analyzed: 06/25/97
Date Reported: 06/27/97
Client ID No.: M-2 519707-10

Lab Contact: George Hampton
Lab ID No.: N8120-4A
Job No.: 808120
COC Log No.: 28543,26,03126
Batch No.: 19911
Instrument ID: GC018
Analyst ID: JENNDC
Matrix: WATER

SURROGATE

Analyte	CAS No.	Surr Conc. (mg/L)	Surrogate Recovery (percent)
o-Chlorotoluene	95-49-8	100	97

Sample: M-2 519707-10

Analyte	CAS No.	Results (mg/L)	Rep. Limit (mg/L)	Dilution (factor)
TPH as Gasoline	N/A	1300	250	5000

ND = Not detected at or above indicated Reporting Limit

CA DOHS ELAP Accreditation/Registration Number 1233

3249 Fitzgerald Road
Rancho Cordova, CA 95742
(916) 638-7301
Fax (916) 638-4510

3083 Gold Canal Drive
Rancho Cordova, CA 95670
(916) 852-6600
Fax (916) 852-7292

CLS Labs

Analysis Report: Total Petroleum Hydrocarbons, EPA Method 8015
Purge and Trap, EPA Method 5030

Client: McLaren/Hart-Alameda
1135 Atlantic Avenue
Alameda, CA 94501

Project No.: 04.0602457.001.001
Contact: Scott Allin
Phone: (510) 748-5694

Project: Bank of America

Date Sampled: 06/19/97
Date Received: 06/23/97
Date Extracted: 06/24/97
Date Analyzed: 06/24/97
Date Reported: 06/27/97
Client ID No.: M-4 519712-15

Lab Contact: George Hampton
Lab ID No.: N8120-6A
Job No.: 808120
COC Log No.: 28543,26,03126
Batch No.: 19911
Instrument ID: GC018
Analyst ID: JENINDC
Matrix: WATER

SURROGATE

Analyte	CAS No.	Surr Conc. (mg/L)	Surrogate Recovery (percent)
o-Chlorotoluene	95-49-8	1.00	102

Sample: M-4 519712-15

Analyte	CAS No.	Results (mg/L)	Rep. Limit (mg/L)	Dilution (factor)
TPH as Gasoline	N/A	79	2.5	50

ND = Not detected at or above indicated Reporting Limit

CA DOHS ELAP Accreditation/Registration Number 1233

3249 Fitzgerald Road
Rancho Cordova, CA 95742
(916) 638-7301

3083 Gold Canal Drive
Rancho Cordova, CA 95670
(916) 852-6600

CLS Labs

Analysis Report: Total Petroleum Hydrocarbons, EPA Method 8015
Purge and Trap, EPA Method 5030

Client: McLaren/Hart-Alameda
1135 Atlantic Avenue
Alameda, CA 94501

Project No.: 04.0602457.001.001
Contact: Scott Allin
Phone: (510)748-5694

Project: Bank of America

Date Sampled: 06/19/97
Date Received: 06/23/97
Date Extracted: 06/24/97
Date Analyzed: 06/24/97
Date Reported: 06/27/97
Client ID No.: M-3 519717-20

Lab Contact: George Hampton
Lab ID No.: N8120-8A
Job No.: 808120
COC Log No.: 28543,26,03126
Batch No.: 19911
Instrument ID: GC018
Analyst ID: JENNDNC
Matrix: WATER

SURROGATE

Analyte	CAS No.	Surr Conc. (mg/L)	Surrogate Recovery (percent)
o-Chlorotoluene	95-49-8	1.00	100

Sample: M-3 519717-20

Analyte	CAS No.	Results (mg/L)	Rep. Limit (mg/L)	Dilution (factor)
TPH as Gasoline	N/A	67	2.5	50

ND = Not detected at or above indicated Reporting Limit

CA DOHS ELAP Accreditation/Registration Number 1233

3249 Fitzgerald Road
Rancho Cordova, CA 95742
(916) 638-7301
Fax (916) 638-4510

3083 Gold Canal Drive
Rancho Cordova, CA 95670
(916) 852-6600
Fax (916) 852-7292

CLS Labs

Analysis Report: Total Petroleum Hydrocarbons, EPA Method 8015
Purge and Trap, EPA Method 5030

Client: McLaren/Hart-Alameda
1135 Atlantic Avenue
Alameda, CA 94501

Project No.: 04.0602457.001.001
Contact: Scott Allin
Phone: (510)748-5694

Project: Bank of America

Lab Contact: George Hampton
Lab ID No.: N8120-10A
Job No.: 808120
COC Log No.: 28543,26,03126
Batch No.: 19911
Instrument ID: GC018
Analyst ID: JENNDG
Matrix: WATER

Date Sampled: 06/19/97
Date Received: 06/23/97
Date Extracted: 06/24/97
Date Analyzed: 06/24/97
Date Reported: 06/27/97
Client ID No.: M-6 519732-35

SURROGATE

Analyte	CAS No.	Surr Conc. (mg/L)	Surrogate Recovery (percent)
o-Chlorotoluene	95-49-8	0.0200	115

Sample: M-6 519732-35

Analyte	CAS No.	Results (mg/L)	Rep. Limit (mg/L)	Dilution (factor)
TPH as Gasoline	N/A	ND	0.050	1.0

ND = Not detected at or above indicated Reporting Limit

CLS Labs

Analysis Report: Total Petroleum Hydrocarbons, EPA Method 8015
Purge and Trap, EPA Method 5030

Client: McLaren/Hart-Alameda
1135 Atlantic Avenue
Alameda, CA 94501

Project No.: 04.0602457.001.001
Contact: Scott Allin
Phone: (510) 748-5694

Project: Bank of America

Date Sampled: 06/19/97
Date Received: 06/23/97
Date Extracted: 06/24/97
Date Analyzed: 06/24/97
Date Reported: 06/27/97
Client ID No.: M-5 519737-40

Lab Contact: George Hampton
Lab ID No.: N8120-12A
Job No.: 808120
COC Log No.: 28543,26,03126
Batch No.: 19911
Instrument ID: GC018
Analyst ID: JENNDNC
Matrix: WATER

SURROGATE

Analyte	CAS No.	Surr Conc. (mg/L)	Surrogate Recovery (percent)
o-Chlorotoluene	95-49-8	0.0200	98

Sample: M-5 519737-40

Analyte	CAS No.	Results (mg/L)	Rep. Limit (mg/L)	Dilution (factor)
TPH as Gasoline	N/A	1.5	0.050	1.0

ND = Not detected at or above indicated Reporting Limit

CA DOHS ELAP Accreditation/Registration Number 1233

3249 Fitzgerald Road
Rancho Cordova, CA 95742
(916) 638-7301
Fax (916) 638-4510

3083 Gold Canal Drive
Rancho Cordova, CA 95670
(916) 852-6600
Fax (916) 852-7292

CLS Labs

Analysis Report: Total Petroleum Hydrocarbons, EPA Method 8015
Purge and Trap, EPA Method 5030

Client: McLaren/Hart-Alameda
1135 Atlantic Avenue
Alameda, CA 94501

Project No.: 04.0602457.001.001
Contact: Scott Allin
Phone: (510)748-5694

Project: Bank of America

Date Sampled: 06/19/97
Date Received: 06/23/97
Date Extracted: 06/24/97
Date Analyzed: 06/24/97
Date Reported: 06/27/97
Client ID No.: M-8 519722-25

Lab Contact: George Hampton
Lab ID No.: N8120-14A
Job No.: 808120
COC Log No.: 28543,26,03126
Batch No.: 19911
Instrument ID: GC018
Analyst ID: JENNDC
Matrix: WATER

SURROGATE

Analyte	CAS No.	Surr Conc. (mg/L)	Surrogate Recovery (percent)
o-Chlorotoluene	95-49-8	0.0200	111

Sample: M-8 519722-25

Analyte	CAS No.	Results (mg/L)	Rep. Limit (mg/L)	Dilution (factor)
TPH as Gasoline	N/A	0.36	0.050	1.0

ND = Not detected at or above indicated Reporting Limit

CA DOHS ELAP Accreditation/Registration Number 1233

3249 Fitzgerald Road
Rancho Cordova, CA 95742
(916) 638-7301
Fax (916) 638-4510

3083 Gold Canal Drive
Rancho Cordova, CA 95670
(916) 852-6600
Fax (916) 852-7292

CLS Labs

Analysis Report: Total Petroleum Hydrocarbons, EPA Method 8015
Purge and Trap, EPA Method 5030

Client: McLaren/Hart-Alameda
1135 Atlantic Avenue
Alameda, CA 94501

Project No.: 04.0602457.001.001
Contact: Scott Allin
Phone: (510) 748-5694

Project: Bank of America

Date Sampled: 06/19/97
Date Received: 06/23/97
Date Extracted: 06/24/97
Date Analyzed: 06/24/97
Date Reported: 06/27/97
Client ID No.: M-3 46104 5.0' -6.0'

Lab Contact: George Hampton
Lab ID No.: N8120-7A
Job No.: 808120
COC Log No.: 28543,26,03126
Batch No.: 19911
Instrument ID: GC018
Analyst ID: JENNDC
Matrix: SOIL

SURROGATE

Analyte	CAS No.	Surr Conc. (mg/kg)	Surrogate Recovery (percent)
o-Chlorotoluene	95-49-8	10.0	108

Sample: M-3 46104 5.0' -6.0'

Analyte	CAS No.	Results (mg/kg)	Rep. Limit (mg/kg)	Dilution (factor)
TPH as Gasoline	N/A	790	100	100

ND = Not detected at or above indicated Reporting Limit

CA DOHS ELAP Accreditation/Registration Number 1233

3249 Fitzgerald Road
Rancho Cordova, CA 95742
(916) 638-7301
Fax (916) 638-4510

3083 Gold Canal Drive
Rancho Cordova, CA 95670
(916) 852-6600
Fax (916) 852-7292

CLS Labs

Analysis Report: Fuel Fingerprinting, EPA 8015 Modified
Sonication, EPA Method 3550

Client: McLaren/Hart-Alameda
1135 Atlantic Avenue
Alameda, CA 94501

Project No.: 04.0602457.001.001
Contact: Scott Allin
Phone: (510)748-5694

Project: Bank of America

Date Sampled: 06/19/97
Date Received: 06/23/97
Date Extracted: 06/24/97
Date Analyzed: 06/30/97
Date Reported: 07/01/97
Client ID No.: M-4 46103 5.0'-6.0'

Lab Contact: George Hampton
Lab ID No.: N8120-5A
Job No.: 808120
COC Log No.: 28543,26,03126
Batch No.: 19912
Instrument ID: PGC06
Analyst ID: SEPIDEHS
Matrix: SOIL

M-4 46103 5.0'-6.0'

Analyte	CAS No.	Results (mg/kg)	Rep. Limit (mg/kg)	Dilution (factor)
Gasoline	N/A	360	100	100

ND = Not detected at or above indicated Reporting Limit

CLS Labs

Analysis Report: Fuel Fingerprinting, EPA 8015 Modified
Sonication, EPA Method 3550

Client: McLaren/Hart-Alameda
1135 Atlantic Avenue
Alameda, CA 94501

Project No.: 04.0602457.001.001
Contact: Scott Allin
Phone: (510)748-5694

Project: Bank of America

Lab Contact: George Hampton
Lab ID No.: N8120-7A
Job No.: 808120
COC Log No.: 28543,26,03126
Batch No.: 19912
Instrument ID: PGC06
Analyst ID: SEPIDEHS
Matrix: SOIL

Date Sampled: 06/19/97
Date Received: 06/23/97
Date Extracted: 06/24/97
Date Analyzed: 06/30/97
Date Reported: 07/01/97
Client ID No.: M-3 46104 5.0'-6.0'

M-3 46104 5.0'-6.0'

Analyte	CAS No.	Results (mg/kg)	Rep. Limit (mg/kg)	Dilution (factor)
Gasoline	N/A	1200	200	200

ND = Not detected at or above indicated Reporting Limit

CLS Labs

Analysis Report: Fuel Fingerprinting, EPA 8015 Modified
Sonication, EPA Method 3550

Client: McLaren/Hart-Alameda
1135 Atlantic Avenue
Alameda, CA 94501

Project No.: 04.0602457.001.001
Contact: Scott Allin
Phone: (510)748-5694

Project: Bank of America

Lab Contact: George Hampton
Lab ID No.: N8120
Job No.: 808120
COC Log No.: 28543,26,03126
Batch No.: 19912
Instrument ID: PGC06
Analyst ID: SEPIDEHS
Matrix: SOIL

Date Extracted: 06/24/97
Date Analyzed: 06/26/97
Date Reported: 07/01/97

METHOD BLANK

Analyte	CAS No.	Results (mg/kg)	Reporting Limit (mg/kg)
Petroleum Hydrocarbons (C7-C32)	N/A	ND	1.0

ND = Not detected at or above indicated Reporting Limit

CLAS 0005 CLAP Accreditation/Registration number 1233

3249 Fitzgerald Road
Rancho Cordova, CA 95742
(916) 638-7301
Fax (916) 638-4510

3083 Gold Canal Drive
Rancho Cordova, CA 95670
(916) 852-6600
Fax (916) 852-7292

CLS Labs

Analysis Report: Fuel Fingerprinting, EPA 8015 Modified
Sonication, EPA Method 3550

Client: McLaren/Hart-Alameda
1135 Atlantic Avenue
Alameda, CA 94501

Project No.: 04.0602457.001.001
Contact: Scott Allin
Phone: (510)748-5694

Project: Bank of America

Date Extracted: 06/24/97
Date Analyzed: 06/27/97
Date Reported: 07/01/97

Lab Contact: George Hampton
Lab ID No.: N8120
Job No.: 808120
COC Log No.: 28543,26,03126
Batch No.: 19912
Instrument ID: PGC06
Analyst ID: SEPIDEHS
Matrix: SOIL

LAB CONTROL SAMPLE

Analyte	CAS No.	LCS Conc. (mg/kg)	LCS Recovery (percent)
Diesel (C12-C22)	N/A	5.00	63
LAB CONTROL SAMPLE DUPLICATE			

Analyte	CAS No.	LCS Conc. (mg/kg)	LCSD Recovery (percent)
Diesel (C12-C22)	N/A	5.00	64
LCS RPD			

Analyte	CAS No.	LCS Relative Percent Difference (percent)
Diesel (C12-C22)	N/A	2

CA DMPS LLAP AGENCY LISTING/REGISTRATION NUMBER 1233

3249 Fitzgerald Road
Rancho Cordova, CA 95742
(916) 638-7301
Fax (916) 638-4510

3083 Gold Canal Drive
Rancho Cordova, CA 95670
(916) 852-6600

CLS Labs

Analysis Report: Fuel Fingerprinting, EPA 8015 Modified
Separatory Funnel, EPA Method 3510

Client: McLaren/Hart-Alameda
1135 Atlantic Avenue
Alameda, CA 94501

Project No.: 04.0602457.001.001
Contact: Scott Allin
Phone: (510)748-5694

Project: Bank of America

Date Sampled: 06/19/97
Date Received: 06/23/97
Date Extracted: 06/25/97
Date Analyzed: 06/30/97
Date Reported: 07/01/97
Client ID No.: M-1 519705

Lab Contact: George Hampton
Lab ID No.: N8120-2B
Job No.: 808120
COC Log No.: 28543,26,03126
Batch No.: 19928
Instrument ID: PGC04
Analyst ID: SEPIDEHS
Matrix: WATER

M-1 519705

Analyte	CAS No.	Results (mg/L)	Rep. Limit (mg/L)	Dilution (factor)
Gasoline	N/A	160	12	200

ND = Not detected at or above indicated Reporting Limit

CA 0085 CLAP Accreditation/Registration Number 1233

3249 Fitzgerald Road
Rancho Cordova, CA 95742
(916) 638-7301
Fax (916) 638-4510

3083 Gold Canal Drive
Rancho Cordova, CA 95670
(916) 852-6600
Fax (916) 852-7292

CLS Labs

Analysis Report: Fuel Fingerprinting, EPA 8015 Modified
Separatory Funnel, EPA Method 3510

Client: McLaren/Hart-Alameda
1135 Atlantic Avenue
Alameda, CA 94501

Project No.: 04.0602457.001.001
Contact: Scott Allin
Phone: (510)748-5694

Project: Bank of America

Lab Contact: George Hampton
Lab ID No.: N8120-4B
Job No.: 808120
COC Log No.: 28543,26,03126
Batch No.: 19928
Instrument ID: PGC04
Analyst ID: SEPIDEHS
Matrix: WATER

Date Sampled: 06/19/97
Date Received: 06/23/97
Date Extracted: 06/25/97
Date Analyzed: 06/30/97
Date Reported: 07/01/97
Client ID No.: M-2 519711

M-2 519711

Analyte	CAS No.	Results (mg/L)	Rep. Limit (mg/L)	Dilution (factor)
Gasoline	N/A	220	22	400

ND - Not detected at or above indicated Reporting Limit

CA 1995 CLAP ACCOUNTS/REGISTRATION NUMBER 1211

3249 Fitzgerald Road
Rancho Cordova, CA 95742
(916) 638-7301
Fax (916) 638-4510

3083 Gold Canal Drive
Rancho Cordova, CA 95670
(916) 852-6600
Fax (916) 852-7292

CLS Labs

Analysis Report: Fuel Fingerprinting, EPA 8015 Modified
Separatory Funnel, EPA Method 3510

Client: McLaren/Hart-Alameda
1135 Atlantic Avenue
Alameda, CA 94501

Project No.: 04.0602457.001.001
Contact: Scott Allin
Phone: (510)748-5694

Project: Bank of America

Lab Contact: George Hampton
Lab ID No.: N8120-8B
Job No.: 808120
COC Log No.: 28543,26,03126
Batch No.: 19928
Instrument ID: PGC04
Analyst ID: SEPIDEHS
Matrix: WATER

Date Sampled: 06/19/97
Date Received: 06/23/97
Date Extracted: 06/25/97
Date Analyzed: 06/30/97
Date Reported: 07/01/97
Client ID No.: M-3 519721

M-3 519721

Analyte	CAS No.	Results (mg/L)	Rep. Limit (mg/L)	Dilution (factor)
Gasoline	N/A	1300	70	1000

ND = Not detected at or above indicated Reporting Limit

CLS Labs

Analysis Report: Fuel Fingerprinting, EPA 8015 Modified
Separatory Funnel, EPA Method 3510

Client: McLaren/Hart-Alameda
1135 Atlantic Avenue
Alameda, CA 94501

Project No.: 04.0602457.001.001
Contact: Scott Allin
Phone: (510)748-5694

Project: Bank of America

Lab Contact: George Hampton
Lab ID No.: N8120-6B
Job No.: 808120
COC Log No.: 28543,26,03126
Batch No.: 19928
Instrument ID: PGC04
Analyst ID: SEPIDEHS
Matrix: WATER

Date Sampled: 06/19/97
Date Received: 06/23/97
Date Extracted: 06/25/97
Date Analyzed: 06/30/97
Date Reported: 07/01/97
Client ID No.: M-4 519716

M-4 519716

Analyte	CAS No.	Results (mg/L)	Rep. Limit (mg/L)	Dilution (factor)
Gasoline	N/A	31	2.8	40

ND = Not detected at or above indicated Reporting Limit

LABORATORY REPORT NUMBER: 1221

3249 Fitzgerald Road
Rancho Cordova, CA 95742
(916) 638-7301
Fax (916) 638-4510

3083 Gold Canal Drive
Rancho Cordova, CA 95670
(916) 852-6600
Fax (916) 852-7292

CLS Labs

Analysis Report: Fuel Fingerprinting, EPA 8015 Modified
Separatory Funnel, EPA Method 3510

Client: McLaren/Hart-Alameda
1135 Atlantic Avenue
Alameda, CA 94501

Project No.: 04.0602457.001.001
Contact: Scott Allin
Phone: (510)748-5694

Project: Bank of America

Date Sampled: 06/19/97
Date Received: 06/23/97
Date Extracted: 06/25/97
Date Analyzed: 06/30/97
Date Reported: 07/01/97
Client ID No.: M-6 519736

Lab Contact: George Hampton
Lab ID No.: N8120-10B
Job No.: 808120
COC Log No.: 28543,26,03126
Batch No.: 19928
Instrument ID: PGC04
Analyst ID: SEPIDEHS
Matrix: WATER

M-6 519736

Analyte	CAS No.	Results (mg/L)	Rep. Limit (mg/L)	Dilution (factor)
Gasoline	N/A	21	2.8	40

ND - Not detected at or above indicated Reporting Limit

CLS Labs Accreditation/Registration Number 1233

3249 Fitzgerald Road
Rancho Cordova, CA 95742
(916) 638-7301
Fax (916) 638-7301

3083 Gold Canal Drive
Rancho Cordova, CA 95670
(916) 852-6600
Fax (916) 852-7292

CLS Labs

Analysis Report: Fuel Fingerprinting, EPA 8015 Modified
Separatory Funnel, EPA Method 3510

Client: McLaren/Hart-Alameda
1135 Atlantic Avenue
Alameda, CA 94501

Project No.: 04.0602457.001.001
Contact: Scott Allin
Phone: (510)748-5694

Project: Bank of America

Lab Contact: George Hampton
Lab ID No.: N8120-12B
Job No.: 808120
COC Log No.: 28543,26,03126
Batch No.: 19928
Instrument ID: PGC04
Analyst ID: SEPIDEHS
Matrix: WATER

Date Sampled: 06/19/97
Date Received: 06/23/97
Date Extracted: 06/25/97
Date Analyzed: 07/01/97
Date Reported: 07/01/97
Client ID No.: M-5 519741

M-5 519741

Analyte	CAS No.	Results (mg/L)	Rep. Limit (mg/L)	Dilution (factor)
Gasoline	N/A	1.2	1.0	20

ND = Not detected at or above indicated Reporting Limit

CA 0907, 11:00 AM, 06/25/97, 04.0602457.001.001, 12:15

3249 Fitzgerald Road
Rancho Cordova, CA 95742
(916) 638-7301
Fax (916) 638-4510

3083 Gold Canal Drive
Rancho Cordova, CA 95670
(916) 852-6600
Fax (916) 852-7292

CLS Labs

Analysis Report: Fuel Fingerprinting, EPA 8015 Modified
Separatory Funnel, EPA Method 3510

Client: McLaren/Hart-Alameda
1135 Atlantic Avenue
Alameda, CA 94501

Project No.: 04.0602457.001.001
Contact: Scott Allin
Phone: (510)748-5694

Project: Bank of America

Date Sampled: 06/19/97
Date Received: 06/23/97
Date Extracted: 06/25/97
Date Analyzed: 07/01/97
Date Reported: 07/01/97
Client ID No.: M-8 519726

Lab Contact: George Hampton
Lab ID No.: N8120-14B
Job No.: 808120
COC Log No.: 28543,26,03126
Batch No.: 19928
Instrument ID: PGC04
Analyst ID: SEPIDEHS
Matrix: WATER

M-8 519726

Analyte	CAS No.	Results (mg/L)	Rep. Limit (mg/L)	Dilution (factor)
Gasoline	N/A	0.32	0.25	5.0
Motor Oil (C22-C32)	N/A	0.51	0.25	5.0

ND - Not detected at or above indicated Reporting Limit

CLS LABS ACCOUNTING/REGISTRATION NUMBER 1233

3249 Fitzgerald Road
Rancho Cordova, CA 95742
(916) 638-7301
Fax (916) 638-4510

3083 Gold Canal Drive
Rancho Cordova, CA 95670
(916) 852-6600
Fax (916) 852-7292

CLS Labs

Analysis Report: Fuel Fingerprinting, EPA 8015 Modified
Separatory Funnel, EPA Method 3510

Client: McLaren/Hart-Alameda
1135 Atlantic Avenue
Alameda, CA 94501

Project No.: 04.0602457.001.001
Contact: Scott Allin
Phone: (510)748-5694

Project: Bank of America

Lab Contact: George Hampton
Lab ID No.: N8120-16B
Job No.: 808120
COC Log No.: 28543,26,03126
Batch No.: 19928
Instrument ID: PGC04
Analyst ID: SEPIDEHS
Matrix: WATER

Date Sampled: 06/20/97
Date Received: 06/23/97
Date Extracted: 06/25/97
Date Analyzed: 06/30/97
Date Reported: 07/01/97
Client ID No.: M-7 517824

M-7 517824

Analyte	CAS No.	Results (mg/L)	Rep. Limit (mg/L)	Dilution (factor)
Motor Oil (C22-C32)	N/A	3.4	1.6	20

ND - Not detected at or above indicated Reporting Limit

CLS Labs

Analysis Report: Fuel Fingerprinting, EPA 8015 Modified
Separatory Funnel, EPA Method 3510

Client: McLaren/Hart-Alameda
1135 Atlantic Avenue
Alameda, CA 94501

Project No.: 04.0602457.001.001
Contact: Scott Allin
Phone: (510)748-5694

Project: Bank of America

Lab Contact: George Hampton
Lab ID No.: N8120-17B
Job No.: 808120
COC Log No.: 28543,26,03126
Batch No.: 19928
Instrument ID: PGC04
Analyst ID: SEPIDEHS
Matrix: WATER

Date Sampled: 06/19/97
Date Received: 06/23/97
Date Extracted: 06/25/97
Date Analyzed: 06/30/97
Date Reported: 07/01/97
Client ID No.: MW-1 519610-11

MW-1 519610-11

Analyte	CAS No.	Results (mg/L)	Rep. Limit (mg/L)	Dilution (factor)
Gasoline	N/A	5.0	0.25	5.0

ND - Not detected at or above indicated Reporting Limit

CA 0005 11-97 Accredited and Registered for 12/97

3249 Fitzgerald Road
Rancho Cordova, CA 95742
(916) 638-7301
Fax (916) 638-4510

3083 Gold Canal Drive
Rancho Cordova, CA 95670
(916) 852-6600
Fax (916) 852-7260

CLS Labs

Analysis Report: Fuel Fingerprinting, EPA 8015 Modified
Separatory Funnel, EPA Method 3510

Client: McLaren/Hart-Alameda
1135 Atlantic Avenue
Alameda, CA 94501

Project No.: 04.0602457.001.001
Contact: Scott Allin
Phone: (510)748-5694

Project: Bank of America

Lab Contact: George Hampton
Lab ID No.: N8120
Job No.: 808120
COC Log No.: 28543,26,03126
Batch No.: 19928
Instrument ID: FGC04
Analyst ID: SEPIDEHS
Matrix: WATER

Date Extracted: 06/25/97
Date Analyzed: 06/27/97
Date Reported: 07/01/97

METHOD BLANK

Analyte	CAS No.	Results (mg/L)	Reporting Limit (mg/L)
Petroleum Hydrocarbons (C7-C32)	N/A	ND	0.050

ND = Not detected at or above indicated Reporting Limit

CLS Labs

Analysis Report: Fuel Fingerprinting, EPA 8015 Modified
Separatory Funnel, EPA Method 3510

Client: McLaren/Hart-Alameda
1135 Atlantic Avenue
Alameda, CA 94501

Project No.: 04.0602457.001.001
Contact: Scott Allin
Phone: (510)748-5694

Project: Bank of America

Lab Contact: George Hampton
Lab ID No.: N8120
Job No.: 808120
COC Log No.: 28543,26,03126
Batch No.: 19928
Instrument ID: PGC04
Analyst ID: SEPIDEHS
Matrix: WATER

Date Extracted: 06/25/97
Date Analyzed: 07/01/97
Date Reported: 07/01/97

LAB CONTROL SAMPLE

Analyte	CAS No.	LCS Conc. (mg/L)	LCS Recovery (percent)
Diesel (C12-C22)	N/A	0.500	82

LAB CONTROL SAMPLE DUPLICATE

Analyte	CAS No.	LCS Conc. (mg/L)	LCSD Recovery (percent)
Diesel (C12-C22)	N/A	0.500	77

LCS RPD

Analyte	CAS No.	LCS Relative Percent Difference (percent)
Diesel (C12-C22)	N/A	6

LAB REPORT GENERATED BY: (510) 748-5694

3249 Fitzgerald Road
Rancho Cordova, CA 95742
(916) 638-7301
Fax (916) 638-4510

3083 Gold Canal Drive
Rancho Cordova, CA 95670
(916) 852-6600
Fax (916) 852-7392

CLS Labs

Analysis Report: Total Petroleum Hydrocarbons, EPA Method 8015
Purge and Trap, EPA Method 5030

Client: McLaren/Hart-Alameda
1135 Atlantic Avenue
Alameda, CA 94501

Project No.: 04.0602457.001.001
Contact: Scott Allin
Phone: (510)748-5694

Project: Bank of America

Date Sampled: 06/20/97
Date Received: 06/23/97
Date Extracted: 06/24/97
Date Analyzed: 06/25/97
Date Reported: 06/27/97
Client ID No.: M-7 517820-23

Lab Contact: George Hampton
Lab ID No.: N8120-16A
Job No.: 808120
COC Log No.: 28543,26,03126
Batch No.: 19911
Instrument ID: GC018
Analyst ID: JENNDNC
Matrix: WATER

SURROGATE

Analyte	CAS No.	Surr Conc. (mg/L)	Surrogate Recovery (percent)
o-Chlorotoluene	95-49-8	0.0200	108

Sample: M-7 517820-23

Analyte	CAS No.	Results (mg/L)	Rep. Limit (mg/L)	Dilution (factor)
TPH as Gasoline	N/A	ND	0.050	1.0

ND = Not detected at or above indicated Reporting Limit

CA DOHS ELAP Accreditation/Registration Number 1233

3249 Fitzgerald Road
Rancho Cordova, CA 95742
(916) 638-7301
Fax (916) 638-4510

3083 Gold Canal Drive
Rancho Cordova, CA 95670
(916) 852-6600
Fax (916) 852-7292

CLS Labs

Analysis Report: Total Petroleum Hydrocarbons, EPA Method 8015
Purge and Trap, EPA Method 5030

Client: McLaren/Hart-Alameda
1135 Atlantic Avenue
Alameda, CA 94501

Project No.: 04.0602457.001.001
Contact: Scott Allin
Phone: (510)748-5694

Project: Bank of America

Date Sampled: 06/19/97
Date Received: 06/23/97
Date Extracted: 06/24/97
Date Analyzed: 06/24/97
Date Reported: 06/27/97
Client ID No.: MW-1 519612-15

Lab Contact: George Hampton
Lab ID No.: N8120-17A
Job No.: 808120
COC Log No.: 28543,26,03126
Batch No.: 19911
Instrument ID: GC018
Analyst ID: JENNDG
Matrix: WATER

SURROGATE

Analyte	CAS No.	Surr Conc. (mg/L)	Surrogate Recovery (percent)
o-Chlorotoluene	95-49-8	1.00	95

Sample: MW-1 519612-15

Analyte	CAS No.	Results (mg/L)	Rep. Limit (mg/L)	Dilution (factor)
TPH as Gasoline	N/A	20	2.5	50

ND = Not detected at or above indicated Reporting Limit

CA DOHS ELAP Accreditation/Registration Number 1233

3249 Fitzgerald Road
Rancho Cordova, CA 95742
(916) 638-7301
Fax (916) 638-4510

3083 Gold Canal Drive
Rancho Cordova, CA 95670
(916) 852-6600
Fax (916) 852-7222

CLS Labs

Analysis Report: Total Petroleum Hydrocarbons, EPA Method 8015
Purge and Trap, EPA Method 5030

Client: McLaren/Hart-Alameda
1135 Atlantic Avenue
Alameda, CA 94501

Project No.: 04.0602457.001.001
Contact: Scott Allin
Phone: (510)748-5694

Project: Bank of America

Date Extracted: 06/24/97
Date Analyzed: 06/24/97
Date Reported: 06/27/97

Lab Contact: George Hampton
Lab ID No.: N8120
Job No.: 808120
COC Log No.: 28543,26,03126
Batch No.: 19911
Instrument ID: GC018
Analyst ID: JENNDC
Matrix: WATER

MB SURROGATE

Analyte	CAS No.	Surr Conc. (mg/L)	MB Surrogate Recovery (percent)
o-Chlorotoluene	95-49-8	0.0200	109

METHOD BLANK

Analyte	CAS No.	Results (mg/L)	Reporting Limit (mg/L)
TPH as Gasoline	N/A	ND	0.050

ND = Not detected at or above indicated Reporting Limit

CA DOHS ELAP Accreditation/Registration Number 1233

3249 Fitzgerald Road
Rancho Cordova, CA 95742
(916) 638-7301
Fax (916) 638-4510

3083 Gold Canal Drive
Rancho Cordova, CA 95670
(916) 852-6600
Fax (916) 852-7292

CLS Labs

Analysis Report: Aromatic Volatile Organics, EPA Method 8020
Purge and Trap, EPA Method 5030

Client: McLaren/Hart-Alameda
1135 Atlantic Avenue
Alameda, CA 94501

Project No.: 04.0602457.001.001
Contact: Scott Allin
Phone: (510) 748-5694

Project: Bank of America

Lab Contact: George Hampton
Lab ID No.: N8120-1A
Job No.: 808120
COC Log No.: 28543,26,03126
Batch No.: 19911
Instrument ID: GC018
Analyst ID: JENNDG
Matrix: SOIL

Date Sampled: 06/19/97
Date Received: 06/23/97
Date Extracted: 06/24/97
Date Analyzed: 06/24/97
Date Reported: 06/27/97
Client ID No.: M-1 46101 6.0'-6.5'

SURROGATE

Analyte	CAS No.	Surr Conc. (ug/kg)	Surrogate Recovery (percent)
o-Chlorotoluene	95-49-8	50000	91

Sample: M-1 46101 6.0'-6.5'

Analyte	CAS No.	Results (ug/kg)	Rep. Limit (ug/kg)	Dilution (factor)
Methyl t-butyl ether	1634-04-4	ND	40000	500
Benzene	71-43-2	4500	2500	500
Toluene	108-88-3	45000	2500	500
Ethylbenzene	100-41-4	4100	2500	500
Xylenes, total	1330-20-7	110000	5000	500

ND = Not detected at or above indicated Reporting Limit

CA DOHS ELAP Accreditation/Registration Number 1213

3249 Fitzgerald Road
Rancho Cordova, CA 95742
(916) 638-7301
Fax (916) 638-4310

3083 Gold Canal Drive
Rancho Cordova, CA 95670
(916) 852-6600
Fax (916) 852-7292

CLS Labs

Analysis Report: Aromatic Volatile Organics, EPA Method 8020
Purge and Trap, EPA Method 5030

Client: McLaren/Hart-Alameda
1135 Atlantic Avenue
Alameda, CA 94501

Project No.: 04.0602457.001.001
Contact: Scott Allin
Phone: (510)748-5694

Project: Bank of America

Lab Contact: George Hampton
Lab ID No.: N8120-7A
Job No.: 808120
COC Log No.: 28543,26,03126
Batch No.: 19911
Instrument ID: GC018
Analyst ID: JENNDG
Matrix: SOIL

Date Sampled: 06/19/97
Date Received: 06/23/97
Date Extracted: 06/24/97
Date Analyzed: 06/24/97
Date Reported: 06/27/97
Client ID No.: M-3 46104 5.0'-6.0'

SURROGATE

Analyte	CAS No.	Surr Conc. (ug/kg)	Surrogate Recovery (percent)
o-Chlorotoluene	95-49-8	10000	72

Sample: M-3 46104 5.0'-6.0'

Analyte	CAS No.	Results (ug/kg)	Rep. Limit (ug/kg)	Dilution (factor)
Methyl t-butyl ether	1634-04-4	ND	8000	100
Benzene	71-43-2	1300	500	100
Toluene	108-88-3	23000	500	100
Ethylbenzene	100-41-4	17000	500	100
Xylenes, total	1330-20-7	97000	5000	500

ND = Not detected at or above indicated Reporting Limit

CA DOHS ELAP Accreditation/Registration Number 1233

3249 Fitzgerald Road
Rancho Cordova, CA 95742
(916) 638-7301
Fax (916) 638-4510

3083 Gold Canal Drive
Rancho Cordova, CA 95670
(916) 852-6600
Fax (916) 852-7292

CLS Labs

Analysis Report: Aromatic Volatile Organics, EPA Method 8020
Purge and Trap, EPA Method 5030

Client: McLaren/Hart-Alameda
1135 Atlantic Avenue
Alameda, CA 94501

Project No.: 04.0602457.001.001
Contact: Scott Allin
Phone: (510)748-5694

Project: Bank of America

Date Extracted: 06/24/97
Date Analyzed: 06/24/97
Date Reported: 06/27/97

Lab Contact: George Hampton
Lab ID No.: N8120
Job No.: 808120
COC Log No.: 28543,26,03126
Batch No.: 19911
Instrument ID: GC018
Analyst ID: JENNDG
Matrix: SOIL

MB SURROGATE

Analyte	CAS No.	Surr Conc. (ug/kg)	MB Surrogate Recovery (percent)
o-Chlorotoluene	95-49-8	100	102

METHOD BLANK

Analyte	CAS No.	Results (ug/kg)	Reporting Limit (ug/kg)
Methyl t-butyl ether	1634-04-4	ND	80
Benzene	71-43-2	ND	5.0
Toluene	108-88-3	ND	5.0
Ethylbenzene	100-41-4	ND	5.0
Xylenes, total	1330-20-7	ND	10

ND = Not detected at or above indicated Reporting Limit

CA DOHS ELAP Accreditation/Registration Number 1233

3249 Fitzgerald Road
Rancho Cordova, CA 95742
(916) 638-7301
Fax (916) 638-4510

3083 Gold Canal Drive
Rancho Cordova, CA 95670
(916) 852-6600
Fax (916) 852-7292

CLS Labs

Analysis Report: Aromatic Volatile Organics, EPA Method 8020
Purge and Trap, EPA Method 5030

Client: McLaren/Hart-Alameda
1135 Atlantic Avenue
Alameda, CA 94501

Project No.: 04.0602457.001.001
Contact: Scott Allin
Phone: (510)748-5694

Project: Bank of America

Date Extracted: 06/24/97
Date Analyzed: 06/24/97
Date Reported: 06/27/97

Lab Contact: George Hampton
Lab ID No.: N8120
Job No.: 808120
COC Log No.: 28543,26,03126
Batch No.: 19911
Instrument ID: GC018
Analyst ID: JENNDC
Matrix: SOIL

MS SURROGATE

Analyte	CAS No.	MS Surr. Conc. (ug/kg)	MS Surrogate Recovery (percent)
o-Chlorotoluene	95-49-8	10000	91

MATRIX SPIKE

Analyte	CAS No.	MS Conc. (ug/kg)	MS Recovery (percent)
Benzene	71-43-2	10000	93
Toluene	108-88-3	10000	108

MSD SURROGATE

Analyte	CAS No.	Surr. Conc. (ug/kg)	MSD Surrogate Recovery (percent)
o-Chlorotoluene	95-49-8	10000	90

MATRIX SPIKE DUPLICATE

Analyte	CAS No.	MSD Conc. (ug/kg)	MSD Recovery (percent)
Benzene	71-43-2	10000	93
Toluene	108-88-3	10000	121

RELATIVE % DIFFERENCE

Analyte	CAS No.	Relative Percent Difference (percent)

CA DOHS ELAP Accreditation/Registration Number 1233

3249 Fitzgerald Road
Rancho Cordova, CA 95742
(916) 638-7301
Fax (916) 638-4510

3083 Gold Canal Drive
Rancho Cordova, CA 95670
(916) 852-6600
Fax (916) 852-7292

CLS Labs

Analysis Report: Aromatic Volatile Organics, EPA Method 8020
Purge and Trap, EPA Method 5030

Client: McLaren/Hart-Alameda
1135 Atlantic Avenue
Alameda, CA 94501

Project No.: 04.0602457.001.001
Contact: Scott Allin
Phone: (510)748-5694

Project: Bank of America

Date Extracted: 06/24/97
Date Analyzed: 06/24/97
Date Reported: 06/27/97

Lab Contact: George Hampton
Lab ID No.: N8120
Job No.: 808120
COC Log No.: 28543,26,03126
Batch No.: 19911
Instrument ID: GC018
Analyst ID: JENNDK
Matrix: SOIL

RELATIVE % DIFFERENCE (cont.)

Analyte	CAS No.	Relative Percent Difference (percent)
Benzene	71-43-2	0
Toluene	108-88-3	11

CA DOHS ELAP Accreditation/Registration Number 1233

3249 Fitzgerald Road
Rancho Cordova, CA 95742
(916) 638-7301
Fax (916) 638-4510

3083 Gold Canal Drive
Rancho Cordova, CA 95670
(916) 852-6600
Fax (916) 852-7292

CLS Labs

Analysis Report: Aromatic Volatile Organics, EPA Method 8020
Purge and Trap, EPA Method 5030

Client: McLaren/Hart-Alameda
1135 Atlantic Avenue
Alameda, CA 94501

Project No.: 04.0602457.001.001
Contact: Scott Allin
Phone: (510)748-5694

Project: Bank of America

Date Extracted: 06/24/97
Date Analyzed: 06/24/97
Date Reported: 06/27/97

Lab Contact: George Hampton
Lab ID No.: N8120
Job No.: 808120
COC Log No.: 28543,26,03126
Batch No.: 19911
Instrument ID: GC018
Analyst ID: JENNDC
Matrix: SOIL

LCS SURROGATE

Analyte	CAS No.	LCS Conc. (ug/kg)	LCS Surrogate Recovery (percent)
o-Chlorotoluene	95-49-8	100	101

LAB CONTROL SAMPLE

Analyte	CAS No.	LCS Conc. (ug/kg)	LCS Recovery (percent)
Benzene	71-43-2	100	106
Toluene	108-88-3	100	102

CA DOHS ELAP Accreditation/Registration Number 1233

3249 Fitzgerald Road
Rancho Cordova, CA 95742
(916) 638-7301
Fax (916) 638-4510

3083 Gold Canal Drive
Rancho Cordova, CA 95670
(916) 852-6600
Fax (916) 852-7292

CLS Labs

Analysis Report: Total Petroleum Hydrocarbons, EPA Method 8015
Purge and Trap, EPA Method 5030

Client: McLaren/Hart-Alameda
1135 Atlantic Avenue
Alameda, CA 94501

Project No.: 04.0602457.001.001
Contact: Scott Allin
Phone: (510)748-5694

Project: Bank of America

Date Sampled: 06/19/97
Date Received: 06/23/97
Date Extracted: 06/24/97
Date Analyzed: 06/24/97
Date Reported: 06/27/97
Client ID No.: M-1 46101 6.0'-6.5'

Lab Contact: George Hampton
Lab ID No.: N8120-1A
Job No.: 808120
COC Log No.: 28543,26,03126
Batch No.: 19911
Instrument ID: GC018
Analyst ID: JENNDNC
Matrix: SOIL

SURROGATE

Analyte	CAS No.	Surr Conc. (mg/kg)	Surrogate Recovery (percent)
o-Chlorotoluene	95-49-8	50.0	94

Sample: M-1 46101 6.0'-6.5'

Analyte	CAS No.	Results (mg/kg)	Rep. Limit (mg/kg)	Dilution (factor)
TPH as Gasoline	N/A	1100	500	500

ND = Not detected at or above indicated Reporting Limit

CA DOHS ELAP Accreditation/Registration Number 1233

3249 Fitzgerald Road
Rancho Cordova, CA 95742
(916) 638-7301
Fax (916) 638-4510

3083 Gold Canal Drive
Rancho Cordova, CA 95670
(916) 852-6600
Fax (916) 852-7232

CLS Labs

Analysis Report: Fuel Fingerprinting, EPA 8015 Modified
Sonication, EPA Method 3550

Client: McLaren/Hart-Alameda
1135 Atlantic Avenue
Alameda, CA 94501

Project No.: 04.0602457.001.001
Contact: Scott Allin
Phone: (510)748-5694

Project: Bank of America

Lab Contact: George Hampton
Lab ID No.: N8120-3A
Job No.: 808120
COC Log No.: 28543,26,03126
Batch No.: 19912
Instrument ID: PGC06
Analyst ID: SEPIDEHS
Matrix: SOIL

Date Sampled: 06/19/97
Date Received: 06/23/97
Date Extracted: 06/24/97
Date Analyzed: 06/30/97
Date Reported: 07/01/97
Client ID No.: M-2 46102 5.0'-6.0'

M-2 46102 5.0'-6.0'

Analyte	CAS No.	Results (mg/kg)	Rep. Limit (mg/kg)	Dilution (factor)
Gasoline	N/A	4800	1000	1000

ND = Not detected at or above indicated Reporting Limit

CA DRUG TEST ACCREDITED TO CALIFORNIA HEALTH SERVICES REGULATORY AGENCY (CHSRA) 12/01

3249 Fitzgerald Road
Rancho Cordova, CA 95742
(916) 638-7301
Fax: (916) 638-4510

3083 Gold Canal Drive
Rancho Cordova, CA 95670
(916) 852-6600
Fax: (916) 852-6600

CLS Labs

Analysis Report: Total Petroleum Hydrocarbons, EPA Method 8015
Purge and Trap, EPA Method 5030

Client: McLaren/Hart-Alameda
1135 Atlantic Avenue
Alameda, CA 94501

Project No.: 04.0602457.001.001
Contact: Scott Allin
Phone: (510)748-5694

Project: Bank of America

Date Sampled: 06/19/97
Date Received: 06/23/97
Date Extracted: 06/24/97
Date Analyzed: 06/24/97
Date Reported: 06/27/97
Client ID No.: M-2 46102 5.0'-6.0'

Lab Contact: George Hampton
Lab ID No.: N8120-3A
Job No.: 808120
COC Log No.: 28543,26,03126
Batch No.: 19911
Instrument ID: GC018
Analyst ID: JENNDNC
Matrix: SOIL

SURROGATE

Analyte	CAS No.	Surr Conc. (mg/kg)	Surrogate Recovery (percent)
o-Chlorotoluene	95-49-8	10.0	85

Sample: M-2 46102 5.0'-6.0'

Analyte	CAS No.	Results (mg/kg)	Rep. Limit (mg/kg)	Dilution (factor)
TPH as Gasoline	N/A	330	100	100

ND = Not detected at or above indicated Reporting Limit

CA DOHS ELAP Accreditation/Registration Number 1233

3249 Fitzgerald Road
Rancho Cordova, CA 95742
(916) 838-7301
Fax (916) 638-4510

3083 Gold Canal Drive
Rancho Cordova, CA 95670
(916) 852-6600
Fax (916) 852-7292

REPORT TO:		CLIENT JOB NUMBER	ANALYSIS REQUESTED				FIELD CONDITIONS: Sunny, 70°											
ADDRESS McLaren Hart 1135 Atlantic Ave Alameda, CA 94501		DESTINATION LABORATORY <input checked="" type="checkbox"/> CLS (916) 638-7301 3249 FITZGERALD RD. RANCHO CORDOVA, CA 95742	PRESERVATIVES BTEX/MTBE 8020								COMPOSITE:							
PROJECT MANAGER Scott Allin 510-521-5200		<input type="checkbox"/> OTHER									TURN AROUND TIME				SPECIAL INSTRUCTIONS			
PROJECT NAME B & A											1 DAY	2 DAY	5 DAY	10 DAY				
SAMPLED BY M/SC																		
JOB DESCRIPTION																		
SITE LOCATION San Leandro																		

DATE	TIME	SAMPLE IDENTIFICATION	MATRIX	CONTAINER		PRESERVATIVE	1 DAY	2 DAY	5 DAY	10 DAY	SPECIAL INSTRUCTIONS
				NO.	TYPE						
3/15/98	0840	M-11 556904-06	H ₂ O	3	40ml V	HCl				X	
	1000	M-14 556916-18	↓	↓	↓	↓					
	0915	M-10 556910-12	↓	↓	↓	↓					
	0855	M-13 556907-09	↓	↓	↓	↓					
	0820	M-9 556901-03	↓	↓	↓	↓					
	0930	M-14 556913-15	↓	↓	↓	↓					
	1300	M-15 556922-24	↓	↓	↓	↓					
		12 SA									

USPECTED CONSTITUENTS	SAMPLE RETENTION TIME	PRESERVATIVES: (1) HCL (2) HNO ₃	(3) = GOLD (4)
-----------------------	-----------------------	---	----------------

RELINQUISHED BY (SIGN) <i>M. Parks</i>	PRINT NAME / COMPANY M. Parks / McLaren Hart	DATE / TIME 3/15/98 1000	RECEIVED BY (SIGN)	PRINT NAME / COMPANY
---	---	-----------------------------	--------------------	----------------------

SHIPPED AT LAB BY <i>M/SC</i>	DATE / TIME 3/20/98 1900	CONDITIONS / COMMENTS:
SHIPPED VIA	<input type="checkbox"/> FED X <input type="checkbox"/> UPS <input checked="" type="checkbox"/> OTHER <u>Express - IT</u>	AIR BILL #

CLS Labs

McLaren/Hart-Alameda
1135 Atlantic Avenue
Alameda, CA 94501

03/25/98

Attention: Scott Allin

Reference: Analytical Results

Project Name: B of A
Project No.:
Date Received: 03/20/98
Chain Of Custody: 32084

CLS ID No.: P2883
CLS Job No.: 812883

The following analyses were performed on the above referenced project:

<u>No. of Samples</u>	<u>Turnaround Time</u>	<u>Analysis Description</u>
7	10 Days	TPH as Gasoline, BTEX and MTBE

These samples were received by CLS Labs in a chilled, intact state and accompanied by a valid chain of custody document.

Calibrations for analytical testing have been performed in accordance to and pass the EPA's criteria for acceptability.

Analytical results are attached to this letter. Please call if we can provide additional assistance.

Sincerely,



George Hampton
Laboratory Director

CLS Labs

Analysis Report: EPA 8020, BTEX and MTBE
Purge and Trap, EPA Method 5030

Client: McLaren/Hart-Alameda
1135 Atlantic Avenue
Alameda, CA 94501

Project No.:
Contact: Scott Allin
Phone: (510) 521-5200

Project: B of A

Date Sampled: 03/18/98
Date Received: 03/20/98
Date Extracted: 03/24/98
Date Analyzed: 03/24/98
Date Reported: 03/25/98
Client ID No.: M-11 556904-06

Lab Contact: Ray Osowski
Lab ID No.: P2883-1A
Job No.: 812883
COC Log No.: 32084
Batch No.: 21972
Instrument ID: GC018
Analyst ID: JENNDG
Matrix: WATER

SURROGATE

Analyte	CAS No.	Surr Conc. (ug/L)	Surrogate Recovery (percent)
o-Chlorotoluene	95-49-8	20.0	101

Sample: M-11 556904-06

Analyte	CAS No.	Results (ug/L)	Rep. Limit (ug/L)	Dilution (factor)
Methyl t-butyl ether	1634-04-4	ND	1.0	1.0
Benzene	71-43-2	ND	0.30	1.0
Toluene	108-88-3	ND	0.30	1.0
Ethylbenzene	100-41-4	ND	0.30	1.0
Xylenes, total	1330-20-7	ND	0.60	1.0

ND = Not detected at or above indicated Reporting Limit

CLS Labs

Analysis Report: EPA 8020, BTEX and MTBE
Purge and Trap, EPA Method 5030

Client: McLaren/Hart-Alameda
1135 Atlantic Avenue
Alameda, CA 94501

Project No.:
Contact: Scott Allin
Phone: (510) 521-5200

Project: B of A

Date Sampled: 03/18/98
Date Received: 03/20/98
Date Extracted: 03/24/98
Date Analyzed: 03/24/98
Date Reported: 03/25/98
Client ID No.: M-14 556916-18

Lab Contact: Ray Oslowski
Lab ID No.: P2883-2A
Job No.: 812883
COC Log No.: 32084
Batch No.: 21972
Instrument ID: GC018
Analyst ID: JENNDG
Matrix: WATER

SURROGATE

Analyte	CAS No.	Surr Conc. (ug/L)	Surrogate Recovery (percent)
o-Chlorotoluene	95-49-8	20.0	100

Sample: M-14 556916-18

Analyte	CAS No.	Results (ug/L)	Rep. Limit (ug/L)	Dilution (factor)
Methyl t-butyl ether	1634-04-4	18	1.0	1.0
Benzene	71-43-2	0.75	0.30	1.0
Toluene	108-88-3	ND	0.30	1.0
Ethylbenzene	100-41-4	ND	0.30	1.0
Xylenes, total	1330-20-7	ND	0.60	1.0

ND = Not detected at or above indicated Reporting Limit

CLS Labs

Analysis Report: EPA 8020, BTEX and MTBE
Purge and Trap, EPA Method 5030

Client: McLaren/Hart-Alameda
1135 Atlantic Avenue
Alameda, CA 94501

Project No.:
Contact: Scott Allin
Phone: (510)521-5200

Project: B of A

Date Sampled: 03/18/98
Date Received: 03/20/98
Date Extracted: 03/24/98
Date Analyzed: 03/24/98
Date Reported: 03/25/98
Client ID No.: M-10 556910-12

Lab Contact: Ray Osowski
Lab ID No.: P2883-3A
Job No.: 812883
COC Log No.: 32084
Batch No.: 21972
Instrument ID: GC018
Analyst ID: JENNDG
Matrix: WATER

SURROGATE

Analyte	CAS No.	Surr Conc. (ug/L)	Surrogate Recovery (percent)
o-Chlorotoluene	95-49-8	20.0	104

Sample: M-10 556910-12

Analyte	CAS No.	Results (ug/L)	Rep. Limit (ug/L)	Dilution (factor)
Methyl t-butyl ether	1634-04-4	ND	1.0	1.0
Benzene	71-43-2	ND	0.30	1.0
Toluene	108-88-3	ND	0.30	1.0
Ethylbenzene	100-41-4	ND	0.30	1.0
Xylenes, total	1330-20-7	ND	0.60	1.0

ND = Not detected at or above indicated Reporting Limit

CLS Labs

Analysis Report: EPA 8020, BTEX and MTBE
Purge and Trap, EPA Method 5030

Client: McLaren/Hart-Alameda
1135 Atlantic Avenue
Alameda, CA 94501

Project No.:
Contact: Scott Allin
Phone: (510) 521-5200

Project: B of A

Date Sampled: 03/18/98
Date Received: 03/20/98
Date Extracted: 03/24/98
Date Analyzed: 03/24/98
Date Reported: 03/25/98
Client ID No.: M-13 556907-09

Lab Contact: Ray Osowski
Lab ID No.: P2883-4A
Job No.: 812883
COC Log No.: 32084
Batch No.: 21972
Instrument ID: GC018
Analyst ID: JENNDC
Matrix: WATER

SURROGATE

Analyte	CAS No.	Surr Conc. (ug/L)	Surrogate Recovery (percent)
o-Chlorotoluene	95-49-8	20.0	104

Sample: M-13 556907-09

Analyte	CAS No.	Results (ug/L)	Rep. Limit (ug/L)	Dilution (factor)
Methyl t-butyl ether	1634-04-4	ND	1.0	1.0
Benzene	71-43-2	ND	0.30	1.0
Toluene	108-88-3	ND	0.30	1.0
Ethylbenzene	100-41-4	ND	0.30	1.0
Xylenes, total	1330-20-7	ND	0.60	1.0

ND = Not detected at or above indicated Reporting Limit

CLS Labs

Analysis Report: EPA 8020, BTEX and MTBE
Purge and Trap, EPA Method 5030

Client: McLaren/Hart-Alameda
1135 Atlantic Avenue
Alameda, CA 94501

Project No.:
Contact: Scott Allin
Phone: (510)521-5200

Project: B of A

Date Sampled: 03/18/98
Date Received: 03/20/98
Date Extracted: 03/24/98
Date Analyzed: 03/24/98
Date Reported: 03/25/98
Client ID No.: M-9 556901-03

Lab Contact: Ray Osowski
Lab ID No.: P2883-SA
Job No.: 812883
COC Log No.: 32084
Batch No.: 21972
Instrument ID: GC018
Analyst ID: JENND
Matrix: WATER

SURROGATE

Analyte	CAS No.	Surr Conc. (ug/L)	Surrogate Recovery (percent)
o-Chlorotoluene	95-49-8	20.0	100

Sample: M-9 556901-03

Analyte	CAS No.	Results (ug/L)	Rep. Limit (ug/L)	Dilution (factor)
Methyl t-butyl ether	1634-04-4	12	1.0	1.0
Benzene	71-43-2	0.43	0.30	1.0
Toluene	108-88-3	ND	0.30	1.0
Ethylbenzene	100-41-4	ND	0.30	1.0
Xylenes, total	1330-20-7	ND	0.60	1.0

ND = Not detected at or above indicated Reporting Limit

CLS Labs

Analysis Report: EPA 8020, BTEX and MTBE
Purge and Trap, EPA Method 5030

Client: McLaren/Hart-Alameda
1135 Atlantic Avenue
Alameda, CA 94501

Project No.:
Contact: Scott Allin
Phone: (510) 521-5200

Project: B of A

Date Sampled: 03/18/98
Date Received: 03/20/98
Date Extracted: 03/24/98
Date Analyzed: 03/24/98
Date Reported: 03/25/98
Client ID No.: M-14 556913-15

Lab Contact: Ray Osowski
Lab ID No.: P2883-6A
Job No.: 812883
COC Log No.: 32084
Batch No.: 21972
Instrument ID: GC018
Analyst ID: JENNDNC
Matrix: WATER

SURROGATE

Analyte	CAS No.	Surr Conc. (ug/L)	Surrogate Recovery (percent)
o-Chlorotoluene	95-49-8	12 20.0	106
Sample: M-14 556913-15			

Analyte	CAS No.	Results (ug/L)	Rep. Limit (ug/L)	Dilution (factor)
Methyl t-butyl ether	1634-04-4	ND	1.0	1.0
Benzene	71-43-2	ND	0.30	1.0
Toluene	108-88-3	ND	0.30	1.0
Ethylbenzene	100-41-4	ND	0.30	1.0
Xylenes, total	1330-20-7	ND	0.60	1.0

ND = Not detected at or above indicated Reporting Limit

CLS Labs

Analysis Report: EPA 8020, BTEX and MTBE
Purge and Trap, EPA Method 5030

Client: McLaren/Hart-Alameda
1135 Atlantic Avenue
Alameda, CA 94501

Project No.:
Contact: Scott Allin
Phone: (510)521-5200

Project: B of A

Date Sampled: 03/18/98
Date Received: 03/20/98
Date Extracted: 03/24/98
Date Analyzed: 03/24/98
Date Reported: 03/25/98
Client ID No.: M-15 556922-24

Lab Contact: Ray Osowski
Lab ID No.: P2883-7A
Job No.: 812883
COC Log No.: 32084
Batch No.: 21972
Instrument ID: GC018
Analyst ID: JENNDK
Matrix: WATER

SURROGATE

Analyte	CAS No.	Surr Conc. (ug/L)	Surrogate Recovery (percent)
o-Chlorotoluene	95-49-8	20.0	105

Sample: M-15 556922-24

Analyte	CAS No.	Results (ug/L)	Rep. Limit (ug/L)	Dilution (factor)
Methyl t-butyl ether	1634-04-4	ND	1.0	1.0
Benzene	71-43-2	ND	0.30	1.0
Toluene	108-88-3	ND	0.30	1.0
Ethylbenzene	100-41-4	ND	0.30	1.0
Xylenes, total	1330-20-7	ND	0.60	1.0

ND = Not detected at or above indicated Reporting Limit

CLS Labs

Analysis Report: EPA 8020, BTEX and MTBE
Purge and Trap, EPA Method 5030

Client: McLaren/Hart-Alameda
1135 Atlantic Avenue
Alameda, CA 94501

Project No.:
Contact: Scott Allin
Phone: (510) 521-5200

Project: B of A

Date Extracted: 03/24/98
Date Analyzed: 03/24/98
Date Reported: 03/25/98

Lab Contact: Ray Osowski
Lab ID No.: P2883
Job No.: 812883
COC Log No.: 32084
Batch No.: 21972
Instrument ID: GC018
Analyst ID: JENNDG
Matrix: WATER

MB SURROGATE

Analyte	CAS No.	Surr Conc. (ug/L)	MB Surrogate Recovery (percent)
o-Chlorotoluene	95-49-8	20.0	106

METHOD BLANK

Analyte	CAS No.	Results (ug/L)	Reporting Limit (ug/L)
Methyl t-butyl ether	1634-04-4	ND	1.0
Benzene	71-43-2	ND	0.30
Toluene	108-88-3	ND	0.30
Ethylbenzene	100-41-4	ND	0.30
Xylenes, total	1330-20-7	ND	0.60

ND = Not detected at or above indicated Reporting Limit

CLS Labs

Analysis Report: Total Petroleum Hydrocarbons, EPA Method 8015
Purge and Trap, EPA Method 5030

Client: McLaren/Hart-Alameda
1135 Atlantic Avenue
Alameda, CA 94501

Project No.:
Contact: Scott Allin
Phone: (510)521-5200

Project: B of A

Date Sampled: 03/18/98
Date Received: 03/20/98
Date Extracted: 03/24/98
Date Analyzed: 03/24/98
Date Reported: 03/25/98
Client ID No.: M-11 556904-06

Lab Contact: Ray Osowski
Lab ID No.: P2883-1A
Job No.: 812883
COC Log No.: 32084
Batch No.: 21972
Instrument ID: GC018
Analyst ID: JENNDNC
Matrix: WATER

SURROGATE

Analyte	CAS No.	Surr Conc. (mg/L)	Surrogate Recovery (percent)
o-Chlorotoluene	95-49-8	0.0200	98

Sample: M-11 556904-06

Analyte	CAS No.	Results (mg/L)	Rep. Limit (mg/L)	Dilution (factor)
TPH as Gasoline	N/A	ND	0.050	1.0

ND = Not detected at or above indicated Reporting Limit

CLS Labs

Analysis Report: Total Petroleum Hydrocarbons, EPA Method 8015
Purge and Trap, EPA Method 5030

Client: McLaren/Hart-Alameda
1135 Atlantic Avenue
Alameda, CA 94501

Project No.:
Contact: Scott Allin
Phone: (510) 521-5200

Project: B of A

Date Sampled: 03/18/98
Date Received: 03/20/98
Date Extracted: 03/24/98
Date Analyzed: 03/24/98
Date Reported: 03/25/98
Client ID No.: M-14 556916-18

Lab Contact: Ray Osowski
Lab ID No.: P2883-2A
Job No.: 812883
COC Log No.: 32084
Batch No.: 21972
Instrument ID: GC018
Analyst ID: JENNDG
Matrix: WATER

SURROGATE

Analyte	CAS No.	Surr Conc. (mg/L)	Surrogate Recovery (percent)
o-Chlorotoluene	95-49-8	0.0200	98

Sample: M-14 556916-18

Analyte	CAS No.	Results (mg/L)	Rep. Limit (mg/L)	Dilution (factor)
TPH as Gasoline	N/A	ND	0.050	1.0

ND = Not detected at or above indicated Reporting Limit

CLS Labs

Analysis Report: Total Petroleum Hydrocarbons, EPA Method 8015
Purge and Trap, EPA Method 5030

Client: McLaren/Hart-Alameda
1135 Atlantic Avenue
Alameda, CA 94501

Project No.:
Contact: Scott Allin
Phone: (510) 521-5200

Project: B of A

Date Sampled: 03/18/98
Date Received: 03/20/98
Date Extracted: 03/24/98
Date Analyzed: 03/24/98
Date Reported: 03/25/98
Client ID No.: M-10 556910-12

Lab Contact: Ray Osowski
Lab ID No.: P2883-3A
Job No.: 812883
COC Log No.: 32084
Batch No.: 21972
Instrument ID: GC018
Analyst ID: JENNDC
Matrix: WATER

SURROGATE

Analyte	CAS No.	Surr Conc. (mg/L)	Surrogate Recovery (percent)
o-Chlorotoluene	95-49-8	0.0200	107

Sample: M-10 556910-12

Analyte	CAS No.	Results (mg/L)	Rep. Limit (mg/L)	Dilution (factor)
TPH as Gasoline	N/A	ND	0.050	1.0

ND = Not detected at or above indicated Reporting Limit

CLS Labs

Analysis Report: Total Petroleum Hydrocarbons, EPA Method 8015
Purge and Trap, EPA Method 5030

Client: McLaren/Hart-Alameda
1135 Atlantic Avenue
Alameda, CA 94501

Project No.:
Contact: Scott Allin
Phone: (510) 521-5200

Project: B of A

Date Sampled: 03/18/98
Date Received: 03/20/98
Date Extracted: 03/24/98
Date Analyzed: 03/24/98
Date Reported: 03/25/98
Client ID No.: M-13 556907-09

Lab Contact: Ray Osowski
Lab ID No.: P2883-4A
Job No.: 812883
COC Log No.: 32084
Batch No.: 21972
Instrument ID: GC018
Analyst ID: JENND
Matrix: WATER

SURROGATE

Analyte	CAS No.	Surr Conc. (mg/L)	Surrogate Recovery (percent)
o-Chlorotoluene	95-49-8	0.0200	106

Sample: M-13 556907-09

Analyte	CAS No.	Results (mg/L)	Rep. Limit (mg/L)	Dilution (factor)
TPH as Gasoline	N/A	ND	0.050	1.0

ND = Not detected at or above indicated Reporting Limit

CLS Labs

Analysis Report: Total Petroleum Hydrocarbons, EPA Method 8015
Purge and Trap, EPA Method 5030

Client: McLaren/Hart-Alameda
1135 Atlantic Avenue
Alameda, CA 94501

Project No.:
Contact: Scott Allin
Phone: (510) 521-5200

Project: B of A

Date Sampled: 03/18/98
Date Received: 03/20/98
Date Extracted: 03/24/98
Date Analyzed: 03/24/98
Date Reported: 03/25/98
Client ID No.: M-9 556901-03

Lab Contact: Ray Oslowski
Lab ID No.: P2883-5A
Job No.: 812883
COC Log No.: 32084
Batch No.: 21972
Instrument ID: GC018
Analyst ID: JENNDG
Matrix: WATER

SURROGATE

Analyte	CAS No.	Surr Conc. (mg/L)	Surrogate Recovery (percent)
o-Chlorotoluene	95-49-8	0.0200	100

Sample: M-9 556901-03

Analyte	CAS No.	Results (mg/L)	Rep. Limit (mg/L)	Dilution (factor)
TPH as Gasoline	N/A	ND	0.050	1.0

ND = Not detected at or above indicated Reporting Limit

CLS Labs

Analysis Report: Total Petroleum Hydrocarbons, EPA Method 8015
Purge and Trap, EPA Method 5030

Client: McLaren/Hart-Alameda
1135 Atlantic Avenue
Alameda, CA 94501

Project No.:
Contact: Scott Allin
Phone: (510) 521-5200

Project: B of A

Date Sampled: 03/18/98
Date Received: 03/20/98
Date Extracted: 03/24/98
Date Analyzed: 03/24/98
Date Reported: 03/25/98
Client ID No.: M-14 556913-15

Lab Contact: Ray Osowski
Lab ID No.: P2883-6A
Job No.: 812883
COC Log No.: 32084
Batch No.: 21972
Instrument ID: GC018
Analyst ID: JENNDG
Matrix: WATER

SURROGATE

Analyte	CAS No.	Surr Conc. (mg/L)	Surrogate Recovery (percent)
o-Chlorotoluene	95-49-8	0.0200	104

12
Sample: M-14 556913-15

Analyte	CAS No.	Results (mg/L)	Rep. Limit (mg/L)	Dilution (factor)
TPH as Gasoline	N/A	ND	0.050	1.0

ND = Not detected at or above indicated Reporting Limit

CLS Labs

Analysis Report: Total Petroleum Hydrocarbons, EPA Method 8015
Purge and Trap, EPA Method 5030

Client: McLaren/Hart-Alameda
1135 Atlantic Avenue
Alameda, CA 94501

Project No.:
Contact: Scott Allin
Phone: (510)521-5200

Project: B of A

Date Sampled: 03/18/98
Date Received: 03/20/98
Date Extracted: 03/24/98
Date Analyzed: 03/24/98
Date Reported: 03/25/98
Client ID No.: M-15 556922-24

Lab Contact: Ray Osowski
Lab ID No.: P2883-7A
Job No.: 812883
COC Log No.: 32084
Batch No.: 21972
Instrument ID: GC018
Analyst ID: JENNDNC
Matrix: WATER

SURROGATE

Analyte	CAS No.	Surr Conc. (mg/L)	Surrogate Recovery (percent)
o-Chlorotoluene	95-49-8	0.0200	101

Sample: M-15 556922-24

Analyte	CAS No.	Results (mg/L)	Rep. Limit (mg/L)	Dilution (factor)
TPH as Gasoline	N/A	ND	0.050	1.0

ND = Not detected at or above indicated Reporting Limit

CLS Labs

Analysis Report: Total Petroleum Hydrocarbons, EPA Method 8015
Purge and Trap, EPA Method 5030

Client: McLaren/Hart-Alameda
1135 Atlantic Avenue
Alameda, CA 94501

Project No.:
Contact: Scott Allin
Phone: (510) 521-5200

Project: B of A

Date Extracted: 03/24/98
Date Analyzed: 03/24/98
Date Reported: 03/25/98

Lab Contact: Ray Osowski
Lab ID No.: P2883
Job No.: 812883
COC Log No.: 32084
Batch No.: 21972
Instrument ID: GC018
Analyst ID: JENNDG
Matrix: WATER

MB SURROGATE

Analyte	CAS No.	Surr Conc. (mg/L)	MB Surrogate Recovery (percent)
o-Chlorotoluene	95-49-8	0.0200	92

METHOD BLANK

Analyte	CAS No.	Results (mg/L)	Reporting Limit (mg/L)
TPH as Gasoline	N/A	ND	0.050

ND = Not detected at or above indicated Reporting Limit

CLS Labs

Analysis Report: Total Petroleum Hydrocarbons, EPA Method 8015
Purge and Trap, EPA Method 5030

Client: McLaren/Hart-Alameda
1135 Atlantic Avenue
Alameda, CA 94501

Project No.:
Contact: Scott Allin
Phone: (510)521-5200

Project: B of A

Date Extracted: 03/24/98
Date Analyzed: 03/24/98
Date Reported: 03/25/98

Lab Contact: Ray Osowski
Lab ID No.: P2883
Job No.: 812883
COC Log No.: 32084
Batch No.: 21972
Instrument ID: GC018
Analyst ID: JENNDG
Matrix: WATER

LCS SURROGATE

Analyte	CAS No.	LCS Conc. (mg/L)	LCS Surrogate Recovery (percent)
o-Chlorotoluene	95-49-8	0.0200	87

LAB CONTROL SAMPLE

Analyte	CAS No.	LCS Conc. (mg/L)	LCS Recovery (percent)
Gasoline	N/A	0.500	90

LCS DUPLICATE SURROGATE

Analyte	CAS No.	LCSD Conc. (mg/L)	LCSD Surrogate Recovery (percent)
o-Chlorotoluene	95-49-8	0.0200	85

LAB CONTROL SAMPLE DUPLICATE

Analyte	CAS No.	LCS Conc. (mg/L)	LCSD Recovery (percent)
Gasoline	N/A	0.500	86

LCS RPD

Analyte	CAS No.	LCS Relative Percent Difference (percent)
Gasoline	N/A	5

CA DOHS ELAP Accreditation/Registration Number 1233

REPORT TO:			CLIENT JOB NUMBER		ANALYSIS REQUESTED				FIELD CONDITIONS:						
ADDRESS <u>McLaren Mart</u>					PRESERVATIVES <i>W 5108 808 Final Print 3/17/98</i>				Sunny, 71°						
<u>1135 Atlantic Ave</u>															
<u>Alameda, CA 94501</u>															
PROJECT MANAGER <u>Scott Allen</u> PHONE# <u>510-521-5200</u>			DESTINATION LABORATORY												
PROJECT NAME <u>B of A</u>			<input checked="" type="checkbox"/> CLS (916) 638-7301 3249 FITZGERALD RD. RANCHO CORDOVA, CA 95742												
SAMPLED BY <u>MP/SL</u>			<input type="checkbox"/> OTHER		COMPOSITE:										
JOB DESCRIPTION					TURN AROUND TIME				SPECIAL INSTRUCTIONS						
SITE LOCATION <u>San Leandro</u>					1 DAY				2 DAY						
					5 DAY				10 DAY						
DATE	TIME	SAMPLE IDENTIFICATION	MATRIX	CONTAINER											
				NO.	TYPE										
<u>3/18/98</u>	<u>1020</u>	<u>M-13 556919</u>	<u>H₂O</u>	<u>1</u>	<u>1L</u>	<u>MY</u>	<u>X</u>								
	<u>1050</u>	<u>M-14 556921</u>													
	<u>1110</u>	<u>M-9 556927</u>													
	<u>1055</u>	<u>M-11 556926</u>													
	<u>1130</u>	<u>M-10 556928</u>													
	<u>1300</u>	<u>M-15 556925</u>													
	<u>1030</u>	<u>M-12 556920</u>													
SUSPECTED CONSTITUENTS						SAMPLE RETENTION TIME				PRESERVATIVES (1) HCL (2) HNO ₃ (3) = COLD (4)					
RELINQUISHED BY (SIGN)		PRINT NAME / COMPANY		DATE / TIME		RECEIVED BY (SIGN)		PRINT NAME / COMPANY							
<u>M. J. [Signature]</u>		<u>M. Pavlos / McLaren Mart</u>		<u>3/19/98 1000</u>											
REC'D AT LAB BY: <u>[Signature]</u>			DATE / TIME: <u>3/20/98 1900</u>			CONDITIONS / COMMENTS									
SHIPPED VIA		<input type="checkbox"/> FED X		<input type="checkbox"/> UPS		<input checked="" type="checkbox"/> OTHER <u>Express - FT</u>		AIR BILL #							

CLS Labs

McLaren/Hart-Alameda
1135 Atlantic Avenue
Alameda, CA 94501

03/31/98

Attention: Scott Allin

Reference: Analytical Results

Project Name: B of A
Project No.:
Date Received: 03/20/98
Chain Of Custody: 32083

CLS ID No.: P2882
CLS Job No.: 812882

The following analyses were performed on the above referenced project:

<u>No. of Samples</u>	<u>Turnaround Time</u>	<u>Analysis Description</u>
7	10 Days	TPH Extractables by Method M8015 (water)

These samples were received by CLS Labs in a chilled, intact state and accompanied by a valid chain of custody document.

Calibrations for analytical testing have been performed in accordance to and pass the EPA's criteria for acceptability.

Analytical results are attached to this letter. Please call if we can provide additional assistance.

Sincerely,

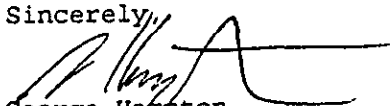

George Hampton
Laboratory Director

CLS Labs

Analysis Report: Total Petroleum Hydrocarbons, EPA Method 8015
Separatory Funnel, EPA Method 3510

Client: McLaren/Hart-Alameda
1135 Atlantic Avenue
Alameda, CA 94501

Project No.:
Contact: Scott Allin
Phone: (510)521-5200

Project: B of A

Date Sampled: 03/18/98
Date Received: 03/20/98
Date Extracted: 03/23/98
Date Analyzed: 03/24/98
Date Reported: 03/31/98
Client ID No.: W-13 556919

Lab Contact: Ray Osowski
Lab ID No.: P2882-1A
Job No.: 812882
COC Log No.: 32083
Batch No.: 21958
Instrument ID: PGC04
Analyst ID: SEPIDEHS
Matrix: WATER

^m
W-13 556919

Analyte	CAS No.	Results (mg/L)	Rep. Limit (mg/L)	Dilution (factor)
TPH as Diesel	N/A	ND	0.050	1.0
TPH as Motor Oil	N/A	0.11	0.050	1.0

ND - Not detected at or above indicated Reporting Limit

CLS Labs

Analysis Report: Total Petroleum Hydrocarbons, EPA Method 8015
Separatory Funnel, EPA Method 3510

Client: McLaren/Hart-Alameda
1135 Atlantic Avenue
Alameda, CA 94501

Project No.:
Contact: Scott Allin
Phone: (510)521-5200

Project: B of A

Date Sampled: 03/18/98
Date Received: 03/20/98
Date Extracted: 03/23/98
Date Analyzed: 03/25/98
Date Reported: 03/31/98
Client ID No.: W-14 556921

Lab Contact: Ray Osowski
Lab ID No.: P2882-2A
Job No.: 812882
COC Log No.: 32083
Batch No.: 21958
Instrument ID: PGC04
Analyst ID: SEPIDEHS
Matrix: WATER

W-14 556921

Analyte	CAS No.	Results (mg/L)	Rep. Limit (mg/L)	Dilution (factor)
TPH as Diesel	N/A	ND	0.25	5.0
TPH as Motor Oil	N/A	1.8	0.25	5.0

ND - Not detected at or above indicated Reporting Limit

CLS Labs

Analysis Report: Total Petroleum Hydrocarbons, EPA Method 8015
Separatory Funnel, EPA Method 3510

Client: McLaren/Hart-Alameda
1135 Atlantic Avenue
Alameda, CA 94501

Project No.:
Contact: Scott Allin
Phone: (510)521-5200

Project: B of A

Date Sampled: 03/18/98
Date Received: 03/20/98
Date Extracted: 03/23/98
Date Analyzed: 03/25/98
Date Reported: 03/31/98
Client ID No.: M-9 556927

Lab Contact: Ray Osowski
Lab ID No.: P2882-3A
Job No.: 812882
COC Log No.: 32083
Batch No.: 21958
Instrument ID: PGC04
Analyst ID: SEPIDEHS
Matrix: WATER

M-9 556927

Analyte	CAS No.	Results (mg/L)	Rep. Limit (mg/L)	Dilution (factor)
TPH as Diesel	N/A	ND	0.050	1.0
TPH as Motor Oil	N/A	0.29	0.050	1.0

ND - Not detected at or above indicated Reporting Limit

CLS Labs

Analysis Report: Total Petroleum Hydrocarbons, EPA Method 8015
Separatory Funnel, EPA Method 3510

Client: McLaren/Hart-Alameda
1135 Atlantic Avenue
Alameda, CA 94501

Project No.:
Contact: Scott Allin
Phone: (510)521-5200

Project: B of A

Date Sampled: 03/18/98
Date Received: 03/20/98
Date Extracted: 03/23/98
Date Analyzed: 03/25/98
Date Reported: 03/31/98
Client ID No.: M-11 556926

Lab Contact: Ray Osowski
Lab ID No.: P2882-4A
Job No.: 812882
COC Log No.: 32083
Batch No.: 21958
Instrument ID: PGC04
Analyst ID: SEPIDEHS
Matrix: WATER

M-11 556926

Analyte	CAS No.	Results (mg/L)	Rep. Limit (mg/L)	Dilution (factor)
TPH as Diesel	N/A	0.27	0.050	1.0
TPH as Motor Oil	N/A	0.68	0.050	1.0

ND - Not detected at or above indicated Reporting Limit

CLS Labs

Analysis Report: Total Petroleum Hydrocarbons, EPA Method 8015
Separatory Funnel, EPA Method 3510

Client: McLaren/Hart-Alameda
1135 Atlantic Avenue
Alameda, CA 94501

Project No.:
Contact: Scott Allin
Phone: (510)521-5200

Project: B of A

Date Sampled: 03/18/98
Date Received: 03/20/98
Date Extracted: 03/23/98
Date Analyzed: 03/25/98
Date Reported: 03/31/98
Client ID No.: M-10 556928

Lab Contact: Ray Osowski
Lab ID No.: P2882-5A
Job No.: 812882
COC Log No.: 32083
Batch No.: 21958
Instrument ID: PGC04
Analyst ID: SEPIDEHS
Matrix: WATER

M-10 556928

Analyte	CAS No.	Results (mg/L)	Rep. Limit (mg/L)	Dilution (factor)
TPH as Diesel	N/A	0.26	0.050	1.0
TPH as Motor Oil	N/A	0.97	0.050	1.0

ND - Not detected at or above indicated Reporting Limit

CLS Labs

Analysis Report: Total Petroleum Hydrocarbons, EPA Method 8015
Separatory Funnel, EPA Method 3510

Client: McLaren/Hart-Alameda
1135 Atlantic Avenue
Alameda, CA 94501

Project No.:
Contact: Scott Allin
Phone: (510)521-5200

Project: B of A

Date Sampled: 03/18/98
Date Received: 03/20/98
Date Extracted: 03/23/98
Date Analyzed: 03/25/98
Date Reported: 03/31/98
Client ID No.: M-12 556920

Lab Contact: Ray Osowski
Lab ID No.: P2882-7A
Job No.: 812882
COC Log No.: 32083
Batch No.: 21958
Instrument ID: PGC04
Analyst ID: SEPIDEHS
Matrix: WATER

M-12 556920

Analyte	CAS No.	Results (mg/L)	Rep. Limit (mg/L)	Dilution (factor)
TPH as Diesel	N/A	ND	0.50	10
TPH as Motor Oil	N/A	4.0	0.50	10

ND - Not detected at or above indicated Reporting Limit

CLS Labs

Analysis Report: Total Petroleum Hydrocarbons, EPA Method 8015
Separatory Funnel, EPA Method 3510

Client: McLaren/Hart-Alameda
1135 Atlantic Avenue
Alameda, CA 94501

Project No.:
Contact: Scott Allin
Phone: (510)521-5200

Project: B of A

Lab Contact: Ray Osowski
Lab ID No.: P2882
Job No.: 812882
COC Log No.: 32083
Batch No.: 21958
Instrument ID: FGC04
Analyst ID: SEPIDEHS
Matrix: WATER

Date Extracted: 03/23/98
Date Analyzed: 03/24/98
Date Reported: 03/31/98

METHOD BLANK

Analyte	CAS No.	Results (mg/L)	Reporting Limit (mg/L)
TPH as Diesel	N/A	ND	0.050
TPH as Motor Oil	N/A	ND	0.050

ND - Not detected at or above indicated Reporting Limit

CLS Labs

Analysis Report: Total Petroleum Hydrocarbons, EPA Method 8015
Separatory Funnel, EPA Method 3510

Client: McLaren/Hart-Alameda
1135 Atlantic Avenue
Alameda, CA 94501

Project No.:
Contact: Scott Allin
Phone: (510)521-5200

Project: B of A

Date Extracted: 03/23/98
Date Analyzed: 03/24/98
Date Reported: 03/31/98

Lab Contact: Ray Osowski
Lab ID No.: P2882
Job No.: 812882
COC Log No.: 32083
Batch No.: 21958
Instrument ID: FGC04
Analyst ID: SEPIDEHS
Matrix: WATER

LAB CONTROL SAMPLE

Analyte	CAS No.	LCS Conc. (mg/L)	LCS Recovery (percent)
Diesel	N/A	0.500	94

LAB CONTROL SAMPLE DUPLICATE

Analyte	CAS No.	LCS Conc. (mg/L)	LCS Recovery (percent)
Diesel	N/A	0.500	92

LCS RPD

Analyte	CAS No.	LCS Relative Percent Difference (percent)
Diesel	N/A	2

CLS Labs

Analysis Report: Fuel Fingerprinting, EPA 8015 Modified
Sonication, EPA Method 3550

Client: McLaren/Hart-Alameda
1135 Atlantic Avenue
Alameda, CA 94501

Project No.: 04.0602457.001.001
Contact: Scott Allin
Phone: (510)748-5694

Project: Bank of America

Lab Contact: George Hampton
Lab ID No.: N8120-1A
Job No.: 808120
COC Log No.: 28543,26,03126
Batch No.: 19912
Instrument ID: PGC06
Analyst ID: SEPIDEHS
Matrix: SOIL

Date Sampled: 06/19/97
Date Received: 06/23/97
Date Extracted: 06/24/97
Date Analyzed: 06/30/97
Date Reported: 07/01/97
Client ID No.: M-1 46101 6.0'-6.5'

M-1 46101 6.0'-6.5'

Analyte	CAS No.	Results (mg/kg)	Rep. Limit (mg/kg)	Dilution (factor)
Gasoline	N/A	4200	500	500

ND = Not detected at or above indicated Reporting Limit

CLS Labs

Analysis Report: Total Petroleum Hydrocarbons, EPA Method 8015
Purge and Trap, EPA Method 5030

Client: McLaren/Hart-Alameda
1135 Atlantic Avenue
Alameda, CA 94501

Project No.: 04.0602457.001.001
Contact: Scott Allin
Phone: (510)748-5694

Project: Bank of America

Date Extracted: 06/24/97
Date Analyzed: 06/24/97
Date Reported: 06/27/97

Lab Contact: George Hampton
Lab ID No.: N8120
Job No.: 808120
COC Log No.: 28543,26,03126
Batch No.: 19911
Instrument ID: GC018
Analyst ID: JENNDC
Matrix: SOIL

MB SURROGATE

Analyte	CAS No.	Surr Conc. (mg/kg)	MB Surrogate Recovery (percent)
o-Chlorotoluene	95-49-8	0.100	108

METHOD BLANK

Analyte	CAS No.	Results (mg/kg)	Reporting Limit (mg/kg)
TPH as Gasoline	N/A	ND	1.0

ND = Not detected at or above indicated Reporting Limit

CA DOHS ELAP Accreditation/Registration Number 1233

3249 Fitzgerald Road
Rancho Cordova, CA 95742
(916) 638-7301
Fax (916) 638-4510

3083 Gold Canal Drive
Rancho Cordova, CA 95670
(916) 852-6600
Fax (916) 852-7292