



RECEIVED

11:46 am, Jan 28, 2010

Alameda County
Environmental Health

ARCADIS U.S., Inc.
100 Montgomery Street, Suite 300
San Francisco, California 94105
Tel 415.374.2744
Fax 415.374.2745
www.arcadis-us.com

Re: Fourth Quarter 2009 Status Report
Former BP Station #11132
3201 35th Avenue
Oakland, California
ACEH Case #RO0000014

ENVIRONMENTAL

"I declare that to the best of my knowledge at the present time, that the information and/or recommendations contained in the attached document are true and correct."

Date:
01/25/2010

Submitted by:
ARCADIS U.S., Inc.

Contact:
Hollis E. Phillips

Phone:
415.374.2744 ext 13

Hollis E. Phillips, PG
Project Manager

Email:
Hollis.phillips@arcadis-us.com

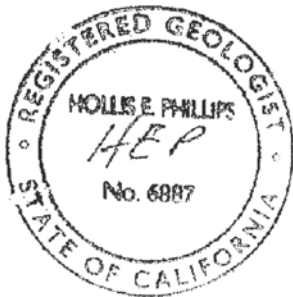

Our ref:
GP09BPNA.C112

25 January 2010

Project No. 09-88-655

ARCADIS-US, Inc.
100 Montgomery Street, Ste. 300
San Francisco, California 94104

Attn.: Ms. Hollis Phillips, PG – Senior Geologist

Re: Fourth Quarter 2009 Status Report, Former BP Station #11132, 3201 35th Avenue,
Oakland, Alameda County, California; ACEH Case #RO0000014

Dear Ms. Phillips:

Provided herein is the *Fourth Quarter 2009 Status Report* for Former BP Station #11132 located at 3201 35th Avenue, Oakland, California (Site). This report presents a summary of current developments at the Site through the Fourth Quarter of 2009.

Should you have questions regarding the work performed or results obtained, please do not hesitate to contact us at (530) 566-1400.

Sincerely,

BROADBENT & ASSOCIATES, INC.

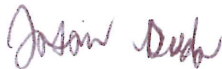

Jason Duda
Project Scientist



Thomas A. Venus, P.E.
Senior Engineer



Enclosures

cc: Mr. Paresh Khatri, Alameda County Environmental Health (Submitted via ACEH ftp site)
Ms. Shelby Lathrop, ConocoPhillips, 76 Broadway, Sacramento, California 95818
Electronic copy uploaded to GeoTracker

STATION #11132 GROUND-WATER MONITORING REPORT

Facility: #11132	Address:	3201 35 th Avenue, Oakland, California
ARCADIS Project Manager:		Ms. Hollis Phillips, PG
Consulting Co./Contact Persons:		Broadbent & Associates, Inc.(BAI) / Jason Duda & Tom Venus (530) 566-1400
Consultant Project No.:		09-88-655
Primary Agency/Regulatory ID No.:		Alameda County Environmental Health (ACEH) ACEH Case # RO0000014

WORK PERFORMED THIS QUARTER (Fourth Quarter 2009):

1. Prepared and submitted *Third Quarter 2009 Ground-Water Monitoring Report* (BAI, 10/5/2009).
2. Performed monthly free product (FP) gauging and bailing on October 9, November 12, and December 11, 2009. Work performed by BAI.

WORK PROPOSED FOR NEXT QUARTER (First Quarter 2010):

1. Prepared and submitted this *Fourth Quarter 2009 Status Report* (contained herein).
2. Conduct semi-annual ground-water monitoring/sampling and FP gauging for First Quarter 2010.

QUARTERLY RESULTS SUMMARY:

Current phase of project:	Ground-Water Monitoring/Sampling/FP Bailing
Frequency of ground-water monitoring:	Semi-Annual (1Q & 3Q): MW-1 through MW-10, RW-1
Frequency of ground-water sampling:	Semi-Annual (1Q & 3Q): MW-1, MW-2, MW-5, MW-8, MW-9, MW-10, and RW-1 Annually (1Q): MW-3, MW-4, MW-6, and MW-7
Is free product (FP) present on-site:	No
FP recovered this quarter:	0 gallons
Cumulative FP recovered since 1990:	234.3 gallons (FP/water mixture)
Current remediation techniques:	Interim FP Bailing
Depth to ground water (below TOC):	NA
General ground-water flow direction:	NA
Approximate hydraulic gradient:	NA

DISCUSSION:

Separate phase hydrocarbons (SPH, or Free Product – FP) were monitored and removed, if present, during October, November, and December 2009. During the FP gauging/bailing event on 29 October 2009, sheen was observed in well MW-1. No FP or sheen was recorded in wells MW-2, MW-8, MW-9, MW-10, and RW-1. No FP bailing was conducted during the 29 October visit. During the FP gauging/bailing event on 12 November 2009, wells MW-2, MW-8, MW-9, and MW-10 were inadvertently not gauged for FP during this visit. No measurable FP was observed in wells MW-1 and RW-1. No FP bailing was conducted during the 12 November visit. During the FP gauging/ bailing event on 11 December 2009, no measurable FP was observed in wells MW-1, MW-2, MW-8, MW-10, and RW-1. Well MW-9 was not accessed due to a parked car. No measurable FP was observed in wells

associated with the Site this quarter. Total cumulative FP/water mixture removed to date at the Site is approximately 234.3 gallons, but this does not include the unknown volume removed within absorbent socks that have been installed and replaced as necessary since Second Quarter 2007. Table 1 contains a summary of FP removal data. Copies of the field data sheets for visits to the Site conducted this quarter are included within Appendix A. Due to the lack of FP present during gauging activities performed this quarter, monthly FP gauging and bailing will be discontinued, but be conducted during the semi-annual groundwater monitoring and sampling events next scheduled for the First Quarter of 2010.

A Site Location Map is provided as Drawing 1. For reference, a ground-water elevation contour and analytical summary map depicting data from the Third Quarter 2009 ground-water sampling event is provided as Drawing 2.

CLOSURE:

The findings presented in this report are based upon: observations of BAI field personnel (see Appendix A) and the points investigated. Our services were performed in accordance with the generally accepted standard of practice at the time this report was written. No other warranty, expressed or implied was made. This report has been prepared for the exclusive use of ARCADIS-US, Inc. and Atlantic Richfield Company (a BP affiliated company). It is possible that variations in soil or ground-water conditions could exist beyond points explored in this investigation. Also, changes in site conditions could occur in the future due to variations in rainfall, temperature, regional water usage, or other factors.

ATTACHMENTS:

- Drawing 1. Site Location Map, Former BP Service Station #11132, 3201 35th Avenue, Oakland, California
- Drawing 2. Ground-Water Elevation Contour and Analytical Summary Map, 6 August 2009, Former BP Service Station #11132, 3201 35th Avenue, Oakland, California
- Table 1. Free Product Removal, Former BP Service Station #11132, 3201 35th Avenue, Oakland, California
- Appendix A. Field Data Sheets

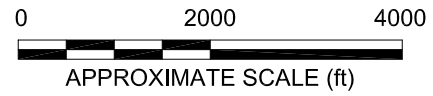
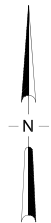
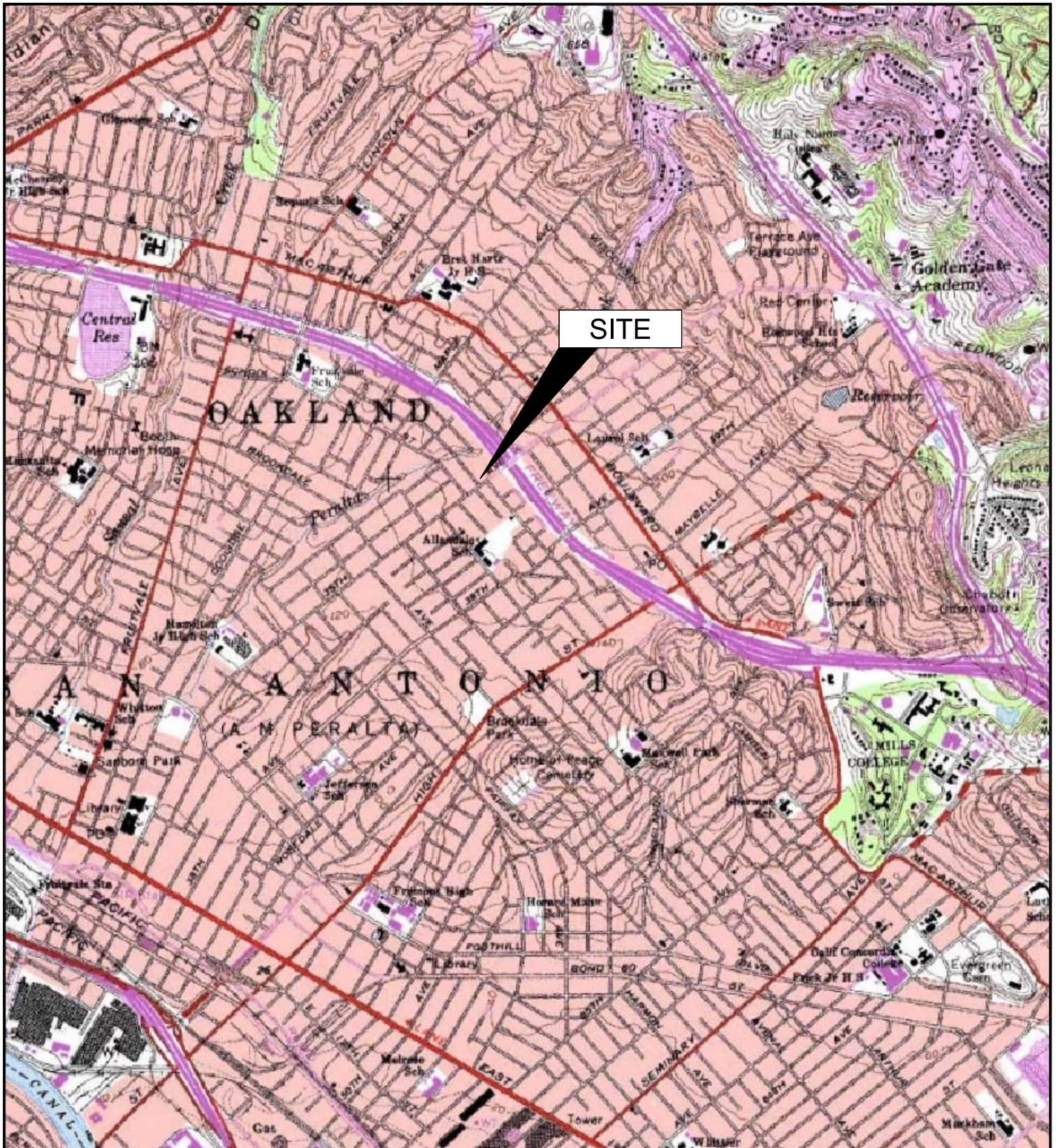
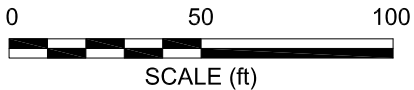
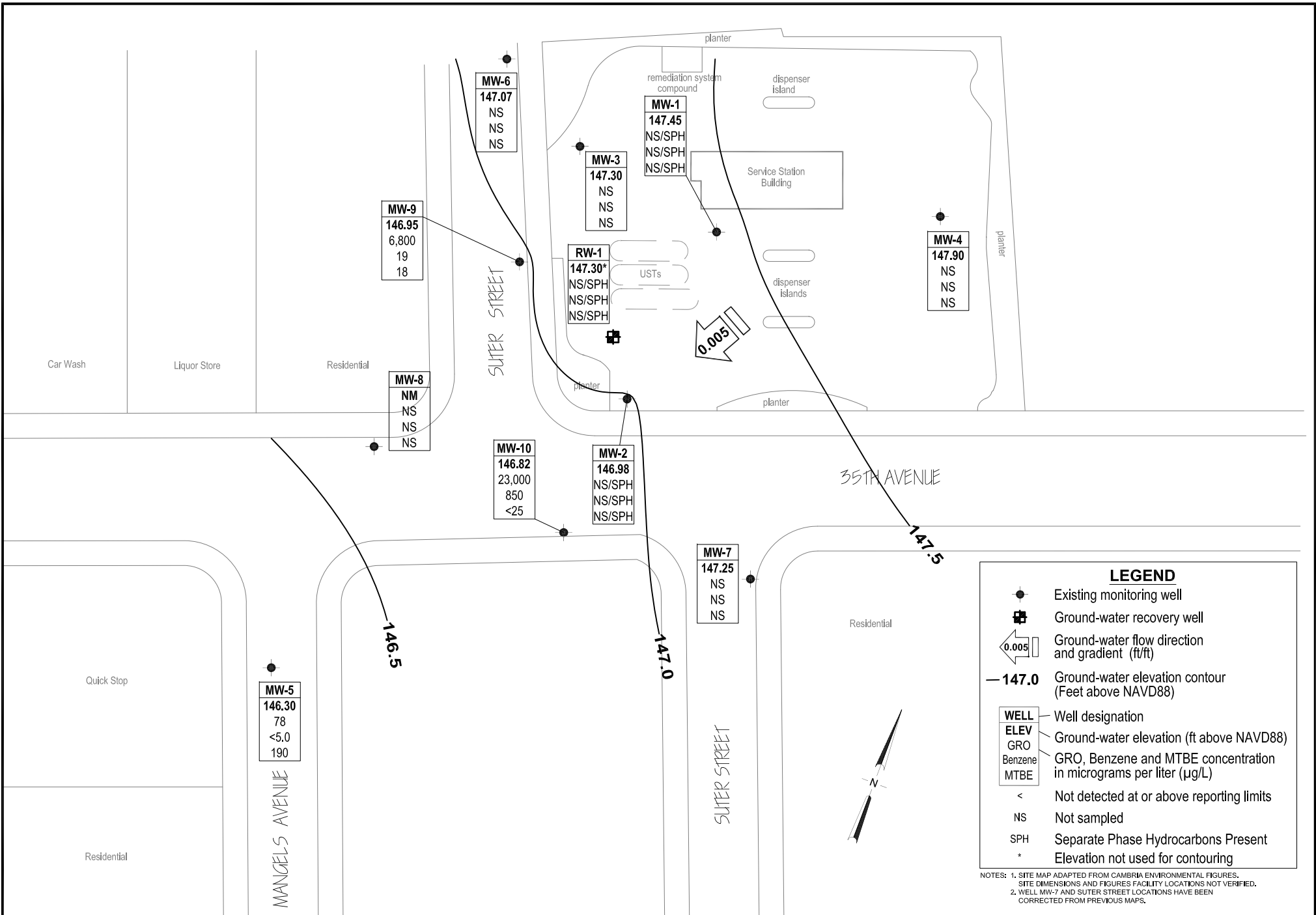

IMAGE SOURCE: USGS



BROADBENT & ASSOCIATES, INC.
ENGINEERING, WATER RESOURCES & ENVIRONMENTAL
1324 Mangrove Ave. Suite 212, Chico, California 95926
Project No.: 06-88-655 Date: 9/15/09

Former BP Service Station #11132
3201 35th Avenue
Oakland, California

Ground-Water Elevation Contours
and Analytical Summary Map
6 August 2009

Drawing

2

Table 1
Free Product Removal
Former BP Service Station #11132
3201 35th Avenue, Oakland, CA

WELL ID	DATE OF MONITORING	PRODUCT THICKNESS (feet)	PRODUCT REMOVED (gallons)	CUMULATIVE PRODUCT REMOVED (gallons)
MW-1	7/9/1990	0.22	2.000	2.000
MW-1	12/21/1990	0.58	2.000	4.000
MW-1	3/7/1991	0.00	--	4.000
MW-1	6/27/1991	0.18	2.000	6.000
MW-1	9/27/1991	0.27	2.000	8.000
MW-1	12/18/1991	0.28	2.000	10.000
MW-1	4/1/1991	0.15	2.000	12.000
MW-1	7/3/1992	0.27	2.000	14.000
MW-1	10/5/1992	0.24	2.000	16.000
MW-1	1/13/1993	0.24	2.000	18.000
MW-1	4/23/1993	0.42	2.000	20.000
MW-1	7/12/1993	0.49	--	20.000
MW-1	10/21/1993	1.09	2.000	22.000
MW-1	1/21/1994	0.76	--	22.000
MW-1	4/20/1994	1.80	2.000	24.000
MW-1	8/1/1994	0.35	--	24.000
MW-1	1/26/1995	1.10	3.000	27.000
MW-1	6/8/95-6/28/95	1.25	0.700	27.700
MW-1	8/22/1995	0.85	0.150	27.850
MW-1	10/30/95-12/23/95	0.69	0.110	27.960
MW-1	1/25/96-2/16/95	1.40	1.080	29.040
MW-1	4/19/1996	1.22	0.750	29.790
MW-1	7/23/1996	0.89	0.000	29.790
MW-1	9/4/1996	--	0.350	30.140
MW-1	11/11/1996	0.89	0.980	31.120
MW-1	1/21/1997	0.90	0.200	31.320
MW-1	4/29/1997	0.85	0.250	31.570
MW-1	8/21/1997	--	0.150	31.720
MW-1	11/2/97-12/9/97	0.87	2.030	33.750
MW-1	2/3/1998	0.32	0.250	34.000
MW-1	2/4/1998	--	--	34.000
MW-1	5/28/1998	0.17	--	34.000
MW-1	12/30/1998	0.08	0.020	34.020
MW-1	2/2/1999	0.03	0.010	34.030
MW-1	5/10/1999	0.03	0.010	34.040
MW-1	8/24/1999	0.06	0.010	34.050
MW-1	11/3/1999	0.36	0.050	34.100
MW-1	3/1/2000	0.23	*	34.100
MW-1	4/21/2000	0.33	0.070	34.170
MW-1	7/31/2000	0.53	0.130	34.300
MW-1	11/20/2000	0.37	0.500	34.800
MW-1	2/18/2001	0.13	0.050	34.850
MW-1	2/26/2001	0.15	0.150	35.000
MW-1	6/7/2001	0.00	--	35.000
MW-1	9/5/2001	0.35	--	35.000
MW-1	11/30/2001	0.41	0.260	35.260
MW-1	12/6/2001	0.27	0.040	35.300
MW-1	2/20/2002	0.15	0.020	35.320
MW-1	6/20/2002	0.34	0.070	35.390
MW-1	9/11/2002	0.40	0.060	35.450
MW-1	11/12/2002	0.37	0.060	35.510
MW-1	1/29/2003	0.30	0.320	35.830
MW-1	5/22/2003	0.20	0.140	35.970

Table 1
Free Product Removal
Former BP Service Station #11132
3201 35th Avenue, Oakland, CA

WELL ID	DATE OF MONITORING	PRODUCT THICKNESS (feet)	PRODUCT REMOVED (gallons)	CUMULATIVE PRODUCT REMOVED (gallons)
MW-1	6/24/2003	0.35	0.070	36.040
MW-1	7/28/2003	0.35	0.080	36.050
MW-1	8/12/2003	0.23	0.040	36.090
MW-1	9/12/2003	0.24	0.040	36.130
MW-1	10/3/2003	0.23	0.040	36.170
MW-1	11/18/2003	0.25	0.040	36.210
MW-1	12/31/2003	0.15	0.020	36.230
MW-1	2/2/2004	0.15	0.020	36.250
MW-1	2/23/2004	0.09	0.030	36.280
MW-1	3/18/2004	0.09	0.010	36.290
MW-1	4/13/2004	0.24	0.040	36.330
MW-1	5/4/2004	0.16	0.030	36.360
MW-1	6/2/2004	0.08	0.010	36.370
MW-1	7/2/2004	0.28	0.040	36.410
MW-1	8/4/2004	0.10	0.080	36.490
MW-1	9/22/2004	0.20	0.030	36.520
MW-1	10/26/2004	0.12	0.020	36.540
MW-1	11/10/2004	0.14	0.020	36.560
MW-1	12/27/2004	0.08	0.010	36.570
MW-1	1/13/2005	0.03	0.005	36.575
MW-1	2/15/2005	0.04	0.006	36.581
MW-1	3/7/2005	0.01	0.007	36.588
MW-1	4/29/2005	0.01	0.002	36.589
MW-1	5/16/2005	0.02	0.003	36.592
MW-1	6/21/2005	0.01	0.002	36.594
MW-1	7/7/2005	0.18	0.029	36.623
MW-1	8/17/2005	0.08	0.013	36.636
MW-1	9/6/2005	0.02	0.003	36.639
MW-1	10/4/2005	0.12	0.020	36.659
MW-1	9/6/2005	0.06	0.010	36.669
MW-1	12/30/2005	0.03	0.005	36.674
MW-1	1/24/2006	0.00	0.000	36.674
MW-1	2/7/2006	0.01	0.002	36.676
MW-1	3/30/2006	0.00	0.000	36.676
MW-1	4/21/2006	0.00	0.000	36.676
MW-1	5/19/2006	<0.01 (SHEEN)	0.000	36.676
MW-1	6/22/2006	0.04	0.006	36.682
MW-1	7/31/2006	0.04	0.006	36.688
MW-1	8/23/2006	0.14	0.022	36.710
MW-1	9/28/2006	0.35	0.056	36.766
MW-1	11/15/2006	0.18	--	36.766
MW-1	2/14/2007	0.17	*	36.766
MW-1	3/14/2007	0.04	****	36.766
MW-1	4/10/2007	0.15	****	36.766
MW-1	5/22/2007	0.01	****	36.766
MW-1	6/26/2007	0.05	****	36.766
MW-1	7/19/2007	0.00	--	36.766
MW-1	8/15/2007	0.01	2.0	38.766
MW-1	9/18/2007	0.10	2.0	40.766
MW-1	10/17/2007	0.01	4.0	44.766
MW-1	11/8/2007	0.01	3.0	47.766
MW-1	12/12/2007	0.01	1.5	49.266
MW-1	1/14/2008	0.01	3.0	52.266

Table 1
Free Product Removal
Former BP Service Station #11132
3201 35th Avenue, Oakland, CA

WELL ID	DATE OF MONITORING	PRODUCT THICKNESS (feet)	PRODUCT REMOVED (gallons)	CUMULATIVE PRODUCT REMOVED (gallons)
MW-1	2/27/2008	--	2.0	54.266
MW-1	4/1/2008	0.01	5.0	59.266
MW-1	5/7/2008	0.02	*	59.266
MW-1	5/20/2008	0.00	1.0	60.266
MW-1	6/18/2008	0.00	4.5	64.766
MW-1	7/16/2008	0.01	2.0	66.766
MW-1	8/13/2008	0.02	9.0	75.766
MW-1	8/20/2008	0.02	0.0	75.766
MW-1	9/15/2008	0.04	3.0	78.766
MW-1	10/15/2008	0.01	8.0	86.766
MW-1	11/17/2008	0.00	0.0	86.766
MW-1	12/18/2008	0.00	0.0	86.766
MW-1	1/14/2009	0.01	2.0	88.766
MW-1	2/4/2009	0.01	4.0	92.766
MW-1	2/25/2009	0.02	1.0	93.766
MW-1	3/11/2009	0.01	2.5	96.266
MW-1	4/8/2009	0.00	0.0	96.266
MW-1	5/28/2009	0.01	3.0	99.266
MW-1	6/16/2009	0.01	4.0	103.266
MW-1	7/22/2009	0.01	8.0	111.266
MW-1	8/6/2009	0.01	2.5	113.766
MW-1	9/11/2009	0.01	4.0	117.766
MW-1	10/29/2009	<0.01 (SHEEN)	0.0	117.766
MW-1	11/12/2009	0.00	0.0	117.766
MW-1	12/11/2009	0.00	0.0	117.766
MW-2	4/1/2008	0.01	1.5	1.500
MW-2	5/7/2008	0.04	*	1.500
MW-2	5/20/2008	0.00	1.0	2.500
MW-2	6/18/2008	0.00	2.5	5.000
MW-2	7/16/2008	0.01	1.5	6.500
MW-2	8/13/2008	<0.01 (SHEEN)	4.0	10.500
MW-2	8/20/2008	0.01	0.0	10.500
MW-2	9/15/2008	0.00	0.0	10.500
MW-2	10/15/2008	0.01	1.0	11.500
MW-2	11/17/2008	<0.01 (SHEEN)	0.0	11.500
MW-2	12/18/2008	0.00	0.0	11.500
MW-2	1/14/2009	0.00	0.0	11.500
MW-2	2/4/2009	0.00	0.0	11.500
MW-2	2/25/2009	0.00	0.0	11.500
MW-2	3/11/2009	0.00	0.0	11.500
MW-2	4/8/2009	0.00	0.0	11.500
MW-2	5/28/2009	<0.01 (SHEEN)	0.0	11.500
MW-2	6/16/2009	0.01	3.0	14.500
MW-2	7/22/2009	0.00	0.0	14.500
MW-2	8/6/2009	0.01	4.0	18.500
MW-2	9/11/2009	0.00	0.0	18.500
MW-2	10/29/2009	0.00	0.0	18.500
MW-2	11/12/2009	NM	0.0	18.500
MW-2	12/11/2009	0.00	0.0	18.500
MW-8	11/02/93-12/09/98	0.12	1.620	1.620
MW-8	9/5/2001	0.04	--	1.660
MW-8	8/12/2003	<0.01 (SHEEN)	--	1.660

Table 1
Free Product Removal
Former BP Service Station #11132
3201 35th Avenue, Oakland, CA

WELL ID	DATE OF MONITORING	PRODUCT THICKNESS (feet)	PRODUCT REMOVED (gallons)	CUMULATIVE PRODUCT REMOVED (gallons)
MW-8	10/3/2003	<0.01 (SHEEN)	--	1.660
MW-8	11/18/2003	<0.01 (SHEEN)	--	1.660
MW-8	12/31/2003	<0.01 (SHEEN)	--	1.660
MW-8	2/2/2004	<0.01 (SHEEN)	--	1.660
MW-8	2/23/2004	<0.01 (SHEEN)	--	1.660
MW-8	3/18/2004	<0.01 (SHEEN)	--	1.660
MW-8	4/13/2004	<0.01 (SHEEN)	--	1.660
MW-8	5/4/2004	<0.01 (SHEEN)	--	1.660
MW-8	6/2/2004	<0.01 (SHEEN)	--	1.660
MW-8	7/2/2004	--	--	1.660
MW-8	8/4/2004	0.05	0.110	1.770
MW-8	9/22/2004	--	--	1.770
MW-8	10/26/2004	--	--	1.770
MW-8	11/10/2004	--	--	1.770
MW-8	12/26/2004	--	--	1.770
MW-8	1/13/2005	--	--	1.770
MW-8	2/15/2005	--	--	1.770
MW-8	3/7/2005	--	--	1.770
MW-8	4/29/2005	--	--	1.770
MW-8	5/16/2005	--	--	1.770
MW-8	6/21/2005	--	--	1.770
MW-8	7/7/2005	--	--	1.770
MW-8	8/17/2005	--	--	1.770
MW-8	9/6/2005	--	--	1.770
MW-8	1/24/2006	--	--	1.770
MW-8	2/7/2006	--	--	1.770
MW-8	3/30/2006	--	--	1.770
MW-8	4/21/2006	--	--	1.770
MW-8	5/19/2006	<0.01 (Sheen)	--	1.770
MW-8	6/22/2006	--	--	1.770
MW-8	7/31/2006	--	--	1.770
MW-8	8/23/2006	--	--	1.770
MW-8	9/28/2006	--	--	1.770
MW-8	11/15/2006	<0.01 (Sheen)	--	1.770
MW-8	2/14/2007	<0.01 (Sheen)	--	1.770
MW-8	5/22/2007	<0.01 (Sheen)	--	1.770
MW-8	6/26/2007	--	--	1.770
MW-8	7/19/2007	--	--	1.770
MW-8	8/15/2007	<0.01 (Sheen)	--	1.770
MW-8	9/18/2007	--	--	1.770
MW-8	10/17/2007	--	--	1.770
MW-8	11/8/2007	--	--	1.770
MW-8	12/12/2007	--	--	1.770
MW-8	1/14/2008	NM	NM	1.770
MW-8	2/27/2008	NM	NM	1.770
MW-8	4/1/2008	NM	NM	1.770
MW-8	5/7/2008	NM	NM	1.770
MW-8	5/20/2008	0.00	0.000	1.770
MW-8	6/18/2008	0.00	0.000	1.770
MW-8	7/16/2008	0.00	0.000	1.770
MW-8	8/13/2008	0.00	0.000	1.770
MW-8	8/20/2008	0.01	0.000	1.770
MW-8	9/15/2008	NM	NM	1.770

Table 1
Free Product Removal
Former BP Service Station #11132
3201 35th Avenue, Oakland, CA

WELL ID	DATE OF MONITORING	PRODUCT THICKNESS (feet)	PRODUCT REMOVED (gallons)	CUMULATIVE PRODUCT REMOVED (gallons)
MW-8	10/15/2008	0.01	1.000	2.770
MW-8	11/17/2008	NM	NM	2.770
MW-8	12/18/2008	0.00	0.000	2.770
MW-8	1/14/2009	NM	NM	2.770
MW-8	2/4/2009	NM	NM	2.770
MW-8	2/25/2009	<0.01 (Sheen)	0.000	2.770
MW-8	3/11/2009	0.00	0.000	2.770
MW-8	4/8/2009	0.00	0.000	2.770
MW-8	5/28/2009	<0.01 (SHEEN)	0.000	2.770
MW-8	6/16/2009	0.00	0.000	2.770
MW-8	7/22/2009	0.00	0.000	2.770
MW-8	8/6/2009	NM	0.000	2.770
MW-8	9/11/2009	NM	0.000	2.770
MW-8	10/29/2009	0.00	0.0	2.770
MW-8	11/12/2009	NM	0.0	2.770
MW-8	12/11/2009	0.00	0.0	2.770
MW-9	11/2/93-4/29/97	0.10	<0.1	0.880
MW-9	11/5/1997	0.01	<0.1	0.880
MW-9	1/29/2003	0.10	0.190	1.070
MW-9	6/24/2003	NM	NM	1.070
MW-9	7/28/2003	<0.01 (SHEEN)	--	1.070
MW-9	8/12/2003	<0.01 (SHEEN)	--	1.070
MW-9	9/12/2003	<0.01 (SHEEN)	--	1.070
MW-9	10/3/2003	0.01	0.002	1.072
MW-9	11/18/2003	<0.01 (SHEEN)	--	1.072
MW-9	12/31/2003	<0.01 (SHEEN)	--	1.072
MW-9	2/2/2004	<0.01 (SHEEN)	--	1.072
MW-9	2/23/2004	<0.01 (SHEEN)	--	1.072
MW-9	3/18/2004	<0.01 (SHEEN)	--	1.072
MW-9	4/13/2004	<0.01 (SHEEN)	--	1.072
MW-9	5/4/2004	<0.01 (SHEEN)	--	1.072
MW-9	6/2/2004	<0.01 (SHEEN)	--	1.072
MW-9	7/2/2004	--	--	1.072
MW-9	8/4/2004	0.03	0.053	1.125
MW-9	9/22/2004	--	--	1.125
MW-9	10/26/2004	--	--	1.125
MW-9	11/10/2004	--	--	1.125
MW-9	12/27/2004	--	--	1.125
MW-9	1/13/2005	--	--	1.125
MW-9	2/15/2005	--	--	1.125
MW-9	3/7/2005	--	--	1.125
MW-9	4/29/2005	--	--	1.125
MW-9	5/16/2005	--	--	1.125
MW-9	6/21/2005	--	--	1.125
MW-9	7/7/2005	--	--	1.125
MW-9	8/17/2005	--	--	1.125
MW-9	9/6/2005	--	--	1.125
MW-9	1/24/2006	--	--	1.125
MW-9	2/7/2006	SHEEN	--	1.125
MW-9	3/30/2006	--	--	1.125
MW-9	4/21/2006	--	--	1.125
MW-9	5/19/2006	NM	--	1.125
MW-9	6/22/2006	--	--	1.125

Table 1
Free Product Removal
Former BP Service Station #11132
3201 35th Avenue, Oakland, CA

WELL ID	DATE OF MONITORING	PRODUCT THICKNESS (feet)	PRODUCT REMOVED (gallons)	CUMULATIVE PRODUCT REMOVED (gallons)
MW-9	7/31/2006	--	--	1.120
MW-9	8/23/2006	--	--	1.120
MW-9	9/28/2006	--	--	1.120
MW-9	11/15/2006	<0.01 (Sheen)	--	1.120
MW-9	2/14/2007	<0.01 (Sheen)	--	1.120
MW-9	5/22/2007	<0.01 (Sheen)	--	1.120
MW-9	6/26/2007	--	--	1.120
MW-9	7/19/2007	--	--	1.120
MW-9	8/15/2007	<0.01 (Sheen)	--	1.120
MW-9	9/18/2007	--	--	1.120
MW-9	10/17/2007	--	--	1.120
MW-9	11/8/2007	--	--	1.120
MW-9	12/12/2007	--	--	1.120
MW-9	1/14/2008	--	--	1.120
MW-9	2/27/2008	--	--	1.120
MW-9	4/1/2008	0.00	0.000	1.120
MW-9	5/7/2008	0.03	*	1.120
MW-9	5/20/2008	0.00	0.000	1.120
MW-9	6/18/2008	0.00	0.000	1.120
MW-9	7/16/2008	0.00	0.000	1.120
MW-9	8/13/2008	0.00	0.000	1.120
MW-9	8/20/2008	0.01	0.000	1.120
MW-9	9/15/2008	0.01	1.000	2.120
MW-9	10/15/2008	0.00	0.000	2.120
MW-9	11/17/2008	0.00	0.000	2.120
MW-9	12/18/2008	0.00	0.000	2.120
MW-9	1/14/2009	0.00	0.000	2.120
MW-9	2/4/2009	0.01	1.500	3.620
MW-9	2/25/2009	<0.01 (Sheen)	0.000	3.620
MW-9	3/11/2009	0.00	0.000	3.620
MW-9	4/8/2009	0.00	0.000	3.620
MW-9	5/28/2009	<0.01 (SHEEN)	0.000	3.620
MW-9	6/16/2009	0.01	0.000	3.620
MW-9	7/22/2009	0.00	0.000	3.620
MW-9	8/6/2009	0.00	0.000	3.620
MW-9	9/11/2009	0.00	0.000	3.620
MW-9	10/29/2009	0.00	0.0	3.620
MW-9	11/12/2009	NM	0.0	3.620
MW-9	12/11/2009	NM	0.0	3.620
MW-10	9/7/93-7/23/96	--	10.520	10.520
MW-10	9/4/1996	0.76	0.100	10.620
MW-10	11/11/1996	--	0.200	10.820
MW-10	1/21/1997	--	<0.03	10.850
MW-10	4/29/1997	--	0.040	10.890
MW-10	4/29/1997	--	0.040	10.930
MW-10	12/2/1997	0.03	<0.1	10.930
MW-10	2/3/1998	--	<0.1	10.930
MW-10	9/5/2001	0.01	--	10.930
MW-10	11/12/2002	0.07	0.010	10.940
MW-10	1/29/2003	0.03	0.030	10.970
MW-10	6/24/2003	0.04	0.010	10.980
MW-10	7/28/2003	0.04	0.020	11.000
MW-10	8/12/2003	<0.01 (SHEEN)	--	11.000

Table 1
Free Product Removal
Former BP Service Station #11132
3201 35th Avenue, Oakland, CA

WELL ID	DATE OF MONITORING	PRODUCT THICKNESS (feet)	PRODUCT REMOVED (gallons)	CUMULATIVE PRODUCT REMOVED (gallons)
MW-10	10/3/2003	<0.01 (SHEEN)	--	11.000
MW-10	11/18/2003	<0.01 (SHEEN)	--	11.000
MW-10	12/31/2003	<0.01 (SHEEN)	--	11.000
MW-10	2/2/2004	<0.01 (SHEEN)	--	11.000
MW-10	2/23/2004	<0.01 (SHEEN)	--	11.000
MW-10	3/18/2004	<0.01 (SHEEN)	--	11.000
MW-10	4/13/2004	<0.01 (SHEEN)	--	11.000
MW-10	5/4/2004	<0.01 (SHEEN)	--	11.000
MW-10	6/2/2004	<0.01 (SHEEN)	--	11.000
MW-10	7/2/2004	<0.01 (SHEEN)	--	11.000
MW-10	8/4/2004	0.08	0.110	11.110
MW-10	9/22/2004	--	--	11.110
MW-10	10/26/2004	--	--	11.110
MW-10	11/10/2004	--	--	11.110
MW-10	12/27/2004	--	--	11.110
MW-10	1/13/2005	<0.01 (SHEEN)	--	11.110
MW-10	2/15/2005	--	--	11.110
MW-10	3/7/2005	--	--	11.110
MW-10	4/29/2005	--	--	11.110
MW-10	5/16/2005	--	--	11.110
MW-10	6/21/2005	--	--	11.110
MW-10	7/7/2005	--	--	11.110
MW-10	8/17/2005	--	--	11.110
MW-10	9/6/2005	--	--	11.110
MW-10	1/24/2006	--	--	11.110
MW-10	2/7/2006	SHEEN	--	11.110
MW-10	3/30/2006	--	--	11.110
MW-10	4/21/2006	--	--	11.110
MW-10	5/19/2006	<0.01 (SHEEN)	--	11.110
MW-10	6/22/2006	--	--	11.110
MW-10	7/31/2006	--	--	11.110
MW-10	8/23/2006	--	--	11.110
MW-10	9/28/2006	--	--	11.110
MW-10	11/15/2006	<0.01 (Sheen)	--	11.110
MW-10	2/14/2007	<0.01 (Sheen)	--	11.110
MW-10	5/22/2007	<0.01 (Sheen)	--	11.110
MW-10	6/26/2007	<0.01 (Sheen)	--	11.110
MW-10	7/19/2007	--	--	11.110
MW-10	8/15/2007	<0.01 (Sheen)	--	11.110
MW-10	9/18/2007	--	--	11.110
MW-10	10/17/2007	--	--	11.110
MW-10	11/8/2007	--	--	11.110
MW-10	12/12/2007	--	--	11.110
MW-10	1/14/2008	--	--	11.110
MW-10	2/27/2008	--	--	11.110
MW-10	4/1/2008	0.00	0.000	11.110
MW-10	5/7/2008	0.00	0.000	11.110
MW-10	5/20/2008	0.00	0.000	11.110
MW-10	6/18/2008	0.00	0.000	11.110
MW-10	7/16/2008	0.01	1.500	12.610
MW-10	8/13/2008	0.01	2.000	14.610
MW-10	8/20/2008	0.01	0.000	14.610
MW-10	9/15/2008	0.00	0.000	14.610

Table 1
Free Product Removal
Former BP Service Station #11132
3201 35th Avenue, Oakland, CA

WELL ID	DATE OF MONITORING	PRODUCT THICKNESS (feet)	PRODUCT REMOVED (gallons)	CUMULATIVE PRODUCT REMOVED (gallons)
MW-10	10/15/2008	0.01	1.000	15.610
MW-10	11/17/2008	0.00	0.000	15.610
MW-10	12/18/2008	0.00	0.000	15.610
MW-10	1/14/2009	0.00	0.000	15.610
MW-10	2/4/2009	0.00	0.000	15.610
MW-10	2/25/2009	0.00	0.000	15.610
MW-10	3/11/2009	0.00	0.000	15.610
MW-10	4/8/2009	0.00	0.000	15.610
MW-10	5/28/2009	<0.01 (SHEEN)	0.000	15.610
MW-10	6/16/2009	0.01	0.000	15.610
MW-10	7/22/2009	0.02	2.500	18.110
MW-10	8/6/2009	0.00	0.000	18.110
MW-10	9/11/2009	0.01	2.500	20.610
MW-10	10/29/2009	0.00	0.0	20.610
MW-10	11/12/2009	NM	0.0	20.610
MW-10	12/11/2009	0.00	0.0	20.610
RW-1	9/5/2001	0.02	--	0.000
RW-1	6/20/2002	**	--	0.000
RW-1	9/11/2002	0.03	0.040	0.040
RW-1	11/12/2002	0.02	0.030	0.070
RW-1	1/29/2003	0.04	0.070	0.140
RW-1	6/24/2003	0.07	0.040	0.180
RW-1	7/28/2003	0.04	0.020	0.200
RW-1	8/12/2003	<0.01 (SHEEN)	--	0.200
RW-1	9/12/2003	0.07	0.100	0.300
RW-1	10/3/2003	0.03	0.040	0.340
RW-1	11/18/2003	<0.01 (SHEEN)	--	0.340
RW-1	12/31/2003	<0.01 (SHEEN)	--	0.340
RW-1	2/23/2004	0.01	0.005	0.345
RW-1	3/18/2004	0.09	0.120	0.465
RW-1	4/13/2004	0.02	0.030	0.495
RW-1	5/4/2004	0.02	0.030	0.525
RW-1	6/2/2004	0.05	0.020	0.545
RW-1	7/2/2004	0.11	0.162	0.707
RW-1	8/4/2004	0.05	0.159	0.865
RW-1	9/22/2004	0.06	0.088	0.953
RW-1	10/26/2004	0.01	0.010	0.963
RW-1	11/10/2004	0.02	0.030	0.993
RW-1	12/27/2004	0.03	0.010	1.003
RW-1	1/13/2005	0.01	0.004	1.007
RW-1	2/15/2005	0.03	0.044	1.051
RW-1	3/7/2005	0.02	0.029	1.080
RW-1	4/29/2005	0.03	0.044	1.124
RW-1	5/16/2005	0.02	0.029	1.154
RW-1	6/21/2005	0.03	0.013	1.167
RW-1	7/7/2005	0.06	0.092	1.259
RW-1	8/17/2005	0.03	0.044	1.304
RW-1	9/6/2005	0.03	0.044	1.348
RW-1	10/4/2005	0.07	0.100	1.448
RW-1	11/18/2005	0.07	0.010	1.458
RW-1	12/30/2005	0.04	0.006	1.464
RW-1	1/24/2006	0.01	0.015	1.479
RW-1	2/7/2006	0.01	0.015	1.494

Table 1
Free Product Removal
Former BP Service Station #11132
3201 35th Avenue, Oakland, CA

WELL ID	DATE OF MONITORING	PRODUCT THICKNESS (feet)	PRODUCT REMOVED (gallons)	CUMULATIVE PRODUCT REMOVED (gallons)
RW-1	3/30/2006	0.02	0.030	1.524
RW-1	4/21/2006	0.00	0.000	1.524
RW-1	5/19/2006	0.04	0.058	1.582
RW-1	6/22/2006	0.03	0.044	1.626
RW-1	7/31/2006	0.12	0.176	1.802
RW-1	8/23/2006	0.07	0.103	1.905
RW-1	9/28/2006	0.07	0.103	2.008
RW-1	11/15/2006	0.07	--	2.008
RW-1	2/14/2007	0.04	*	2.008
RW-1	3/14/2007	0.05	****	2.008
RW-1	4/10/2007	0.10	****	2.008
RW-1	5/22/2007	**	****	2.008
RW-1	6/26/2007	0.05	****	2.008
RW-1	7/19/2007	<0.01 (Sheen)	--	2.008
RW-1	8/15/2007	0.02	2.0	4.008
RW-1	9/18/2007	0.03	2.0	6.008
RW-1	10/17/2007	0.01	4.0	10.008
RW-1	11/8/2007	0.01	2.5	12.508
RW-1	12/12/2007	0.01	2.5	15.008
RW-1	1/14/2008	0.01	4.0	19.008
RW-1	2/27/2008	--	1.0	20.008
RW-1	4/1/2008	0.01	1.5	21.508
RW-1	5/7/2008	NM	NM	21.508
RW-1	5/20/2008	0.00	2.0	23.508
RW-1	6/18/2008	0.00	3.0	26.508
RW-1	7/16/2008	0.02	4.0	30.508
RW-1	8/13/2008	0.01	7.0	37.508
RW-1	8/20/2008	0.02	0.0	37.508
RW-1	9/15/2008	0.02	4.0	41.508
RW-1	10/15/2008	0.03	3.0	44.508
RW-1	11/17/2008	0.00	0.0	44.508
RW-1	12/18/2008	0.00	0.0	44.508
RW-1	1/14/2009	0.01	3.0	47.508
RW-1	2/4/2009	0.01	3.5	51.008
RW-1	2/25/2009	0.02	4.0	55.008
RW-1	3/11/2009	0.01	3.5	58.508
RW-1	4/8/2009	0.00	0.0	58.508
RW-1	5/28/2009	0.01	3.0	61.508
RW-1	6/16/2009	0.01	0.0	61.508
RW-1	7/22/2009	0.01	1.5	63.008
RW-1	8/6/2009	0.01	4.0	67.008
RW-1	9/11/2009	0.01	4.0	71.008
RW-1	10/29/2009	0.00	0.0	71.008
RW-1	11/12/2009	0.00	0.0	71.008
RW-1	12/11/2009	0.00	0.0	71.008

Free Product Removed this Quarter = **0.0**

Total Free Product = **234.274**

NM = Unable to gauge free product thickness or remove product because the well was inaccessible.

* No hazardous waste drum on-site or drum was full, therefore no product was removed.

** Indeterminate thickness of product. The nature of product is unknown, very viscous.

*** Data prior to 1998 is incomplete, and amounts removed are estimates based on quarter reports from the previous consultants.

Table 1
Free Product Removal
Former BP Service Station #11132
3201 35th Avenue, Oakland, CA

WELL ID	DATE OF MONITORING	PRODUCT THICKNESS (feet)	PRODUCT REMOVED (gallons)	CUMULATIVE PRODUCT REMOVED (gallons)
----------------	---------------------------	---------------------------------	----------------------------------	---

*** Absorbent socks used to collect product. Unknown amount of product recovered.

The data within this table collected prior to June 2006 was provided to BAI by RM and their previous consultants. BAI has not verified the accuracy of this information.

APPENDIX A

FIELD DATA SHEETS

DATE: 11/12/09
 PERSONNEL: T. Geddes
 WEATHER: clear

PROJECT NO.: GG-88-655
 COMMENTS: No Product

Well ID	Time	MEASURING POINT	DTW (FT)	PRODUCT THICKNESS	Equip:							WELL HEAD CONDITION: VAULT, BOLTS, CAP, LOCK, ETC			
					Geosquirt	Tubing	Bailers	DO	Wli	Ec/pH	pH		Cond. (X100)	Temp. (C/F)	DO (mg/l)
RW-1															No product
MW-1															No product

DATE: 12/11/09 11132
PERSONNEL: T. Giddis
WEATHER: overcast 50's

PROJECT NO.: 09-88-655
COMMENTS:

Well ID	Time	MEASURING POINT	DTW (FT)	PRODUCT THICKNESS	COMMENTS:							WELL HEAD CONDITION: VAULT, BOLTS, CAP, LOCK, ETC	
					Equip:	Geosquirt	Tubing	Bailers	DO	wli	Ec/pH		
MW-1			20.75	none									no product
MW-2			19.60	none									no product
MW-8	0920		17.42	none									no product
MW-9													Not sampled - car parked over well
MW-10			18.61	none									no product
RW-1			19.14	none									no product
													2 product bins/drums onsite
													one is 1/3 full
													other is 1/4 full