



**BP OIL**

March 13, 1994

Alameda County Health Care Services Agency  
Division of Hazardous Materials  
Attention Mr. Ron Owcarz  
80 Swan Way, Room 200,  
Oakland, CA 94621

SH

California Regional Water Quality Control Board  
Attention Mr. Eddie So  
San Francisco Bay Region  
2101 Webster Street, Suite 500  
Oakland, CA 94612

RE: **BP Oil Site No. 11132**  
**3201 35th Street**  
**Oakland, CA**

Greetings:

Attached please find a Groundwater Sampling and Monitoring Report dated January 10, 1994. You should note that we have lowered the elevation of the pump intake in RW-1, and this appears to have enlarged the associated cone of depression. This should enhance migration control, and may obviate the need for an additional recovery well. I have also directed Alisto Engineering Group to perform additional manual bailing as an interim measure. An oil-water separator is also being added to the remediation system.

Please give me a call in the event you wish to discuss this matter further. I can be reached at (206) 251-0689.

Sincerely,

A handwritten signature in cursive script, appearing to read 'Scott T. Hooton', is written over the typed name.

Scott T. Hooton  
Environmental Resources Management

attachment

cc: site file  
B. Nagle - Alisto

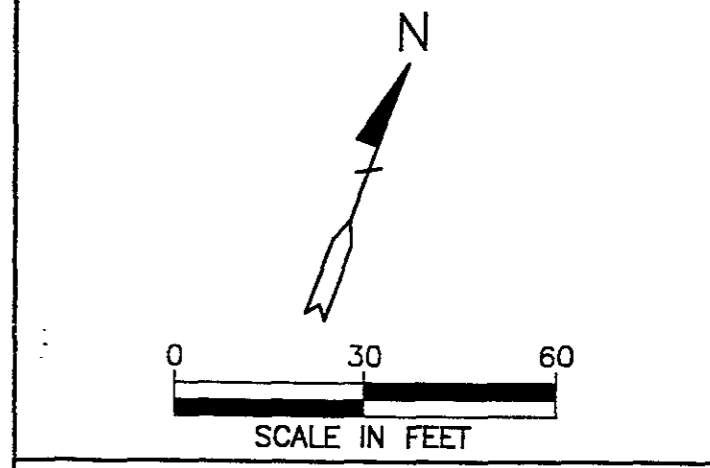
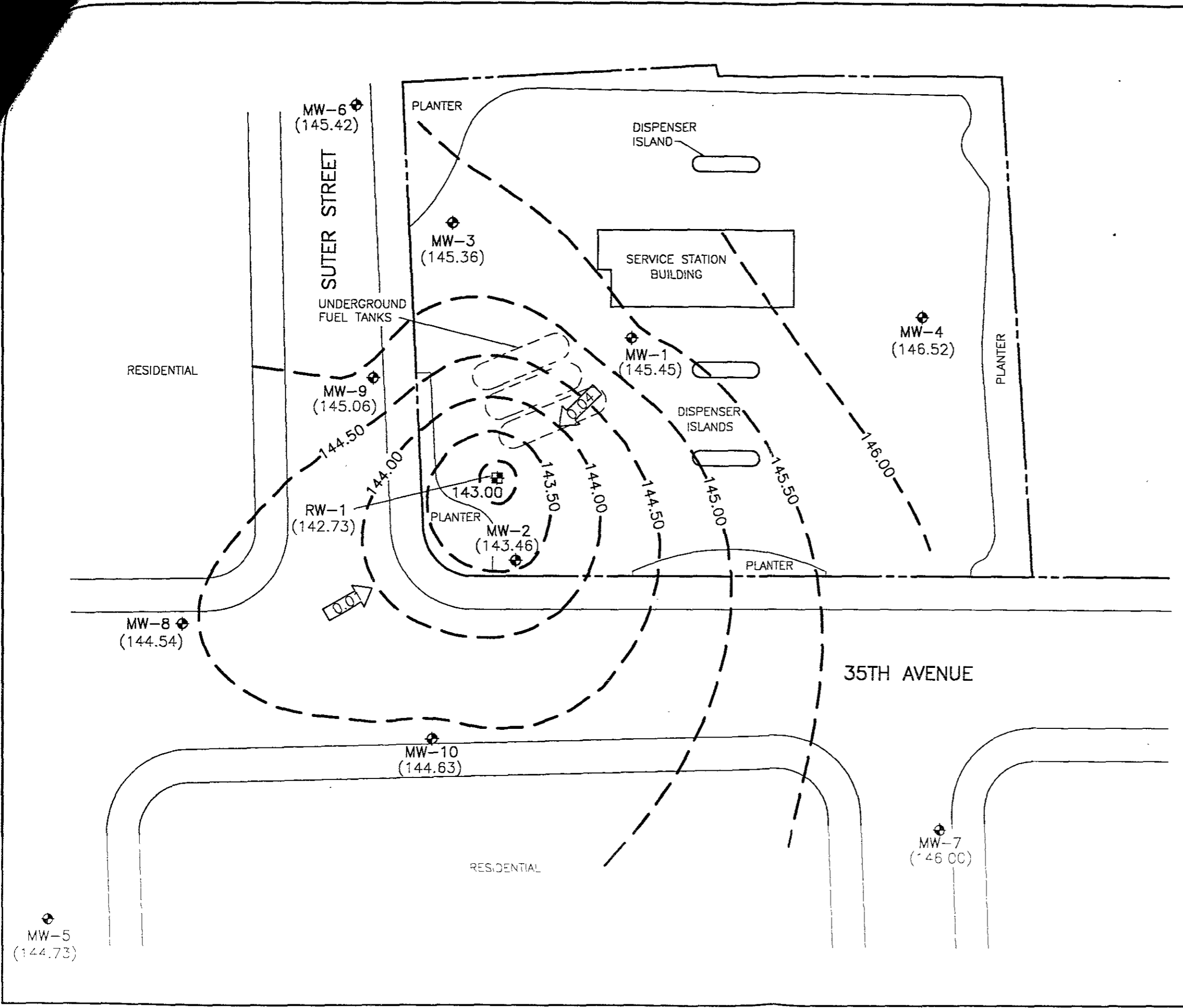

- LEGEND**
- ◆ GROUNDWATER MONITORING WELL
  - ⊕ GROUNDWATER RECOVERY WELL
  - (145.45) GROUNDWATER ELEVATION IN FEET ABOVE MEAN SEA LEVEL
  - 145.00 - GROUNDWATER ELEVATION CONTOUR IN FEET ABOVE MEAN SEA LEVEL (CONTOUR INTERVAL - 0.50 FOOT)
  - ← 0.04 → CALCULATED GROUNDWATER GRADIENT DIRECTION AND MAGNITUDE IN FOOT PER FOOT

**FIGURE 2**  
**POTENTIOMETRIC GROUNDWATER ELEVATION CONTOUR MAP**  
 OCTOBER 21, 1993  
 BP OIL SERVICE STATION NO. 11132  
 3201 35TH STREET  
 OAKLAND, CALIFORNIA  
 PROJECT NO. 10-024

100240-110-024-12-2-93-BRW-1A-30

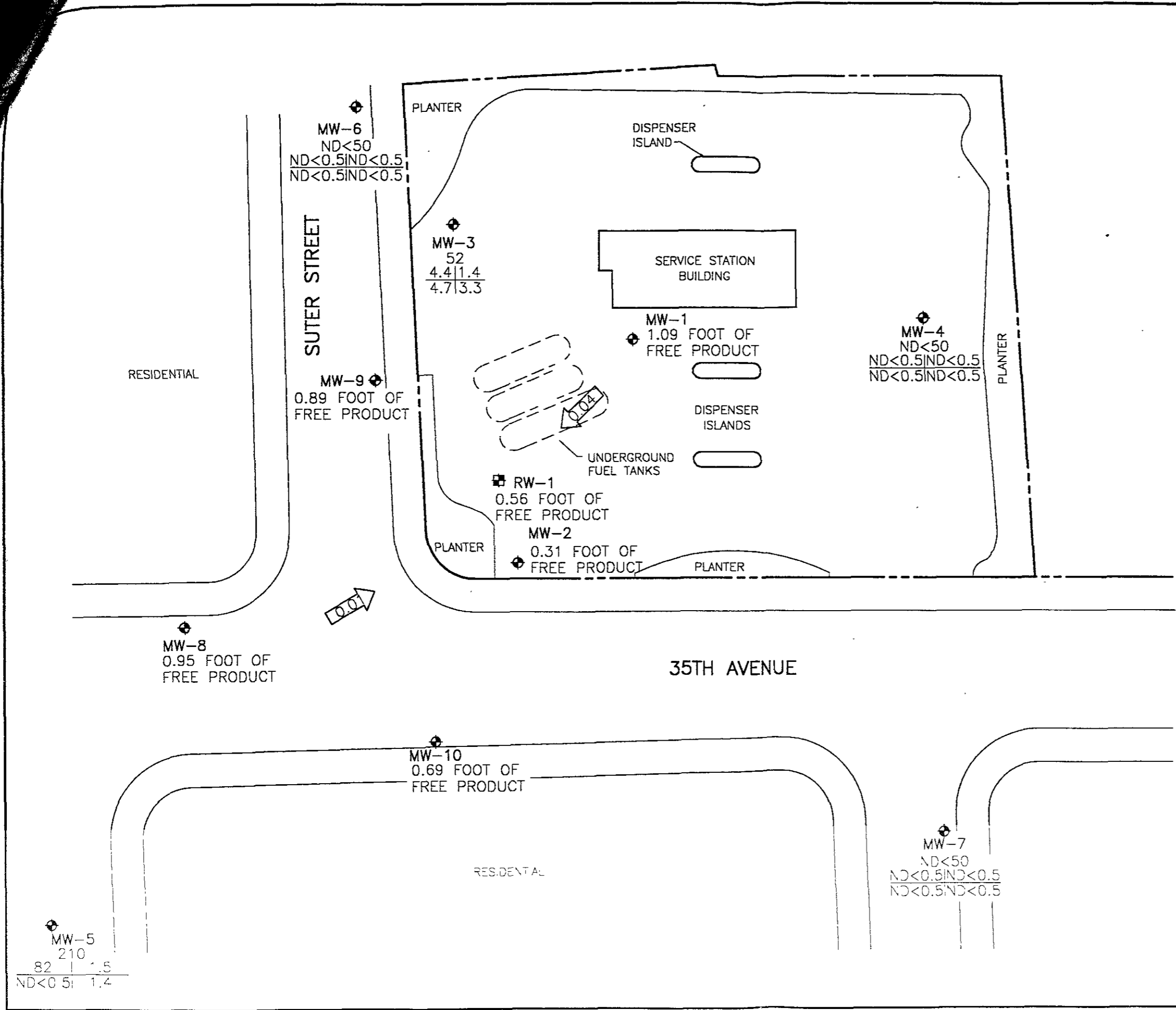

**LEGEND**

- ◆ GROUNDWATER MONITORING WELL
- GROUNDWATER RECOVERY WELL
- TPH-G | T CONCENTRATION OF CONSTITUENTS IN PARTS PER BILLION
- B | X
- E | X
- TPH-G TOTAL PETROLEUM HYDROCARBONS AS GASOLINE
- B BENZENE
- T TOLUENE
- E ETHYLBENZENE
- X TOTAL XYLENES
- ND NOT DETECTED ABOVE REPORTED DETECTION LIMIT
- ← 0.04 CALCULATED GROUNDWATER GRADIENT DIRECTION AND MAGNITUDE IN FOOT PER FOOT

**FIGURE 3**  
**CONCENTRATIONS OF PETROLEUM HYDROCARBONS IN GROUNDWATER**  
 OCTOBER 21, 1993  
 BP OIL SERVICE STATION NO. 11132  
 3201 35TH STREET  
 OAKLAND, CALIFORNIA  
 PROJECT NO. 10-024

10024L-H10WG 12-11-93 RHW 11-30