

ASSESSOR'S MAP I

Code Area Nos. 17-022

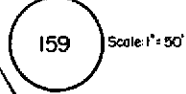

OAKLAND (KELLERSBERGER'S) (86.7 Pg. 3)

Drawn: G. STRAIN. Revised: 4-7-76 NW

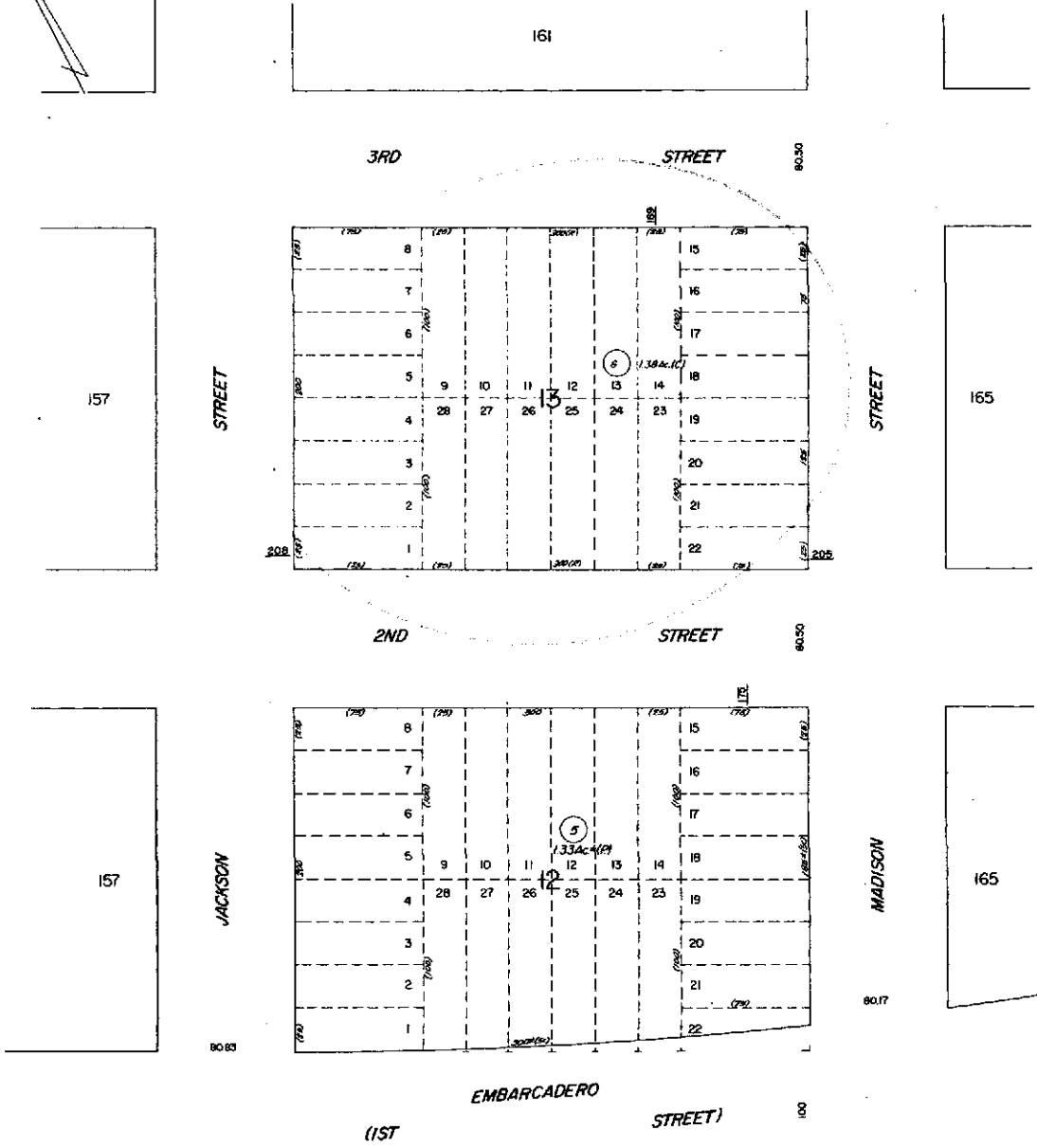

Form No. 204, 12/81/3

17-022

B O O K O

ACA

Reference:

11746

R012



COUNTY OF ALAMEDA
Assessor's Office

Property Value System

[Help](#)

[New Query](#)

[History](#)

[Value](#)

[Transfer](#)

[Map](#)

[Glossary](#)

Parcel Number: **1-159-6** Inactive: **N** Lien Date: **01/01/2007** Owner: **SSR WESTERN MULTIFAMILY LLC**
 Property Address: **208 JACKSON ST, OAKLAND, CA 94607-4326**
 Current Mailing Address as of 03/11/2005: **SSR WESTERN MULTIFAMILY LLC, c/o PARADIGM TAX GROUP,
 3645 RUFFIN RD STE 310, SAN DIEGO, CA 92123-1887**
[Parcel History](#)

Mailing Name		Historical Mailing Address	Document Date	Document Number	Value From Trans Tax	Parcel Count	Use
SSR WESTERN MULTIFAMILY LLC c/o KPMG LLP	List Owners	750 B ST STE 1500, SAN DIEGO, CA 92101-8131	12/31/2001	2001- 507902		3	7700
SNK PEABODY JLS LLC	List Owners	1313 E OSBORN RD # 213, PHOENIX, AZ 85014	10/22/1998	1998- 371292		1	7700
SNK ALLEGRO AT JLS LLC c/o SNK REALTY GROUP	List Owners	185 BERRY ST , SAN FRANCISCO, CA 94107- 5705	07/10/1998	1998- 243358		1	7700
CHEN TZU M & CHIH C	List Owners	132 10TH ST , OAKLAND, CA 94607-4804	11/13/1990	1990- 299987		1	7700
EAST BAY PACKING CO	List Owners	208 JACKSON ST , OAKLAND, CA 94607-4326	03/18/1976	1976- 40980		1	7700
KWAHOM CORPORATION	List Owners	208 JACKSON ST , OAKLAND, CA 94607-4326	11/20/1970	1970- 128511		4	7700

All information on this site is to be assumed accurate for property assessment purposes only, and is based upon the Assessor's knowledge of each property. Caution is advised for use other than its intended purpose.

The Alameda County Intranet site is best viewed in Internet Explorer Version 5.5 or later.
[Click here](#) for more information regarding supported browsers.

Copyright © 2001 Alameda County