



State Water Resources Control Board



Linda S. Adams
Secretary for
Environmental Protection

Division of Financial Assistance
1001 I Street • Sacramento, California 95814
P.O. Box 944212 • Sacramento, California • 94244-2120
(916) 341-5714 • FAX (916) 341-5806 • www.waterboards.ca.gov/cwphome/ustcf

Arnold Schwarzenegger
Governor

SHELL OIL COMPANY
SHELL OIL PRODUCTS US - HSE/S&E
DEBORAH PRYOR
20945 WILMINGTON AVE S
CARSON, CA 90810

September 13, 2006

UNDERGROUND STORAGE TANK CLEANUP FUND (FUND), NOTICE OF
ELIGIBILITY DETERMINATION: CLAIM NUMBER 018773; FOR SITE ADDRESS:
2800 TELEGRAPH AVE, OAKLAND

Your claim has been accepted for placement on the Priority List in Priority Class "D"
with a deductible of \$10,000.

We have completed our initial review. The next step in the claim review process is to
conduct a compliance review.

Compliance Review: Staff reviews, verifies, and processes claims based on the priority
and rank within a priority class. After the Board adopts the Priority List, your claim will
remain on the Priority List until your Priority Class and rank are reached. At that time,
staff will conduct an extensive Compliance Review at the local regulatory agency or
Regional Water Quality Control Board. During this Compliance Review, staff may
request additional information needed to verify eligibility. Once the Compliance Review
is completed, staff will determine if the claim is valid or must be rejected. If the claim is
valid, a Letter of Commitment will be issued obligating funds toward the cleanup. If staff
determine that you have not complied with regulations governing site cleanup, you have
not supplied necessary information or documentation, or your claim application contains
a material error, the claim will be rejected. In such event, you will be issued a Notice of
Intended Removal from the Priority List, informed of the basis for the proposed removal
of your claim, and provided an opportunity to correct the condition that is the basis for
the proposed removal. Your claim will be barred from further participation in the Fund, if
the claim application contains a material error resulting from fraud or misrepresentation.

Record keeping: During your cleanup project you should keep complete and well
organized records of all corrective action activity and payment transactions. If you are
eventually issued a Letter of Commitment, you will be required to submit: (1) copies of
detailed invoices for all corrective action activity performed (including subcontractor
invoices), (2) copies of canceled checks used to pay for work shown on the invoices, (3)
copies of technical documents (bids, narrative work description, reports), and (4)
evidence that the claimant paid for the work performed (not paid by another party).
These documents are necessary for reimbursement and failure to submit them could
impact the amount of reimbursement made by the Fund. **It is not necessary to submit**

California Environmental Protection Agency



these documents at this time; however, they will definitely be required prior to reimbursement.

Compliance with Corrective Action Requirements: In order to be reimbursed for your eligible costs of cleanup incurred after December 2, 1991, you must have complied with corrective action requirements of Article 11, Chapter 16, Division 3, Title 23, California Code of Regulations. Article 11 categorized the corrective action process into **phases**. In addition, Article 11 requires the responsible party to submit an **investigative workplan/Corrective Action Plan (CAP)** before performing any work. This phasing process and the workplan/CAP requirements were intended to:

1. help the responsible party undertake the necessary corrective action in a cost-effective, efficient and timely manner;
2. enable the regulatory agency to review and approve the proposed cost-effective corrective action alternative before any corrective action work was performed; and
3. ensure the Fund will only reimburse the most cost-effective corrective action alternative required by the regulatory agency to achieve the minimum cleanup necessary to protect human health, safety and the environment.

In some limited situations **interim cleanup** will be necessary to mitigate a demonstrated immediate hazard to public health, or the environment. Program regulations allow the responsible party to undertake interim remedial action after: (1) notifying the regulatory agency of the proposed action, and; (2) complying with any requirements that the regulatory agency may set. Interim remedial action should only be proposed when necessary to mitigate an immediate demonstrated hazard. **Implementing interim remedial action does not eliminate the requirement for a CAP and an evaluation of the most cost-effective corrective action alternative.**

Three bids: Only corrective action costs required by the regulatory agency to protect human health, safety and the environment can be claimed for reimbursement. You must comply with all regulatory agency time schedules and requirements and you must obtain three bids for any required corrective action. ***If you do not obtain three bids or a waiver of the three-bid requirement, reimbursement is not assured and costs may be rejected as ineligible.***

If you have any questions, please contact me at (916) 341-5714.

Sincerely,

Shari Knieriem

Shell Oil Company

-3-

Shari Knieriem
Claims Review Unit
Underground Storage Tank Cleanup Fund

cc: Ms. Donna Drogos
Alameda County EHD
1131 Harbor Bay Pkway, 2nd Fl.
Alameda, CA 94502-6577

ALAMEDA COUNTY
HEALTH CARE SERVICES

AGENCY

DAVID J. KEARS, Agency Director



F

ENVIRONMENTAL HEALTH SERVICES
ENVIRONMENTAL PROTECTION
1131 Harbor Bay Parkway, Suite 250
Alameda, CA 94502-6577
(510) 567-6700
FAX (510) 337-9335

August 30, 2006

Denis Brown
Shell Oil Products US
20945 S. Wilmington Ave.
Carson, CA 90810-1039

Harman Management Corporation
199 1st Street, Suite 212
Los Altos, CA 94022

Subject: Fuel Leak Case No. RO0000009, 2800 Telegraph Ave., Oakland, CA

Dear Mr. Brown:

Alameda County Environmental Health (ACEH) staff has reviewed the fuel leak case file for the above-referenced site and the reports plan entitled, "Well Destruction, Well Installation, and Groundwater Monitoring Report - First Quarter 2006," dated May 15, 2006 and "Groundwater Monitoring Report - Second Quarter 2006," dated August 15, 2006. Both reports were prepared on your behalf by Cambria Environmental Technology, Inc. The "Well Destruction, Well Installation, and Groundwater Monitoring Report - First Quarter 2006," presents the results from the destruction of well S-3, and installation of replacement well S-3R, and sampling of the three monitoring wells at the site. The "Groundwater Monitoring Report - Second Quarter 2006," dated August 15, 2006 presents the results of groundwater sampling for chemicals of concern and general water quality.

We request that you address the following technical comments, perform the proposed work, and send us the reports described below.

TECHNICAL COMMENTS

1. **Quarterly Groundwater Monitoring.** The "Well Destruction, Well Installation, and Groundwater Monitoring Report - First Quarter 2006," report recommends that well S-6, S-7, and S-3R should be gauged and sampled on a quarterly basis. We concur with quarterly sampling of the three existing wells and analysis for TPHg and BTEX, with annual analysis for the five oxygenates. Please present the results in the quarterly monitoring reports requested below.
2. **Dissolved Iron Concentrations.** The "Groundwater Monitoring Report - Second Quarter 2006," states that the groundwater at the site would not be usable as a potential source of drinking water based solely on dissolved iron concentrations. This analysis is not valid since groundwater chemistry, including the concentration of dissolved iron, is altered within a petroleum hydrocarbon plume and does not reflect ambient conditions. Specifically, iron exists as an electron acceptor in the solid phase (Fe(OH)³ under ambient conditions, which

are typically aerobic. Reduction of iron from the oxidized form to the reduced form (Fe^{2+}) results in mobilization and hence increased dissolved iron concentrations. Therefore, the observed increased concentrations of dissolved iron do not reflect ambient conditions and should not be used to assess the potability of groundwater in the area.

TECHNICAL REPORT REQUEST

Please submit technical reports to Alameda County Environmental Health (Attention: Jerry Wickham), according to the following schedule:

- **November 17, 2006** - Quarterly Monitoring Report for the Third Quarter 2006
- **February 17, 2007** - Quarterly Monitoring Report for the Fourth Quarter 2006

These reports are being requested pursuant to California Health and Safety Code Section 25296.10. 23 CCR Sections 2652 through 2654, and 2721 through 2728 outline the responsibilities of a responsible party in response to an unauthorized release from a petroleum UST system, and require your compliance with this request.

ELECTRONIC SUBMITTAL OF REPORTS

Effective **January 31, 2006**, the Alameda County Environmental Cleanup Oversight Programs (LOP and SLIC) require submission of all reports in electronic form to the county's ftp site. Paper copies of reports will no longer be accepted. The electronic copy replaces the paper copy and will be used for all public information requests, regulatory review, and compliance/enforcement activities. Instructions for submission of electronic documents to the Alameda County Environmental Cleanup Oversight Program ftp site are provided on the attached "Electronic Report Upload (ftp) Instructions." Please do not submit reports as attachments to electronic mail.

Submission of reports to the Alameda County ftp site is an addition to existing requirements for electronic submittal of information to the State Water Resources Control Board (SWRCB) Geotracker website. Submission of reports to the Geotracker website does not fulfill the requirement to submit documents to the Alameda County ftp site. In September 2004, the SWRCB adopted regulations that require electronic submittal of information for groundwater cleanup programs. For several years, responsible parties for cleanup of leaks from underground storage tanks (USTs) have been required to submit groundwater analytical data, surveyed locations of monitor wells, and other data to the Geotracker database over the Internet. Beginning July 1, 2005, electronic submittal of a complete copy of all necessary reports was required in Geotracker (in PDF format). Please visit the SWRCB website for more information on these requirements (http://www.swrcb.ca.gov/ust/cleanup/electronic_reporting).

PERJURY STATEMENT

All work plans, technical reports, or technical documents submitted to ACEH must be accompanied by a cover letter from the responsible party that states, at a minimum, the following: "I declare, under penalty of perjury, that the information and/or recommendations contained in the attached document or report is true and correct to the best of my knowledge." This letter must be signed by an officer or legally authorized representative of your company. Please include a cover

Denis Brown
Harman Management Company
August 30, 2006
Page 3

letter satisfying these requirements with all future reports and technical documents submitted for this fuel leak case.

PROFESSIONAL CERTIFICATION & CONCLUSIONS/RECOMMENDATIONS

The California Business and Professions Code (Sections 6735, 6835, and 7835.1) requires that work plans and technical or implementation reports containing geologic or engineering evaluations and/or judgments be performed under the direction of an appropriately registered or certified professional. For your submittal to be considered a valid technical report, you are to present site specific data, data interpretations, and recommendations prepared by an appropriately licensed professional and include the professional registration stamp, signature, and statement of professional certification. Please ensure all that all technical reports submitted for this fuel leak case meet this requirement.

UNDERGROUND STORAGE TANK CLEANUP FUND

Please note that delays in investigation, later reports, or enforcement actions may result in your becoming ineligible to receive grant money from the state's Underground Storage Tank Cleanup Fund (Senate Bill 2004) to reimburse you for the cost of cleanup.

AGENCY OVERSIGHT

If it appears as though significant delays are occurring or reports are not submitted as requested, we will consider referring your case to the Regional Board or other appropriate agency, including the County District Attorney, for possible enforcement actions. California Health and Safety Code, Section 25299.76 authorizes enforcement including administrative action or monetary penalties of up to \$10,000 per day for each day of violation.

If you have any questions, please call me at (510) 567-6791.

Sincerely,

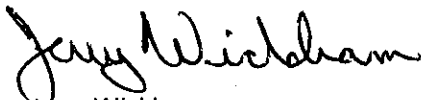

Jerry Wickham
Hazardous Materials Specialist

Enclosure: ACEH Electronic Report Upload (ftp) Instructions

cc: Ana Friel
Cambria Environmental Technology, Inc.
270 Perkins Street
Sonoma, CA 95406

Donna Drogos, ACEH
Jerry Wickham, ACEH
File

Alameda County Environmental Cleanup Oversight Programs (LOP and SLIC)	ISSUE DATE: July 5, 2005
	REVISION DATE: May 31, 2006
	PREVIOUS REVISIONS: October 31, 2005, December 16, 2005
SECTION: Miscellaneous Administrative Topics & Procedures	SUBJECT: Electronic Report Upload (ftp) Instructions

Effective **January 31, 2006**, the Alameda County Environmental Cleanup Oversight Programs (LOP and SLIC) require submission of all reports in electronic form to the county's ftp site. Paper copies of reports will no longer be accepted. The electronic copy replaces the paper copy and will be used for all public information requests, regulatory review, and compliance/enforcement activities.

REQUIREMENTS

- Entire report including cover letter must be submitted to the ftp site as a **single portable document format (PDF) with no password protection**. (Please do not submit reports as attachments to electronic mail.)
- It is **preferable** that reports be converted to PDF format from their original format, (e.g., Microsoft Word) rather than scanned.
- Signature pages and perjury statements **must** be included and have either original or electronic signature.
- **Do not password protect the document**. Once indexed and inserted into the correct electronic case file, the document will be secured in compliance with the County's current security standards and a password. **Documents with password protection will not be accepted.**
- Each page in the PDF document should be rotated in the direction that will make it easiest to read on a computer monitor.
- Reports must be named and saved using the following naming convention:
RO#_Report Name_Year-Month-Date (e.g., RO#5555_WorkPlan_2005-06-14)

Additional Recommendations

- A separate copy of the tables in the document should be submitted by e-mail to your Caseworker in **Excel** format. These are for use by assigned Caseworker only.

Submission Instructions

- 1) Obtain User Name and Password:
 - a) Contact the Alameda County Environmental Health Department to obtain a User Name and Password to upload files to the ftp site.
 - i) Send an e-mail to dehloptoxic@acgov.org
 - or
 - ii) Send a fax on company letterhead to (510) 337-9335, to the attention of: **ftp Site Coordinator**.
 - b) In the subject line of your request, be sure to include "**ftp PASSWORD REQUEST**" and in the body of your request, include the **Contact Information, Site Addresses, and the Case Numbers (RO# available in Geotracker) you will be posting for.**
- 2) Upload Files to the ftp Site
 - a) Using Internet Explorer (IE4+), go to <ftp://alcoftp1.acgov.org>
 - (i) Note: Netscape and Firefox browsers will not open the FTP site.
 - b) Click on File, then on Login As.
 - c) Enter your User Name and Password. (Note: Both are Case Sensitive.)
 - d) Open "My Computer" on your computer and navigate to the file(s) you wish to upload to the ftp site.
 - e) With both "My Computer" and the ftp site open in separate windows, drag and drop the file(s) from "My Computer" to the ftp window.
- 3) Send E-mail Notifications to the Environmental Cleanup Oversight Programs
 - a) Send email to dehloptoxic@acgov.org notify us that you have placed a report on our ftp site.
 - b) Copy your Caseworker on the e-mail. Your Caseworker's e-mail address is the entire first name then a period and entire last name at acgov.org. (e.g., firstname.lastname@acgov.org)
 - c) The subject line of the e-mail must start with the RO# followed by **Report Upload**. (e.g., Subject: RO1234 Report Upload)

ALAMEDA COUNTY
HEALTH CARE SERVICES

AGENCY
DAVID J. KEARS, Agency Director



Handwritten signature or mark.

copy

ENVIRONMENTAL HEALTH SERVICES
ENVIRONMENTAL PROTECTION
1131 Harbor Bay Parkway, Suite 250
Alameda, CA 94502-6577
(510) 567-6700
FAX (510) 337-9335

August 22, 2005

Denis Brown
Shell Oil Products US
20945 S. Wilmington Ave.
Carson, CA 90810-1039

Harman Management Corporation
199 1st Street, Suite 212
Los Altos, CA 94022

Subject: Fuel Leak Case No. RO0000009, 2800 Telegraph Ave., Oakland, CA – Work Plan Approval

Dear Mr. Brown:

Alameda County Environmental Health (ACEH) staff has reviewed the fuel leak case file for the above-referenced site and the work plan entitled, "Site Investigation Work Plan," dated August 4, 2005, prepared on your behalf by Cambria Environmental Technology, Inc. The work plan proposed a scope of work to destroy monitoring wells S-1, S-3, S-4, S-5, S-10, and SR-1 and install a replacement well for S-3. ACEH concurs with the work plan as proposed. ACEH requests that you perform the proposed work and send us the reports described below.

TECHNICAL COMMENTS

1. **Quarterly Groundwater Monitoring.** Please present groundwater sampling results in the Quarterly Monitoring Reports requested below.

TECHNICAL REPORT REQUEST

Please submit technical reports to Alameda County Environmental Health (Attention: Jerry Wickham), according to the following schedule:

- **January 6, 2006** – Well Destruction and Well Installation Report
- **February 28, 2006** - Quarterly Monitoring Report for the Fourth Quarter 2005
- **May 28, 2006** - Quarterly Monitoring Report for the First Quarter 2006

These reports are being requested pursuant to California Health and Safety Code Section 25296.10. 23 CCR Sections 2652 through 2654, and 2721 through 2728 outline the responsibilities of a responsible party in response to an unauthorized release from a petroleum UST system, and require your compliance with this request.

ELECTRONIC SUBMITTAL OF REPORTS

ACEH's Environmental Cleanup Oversight Programs (LOP and SLIC) now request submission of reports in electronic form. The electronic copy is intended to replace the need for a paper copy and is expected to be used for all public information requests, regulatory review, and compliance/enforcement activities. Instructions for submission of electronic documents to the Alameda County Environmental Cleanup Oversight Program FTP site are provided on the attached "Electronic Report Upload Instructions." Submission of reports to the Alameda County FTP site is an addition to existing requirements for electronic submittal of information to the State Water Resources Control Board (SWRCB) Geotracker website. In September 2004, the SWRCB adopted regulations that require electronic submittal of information for groundwater cleanup programs. For several years, responsible parties for cleanup of leaks from underground storage tanks (USTs) have been required to submit groundwater analytical data, surveyed locations of monitoring wells, and other data to the Geotracker database over the Internet. Beginning July 1, 2005, electronic submittal of a complete copy of all reports is required in Geotracker (in PDF format). Please visit the State Water Resources Control Board for more information on these requirements (http://www.swrcb.ca.gov/ust/cleanup/electronic_reporting).

PERJURY STATEMENT

All work plans, technical reports, or technical documents submitted to ACEH must be accompanied by a cover letter from the responsible party that states, at a minimum, the following: "I declare, under penalty of perjury, that the information and/or recommendations contained in the attached document or report is true and correct to the best of my knowledge." This letter must be signed by an officer or legally authorized representative of your company. Please include a cover letter satisfying these requirements with all future reports and technical documents submitted for this fuel leak case.

PROFESSIONAL CERTIFICATION & CONCLUSIONS/RECOMMENDATIONS

The California Business and Professions Code (Sections 6735, 6835, and 7835.1) requires that work plans and technical or implementation reports containing geologic or engineering evaluations and/or judgments be performed under the direction of an appropriately registered or certified professional. For your submittal to be considered a valid technical report, you are to present site specific data, data interpretations, and recommendations prepared by an appropriately licensed professional and include the professional registration stamp, signature, and statement of professional certification. Please ensure all that all technical reports submitted for this fuel leak case meet this requirement.

UNDERGROUND STORAGE TANK CLEANUP FUND

Please note that delays in investigation, later reports, or enforcement actions may result in your becoming ineligible to receive grant money from the state's Underground Storage Tank Cleanup Fund (Senate Bill 2004) to reimburse you for the cost of cleanup.

Denis Brown
August 22, 2005
Page 3

AGENCY OVERSIGHT

If it appears as though significant delays are occurring or reports are not submitted as requested, we will consider referring your case to the Regional Board or other appropriate agency, including the County District Attorney, for possible enforcement actions. California Health and Safety Code, Section 25299.76 authorizes enforcement including administrative action or monetary penalties of up to \$10,000 per day for each day of violation.

If you have any questions, please call me at (510) 567-6791.

Sincerely,

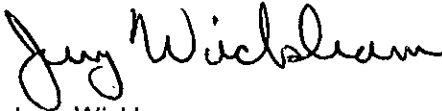

Jerry Wickham
Hazardous Materials Specialist

Enclosure: ACEH Electronic Report Upload (ftp) Instructions

cc: Ana Friel
Cambria Environmental Technology, Inc.
270 Perkins Street
Sonoma, CA 95406

Donna Drogos, ACEH
Jerry Wickham, ACEH
File

ALAMEDA COUNTY
HEALTH CARE SERVICES

AGENCY
DAVID J. KEARS, Agency Director



7

ENVIRONMENTAL HEALTH SERVICES
ENVIRONMENTAL PROTECTION
1131 Harbor Bay Parkway, Suite 250
Alameda, CA 94502-6577
(510) 567-6700
FAX (510) 337-9335

June 15, 2005

Mr. Denis Brown
Shell Oil Products US
20945 S. Wilmington Ave.
Carson, CA 90810-1039

Harman Management Corporation
199 1st Street, Suite 212
Los Altos, CA 94022

Subject: Fuel Leak Case No. RO0000009, Shell, 2800 Telegraph Ave., Oakland, CA – Comments on Groundwater Monitoring and Site Investigation Report

Dear Mr. Brown:

Alameda County Environmental Health (ACEH) staff has reviewed the case file and the document entitled, "Groundwater Monitoring Report – Second and Third Quarter 2004 and Site Investigation Report," dated November 30, 2004 and the document entitled, "Groundwater Monitoring Report – First Quarter 2005," dated May 31, 2005. Both documents were prepared on behalf of Shell by Cambria Environmental Technology, Inc. Based on the consistent hydraulic gradient at the site and low concentrations of chemicals detected in specific wells, the Site Investigation Report dated November 30, 2004 recommends that five wells be properly destroyed and that well S-3 be repaired or replaced.

Based on staff review of the two documents referenced above, please address the following technical comments, perform the proposed work, and send us the reports described below.

TECHNICAL COMMENTS

1. **Destruction of Five Wells.** ACEH concurs with the recommendation to destroy wells S-1, S-4, S-5, S-10, and SR-1. Groundwater monitoring has been ongoing in these wells since 1992. Continued groundwater monitoring of these wells will not provide significant additional information on hydraulic gradient or contaminant distribution. Please describe the method to be used for well destruction in the Work Plan requested below.
2. **Well S-3.** Well S-3 has been covered and inaccessible since 1992. High concentrations of fuel hydrocarbons were detected in groundwater grab samples collected on May 21, 2004 within the southwest corner of the site. The Site Investigation Report dated November 30, 2004 recommends that well S-3 be repaired or the well be destroyed and replaced. ACEH requests that well S-3 be located and properly destroyed. Well S-3 extends more than 27 feet below ground surface and may not obtain groundwater samples that are representative of shallow groundwater. A monitoring well to replace well S-3 is to be installed within the immediate area of former well S-3. The monitoring well to replace well S-3 should be designed to have a screened interval that intersects the water table. The filter pack for the

well should be less than 10 feet in length. Please submit a Work Plan that describes the methods and proposed specifications for installation of a well to replace well S-3.

3. **Groundwater Monitoring.** ACEH concurs with the recommendation to implement semi-annual monitoring (during first and third quarters) for existing wells S-6 and S-8. Therefore, groundwater sampling during the second quarter 2005 is not required. Please provide a schedule for sampling of the well to replace S-3 in the Work Plan requested below.

TECHNICAL REPORT REQUEST

Please submit technical reports to Alameda County Environmental Health (Attention: Mr. Jerry Wickham), according to the following schedule:

- **August 15, 2005** - Work Plan to Destroy Wells and Install Monitoring Well
- **November 15, 2005** - Quarterly Report for the Third Quarter 2005

These reports are being requested pursuant to California Health and Safety Code Section 25296.10. 23 CCR Sections 2652 through 2654, and 2721 through 2728 outline the responsibilities of a responsible party in response to an unauthorized release from a petroleum UST system, and require your compliance with this request.

PERJURY STATEMENT

All work plans, technical reports, or technical documents submitted to ACEH must be accompanied by a cover letter from the responsible party that states, at a minimum, the following: "I declare, under penalty of perjury, that the information and/or recommendations contained in the attached document or report is true and correct to the best of my knowledge." This letter must be signed by an officer or legally authorized representative of your company. Please include a cover letter satisfying these requirements with all future reports and technical documents submitted for this fuel leak case.

PROFESSIONAL CERTIFICATION & CONCLUSIONS/RECOMMENDATIONS

The California Business and Professions Code (Sections 6735, 6835, and 7835.1) requires that work plans and technical or implementation reports containing geologic or engineering evaluations and/or judgments be performed under the direction of an appropriately registered or certified professional. For your submittal to be considered a valid technical report, you are to present site specific data, data interpretations, and recommendations prepared by an appropriately licensed professional and include the professional registration stamp, signature, and statement of professional certification. Please ensure all that all technical reports submitted for this fuel leak case meet this requirement.

UNDERGROUND STORAGE TANK CLEANUP FUND

Please note that delays in investigation, later reports, or enforcement actions may result in your becoming ineligible to receive grant money from the state's Underground Storage Tank Cleanup Fund (Senate Bill 2004) to reimburse you for the cost of cleanup.

Mr. Denis Brown
June 15, 2005
Page 3

AGENCY OVERSIGHT

If it appears as though significant delays are occurring or reports are not submitted as requested, we will consider referring your case to the Regional Board or other appropriate agency, including the County District Attorney, for possible enforcement actions. California Health and Safety Code, Section 25299.76 authorizes enforcement including administrative action or monetary penalties of up to \$10,000 per day for each day of violation.

If you have any questions, please call me at (510) 567-6791.

Sincerely,

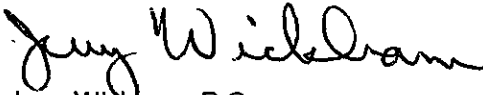

Jerry Wickham, P.G.
Hazardous Materials Specialist

cc: Ana Friel
Cambria Environmental Technology, Inc.
270 Perkins Street
Sonoma, CA 95406

Donna Drogos, ACEH
Jerry Wickham, ACEH
File

C A M B R I A



To: Don Hwang
Company: ACHCSD
Fax: 510-337-9335
Phone: 510-567-6746

From: Ana Friel
Phone: 707-442-2700
Pages: 2 (including cover page)
Date: April 19, 2004
Re: 2800 Telegraph Ave, Oakland

Fax

Hard Copy to Follow? Yes No

Don,

As we discussed last week, attached is a revised proposed boring location map for the borings to be installed in the vicinity of the former Shell service station at 2800 Telegraph Avenue in Oakland. As requested by your agency, two additional borings are proposed within 28th Street (HB-9 and HB-10).

HB-9 is positioned to assess migration from the site via the utilities within 28th Street, and HB-10 is positioned further west in 28th Street to assess similar conditions *upgradient* of the former USTs and dispensers.

Cambria is permitting the activities and will provide your office with 1 week's notice prior to initiating the field work.

Regards,

Ana Friel

This fax transmittal is intended solely for use by the person or entity identified above. Any copying or distribution of this document by anyone other than the intended recipient is strictly prohibited. If you are not the intended recipient, please telephone us immediately and return the original transmittal to us at the address listed below.

Cambria Environmental Technology, Inc., 270 Perkins St., Sonoma, CA 95478
Tel (707) 935-4850 Fax (707) 935-6648

16-Apr-04

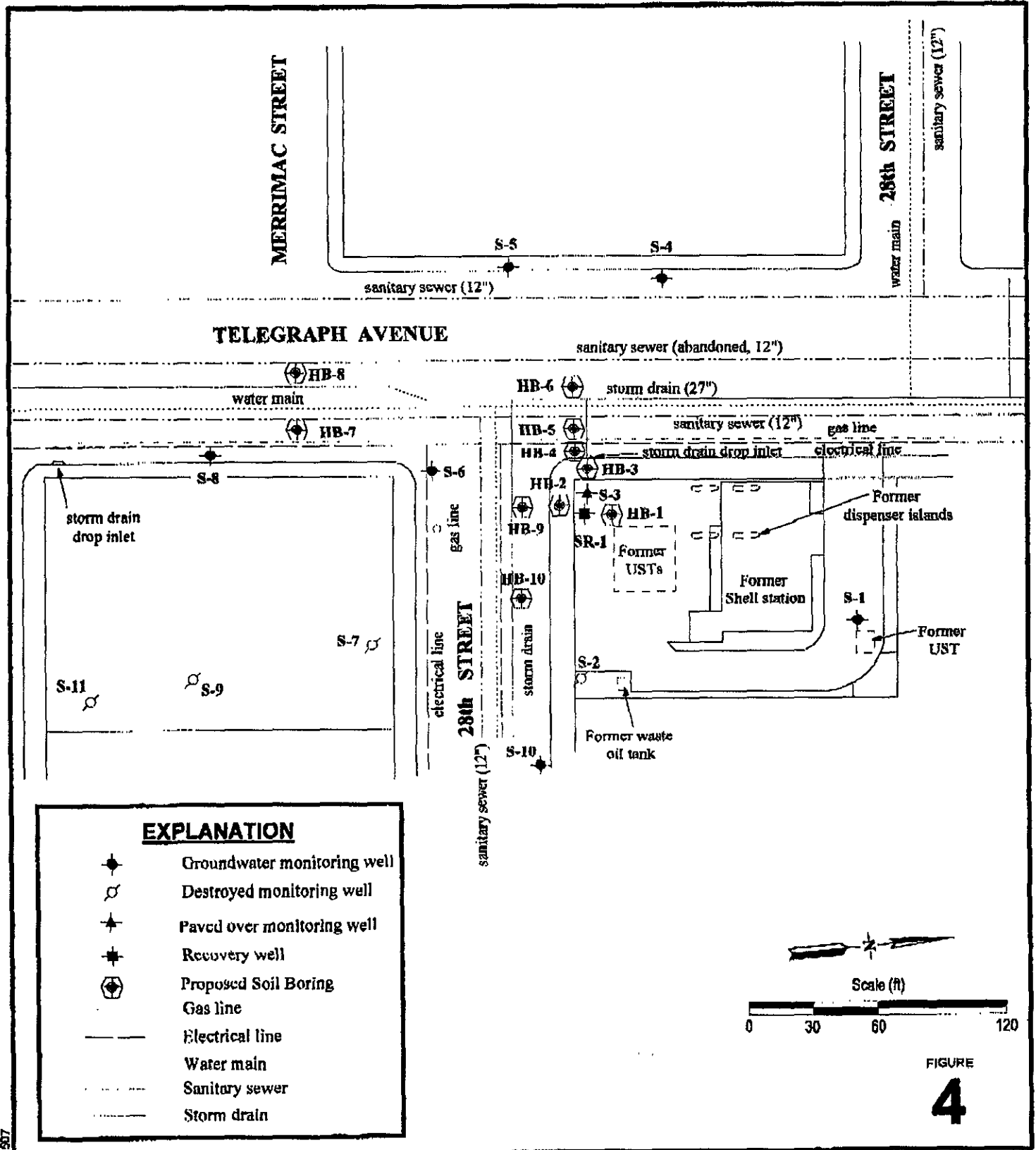

**Former Shell Service Station/
Current KFC Restaurant**
2800 Telegraph Avenue
Oakland, California



CAMBRIA

**Utilities and Proposed
Boring Locations**

(Revised April 2004)

C A M B R I A

Alameda County March 17, 2004

MAR 18 2004

Environmental Health

Don Hwang
Hazardous Materials Specialist
Alameda County Health Care Services Agency
1131 Harbor Bay Parkway, Suite 250
Alameda, California 94502-6577

Re: **Notice of Intent to Implement Work Plan**
Former Shell Service Station/Current KFC Restaurant
2800 Telegraph Avenue
Oakland, California
Incident No. 97093398
Fuel Leak Case No. RO0000009



Dear Mr. Hwang:

Cambria Environmental Technology, Inc. (Cambria) prepared this letter on behalf of Equilon Enterprises LLC dba Shell Oil Products US (Shell) to notify the Alameda County Health Care Services (ACHCS) of our intent to implement the scope of work presented in the *Agency Response and Utility Conduit Investigation Work Plan* dated November 7, 2003.

Since more than 60 days have passed without any comment from the ACHCS, we assume concurrence with the proposed activities, and hereby provide notification of our intent to implement these activities the week of April 19, 2004. The performance of the work will be contingent upon right of entry agreements and authorization from the utility purveyors, and may be delayed from the above-referenced date.

Please call Ana Friel at (707) 442-2700 if you have any questions or comments.

Sincerely,

Cambria Environmental Technology, Inc.

Ana Friel, RG
Senior Project Geologist

Cambria
Environmental
Technology, Inc.

270 Perkins Street
P.O. Box 259
Sonoma, CA 95476
Tel (707) 935-4850
Fax (707) 935-6649

cc: Karen Petryna, Shell
Harmon Management Corp.

Hwang, Don, Env. Health

From: Hwang, Don, Env. Health
Sent: Friday, October 24, 2003 3:23 PM
To: 'Ana Friel'
Subject: RE: 2800 Telegraph, Oakland, Request for 1 week extension

Ana, There is no problem with this request. Don

-----Original Message-----

From: Ana Friel [mailto:afriel@Cambria-env.com]
Sent: Friday, October 24, 2003 1:49 PM
To: dhwang@co.alameda.ca.us
Cc: kepetryna@shellopus.com
Subject: 2800 Telegraph, Oakland, Request for 1 week extension

November 24, 2003

Request for 1 week extension - 2800 Telegraph Ave, Oakland/File No. RO0000009

Don,

I am writing to request a short extension for the submittal of the 3Q03 QMR and Submittal of additional requested items, as requested in the ACHCS letter dated September 3, 2003. We did not receive the 3Q03 data until yesterday, and I am still preparing cross section/graphs, etc, and still need to forward the draft to Shell for their review.

Currently, the QMR is due 10/31/03 and the other items are due 11/3/03. I would like a 1-week extension, and will submit both documents by **November 7, 2003**.

If there is no problem with this request, please confirm approval of the extension by return email.

Regards,

Ana Friel
Cambria Environmental
707-442-2700

ALAMEDA COUNTY
HEALTH CARE SERVICES

AGENCY

DAVID J. KEARS, Agency Director



ENVIRONMENTAL HEALTH SERVICES
ENVIRONMENTAL PROTECTION
1131 Harbor Bay Parkway, Suite 250
Alameda, CA 94502-6577
(510) 567-6700
FAX (510) 337-9335

September 3, 2003

Karen Petryna
Equiva Services LLC
PO Box 7869
Burbank, CA 91501-7869

Dear Ms. Petryna:

Subject: Fuel Leak Case No. RO0000009, Shell Service Station, 2800 Telegraph Ave.,
Oakland, CA

Alameda County Environmental Health (ACEH) staff has reviewed "Closure Request Follow-up" dated October 31, 2002, and "1st Quarter 2001 Monitoring Report, Sensitive Receptor Survey and Closure Request" dated June 4, 2001, both prepared by Cambria Environmental Technology. We deny the request for closure. We request that you address the following technical comments and send us the technical reports requested below.

TECHNICAL COMMENTS

- 1) The dissolved petroleum hydrocarbon concentrations are unstable and markedly increased during the last sampling event compared to the prior sampling event for monitoring well S-8. S-8 last sampled on March 9, 2001, detected 4,110 micrograms/liter (ug/l) Total Purgeable Petroleum Hydrocarbons, 80.1 ug/l Benzene, and 70.4 ug/l Methyl Tertiary-Butyl Ether (MTBE). Please reinstitute quarterly groundwater monitoring.
- 2) Groundwater Analyses – In addition to the analyses used before, we request that you include the other fuel oxygenates Tertiary Amyl Methyl Ether (TAME), Ethyl Tertiary Butyl Ether (ETBE), Di-Isopropyl Ether (DIPE), and Tertiary Butyl Alcohol (TBA), Ethanol by EPA Method 8260 and the lead scavengers, Ethylene Dibromide (EDB), Ethylene Dichloride (EDC) for analyses of grab and monitoring well groundwater samples, and for the lead scavengers, EDB and EDC, also perform analyses on soil samples. If any of the latter compounds are detected, and are determined to be of concern (poses a risk to human health, the environment, or water resources) it is to be incorporated into your regular monitoring plan.
- 3) The utility conduits were of sufficient depth to intercept the dissolved plume. Provide a proposal to determine if and to what extent the utility conduits may have diverted the plume. In order for us to evaluate your proposal, please provide geologic cross-sections showing soil and groundwater analytical results, utility conduits, well screens, etc.
- 4) Missing boring logs S4 – S7, and the well construction diagrams. Please submit.

Ms. Petryna
September 3, 2003
Page 2 of 2

- 5) The Well Concentrations Tables prior to May 4, 1992 did not include groundwater depths. Please include.
- 6) Historical hydraulic gradients were not compiled. Please provide rose diagrams, which include cumulative groundwater gradients in all future reports submitted for this site.

TECHNICAL REPORT REQUEST

Please submit technical reports to Alameda County Environmental Health (Attention: Don Hwang), according to the following schedule:

October 31, 2003 - "3rd Quarter 2003 Monitoring Report"
November 2, 2003 - Geologic cross-sections of utility conduits for evaluation proposal
November 2, 2003 - Boring logs S4 - S7, and the well construction diagrams
November 2, 2003 - Revised Well Concentrations Tables with groundwater depths
January 31, 2004 - "4th Quarter 2003 Monitoring Report"
April 30, 2004 - 1st Quarter 2003 Groundwater Monitoring Report
July 31, 2004 - 2nd Quarter 2003 Groundwater Monitoring Report

These reports are being requested pursuant to the Regional Water Quality Control Board's (Regional Board) authority under Section 13267 of the California Water Code. If you have any questions, please call me at (510) 567-6746.

Sincerely,

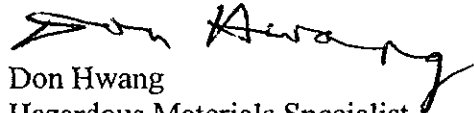

Don Hwang
Hazardous Materials Specialist
Local Oversight Program

C: Melody Munz, Cambria Environmental Technology, Inc., 1144-65th St., Suite B,
Oakland, CA 94608
Donna Drogos
✓File

C A M B R I A



Fax

To: Susan Hugo

Company: ACDEHS

Fax: 510-337-9335

Phone: 510-567-6780

From: Ian Young

Phone: 510-420-3305 ; Fax 510 420-9170

Pages: 3

Date: 2/13/01

Re: DWR Driller's Reports Request Authorization

Susan,

Enclosed, please find the Request Authorizations for the following sites:

- 1) 2800 Telegraph Rd., Oakland CA 94609
- 2) 3420 San Pablo Ave., Oakland CA

Please fax the forms back to me when you have completed them.
I appreciate your assistance, and thank you for your help with these projects.

Sincerely,

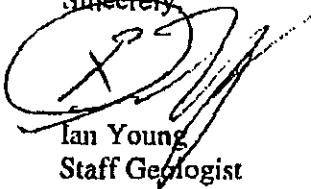

Ian Young
Staff Geologist

2/13/01 Referred to Chuck Headlee



State of California
Department of Water Resources
Central District
3251 S Street
Sacramento, CA 95816-7017

**WELL DRILLER'S REPORTS
INSPECTION REQUEST AND AGREEMENT**

Project: FORMER SHELL SERVICE STATION

Location: 2800 TELEGRAPH AVE.

County: ALAMEDA Contract Number: _____

Request is made pursuant to Section 13751 of the California Water Code for permission to inspect or copy Water Well Driller's Reports which are on file in your office.

In accordance with the requirements of Section 13752 of the Water Code, it is stipulated and agreed that such reports, or any copy or copies made thereof, will not be made available for inspection by the public but will be used solely by this governmental agency for making studies. If copies are made or taken, each copy will be stamped "CONFIDENTIAL" or "FOR OFFICIAL USE ONLY" and will be kept in a restricted file, access to which is limited to the staff of this governmental agency or to its contracted agents. Any copies furnished to contracted agents must be returned to the Department of Water Resources, Central District upon completion of work by the contracted agent.

No information contained in these reports can be disseminated or published without the written permission of the owner of the well.

<u>ANNI KREML - CAMBRIA</u> Contracted Agent	<u>ALAMEDA CO. HEALTH CARE SERVICES AGENCY</u> Governmental Agency
<u>1144 65TH ST. SUITE B</u> Address	<u>1131 HARBOR BAY PKWY., 2ND FL.</u> Address
<u>OAKLAND, CA 94608</u> City, State, & Zip Code	<u>ALAMEDA, CA 94502</u> City, State, & Zip Code
By <u>[Signature]</u> Officer	By _____ Officer
<u>SENIOR STAFF SCIENTIST</u> Title	_____ Title
<u>(510) 420-3335</u> Telephone	<u>()</u> Telephone
<u>02/09/01</u> Date	_____ Date

(For Departmental Information: _____ copies sent _____)

C A M B R I A

ENVIRONMENTAL
PROTECTION
00 JUL -7 PM 3:55

July 5, 2000

Susan Hugo
Alameda County Health Care Services Agency
1131 Harbor Bay Parkway, Suite 250
Alameda, California 94502-6577

R009

Re: Certified List of Record Fee Title Holders for:
Former Shell Service Station
2800 Telegraph Avenue
Oakland, California
Incident #97093398



Dear Ms. Hugo:

This correspondence identifies the current landowner of the referenced property and is being made on behalf of Equiva Services LLC in compliance with section 25297.15(a) of Chapter 6.7 of the Health Safety Code. Landowner information for the referenced property was researched by using one or more of the following methods:

1. Directly contacting the county assessor's office.
2. Reviewing a private vendor database of assessor information, and/or
3. Reviewing Equiva's or Cambria's files.

To the best of my knowledge, the following is a complete list of current fee title owners and their mailing addresses for the referenced property.

Harmon Management Corp., 199 First Street #212, Los Altos, CA 94022-2767

Sincerely,

Stephan A. Bork, C.E.G., C.HG.
Associate Hydrogeologist

Oakland, CA
San Ramon, CA
Sonoma, CA
Portland, OR

cc: Karen Petryna, Equiva Services LLC, P.O. Box 7869, Burbank, California 91510-7869
Harmon Management Corp., 199 First Street #212, Los Altos, CA 94022-2767

**Cambria
Environmental
Technology, Inc.**

1144 65th Street
Suite B
Oakland, CA 94608
Tel (510) 420-0700
Fax (510) 420-9170

ALAMEDA COUNTY
HEALTH CARE SERVICES

AGENCY
DAVID J. KEARS, Agency Director



ENVIRONMENTAL HEALTH SERVICES
1131 Harbor Bay Parkway, Suite 250
Alameda, CA 94502-6577
(510) 567-6700
(510) 337-9335 (FAX)

November 5, 1999

Ms. Karen Petryna
Equiva Services, LLC
P.O. Box 6249
Carson, CA 90749-6249

*Root 9
Open LOP*

**RE: Former Shell Service Station (STID # 413)
2800 Telegraph Avenue, Oakland, California 94609**

LANDOWNER NOTIFICATION AND PARTICIPATION REQUIREMENTS

Dear Ms. Petryna:

This letter is to inform you of new legislative requirements pertaining to cleanup and closure of sites where an unauthorized release of hazardous substance, including petroleum, has occurred from an underground storage tank (UST). Section 25297.15(a) of Ch. 6.7 of the Health & Safety Code requires the primary or active responsible party to notify all current record owners of fee title to the site of: 1) a site cleanup proposal, 2) a site closure proposal, 3) a local agency intention to make a determination that no further action is required, and 4) a local agency intention to issue a closure letter. Section 25297.15(b) requires the local agency to take all reasonable steps to accommodate responsible landowners' participation in the cleanup or site closure process and to consider their input and recommendations.

For purposes of implementing these sections, you have been identified as the primary or active responsible party. Please provide to this agency, within twenty (20) calendar days of receipt of this notice, a complete mailing list of all current record owners of fee title to the site. You may use the enclosed "list of landowners" form (sample letter 2) as a template to comply with this requirement. If the list of current record owners of fee title to the site changes, you must notify the local agency of the change within 20 calendar days from when you are notified of the change.

If you are the sole landowner, please indicate that on the landowner list form. The following notice requirements do not apply to responsible parties who are the sole landowner for the site.

LANDOWNER NOTIFICATION

Re: 2800 Telegraph Avenue, Oakland, CA

November 5, 1999

Page 2 of 2

In accordance with Section 25297.15(a) of Ch. 6.7 of the Health & Safety Code, you must certify to the local agency that all current record owners of fee title to the site have been informed of the proposed action before the local agency may do any of the following:

- 1) consider a cleanup proposal (corrective action plan)
- 2) consider a site closure proposal
- 3) make a determination that no further action is required
- 4) issue a closure letter

You may use the enclosed "notice of proposed action" form (sample letter 3) as a template to comply with this requirement. Before approving a cleanup proposal or site closure proposal, determining that no further action is required, or issuing a closure letter, the local agency will take all reasonable steps necessary to accommodate responsible landowner participation in the cleanup and site closure process and will consider all input and recommendations from any responsible landowner.

Please call me at (510) 567-6780 should you have any questions about the content of this letter.

Sincerely,

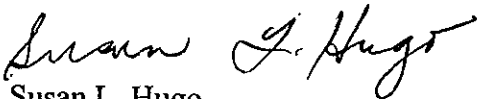

Susan L. Hugo
Hazardous Materials Specialist

Attachments

cc: Chuck Headlee, RWQCB
SH / files

SAMPLE LETTER (2): LIST OF LANDOWNERS FORM

Name of local agency
Street address
City

SUBJECT: CERTIFIED LIST OF RECORD FEE TITLE OWNERS FOR (*Site Name and Address*)

(Note: Fill out item 1 if there are multiple site landowners. If you are the sole site landowner, skip item 1 and fill out item 2.)

1. In accordance with section 25297.15(a) of Chapter 6.7 of the Health & Safety Code, I, (*name of primary responsible party*), certify that the following is a complete list of current record fee title owners and their mailing addresses for the above site:

2. In accordance with section 25297.15(a) of Chapter 6.7 of the Health & Safety Code, I, (*name of primary responsible party*), certify that I am the sole landowner for the above site.

Sincerely,

Signature of primary responsible party

Name of primary responsible party

SAMPLE LETTER 3: NOTICE OF PROPOSED ACTION SUBMITTED TO LOCAL AGENCY

Name of local agency
Street address
City

SUBJECT: NOTICE OF PROPOSED ACTION SUBMITTED TO LOCAL AGENCY FOR
(Site Name and Address)

In accordance with section 25297,15(a) of Chapter 6.7 of the Health & Safety Code, I, (*name of primary responsible party*), certify that I have notified all responsible landowners of the enclosed proposed action. Check space for applicable proposed action(s):

cleanup proposal (corrective action plan)

site closure proposal

local agency intention to make a determination that no further action is required

local agency intention to issue a closure letter

Sincerely,

Signature of primary responsible party

Name of primary responsible party

cc: Names and addresses of all record fee title owners

ALAMEDA COUNTY
HEALTH CARE SERVICES

AGENCY
DAVID J. KEARS, Agency Director



RAFAT A. SHAHID, DIRECTOR

April 18, 1996

Mr. R Jeff Granberry
Shell Oil Products Company
P.O. Box 4023
Concord, California 94524

DEPARTMENT OF ENVIRONMENTAL HEALTH
1131 Harbor Bay Parkway
Alameda, CA 94502-6577
(510) 567-6777

RE: Shell Oil Company Sites

Dear Mr. Granberry:

Recently, reports for the Shell Oil Company sites have been submitted to different inspectors / case officers that are not the assigned case workers. I'm currently overseeing the investigation / cleanup of the following Shell Oil Company sites in this department:

<u>STID#</u>	<u>Site Name</u>	<u>Address</u>
3670	Melina Albany Shell	999 San Pablo Avenue, Albany
814	Bay Super Shell	1800 Powell Street, Emeryville
381	Shell Oil Company	3420 San Pablo Ave., Oakland
3613	Former Shell Oil	500 40th Street, Oakland
413	Pill Hill Shell	2800 Telegraph Ave., Oakland RO 09
3673	Shell Service Station	230 W MacArthur Blvd., Oakland RO 09
3618	Broadway Shell	5755 Broadway, Oakland

Please inform your consultants that all quarterly monitoring reports and work plans for the above mentioned sites should be submitted to my attention.

If you have any questions concerning this letter, please call me at (510) 567-6780.

Sincerely,

Susan L. Hugo
Senior Hazardous Materials Specialist

c: Jun Makishima, Interim Director, Environmental Health
Gordon Coleman, Acting Chief, Environmental Protection / files

LOP CHANGE RECORD REQUEST FORM

printed:
10/31/95

Mark Out What Needs Changing and Hand to LOP Data Entry
(Name/Address changes go to Annual Programs Data Entry)

Insp:

AGENCY # : 10000 SOURCE OF FUNDS: F SUBSTANCE: 8006619
 StID : 413 LOC: -0-
 SITE NAME: Pill Hill Shell DATE REPORTED : 12/07/88
 ADDRESS : 2800 Telegraph Ave DATE CONFIRMED: 12/07/88
 CITY/ZIP : Oakland 94609 MULTIPLE RPs : Y

SITE STATUS

 CASE TYPE: G CONTRACT STATUS: 4 PRIOR CODE:2B4 EMERGENCY RESP: -0-
 RP SEARCH: S DATE COMPLETED: 03/31/92
 PRELIMINARY ASMNT: U DATE UNDERWAY: 04/22/88 DATE COMPLETED: -0-
 REM INVESTIGATION: - DATE UNDERWAY: -0- DATE COMPLETED: -0-
 REMEDIAL ACTION: - DATE UNDERWAY: -0- DATE COMPLETED: -0-
 POST REMED ACT MON:- DATE UNDERWAY: -0- DATE COMPLETED: -0-

ENFORCEMENT ACTION TYPE: 1 DATE ENFORCEMENT ACTION TAKEN: 03/31/92
 LUFT FIELD MANUAL CONSID: 3HSCAWG
 CASE CLOSED: - DATE CASE CLOSED: -0-
 DATE EXCAVATION STARTED : 12/07/88 REMEDIAL ACTIONS TAKEN: ED

RESPONSIBLE PARTY INFORMATION

 RP#1-CONTACT NAME: Kurt Miller
 COMPANY NAME: Shell Oil Company Corp.
 ADDRESS: Po Box 4023
 CITY/STATE: Concord C A 94524

RP#2-CONTACT NAME: Harman Management
 COMPANY NAME: Company
 ADDRESS: 199-1st St. Suite 212
 CITY/STATE: Los Altos, California 94022

INSPECTOR VERIFICATION:

NAME _____ SIGNATURE _____ DATE _____

DATA ENTRY INPUT:

Name/Address Changes Only Case Progress Changes

ANPNPGMS _____ LOP _____ DATE _____ LOP _____ DATE _____

COM No.	REMOTE STATION	START TIME	DURATION	PAGES	RESULT	USER ID	REMARKS
507	916 2274349	10-31 16:41	00' 37	01/01	OK		

7499402046

LOP - CHANGE RECORD REQUEST FORM

Mark Out What Needs Changing and Hand to LOP Data Entry
 (Name/Address changes go to Annual Programs Data Entry)

printed:
 10/31/95

AGENCY # : 10000 SOURCE OF FUNDS: F Insp:
 StID : 413 LOC: -0- SUBSTANCE: 8006619
 SITE NAME: Pill Hill Shell
 ADDRESS : 2800 Telegraph Ave DATE REPORTED : 12/07/88
 CITY/ZIP : Oakland 94609 DATE CONFIRMED: 12/07/88
 MULTIPLE RPs : Y

SITE STATUS

CASE TYPE: G CONTRACT STATUS: 4 PRIOR CODE: 2B4 EMERGENCY RESP: -0-
 RP SEARCH: S DATE UNDERWAY: 04/22/88 DATE COMPLETED: 03/31/92
 PRELIMINARY ASMNT: U DATE UNDERWAY: -0- DATE COMPLETED: -0-
 REM INVESTIGATION: - DATE UNDERWAY: -0- DATE COMPLETED: -0-
 REMEDIAL ACTION: - DATE UNDERWAY: -0- DATE COMPLETED: -0-
 POST REMED ACT MON:- DATE UNDERWAY: -0- DATE COMPLETED: -0-
 ENFORCEMENT ACTION TYPE: 1 DATE ENFORCEMENT ACTION TAKEN: 03/31/92
 LUFT FIELD MANUAL CONSID: 3HSCAWG
 CASE CLOSED: - DATE CASE CLOSED: -0-
 DATE EXCAVATION STARTED : 12/07/88 REMEDIAL ACTIONS TAKEN: ED

RESPONSIBLE PARTY INFORMATION

RP#1-CONTACT NAME: Kurt Miller
 COMPANY NAME: Shell Oil Company Corp.
 ADDRESS: Po Box 4023
 CITY/STATE: Concord C A 94524

RP#2-CONTACT NAME: Harman Management
 COMPANY NAME: Company
 ADDRESS: 199-1st St. Suite 212
 CITY/STATE: Los Altos, California 94022

INSPECTOR VERIFICATION:

NAME _____ SIGNATURE _____ DATE _____

Name/Address Changes Only

DATA ENTRY INPUT:

ANNPGMS _____ LOP _____ DATE _____

Case Progress Changes

LOP _____ DATE _____

LOP - CHANGE RECORD REQUEST FORM

printed:
10/31/95

Mark Out What Needs Changing and Hand to LOP Data Entry
(Name/Address changes go to Annual Programs Data Entry)

Insp:

AGENCY # : 10000 SOURCE OF FUNDS: F SUBSTANCE: 8006619
 StID : 413 LOC:
 SITE NAME: Pill Hill Shell DATE REPORTED : 12/07/88
 ADDRESS : 2800 Telegraph Ave DATE CONFIRMED: 12/07/88
 CITY/ZIP : Oakland 94609 MULTIPLE RPs : Y

SITE STATUS

CASE TYPE: G CONTRACT STATUS: 4 PRIOR CODE: EMERGENCY RESP:
 RP SEARCH: S DATE COMPLETED: 03/31/92
 PRELIMINARY ASMNT: U DATE UNDERWAY: 04/22/88 DATE COMPLETED:
 REM INVESTIGATION: DATE UNDERWAY: DATE COMPLETED:
 REMEDIAL ACTION: DATE UNDERWAY: DATE COMPLETED:
 POST REMED ACT MON: DATE UNDERWAY: DATE COMPLETED:

ENFORCEMENT ACTION TYPE: 1 DATE ENFORCEMENT ACTION TAKEN: 03/31/92
 LUFT FIELD MANUAL CONSID: 3HSCAWG
 CASE CLOSED: DATE CASE CLOSED:
 DATE EXCAVATION STARTED : 12/07/88 REMEDIAL ACTIONS TAKEN: ED

RESPONSIBLE PARTY INFORMATION

RP#1-CONTACT NAME: Ray Newsome
 COMPANY NAME: Shell Oil Company Corp.
 ADDRESS: Po Box 4023
 CITY/STATE: Concord C A 94524

RP#2-CONTACT NAME: Braunstein, Baruch &
 COMPANY NAME: Gladys Trs
 ADDRESS: 3005 Garber Street
 CITY/STATE: Berkeley, Ca 94705

INSPECTOR VERIFICATION:

NAME _____	SIGNATURE _____	DATE _____
------------	-----------------	------------

DATA ENTRY INPUT:

Name/Address Changes Only	Case Progress Changes
---------------------------	-----------------------

ANNPMS _____	LOP _____	DATE _____		LOP _____	DATE _____
--------------	-----------	------------	--	-----------	------------

HARMAN MANAGEMENT CORP.
 199 1st St #212
 LOS ALTOS , CA 94022



GeoStrategies Inc.
 Environmental Consulting,
 Engineering and Geologic Services

Letter of Transmittal

Date: 12-1-92

From: Clyde Galantine
 To: Mr. Stan Roller
Shell Oil Company
P.O. Box 4023
Concord, CA 94520

Project No: 7610.05-21
 Subject: Soil Sampling & Excavation Report
Former Shell Service Station
2800 Telegraph Ave.
Oakland, CA

The following items are: Enclosed Sent Separately
 via _____

Date	Description	No. of Copies
11-30-92	Soil Sampling and Excavation Report	1

- These are transmitted:
- At you request
 - For your approval
 - For your review
 - Preliminary
 - For your action
 - For your files
 - For your information
 - _____

Comments: CC: Mr. Susan Hugo, Alameda Co. Health Agency
Mr. Rich Hiett, RWQCB
Mr. Larry Turner, Shell Oil Company
Mr. Paul Hayes, Shell Oil Company

2140 W. Winton Avenue, Hayward, CA 94545
 (510) 352-4800 - Fax (510) 783-1089

601 University Avenue, Sacramento, CA 95825
 (916) 568-7500 - Fax (916) 568-7504

Clyde Galantine
 (Signed)



GeoStrategies Inc.
2140 WEST WINTON AVENUE
HAYWARD, CALIFORNIA 94545

(510) 352-4800

FACSIMILE COVER SHEET

TO: Susan Hugo

COMPANY: Alameda County

FROM: Clyde Galantine

DATE: 8-10-92

RE: 2800 Telegraph Ave Oakland Shell

COMMENTS: All data here plus map - will probably
want to DVE/ excavate Tuesday 8-17
Thanks

3 pages including cover.

If there are any problems with this transmission, please call (510) 352-4800.

EXPLANATION

- ◆ Ground
- ⊕ Ground
- Soil b

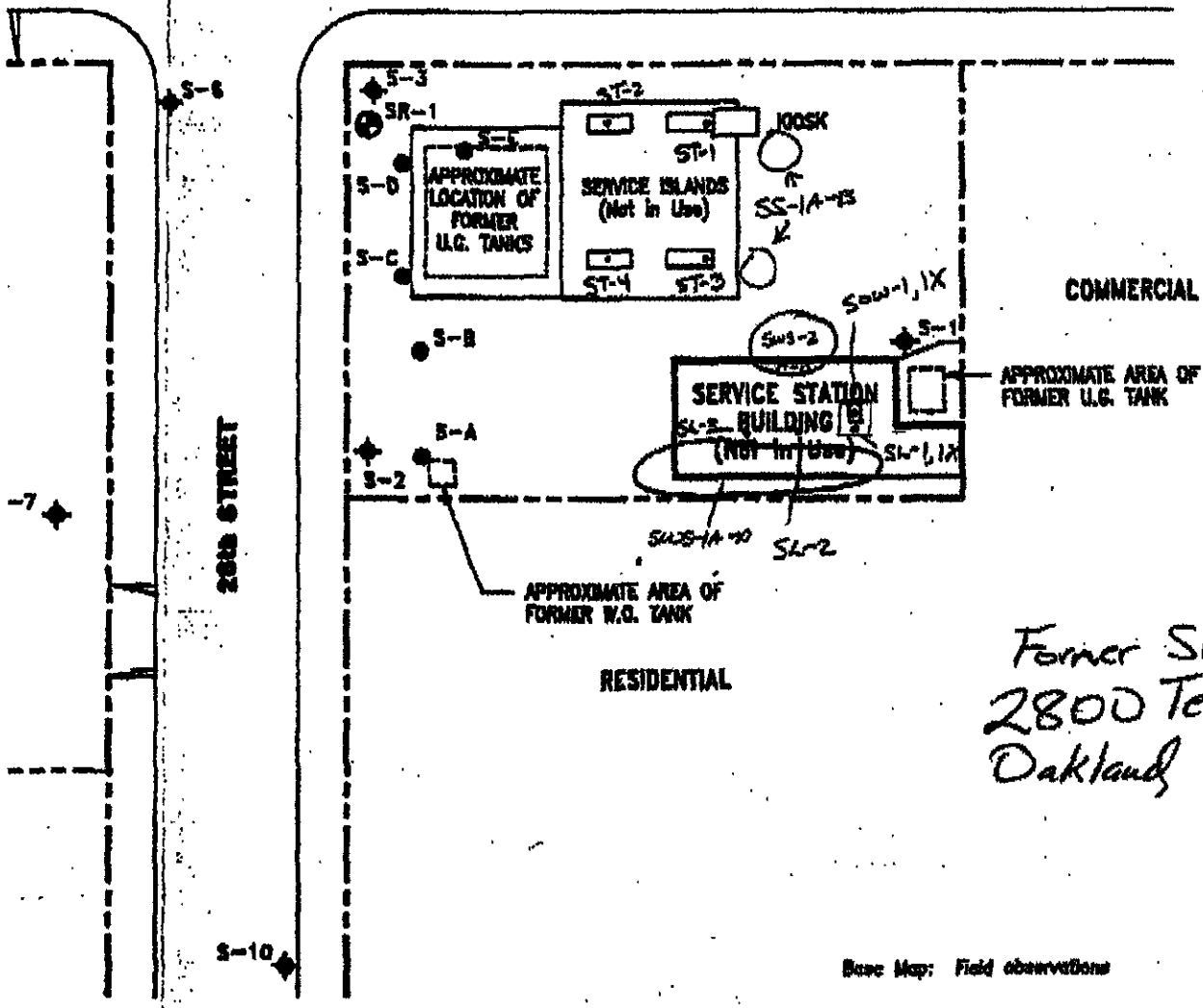
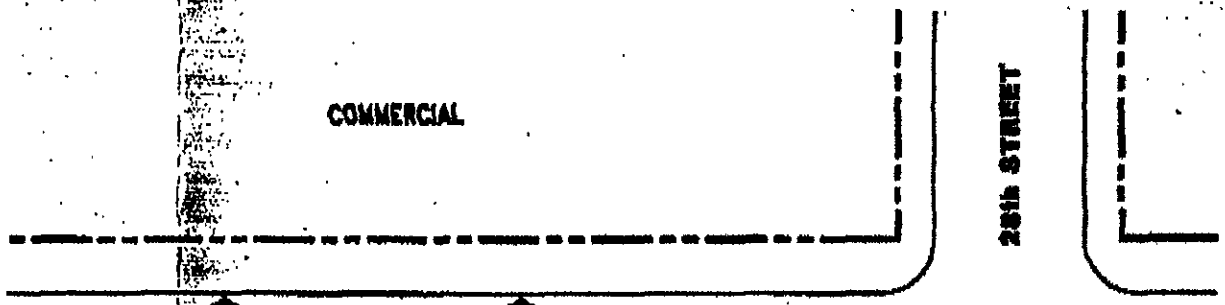

Former Shell
 2800 Telegraph Ave.
 Oakland, CA

Base Map: Field observations

table 1

Soil Analytical Data Excavations and Stockpiles

1610.05-

Sample #	Depth	Sample Date	Analysis Date	TPH (ppm)	Benzene (ppm)	Toluene (ppm)	Ethylbenzene (ppm)	Xylenes (ppm)	TPH-D (ppm)	TPH-O (ppm)	OTG (ppm)	Total Pb (ppm)	Org Pb (ppm)
ST-1	3'	6-18-92	6-22-92	<1.0	<0.0050	<0.0050	<0.0050	<0.0050				<50	
ST-2	3'	↓	↓	↓	↓	↓	↓	↓				13	
ST-3	3'	↓	↓	↓	↓	↓	↓	↓				62	
ST-4	3'	↓	↓	↓	↓	↓	↓	↓				7.7	
SOW-1	5 1/2'	6-18-92	6-22-92	<1.0	<0.0050	<0.0050	<0.0050	<0.0050	<1.0	<1.0	68	5.1	
SOW-1X	8 1/2'	7-9-92	7-14-92	6.4	<0.0050	<0.0050	<0.0050	<0.0050	1.2	—	59	<50	
SL-1	7 1/2'	6-18-92	6-25-92	—	—	—	—	—	40	580			
SL-1X	10'	7-9-92	7-14-92	—	—	—	—	—	27	340			
SL-2	8'	6-18-92	6-25-92	—	—	—	—	—	<1.0	<1.0			
SL-3	8'	6-18-92	6-25-92	—	—	—	—	—	<1.0	<1.0			
SS-1A-B		6-18-92	6-24-92	<1.0	<0.005	<0.005	<0.005	<0.005	—				<50
SWS-1A-D		6-18-92	6-26-92	<1.0	<0.005	<0.005	<0.005	0.006	11		260		"
SWS-2A-D		7-9-92	7-14-92							520			

SENT BY: GENT: er-Ryan Inc. : 8-10-92 : 15:02 : 51058947574# 3

LDP 413

28th STREET

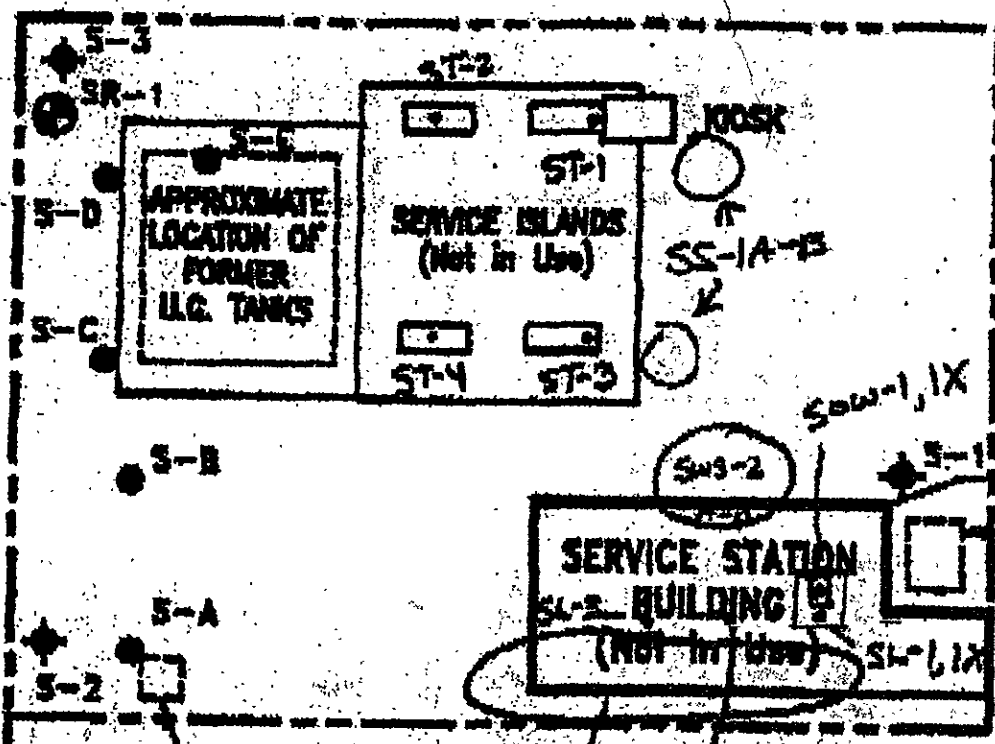

Former Sh
2800 Tel
Oakland, C

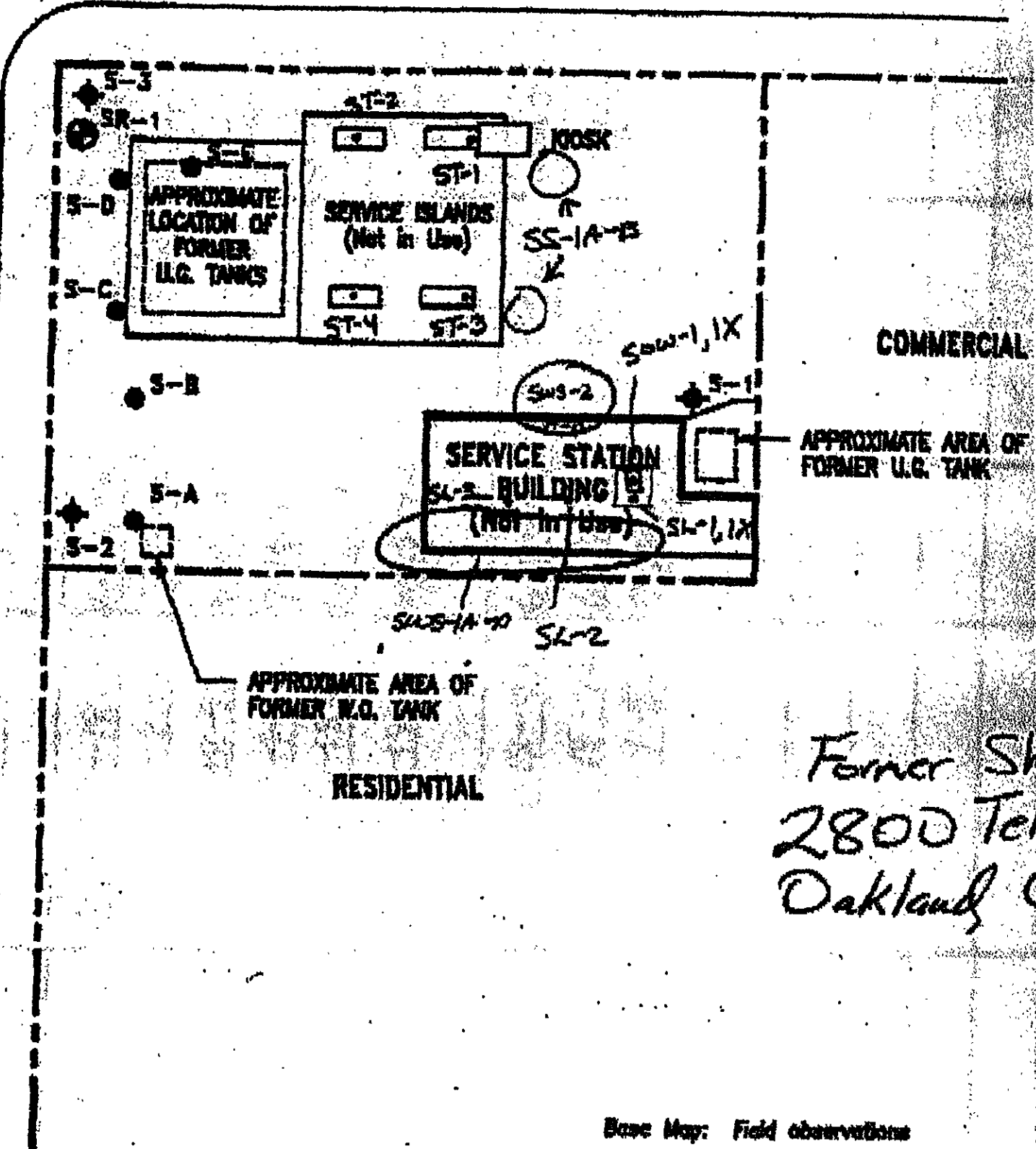

Former Sh
 2800 Tel
 Oakland, CA

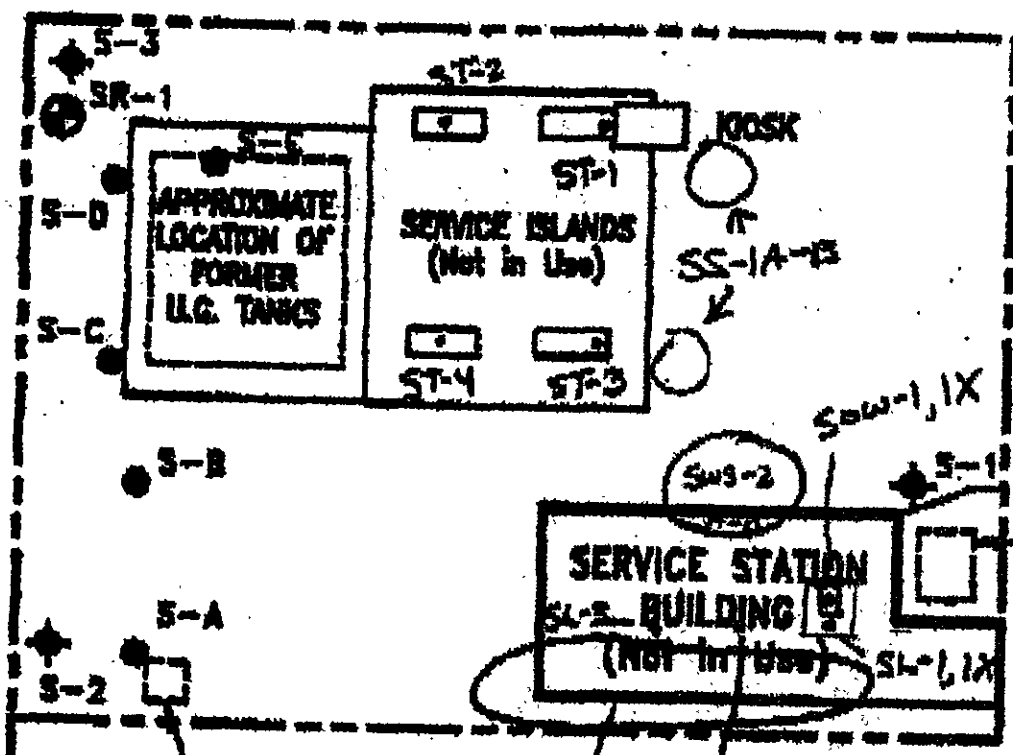

COMMERCIAL

APPROXIMATE AREA OF FORMER W.O. TANK

RESIDENTIAL

Former Sh
2800 Tel
Oakland, C



GeoStrategies Inc.

2140 WEST WINTON AVENUE
HAYWARD, CALIFORNIA 94545

(510) 352-4800

STD # 413

FACSIMILE COVER SHEET

TO: Susan Hugo Fax # 510-569-4757

COMPANY: ACHA

FROM: Clyde Galantine

DATE: 7-7-92

RE: Former Shell Station 2800 Telegraph Oakland

COMMENTS: Here is the map & data table -> the
area around SOW-1/SL-1 is to be overexcavated
& resampled. Thank Clyde

3 pages including cover.

If there are any problems with this transmission, please call (510) 352-4800.

7/9/92 Over excavating will take
 2 verification samples
 on the location of hydraulic lift #3
 of o/w separator

TELEGRAPH AVENUE

28th STREET

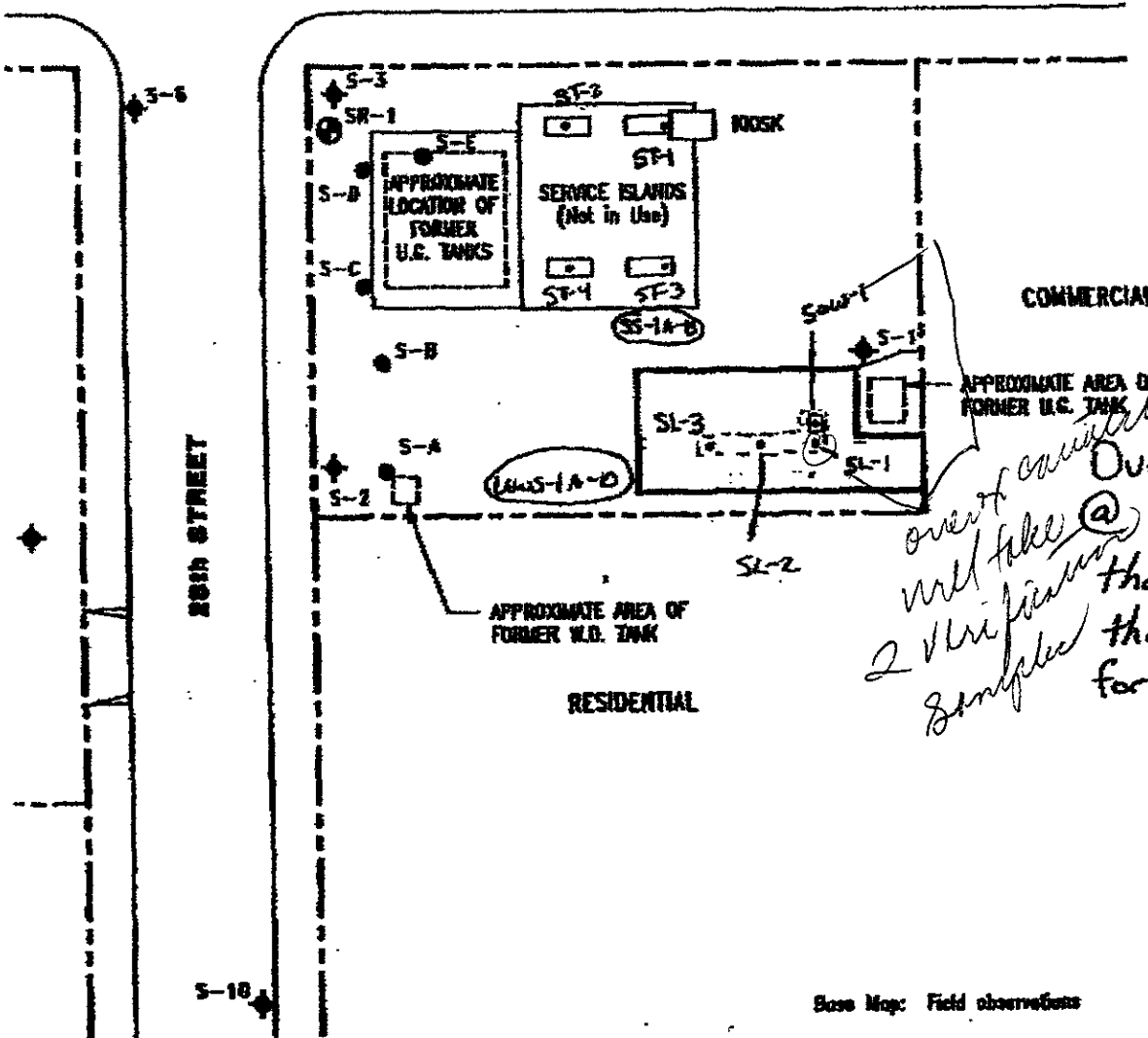

Base Map: Field observations

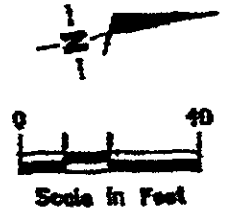

over excavated
will take
2 verification samples

Overexcavation will be initiated @ SOW-1/SL-1 area, I propose that 1 sample be collected from the overexcavation and analyzed for the waste oil suite.

SITE PLAN
 Former Shell Service Station
 2800 Telegraph Avenue
 Oakland, California

GeoStrategies Inc.



SENT BY: Gettler-Ryan Inc. ; 7-7-92 ; 10:05 ;
 DATE 1/9/21
 REVISION BY: M.S.
 NUMBER: 5105884757 ; # 2
 DRAWING NOT TO SCALE

Table 1

Soil Analytical Data Excavations and Stockpiles

1610.05-

Sample #	Depth	Sample Date	Analysis Date	TPH (ppm)	Benzene (ppm)	Toluene (ppm)	Ethylbenzene (ppm)	Xylenes (ppm)	TPH-D (ppm)	TPH-O (ppm)	Oil & Grease (ppm)	Total Pb (ppm)	Org Pb (ppm)
ST-1	3'	6-18-92	6-22-92	41.0	<0.0050	<0.0050	<0.0050	<0.0050				45.0	
ST-2	3'	↓	↓	↓	↓	↓	↓	↓				13	
ST-3	3'	↓	↓	↓	↓	↓	↓	↓				6.2	
ST-4	3'	↓	↓	↓	↓	↓	↓	↓				7.7	
SOW-1	5 1/2'	6-18-92	6-22-92	<1.0	<0.0050	<0.0050	<0.0050	<0.0050	<1.0	<1.0	68	5.1	
SL-1	7 1/2'	6-18-92	6-25-92	—	—	—	—	—	40	580			
SL-2	8'	6-18-92	6-25-92	—	—	—	—	—	<1.0	<1.0			
SL-3	8'	6-18-92	6-25-92	—	—	—	—	—	<1.0	<1.0			
SS-1A-B		6-18-92	6-24-92	<1.0	<0.005	<0.005	<0.005	<0.005	—	—			<0.0
SWS-1A-D		6-18-92	6-26-92	4.0	<0.005	<0.005	<0.005	0.006	11		260		"

SENT BY: Gettier-Ryan Inc.
 6-7-92 : 10:05 :
 51058847571# 3



6/18/92 2800 Telegraph Ave #4609
Hydraulic lift #2



6/18/92
2800 Telegraph Ave Oakland
#4609 Sampling under
near the dispenser

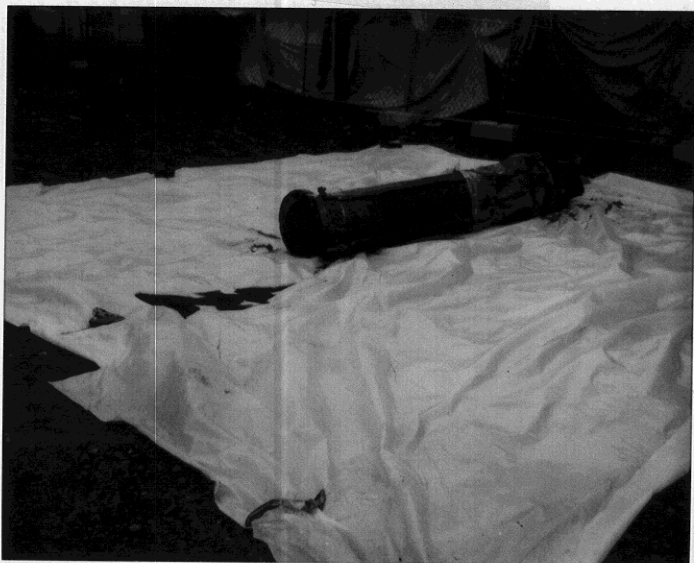

6/18/92
2800 Telegraph Ave Oakland #4609
#1 Hydraulic lift



SAN FRANCISCO OFFICE
2806 VAN NESS AVENUE
SAN FRANCISCO, CALIFORNIA 94109
(415) 441-1700

CARMEL OFFICE
P.O. BOX 3096
CARMEL, CALIFORNIA 93921
(408) 626-2653

LAW OFFICES OF
JACK B. RIPSTEEN

THE CLOCK BUILDING
P.O. BOX 5538
3160 COLLEGE AVENUE · SUITE 208
BERKELEY, CALIFORNIA 94705
TELEPHONE (415) 652-1230

FAX NO. (415) 652-1171

92 MAR 23 11:38
PLEASE REPLY TO: Berkeley

March 25, 1992

Mr. Edgar B. Howell, III
Chief Contract Project Director
Alameda County Health Care Services Agency
Department of Environmental Health
Hazardous Materials Division
80 Swan Way
Room 200
Oakland, California 94621

RE: STID # 413

Dear Mr. Howell:

Per my discussion with Jennifer Eberle, of your department, this day, this will confirm my representation that Baruch and Gladys Braunstein are not and have never been the owners of 2800 Telegraph Avenue, Oakland, California.

The confusion is that the Braunsteins do in fact own 2800 Telegraph Avenue, but it is the 2800 in Berkeley, which to my knowledge has always been a storefront and not a gasoline service station site.

Would you therefore correct your records and send me confirmation of the same.

Very truly yours,

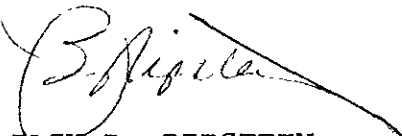

JACK B. RIPSTEEN
JBR:ddl
Enclosure

File 4/28/83
Am

UNDERGROUND STORAGE TANK UNAUTHORIZED RELEASE (LEAK) / CONTAMINATION SITE REPORT

EMERGENCY <input type="checkbox"/> YES <input checked="" type="checkbox"/> NO		HAS STATE OFFICE OF EMERGENCY SERVICES REPORT BEEN FILED? <input type="checkbox"/> YES <input type="checkbox"/> NO		FOR LOCAL AGENCY USE ONLY I HEREBY CERTIFY THAT I AM A DESIGNATED GOVERNMENT EMPLOYEE AND THAT I HAVE REPORTED THIS INFORMATION TO LOCAL OFFICIALS PURSUANT TO SECTION 25180.7 OF THE HEALTH AND SAFETY CODE.		
REPORT DATE 04/21/83		CASE # _____		SIGNED _____ DATE _____		
REPORTED BY	NAME OF INDIVIDUAL FILING REPORT Dennis Byrne		PHONE (415) 271-4320		SIGNATURE <i>Dennis J Byrne</i>	
	REPRESENTING <input type="checkbox"/> OWNER/OPERATOR <input type="checkbox"/> REGIONAL BOARD <input checked="" type="checkbox"/> LOCAL AGENCY <input type="checkbox"/> OTHER		COMPANY OR AGENCY NAME Alameda County Dept. Environ. Health Haz Mat Div			
	ADDRESS 80 Swan Way Room 200 Oakland Ca 94621					
RESPONSIBLE PARTY	NAME Shell Oil Company <input type="checkbox"/> UNKNOWN		CONTACT PERSON Ray Newsome		PHONE (415) 676-1414	
	ADDRESS P.O. Box 4023 Concord Ca 94524					
SITE LOCATION	FACILITY NAME (IF APPLICABLE) Shell Service Station		OPERATOR _____		PHONE ()	
	ADDRESS 2800 Telegraph Ave Oakland Alameda 94609					
	CROSS STREET 28th St		TYPE OF AREA <input checked="" type="checkbox"/> COMMERCIAL <input type="checkbox"/> INDUSTRIAL <input type="checkbox"/> RURAL <input checked="" type="checkbox"/> RESIDENTIAL <input type="checkbox"/> OTHER		TYPE OF BUSINESS <input checked="" type="checkbox"/> RETAIL FUEL STATION <input type="checkbox"/> FARM <input type="checkbox"/> OTHER	
IMPLEMENTING AGENCIES	LOCAL AGENCY Alameda County Dept. Environ Health Haz. Mat Div		AGENCY NAME _____		CONTACT PERSON Dennis Byrne	
	REGIONAL BOARD San Francisco Bay Area		CONTACT PERSON Dyan Whyte		PHONE (415) 271-4320 (415) 464-1036	
SUBSTANCES INVOLVED	(1) NAME Gasoline		QUANTITY LOST (GALLONS) _____ <input checked="" type="checkbox"/> UNKNOWN			
	(2) _____		<input type="checkbox"/> UNKNOWN			
DISCOVERY/ABATEMENT	DATE DISCOVERED 1/2/0/7/8/8		HOW DISCOVERED <input type="checkbox"/> INVENTORY CONTROL <input type="checkbox"/> SUBSURFACE MONITORING <input type="checkbox"/> NUISANCE CONDITIONS <input type="checkbox"/> TANK TEST <input checked="" type="checkbox"/> TANK REMOVAL <input type="checkbox"/> OTHER			
	DATE DISCHARGE BEGAN _____ <input checked="" type="checkbox"/> UNKNOWN		METHOD USED TO STOP DISCHARGE (CHECK ALL THAT APPLY) <input checked="" type="checkbox"/> REMOVE CONTENTS <input checked="" type="checkbox"/> REPLACE TANK <input type="checkbox"/> CLOSE TANK <input type="checkbox"/> REPAIR TANK <input type="checkbox"/> REPAIR PIPING <input type="checkbox"/> CHANGE PROCEDURE <input type="checkbox"/> OTHER			
	HAS DISCHARGE BEEN STOPPED? <input checked="" type="checkbox"/> YES <input type="checkbox"/> NO IF YES, DATE 1/2/0/7/8/8					
SOURCE/CAUSE	SOURCE OF DISCHARGE <input type="checkbox"/> TANK LEAK <input checked="" type="checkbox"/> UNKNOWN <input type="checkbox"/> PIPING LEAK <input type="checkbox"/> OTHER		TANKS ONLY/CAPACITY 10,000-550 GAL. AGE _____ YRS <input checked="" type="checkbox"/> UNKNOWN		MATERIAL <input checked="" type="checkbox"/> FIBERGLASS <input checked="" type="checkbox"/> STEEL <input type="checkbox"/> OTHER	
	CAUSE(S) <input type="checkbox"/> OVERFILL <input type="checkbox"/> RUPTURE/FAILURE <input type="checkbox"/> CORROSION <input checked="" type="checkbox"/> UNKNOWN <input type="checkbox"/> SPILL <input type="checkbox"/> OTHER					
CASE TYPE	CHECK ONE ONLY <input checked="" type="checkbox"/> UNDETERMINED <input type="checkbox"/> SOIL ONLY <input type="checkbox"/> GROUNDWATER <input type="checkbox"/> DRINKING WATER - (CHECK ONLY IF WATER WELLS HAVE ACTUALLY BEEN AFFECTED)					
CURRENT STATUS	CHECK ONE ONLY <input checked="" type="checkbox"/> SITE INVESTIGATION IN PROGRESS (DEFINING EXTENT OF PROBLEM) <input type="checkbox"/> CLEANUP IN PROGRESS <input type="checkbox"/> SIGNED OFF (CLEANUP COMPLETED OR UNNECESSARY) <input type="checkbox"/> NO ACTION TAKEN <input type="checkbox"/> POST CLEANUP MONITORING IN PROGRESS <input type="checkbox"/> NO FUNDS AVAILABLE TO PROCEED <input type="checkbox"/> EVALUATING CLEANUP ALTERNATIVES					
REMEDIAL ACTION	CHECK APPROPRIATE ACTION(S) (SEE BACK FOR DETAILS) <input type="checkbox"/> CAP SITE (CD) <input checked="" type="checkbox"/> EXCAVATE & DISPOSE (ED) <input type="checkbox"/> REMOVE FREE PRODUCT (FP) <input type="checkbox"/> ENHANCED BIO DEGRADATION (IT) <input type="checkbox"/> CONTAINMENT BARRIER (CB) <input type="checkbox"/> EXCAVATE & TREAT (ET) <input type="checkbox"/> PUMP & TREAT GROUNDWATER (GT) <input type="checkbox"/> REPLACE SUPPLY (RS) <input type="checkbox"/> TREATMENT AT HOOKUP (HU) <input type="checkbox"/> NO ACTION REQUIRED (NA) <input type="checkbox"/> OTHER (OT)					
COMMENTS	TPH contamination in soil of up to 2800 ppm.					

SENDER: Complete items 1 and 2 when additional services are desired, and complete items 3 and 4. Put your address in the "RETURN TO" Space on the reverse side. Failure to do this will prevent this card from being returned to you. The return receipt fee will provide you the name of the person delivered to and the date of delivery. For additional fees the following services are available. Consult postmaster for fees and check box(es) for additional service(s) requested.

1. Show to whom delivered, date, and addressee's address. (Extra charge) *SA* 2. Restricted Delivery (Extra charge)

3. Article Addressed to: <i>STID 413</i> Braunstein, Baruch & Gladys 3005 Garber St. Berkeley CA 94705	4. Article Number <i>P367603923</i> Type of Service: <input type="checkbox"/> Registered <input type="checkbox"/> Insured <input checked="" type="checkbox"/> Certified <input type="checkbox"/> COD <input type="checkbox"/> Express Mail <input type="checkbox"/> Return Receipt for Merchandise Always obtain signature of addressee or agent and DATE DELIVERED.
5. Signature - Address <i>X</i>	8. Addressee's Address (ONLY if requested and fee paid)
6. Signature - Agent <i>X</i> <i>Harold Horne</i>	
7. Date of Delivery <i>3-14-92</i>	

PS Form 3811, Mar. 1988 * U.S.G.P.O. 1988-212-865 DOMESTIC RETURN RECEIPT

P 367 603 923

RECEIPT FOR CERTIFIED MAIL

NO INSURANCE COVERAGE PROVIDED
NOT FOR INTERNATIONAL MAIL

(See Reverse)

PS Form 3800, June 1985 * U.S.G.P.O. 1989-234-555

Sent to	
Braunstein, Baruch	
Street and No	
3005 Garber St.	
P.O., State and ZIP Code	
Berkeley CA 94705	
Postage	S
Certified Fee	
Special Delivery Fee	
Restricted Delivery Fee	
Return Receipt showing to whom and Date Delivered	
Return Receipt showing to whom, Date, and Address of Delivery	
TOTAL Postage and Fees	\$ 2.29
Postmark or Date	<i>3-13-92</i> <i>4PM</i>

STID 413

ALAMEDA COUNTY
HEALTH CARE SERVICES

AGENCY

DAVID J. KEARS, Agency Director



DEPARTMENT OF ENVIRONMENTAL HEALTH
Hazardous Materials Program
80 Swan Way, Rm. 200
Oakland, CA 94621
(415) 271-4320

24 April, 1989

Ray Newsome
Shell Oil Company
P.O. Box 4023
Concord, Ca. 94524

Subject: Underground Storage Tank Removal at 2800 Telegraph Avenue,
Oakland.

Dear Mr. Newsome

Thank you for the analytical report from Kaprealian Engineering concerning the follow-up sampling conducted at the above location. It would appear that a quarterly groundwater monitoring program is in order. Please communicate to our office your intentions in regards to this issue.

Our office has never received the initial report of the data derived from the sampling conducted during the tank removal in December of 1988. Could you please send a copy of this data and the tank hazardous waste manifest for inclusion into our records.

If you have any questions concerning this matter, please contact, Dennis Byrne, Hazardous Materials Specialist, at (415)271-4320.

Sincerely,

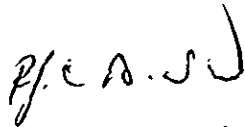
Rafat A. Shahid, Chief,
Hazardous Materials Division

RAS:DB

cc: Dyan Whyte, SFBRWQCB
Gary Johnson, Kaprealian Engineering, Inc.
P.O. Box 913
Benicia, Ca. 94510



gettler — ryan inc.

general contractors

April 14, 1989

Mr. Steven R. Ritchie
Regional Water Quality Control Board
San Francisco Bay Region
1111 Jackson Street, Room 6040
Oakland, California 94607

Reference: Shell Service Station
2800 Telegraph Avenue
Oakland, California

Gentlemen:

As requested by Ms. Diane Lundquist of Shell Oil Company, Gettler-Ryan Inc. is forwarding the Quarterly Summary Report (Shell Oil Company's CALWATER program) for the above referenced location. The summary reports cover the first quarter of 1989 (January - March, 1989). The quarterly technical report for this location was issued by Woodward-Clyde Consultants on March 20, 1989.

Please do not hesitate to call should you have any questions or comments.

Sincerely,

John P. Werfal
Project Manager

JPW/ns

enclosure

cc: Ms. Diane Lundquist, Shell Oil Company
Mr. Rafat Shahid, Alameda County Environmental Health

ALAMEDA COUNTY
APR 21 1989

12-20-88

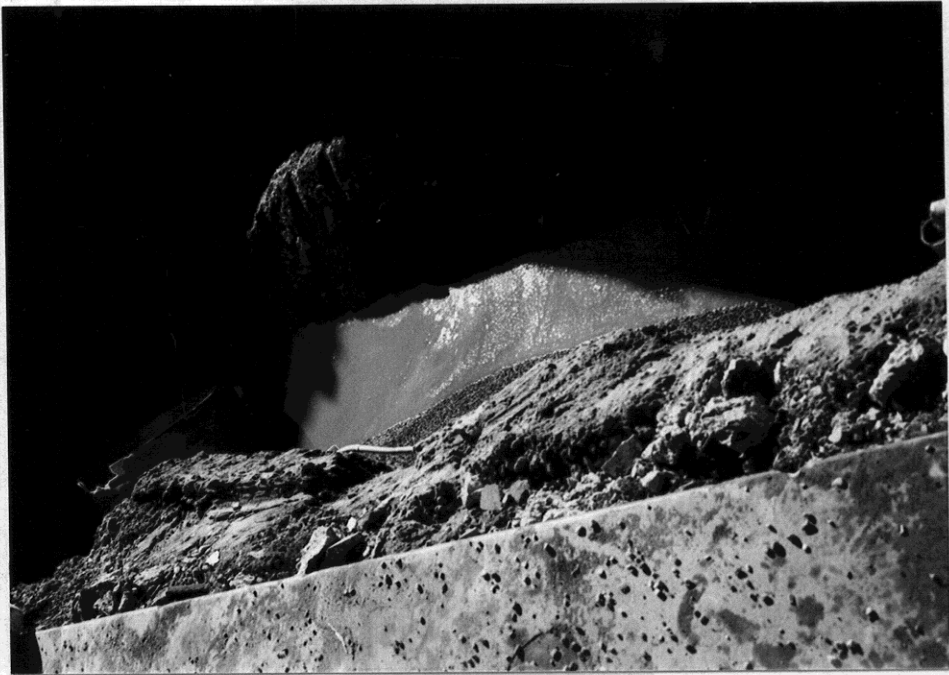

white -env.health
yellow -facility
pink -files

ALAMEDA COUNTY, DEPARTMENT OF ENVIRONMENTAL HEALTH

80 Swan Way, #200
Oakland, CA 94621
(415) 271-4320

Hazardous Materials Division Inspection Form

Site ID# _____ Site Name Shell Service Station Today's Date 12/7/88
Site Address 2800 Telegraph Ave EPA ID# CA098140-
City Oakland Zip 94612 Phone CA0

MAX Amt. Stored > 500lbs/55g/200cf? Y N
Hazardous Waste generated per month? _____

- Inspection Categories:**
- I. Haz. Mat/Waste GENERATOR/TRANSPORTER
 - II. Business Plans, Acute Hazardous Materials
 - III. Underground Tanks

The marked items represent violations of the Calif. Administration Code (CAC) or the Health & Safety Code (HS&C)

- I.A GENERATOR (Title 22)**
- ___ 1. Waste ID * 66471
 - ___ 2. EPA ID 66472
 - ___ 3. > 90 days 66508
 - ___ 4. Label dates 66508
 - ___ 5. Biennial 66493
-
- Manifest**
- ___ 6. Records 66492
 - ___ 7. Correct 66484
 - ___ 8. Copy sent 66492
 - ___ 9. Exception 66484
 - ___ 10. Copies Rec'd 66492
-
- Misc.**
- ___ 11. Treatment 66371
 - ___ 12. On-site Disp. (H.S.&C.) 26189.5
 - ___ 13. Ex Haz. Waste 66570
-
- Prevention**
- ___ 14. Communications 67121
 - ___ 15. Aisle Space 67124
 - ___ 16. Local Authority 67126
 - ___ 17. Maintenance 67120
 - ___ 18. Training 67105
-
- Contn. Agency**
- ___ 19. Prepared 67140
 - ___ 20. Name List 67141
 - ___ 21. Copies 67141
 - ___ 22. Emg. Coord. Trng. 67144
-
- Containers, Tanks**
- ___ 23. Condition 67241
 - ___ 24. Compatibility 67242
 - ___ 25. Maintenance 67243
 - ___ 26. Inspection 67244
 - ___ 27. Buffer Zone 67246
 - ___ 28. Tank Inspection 67259
 - ___ 29. Containment 67245
 - ___ 30. Safe Storage 67261
 - ___ 31. Freeboard 67257

Comments:

Observed removal of 4 UG T's

1) 550 waste oil (-TPH, BTX+E, CHC, oil + Grease)

2) 10,000 unleaded } TPH 2 soil + 1 water

3) 10,000 unleaded } + sample from

4) 10,000 regular } BTX+E each gas tank

Ground water with floating product was obvious below all three gasoline tanks

No obvious holes observed in any of the tanks upon removal

Gasoline odor was noticeable with each soil sample from gas tanks

- I.B TRANSPORTER (Title 22)**
- ___ 32. Applic./Insurance 66428
 - ___ 33. Comp. Cert./CHP Insp. 66448
 - ___ 34. Containers 66465
-
- Manifest**
- ___ 35. Vehicles 66465
 - ___ 36. EPA ID #s 66531
 - ___ 37. Correct 66541
 - ___ 38. HW Delivery 66543
 - ___ 39. Records 66544
-
- Cont'r**
- ___ 40. Name/ Covers 66545
 - ___ 41. Recyclables 66800

Contact: _____

Title: Richard Campbell Inspector: D. Byrne

Signature: _____ Signature: Danni Byrne

ALABAMA COUNTY HEALTH CARE SERVICES AGENCY
 DEPARTMENT OF ENVIRONMENTAL HEALTH
 HAZARDOUS MATERIALS DIVISION

~~470 - 27TH ST., RM. 322~~
~~OAKLAND, CA 94612~~
 PHONE NO. 415/874-7237
 80 STANWAY SUITE #200
 OAKLAND, CA 94621

ACCEPTED *BR*
 11/25/88
 DEPARTMENT OF ENVIRONMENTAL HEALTH
 470 - 27th Street, Third Floor
 Oakland, CA 94612
 Telephone: (415) 874-7237

These plans have been reviewed and found to be acceptable and essentially meet the requirements of State and local health laws. Changes to your plans indicated by this Department are to assure compliance with State and local laws. The project proposed herein is now released for issuance of the required building permits for construction. One copy of these accepted plans must be on the job and available to all contractors and craftsmen involved with the removal.

Any change or alterations of these plans and specifications must be submitted to this Department and to the Fire and Building Inspection Department to determine if such changes meet the requirements of State and local laws. Notify this Department at least 48 hours prior to the following required inspections:

- 12/1/88 Removal of Tank and Piping
- 12/7/88 Sealing
- Final Inspection

Issuance of a permit to operate is dependent on compliance with erected plans and all applicable laws and regulations.

THIS IS A FINAL DETERMINATION NOT
 OPEN TO APPEAL

UNDERGROUND TANK CLOSURE/MODIFICATION PLANS

1. Business Name SHELL SERVICE STATION
 Business Owner SHELL OIL CO. 9/0 RAY NEWSOME
2. Site Address 2800 TELEGRAPH AVE. & 28TH ST.
 City OAKLAND, CA. Zip 94609 Phone (415) 676-1414
 EXT. 128
3. Mailing Address P.O. BOX 4023
 City CONCORD, CA. Zip 94524 Phone (415) 510-676-1414
 X128
4. Land Owner SHELL OIL CO. 9/0 RAY NEWSOME
 Address P.O. BOX 4023 City, State CONCORD, CA Zip 94524
5. EPA I.D. No. #CAD 981402928
6. Contractor R.W. JOHNSTON & SONS
 Address 801 53RD. AVE.
 City OAKLAND, CA. 94621 Phone 261-9424
 License Type ASBSC33 ID# 289839
7. Other (Specify) _____
 Address _____
 City _____ Phone _____

Project # 4528757
 Fee Paid 750
 Date 11/23/88

8. Contact Person for Investigation

Name RAY NEWSOME Title SHELL ENGINEER
Phone (415) 676-1414

9. Total No. of Tanks at facility 4

10. Have permit applications for all tanks been submitted to this office? Yes [] No []

11. State Registered Hazardous Waste Transporters/Facilities

a) Product/Waste Tranporter

Name CROSBY OVERTON EPA I.D. No. #CAD981461064
Address 8430 AMELIA ST.
City OAKLAND State CA. Zip 94107

b) Rinsate Transporter

Name CROSBY OVERTON EPA I.D. No. #CAD981461064
Address 8430 AMELIA ST.
City OAKLAND State CA. Zip 94107

c). Tank Transporter

Name CROSBY OVERTON EPA I.D. No. #CAD98141064
Address 8430 AMELIA ST.
City OAKLAND State CA. Zip 94107

d) Contaminated Soil Transporter

Name CROSBY OVERTON EPA I.D. No. #CAD9814064
Address 8430 AMELIA ST.
City OAKLAND State CA. Zip 94107

12. Sample Collector

Name MR. MARDO KAPREALIAN
Company KAPREALIAN ENGINEERING
Address P.O. BOX 913
City BENECIA State CA Zip 94510 Phone (707) 746-6915

13. Sampling Information for each tank or area

Tank or Area		Material sampled	Location & Depth
Capacity	Historic Contents (past 5 years)		
10M GAL.	REGULAR LEADED	NATIVE SOIL	2'-0" BENEATH REMOVED TANK
10M GAL.	REG. UNLEADED		
10M GAL.	SUPER UNLEADED		
550 GAL.	WASTE OIL		

14. Have tanks or pipes leaked in the past? Yes [] No []

If yes, describe. UNKNOWN

15. NFPA methods used for rendering tank inert? Yes [] No []

If yes, describe. ADDING 1.5 LB. PER 100 GALLONS OF
TANK CAPACITY

16. Laboratories

Name HAZCAT LABS

Address 733 DARTMOUTH AVE.

City SAN CARLOS State CA. Zip 94070

State Certification No. _____

17. Chemical Methods be used for Analyzing Samples

Contaminant Sought	EPA, DHS, or Other Sample Preparation Method Number	EPA, DHS, or Other Analysis Number
GASOLINE	<u>SOIL</u> • TPH, LOW BOILING POINT FRACTION EPA# 5030/8015 (TOTAL PETROLEUM HYDROCARBON-FORMERLY THC) • BTXE (BENZENE, TOULENE, XYLENE, ?) EPA# 8020	
	<u>WATER</u> • TPH, LOW B.P. FRACTION EPA# 5030 • BTXE EPA# 602	
WASTE OIL	<u>SOIL</u> • T.O.G. (TOTAL EPA# 5030/5032) • TPH GAS & DIESEL EPA# 5030/8015 • BTXE	

18. Site Safety Plan submitted? Yes [] No [X]

19. Workman's Compensation: Yes [X] No []

Copy of Certificate enclosed? Yes [X] No []

Name of Insurer Republic Indemnity

20. Plot Plan submitted? Yes [X] No []

21. Deposit enclosed? Yes [X] No []

22. Please forward to this office the following information within 60 days after receipt of sample results.

- a) Chain of Custody Sheets
- b) Original Signed Laboratory Reports
- c) TSD to Generator copies of wastes shipped and received
- d) Attachment A summarizing laboratory results

17. Chemical Methods to be used for Analyzing Samples

Contaminant Sought	EPA, DHS, or Other Sample Preparation Method Number	EPA, DHS, or Other Analysis Number
WASTE OIL (CON.)	<ul style="list-style-type: none"> EPA# 8020 • CLH (CHLORINATED HYDROCARBONS) EPA# 8010 • T.O.G. EPA# 503A/503E • T.P.H. GAS & DIESEL EPA# 5030/5015 • BTXE EPA# 602 • CLHC EPA# 601 	

18. Site Safety Plan submitted? Yes [] No [X]

19. Workman's Compensation: Yes [] No []

Copy of Certificate enclosed? Yes [] No []

Name of Insurer _____

20. Plot Plan submitted? Yes [X] No []

21. Deposit enclosed? Yes [X] No []

22. Please forward to this office the following information within 60 days after receipt of sample results.

- a) Chain of Custody Sheets
- b) Original Signed Laboratory Reports
- c) TSD to Generator copies of wastes shipped and received
- d) Attachment A summarizing laboratory results

I declare that to the best of my knowledge and belief the statements and information provided above are correct and true. I understand that information in addition to that provided above may be needed in order to obtain an approval from the Department of Environmental Health and that no work is to begin on this project until this plan is approved.

I understand that any changes in design, materials or equipment will void this plan if prior approval is not obtained.

I will notify the Department of Environmental Health at least two (2) working days (48 hours) in advance to schedule any required inspections. I understand that site and worker safety are solely the responsibility of the property owner or his agent and that this responsibility is not shared nor assumed by the County of Alameda.

Signature of Contractor R. W. JOHNSTON & SON
Name (please type) 801 - 53rd AVE.
OAKLAND, CA 94601.
Signature [Handwritten Signature]
Date NOV 23 1988

Signature of Site Owner or Operator
Name (please type) R G Newsome Shell Oil Co.
Signature [Handwritten Signature]
Date 11-22-88

NOTES:

1. Any changes in this document must be approved by this Department.
2. Any leaks discovered must be submitted to this office on an underground storage tank unauthorized leak/contamination site report form within 5 days of its discovery.
3. Three (3) copies of this plan must be submitted to this Department. One copy must be at the construction site at all times.
4. A copy of your approved plan must be sent to the landowner.

UNDERGROUND TANK CLOSURE/MODIFICATION PLANS

ATTACHMENT A

SAMPLING RESULTS

Tank or Area	Contaminant	Location & Depth	Results (specify units)

PRODUCER

PUTNAM, KNUDSEN & WIEKING
INSURANCE BROKERS
 P.O. BOX 24205
 OAKLAND, CA 94623-4205
 TEL: (415) 834-4500

THIS CERTIFICATE IS ISSUED AS A MATTER OF INFORMATION ONLY AND CONFERS NO RIGHTS UPON THE CERTIFICATE HOLDER. THIS CERTIFICATE DOES NOT AMEND, EXTEND OR ALTER THE COVERAGE AFFORDED BY THE POLICIES BELOW.

COMPANIES AFFORDING COVERAGE

COMPANY LETTER A	REPUBLIC INSURANCE
COMPANY LETTER B	
COMPANY LETTER C	
COMPANY LETTER D	
COMPANY LETTER E	

INSURED

R.W. JOHNSTON & SONS, INC.
 801 - 53RD AVE.
 OAKLAND, CA 94601

COVERAGES

THIS IS TO CERTIFY THAT POLICIES OF INSURANCE LISTED BELOW HAVE BEEN ISSUED TO THE INSURED NAMED ABOVE FOR THE POLICY PERIOD INDICATED, NOTWITHSTANDING ANY REQUIREMENT, TERM OR CONDITION OF ANY CONTRACT OR OTHER DOCUMENT WITH RESPECT TO WHICH THIS CERTIFICATE MAY BE ISSUED OR MAY PERTAIN, THE INSURANCE AFFORDED BY THE POLICIES DESCRIBED HEREIN IS SUBJECT TO ALL THE TERMS, EXCLUSIONS, AND CONDITIONS OF SUCH POLICIES.

CO LTR	TYPE OF INSURANCE	POLICY NUMBER	POLICY EFFECTIVE DATE (MM/DD/YY)	POLICY EXPIRATION DATE (MM/DD/YY)	ALL LIMITS IN THOUSANDS	
	GENERAL LIABILITY <input type="checkbox"/> COMMERCIAL GENERAL LIABILITY <input type="checkbox"/> CLAIMS MADE <input type="checkbox"/> OCCURRENCE <input type="checkbox"/> OWNER'S & CONTRACTORS PROTECTIVE				GENERAL AGGREGATE	\$
					PRODUCTS-COMP/OPS AGGREGATE	\$
					PERSONAL & ADVERTISING INJURY	\$
					EACH OCCURRENCE	\$
					FIRE DAMAGE (ANY ONE FIRE)	\$
					MEDICAL EXPENSE (ANY ONE PERSON)	\$
	AUTOMOBILE LIABILITY <input type="checkbox"/> ANY AUTO <input type="checkbox"/> ALL OWNED AUTOS <input type="checkbox"/> SCHEDULED AUTOS <input type="checkbox"/> HIRED AUTOS <input type="checkbox"/> NON-OWNED AUTOS <input type="checkbox"/> GARAGE LIABILITY				CSL	\$
					BODILY INJURY (PER PERSON)	\$
					BODILY INJURY (PER ACCIDENT)	\$
					PROPERTY DAMAGE	\$
	EXCESS LIABILITY <input type="checkbox"/> OTHER THAN UMBRELLA FORM				EACH OCCURRENCE	\$
					AGGREGATE	\$
A	WORKERS' COMPENSATION AND EMPLOYERS' LIABILITY	PC989901	07/01/88	07/01/89	STATUTORY	
					\$ 1,000	(EACH ACCIDENT)
					\$ 1,000	(DISEASE-POLICY LIMIT)
					\$ 1,000	(DISEASE-EACH EMPLOYEE)
	OTHER					

DESCRIPTION OF OPERATIONS/LOCATIONS/VEHICLES/RESTRICTIONS/SPECIAL ITEMS

RE: INSURED'S CALIFORNIA OPERATION

CERTIFICATE HOLDER

ALAMEDA COUNTY HEALTH DEPT.
HAZARDOUS MATERIAL DIVISION
 470 - 27TH ST, RM. #322
 OAKLAND, CA 94612

CANCELLATION

SHOULD ANY OF THE ABOVE DESCRIBED POLICIES BE CANCELLED BEFORE THE EXPIRATION DATE THEREOF, THE ISSUING COMPANY WILL MAIL 10 DAYS WRITTEN NOTICE TO THE CERTIFICATE HOLDER NAMED TO THE LEFT.

 AUTHORIZED REPRESENTATIVE

JFW/LM/88

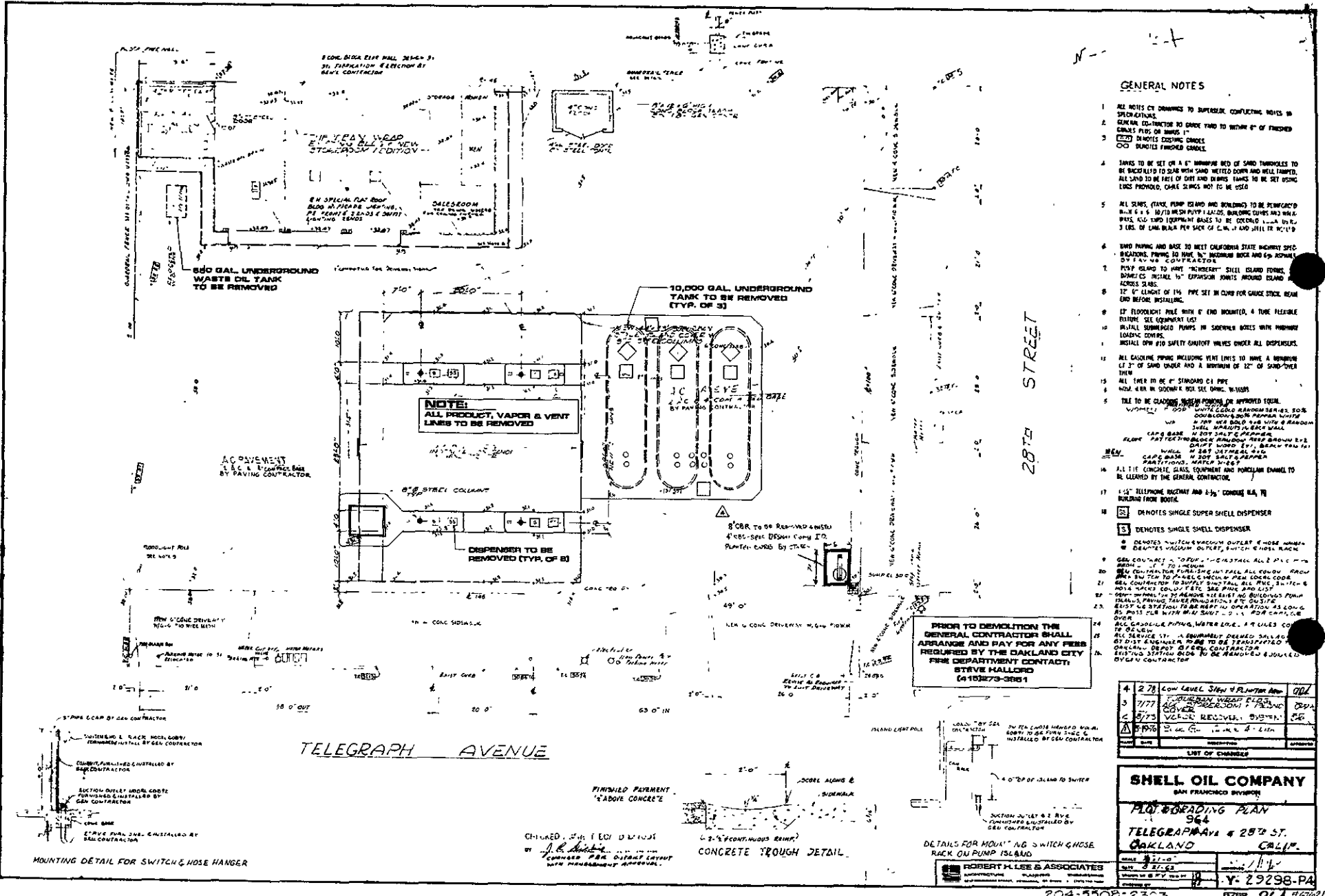

- ### GENERAL NOTES
- 1 ALL NOTES BY DRAWING TO SUPPLEMENT EXISTING NOTES IN SPECIFICATIONS.
 - 2 GENERAL CONTRACTOR TO CHECK TANK TO WITHIN 6" OF FINISHED GRADE PLUS OR MINUS 1"
 - 3 (S) IN NOTES EXISTING CONDUIT OR BUNDLES FINISHED GRADE.
 - 4 TANKS TO BE SET ON A 6" MINIMUM BED OF SAND THROUGHOUT TO BE BACKFILLED TO GRADE WITH SAND WETTED DOWN AND WELL TAMPED. ALL SAND TO BE FREE OF COKE AND OTHER TANKS TO BE SET USING LINKS PROVIDED. CHAIN SLINGS NOT TO BE USED.
 - 5 ALL RIMS, STAND, PUMP ISLAND AND BUILDINGS TO BE REINFORCED WITH 4" X 6" 18#10 WELD PIPE. BUILDING CONCRETE AND WALLS AND TANKS TO BE REINFORCED WITH 4" X 6" 18#10 WELD PIPE PER SACK OF CEMENT AND 1/2" DIAMETER REBAR.
 - 6 SAND PILING AND BASE TO MEET CALIFORNIA STATE HIGHWAY SPECIFICATIONS. PILING TO BE 12" DIAMETER WITH 40# REBAR BY TYPICAL CONTRACTOR.
 - 7 PUMP ISLAND TO HAVE "HEAVENLY" STEEL EXHAUST FAN. FAN TO BE 12" DIAMETER WITH 12" EXHAUST PORTS AROUND ISLAND ACROSS GRADE.
 - 8 12" DIAMETER OF 1/2" PIPE SET IN CONCRETE FOR GAS CHECK BEHIND SAND BEFORE INSTALLING.
 - 9 IF FLOODLIGHT WITH 6" END MOUNTED, 4 TUBE FLEXIBLE EXHAUST SEE EQUIPMENT LIST.
 - 10 INSTALL SUBMERGED PUMPS IN SOUPERS BOWLS WITH FURNISHING LOADING CONDUITS.
 - 11 INSTALL 1/2" DIA SAFETY SHUTOFF VALVES UNDER ALL DISPENSERS.
 - 12 ALL GASOLINE PIPING INCLUDING VENT LINES TO HAVE A MINIMUM 1/2" OF SAND COVER AND A MINIMUM OF 12" OF SAND OVER THEM.
 - 13 ALL TANKS TO BE 6" STANDARD GA PIPE.
 - 14 WALLS TO BE 12" MINIMUM THICKNESS. WALLS.
 - 15 TANKS TO BE CLASSIFIED AS FURNISHING APPROVED TANKS.
 - 16 ALL CONCRETE SHALL BE REINFORCED WITH 4" X 6" 18#10 WELD PIPE PER SACK OF CEMENT AND 1/2" DIAMETER REBAR. CONCRETE SHALL BE FINISHED WITH A RANDOM PATTERN. ALL CONCRETE SHALL BE FINISHED WITH A RANDOM PATTERN. ALL CONCRETE SHALL BE FINISHED WITH A RANDOM PATTERN.
 - 17 ALL TIE CONCRETE, GLASS, EQUIPMENT AND PORTLAND CEMENT TO BE CLEARED BY THE GENERAL CONTRACTOR.
 - 18 1/2" TELEPHONE BASEWAY AND 1/2" CONDUIT 1/2" DIA. BUILDING FROM BOOTH.
 - 19 (S) DENOTES SINGLE SHELL DISPENSER.
 - 20 (S) DENOTES SINGLE SHELL DISPENSER.
 - 21 (S) DENOTES SINGLE SHELL DISPENSER.
 - 22 (S) DENOTES SINGLE SHELL DISPENSER.
 - 23 (S) DENOTES SINGLE SHELL DISPENSER.
 - 24 (S) DENOTES SINGLE SHELL DISPENSER.
 - 25 (S) DENOTES SINGLE SHELL DISPENSER.
 - 26 (S) DENOTES SINGLE SHELL DISPENSER.

PRIOR TO DEMOLITION THE GENERAL CONTRACTOR SHALL ARRANGE AND PAY FOR ANY FEES REQUIRED BY THE OAKLAND CITY FIRE DEPARTMENT CONTACT: STEVE HALLOD (415)273-3861

NO.	DATE	DESCRIPTION	BY
1	2/78	LOW LEVEL SHED 4 PUMP ISLAND	GBL
2	7/77	CONCRETE TROUGH DETAIL	GBL
3	5/73	VACUUM RECOVERY SYSTEM	GBL
4	1/78	2" GAS CONDUIT	GBL

SHELL OIL COMPANY
SAN FRANCISCO DIVISION

PLOT GRADING PLAN
964
TELEGRAPH AVENUE & 28th ST.
OAKLAND CALIF.

ROBERT M. LEE & ASSOCIATES
ARCHITECTURE PLANNING ENGINEERING
204-5508-2303

MOUNTING DETAIL FOR SWITCH & HOSE HANGER

FINISHED PAYMENT "ABOVE CONCRETE"

CONCRETE TROUGH DETAIL

DETAILS FOR MOUNTING RACK ON PUMP ISLAND

R.W. JOHNSTON & SON
801 - 53RD Avenue
Oakland, CA 94601
Cal State Contractors Lic#289839

O.S.H.A. (ACCIDENT PREVENTION PROGRAM) FOR ALL FOREMEN

I. Planning for Construction Work

In advance of starting any construction work the following should be considered:

- A. Workers and Equipment Access Movement at Work Site
 - 1. Adequate work areas.
 - 2. Walkways, runways, ladders, stairs and roads.
 - a) clear of debris at all times.
 - 3. All floor, roof and excavation openings shall be protected.
 - 4. When working during darkness provide adequate lighting.
- B. Location of Temporary Facilities
 - 1. Consider location of all existing and future utilities when locating temporary office, tool sheds, toilets, and drinking water.
- C. Schedule Work for Safety
 - 1. Have all safety equipment ready when needed (shoring, first aid, and personal protective equipment).
 - 2. Plan work so that too many people are not in a small area at the same time.
- D. Work Procedures
 - 1. Use proper equipment for each job.
 - a) cranes, fork trucks, back hoes and trucks.
 - 2. Use proper tools specifically designed for the work being done.
 - 3. Train all workers in proper use of tools and equipment.
 - 4. Provide for (tail gate) safety meetings each week, or as necessary.
 - 5. Have adequate manpower available.
 - 6. Post all safety regulations and posters required.

II. Code of Safe Practices

General

1. All persons shall follow these safe practices rules, render every possible aid to safe operations, and report all unsafe conditions or practices to the foreman or superintendent.
2. Foremen shall insist on employees observing and obeying every rule, regulation, and order as is necessary to the safe conduct of the work, and shall take such action as is necessary to obtain observance.
3. All employees shall be given frequent accident prevention instructions. Instructions shall be given at least every 10 working days.
4. Anyone known to be under the influence of drugs or intoxicating substances which impair the employee's ability to safely perform the assigned duties shall not be allowed on the job while in that condition.
5. Horseplay, scuffling, and other acts which tend to have an adverse influence on the safety or well-being of the employees shall be prohibited.
6. Work shall be well planned and supervised to prevent injuries in the handling of materials and in working together with equipment.
7. No one shall knowingly be permitted or required to work while the employee's ability or alertness is so impaired by fatigue, illness, or other causes that it might unnecessarily expose the employee or others to injury.
8. Employees shall not enter manholes, underground vaults, chambers, tanks, silos, or other similar places that receive little ventilation, unless it has been determined that it is safe to enter.
9. Employees shall be instructed to ensure that all guards and other protective devices are in proper places and adjusted, and shall report deficiencies promptly to the foreman or superintendent.
10. Workers shall not handle or tamper with any electrical equipment, machinery, or air or water lines in a manner not within the scope of their duties, unless they have received instructions from their foreman.
11. All injuries shall be reported promptly to the foreman or superintendent so that arrangements can be made for medical or first aid treatment.
12. When lifting heavy objects, the large muscles of the leg instead of the smaller muscles of the back shall be used.
13. Inappropriate footwear or shoes with thin or badly worn soles shall not be worn.
14. Materials, tools, or other objects shall not be thrown from buildings or structures until proper precautions are taken to protect others from the falling objects.
15. Employees shall cleanse thoroughly after handling hazardous substances, and follow special instructions from authorized sources.
16. Work shall be so arranged that employees are able to face ladder and use both hands while climbing.
17. Gasoline shall not be used for cleaning purposes.

Code of Safety Practices

18. No burning, welding, or other source of ignition shall be applied to any enclosed tank or vessel, even if there are some openings, until it has first been determined that no possibility of explosion exists, and authority for the work is obtained from the foreman or superintendent.
19. Any damage to scaffolds, falsework, or other supporting structures shall be immediately reported to the foreman and repaired before use.
20. All work on gasoline tanks and piping must be done per National Fire Protection Authority regulations.

Use of Tools and Equipment

21. All tools and equipment shall be maintained in good condition.
22. Damaged tools or equipment shall be removed from service and tagged "DEFECTIVE."
23. Pipe or Stillson wrenches shall not be used as a substitute for other wrenches.
24. Only appropriate tools shall be used for the job.
25. Wrenches shall not be altered by the addition of handle-extensions or "cheaters."
26. Files shall be equipped with handles and not used to punch or pry.
27. A screwdriver shall not be used as a chisel.
28. Wheelbarrows shall not be pushed with handles in an upright position.
29. Portable electric tools shall not be lifted or lowered by means of the power cord. Ropes shall be used.
30. Electric cords shall not be exposed to damage from vehicles.
31. In locations where the use of a portable power tool is difficult, the tool shall be supported by means of a rope or similar support of adequate strength.

Machinery and Vehicles

32. Only authorized persons shall operate machinery or equipment.
33. Loose or frayed clothing, or long hair, dangling ties, finger rings, etc., shall not be worn around moving machinery or other sources of entanglement.
34. Machinery shall not be serviced, repaired or adjusted while in operation, nor shall oiling of moving parts be attempted, except on equipment that is designed or fitted with safeguards to protect the person performing the work.
35. Where appropriate, lock-out procedures shall be used.
36. Employees shall not work under vehicles supported by jacks or chain hoists, without protective blocking that will prevent injury if jacks or hoists should fail.
37. Air hoses shall not be disconnected at compressors until hose line has been bled.
38. All excavations shall be visually inspected before backfilling, to ensure that it is safe to backfill.
39. Excavating equipment shall not be operated near tops of cuts, banks, and cliffs if employees are working below.

Code of Safety Practices

40. Tractors, bulldozers, scrapers and carryalls shall not operate where there is possibility of overturning in dangerous areas like edges of deep fills, cut banks, and steep slopes.

Blasting Operations

1. Any blasting necessary or required shall be subcontracted to a contractor properly licensed and experienced for this work.

R. W. JOHNSTON & SON
GENERAL CONTRACTORS
801 - 53RD AVENUE
OAKLAND, CALIFORNIA 94601

R. W. JOHNSTON & SON'S SITE SAFETY PLAN FOR REMOVING UNDERGROUND STORAGE TANKS IS AS FOLLOWS...

1. OBTAIN ALL REQUIRED PERMITS FROM GOVERNING AUTHORITIES.
2. KEEP 2 - 15# B C FIRE EXTINGUISHERS ON SITE WHILE TANK AND PIPE REMOVAL WORK IS BEING DONE.
3. REMOVE ALL PRODUCT FROM TANKS.
4. WASH ALL LINES BACK INTO TANK WITH CLEAR WATER: TRIPLE RINSE.
5. EXCAVATE TANKS.
6. TRIPLE RINSE TANKS AND REMOVE ALL WATER AND RESIDUE FROM TANKS. (BY LICENSED HAZARDOUS WASTE HAULER).
7. DE-GAS TANK OR TANKS USING C-0,2 OR DRY ICE, 15# PER THOUSAND MINIMUM, OR PER LOCAL REQUIREMENTS.
8. PROVIDE COMBUSTABLE GAS INDICATOR AND CHECK TANKS FOR EXPLOSIVE VAPORS BEFORE REMOVAL FROM EXCAVATION. (MUST BE BELOW .2 L.E.L.)
9. REMOVE TANKS AND INSPECT SAME FOR LEAKAGE. SEAL ANY LEAKS TO PREVENT SPILLAGE.
10. REMOVE TANKS TO APPROVED LOCATION AND CRUSH FOR DISPOSAL AT APPROVED DUMP. (BY HAZARDOUS WASTE HAULER).

ROBERT H. LEE & ASSOCIATES INC.
 900 Larkspur Landing Circle
 Suite 125
 LARKSPUR, CALIFORNIA 94939

LETTER OF TRANSMITTAL

(415) 461-8890

TO

ALAMEDA HEALTH DEPT.

DATE	11-22-88	JOB NO.	6762
ATTENTION	Tom Peacock		
RE	TANK REMOVAL Shell Service Station 2800 TELEGRAPH AVE & 28th St. OAKLAND, CA.		

WE ARE SENDING YOU Attached Under separate cover via _____ the following items:

- Shop drawings Prints Plans Samples Specifications
 Copy of letter Change order _____

COPIES	DATE	NO.	DESCRIPTION
1			TANK Removal Application
1			\$750.00 Check # 2301
3			8 1/2" x 11" SITE PLANS

THESE ARE TRANSMITTED as checked below:

- For approval Approved as submitted Resubmit _____ copies for approval
 For your use Approved as noted Submit _____ copies for distribution
 As requested Returned for corrections Return _____ corrected prints
 For review and comment _____
 FOR BIDS DUE _____ 19 _____ PRINTS RETURNED AFTER LOAN TO US

REMARKS

Please Return a Check Receipt to our office

COPY TO

RAY WEUSOME

SIGNED:

John Datto



ALAMEDA COUNTY FLOOD CONTROL AND WATER CONSERVATION DISTRICT
 5997 PARKSIDE DRIVE PLEASANTON, CALIFORNIA 94566 (415) 484-2600

Liz
11/21/88

26 October 1988

RECEIVED
 NOV 11 1988

RECEIVED
 OCT 27 1988

Mr. Gerald H. Winn, Director
 Division of Environmental Health
 470-27th Street
 Oakland, CA 94612

CC. Bob
CASAF
TED

HAZARDOUS MATERIAL

Dear Mr. Winn:

Pursuant to your request, tabulated below are the water supply and monitoring well construction permits issued since 30 September 1988.

<u>Permit #</u>	<u>Owner</u>	<u>Location</u>
<u>Water Supply Wells</u>		
88513	Kohne	3577 Little Valley Road, Sunol
88520	Hom	Laughlin Road near North Front Road, Livermore
88535	Thomas	6917 Sunnyslope Avenue, Castro Valley

Monitoring Well Projects

88507	Lee	528 Jackson Street, Hayward
88508	U. S. Postal Service	24438 Santa Clara Street, Hayward
88509	U. S. Postal Service	577 West Grand Avenue, Oakland
88510	Vukovic Retail Partners	14400 Washington Avenue, San Leandro
88511	Chevron, U.S.A.	4300 MacArthur Boulevard, Oakland
88514	Texaco	500 Grand Avenue, Oakland
88515	Spieker Partners	355 South Vasco Road, Livermore
88521	Chevron, U.S.A.	7240 Dublin Boulevard, Dublin
88523	Beacon Oil	29705 Mission Boulevard, Hayward
88524	Bottorf	1245 Almond Avenue, Livermore
88525	Barrett Metal Finishing	910-89th Avenue, Oakland
88528	Shell Oil	2800 Telegraph Avenue, Oakland
88530	Robinson	27814 Hesperian Boulevard, Hayward
88537	Exxon	2991 Hopyard Road, Pleasanton
88538	Goldsmith & Lathrop	21st Street & Broadway, Oakland
88540	Chevron, U.S.A.	17th Street & Harrison Street, Oakland
88541	City of San Leandro	Davis & San Leandro Boulevard, San Leandro
88542	Levitt	1033-44th Avenue, Oakland

If you have any questions, please contact Craig Mayfield at 484-2600.

Very truly yours,

Mun J. Mar
 General Manager

By *Craig A. Mayfield*
 Craig A. Mayfield
 Water Resources Engineer III

CM:bkm

cc: Steve Faelz, Hayward Fire Department
 Richard Mueller, Pleasanton Fire Department

9/28/88

BRIEF HISTORY

- Soil investigation was conducted on December 9, 1987 in order to document soil conditions adjacent to the subsurface tanks prior to relinquishment of the property. Five soil borings (S-A through S-E) were drilled. Boring S-A was drilled adjacent to the waste oil tank, S-B through S-D adjacent to the gasoline tank complex, and S-E within the tank backfill. Gasoline concentrations in analyzed soil samples ranged from none detected in S-E at 13 feet to 4,400 ppm at 10 feet in boring S-B for total hydrocarbons. Benzene concentrations ranged from 0.05 ppm to 26 ppm. High boiling hydrocarbons were none detected in boring S-A. Groundwater was encountered at approximately 8 feet below grade. A 1/2 mile radius well location survey was performed. Pacific Environmental Group, Inc. issued report dated January 15, 1988.
- In response to the soil contamination encountered during the site relinquishment investigation, groundwater wells (S-1, S-2, and S-3) were installed on April 22, 1988. No hydrocarbon odors were observed in soils from S-1. Laboratory analysis of soil from wells S-2 and S-3 detected gasoline concentrations ranging from 4,800 ppm to 5 ppm. Groundwater concentrations ranged from 46 ppm in well S-3 to none detected in well S-1 for total hydrocarbons calculated as gasoline. No high boiling hydrocarbons detected in S-1. Report dated June 17, 1988 by Woodward-Clyde Consultants.

WORK COMPLETED THIS PERIOD

- Report documenting on-site investigation forwarded to Alameda County Hazardous Material Division on June 20, 1988.
- Applied for an encroachment permit from the City of Oakland on July 21, 1988 to install three groundwater monitoring wells to define the extent of groundwater contamination. Application approval is pending.

GROUNDWATER MONITORING

FREQUENCY: WEEKLY

- INITIAL: Three groundwater monitoring wells (S-1, S-2, and S-3) and two tank complex monitoring wells (A and B), no separate phase product, static groundwater at 8 feet.
- CURRENT: Floating product encountered in well S-3 in thicknesses up to 0.04 feet.
- PRODUCT RECOVERED: NONE

**SHELL OIL COMPANY
2800 TELEGRAPH AVE.
OAKLAND**

9/28/88

GROUNDWATER SAMPLING

FREQUENCY: NONE

- **INITIAL:** On May 2, 1988, the highest concentrations in the groundwater were from well S-3 which contained 46 ppm gasoline and 2.7 ppm benzene. See attached table summarizing the results.
- **HISTORICAL: NONE**
- **CURRENT: NONE**

PROPOSED ACTION:

- Quarterly sampling of S-1, S-2, and S-3 for gas, BTX.
- Install additional wells to define the extent of the dissolved contamination.
- Remove existing underground storage tanks and remediate soil contamination from excavation and site.

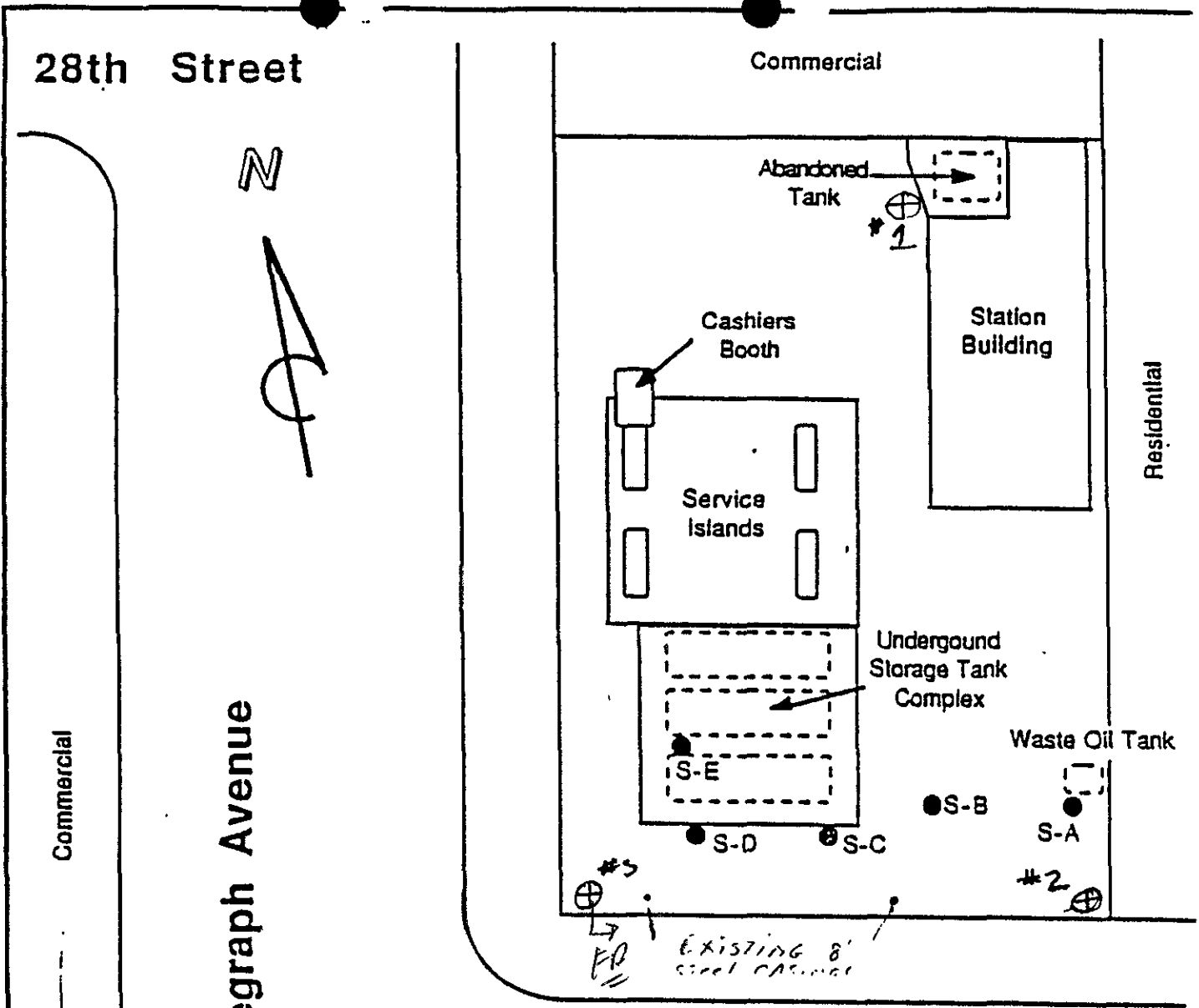

28th Street

LEGEND

● S-A Soil Boring Location and Designation

SCALE

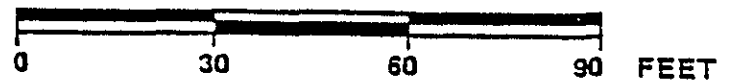

FORMER SHELL SERVICE STATION
 Telegraph Avenue & 28th Street
 Oakland, California
 SITE PLAN

FIGURE:
 2
 PROJECT:
 101-13.01

ANALYTICAL LOG

DATE	SAMPLE POINT	TVHC (PPM)	BENZENE (PPM)	TOLUENE (PPM)	XYLENES (PPM)
DETECTION LIMITS		0.05	0.0005	0.001	0.004
02-May-88	S1	ND	0.5	ND	ND
02-May-88	S2	1.6	0.079	0.089	0.048
02-May-88	S3	46	2.7	10	10

DATE	WELL	DTH	DTW	HT	BAILED	FLOWMETER	PT-LIQ.	PT-H2O	EMP	C.ELEV
16-Aug-88	1		14.33	0.00						DF
30-Aug-88	1		10.48	0.00						DF
16-Aug-88	2		14.18	0.00						
30-Aug-88	2		10.27	0.00						
16-Aug-88	3		14.04	0.00						
30-Aug-88	3		10.19	0.00						



Account # U 5245 55
Payable \$ 900.00
Date 7/28/88

July 20, 1988

Alameda County Health Care Services
Department of Environmental Health
Hazardous Materials Division
80 Swan Way, Room 200
Oakland, California 94621

RECEIVED
JUL 26 1988

HAZARDOUS MATERIALS/
WASTE PROGRAM

Attention: Mr. Rafat Shahid

Reference: Shell Service Station
2800 Telegraph Avenue
Oakland, California

Gentlemen:

Enclosed is check #3515 in the amount of \$900.00 to cover the deposit requested in your July 5, 1988 letter to Mr. Stanley J. Roller of Shell Oil Company regarding the referenced location.

Please do not hesitate to call should you have any question or comment.

John P. Werfal

enclosure

cc: Mr. Stanley J. Roller, Shell Oil Company

ALAMEDA COUNTY
HEALTH CARE SERVICES

AGENCY
DAVID J. KEARS, Director



Department of Environmental Health
Hazardous Materials Division
80 Swan Way, Room 200
Oakland, CA 94621

Telephone Number: (415) 271-4320

July 5, 1988

Shell Oil Company
P. O. Box 4023
Concord, CA 94520
Attn: Mr. Stan Roller

SUBJECT: SHELL STATION, 2800 TELEGRAPH, OAKLAND

Dear Mr. Roller:

We are in receipt of your letter dated June 20, 1988, and the accompanying Woodward-Clyde report of June 17, 1988. Before this information can be reviewed, a deposit of \$900.00 must be submitted. This deposit is based upon the removal of five (5) tanks. In addition, the following information is requested concerning:

- (1) the observed conditions of the tanks and the site,
- (2) summary of site work to date and
- (3) manifests on the tanks and disposal site.

Should you have any questions concerning this matter, please contact Mr. Storm Goranson, Hazardous Materials Specialist at 271-4320.

Sincerely,

Rafat A. Shahid, Chief
Hazardous Materials Division

RAS:SG:mam

Shell Oil Company



P.O. Box 4023
Concord, CA 94520

Telephone (415) 676-1414

June 20, 1988

Mr. Rafat A. Shahid
Chief, Hazardous Materials Division
Alameda County Environmental Health Department
80 Swan Way, Room 200
Oakland,, CA 94621 430-4530

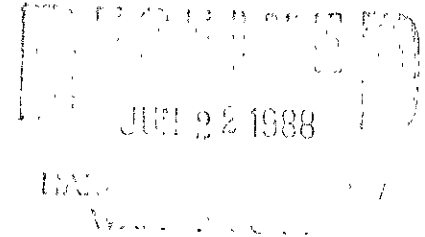

SUBJECT: SHELL SITE
2800 TELEGRAPH
OAKLAND, CA.

Dear Mr. Shahid:

Enclosed is a copy of an Environmental Assessment for the above site completed by Woodward-Clyde Consultants. We will have Woodward-Clyde contact you regarding additional site characterization required to fully define the vertical and lateral extent of the contamination.

Please contact at (415) 676-1414 ext. 127 if you have any questions.

Very truly yours,

A handwritten signature in cursive script, appearing to read "Stanley J. Roller".

Stanley J. Roller
Area Environmental Engineer

cc: REGIONAL WATER QUALITY CONTROL BOARD, GREG ZENTNER
GETTLER-RYAN, INC. JEFF RYAN
EAST BAY DISTRICT MANAGER, KURT FEASEL
EAST BAY DISTRICT ENGINEER, RAY NEWSOME
EAST BAY DISTRICT REAL ESTATE

Enclosure