



Shell Oil Products US

RECEIVED

By dehloptoxic at 8:54 am, Jun 26, 2006

June 23, 2006

Mr. Jerry Wickham
Alameda County Health Care Services Agency
1131 Harbor Bay Parkway, Suite 250
Alameda, California 94502-6577

Subject: Former Shell/Current Operating Service Station
3420 San Pablo Avenue
Oakland, California

Dear Mr. Wickham:

Attached for your review and comment is a copy of the *Groundwater Monitoring Report – Second Quarter 2006 And Well Destruction Report (MW-8)* for the above referenced site. Upon information and belief, I declare, under penalty of perjury, that the information contained in the attached document is true and correct.

As always, please feel free to contact me directly at (707) 865-0251 with any questions or concerns.

Sincerely,

Shell Oil Products US

A handwritten signature in black ink, appearing to read "Denis L. Brown", with a long horizontal flourish extending to the right.

Denis L. Brown
Project Manager

RECEIVED

By dehloptoxic at 8:54 am, Jun 26, 2006

C A M B R I A

June 23, 2006

Mr. Jerry Wickham
Alameda County Health Care Services Agency
1131 Harbor Bay Parkway, Suite 250
Alameda, California 94502-6577

Re: **Groundwater Monitoring Report - Second Quarter 2006
And Well Destruction Report (MW-8)**
Former Shell/Current Operating Service Station
3420 San Pablo Avenue
Oakland, California
SAP Code 139619
Incident No. 98995748
ACEH Fuel Leak Case No. RO0000006



Dear Mr. Wickham:

On behalf of Equilon Enterprises LLC dba Shell Oil Products US (Shell), Cambria Environmental Technology, Inc. (Cambria) is submitting this groundwater monitoring report in accordance with the reporting requirements of 23 CCR 2652d. This report also includes documentation of the destruction of damaged well, MW-8.

HISTORICAL INTERIM REMEDIATION

One-Time Groundwater Extraction: On January 12, 2004, Cambria coordinated a one-time groundwater extraction event, using a vacuum truck to remove separate-phase hydrocarbons (SPH) and groundwater from well MW-6R prior to the monitoring event. Approximately 71 gallons of water with free product were removed in 40 minutes of extraction. After extraction, no SPH was observed in any site wells. Cambria and Blaine Tech Services, Inc. (Blaine) of San Jose, California continue to monitor site conditions for the presence of SPH.

SECOND QUARTER 2006 ACTIVITIES

Blaine gauged and sampled selected site wells, checked well MW-6R for SPH, calculated groundwater elevations, and compiled the analytical data. SPH was detected in MW-6R at a thickness of 0.04. Cambria prepared a vicinity map which includes previously submitted well survey information (Figure 1) and a groundwater contour/chemical concentration map (Figure 2). The repair of cracked wells and destruction of MW-8 appears to have resolved the groundwater mounding observed previously. Blaine's report, presenting the laboratory report and field documents, is included as Appendix A.

Sampling was coordinated with the adjacent Former Thrifty site. Their groundwater monitoring data is shown on Figure 2 and included as Appendix B.

**Cambria
Environmental
Technology, Inc.**

270 Perkins Street
Sonoma, CA 95476
Tel (707) 935-4850
Fax (707) 935-6649

ANTICIPATED THIRD QUARTER 2006 ACTIVITIES

Blaine will coordinate monitoring with the adjacent Thrifty site, gauge and sample selected site wells, and tabulate the data. If SPH is present in MW-6R, Blaine will purge product from the well. Depending on the well's response, additional vacuum truck extraction may be considered. Cambria will prepare a monitoring report.

MW-8 DESTRUCTION



Because well MW-8 was documented to have an unrepairable crack extending at least 6 feet below grade, the well was permitted and scheduled for destruction. Cambria was unable to overdrill the well due to the presence of nearby irrigation line and other utilities. Thus, a waiver was obtained to destroy the well by pressure grouting.

On June 2, 2006, under Alameda County Public Works Agency permit #W2006-0338 (Appendix C), Cambria staff geologist, Bill Deboer oversaw Gregg Drilling of Martinez, California (C-57 License # 485-165).

Gregg filled well MW-8 with neat Portland Type I/II cement grout from the bottom up using tremie pipe. Once the well was completely filled with grout, 25 pounds per square inch of air pressure were applied with a portable air compressor for approximately 15 minutes. After the well was pressurized, the excess space in the well casing was topped off with grout, the well vault was removed, and the void was filled with native soil to match surrounding conditions. Appendix D presents Department of Water Resources (DWR) well completion reports.

C A M B R I A

CLOSING

We appreciate the opportunity to work with you on this project. Please call Ana Friel at (707) 268-3812 if you have any questions or comments.

Sincerely,

Cambria Environmental Technology, Inc

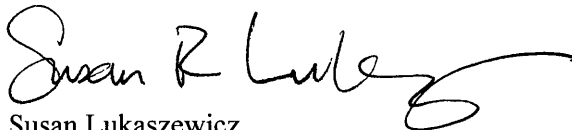

Susan Lukaszewicz
Staff Scientist

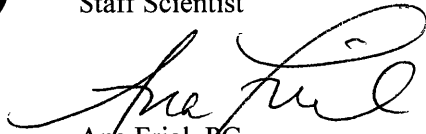

Ana Friel, PG
Associate Geologist

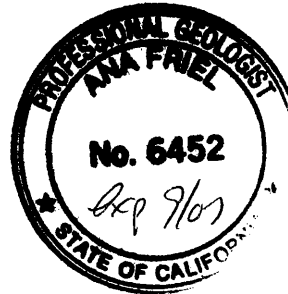

Attachments:

- | | |
|-------------|--|
| Figure 1. | Vicinity/Area Well Survey Map |
| Figure 2. | Groundwater Contour/Chemical Concentration Map |
| Appendix A. | Blaine Groundwater Monitoring Report and Field Notes |
| Appendix B. | Thrifty Groundwater Monitoring Data |
| Appendix C. | Permit |
| Appendix D. | DWR Well Completion Report |

cc: Denis Brown, Shell Oil Products US, 20945 S. Wilmington Ave., Carson, CA 90810
Mr. Shahriar Almasi, Portola Valley Shell
Mike Bowery, Thrifty Oil Co., 13116 Imperial Hwy., Santa Fe Springs, CA 90670

E:\Oakland3420SanPablo\QM\2006\2Q06\2Q06.doc

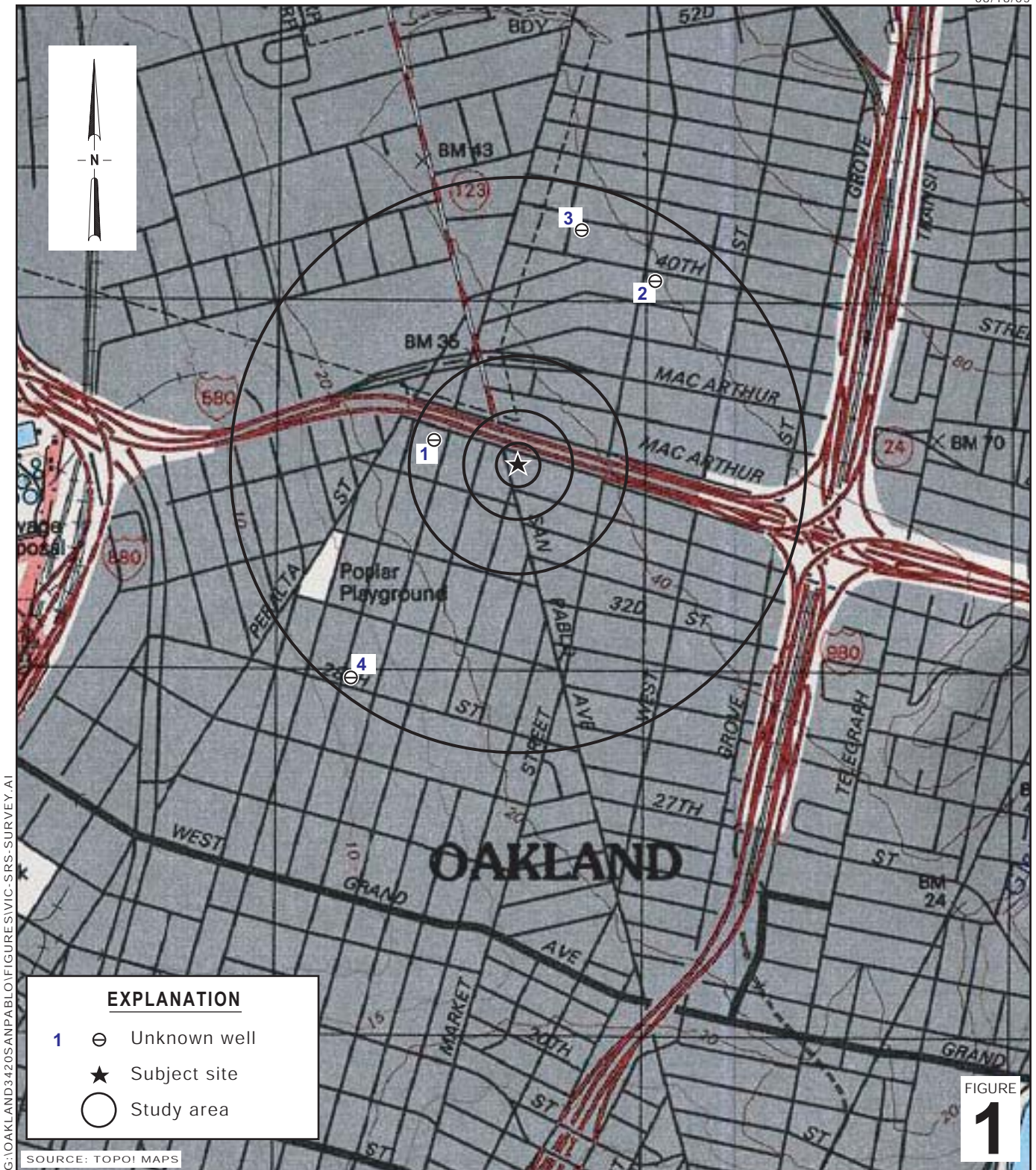

G:\OAKLAND\3420SANPABLO\FIGURES\VIC-SRS-SURVEY.A1

EXPLANATION	
1	⊖ Unknown well
	★ Subject site
	○ Study area

FIGURE 1

0 1/8 1/4 1/2 1
 SCALE : 1" = 1/4 MILE

**Former Shell/
 Current Operating Station**
 3420 San Pablo Avenue
 Oakland, California



**Site Vicinity and Area Well
 Survey Map**
 (1/2 Mile Radius)

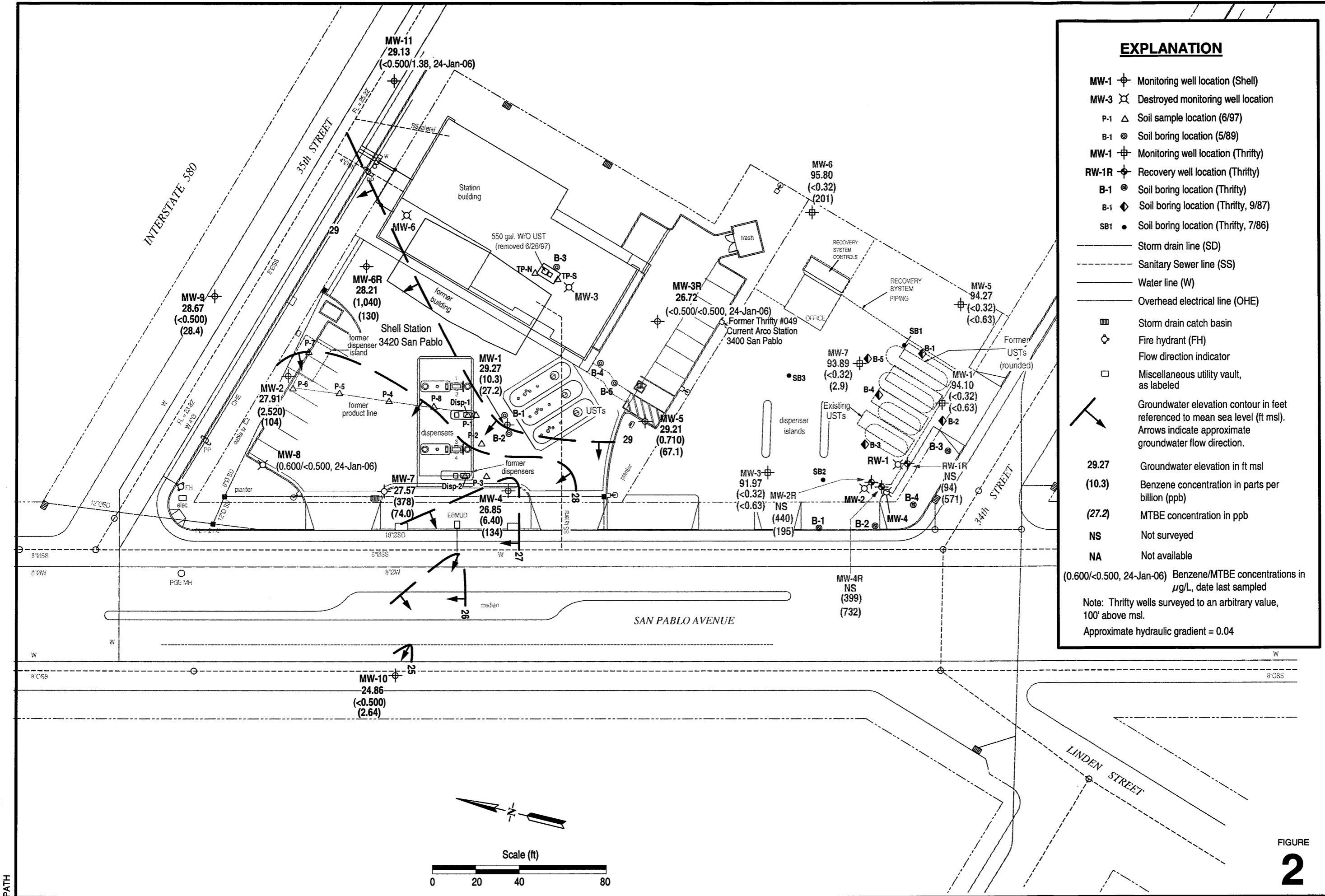

EXPLANATION

- MW-1 ⊕ Monitoring well location (Shell)
- MW-3 ⊗ Destroyed monitoring well location
- P-1 △ Soil sample location (6/97)
- B-1 ⊙ Soil boring location (5/89)
- MW-1 ⊕ Monitoring well location (Thrifty)
- RW-1R ⊕ Recovery well location (Thrifty)
- B-1 ⊙ Soil boring location (Thrifty)
- B-1 ⊕ Soil boring location (Thrifty, 9/87)
- SB1 ● Soil boring location (Thrifty, 7/86)

- Storm drain line (SD)
- - - Sanitary Sewer line (SS)
- Water line (W)
- Overhead electrical line (OHE)

- ▣ Storm drain catch basin
- ⊕ Fire hydrant (FH)
- Flow direction indicator
- Miscellaneous utility vault, as labeled

Groundwater elevation contour in feet referenced to mean sea level (ft msl). Arrows indicate approximate groundwater flow direction.

- 29.27 Groundwater elevation in ft msl
- (10.3) Benzene concentration in parts per billion (ppb)
- (27.2) MTBE concentration in ppb
- NS Not surveyed
- NA Not available

(0.600/<0.500, 24-Jan-06) Benzene/MTBE concentrations in $\mu\text{g/L}$, date last sampled

Note: Thrifty wells surveyed to an arbitrary value, 100' above msl.

Approximate hydraulic gradient = 0.04

FIGURE

2

Scale (ft)

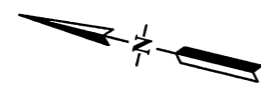

APPENDIX A

Blaine Groundwater Monitoring Report and Field Notes

BLAINE
TECH SERVICES INC.

GROUNDWATER SAMPLING SPECIALISTS
SINCE 1985

May 15, 2006

Denis Brown
Shell Oil Products US
20945 South Wilmington Avenue
Carson, CA 90810

Second Quarter 2006 Groundwater Monitoring at
Former Shell/Current AmeriGas Service Station
3420 San Pablo Avenue
Oakland, CA

Monitoring performed on April 19, 2006

Groundwater Monitoring Report **060419-DR-1**

This report covers the routine monitoring of groundwater wells at this former Shell-branded facility. In accordance with standard procedures that conform to Regional Water Quality Control Board requirements, routine field data collection includes depth to water, total well depth, thickness of any separate immiscible layer, water column volume, calculated purge volume (if applicable), elapsed evacuation time (if applicable), total volume of water removed (if applicable), and standard water parameter instrument readings. Sample material is collected, contained, stored, and transported to the laboratory in conformance with EPA standards. Purgewater (if applicable) is, likewise, collected and transported to the Shell Martinez Manufacturing Complex.

Basic field information is presented alongside analytical values excerpted from the laboratory report in the cumulative table of **WELL CONCENTRATIONS**. The full analytical report for the most recent samples and the field data sheets are attached to this report.

At a minimum, Blaine Tech Services, Inc. field personnel are certified on completion of a forty hour Hazardous Materials and Emergency Response training course per 29 CFR 1910.120. Field personnel are also enrolled in annual eight hour refresher courses.

Blaine Tech Services, Inc. conducts sampling and documentation assignments of this type as an independent third party. Our activities at this site consisted of objective data and sample collection only. No interpretation of analytical results, defining of hydrological conditions or formulation of recommendations was performed.

Please call if you have any questions.

Yours truly,

Mike Ninokata
Project Coordinator

MN/ks

attachments: Cumulative Table of WELL CONCENTRATIONS
Certified Analytical Report
Field Data Sheet

cc: Ana Friel
Cambria Environmental Technology, Inc.
270 Perkins Street
Sonoma, CA 95476

WELL CONCENTRATIONS
Former Shell/Current AmeriGas Service Station
3420 San Pablo Avenue
Oakland, CA

Well ID	Date	TPPH (ug/L)	B (ug/L)	T (ug/L)	E (ug/L)	X (ug/L)	MTBE 8020 (ug/L)	MTBE 8260 (ug/L)	DIPE (ug/L)	ETBE (ug/L)	TAME (ug/L)	TBA (ug/L)	Ethanol (ug/L)	TOC (MSL)	Depth to Water (ft.)	Depth to SPH (ft.)	GW Elevation (MSL)	SPH Thickness (ft.)	DO Reading (ppm)
MW-1	08/06/1991	NA	NA	NA	NA	NA	NA	NA	NA	NA	NA	NA	NA	21.28	10.86	NA	10.43	NA	NA
MW-1	10/23/1991	32,000	2,700	360	550	3,700	NA	NA	NA	NA	NA	NA	NA	21.28	11.05	NA	10.24	0.01	NA
MW-1	01/28/1992	14,000	1,000	106	450	1,600	NA	NA	NA	NA	NA	NA	NA	21.28	10.84	NA	10.44	NA	NA
MW-1	05/05/1992	98,000	11,000	1,200	3,500	18,000	NA	NA	NA	NA	NA	NA	NA	21.28	9.42	NA	11.86	<0.01	NA
MW-1	07/13/1992	11,000	1,100	130	740	1,300	NA	NA	NA	NA	NA	NA	NA	21.28	11.36	NA	9.92	NA	NA
MW-1	10/12/1992	NA	NA	NA	NA	NA	NA	NA	NA	NA	NA	NA	NA	21.28	13.14	NA	8.21	0.09	NA
MW-1	01/12/1993	NA	110	NA	NA	NA	NA	NA	NA	NA	NA	NA	NA	21.28	7.52	NA	13.78	0.02	NA
MW-1	04/06/1993	NA	NA	NA	NA	NA	NA	NA	NA	NA	NA	NA	NA	21.28	7.13	NA	14.16	<0.01	NA
MW-1	07/12/1993	NA	NA	NA	NA	NA	NA	NA	NA	NA	NA	NA	NA	21.28	11.02	NA	10.27	0.01	NA
MW-1	10/13/1993	NA	NA	NA	NA	NA	NA	NA	NA	NA	NA	NA	NA	21.28	12.18	NA	9.11	0.01	NA
MW-1	01/20/1994	NA	NA	NA	NA	NA	NA	NA	NA	NA	NA	NA	NA	21.28	9.18	NA	12.10	0.01	NA
MW-1	04/13/1994	NA	NA	NA	NA	NA	NA	NA	NA	NA	NA	NA	NA	21.28	8.72	NA	12.58	0.02	NA
MW-1	07/19/1994	17,000	420	140	530	1,300	NA	NA	NA	NA	NA	NA	NA	21.28	8.76	NA	12.52	NA	NA
MW-1	10/27/1994	23,000	1,200	130	990	960	NA	NA	NA	NA	NA	NA	NA	21.28	10.49	NA	10.79	NA	NA
MW-1	01/03/1995	31,000	610	160	1,200	5,000	NA	NA	NA	NA	NA	NA	NA	21.28	6.15	NA	15.13	NA	NA
MW-1	04/13/1995	20,000	340	42	680	2,900	NA	NA	NA	NA	NA	NA	NA	21.28	5.24	NA	16.04	NA	NA
MW-1	06/30/1995	16,000	450	62	460	1,200	NA	NA	NA	NA	NA	NA	NA	21.28	7.24	NA	14.04	NA	NA
MW-1	10/11/1995	8,400	660	47	510	850	8,000	NA	NA	NA	NA	NA	NA	21.28	9.48	NA	11.80	NA	NA
MW-1	10/13/1995	7,400	730	54	490	1,100	8,200	NA	NA	NA	NA	NA	NA	21.28	NA	NA	NA	NA	NA
MW-1	01/17/1996	24,000	570	110	820	2,900	15,000	NA	NA	NA	NA	NA	NA	21.28	6.48	NA	14.80	NA	NA
MW-1	04/10/1996	20,000	120	11	420	1,400	15,000	NA	NA	NA	NA	NA	NA	21.28	5.38	NA	15.90	NA	NA
MW-1	07/30/1996	7,900	240	22	170	300	12,000	NA	NA	NA	NA	NA	NA	21.28	7.61	NA	13.67	NA	NA
MW-1	10/17/1996	6,600	1,000	20	120	130	10,000	NA	NA	NA	NA	NA	NA	21.28	8.66	NA	12.62	NA	1.4
MW-1	01/22/1997	13,000	170	<50	330	1,200	18,000	NA	NA	NA	NA	NA	NA	21.28	5.00	NA	16.28	NA	1.6
MW-1	04/01/1997	7,900	240	26	130	200	6,400	NA	NA	NA	NA	NA	NA	21.28	6.42	NA	14.86	NA	1.4
MW-1	07/14/1997	5,000	<20	<20	59	61	9,000	NA	NA	NA	NA	NA	NA	21.28	8.92	NA	12.36	NA	1.9
MW-1	10/08/1997	3,200	180	7.6	18	6.1	11,000	NA	NA	NA	NA	NA	NA	21.28	9.43	NA	11.85	NA	4.8
MW-1	01/19/1998	8,100	39	<20	280	660	1,100	NA	NA	NA	NA	NA	NA	21.28	1.20	NA	20.08	NA	2.6
MW-1	04/28/1998	2,900	62	<10	160	370	1,200	1,200	NA	NA	NA	NA	NA	21.28	4.81	NA	16.47	NA	2.4
MW-1	09/30/1998	1,300	25	8.3	<5.0	12	2,000	NA	NA	NA	NA	NA	NA	21.05	9.90	NA	11.15	NA	1.6
MW-1	12/09/1998	21,000	240	<200	520	920	18,000	18,000	NA	NA	NA	NA	NA	21.05	12.26	NA	8.79	NA	4.3
MW-1	01/18/1999	10,600	<100	<100	471	130	48,600	50,800	NA	NA	NA	NA	NA	21.05	6.00	NA	15.05	NA	1.3

WELL CONCENTRATIONS
Former Shell/Current AmeriGas Service Station
3420 San Pablo Avenue
Oakland, CA

Well ID	Date	TPPH (ug/L)	B (ug/L)	T (ug/L)	E (ug/L)	X (ug/L)	MTBE 8020 (ug/L)	MTBE 8260 (ug/L)	DIPE (ug/L)	ETBE (ug/L)	TAME (ug/L)	TBA (ug/L)	Ethanol (ug/L)	TOC (MSL)	Depth to Water (ft.)	Depth to SPH (ft.)	GW Elevation (MSL)	SPH Thickness (ft.)	DO Reading (ppm)
MW-1	04/12/1999	7,500	101	26.0	248	578	31,000	37,900	NA	NA	NA	NA	NA	21.05	4.00	NA	17.05	NA	1.2
MW-1	07/27/1999	5,420	80.1	<50.0	123	143	24,700	33,200*	NA	NA	NA	NA	NA	21.05	6.18	NA	14.87	NA	1.3
MW-1	10/14/1999	3,750	75.8	<12.5	30.3	37.0	17,200	20,600	NA	NA	NA	NA	NA	21.05	6.83	NA	14.22	NA	1.3
MW-1	01/06/2000	5,550	82.2	<5.00	128	45.4	9,410	8,200	NA	NA	NA	NA	NA	21.05	6.36	NA	14.69	NA	1.3
MW-1	04/05/2000	2,860	50.6	<10.0	98.2	36.2	4,120	3,150*	NA	NA	NA	NA	NA	21.05	3.65	NA	17.40	NA	2.0
MW-1	07/20/2000	3,600	37.9	36.0	34.2	40.4	3,140	3,430*	NA	NA	NA	NA	NA	21.05	4.11	NA	16.94	NA	1.2
MW-1	10/24/2000	2,330	32.3	<10.0	10.5	27.1	4,900	4,500	NA	NA	NA	NA	NA	21.05	5.18	NA	15.87	NA	1.4
MW-1	01/19/2001	2,000	25.9	24.9	12.5	29.7	2,610	3,070	NA	NA	NA	NA	NA	32.01	3.90	NA	28.11	NA	1.8
MW-1	04/27/2001	2,200	14	<2.0	5.3	6.8	NA	1,100	NA	NA	NA	NA	NA	32.01	4.48	NA	27.53	NA	1.5
MW-1	07/26/2001	2,600	26	2.3	<2.0	5.4	NA	890	NA	NA	NA	NA	NA	32.01	6.28	NA	25.73	NA	1.2
MW-1	10/02/2001	1,900	54	<2.0	7.8	14	NA	890	<2.0	<2.0	<2.0	450	<500	32.01	6.53	NA	25.48	NA	1.6
MW-1	01/15/2002	2,300	19	2.8	9.3	12	NA	370	NA	NA	NA	NA	NA	32.01	5.00	NA	27.01	NA	1.9
MW-1	04/17/2002	4,500	20	2.0	1.3	4.6	NA	500	NA	NA	NA	NA	NA	32.01	5.63	NA	26.38	NA	2.4
MW-1	07/11/2002	2,700	25	1.1	<1.0	2.1	NA	500	NA	NA	NA	NA	NA	32.01	6.10	NA	25.91	NA	1.5
MW-1	10/10/2002	2,200	20	1.0	1.8	3.5	NA	580	NA	NA	NA	NA	NA	32.01	6.68	NA	25.33	NA	2.5
MW-1	01/21/2003	3,100	27	12	30	14	NA	810	NA	NA	NA	NA	NA	32.01	4.35	NA	27.66	NA	1.7
MW-1	05/02/2003	4,100	36	<25	<25	<50	NA	1,000	NA	NA	NA	NA	NA	32.01	5.19	NA	26.82	NA	2.1
MW-1	07/10/2003	1,900	37	<12	<12	<25	NA	600	NA	NA	NA	NA	NA	32.01	5.61	NA	26.40	NA	NA
MW-1	10/28/2003	4,300	97	<10	10	<20	NA	1,800	NA	NA	NA	NA	NA	32.01	5.78	NA	26.23	NA	NA
MW-1	01/13/2004	3,000	53	10	29	<10	NA	510	NA	NA	NA	NA	NA	32.01	4.95	NA	27.06	NA	NA
MW-1	04/01/2004	3,000	85	29	11	15	NA	310	NA	NA	NA	NA	NA	32.01	5.05	NA	26.96	NA	NA
MW-1	07/21/2004	3,200	130	19	7.7	18	NA	410	<20	<20	<20	1,100	NA	32.01	5.90	NA	26.11	NA	NA
MW-1	10/20/2004	3,600	200	8.4	12	21	NA	320	NA	NA	NA	NA	NA	32.01	5.63	NA	26.38	NA	NA
MW-1	01/19/2005	2,800	55	<5.0	21	17	NA	170	NA	NA	NA	NA	NA	32.01	4.64	NA	27.37	NA	NA
MW-1	04/20/2005	2,600	28	<5.0	11	<10	NA	140	NA	NA	NA	NA	NA	32.01	3.75	NA	28.26	NA	NA
MW-1	07/20/2005	2,000	20	<1.0	1.6	2.3	NA	110	<4.0	<4.0	<4.0	220	NA	32.01	6.19	NA	25.82	NA	NA
MW-1	10/19/2005	2,200	21	0.80	2.1	1.9	NA	80	NA	NA	NA	NA	NA	32.01	7.20	NA	24.81	NA	NA
MW-1	01/24/2006	7,000	35.5	2.24	119	17.1	NA	80.2	NA	NA	NA	NA	NA	32.01	4.04	NA	27.97	NA	NA
MW-1	04/19/2006	2,030	10.3	1.04	2.44	<0.500	NA	27.2	NA	NA	NA	NA	NA	32.01	2.74	NA	29.27	NA	NA
MW-2	08/06/1991	50,000	15,000	NA	2,700	13,000	NA	NA	NA	NA	NA	NA	NA	21.56	9.72	NA	11.84	NA	NA
MW-2	10/23/1991	120,000	11,000	1,400	3,500	19,000	NA	NA	NA	NA	NA	NA	NA	21.56	10.03	NA	11.53	NA	NA
MW-2	01/28/1992	49,000	7,400	800	1,800	8,300	NA	NA	NA	NA	NA	NA	NA	21.56	8.78	NA	12.78	NA	NA

WELL CONCENTRATIONS
Former Shell/Current AmeriGas Service Station
3420 San Pablo Avenue
Oakland, CA

Well ID	Date	TPPH (ug/L)	B (ug/L)	T (ug/L)	E (ug/L)	X (ug/L)	MTBE 8020 (ug/L)	MTBE 8260 (ug/L)	DIPE (ug/L)	ETBE (ug/L)	TAME (ug/L)	TBA (ug/L)	Ethanol (ug/L)	TOC (MSL)	Depth to Water (ft.)	Depth to SPH (ft.)	GW Elevation (MSL)	SPH Thickness (ft.)	DO Reading (ppm)
MW-2	05/05/1992	52,000	12,000	1,100	2,200	12,000	NA	NA	NA	NA	NA	NA	NA	21.56	7.58	NA	13.98	NA	NA
MW-2	07/13/1992	47,000	15,000	2,400	4,500	16,000	NA	NA	NA	NA	NA	NA	NA	21.56	9.63	NA	11.93	NA	NA
MW-2	10/12/1992	NA	NA	NA	NA	NA	NA	NA	NA	NA	NA	NA	NA	21.56	11.66	NA	9.92	0.03	NA
MW-2	01/12/1993	NA	NA	NA	NA	NA	NA	NA	NA	NA	NA	NA	NA	21.56	7.13	NA	14.44	0.01	NA
MW-2	04/06/1993	NA	NA	NA	NA	NA	NA	NA	NA	NA	NA	NA	NA	21.56	6.40	NA	15.17	<0.01	NA
MW-2	07/12/1993	59,000	12,000	950	2,400	11,000	NA	NA	NA	NA	NA	NA	NA	21.56	8.75	NA	12.81	NA	NA
MW-2	10/13/1993	54,000	14,000	1,200	3,700	22,000	NA	NA	NA	NA	NA	NA	NA	21.56	10.28	NA	11.28	NA	NA
MW-2	01/20/1994	NA	NA	NA	NA	NA	NA	NA	NA	NA	NA	NA	NA	21.56	NA	NA	NA	NA	NA
MW-2	04/13/1994	79,000	9,400	740	2,100	12,000	NA	NA	NA	NA	NA	NA	NA	21.56	7.35	NA	14.22	<0.01	NA
MW-2	07/19/1994	63,000	13,000	810	1,900	13,000	NA	NA	NA	NA	NA	NA	NA	21.56	8.24	NA	13.32	NA	NA
MW-2	10/27/1994	64,000	8,800	480	2,100	10,000	NA	NA	NA	NA	NA	NA	NA	21.56	10.26	NA	13.32	NA	NA
MW-2	01/03/1995	67,000	9,800	720	2,800	11,000	NA	NA	NA	NA	NA	NA	NA	21.56	6.44	NA	15.12	NA	NA
MW-2	04/13/1995	83,000	10,000	490	2,600	13,000	NA	NA	NA	NA	NA	NA	NA	21.56	5.89	NA	15.67	NA	NA
MW-2	06/30/1995	65,000	12,000	1,800	2,400	12,000	NA	NA	NA	NA	NA	NA	NA	21.56	7.41	NA	14.15	NA	NA
MW-2	10/11/1995	68,000	8,800	840	3,000	13,000	1,400	NA	NA	NA	NA	NA	NA	21.56	8.02	NA	13.54	NA	NA
MW-2	01/17/1996	79,000	12,000	640	2,700	14,000	2,200	NA	NA	NA	NA	NA	NA	21.56	7.42	NA	14.14	NA	NA
MW-2	04/10/1996	84,000	7,200	310	1,700	7,800	2,900	NA	NA	NA	NA	NA	NA	21.56	6.91	NA	14.65	NA	NA
MW-2	07/30/1996	26,000	6,800	210	1,300	5,500	4,500	NA	NA	NA	NA	NA	NA	21.56	7.63	NA	13.93	NA	NA
MW-2	10/17/1996	46,000	9,800	340	2,000	6,500	4,900	NA	NA	NA	NA	NA	NA	21.56	8.27	NA	13.29	NA	1.8
MW-2	01/22/1997	52,000	6,200	220	1,400	6,600	3,000	NA	NA	NA	NA	NA	NA	21.56	7.09	NA	14.47	NA	1.9
MW-2	04/01/1997	69,000	6,000	380	2,400	11,000	3,800	NA	NA	NA	NA	NA	NA	21.56	6.91	NA	14.65	NA	2.0
MW-2	07/14/1997	53,000	7,700	260	1,600	5,200	2,400	NA	NA	NA	NA	NA	NA	21.56	9.93	NA	11.63	NA	1.2
MW-2	10/08/1997	56,000	8,500	320	1,600	5,100	4,200	NA	NA	NA	NA	NA	NA	21.56	10.43	NA	11.13	NA	2.1
MW-2	01/19/1998	64,000	10,000	230	2,400	12,000	2,700	NA	NA	NA	NA	NA	NA	21.56	3.60	NA	17.96	NA	2.4
MW-2	04/28/1998	45,000	9,800	310	2,700	11,000	2,400	2,000	NA	NA	NA	NA	NA	21.56	4.81	NA	15.71	NA	2
MW-2	09/30/1998	42,000	7,400	200	2,600	9,800	1,800	NA	NA	NA	NA	NA	NA	21.58	7.20	NA	14.38	NA	1.6
MW-2	12/09/1998	60,000	7,000	270	1,600	7,000	2,100	NA	NA	NA	NA	NA	NA	21.58	7.11	NA	14.47	NA	4.6
MW-2	01/18/1999	45,000	7,960	151	1,750	6,410	1,310	NA	NA	NA	NA	NA	NA	21.58	6.83	NA	14.75	NA	1.8
MW-2	04/12/1999	47,400	7,680	131	1,840	6,400	<1,000	NA	NA	NA	NA	NA	NA	21.58	5.90	NA	15.68	NA	1.9
MW-2	07/27/1999	36,400	6,750	83.5	1,590	5,070	682	NA	NA	NA	NA	NA	NA	21.58	6.56	NA	15.02	NA	2.0
MW-2	10/14/1999	45,300	6,990	144	1,850	4,930	1,070	NA	NA	NA	NA	NA	NA	21.58	8.90	NA	12.68	NA	1.5
MW-2	01/06/2000	44,100	5,820	107	1,720	4,590	841	NA	NA	NA	NA	NA	NA	21.58	7.27	NA	14.31	NA	1.4
MW-2	04/05/2000	32,000	6,680	<100	1,770	4,030	934	NA	NA	NA	NA	NA	NA	21.58	5.32	NA	16.26	NA	1.3

WELL CONCENTRATIONS
Former Shell/Current AmeriGas Service Station
3420 San Pablo Avenue
Oakland, CA

Well ID	Date	TPPH (ug/L)	B (ug/L)	T (ug/L)	E (ug/L)	X (ug/L)	MTBE 8020 (ug/L)	MTBE 8260 (ug/L)	DIPE (ug/L)	ETBE (ug/L)	TAME (ug/L)	TBA (ug/L)	Ethanol (ug/L)	TOC (MSL)	Depth to Water (ft.)	Depth to SPH (ft.)	GW Elevation (MSL)	SPH Thickness (ft.)	DO Reading (ppm)
MW-2	07/20/2000	32,100	5,290	68.6	1,870	3,810	254	NA	NA	NA	NA	NA	NA	21.58	5.47	NA	16.11	NA	2.9
MW-2	10/24/2000	24,400	4,680	<50.0	1,460	2,380	682	NA	NA	NA	NA	NA	NA	21.58	5.88	NA	15.70	NA	2.2
MW-2	01/19/2001	29,200	4,980	127	2,820	4,320	<500	NA	NA	NA	NA	NA	NA	32.54	5.96	NA	26.58	NA	1.4
MW-2	04/27/2001	40,000	5,400	67	2,800	5,100	NA	380	NA	NA	NA	NA	NA	32.54	5.87	NA	26.67	NA	1.1
MW-2	07/26/2001	42,000	4,700	59	2,800	4,300	NA	<250	NA	NA	NA	NA	NA	32.54	6.48	NA	26.06	NA	1.0
MW-2	10/02/2001	36,000	4,200	64	2,400	2,700	NA	<200	NA	NA	NA	NA	NA	32.54	6.65	NA	25.89	NA	1.6
MW-2	01/15/2002	39,000	4,100	46	2,200	2,300	NA	280	NA	NA	NA	NA	NA	32.54	5.81	NA	26.73	NA	1.8
MW-2	04/17/2002	30,000	3,800	44	2,100	2,100	NA	270	NA	NA	NA	NA	NA	32.54	6.03	NA	26.51	NA	1.6
MW-2	07/11/2002	34,000	3,600	18	2,700	2,200	NA	110	NA	NA	NA	NA	NA	32.54	6.49	NA	26.05	NA	2.7
MW-2	10/10/2002	26,000	2,600	19	1,900	810	NA	<100	NA	NA	NA	NA	NA	32.54	6.82	NA	25.72	NA	2.4
MW-2	01/21/2003	30,000	3,000	24	2,000	1,400	NA	140	NA	NA	NA	NA	NA	32.54	6.00	NA	26.54	NA	1.6
MW-2	05/02/2003	23,000	2,800	28	1,400	880	NA	<250	NA	NA	NA	NA	NA	32.54	5.85	NA	26.69	NA	1.7
MW-2	07/10/2003	20,000	3,800	<50	2,500	1,500	NA	180	NA	NA	NA	NA	NA	32.54	6.16	NA	26.38	NA	NA
MW-2	10/28/2003	35,000	5,400	59	2,800	1,400	NA	140	NA	NA	NA	NA	NA	32.54	6.30	NA	26.24	NA	NA
MW-2	01/13/2004	39,000	6,400	55	3,000	1,400	NA	240	NA	NA	NA	NA	NA	32.54	5.93	NA	26.61	NA	NA
MW-2	04/01/2004	29,000	4,200	<50	2,300	1,000	NA	140	NA	NA	NA	NA	NA	32.54	5.99	NA	26.55	NA	NA
MW-2	07/21/2004	43,000	3,900	<50	2,700	860	NA	93	<200	<200	<200	<500	NA	32.54	6.05	NA	26.49	NA	NA
MW-2	10/20/2004	33,000	5,100	<50	2,800	950	NA	97	NA	NA	NA	NA	NA	32.54	6.10	NA	26.44	NA	NA
MW-2	01/19/2005	27,000	3,400	<50	2,000	580	NA	120	NA	NA	NA	NA	NA	32.54	5.41	NA	27.13	NA	NA
MW-2	04/20/2005	37,000	3,400	<50	1,900	580	NA	110	NA	NA	NA	NA	NA	32.54	5.86	NA	26.68	NA	NA
MW-2	07/20/2005	33,000	3,900	<50	2,300	590	NA	86	<200	<200	<200	<500	NA	32.54	8.39	NA	24.15	NA	NA
MW-2	10/19/2005	12,000	2,100	15	1,500	430	NA	80	NA	NA	NA	NA	NA	32.54	7.96	NA	24.58	NA	NA
MW-2	01/24/2006	44,600	3,260	20.3	2,220	458	NA	107	NA	NA	NA	NA	NA	32.54	4.54	NA	28.00	NA	NA
MW-2	04/19/2006	<2,500	2,520	13.2	1,610	343	NA	104	NA	NA	NA	NA	NA	32.54	4.63	NA	27.91	NA	NA

MW-3	08/06/1991	430	8	1	4	15	NA	NA	NA	NA	NA	NA	NA	21.78	11.18	NA	10.60	NA	NA
MW-3	10/23/1991	390	2.10	<0.3	0.48	2	NA	NA	NA	NA	NA	NA	NA	21.78	11.69	NA	10.09	NA	NA
MW-3	01/28/1992	190	<0.5	<0.5	<0.5	<0.5	NA	NA	NA	NA	NA	NA	NA	21.78	9.99	NA	11.79	NA	NA
MW-3	05/04/1992	190	<1	<1	<1	0.71	NA	NA	NA	NA	NA	NA	NA	21.78	9.46	NA	12.32	NA	NA
MW-3	07/20/1992	200a	<0.5	<0.5	<0.5	<0.5	NA	NA	NA	NA	NA	NA	NA	21.78	11.29	NA	10.49	NA	NA
MW-3	10/12/1992	180a	<0.5	<0.5	<0.5	<0.5	NA	NA	NA	NA	NA	NA	NA	21.78	13.10	NA	8.68	NA	NA
MW-3	01/12/1993	180	<0.5	2.3	0.9	5.6	NA	NA	NA	NA	NA	NA	NA	21.78	7.32	NA	14.46	NA	NA
MW-3	04/06/1993	280	<0.5	<0.5	<0.5	<0.5	NA	NA	NA	NA	NA	NA	NA	21.78	7.44	NA	14.34	NA	NA

WELL CONCENTRATIONS
Former Shell/Current AmeriGas Service Station
3420 San Pablo Avenue
Oakland, CA

Well ID	Date	TPPH (ug/L)	B (ug/L)	T (ug/L)	E (ug/L)	X (ug/L)	MTBE 8020 (ug/L)	MTBE 8260 (ug/L)	DIPE (ug/L)	ETBE (ug/L)	TAME (ug/L)	TBA (ug/L)	Ethanol (ug/L)	TOC (MSL)	Depth to Water (ft.)	Depth to SPH (ft.)	GW Elevation (MSL)	SPH Thickness (ft.)	DO Reading (ppm)
MW-3	07/12/1993	310a	<0.5	<0.5	<0.5	<0.5	NA	NA	NA	NA	NA	NA	NA	21.78	10.62	NA	11.16	NA	NA
MW-3	10/13/1993	150	<0.5	<0.5	<0.5	<0.5	NA	NA	NA	NA	NA	NA	NA	21.78	12.05	NA	9.73	NA	NA
MW-3	01/20/1994	180	<0.5	<0.5	<0.5	<0.5	NA	NA	NA	NA	NA	NA	NA	21.78	9.62	NA	12.16	NA	NA
MW-3	04/13/1994	270	<0.5	<0.5	<0.5	<0.5	NA	NA	NA	NA	NA	NA	NA	21.78	9.15	NA	12.63	NA	NA
MW-3	07/19/1994	190a	<0.5	<0.5	<0.5	<0.5	NA	NA	NA	NA	NA	NA	NA	21.78	10.13	NA	11.65	NA	NA
MW-3	10/27/1994	160a	<0.5	<0.5	<0.5	<0.5	NA	NA	NA	NA	NA	NA	NA	21.78	11.66	NA	10.12	NA	NA
MW-3	01/03/1995	100a	<0.5	<0.5	<0.5	<0.5	NA	NA	NA	NA	NA	NA	NA	21.78	6.89	NA	14.89	NA	NA
MW-3	04/13/1995	120a	<0.5	<0.5	<0.5	<0.5	NA	NA	NA	NA	NA	NA	NA	21.78	6.79	NA	14.99	NA	NA
MW-3	06/30/1995	180a	<0.5	<0.5	<0.5	<0.5	NA	NA	NA	NA	NA	NA	NA	21.78	8.94	NA	12.84	NA	NA
MW-3	10/11/1995	150	2.2	<0.5	<0.5	<0.5	2.3	NA	NA	NA	NA	NA	NA	21.78	10.62	NA	11.16	NA	NA
MW-3	01/17/1996	120	<0.5	<0.5	<0.5	<0.5	7.8	NA	NA	NA	NA	NA	NA	21.78	7.18	NA	14.60	NA	NA
MW-3	04/10/1996	160	<0.5	<0.5	<0.5	<0.5	12	NA	NA	NA	NA	NA	NA	21.78	6.76	NA	15.02	NA	NA
MW-3	07/30/1996	57	<0.5	<0.5	<0.5	<0.5	<2.5	NA	NA	NA	NA	NA	NA	21.78	9.04	NA	12.74	NA	NA
MW-3	10/17/1996	<50	<0.5	<0.5	<0.5	<0.5	<2.5	NA	NA	NA	NA	NA	NA	21.78	9.04	NA	12.74	NA	2.0
MW-3	01/22/1997	<50	<0.5	<0.5	<0.5	<0.5	3.7	NA	NA	NA	NA	NA	NA	21.78	5.03	NA	16.75	NA	2.4
MW-3	04/01/1997	71	<0.50	<0.50	<0.50	<0.50	NA b	NA	NA	NA	NA	NA	NA	21.78	8.23	NA	13.55	NA	1.6
MW-3	07/14/1997	<50	<0.50	<0.50	<0.50	1.5	NA b	NA	NA	NA	NA	NA	NA	21.78	9.09	NA	12.69	NA	1.9
MW-3	10/08/1997	73	<0.50	<0.50	<0.50	<0.50	NA b	NA	NA	NA	NA	NA	NA	21.78	10.23	NA	11.55	NA	5.5
MW-3	12/05/1997	Abandoned																	

MW-3R	04/06/1999	NA	NA	NA	NA	NA	NA	NA	NA	NA	NA	NA	NA	21.83	9.89	NA	11.94	NA	NA
MW-3R	04/12/1999	<50.0	<0.500	<0.500	<0.500	<0.500	<5.00	NA	NA	NA	NA	NA	NA	21.83	5.83	NA	16.00	NA	2.1
MW-3R	07/27/1999	<50.0	<0.500	<0.500	<0.500	<0.500	4.15	NA	NA	NA	NA	NA	NA	21.83	9.59	NA	12.24	NA	2.0
MW-3R	10/14/1999	<50.0	<0.500	<0.500	<0.500	<0.500	9.43	NA	NA	NA	NA	NA	NA	21.83	10.00	NA	11.83	NA	0.6
MW-3R	01/06/2000	78	<0.500	<0.500	<0.500	<0.500	31	NA	NA	NA	NA	NA	NA	21.83	9.71	NA	12.12	NA	0.8
MW-3R	04/05/2000	<50.0	<0.500	<0.500	<0.500	<0.500	273	2,890*	NA	NA	NA	NA	NA	21.83	6.90	NA	14.93	NA	1.5
MW-3R	07/20/2000	<50.0	<0.500	<0.500	<0.500	<0.500	<2.50	NA	NA	NA	NA	NA	NA	21.83	6.94	NA	14.89	NA	1.1
MW-3R	10/24/2000	NA	NA	NA	NA	NA	NA	NA	NA	NA	NA	NA	NA	21.83	8.90	NA	12.93	NA	NA
MW-3R	01/19/2001	<50.0	<0.500	<0.500	<0.500	<0.500	79.2	NA	NA	NA	NA	NA	NA	32.79	7.04	NA	25.75	NA	2.0
MW-3R	04/27/2001	NA	NA	NA	NA	NA	NA	NA	NA	NA	NA	NA	NA	32.79	7.38	NA	25.41	NA	NA
MW-3R	07/26/2001	97	<0.50	<0.50	<0.50	<0.50	NA	200	NA	NA	NA	NA	NA	32.79	9.30	NA	23.49	NA	1.8
MW-3R	10/02/2001	NA	NA	NA	NA	NA	NA	NA	NA	NA	NA	NA	NA	32.79	9.41	NA	23.38	NA	NA
MW-3R	01/15/2002	55	<0.50	<0.50	<0.50	<0.50	NA	32	NA	NA	NA	NA	NA	32.79	6.05	NA	26.74	NA	0.7

WELL CONCENTRATIONS
Former Shell/Current AmeriGas Service Station
3420 San Pablo Avenue
Oakland, CA

Well ID	Date	TPPH (ug/L)	B (ug/L)	T (ug/L)	E (ug/L)	X (ug/L)	MTBE 8020 (ug/L)	MTBE 8260 (ug/L)	DIPE (ug/L)	ETBE (ug/L)	TAME (ug/L)	TBA (ug/L)	Ethanol (ug/L)	TOC (MSL)	Depth to Water (ft.)	Depth to SPH (ft.)	GW Elevation (MSL)	SPH Thickness (ft.)	DO Reading (ppm)
MW-3R	04/17/2002	NA	NA	NA	NA	NA	NA	NA	NA	NA	NA	NA	NA	32.79	7.70	NA	25.09	NA	NA
MW-3R	07/11/2002	110	<0.50	<0.50	<0.50	<0.50	NA	65	NA	NA	NA	NA	NA	32.79	8.76	NA	24.03	NA	2.5
MW-3R	10/10/2002	NA	NA	NA	NA	NA	NA	NA	NA	NA	NA	NA	NA	32.79	9.65	NA	23.14	NA	NA
MW-3R	01/21/2003	65	<0.50	<0.50	<0.50	<0.50	NA	13	NA	NA	NA	NA	NA	32.79	5.21	NA	27.58	NA	1.6
MW-3R	05/02/2003	NA	NA	NA	NA	NA	NA	NA	NA	NA	NA	NA	NA	32.79	6.08	NA	26.71	NA	NA
MW-3R	07/10/2003	<50	<0.50	<0.50	<0.50	<1.0	NA	11	NA	NA	NA	NA	NA	32.79	8.20	NA	24.59	NA	NA
MW-3R	10/28/2003	NA	NA	NA	NA	NA	NA	NA	NA	NA	NA	NA	NA	32.79	8.57	NA	24.22	NA	NA
MW-3R	01/13/2004	<50	<0.50	<0.50	<0.50	<1.0	NA	3.9	NA	NA	NA	NA	NA	32.79	5.79	NA	27.00	NA	NA
MW-3R	04/01/2004	NA	NA	NA	NA	NA	NA	NA	NA	NA	NA	NA	NA	32.79	7.22	NA	25.57	NA	NA
MW-3R	07/21/2004	<50	<0.50	<0.50	<0.50	<1.0	NA	2.7	<2.0	<2.0	<2.0	<5.0	NA	32.79	8.55	NA	24.24	NA	NA
MW-3R	10/20/2004	NA	NA	NA	NA	NA	NA	NA	NA	NA	NA	NA	NA	32.79	8.30	NA	24.49	NA	NA
MW-3R	01/19/2005	<50	<0.50	<0.50	<0.50	<1.0	NA	2.0	NA	NA	NA	NA	NA	32.79	6.10	NA	26.69	NA	NA
MW-3R	04/20/2005	NA	NA	NA	NA	NA	NA	NA	NA	NA	NA	NA	NA	32.79	6.41	NA	26.38	NA	NA
MW-3R	07/20/2005	<50	<0.50	<0.50	<0.50	<1.0	NA	2.9	<2.0	<2.0	<2.0	<5.0	NA	32.79	8.76	NA	24.03	NA	NA
MW-3R	10/19/2005	NA	NA	NA	NA	NA	NA	NA	NA	NA	NA	NA	NA	32.79	9.87	NA	22.92	NA	NA
MW-3R	01/24/2006	<50.0	<0.500	<0.500	<0.500	<0.500	NA	<0.500	NA	NA	NA	NA	NA	32.79	5.96	NA	26.83	NA	NA
MW-3R	04/19/2006	NA	NA	NA	NA	NA	NA	NA	NA	NA	NA	NA	NA	32.79	6.07	NA	26.72	NA	NA
MW-4	08/06/1991	1,300	28	18	68	150	NA	NA	NA	NA	NA	NA	NA	20.31	10.57	NA	9.74	NA	NA
MW-4	10/23/1991	1,900	97	6.10	38	77	NA	NA	NA	NA	NA	NA	NA	20.31	10.46	NA	9.85	NA	NA
MW-4	01/28/1992	200	7.60	<0.5	3	3.30	NA	NA	NA	NA	NA	NA	NA	20.31	9.54	NA	10.77	NA	NA
MW-4	05/04/1992	690	98	3	13	<1	NA	NA	NA	NA	NA	NA	NA	20.31	8.33	NA	11.98	NA	NA
MW-4	07/13/1992	1,500	140	2.90	17	12	NA	NA	NA	NA	NA	NA	NA	20.31	9.87	NA	10.44	NA	NA
MW-4	10/12/1992	NA	NA	NA	NA	NA	NA	NA	NA	NA	NA	NA	NA	20.31	12.43	NA	8.50	0.78	NA
MW-4	01/12/1993	NA	NA	NA	NA	NA	NA	NA	NA	NA	NA	NA	NA	20.31	7.12	NA	13.99	1.00	NA
MW-4	04/06/1993	NA	NA	NA	NA	NA	NA	NA	NA	NA	NA	NA	NA	20.31	7.23	NA	13.84	0.95	NA
MW-4	07/12/1993	NA	NA	NA	NA	NA	NA	NA	NA	NA	NA	NA	NA	20.31	10.08	NA	10.25	0.03	NA
MW-4	10/13/1993	NA	NA	NA	NA	NA	NA	NA	NA	NA	NA	NA	NA	20.31	11.35	NA	9.06	0.12	NA
MW-4	01/20/1994	NA	NA	NA	NA	NA	NA	NA	NA	NA	NA	NA	NA	20.31	9.06	NA	11.26	0.02	NA
MW-4	04/13/1994	NA	NA	NA	NA	NA	NA	NA	NA	NA	NA	NA	NA	20.31	8.58	NA	11.74	0.01	NA
MW-4	07/19/1994	12,000	230	43	230	660	NA	NA	NA	NA	NA	NA	NA	20.31	9.71	NA	10.60	NA	NA
MW-4	10/27/1994	NA	NA	NA	NA	NA	NA	NA	NA	NA	NA	NA	NA	20.31	10.60	NA	9.73	0.03	NA
MW-4	01/03/1995	NA	NA	NA	NA	NA	NA	NA	NA	NA	NA	NA	NA	20.31	5.49	NA	14.83	0.01	NA

WELL CONCENTRATIONS
Former Shell/Current AmeriGas Service Station
3420 San Pablo Avenue
Oakland, CA

Well ID	Date	TPPH (ug/L)	B (ug/L)	T (ug/L)	E (ug/L)	X (ug/L)	MTBE 8020 (ug/L)	MTBE 8260 (ug/L)	DIPE (ug/L)	ETBE (ug/L)	TAME (ug/L)	TBA (ug/L)	Ethanol (ug/L)	TOC (MSL)	Depth to Water (ft.)	Depth to SPH (ft.)	GW Elevation (MSL)	SPH Thickness (ft.)	DO Reading (ppm)
MW-4	04/13/1995	NA	NA	NA	NA	NA	NA	NA	NA	NA	NA	NA	NA	20.31	6.53	NA	13.80	0.03	NA
MW-4	06/30/1995	7,400	140	<0.5	160	350	NA	NA	NA	NA	NA	NA	NA	20.31	9.57	NA	10.74	NA	NA
MW-4	10/11/1995	3,000	29	10	100	82	9,700	NA	NA	NA	NA	NA	NA	20.31	10.30	NA	10.01	NA	NA
MW-4	01/17/1996	9,700	190	<0.5	190	410	4,500	NA	NA	NA	NA	NA	NA	20.31	6.68	NA	13.63	NA	NA
MW-4	04/10/1996	2,800	16	<0.5	22	50	6,100	NA	NA	NA	NA	NA	NA	20.31	7.90	NA	12.41	NA	NA
MW-4	07/30/1996	1,600	68	<12	58	39	8,500	NA	NA	NA	NA	NA	NA	20.31	8.73	NA	11.58	NA	2.8
MW-4	10/17/1996	4,800	120	<25	150	96	11,000	NA	NA	NA	NA	NA	NA	20.31	7.63	NA	10.34	NA	2.8
MW-4	01/22/1997	12,000	83	<20	170	240	4,300	NA	NA	NA	NA	NA	NA	20.31	5.26	NA	15.05	NA	2.6
MW-4	04/01/1997	4,800	65	<5.0	81	93	3,200	NA	NA	NA	NA	NA	NA	20.31	8.02	NA	12.29	NA	2.4
MW-4	07/14/1997	2,400	35	<10	30	20	6,000	NA	NA	NA	NA	NA	NA	20.31	10.05	NA	10.26	NA	2.0
MW-4	10/08/1997	2,900	66	<20	<20	<20	7,300	NA	NA	NA	NA	NA	NA	20.31	10.22	NA	10.09	NA	5.9
MW-4	01/19/1998	Inaccessible		NA	NA	NA	NA	NA	NA	NA	NA	NA	NA	20.31	NA	NA	NA	NA	NA
MW-4	04/28/1998	Inaccessible		NA	NA	NA	NA	NA	NA	NA	NA	NA	NA	20.31	NA	NA	NA	NA	NA
MW-4	09/30/1998	1,300	57	8.7	58	37	3,600	NA	NA	NA	NA	NA	NA	20.92	9.31	NA	11.61	NA	2.9
MW-4	12/09/1998	3,500	130	<5.0	100	36	3,200	4,500	NA	NA	NA	NA	NA	20.92	9.30	NA	11.62	NA	2.2
MW-4	01/18/1999	7,040	321	<25.0	273	<25.0	4,830	4,660	NA	NA	NA	NA	NA	20.92	8.60	NA	12.32	NA	2.3
MW-4	04/12/1999	1,540	47.6	<10.0	24.4	<10.0	2,760	NA	NA	NA	NA	NA	NA	20.92	6.25	NA	14.67	NA	1.9
MW-4	07/27/1999	3,570	214	<25.0	58.3	31.0	5,440	7,280*	NA	NA	NA	NA	NA	20.92	9.33	NA	11.59	NA	1.9
MW-4	10/14/1999	3,920	157	<25.0	103	<25.0	6,550	8,990	NA	NA	NA	NA	NA	20.92	9.93	NA	10.99	NA	1.7
MW-4	01/06/2000	5,030	247	7.2	169	37.7	6,860	7,400	NA	NA	NA	NA	NA	20.92	9.31	NA	11.61	NA	1.7
MW-4	04/05/2000	1,870	120	<5.00	15.1	<5.00	4,400	2,890*	NA	NA	NA	NA	NA	20.92	6.00	NA	14.92	NA	1.8
MW-4	07/20/2000	6,740	114	36.4	71.9	28.2	1,900	NA	NA	NA	NA	NA	NA	20.92	6.10	NA	14.82	NA	2.1
MW-4	10/24/2000	2,120	108	8.28	12.5	<5.00	6,070	5,950	NA	NA	NA	NA	NA	20.92	8.90	NA	12.02	NA	1.1
MW-4	01/19/2001	3,330	67.2	<5.00	7.18	<5.00	3,620	4,330	NA	NA	NA	NA	NA	31.88	7.25	NA	24.63	NA	1.8
MW-4	04/27/2001	1,600	79	<10	<10	<10	NA	3,900	NA	NA	NA	NA	NA	31.88	7.41	NA	24.47	NA	1.4
MW-4	07/26/2001	2,700	140	<20	24	<20	NA	4,700	NA	NA	NA	NA	NA	31.88	8.20	NA	23.68	NA	1.8
MW-4	10/02/2001	4,600	170	<10	50	<10	NA	6,300	<10	<10	<10	2,600	<500	31.88	8.55	NA	23.33	NA	2.1
MW-4	01/15/2002	1,000	34	<5.0	<5.0	9.8	NA	2,800	NA	NA	NA	NA	NA	31.88	6.53	NA	25.35	NA	2.7
MW-4	04/17/2002	1,400	92	<10	<10	11	NA	4,100	NA	NA	NA	NA	NA	31.88	7.00	NA	24.88	NA	2.4
MW-4	07/11/2002	1,800	82	<10	<10	11	NA	4,500	NA	NA	NA	NA	NA	31.88	8.49	NA	23.39	NA	2.1
MW-4	10/10/2002	7,400	230	<10	45	<10	NA	6,600	NA	NA	NA	NA	NA	31.88	9.05	NA	22.83	NA	2.5
MW-4	01/21/2003	1,400	27	<2.5	<2.5	<2.5	NA	1,200	NA	NA	NA	NA	NA	31.88	6.50	NA	25.38	NA	0.4
MW-4	05/02/2003	<2,500	80	<25	<25	<50	NA	2,500	NA	NA	NA	NA	NA	31.88	6.97	NA	24.91	NA	1.3

WELL CONCENTRATIONS
Former Shell/Current AmeriGas Service Station
3420 San Pablo Avenue
Oakland, CA

Well ID	Date	TPPH (ug/L)	B (ug/L)	T (ug/L)	E (ug/L)	X (ug/L)	MTBE 8020 (ug/L)	MTBE 8260 (ug/L)	DIPE (ug/L)	ETBE (ug/L)	TAME (ug/L)	TBA (ug/L)	Ethanol (ug/L)	TOC (MSL)	Depth to Water (ft.)	Depth to SPH (ft.)	GW Elevation (MSL)	SPH Thickness (ft.)	DO Reading (ppm)
MW-4	07/10/2003	<2,500	93	<25	<25	<50	NA	2,800	NA	NA	NA	NA	NA	31.88	7.74	NA	24.14	NA	NA
MW-4	10/28/2003	4,000	120	<10	<10	<20	NA	2,100	NA	NA	NA	NA	NA	31.88	8.43	NA	23.45	NA	NA
MW-4	01/13/2004	2,000	45	<5.0	<5.0	<10	NA	620	NA	NA	NA	NA	NA	31.88	6.75	NA	25.13	NA	NA
MW-4	04/01/2004	1,400	17	<2.5	<2.5	<5.0	NA	540	NA	NA	NA	NA	NA	31.88	6.40	NA	25.48	NA	NA
MW-4	07/21/2004	3,100	120	<2.5	11	<5.0	NA	900	<10	<10	<10	2,200	NA	31.88	8.23	NA	23.65	NA	NA
MW-4	10/20/2004	3,600	97	<2.5	9.7	<5.0	NA	470	NA	NA	NA	NA	NA	31.88	8.30	NA	23.58	NA	NA
MW-4	01/19/2005	1,600	15	<2.5	<2.5	<5.0	NA	220	NA	NA	NA	NA	NA	31.88	5.83	NA	26.05	NA	NA
MW-4	04/20/2005	1,300	8.8	<2.5	<2.5	<5.0	NA	210	NA	NA	NA	NA	NA	31.88	6.12	NA	25.76	NA	NA
MW-4	07/20/2005	1,600	34	<2.5	3.8	<5.0	NA	280	<10	<10	<10	1,100	NA	31.88	8.35	NA	23.53	NA	NA
MW-4	10/19/2005	2,400	74	1.1	7.2	<2.0	NA	360	NA	NA	NA	NA	NA	31.88	9.25	NA	22.63	NA	NA
MW-4	01/24/2006	3,290	17.2	<0.500	3.02	<0.500	NA	159	NA	NA	NA	NA	NA	31.88	6.32	NA	25.56	NA	NA
MW-4	04/19/2006	430	6.40	<0.500	0.610	<0.500	NA	134	NA	NA	NA	NA	NA	31.88	5.03	NA	26.85	NA	NA

MW-5	08/06/1991	9,100	210	27	240	660	NA	NA	NA	NA	NA	NA	NA	20.91	10.23	NA	10.68	NA	NA
MW-5	10/23/1991	12,000	92	18	230	450	NA	NA	NA	NA	NA	NA	NA	20.91	10.89	NA	10.02	NA	NA
MW-5	01/28/1992	3,300	130	10	180	220	NA	NA	NA	NA	NA	NA	NA	20.91	8.45	NA	12.46	NA	NA
MW-5	05/04/1992	3,900	95	<12.5	260	120	NA	NA	NA	NA	NA	NA	NA	20.91	8.05	NA	12.86	NA	NA
MW-5	07/13/1992	4,100	180	12	250	73	NA	NA	NA	NA	NA	NA	NA	20.91	10.00	NA	10.91	NA	NA
MW-5	10/12/1992	NA	NA	NA	NA	NA	NA	NA	NA	NA	NA	NA	NA	20.91	11.83	NA	9.09	0.01	NA
MW-5	01/12/1993	NA	NA	NA	NA	NA	NA	NA	NA	NA	NA	NA	NA	20.91	6.10	NA	14.81	<0.01	NA
MW-5	04/06/1993	6,200	71	<0.5	53	150	NA	NA	NA	NA	NA	NA	NA	20.91	6.18	NA	14.73	NA	NA
MW-5	07/12/1993	3,400	130	<0.5	170	130	NA	NA	NA	NA	NA	NA	NA	20.91	9.59	NA	11.32	NA	NA
MW-5	10/13/1993	NA	NA	NA	NA	NA	NA	NA	NA	NA	NA	NA	NA	20.91	10.80	NA	10.13	0.03	NA
MW-5	01/20/1994	NA	NA	NA	NA	NA	NA	NA	NA	NA	NA	NA	NA	20.91	7.42	NA	13.49	0.01	NA
MW-5	04/13/1994	NA	NA	NA	NA	NA	NA	NA	NA	NA	NA	NA	NA	20.91	7.05	NA	13.87	0.01	NA
MW-5	07/19/1994	11,000	180	13	180	260	NA	NA	NA	NA	NA	NA	NA	20.91	8.57	NA	12.34	NA	NA
MW-5	10/27/1994	6,900	82	<5	210	1,110	NA	NA	NA	NA	NA	NA	NA	20.91	10.14	NA	10.77	NA	NA
MW-5	01/03/1995	12,000	110	46	790	510	NA	NA	NA	NA	NA	NA	NA	20.91	5.84	NA	15.07	NA	NA
MW-5	04/13/1995	10,000	61	<20	330	140	NA	NA	NA	NA	NA	NA	NA	20.91	5.28	NA	15.63	NA	NA
MW-5	06/30/1995	12,000	180	8.60	440	340	NA	NA	NA	NA	NA	NA	NA	20.91	7.43	NA	13.48	NA	NA
MW-5	10/11/1995	11,000	<50	<50	440	340	5,100	NA	NA	NA	NA	NA	NA	20.91	8.90	NA	12.01	NA	NA
MW-5	01/17/1996	82,000	330	120	960	1,400	820	NA	NA	NA	NA	NA	NA	20.91	6.40	NA	14.51	NA	NA
MW-5	04/10/1996	23,000	<50	<50	360	190	770	NA	NA	NA	NA	NA	NA	20.91	5.70	NA	15.21	NA	NA

WELL CONCENTRATIONS
Former Shell/Current AmeriGas Service Station
3420 San Pablo Avenue
Oakland, CA

Well ID	Date	TPPH (ug/L)	B (ug/L)	T (ug/L)	E (ug/L)	X (ug/L)	MTBE 8020 (ug/L)	MTBE 8260 (ug/L)	DIPE (ug/L)	ETBE (ug/L)	TAME (ug/L)	TBA (ug/L)	Ethanol (ug/L)	TOC (MSL)	Depth to Water (ft.)	Depth to SPH (ft.)	GW Elevation (MSL)	SPH Thickness (ft.)	DO Reading (ppm)
MW-5	07/30/1996	38,000	3,000	<100	1,100	2,600	560	NA	NA	NA	NA	NA	NA	20.91	7.71	NA	13.20	NA	NA
MW-5	10/17/1996	13,000	36	<10	210	160	720	NA	NA	NA	NA	NA	NA	20.91	9.04	NA	11.87	NA	1.4
MW-5	01/22/1997	20,000	63	<50	380	390	650	NA	NA	NA	NA	NA	NA	20.91	4.85	NA	16.06	NA	1.6
MW-5	04/01/1997	16,000	110	<50	390	320	2,200	NA	NA	NA	NA	NA	NA	20.91	6.54	NA	14.37	NA	1.4
MW-5	07/14/1997	15,000	70	<20	220	170	450	NA	NA	NA	NA	NA	NA	20.91	8.54	NA	12.37	NA	1.8
MW-5	10/08/1997	9,100	27	11	170	57	530	NA	NA	NA	NA	NA	NA	20.91	9.09	NA	11.82	NA	4.7
MW-5	01/19/1998	9,500	92	<50	200	77	1,100	NA	NA	NA	NA	NA	NA	20.91	2.11	NA	18.80	NA	2.5
MW-5	04/28/1998	15,000	100	53	150	80	460	NA	NA	NA	NA	NA	NA	20.91	4.90	NA	16.01	NA	2.2
MW-5	09/30/1998	11,000	120	<100	240	200	<500	NA	NA	NA	NA	NA	NA	21.71	8.05	NA	13.66	NA	2.0
MW-5	12/09/1998	45,000	<200	<200	240	240	<1,000	NA	NA	NA	NA	NA	NA	21.71	8.62	NA	13.09	NA	4.7
MW-5	01/18/1999	9,120	13.8	<2.50	315	74.5	131	NA	NA	NA	NA	NA	NA	21.71	6.75	NA	14.96	NA	2.1
MW-5	04/12/1999	16,200	80.9	<50.0	163	<50.0	8,310	NA	NA	NA	NA	NA	NA	21.71	4.80	NA	16.91	NA	2.3
MW-5	07/27/1999	6,820	<5.00	<5.00	99.7	<5.00	216	NA	NA	NA	NA	NA	NA	21.71	6.25	NA	15.46	NA	2.1
MW-5	10/14/1999	10,800	47.8	<12.5	313	23.1	232	NA	NA	NA	NA	NA	NA	21.71	6.93	NA	14.78	NA	2.8
MW-5	01/06/2000	9,920	39.8	15.4	220	69.6	478	NA	NA	NA	NA	NA	NA	21.71	7.52	NA	14.19	NA	2.9
MW-5	04/05/2000	8,370	68.3	20.1	40.2	<10.0	1,570	NA	NA	NA	NA	NA	NA	21.71	5.31	NA	16.40	NA	0.4
MW-5	07/20/2000	15,500	60.5	181	104	108	460	NA	NA	NA	NA	NA	NA	21.71	5.40	NA	16.31	NA	1.7
MW-5	10/24/2000	5,170	24.3	12.6	16.5	9.79	130	NA	NA	NA	NA	NA	NA	21.71	5.59	NA	16.12	NA	1.3
MW-5	01/19/2001	4,000	<5.00	17.4	88.1	22.6	371	NA	NA	NA	NA	NA	NA	32.67	5.05	NA	27.62	NA	1.0
MW-5	04/27/2001	3,100	<1.0	<1.0	2.6	1.3	NA	210	NA	NA	NA	NA	NA	32.67	5.38	NA	27.29	NA	1.3
MW-5	07/26/2001	11,000	1.4	<1.0	13	2.2	NA	46	NA	NA	NA	NA	NA	32.67	7.17	NA	25.50	NA	1.6
MW-5	10/02/2001	5,300	6.2	3.4	60	11	NA	<100	NA	NA	NA	NA	NA	32.67	7.86	NA	24.81	NA	2.2
MW-5	01/15/2002	3,800	1.0	<0.50	1.7	0.60	NA	120	NA	NA	NA	NA	NA	32.67	4.35	NA	28.32	NA	1.7
MW-5	04/17/2002	4,600	0.61	<0.50	1.5	<0.50	NA	140	NA	NA	NA	NA	NA	32.67	6.04	NA	26.63	NA	0.5
MW-5	07/11/2002	7,200	1.8	0.58	5.9	0.78	NA	130	NA	NA	NA	NA	NA	32.67	6.72	NA	25.95	NA	4.2
MW-5	10/10/2002	4,300	3.2	<1.0	3.5	<1.0	NA	86	NA	NA	NA	NA	NA	32.67	6.99	NA	25.68	NA	2.5
MW-5	01/21/2003	4,300	2.4	<0.50	7.8	0.67	NA	170	NA	NA	NA	NA	NA	32.67	5.09	NA	27.58	NA	0.5
MW-5	05/02/2003	3,600 d	<10	<10	<10	<20	NA	170	NA	NA	NA	NA	NA	32.67	5.14	NA	27.53	NA	0.05
MW-5	07/10/2003	2,700	2.1	<1.0	4.8	<2.0	NA	48	NA	NA	NA	NA	NA	32.67	5.68	NA	26.99	NA	NA
MW-5	10/28/2003	7,500	<5.0	<5.0	11	<10	NA	63	NA	NA	NA	NA	NA	32.67	5.79	NA	26.88	NA	NA
MW-5	01/13/2004	3,800	<2.5	<2.5	6.9	<5.0	NA	140	NA	NA	NA	NA	NA	32.67	4.69	NA	27.98	NA	NA
MW-5	04/01/2004	3,800	<5.0	<5.0	<5.0	<10	NA	180	NA	NA	NA	NA	NA	32.67	5.60	NA	27.07	NA	NA
MW-5	07/21/2004	2,500	<5.0	<5.0	<5.0	<10	NA	85	<20	<20	<20	59	NA	32.67	6.50	NA	26.17	NA	NA

WELL CONCENTRATIONS
Former Shell/Current AmeriGas Service Station
3420 San Pablo Avenue
Oakland, CA

Well ID	Date	TPPH (ug/L)	B (ug/L)	T (ug/L)	E (ug/L)	X (ug/L)	MTBE 8020 (ug/L)	MTBE 8260 (ug/L)	DIPE (ug/L)	ETBE (ug/L)	TAME (ug/L)	TBA (ug/L)	Ethanol (ug/L)	TOC (MSL)	Depth to Water (ft.)	Depth to SPH (ft.)	GW Elevation (MSL)	SPH Thickness (ft.)	DO Reading (ppm)
MW-5	10/20/2004	4,900	<5.0	<5.0	<5.0	<10	NA	120	NA	NA	NA	NA	NA	32.67	6.87	NA	25.80	NA	NA
MW-5	01/19/2005	3,200	<5.0	<5.0	<5.0	<10	NA	110	NA	NA	NA	NA	NA	32.67	4.73	NA	27.94	NA	NA
MW-5	04/20/2005	3,300	<5.0	<5.0	<5.0	<10	NA	53	NA	NA	NA	NA	NA	32.67	5.29	NA	27.38	NA	NA
MW-5	07/20/2005	2,100	<1.0	<1.0	1.0	<2.0	NA	110	<4.0	<4.0	<4.0	51	NA	32.67	7.00	NA	25.67	NA	NA
MW-5	10/19/2005	2,900	1.7	<1.0	2.8	<2.0	NA	140	NA	NA	NA	NA	NA	32.67	8.91	NA	23.76	NA	NA
MW-5	01/24/2006	4,890	0.670	2.41	4.89	<0.500	NA	37.9	NA	NA	NA	NA	NA	32.67	4.90	NA	27.77	NA	NA
MW-5	04/19/2006	5,010	0.710	1.26	1.09	<0.500	NA	67.1	NA	NA	NA	NA	NA	32.67	3.46	NA	29.21	NA	NA
MW-6	08/06/1991	28,000	1,400	200	1,300	4,200	NA	NA	NA	NA	NA	NA	NA	22.32	10.61	NA	11.71	NA	NA
MW-6	10/23/1991	53,000	1,400	230	1,800	6,700	NA	NA	NA	NA	NA	NA	NA	22.32	11.68	NA	10.64	NA	NA
MW-6	01/28/1992	87,000	1,200	470	2,000	6,600	NA	NA	NA	NA	NA	NA	NA	22.32	8.90	NA	13.42	NA	NA
MW-6	05/05/1992	230,000	<500	<500	3,200	11,000	NA	NA	NA	NA	NA	NA	NA	22.32	8.01	NA	14.31	NA	NA
MW-6	07/13/1992	2,700,000	<2,500	3,500	14,000	36,000	NA	NA	NA	NA	NA	NA	NA	22.32	10.77	NA	11.55	NA	NA
MW-6	10/12/1992	NA	NA	NA	NA	NA	NA	NA	NA	NA	NA	NA	NA	22.32	8.68	NA	9.34	0.48	NA
MW-6	01/12/1993	NA	NA	NA	NA	NA	NA	NA	NA	NA	NA	NA	NA	22.32	6.40	NA	15.92	<0.01	NA
MW-6	04/06/1993	320,000	2,500	14,000	980	14,000	NA	NA	NA	NA	NA	NA	NA	22.32	5.93	NA	16.39	NA	NA
MW-6	07/12/1993	31,000	1,100	4,500	150	4,500	NA	NA	NA	NA	NA	NA	NA	22.32	10.25	NA	12.07	NA	NA
MW-6	10/13/1993	NA	NA	NA	NA	NA	NA	NA	NA	NA	NA	NA	NA	22.32	12.28	NA	10.20	0.20	NA
MW-6	01/20/1994	NA	NA	NA	NA	NA	NA	NA	NA	NA	NA	NA	NA	22.32	9.14	NA	13.20	0.02	NA
MW-6	04/13/1994	NA	NA	NA	NA	NA	NA	NA	NA	NA	NA	NA	NA	22.32	7.67	NA	14.66	0.01	NA
MW-6	07/19/1994	NA	NA	NA	NA	NA	NA	NA	NA	NA	NA	NA	NA	22.32	10.07	NA	12.31	0.07	NA
MW-6	10/27/1994	NA	NA	NA	NA	NA	NA	NA	NA	NA	NA	NA	NA	22.32	11.84	NA	10.57	0.11	NA
MW-6	01/03/1995	NA	NA	NA	NA	NA	NA	NA	NA	NA	NA	NA	NA	22.32	7.80	NA	14.54	0.02	NA
MW-6	04/13/1995	NA	NA	NA	NA	NA	NA	NA	NA	NA	NA	NA	NA	22.32	5.77	NA	16.57	0.02	NA
MW-6	06/30/1995	1,100,000	6,600	6,100	12,000	29,000	NA	NA	NA	NA	NA	NA	NA	22.32	7.78	NA	14.54	NA	NA
MW-6	10/11/1995	30,000	130	<50	1,400	4,200	710	NA	NA	NA	NA	NA	NA	22.32	10.06	NA	12.26	NA	NA
MW-6	01/17/1996	450,000	510	1,400	2,700	11,000	630	NA	NA	NA	NA	NA	NA	22.32	6.91	NA	15.41	NA	NA
MW-6	04/10/1996	22,000	47	<10	350	860	<50	NA	NA	NA	NA	NA	NA	22.32	5.92	NA	16.40	NA	NA
MW-6	07/30/1996	38,000	3,000	<100	1,100	2,600	560	NA	NA	NA	NA	NA	NA	22.32	8.97	NA	13.35	NA	NA
MW-6	10/17/1996	34,000	470	<100	1,300	3,900	<500	NA	NA	NA	NA	NA	NA	22.32	9.87	NA	12.45	NA	1.0
MW-6	01/22/1997	26,000	<100	<100	600	1,700	<500	NA	NA	NA	NA	NA	NA	22.32	4.43	NA	17.89	NA	1.3
MW-6	04/01/1997	30,000	96	33	840	2,600	190	NA	NA	NA	NA	NA	NA	22.32	6.84	NA	15.48	NA	1.4
MW-6	07/14/1997	29,000	200	<100	690	2,000	<500	NA	NA	NA	NA	NA	NA	22.32	10.30	NA	12.02	NA	2.3

WELL CONCENTRATIONS
Former Shell/Current AmeriGas Service Station
3420 San Pablo Avenue
Oakland, CA

Well ID	Date	TPPH (ug/L)	B (ug/L)	T (ug/L)	E (ug/L)	X (ug/L)	MTBE 8020 (ug/L)	MTBE 8260 (ug/L)	DIPE (ug/L)	ETBE (ug/L)	TAME (ug/L)	TBA (ug/L)	Ethanol (ug/L)	TOC (MSL)	Depth to Water (ft.)	Depth to SPH (ft.)	GW Elevation (MSL)	SPH Thickness (ft.)	DO Reading (ppm)
MW-6	10/08/1997	55,000	500	110	640	1,500	900	NA	NA	NA	NA	NA	NA	22.32	10.46	NA	11.86	NA	0.0
MW-6	12/05/1997	Abandoned																	
MW-6R	04/06/1999	NA	NA	NA	NA	NA	NA	NA	NA	NA	NA	NA	NA	22.19	12.13	NA	10.06	NA	NA
MW-6R	04/12/1999	26,100	1,750	68.5	2,160	4,450	765	NA	NA	NA	NA	NA	NA	22.19	6.10	NA	16.09	NA	2.4
MW-6R	07/27/1999	25,600	1,190	30.5	1,810	3,030	163	NA	NA	NA	NA	NA	NA	22.19	8.60	NA	13.59	NA	2.5
MW-6R	10/14/1999	21,400	999	<50.0	1,400	1,680	<500	NA	NA	NA	NA	NA	NA	22.19	9.35	NA	12.84	NA	2.0
MW-6R	01/06/2000	17,800	1,440	<50.0	1,310	2,340	301	NA	NA	NA	NA	NA	NA	22.19	9.18	NA	13.01	NA	2.1
MW-6R	04/05/2000	24,400	1,470	63.1	1,750	3,590	496	NA	NA	NA	NA	NA	NA	22.19	6.26	NA	15.93	NA	0.4
MW-6R	07/20/2000	17,200	1,070	42.9	1,260	2,490	725	NA	NA	NA	NA	NA	NA	22.19	6.79	NA	15.40	NA	2.6
MW-6R	10/24/2000	17,200	1,890	107	869	1,620	1,320	NA	NA	NA	NA	NA	NA	22.19	7.40	NA	14.79	NA	1.1
MW-6R	01/19/2001	15,000	1,120	40.2	1,240	2,230	1,670	NA	NA	NA	NA	NA	NA	33.15	6.16	NA	26.99	NA	1.4
MW-6R	04/27/2001	25,000	1,300	24	1,300	2,400	NA	400	NA	NA	NA	NA	NA	33.15	6.93	NA	26.22	NA	1.0
MW-6R	07/26/2001	31,000	1,500	31	1,800	3,000	NA	370	NA	NA	NA	NA	NA	33.15	9.12	NA	24.03	NA	1.4
MW-6R	10/02/2001	28,000	1,100	28	1,800	2,800	NA	160	NA	NA	NA	NA	NA	33.15	8.88	NA	24.27	NA	2.1
MW-6R	01/15/2002	17,000	1,400	19	900	1,500	NA	650	NA	NA	NA	NA	NA	33.15	5.46	NA	27.69	NA	2.1
MW-6R	04/17/2002	33,000	1,600	33	1,700	3,100	NA	220	NA	NA	NA	NA	NA	33.15	7.68	NA	25.47	NA	2.2
MW-6R	07/11/2002	25,000	1,200	21	1,300	1,900	NA	240	NA	NA	NA	NA	NA	33.15	8.75	NA	24.40	NA	1.6
MW-6R	10/10/2002	83,000 c	1,400	34	2,000	4,400	NA	290	NA	NA	NA	NA	NA	33.15	9.27	NA	23.88	NA	1.0
MW-6R	01/21/2003	20,000	1,200	18	1,100	1,700	NA	340	NA	NA	NA	NA	NA	33.15	6.95	NA	26.20	NA	1.2
MW-6R	05/02/2003	28,000	1,600	32	1,600	2,400	NA	300	NA	NA	NA	NA	NA	33.15	7.50	NA	25.65	NA	1.6
MW-6R	07/10/2003	19,000	1,600	<25	1,400	2,000	NA	730	NA	NA	NA	NA	NA	33.15	8.60	e	24.55	NA	NA
MW-6R	10/28/2003	NA	NA	NA	NA	NA	NA	NA	NA	NA	NA	NA	NA	33.15	8.91	8.65	24.45	0.26	NA
MW-6R	11/24/2003	NA	NA	NA	NA	NA	NA	NA	NA	NA	NA	NA	NA	33.15	8.47	8.32	24.80	0.15	NA
MW-6R	01/13/2004	87,000	1,300	<50	3,300	6,700	NA	160	NA	NA	NA	NA	NA	33.15	6.52	NA	26.63	NA	NA
MW-6R	04/01/2004	39,000	1,300	<50	2,400	3,500	NA	160	NA	NA	NA	NA	NA	33.15	6.90	NA	26.25	NA	NA
MW-6R	07/21/2004	51,000	970	<50	3,200	6,700	NA	120	<200	<200	<200	<500	NA	33.15	8.40	NA	24.75	NA	NA
MW-6R	10/20/2004	140,000	1,700	<50	4,300	7,400	NA	210	NA	NA	NA	NA	NA	33.15	8.61	NA	24.54	<.01	NA
MW-6R	01/19/2005	44,000	1,300	<50	2,700	3,300	NA	140	NA	NA	NA	NA	NA	33.15	6.11	NA	27.04	NA	NA
MW-6R	04/20/2005	26,000	340	<50	800	920	NA	<50	NA	NA	NA	NA	NA	33.15	7.01	NA	26.14	NA	NA
MW-6R	07/20/2005	35,000	640	<50	2,000	2,200	NA	83	<200	<200	<200	<500	NA	33.15	8.64	NA	24.51	NA	NA
MW-6R	10/19/2005	57,000	1,100	<50	2,600	2,400	NA	100	NA	NA	NA	NA	NA	33.15	10.10	NA	23.05	NA	NA
MW-6R	01/24/2006	NA	NA	NA	NA	NA	NA	NA	NA	NA	NA	NA	NA	33.15	5.95	5.91	27.23	0.04	NA

WELL CONCENTRATIONS
Former Shell/Current AmeriGas Service Station
3420 San Pablo Avenue
Oakland, CA

Well ID	Date	TPPH (ug/L)	B (ug/L)	T (ug/L)	E (ug/L)	X (ug/L)	MTBE 8020 (ug/L)	MTBE 8260 (ug/L)	DIPE (ug/L)	ETBE (ug/L)	TAME (ug/L)	TBA (ug/L)	Ethanol (ug/L)	TOC (MSL)	Depth to Water (ft.)	Depth to SPH (ft.)	GW Elevation (MSL)	SPH Thickness (ft.)	DO Reading (ppm)
MW-6R	04/19/2006	62,200	1,040	9.41	1,430	1,280	NA	130	NA	NA	NA	NA	NA	33.15	4.95	4.94	28.21	0.01	NA
MW-7	08/06/1991	13,000	4,300	76	770	730	NA	NA	NA	NA	NA	NA	NA	20.36	8.00	NA	12.36	NA	NA
MW-7	10/23/1991	18,000	3,200	31	660	770	NA	NA	NA	NA	NA	NA	NA	20.36	8.16	NA	12.20	NA	NA
MW-7	01/28/1992	5,000	1,200	<10	220	54	NA	NA	NA	NA	NA	NA	NA	20.36	7.11	NA	13.25	NA	NA
MW-7	05/05/1992	9,500	3,100	72	620	880	NA	NA	NA	NA	NA	NA	NA	20.36	6.47	NA	13.89	NA	NA
MW-7	07/13/1992	20,000	4,200	130	1,600	1,100	NA	NA	NA	NA	NA	NA	NA	20.36	7.73	NA	12.63	NA	NA
MW-7	10/12/1992	16,000	2,500	170	560	170	NA	NA	NA	NA	NA	NA	NA	20.36	9.97	NA	11.68	NA	NA
MW-7	01/12/1993	15,000	2,300	<50	690	440	NA	NA	NA	NA	NA	NA	NA	20.36	6.26	NA	14.10	NA	NA
MW-7	04/06/1993	26,000	5,400	<0.5	1,200	3,000	NA	NA	NA	NA	NA	NA	NA	20.36	5.92	NA	14.44	NA	NA
MW-7	07/12/1993	10,000	3,000	100	510	530	NA	NA	NA	NA	NA	NA	NA	20.36	7.27	NA	13.09	NA	NA
MW-7	10/13/1993	59,000	13,000	4,400	4,400	20,000	NA	NA	NA	NA	NA	NA	NA	20.36	9.40	NA	10.96	NA	NA
MW-7	01/20/1994	NA	NA	NA	NA	NA	NA	NA	NA	NA	NA	NA	NA	20.36	7.03	NA	13.37	0.05	NA
MW-7	04/13/1994	NA	NA	NA	NA	NA	NA	NA	NA	NA	NA	NA	NA	20.36	6.56	NA	13.93	0.16	NA
MW-7	07/19/1994	NA	NA	NA	NA	NA	NA	NA	NA	NA	NA	NA	NA	20.36	6.91	NA	13.61	0.20	NA
MW-7	10/27/1994	NA	NA	NA	NA	NA	NA	NA	NA	NA	NA	NA	NA	20.36	8.28	NA	12.11	0.04	NA
MW-7	01/03/1995	NA	NA	NA	NA	NA	NA	NA	NA	NA	NA	NA	NA	20.36	6.48	NA	13.90	0.02	NA
MW-7	04/13/1995	NA	NA	NA	NA	NA	NA	NA	NA	NA	NA	NA	NA	20.36	6.54	NA	13.84	0.02	NA
MW-7	06/30/1995	900,000	11,000	8,500	14,000	52,000	NA	NA	NA	NA	NA	NA	NA	20.36	7.08	NA	13.28	NA	NA
MW-7	10/11/1995	NA	NA	NA	NA	NA	NA	NA	NA	NA	NA	NA	NA	20.36	7.88	NA	12.51	0.04	NA
MW-7	01/17/1996	NA	NA	NA	NA	NA	NA	NA	NA	NA	NA	NA	NA	20.36	7.26	NA	13.13	0.04	NA
MW-7	04/10/1996	NA	NA	NA	NA	NA	NA	NA	NA	NA	NA	NA	NA	20.36	6.98	NA	13.42	0.05	NA
MW-7	07/30/1996	NA	NA	NA	NA	NA	NA	NA	NA	NA	NA	NA	NA	20.36	7.34	NA	13.04	0.03	NA
MW-7	10/17/1996	NA	NA	NA	NA	NA	NA	NA	NA	NA	NA	NA	NA	20.36	7.63	NA	12.75	0.02	NA
MW-7	01/22/1997	56,000	2,000	520	1,400	8,400	1,800	NA	NA	NA	NA	NA	NA	20.36	6.46	NA	13.90	NA	0.5
MW-7	04/01/1997	66,000	3,600	460	2,400	10,000	2,300	NA	NA	NA	NA	NA	NA	20.36	6.97	NA	13.39	NA	1.6
MW-7	07/14/1997	NA	NA	NA	NA	NA	NA	NA	NA	NA	NA	NA	NA	20.36	8.90	NA	11.48	0.03	NA
MW-7	10/08/1997	68,000	3,200	470	2,400	9,700	3,300	NA	NA	NA	NA	NA	NA	20.36	9.21	NA	11.15	0.01	2.1
MW-7	01/19/1998	44,000	1,800	220	1,700	7,800	1,600	NA	NA	NA	NA	NA	NA	20.36	4.65	NA	15.71	NA	1.6
MW-7	04/28/1998	82,000	1,500	<500	1,200	8,900	<2,500	NA	NA	NA	NA	NA	NA	20.36	6.53	NA	13.83	NA	1.3
MW-7	09/30/1998	41,000	2,300	290	2,200	7,000	1,400	NA	NA	NA	NA	NA	NA	20.35	5.59	NA	14.76	NA	1.4
MW-7	12/09/1998	31,000	530	130	1,100	4,300	<500	NA	NA	NA	NA	NA	NA	20.35	5.91	NA	14.44	NA	4.9
MW-7	01/18/1999	35,300	975	175	1,360	5,750	256	NA	NA	NA	NA	NA	NA	20.35	5.02	NA	15.33	NA	1.2

WELL CONCENTRATIONS
Former Shell/Current AmeriGas Service Station
3420 San Pablo Avenue
Oakland, CA

Well ID	Date	TPPH (ug/L)	B (ug/L)	T (ug/L)	E (ug/L)	X (ug/L)	MTBE 8020 (ug/L)	MTBE 8260 (ug/L)	DIPE (ug/L)	ETBE (ug/L)	TAME (ug/L)	TBA (ug/L)	Ethanol (ug/L)	TOC (MSL)	Depth to Water (ft.)	Depth to SPH (ft.)	GW Elevation (MSL)	SPH Thickness (ft.)	DO Reading (ppm)
MW-7	04/12/1999	43,300	728	161	1,820	6,190	<500	NA	NA	NA	NA	NA	NA	20.35	4.57	NA	15.78	NA	1.3
MW-7	07/27/1999	36,600	863	68.3	1,540	4,370	593	NA	NA	NA	NA	NA	NA	20.35	5.36	NA	14.99	NA	1.2
MW-7	10/14/1999	65,600	1,140	157	2,230	7,060	1,090	NA	NA	NA	NA	NA	NA	20.35	5.87	NA	14.48	NA	1.8
MW-7	01/06/2000	57,100	1,060	142	1,540	5,980	634	NA	NA	NA	NA	NA	NA	20.35	6.12	NA	14.23	NA	1.8
MW-7	04/05/2000	36,500	843	<100	1,460	4,220	1,140	NA	NA	NA	NA	NA	NA	20.35	4.87	NA	15.48	NA	1.4
MW-7	07/20/2000	28,400	263	251	457	1,300	690	NA	NA	NA	NA	NA	NA	20.35	5.01	NA	15.34	NA	1.7
MW-7	10/24/2000	33,500	464	<200	1,600	3,830	<1,000	NA	NA	NA	NA	NA	NA	20.35	4.17	NA	16.18	NA	1.5
MW-7	01/19/2001	1,860,000	<2,000	<2,000	<2,000	5,790	<10,000	NA	NA	NA	NA	NA	NA	31.31	5.18	NA	26.13	NA	1.2
MW-7	04/27/2001	31,000	150	20	1,400	3,000	NA	190	NA	NA	NA	NA	NA	31.31	4.99	NA	26.32	NA	1.4
MW-7	07/26/2001	30,000	340	20	1,500	2,600	NA	380	NA	NA	NA	NA	NA	31.31	6.20	NA	25.11	NA	1.1
MW-7	10/02/2001	38,000	480	9.0	970	2,600	NA	300	NA	NA	NA	NA	NA	31.31	6.45	NA	24.86	NA	1.5
MW-7	01/15/2002	33,000	160	6.6	810	1,300	NA	130	NA	NA	NA	NA	NA	31.31	4.31	NA	27.00	NA	2.0
MW-7	04/17/2002	28,000	160	6.1	1,000	1,700	NA	140	NA	NA	NA	NA	NA	31.31	4.12	NA	27.19	NA	1.2
MW-7	07/11/2002	26,000	200	<5.0	830	1,300	NA	170	NA	NA	NA	NA	NA	31.31	5.90	NA	25.41	NA	3.0
MW-7	10/10/2002	95,000 c	380	11	1,500	3,900	NA	330	NA	NA	NA	NA	NA	31.31	6.32	NA	24.99	NA	2.9
MW-7	01/21/2003	18,000	100	2.6	530	780	NA	96	NA	NA	NA	NA	NA	31.31	3.04	NA	28.27	NA	0.9
MW-7	05/02/2003	23,000	99	<10	490	620	NA	<100	NA	NA	NA	NA	NA	31.31	3.45	NA	27.86	NA	0.91
MW-7	07/10/2003	18,000	200	<5.0	460	1,100	NA	52	NA	NA	NA	NA	NA	31.31	4.59	NA	26.72	NA	NA
MW-7	10/28/2003	37,000	290	<10	830	1,200	NA	98	NA	NA	NA	NA	NA	31.31	4.97	NA	26.34	NA	NA
MW-7	01/13/2004	22,000	94	<10	410	680	NA	97	NA	NA	NA	NA	NA	31.31	4.55	NA	26.76	NA	NA
MW-7	04/01/2004	24,000	250	<10	440	660	NA	210	NA	NA	NA	NA	NA	31.31	4.91	NA	26.40	NA	NA
MW-7	07/21/2004	21,000	440	<10	460	640	NA	110	<40	<40	<40	<100	NA	31.31	4.58	NA	26.73	NA	NA
MW-7	10/20/2004	23,000	430	<10	410	640	NA	40	NA	NA	NA	NA	NA	31.31	1.95	NA	29.36	NA	NA
MW-7	01/19/2005	17,000	97	<10	240	370	NA	150	NA	NA	NA	NA	NA	31.31	3.91	NA	27.40	NA	NA
MW-7	04/20/2005	18,000	160	<10	260	320	NA	80	NA	NA	NA	NA	NA	31.31	4.64	NA	26.67	NA	NA
MW-7	07/20/2005	15,000	800	<10	200	250	NA	660	<40	<40	<40	290	NA	31.31	6.29	NA	25.02	NA	NA
MW-7	10/19/2005	12,000	1,200	<5.0	120	150	NA	760	NA	NA	NA	NA	NA	31.31	7.25	NA	24.06	NA	NA
MW-7	01/24/2006	24,900	604	3.14	135	216	NA	259	NA	NA	NA	NA	NA	31.31	4.50	NA	26.81	NA	NA
MW-7	04/19/2006	135,000	378	1.82	66.0	177	NA	74.0	NA	NA	NA	NA	NA	31.31	3.74	NA	27.57	NA	NA
MW-8	08/06/1991	32,000	3,700	1,100	1,400	6,100	NA	NA	NA	NA	NA	NA	NA	20.95	9.60	NA	11.35	NA	NA
MW-8	10/23/1991	63,000	4,800	1,300	1,300	6,900	NA	NA	NA	NA	NA	NA	NA	20.95	9.73	NA	11.22	NA	NA
MW-8	01/28/1992	32,000	1,900	750	1,400	6,300	NA	NA	NA	NA	NA	NA	NA	20.95	7.72	NA	13.23	NA	NA

WELL CONCENTRATIONS
Former Shell/Current AmeriGas Service Station
3420 San Pablo Avenue
Oakland, CA

Well ID	Date	TPPH (ug/L)	B (ug/L)	T (ug/L)	E (ug/L)	X (ug/L)	MTBE 8020 (ug/L)	MTBE 8260 (ug/L)	DIPE (ug/L)	ETBE (ug/L)	TAME (ug/L)	TBA (ug/L)	Ethanol (ug/L)	TOC (MSL)	Depth to Water (ft.)	Depth to SPH (ft.)	GW Elevation (MSL)	SPH Thickness (ft.)	DO Reading (ppm)
MW-8	05/05/1992	180,000	2,200	2,000	2,700	13,000	NA	NA	NA	NA	NA	NA	NA	20.95	6.48	NA	14.47	NA	NA
MW-8	07/13/1992	56,000	4,500	1,500	2,700	9,100	NA	NA	NA	NA	NA	NA	NA	20.95	8.55	NA	12.40	NA	NA
MW-8	10/12/1992	34,000	2,400	550	1,400	6,400	NA	NA	NA	NA	NA	NA	NA	20.95	9.97	NA	10.98	NA	NA
MW-8	01/12/1993	110,000	2,100	1,200	2,400	12,000	NA	NA	NA	NA	NA	NA	NA	20.95	6.94	NA	14.01	NA	NA
MW-8	04/06/1993	38,000	2,500	840	1,100	4,900	NA	NA	NA	NA	NA	NA	NA	20.95	5.72	NA	15.23	NA	NA
MW-8	07/12/1993	27,000	2,800	990	1,200	5,300	NA	NA	NA	NA	NA	NA	NA	20.95	7.65	NA	13.30	NA	NA
MW-8	10/13/1993	32,000	3,300	1,300	1,600	8,400	NA	NA	NA	NA	NA	NA	NA	20.95	8.25	NA	12.70	NA	NA
MW-8	01/20/1994	78,000	1,900	670	1,300	6,600	NA	NA	NA	NA	NA	NA	NA	20.95	7.25	NA	13.70	NA	NA
MW-8	04/13/1994	41,000	1,300	720	1,200	6,000	NA	NA	NA	NA	NA	NA	NA	20.95	7.12	NA	13.83	NA	NA
MW-8	07/19/1994	140,000	1,800	1,400	2,000	9,000	NA	NA	NA	NA	NA	NA	NA	20.95	7.43	NA	13.52	NA	NA
MW-8	10/27/1994	32,000	1,200	670	1,200	5,700	NA	NA	NA	NA	NA	NA	NA	20.95	7.55	NA	13.40	NA	NA
MW-8	01/03/1995	38,000	1,000	700	1,500	7,500	NA	NA	NA	NA	NA	NA	NA	20.95	6.04	NA	14.91	NA	NA
MW-8	04/13/1995	31,000	1,200	570	1,000	5,300	NA	NA	NA	NA	NA	NA	NA	20.95	5.04	NA	15.91	NA	NA
MW-8	06/30/1995	110,000	2,000	1,500	2,000	9,700	NA	NA	NA	NA	NA	NA	NA	20.95	5.72	NA	15.23	NA	NA
MW-8	10/11/1995	36,000	170	60	1,300	6,300	510	NA	NA	NA	NA	NA	NA	20.95	7.06	NA	13.89	NA	NA
MW-8	01/17/1996	38,000	1,000	520	1,100	6,200	950	NA	NA	NA	NA	NA	NA	20.95	5.84	NA	15.11	NA	NA
MW-8	04/10/1996	54,000	650	260	850	4,700	<250	NA	NA	NA	NA	NA	NA	20.95	5.03	NA	15.92	NA	NA
MW-8	07/30/1996	33,000	780	330	830	4,200	1,700	NA	NA	NA	NA	NA	NA	20.95	6.36	NA	14.59	NA	NA
MW-8	10/17/1996	35,000	750	300	1,100	5,000	1,200	NA	NA	NA	NA	NA	NA	20.95	5.94	NA	15.01	NA	1.6
MW-8	01/22/1997	25,000	260	78	420	2,400	120	NA	NA	NA	NA	NA	NA	20.95	5.93	NA	15.02	NA	1.8
MW-8	04/01/1997	22,000	680	180	550	2,500	260	NA	NA	NA	NA	NA	NA	20.95	6.24	NA	14.71	NA	1.8
MW-8	07/14/1997	29,000	870	200	850	3,100	500	NA	NA	NA	NA	NA	NA	20.95	8.59	NA	12.36	NA	1.4
MW-8	10/08/1997	27,000	1,000	190	960	3,000	170	NA	NA	NA	NA	NA	NA	20.95	9.04	NA	11.91	NA	4.6
MW-8	01/19/1998	21,000	660	160	740	3,300	170	NA	NA	NA	NA	NA	NA	20.95	3.34	NA	17.61	NA	2.2
MW-8	04/28/1998	Well inaccessible		NA	NA	NA	NA	NA	NA	NA	NA	NA	NA	20.95	NA	NA	NA	NA	NA
MW-8	09/30/1998	19,000	370	230	880	3,800	410	NA	NA	NA	NA	NA	NA	21.15	7.00	NA	14.15	NA	1.2
MW-8	12/09/1998	1,400	92	90	74	260	<250	NA	NA	NA	NA	NA	NA	21.15	6.38	NA	14.77	NA	3.6
MW-8	01/18/1999	317	<0.500	<0.500	3.04	0.984	3.92	NA	NA	NA	NA	NA	NA	21.15	1.85	NA	19.30	NA	2.0
MW-8	04/12/1999	8,300	35.6	24.4	144	466	<100	NA	NA	NA	NA	NA	NA	21.15	3.65	NA	17.50	NA	1.6
MW-8	07/27/1999	12,700	<5.00	5.47	281	1,130	50.3	NA	NA	NA	NA	NA	NA	21.15	5.00	NA	16.15	NA	1.4
MW-8	10/14/1999	11,900	86.7	16.9	210	469	<100	NA	NA	NA	NA	NA	NA	21.15	5.95	NA	15.20	NA	1.2
MW-8	01/06/2000	5,930	65	12.4	106	129	203.0	NA	NA	NA	NA	NA	NA	21.15	6.19	NA	14.96	NA	1.3
MW-8	04/05/2000	6,770	100	<50.0	61.3	150	322	NA	NA	NA	NA	NA	NA	21.15	5.14	NA	16.01	NA	2.1

WELL CONCENTRATIONS
Former Shell/Current AmeriGas Service Station
3420 San Pablo Avenue
Oakland, CA

Well ID	Date	TPPH (ug/L)	B (ug/L)	T (ug/L)	E (ug/L)	X (ug/L)	MTBE 8020 (ug/L)	MTBE 8260 (ug/L)	DIPE (ug/L)	ETBE (ug/L)	TAME (ug/L)	TBA (ug/L)	Ethanol (ug/L)	TOC (MSL)	Depth to Water (ft.)	Depth to SPH (ft.)	GW Elevation (MSL)	SPH Thickness (ft.)	DO Reading (ppm)
MW-8	07/20/2000	28,900	109	307	119	235	337	NA	NA	NA	NA	NA	NA	21.15	5.21	NA	15.94	NA	2.1
MW-8	10/24/2000	8,620	99.0	12.8	152	366	225	NA	NA	NA	NA	NA	NA	21.15	3.11	NA	18.04	NA	1.0
MW-8	01/19/2001	5,590	49.4	6.50	26.0	57.4	99.5	NA	NA	NA	NA	NA	NA	32.11	5.35	NA	26.76	NA	1.8
MW-8	04/27/2001	3,800	<0.50	<0.50	14	31	NA	<5.0	NA	NA	NA	NA	NA	32.11	4.58	NA	27.53	NA	0.7
MW-8	07/26/2001	4,400	0.88	0.59	7.0	14	NA	<5.0	NA	NA	NA	NA	NA	32.11	5.83	NA	26.28	NA	0.9
MW-8	10/02/2001	1,800	9.8	<0.50	23	16	NA	<5.0	NA	NA	NA	NA	NA	32.11	6.50	NA	25.61	NA	1.2
MW-8	01/15/2002	2,700	1.2	1.5	0.93	1.7	NA	12	NA	NA	NA	NA	NA	32.11	5.07	NA	27.04	NA	1.6
MW-8	04/17/2002	3,200	2.2	<1.0	9.0	14	NA	<10	NA	NA	NA	NA	NA	32.11	3.80	NA	28.31	NA	1.0
MW-8	07/11/2002	6,500	23	1.0	12	19	NA	<10	NA	NA	NA	NA	NA	32.11	6.29	NA	25.82	NA	1.9
MW-8	10/10/2002	1,900	5.3	<0.50	30	33	NA	7.6	NA	NA	NA	NA	NA	32.11	4.32	NA	27.79	NA	2.4
MW-8	01/21/2003	3,700	1.4	<1.0	3.9	6.6	NA	<10	NA	NA	NA	NA	NA	32.11	5.57	NA	26.54	NA	0.6
MW-8	05/02/2003	3,900 d	<5.0	<5.0	<5.0	<10	NA	<50	NA	NA	NA	NA	NA	32.11	1.67	NA	30.44	NA	0.23
MW-8	07/10/2003	2,400	<2.5	<2.5	<2.5	<5.0	NA	<2.5	NA	NA	NA	NA	NA	32.11	3.81	NA	28.30	NA	NA
MW-8	10/28/2003	3,000	<2.5	3.1	4.6	6.1	NA	<2.5	NA	NA	NA	NA	NA	32.11	4.99	NA	27.12	NA	NA
MW-8	01/13/2004	4,600	3.6	<2.5	14	20	NA	2.5	NA	NA	NA	NA	NA	32.11	5.10	NA	27.01	NA	NA
MW-8	04/01/2004	4,200	3.9	<2.5	7.1	8.8	NA	<2.5	NA	NA	NA	NA	NA	32.11	3.32	NA	28.79	NA	NA
MW-8	07/21/2004	3,400	<2.5	<2.5	4.1	<5.0	NA	<2.5	<10	<10	<10	<25	NA	32.11	3.95	NA	28.16	NA	NA
MW-8	10/20/2004	2,300	<2.5	<2.5	<2.5	<5.0	NA	<2.5	NA	NA	NA	NA	NA	32.11	1.48	NA	30.63	NA	NA
MW-8	01/19/2005	2,000	<2.5	<2.5	<2.5	<5.0	NA	<2.5	NA	NA	NA	NA	NA	32.11	5.28	NA	26.83	NA	NA
MW-8	04/20/2005	2,300	<2.5	<2.5	<2.5	<5.0	NA	<2.5	NA	NA	NA	NA	NA	32.11	3.52	NA	28.59	NA	NA
MW-8	07/20/2005	1,500	2.0	0.77	1.4	1.3	NA	<0.50	<2.0	<2.0	<2.0	<5.0	NA	32.11	5.35	NA	26.76	NA	NA
MW-8	10/19/2005	2,200	4.0	0.96	2.5	3.1	NA	<0.50	NA	NA	NA	NA	NA	32.11	7.80	NA	24.31	NA	NA
MW-8	01/24/2006	5,150	0.600	<0.500	3.33	<0.500	NA	<0.500	NA	NA	NA	NA	NA	32.11	2.18	NA	29.93	NA	NA
MW-9	08/06/1991	11,000	1,700	95	520	1,400	NA	NA	NA	NA	NA	NA	NA	21.19	10.33	NA	10.86	NA	NA
MW-9	10/23/1991	20,000	1,000	47	<0.3	940	NA	NA	NA	NA	NA	NA	NA	21.19	11.13	NA	10.06	NA	NA
MW-9	01/28/1992	3,500	120	<10	280	36	NA	NA	NA	NA	NA	NA	NA	21.19	9.02	NA	12.17	NA	NA
MW-9	05/04/1992	7,700	1,200	<50	380	630	NA	NA	NA	NA	NA	NA	NA	21.19	7.67	NA	13.52	NA	NA
MW-9	07/20/1992	11,000	910	<50	220	1,200	NA	NA	NA	NA	NA	NA	NA	21.19	10.26	NA	10.93	NA	NA
MW-9	10/12/1992	2,100	340	15	77	44	NA	NA	NA	NA	NA	NA	NA	21.19	12.19	NA	9.00	NA	NA
MW-9	01/12/1993	Well inaccessible		NA	NA	NA	NA	NA	NA	NA	NA	NA	NA	21.19	NA	NA	NA	NA	NA
MW-9	04/06/1993	Well inaccessible		NA	NA	NA	NA	NA	NA	NA	NA	NA	NA	21.19	NA	NA	NA	NA	NA
MW-9	07/12/1993	Well inaccessible		NA	NA	NA	NA	NA	NA	NA	NA	NA	NA	21.19	NA	NA	NA	NA	NA

WELL CONCENTRATIONS
Former Shell/Current AmeriGas Service Station
3420 San Pablo Avenue
Oakland, CA

Well ID	Date	TPPH (ug/L)	B (ug/L)	T (ug/L)	E (ug/L)	X (ug/L)	MTBE 8020 (ug/L)	MTBE 8260 (ug/L)	DIPE (ug/L)	ETBE (ug/L)	TAME (ug/L)	TBA (ug/L)	Ethanol (ug/L)	TOC (MSL)	Depth to Water (ft.)	Depth to SPH (ft.)	GW Elevation (MSL)	SPH Thickness (ft.)	DO Reading (ppm)
MW-9	10/13/1993	2,900	140	<5	<5	120	NA	NA	NA	NA	NA	NA	NA	21.19	11.17	NA	10.02	NA	NA
MW-9	01/20/1994	1,700	380	6.90	150	400	NA	NA	NA	NA	NA	NA	NA	21.19	8.03	NA	13.16	NA	NA
MW-9	04/13/1994	6,000	1,000	<20	450	420	NA	NA	NA	NA	NA	NA	NA	21.19	7.81	NA	13.38	NA	NA
MW-9	07/19/1994	12,000	1,400	<5	740	1,200	NA	NA	NA	NA	NA	NA	NA	21.19	8.96	NA	12.23	NA	NA
MW-9	10/27/1994	10,000	1,200	160	280	860	NA	NA	NA	NA	NA	NA	NA	21.19	11.00	NA	10.19	NA	NA
MW-9	01/03/1995	4,400	680	7.70	180	370	NA	NA	NA	NA	NA	NA	NA	21.19	6.60	NA	14.59	NA	NA
MW-9	04/13/1995	1,700	270	<10	69	170	NA	NA	NA	NA	NA	NA	NA	21.19	6.73	NA	14.46	NA	NA
MW-9	06/30/1995	14,000	2,200	18	900	2,600	NA	NA	NA	NA	NA	NA	NA	21.19	7.32	NA	13.87	NA	NA
MW-9	10/11/1995	9,600	35	12	360	980	590	NA	NA	NA	NA	NA	NA	21.19	8.10	NA	13.09	NA	NA
MW-9	01/17/1996	2,800	150	7.41	54	130	170	NA	NA	NA	NA	NA	NA	21.19	5.75	NA	15.44	NA	NA
MW-9	04/10/1996	5,200	290	<5	92	220	240	NA	NA	NA	NA	NA	NA	21.19	5.17	NA	16.02	NA	NA
MW-9	07/30/1996	5,100	960	<10	380	770	670	NA	NA	NA	NA	NA	NA	21.19	8.10	NA	13.09	NA	NA
MW-9	10/17/1996	15,000	2,100	<25	590	1,300	1,500	NA	NA	NA	NA	NA	NA	21.19	9.12	NA	12.07	NA	2.4
MW-9	01/22/1997	5,600	690	<5.0	140	310	620	NA	NA	NA	NA	NA	NA	21.19	4.72	NA	16.47	NA	2.2
MW-9	04/01/1997	4,000	590	<10	140	200	600	NA	NA	NA	NA	NA	NA	21.19	6.86	NA	14.33	NA	2.2
MW-9	07/14/1997	7,100	860	<10	51	230	950	NA	NA	NA	NA	NA	NA	21.19	10.04	NA	11.15	NA	3.8
MW-9	10/08/1997	1,500	57	<2.0	2.0	13	540	NA	NA	NA	NA	NA	NA	21.19	11.38	NA	9.81	NA	8.2
MW-9	01/19/1998	2,500	280	<20	79	61	620	NA	NA	NA	NA	NA	NA	21.19	3.88	NA	17.31	NA	1.4
MW-9	04/28/1998	2,200	330	<20	91	110	640	NA	NA	NA	NA	NA	NA	21.19	5.87	NA	15.32	NA	1.6
MW-9	09/30/1998	2,800	490	<5.0	87	240	1,200	NA	NA	NA	NA	NA	NA	21.19	8.25	NA	12.94	NA	4.0
MW-9	12/09/1998	3,700	370	<5.0	83	130	1,100	NA	NA	NA	NA	NA	NA	21.19	8.07	NA	13.12	NA	2.9
MW-9	01/18/1999	9,670	1,110	<5.00	442	571	786	NA	NA	NA	NA	NA	NA	21.19	7.54	NA	13.65	NA	3.2
MW-9	04/12/1999	3,140	272	<10.0	41.6	114	542	NA	NA	NA	NA	NA	NA	21.19	5.60	NA	15.59	NA	1.7
MW-9	07/27/1999	3,580	247	<1.00	67.7	137	432	NA	NA	NA	NA	NA	NA	21.19	7.30	NA	13.89	NA	1.6
MW-9	10/14/1999	3,200	199	<10.0	74.1	88.9	468	NA	NA	NA	NA	NA	NA	21.19	7.26	NA	13.93	NA	1.4
MW-9	01/06/2000	<50.0	<0.500	<0.500	<0.500	<0.500	<2.50	NA	NA	NA	NA	NA	NA	21.19	8.31	NA	12.88	NA	1.5
MW-9	04/05/2000	2,790	156	<5.00	39.1	57.8	399	NA	NA	NA	NA	NA	NA	21.19	5.40	NA	15.79	NA	0.9
MW-9	07/20/2000	5,530	283	14.9	379	728	92.7	NA	NA	NA	NA	NA	NA	21.19	5.70	NA	15.49	NA	2.1
MW-9	10/24/2000	3,090	110	<5.00	46.4	63.3	362	NA	NA	NA	NA	NA	NA	21.19	5.90	NA	15.29	NA	1.0
MW-9	01/19/2001	6,060	180	<5.00	181	164	231	NA	NA	NA	NA	NA	NA	32.15	5.39	NA	26.76	NA	1.2
MW-9	04/27/2001	2,700	56	<0.50	26	46	NA	150	NA	NA	NA	NA	NA	32.15	5.38	NA	26.77	NA	1.2
MW-9	07/26/2001	4,200	50	<0.50	28	53	NA	180	NA	NA	NA	NA	NA	32.15	6.45	NA	25.70	NA	1.0
MW-9	10/02/2001	11,000	150	<2.0	120	140	NA	180	NA	NA	NA	NA	NA	32.15	6.10	NA	26.05	NA	1.4

WELL CONCENTRATIONS
Former Shell/Current AmeriGas Service Station
3420 San Pablo Avenue
Oakland, CA

Well ID	Date	TPPH (ug/L)	B (ug/L)	T (ug/L)	E (ug/L)	X (ug/L)	MTBE 8020 (ug/L)	MTBE 8260 (ug/L)	DIPE (ug/L)	ETBE (ug/L)	TAME (ug/L)	TBA (ug/L)	Ethanol (ug/L)	TOC (MSL)	Depth to Water (ft.)	Depth to SPH (ft.)	GW Elevation (MSL)	SPH Thickness (ft.)	DO Reading (ppm)
MW-9	01/15/2002	1,200	<0.50	<0.50	<0.50	<0.50	NA	<5.0	NA	NA	NA	NA	NA	32.15	4.77	NA	27.38	NA	1.2
MW-9	04/17/2002	2,200	24	<0.50	26	27	NA	96	NA	NA	NA	NA	NA	32.15	5.57	NA	26.58	NA	0.6
MW-9	07/11/2002	4,600	21	<0.50	17	33	NA	140	NA	NA	NA	NA	NA	32.15	6.64	NA	25.51	NA	2.1
MW-9	10/10/2002	2,800	8.8	<0.50	3.2	9.5	NA	160	NA	NA	NA	NA	NA	32.15	7.41	NA	24.74	NA	2.4
MW-9	01/21/2003	470	1.9	<0.50	1.7	1.1	NA	13	NA	NA	NA	NA	NA	32.15	5.47	NA	26.68	NA	1.0
MW-9	05/02/2003	770	2.9	<0.50	1.5	1.8	NA	82	NA	NA	NA	NA	NA	32.15	5.40	NA	26.75	NA	0.96
MW-9	07/10/2003	1,700	4.9	<2.5	3.0	5.2	NA	100	NA	NA	NA	NA	NA	32.15	6.59	NA	25.56	NA	NA
MW-9	10/28/2003	2,400	<5.0	<5.0	<5.0	<10	NA	180	NA	NA	NA	NA	NA	32.15	6.94	NA	25.21	NA	NA
MW-9	01/13/2004	550	<0.50	0.54	<0.50	<1.0	NA	23	NA	NA	NA	NA	NA	32.15	5.62	NA	26.53	NA	NA
MW-9	04/01/2004	440	<0.50	<0.50	<0.50	<1.0	NA	19	NA	NA	NA	NA	NA	32.15	5.94	NA	26.21	NA	NA
MW-9	07/21/2004	1,100	<0.50	<0.50	<0.50	<1.0	NA	110	<2.0	<2.0	<2.0	34	NA	32.15	6.60	NA	25.55	NA	NA
MW-9	10/20/2004	730	<0.50	<0.50	<0.50	<1.0	NA	56	NA	NA	NA	NA	NA	32.15	4.48	NA	27.67	NA	NA
MW-9	01/19/2005	320	<0.50	<0.50	<0.50	<1.0	NA	3.0	NA	NA	NA	NA	NA	32.15	4.56	NA	27.59	NA	NA
MW-9	04/20/2005	100	<0.50	0.56	<0.50	<1.0	NA	5.8	NA	NA	NA	NA	NA	32.15	5.21	NA	26.94	NA	NA
MW-9	07/20/2005	400	<0.50	1.4	<0.50	<1.0	NA	45	<2.0	<2.0	<2.0	20	NA	32.15	6.90	NA	25.25	NA	NA
MW-9	10/19/2005	400	<0.50	<0.50	<0.50	<1.0	NA	44	NA	NA	NA	NA	NA	32.15	7.75	NA	24.40	NA	NA
MW-9	01/24/2006	666	<0.500	3.24	<0.500	<0.500	NA	2.96	NA	NA	NA	NA	NA	32.15	4.64	NA	27.51	NA	NA
MW-9	04/19/2006	<50.0	<0.500	<0.500	0.610	<0.500	NA	28.4	NA	NA	NA	NA	NA	32.15	3.48	NA	28.67	NA	NA
MW-10	10/23/1991	27,000	1,600	110	1,800	510	NA	NA	NA	NA	NA	NA	NA	19.74	8.57	NA	11.17	NA	NA
MW-10	01/28/1992	3,800	360	14	170	39	NA	NA	NA	NA	NA	NA	NA	19.74	7.60	NA	12.14	NA	NA
MW-10	05/04/1992	3,000	360	<12.5	140	26	NA	NA	NA	NA	NA	NA	NA	19.74	7.54	NA	12.20	NA	NA
MW-10	07/20/1992	15,000	400	<25	180	67	NA	NA	NA	NA	NA	NA	NA	19.74	8.59	NA	11.15	NA	NA
MW-10	10/12/1992	16,000	320	<50	360	100	NA	NA	NA	NA	NA	NA	NA	19.74	10.23	NA	9.51	NA	NA
MW-10	01/12/1993	Well inaccessible		NA	NA	NA	NA	NA	NA	NA	NA	NA	NA	19.74	NA	NA	NA	NA	NA
MW-10	04/06/1993	14,000	370	<0.5	880	210	NA	NA	NA	NA	NA	NA	NA	19.74	6.70	NA	13.04	NA	NA
MW-10	07/12/1993	10,000	440	58	890	220	NA	NA	NA	NA	NA	NA	NA	19.74	8.05	NA	11.69	NA	NA
MW-10	10/13/1993	15,000	1,000	51	810	170	NA	NA	NA	NA	NA	NA	NA	19.74	8.25	NA	11.49	NA	NA
MW-10	01/20/1994	12,000	820	56	1,100	350	NA	NA	NA	NA	NA	NA	NA	19.74	7.20	NA	12.54	NA	NA
MW-10	04/13/1994	18,000	760	36	700	130	NA	NA	NA	NA	NA	NA	NA	19.74	7.57	NA	12.17	NA	NA
MW-10	07/19/1994	24,000	400	2.30	800	22	NA	NA	NA	NA	NA	NA	NA	19.74	8.18	NA	11.56	NA	NA
MW-10	10/27/1994	11,000	360	43	310	89	NA	NA	NA	NA	NA	NA	NA	19.74	8.68	NA	11.06	NA	NA
MW-10	01/03/1995	17,000	770	38	690	160	NA	NA	NA	NA	NA	NA	NA	19.74	6.86	NA	12.88	NA	NA

WELL CONCENTRATIONS
Former Shell/Current AmeriGas Service Station
3420 San Pablo Avenue
Oakland, CA

Well ID	Date	TPPH (ug/L)	B (ug/L)	T (ug/L)	E (ug/L)	X (ug/L)	MTBE 8020 (ug/L)	MTBE 8260 (ug/L)	DIPE (ug/L)	ETBE (ug/L)	TAME (ug/L)	TBA (ug/L)	Ethanol (ug/L)	TOC (MSL)	Depth to Water (ft.)	Depth to SPH (ft.)	GW Elevation (MSL)	SPH Thickness (ft.)	DO Reading (ppm)
MW-10	04/13/1995	9,900	650	16	280	40	NA	NA	NA	NA	NA	NA	NA	19.74	6.91	NA	12.83	NA	NA
MW-10	06/30/1995	12,000	750	20	480	130	NA	NA	NA	NA	NA	NA	NA	19.74	7.61	NA	12.13	NA	NA
MW-10	01/17/1996	17,000	870	260	93	830	NA	NA	NA	NA	NA	NA	NA	19.74	7.00	NA	12.74	NA	NA
MW-10	04/10/1996	14,000	470	38	110	370	NA	NA	NA	NA	NA	NA	NA	19.74	6.80	NA	NA	NA	NA
MW-10	07/30/1996	NA	NA	NA	NA	NA	NA	NA	NA	NA	NA	NA	NA	19.74	NA	NA	NA	NA	NA
MW-10	10/17/1996	NA	NA	NA	NA	NA	NA	NA	NA	NA	NA	NA	NA	19.74	NA	NA	NA	NA	NA
MW-10	01/22/1997	10,000	520	<20	64	32	180	NA	NA	NA	NA	NA	NA	19.74	6.68	NA	13.06	NA	3.1
MW-10	04/01/1997	11,000	590	<20	53	32	210	NA	NA	NA	NA	NA	NA	19.74	7.34	NA	12.40	NA	2.8
MW-10	07/14/1997	6,600	410	13	28	11	89	NA	NA	NA	NA	NA	NA	19.74	8.10	NA	11.64	NA	1.4
MW-10	10/08/1997	7,600	220	13	65	22	190	NA	NA	NA	NA	NA	NA	19.74	8.20	NA	11.54	NA	6.4
MW-10	01/19/1998	Well inaccessible		NA	NA	NA	NA	NA	NA	NA	NA	NA	NA	19.74	NA	NA	NA	NA	NA
MW-10	04/28/1998	Well inaccessible		NA	NA	NA	NA	NA	NA	NA	NA	NA	NA	19.74	NA	NA	NA	NA	NA
MW-10	09/30/1998	Well inaccessible		NA	NA	NA	NA	NA	NA	NA	NA	NA	NA	19.76	8.11	NA	11.65	NA	NA
MW-10	12/09/1998	28,000	150	<100	240	160	<500	NA	NA	NA	NA	NA	NA	19.76	8.21	NA	11.55	NA	2.7
MW-10	01/18/1999	Well inaccessible		NA	NA	NA	NA	NA	NA	NA	NA	NA	NA	19.76	NA	NA	NA	NA	NA
MW-10	04/12/1999	8,320	71.2	27.4	138	456	<100	NA	NA	NA	NA	NA	NA	19.76	5.96	NA	13.80	NA	1.8
MW-10	07/27/1999	Well inaccessible		NA	NA	NA	NA	NA	NA	NA	NA	NA	NA	19.76	NA	NA	NA	NA	NA
MW-10	10/14/1999	Well inaccessible		NA	NA	NA	NA	NA	NA	NA	NA	NA	NA	19.76	NA	NA	NA	NA	NA
MW-10	01/06/2000	Well inaccessible		NA	NA	NA	NA	NA	NA	NA	NA	NA	NA	19.76	NA	NA	NA	NA	NA
MW-10	02/01/2000	4880	40.2	5.27	27.0	8.42	75.5	23.9	NA	NA	NA	NA	NA	19.76	6.43	NA	13.33	NA	1.6
MW-10	04/05/2000	4,950	97.6	6.72	20.2	5.39	104	NA	NA	NA	NA	NA	NA	19.76	7.00	NA	12.76	NA	1.7
MW-10	07/20/2000	2,800	166	191	27.6	88.7	81.5	NA	NA	NA	NA	NA	NA	19.76	7.03	NA	12.73	NA	1.0
MW-10	10/24/2000	5,070	79.6	46.6	34.2	11.7	242	NA	NA	NA	NA	NA	NA	19.76	7.96	NA	11.80	NA	1.9
MW-10	01/19/2001	Well inaccessible		NA	NA	NA	NA	NA	NA	NA	NA	NA	NA	19.76	NA	NA	NA	NA	NA
MW-10	01/30/2001	6,920	362	14.2	22.7	<10.0	138	NA	NA	NA	NA	NA	NA	30.75	7.32	NA	23.43	NA	2.2
MW-10	04/27/2001	12,000	35	<2.5	37	6.5	NA	51	NA	NA	NA	NA	NA	30.75	8.28	NA	22.47	NA	1.2
MW-10	07/26/2001	Well inaccessible		NA	NA	NA	NA	NA	NA	NA	NA	NA	NA	30.75	NA	NA	NA	NA	NA
MW-10	10/02/2001	Well inaccessible		NA	NA	NA	NA	NA	NA	NA	NA	NA	NA	30.75	NA	NA	NA	NA	NA
MW-10	10/23/2001	470	3.5	<0.50	<0.50	<0.50	NA	<5.0	NA	NA	NA	NA	NA	30.75	7.02	NA	23.73	NA	1.8
MW-10	01/15/2002	3,000	5.4	<0.50	7.9	2.1	NA	12	NA	NA	NA	NA	NA	30.75	6.69	NA	24.06	NA	2.7
MW-10	04/17/2002	5,100	7.9	<1.0	9.3	2.6	NA	15	NA	NA	NA	NA	NA	30.75	7.34	NA	23.41	NA	0.6
MW-10	07/11/2002	5,700	38	2.2	7.8	3.5	NA	43	NA	NA	NA	NA	NA	30.75	7.85	NA	22.90	NA	2.0
MW-10	10/10/2002	4,700	53	2.1	3.8	2.8	NA	80	NA	NA	NA	NA	NA	30.75	8.04	NA	22.71	NA	3.3

WELL CONCENTRATIONS
Former Shell/Current AmeriGas Service Station
3420 San Pablo Avenue
Oakland, CA

Well ID	Date	TPPH (ug/L)	B (ug/L)	T (ug/L)	E (ug/L)	X (ug/L)	MTBE 8020 (ug/L)	MTBE 8260 (ug/L)	DIPE (ug/L)	ETBE (ug/L)	TAME (ug/L)	TBA (ug/L)	Ethanol (ug/L)	TOC (MSL)	Depth to Water (ft.)	Depth to SPH (ft.)	GW Elevation (MSL)	SPH Thickness (ft.)	DO Reading (ppm)
MW-10	01/21/2003	3,900	11	1.0	7.5	2.3	NA	51	NA	NA	NA	NA	NA	30.75	6.81	NA	23.94	NA	1.7
MW-10	05/02/2003	3,100	1.4	<0.50	4.6	1.4	NA	41	NA	NA	NA	NA	NA	30.75	7.12	NA	23.63	NA	0.75
MW-10	07/10/2003	4,200	17	<1.2	6.2	<2.5	NA	51	NA	NA	NA	NA	NA	30.75	7.80	NA	22.95	NA	NA
MW-10	10/28/2003	7,100	20	<5.0	8.4	<10	NA	120	NA	NA	NA	NA	NA	30.75	7.91	NA	22.84	NA	NA
MW-10	01/13/2004	4,800	18	<2.5	6.3	<5.0	NA	99	NA	NA	NA	NA	NA	30.75	6.62	NA	24.13	NA	NA
MW-10	04/01/2004	5,500	6.0	<5.0	<5.0	<10	NA	59	NA	NA	NA	NA	NA	30.75	7.00	NA	23.75	NA	NA
MW-10	07/21/2004	Well inaccessible		NA	NA	NA	NA	NA	NA	NA	NA	NA	NA	30.75	NA	NA	NA	NA	NA
MW-10	07/29/2004	4,700	22	<5.0	5.5	<10	NA	95	<20	<20	<20	<50	NA	30.75	7.60	NA	23.15	NA	NA
MW-10	10/20/2004	4,800	23	<5.0	<5.0	<10	NA	110	NA	NA	NA	NA	NA	30.75	7.90	NA	22.85	NA	NA
MW-10	01/19/2005	1,200	1.1	<0.50	<0.50	<1.0	NA	30	NA	NA	NA	NA	NA	30.75	6.28	NA	24.47	NA	NA
MW-10	04/20/2005	3,900	3.9	<0.50	2.7	<1.0	NA	9.0	NA	NA	NA	NA	NA	30.75	6.80	NA	23.95	NA	NA
MW-10	07/20/2005	3,000	8.1	1.2	2.1	1.4	NA	35	29	<2.0	<2.0	19	NA	30.75	7.82	NA	22.93	NA	NA
MW-10	10/19/2005	1,900	2.9	0.62	0.85	<1.0	NA	39	NA	NA	NA	NA	NA	30.75	8.30	NA	22.45	NA	NA
MW-10	01/24/2006	6,110	0.710	<0.500	2.01	<0.500	NA	20.1	NA	NA	NA	NA	NA	30.75	6.47	NA	24.28	NA	NA
MW-10	04/19/2006	<50.0	<0.500	<0.500	<0.500	<0.500	NA	2.64	NA	NA	NA	NA	NA	30.75	5.89	NA	24.86	NA	NA

MW-11	10/23/1991	140	<12	<0.3	0.37	0.56	NA	NA	NA	NA	NA	NA	NA	22.06	8.06	NA	8.06	NA	NA
MW-11	01/28/1992	<50	<0.5	<0.5	<0.5	<0.5	NA	NA	NA	NA	NA	NA	NA	22.06	8.74	NA	3.32	NA	NA
MW-11	05/04/1992	<50	<0.5	<0.5	<0.5	<0.5	NA	NA	NA	NA	NA	NA	NA	22.06	8.29	NA	13.77	NA	NA
MW-11	07/13/1992	140	<0.5	<0.5	<0.5	<0.5	NA	NA	NA	NA	NA	NA	NA	22.06	10.50	NA	11.56	NA	NA
MW-11	10/12/1992	75	<0.5	<0.5	<0.5	<0.5	NA	NA	NA	NA	NA	NA	NA	22.06	12.40	NA	9.66	NA	NA
MW-11	01/12/1993	Well inaccessible		NA	NA	NA	NA	NA	NA	NA	NA	NA	NA	22.06	NA	NA	NA	NA	NA
MW-11	04/06/1993	Well inaccessible		NA	NA	NA	NA	NA	NA	NA	NA	NA	NA	22.06	NA	NA	NA	NA	NA
MW-11	07/12/1993	Well inaccessible		NA	NA	NA	NA	NA	NA	NA	NA	NA	NA	22.06	NA	NA	NA	NA	NA
MW-11	10/13/1993	<50	<0.5	<0.5	<0.5	<0.5	NA	NA	NA	NA	NA	NA	NA	22.06	11.47	NA	10.59	NA	NA
MW-11	01/20/1994	<50	<0.5	<0.5	<0.5	<0.5	NA	NA	NA	NA	NA	NA	NA	22.06	9.09	NA	12.97	NA	NA
MW-11	04/13/1994	<50	<0.5	<0.5	<0.5	<0.5	NA	NA	NA	NA	NA	NA	NA	22.06	8.02	NA	14.04	NA	NA
MW-11	07/19/1994	50	<0.5	<0.5	<0.5	<0.5	NA	NA	NA	NA	NA	NA	NA	22.06	9.82	NA	12.24	NA	NA
MW-11	10/27/1994	60*	<0.5	<0.5	<0.5	<0.5	NA	NA	NA	NA	NA	NA	NA	22.06	11.66	NA	10.40	NA	NA
MW-11	01/03/1995	<50	<0.5	<0.5	<0.5	<0.5	NA	NA	NA	NA	NA	NA	NA	22.06	6.15	NA	15.91	NA	NA
MW-11	04/13/1995	<50	<0.5	<0.5	<0.5	<0.5	NA	NA	NA	NA	NA	NA	NA	22.06	6.00	NA	16.06	NA	NA
MW-11	06/30/1995	70	<0.5	<0.5	<0.5	<0.5	NA	NA	NA	NA	NA	NA	NA	22.06	8.31	NA	13.75	NA	NA
MW-11	10/11/1995	60	53	<0.5	<0.5	0.80	3.0	NA	NA	NA	NA	NA	NA	22.06	10.30	NA	11.76	NA	NA

WELL CONCENTRATIONS
Former Shell/Current AmeriGas Service Station
3420 San Pablo Avenue
Oakland, CA

Well ID	Date	TPPH (ug/L)	B (ug/L)	T (ug/L)	E (ug/L)	X (ug/L)	MTBE 8020 (ug/L)	MTBE 8260 (ug/L)	DIPE (ug/L)	ETBE (ug/L)	TAME (ug/L)	TBA (ug/L)	Ethanol (ug/L)	TOC (MSL)	Depth to Water (ft.)	Depth to SPH (ft.)	GW Elevation (MSL)	SPH Thickness (ft.)	DO Reading (ppm)
MW-11	01/17/1996	<50	<0.5	<0.5	<0.5	<0.5	<2	NA	NA	NA	NA	NA	NA	22.06	6.45	NA	15.61	NA	NA
MW-11	04/10/1996	<50	<0.5	<0.5	<0.5	<0.5	3.9	NA	NA	NA	NA	NA	NA	22.06	6.05	NA	16.01	NA	NA
MW-11	07/30/1996	<50	<0.5	<0.5	<0.5	<0.5	<2.5	NA	NA	NA	NA	NA	NA	22.06	8.92	NA	13.14	NA	NA
MW-11	10/17/1996	3,000	28	23	29	210	76	NA	NA	NA	NA	NA	NA	22.06	9.24	NA	12.82	NA	NA
MW-11	01/22/1997	<50	<0.5	<0.5	<0.5	<0.5	<2.5	NA	NA	NA	NA	NA	NA	22.06	5.12	NA	16.94	NA	3.7
MW-11	04/01/1997	<50	<0.50	<0.50	<0.50	<0.50	<2.5	NA	NA	NA	NA	NA	NA	22.06	7.41	NA	14.65	NA	2.8
MW-11	07/14/1997	<50	<0.50	<0.50	<0.50	<0.50	<2.5	NA	NA	NA	NA	NA	NA	22.06	9.74	NA	12.32	NA	1.9
MW-11	10/08/1997	<50	<0.50	<0.50	<0.50	<0.50	<2.5	NA	NA	NA	NA	NA	NA	22.06	10.23	NA	11.83	NA	2.4
MW-11	01/19/1998	<50	<0.50	<0.50	<0.50	<0.50	<2.5	NA	NA	NA	NA	NA	NA	22.06	3.69	NA	18.37	NA	3.2
MW-11	04/28/1998	<50	<0.50	<0.50	<0.50	<0.50	<2.5	NA	NA	NA	NA	NA	NA	22.06	5.83	NA	16.23	NA	3.0
MW-11	09/30/1998	Well inaccessible		NA	NA	NA	NA	NA	NA	NA	NA	NA	NA	22.06	NA	NA	NA	NA	NA
MW-11	12/09/1998	Well inaccessible		NA	NA	NA	NA	NA	NA	NA	NA	NA	NA	22.06	NA	NA	NA	NA	NA
MW-11	01/18/1999	Well inaccessible		NA	NA	NA	NA	NA	NA	NA	NA	NA	NA	22.06	NA	NA	NA	NA	NA
MW-11	04/12/1999	Well inaccessible		NA	NA	NA	NA	NA	NA	NA	NA	NA	NA	22.06	NA	NA	NA	NA	NA
MW-11	04/26/1999	63	<0.50	<0.50	<0.50	<0.50	<2.5	NA	NA	NA	NA	NA	NA	22.06	5.80	NA	16.26	NA	3.6
MW-11	07/27/1999	<50.0	<0.500	<0.500	<0.500	<0.500	6.02	NA	NA	NA	NA	NA	NA	22.06	8.30	NA	13.76	NA	2.0
MW-11	10/14/1999	<50.0	<0.500	<0.500	<0.500	<0.500	<5.00	NA	NA	NA	NA	NA	NA	22.06	8.99	NA	13.07	NA	2.4
MW-11	01/06/2000	<50.0	<0.500	<0.500	<0.500	<0.500	<2.50	NA	NA	NA	NA	NA	NA	22.06	9.93	NA	12.13	NA	2.9
MW-11	04/05/2000	<50.0	<0.500	<0.500	<0.500	<0.500	3.53	NA	NA	NA	NA	NA	NA	22.06	5.90	NA	16.16	NA	1.8
MW-11	07/20/2000	<50.0	<0.500	<0.500	<0.500	<0.500	<2.50	NA	NA	NA	NA	NA	NA	22.06	6.13	NA	15.93	NA	1.7
MW-11	10/24/2000	NA	NA	NA	NA	NA	NA	NA	NA	NA	NA	NA	NA	22.06	7.45	NA	14.61	NA	NA
MW-11	01/19/2001	<50.0	<0.500	<0.500	<0.500	<0.500	4.29	NA	NA	NA	NA	NA	NA	32.99	5.95	NA	27.04	NA	1.6
MW-11	04/27/2001	NA	NA	NA	NA	NA	NA	NA	NA	NA	NA	NA	NA	32.99	6.12	NA	26.87	NA	NA
MW-11	07/26/2001	<50	<0.50	<0.50	<0.50	<0.50	NA	<5.0	NA	NA	NA	NA	NA	32.99	7.65	NA	25.34	NA	2.1
MW-11	10/02/2001	NA	NA	NA	NA	NA	NA	NA	NA	NA	NA	NA	NA	32.99	6.17	NA	26.82	NA	NA
MW-11	01/15/2002	69	<0.50	<0.50	<0.50	<0.50	NA	<5.0	NA	NA	NA	NA	NA	32.99	4.95	NA	28.04	NA	1.5
MW-11	04/17/2002	NA	NA	NA	NA	NA	NA	NA	NA	NA	NA	NA	NA	32.99	6.35	NA	26.64	NA	NA
MW-11	07/11/2002	58	<0.50	<0.50	<0.50	<0.50	NA	<5.0	NA	NA	NA	NA	NA	32.99	7.47	NA	25.52	NA	2.3
MW-11	10/10/2002	NA	NA	NA	NA	NA	NA	NA	NA	NA	NA	NA	NA	32.99	8.45	NA	24.54	NA	NA
MW-11	01/21/2003	57	<0.50	<0.50	<0.50	<0.50	NA	<5.0	NA	NA	NA	NA	NA	32.99	5.45	NA	27.54	NA	1.4
MW-11	05/02/2003	NA	NA	NA	NA	NA	NA	NA	NA	NA	NA	NA	NA	32.99	5.14	NA	27.85	NA	NA
MW-11	07/10/2003	<50	<0.50	<0.50	<0.50	<1.0	NA	2.1	NA	NA	NA	NA	NA	32.99	7.41	NA	25.58	NA	NA
MW-11	10/28/2003	NA	NA	NA	NA	NA	NA	NA	NA	NA	NA	NA	NA	32.99	7.78	NA	25.21	NA	NA

WELL CONCENTRATIONS
Former Shell/Current AmeriGas Service Station
3420 San Pablo Avenue
Oakland, CA

Well ID	Date	TPPH (ug/L)	B (ug/L)	T (ug/L)	E (ug/L)	X (ug/L)	MTBE 8020 (ug/L)	MTBE 8260 (ug/L)	DIPE (ug/L)	ETBE (ug/L)	TAME (ug/L)	TBA (ug/L)	Ethanol (ug/L)	TOC (MSL)	Depth to Water (ft.)	Depth to SPH (ft.)	GW Elevation (MSL)	SPH Thickness (ft.)	DO Reading (ppm)
MW-11	01/13/2004	56 d	<0.50	0.50	<0.50	<1.0	NA	2.9	NA	NA	NA	NA	NA	32.99	5.85	NA	27.14	NA	NA
MW-11	04/01/2004	NA	NA	NA	NA	NA	NA	NA	NA	NA	NA	NA	NA	32.99	6.02	NA	26.97	NA	NA
MW-11	07/21/2004	<50	<0.50	<0.50	<0.50	<1.0	NA	2.2	<2.0	<2.0	<2.0	<5.0	NA	32.99	7.52	NA	25.47	NA	NA
MW-11	10/20/2004	NA	NA	NA	NA	NA	NA	NA	NA	NA	NA	NA	NA	32.99	7.20	NA	25.79	NA	NA
MW-11	01/19/2005	<50	<0.50	<0.50	<0.50	<1.0	NA	1.8	NA	NA	NA	NA	NA	32.99	4.50	NA	28.49	NA	NA
MW-11	04/20/2005	NA	NA	NA	NA	NA	NA	NA	NA	NA	NA	NA	NA	32.99	5.09	NA	27.90	NA	NA
MW-11	07/20/2005	53 f	<0.50	<0.50	<0.50	<1.0	NA	2.9	<2.0	<2.0	<2.0	<5.0	NA	32.99	7.31	NA	25.68	NA	NA
MW-11	10/19/2005	NA	NA	NA	NA	NA	NA	NA	NA	NA	NA	NA	NA	32.99	8.60	NA	24.39	NA	NA
MW-11	01/24/2006	<50.0	<0.500	<0.500	<0.500	<0.500	NA	1.38	NA	NA	NA	NA	NA	32.99	4.38	NA	28.61	NA	NA
MW-11	04/19/2006	NA	NA	NA	NA	NA	NA	NA	NA	NA	NA	NA	NA	32.99	3.86	NA	29.13	NA	NA

Abbreviations:

TPPH = Total petroleum hydrocarbons as gasoline by modified EPA Method 8260B; prior to April 27, 2001, analyzed by EPA Method 8015.

BTEX = Benzene, toluene, ethylbenzene, xylenes by EPA Method 8260B; prior to April 27, 2001, analyzed by EPA Method 8020.

MTBE = Methyl tertiary butyl ether

DIPE = Di-isopropyl ether, analyzed by EPA Method 8260B

ETBE = Ethyl tertiary butyl ether, analyzed by EPA Method 8260B

TAME = Tertiary butyl methyl ether, analyzed by EPA Method 8260B

TBA = Tertiary butyl alcohol, analyzed by EPA Method 8260B

TOC = Top of Casing Elevation

SPH = Separate-Phase Hydrocarbons

GW = Groundwater

DO = Dissolved Oxygen

ug/L = Parts per billion

ppm = Parts per million

MSL = Mean sea level

ft. = Feet

<n = Below detection limit

(D) = Duplicate sample

NA = Not applicable

WELL CONCENTRATIONS
Former Shell/Current AmeriGas Service Station
3420 San Pablo Avenue
Oakland, CA

Well ID	Date	TPPH (ug/L)	B (ug/L)	T (ug/L)	E (ug/L)	X (ug/L)	MTBE 8020 (ug/L)	MTBE 8260 (ug/L)	DIPE (ug/L)	ETBE (ug/L)	TAME (ug/L)	TBA (ug/L)	Ethanol (ug/L)	TOC (MSL)	Depth to Water (ft.)	Depth to SPH (ft.)	GW Elevation (MSL)	SPH Thickness (ft.)	DO Reading (ppm)
---------	------	----------------	-------------	-------------	-------------	-------------	------------------------	------------------------	----------------	----------------	----------------	---------------	-------------------	--------------	----------------------------	--------------------------	--------------------------	---------------------------	------------------------

Notes:

a = Chromatogram pattern indicates an unidentified hydrocarbon.

b = MTBE could not be quantified due to co-eluting compounds.

c = The highest recovery value for TPH has been reported, but this should be considered an estimate. Repeated analysis yielded inconsistent results.

d = Hydrocarbon does not match pattern of laboratory's standard.

e = SPH present in well measured at less than 0.01 feet. Visual inspection revealed the presence of distinct phases within the sample, indicating the possible presence of undissolved hydrocarbons.

f = The concentration reported reflects individual or discrete unidentified peaks not matching a typical fuel pattern.

* = This sample was analyzed outside the EPA recommended holding time.

When separate-phase hydrocarbons are present, groundwater elevations is adjusted using the equation:

$$\text{Corrected Groundwater Elevation} = \text{Top of Casing Elevation} - \text{Depth to water} + (0.8 \times \text{Hydrocarbon Thickness}).$$

Resurvey of wells was performed on August 28, 1998 by Virgil Chavez Land Surveying of Vallejo, CA..

All wells except MW-11 surveyed February 26, 2001 by Virgil Chavez Land Surveying of Vallejo, CA.

May 01, 2006

Client: Cambria Env. Tech. (Sonoma) / SHELL (13674)
270 Perkins Street
Sonoma, CA 95476
Attn: Ana Friel

Work Order: NPD2697
Project Name: 3420 San Pablo Ave., Oakland, CA
Project Nbr: SAP 139619
P/O Nbr: 98995748
Date Received: 04/21/06

SAMPLE IDENTIFICATION	LAB NUMBER	COLLECTION DATE AND TIME
MW-1	NPD2697-01	04/19/06 13:25
MW-2	NPD2697-02	04/19/06 13:40
MW-4	NPD2697-03	04/19/06 13:05
MW-5	NPD2697-04	04/19/06 13:20
MW-6R	NPD2697-05	04/19/06 12:35
MW-7	NPD2697-06	04/19/06 13:35
MW-9	NPD2697-07	04/19/06 09:30
MW-10	NPD2697-08	04/19/06 10:15

An executed copy of the chain of custody, the project quality control data, and the sample receipt form are also included as an addendum to this report. If you have any questions relating to this analytical report, please contact your Laboratory Project Manager at 1-800-765-0980. Any opinions, if expressed, are outside the scope of the Laboratory's accreditation.

This material is intended only for the use of the individual(s) or entity to whom it is addressed, and may contain information that is privileged and confidential. If you are not the intended recipient, or the employee or agent responsible for delivering this material to the intended recipient, you are hereby notified that any dissemination, distribution, or copying of this material is strictly prohibited. If you have received this material in error, please notify us immediately at 615-726-0177.

California Certification Number: 01168CA

The Chain(s) of Custody, 2 pages, are included and are an integral part of this report.

These results relate only to the items tested. This report shall not be reproduced except in full and with permission of the laboratory.

Report Approved By:



Jim Hatfield
Project Management

Client Cambria Env. Tech. (Sonoma) / SHELL (13674)
 270 Perkins Street
 Sonoma, CA 95476
 Attn Ana Friel

Work Order: NPD2697
 Project Name: 3420 San Pablo Ave., Oakland, CA
 Project Number: SAP 139619
 Received: 04/21/06 08:10

ANALYTICAL REPORT

Analyte	Result	Flag	Units	MRL	Dilution Factor	Analysis Date/Time	Method	Batch
Sample ID: NPD2697-01 (MW-1 - Water) Sampled: 04/19/06 13:25								
Selected Volatile Organic Compounds by EPA Method 8260B								
Benzene	10.3		ug/L	0.500	1	04/26/06 18:11	SW846 8260B	6044945
Ethylbenzene	2.44		ug/L	0.500	1	04/26/06 18:11	SW846 8260B	6044945
Methyl tert-Butyl Ether	27.2		ug/L	0.500	1	04/26/06 18:11	SW846 8260B	6044945
Toluene	1.04		ug/L	0.500	1	04/26/06 18:11	SW846 8260B	6044945
Xylenes, total	ND		ug/L	0.500	1	04/26/06 18:11	SW846 8260B	6044945
Surr: 1,2-Dichloroethane-d4 (70-130%)	94 %					04/26/06 18:11	SW846 8260B	6044945
Surr: Dibromofluoromethane (79-122%)	105 %					04/26/06 18:11	SW846 8260B	6044945
Surr: Toluene-d8 (78-121%)	103 %					04/26/06 18:11	SW846 8260B	6044945
Surr: 4-Bromofluorobenzene (78-126%)	103 %					04/26/06 18:11	SW846 8260B	6044945
Purgeable Petroleum Hydrocarbons								
Gasoline Range Organics	2030		ug/L	50.0	1	04/26/06 18:11	CA LUFT GC/MS	6044945
Sample ID: NPD2697-02RE1 (MW-2 - Water) Sampled: 04/19/06 13:40								
Selected Volatile Organic Compounds by EPA Method 8260B								
Benzene	2520		ug/L	25.0	50	04/27/06 16:53	SW846 8260B	6045320
Ethylbenzene	1610		ug/L	25.0	50	04/27/06 16:53	SW846 8260B	6045320
Methyl tert-Butyl Ether	104		ug/L	0.500	1	04/26/06 13:45	SW846 8260B	6044945
Toluene	13.2		ug/L	0.500	1	04/26/06 13:45	SW846 8260B	6044945
Xylenes, total	343		ug/L	0.500	1	04/26/06 13:45	SW846 8260B	6044945
Surr: 1,2-Dichloroethane-d4 (70-130%)	96 %					04/26/06 13:45	SW846 8260B	6044945
Surr: 1,2-Dichloroethane-d4 (70-130%)	88 %					04/27/06 16:53	SW846 8260B	6045320
Surr: Dibromofluoromethane (79-122%)	107 %					04/26/06 13:45	SW846 8260B	6044945
Surr: Dibromofluoromethane (79-122%)	100 %					04/27/06 16:53	SW846 8260B	6045320
Surr: Toluene-d8 (78-121%)	104 %					04/26/06 13:45	SW846 8260B	6044945
Surr: Toluene-d8 (78-121%)	104 %					04/27/06 16:53	SW846 8260B	6045320
Surr: 4-Bromofluorobenzene (78-126%)	104 %					04/26/06 13:45	SW846 8260B	6044945
Surr: 4-Bromofluorobenzene (78-126%)	102 %					04/27/06 16:53	SW846 8260B	6045320
Purgeable Petroleum Hydrocarbons								
Gasoline Range Organics	ND		ug/L	2500	50	04/27/06 16:53	CA LUFT GC/MS	6045320
Sample ID: NPD2697-03RE1 (MW-4 - Water) Sampled: 04/19/06 13:05								
Selected Volatile Organic Compounds by EPA Method 8260B								
Benzene	6.40		ug/L	0.500	1	04/27/06 13:55	SW846 8260B	6045320
Ethylbenzene	0.610		ug/L	0.500	1	04/27/06 13:55	SW846 8260B	6045320
Methyl tert-Butyl Ether	134		ug/L	0.500	1	04/26/06 14:07	SW846 8260B	6044945
Toluene	ND		ug/L	0.500	1	04/27/06 13:55	SW846 8260B	6045320
Xylenes, total	ND		ug/L	0.500	1	04/26/06 14:07	SW846 8260B	6044945
Surr: 1,2-Dichloroethane-d4 (70-130%)	98 %					04/26/06 14:07	SW846 8260B	6044945
Surr: 1,2-Dichloroethane-d4 (70-130%)	92 %					04/27/06 13:55	SW846 8260B	6045320
Surr: Dibromofluoromethane (79-122%)	104 %					04/26/06 14:07	SW846 8260B	6044945
Surr: Dibromofluoromethane (79-122%)	105 %					04/27/06 13:55	SW846 8260B	6045320
Surr: Toluene-d8 (78-121%)	102 %					04/26/06 14:07	SW846 8260B	6044945
Surr: Toluene-d8 (78-121%)	102 %					04/27/06 13:55	SW846 8260B	6045320
Surr: 4-Bromofluorobenzene (78-126%)	105 %					04/26/06 14:07	SW846 8260B	6044945

Client Cambria Env. Tech. (Sonoma) / SHELL (13674)
 270 Perkins Street
 Sonoma, CA 95476
 Attn Ana Friel

Work Order: NPD2697
 Project Name: 3420 San Pablo Ave., Oakland, CA
 Project Number: SAP 139619
 Received: 04/21/06 08:10

ANALYTICAL REPORT

Analyte	Result	Flag	Units	MRL	Dilution Factor	Analysis Date/Time	Method	Batch
Sample ID: NPD2697-03RE1 (MW-4 - Water) - cont. Sampled: 04/19/06 13:05								
Selected Volatile Organic Compounds by EPA Method 8260B - cont.								
<i>Surr: 4-Bromofluorobenzene (78-126%)</i>	99 %					04/27/06 13:55	SW846 8260B	6045320
Purgeable Petroleum Hydrocarbons								
Gasoline Range Organics	430		ug/L	50.0	1	04/27/06 13:55	CA LUFT GC/MS	6045320
Sample ID: NPD2697-04RE1 (MW-5 - Water) Sampled: 04/19/06 13:20								
Selected Volatile Organic Compounds by EPA Method 8260B								
Benzene	0.710		ug/L	0.500	1	04/27/06 14:18	SW846 8260B	6045320
Ethylbenzene	1.09		ug/L	0.500	1	04/26/06 14:30	SW846 8260B	6044945
Methyl tert-Butyl Ether	67.1		ug/L	0.500	1	04/26/06 14:30	SW846 8260B	6044945
Toluene	1.26		ug/L	0.500	1	04/27/06 14:18	SW846 8260B	6045320
Xylenes, total	ND		ug/L	0.500	1	04/26/06 14:30	SW846 8260B	6044945
<i>Surr: 1,2-Dichloroethane-d4 (70-130%)</i>	97 %					04/26/06 14:30	SW846 8260B	6044945
<i>Surr: 1,2-Dichloroethane-d4 (70-130%)</i>	88 %					04/27/06 14:18	SW846 8260B	6045320
<i>Surr: Dibromofluoromethane (79-122%)</i>	106 %					04/26/06 14:30	SW846 8260B	6044945
<i>Surr: Dibromofluoromethane (79-122%)</i>	103 %					04/27/06 14:18	SW846 8260B	6045320
<i>Surr: Toluene-d8 (78-121%)</i>	105 %					04/26/06 14:30	SW846 8260B	6044945
<i>Surr: Toluene-d8 (78-121%)</i>	101 %					04/27/06 14:18	SW846 8260B	6045320
<i>Surr: 4-Bromofluorobenzene (78-126%)</i>	104 %					04/26/06 14:30	SW846 8260B	6044945
<i>Surr: 4-Bromofluorobenzene (78-126%)</i>	101 %					04/27/06 14:18	SW846 8260B	6045320
Purgeable Petroleum Hydrocarbons								
Gasoline Range Organics	5010		ug/L	50.0	1	04/26/06 14:30	CA LUFT GC/MS	6044945
Sample ID: NPD2697-05RE1 (MW-6R - Water) Sampled: 04/19/06 12:35								
Selected Volatile Organic Compounds by EPA Method 8260B								
Benzene	1040		ug/L	5.00	10	04/27/06 16:09	SW846 8260B	6045320
Ethylbenzene	1430		ug/L	5.00	10	04/27/06 16:09	SW846 8260B	6045320
Methyl tert-Butyl Ether	130		ug/L	0.500	1	04/26/06 14:52	SW846 8260B	6044945
Toluene	9.41		ug/L	0.500	1	04/26/06 14:52	SW846 8260B	6044945
Xylenes, total	1280		ug/L	5.00	10	04/27/06 16:09	SW846 8260B	6045320
<i>Surr: 1,2-Dichloroethane-d4 (70-130%)</i>	96 %					04/26/06 14:52	SW846 8260B	6044945
<i>Surr: 1,2-Dichloroethane-d4 (70-130%)</i>	87 %					04/27/06 16:09	SW846 8260B	6045320
<i>Surr: Dibromofluoromethane (79-122%)</i>	107 %					04/26/06 14:52	SW846 8260B	6044945
<i>Surr: Dibromofluoromethane (79-122%)</i>	101 %					04/27/06 16:09	SW846 8260B	6045320
<i>Surr: Toluene-d8 (78-121%)</i>	112 %					04/26/06 14:52	SW846 8260B	6044945
<i>Surr: Toluene-d8 (78-121%)</i>	103 %					04/27/06 16:09	SW846 8260B	6045320
<i>Surr: 4-Bromofluorobenzene (78-126%)</i>	111 %					04/26/06 14:52	SW846 8260B	6044945
<i>Surr: 4-Bromofluorobenzene (78-126%)</i>	101 %					04/27/06 16:09	SW846 8260B	6045320
Purgeable Petroleum Hydrocarbons								
Gasoline Range Organics	62200		ug/L	500	10	04/27/06 16:09	CA LUFT GC/MS	6045320

Client Cambria Env. Tech. (Sonoma) / SHELL (13674)
 270 Perkins Street
 Sonoma, CA 95476
 Attn Ana Friel

Work Order: NPD2697
 Project Name: 3420 San Pablo Ave., Oakland, CA
 Project Number: SAP 139619
 Received: 04/21/06 08:10

ANALYTICAL REPORT

Analyte	Result	Flag	Units	MRL	Dilution Factor	Analysis Date/Time	Method	Batch
Sample ID: NPD2697-06RE1 (MW-7 - Water) Sampled: 04/19/06 13:35								
Selected Volatile Organic Compounds by EPA Method 8260B								
Benzene	378		ug/L	5.00	10	04/27/06 16:31	SW846 8260B	6045320
Ethylbenzene	66.0		ug/L	0.500	1	04/26/06 15:14	SW846 8260B	6044945
Methyl tert-Butyl Ether	74.0		ug/L	0.500	1	04/26/06 15:14	SW846 8260B	6044945
Toluene	1.82		ug/L	0.500	1	04/26/06 15:14	SW846 8260B	6044945
Xylenes, total	177		ug/L	0.500	1	04/26/06 15:14	SW846 8260B	6044945
Surr: 1,2-Dichloroethane-d4 (70-130%)	93 %					04/26/06 15:14	SW846 8260B	6044945
Surr: 1,2-Dichloroethane-d4 (70-130%)	90 %					04/27/06 16:31	SW846 8260B	6045320
Surr: Dibromofluoromethane (79-122%)	101 %					04/26/06 15:14	SW846 8260B	6044945
Surr: Dibromofluoromethane (79-122%)	104 %					04/27/06 16:31	SW846 8260B	6045320
Surr: Toluene-d8 (78-121%)	103 %					04/26/06 15:14	SW846 8260B	6044945
Surr: Toluene-d8 (78-121%)	104 %					04/27/06 16:31	SW846 8260B	6045320
Surr: 4-Bromofluorobenzene (78-126%)	107 %					04/26/06 15:14	SW846 8260B	6044945
Surr: 4-Bromofluorobenzene (78-126%)	99 %					04/27/06 16:31	SW846 8260B	6045320
Purgeable Petroleum Hydrocarbons								
Gasoline Range Organics	135000		ug/L	1000	20	04/29/06 16:10	CA LUFT GC/MS	6045333
Surr: 1,2-Dichloroethane-d4 (0-200%)	90 %					04/29/06 16:10	CA LUFT GC/MS	6045333
Surr: Dibromofluoromethane (0-200%)	104 %					04/29/06 16:10	CA LUFT GC/MS	6045333
Surr: Toluene-d8 (0-200%)	102 %					04/29/06 16:10	CA LUFT GC/MS	6045333
Surr: 4-Bromofluorobenzene (0-200%)	101 %					04/29/06 16:10	CA LUFT GC/MS	6045333
Sample ID: NPD2697-07RE1 (MW-9 - Water) Sampled: 04/19/06 09:30								
Selected Volatile Organic Compounds by EPA Method 8260B								
Benzene	ND		ug/L	0.500	1	04/27/06 14:40	SW846 8260B	6045320
Ethylbenzene	0.610		ug/L	0.500	1	04/26/06 15:36	SW846 8260B	6044945
Methyl tert-Butyl Ether	28.4		ug/L	0.500	1	04/26/06 15:36	SW846 8260B	6044945
Toluene	ND		ug/L	0.500	1	04/26/06 15:36	SW846 8260B	6044945
Xylenes, total	ND		ug/L	0.500	1	04/26/06 15:36	SW846 8260B	6044945
Surr: 1,2-Dichloroethane-d4 (70-130%)	95 %					04/26/06 15:36	SW846 8260B	6044945
Surr: 1,2-Dichloroethane-d4 (70-130%)	88 %					04/27/06 14:40	SW846 8260B	6045320
Surr: Dibromofluoromethane (79-122%)	103 %					04/26/06 15:36	SW846 8260B	6044945
Surr: Dibromofluoromethane (79-122%)	99 %					04/27/06 14:40	SW846 8260B	6045320
Surr: Toluene-d8 (78-121%)	104 %					04/26/06 15:36	SW846 8260B	6044945
Surr: Toluene-d8 (78-121%)	101 %					04/27/06 14:40	SW846 8260B	6045320
Surr: 4-Bromofluorobenzene (78-126%)	103 %					04/26/06 15:36	SW846 8260B	6044945
Surr: 4-Bromofluorobenzene (78-126%)	101 %					04/27/06 14:40	SW846 8260B	6045320
Purgeable Petroleum Hydrocarbons								
Gasoline Range Organics	ND		ug/L	50.0	1	04/26/06 15:36	CA LUFT GC/MS	6044945
Sample ID: NPD2697-08RE1 (MW-10 - Water) Sampled: 04/19/06 10:15								
Selected Volatile Organic Compounds by EPA Method 8260B								
Benzene	ND		ug/L	0.500	1	04/27/06 15:02	SW846 8260B	6045320
Ethylbenzene	ND		ug/L	0.500	1	04/26/06 15:58	SW846 8260B	6044945
Methyl tert-Butyl Ether	2.64		ug/L	0.500	1	04/26/06 15:58	SW846 8260B	6044945
Toluene	ND		ug/L	0.500	1	04/26/06 15:58	SW846 8260B	6044945

Client Cambria Env. Tech. (Sonoma) / SHELL (13674)
 270 Perkins Street
 Sonoma, CA 95476
 Attn Ana Friel

Work Order: NPD2697
 Project Name: 3420 San Pablo Ave., Oakland, CA
 Project Number: SAP 139619
 Received: 04/21/06 08:10

ANALYTICAL REPORT

Analyte	Result	Flag	Units	MRL	Dilution Factor	Analysis Date/Time	Method	Batch
Sample ID: NPD2697-08 (MW-10 - Water) - cont. Sampled: 04/19/06 10:15								
Selected Volatile Organic Compounds by EPA Method 8260B - cont.								
Xylenes, total	ND		ug/L	0.500	1	04/26/06 15:58	SW846 8260B	6044945
Surr: 1,2-Dichloroethane-d4 (70-130%)	93 %					04/26/06 15:58	SW846 8260B	6044945
Surr: 1,2-Dichloroethane-d4 (70-130%)	91 %					04/27/06 15:02	SW846 8260B	6045320
Surr: Dibromofluoromethane (79-122%)	103 %					04/26/06 15:58	SW846 8260B	6044945
Surr: Dibromofluoromethane (79-122%)	103 %					04/27/06 15:02	SW846 8260B	6045320
Surr: Toluene-d8 (78-121%)	104 %					04/26/06 15:58	SW846 8260B	6044945
Surr: Toluene-d8 (78-121%)	103 %					04/27/06 15:02	SW846 8260B	6045320
Surr: 4-Bromofluorobenzene (78-126%)	103 %					04/26/06 15:58	SW846 8260B	6044945
Surr: 4-Bromofluorobenzene (78-126%)	103 %					04/27/06 15:02	SW846 8260B	6045320
Purgeable Petroleum Hydrocarbons								
Gasoline Range Organics	ND		ug/L	50.0	1	04/26/06 15:58	CA LUFT GC/MS	6044945

Client Cambria Env. Tech. (Sonoma) / SHELL (13674)
 270 Perkins Street
 Sonoma, CA 95476
 Attn Ana Friel

Work Order: NPD2697
 Project Name: 3420 San Pablo Ave., Oakland, CA
 Project Number: SAP 139619
 Received: 04/21/06 08:10

PROJECT QUALITY CONTROL DATA
Blank

Analyte	Blank Value	Q	Units	Q.C. Batch	Lab Number	Analyzed Date/Time
---------	-------------	---	-------	------------	------------	--------------------

Selected Volatile Organic Compounds by EPA Method 8260B

6044945-BLK1

Benzene	<0.200		ug/L	6044945	6044945-BLK1	04/26/06 10:25
Ethylbenzene	<0.200		ug/L	6044945	6044945-BLK1	04/26/06 10:25
Methyl tert-Butyl Ether	<0.200		ug/L	6044945	6044945-BLK1	04/26/06 10:25
Toluene	<0.200		ug/L	6044945	6044945-BLK1	04/26/06 10:25
Xylenes, total	<0.350		ug/L	6044945	6044945-BLK1	04/26/06 10:25
Surrogate: 1,2-Dichloroethane-d4	98%			6044945	6044945-BLK1	04/26/06 10:25
Surrogate: Dibromofluoromethane	103%			6044945	6044945-BLK1	04/26/06 10:25
Surrogate: Toluene-d8	106%			6044945	6044945-BLK1	04/26/06 10:25
Surrogate: 4-Bromofluorobenzene	108%			6044945	6044945-BLK1	04/26/06 10:25

6045320-BLK1

Benzene	<0.200		ug/L	6045320	6045320-BLK1	04/27/06 12:55
Ethylbenzene	<0.200		ug/L	6045320	6045320-BLK1	04/27/06 12:55
Methyl tert-Butyl Ether	<0.200		ug/L	6045320	6045320-BLK1	04/27/06 12:55
Toluene	<0.200		ug/L	6045320	6045320-BLK1	04/27/06 12:55
Xylenes, total	<0.350		ug/L	6045320	6045320-BLK1	04/27/06 12:55
Surrogate: 1,2-Dichloroethane-d4	89%			6045320	6045320-BLK1	04/27/06 12:55
Surrogate: Dibromofluoromethane	101%			6045320	6045320-BLK1	04/27/06 12:55
Surrogate: Toluene-d8	101%			6045320	6045320-BLK1	04/27/06 12:55
Surrogate: 4-Bromofluorobenzene	103%			6045320	6045320-BLK1	04/27/06 12:55

Purgeable Petroleum Hydrocarbons

6044945-BLK1

Gasoline Range Organics	<50.0		ug/L	6044945	6044945-BLK1	04/26/06 10:25
Surrogate: 1,2-Dichloroethane-d4	98%			6044945	6044945-BLK1	04/26/06 10:25
Surrogate: Dibromofluoromethane	103%			6044945	6044945-BLK1	04/26/06 10:25
Surrogate: Toluene-d8	106%			6044945	6044945-BLK1	04/26/06 10:25
Surrogate: 4-Bromofluorobenzene	108%			6044945	6044945-BLK1	04/26/06 10:25

6045320-BLK1

Gasoline Range Organics	<50.0		ug/L	6045320	6045320-BLK1	04/27/06 12:55
Surrogate: 1,2-Dichloroethane-d4	89%			6045320	6045320-BLK1	04/27/06 12:55
Surrogate: Dibromofluoromethane	101%			6045320	6045320-BLK1	04/27/06 12:55
Surrogate: Toluene-d8	101%			6045320	6045320-BLK1	04/27/06 12:55
Surrogate: 4-Bromofluorobenzene	103%			6045320	6045320-BLK1	04/27/06 12:55

6045333-BLK1

Gasoline Range Organics	<50.0		ug/L	6045333	6045333-BLK1	04/29/06 09:56
Surrogate: 1,2-Dichloroethane-d4	91%			6045333	6045333-BLK1	04/29/06 09:56
Surrogate: Dibromofluoromethane	101%			6045333	6045333-BLK1	04/29/06 09:56
Surrogate: Toluene-d8	101%			6045333	6045333-BLK1	04/29/06 09:56
Surrogate: 4-Bromofluorobenzene	104%			6045333	6045333-BLK1	04/29/06 09:56

Client Cambria Env. Tech. (Sonoma) / SHELL (13674)
270 Perkins Street
Sonoma, CA 95476
Attn Ana Friel

Work Order: NPD2697
Project Name: 3420 San Pablo Ave., Oakland, CA
Project Number: SAP 139619
Received: 04/21/06 08:10

PROJECT QUALITY CONTROL DATA
Blank - Cont.

Analyte	Blank Value	Q	Units	Q.C. Batch	Lab Number	Analyzed Date/Time
---------	-------------	---	-------	------------	------------	--------------------

Purgeable Petroleum Hydrocarbons

Client Cambria Env. Tech. (Sonoma) / SHELL (13674)
 270 Perkins Street
 Sonoma, CA 95476
 Attn Ana Friel

Work Order: NPD2697
 Project Name: 3420 San Pablo Ave., Oakland, CA
 Project Number: SAP 139619
 Received: 04/21/06 08:10

PROJECT QUALITY CONTROL DATA
LCS

Analyte	Known Val.	Analyzed Val	Q	Units	% Rec.	Target Range	Batch	Analyzed Date/Time
---------	------------	--------------	---	-------	--------	--------------	-------	--------------------

Selected Volatile Organic Compounds by EPA Method 8260B

6044945-BS1

Benzene	50.0	45.8		ug/L	92%	79 - 123	6044945	04/26/06 09:18
Ethylbenzene	50.0	42.3		ug/L	85%	79 - 125	6044945	04/26/06 09:18
Methyl tert-Butyl Ether	50.0	40.2		ug/L	80%	66 - 142	6044945	04/26/06 09:18
Toluene	50.0	42.1		ug/L	84%	78 - 122	6044945	04/26/06 09:18
Xylenes, total	150	142		ug/L	95%	79 - 130	6044945	04/26/06 09:18
Surrogate: 1,2-Dichloroethane-d4	50.0	48.5			97%	70 - 130	6044945	04/26/06 09:18
Surrogate: Dibromofluoromethane	50.0	50.6			101%	79 - 122	6044945	04/26/06 09:18
Surrogate: Toluene-d8	50.0	51.5			103%	78 - 121	6044945	04/26/06 09:18
Surrogate: 4-Bromofluorobenzene	50.0	52.6			105%	78 - 126	6044945	04/26/06 09:18

6045320-BS1

Benzene	50.0	46.4		ug/L	93%	79 - 123	6045320	04/27/06 11:48
Ethylbenzene	50.0	42.7		ug/L	85%	79 - 125	6045320	04/27/06 11:48
Methyl tert-Butyl Ether	50.0	42.0		ug/L	84%	66 - 142	6045320	04/27/06 11:48
Toluene	50.0	43.2		ug/L	86%	78 - 122	6045320	04/27/06 11:48
Xylenes, total	150	139		ug/L	93%	79 - 130	6045320	04/27/06 11:48
Surrogate: 1,2-Dichloroethane-d4	50.0	43.6			87%	70 - 130	6045320	04/27/06 11:48
Surrogate: Dibromofluoromethane	50.0	48.7			97%	79 - 122	6045320	04/27/06 11:48
Surrogate: Toluene-d8	50.0	51.3			103%	78 - 121	6045320	04/27/06 11:48
Surrogate: 4-Bromofluorobenzene	50.0	51.0			102%	78 - 126	6045320	04/27/06 11:48

Purgeable Petroleum Hydrocarbons

6044945-BS1

Gasoline Range Organics	3050	2310		ug/L	76%	67 - 130	6044945	04/26/06 09:18
Surrogate: 1,2-Dichloroethane-d4	50.0	48.5			97%	70 - 130	6044945	04/26/06 09:18
Surrogate: Dibromofluoromethane	50.0	50.6			101%	70 - 130	6044945	04/26/06 09:18
Surrogate: Toluene-d8	50.0	51.5			103%	70 - 130	6044945	04/26/06 09:18
Surrogate: 4-Bromofluorobenzene	50.0	52.6			105%	70 - 130	6044945	04/26/06 09:18

6045320-BS1

Gasoline Range Organics	3050	2430		ug/L	80%	67 - 130	6045320	04/27/06 11:48
Surrogate: 1,2-Dichloroethane-d4	50.0	43.6			87%	70 - 130	6045320	04/27/06 11:48
Surrogate: Dibromofluoromethane	50.0	48.7			97%	70 - 130	6045320	04/27/06 11:48
Surrogate: Toluene-d8	50.0	51.3			103%	70 - 130	6045320	04/27/06 11:48
Surrogate: 4-Bromofluorobenzene	50.0	51.0			102%	70 - 130	6045320	04/27/06 11:48

6045333-BS1

Gasoline Range Organics	3050	3020		ug/L	99%	67 - 130	6045333	04/29/06 08:49
Surrogate: 1,2-Dichloroethane-d4	50.0	48.7			97%	70 - 130	6045333	04/29/06 08:49
Surrogate: Dibromofluoromethane	50.0	49.0			98%	70 - 130	6045333	04/29/06 08:49
Surrogate: Toluene-d8	50.0	50.8			102%	70 - 130	6045333	04/29/06 08:49
Surrogate: 4-Bromofluorobenzene	50.0	51.5			103%	70 - 130	6045333	04/29/06 08:49

Client Cambria Env. Tech. (Sonoma) / SHELL (13674)
 270 Perkins Street
 Sonoma, CA 95476
 Attn Ana Friel

Work Order: NPD2697
 Project Name: 3420 San Pablo Ave., Oakland, CA
 Project Number: SAP 139619
 Received: 04/21/06 08:10

PROJECT QUALITY CONTROL DATA
LCS - Cont.

Analyte	Known Val.	Analyzed Val	Q	Units	% Rec.	Target Range	Batch	Analyzed Date/Time
---------	------------	--------------	---	-------	--------	--------------	-------	--------------------

Purgeable Petroleum Hydrocarbons

Client Cambria Env. Tech. (Sonoma) / SHELL (13674)
 270 Perkins Street
 Sonoma, CA 95476
 Attn Ana Friel

Work Order: NPD2697
 Project Name: 3420 San Pablo Ave., Oakland, CA
 Project Number: SAP 139619
 Received: 04/21/06 08:10

PROJECT QUALITY CONTROL DATA
Matrix Spike

Analyte	Orig. Val.	MS Val	Q	Units	Spike Conc	% Rec.	Target Range	Batch	Sample Spiked	Analyzed Date/Time
Selected Volatile Organic Compounds by EPA Method 8260B										
6044945-MS1										
Benzene	10.3	29.6	M8	ug/L	50.0	39%	71 - 137	6044945	NPD2697-01	04/26/06 18:33
Ethylbenzene	2.44	20.1	M8	ug/L	50.0	35%	72 - 139	6044945	NPD2697-01	04/26/06 18:33
Methyl tert-Butyl Ether	27.2	44.6	M8	ug/L	50.0	35%	55 - 152	6044945	NPD2697-01	04/26/06 18:33
Toluene	1.04	18.5	M8	ug/L	50.0	35%	73 - 133	6044945	NPD2697-01	04/26/06 18:33
Xylenes, total	ND	55.7	M8	ug/L	150	37%	70 - 143	6044945	NPD2697-01	04/26/06 18:33
Surrogate: 1,2-Dichloroethane-d4		47.7		ug/L	50.0	95%	70 - 130	6044945	NPD2697-01	04/26/06 18:33
Surrogate: Dibromofluoromethane		51.9		ug/L	50.0	104%	79 - 122	6044945	NPD2697-01	04/26/06 18:33
Surrogate: Toluene-d8		49.8		ug/L	50.0	100%	78 - 121	6044945	NPD2697-01	04/26/06 18:33
Surrogate: 4-Bromofluorobenzene		52.0		ug/L	50.0	104%	78 - 126	6044945	NPD2697-01	04/26/06 18:33
Purgeable Petroleum Hydrocarbons										
6044945-MS1										
Gasoline Range Organics	2030	ND	M8	ug/L	3050	-67%	60 - 140	6044945	NPD2697-01	04/26/06 18:33
Surrogate: 1,2-Dichloroethane-d4		47.7		ug/L	50.0	95%	0 - 200	6044945	NPD2697-01	04/26/06 18:33
Surrogate: Dibromofluoromethane		51.9		ug/L	50.0	104%	0 - 200	6044945	NPD2697-01	04/26/06 18:33
Surrogate: Toluene-d8		49.8		ug/L	50.0	100%	0 - 200	6044945	NPD2697-01	04/26/06 18:33
Surrogate: 4-Bromofluorobenzene		52.0		ug/L	50.0	104%	0 - 200	6044945	NPD2697-01	04/26/06 18:33
6045333-MS1										
Gasoline Range Organics	ND	3130		ug/L	3050	103%	60 - 140	6045333	NPD3339-01	04/29/06 18:01
Surrogate: 1,2-Dichloroethane-d4		46.4		ug/L	50.0	93%	0 - 200	6045333	NPD3339-01	04/29/06 18:01
Surrogate: Dibromofluoromethane		51.4		ug/L	50.0	103%	0 - 200	6045333	NPD3339-01	04/29/06 18:01
Surrogate: Toluene-d8		49.8		ug/L	50.0	100%	0 - 200	6045333	NPD3339-01	04/29/06 18:01
Surrogate: 4-Bromofluorobenzene		52.4		ug/L	50.0	105%	0 - 200	6045333	NPD3339-01	04/29/06 18:01

Client Cambria Env. Tech. (Sonoma) / SHELL (13674)
 270 Perkins Street
 Sonoma, CA 95476
 Attn Ana Friel

Work Order: NPD2697
 Project Name: 3420 San Pablo Ave., Oakland, CA
 Project Number: SAP 139619
 Received: 04/21/06 08:10

PROJECT QUALITY CONTROL DATA
Matrix Spike Dup

Analyte	Orig. Val.	Duplicate	Q	Units	Spike Conc	% Rec.	Target Range	RPD	Limit	Batch	Sample Duplicated	Analyzed Date/Time
Selected Volatile Organic Compounds by EPA Method 8260B												
6044945-MSD1												
Benzene	10.3	45.0	M8, R2	ug/L	50.0	69%	71 - 137	41	23	6044945	NPD2697-01	04/26/06 18:56
Ethylbenzene	2.44	34.9	M8, R2	ug/L	50.0	65%	72 - 139	54	23	6044945	NPD2697-01	04/26/06 18:56
Methyl tert-Butyl Ether	27.2	53.4	M8	ug/L	50.0	52%	55 - 152	18	27	6044945	NPD2697-01	04/26/06 18:56
Toluene	1.04	32.9	M8, R2	ug/L	50.0	64%	73 - 133	56	25	6044945	NPD2697-01	04/26/06 18:56
Xylenes, total	ND	106	M8, R2	ug/L	150	71%	70 - 143	62	27	6044945	NPD2697-01	04/26/06 18:56
Surrogate: 1,2-Dichloroethane-d4		47.7		ug/L	50.0	95%	70 - 130			6044945	NPD2697-01	04/26/06 18:56
Surrogate: Dibromofluoromethane		50.7		ug/L	50.0	101%	79 - 122			6044945	NPD2697-01	04/26/06 18:56
Surrogate: Toluene-d8		51.6		ug/L	50.0	103%	78 - 121			6044945	NPD2697-01	04/26/06 18:56
Surrogate: 4-Bromofluorobenzene		51.5		ug/L	50.0	103%	78 - 126			6044945	NPD2697-01	04/26/06 18:56
Purgeable Petroleum Hydrocarbons												
6044945-MSD1												
Gasoline Range Organics	2030	ND	M8	ug/L	3050	-67%	60 - 140	40		6044945	NPD2697-01	04/26/06 18:56
Surrogate: 1,2-Dichloroethane-d4		47.7		ug/L	50.0	95%	0 - 200			6044945	NPD2697-01	04/26/06 18:56
Surrogate: Dibromofluoromethane		50.7		ug/L	50.0	101%	0 - 200			6044945	NPD2697-01	04/26/06 18:56
Surrogate: Toluene-d8		51.6		ug/L	50.0	103%	0 - 200			6044945	NPD2697-01	04/26/06 18:56
Surrogate: 4-Bromofluorobenzene		51.5		ug/L	50.0	103%	0 - 200			6044945	NPD2697-01	04/26/06 18:56
6045333-MSD1												
Gasoline Range Organics	ND	2530		ug/L	3050	83%	60 - 140	21	40	6045333	NPD3339-01	04/29/06 18:23
Surrogate: 1,2-Dichloroethane-d4		48.3		ug/L	50.0	97%	0 - 200			6045333	NPD3339-01	04/29/06 18:23
Surrogate: Dibromofluoromethane		50.3		ug/L	50.0	101%	0 - 200			6045333	NPD3339-01	04/29/06 18:23
Surrogate: Toluene-d8		50.0		ug/L	50.0	100%	0 - 200			6045333	NPD3339-01	04/29/06 18:23
Surrogate: 4-Bromofluorobenzene		51.1		ug/L	50.0	102%	0 - 200			6045333	NPD3339-01	04/29/06 18:23

Client Cambria Env. Tech. (Sonoma) / SHELL (13674)
 270 Perkins Street
 Sonoma, CA 95476
 Attn Ana Friel

Work Order: NPD2697
 Project Name: 3420 San Pablo Ave., Oakland, CA
 Project Number: SAP 139619
 Received: 04/21/06 08:10

CERTIFICATION SUMMARY

TestAmerica Analytical - Nashville

Method	Matrix	AIHA	Nelac	California
CA LUFT GC/MS	Water			X
NA	Water			
SW846 8260B	Water	N/A	X	X

Client Cambria Env. Tech. (Sonoma) / SHELL (13674)
270 Perkins Street
Sonoma, CA 95476
Attn Ana Friel

Work Order: NPD2697
Project Name: 3420 San Pablo Ave., Oakland, CA
Project Number: SAP 139619
Received: 04/21/06 08:10

NELAC CERTIFICATION SUMMARY

TestAmerica Analytical - Nashville does not hold NELAC certifications for the following analytes included in this report

<u>Method</u>	<u>Matrix</u>	<u>Analyte</u>
CA LUFT GC/MS	Water	Gasoline Range Organics

Client Cambria Env. Tech. (Sonoma) / SHELL (13674)
270 Perkins Street
Sonoma, CA 95476
Attn Ana Friel

Work Order: NPD2697
Project Name: 3420 San Pablo Ave., Oakland, CA
Project Number: SAP 139619
Received: 04/21/06 08:10

DATA QUALIFIERS AND DEFINITIONS

M8 The MS and/or MSD were below the acceptance limits. See Blank Spike (LCS).
R2 The RPD exceeded the acceptance limit.

METHOD MODIFICATION NOTES

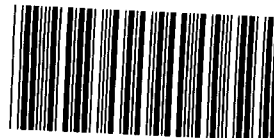

Nashville Division COOLER RECEIPT FORM

BC#

NPD2697

Cooler Received/Opened On 4/21/06 8:10

1. Indicate the Airbill Tracking Number (last 4 digits for Fedex only) and Name of Courier below: 7519

Fed-Ex UPS Velocity DHL Route Off-street Misc.

2. Temperature of representative sample or temperature blank when opened: 5.0 Degrees Celsius
(indicate IR Gun ID#)

NA A00466 A00750 A01124 100190 101282 Raynger ST

3. Were custody seals on outside of cooler?..... YES...NO...NA
a. If yes, how many and where: 1 Front

4. Were the seals intact, signed, and dated correctly?..... YES...NO...NA

5. Were custody papers inside cooler?..... YES...NO...NA
JR

I certify that I opened the cooler and answered questions 1-5 (initial).....

6. Were custody seals on containers: YES NO and Intact YES NO NA
were these signed, and dated correctly?..... YES...NO...NA

7. What kind of packing material used? Bubblewrap Peanuts Vermiculite Foam Insert
Plastic bag Paper Other _____ None

8. Cooling process: Ice Ice-pack Ice (direct contact) Dry ice Other None

9. Did all containers arrive in good condition (unbroken)?..... YES...NO...NA

10. Were all container labels complete (#, date, signed, pres., etc)?..... YES...NO...NA

11. Did all container labels and tags agree with custody papers?..... YES...NO...NA

12. a. Were VOA vials received?..... YES...NO...NA

b. Was there any observable head space present in any VOA vial?..... YES...NO...NA
JR

I certify that I unloaded the cooler and answered questions 6-12 (initial).....

13. a. On preserved bottles did the pH test strips suggest that preservation reached the correct pH level? JR 4-21-06 YES...NO... NA

b. Did the bottle labels indicate that the correct preservatives were used..... YES...NO...NA
If preservation in-house was needed, record standard ID of preservative used here _____

14. Was residual chlorine present?..... YES...NO... NA

I certify that I checked for chlorine and pH as per SOP and answered questions 13-14 (initial)..... JR

15. Were custody papers properly filled out (ink, signed, etc)?..... YES...NO...NA

16. Did you sign the custody papers in the appropriate place?..... YES...NO...NA

17. Were correct containers used for the analysis requested?..... YES...NO...NA

18. Was sufficient amount of sample sent in each container?..... YES...NO...NA
JR

I certify that I entered this project into LIMS and answered questions 15-18 (initial).....

I certify that I attached a label with the unique LIMS number to each container (initial)..... JR

19. Were there Non-Conformance issues at login YES NO Was a PIPE generated YES NO # _____

SHELL Chain Of Custody Record

LAB: Test America STL Other _____

- Lab Identification (if necessary):
- TA - Irvine, California
 - TA - Morgan Hill, California
 - TA - Nashville, Tennessee
 - STL
 - Other (location) _____

Shell Project Manager to be invoiced:
 ENVIRONMENTAL SERVICES
 TECHNICAL SERVICES
 CRMT HOUSTON
 NOT FOR ENV. REMEDIATION - NO ETIM - SEND PAPER INVOICE

Denis Brown

INCIDENT NUMBER (ES ONLY)
 9 8 9 9 5 7 4 8
 SAP or CRMT NUMBER (TS/CRMT)

DATE: 4/19/06
 PAGE: 1 of 1

SAMPLING COMPANY:
Blaine Tech Services
 LOG CODE: **BTSS**

SITE ADDRESS: Street and City
3420 San Pablo Ave., Oakland

State: **CA** GLOBAL ID NO.: **T0600101253**
 CONSULTANT PROJECT NO.: _____

ADDRESS:
1680 Rogers Avenue, San Jose, CA 95112

EDF DELIVERABLE TO (Name, Company, Office Location):
Ana Friel, Cambria, Eureka Office

PHONE NO.: **(707) 268-3812**
 E-MAIL: **sonomaedf@cambria-env.com**
 BTS # **060419-201**

PROJECT CONTACT (Hardcopy or PDF Report to):
Michael Ninokata

SAMPLER NAME(S) (Print):
D. Raynal

TELEPHONE: **408-573-0555** FAX: **408-573-7771** E-MAIL: **mninokata@blainetech.com**

TURNAROUND TIME (STANDARD IS 10 CALENDAR DAYS):
 STD 5 DAY 3 DAY 2 DAY 24 HOURS
 RESULTS NEEDED ON WEEKEND

REQUESTED ANALYSIS

GC/MS MTBE CONFIRMATION: HIGHEST _____ HIGHEST per BORING _____ ALL _____
 SPECIAL INSTRUCTIONS OR NOTES:
NPD2697
05/01/06 23:59
 CHECK BOX IF EDD IS NOT NEEDED
 RECEIPT VERIFICATION REQUESTED

TPH - Gas, Purgeable (8260B)	TPH - Diesel, Extractable (8015m)	BTEX (8260B)	5 Oxygenates (8260B) (MTBE, TBA, DIPE, TAME, ETBE)	MTBE (8260B)	TBA (8260B)	DIPE (8260B)	TAME (8260B)	ETBE (8260B)	1,2 DCA (8260B)	EDB (8260B)	Ethanol (8260B)	Methanol (8015M)	FIELD NOTES: Container/Preservative or PID Readings or Laboratory Notes
													TEMPERATURE ON RECEIPT C°

LAB USE ONLY	Field Sample Identification	SAMPLING		MATRIX	NO. OF CONT.	TPH - Gas, Purgeable (8260B)	TPH - Diesel, Extractable (8015m)	BTEX (8260B)	5 Oxygenates (8260B) (MTBE, TBA, DIPE, TAME, ETBE)	MTBE (8260B)	TBA (8260B)	DIPE (8260B)	TAME (8260B)	ETBE (8260B)	1,2 DCA (8260B)	EDB (8260B)	Ethanol (8260B)	Methanol (8015M)	FIELD NOTES: Container/Preservative or PID Readings or Laboratory Notes	
		DATE	TIME																	
	MW-1	4/19/06	1325	W	3	X	X	X												
	MW-2		1340	W	3	X	X	X												
	MW-4		1305	W	3	X	X	X												
	MW-5		1320	W	3	X	X	X												
	MW-6R		1235	W	3	X	X	X												
	MW-7		1335	W	3	X	X	X												
	MW-9		930	W	3	X	X	X												
	MW-10		10:15	W	3	X	X	X												

Relinquished by: (Signature) <i>D. 22</i>	Received by: (Signature) <i>Sample Custodian</i>	Date: <u>4/19/06</u>	Time: <u>10:29</u>
Relinquished by: (Signature) <i>[Signature]</i>	Received by: (Signature) <i>[Signature]</i>	Date: <u>4/19/06</u>	Time: <u>1705</u>
Relinquished by: (Signature) <i>[Signature]</i>	Received by: (Signature) <i>[Signature]</i>	Date: <u>4/19/06</u>	Time: <u>1812</u>

WELLHEAD INSPECTION CHECKLIST

Page 1 of 1

Client 9899 5748 Date 4/19/06
 Site Address 3420 San Pablo Ave. Oakland CA
 Job Number 060419-DR1 Technician DR

Well ID	Well Inspected - No Corrective Action Required	WELL IS SECURABLE BY DESIGN (12" or less)	WELL IS MARKED WITH THE WORDS "MONITORING WELL" (12" or less)	Water Bailed From Wellbox	Wellbox Components Cleaned	Cap Replaced	Lock Replaced	Other Action Taken (explain below)	Well Not Inspected (explain below)	Repair Order Submitted
MW-1	X									
MW-2	X									
MW-3R	X									
MW-4	X									
MW-5				X						
MW-6R	X									
MW-7	X									
MW-9								X		
MW-10	X									
MW-11	X									

NOTES: MW-9 Apron cracked.

WELL GAUGING DATA

Project # 060419-DRI Date 9/19/06 Client 98995748

Site 3420 San Pablo Ave. Oakland CA

Well ID	Well Size (in.)	Sheen / Odor	Depth to Immiscible Liquid (ft.)	Thickness of Immiscible Liquid (ft.)	Volume of Immiscibles Removed (ml)	Depth to water (ft.)	Depth to well bottom (ft.)	Survey Point: TOB or TOE	
MW-1	4					2.74	24.41	↓	
MW-2	4					4.63	19.24		
MW-3A	2	odor	Under Pressure			6.07	29.11		G.O.
MW-4	4					5.03	19.15		
MW-5	4					3.46	24.68		
MW-6R	2	Sheen	4.94	0.01	—	4.95	29.88		
MW-7	4					3.74	19.45		
MW-9	4					3.48	19.60		
MW-10	4					5.88	18.75		
MW-11	4					3.86	18.60		G.O.
waited 15 min. to stabilization									

SHELL WELL MONITORING DATA SHEET

BTS #: 060419-DR1	Site: 98995748
Sampler: DR	Date: 4/19/06
Well I.D.: MW-1	Well Diameter: 2 3 <u>4</u> 6 8
Total Well Depth (TD): 24.41	Depth to Water (DTW): 2.74
Depth to Free Product:	Thickness of Free Product (feet):
Referenced to: <u>PVC</u> Grade	D.O. Meter (if req'd): YSI HACH
DTW with 80% Recharge [(Height of Water Column x 0.20) + DTW]: 7.07	

Purge Method: Bailer Disposable Bailer Positive Air Displacement <input checked="" type="checkbox"/> Electric Submersible	Waterra Peristaltic Extraction Pump Other _____	Sampling Method: <input checked="" type="checkbox"/> Bailer Disposable Bailer Extraction Port Dedicated Tubing Other: _____
--	--	---

14.1 (Gals.) X 3 = 42.3 Gals. I Case Volume Specified Volumes Calculated Volume	<table border="1" style="width: 100%; border-collapse: collapse; font-size: small;"> <tr> <th>Well Diameter</th> <th>Multiplier</th> <th>Well Diameter</th> <th>Multiplier</th> </tr> <tr> <td>1"</td> <td>0.04</td> <td>4"</td> <td>0.65</td> </tr> <tr> <td>2"</td> <td>0.16</td> <td>6"</td> <td>1.47</td> </tr> <tr> <td>3"</td> <td>0.37</td> <td>Other</td> <td>radius² * 0.163</td> </tr> </table>	Well Diameter	Multiplier	Well Diameter	Multiplier	1"	0.04	4"	0.65	2"	0.16	6"	1.47	3"	0.37	Other	radius ² * 0.163
Well Diameter	Multiplier	Well Diameter	Multiplier														
1"	0.04	4"	0.65														
2"	0.16	6"	1.47														
3"	0.37	Other	radius ² * 0.163														

Time	Temp (°F)	pH	Cond. (mS or µS)	Turbidity (NTUs)	Gals. Removed	Observations
1118	66.8	6.8	563	63	14.1	clear
1121	66.7	6.8	563	26	28.2	"
1124	67.0	6.8	560	11	42.3	"
						DTW = 17.23

Did well dewater? Yes <input type="checkbox"/> No <input checked="" type="checkbox"/>	Gallons actually evacuated: 42.3	
Sampling Date: 4/19/06	Sampling Time: 1325	Depth to Water: 3.05
Sample I.D.: MW-1	Laboratory: STL	Other: <u>EA</u>
Analyzed for: TPH-G BTEX MTBE TPH-D	Other: _____	
EB I.D. (if applicable): _____ @ _____ Time	Duplicate I.D. (if applicable): _____	
Analyzed for: TPH-G BTEX MTBE TPH-D	Other: _____	
D.O. (if req'd): Pre-purge: _____ mg/L	Post-purge: _____ mg/L	
O.R.P. (if req'd): Pre-purge: _____ mV	Post-purge: _____ mV	

SHELL WELL MONITORING DATA SHEET

BTS #: 060419-DR1	Site: 98995748
Sampler: DR	Date: 4/19/06
Well I.D.: MW-2	Well Diameter: 2 3 ϕ 6 8 _____
Total Well Depth (TD): 19.24	Depth to Water (DTW): 4.63
Depth to Free Product:	Thickness of Free Product (feet):
Referenced to: <u>PVC</u> Grade	D.O. Meter (if req'd): YSI HACH
DTW with 80% Recharge [(Height of Water Column x 0.20) + DTW]: 7.55	

Purge Method: Bailer Disposable Bailer Positive Air Displacement <input checked="" type="checkbox"/> Electric Submersible	Watera Peristaltic Extraction Pump Other _____	Sampling Method: <input checked="" type="checkbox"/> Bailer Disposable Bailer Extraction Port Dedicated Tubing Other: _____
--	---	---

9.5 (Gals.) X 3 = 28.5 Gals. 1 Case Volume Specified Volumes Calculated Volume	<table border="1" style="width: 100%; border-collapse: collapse;"> <thead> <tr> <th>Well Diameter</th> <th>Multiplier</th> <th>Well Diameter</th> <th>Multiplier</th> </tr> </thead> <tbody> <tr> <td>1"</td> <td>0.04</td> <td>4"</td> <td>0.65</td> </tr> <tr> <td>2"</td> <td>0.16</td> <td>6"</td> <td>1.47</td> </tr> <tr> <td>3"</td> <td>0.37</td> <td>Other</td> <td>radius² * 0.163</td> </tr> </tbody> </table>	Well Diameter	Multiplier	Well Diameter	Multiplier	1"	0.04	4"	0.65	2"	0.16	6"	1.47	3"	0.37	Other	radius ² * 0.163
Well Diameter	Multiplier	Well Diameter	Multiplier														
1"	0.04	4"	0.65														
2"	0.16	6"	1.47														
3"	0.37	Other	radius ² * 0.163														

Time	Temp (°F)	pH	Cond. (mS or μ S)	Turbidity (NTUs)	Gals. Removed	Observations
1155	67.0	6.5	953	91	9.5	clear
1157	65.9	6.5	986	87	19.0	"
1159	65.7	6.6	995	85	28.5	"
						DTW = 10.56

Did well dewater? Yes <input checked="" type="checkbox"/> NO	Gallons actually evacuated: 28.5	
Sampling Date: 4/19/06	Sampling Time: 1340	Depth to Water: 4.92
Sample I.D.: MW-2	Laboratory: STL	Other: <u>EA</u>
Analyzed for: TPH-G BTEX MTBE TPH-D	Other: _____	
EB I.D. (if applicable): _____ @ _____ Time	Duplicate I.D. (if applicable): _____	
Analyzed for: TPH-G BTEX MTBE TPH-D	Other: _____	
D.O. (if req'd): Pre-purge: _____ mg/L	Post-purge: _____ mg/L	
O.R.P. (if req'd): Pre-purge: _____ mV	Post-purge: _____ mV	

Blaine Tech Services, Inc. 1680 Rogers Ave., San Jose, CA 95112 (800) 545-7558

SHELL WELL MONITORING DATA SHEET

BTS #: 060419-DR1	Site: 98995748
Sampler: DR	Date: 4/19/06
Well I.D.: MW-4	Well Diameter: 2 3 4 6 8
Total Well Depth (TD): 19.15	Depth to Water (DTW): 5.03
Depth to Free Product:	Thickness of Free Product (feet):
Referenced to: <u>PVC</u> Grade	D.O. Meter (if req'd): YSI HACH
DTW with 80% Recharge [(Height of Water Column x 0.20) + DTW]: 7.85	

Purge Method: Bailer Disposable Bailer Positive Air Displacement Electric Submersible

Water: Peristaltic Extraction Pump Other _____

Sampling Method: Bailer Disposable Bailer Extraction Port Dedicated Tubing

Other: _____

$9.2 \text{ (Gals.)} \times 3 = 27.6 \text{ Gals.}$	<table border="1" style="width: 100%; border-collapse: collapse;"> <thead> <tr> <th>Well Diameter</th> <th>Multiplier</th> <th>Well Diameter</th> <th>Multiplier</th> </tr> </thead> <tbody> <tr> <td>1"</td> <td>0.04</td> <td>4"</td> <td>0.65</td> </tr> <tr> <td>2"</td> <td>0.16</td> <td>6"</td> <td>1.47</td> </tr> <tr> <td>3"</td> <td>0.37</td> <td>Other</td> <td>radius² * 0.163</td> </tr> </tbody> </table>	Well Diameter	Multiplier	Well Diameter	Multiplier	1"	0.04	4"	0.65	2"	0.16	6"	1.47	3"	0.37	Other	radius ² * 0.163
Well Diameter	Multiplier	Well Diameter	Multiplier														
1"	0.04	4"	0.65														
2"	0.16	6"	1.47														
3"	0.37	Other	radius ² * 0.163														
1 Case Volume	Specified Volumes	Calculated Volume															

Time	Temp (°F)	pH	Cond. (mS or μ S)	Turbidity (NTUs)	Gals. Removed	Observations
1041	66.4	6.6	890	114	9.2	clear/odor
1043	66.7	6.6	877	73	18.4	" "
1045	67.0	6.7	860	49	27.6	" "
						DTW = 14.70

Did well dewater? Yes No Gallons actually evacuated: **27.6**

Sampling Date: 4/19/06 Sampling Time: 1305 Depth to Water: 5.21

Sample I.D.: MW-4 Laboratory: STL Other: EA

Analyzed for: ~~TPH-G~~ ~~BTEX~~ ~~MTBE~~ TPH-D Other: _____

EB I.D. (if applicable): @ _____ Duplicate I.D. (if applicable): _____

Analyzed for: TPH-G BTEX MTBE TPH-D Other: _____

D.O. (if req'd):	Pre-purge:	mg/L	Post-purge:	mg/L
O.R.P. (if req'd):	Pre-purge:	mV	Post-purge:	mV

SHELL WELL MONITORING DATA SHEET

BTS #: 060419-DR1	Site: 98995748
Sampler: DR	Date: 4/19/06
Well I.D.: MW-5	Well Diameter: 2 3 <u>4</u> 6 8
Total Well Depth (TD): 24.68	Depth to Water (DTW): 3.46
Depth to Free Product:	Thickness of Free Product (feet):
Referenced to: <u>PVC</u> Grade	D.O. Meter (if req'd): YSI HACH
DTW with 80% Recharge [(Height of Water Column x 0.20) + DTW]: 7.70	

Purge Method: Bailer Disposable Bailer Positive Air Displacement <input checked="" type="checkbox"/> Electric Submersible	Waterra Peristaltic Extraction Pump Other _____	Sampling Method: <input checked="" type="checkbox"/> Bailer Disposable Bailer Extraction Port Dedicated Tubing Other: _____
--	--	---

$13.8 \text{ (Gals.)} \times 3 = 41.4 \text{ Gals.}$ I Case Volume Specified Volumes Calculated Volume	<table border="1" style="width: 100%; border-collapse: collapse; font-size: small;"> <thead> <tr> <th>Well Diameter</th> <th>Multiplier</th> <th>Well Diameter</th> <th>Multiplier</th> </tr> </thead> <tbody> <tr> <td>1"</td> <td>0.04</td> <td>4"</td> <td>0.65</td> </tr> <tr> <td>2"</td> <td>0.16</td> <td>6"</td> <td>1.47</td> </tr> <tr> <td>3"</td> <td>0.37</td> <td>Other</td> <td>radius² * 0.163</td> </tr> </tbody> </table>	Well Diameter	Multiplier	Well Diameter	Multiplier	1"	0.04	4"	0.65	2"	0.16	6"	1.47	3"	0.37	Other	radius ² * 0.163
Well Diameter	Multiplier	Well Diameter	Multiplier														
1"	0.04	4"	0.65														
2"	0.16	6"	1.47														
3"	0.37	Other	radius ² * 0.163														

Time	Temp (°F)	pH	Cond. (mS or μ S)	Turbidity (NTUs)	Gals. Removed	Observations
1058	66.7	6.7	559	89	13.8	clear
1101	65.8	6.7	556	32	27.6	"
1104	65.5	6.6	573	18	41.4	"
						DTW = 16.65

Did well dewater? Yes No Gallons actually evacuated: 41.4

Sampling Date: 4/19/06 Sampling Time: 1320 Depth to Water: 3.51

Sample I.D.: MW-5 Laboratory: STL Other: EA

Analyzed for: ~~TPH-B~~ ~~BTEX~~ ~~MTBE~~ TPH-D Other:

EB I.D. (if applicable): @ Time Duplicate I.D. (if applicable):

Analyzed for: TPH-G BTEX MTBE TPH-D Other:

D.O. (if req'd):	Pre-purge:	mg/L	Post-purge:	mg/L
------------------	------------	------	-------------	------

O.R.P. (if req'd):	Pre-purge:	mV	Post-purge:	mV
--------------------	------------	----	-------------	----

SHELL WELL MONITORING DATA SHEET

BTS #: 060419-DR1	Site: 98995748
Sampler: DR	Date: 4/19/06
Well I.D.: MW-6R	Well Diameter: <input checked="" type="radio"/> 3 <input type="radio"/> 4 <input type="radio"/> 6 <input type="radio"/> 8 _____
Total Well Depth (TD): 29.88	Depth to Water (DTW): 4.95
Depth to Free Product:	Thickness of Free Product (feet):
Referenced to: <input checked="" type="radio"/> PVC <input type="radio"/> Grade	D.O. Meter (if req'd): YSI HACH
DTW with 80% Recharge [(Height of Water Column x 0.20) + DTW]: 9.94	

Purge Method: Bailer Waterra Sampling Method: Bailer
 Disposable Bailer Peristaltic Disposable Bailer
 Positive Air Displacement Extraction Pump Extraction Port
 Electric Submersible Other _____ Dedicated Tubing

Other: _____

$4.0 \text{ (Gals.)} \times 3 = 12.0 \text{ Gals.}$ I Case Volume Specified Volumes Calculated Volume	<table border="1" style="width: 100%; border-collapse: collapse; font-size: small;"> <tr> <th>Well Diameter</th> <th>Multiplier</th> <th>Well Diameter</th> <th>Multiplier</th> </tr> <tr> <td>1"</td> <td>0.04</td> <td>4"</td> <td>0.65</td> </tr> <tr> <td>2"</td> <td>0.16</td> <td>6"</td> <td>1.47</td> </tr> <tr> <td>3"</td> <td>0.37</td> <td>Other</td> <td>radius² * 0.163</td> </tr> </table>	Well Diameter	Multiplier	Well Diameter	Multiplier	1"	0.04	4"	0.65	2"	0.16	6"	1.47	3"	0.37	Other	radius ² * 0.163
Well Diameter	Multiplier	Well Diameter	Multiplier														
1"	0.04	4"	0.65														
2"	0.16	6"	1.47														
3"	0.37	Other	radius ² * 0.163														

Time	Temp (°F)	pH	Cond. (mS or <u>µS</u>)	Turbidity (NTUs)	Gals. Removed	Observations
1215	67.8	6.5	920	619	4.0	light cloudy / odor
1221	68.0	6.6	948	285	8.0	" "
1227	68.3	6.6	957	87	12.0	clear / odor

Did well dewater? Yes No Gallons actually evacuated: 12.0

Sampling Date: 4/19/06 Sampling Time: 1235 Depth to Water: 9.45

Sample I.D.: MW-6R Laboratory: STL Other: EA

Analyzed for: ~~TPH-G~~ ~~BTEX~~ ~~MTBE~~ TPH-D Other:

EB I.D. (if applicable): _____ @ _____ Time Duplicate I.D. (if applicable): _____

Analyzed for: TPH-G BTEX MTBE TPH-D Other:

D.O. (if req'd):	Pre-purge:	mg/L	Post-purge:	mg/L
O.R.P. (if req'd):	Pre-purge:	mV	Post-purge:	mV

SHELL WELL MONITORING DATA SHEET

BTS #: 060419-DR1	Site: 98995748
Sampler: DR	Date: 4/19/06
Well I.D.: MW-7	Well Diameter: 2 3 <u>4</u> 6 8
Total Well Depth (TD): 19.45	Depth to Water (DTW): 3.74
Depth to Free Product:	Thickness of Free Product (feet):
Referenced to: <u>PVC</u> Grade	D.O. Meter (if req'd): YSI HACH
DTW with 80% Recharge [(Height of Water Column x 0.20) + DTW]: <u>6.89</u>	

Purge Method: Bailer Waterra Sampling Method: Bailer
 Disposable Bailer Peristaltic Disposable Bailer
 Positive Air Displacement Extraction Pump Extraction Port
 Electric Submersible Other _____ Dedicated Tubing

Other: _____

$\frac{10.2 \text{ (Gals.)} \times 3}{1 \text{ Case Volume}} = \frac{30.6}{\text{Specified Volumes}} \text{ Gals.}$	<table border="1" style="width: 100%; border-collapse: collapse; font-size: small;"> <thead> <tr> <th>Well Diameter</th> <th>Multiplier</th> <th>Well Diameter</th> <th>Multiplier</th> </tr> </thead> <tbody> <tr> <td>1"</td> <td>0.04</td> <td>4"</td> <td>0.65</td> </tr> <tr> <td>2"</td> <td>0.16</td> <td>6"</td> <td>1.47</td> </tr> <tr> <td>3"</td> <td>0.37</td> <td>Other</td> <td>radius² * 0.163</td> </tr> </tbody> </table>	Well Diameter	Multiplier	Well Diameter	Multiplier	1"	0.04	4"	0.65	2"	0.16	6"	1.47	3"	0.37	Other	radius ² * 0.163
Well Diameter	Multiplier	Well Diameter	Multiplier														
1"	0.04	4"	0.65														
2"	0.16	6"	1.47														
3"	0.37	Other	radius ² * 0.163														

Time	Temp (°F)	pH	Cond. (mS or μ S)	Turbidity (NTUs)	Gals. Removed	Observations
11 37	66.3	6.8	689	41	10.2	clear / odor
11 39	65.2	6.8	690	17	20.4	" "
11 41	64.4	6.8	684	12	30.6	" "
						DTW = 13.67

Did well dewater? Yes No Gallons actually evacuated: 30.6

Sampling Date: 4/19/06 Sampling Time: 13:35 Depth to Water: 6.72

Sample I.D.: MW-7 Laboratory: STL Other: EA

Analyzed for: ~~TPH-G~~ ~~BTEX~~ ~~MTBE~~ TPH-D Other: _____

EB I.D. (if applicable): _____ @ _____ Time Duplicate I.D. (if applicable): _____

Analyzed for: TPH-G BTEX MTBE TPH-D Other: _____

D.O. (if req'd): Pre-purge:	mg/L	Post-purge:	mg/L
O.R.P. (if req'd): Pre-purge:	mV	Post-purge:	mV

SHELL WELL MONITORING DATA SHEET

BTS #: 060419-DR1	Site: 98995748
Sampler: DR	Date: 4/19/06
Well I.D.: MW-9	Well Diameter: 2 3 <u>4</u> 6 8
Total Well Depth (TD): 19.60	Depth to Water (DTW): 3.48
Depth to Free Product:	Thickness of Free Product (feet):
Referenced to: <u>PVC</u> Grade	D.O. Meter (if req'd): YSI HACH
DTW with 80% Recharge [(Height of Water Column x 0.20) + DTW]: Traffic Well	

Purge Method: Bailer Waterra Sampling Method: Bailer
 Disposable Bailer Peristaltic Disposable Bailer
 Positive Air Displacement Extraction Pump Extraction Port
 Electric Submersible Other _____ Dedicated Tubing

Other: _____

$10.5 \text{ (Gals.)} \times 3 = 31.5 \text{ Gals.}$ I Case Volume Specified Volumes Calculated Volume	<table border="1" style="width: 100%; border-collapse: collapse; font-size: small;"> <tr> <th>Well Diameter</th> <th>Multiplier</th> <th>Well Diameter</th> <th>Multiplier</th> </tr> <tr> <td>1"</td> <td>0.04</td> <td>4"</td> <td>0.65</td> </tr> <tr> <td>2"</td> <td>0.16</td> <td>6"</td> <td>1.47</td> </tr> <tr> <td>3"</td> <td>0.37</td> <td>Other</td> <td>radius² * 0.163</td> </tr> </table>	Well Diameter	Multiplier	Well Diameter	Multiplier	1"	0.04	4"	0.65	2"	0.16	6"	1.47	3"	0.37	Other	radius ² * 0.163
Well Diameter	Multiplier	Well Diameter	Multiplier														
1"	0.04	4"	0.65														
2"	0.16	6"	1.47														
3"	0.37	Other	radius ² * 0.163														

Time	Temp (°F)	pH	Cond. (mS or µS)	Turbidity (NTUs)	Gals. Removed	Observations
920	67.0	6.4	571	594	10.5	Grey / odor
922	66.0	6.5	532	132	21.0	clear / odor
924	66.3	6.6	519	54	31.5	11 / 11

Did well dewater? Yes <input checked="" type="checkbox"/> No	Gallons actually evacuated: 31.5
Sampling Date: 4/19/06 Sampling Time: 930 Depth to Water: 15.54 Traffic Well	
Sample I.D.: MW-9 Laboratory: STL Other: <u>TA</u>	
Analyzed for: TPH-G BTEX MTBE TPH-D Other:	
EB I.D. (if applicable): @ Time Duplicate I.D. (if applicable):	
Analyzed for: TPH-G BTEX MTBE TPH-D Other:	
D.O. (if req'd): Pre-purge: _____ mg/L Post-purge: _____ mg/L	
O.R.P. (if req'd): Pre-purge: _____ mV Post-purge: _____ mV	

SHELL WELL MONITORING DATA SHEET

BTS #: 060419-DR1	Site: 9899 5748
Sampler: DR	Date: 4/19/06
Well I.D.: MW-10	Well Diameter: 2 3 @ 6 8
Total Well Depth (TD): 18.75	Depth to Water (DTW): 5.89
Depth to Free Product:	Thickness of Free Product (feet):
Referenced to: PVC Grade	D.O. Meter (if req'd): YSI HACH
DTW with 80% Recharge [(Height of Water Column x 0.20) + DTW]: Traffic Well	

Purge Method: Bailer Waterra Sampling Method: X Bailer
 Disposable Bailer Peristaltic Disposable Bailer
 Positive Air Displacement Extraction Pump Extraction Port
 Electric Submersible Other _____ Dedicated Tubing

Other: _____

8.4 (Gals.) X 3 = 25.2 Gals.
 1 Case Volume Specified Volumes Calculated Volume

Well Diameter	Multiplier	Well Diameter	Multiplier
1"	0.04	4"	0.65
2"	0.16	6"	1.47
3"	0.37	Other	radius ² * 0.163

Time	Temp (°F)	pH	Cond. (mS or µS)	Turbidity (NTUs)	Gals. Removed	Observations
1004	66.1	7.0	1094	60	8.4	clear
1006	65.5	7.0	1102	39	16.8	"
1007	64.9	7.0	1123	21	25.2	"

Did well dewater? Yes No Gallons actually evacuated: 25.2

Sampling Date: 4/19/06 Sampling Time: 1015 Depth to Water: 11.78 Traffic Well

Sample I.D.: MW-10 Laboratory: STL Other: EA

Analyzed for: ~~TPH-G~~ ~~BTEX~~ ~~MTBE~~ TPH-D Other:

EB I.D. (if applicable): @ Time Duplicate I.D. (if applicable):

Analyzed for: TPH-G BTEX MTBE TPH-D Other:

D.O. (if req'd):	Pre-purge:	mg/L	Post-purge:	mg/L
O.R.P. (if req'd):	Pre-purge:	mV	Post-purge:	mV

Blaine Tech Services, Inc. 1680 Rogers Ave., San Jose, CA 95112 (800) 545-7558

APPENDIX B

Thrifty Groundwater Monitoring Data

TABLE 1A
CURRENT PERIOD GROUNDWATER DATA
THRIFTY OIL STATION #049 , OAKLAND, CA.

WELL	Monit./ Sampl. Date	ANALYTICAL PARAMETERS											MONITORING PARAMETERS				ELEVATION		
		TPH (ug/L)	B (ug/L)	T (ug/L)	E (ug/L)	X (ug/L)	MTBE (ug/L)	DIPE (ug/L)	ETBE (ug/L)	TAME (ug/L)	TBA (ug/L)	ETH (mg/L)	METH (mg/L)	DTW (feet)	DTB (feet)	DTP (feet)	PT (feet)	CASING (feet)	GW (feet)
MW-1	04/19/06	<5.6	<0.32	<0.10	<0.24	<0.30	<0.63	<0.29	<0.17	<0.28	<10	<20	<20	3.93	17.72	NP	0.00	98.03	94.10
MW-2R	04/19/06	22,100	440	4,240	234	1,530	195	<5.8	<3.4	<5.6	<200	<20	<20	3.38	16.76	NP	0.00	-	-
MW-3	04/19/06	<5.6	<0.32	<0.10	<0.24	<0.30	<0.63	<0.29	<0.17	<0.28	<10	<20	<20	5.72	24.13	NP	0.00	97.69	91.97
MW-4R	04/19/06	26,100	399	1,290	254	3,350	732	<2.9	<1.7	36	231	<20	<20	4.72	19.64	NP	0.00	-	-
MW-5	04/19/06	<5.6	<0.32	<0.10	<0.24	<0.30	<0.63	<0.29	<0.17	<0.28	<10	<20	<20	4.58	13.77	NP	0.00	98.85	94.27
MW-6	04/19/06	78	<0.32	<0.10	<0.24	<0.30	201	<0.29	<0.17	<0.28	13	<20	<20	3.87	13.06	NP	0.00	99.67	95.80
MW-7	04/19/06	<5.6	<0.32	<0.10	<0.24	<0.30	2.9	<0.29	<0.17	<0.28	<10	<20	<20	5.13	13.54	NP	0.00	99.02	93.89
RW-1R	04/19/06	7,430	94	411	<2.4	1,820	571	<2.9	<1.7	11	206	<20	<20	4.94	19.09	NP	0.00	-	-

APPENDIX C

Permit

Alameda County Public Works Agency - Water Resources Well Permit



399 Elmhurst Street
Hayward, CA 94544-1395
Telephone: (510)670-6633 Fax: (510)782-1939

Application Approved on: 05/05/2006 **By** Jamesy
Permits Issued: W2006-0338

Receipt Number: WR2006-0213
Permits Valid from 06/02/2006 **to** 06/02/2006

Application Id: 1146784193760
Site Location: 3420 San Pablo Ave, Emeryville, CA 94608
Project Start Date: 06/02/2006

City of Project Site: Oakland
Completion Date: 06/02/2006

Applicant: Cambria - Bill DeBoer
5900 Holis St #A, Emeryville, CA 94608
Property Owner: Shell Oil Products US
20945 S Wilmington Ave, Carson, CA 90818
Client: ** same as Property Owner **

Phone: 510-420-3369
Phone: --

	Total Due:	\$300.00
	Total Amount Paid:	\$300.00
Payer Name : Cambria	Paid By: CHECK	PAID IN FULL

Works Requesting Permits:

Well Destruction-Monitoring - 1 Wells
Driller: Gregg Drilling - Lic #: 485156 - Method: other

Work Total: \$300.00

Specifications

Permit #	Issued Date	Expire Date	Owner Well Id	Hole Diam.	Casing Diam.	Seal Depth	Max. Depth	State Well #	Orig. Permit #	DWR #
W2006-0338	05/05/2006	08/31/2006	MW8	0.00 in.	4.00 in.	0.50 ft	20.00 ft			

Specific Work Permit Conditions

1. Drilling Permit(s) can be voided/ cancelled only in writing. It is the applicant's responsibility to notify Alameda County Public Works Agency, Water Resources Section in writing for an extension or to cancel the drilling permit application. No drilling permit application(s) shall be extended beyond ninety (90) days from the original start date. Applicants may not cancel a drilling permit application after the completion date of the permit issued has passed.

2. Sound the well to measure depth and to ensure no obstructions exist.

Excavate and remove existing casing 3 to 5 foot below ground surface (bgs), including vent cap and well or vault cover.

Grout neat cement with a tremie to the bottom of the well and by filling with neat cement to three (3-5) feet below surface grade.

After the seal has set, backfill the remaining hole with concrete or compacted material to match existing conditions

3. Prior to any drilling activities, it shall be the applicant's responsibility to contact and coordinate an Underground Service Alert (USA), obtain encroachment permit(s), excavation permit(s) or any other permits or agreements required for that Federal, State, County or City, and follow all City or County Ordinances. No work shall begin until all the permits and requirements have been approved or obtained.

4. Compliance with the well-sealing specifications shall not exempt the well-sealing contractor from complying with appropriate State reporting-requirements related to well destruction (Sections 13750 through 13755 (Division 7, Chapter 10, Article 3) of the California Water Code). Contractor must complete State DWR Form 188 and mail original to the Alameda County Public Works Agency, Water Resources Section, within 60 days. Including permit number and site

Alameda County Public Works Agency - Water Resources Well Permit

map.

5. Permittee shall assume entire responsibility for all activities and uses under this permit and shall indemnify, defend and save the Alameda County Public Works Agency, its officers, agents, and employees free and harmless from any and all expense, cost and liability in connection with or resulting from the exercise of this Permit including, but not limited to, property damage, personal injury and wrongful death.

6. Applicant shall contact George Cashen for an inspection time at 510-670-6610 at least five (5) working days prior to starting, once the permit has been approved. Confirm the scheduled date(s) at least 24 hours prior to drilling.

7. Permittee, permittee's contractors, consultants or agents shall be responsible to assure that all material or waters generated during drilling, boring destruction, and/or other activities associated with this Permit will be safely handled, properly managed, and disposed of according to all applicable federal, state, and local statutes regulating such. In no case shall these materials and/or waters be allowed to enter, or potentially enter, on or off-site storm sewers, dry wells, or waterways or be allowed to move off the property where work is being completed.

APPENDIX D

DWR Well Completion Report

CONFIDENTIAL

STATE OF CALIFORNIA DWR
WELL COMPLETION REPORT
(WELL LOGS)

REMOVED