

THRIFTY OIL CO. ENVIRONMENTAL PROTECTION

00 APR 10 PM 4:55

April 5, 2000

Ms. Susan Hugo
Alameda County Health Care Services
Department of Environmental Health
1131 Harbor Bay parkway, 2nd Floor
Alameda, CA 94502

LOP 3871
mtbe priority solo 0.02242
PO 05

RE: **Thrifty Oil Co. Station #063**
6125 Telegraph Avenue
Oakland, CA 94609
1st Quarter 2000, Status Report

Dear Ms. Hugo:

Presented herewith is the First Quarter 1999, Status Report for Former Thrifty Oil Co. Station #063 located at 6125 Telegraph Avenue, Oakland, California.

If you have any questions or comments, please contact the undersigned in this report or myself at (562) 921-3581.

Sincerely,

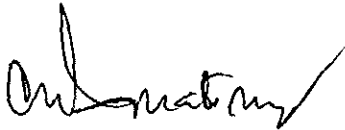

Chris Panaitescu
General Manager
Environmental Affairs

cc: ARCO Products Company
File



LOP - RECORD CHANGE REQUEST FORM

printed:
04/24/2000

Mark Out What Needs Changing and Hand to LOP Data Entry
(Name/Address changes go to Annual Programs Data Entry)

Insp: SH

AGENCY # : 10000 SOURCE OF FUNDS: F SUBSTANCE: 8006619
StID : 3871 LOC: 12/13/1994
SITE NAME: Thrifty Oil Co. #063 DATE REPORTED : 06/21/1986
ADDRESS : 6125 Telegraph Ave DATE CONFIRMED: 06/21/1986
CITY/ZIP : Oakland 94609 MULTIPLE RPs : N

SITE STATUS

CASE TYPE: S CONTRACT STATUS: 4 PRIOR CODE:2B3 EMERGENCY RESP:
RP SEARCH: S DATE COMPLETED: 03/27/1992
PRELIMINARY ASMNT: U DATE UNDERWAY: 12/08/1989 DATE COMPLETED:
REM INVESTIGATION: DATE UNDERWAY: DATE COMPLETED:
REMEDIAL ACTION: DATE UNDERWAY: DATE COMPLETED:
POST REMED ACT MON: DATE UNDERWAY: DATE COMPLETED:

ENFORCEMENT ACTION TYPE: 1 DATE ENFORCEMENT ACTION TAKEN: 03/27/1992
LUFT FIELD MANUAL CONSID: HSGWA
CASE CLOSED: DATE CASE CLOSED:
DATE EXCAVATION STARTED : REMEDIAL ACTIONS TAKEN: UK

RESPONSIBLE PARTY INFORMATION

RP#1-CONTACT NAME: Peter D' Amico *Crungell*
COMPANY NAME: Thrifty Oil Co.
ADDRESS: 10000 Lakewood Blvd
CITY/STATE: Downey, C A 90240

INSPECTOR VERIFICATION:

NAME _____ SIGNATURE _____ DATE _____

DATA ENTRY INPUT:

Name/Address Changes Only Case Progress Changes

ANNPGMS _____ LOP _____ DATE _____ || LOP _____ DATE _____

LOP - RECORD CHANGE REQUEST FORM

printed:
04/24/2000

Mark Out What Needs Changing and Hand to LOP Data Entry
(Name/Address changes go to Annual Programs Data Entry)

Insp: SH

AGENCY # : 10000 SOURCE OF FUNDS: F SUBSTANCE: 8006619
 StID : 3871 LOC: 12/13/1994
 SITE NAME: Thrifty Oil Co. #063 DATE REPORTED : 06/21/1986
 ADDRESS : 6125 Telegraph Ave DATE CONFIRMED: 06/21/1986
 CITY/ZIP : Oakland 94609 MULTIPLE RPs : N

SITE STATUS

CASE TYPE: S CONTRACT STATUS: 4 PRIOR CODE:2B3 EMERGENCY RESP:
 RP SEARCH: S DATE COMPLETED: 03/27/1992
 PRELIMINARY ASMNT: U DATE UNDERWAY: 12/08/1989 DATE COMPLETED:
 REM INVESTIGATION: DATE UNDERWAY: DATE COMPLETED:
 REMEDIAL ACTION: DATE UNDERWAY: DATE COMPLETED:
 POST REMED ACT MON: DATE UNDERWAY: DATE COMPLETED:

ENFORCEMENT ACTION TYPE: 1 DATE ENFORCEMENT ACTION TAKEN: 03/27/1992
 LUFT FIELD MANUAL CONSID: HSGWA
 CASE CLOSED: DATE CASE CLOSED:
 DATE EXCAVATION STARTED : REMEDIAL ACTIONS TAKEN: UK

RESPONSIBLE PARTY INFORMATION

RP#1-CONTACT NAME: Chris Panaitescu
 COMPANY NAME: Thrifty Oil Co.
 ADDRESS: 13539 E. Foster Road
 CITY/STATE: Santa Fe Springs, Ca 90670

INSPECTOR VERIFICATION:

NAME _____ SIGNATURE _____ DATE _____

DATA ENTRY INPUT:

Name/Address Changes Only Case Progress Changes

ANNPGMS _____ LOP _____ DATE _____ LOP _____ DATE _____

THRIFTY OIL CO.

April 5, 2000

Ms. Susan Hugo
Alameda County Health Care Services
Department of Environmental Health
1131 Harbor Bay Parkway, 2nd Floor
Alameda, CA 94502

RE: **Former Thrifty Oil Co. Station #063**
6125 Telegraph Avenue
Oakland, CA
1st Quarter 2000, Status Report

Dear Ms. Hugo:

Presented herein is the First Quarter 2000, Status Report prepared for Former Thrifty Oil Co. (Thrifty) Station #063 located at 6125 Telegraph Avenue, Oakland, California (**Figure 1**). Presented in this report are the results of the site monitoring efforts conducted on January 26, 2000 in the First Quarter 1999. Thrifty has retained the services of Earth Management Company (EMC) to conduct quarterly monitoring and sampling activities at this site.

Groundwater Monitoring

Depth to groundwater is measured in each monitoring well on a quarterly basis. In general, groundwater occurs under water table conditions beneath the station at depths ranging from 12.62 feet below surface grade (bsg) in monitoring well MW-4 to 14.80 feet (bsg) in monitoring well MW-5 (**Appendix A**). A groundwater elevation contour map based on the January 26, 2000 data is presented in **Figure 2**. The groundwater is flowing to the south and west at gradients ranging from approximately 0.01 feet/foot to 0.10 feet/foot.

Quarterly Groundwater Sampling

As part of the ongoing groundwater monitoring program, groundwater samples were obtained from monitoring wells MW-1, MW-4, MW-5, and MW-6 on January 26, 2000. Well MW-3 serves as a groundwater extraction well, and water from this well was sampled on January 26, 2000 as influent stream into the groundwater remediation system. Groundwater samples were obtained by EMC and delivered in a chilled state following strict Chain-of-Custody procedures to a state-certified laboratory and analyzed for total petroleum hydrocarbons (TPH-g) EPA method 8015 modified for gasoline. Volatile aromatic compounds of benzene, toluene, ethylbenzene, xylenes (BTEX) and methyl tert-butyl ether (MTBE) were analyzed for by EPA method 8020. A summary of historical analytical sampling results are provided in **Table 1**. Copies of the EMC Field Status Reports are



FIGURES

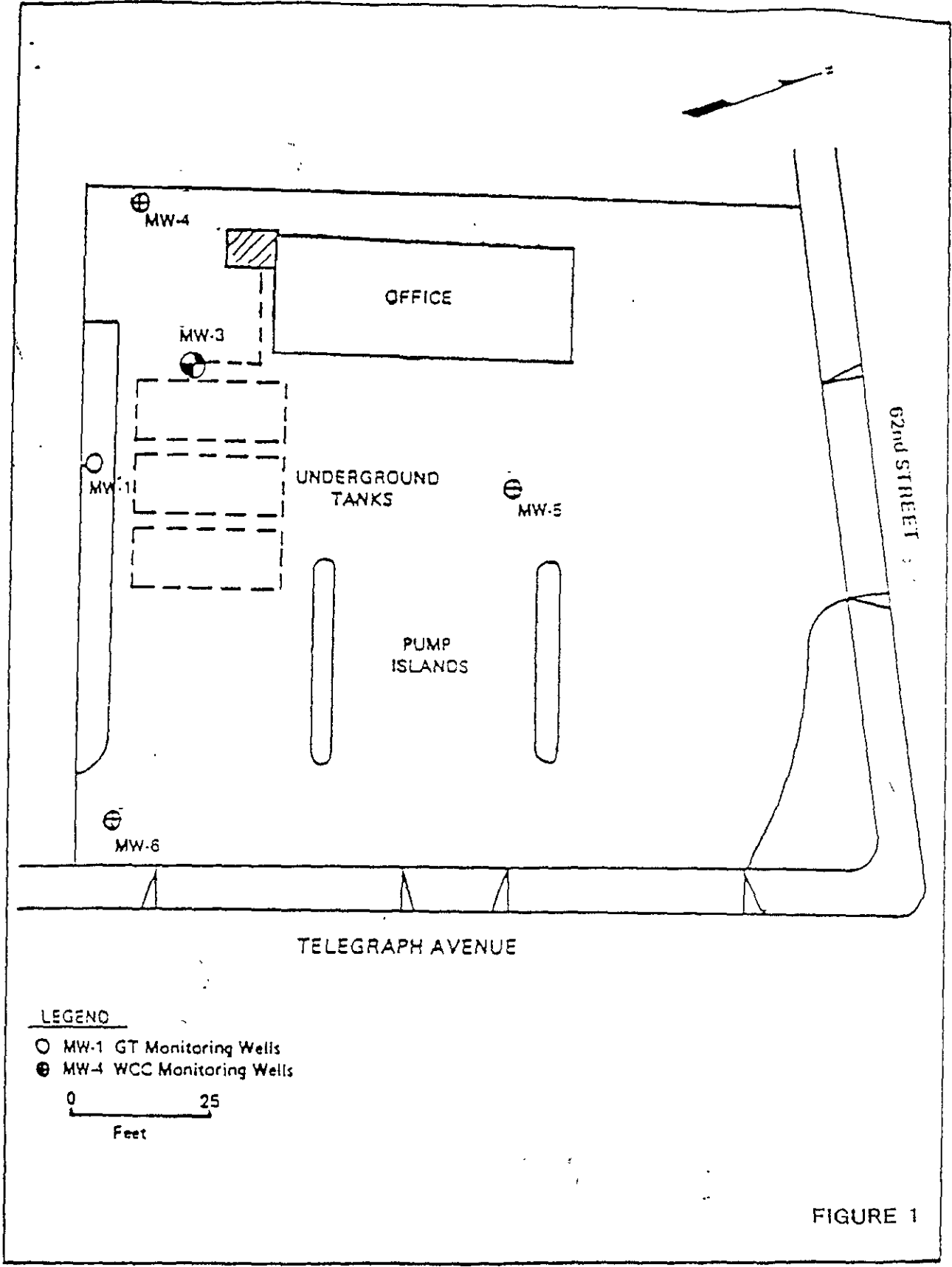
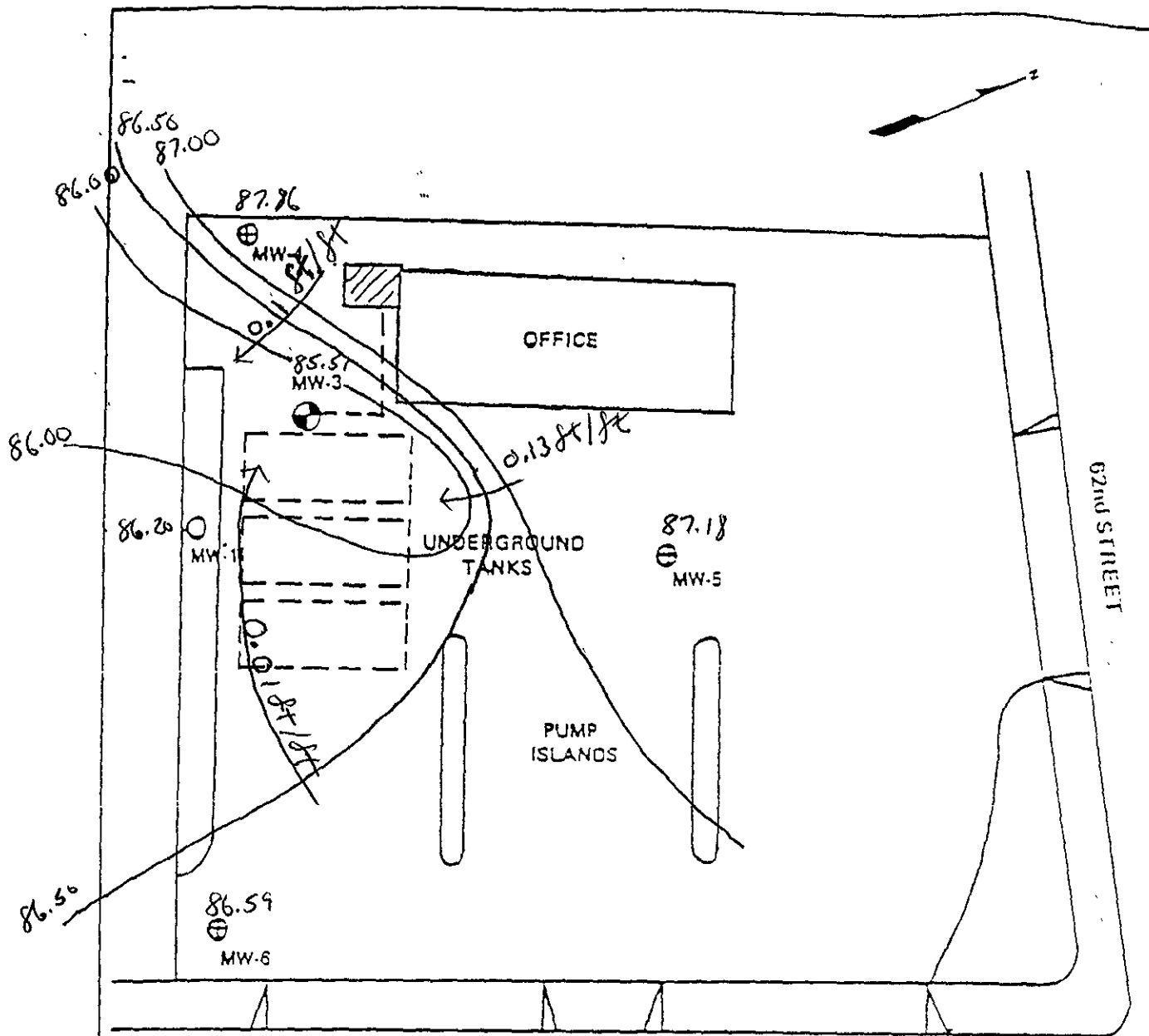

FIGURE 1

SITE PLAN AND RECOVERY SYSTEM
 THRIFTY SERVICE STATION NO. 63
 6125 TELEGRAPH AVE.
 OAKLAND, CA



LEGEND

- MW-1 GT Monitoring Wells
- MW-4 WCC Monitoring Wells

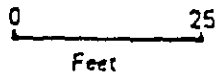
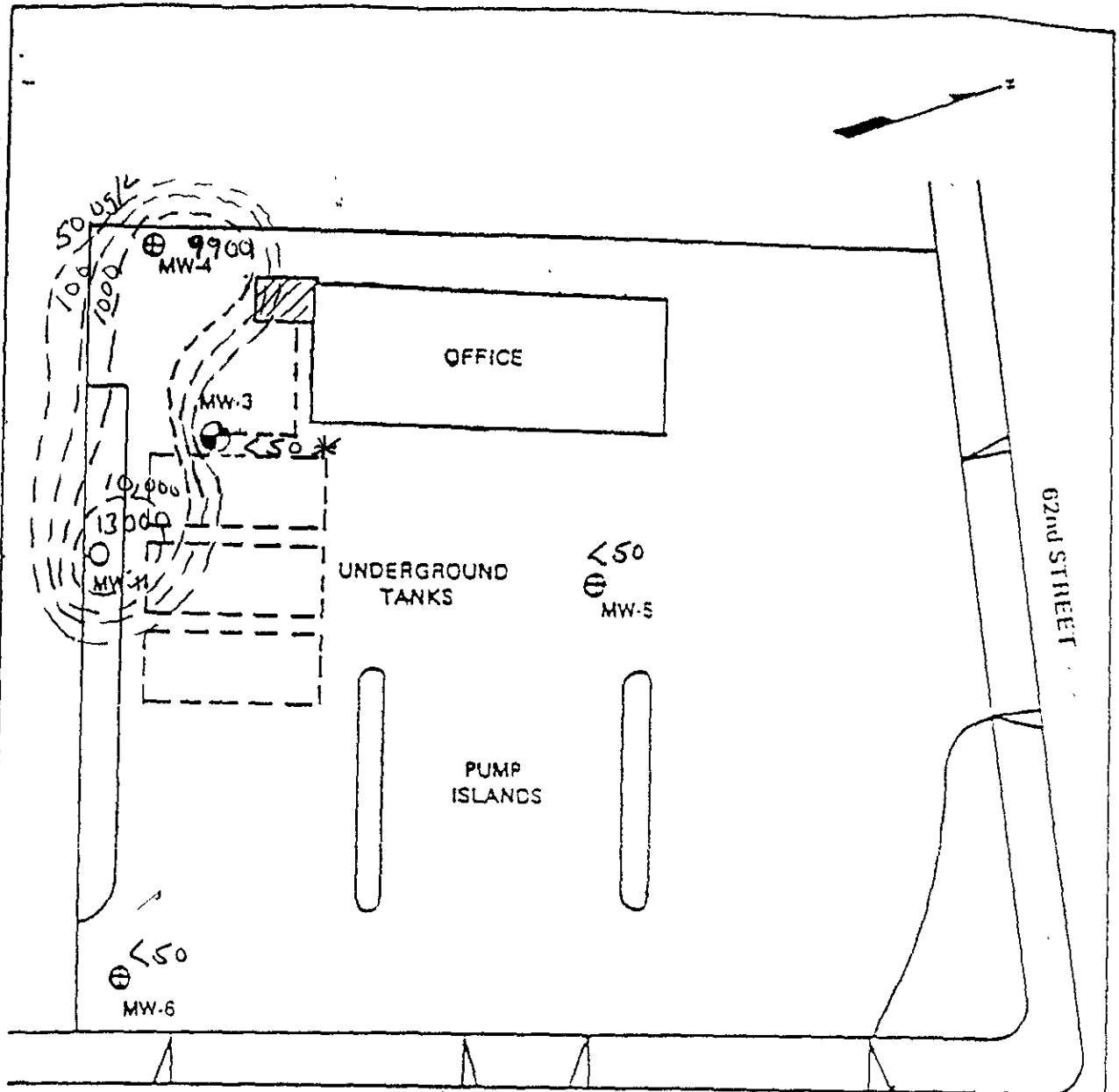

FIGURE 2

Groundwater Contour Map
 THRIFTY SERVICE STATION NO. 63
 6125 TELEGRAPH AVE.
 OAKLAND, CA



LEGEND

- MW-1 GT Monitoring Wells
- MW-4 WCC Monitoring Wells



* MW-3 is based on influent sample concentrations

FIGURE 3

From water extracted from This well. **TPH-g Isoconcentration Map ug/L**
THRIFTY SERVICE STATION NO. 63
6125 TELEGRAPH AVE.
OAKLAND, CA

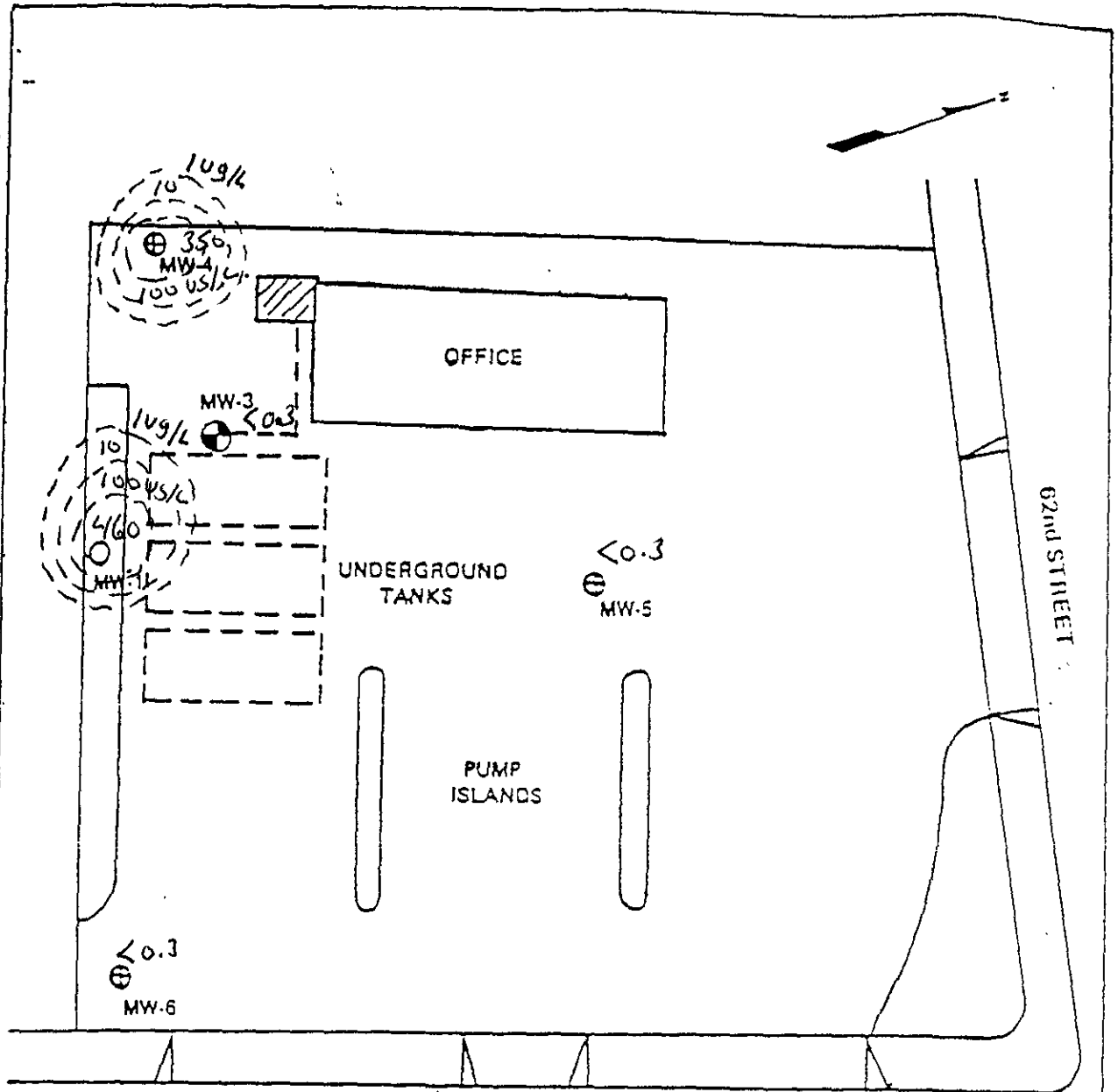

LEGEND
 ○ MW-1 GT Monitoring Wells
 ⊕ MW-4 WCC Monitoring Wells

0 25
 Feet

* MW-3 is based on influent sample concentrations from water extracted from this well.

FIGURE 4

Benzene Isoconcentration Map ug/L
 THRIFTY SERVICE STATION NO. 63
 6125 TELEGRAPH AVE.
 OAKLAND, CA

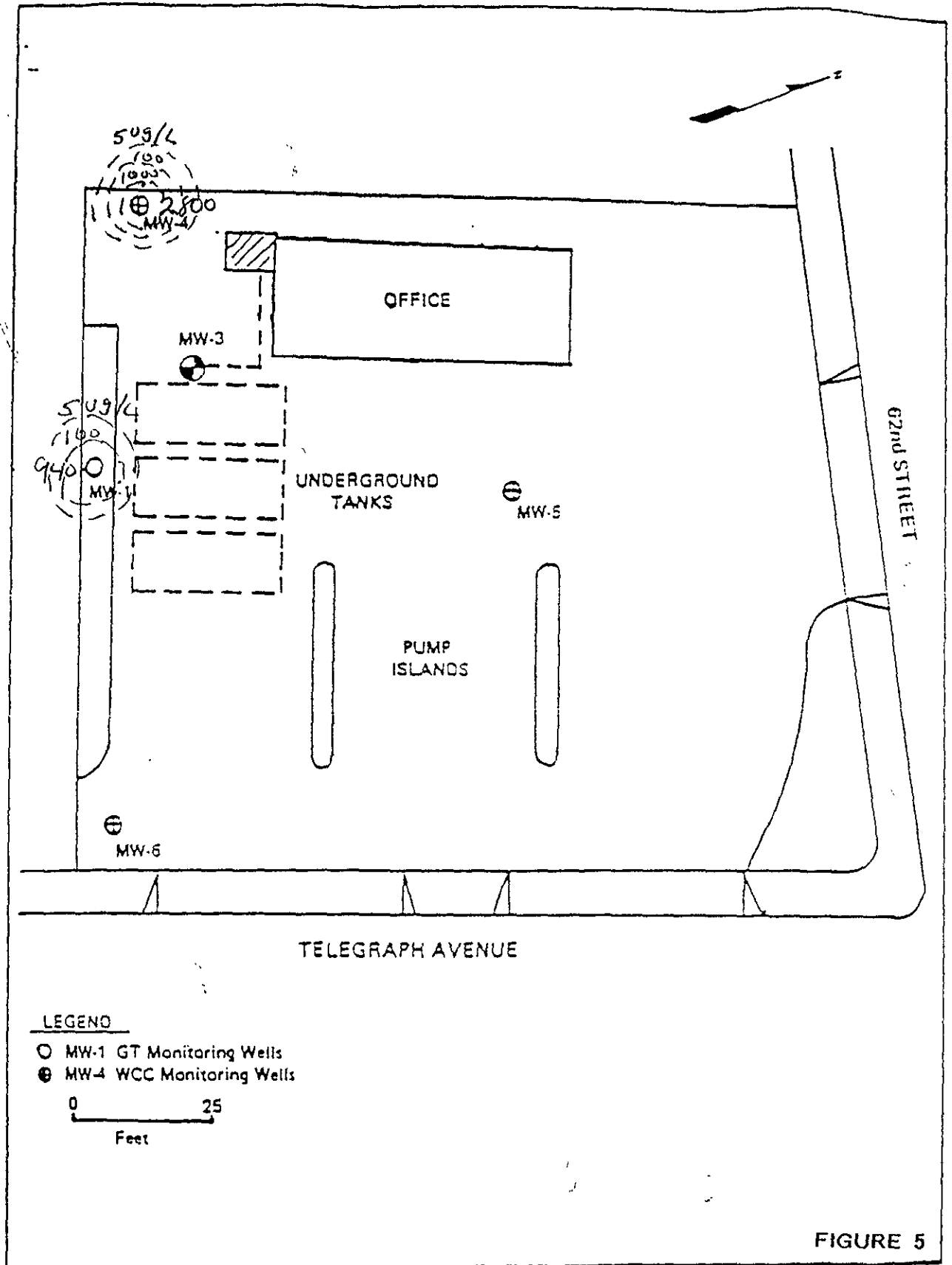

FIGURE 5

MTBE Isoconcentration Map ug/L
 THRIFTY SERVICE STATION NO. 63
 6125 TELEGRAPH AVE.
 OAKLAND, CA

TABLES

TABLE 1
GROUNDWATER DATA
THRIFTY OIL STATION #063, OAKLAND, CA

DATE SAMPLED	ANALYTICAL PARAMETERS						DEPTH TO GROUNDWATER (feet)	DEPTH TO PRODUCT (feet)	PRODUCT THICKNESS (feet)	CASING ELEVATION (feet)	GROUNDWATER ELEVATION (feet)
	TPH (ug/L)	BENZENE (ug/L)	TOLUENE (ug/L)	EthylBenzene (ug/L)	XYLENE (ug/L)	MIBK (ug/L)					
MONITORING WELL #MW-1											
11/21/86	-	-	-	-	-	-	15.42	NP	0.00	99.34	83.92
07/22/91	-	-	-	-	-	-	20.41	FILM	0.00	99.34	78.93
10/24/91	-	-	-	-	-	-	19.06	SHEEN	0.00	99.34	80.28
01/22/92	-	-	-	-	-	-	18.78	SHEEN	0.00	99.34	80.56
03/24/92	-	-	-	-	-	-	13.55	SHEEN	0.00	99.34	85.79
07/15/92	-	-	-	-	-	-	18.90	FILM	0.00	99.34	80.44
10/05/92	-	-	-	-	-	-	20.50	FILM	0.00	99.34	78.84
01/06/93	-	-	-	-	-	-	14.93	FILM	0.00	99.34	84.41
07/13/93	-	-	-	-	-	-	15.44	FILM	0.00	99.34	83.90
10/11/93	-	-	-	-	-	-	20.36	FILM	0.00	99.34	78.98
01/11/94	-	-	-	-	-	-	19.50	FILM	0.00	99.34	79.84
04/12/94	-	-	-	-	-	-	18.10	FILM	0.00	99.34	81.24
07/14/94	-	-	-	-	-	-	20.03	FILM	0.00	99.34	79.31
01/15/96	11,000	2,800	150	780	770	-	19.02	NP	0.00	99.34	80.32
04/15/96	17,000	3,600	330	1,500	3,400	-	18.82	NP	0.00	99.34	80.52
07/15/96	12,000	1,300	200	1,200	4,600	250	-	NP	-	-	-
10/09/96	-	-	-	-	-	-	14.87	NP	0.00	99.34	84.47
01/13/97	27,000	810	6,000	570	4,100	2,700	10.20	NP	0.00	99.34	89.14
04/14/97	2,900	3.0	2.9	<0.3	1.7	9,900	-	NP	-	-	-
07/07/97	5,200	0.57	0.57	<0.3	0.71	16,000	18.75	NP	0.00	99.34	80.59
10/16/97	680	<0.3	0.55	<0.3	<0.5	-	17.92	NP	0.00	99.34	81.42
01/07/98	42,000	980	2,800	1,200	5,200	1.3	9.80	NP	0.00	99.34	89.54
04/06/98	7,100	700	340	170	2,600	1,000	9.60	NP	0.00	99.34	89.74
07/14/98	19,000	2,100	400	890	5,800	1,600	13.70	NP	0.00	99.34	85.64
10/15/98	490	<0.3	<0.3	<0.3	<0.5	1,300	15.25	NP	0.00	99.34	84.09
01/20/99	350	<0.3	<0.3	<0.3	<0.5	* 670 / 820	12.20	NP	0.00	99.34	87.14
04/16/99	320	<0.3	<0.3	<0.3	<0.5	* 540 / 630	12.20	NP	0.00	99.34	87.14
07/14/99	290	<0.3	<0.3	<0.3	<0.5	*590 / 580	13.75	NP	0.00	99.34	85.59
10/07/99	130	<0.3	<0.3	<0.3	<0.5	270	12.15	NP	0.00	99.34	87.19
01/26/00	13,000	460	54	290	3,700	940	13.14	NP	0.00	99.34	86.20
MONITORING WELL #MW-2											
11/21/86	-	-	-	-	-	-	14.90	0.11	14.79	100.01	96.28
07/22/91	-	-	-	-	-	-	17.84	0.38	17.46	100.01	95.35

TABLE 1
GROUNDWATER DATA
THRIFTY OIL STATION #063, OAKLAND, CA

DATE SAMPLED	ANALYTICAL PARAMETERS						DEPTH TO GROUNDWATER (feet)	DEPTH TO PRODUCT (feet)	PRODUCT THICKNESS (feet)	CASING ELEVATION (feet)	GROUNDWATER ELEVATION (feet)
	TPH (ug/L)	BENZENE (ug/L)	TOLUENE (ug/L)	EthylBenzene (ug/L)	XYLENE (ug/L)	MTBE (ug/L)					
10/24/91	-	-	-	-	-	-	17.00	16.97	0.03	100.01	83.03
01/22/92	-	-	-	-	-	-	16.72	FILM	0.00	100.01	83.29
03/24/92	-	-	-	-	-	-	15.81	11.98	3.83	100.01	87.09
07/15/92	-	-	-	-	-	-	16.37	FILM	0.00	100.01	83.64
10/05/92	-	-	-	-	-	-	18.41	18.09	0.32	100.01	81.84
01/06/93	-	-	-	-	-	-	12.37	FILM	0.00	100.01	87.64
07/13/93	-	-	-	-	-	-	15.19	FILM	0.00	100.01	84.82
10/11/93	-	-	-	-	-	-	18.05	0.10	17.95	100.01	95.51
01/11/94	-	-	-	-	-	-	16.98	0.03	16.95	100.01	95.83
04/12/94	-	-	-	-	-	-	15.54	FILM	0.00	100.01	84.47
07/14/94	-	-	-	-	-	-	17.93	FILM	0.00	100.01	82.08
01/15/96	7,100	720	280	48	660	-	17.20	NP	0.00	100.01	82.81
04/15/96	11,000	600	59	420	870	-	17.26	NP	0.00	100.01	82.75
07/15/96	19,000	360	51	610	1,600	<250	-	-	-	-	-
10/09/96	-	-	-	-	-	-	14.42	NP	0.00	100.01	85.59
01/13/97	11,000	230	30	91	700	56	10.25	NP	0.00	100.01	89.76
04/14/97	141	1.2	0.33	0.44	<0.5	20	-	-	-	-	-
07/07/97	<50	<0.3	<0.3	<0.3	<0.5	<20	17.20	NP	0.00	100.01	82.81
10/16/97	<50	<0.3	<0.3	<0.3	<0.5	-	16.20	NP	0.00	100.01	83.81
01/07/98	-	-	-	-	-	-	16.26	16.18	0.08	100.01	83.81
Well Abandoned 1/30/98											
MONITORING WELL #MW-3											
11/21/86	-	100	5.1	<1.0	25	-	16.25	0.10	16.15	99.76	95.70
07/22/91	-	-	-	-	-	-	24.00	NP	0.00	99.76	75.76
10/24/91	-	-	-	-	-	-	18.10	NP	0.00	99.76	81.66
01/22/92	-	-	-	-	-	-	25.80	SHEEN	0.00	99.76	73.96
03/24/92	-	-	-	-	-	-	15.60	NP	0.00	99.76	84.16
07/15/92	-	-	-	-	-	-	25.10	FILM	0.00	99.76	74.66
10/05/92	-	-	-	-	-	-	25.20	NP	0.00	99.76	74.56
01/06/93	-	-	-	-	-	-	25.45	NP	0.00	99.76	74.31
07/13/93	-	-	-	-	-	-	14.24	NP	0.00	99.76	85.52
10/11/93	-	-	-	-	-	-	25.60	NP	0.00	99.76	74.16
01/11/94	-	-	-	-	-	-	25.90	NP	0.00	99.76	73.86
04/12/94	-	-	-	-	-	-	25.70	NP	0.00	99.76	74.06
07/14/94	-	-	-	-	-	-	25.10	NP	0.00	99.76	74.66

**TABLE 1
GROUNDWATER DATA
THRIFTY OIL STATION #063, OAKLAND, CA**

DATE SAMPLED	ANALYTICAL PARAMETERS						DEPTH TO GROUNDWATER (feet)	DEPTH TO PRODUCT (feet)	PRODUCT THICKNESS (feet)	CASING ELEVATION (feet)	GROUNDWATER ELEVATION (feet)
	TPH (ug/L)	BENZENE (ug/L)	TOLUENE (ug/L)	EthylBenzene (ug/L)	XYLENE (ug/L)	MIBC (ug/L)					
01/15/96	-	-	-	-	-	-	26.04	NP	0.00	99.76	73.72
04/15/96	-	-	-	-	-	-	21.03	NP	0.00	99.76	78.73
07/15/96	5,900	240	30	270	730	780	-	-	-	-	-
10/09/96	-	-	-	-	-	-	21.43	NP	0.00	99.76	78.33
01/13/97	-	-	-	-	-	-	11.20	NP	0.00	99.76	88.56
07/07/97	-	-	-	-	-	-	23.40	NP	0.00	99.76	76.36
10/16/97	-	-	-	-	-	-	22.30	NP	0.00	99.76	77.46
01/07/98	-	-	-	-	-	-	20.10	NP	0.00	99.76	79.66
07/14/98	-	-	-	-	-	-	14.40	NP	0.00	99.76	85.36
10/15/98	-	-	-	-	-	-	-	-	-	-	-
01/20/99	-	-	-	-	-	-	-	-	-	-	-
04/16/99	-	-	-	-	-	-	11.20	NP	0.00	99.76	88.56
07/14/99	5,600	9.6	1.3	3.5	8.1	*14,000 / 14,000	25.87	NP	0.00	99.76	73.89
10/07/99	-	-	-	-	-	-	15.40	NP	0.00	99.76	84.36
01/26/00	-	-	-	-	-	-	14.25	NP	0.00	99.76	85.51
MONITORING WELL #MW-4											
11/21/86	100,000	3,200	2,700	2,400	14,000	-	16.22	FILM	0.00	99.48	83.26
07/22/91	-	-	-	-	-	-	21.80	21.35	0.45	99.48	78.02
10/24/91	-	-	-	-	-	-	20.02	SHEEN	0.00	99.48	79.46
01/22/92	-	-	-	-	-	-	19.78	SHEEN	0.00	99.48	79.70
03/24/92	-	-	-	-	-	-	13.94	FILM	0.00	99.48	85.54
07/15/92	-	-	-	-	-	-	19.27	FILM	0.00	99.48	80.21
10/05/92	-	-	-	-	-	-	21.44	FILM	0.00	99.48	78.04
01/06/93	-	-	-	-	-	-	14.08	FILM	0.00	99.48	85.40
07/13/93	-	-	-	-	-	-	16.09	FILM	0.00	99.48	83.39
10/11/93	-	-	-	-	-	-	21.33	FILM	0.00	99.48	78.15
01/11/94	-	-	-	-	-	-	20.45	FILM	0.00	99.48	79.03
04/12/94	-	-	-	-	-	-	19.05	FILM	0.00	99.48	80.43
07/14/94	-	-	-	-	-	-	20.41	FILM	0.00	99.48	79.07
01/15/96	5,000	370	38	300	390	-	19.89	NP	0.00	99.48	79.59
04/15/96	38,000	300	78	540	470	-	19.62	NP	0.00	99.48	79.86
07/15/96	13,000	880	69	820	1,100	3,600	-	-	-	-	-
10/09/96	-	-	-	-	-	-	15.32	NP	0.00	99.48	84.16
01/13/97	47,000	2,500	2,500	1,100	2,800	70,000	10.80	NP	0.00	99.48	88.68

**TABLE 1
GROUNDWATER DATA
THRIFTY OIL STATION #063, OAKLAND, CA**

DATE SAMPLED	ANALYTICAL PARAMETERS						DEPTH TO GROUNDWATER (feet)	DEPTH TO PRODUCT (feet)	PRODUCT THICKNESS (feet)	CASING ELEVATION (feet)	GROUNDWATER ELEVATION (feet)
	TPH (ug/L)	BENZENE (ug/L)	TOLUENE (ug/L)	EthylBenzene (ug/L)	XYLENE (ug/L)	MTBE (ug/L)					
04/14/97	8,700	<0.3	0.45	<0.3	0.64	29,000	-	-	-	-	-
07/07/97	12,000	<0.3	<0.3	<0.3	<0.5	-	18.80	NP	0.00	99.48	80.68
10/16/97	770	<0.3	<0.3	<0.3	<0.5	-	17.76	NP	0.00	99.48	81.72
01/07/98	75,000	3,000	900	1,400	2,500	110	11.60	NP	0.00	99.48	87.88
04/08/98	18,000	1,200	130	710	1,400	22,000	10 10	NP	0.00	99.48	89.38
07/14/98	21,000	1,300	58	1,200	1,100	23,000	16.30	NP	0.00	99.48	83.18
10/15/98	9,100	1.1	0.62	<0.3	<0.5	30,000	16.90	NP	0.00	99.48	82.58
01/20/99	16,000	<0.3	0.91	0.72	1.4	* 43,000 / 42,000	15 35	NP	0.00	100.48	85.13
04/16/99	17,000	0.48	0.92	0.54	1.4	* 28,000 / 26,000	15.30	NP	0.00	100.48	85 18
07/14/99	8,500	<6	<6	<6	<10	*21,000 / 16,000	18.40	NP	0.00	100.48	82 08
10/07/99	2,500	<1.5	3.1	<1.5	<2.5	4,800	16.89	NP	0.00	100.48	83.59
01/26/00	9,900	350	9	460	460	2,800	12.62	NP	0.00	100.48	87 86
MONITORING WELL #MW-5											
11/21/86	<1,000	4.8	2.1	<0.5	7.4	-	16.10	NP	0.00	100.98	84.88
07/22/91	-	<0.5	1.6	<1.0	2.0	-	18.20	NP	0.00	100.98	82 78
10/24/91	-	-	-	-	-	-	17.67	NP	0.00	100.98	83 31
01/22/92	600	21.0	8.0	2.0	17.0	-	-	-	-	-	-
03/24/92	-	-	-	-	-	-	12.98	NP	0.00	100.98	88.00
07/15/92	<200	<0.5	<0.5	<0.5	<0.5	-	17.29	NP	0.00	100.98	83 69
10/05/92	-	-	-	-	-	-	18.92	NP	0.00	100.98	82.06
01/06/93	300	2.7	<0.5	1.3	26.0	-	13.12	NP	0.00	100.98	87.86
07/13/93	<100	1.1	0.5	1.0	1.5	-	16.15	NP	0.00	100.98	84 83
10/11/93	130	1.2	<0.3	<0.3	<0.6	-	18.75	NP	0 00	100.98	82.23
01/11/94	<50	1.5	<0.3	<0.3	<0.5	-	17.80	NP	0.00	100.98	83.18
04/12/94	<50	<0.3	<0.3	<0.3	<0.5	-	13.59	NP	0.00	100.98	87 39
07/14/94	<50	0.42	<0.3	<0.3	<0.5	-	18.26	NP	0.00	100.98	82 72
07/15/95	100	1.2	<0.5	0.8	<1	-	-	-	-	-	-
01/15/96	1,900	21	13	6.2	6 8	-	13.09	NP	0.00	100.98	87 89
04/15/96	250	5 1	2.7	1.7	1.1	-	13 16	NP	0.00	100.98	87 82
07/15/96	270	6.5	1 4	1.8	1.4	230	-	NP	-	-	-
10/09/96	-	-	-	-	-	-	15.37	NP	0.00	100 98	85.61
01/13/97	25,000	780	5,700	560	4,000	24,000	10.90	NP	0 00	100.98	90 08
04/14/97	6,300	260	1,600	28	550	9,000	-	-	-	-	-
07/07/97	7,500	300	1,500	12	110	16,000	14 70	NP	0.00	100.98	86 28

TABLE 1
GROUNDWATER DATA
THRIFTY OIL STATION #063, OAKLAND, CA

DATE SAMPLED	ANALYTICAL PARAMETERS						DEPTH TO GROUNDWATER (feet)	DEPTH TO PRODUCT (feet)	PRODUCT THICKNESS (feet)	CASING ELEVATION (feet)	GROUNDWATER ELEVATION (feet)
	TPH (ug/L)	BENZENE (ug/L)	TOLUENE (ug/L)	EthylBenzene (ug/L)	XYLENE (ug/L)	MTBE (ug/L)					
10/16/97	4,600	<0.3	0.65	<0.3	<0.5	-	13.60	NP	0.00	100.98	87.38
01/07/98	2,700	33	11	37	580	7.3	10.97	NP	0.00	100.98	90.01
04/08/98	300	9.1	<0.3	<0.3	<0.5	650	10.90	NP	0.00	100.98	90.08
07/14/98	670	5.9	<0.3	<0.3	0.53	2,300	15.20	NP	0.00	100.98	85.78
10/15/98	<50	<0.3	<0.3	<0.3	<0.5	19	15.90	NP	0.00	100.98	85.08
01/20/99	<50	<0.3	<0.3	<0.3	<0.5	<5	15.20	NP	0.00	101.98	86.78
04/16/99	<50	<0.3	<0.3	<0.3	<0.5	<5	15.25	NP	0.00	101.98	86.73
07/14/99	<50	<0.3	<0.3	<0.3	<0.5	<5	15.96	NP	0.00	101.98	86.02
10/07/99	<50	<0.3	<0.3	<0.3	<0.5	<5	16.33	NP	0.00	101.98	85.65
01/26/00	<50	<0.3	<0.3	<0.3	<0.5	<5	14.80	NP	0.00	101.98	87.18
MONITORING WELL #MW-6											
11/21/86	<1,000	<2.0	<2.0	<2.0	<2.0	-	12.64	NP	0.00	99.44	86.80
07/22/91	-	-	-	-	-	-	-	-	-	-	-
01/22/92	<200	<0.5	<0.5	<0.5	1.5	-	-	-	-	-	-
03/24/92	-	-	-	-	-	-	10.04	NP	0.00	99.44	89.40
07/15/92	<200	<0.5	<0.5	<0.5	<0.5	-	13.29	NP	0.00	99.44	86.15
10/05/92	-	-	-	-	-	-	14.69	NP	0.00	99.44	84.75
01/06/93	<200	<0.5	<0.5	<0.5	<1.0	-	10.87	NP	0.00	99.44	88.57
07/13/93	<100	<0.5	<0.5	<0.5	<1.0	-	13.10	NP	0.00	99.44	86.34
10/11/93	<60	<0.3	<0.3	<0.3	<0.6	-	14.43	NP	0.00	99.44	85.01
01/11/94	<50	<0.3	<0.3	<0.3	<0.5	-	13.56	NP	0.00	99.44	85.88
04/12/94	<50	<0.3	<0.3	<0.3	<0.3	-	12.10	NP	0.00	99.44	87.34
07/14/94	<50	<0.3	<0.3	<0.3	<0.3	-	14.16	NP	0.00	99.44	85.28
07/15/95	140	<0.5	<0.5	<0.5	<1	-	-	-	-	-	-
01/15/96	56	0.38	0.33	<0.3	<0.5	-	14.29	NP	0.00	99.44	85.15
04/15/96	96	4.5	<0.3	<0.3	0.53	-	14.32	NP	0.00	99.44	85.12
07/15/96	140	2.4	0.44	<0.3	0.70	110	-	-	-	-	-
10/09/96	-	-	-	-	-	-	12.09	NP	0.00	99.44	87.35
01/13/97	210	<0.3	1.2	<0.3	0.68	270	9.85	NP	0.00	99.44	89.59
04/14/97	<50	<0.3	<0.3	<0.3	<0.5	<20	-	-	-	-	-
07/07/97	<50	<0.3	<0.3	<0.3	<0.5	<20	14.20	NP	0.00	99.44	85.24
10/16/97	<50	<0.3	<0.3	<0.3	<0.5	-	13.10	NP	0.00	99.44	86.34
01/07/98	<50	<0.3	<0.3	<0.3	<0.5	0.10	9.80	NP	0.00	99.44	89.64
07/14/98	330	<0.3	<0.3	<0.3	<0.5	380	12.30	NP	0.00	99.44	87.14

TABLE 1
GROUNDWATER DATA
THRIFTY OIL STATION #063, OAKLAND, CA

DATE SAMPLED	ANALYTICAL PARAMETERS						DEPTH TO GROUNDWATER (feet)	DEPTH TO PRODUCT (feet)	PRODUCT THICKNESS (feet)	CASING ELEVATION (feet)	GROUNDWATER ELEVATION (feet)
	TPH (ug/L)	BENZENE (ug/L)	TOLUENE (ug/L)	EthylBenzene (ug/L)	XYLENE (ug/L)	MTBE (ug/L)					
10/15/98	<50	<0.3	<0.3	<0.3	<0.5	<5	14.30	NP	0.00	99.44	85.14
01/20/99	<50	0.47	<0.3	<0.3	<0.5	<5	13.60	NP	0.00	100.44	86.84
04/16/99	<50	<0.3	<0.3	<0.3	<0.5	<5	13.50	NP	0.00	100.44	86.94
07/14/99	<50	<0.3	<0.3	<0.3	<0.5	*5.4 / <5	14.65	NP	0.00	100.44	85.79
10/07/99	<50	<0.3	0.96	0.35	1.8	<5	15.39	NP	0.00	100.44	85.05
01/26/00	<50	<0.3	<0.3	<0.3	0.63	<5	13.85	NP	0.00	100.44	86.59

NOTE: NP = No free hydrocarbon product
 " - " = Not analyzed / Not available
 * MTBE 8020 / 8260

Benzene, toluene, ethylbenzene, and xylene analyzed by EPA method 8020
 Total petroleum hydrocarbons (TPH) analyzed by EPA method 8015 modified for gasoline
 Methyl-tert Butyl Ether (MTBE) analyzed by EPA method 8020 or 8260

TABLE 2
GROUNDWATER REMEDIATION SYSTEM MONITORING PROGRAM
 Thrifty Oil Co. Station No 063, OAKLAND, CA

Date	Totalizer (gallons)	Total/Cum. Discharge (gallons)	Flow (gal/day)	EFFLUENT (ug/L)						INFLUENT (ug/L)						
				TPH-g	B	T	E	X	MTBE	TPH-g	E	T	E	X	MTBE	
4/8/91	1,669	0	-	-	<0.3	<0.3	<0.3	<0.9	-	-	1300	120	<7.5	1300	-	
4/15/91	5,742	4,073	582	-	<0.3	<0.3	<0.3	<0.3	-	-	700	140	<15	500	-	
4/22/91	10,240	8,571	643	-	<0.3	<0.3	<0.3	<0.9	-	-	850	100	34	860	-	
4/29/91	15,510	13,841	753	-	<0.3	<0.3	<0.3	<0.9	-	-	220	8.4	<0.3	42	-	
5/6/91	20,200	18,531	670	-	<0.3	<0.3	<0.3	<0.9	-	-	280	0.8	<0.3	56	-	
5/13/91	24,430	22,761	604	-	<0.3	<0.3	<0.3	<0.9	-	-	190	5.6	<0.3	37	-	
5/20/91	28,480	26,811	579	-	<0.3	<0.3	<0.3	<0.9	-	-	150	0.83	1.4	29	-	
5/28/91	29,310	27,641	104	-	<0.3	<0.3	<0.3	<0.9	-	-	<0.3	<0.3	<0.3	<0.9	-	
6/3/91	33,080	31,411	628	-	<0.3	<0.3	<0.3	<0.9	-	-	58	4	<0.3	33	-	
6/10/91	36,939	35,270	551	-	<0.3	<0.3	<0.3	<0.9	-	-	45	<0.3	<0.3	16	-	
6/17/91	40,673	39,004	533	-	<0.3	<0.3	<0.3	<0.9	-	-	69	4.9	0.9	21	-	
6/24/91	44,453	42,784	540	-	<0.3	<0.3	<0.3	<0.9	-	-	5.4	2	<0.3	6.6	-	
7/1/91	48,173	46,504	531	-	<0.5	<0.5	<1	<1	-	-	14	15	<1	9.1	-	
7/8/91	51,681	50,012	501	-	<0.5	<0.5	<1	<1	-	-	<0.5	<0.5	<1	6.9	-	
7/15/91	55,186	53,517	501	-	<0.5	<0.5	<1	<1	-	-	<0.5	0.6	<1	6.3	-	
7/22/91	62,150	60,481	995	-	<0.5	<0.5	<1	<1	-	-	<0.5	<0.5	<1	2.6	-	
7/29/91	62,150	60,481	-	-	<0.5	<0.5	<1	<1	-	-	<0.5	<0.5	1.2	19	-	
8/5/91	63,241	61,572	156	-	<0.5	<0.5	<1	<1	-	-	<0.5	<0.5	<1	<1	-	
8/12/91	66,091	64,422	407	-	<0.5	<0.5	<1	<1	-	-	2.6	<0.5	<1	12	-	
8/19/91	67,649	65,980	223	-	<0.5	<0.5	<1	<1	-	-	20	3.3	2.8	70	-	
8/26/91	70,514	68,845	409	-	<0.5	<0.5	<1	<1	-	-	<0.5	<0.5	1.2	19	-	
9/9/91	70,564	68,895	4	-	<0.5	<0.5	<1	<1	-	-	270	10	13	69	-	
9/16/91	73,526	71,857	423	System shut down due to damaged compressor pump						-	-	-	-	-	-	-
10/7/91	73,526	71,857	-	-	<0.5	<0.5	<1	<1	-	-	<0.5	<0.5	<1	3.8	-	
10/14/91	74,516	72,847	141	-	<0.5	<0.5	<1	<1	-	-	60	1.1	<1	23	-	
10/21/91	76,091	74,422	225	-	<0.5	<0.5	<1	<1	-	-	<0.5	<0.5	<1	<1	-	
10/28/91	83,242	81,573	1,022	-	<0.5	<0.5	<1	<1	-	-	<0.5	<0.5	<1	14	-	
11/3/91	83,242	81,573	-	-	<0.5	<0.5	<1	<1	-	-	<0.5	<0.5	<1	3.1	-	
11/11/91	84,351	82,682	139	-	<0.5	<0.5	<1	<1	-	-	99	1.9	<1	14	-	
11/18/91	85,647	83,978	185	-	<0.5	<0.5	<1	<1	-	-	42	1	1	10	-	
11/25/91	89,512	87,843	552	-	<0.5	<0.5	<1	<1	-	-	<0.5	<0.5	<1	3.9	-	
12/3/91	93,407	91,738	487	-	<0.5	<0.5	<1	<1	-	-	<0.5	<0.5	<1	3.8	-	
12/9/91	96,210	94,541	467	-	<0.5	<0.5	<1	<1	-	-	<0.5	<0.5	<1	3.2	-	
12/16/91	99,045	97,376	405	-	<0.5	<0.5	<0.5	<0.5	-	-	1.3	<0.5	<0.5	1.5	-	
12/23/91	102,334	100,665	470	-	<0.5	<0.5	<0.5	<0.5	-	-	1.7	<0.5	<0.5	2.4	-	
12/30/91	105,124	103,455	399	-	<0.5	<0.5	<0.5	<0.5	-	-	22.6	1.2	0.7	4.9	-	
1/15/92	115,691	114,022	660	-	<0.5	<0.5	<0.5	<0.5	-	-	130	11	<0.5	50	-	
2/10/92	124,846	123,177	352	-	<0.5	<0.5	<0.5	<0.5	-	-	20	0.51	<0.5	3.6	-	

TABLE 2
GROUNDWATER REMEDIATION SYSTEM MONITORING PROGRAM
 Thrifty Oil Co. Station No 063, OAKLAND, CA

Date	Totalizer (gallons)	Total/Cum. Discharge (gallons)	Flow (gal/day)	EFFLUENT (ug/L)						INFLUENT (ug/L)						
				TPH-g	B	T	E	X	MTBE	TPH-g	B	T	E	X	MTBE	
3/9/92	149,965	148,296	897	<200	<0.5	<0.5	<0.5	<0.5	-	12,000	2,100	400	170	2,100	-	
4/13/92	168,567	166,898	531	<200	<0.5	<0.5	<0.5	<0.5	-	2,100	280	3.9	<2.5	98	-	
5/11/92	187,170	185,501	664	<200	<0.5	0.7	<0.5	<0.5	-	<200	<0.5	<0.5	<0.5	<0.5	-	
6/8/92	190,490	188,821	119	-	<0.5	<0.5	<0.5	<0.5	-	-	44	3.7	0.7	64	-	
7/6/92	197,080	195,411	235	-	-	-	-	-	-	-	-	-	-	-	-	
7/13/92	197,890	196,221	116	-	<0.5	<0.5	<0.5	<0.5	-	-	<0.5	<0.5	<0.5	<0.5	-	
7/13/92	197,890	196,221	-	System shut down for repair of electrical motor												
8/10/92	197,890	196,221	-	Restart the system												
8/17/92	201,300	199,631	487	-	<0.5	<0.5	<0.5	<0.5	-	-	<0.5	<0.5	<0.5	<0.5	-	
9/14/92	209,647	207,978	298	-	<0.5	<0.5	<0.5	<1	-	-	<0.5	<0.5	<0.5	<1	-	
10/5/92	217,360	215,691	367	<200	<0.5	<0.5	<0.5	<1	-	<200	<0.5	<0.5	<0.5	<1	-	
11/09/92	225,780	224,111	241	-	<0.5	<0.5	<0.5	<1	-	-	1.1	0.5	<0.5	10	-	
12/14/92	243,048	241,379	493	-	<0.5	<0.5	<0.5	<1	-	-	720	46	<10	1,700	-	
01/04/93	252,510	250,841	451	-	<0.5	<0.5	<0.5	<1	-	-	400	32	<25	520	-	
02/15/93	266,210	264,541	326	<200	<0.5	<0.5	<0.5	<1	-	9,000	1,400	330	260	1,200	-	
03/08/93	269,330	267,661	149	-	<0.5	<0.5	<0.5	<1	-	-	1,100	150	7.5	1,000	-	
04/26/93	271,290	269,621	40	<100	<0.5	<0.5	<0.5	<1	-	7,200	1,100	100	25	780	-	
04/26/93	271,290	269,621	-	System shut down for repair												
07/15/93	272,577	270,908	16	Restart the system												
08/11/93	284,230	282,561	432	-	<0.5	<0.5	<0.5	<1	-	-	1.3	<0.5	<0.5	1.6	-	
09/16/93	298,832	297,163	406	<60	<0.3	<0.3	<0.3	<0.6	-	<60	<0.3	<0.3	<0.3	<0.6	-	
10/08/93	305,641	303,972	310	-	-	-	-	-	-	-	-	-	-	-	-	
10/11/93	307,068	305,399	476	<60	<0.3	<0.3	<0.3	<0.6	-	<60	<0.3	<0.3	<0.3	<0.6	-	
10/15/93	308,495	306,826	357	-	-	-	-	-	-	-	-	-	-	-	-	
11/12/93	318,203	316,534	347	<50	<0.3	<0.3	<0.3	<0.5	-	<50	<0.3	<0.3	<0.3	<0.5	-	
12/10/93	329,947	328,278	419	<50	<0.3	<0.3	<0.3	<0.5	-	<50	<0.3	<0.3	<0.3	<0.5	-	
01/13/94	345,860	344,191	468	-	<0.3	<0.3	<0.3	<0.5	-	-	<0.3	<0.3	<0.3	<0.5	-	
02/10/94	359,662	357,993	493	-	<0.3	<0.3	<0.3	<0.5	-	-	430	41	36	480	-	
02/18/94	618,620	-	-	Changed air filters. The water flowmeter jumped from 359,662 to 618,620												
03/10/94	627,540	366,913	446	-	<0.3	<0.3	<0.3	<0.5	-	-	<0.3	<0.3	<0.3	7.7	-	
04/14/94	645,330	384,703	508	<50	<0.3	<0.3	<0.3	<0.5	-	170	1.5	<0.3	0.38	0.73	-	
05/19/94	653,520	392,893	234	<50	<0.3	<0.3	<0.3	<0.5	-	1,500	46	4.1	0.5	84	-	
06/16/94	664,015	403,388	375	<50	<0.3	<0.3	<0.3	<0.5	-	12,000	860	37	<13	1,600	-	
07/14/94	672,750	412,123	312	<50	<0.3	<0.3	<0.3	<0.5	-	<50	<0.3	<0.3	<0.3	<0.5	-	
08/11/94	681,920	421,293	328	<50	<0.3	<0.3	<0.3	<0.5	-	<50	<0.3	<0.3	<0.3	<0.5	-	
09/15/94	692,083	431,456	290	<50	<0.3	<0.3	<0.3	<0.5	-	<50	<0.3	<0.3	<0.3	<0.5	-	
10/17/94	699,979	439,352	247	<50	<0.3	<0.3	<0.3	<0.5	-	<50	<0.3	<0.3	<0.5	<0.5	-	
11/14/94	712,539	451,912	449	<50	<0.3	<0.3	<0.3	<0.5	-	<50	<0.3	<0.3	<0.5	<0.5	-	
12/19/94	734,620	473,993	631	<50	<0.3	<0.3	<0.3	<0.5	-	<50	<0.3	<0.3	<0.5	<0.5	-	

TABLE 2
GROUNDWATER REMEDIATION SYSTEM MONITORING PROGRAM
 Thrifty Oil Co. Station No 063, OAKLAND, CA

Date	Totalizer (gallons)	Total/Cum. Discharge (gallons)	Flow (gal/day)	EFFLUENT (ug/L)						INFLUENT (ug/L)						
				TPH-g	B	T	E	X	MTBE	TPH-g	B	T	E	X	MTBE	
01/10/95	742,072	481,445	339	-	-	-	-	-	-	-	-	-	-	-	-	
01/16/95	742,074	481,447	0	System shut down for repair of compressor pump												
02/06/95	742,074	481,447	-	Restart the system												
02/13/95	744,063	483,436	284	<50	<0.3	<0.3	<0.5	<0.5	-	<50	<0.3	<0.3	<0.5	<0.5	-	
03/13/95	758,930	498,303	531	<100	<0.5	<0.5	<0.5	<1	-	1,300	<0.5	<0.5	<0.5	<1	-	
04/17/95	768,276	507,649	267	<100	<0.5	<0.5	<0.5	<1	-	6,200	410	73	97	260	-	
05/15/95	780,716	520,089	444	<100	<0.5	<0.5	<0.5	<1	-	1,300	0.6	<0.5	<0.5	<1	-	
06/12/95	784,514	523,887	136	<100	<0.5	<0.5	<0.5	<1	-	<100	<0.5	<0.5	<0.5	<1	-	
07/18/95	794,158	533,531	268	<100	<0.5	<0.5	<0.5	<1	-	1,100	<0.5	<0.5	<0.5	<1	-	
08/14/95	795,216	534,589	39	<100	<0.5	<0.5	<0.5	<1	-	170	<0.5	<0.5	<0.5	<1	-	
09/06/95	797,631	537,004	105	<100	<0.5	<0.5	<0.5	<1	-	1,320	<0.5	<0.5	<0.5	<1	-	
10/17/95	800,316	539,689	65	<100	<0.5	<0.5	<0.5	<1	-	2,400	26	2.7	3.9	46	-	
11/20/95	806,264	545,637	175	150	<0.3	<0.3	<0.3	<0.5	-	450	0.31	<0.3	<0.3	<0.5	-	
12/11/95	809,236	548,609	142	300	<0.3	<0.3	<0.3	0.59	-	470	<0.3	<0.3	<0.3	<0.5	-	
01/15/96	822,734	562,107	386	510	<0.3	<0.3	<0.3	<0.5	-	900	0.39	<0.3	<0.3	<0.5	-	
02/19/96	848,213	587,586	728	800	<0.3	0.57	<0.3	0.83	-	1700	23	3.7	<0.3	80	-	
03/19/96	849,587	588,960	47	930	<0.3	<0.3	<0.3	<0.5	-	1,600	5.5	1.4	<0.3	94	-	
04/15/96	852,042	591,415	91	990	<0.3	<0.3	<0.3	<0.5	-	1,100	0.43	<0.3	<0.3	<0.5	-	
05/13/96	890,214	629,587	1,363	840	<0.3	<0.3	<0.3	<0.5	-	910	<0.3	<0.3	<0.3	<0.5	-	
05/13/96	890,214	629,587	-	System shut down for carbon change												
06/14/96	890,214	629,587	-	Restart the system												
06/18/96	890,818	630,191	151	<50	<0.3	<0.3	<0.3	<0.5	-	1,000	92	8.7	3.4	55	-	
07/01/96	892,781	632,154	151	-	-	-	-	-	-	-	-	-	-	-	-	
07/08/96	894,210	633,583	204	System shut down due to burglary and damaged air compressor												
08/05/96	894,210	633,583	-	Restart the system												
08/13/96	896,220	635,593	251	<50	<0.3	<0.3	<0.3	<0.5	-	3,500	160	110	220	650	-	
09/23/96	899,410	638,783	78	<50	<0.3	<0.3	<0.3	<0.5	-	<50	0.49	<0.3	<0.3	<0.5	-	
10/09/96	899,845	639,218	27	<50	<0.3	<0.3	<0.3	<0.5	-	730	1.7	0.42	2.1	2.5	-	
11/11/96	901,348	640,721	46	<50	<0.3	<0.3	<0.3	<0.5	-	81	<0.3	<0.3	<0.3	<0.5	-	
12/09/96	901,576	640,949	8	<50	<0.3	<0.3	<0.3	<0.5	-	<50	<0.3	<0.3	<0.3	<0.5	-	
01/13/97	904,630	644,003	87	<50	<0.3	<0.3	<0.3	<0.5	-	13,000	590	250	180	850	-	
02/10/97	912,610	651,983	285	82	<0.3	0.38	<0.3	<0.5	-	700	0.92	0.75	<0.3	4.1	-	
03/10/97	921,020	660,393	300	<50	<0.3	<0.3	<0.3	<0.5	-	600	<0.3	<0.3	<0.3	<0.5	-	
04/14/97	932,410	671,783	325	<50	<0.3	<0.3	<0.3	<0.5	-	4,400	<0.3	<0.3	<0.3	<0.5	-	
05/12/97	941,028	680,401	308	<50	<0.3	<0.3	<0.3	<0.5	-	5,600	7.3	0.32	<0.3	17	-	
06/23/97	943,183	682,556	51	-	-	-	-	-	-	-	-	-	-	-	-	
07/07/97	945,821	685,194	188	<50	<0.3	<0.3	<0.3	<0.5	-	1,500	3.4	<0.3	<0.3	26	-	
08/04/97	951,020	690,393	186	-	-	-	-	-	-	-	-	-	-	-	-	
09/02/97	957,933	697,306	238	System shut down due to stolen air compressor												

TABLE 2
GROUNDWATER REMEDIATION SYSTEM MONITORING PROGRAM
 Thrifty Oil Co. Station No 063, OAKLAND, CA

Date	Totalizer (gallons)	Total/Cum. Discharge (gallons)	Flow (gpd/day)	EFFLUENT (ug/L)						INFLUENT (ug/L)					
				TPH-g	B	T	E	X	MTBE	TPH-g	B	T	E	X	MTBE
10/06/97	961,030	700,403	91	-	-	-	-	-	-	-	-	-	-	-	-
10/16/97	961,077	700,450	5	<50	<0.3	<0.3	<0.3	<0.5	-	550	<0.3	<0.3	<0.3	<0.5	-
11/17/97	970,920	710,293	308	-	-	-	-	-	-	-	-	-	-	-	-
12/23/97	986,016	725,389	419	-	-	-	-	-	-	-	-	-	-	-	-
01/05/98	991,520	730,893	423	-	-	-	-	-	-	-	-	-	-	-	-
01/07/98	992,365	731,738	423	<50	<0.3	<0.3	<0.3	<0.5	-	65,000	690	8,400	3,100	20,000	-
02/02/98	996,874	736,247	173	-	-	-	-	-	-	-	-	-	-	-	-
02/09/98	-	-	-	System shut down due to the UST replacement and station remodeling											
02/17/98	-	-	-	<50	<0.3	<0.3	<0.3	<0.5	-	35,000	150	<15	<15	8,900	-
04/13/98	53,000	736,247	-	Replaced carbons and restarted system with new meter (53,000)											
4/13 - 6/1/98	-	-	-	System was undergoing several maintenance / piping / hose replacement											
06/01/98	53,780	737,027	16	-	-	-	-	-	-	-	-	-	-	-	-
07/14/98	56,905	740,152	73	<50	<0.3	<0.3	<0.3	<0.5	-	3,500	14	0.56	<0.3	26	-
08/13/98	59,426	742,673	84	-	-	-	-	-	-	-	-	-	-	-	-
09/11/98	62,356	745,603	101	-	-	-	-	-	-	-	-	-	-	-	-
10/15/98	62,714	745,961	11	<50	<0.3	<0.3	<0.3	<0.5	-	2,200	21	4	<0.3	100	-
11/06/98	62,952	746,199	11	-	-	-	-	-	-	-	-	-	-	-	-
11/20/98	-	-	-	System shut down for flowmeter replacement											
12/01/98	0.0	746,199	-	Restart the system with flowmeter at 000											
12/31/98	5,340.0	751,539	178	-	-	-	-	-	-	-	-	-	-	-	-
01/11/99	15,020.0	761,219	880	System shut down											
1/11 - 2/1/99	-	-	-	System was undergoing maintenance for the compressor											
01/20/99	-	-	-	<50	<0.3	<0.3	<0.3	<0.5	-	110	0.43	0.42	<0.3	<0.5	260
02/01/99	15,600.0	761,799	28	Restart system											
02/12/99	22,840.0	769,039	658	-	-	-	-	-	-	-	-	-	-	-	-
02/22/99	22,840.0	769,039	-	System shut down for carbon canister replacement											
03/26/99	22,840.0	769,039	-	Restart the system											
03/31/99	24,620.0	770,819	356	-	-	-	-	-	-	-	-	-	-	-	-
04/16/99	29,605.0	775,804	312	<50	<0.3	<0.3	<0.3	<0.5	<5	<50	<0.3	<0.3	<0.3	<0.5	<5
05/11/99	36,010.0	782,209	256	-	-	-	-	-	-	-	-	-	-	-	-
05/25/99	46,000.0	792,199	714	System shut down due to carbon canister leaking											
09/02/99	46,000.0	792,199	-	Restart system											
09/17/99	46,217.0	792,416	14	-	-	-	-	-	-	-	-	-	-	-	-
10/07/99	46,809.0	793,008	30	<50	<0.3	<0.3	<0.3	<0.5	11	65	<0.3	<0.3	<0.3	<0.5	120
10/21/99	47,278.0	793,477	34	System shut down for carbon change											
11/24/99	47,283.0	793,482	0	Restart system											
12/30/99	49,386.0	795,585	58	-	-	-	-	-	-	-	-	-	-	-	-
01/26/00	50,569.0	796,768	44	<50	<0.3	<0.3	<0.3	<0.5	-	<50	<0.3	<0.3	<0.3	<0.5	-

APPENDIX A

FIELD DATA - GROUNDWATER SAMPLING PROGRAM

Site: <u>#063</u>	Date: <u>01-26-00</u>
Address: _____	
Personnel: <u>SERBATA P.</u>	Weather: <u>SUNNY and RAIN</u>
Well No: <u>MW-1</u>	Equip: <u>BAUER</u>

Before Purging: _____			
Total Well Depth (ft.)	<u>29.03</u>	Well Diameter	<u>24</u>
Depth to Water (ft)	<u>13.14</u>	Est. Purge Volume:	<u>10</u>

Sampling Data:							
Initial Turbidity:	Final Turbidity:						
Time	9:50	9:52	9:54	9:55	9:57	9:58	10:00
EC	1720	1720	1620	1640	1650	1620	1610
pH	6.03	5.95	5.91	5.87	5.87	5.74	5.71
Temp	71.3	71.5	71.7	71.9	72.0	72.3	72.5
Gal.	1	2	4	5	7	8	10
Time							
EC							
pH							
Temp							
Gal.							

After Purging/Before Sample Collection			
Depth to Water (ft.)	<u>11.87</u>	Total Well Depth(ft).	<u>29.03</u>

FIELD DATA -GROUNDWATER SAMPLING PROGRAM

Site: <u>SSA 063</u>	Date: <u>01-26-00</u>
Address: _____	
Personnel: <u>SERBON P.</u>	Weather: <u>RAIN and SUNNY</u>
Well No: <u>MW-4</u>	Equip: <u>BAUER</u>

Before Purging:			
Total Well Depth: (ft.)	<u>29.15</u>	Well Diameter	<u>2"</u>
Depth to Water (ft)	<u>12.62</u>	Est. Purge Volume:	<u>M</u>

Sampling Data:							
	Initial Turbidity:			Final Turbidity:			
Time	10:10	10:12	10:13	10:15	10:16	10:18	10:20
EC	1940	1920	1930	1910	1920	1900	1890
pH	6.08	6.03	5.93	5.87	5.83	5.83	5.81
Temp	71.1	71.3	71.6	71.7	71.9	71.8	71.4
Gal.	1	3	4	6	7	9	M
Time							
EC							
pH							
Temp							
Gal.							

After Purging/Before Sample Collection			
Depth to Water (ft.)	<u>10.82</u>	Total Well Depth(ft.)	<u>29.15</u>

FIELD DATA - GROUNDWATER SAMPLING PROGRAM

Site:	SSA-063	Date:	01-26-00
Address:			
Personnel:	ERBOUT P -	Weather:	Rain and Sunny
Well No:	MW-5	Equip:	BAUER

Before Purging:			
Total Well Depth: (ft.)	26.28	Well Diameter	4.4
Depth to Water (ft)	14.80	Est. Purge Volume:	30

Sampling Data:							
Initial Turbidity:				Final Turbidity:			
Time	9:14	9:18	9:22	9:27	9:31	9:35	9:40
EC	1180	1120	1180	1120	1110	990	970
pH	5.89	5.94	5.95	5.94	5.92	5.89	5.77
Temp	71.2	71.4	71.2	71.1	71.0	70.9	70.7
Gal.	4	8	12	17	21	25	30
Time							
EC							
pH							
Temp							
Gal.							

After Purging/Before Sample Collection			
Depth to Water (ft.)	13.63	Total Well Depth(ft.)	26.28

FIELD DATA - GROUNDWATER SAMPLING PROGRAM

Site:	SS# 063	Date:	01-26-00
Address:			
Personnel:	BFRDIX P -	Weather:	SUNNY and Rain
Well No:	MW-6	Equip:	BAILER

Before Purging:			
Total Well Depth: (ft.)	26.87	Well Diameter	4.4
Depth to Water (ft)	13.85	Est. Purge Volume:	34

Initial Turbidity:		Final Turbidity:					
Time	8:30	8:35	8:40	8:45	8:50	8:55	9:00
EC	1100	1020	1040	1030	1020	1020	1010
pH	5.86	5.93	5.96	5.93	5.92	5.92	5.94
Temp	21.3	21.1	20.9	20.7	20.9	20.9	20.1
Gal.	4	9	14	19	24	29	34
Time							
EC							
pH							
Temp							
Gal.							

After Purging/Before Sample Collection			
Depth to Water (ft.)	13.62	Total Well Depth(ft).	26.87

APPENDIX B



LABORATORY ANALYSIS RESULTS

Client: Thrifty Oil Company
Project No.: N/A
Project Name: SS #063
Sample Matrix: Water
Method: EPA 8015M (Gasoline)

AA Project No.: A135063-64
Date Received: 01/28/00
Date Reported: 02/08/00
Units: ug/L

AA I.D. No.	Client I.D. No.	Date Sampled	Date Analyzed	Results	MRL
101399	MW-6	01/26/00	02/03/00	<50	50
101400	MW-5	01/26/00	02/03/00	<50	50
101401	MW-1	01/26/00	02/03/00	13000	50
101402	MW-4	01/26/00	02/03/00	9900	50
101403	Trip Blank	01/26/00	02/03/00	<50	50

MRL: Method Reporting Limit
<: Not detected at or above the value of the concentration indicated.

George Havallas
Laboratory Director



LABORATORY ANALYSIS RESULTS

Client: Thrifty Oil Company
Project No.: N/A
Project Name: SS #063
Sample Matrix: Water
Method: EPA 8020 (BTEX)

AA Project No.: A135063-64
Date Received: 01/28/00
Date Reported: 02/08/00
Units: ug/L

Date Sampled:	01/26/00	01/26/00	01/26/00	01/26/00	
Date Analyzed:	02/03/00	02/03/00	02/03/00	02/03/00	
AA ID No.:	101399	101400	101401	101402	
Client ID No.:	MW-6	MW-5	MW-1	MW-4	MRL
Compounds:					
Benzene	<0.3	<0.3	460	350	0.3
Ethylbenzene	<0.3	<0.3	290	460	0.3
Toluene	<0.3	<0.3	54	9.0	0.3
Xylenes	0.63	<0.5	3700	460	0.5

George Havallas
Laboratory Director



LABORATORY ANALYSIS RESULTS

Client: Thrifty Oil Company
Project No.: N/A
Project Name: SS #063
Sample Matrix: Water
Method: EPA 8020 (BTEX)

AA Project No.: A135063-64
Date Received: 01/28/00
Date Reported: 02/08/00
Units: ug/L

Date Sampled:	01/26/00	
Date Analyzed:	02/03/00	
AA ID No.:	101403	
Client ID No.:	Trip Blank	MRL

<u>Compounds:</u>		
Benzene	<0.3	0.3
Ethylbenzene	<0.3	0.3
Toluene	0.58	0.3
Xylenes	<0.5	0.5

MRL: Method Reporting Limit
<: Not detected at or above the value of the concentration indicated.



George Havalias
Laboratory Director



LABORATORY ANALYSIS RESULTS

Client: Thrifty Oil Company
Project No.: N/A
Project Name: SS #063
Sample Matrix: Water
Method: MTBE (EPA 8020)

AA Project No.: A135063-64
Date Received: 01/28/00
Date Reported: 02/08/00
Units: ug/L

AA I.D. No.	Client I.D. No.	Date Sampled	Date Analyzed	Results	MRL
101399	MW-6	01/26/00	02/03/00	<5	5
101400	MW-5	01/26/00	02/03/00	<5	5
101401	MW-1	01/26/00	02/03/00	940	5
101402	MW-4	01/26/00	02/03/00	2800	5

MRL: Method Reporting Limit
<: Not detected at or above the value of the concentration indicated.

George Havalias
Laboratory Director



LABORATORY QA/QC REPORT

Client: Thrifty Oil Company
Project Name: SS #063
Method: EPA 8020 (BTEX)
Sample ID: Matrix Spike
Concentration: 20 ug/L

AA ID No.: 101400
Project No.: N/A
AA Project No.: A135063-64
Date Analyzed: 02/03/00
Date Reported: 02/08/00

Compounds	Result (ug/L)	Spike Recovery (%)	Dup. Result (ug/L)	Spike/Dup. Recovery (%)	RPD (%)	Accept. Rec. Range (%)
Benzene	21.33	107	21.41	107	0	65 - 135
Ethylbenzene	19.41	97	19.38	97	0	77 - 123
Toluene	19.08	95	19.14	96	1	66 - 134
Xylenes	19.10	96	19.07	95	1	73 - 127

George Havalias
Laboratory Director



LABORATORY QA/QC REPORT

Client: Thrifty Oil Company
Project Name: SS #063
Method: EPA 8015M (Gasoline)
Sample ID: Matrix Spike
Concentration: 500 ug/L

AA ID No.: 101400
Project No.: N/A
AA Project No.: A135063-64
Date Analyzed: 02/03/00
Date Reported: 02/08/00

Compounds	Result (ug/L)	Spike Recovery (%)	Dup. Result (ug/L)	Spike/Dup. Recovery (%)	RPD (%)	Accept.Rec. Range (%)
Gasoline Range Organics	520	104	560	112	7	59 - 149

George Havalias
Laboratory Director



AMERICAN ANALYTICS CHAIN-OF-CUSTODY RECORD

9765 ETON AVE., CHATSWORTH, CA 91311

(818) 998-5547

(818) 998-5548

1-800-533-TEST

1-800-533-8378

FAX (818) 998-7258

DATE: 01-26-00

PAGE 1 OF 1

AA Client <u>T. O. C.</u>						Phone <u>(562) 921-3581</u>		Sampler's Name <u>SEBASTIAN P.</u>		
Project Manager <u>JEFF SURYAROSUMA</u>						P.O. No.		Sampler's Signature <u>[Signature]</u>		
Project Name <u>Q.U.S.</u>						Project No.		Project Manager's Signature		
Job Name <u># 063</u>						ANALYSIS REQUIRED				
Address <u>6125 TELEGRAPH AVE</u>						Test Requirements				
Address <u>OAKLAND, CA - 94609</u>										
AA ID.#	Client's ID.	Date	Time	Sample Type	Number of Containers	Detection Limits				
						Test Name				
						<div style="display: flex; justify-content: space-around;"> TPH BTEX MTBE 1,1,2,2-TET </div>				
<u>101399</u>	<u>MW-6</u>	<u>01-26-00</u>	<u>13:00</u>	<u>WATER</u>	<u>3</u>	X	X	X	X	
<u>101400</u>	<u>MW-5</u>	↑	<u>13:10</u>	↑	<u>3</u>	X	X	X	X	
<u>101401</u>	<u>MW-1</u>	↑	<u>13:20</u>	↑	<u>3</u>	X	X	X	X	
<u>101402</u>	<u>MW-4</u>	↓	<u>13:25</u>	↓	<u>3</u>	X	X	X	X	
<u>101403</u>	<u>TRIP BLANK</u>	↓	<u>1:30</u>	↓	<u>2</u>	X	X			
} Add 3 dumps 1X HCL										
SAMPLE INTEGRITY-TO BE FILLED IN BY RECEIVING LAB						Relinquished by: <u>[Signature]</u>		Date: <u>01-26-00</u>	Time: <u>17:00</u>	Received by: <u>CA. OVERNIGHT</u>
Samples Intact Yes <input checked="" type="checkbox"/> No <input type="checkbox"/>						Relinquished by: <u>CA. OVERNIGHT</u>		Date: <u>01-26-00</u>	Time: <u>11:30</u>	Received by: _____
Samples Properly Cooled Yes <input checked="" type="checkbox"/> No <input type="checkbox"/>						Relinquished by: _____		Date: <u>1-28-00</u>	Time: <u>9 AM</u>	Received by: <u>[Signature]</u>
Samples Accepted Yes <input checked="" type="checkbox"/> No <input type="checkbox"/>						Relinquished by: _____		Date: _____	Time: _____	Received by: _____
If Not Why: _____						Relinquished by: _____		Date: _____	Time: _____	Received by: _____
AA Project No. <u>A135063-64</u>						Relinquished by: _____		Date: _____	Time: _____	Received by: _____

APPENDIX C

THRIFTY OIL CO. SERVICE STATION #63
6125 TELEGRAPH AVENUE, OAKLAND, CALIFORNIA
GROUNDWATER EXTRACTION/TREATMENT SYSTEM INSPECTION FORM

NAME OF INSPECTOR: SERBOVA P

DATE OF INSPECTION: 03-29-00

OBSERVATIONS AND
COMMENTS: CHECK OIL, BELT, HOSES, CLEAN
WATER BAG FILTER

FLOW METER READING: 54897

SAMPLES OBTAINED: N/A

PRESSURE GAUGE READING UP STREAM OF THE BAG FILTER: 13

PRESSURE GAUGE READING DOWN STREAM OF THE CARTRIDGE FILTER: 11

PRESSURE GAUGE READING DOWN STREAM OF THE PRIMARY GAC UNIT: 1.1

PRESSURE GAUGE READING DOWN STREAM OF THE SECONDARY GAC UNIT: 1.0

PRESSURE GAUGE READING DOWN STREAM OF THE THIRD GAC UNIT: 07

INSPECTOR'S SIGNATURE: Serbova P

THRIFTY OIL CO. SERVICE STATION #63
6125 TELEGRAPH AVENUE, OAKLAND, CALIFORNIA
GROUNDWATER EXTRACTION/TREATMENT SYSTEM INSPECTION FORM

NAME OF INSPECTOR: SEBOW P.

DATE OF INSPECTION: 03-24-00

OBSERVATIONS AND
COMMENTS: Check oil, hoses, replace cartridge
water filter, clean water bag filter

FLOW METER READING: 54603

SAMPLES OBTAINED: N/A

PRESSURE GAUGE READING UP STREAM OF THE BAG FILTER: 13

PRESSURE GAUGE READING DOWN STREAM OF THE CARTRIDGE FILTER: 11

PRESSURE GAUGE READING DOWN STREAM OF THE PRIMARY GAC UNIT: 1.2

PRESSURE GAUGE READING DOWN STREAM OF THE SECONDARY GAC UNIT: 1.1

PRESSURE GAUGE READING DOWN STREAM OF THE THIRD GAC UNIT: 0.9

INSPECTOR'S SIGNATURE: Sebow

063

THRIFTY OIL CO. SERVICE STATION #63
6125 TELEGRAPH AVENUE, OAKLAND, CALIFORNIA
GROUNDWATER EXTRACTION/TREATMENT SYSTEM INSPECTION FORM

NAME OF INSPECTOR: SERBAH P-

DATE OF INSPECTION: 03-17-00

OBSERVATIONS AND COMMENTS: Add oil, check belt, hoses connection
clean water bag, replace cartridge water filter

FLOW METER READING: 53978

SAMPLES OBTAINED: N/A

PRESSURE GAUGE READING UP STREAM OF THE BAG FILTER: 13

PRESSURE GAUGE READING DOWN STREAM OF THE CARTRIDGE FILTER: 11

PRESSURE GAUGE READING DOWN STREAM OF THE PRIMARY GAC UNIT: 1.2

PRESSURE GAUGE READING DOWN STREAM OF THE SECONDARY GAC UNIT: 1.1

PRESSURE GAUGE READING DOWN STREAM OF THE THIRD GAC UNIT: 0.9

INSPECTOR'S SIGNATURE: [Signature]

THRIFTY OIL CO. SERVICE STATION #63
6125 TELEGRAPH AVENUE, OAKLAND, CALIFORNIA
GROUNDWATER EXTRACTION/TREATMENT SYSTEM INSPECTION FORM

NAME OF INSPECTOR: SERAFIN P

DATE OF INSPECTION: 02-11-00

OBSERVATIONS AND COMMENTS: check oil, belt, replace cartridge water filter

FLOW METER READING: 51068

SAMPLES OBTAINED: N/A

PRESSURE GAUGE READING UP STREAM OF THE BAG FILTER: 12

PRESSURE GAUGE READING DOWN STREAM OF THE CARTRIDGE FILTER: 8

PRESSURE GAUGE READING DOWN STREAM OF THE PRIMARY GAC UNIT: 1.2

PRESSURE GAUGE READING DOWN STREAM OF THE SECONDARY GAC UNIT: 0.8

PRESSURE GAUGE READING DOWN STREAM OF THE THIRD GAC UNIT: 0.9

INSPECTOR'S SIGNATURE: [Signature]

063

THRIFTY OIL CO. SERVICE STATION #63
6125 TELEGRAPH AVENUE, OAKLAND, CALIFORNIA
GROUNDWATER EXTRACTION/TREATMENT SYSTEM INSPECTION FORM

NAME OF INSPECTOR: SERBATA P.

DATE OF INSPECTION: 02-04-00

OBSERVATIONS AND
COMMENTS: clean water filter, replace water cartridge
check oil, belt

FLOW METER READING: 50833

SAMPLES OBTAINED: N/A

PRESSURE GAUGE READING UP STREAM OF THE BAG FILTER: 12

PRESSURE GAUGE READING DOWN STREAM OF THE CARTRIDGE FILTER: 8

PRESSURE GAUGE READING DOWN STREAM OF THE PRIMARY GAC UNIT: 1

PRESSURE GAUGE READING DOWN STREAM OF THE SECONDARY GAC UNIT: 0.8

PRESSURE GAUGE READING DOWN STREAM OF THE THIRD GAC UNIT: 0.9

INSPECTOR'S SIGNATURE: 

THRIFTY OIL CO. SERVICE STATION #63
6125 TELEGRAPH AVENUE, OAKLAND, CALIFORNIA
GROUNDWATER EXTRACTION/TREATMENT SYSTEM INSPECTION FORM

NAME OF INSPECTOR: SERBAN P.

DATE OF INSPECTION: 01-26-00

OBSERVATIONS AND
COMMENTS: Add oil, change water filter,

FLOW METER READING: 50569

SAMPLES OBTAINED: yes

PRESSURE GAUGE READING UP STREAM OF THE BAG FILTER: 13

PRESSURE GAUGE READING DOWN STREAM OF THE CARTRIDGE FILTER: 11

PRESSURE GAUGE READING DOWN STREAM OF THE PRIMARY GAC UNIT: 1.3

PRESSURE GAUGE READING DOWN STREAM OF THE SECONDARY GAC UNIT: 1.1

PRESSURE GAUGE READING DOWN STREAM OF THE THIRD GAC UNIT: 0.9

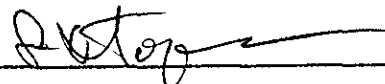
INSPECTOR'S SIGNATURE: 

THRIFTY OIL CO. SERVICE STATION #63
6125 TELEGRAPH AVENUE, OAKLAND, CALIFORNIA
GROUNDWATER EXTRACTION/TREATMENT SYSTEM INSPECTION FORM

NAME OF INSPECTOR: 3ERBOK P.

DATE OF INSPECTION: 01-21-00

OBSERVATIONS AND COMMENTS: check oil, replace water filter
cartridge, change water filter.

FLOW METER READING: 50328

SAMPLES OBTAINED: N/A

PRESSURE GAUGE READING UP STREAM OF THE BAG FILTER: 13

PRESSURE GAUGE READING DOWN STREAM OF THE CARTRIDGE FILTER: 11

PRESSURE GAUGE READING DOWN STREAM OF THE PRIMARY GAC UNIT: 1.3

PRESSURE GAUGE READING DOWN STREAM OF THE SECONDARY GAC UNIT: 1.1

PRESSURE GAUGE READING DOWN STREAM OF THE THIRD GAC UNIT: 0.9

INSPECTOR'S SIGNATURE: [Signature]

THRIFTY OIL CO. SERVICE STATION #63
6125 TELEGRAPH AVENUE, OAKLAND, CALIFORNIA
GROUNDWATER EXTRACTION/TREATMENT SYSTEM INSPECTION FORM

NAME OF INSPECTOR: SERBAN P.

DATE OF INSPECTION: 01-14-00

OBSERVATIONS AND
COMMENTS: Add oil, clean water filter, replace
cartridge water filter

FLOW METER READING: 50.097

SAMPLES OBTAINED: N/A

PRESSURE GAUGE READING UP STREAM OF THE BAG FILTER: 13

PRESSURE GAUGE READING DOWN STREAM OF THE CARTRIDGE FILTER: 11

PRESSURE GAUGE READING DOWN STREAM OF THE PRIMARY GAC UNIT: 1.3

PRESSURE GAUGE READING DOWN STREAM OF THE SECONDARY GAC UNIT: 1.1

PRESSURE GAUGE READING DOWN STREAM OF THE THIRD GAC UNIT: 0.8

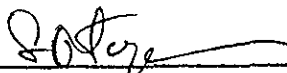
INSPECTOR'S SIGNATURE: 

THRIFTY OIL CO. SERVICE STATION #63
6125 TELEGRAPH AVENUE, OAKLAND, CALIFORNIA
GROUNDWATER EXTRACTION/TREATMENT SYSTEM INSPECTION FORM

NAME OF INSPECTOR: SEBASTIAN P.

DATE OF INSPECTION: 01-07-00

OBSERVATIONS AND COMMENTS: check oil, belt, clean water filter

FLOW METER READING: 49811

SAMPLES OBTAINED: N/A

PRESSURE GAUGE READING UP STREAM OF THE BAG FILTER: 13

PRESSURE GAUGE READING DOWN STREAM OF THE CARTRIDGE FILTER: 11

PRESSURE GAUGE READING DOWN STREAM OF THE PRIMARY GAC UNIT: 1.3

PRESSURE GAUGE READING DOWN STREAM OF THE SECONDARY GAC UNIT: 1.1

PRESSURE GAUGE READING DOWN STREAM OF THE THIRD GAC UNIT: 0.9

INSPECTOR'S SIGNATURE: SPD

APPENDIX D



LABORATORY ANALYSIS RESULTS

Client: Thrifty Oil Company
Project No.: N/A
Project Name: SS #063 ✓
Sample Matrix: Water
Method: EPA 8015M (Gasoline)

AA Project No.: A135063-63 ✓
Date Received: 01/28/00
Date Reported: 02/03/00
Units: ug/L

AA I.D. No.	Client I.D. No.	Date Sampled	Date Analyzed	Results	MRL
101396	Effluent	01/26/00	02/01/00	<50	50
101397	Intermed	01/26/00	02/01/00	<50	50
101398	Influent	01/26/00	02/01/00	<50	50

MRL: Method Reporting Limit
<: Not detected at or above the value of the concentration indicated.

George Havalias
Laboratory Director



LABORATORY ANALYSIS RESULTS

Client: Thrifty Oil Company
Project No.: N/A
Project Name: SS #063
Sample Matrix: Water
Method: EPA 8020 (BTEX)

AA Project No.: A135063-63
Date Received: 01/28/00
Date Reported: 02/03/00
Units: ug/L

Date Sampled:	01/26/00	01/26/00	01/26/00	
Date Analyzed:	02/01/00	02/01/00	02/01/00	
AA ID No.:	101396	101397	101398	
Client ID No.:	Effluent	Intermed	Influent	MRL
<u>Compounds:</u>				
Benzene	<0.3	<0.3	<0.3	0.3
Ethylbenzene	<0.3	<0.3	<0.3	0.3
Toluene	<0.3	<0.3	<0.3	0.3
Xylenes	<0.5	<0.5	<0.5	0.5

MRL: Method Reporting Limit

<: Not detected at or above the value of the concentration indicated.

George Havalias
Laboratory Director



LABORATORY QA/QC REPORT

Client: Thrifty Oil Company
Project Name: SS #063
Method: EPA 8020 (BTEX)
Sample ID: Matrix Spike
Concentration: 20 ug/L

AA ID No.: 101396
Project No.: N/A
AA Project No.: A135063-63
Date Analyzed: 02/01/00
Date Reported: 02/03/00

Compounds	Result (ug/L)	Spike Recovery (%)	Dup. Result (ug/L)	Spike/Dup. Recovery (%)	RPD (%)	Accept. Rec. Range (%)
Benzene	22.56	113	21.39	107	5	65 - 135
Ethylbenzene	20.42	102	20.46	102	0	77 - 123
Toluene	20.64	103	20.78	104	1	66 - 134
Xylenes	20.21	101	20.38	102	1	73 - 127

George Havalias
Laboratory Director



LABORATORY QA/QC REPORT

Client: Thrifty Oil Company
Project Name: SS #063
Method: EPA 8015M (Gasoline)
Sample ID: Matrix Spike
Concentration: 500 ug/L

AA ID No.: 101396
Project No.: N/A
AA Project No.: A135063-63
Date Analyzed: 02/01/00
Date Reported: 02/03/00

Compounds	Result (ug/L)	Spike Recovery (%)	Dup. Result (ug/L)	Spike/Dup. Recovery (%)	RPD (%)	Accept.Rec. Range (%)
Gasoline Range Organics	480	96	470	94	2	59 - 149

George Havalias
Laboratory Director



AMERICAN ANALYTICS CHAIN-OF-CUSTODY RECORD

9765 ETON AVE., CHATSWORTH, CA 91311

(818) 998-5547

(818) 998-5548

1-800-533-TEST

1-800-533-8378

FAX (818) 998-7258

DATE: _____

PAGE _____ OF _____

AA Client: T.O.C.						Phone		Sampler's Name																	
Project Manager: JEFF SURYARUSUMA						P.O. No.		Sampler's Signature																	
Project Name: System Sampling						Project No.		Project Manager's Signature																	
Job Name and Address: 6125 TELEGRAPH AVE. ORLANDO FL 32609						ANALYSIS REQUIRED				Test Requirements															
						Detection Limits		Test Name			<table border="1" style="width:100%; height: 100px;"> <tr><td style="width: 50px;">TPH</td><td style="width: 50px;">BTEX</td><td></td><td></td><td></td><td></td><td></td><td></td><td></td><td></td></tr> <tr><td></td><td></td><td></td><td></td><td></td><td></td><td></td><td></td><td></td><td></td></tr> </table>		TPH	BTEX											
TPH	BTEX																								
AA ID.#	Client's ID.	Date	Time	Sample Type	Number of Containers																				
101396	EFFLUENT	01.26.00	11:00	WATER	2	X	X			} Add 3 droops K1HCL															
101397	INTERMED	01.26.00	11:10	WATER	2	X	X																		
101398	INFLUENT	01.26.00	11:20	WATER	2	X	X																		
SAMPLE INTEGRITY TO BE FILLED IN BY RECEIVING LAB						Relinquished by: <i>[Signature]</i>		Date: 01.26.00	Time: 17:00	Received by: CH. OVERNIGHT															
Samples Intact Yes <input checked="" type="checkbox"/> No <input type="checkbox"/>						Relinquished by: CH. OVERNIGHT		Date: 01.26.00	Time: 17:30	Received by: _____															
Samples Properly Cooled Yes <input checked="" type="checkbox"/> No <input type="checkbox"/>						Relinquished by: _____		Date: 1-28-00	Time: 9AM	Received by: <i>[Signature]</i>															
Samples Accepted Yes <input checked="" type="checkbox"/> No <input type="checkbox"/>						Relinquished by: _____		Date: _____	Time: _____	Received by: _____															
If Not Why: _____						Relinquished by: _____		Date: _____	Time: _____	Received by: _____															
AA Project No. A135063-63						Relinquished by: _____		Date: _____	Time: _____	Received by: _____															