

THRIFTY OIL CO.

Ro 4

O.41761

December 29, 2003

Mr. Barney Chan
Alameda County Health Care Services
Department of Environmental Health
1131 Harbor Bay Parkway, 2nd Floor
Alameda, CA 94502

Local #4057
RWQCB #01-1478
Global ID #T0600101365
Confirmation #7352549195

RE: **Former Thrifty Oil Co. Station #049**
3400 San Pablo Avenue
Oakland, CA 94612
4th Quarter 2003, Status Report

Alameda County
DEC 31 2003
Environmental Health

Dear Mr. Chan:

Presented herein is the 4th Quarter 2003, Status Report prepared for former Thrifty Oil Co. (Thrifty) Station #049 located at 3400 San Pablo Avenue, Oakland, California (**Figure 1**). This report presents the results of the site monitoring and remedial activities conducted during the fourth quarter of 2003. Thrifty has retained the services of Earth Management Company (EMC) to conduct quarterly monitoring and sampling, and remediation system monitoring activities at this site.

Groundwater Monitoring

Depth to groundwater is measured in each monitoring well on a quarterly basis. In general, groundwater occurs beneath the station at depths ranging from 4.56 feet below top of casing (btc) in monitoring well MW-4 to 5.61 feet btc in monitoring well MW-3 (**Appendix A**). A groundwater elevation contour map based on the October 10, 2003, monitoring data is presented in **Figure 2**. Groundwater elevation data indicates that groundwater flow to the southwest under at an approximate gradient ranging from 0.0214 to 0.0375 feet/foot.

Quarterly Groundwater Sampling

As part of the ongoing groundwater-monitoring program, EMC obtained groundwater samples from monitoring wells MW-1 through MW-7 on October 10, 2003. Groundwater samples were delivered by EMC in a chilled state following strict Chain-of-Custody procedures to a state-certified laboratory and analyzed for total petroleum hydrocarbons as gasoline (TPHg) by EPA Method 8015M. Volatile organic compounds of benzene, toluene, ethylbenzene, xylenes (BTEX), methyl tert butyl ether (MTBE), and other oxygenates were analyzed by EPA Method 8260B. A summary of historical analytical sampling results for TPHg, BTEX, and MTBE is provided in **Table 1** and other oxygenates data is provided on **Table 2**. Copies of the EMC Field Data Groundwater Sampling Forms are provided in **Appendix A**, and copies of the laboratory analytical reports are contained in **Appendix B**.

TPHg, benzene, and MTBE isoconcentration maps in micrograms per liter (ug/L) were prepared using data from the October 10, 2003, sampling event and are presented in **Figures 3, 4, and 5**, respectively. Laboratory results indicate the highest concentration of TPHg was detected in well MW-3 (13,700 ug/L). The highest benzene concentration was detected in well MW-4 (672 ug/L) and the highest MTBE concentration was detected in well MW-2 (5,980 ug/L).



Mr. Barney Chan
Thrifty #049
4th Quarter 2003
Page 2

TPHg, benzene, and MTBE concentrations all increased significantly in well MW-3 during the current reporting period when compared to data over the past four years. The last reporting period that the TPHg and MTBE concentrations were elevated to near the current concentrations was in the 3rd Quarter 1999 (July 1999), as shown on **Table 1**. According to Associated Laboratories, the "spike" in TPHg concentration is actually the result of a large infusion of MTBE that is interfering with and falsely elevating the TPHg concentration. Although the exact reason for the increase in MTBE is not certain, it is possible that a recent release (post 1999) has occurred in the area of well MW-3, possibly from the adjacent pump island. It is also possible that cross contamination or laboratory error could have contributed to the anomalous MTBE concentration in well MW-3. To clarify this, Thrifty will resample well MW-3 in January 2004 and will report the results to the Alameda County Health Care Agency (ACHCA) as soon as they are available.

Remediation Status

Site remedial activities were initiated in April 1991. The remediation system consists of a Groundwater Treatment System using activated carbon, with groundwater extraction from recovery well RW-1. System operational data is included in **Table 3** and in **Appendix C**. On February 14, 2003, the groundwater system was shut down initially for carbon replacement, and on April 4, 2003, the system was left off for system upgrade activities. As of April 4, 2003, the system has treated approximately 1,445,088 gallons of groundwater since start up (April 1991).

Other Activities

As requested by the ACHCA, Thrifty submitted a *Production Well and Utility Conduit Survey* dated October 9, 2003, prepared by Advanced GeoEnvironmental, Inc. (AGE). In addition, Thrifty has selected AGE to conduct remedial system upgrade activities including installation of a new treatment compound, installation of new piping, and the operation and maintenance of a groundwater pump and treat system. AGE will also complete onsite well abandonment and replacement well installation activities, and the completion of three (3) offsite borings and offsite well MW-8. AGE has indicated that the three offsite borings and offsite well MW-8 should be completed by January 6, 2004, and well abandonment and replacement well activities should be completed by January 14, 2004, depending on the final acquisition of the proper permits.

The existing treatment compound has been removed from the site; the installation of the replacement compound and trenching activities are scheduled for January 19 through 23, 2004. Thrifty will notify the ACHCA of any significant changes to the above-listed schedule and will continue to keep the ACHCA updated of future system upgrade activities.

The groundwater monitoring wells will be monitored and sampled during the next quarter. All site monitoring/sampling data generated during the next quarter will be reported in the First Quarter 2004 monitoring report.

Mr. Barney Chan
Thrifty #049
4th Quarter 2003
Page 3

All interpretations expressed in this report are based solely upon data collected by EMC and laboratory analyses conducted by Associated Laboratories.

Sincerely,

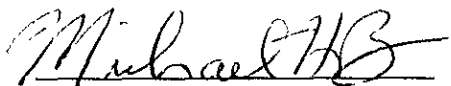

Michael H. Bowery, R. G.
Project Manager

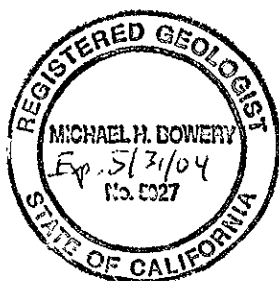

Chris Panaitescu
General Manager
Environmental Affairs

cc: BP West Coast Products LLP; Ms. Kateri Luka
File

TABLES

TABLE 1
GROUNDWATER DATA
THRIFTY OIL STATION #049, OAKLAND, CA.

DATE SAMPLED	ANALYTICAL PARAMETERS						DEPTH TO GROUNDWATER (feet)	DEPTH TO PRODUCT (feet)	PRODUCT THICKNESS (feet)	CASING ELEVATION (feet)	GROUNDWATER ELEVATION (feet)
	TPH (ug/L)	BENZENE (ug/L)	TOLUENE (ug/L)	EthylBenzene (ug/L)	XYLENE (ug/L)	MTBE (ug/L)					
MONITORING WELL #MW-1											
<i>Screen Interval = 5 to 25 feet</i>											
01/09/92	-	-	-	-	-	-	5.54	NP	0.00	98.03	92.49
04/13/92	-	-	-	-	-	-	5.86	NP	0.00	98.03	92.17
10/05/92	-	-	-	-	-	-	9.39	NP	0.00	98.03	88.64
01/06/93	-	-	-	-	-	-	4.76	NP	0.00	98.03	93.27
04/26/93	-	-	-	-	-	-	4.96	NP	0.00	98.03	93.07
01/04/94	-	-	-	-	-	-	7.00	NP	0.00	98.03	91.03
04/05/94	-	-	-	-	-	-	6.44	NP	0.00	98.03	91.59
10/09/95	44,000	4,500	4,300	1,700	10,000	-	-	-	-	98.03	-
01/08/96	21,000	1,200	150	34	4,800	-	6.15	NP	0.00	98.03	91.88
04/08/96	4,700	80	110	10	910	-	5.40	NP	0.00	98.03	92.63
07/22/96	7,000	280	130	<3	2,100	440	5.50	NP	0.00	98.03	92.53
10/16/96	120	<0.3	<0.3	<0.3	<0.5	180	6.02	NP	0.00	98.03	92.01
01/22/97	160	<0.3	<0.3	<0.3	<0.5	360	4.40	NP	0.00	98.03	93.63
04/21/97	20,000	420	140	5.8	840	55,000	6.30	NP	0.00	98.03	91.73
07/14/97	13,000	<0.3	<0.3	<0.3	<0.55	30,000	5.92	NP	0.00	98.03	92.11
10/07/97	-	-	-	-	-	-	7.71	7.70	0.01	98.03	90.33
01/15/98	<50	0.3	<0.3	<0.3	<0.5	-	4.40	NP	0.00	98.03	93.63
04/23/98	540	<0.3	<0.3	<0.3	<0.5	<20	8.10	NP	0.00	98.03	89.93
07/20/98	<50	<0.3	<0.3	<0.3	<0.5	<5	5.55	NP	0.00	98.03	92.48
10/14/98	50	1.4	0.56	<0.3	11	22	7.05	NP	0.00	98.03	90.98
01/21/99	<50	0.59	<0.3	<0.3	<0.5	<5	4.10	NP	0.00	98.03	93.93
04/15/99	<50	<0.3	<0.3	<0.3	<0.5	<5	4.30	NP	0.00	98.03	93.73
07/26/99	<50	<0.3	<0.3	<0.3	<0.5	<5	5.54	NP	0.00	98.03	92.49
10/13/99	<50	<0.3	<0.3	<0.3	<0.5	<5	6.13	NP	0.00	98.03	91.90
01/20/00	<50	<0.3	<0.3	<0.3	<0.5	<5	6.04	NP	0.00	98.03	91.99
04/05/00	<50	<0.25	<0.25	<0.25	<0.5	<5	4.03	NP	0.00	98.03	94.00
07/19/00	<50	<0.3	<0.3	<0.3	<0.6	<5	4.00	NP	0.00	98.03	94.03
10/18/00	<50	<0.18	<0.14	<0.18	<0.26	<0.24	5.53	NP	0.00	98.03	92.50
01/17/01	<50	<0.18	<0.14	<0.18	<0.26	<0.24	3.97	NP	0.00	98.03	94.06
04/19/01	<50	<0.18	<0.14	<0.18	<0.26	<0.24	3.98	NP	0.00	98.03	94.05
07/18/01	<50	<0.18	<0.14	<0.18	<0.26	<0.24	5.51	NP	0.00	98.03	92.52
10/10/01	<50	<0.18	<0.14	<0.18	<0.26	<0.24	3.97	NP	0.00	98.03	94.06
01/30/02	<50	<0.18	<0.14	<0.18	<0.26	<0.24	3.95	NP	0.00	98.03	94.08
04/17/02	<50	<0.18	<0.14	<0.18	<0.26	<0.24	2.42	NP	0.00	98.03	95.61
07/31/02	<50	<0.18	1.3	<0.18	<0.26	<0.24	5.49	NP	0.00	98.03	92.54

**TABLE 1
GROUNDWATER DATA
THRIFTY OIL STATION #049, OAKLAND, CA.**

DATE SAMPLED	ANALYTICAL PARAMETERS						DEPTH TO GROUNDWATER (feet)	DEPTH TO PRODUCT (feet)	PRODUCT THICKNESS (feet)	CASING ELEVATION (feet)	GROUNDWATER ELEVATION (feet)
	TPH (ug/L)	BENZENE (ug/L)	TOLUENE (ug/L)	EthylBenzene (ug/L)	XYLENE (ug/L)	MTBE (ug/L)					
11/14/02	<50	<0.08	<0.18	<0.17	<0.4	16	6.13	NP	0.00	98.03	91.90
01/29/03	<15	<0.04	<0.02	<0.02	<0.06	<0.03	2.45	NP	0.00	98.03	95.58
04/23/03	<15	<0.04	<0.02	<0.02	<0.06	<0.03	7.02	NP	0.00	98.03	91.01
07/10/03	<15	<0.22	<0.32	<0.31	<0.4	<0.18	5.15	NP	0.00	98.03	92.88
10/20/03	<15	<0.04	<0.02	<0.02	<0.06	<0.03	5.13	NP	0.00	98.03	92.90
MONITORING WELL #MW-2 Screen Interval = 5 to 25 feet											
01/09/92	-	-	-	-	-	-	5.35	NP	0.00	97.44	92.09
04/13/92	-	-	-	-	-	-	7.42	NP	0.00	97.44	90.02
10/05/92	-	-	-	-	-	-	12.15	NP	0.00	97.44	85.29
01/06/93	-	-	-	-	-	-	5.46	NP	0.00	97.44	91.98
04/26/93	-	-	-	-	-	-	5.15	NP	0.00	97.44	92.29
01/04/94	-	-	-	-	-	-	9.45	NP	0.00	97.44	87.99
04/05/94	-	-	-	-	-	-	8.23	NP	0.00	97.44	89.21
10/09/95	33,000	6,000	390	1,700	4,900	-	-	-	-	97.44	-
01/08/96	<50	0.32	<0.3	0.41	2.1	-	5.60	NP	0.00	97.44	91.84
04/08/96	10,000	490	210	210	830	-	5.43	NP	0.00	97.44	92.01
07/22/96	60,000	6,500	1,000	1,500	10,000	8,500	5.65	NP	0.00	97.44	91.79
10/16/96	6,500	12	0.34	0.72	110	4,700	5.82	NP	0.00	97.44	91.62
01/22/97	3,200	<0.3	0.46	0.37	<0.5	8,000	4.30	NP	0.00	97.44	93.14
04/21/97	66,000	5,300	1,000	2,300	14,000	30,000	5.80	NP	0.00	97.44	91.64
07/14/97	17,000	1.8	4.6	4.6	350	24,000	8.92	NP	0.00	97.44	88.52
10/07/97	220,000	5,200	1,700	3,800	15,000	-	6.80	NP	0.00	97.44	90.64
01/19/98	25,000	5.4	2.2	2.1	240	-	8.50	NP	0.00	97.44	88.94
04/23/98	7,700	<0.3	0.55	0.38	4.9	28,000	7.60	NP	0.00	97.44	89.84
07/20/98	430,000	4,200	10,000	5,400	28,000	77,000	6.94	NP	0.00	97.44	90.50
10/14/98	27,000	<0.3	4.5	4.1	4.6	65,000	8.45	NP	0.00	97.44	88.99
01/21/99	16,000	7.6	9.8	4.2	310	* 49,000 / 42,000	6.95	NP	0.00	97.44	90.49
04/15/99	20,000	<0.3	<0.3	<0.3	<0.5	* 31,000 / 30,000	8.45	NP	0.00	97.44	88.99
07/26/99	6,700	<6	<6	<6	<10	* 11,000 / 15,000	6.94	NP	0.00	97.44	90.50
10/13/99	7,600	<3	3.7	<3	11	11,000	5.48	NP	0.00	97.44	91.96
01/20/00	7,500	<6	<6	<6	<10	* 14,000 / 16,000	5.84	NP	0.00	97.44	91.60
04/05/00	10,400	<0.25	<0.25	<0.25	<0.5	* 10,000 / 14,400	5.41	NP	0.00	97.44	92.03
07/19/00	130	<0.3	<0.3	<0.3	<0.6	* 9,620 / 6,520	5.40	NP	0.00	97.44	92.04
10/18/00	150	<0.18	<0.14	<0.18	<0.26	* 9,090 / 6,560	6.91	NP	0.00	97.44	90.53

**TABLE 1
GROUNDWATER DATA
THRIFTY OIL STATION #049, OAKLAND, CA.**

DATE SAMPLED	ANALYTICAL PARAMETERS						DEPTH TO GROUNDWATER (feet)	DEPTH TO PRODUCT (feet)	PRODUCT THICKNESS (feet)	CASING ELEVATION (feet)	GROUNDWATER ELEVATION (feet)
	TPH (ug/L)	BENZENE (ug/L)	TOLUENE (ug/L)	EthylBenzene (ug/L)	XYLENE (ug/L)	MIBE (ug/L)					
01/17/01	75	<0.18	2.0	2.0	3.0	*8,650 / 9,710	5.41	NP	0.00	97.44	92.03
04/19/01	4,380	<0.18	<0.14	<0.18	<0.26	8,890	5.40	NP	0.00	97.44	92.04
07/18/01	3,260	<0.18	<0.14	<0.18	2.0	*7960 / 1,710	6.92	NP	0.00	97.44	90.52
10/10/01	1,760	<0.18	<0.14	<0.18	<0.26	*2,980 / 2,600	3.87	NP	0.00	97.44	93.57
01/30/02	1,770	<0.18	1.0	1.0	2.0	*2,560 / 1,590	8.45	NP	0.00	97.44	88.99
04/17/02	1,470	1.0	<0.14	<0.18	<0.26	*2,460 / 2,080	8.45	NP	0.00	97.44	88.99
07/31/02	3,910	<0.18	1.2	<0.18	2.1	*2,090 / 1,740	9.98	NP	0.00	97.44	87.46
11/14/02	39,400	1,680	728	173	5,120	8,270	5.40	NP	0.00	97.44	92.04
01/29/03	22,100	746	76	<1.0	2,840	8,220	8.43	NP	0.00	97.44	89.01
04/23/03	19,500	<0.8	<0.4	<0.4	<1.2	9,580	5.38	NP	0.00	97.44	92.06
07/10/03	29,900	<2.2	<3.2	<3.1	<4.0	6,690	5.10	NP	0.00	97.44	92.34
10/20/03	13,000	4.79	<0.02	<0.02	<0.06	*6,330 / 5,980	5.10	NP	0.00	97.44	92.34
MONITORING WELL #MW-3											
<i>Screen Interval = 5 to 25 feet</i>											
01/09/92	-	-	-	-	-	-	17.60	NP	0.00	97.69	80.09
04/13/92	-	-	-	-	-	-	17.40	NP	0.00	97.69	80.29
10/05/92	-	-	-	-	-	-	17.35	NP	0.00	97.69	80.34
01/06/93	-	-	-	-	-	-	17.40	NP	0.00	97.69	80.29
04/26/93	-	-	-	-	-	-	17.90	NP	0.00	97.69	79.79
01/04/94	-	-	-	-	-	-	17.60	NP	0.00	97.69	80.09
04/05/94	-	-	-	-	-	-	16.25	NP	0.00	97.69	81.44
01/08/96	-	-	-	-	-	-	7.11	NP	0.00	97.69	90.58
04/08/96	8,800	610	31	530	900	-	7.20	NP	0.00	97.69	90.49
07/22/96	38,000	4,100	1,500	1,600	5,400	2,600	6.82	NP	0.00	97.69	90.87
10/16/96	2,400	<0.3	<0.3	<0.3	<0.5	3,800	6.84	NP	0.00	97.69	90.85
01/22/97	2,200	<0.3	<0.3	<0.3	<0.5	5,500	4.80	NP	0.00	97.69	92.89
04/21/97	15,000	1,500	36	260	710	11,000	9.40	NP	0.00	97.69	88.29
07/14/97	5,400	0.45	<0.3	<0.3	<0.5	14,000	10.92	NP	0.00	97.69	86.77
10/07/97	8,800	0.39	<0.3	<0.3	0.88	-	11.95	NP	0.00	97.69	85.74
01/19/98	22,000	1,300	15	20	310	-	7.85	NP	0.00	97.69	89.84
04/23/98	9,200	3.9	3.1	5.7	9.8	16,000	11.20	NP	0.00	97.69	86.49
07/20/98	750	0.41	1.4	0.47	1.8	2,800	7.36	NP	0.00	97.69	90.33
10/14/98	750	<0.3	<0.3	<0.3	<0.5	15,000	11.95	NP	0.00	97.69	85.74
01/21/99	4,700	0.32	<0.3	<0.3	<0.5	*12,000 / 16,000	10.45	NP	0.00	97.69	87.24
04/15/99	7,900	0.59	0.69	<0.3	0.94	*11,000 / 14,000	7.86	NP	0.00	97.69	89.83

**TABLE 1
GROUNDWATER DATA
THRIFTY OIL STATION #049, OAKLAND, CA.**

DATE SAMPLED	ANALYTICAL PARAMETERS						DEPTH TO GROUNDWATER (feet)	DEPTH TO PRODUCT (feet)	PRODUCT THICKNESS (feet)	CASING ELEVATION (feet)	GROUNDWATER ELEVATION (feet)
	TPH (ug/L)	BENZENE (ug/L)	TOLUENE (ug/L)	EthylBenzene (ug/L)	XYLENE (ug/L)	MTBE (ug/L)					
07/26/99	5,200	<3	<3	<3	<5	*9,600 / 11,000	10.40	NP	0.00	97.69	87.29
10/13/99	<50	<0.3	<0.3	<0.3	<0.5	<5	7.09	NP	0.00	97.69	90.60
01/20/00	<50	<0.3	<0.3	<0.3	<0.5	<5	6.86	NP	0.00	97.69	90.83
04/05/00	<50	0.8	<0.25	<0.25	<0.5	*5.6 / <5	8.85	NP	0.00	97.69	88.84
07/19/00	<50	<0.3	<0.3	<0.3	<0.6	<5	8.86	NP	0.00	97.69	88.83
10/18/00	<50	<0.18	<0.14	<0.18	<0.26	<0.24	7.32	NP	0.00	97.69	90.37
01/17/01	<50	<0.18	2.0	<0.18	1.0	*39 / 39	5.40	NP	0.00	97.69	92.29
04/19/01	<50	<0.18	<0.14	<0.18	<0.26	<0.24	8.87	NP	0.00	97.69	88.82
07/18/01	<50	<0.18	<0.14	<0.18	<0.26	<0.24	7.32	NP	0.00	97.69	90.37
10/10/01	<50	<0.18	<0.14	<0.18	<0.26	<0.24	8.87	NP	0.00	97.69	88.82
01/30/02	<50	<0.18	<0.14	<0.18	<0.26	<0.24	5.78	NP	0.00	97.69	91.91
04/17/02	<50	<0.18	<0.14	<0.18	<0.26	<0.24	7.31	NP	0.00	97.69	90.38
07/31/02	138	1.1	1.2	<0.18	<0.26	<0.24	5.76	NP	0.00	97.69	91.93
11/14/02	<50	<0.08	<0.18	<0.17	<0.4	21	5.73	NP	0.00	97.69	91.96
01/29/03	<15	<0.04	<0.02	<0.02	<0.06	16	7.30	NP	0.00	97.69	90.39
04/23/03	<15	<0.04	<0.02	<0.02	<0.06	16	5.76	NP	0.00	97.69	91.93
07/10/03	<15	<0.22	<0.32	<0.31	<0.4	11	5.63	NP	0.00	97.69	92.06
10/20/03	13,700	4.13	<0.02	<0.02	<0.06	*6,570 / 4,920	5.61	NP	0.00	97.69	92.08
MONITORING WELL #MW-4											
<i>Screen Interval = 4 to 14 feet</i>											
01/09/92	-	-	-	-	-	-	5.25	NP	0.00	97.33	92.08
04/13/92	-	-	-	-	-	-	6.40	NP	0.00	97.33	90.93
10/05/92	-	-	-	-	-	-	9.95	NP	0.00	97.33	87.38
01/06/93	-	-	-	-	-	-	4.10	NP	0.00	97.33	93.23
04/26/93	-	-	-	-	-	-	4.84	NP	0.00	97.33	92.49
01/04/94	-	-	-	-	-	-	9.05	NP	0.00	97.33	88.28
04/05/94	-	-	-	-	-	-	8.10	NP	0.00	97.33	89.23
10/09/95	63,000	9,000	2,100	2,500	9,600	-	-	-	-	97.33	-
01/08/96	23,000	2,200	830	880	3,600	-	5.57	NP	0.00	97.33	91.76
04/08/96	56,000	5,000	2,500	2,600	11,000	-	5.36	NP	0.00	97.33	91.97
07/22/96	33,000	3,700	1,600	1,400	6,000	2,400	4.80	NP	0.00	97.33	92.53
10/16/96	2,800	7.8	0.60	0.41	52	2,000	5.47	NP	0.00	97.33	91.86
01/22/97	1,400	<0.3	<0.3	<0.3	<0.5	3,100	5.15	NP	0.00	97.33	92.18
04/21/97	-	-	-	-	-	-	6.36	5.30	1.06	97.33	91.77
07/14/97	-	-	-	-	-	-	5.24	5.21	0.03	97.33	92.11

TABLE 1
GROUNDWATER DATA
THRIFTY OIL STATION #049, OAKLAND, CA.

DATE SAMPLED	ANALYTICAL PARAMETERS						DEPTH TO GROUNDWATER (feet)	DEPTH TO PRODUCT (feet)	PRODUCT THICKNESS (feet)	CASING ELEVATION (feet)	GROUNDWATER ELEVATION (feet)
	TPH (ug/L)	BENZENE (ug/L)	TOLUENE (ug/L)	EthylBenzene (ug/L)	XYLENE (ug/L)	MTBE (ug/L)					
<i>B2.0 / 8260</i>											
10/07/97	-	-	-	-	-	-	7.82	7.80	0.02	97.33	89.53
01/15/98	-	-	-	-	-	-	6.68	6.60	0.08	97.33	90.71
04/23/98	-	-	-	-	-	-	6.36	5.30	1.06	97.33	91.77
07/20/98	<50	<0.3	<0.3	<0.3	<0.5	<5	6.05	NP	0.00	97.33	91.28
10/14/98	3,100	86	23	2.0	520	1,100	6.85	NP	0.00	97.33	90.48
01/21/99	9,100	3.2	5.6	1.8	130	*24,000 / 17,000	6.10	NP	0.00	97.33	91.23
04/15/99	14,000	<0.3	0.71	<0.3	<0.5	*20,000 / 22,000	6.05	NP	0.00	97.33	91.28
07/26/99	4,500	<6	<6	<6	<10	*8,700 / 9,800	6.07	NP	0.00	97.33	91.26
10/13/99	410	<0.3	0.63	<0.3	<0.5	660	5.54	NP	0.00	97.33	91.79
01/20/00	770	<0.3	<0.3	<0.3	<0.5	*2,400 / 1,900	5.49	NP	0.00	97.33	91.84
04/05/00	61,200	0.9	<0.25	<0.25	<0.5	*18,500 / 21,900	5.30	NP	0.00	97.33	92.03
07/19/00	96,600	1,770	1,760	2,690	8,730	21,900 / 9,740 J	5.29	NP	0.00	97.33	92.04
10/18/00	34,900	698	1,010	607	4,130	*27,800 / 15,900	6.02	NP	0.00	97.33	91.31
01/17/01	29,100	799	930	614	3,400	*24,300 / 31,400	4.88	NP	0.00	97.33	92.45
04/19/01	103,000	4,880	3,980	3,260	11,800	66,900	4.89	NP	0.00	97.33	92.44
07/18/01	52,200	3,320	2,090	440	5,520	*55,500 / 16,800	6.04	NP	0.00	97.33	91.29
10/10/01	8,580	6.1	14	5.3	70	*40,100 / 30,000	4.51	NP	0.00	97.33	92.82
01/30/02	36,500	<0.18	3.0	1.0	3.0	*43,000 / 24,900	4.51	NP	0.00	97.33	92.82
04/17/02	12,900	8.0	1.0	<0.18	1.0	16,000 / 13,600	4.51	NP	0.00	97.33	92.82
07/31/02	19,300	<0.18	1.2	1.5	2.6	*13,200 / 10,100	5.26	NP	0.00	97.33	92.07
11/14/02	36,200	1,720	940	235	6,190	8,280	5.27	NP	0.00	97.33	92.06
01/29/03	13,000	444	39	<0.4	1,200	8,160	4.50	NP	0.00	97.33	92.83
04/23/03	7,430	130	5.7	<0.2	387	5,830	4.80	NP	0.00	97.33	92.53
07/10/03	16,200	<2.2	<3.2	<3.1	<4.0	3,930	4.55	NP	0.00	97.33	92.78
10/20/03	6,040	672	384	3.4	444	*3,780 / 3,220	4.56	NP	0.00	97.33	92.77
MONITORING WELL #MW-5 <i>Screen Interval = 4 to 14 feet</i>											
01/09/92	-	-	-	-	-	-	5.32	NP	0.00	98.85	93.53
04/13/92	-	-	-	-	-	-	4.82	NP	0.00	98.85	94.03
10/0/92	-	-	-	-	-	-	8.78	NP	0.00	98.85	90.07
01/06/93	-	-	-	-	-	-	3.46	NP	0.00	98.85	95.39
04/26/93	-	-	-	-	-	-	4.66	NP	0.00	98.85	94.19
01/04/94	-	-	-	-	-	-	6.36	NP	0.00	98.85	92.49
04/05/94	-	-	-	-	-	-	5.94	NP	0.00	98.85	92.91
07/12/95	<100	<0.5	<0.5	<0.5	<1	-	-	-	-	98.85	-

TABLE I
GROUNDWATER DATA
THRIFTY OIL STATION #049, OAKLAND, CA.

DATE SAMPLED	ANALYTICAL PARAMETERS						DEPTH TO GROUNDWATER (feet)	DEPTH TO PRODUCT (feet)	PRODUCT THICKNESS (feet)	CASING ELEVATION (feet)	GROUNDWATER ELEVATION (feet)
	TPH (ug/L)	BENZENE (ug/L)	TOLUENE (ug/L)	EthylBenzene (ug/L)	XYLENE (ug/L)	MTBE (ug/L)					
10/09/95	440	31	11	19	84	-	-	-	98.85	-	
01/08/96	<50	<0.3	<0.3	<0.3	<0.5	-	6.63	NP	98.85	92.22	
04/08/96	<50	<0.3	<0.3	<0.3	<0.5	-	5.22	NP	98.85	93.63	
07/22/96	<50	<0.3	<0.3	<0.3	<0.5	<20	6.62	NP	98.85	92.23	
10/16/96	<50	<0.3	<0.3	<0.3	<0.5	<20	6.12	NP	98.85	92.73	
01/22/97	<50	<0.3	<0.3	<0.3	<0.5	<20	5.17	NP	98.85	93.68	
04/21/97	73	2.5	0.34	0.74	3.8	21	6.64	NP	98.85	92.21	
07/14/97	<50	<0.3	<0.3	<0.3	<0.5	<20	6.67	NP	98.85	92.18	
10/07/97	130	<0.3	<0.3	<0.3	<0.5	-	8.20	NP	98.85	90.65	
01/19/98	85	<0.3	<0.3	<0.3	<0.5	-	1.55	NP	98.85	97.30	
04/23/98	220	0.39	<0.3	<0.3	<0.5	350	8.10	NP	98.85	90.75	
07/20/98	<50	<0.3	<0.3	<0.3	<0.5	<5	6.30	NP	98.85	92.55	
10/14/98	<50	<0.3	<0.3	<0.3	<0.5	<5	7.65	NP	98.85	91.20	
01/21/99	<50	<0.3	<0.3	<0.3	<0.5	*6.7 / <5	6.15	NP	98.85	92.70	
04/15/99	<50	<0.3	<0.3	<0.3	<0.5	<5	1.60	NP	98.85	97.25	
07/26/99	<50	<0.3	<0.3	<0.3	<0.5	<5	6.13	NP	98.85	92.72	
10/13/99	<50	<0.3	<0.3	<0.3	<0.5	<5	6.61	NP	98.85	92.24	
01/20/00	<50	<0.3	<0.3	<0.3	<0.5	<5	6.14	NP	98.85	92.71	
04/05/00	<50	0.5	<0.25	<0.25	<0.5	*5.4 / <5	4.58	NP	98.85	94.27	
07/19/00	<50	<0.3	<0.3	<0.3	<0.6	<5	4.59	NP	98.85	94.26	
10/18/00	<50	<0.18	<0.14	<0.18	<0.26	<0.24	6.28	NP	98.85	92.57	
01/17/01	<50	<0.18	<0.14	<0.18	1.0	*5 / 4.8	4.58	NP	98.85	94.27	
04/19/01	<50	<0.18	<0.14	<0.18	<0.26	<0.24	4.58	NP	98.85	94.27	
07/18/01	<50	<0.18	<0.14	<0.18	<0.26	<0.24	6.12	NP	98.85	92.73	
10/10/01	<50	<0.18	<0.14	<0.18	<0.26	<0.24	4.58	NP	98.85	94.27	
01/30/02	<50	<0.18	<0.14	<0.18	<0.26	<0.24	4.48	NP	98.85	94.37	
04/17/02	<50	<0.18	<0.14	<0.18	<0.26	<0.24	4.58	NP	98.85	94.27	
07/31/02	<50	<0.18	<0.14	<0.18	<0.26	<0.24	6.10	NP	98.85	92.75	
11/14/02	<50	<0.08	<0.18	<0.17	<0.4	9	6.11	NP	98.85	92.74	
01/29/03	<15	<0.04	<0.02	<0.02	<0.06	7.1	4.55	NP	98.85	94.30	
04/23/03	<15	<0.04	<0.02	<0.02	<0.06	7.9	3.03	NP	98.85	95.82	
07/10/03	<15	<0.22	<0.32	<0.31	<0.4	7.4	5.25	NP	98.85	93.60	
10/20/03	<15	<0.04	<0.02	<0.02	<0.06	*9.11 / 9.2	5.25	NP	98.85	93.60	

TABLE 1
GROUNDWATER DATA
THRIFTY OIL STATION #049, OAKLAND, CA.

DATE SAMPLED	ANALYTICAL PARAMETERS						DEPTH TO GROUNDWATER (feet)	DEPTH TO PRODUCT (feet)	PRODUCT THICKNESS (feet)	CASING ELEVATION (feet)	GROUNDWATER ELEVATION (feet)
	TPH (ug/L)	BENZENE (ug/L)	TOLUENE (ug/L)	EthylBenzene (ug/L)	XYLENE (ug/L)	MTBE (ug/L)					
MONITORING WELL #MW-6											
<i>Screen Interval = 4 to 14 feet</i>											
01/09/92	-	-	-	-	-	-	6.30	NP	0.00	99.67	93.37
04/13/92	-	-	-	-	-	-	5.47	NP	0.00	99.67	94.20
10/05/92	-	-	-	-	-	-	9.85	NP	0.00	99.67	89.82
01/06/93	-	-	-	-	-	-	4.16	NP	0.00	99.67	95.51
04/26/93	-	-	-	-	-	-	5.75	NP	0.00	99.67	93.92
01/14/94	-	-	-	-	-	-	7.20	NP	0.00	99.67	92.47
04/05/94	-	-	-	-	-	-	6.76	NP	0.00	99.67	92.91
07/10/95	<100	<0.5	0.9	<0.5	1.1	-	-	-	-	99.67	-
10/09/95	250	4.8	5.6	11	58	-	-	-	-	99.67	-
01/08/96	<50	<0.3	<0.3	<0.3	<0.5	-	6.16	NP	0.00	99.67	93.51
04/08/96	230	4.6	4.7	3.2	33	-	4.60	NP	0.00	99.67	95.07
07/22/96	<50	<0.3	<0.3	<0.3	<0.5	<20	7.30	NP	0.00	99.67	92.37
10/16/96	<50	<0.3	<0.3	<0.3	<0.5	<20	5.82	NP	0.00	99.67	93.85
01/22/97	<50	<0.3	<0.3	<0.3	<0.5	<20	4.40	NP	0.00	99.67	95.27
04/21/97	130	<0.3	<0.3	<0.3	<0.5	<20	7.10	NP	0.00	99.67	92.57
07/14/97	<50	<0.3	<0.3	<0.3	0.70	<20	7.35	NP	0.00	99.67	92.32
10/07/97	<50	0.78	0.3	<0.3	<0.5	-	6.98	NP	0.00	99.67	92.69
01/23/98	<50	<0.3	<0.3	<0.3	<0.5	-	2.35	NP	0.00	99.67	97.32
04/23/98	<50	<0.3	<0.3	<0.3	<0.5	<20	6.90	NP	0.00	99.67	92.77
07/20/98	<50	<0.3	1.1	<0.3	1.4	<5	5.45	NP	0.00	99.67	94.22
10/14/98	<50	<0.3	<0.3	<0.3	<0.5	<5	4.95	NP	0.00	99.67	94.72
01/21/99	<50	0.35	0.62	<0.3	<0.5	<5	3.90	NP	0.00	99.67	95.77
04/15/99	<50	<0.3	<0.3	<0.3	<0.5	<5	2.35	NP	0.00	99.67	97.32
07/26/99	1,000	<0.3	<0.3	<0.3	<0.5	*2,300 / 3,900	3.93	NP	0.00	99.67	95.74
10/13/99	<50	<0.3	<0.3	<0.3	<0.5	<5	6.15	NP	0.00	99.67	93.52
01/20/00	<50	<0.3	<0.3	<0.3	<0.5	*42 / 41	5.84	NP	0.00	99.67	93.83
04/05/00	4,600	338	2.8	1.2	55.2	*282 / 230	3.89	NP	0.00	99.67	95.78
07/19/00	60	1.0	2.0	<0.3	<0.6	*87 / 76	3.07	NP	0.00	99.67	96.60
10/18/00	-	-	-	-	-	-	-	-	-	99.67	-
01/17/01	103	<0.18	2.0	<0.18	3.0	*78 / 106	3.87	NP	0.00	99.67	95.80
04/19/01	<50	<0.18	<0.14	<0.18	<0.26	<0.24	3.86	NP	0.00	99.67	95.81
07/18/01	<50	<0.18	<0.14	<0.18	<0.26	<0.24	5.40	NP	0.00	99.67	94.27
10/10/01	<50	<0.18	<0.14	<0.18	<0.26	<0.24	3.86	NP	0.00	99.67	95.81
01/30/02	<50	<0.18	<0.14	<0.18	<0.26	<0.24	3.86	NP	0.00	99.67	95.81
04/17/02	<50	<0.18	<0.14	<0.18	<0.26	<0.24	3.86	NP	0.00	99.67	95.81

TABLE 1
GROUNDWATER DATA
THRIFTY OIL STATION #049, OAKLAND, CA.

DATE SAMPLED	ANALYTICAL PARAMETERS						DEPTH TO GROUNDWATER (feet)	DEPTH TO PRODUCT (feet)	PRODUCT THICKNESS (feet)	CASING ELEVATION (feet)	GROUNDWATER ELEVATION (feet)
	TPH (ug/L)	BENZENE (ug/L)	TOLUENE (ug/L)	EthylBenzene (ug/L)	XYLENE (ug/L)	MTBE (ug/L)					
07/31/02	<50	<0.18	<0.14	<0.18	<0.26	<0.24	5.40	NP	0.00	99.67	94.27
11/14/02	140	3.2	<0.18	5.2	<0.4	111	5.42	NP	0.00	99.67	94.25
01/29/03	694 J	<0.04	<0.02	<0.02	<0.06	630	3.88	NP	0.00	99.67	95.79
04/23/03	1,550	<0.04	<0.02	<0.02	<0.06	578	3.86	NP	0.00	99.67	95.81
07/10/03	1,670	<0.22	<0.32	<0.31	<0.4	509	5.31	NP	0.00	99.67	94.36
10/20/03	1,320	<0.04	<0.02	<0.02	<0.06	*656 / 662	5.30	NP	0.00	99.67	94.37
MONITORING WELL #MW-7 <i>Screen Interval = 4 to 14 feet</i>											
01/09/92	-	-	-	-	-	-	6.30	NP	0.00	99.02	92.72
04/13/92	-	-	-	-	-	-	6.68	NP	0.00	99.02	92.34
10/05/92	-	-	-	-	-	-	9.60	NP	0.00	99.02	89.42
01/06/93	-	-	-	-	-	-	13.90	NP	0.00	99.02	85.12
04/26/93	-	-	-	-	-	-	5.55	NP	0.00	99.02	93.47
01/04/94	-	-	-	-	-	-	7.58	NP	0.00	99.02	91.44
04/05/94	-	-	-	-	-	-	6.66	NP	0.00	99.02	92.36
10/09/95	27,000	2,400	140	1,700	2,700	-	-	-	-	99.02	-
01/08/96	13,000	800	42	540	860	-	6.94	NP	0.00	99.02	92.08
04/08/96	9,100	840	31	690	1,200	-	5.48	NP	0.00	99.02	93.54
07/22/96	11,000	1,700	22	660	700	840	6.60	NP	0.00	99.02	92.42
10/16/96	180	<0.3	<0.3	<0.3	<0.5	270	6.42	NP	0.00	99.02	92.60
01/22/97	130	<0.3	<0.3	<0.3	<0.5	470	5.70	NP	0.00	99.02	93.32
04/21/97	10,000	1,400	27	820	490	1,100	5.30	NP	0.00	99.02	93.72
07/14/97	8,200	660	15	230	270	560	7.90	NP	0.00	99.02	91.12
10/07/97	7,700	480	15	8.4	350	-	7.70	NP	0.00	99.02	91.32
01/19/98	1,400	20	0.74	0.46	4.4	-	6.05	NP	0.00	99.02	92.97
04/23/98	590	<0.3	<0.3	<0.3	<0.5	1,700	7.60	NP	0.00	99.02	91.42
07/20/98	4,900	570	150	300	500	1,500	5.30	NP	0.00	99.02	93.72
10/14/98	1,100	1.0	<0.3	<0.3	5.3	2,000	8.60	NP	0.00	99.02	90.42
01/21/99	570	0.32	<0.3	<0.3	<0.5	* 1,500 / 1,700	6.70	NP	0.00	99.02	92.32
04/15/99	770	<0.3	<0.3	<0.3	<0.5	* 1,400 / 1,200	6.07	NP	0.00	99.02	92.95
07/26/99	500	<0.3	<0.3	<0.3	<0.5	*710 / 950	7.86	NP	0.00	99.02	91.16
10/13/99	<50	<0.3	0.44	<0.3	0.62	<5	6.93	NP	0.00	99.02	92.09
01/20/00	<50	<0.3	<0.3	<0.3	<0.5	*5 / <5	6.44	NP	0.00	99.02	92.58
04/05/00	5,670	415	19	1.7	60.1	*329 / 194	7.86	NP	0.00	99.02	91.16
07/19/00	1,350	14	<3	<3	10	*237 / 120	7.10	NP	0.00	99.02	91.92

**TABLE 1
GROUNDWATER DATA
THRIFTY OIL STATION #049, OAKLAND, CA.**

DATE SAMPLED	ANALYTICAL PARAMETERS						DEPTH TO GROUNDWATER (feet)	DEPTH TO PRODUCT (feet)	PRODUCT THICKNESS (feet)	CASING ELEVATION (feet)	GROUNDWATER ELEVATION (feet)
	TPH (ug/L)	BENZENE (ug/L)	TOLUENE (ug/L)	EthylBenzene (ug/L)	XYLENE (ug/L)	MTBE (ug/L)					
10/18/00	<50	<0.18	<0.14	<0.18	<0.26	*63 / 41.1	5.28	NP	0.00	99.02	93.74
01/17/01	<50	<0.18	<0.14	<0.18	3.0	*57 / 81	5.27	NP	0.00	99.02	93.75
04/19/01	<50	<0.18	<0.14	<0.18	<0.26	66	7.86	NP	0.00	99.02	91.16
07/18/01	<50	<0.18	<0.14	<0.18	<0.26	*9 / 3.5	6.30	NP	0.00	99.02	92.72
10/10/01	<50	<0.18	<0.14	<0.18	<0.26	*9.4 / 7.9	8.23	NP	0.00	99.02	90.79
01/30/02	2,590	40	90	8.0	6.0	*45 / 22	5.14	NP	0.00	99.02	93.88
04/17/02	51	<0.18	<0.14	<0.18	<0.26	*58 / 45	5.53	NP	0.00	99.02	93.49
07/31/02	<50	<0.18	<0.14	<0.18	<0.26	*39 / 33	5.93	NP	0.00	99.02	93.09
11/14/02	<50	<0.08	<0.18	<0.17	<0.4	68	5.92	NP	0.00	99.02	93.10
01/29/03	<15	<0.04	<0.02	<0.02	<0.06	<0.03	5.51	NP	0.00	99.02	93.51
04/23/03	<15	<0.04	<0.02	<0.02	<0.06	<0.03	5.14	NP	0.00	99.02	93.88
07/10/03	<15	<0.22	<0.32	<0.31	<0.4	<0.18	5.03	NP	0.00	99.02	93.99
10/20/03	<15	<0.04	<0.02	<0.02	<0.06	<0.03	5.01	NP	0.00	99.02	94.01
MONITORING WELL #RW-1											
01/09/92	-	-	-	-	-	-	14.00	NP	0.00	-	-
04/13/92	-	-	-	-	-	-	14.00	NP	0.00	-	-
10/05/92	-	-	-	-	-	-	15.05	NP	0.00	-	-
01/06/93	-	-	-	-	-	-	5.43	NP	0.00	-	-
04/26/93	-	-	-	-	-	-	13.20	NP	0.00	-	-
01/04/94	-	-	-	-	-	-	14.30	NP	0.00	-	-
04/05/94	-	-	-	-	-	-	14.13	NP	0.00	-	-
01/08/96	-	-	-	-	-	-	14.22	NP	0.00	-	-
04/08/96	-	-	-	-	-	-	14.33	NP	0.00	-	-
07/22/96	8,100	530	84	120	860	-	14.27	NP	0.00	-	-
10/16/96	-	-	-	-	-	-	13.10	NP	0.00	-	-
01/22/97	-	-	-	-	-	-	16.97	NP	0.00	-	-
10/07/97	-	-	-	-	-	-	14.20	NP	0.00	-	-
01/15/98	-	-	-	-	-	-	15.60	NP	0.00	-	-
04/23/98	81,000	0.72	1.4	3.2	5.7	270,000	14.20	NP	0.00	-	-
07/20/98	-	-	-	-	-	-	14.30	NP	0.00	-	-
10/14/98	-	-	-	-	-	-	11.20	NP	0.00	-	-
01/21/99	-	-	-	-	-	-	-	-	-	-	-
04/15/99	-	-	-	-	-	-	13.10	NP	0.00	-	-
07/26/99	4,400	<3	<3	<3	<5	*6,800 / 9,000	13.83	NP	0.00	-	-

**TABLE 1
GROUNDWATER DATA
THRIFTY OIL STATION #049, OAKLAND, CA.**

DATE SAMPLED	ANALYTICAL PARAMETERS						DEPTH TO GROUNDWATER (feet)	DEPTH TO PRODUCT (feet)	PRODUCT THICKNESS (feet)	CASING ELEVATION (feet)	GROUNDWATER ELEVATION (feet)
	TPH (ug/L)	BENZENE (ug/L)	TOLUENE (ug/L)	EthylBenzene (ug/L)	XYLENE (ug/L)	MTBE (ug/L)					
10/13/99	-	-	-	-	-	-	-	-	-	-	-
01/20/00	-	-	-	-	-	-	13.22	NP	0.00	-	-
04/05/00	-	-	-	-	-	-	-	-	-	-	-
07/19/00	-	-	-	-	-	-	13.25	NP	0.00	-	-
10/18/00	-	-	-	-	-	-	11.14	NP	0.00	-	-
01/17/01	-	-	-	-	-	-	11.12	NP	0.00	-	-
04/19/01	-	-	-	-	-	-	-	-	-	-	-
07/18/01	-	-	-	-	-	-	11.20	NP	0.00	-	-
10/10/01	-	-	-	-	-	-	11.20	NP	0.00	-	-
01/30/02	-	-	-	-	-	-	12.30	NP	0.00	-	-
04/17/02	-	-	-	-	-	-	14.30	NP	0.00	-	-
07/31/02	-	-	-	-	-	-	14.21	NP	0.00	-	-
11/14/02	-	-	-	-	-	-	14.13	NP	0.00	-	-
01/29/03	-	-	-	-	-	-	13.12	NP	0.00	-	-
04/23/03	-	-	-	-	-	-	No Access	-	-	-	-
07/10/03	-	-	-	-	-	-	No Access	-	-	-	-
10/20/03	-	-	-	-	-	-	No Access	-	-	-	-

NOTE: * MTBE 8020 / 8260
 ND = Nondetectable
 NP = No free hydrocarbon product
 " - " = Not analyzed / Not available

Benzene, toluene, ethylbenzene, and xylene analyzed by EPA method 8020
 Total petroleum hydrocarbons (TPH) analyzed by EPA method 8015 modified for gasoline
 Methyl-tert Butyl Ether (MTBE) analyzed by EPA method 8020 or 8260
 On 7/10/03 & 11/14/02, BTEX and MTBE done by 8260B

**TABLE 2
 ADDITIONAL GROUNDWATER DATA
 THRIFTY OIL STATION # 049, OAKLAND, CA.**

DATE SAMPLED	OXYGENATES				1,2-Dichloroethane (ug/L)
	Di-Isopropyl Ether (DIPE) (ug/L)	Ethyl-Tert-Butyl Ether (ETBE) (ug/L)	Tert-Amyl Methyl Ether (TAME) (ug/L)	Tert-Butyl Alcohol (TBA) (ug/L)	
MONITORING WELL # MW-1					
11/14/02	<0.2	<0.12	<0.16	<10	<0.13
01/29/03	-	-	-	-	-
04/23/03	-	-	-	-	-
07/10/03	<0.29	<0.17	<0.28	<10	-
10/20/03	-	-	-	-	-
MONITORING WELL # MW-2					
11/14/02	<2.0	<1.2	111	341	<1.3
01/29/03	-	-	-	-	-
04/23/03	-	-	-	-	-
07/10/03	<2.9	<1.7	59	449	-
10/20/03	-	-	-	-	-
MONITORING WELL # MW-3					
11/14/02	<0.2	<0.12	<0.16	<10	<0.13
01/29/03	-	-	-	-	-
04/23/03	-	-	-	-	-
07/10/03	<0.29	<0.17	<0.28	<10	-
10/20/03	-	-	-	-	-
MONITORING WELL # MW-4					
11/14/02	<2.0	<1.2	106	281	<1.3
01/29/03	-	-	-	-	-
04/23/03	-	-	-	-	-
07/10/03	<2.9	<1.7	35	<100	-
10/20/03	-	-	-	-	-
MONITORING WELL # MW-5					
11/14/02	<0.2	<0.12	<0.16	<10	<0.13
01/29/03	-	-	-	-	-
04/23/03	-	-	-	-	-
07/10/03	<0.29	<0.17	<0.28	<10	-
10/20/03	-	-	-	-	-
MONITORING WELL # MW-6					
11/14/02	<0.2	<0.12	<0.16	<10	<0.13
01/29/03	-	-	-	-	-
04/23/03	-	-	-	-	-

TABLE 2
ADDITIONAL GROUNDWATER DATA
THRIFTY OIL STATION # 049, OAKLAND, CA.

DATE SAMPLED	OXYGENATES				1,2-Dichloroethane (ug/L)
	Di-Isopropyl Ether (DIPE) (ug/L)	Ethyl-Tert-Butyl Ether (ETBE) (ug/L)	Tert-Amyl Methyl Ether (TAME) (ug/L)	Tert-Butyl Alcohol (TBA) (ug/L)	
07/10/03	<0.29	<0.17	2.1	38	-
10/20/03	-	-	-	-	-
MONITORING WELL # MW-7					
11/14/02	<0.2	<0.12	<0.16	<10	<0.13
01/29/03	-	-	-	-	-
04/23/03	-	-	-	-	-
07/10/03	<0.29	<0.17	<0.28	<10	-
10/20/03	-	-	-	-	-

NOTE: DIPE, ETBE, TAME, TBA analyzed by EPA Method 8260B

TABLE 3
GROUNDWATER REMEDIATION SYSTEM MONITORING PROGRAM
 Thrifty Oil Co. Station No 049, OAKLAND, CA

Date	Totalizer (gallons)	Total/Cum. Discharge (gallons)	Flow (gal/day)	Total H-C Removed (lbs)	EFFLUENT (ug/L)						INFLUENT (ug/L)					
					TPH-g	B	T	E	X	MTBE	TPH-g	B	T	E	X	MTBE
02/10/92	6,264	4,954	21	1,939	-	<0.5	<0.5	<0.5	<0.5	-	-	5,800	2,800	320	7,200	-
03/09/92	8,520	7,210	81	2,822	<200	<0.5	1.6	<0.5	<0.5	-	47,000	7,100	4,800	630	10,300	-
04/13/92	22,888	21,578	411	7,369	<200	<0.5	<0.5	<0.5	<0.5	-	29,000	4,500	2,200	160	4,800	-
05/11/92	24,920	23,610	73	7,800	<200	<0.5	<0.5	<0.5	<0.5	-	22,000	4,300	1,500	130	3,800	-
06/01/92	28,330	27,020	162	8,368	<200	<0.5	<0.5	<0.5	<0.5	-	18,000	3,400	1,500	660	4,200	-
07/13/92	72,675	27,020	-	8,368	-	<0.5	<0.5	<0.5	<0.5	-	-	1,800	750	150	5,600	-
07/13/92	72,675	27,020	-	8,368	The system pumped air and flowmeter jumped from 30,000 gallons to 70,000 gallons						-	-	-	-	-	-
08/17/92	75,046	29,391	68	8,724	-	<0.5	<0.5	<0.5	<0.5	-	-	1,100	350	200	1,100	-
09/14/92	75,582	29,927	19	8,804	-	<0.5	<0.5	<0.5	<1	-	-	2,100	520	<25	3,500	-
10/05/92	75,680	30,025	5	8,819	<200	<0.5	<0.5	<0.5	<1	-	19,000	1,700	270	<25	4,000	-
11/09/92	77,280	31,625	46	9,072	-	<0.5	<0.5	<0.5	<0.5	-	-	4,000	1,400	120	5,900	-
12/14/92	79,420	33,765	61	9,411	-	<0.5	<0.5	<0.5	<1	-	-	7,300	4,900	1,800	16,000	-
01/04/93	84,720	39,065	252	10,250	-	<0.5	<0.5	<0.5	<1	-	-	5,400	2,100	450	7,800	-
02/15/93	102,689	57,034	428	14,739	<200	<0.5	<0.5	<0.5	<1	-	41,000	6,600	3,200	260	9,600	-
02/22/93	146,430	57,034	-	14,739	The system pumped air and flowmeter jumped from 102,689 gallons to 146,430 gallons						-	-	-	-	-	-
03/08/93	147,500	58,104	76	15,104	-	<0.5	<0.5	<0.5	<1	-	-	7,400	3,400	56	11,000	-
04/26/93	151,200	61,804	76	16,291	<100	<0.5	<0.5	<0.5	<1	-	36,000	4,300	2,200	420	8,300	-
04/26/93	151,200	61,804	-	16,291	Shut down system for repair						-	-	-	-	-	-
07/21/93	151,240	61,844	0	16,303	Restart the system						-	-	-	-	-	-
08/11/93	151,650	62,254	20	16,426	-	<0.5	<0.5	<0.5	<1	-	-	6,500	2,300	390	6,200	-
09/16/93	154,005	64,609	65	17,200	<60	<0.3	<0.3	<0.3	<0.6	-	43,000	2,300	320	<4.4	2,900	-
10/04/93	154,896	65,500	50	17,482	<60	<0.3	<0.3	<0.3	<0.6	-	33,000	2,900	470	6.9	3,500	-
11/05/93	157,431	68,035	79	17,989	<50	<0.3	<0.3	<0.3	<0.5	-	15,000	1,100	27	<0.3	920	-
12/03/93	159,324	69,928	68	18,233	<50	<0.3	<0.3	<0.3	<0.5	-	16,000	1,100	88	<6.6	2,300	-
01/06/94	166,440	77,044	209	19,181	-	<0.3	<0.3	<0.3	<0.5	-	-	3,800	730	<13	1,200	-
02/03/94	170,720	81,324	153	19,752	-	<0.3	<0.3	<0.3	<0.5	-	-	3,600	610	<4.4	4,800	-
03/03/94	178,168	88,772	266	20,744	-	<0.3	<0.3	<0.3	<0.5	-	-	2,800	2,000	270	3,400	-
04/07/94	185,670	96,274	214	22,056	<50	<0.3	<0.3	<0.3	<0.5	-	26,000	2,200	550	<6.6	1,900	-
05/12/94	188,840	99,444	91	22,460	<50	<0.3	<0.3	<0.3	<0.5	-	4,600	100	10	8.4	280	-
06/16/94	194,680	105,284	167	22,684	<50	<0.3	<0.3	<0.3	<0.5	-	<50	<0.3	<0.3	<0.3	<0.5	-
07/11/94	199,135	109,739	178	22,832	<50	<0.3	<0.3	<0.3	<0.5	-	4,000	220	<2.6	<2.6	320	-
08/04/94	200,910	111,514	74	22,919	<50	<0.3	<0.3	<0.3	<0.5	-	7,800	480	6.2	<0.3	830	-
09/15/94	203,450	114,054	60	23,036	<50	<0.3	<0.3	<0.3	<0.5	-	3,200	150	2.4	2.6	170	-
10/10/94	205,210	115,814	70	23,069	<50	<0.3	<0.3	<0.3	<0.5	-	1,300	8.6	1.5	1.1	15	-
11/07/94	206,060	116,664	30	23,074	<50	<0.3	<0.3	<0.3	<0.5	-	170	1.5	<0.3	<0.5	0.5	-
12/05/94	207,093	117,697	37	23,075	<50	<0.3	<0.3	<0.3	<0.5	-	75	1.3	<0.3	<0.5	<0.5	-
01/09/95	207,293	117,897	6	23,075	<50	<0.3	<0.3	<0.3	<0.5	-	<50	<0.3	<0.3	<0.5	<0.5	-
02/01/95	207,650	118,254	16	23,075	<50	<0.3	<0.3	<0.3	<0.5	-	<50	<0.3	<0.3	<0.5	<0.5	-
02/06/95	207,810	118,414	32	23,075	<50	<0.3	<0.3	<0.3	<0.5	-	<50	2.7	<0.3	<0.5	<0.5	-

TABLE 3
GROUNDWATER REMEDIATION SYSTEM MONITORING PROGRAM
 Thrifty Oil Co. Station No 049, OAKLAND, CA

Date	Totalizer (gallons)	Total/Cum. Discharge (gallons)	Flow (gal/day)	Total H-C Removed (lbs)	EFFLUENT (ug/L)						INFLUENT (ug/L)					
					TPH-g	B	T	E	X	MTBE	TPH-g	B	T	E	X	MTBE
03/10/95	208,430	119,034	19	23,076	<100	<0.5	<0.5	<0.5	<1	-	<100	<0.5	<0.5	<0.5	<1	-
04/10/95	208,564	119,168	4	23,079	<100	<0.5	<0.5	<0.5	<1	-	3,300	180	7.6	2.1	150	-
05/08/95	208,608	119,212	2	23,082	<100	<0.5	<0.5	<0.5	<1	-	11,000	640	9.2	<5	1,100	-
06/05/95	208,926	119,530	11	23,103	<100	<0.5	<0.5	<0.5	<1	-	5,100	270	2.2	<0.5	49	-
07/10/95	214,182	124,786	150	23,500	<100	<0.5	<0.5	<0.5	<1	-	13,000	1,600	120	24	1,300	-
08/07/95	221,876	132,480	275	24,332	Shut down system for repair						-	-	-	-	-	-
08/28/95	221,997	132,601	6	24,346	Restart the system						-	-	-	-	-	-
09/06/95	222,003	132,607	1	24,346	<100	<0.5	<0.5	<0.5	<1	-	2,300	<0.5	<0.5	<0.5	<1	-
10/09/95	222,343	132,947	10	24,352	<100	<0.5	<0.5	<0.5	<1	-	2,000	5.6	0.77	0.66	3.8	-
11/06/95	222,704	133,308	13	24,360	<50	0.3	0.31	<0.3	0.68	-	3,000	27	1.7	3.7	48	-
12/11/95	223,792	134,396	31	24,387	<50	<0.3	<0.3	<0.3	<0.5	-	<50	<0.3	<0.3	<0.3	0.96	-
01/08/96	224,661	135,265	31	24,400	970	<0.3	<0.3	<0.3	0.67	-	1,800	39	<0.3	<0.3	<0.5	-
02/12/96	227,812	138,416	90	24,467	<50	10	0.37	<0.3	0.53	-	3,300	190	<7.5	<7.5	20	-
03/12/96	229,301	139,905	51	24,504	<50	<0.3	<0.3	<0.3	<0.5	-	2,700	250	2.3	<1.5	<2.5	-
04/08/96	242,320	152,924	482	24,704	<50	<0.3	<0.3	<0.3	<0.5	-	1,000	90	5	<0.3	67	-
05/06/96	247,840	158,444	197	25,072	100	<0.3	<0.3	<0.3	<0.5	-	15,000	2,200	600	32	2,400	-
06/03/96	248,423	159,027	21	25,145	Shut down system for carbon change						-	-	-	-	-	-
08/08/96	248,423	159,027	-	25,145	Start-up system						-	-	-	-	-	-
08/20/96	248,630	159,234	17	25,149	<50	<0.3	<0.3	<0.3	<0.5	-	2,100	24	<0.3	<0.3	49	-
09/23/96	259,030	169,634	306	25,417	<50	<0.3	<0.3	<0.3	<0.5	-	4,100	260	3.8	<3	34	-
10/16/96	263,610	174,214	199	25,547	<50	<0.3	<0.3	<0.3	<0.5	-	2,700	220	3.8	<0.6	44	-
11/19/96	263,986	174,590	11	25,553	<50	<0.3	<0.3	<0.3	<0.5	-	1,200	<0.3	<0.3	<0.3	<0.5	-
12/16/96	264,210	174,814	8	25,581	<50	<0.3	<0.3	<0.3	1.5	-	29,000	410	2,300	120	1,100	-
01/22/97	266,220	176,824	54	26,393	<50	<0.3	<0.3	<0.3	<0.5	-	68,000	<0.3	<0.3	<0.3	<0.5	-
02/24/97	267,030	177,634	25	26,794	<50	<0.3	<0.3	<0.3	<0.5	-	51,000	3,500	3,200	390	2,200	-
03/17/97	267,230	177,834	10	26,911	<50	<0.3	<0.3	<0.3	<0.5	-	89,000	<6	11	<6	14	-
04/21/97	267,415	178,019	5	27,026	<50	<0.3	<0.3	<0.3	<0.5	-	61,000	730	18	130	360	-
05/22/97	276,535	187,139	294	29,375	<50	<0.3	<0.3	<0.3	<0.5	-	850	1.3	<0.3	0.4	4.6	-
06/23/97	281,214	191,818	146	29,408	-	-	-	-	-	-	-	-	-	-	-	-
07/14/97	284,210	194,814	143	29,501	<50	<0.3	<0.3	<0.3	<0.5	-	6,600	<0.3	0.59	<0.3	9	-
08/18/97	298,610	209,214	411	30,293	-	-	-	-	-	-	-	-	-	-	-	-
09/15/97	301,043	211,647	87	30,427	-	-	-	-	-	-	-	-	-	-	-	-
10/07/97	333,480	244,084	1,474	44,014	<50	<0.3	<0.3	<0.3	<0.5	-	94,000	<0.3	<0.3	<0.3	<0.5	-
11/17/97	334,286	244,890	20	44,645	-	-	-	-	-	-	-	-	-	-	-	-
12/08/97	334,382	244,986	5	44,720	-	-	-	-	-	-	-	-	-	-	-	-
12/12/97	334,382	244,986	-	44,720	Shut down system due to stolen equipment						-	-	-	-	-	-
04/08/98	334,382	244,986	-	44,720	<50	<0.3	<0.3	<0.3	<0.5	<20	3,100	12	1	<0.3	490	2,800
05/11/98	334,382	244,986	-	44,720	-	-	-	-	-	-	-	-	-	-	-	-
06/22/98	334,382	244,986	-	44,720	-	-	-	-	-	-	-	-	-	-	-	-

TABLE 3
GROUNDWATER REMEDIATION SYSTEM MONITORING PROGRAM
 Thrifty Oil Co. Station No 049, OAKLAND, CA

Date	Totalizer (gallons)	Total/Cum. Discharge (gallons)	Flow (gal/day)	Total H-C Removed (lbs)	EFFLUENT (ug/L)						INFLUENT (ug/L)					
					TPH-g	B	T	E	X	MTBE	TPH-g	B	T	E	X	MTBE
07/20/98	334,382	244,986	-	44,720	<50	<0.3	<0.3	<0.3	<0.5	-	52,000	8	0.52	0.83	1.5	-
08/03/98	346,521	257,125	867	49,977	Shut down system for carbon canisters replacement											
09/17/98	354,985	265,589	188	53,642	-	-	-	-	-	-	-	-	-	-	-	-
10/14/98	358,015	268,619	112	54,338	<50	<0.3	<0.3	<0.3	1.6	-	3,100	45	13	3.5	350	-
11/05/98	359,600	270,204	72	54,378	System shut down due to vandalism and stolen equipment											
11/20/98	359,600	270,204	-	54,378	Restart											
12/11/98	369,452	280,056	469	54,633	-	-	-	-	-	-	-	-	-	-	-	-
12/24/98	-	280,056	-	54,633	No reading, meter broken											
01/15/99	0	280,056	-	54,633	Replaced Flowmeter started at 0											
01/21/99	985.5	281,042	164	54,636	57	<0.3	<0.3	<0.3	0.76	-	380	6.2	1	<0.3	9.1	-
02/12/99	1,971.0	282,027	45	54,639	-	-	-	-	-	-	-	-	-	-	-	-
03/12/99	4,390.0	284,446	86	54,647	-	-	-	-	-	-	-	-	-	-	-	-
04/15/99	8,595.0	288,651	124	54,661	<50	<0.3	<0.3	<0.3	<0.5	<5	410	1.6	0.78	<0.3	5	*580 / 330
05/04/99	9,410.0	289,466	43	54,663	-	-	-	-	-	-	-	-	-	-	-	-
05/18/99	9,410.0	289,466	-	54,663	Shut down system for pump controller repair by manufacturer											
09/20/99	9,411.0	289,467	0	54,663	Restart the system											
09/24/99	9,412.4	289,468	0	54,663	-	-	-	-	-	-	-	-	-	-	-	-
10/13/99	9,509.8	289,566	5	54,666	<50	<0.3	<0.3	<0.3	<0.5	<5	6,000	<0.3	<0.3	<0.3	<0.5	13,000
11/12/99	9,701.9	289,758	6	54,676	-	-	-	-	-	-	-	-	-	-	-	-
12/17/99	9,893.7	289,950	5	54,685	-	-	-	-	-	-	-	-	-	-	-	-
01/20/00	10,052.1	290,108	5	54,693	<50	<0.3	<0.3	<0.3	<0.5	-	<50	<0.3	<0.3	<0.3	<0.5	-
02/17/00	10,156.6	290,213	4	54,698	-	-	-	-	-	-	-	-	-	-	-	-
03/13/00	10,354.7	290,411	8	54,708	-	-	-	-	-	-	-	-	-	-	-	-
04/05/00	10,545.7	290,602	8	54,897	72.7	1.8	4.1	0.7	6.7	-	119,000	2,360	6,440	6,240	25,200	*30,800 / 21,800
05/19/00	11,071.7	291,128	12	55,419	Shut down system for carbon drum replacement											
06/05/00	11,075.4	291,131	0	55,419	Restart the system											
06/14/00	11,131.6	291,188	6	55,474	<50	<0.3	<0.3	<0.3	<0.6	<5	<1,000	<6	<6	<6	14	24,500
07/06/00	11,362.0	291,418	10	55,703	Shut down system for carbon replacement											
07/17/00	0.0	291,418	-	55,703	Restart the system after carbon change, repipe and flowmeter change (starting at 0.0)											
07/24/00	411.0	291,829	59	55,907	<50	<0.3	<0.3	<0.3	<0.6	<5	205	<0.3	1	<0.3	<0.6	*99 / 104
08/21/00	8,193.0	299,611	278	55,920	-	-	-	-	-	-	-	-	-	-	-	-
09/18/00	27,251.0	318,669	681	55,953	-	-	-	-	-	-	-	-	-	-	-	-
10/18/00	54,280.0	345,698	901	96,155	<50	<0.18	<0.14	<0.18	<0.26	<0.24	357,000	2,380	2,960	1,290	6,850	9,630
10/30/00	64,610.0	356,028	861	126,867	-	-	-	-	-	-	-	-	-	-	-	-
11/27/00	79,870.0	371,288	545	172,235	-	-	-	-	-	-	-	-	-	-	-	-
12/22/00	99,240.0	390,658	775	229,823	-	-	-	-	-	-	-	-	-	-	-	-
01/17/01	101,250.0	392,668	77	233,018	<50	<0.18	<0.14	<0.18	<0.26	<0.24	24,700	783	373	2	3,480	15,000
02/23/01	144,120.0	435,538	1,159	241,836	-	-	-	-	-	-	-	-	-	-	-	-
03/30/01	195,400.0	486,818	1,465	252,385	-	-	-	-	-	-	-	-	-	-	-	-

TABLE 3
GROUNDWATER REMEDIATION SYSTEM MONITORING PROGRAM
 Thrifty Oil Co. Station No 049, OAKLAND, CA

Date	Totalizer (gallons)	Total/Cum. Discharge (gallons)	Flow (gal/day)	Total H-C Removed (lbs)	EFFLUENT (ug/L)						INFLUENT (ug/L)					
					TPH-g	B	T	E	X	MTBE	TPH-g	B	T	E	X	MTBE
04/06/01	199,090.0	490,508	527	253,144	System shut down for carbon replacement. Replaced on 4/11/01, restart on 4/13/01											
04/20/01	207,050.0	498,468	569	255,172	88	<0.18	<0.14	<0.18	<0.26	93	36,500	855	716	659	1,570	11,400
04/27/01	210,640.0	502,058	513	256,263	System shut down for repair/replacement of compressor's pressure switch and exhaust valve											
04/30/01	210,640.0	502,058	-	256,263	320	<0.18	<0.14	<0.18	<0.26	*337 / 60	7,620	268	22	10	124	*13,600 / 9,130
05/11/01	210,640.0	502,058	-	256,263	Replaced pressure switch on 5/7/01, system still off for carbon replacement											
05/21/01	210,640.0	502,058	-	256,263	Restart the system											
05/30/01	226,830.0	518,248	1,799	263,289	<50	<0.18	<0.14	<0.18	<0.26	<0.24	96,600	4,980	1,660	2,770	11,300	*53,600 / 41,600
06/29/01	267,230.0	558,648	1,347	295,790	-	-	-	-	-	-	-	-	-	-	-	-
07/11/01	310,010.0	601,428	3,565	341,855	<50	<0.18	<0.14	<0.18	<0.26	<0.24	162,000	<0.18	4,140	4,760	24,000	<0.24
08/17/01	441,270.0	732,688	3,548	518,940	-	-	-	-	-	-	-	-	-	-	-	-
09/28/01	498,310.0	789,728	1,358	595,894	-	-	-	-	-	-	-	-	-	-	-	-
10/03/01	503,930.0	795,348	1,124	600,424	<50	<0.18	<0.14	<0.18	<0.26	<0.24	31,600	<1.8	150	294	5,280	<2.4
11/12/01	664,700.0	956,118	4,019	642,733	-	-	-	-	-	-	-	-	-	-	-	-
12/28/01	706,300.0	997,718	904	653,680	-	-	-	-	-	-	-	-	-	-	-	-
01/11/02	721,050.0	1,012,468	1,054	657,562	System shut down for carbon replacement											
01/21/02	721,050.0	1,012,468	-	657,562	Restart the system											
02/01/02	731,320.0	1,022,738	934	658,963	<100	<0.3	<0.3	<0.3	<0.6	<5	1,172	1	1	1	6	<5
02/22/02	751,340.0	1,042,758	953	659,159	-	-	-	-	-	-	-	-	-	-	-	-
03/27/02	813,240.0	1,104,658	1,876	659,763	-	-	-	-	-	-	-	-	-	-	-	-
04/12/02	835,170.0	1,126,588	1,371	660,975	<50	<0.18	<0.14	<0.18	<0.26	<0.24	12,100	5	1	<0.18	<0.26	18,400
04/26/02	918,670.0	1,210,088	5,964	669,389	System shut down											
05/10/02	918,680.0	1,210,098	1	669,390	Restart											
05/17/02	928,670.0	1,220,088	1,427	670,397	-	-	-	-	-	-	-	-	-	-	-	-
06/03/02	-	-	-	-	-	<0.5	<0.7	<0.8	<3.3	-	Outlet sampling results from EBMUD (sample collected by EBMUD inspector)					
06/03/02	-	-	-	-	<50	<0.18	<0.14	<0.18	<0.26	<0.24	Split-sample results (sample collected by us)					
06/07/02	971,240.0	1,262,658	2,027	674,686	-	-	-	-	-	-	-	-	-	-	-	-
06/28/02	1,012,150.0	1,303,568	1,948	678,809	-	-	-	-	-	-	-	-	-	-	-	-
07/15/02	1,045,670.0	1,337,088	1,972	681,977	<50	<0.18	<0.14	<0.18	<0.26	3.3 J	10,600	<0.18	<0.14	<0.18	<0.26	10,000
07/31/02	1,052,380.0	1,343,798	419	682,569	System shut down for carbon replacement											
08/16/02	1,052,390.0	1,343,808	1	682,569	Restart											
08/30/02	1,057,310.0	1,348,728	351	683,004	-	-	-	-	-	-	-	-	-	-	-	-
09/20/02	-	-	-	-	Sample results from EBMUD not received yet						Outlet sampling results from EBMUD (sample collected by EBMUD inspector)					
09/20/02	1,061,730.0	1,353,148	210	683,394	<50	<0.1	<0.15	<0.06	-	-	Split-sample results (sample collected by us, analysis by EPA 624 & 8015M)					
09/27/02	1,064,020.0	1,355,438	327	683,596	-	-	-	-	-	-	-	-	-	-	-	-
10/04/02	1,069,130.0	1,360,548	730	683,787	<50	<0.18	<0.14	<0.18	<0.26	<0.24	4,500 J	<0.18	<0.14	<0.18	<0.26	2,570
10/25/02	1,082,500.0	1,373,918	637	684,289	-	-	-	-	-	-	-	-	-	-	-	-
11/29/02	1,108,680.0	1,400,098	748	685,270	-	-	-	-	-	-	-	-	-	-	-	-
12/27/02	1,123,890.0	1,415,308	543	685,840	-	-	-	-	-	-	-	-	-	-	-	-
01/03/03	1,128,910.0	1,420,328	717	686,028	System shut down for carbon replacement											

TABLE 3
GROUNDWATER REMEDIATION SYSTEM MONITORING PROGRAM
 Thrifty Oil Co Station No 049, OAKLAND, CA

Date	Totalizer (gallons)	Total/Cum. Discharge (gallons)	Flow (gal/day)	Total H-C Removed (lbs)	EFFLUENT (ug/L)						INFLUENT (ug/L)					
					TPH-g	B	T	E	X	MTBE	TPH-g	B	T	E	X	MTBE
4/8/91	1,310	0	-	0.000	-	<0.3	<0.3	<0.3	<0.9	-	-	910	2000	160	2000	-
4/15/91	1,434	124	18	0.049	-	<0.3	<0.3	<0.3	<0.3	-	-	2800	4600	310	5000	-
4/22/91	1,510	200	11	0.078	-	<15	<15	<15	<45	-	-	3100	3300	<15	2800	-
4/29/91	1,660	350	21	0.137	-	<0.3	<0.3	<0.3	<0.9	-	-	3600	4500	300	5000	-
5/6/91	1,740	430	11	0.168	-	<0.3	<0.3	<0.3	<0.9	-	-	3600	3500	300	3800	-
5/13/91	1,880	570	20	0.223	-	<0.3	<0.3	<0.3	<0.9	-	-	3300	3200	230	3900	-
5/20/91	2,010	700	19	0.274	-	<0.3	<0.3	<0.3	<0.9	-	-	3300	3400	260	5100	-
5/28/91	2,050	740	5	0.290	-	<0.3	<0.3	<0.3	<0.9	-	-	2900	3000	230	4200	-
6/3/91	2,110	800	10	0.313	-	<0.3	<0.3	<0.3	<0.9	-	-	2500	2100	110	2800	-
6/10/91	2,160	850	7	0.333	-	<0.3	<0.3	<0.3	<0.9	-	-	1800	1700	120	2100	-
6/17/91	2,219	909	8	0.356	-	<0.3	<0.3	<0.3	<0.9	-	-	2100	1900	170	2700	-
6/24/91	2,263	953	6	0.373	-	<0.3	<0.3	<0.3	<0.9	-	-	2100	1800	150	2700	-
07/01/91	2,313	1,003	7	0.393	-	<0.5	<0.5	<1	<1	-	-	2,700	2,000	150	2,900	-
07/08/91	2,700	1,390	55	0.544	-	<0.5	<0.5	<1	<1	-	-	4,000	2,500	130	4,400	-
07/15/91	2,872	1,562	25	0.611	-	<0.5	<0.5	<1	<1	-	-	3,100	1,900	140	3,200	-
07/22/91	3,144	1,834	39	0.718	-	<0.5	<0.5	<1	<1	-	-	3,400	2,100	110	2,800	-
07/29/91	3,220	1,910	11	0.748	-	<0.5	<0.5	<1	<1	-	-	5,100	2,200	180	2,700	-
08/05/91	3,348	2,038	18	0.798	-	<0.5	<0.5	<1	<1	-	-	5,100	3,900	400	4,200	-
08/12/91	3,472	2,162	18	0.846	-	<0.5	<0.5	<1	<1	-	-	11,000	6,200	440	8,400	-
08/19/91	3,548	2,238	11	0.876	-	<0.5	<0.5	<1	<1	-	-	4,500	2,400	130	2,600	-
08/26/91	3,655	2,345	15	0.918	-	<0.5	<0.5	<1	<1	-	-	4,400	2,500	260	3,600	-
09/09/91	3,822	2,512	12	0.983	-	<0.5	<0.5	<1	<1	-	-	5,200	3,000	390	3,700	-
09/16/91	3,884	2,574	9	1.007	-	<0.5	<0.5	<1	<1	-	-	4,100	2,000	460	4,900	-
09/23/91	4,013	2,703	18	1.058	-	<0.5	<0.5	<1	<1	-	-	4,600	1,600	710	6,400	-
09/30/91	4,092	2,782	11	1.089	-	<0.5	<0.5	<1	<1	-	-	5,700	2,000	380	6,200	-
10/07/91	4,131	2,821	6	1.104	System shut down											
10/14/91	4,195	2,885	9	1.129	-	<0.5	<0.5	<1	<1	-	-	4,400	2,000	370	8,100	-
10/21/91	4,406	3,096	30	1.212	-	<0.5	<0.5	<1	<1	-	-	2,300	1,100	190	4,200	-
10/28/91	4,474	3,164	10	1.238	-	<0.5	<0.5	<1	<1	-	-	6,400	4,100	620	6,100	-
11/03/91	4,613	3,303	23	1.293	-	<0.5	<0.5	<1	<1	-	-	6,100	2,800	200	5,600	-
11/11/91	4,700	3,390	11	1.327	-	<0.5	<0.5	<1	<1	-	-	6,500	2,300	<30	4,900	-
11/18/91	4,887	3,577	27	1.400	-	<0.5	<0.5	<1	<1	-	-	5,600	2,500	300	4,600	-
11/25/91	5,042	3,732	22	1.461	-	<0.5	<0.5	<1	<1	-	-	5,400	2,800	230	5,700	-
12/03/91	5,263	3,953	28	1.547	-	<0.5	<0.5	<1	<1	-	-	7,200	3,300	490	5,500	-
12/09/91	5,362	4,052	17	1.586	-	<0.5	<0.5	<1	<1	-	-	4,400	1,700	140	3,900	-
12/16/91	5,486	4,176	18	1.635	-	<0.5	<0.5	<0.5	<0.5	-	-	4,700	2,300	310	4,600	-
12/23/91	5,516	4,206	4	1.646	-	<0.5	<0.5	<0.5	<0.5	-	-	4,000	2,200	290	5,900	-
12/30/91	5,575	4,265	8	1.669	-	<0.5	<0.5	<0.5	<0.5	-	-	5,200	2,500	350	5,800	-
01/15/92	5,720	4,410	9	1.726	-	<0.5	<0.5	<0.5	<0.5	-	-	3,400	1,900	300	6,300	-

TABLE 3
GROUNDWATER REMEDIATION SYSTEM MONITORING PROGRAM
 Thrifty Oil Co. Station No 049, OAKLAND, CA

Date	Totalizer (gallons)	Total/Cum. Discharge (gallons)	Flow (gal/day)	Total H-C Removed (lbs)	EFFLUENT (ug/L)						INFLUENT (ug/L)						
					TPH-g	B	T	E	X	MTBE	TPH-g	B	T	E	X	MTBE	
01/10/03	1,128,970.0	1,420,388	9	686,030	Restart												
01/17/03	1,132,560.0	1,423,978	513	686,999	<50	<0.14	<0.07	<0.08	1.1	<2.0	32,400	11	64	<0.8	6,050	706	
01/31/03	1,143,290.0	1,434,708	766	689,460	<15	<0.04	0.58	<0.02	1.1	<0.03	22,700	14	34	18	5,160	550	
02/14/03	1,153,670.0	1,445,088	741	691,423	System shut down for carbon replacement												
04/04/03	1,153,670.0	1,445,088	-	691,423	System shut down for upgrade												

WD PERMIT LIMITS:	NE	5.0	5.0	5.0	5.0	NE
--------------------------	----	-----	-----	-----	-----	----

Note: < = less than laboratory detection level indicated
 - = no sample / not analyzed
 NE = Permit Limit not established

TPH is analyzed by EPA Method 8015 M
 BTEX is analyzed by EPA Method 602 or 8020
 *MTBE 8020/8260

In February 2000, the total cumulative discharge amount was corrected to reflect all system maintenance and flowmeter changeouts since the startup of the system. The total number may be different from previous versions of this table
 Total Hydrocarbons Removed = From 4/8/91 to 2/10/92, the influent TPHg is assumed to be 47,000 (3/9/92)

FIGURES

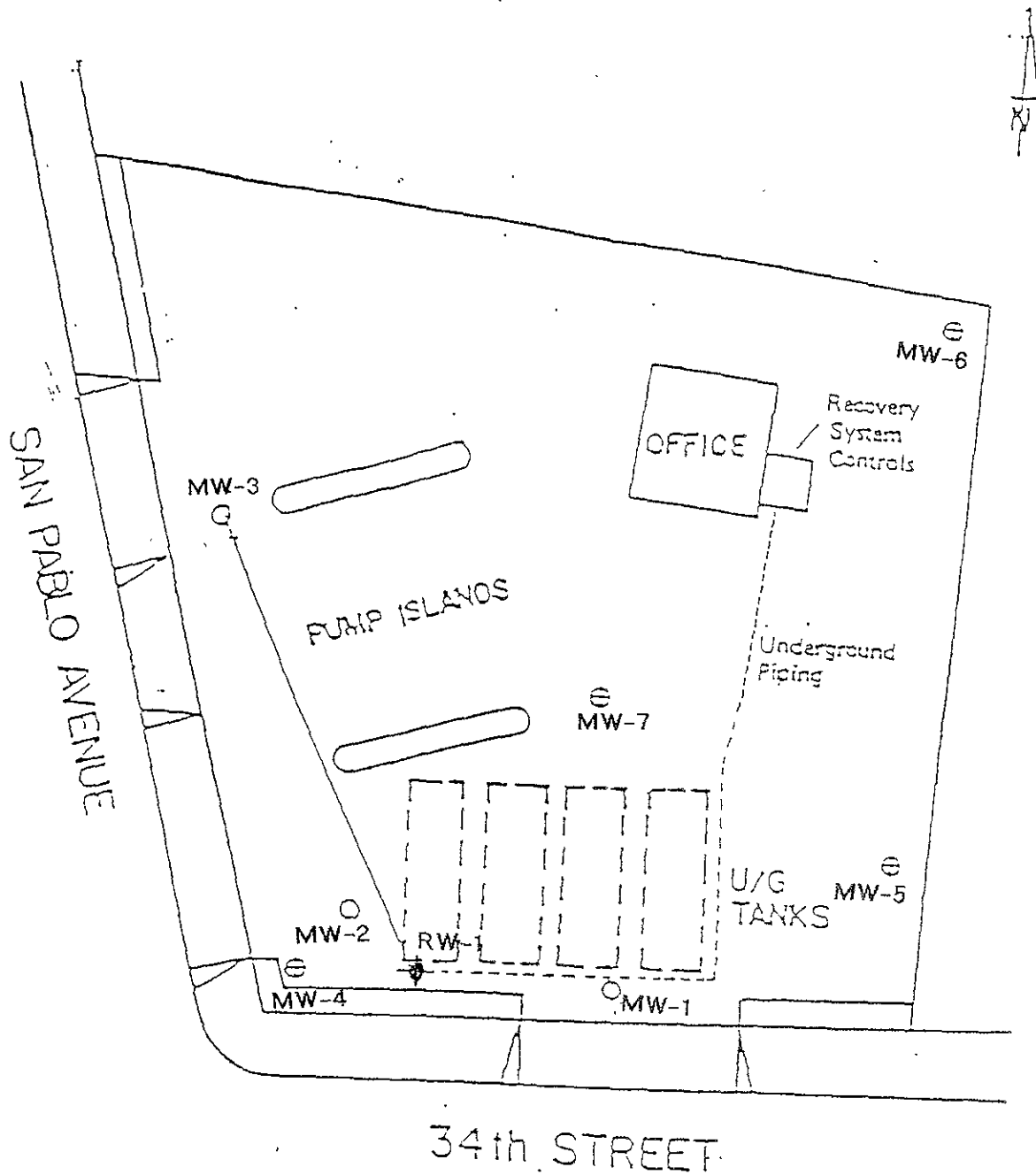

SITE PLAN AND RECOVERY SYSTEM LOCATION
 THRIFTY SERVICE STATION NO. 49
 3400 SAN PABLO AVE.
 OAKLAND, CA

LEGEND

- MW1 - GT MONITORING WELLS
- ⊕ MW-4 - WCC MONITORING WELLS
- ⊕ RW-1 - PROPOSED RECOVERY WELL

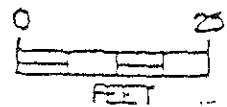
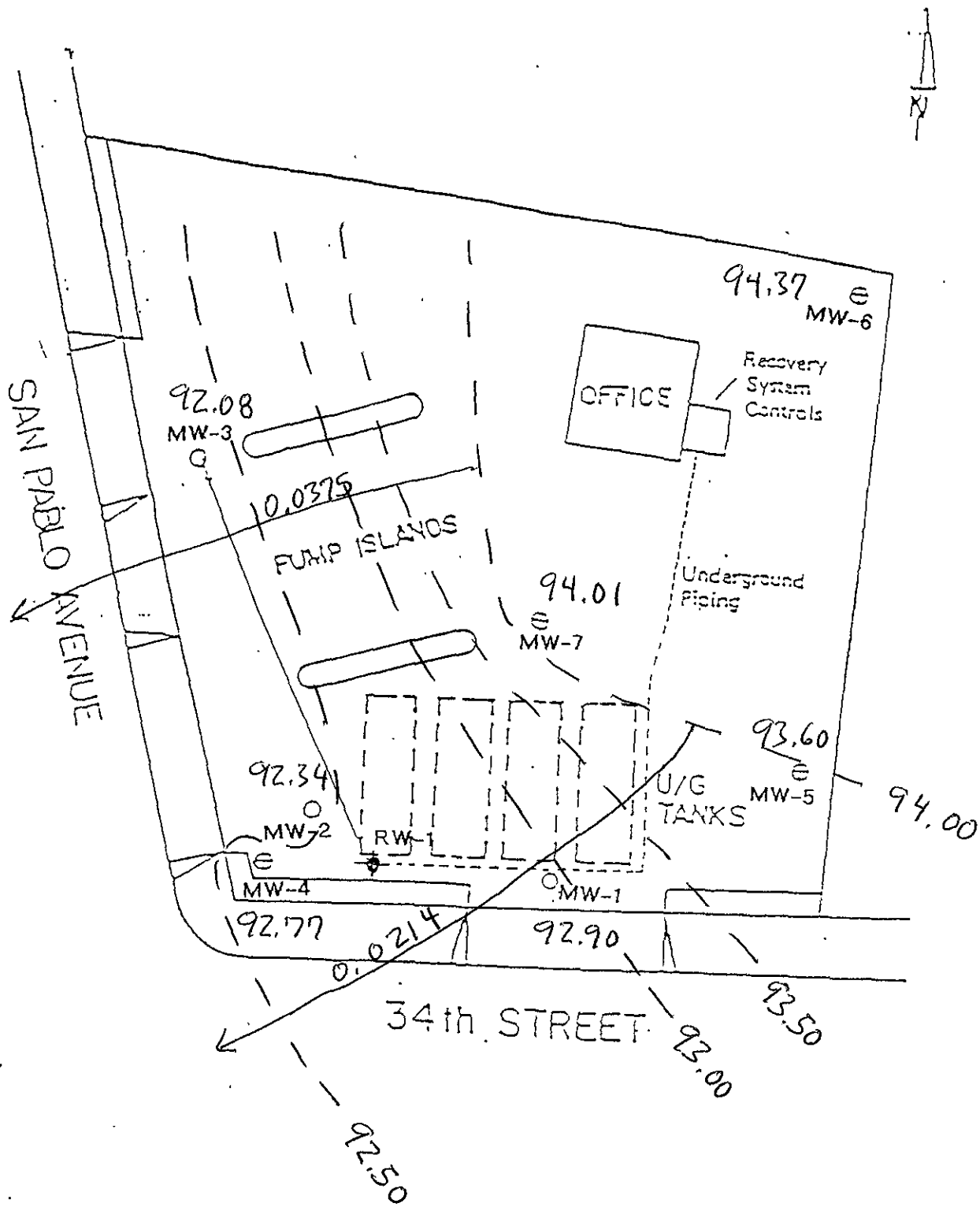

FIGURE 1



10/20/2003
 Datum is Mean
 Sea Level
LEGEND

GROUNDWATER CONTOUR MAP
 THRIFTY SERVICE STATION NO. 49
 3400 SAN PABLO AVE.
 OAKLAND, CA

- MW-1 - GT MONITORING WELLS
- ⊕ MW-4 - WCC MONITORING WELLS
- ⊕ RW-1 - PROPOSED RECOVERY WELL

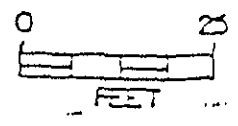
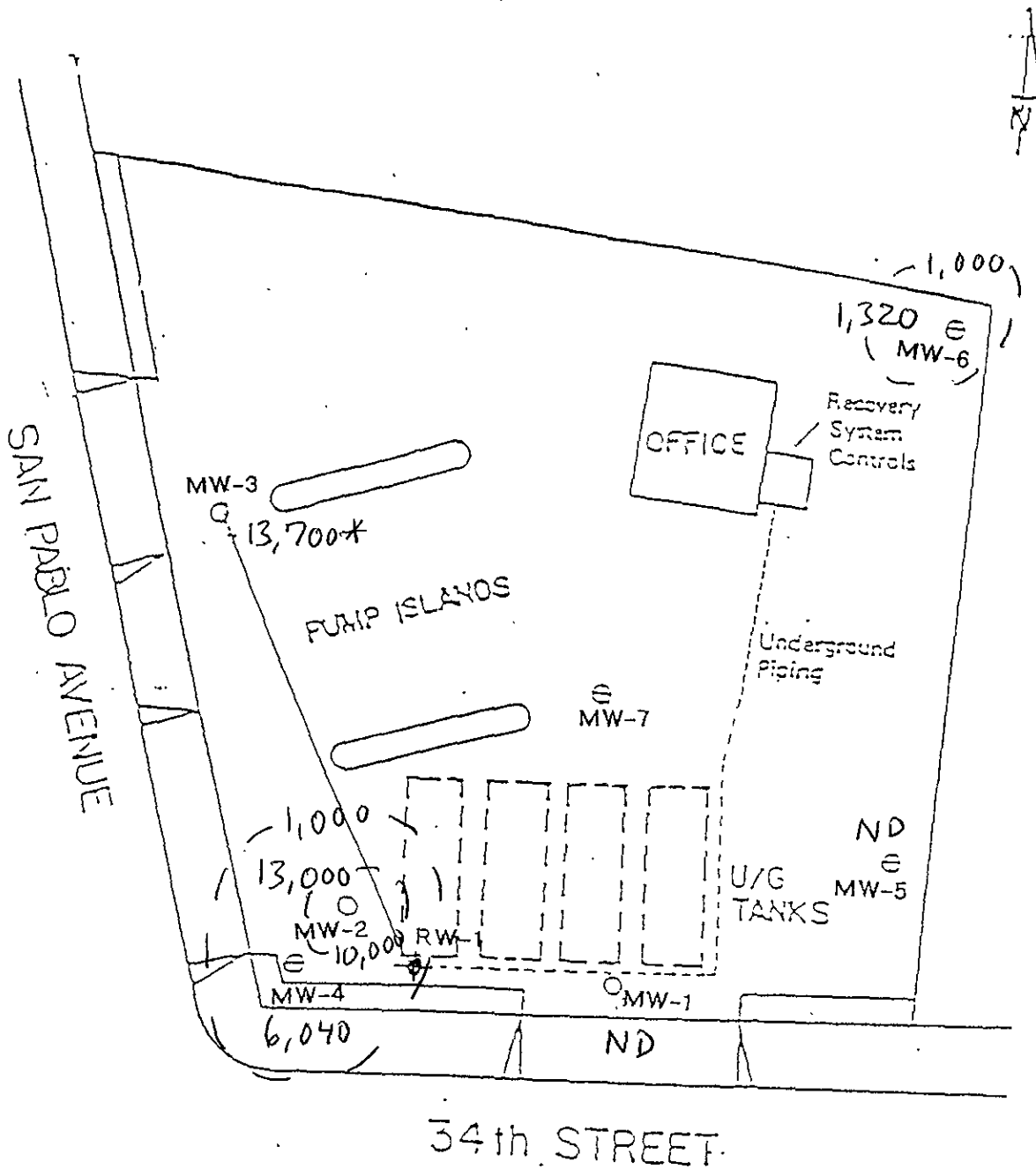

FIGURE 2



10/20/2003

ug/L

* TPH_g data anomalous -
Not Contoured

TPH ISOCONCENTRATION MAP ug/L
THRIFTY SERVICE STATION NO. 49
3400 SAN PABLO AVE.
OAKLAND, CA

LEGEND

- MW1 - GT MONITORING WELLS
- ⊖ MW-4 - WCC MONITORING WELLS
- ⊕ RW-1 - PROPOSED RECOVERY WELL

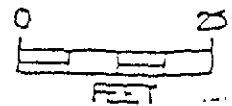
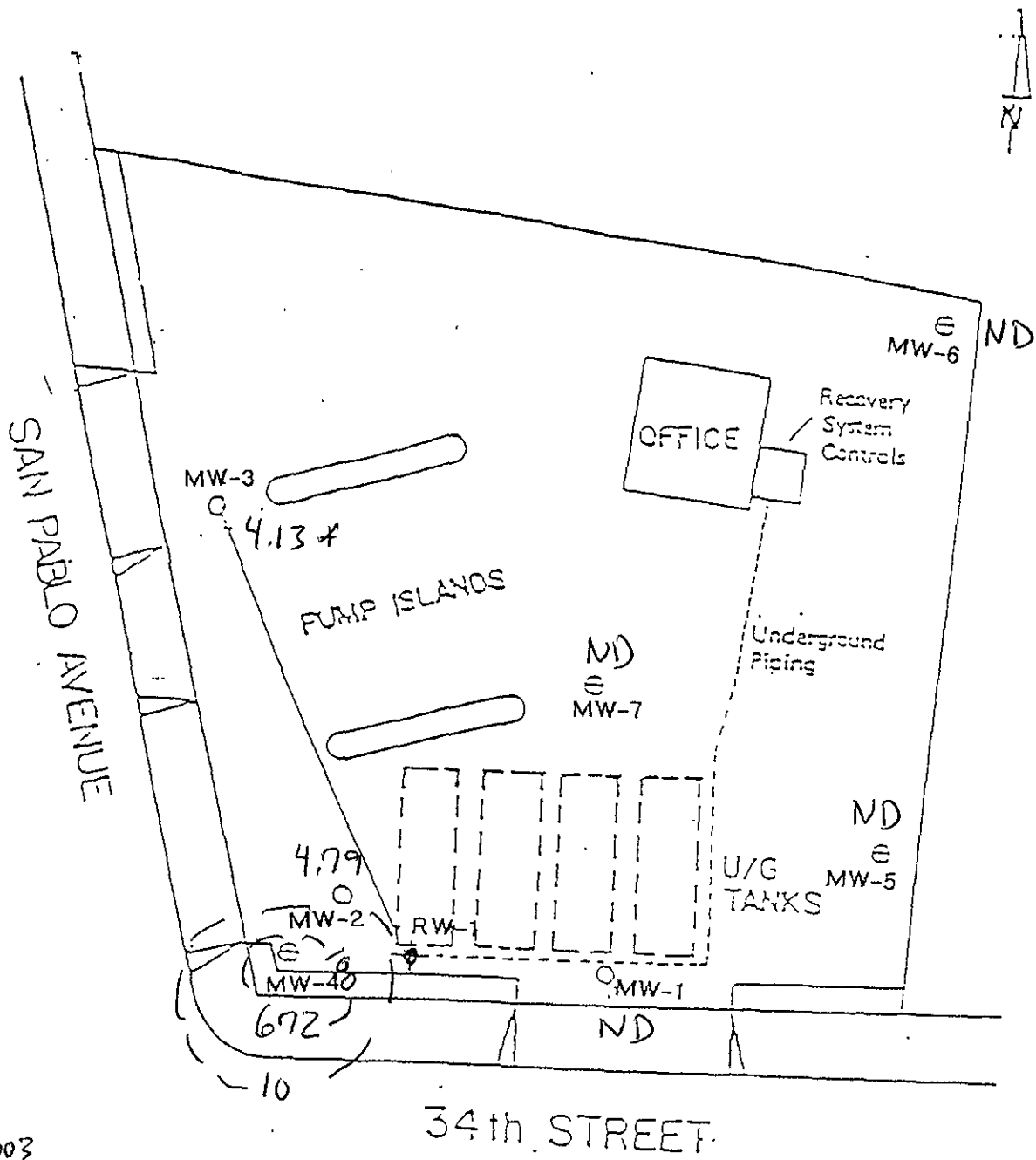

FIGURE 3



10/20/2003

ug/L

* Benzene data anomalous
Not Contoured

BENZENE ISOCONCENTRATION MAP ug/L
THRIFTY SERVICE STATION NO. 49
3400 SAN PABLO AVE.
OAKLAND, CA

LEGEND

- MW1 - GT MONITORING WELLS
- ⊕ MW-4 - WCC MONITORING WELLS
- ⊕ RW-1 - PROPOSED RECOVERY WELL

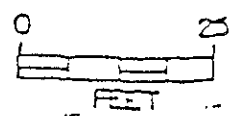
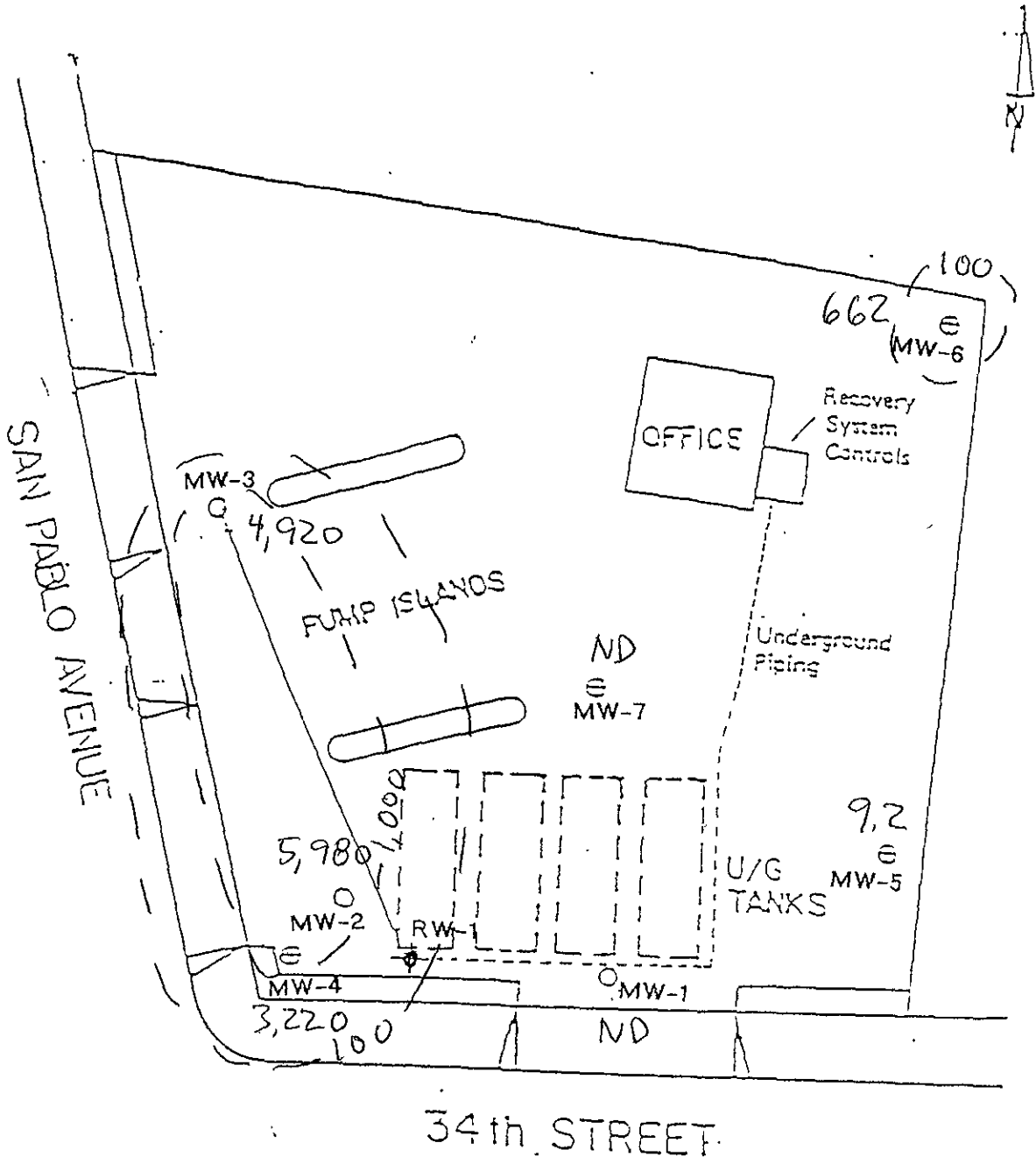

FIGURE 4



MTBE ISOCONCENTRATION MAP ug/L
 THRIFTY SERVICE STATION NO. 49
 3400 SAN PABLO AVE.
 OAKLAND, CA

LEGEND

- MW1 - GT MONITORING WELLS
- ⊕ MW4 - WCC MONITORING WELLS
- ⊕ RW-1 - PROPOSED RECOVERY WELL

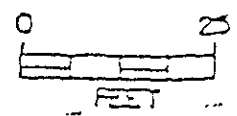

FIGURE 5

APPENDIX A



PROJECT STATUS REPORT

SITE: THRIFTY OIL CO. #049
 ADDRESS: 3400 SAN PABLO AVE.
OAKLAND, CA. 94612

DATE: 10-20-03

PERSONNEL: SERBAN

WELL ID	DTP (FT)	DTW (FT)	DTB (FT)	PT (FT)	WC (FT)	DIA (IN)	PURGE (GAL)		COMMENT
							EST.	ACT.	
MONTHLY/QUARTERLY									
MW-1		5.13	17.74		12.61	2"	8	10	
MW-2		5.10	23.76		18.66	2"	12	12	
MW-3		5.61	24.16		18.55	2"	12	12	
MW-4		4.56	13.60		9.04	4"	24	24	
MW-5		5.25	13.76		8.51	2"	6	10	
MW-6		5.30	13.04		7.74	2"	5	10	
MW-7		5.01	13.56		8.55	4"	22	22	
RW-1		-	-		-	6"	-	-	

FREE PRODUCT REMOVED: APPROX. - GALLONS

PURGE-WATER REMOVED: APPROX. 100 GALLONS

REMARKS: RW-1 CAN'T BE SAMPLE BECAUSE AROUND 5F 90" IS OBSTRUCT WITH SILT -

EXPLANATION:

DTP= DEPTH TO PRODUCT, DTW= DEPTH TO WATER, DTB= DEPTH TO BOTTOM; ALL MEASURED FROM TOP OF CASING
 PT= PRODUCT THICKNESS, WC= WATER COLUMN, DIA= DIAMETER, EST=ESTIMATE, ACT= ACTUAL, FT= FEET, GAL= GALLONS

REV: 8/28/02

FIELD DATA -GROUNDWATER SAMPLING PROGRAM

Site:	<u>H 049</u>	Date:	<u>10-20-03</u>
Address:			
Personnel:	<u>SEEBACH</u>	Weather:	<u>SUNNY DAY</u>
Well No:	<u>MW-1</u>	Equip:	<u>BAUER</u>

<u>Before Purging:</u>			
Total Well Depth: (ft.)	<u>17.74</u>	Well Diameter	<u>2"</u>
Depth to Water (ft)	<u>5.13</u>	Est. Purge Volume:	<u>8</u>

<u>Sampling Data:</u>							
Initial Turbidity:				Final Turbidity:			
Time	9:36	9:38	9:40	9:42	9:45	9:47	9:50
EC	1810	1820	1830	1820	1810	1820	1810
pH	5.60	5.70	5.76	5.86	5.72	5.86	5.76
Temp	73.1	73.1	72.8	72.7	72.6	72.7	72.6
Gal.	1	2	3	4	5	6	8
Time							
EC							
pH							
Temp							
Gal.							

<u>After Purging/Before Sample Collection</u>	
Depth to Water (ft.)	<u>8.11</u> Total Well Depth(ft.) <u>17.74</u>

FIELD DATA -GROUNDWATER SAMPLING PROGRAM

Site: # 049	Date: 10-20-03
Address:	
Personnel: SERBOM	Weather: SUNNY DAY
Well No: MW-2	Equip: BAUER

Before Purging:			
Total Well Depth: (ft.)	23.76	Well Diameter	24
Depth to Water (ft)	5.10	Est. Purge Volume:	12

Sampling Data:							
Initial Turbidity:				Final Turbidity:			
Time	11:28	11:30	11:32	11:34	11:36	11:38	11:40
EC	1420	1420	1410	1390	1370	1360	1340
pH	6.22	6.18	6.24	6.11	6.13	6.12	6.10
Temp	72.2	72.1	71.8	71.9	71.7	71.6	71.6
Gal.	1	3	5	6	8	10	12
Time							
EC							
pH							
Temp							
Gal.							

After Purging/Before Sample Collection	
Depth to Water (ft.)	9.21
Total Well Depth(ft).	23.76

FIELD DATA - GROUNDWATER SAMPLING PROGRAM

Site:	# 044	Date:	10-20-03
Address:			
Personnel:	SERBADA	Weather:	SUNNY DAY
Well No:	MW-2	Equip:	BAILER

Before Purging:			
Total Well Depth: (ft.)	24.16	Well Diameter	2"
Depth to Water (ft)	5.61	Est. Purge Volume:	12

Sampling Data:							
Initial Turbidity:				Final Turbidity:			
Time	9:56	9:58	10:00	10:03	10:05	10:07	10:10
EC	1840	1830	1820	1740	1740	1820	1820
pH	5.76	5.71	5.50	5.52	5.51	5.50	5.51
Temp	71.3	71.2	71.2	70.9	70.7	70.6	70.6
Gal.	1	3	5	6	8	10	12
Time							
EC							
pH							
Temp							
Gal.							

After Purging/Before Sample Collection	
Depth to Water (ft.)	10.04
Total Well Depth(ft).	24.16

FIELD DATA - GROUNDWATER SAMPLING PROGRAM

Site:	# 049	Date:	10-20-03
Address:			
Personnel:	JERBAZ	Weather:	SUNNY DAY
Well No:	MW-4	Equip:	BAILED

Before Purging:			
Total Well Depth: (ft.)	13.60	Well Diameter	4"
Depth to Water (ft)	4.56	Est. Purge Volume:	24

Sampling Data:							
	Initial Turbidity:			Final Turbidity:			
Time	10:57	11:00	11:05	11:09	11:13	11:16	11:20
EC	1340	1310	1290	1280	1280	1266	1280
pH	5.28	5.38	5.24	5.22	5.20	5.23	5.21
Temp	73.2	73.1	72.8	72.7	72.6	72.4	72.2
Gal.	3	6	10	13	17	20	24
Time							
EC							
pH							
Temp							
Gal.							

After Purging/Before Sample Collection	
Depth to Water (ft.)	4.11
Total Well Depth(ft).	13.60

FIELD DATA - GROUNDWATER SAMPLING PROGRAM

Site:	<u>H 049</u>	Date:	<u>10-20-03</u>
Address:			
Personnel:	<u>STERBAN</u>	Weather:	<u>SUNNY DAY</u>
Well No:	<u>MW-5</u>	Equip:	<u>BAILER</u>

Before Purging:			
Total Well Depth: (ft.)	<u>13.76</u>	Well Diameter	<u>2'</u>
Depth to Water (ft)	<u>5.25</u>	Est. Purge Volume:	<u>6</u>

Sampling Data:							
Initial Turbidity:				Final Turbidity:			
Time	<u>9:18</u>	<u>9:20</u>	<u>9:22</u>	<u>9:24</u>	<u>9:26</u>	<u>9:28</u>	<u>9:30</u>
EC	<u>1720</u>	<u>1750</u>	<u>1770</u>	<u>1780</u>	<u>1770</u>	<u>1870</u>	<u>1780</u>
pH	<u>6.04</u>	<u>6.10</u>	<u>6.06</u>	<u>6.11</u>	<u>6.13</u>	<u>6.10</u>	<u>6.10</u>
Temp	<u>71.2</u>	<u>71.1</u>	<u>70.9</u>	<u>70.7</u>	<u>70.5</u>	<u>70.3</u>	<u>70.3</u>
Gal.	<u>0.5</u>	<u>1</u>	<u>2</u>	<u>3</u>	<u>4</u>	<u>5</u>	<u>6</u>
Time							
EC							
pH							
Temp							
Gal.							

After Purging/Before Sample Collection	
Depth to Water (ft.)	<u>8.04</u> Total Well Depth(ft). <u>13.76</u>

FIELD DATA - GROUNDWATER SAMPLING PROGRAM

Site:	# 049	Date:	10-20-02
Address:			
Personnel:	SERBATA	Weather:	SUNNY DAY
Well No:	MU-6	Equip:	BAUER

Before Purging:			
Total Well Depth: (ft.)	13.04	Well Diameter	2"
Depth to Water (ft)	5.30	Est. Purge Volume:	5

Sampling Data:							
Initial Turbidity:				Final Turbidity:			
Time	10:44	10:45	10:46	10:47	10:48	10:49	10:50
EC	1630	1630	1630	1610	1620	1640	1640
pH	6.13	6.18	6.16	6.17	6.14	6.26	6.26
Temp	72.4	72.3	72.1	72.1	71.8	71.6	71.6
Gal.	0.5	1	2	2.5	3	4	5
Time							
EC							
pH							
Temp							
Gal.							

After Purging/Before Sample Collection			
Depth to Water (ft.)	7.21	Total Well Depth(ft.)	13.04

FIELD DATA - GROUNDWATER SAMPLING PROGRAM

Site:	# 049	Date:	10-20-03
Address:			
Personnel:	SERBAH	Weather:	SUNNY DAY
Well No:	MW-7	Equip:	BAFLER

Before Purging:			
Total Well Depth: (ft.)	13.56	Well Diameter	4"
Depth to Water (ft)	5.01	Est. Purge Volume:	22

Sampling Data:							
Initial Turbidity:				Final Turbidity:			
Time	10:16	10:20	10:23	10:27	10:31	10:36	10:40
EC	1740	1770	1810	1830	1810	1840	1830
pH	6.11	6.31	6.20	6.30	6.20	6.22	6.21
Temp	72.1	71.4	71.8	71.7	71.6	71.4	71.3
Gal.	3	6	9	12	15	18	22
Time							
EC							
pH							
Temp							
Gal.							

After Purging/Before Sample Collection			
Depth to Water (ft.)	7.11	Total Well Depth(ft.)	13.56

APPENDIX B



ASSOCIATED LABORATORIES

806 North Batavia - Orange, California 92868 - 714/771-6900

FAX 714/538-1209

CLIENT Thrifty Oil Company (8871)
ATTN: Jeff Suryakusuma
13116 Imperial Hwy.
P.O. Box 2128
Santa Fe Springs, CA 90670

LAB REQUEST 118630

REPORTED 11/03/2003

RECEIVED 10/22/2003

PROJECT Station #049
3400 San Pablo Ave., Oakland

SUBMITTER Client

COMMENTS Global ID# T0600101366.

This laboratory request covers the following listed samples which were analyzed for the parameters indicated on the attached Analytical Result Report. All analyses were conducted using the appropriate methods as indicated on the report. This cover letter is an integral part of the final report.

<u>Order No.</u>	<u>Client Sample Identification</u>
472000	TOC #049 MW-5
472001	TOC #049 MW-1
472002	TOC #049 MW-3
472003	TOC #049 MW-7
472004	TOC #049 MW-6
472005	TOC #049 MW-4
472006	TOC #049 MW-2
472007	Trip Blank
472008	Laboratory Method Blank

Thank you for the opportunity to be of service to your company. Please feel free to call if there are any questions regarding this report or if we can be of further service.

ASSOCIATED LABORATORIES by,

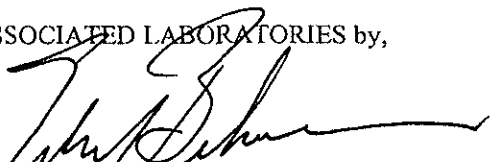
Edward S. Beharc, Ph.D.
Vice President

NOTE: Unless notified in writing, all samples will be discarded by appropriate disposal protocol 30 days from date reported.

The reports of the Associated Laboratories are confidential property of our clients and may not be reproduced or used for publication in part or in full without our written permission. This is for the mutual protection of the public, our clients, and ourselves.

TESTING & CONSULTING
Chemical
Microbiological
Environmental

Order #: 472000**Client Sample ID:** TOC #049 MW-5**Matrix:** WATER**Date Sampled:** 10/20/2003 **Time Sampled:** 14:00

Analyte	Result	DF	PQL	MDL	Units	Date/Analyst
8021B BTEX + MTBE						
Benzene	ND	1	0.3	0.04	ug/L	10/23/03 LZ
Ethyl benzene	ND	1	0.3	0.02	ug/L	10/23/03 LZ
Methyl t - butyl ether	9.11	1	5	0.03	ug/L	10/23/03 LZ
Toluene	ND	1	0.3	0.02	ug/L	10/23/03 LZ
Xylene (total)	ND	1	0.6	0.06	ug/L	10/23/03 LZ
8260B BTEX/MTBE Only						
Methyl-tert-butylether (MTBE)	9.2	1	1	0.18	ug/L	10/31/03 LB
8015M - Gasoline						
Gasoline	ND	1	50	15	ug/L	10/23/03 LZ
Surrogates				Units	Control Limits	
a,a,a-Trifluorotoluene	91			%	55 - 200	

PQL = Practical Quantitation Limit, MDL = Method detection limit, DF = Dilution Factor
 ND = Not detected below indicated MDL, J=Trace



Order #: 472001**Client Sample ID:** TOC #049 MW-1**Matrix:** WATER**Date Sampled:** 10/20/2003 **Time Sampled:** 14:10

Analyte	Result	DF	PQL	MDL	Units	Date/Analyst
8021B BTEX + MTBE						
Benzene	ND	1	0.3	0.04	ug/L	10/23/03 LZ
Ethyl benzene	ND	1	0.3	0.02	ug/L	10/23/03 LZ
Methyl t - butyl ether	ND	1	5	0.03	ug/L	10/23/03 LZ
Toluene	ND	1	0.3	0.02	ug/L	10/23/03 LZ
Xylene (total)	ND	1	0.6	0.06	ug/L	10/23/03 LZ
8015M - Gasoline						
Gasoline	ND	1	50	15	ug/L	10/23/03 LZ
Surrogates					Units	Control Limits
a,a,a-Trifluorotoluene	88				%	55 - 200

PQL = Practical Quantitation Limit, MDL = Method detection limit, DF = Dilution Factor
 ND = Not detected below indicated MDL, J=Trace



Order #: 472002

Client Sample ID TOC #049 MW-3

Matrix: WATER

Date Sampled: 10/20/2003 Time Sampled: 14:20

Analyte	Result	DF	PQL	MDL	Units	Date/Analyst
8021B BTEX + MTBE						
Benzene	4.13	1	0.3	0.04	ug/L	10/23/03 LZ
Ethyl benzene	ND	1	0.3	0.02	ug/L	10/23/03 LZ
Methyl t - butyl ether	6570	200	1000.0	0.03	ug/L	10/23/03 LZ
Toluene	ND	1	0.3	0.02	ug/L	10/23/03 LZ
Xylene (total)	ND	1	0.6	0.06	ug/L	10/23/03 LZ
8260B BTEX/MTBE Only						
Methyl-tert-butylether (MTBE)	4920	1	1	0.18	ug/L	10/31/03 LB
8015M - Gasoline						
Gasoline	13700	200	10000.0	15	ug/L	10/23/03 LZ
Surrogates					Units	Control Limits
a,a,a-Trifluorotoluene	86				%	55 - 200

PQL = Practical Quantitation Limit, MDL = Method detection limit, DF = Dilution Factor
 ND = Not detected below indicated MDL, J=Trace



Order #: 472003**Client Sample ID:** TOC #049 MW-7**Matrix:** WATER**Date Sampled:** 10/20/2003 **Time Sampled:** 14:30

Analyte	Result	DF	PQL	MDL	Units	Date/Analyst
8021B BTEX + MTBE						
Benzene	ND	1	0.3	0.04	ug/L	10/23/03 LZ
Ethyl benzene	ND	1	0.3	0.02	ug/L	10/23/03 LZ
Methyl t - butyl ether	ND	1	5	0.03	ug/L	10/23/03 LZ
Toluene	ND	1	0.3	0.02	ug/L	10/23/03 LZ
Xylene (total)	ND	1	0.6	0.06	ug/L	10/23/03 LZ
8015M - Gasoline						
Gasoline	ND	1	50	15	ug/L	10/23/03 LZ
Surrogates						
a,a,a-Trifluorotoluene	85				Units %	Control Limits 55 - 200

PQL = Practical Quantitation Limit, MDL = Method detection limit, DF = Dilution Factor
ND = Not detected below indicated MDL, J=Trace



Order #: 472004**Client Sample ID:** TOC #049 MW-6**Matrix:** WATER**Date Sampled:** 10/20/2003 **Time Sampled:** 14:50

Analyte	Result	DF	PQL	MDL	Units	Date/Analyst
8021B BTEX + MTBE						
Benzene	ND	1	0.3	0.04	ug/L	10/23/03 LZ
Ethyl benzene	ND	1	0.3	0.02	ug/L	10/23/03 LZ
Methyl t - butyl ether	656	20	100.0	0.03	ug/L	10/23/03 LZ
Toluene	ND	1	0.3	0.02	ug/L	10/23/03 LZ
Xylene (total)	ND	1	0.6	0.06	ug/L	10/23/03 LZ
8260B BTEX/MTBE Only						
Methyl-tert-butylether (MTBE)	662	1	1	0.18	ug/L	10/31/03 LB
8015M - Gasoline						
Gasoline	1320	20	1000.0	15	ug/L	10/23/03 LZ
Surrogates						
a,a,a-Trifluorotoluene	90				%	55 - 200

PQL = Practical Quantitation Limit, MDL = Method detection limit, DF = Dilution Factor
 ND = Not detected below indicated MDL, J=Trace



Order #: 472005**Client Sample ID:** TOC #049 MW-4**Matrix:** WATER**Date Sampled:** 10/20/2003 **Time Sampled:** 15:00

Analyte	Result	DF	PQL	MDL	Units	Date/Analyst
8021B BTEX + MTBE						
Benzene	672	50	15.0	0.04	ug/L	10/23/03 LZ
Ethyl benzene	3.40	5	1.5	0.02	ug/L	10/23/03 LZ
Methyl t - butyl ether	3780	100	500.0	0.03	ug/L	10/23/03 LZ
Toluene	384	50	15.0	0.02	ug/L	10/23/03 LZ
Xylene (total)	444	5	3.0	0.06	ug/L	10/23/03 LZ
8260B BTEX/MTBE Only						
Methyl-tert-butylether (MTBE)	3220	10	10.0	0.18	ug/L	10/31/03 LB
8015M - Gasoline						
Gasoline	6040	50	2500.0	15	ug/L	10/23/03 LZ
Surrogates					Units	Control Limits
a,a,a-Trifluorotoluene	95				%	55 - 200

PQL = Practical Quantitation Limit, MDL = Method detection limit, DF = Dilution Factor
 ND = Not detected below indicated MDL, J=Trace



Order #: 472006**Client Sample ID:** TOC #049 MW-2**Matrix:** WATER**Date Sampled:** 10/20/2003 **Time Sampled:** 15:11

Analyte	Result	DF	PQL	MDL	Units	Date/Analyst
8021B BTEX + MTBE						
Benzene	4.79	1	0.3	0.04	ug/L	10/23/03 LZ
Ethyl benzene	ND	1	0.3	0.02	ug/L	10/23/03 LZ
Methyl t - butyl ether	6330	200	1000.0	0.03	ug/L	10/23/03 LZ
Toluene	ND	1	0.3	0.02	ug/L	10/23/03 LZ
Xylene (total)	ND	1	0.6	0.06	ug/L	10/23/03 LZ
8260B BTEX/MTBE Only						
Methyl-tert-butylether (MTBE)	5980	10	10.0	0.18	ug/L	10/31/03 LB
8015M - Gasoline						
Gasoline	13000	200	10000.0	15	ug/L	10/23/03 LZ
Surrogates						
a,a,a-Trifluorotoluene	86				Units	Control Limits
					%	55 - 200

PQL = Practical Quantitation Limit, MDL = Method detection limit, DF = Dilution Factor
 ND = Not detected below indicated MDL, J=Trace



Order #: 472007**Client Sample ID:** Trip Blank**Matrix:** WATER**Date Sampled:** 10/20/2003 **Time Sampled:** 14:00

Analyte	Result	DF	PQL	MDL	Units	Date/Analyst
8021B BTEX						
Benzene	ND	1	0.3	0.04	ug/L	10/23/03 LZ
Ethyl benzene	ND	1	0.3	0.02	ug/L	10/23/03 LZ
Toluene	ND	1	0.3	0.02	ug/L	10/23/03 LZ
Xylene (total)	ND	1	0.6	0.06	ug/L	10/23/03 LZ
8015M - Gasoline						
Gasoline	ND	1	50	15	ug/L	10/23/03 LZ
Surrogates						
a,a,a-Trifluorotoluene	90				%	55 - 200

PQL = Practical Quantitation Limit, MDL = Method detection limit, DF = Dilution Factor
ND = Not detected below indicated MDL, J=Trace



Order #: 472008**Client Sample ID:** Laboratory Method Blank**Matrix:** WATER

Analyte	Result	DF	PQL	MDL	Units	Date/Analyst
---------	--------	----	-----	-----	-------	--------------

8021B BTEX + MTBE

Benzene	ND	1	0.3	0.04	ug/L	10/23/03 LZ
Ethyl benzene	ND	1	0.3	0.02	ug/L	10/23/03 LZ
Methyl t - butyl ether	ND	1	5	0.03	ug/L	10/23/03 LZ
Toluene	ND	1	0.3	0.02	ug/L	10/23/03 LZ
Xylene (total)	ND	1	0.6	0.06	ug/L	10/23/03 LZ

8260B BTEX/MTBE Only

Methyl-tert-butylether (MTBE)	ND	1	1	0.18	ug/L	10/30/03 LB
-------------------------------	----	---	---	------	------	-------------

8015M - Gasoline

Gasoline	ND	1	50	15	ug/L	10/23/03 LZ
----------	----	---	----	----	------	-------------

Surrogates

				Units	Control Limits
a,a,a-Trifluorotoluene	94			%	55 - 200

PQL = Practical Quantitation Limit, MDL = Method detection limit, DF = Dilution Factor
 ND = Not detected below indicated MDL, J=Trace



ASSOCIATED LABORATORIES
QA REPORT FORM

QC Sample: LCS / LCSD
 Matrix: WATER
 Prep. Date: 10/23/03
 Analysis Date: 10/23/03-10/24/03
 ID#'s in Batch: LR 118630, 118618

Reporting Units = mg/L

PREPARATION BLANK / LAB CONTROL SAMPLE RESULTS

			PREP BLK					
			Value	Result	True	%Rec	L.Limit	H.Limit
Test	Method	LCS	ND	488	500	98	80%	120%
TPH	8015M-G	LCSD	ND	502	500	100	80%	120%

LCS Result = Lab Control Sample Result

True = True Value of LCS

L.Limit / H.Limit = LCS Control Limits

SURROGATE RECOVERY

Sample No.	AAA-TFT
QC Limit	55-200
Method Blank	94
LCS	159
LCSD	159

AAA-TFT = a,a,a-Trifluorotoluene

**ASSOCIATED LABORATORIES
LCS REPORT FORM**

QC Sample: LCS / LCSD
 Matrix: WATER
 Prep. Date: 10/23/03
 Analysis Date: 10/23/03-10/24/03
 LAB ID#'s in Batch: LR 118630, 118618

REPORTING UNITS = mg/L

PREPARATION BLANK / LAB CONTROL SAMPLE RESULTS

Test	Method	PREP. BLK	LCS			LCSD	
		Value	Result	TRUE	%Rec	Result	%Rec
Benzene	8021	ND	19.5	20	98	18.4	92
Toluene	8021	ND	21.4	20	107	20.5	103
Ethylbenzene	8021	ND	23.3	20	117	22.9	115
Xylenes	8021	ND	68.0	60	113	64.8	108

LCS = Lab Control Sample Result
TRUE = True Value of LCS
L.LIMIT / H.LIMIT = LCS Control Limits

<i>L.Limit</i>	<i>H.Limit</i>
80%	120%

SURROGATE RECOVERY

Sample No.	AAA-TFT
QC Limit	55-200
Method Blank	94
LCS	101
LCSD	100

AAA-TFT = a,a,a-Trifluorotoluene

ASSOCIATED LABORATORIES
LCS REPORT FORM - METHOD 8260 / 624 / 524.2

QC Sample: LCS/LCSD - Water Samples

Analysis Date: 10/30/03

Applies to: LR 118732, 118630

Reporting Units = ug/L

Lab Controlled Spike / Lab Controlled Spike Duplicate

Test	Sample Result	Spike Added	LCS Spike	LCS Spk. Dup	%Rec LCS	%Rec LCS D	RPD	QC Limits	
								RPD	%REC
1,1-Dichloroethene	ND	50	43.99	45.54	88	91	3	22	59-172
MTBE	ND	50	45.23	45.58	90	91	1	24	62-137
Benzene	ND	50	47.15	48.91	94	98	4	24	62-137
Trichloroethene	ND	50	45.93	47.99	92	96	4	21	66-142
Toluene	ND	50	49.13	49.96	98	100	2	21	59-139
Chlorobenzene	ND	50	48.15	48.32	96	97	0	21	60-133

Method Blank = All ND

SURROGATE (QC Limits : 70-135)

Compounds	DBFM	1,2-DCA	Tol-d8	p-BFB
LCS	98	93	97	88
LCSD	94	94	96	89
BLANK # 1	92	109	96	93

Chain of Custody Record

118630



Company THRIFTY OIL CO.		Phone (562) 921-3581		A.L. Job No.		Page 1 of 1			
Project Manager JEFF BURYAKWISMA		Fax (562) 921-7510		Analysis Requested				Test Instructions & Comments	
Project Name R. W. S.		Project # 049							
Site Name and Address 3400 SAN PABLO AVE OAKLAND, CA. 94612				TPTT DTEX MTRFE				T0600101366	
Sample ID	Lab ID	Date	Time	Matrix	Container Number/Size	Pres.	TPTT	DTEX	MTRFE
1 MW-5		10-20-03	14:00	H ₂ O	3UOA	HCL	X	X	X
2 MW-1		↑	14:10	↑	↑	↑	X	X	X
3 MW-3		↑	14:20	↑	↑	↑	X	X	X
4 MW-7		↑	14:30	↑	↑	↑	X	X	X
5 MW-6		↑	14:50	↑	↑	↑	X	X	X
6 MW-4		↑	15:00	↑	↑	↑	X	X	X
7 MW-2		↓	15:15	↓	↓	↓	X	X	X
8 TRIP BLANK		↓	16:00	↓	2UOA	HCL	X	X	
9									
10									
11									
12									
13									
14									
15									

Sample Receipt - To Be Filled By Laboratory				Relinquished by Sampler: THRIFTY 1.		Relinquished by GOLDETT STARK 2.		Relinquished by 3.	
Total Number of Containers		Properly Cooled Y / N / NA		Signature: [Signature]	Signature: [Signature]	Signature:	Signature:	Signature:	Signature:
Custody Seals Y / N / NA		Samples Intact Y / N / NA		Printed Name: [Signature]	Printed Name: OVERNIGHT	Printed Name:	Printed Name:	Printed Name:	Printed Name:
Received in Good Condition Y / N		Samples Accepted Y / N		Date: 10-20-03 Time: 17:30	Date:	Time:	Date:	Time:	
Turn Around Time				Received By: GOLDETT STARK		Received By: 2.		Received By: 3.	
<input checked="" type="checkbox"/> Normal <input type="checkbox"/> Rush <input type="checkbox"/> Same Day <input type="checkbox"/> 48 hrs. <input type="checkbox"/> 24 hrs. <input type="checkbox"/> 72 hrs.				Signature: [Signature]	Signature: [Signature]	Signature:	Signature:	Signature:	Signature:
				Printed Name:	Printed Name: [Signature]	Printed Name:	Printed Name:	Printed Name:	Printed Name:
				Date:	Date: 10/22/03 Time: 10:00	Date:	Date: 10-22-03 Time: 10:40	Date:	Date: