

**SUMMARY TABLE
CURRENT PERIOD GROUNDWATER DATA
THRIFTY OIL STATION #049, OAKLAND, CA, 94612
T0600101365**

Well ID	Status	Date	CONCENTRATIONS (µg/L)										DEPTH (ft)			Product	Date		
			TPH _g	TPH _d	B	T	E	X	MTBE	DIPE	ETBE	TAME	TBA	DTW	DTB			PT	
MW-1	ACT	01/16/08	<5.6	<0.18	<0.24	<0.21	<0.45	1.3	<0.20	<0.23	<0.19	<10	NP	5.46	17.72	0.00	31.55	26.09	5 - 25
MW-2R	ACT	01/16/08	77	<0.18	<0.24	<0.21	<0.45	105	<0.20	<0.23	2.9	<10	NP	4.51	16.80	0.00	30.49	25.98	5 - 20
MW-3	ACT	01/16/08	<5.6	<0.18	<0.24	<0.21	<0.45	1.3	<0.20	<0.23	<0.19	<10	NP	5.73	24.14	0.00	31.15	25.42	5 - 25
MW-4R	ACT	01/16/08	2,040	14	5.6	33	97	107	<0.20	<0.23	<0.19	25	NP	4.34	19.65	0.00	30.23	25.89	5 - 20
MW-5	ACT	01/16/08	<5.6	<0.18	<0.24	<0.21	<0.45	<0.19	<0.20	<0.23	<0.19	<10	NP	4.56	13.75	0.00	32.30	27.74	4 - 14
MW-6	ACT	01/16/08	<5.6	<0.18	<0.24	<0.21	<0.45	<0.19	<0.20	<0.23	<0.19	<10	NP	5.39	13.06	0.00	33.14	27.75	4 - 14
MW-7	ACT	01/06/08	<5.6	<0.18	<0.24	<0.21	<0.45	<0.19	<0.20	<0.23	<0.19	<10	NP	4.79	13.52	0.00	31.61	26.82	4 - 14
RW-1R	ACT	01/16/08	1,990	14	5.6	33	99	108	<0.20	<0.23	<0.19	31	NP	4.56	19.09	0.00	30.59	26.03	5 - 20

NOTE:

ACT	Groundwater well currently used for monitoring	TPH _g	= Total Petroleum Hydrocarbons as gasoline	MTBE	= Methyl-tert-butyl ether	DTP	= Depth To Product	" - "	= Not analyzed / Not available
INACT	Groundwater well is NOT included in monitoring program	TPH _d	= Total Petroleum Hydrocarbons as diesel	DIPE	= Isopropyl ether	DTW	= Depth To Water	" < "	= Less than detection level indicated
DRY	Groundwater well is dry and cannot be sampled	B	= Benzene	ETBE	= Ethyl-tert-butyl ether	DTB	= Depth To Bottom	" J "	= Flag indicating value between MDL & PQL
NOACC	Presently no access to groundwater well	T	= Toluene	TAME	= Tert-amyl methyl ether	PT	= Product Thickness	NP	= No free product
DEST	Well has been properly destroyed, no longer a conduit to subsurface	E	= Ethylbenzene	TBA	= Tertiary butyl alcohol	GW	= Groundwater		
AB	Groundwater well is abandoned, but not yet destroyed	X	= Total Xylenes						

**TABLE 1
GROUNDWATER DATA
THRIFTY OIL STATION #049, OAKLAND, CA.**

DATE SAMPLED	VOLATILE ORGANIC COMPOUNDS						DEPTH TO PRODUCT (feet)	DEPTH TO GROUNDWATER (feet)	PRODUCT THICKNESS (feet)	CASING ELEVATION (feet)	GROUNDWATER ELEVATION (feet)
	BENZENE (ppb)	TOLUENE (ppb)	ETHYLENE GLYCOL (ppb)	XYLENE (ppb)	MIBK (ppb)	OTHER (ppb)					
01/09/92	-	-	-	-	-	-	NP	5.54	0.00	98.03	92.49
04/13/92	-	-	-	-	-	-	NP	5.86	0.00	98.03	92.17
10/05/92	-	-	-	-	-	-	NP	9.39	0.00	98.03	88.64
01/06/93	-	-	-	-	-	-	NP	4.76	0.00	98.03	93.27
04/26/93	-	-	-	-	-	-	NP	4.96	0.00	98.03	93.07
01/04/94	-	-	-	-	-	-	NP	7.00	0.00	98.03	91.03
04/05/94	-	-	-	-	-	-	NP	6.44	0.00	98.03	91.59
10/09/95	44,000	4,500	4,300	1,700	10,000	-	-	-	-	98.03	-
01/08/96	21,000	1,200	150	34	4,800	-	NP	6.15	0.00	98.03	91.88
04/08/96	4,700	80	110	10	910	-	NP	5.40	0.00	98.03	92.63
07/22/96	7,000	280	130	<3.0	2,100	440	NP	5.50	0.00	98.03	92.53
10/16/96	120	<0.3	<0.3	<0.3	<0.5	180	NP	6.02	0.00	98.03	92.01
01/22/97	160	<0.3	<0.3	<0.3	<0.5	360	NP	4.40	0.00	98.03	93.63
04/21/97	20,000	420	140	5.8	840	55,000	NP	6.30	0.00	98.03	91.73
07/14/97	13,000	<0.3	<0.3	<0.3	<0.55	30,000	NP	5.92	0.00	98.03	92.11
10/07/97	-	-	-	-	-	-	7.70	7.71	0.01	98.03	90.33
01/15/98	<50	0.3	<0.3	<0.3	<0.5	-	NP	4.40	0.00	98.03	93.63
04/23/98	540	<0.3	<0.3	<0.3	<0.5	<20	NP	8.10	0.00	98.03	89.93
07/20/98	<50	<0.3	<0.3	<0.3	<0.5	<5.0	NP	5.55	0.00	98.03	92.48
10/14/98	50	1.4	0.56	<0.3	11	22	NP	7.05	0.00	98.03	90.98
01/21/99	<50	0.59	<0.3	<0.3	<0.5	<5.0	NP	4.10	0.00	98.03	93.93
04/15/99	<50	<0.3	<0.3	<0.3	<0.5	<5.0	NP	4.30	0.00	98.03	93.73
07/26/99	<50	<0.3	<0.3	<0.3	<0.5	<5.0	NP	5.54	0.00	98.03	92.49
10/13/99	<50	<0.3	<0.3	<0.3	<0.5	<5.0	NP	6.13	0.00	98.03	91.90
01/20/00	<50	<0.3	<0.3	<0.3	<0.5	<5.0	NP	6.04	0.00	98.03	91.99
04/05/00	<50	<0.25	<0.25	<0.25	<0.5	<5.0	NP	4.03	0.00	98.03	94.00
07/19/00	<50	<0.3	<0.3	<0.3	<0.6	<5.0	NP	4.00	0.00	98.03	94.03
10/18/00	<50	<0.18	<0.14	<0.18	<0.26	<0.24	NP	5.53	0.00	98.03	92.50
01/17/01	<50	<0.18	<0.14	<0.18	<0.26	<0.24	NP	3.97	0.00	98.03	94.06
04/19/01	<50	<0.18	<0.14	<0.18	<0.26	<0.24	NP	3.98	0.00	98.03	94.05
07/18/01	<50	<0.18	<0.14	<0.18	<0.26	<0.24	NP	5.51	0.00	98.03	92.52
10/10/01	<50	<0.18	<0.14	<0.18	<0.26	<0.24	NP	3.97	0.00	98.03	94.06
01/30/02	<50	<0.18	<0.14	<0.18	<0.26	<0.24	NP	3.95	0.00	98.03	94.08
04/17/02	<50	<0.18	<0.14	<0.18	<0.26	<0.24	NP	2.42	0.00	98.03	95.61
07/31/02	<50	<0.18	1.3	<0.18	<0.26	<0.24	NP	5.49	0.00	98.03	92.54
11/14/02	<50	<0.08	<0.18	<0.17	<0.4	16	NP	6.13	0.00	98.03	91.90
01/29/03	<15	<0.04	<0.02	<0.02	<0.06	<0.03	NP	2.45	0.00	98.03	95.58
04/23/03	<15	<0.04	<0.02	<0.02	<0.06	<0.03	NP	7.02	0.00	98.03	91.01
07/10/03	<15	<0.22	<0.32	<0.31	<0.4	<0.18	NP	5.15	0.00	98.03	92.88
10/20/03	<15	<0.04	<0.02	<0.02	<0.06	<0.03	NP	5.13	0.00	98.03	92.90
01/14/04	<15	<0.04	<0.02	<0.02	<0.06	<0.03	NP	3.92	0.00	98.03	94.11
04/08/04	<15	<0.22	<0.32	<0.31	<0.4	<0.18	NP	4.54	0.00	98.03	93.49
07/21/04	<15	<0.22	<0.32	<0.31	<0.4	<0.18	NP	7.01	0.00	98.03	91.02
10/20/04	<15	<0.22	<0.32	<0.31	<0.4	<0.18	NP	5.46	0.00	98.03	92.57
01/19/05	<15	<0.22	<0.32	<0.31	<0.4	<0.18	NP	5.48	0.00	98.03	92.55
04/20/05	<15	<0.22	<0.32	<0.31	<0.4	<0.18	NP	6.99	0.00	98.03	91.04
07/20/05	<2.9	<0.32	<0.10	<0.24	<0.30	<0.63	NP	6.42	0.00	98.03	91.61
10/19/05	<2.9	<0.32	<0.10	<0.24	<0.30	<0.63	NP	6.98	0.00	98.03	91.05
01/24/06	<2.9	<0.32	<0.10	<0.24	<0.30	<0.63	NP	4.56	0.00	98.03	93.47

**TABLE 1
GROUNDWATER DATA
THRIFTY OIL STATION #049, OAKLAND, CA.**

DATE	DEPTH	ANALYTICAL PARAMETERS					DEPTH TO PRODUCT (feet)	DEPTH TO GROUNDWATER (feet)	PRODUCT THICKNESS (feet)	CASING ELEVATION (feet)	GROUNDWATER ELEVATION (feet)
		BENZENE (ug/L)	TOLUENE (ug/L)	ETHYL BENZENE (ug/L)	XYLENE (ug/L)	METHE (ug/L)					
04/19/06	<5.6	<0.32	<0.10	<0.24	<0.30	<0.63	NP	3.93	0.00	98.03	94.10
07/19/06	17,100	21	279	388	2,010	128	NP	5.92	0.00	98.03	92.11
09/15/06	<5.6	<0.32	<0.10	<0.24	<0.30	33	NP	6.38	0.00	98.03	91.65
10/18/06	<5.6	<0.32	<0.10	<0.24	<0.30	<0.63	NP	6.99	0.00	98.03	91.04
01/17/07	<5.6	<0.32	<0.10	<0.24	<0.30	<0.63	NP	5.40	0.00	31.55	26.15
04/18/07	<5.6	<0.32	<0.10	<0.24	<0.3	7.1	NP	5.46	0.00	31.55	26.09
07/18/07	<5.6	<0.18	<0.24	<0.21	<0.45	4.9	NP	5.92	0.00	31.55	25.63
10/17/07	<5.6	<0.18	<0.24	<0.21	<0.45	1.6	NP	5.46	0.00	31.55	26.09
01/16/08	<5.6	<0.18	<0.24	<0.21	<0.45	1.3	NP	5.46	0.00	31.55	26.09
NO DETECTION LIMITS (ND) - SCREENING LEVELS (0.25 ug/L)											
01/09/92	-	-	-	-	-	-	NP	5.35	0.00	97.44	92.09
04/13/92	-	-	-	-	-	-	NP	7.42	0.00	97.44	90.02
10/05/92	-	-	-	-	-	-	NP	12.15	0.00	97.44	85.29
01/06/93	-	-	-	-	-	-	NP	5.46	0.00	97.44	91.98
04/26/93	-	-	-	-	-	-	NP	5.15	0.00	97.44	92.29
01/04/94	-	-	-	-	-	-	NP	9.45	0.00	97.44	87.99
04/05/94	-	-	-	-	-	-	NP	8.23	0.00	97.44	89.21
10/09/95	33,000	6,000	390	1,700	4,900	-	-	-	-	97.44	-
01/08/96	<50	0.32	<0.3	0.41	2.1	-	NP	5.60	0.00	97.44	91.84
04/08/96	10,000	490	210	210	830	-	NP	5.43	0.00	97.44	92.01
07/22/96	60,000	6,500	1,000	1,500	10,000	8,500	NP	5.65	0.00	97.44	91.79
10/16/96	6,500	12	0.34	0.72	110	4,700	NP	5.82	0.00	97.44	91.62
01/22/97	3,200	<0.3	0.46	0.37	<0.5	8,000	NP	4.30	0.00	97.44	93.14
04/21/97	66,000	5,300	1,000	2,300	14,000	30,000	NP	5.80	0.00	97.44	91.64
07/14/97	17,000	1.8	4.6	4.6	350	24,000	NP	8.92	0.00	97.44	88.52
10/07/97	220,000	5,200	1,700	3,800	15,000	-	NP	6.80	0.00	97.44	90.64
01/19/98	25,000	5.4	2.2	2.1	240	-	NP	8.50	0.00	97.44	88.94
04/23/98	7,700	<0.3	0.55	0.38	4.9	28,000	NP	7.60	0.00	97.44	89.84
07/20/98	430,000	4,200	10,000	5,400	28,000	77,000	NP	6.94	0.00	97.44	90.50
10/14/98	27,000	<0.3	4.5	4.1	4.6	65,000	NP	8.45	0.00	97.44	88.99
01/21/99	16,000	7.6	9.8	4.2	310	*49,000 / 42,000	NP	6.95	0.00	97.44	90.49
04/15/99	20,000	<0.3	<0.3	<0.3	<0.5	*31,000 / 30,000	NP	8.45	0.00	97.44	88.99
07/26/99	6,700	<6.0	<6.0	<6.0	<10	*11,000 / 15,000	NP	6.94	0.00	97.44	90.50
10/13/99	7,600	<3.0	3.7	<3.0	11	11,000	NP	5.48	0.00	97.44	91.96
01/20/00	7,500	<6.0	<6.0	<6.0	<10	*14,000 / 16,000	NP	5.84	0.00	97.44	91.60
04/05/00	10,400	<0.25	<0.25	<0.25	<0.5	*10,000 / 14,400	NP	5.41	0.00	97.44	92.03
07/19/00	130	<0.3	<0.3	<0.3	<0.6	*9,620 / 6,520	NP	5.40	0.00	97.44	92.04
10/18/00	150	<0.18	<0.14	<0.18	<0.26	*9,090 / 6,560	NP	6.91	0.00	97.44	90.53
01/17/01	75	<0.18	2.0	2.0	3.0	*8,650 / 9,710	NP	5.41	0.00	97.44	92.03
04/19/01	4,380	<0.18	<0.14	<0.18	<0.26	8,890	NP	5.40	0.00	97.44	92.04
07/18/01	3,260	<0.18	<0.14	<0.18	2.0	*7960 / 1,710	NP	6.92	0.00	97.44	90.52
10/10/01	1,760	<0.18	<0.14	<0.18	<0.26	*2,980 / 2,600	NP	3.87	0.00	97.44	93.57
01/30/02	1,770	<0.18	1.0	1.0	2.0	*2,560 / 1,590	NP	8.45	0.00	97.44	88.99
04/17/02	1,470	1.0	<0.14	<0.18	<0.26	*2,460 / 2,080	NP	8.45	0.00	97.44	88.99
07/31/02	3,910	<0.18	1.2	<0.18	2.1	*2,090 / 1,740	NP	9.98	0.00	97.44	87.46
11/14/02	39,400	1,680	728	173	5,120	8,270	NP	5.40	0.00	97.44	92.04
01/29/03	22,100	746	76	<1.0	2,840	8,220	NP	8.43	0.00	97.44	89.01
04/23/03	19,500	<0.8	<0.4	<0.4	<1.2	9,580	NP	5.38	0.00	97.44	92.06

**TABLE 1
GROUNDWATER DATA
THRIFTY OIL STATION #049, OAKLAND, CA.**

DATE SAMPLED	ANALYTICAL PARAMETERS						DEPTH TO PRODUCT (ft)	DEPTH TO GROUNDWATER (ft)	PRODUCT THICKNESS (ft)	CASING ELEVATION (ft)	GROUNDWATER ELEVATION (ft)
	TOC (mg/l)	BENZENE (ppb)	CHLORINE (ppb)	ETHYLENE (ppb)	STYRENE (ppb)	MPHE (ppb)					
07/10/03	29,900	<2.2	<3.2	<3.1	<4.0	6,690	NP	5.10	0.00	97.44	92.34
10/20/03	13,000	4.79	<0.02	<0.02	<0.06	*6,330 / 5,980	NP	5.10	0.00	97.44	92.34
MONITORING WELL 101 Screen Interval = 5 to 20 feet											
02/03/04							-	-	-	-	-
04/08/04	11,600	304	16 J	55	427	4,170	NP	4.58	0.00	-	-
07/21/04	<15	<0.22	<0.32	<0.31	<0.4	<0.18	NP	6.72	0.00	-	-
10/20/04	20,900	3,180	2,970	259	1,240	92	NP	3.72	0.00	-	-
01/19/05	18,900	537	250	866	2,290	3,340	NP	4.50	0.00	-	-
04/20/05	13,100	<2.2	<3.2	<3.1	<4.0	563	NP	5.27	0.00	-	-
07/07/05	2,500	70	7.6	<0.24	160	1,930	-	-	-	-	-
07/20/05	4,260	392	15 J	175	100	742	NP	6.12	0.00	-	-
10/19/05	321	<0.32	<0.10	<0.24	<0.30	423	NP	5.28	0.00	-	-
01/24/06	3,200	34	331	87	510	86	NP	4.58	0.00	-	-
04/19/06	22,100	440	4,240	234	1,530	195	NP	3.38	0.00	-	-
07/19/06	15,800	377	629	627	578	530	NP	8.10	0.00	-	-
09/15/06	-	-	-	-	-	-	-	-	-	-	-
10/18/06	57,600	75	5,730	1,770	7,820	263	NP	5.28	0.00	-	-
01/17/07	117,000	254	15,200	4,840	28,800	300	NP	6.82	0.00	30.49	23.67
04/18/07	896	<0.32	<0.10	<0.24	117	49	NP	7.60	0.00	30.49	22.89
07/18/07	2,290	106	3.7 J	2.2 J	160	146	NP	5.62	0.00	30.49	24.87
10/17/07	313	<0.18	5.9	1.6 J	20	162	NP	3.41	0.00	30.49	27.08
01/16/08	77	<0.18	<0.24	<0.21	<0.45	105	NP	4.51	0.00	30.49	25.98
MONITORING WELL 102 Screen Interval = 5 to 25 feet											
01/09/92	-	-	-	-	-	-	NP	17.60	0.00	97.69	80.09
04/13/92	-	-	-	-	-	-	NP	17.40	0.00	97.69	80.29
10/05/92	-	-	-	-	-	-	NP	17.35	0.00	97.69	80.34
01/06/93	-	-	-	-	-	-	NP	17.40	0.00	97.69	80.29
04/26/93	-	-	-	-	-	-	NP	17.90	0.00	97.69	79.79
01/04/94	-	-	-	-	-	-	NP	17.60	0.00	97.69	80.09
04/05/94	-	-	-	-	-	-	NP	16.25	0.00	97.69	81.44
01/08/96	-	-	-	-	-	-	NP	7.11	0.00	97.69	90.58
04/08/96	8,800	610	31	530	900	-	NP	7.20	0.00	97.69	90.49
07/22/96	38,000	4,100	1,500	1,600	5,400	2,600	NP	6.82	0.00	97.69	90.87
10/16/96	2,400	<0.3	<0.3	<0.3	<0.5	3,800	NP	6.84	0.00	97.69	90.85
01/22/97	2,200	<0.3	<0.3	<0.3	<0.5	5,500	NP	4.80	0.00	97.69	92.89
04/21/97	15,000	1,500	36	260	710	11,000	NP	9.40	0.00	97.69	88.29
07/14/97	5,400	0.45	<0.3	<0.3	<0.5	14,000	NP	10.92	0.00	97.69	86.77
10/07/97	8,800	0.39	<0.3	<0.3	0.88	-	NP	11.95	0.00	97.69	85.74
01/19/98	22,000	1,300	15	20	310	-	NP	7.85	0.00	97.69	89.84
04/23/98	9,200	3.9	3.1	5.7	9.8	16,000	NP	11.20	0.00	97.69	86.49
07/20/98	750	0.41	1.4	0.47	1.8	2,800	NP	7.36	0.00	97.69	90.33
10/14/98	750	<0.3	<0.3	<0.3	<0.5	15,000	NP	11.95	0.00	97.69	85.74
01/21/99	4,700	0.32	<0.3	<0.3	<0.5	* 12,000 / 16,000	NP	10.45	0.00	97.69	87.24
04/15/99	7,900	0.59	0.69	<0.3	0.94	* 11,000 / 14,000	NP	7.86	0.00	97.69	89.83
07/26/99	5,200	<0.0	<0.0	<0.0	<0.0	* 9,600 / 11,000	NP	10.40	0.00	97.69	87.29
10/13/99	<50	<0.3	<0.3	<0.3	<0.5	<5.0	NP	7.09	0.00	97.69	90.60

**TABLE I
GROUNDWATER DATA
THRIFTY OIL STATION #049, OAKLAND, CA.**

DATE SAMPLED	ANALYTICAL PARAMETERS						DEPTH TO PRODUCT (ft)	DEPTH TO GROUNDWATER (feet)	PRODUCT THICKNESS (feet)	CASING ELEVATION (ft)	GROUNDWATER ELEVATION (feet)
	TOPE (ppm)	BENZENE (ppm)	TOLUENE (ppm)	XYLENE (ppm)	MIBK (ppm)	CHLORIDE (ppm)					
01/20/00	<50	<0.3	<0.3	<0.3	<0.5	<5.0	NP	6.86	0.00	97.69	90.83
04/05/00	<50	0.8	<0.25	<0.25	<0.5	*5.6 / <5.0	NP	8.85	0.00	97.69	88.84
07/19/00	<50	<0.3	<0.3	<0.3	<0.6	<5.0	NP	8.86	0.00	97.69	88.83
10/18/00	<50	<0.18	<0.14	<0.18	<0.26	<0.24	NP	7.32	0.00	97.69	90.37
01/17/01	<50	<0.18	2.0	<0.18	1.0	*39 / 39	NP	5.40	0.00	97.69	92.29
04/19/01	<50	<0.18	<0.14	<0.18	<0.26	<0.24	NP	8.87	0.00	97.69	88.82
07/18/01	<50	<0.18	<0.14	<0.18	<0.26	<0.24	NP	7.32	0.00	97.69	90.37
10/10/01	<50	<0.18	<0.14	<0.18	<0.26	<0.24	NP	8.87	0.00	97.69	88.82
01/30/02	<50	<0.18	<0.14	<0.18	<0.26	<0.24	NP	5.78	0.00	97.69	91.91
04/17/02	<50	<0.18	<0.14	<0.18	<0.26	<0.24	NP	7.31	0.00	97.69	90.38
07/31/02	138	1.1	1.2	<0.18	<0.26	<0.24	NP	5.76	0.00	97.69	91.93
11/14/02	<50	<0.08	<0.18	<0.17	<0.4	21	NP	5.73	0.00	97.69	91.96
01/29/03	<15	<0.04	<0.02	<0.02	<0.06	16	NP	7.30	0.00	97.69	90.39
04/23/03	<15	<0.04	<0.02	<0.02	<0.06	16	NP	5.76	0.00	97.69	91.93
07/10/03	<15	<0.22	<0.32	<0.31	<0.4	11	NP	5.63	0.00	97.69	92.06
10/20/03	13,700	4.13	<0.02	<0.02	<0.06	*6,570 / 4,920	NP	5.61	0.00	97.69	92.08
01/14/04	1,160	2.0	2.2	6.1	7.8	*1,510 / 767	NP	4.23	0.00	97.69	93.46
04/08/04	<15	<0.22	<0.32	<0.31	<0.4	<0.18	NP	5.48	0.00	97.69	92.21
07/21/04	<15	<0.22	<0.32	<0.31	<0.4	<0.18	NP	6.66	0.00	97.69	91.03
10/20/04	<15	<0.22	<0.32	<0.31	<0.4	<0.18	NP	4.20	0.00	97.69	93.49
01/19/05	<15	<0.22	<0.32	<0.31	<0.4	<0.18	NP	5.74	0.00	97.69	91.95
04/20/05	<15	<0.22	<0.32	<0.31	<0.4	<0.18	NP	7.23	0.00	97.69	90.46
07/20/05	<2.9	<0.32	<0.10	<0.24	<0.30	<0.63	NP	6.82	0.00	97.69	90.87
10/19/05	<2.9	<0.32	<0.10	<0.24	<0.30	7.0	NP	7.26	0.00	97.69	90.43
01/24/06	<2.9	<0.32	<0.10	<0.24	<0.30	<0.63	NP	5.50	0.00	97.69	92.19
04/19/06	<5.6	<0.32	<0.10	<0.24	<0.30	<0.63	NP	5.72	0.00	97.69	91.97
07/19/06	12,900	539	744	169	296	1,640	NP	5.63	0.00	97.69	92.06
09/15/06	1,750	4.3	68	11	90	502	NP	6.62	0.00	97.69	91.07
10/18/06	75	<0.32	<0.10	1.1 J	1.1 J	47	NP	5.72	0.00	97.69	91.97
01/17/07	<5.6	<0.32	2.1 J	<0.24	1.0 J	13	NP	5.73	0.00	31.15	25.42
04/18/07	<5.6	<0.32	2.0 J	<0.24	6.2	11	NP	5.74	0.00	31.15	25.41
07/18/07	<5.6	<0.18	2.2 J	<0.21	1.3 J	5.3	NP	8.36	0.00	31.15	22.79
10/17/07	<5.6	1.0	<0.24	<0.21	<0.45	1.5	NP	5.74	0.00	31.15	25.41
01/16/08	<5.6	<0.18	<0.24	<0.21	<0.45	1.3	NP	5.73	0.00	31.15	25.42
MONITORING POINTS											
Screen Interval = 4 to 14 feet											
01/09/92	-	-	-	-	-	-	NP	5.25	0.00	97.33	92.08
04/13/92	-	-	-	-	-	-	NP	6.40	0.00	97.33	90.93
10/05/92	-	-	-	-	-	-	NP	9.95	0.00	97.33	87.38
01/06/93	-	-	-	-	-	-	NP	4.10	0.00	97.33	93.23
04/26/93	-	-	-	-	-	-	NP	4.84	0.00	97.33	92.49
01/04/94	-	-	-	-	-	-	NP	9.05	0.00	97.33	88.28
04/05/94	-	-	-	-	-	-	NP	8.10	0.00	97.33	89.23
10/09/95	63,000	9,000	2,100	2,500	9,600	-	-	-	-	97.33	-
01/08/96	23,000	2,200	830	880	3,600	-	NP	5.57	0.00	97.33	91.76
04/08/96	56,000	5,000	2,500	2,600	11,000	-	NP	5.36	0.00	97.33	91.97
07/22/96	33,000	3,700	1,600	1,400	6,000	2,400	NP	4.80	0.00	97.33	92.53
10/16/96	2,800	7.8	0.60	0.41	52	2,000	NP	5.47	0.00	97.33	91.86
01/22/97	1,400	<0.3	<0.3	<0.3	<0.5	3,100	NP	5.15	0.00	97.33	92.18

**TABLE 1
GROUNDWATER DATA
THRIFTY OIL STATION #049, OAKLAND, CA.**

DATE SAMPLED	ANIONIC PARAMETERS						DEPTH TO PRODUCT (ft)	DEPTH TO GROUNDWATER (ft)	PRODUCT THICKNESS (in)	CASING ELEVATION (ft)	GROUNDWATER ELEVATION (ft)
	TOPE	BENZENE	TOLUENE	ETHYLENE	XYLENE	WIFE					
04/21/97	-	-	-	-	-	-	5.30	6.36	1.06	97.33	91.77
07/14/97	-	-	-	-	-	-	5.21	5.24	0.03	97.33	92.11
10/07/97	-	-	-	-	-	-	7.80	7.82	0.02	97.33	89.53
01/15/98	-	-	-	-	-	-	6.60	6.68	0.08	97.33	90.71
04/23/98	-	-	-	-	-	-	5.30	6.36	1.06	97.33	91.77
07/20/98	<50	<0.3	<0.3	<0.3	<0.5	<5.0	NP	6.05	0.00	97.33	91.28
10/14/98	3,100	86	23	2.0	520	1,100	NP	6.85	0.00	97.33	90.48
01/21/99	9,100	3.2	5.6	1.8	130	* 24,000 / 17,000	NP	6.10	0.00	97.33	91.23
04/15/99	14,000	<0.3	0.71	<0.3	<0.5	* 20,000 / 22,000	NP	6.05	0.00	97.33	91.28
07/26/99	4,500	<6.0	<6	<6	<10	*8,700 / 9,800	NP	6.07	0.00	97.33	91.26
10/13/99	410	<0.3	0.63	<0.3	<0.5	660	NP	5.54	0.00	97.33	91.79
01/20/00	770	<0.3	<0.3	<0.3	<0.5	*2,400 / 1,900	NP	5.49	0.00	97.33	91.84
04/05/00	61,200	0.9	<0.25	<0.25	<0.5	*18,500 / 21,900	NP	5.30	0.00	97.33	92.03
07/19/00	96,600	1,770	1,760	2,690	8,730	21,900 / 9,740 J	NP	5.29	0.00	97.33	92.04
10/18/00	34,900	698	1,010	607	4,130	*27,800 / 15,900	NP	6.02	0.00	97.33	91.31
01/17/01	29,100	799	930	614	3,400	*24,300 / 31,400	NP	4.88	0.00	97.33	92.45
04/19/01	103,000	4,880	3,980	3,260	11,800	66,900	NP	4.89	0.00	97.33	92.44
07/18/01	52,200	3,320	2,090	440	5,520	*55,500 / 16,800	NP	6.04	0.00	97.33	91.29
10/10/01	8,580	6.1	14	5.3	70	*40,100 / 30,000	NP	4.51	0.00	97.33	92.82
01/30/02	36,500	<0.18	3.0	1.0	3.0	*43,000 / 24,900	NP	4.51	0.00	97.33	92.82
04/17/02	12,900	8.0	1.0	<0.18	1.0	16,000 / 13,600	NP	4.51	0.00	97.33	92.82
07/31/02	19,300	<0.18	1.2	1.5	2.6	*13,200 / 10,100	NP	5.26	0.00	97.33	92.07
11/14/02	36,200	1,720	940	235	6,190	8,280	NP	5.27	0.00	97.33	92.06
01/29/03	13,000	444	39	<0.4	1,200	8,160	NP	4.50	0.00	97.33	92.83
04/23/03	7,430	130	5.7	<0.2	387	5,830	NP	4.80	0.00	97.33	92.53
07/10/03	16,200	<2.2	<3.2	<3.1	<4.0	3,930	NP	4.55	0.00	97.33	92.78
10/20/03	6,040	672	384	3.4	444	*3,780 / 3,220	NP	4.56	0.00	97.33	92.77
MONITORING WELLS											
Standard = 500 gal											
02/03/04	-	-	-	-	-	-	-	-	-	-	-
04/08/04	37,900	819	424	159	3,190	18,400	NP	4.96	0.00	-	-
07/21/04	14,500	<2.2	<3.2	<3.1	39 J	18,900	NP	6.60	0.00	-	-
10/20/04	66,000	6,390	6,560	672	3,290	13,300	NP	3.38	0.00	-	-
01/19/05	17,600	513	240	855	2,230	3,310	NP	4.32	0.00	-	-
04/20/05	19,200	190	109	452	974	1,870	NP	4.72	0.00	-	-
07/07/05	11,500	233	68	369	875	2,350	-	-	-	-	-
07/20/05	11,300	251	90	154	1,460	1,280	NP	6.08	0.00	-	-
10/19/05	1,310	<0.32	<0.10	<0.24	<0.30	1,160	NP	5.08	0.00	-	-
01/24/06	41,300	391	2,310	871	5,430	388	NP	4.98	0.00	-	-
04/19/06	26,100	399	1,290	254	3,350	732	NP	4.72	0.00	-	-
07/19/06	34,500	38	1,120	251	3,950	115	NP	6.84	0.00	-	-
09/15/06	-	-	-	-	-	-	-	-	-	-	-
10/18/06	37,000	<32	3,910	1,350	5,770	389	NP	5.85	0.00	-	-
01/17/07	211,000	223.00	22,800	5,670	33,800	<126	NP	6.62	0.00	30.23	23.61
04/18/07	13,000	52	2,300	97 J	5,140	102	NP	7.02	0.00	30.23	23.21
07/18/07	2,510	88	1.7 J	<0.21	107	124	NP	5.36	0.00	30.23	24.87
10/17/07	580	<0.18	24	3.9 J	81	120	NP	4.72	0.00	30.23	25.51
01/16/08	2,040	14	5.6	33.00	97	107	NP	4.34	0.00	30.23	25.89

TABLE 1
GROUNDWATER DATA
THRIFTY OIL STATION #049, OAKLAND, CA.

DATE SAMPLED	ANALYTICAL PARAMETERS						DEPTH TO PRODUCT (feet)	DEPTH TO GROUNDWATER (feet)	PRODUCT THICKNESS (feet)	CASING ELEVATION (feet)	GROUNDWATER ELEVATION (feet)
	TPE (ug/L)	BENZENE (ug/L)	ADIENE (ug/L)	1,2-DIBENZENE (ug/L)	XYLENE (ug/L)	MIBK (ug/L)					
MONITORING WELL #111 - Screen Interval = 4 to 14 feet											
01/09/92	-	-	-	-	-	-	NP	5.32	0.00	98.85	93.53
04/13/92	-	-	-	-	-	-	NP	4.82	0.00	98.85	94.03
10/0/92	-	-	-	-	-	-	NP	8.78	0.00	98.85	90.07
01/06/93	-	-	-	-	-	-	NP	3.46	0.00	98.85	95.39
04/26/93	-	-	-	-	-	-	NP	4.66	0.00	98.85	94.19
01/04/94	-	-	-	-	-	-	NP	6.36	0.00	98.85	92.49
04/05/94	-	-	-	-	-	-	NP	5.94	0.00	98.85	92.91
07/12/95	<100	<0.5	<0.5	<0.5	<1.0	-	-	-	-	98.85	-
10/09/95	440	31	11	19	84	-	-	-	-	98.85	-
01/08/96	<50	<0.3	<0.3	<0.3	<0.5	-	NP	6.63	0.00	98.85	92.22
04/08/96	<50	<0.3	<0.3	<0.3	<0.5	-	NP	5.22	0.00	98.85	93.63
07/22/96	<50	<0.3	<0.3	<0.3	<0.5	<20	NP	6.62	0.00	98.85	92.23
10/16/96	<50	<0.3	<0.3	<0.3	<0.5	<20	NP	6.12	0.00	98.85	92.73
01/22/97	<50	<0.3	<0.3	<0.3	<0.5	<20	NP	5.17	0.00	98.85	93.68
04/21/97	73	2.5	0.34	0.74	3.8	21	NP	6.64	0.00	98.85	92.21
07/14/97	<50	<0.3	<0.3	<0.3	<0.5	<20	NP	6.67	0.00	98.85	92.18
10/07/97	130	<0.3	<0.3	<0.3	<0.5	-	NP	8.20	0.00	98.85	90.65
01/19/98	85	<0.3	<0.3	<0.3	<0.5	-	NP	1.55	0.00	98.85	97.30
04/23/98	220	0.39	<0.3	<0.3	<0.5	350	NP	8.10	0.00	98.85	90.75
07/20/98	<50	<0.3	<0.3	<0.3	<0.5	<5.0	NP	6.30	0.00	98.85	92.55
10/14/98	<50	<0.3	<0.3	<0.3	<0.5	<5.0	NP	7.65	0.00	98.85	91.20
01/21/99	<50	<0.3	<0.3	<0.3	<0.5	*6.7 / <5.0	NP	6.15	0.00	98.85	92.70
04/15/99	<50	<0.3	<0.3	<0.3	<0.5	<5.0	NP	1.60	0.00	98.85	97.25
07/26/99	<50	<0.3	<0.3	<0.3	<0.5	<5.0	NP	6.13	0.00	98.85	92.72
10/13/99	<50	<0.3	<0.3	<0.3	<0.5	<5.0	NP	6.61	0.00	98.85	92.24
01/20/00	<50	<0.3	<0.3	<0.3	<0.5	<5.0	NP	6.14	0.00	98.85	92.71
04/05/00	<50	0.5	<0.25	<0.25	<0.5	*5.4 / <5.0	NP	4.58	0.00	98.85	94.27
07/19/00	<50	<0.3	<0.3	<0.3	<0.6	<5.0	NP	4.59	0.00	98.85	94.26
10/18/00	<50	<0.18	<0.14	<0.18	<0.26	<0.24	NP	6.28	0.00	98.85	92.57
01/17/01	<50	<0.18	<0.14	<0.18	1.0	*5 / 4.8	NP	4.58	0.00	98.85	94.27
04/19/01	<50	<0.18	<0.14	<0.18	<0.26	<0.24	NP	4.58	0.00	98.85	94.27
07/18/01	<50	<0.18	<0.14	<0.18	<0.26	<0.24	NP	6.12	0.00	98.85	92.73
10/10/01	<50	<0.18	<0.14	<0.18	<0.26	<0.24	NP	4.58	0.00	98.85	94.27
01/30/02	<50	<0.18	<0.14	<0.18	<0.26	<0.24	NP	4.48	0.00	98.85	94.37
04/17/02	<50	<0.18	<0.14	<0.18	<0.26	<0.24	NP	4.58	0.00	98.85	94.27
07/31/02	<50	<0.18	<0.14	<0.18	<0.26	<0.24	NP	6.10	0.00	98.85	92.75
11/14/02	<50	<0.08	<0.18	<0.17	<0.4	9.0	NP	6.11	0.00	98.85	92.74
01/29/03	<15	<0.04	<0.02	<0.02	<0.06	7.1	NP	4.55	0.00	98.85	94.30
04/23/03	<15	<0.04	<0.02	<0.02	<0.06	7.9	NP	3.03	0.00	98.85	95.82
07/10/03	<15	<0.22	<0.32	<0.31	<0.4	7.4	NP	5.25	0.00	98.85	93.60
10/20/03	<15	<0.04	<0.02	<0.02	<0.06	*9.11 / 9.2	NP	5.25	0.00	98.85	93.60
01/14/04	<15	<0.04	<0.02	<0.02	<0.06	*8.2 / 4.1	NP	3.03	0.00	98.85	95.82
04/08/04	797	<0.22	<0.32	<0.31	<0.4	635	NP	4.35	0.00	98.85	94.50
07/21/04	548	<0.22	<0.32	<0.31	<0.4	788	NP	5.56	0.00	98.85	93.29
10/20/04	901	<0.22	<0.32	<0.31	<0.4	734	NP	4.15	0.00	98.85	94.70
01/19/05	350	<0.22	<0.32	<0.31	<0.4	860	NP	4.57	0.00	98.85	94.28
04/20/05	718	<0.22	<0.32	<0.31	<0.4	848	NP	6.10	0.00	98.85	92.75
07/20/05	255	<0.32	<0.10	<0.24	<0.30	274	NP	5.76	0.00	98.85	93.09

**TABLE 1
GROUNDWATER DATA
THRIFTY OIL STATION #049, OAKLAND, CA.**

DATE SAMPLED	ANALYTICAL PARAMETERS						DEPTH TO PRODUCT (ft)	DEPTH TO GROUNDWATER (ft)	PRODUCT THICKNESS (ft)	CASING ELEVATION (ft)	GROUNDWATER ELEVATION (ft)
	TOC (mg/L)	BENZENE (ug/L)	TOLUENE (ug/L)	ETHYLBENZENE (ug/L)	XYLENE (ug/L)	MTBE (ug/L)					
10/19/05	225	<0.32	<0.10	<0.24	<0.30	300	NP	6.10	0.00	98.85	92.75
01/24/06	681	<0.32	<0.10	<0.24	<0.30	334	NP	4.34	0.00	98.85	94.51
04/19/06	<5.6	<0.32	<0.10	<0.24	<0.30	<0.63	NP	4.58	0.00	98.85	94.27
07/19/06	3,500	11	584	52	208	<0.63	NP	5.56	0.00	98.85	93.29
09/15/06	<5.6	<0.32	<0.10	<0.24	<0.30	1.8	NP	5.81	0.00	98.85	93.04
10/18/06	<5.6	<0.32	<0.10	<0.24	<0.30	<0.63	NP	6.08	0.00	98.85	92.77
01/17/07	162	<0.32	<0.10	<0.24	<0.30	<0.63	NP	6.09	0.00	32.30	26.21
04/18/07	<5.6	<0.32	<0.10	<0.24	<0.3	<0.63	NP	6.09	0.00	32.30	26.21
07/18/07	<5.6	<0.18	<0.24	<0.21	<0.45	<0.19	NP	6.52	0.00	32.30	25.78
10/17/07	<5.6	<0.18	<0.24	<0.21	<0.45	<0.19	NP	4.55	0.00	32.30	27.75
01/16/08	<5.6	<0.18	<0.24	<0.21	<0.45	<0.19	NP	4.56	0.00	32.30	27.74
MONITORING WELLS											
01/09/92	-	-	-	-	-	-	NP	6.30	0.00	99.67	93.37
04/13/92	-	-	-	-	-	-	NP	5.47	0.00	99.67	94.20
10/05/92	-	-	-	-	-	-	NP	9.85	0.00	99.67	89.82
01/06/93	-	-	-	-	-	-	NP	4.16	0.00	99.67	95.51
04/26/93	-	-	-	-	-	-	NP	5.75	0.00	99.67	93.92
01/14/94	-	-	-	-	-	-	NP	7.20	0.00	99.67	92.47
04/05/94	-	-	-	-	-	-	NP	6.76	0.00	99.67	92.91
07/10/95	<100	<0.5	0.9	<0.5	1.1	-	-	-	-	99.67	-
10/09/95	250	4.8	5.6	11	58	-	-	-	-	99.67	-
01/08/96	<50	<0.3	<0.3	<0.3	<0.5	-	NP	6.16	0.00	99.67	93.51
04/08/96	230	4.6	4.7	3.2	33	-	NP	4.60	0.00	99.67	95.07
07/22/96	<50	<0.3	<0.3	<0.3	<0.5	<20	NP	7.30	0.00	99.67	92.37
10/16/96	<50	<0.3	<0.3	<0.3	<0.5	<20	NP	5.82	0.00	99.67	93.85
01/22/97	<50	<0.3	<0.3	<0.3	<0.5	<20	NP	4.40	0.00	99.67	95.27
04/21/97	130	<0.3	<0.3	<0.3	<0.5	<20	NP	7.10	0.00	99.67	92.57
07/14/97	<50	<0.3	<0.3	<0.3	0.70	<20	NP	7.35	0.00	99.67	92.32
10/07/97	<50	0.78	0.3	<0.3	<0.5	-	NP	6.98	0.00	99.67	92.69
01/23/98	<50	<0.3	<0.3	<0.3	<0.5	-	NP	2.35	0.00	99.67	97.32
04/23/98	<50	<0.3	<0.3	<0.3	<0.5	<20	NP	6.90	0.00	99.67	92.77
07/20/98	<50	<0.3	1.1	<0.3	1.4	<5.0	NP	5.45	0.00	99.67	94.22
10/14/98	<50	<0.3	<0.3	<0.3	<0.5	<5.0	NP	4.95	0.00	99.67	94.72
01/21/99	<50	0.35	0.62	<0.3	<0.5	<5.0	NP	3.90	0.00	99.67	95.77
04/15/99	<50	<0.3	<0.3	<0.3	<0.5	<5.0	NP	2.35	0.00	99.67	97.32
07/26/99	1,000	<0.3	<0.3	<0.3	<0.5	*2,300 / 3,900	NP	3.93	0.00	99.67	95.74
10/13/99	<50	<0.3	<0.3	<0.3	<0.5	<5.0	NP	6.15	0.00	99.67	93.52
01/20/00	<50	<0.3	<0.3	<0.3	<0.5	*42 / 41	NP	5.84	0.00	99.67	93.83
04/05/00	4,600	338	2.8	1.2	55.2	*282 / 230	NP	3.89	0.00	99.67	95.78
07/19/00	60	1.0	2.0	<0.3	<0.6	*87 / 76	NP	3.07	0.00	99.67	96.60
10/18/00	-	-	-	-	-	-	-	-	-	99.67	-
01/17/01	103	<0.18	2.0	<0.18	3.0	*78 / 106	NP	3.87	0.00	99.67	95.80
04/19/01	<50	<0.18	<0.14	<0.18	<0.26	<0.24	NP	3.86	0.00	99.67	95.81
07/18/01	<50	<0.18	<0.14	<0.18	<0.26	<0.24	NP	5.40	0.00	99.67	94.27
10/10/01	<50	<0.18	<0.14	<0.18	<0.26	<0.24	NP	3.86	0.00	99.67	95.81
01/30/02	<50	<0.18	<0.14	<0.18	<0.26	<0.24	NP	3.86	0.00	99.67	95.81
04/17/02	<50	<0.18	<0.14	<0.18	<0.26	<0.24	NP	3.86	0.00	99.67	95.81
07/31/02	<50	<0.18	<0.14	<0.18	<0.26	<0.24	NP	5.40	0.00	99.67	94.27

**TABLE 1
GROUNDWATER DATA
THRIFTY OIL STATION #049, OAKLAND, CA.**

DATE SAMPLED	ANALYTICAL PARAMETERS						DEPTH TO PRODUCT (feet)	DEPTH TO GROUNDWATER (feet)	PRODUCT THICKNESS (feet)	CASING ELEVATION (feet)	GROUNDWATER ELEVATION (feet)
	BTEX	BENZENE (UG/L)	TOLUENE (UG/L)	ETHYLBENZENE (UG/L)	XYLENE (UG/L)	MTBE (UG/L)					
11/14/02	140	3.2	<0.18	5.2	<0.4	111	NP	5.42	0.00	99.67	94.25
01/29/03	694 J	<0.04	<0.02	<0.02	<0.06	630	NP	3.88	0.00	99.67	95.79
04/23/03	1,550	<0.04	<0.02	<0.02	<0.06	578	NP	3.86	0.00	99.67	95.81
07/10/03	1,670	<0.22	<0.32	<0.31	<0.4	509	NP	5.31	0.00	99.67	94.36
10/20/03	1,320	<0.04	<0.02	<0.02	<0.06	*656 / 662	NP	5.30	0.00	99.67	94.37
01/14/04	272	<0.04	<0.02	<0.02	<0.06	*304 / 180	NP	3.82	0.00	99.67	95.85
04/08/04	<15	<0.22	<0.32	<0.31	<0.4	<0.18	NP	5.18	0.00	99.67	94.49
07/21/04	<15	<0.22	<0.32	<0.31	<0.4	<0.18	NP	6.42	0.00	99.67	93.25
10/20/04	<15	<0.22	<0.32	<0.31	<0.4	<0.18	NP	5.62	0.00	99.67	94.05
01/19/05	<15	<0.22	<0.32	<0.31	<0.4	<0.18	NP	5.40	0.00	99.67	94.27
04/20/05	<15	<0.22	<0.32	<0.31	<0.4	<0.18	NP	5.41	0.00	99.67	94.26
07/20/05	<2.9	<0.32	<0.10	<0.24	<0.30	<0.63	NP	4.07	0.00	99.67	95.60
10/19/05	<2.9	<0.32	<0.10	<0.24	<0.30	<0.63	NP	3.86	0.00	99.67	95.81
01/24/06	<2.9	<0.32	<0.10	<0.24	<0.30	<0.63	NP	5.20	0.00	99.67	94.47
04/19/06	78	<0.32	<0.10	<0.24	<0.30	201	NP	3.87	0.00	99.67	95.80
07/19/06	<5.6	<0.32	<0.10	<0.24	<0.30	<0.63	NP	6.54	0.00	99.67	93.13
09/15/06	-	-	-	-	-	-	-	-	-	-	-
10/18/06	<5.6	<0.32	<0.10	<0.24	<0.30	<0.63	NP	5.40	0.00	99.67	94.27
01/17/07	<5.6	<0.32	<0.10	<0.24	<0.30	<0.63	NP	5.40	0.00	33.14	27.74
04/18/07	2,110	29	357	37	914	<0.63	NP	5.40	0.00	33.14	27.74
07/18/07	65	<0.18	<0.24	<0.21	<0.45	<0.19	NP	7.38	0.00	33.14	25.76
10/17/07	<5.6	<0.18	<0.24	<0.21	<0.45	<0.19	NP	3.86	0.00	33.14	29.28
01/16/08	<5.6	<0.18	<0.24	<0.21	<0.45	<0.19	NP	5.39	0.00	33.14	27.75
MONITORING DATA											
01/09/92	-	-	-	-	-	-	NP	6.30	0.00	99.02	92.72
04/13/92	-	-	-	-	-	-	NP	6.68	0.00	99.02	92.34
10/05/92	-	-	-	-	-	-	NP	9.60	0.00	99.02	89.42
01/06/93	-	-	-	-	-	-	NP	13.90	0.00	99.02	85.12
04/26/93	-	-	-	-	-	-	NP	5.55	0.00	99.02	93.47
01/04/94	-	-	-	-	-	-	NP	7.58	0.00	99.02	91.44
04/05/94	-	-	-	-	-	-	NP	6.66	0.00	99.02	92.36
10/09/95	27,000	2,400	140	1,700	2,700	-	-	-	-	99.02	-
01/08/96	13,000	800	42	540	860	-	NP	6.94	0.00	99.02	92.08
04/08/94	9,100	840	31	690	1,200	-	NP	5.48	0.00	99.02	93.54
07/22/96	11,000	1,700	22	660	700	840	NP	6.60	0.00	99.02	92.42
10/16/96	180	<0.3	<0.3	<0.3	<0.5	270	NP	6.42	0.00	99.02	92.60
01/22/97	130	<0.3	<0.3	<0.3	<0.5	470	NP	5.70	0.00	99.02	93.32
04/21/97	10,000	1,400	27	820	490	1,100	NP	5.30	0.00	99.02	93.72
07/14/97	8,200	660	15	230	270	560	NP	7.90	0.00	99.02	91.12
10/07/97	7,700	480	15	8.4	350	-	NP	7.70	0.00	99.02	91.32
01/19/98	1,400	20	0.74	0.46	4.4	-	NP	6.05	0.00	99.02	92.97
04/23/98	590	<0.3	<0.3	<0.3	<0.5	1,700	NP	7.60	0.00	99.02	91.42
07/20/98	4,900	570	150	300	500	1,500	NP	5.30	0.00	99.02	93.72
10/14/98	1,100	1.0	<0.3	<0.3	5.3	2,000	NP	8.60	0.00	99.02	90.42
01/21/99	570	0.32	<0.3	<0.3	<0.5	* 1,500 / 1,700	NP	6.70	0.00	99.02	92.32
04/15/99	770	<0.3	<0.3	<0.3	<0.5	* 1,400 / 1,200	NP	6.07	0.00	99.02	92.95
07/26/99	500	<0.3	<0.3	<0.3	<0.5	*710 / 950	NP	7.86	0.00	99.02	91.16
10/13/99	<50	<0.3	0.44	<0.3	0.62	<5.0	NP	6.93	0.00	99.02	92.09

**TABLE 1
GROUNDWATER DATA
THRIFTY OIL STATION #049, OAKLAND, CA.**

DATE SAMPLED	ANALYTICAL PARAMETERS						DEPTH TO PRODUCT (feet)	DEPTH TO GROUNDWATER (feet)	PRODUCT THICKNESS (feet)	CASING ELEVATION (feet)	GROUNDWATER ELEVATION (feet)
	WPILE (ug/L)	BENZENE (ug/L)	TOLUENE (ug/L)	ETHYLBENZENE (ug/L)	XYLENE (ug/L)	MIBK (ug/L)					
01/20/00	<50	<0.3	<0.3	<0.3	<0.5	*5.0 / <5.0	NP	6.44	0.00	99.02	92.58
04/05/00	5,670	415	19	1.7	60.1	*329 / 194	NP	7.86	0.00	99.02	91.16
07/19/00	1,350	14	<3.0	<3.0	10	*237 / 120	NP	7.10	0.00	99.02	91.92
10/18/00	<50	<0.18	<0.14	<0.18	<0.26	*63 / 41.1	NP	5.28	0.00	99.02	93.74
01/17/01	<50	<0.18	<0.14	<0.18	<0.26	*57 / 81	NP	5.27	0.00	99.02	93.75
04/19/01	<50	<0.18	<0.14	<0.18	<0.26	66	NP	7.86	0.00	99.02	91.16
07/18/01	<50	<0.18	<0.14	<0.18	<0.26	*9.0 / 3.5	NP	6.30	0.00	99.02	92.72
10/10/01	<50	<0.18	<0.14	<0.18	<0.26	*9.4 / 7.9	NP	8.23	0.00	99.02	90.79
01/30/02	2,590	40	9.0	8.0	6.0	*45 / 22	NP	5.14	0.00	99.02	93.88
04/17/02	51	<0.18	<0.14	<0.18	<0.26	*58 / 45	NP	5.53	0.00	99.02	93.49
07/31/02	<50	<0.18	<0.14	<0.18	<0.26	*39 / 33	NP	5.93	0.00	99.02	93.09
11/14/02	<50	<0.08	<0.18	<0.17	<0.4	6.8	NP	5.92	0.00	99.02	93.10
01/29/03	<15	<0.04	<0.02	<0.02	<0.06	<0.03	NP	5.51	0.00	99.02	93.51
04/23/03	<15	<0.04	<0.02	<0.02	<0.06	<0.03	NP	5.14	0.00	99.02	93.88
07/10/03	<15	<0.22	<0.32	<0.31	<0.4	<0.18	NP	5.03	0.00	99.02	93.99
10/20/03	<15	<0.04	<0.02	<0.02	<0.06	<0.03	NP	5.01	0.00	99.02	94.01
01/14/04	<15	<0.04	<0.02	<0.02	<0.06	<0.03	NP	4.38	0.00	99.02	94.64
04/08/04	<15	<0.22	<0.32	<0.31	<0.4	<0.18	NP	4.86	0.00	99.02	94.16
07/21/04	<15	<0.22	<0.32	<0.31	<0.4	<0.18	NP	6.82	0.00	99.02	92.20
10/20/04	<15	<0.22	<0.32	<0.31	<0.4	<0.18	NP	5.71	0.00	99.02	93.31
01/19/05	<15	<0.22	<0.32	<0.31	<0.4	<0.18	NP	4.77	0.00	99.02	94.25
04/20/05	<15	<0.22	<0.32	<0.31	<0.4	<0.18	NP	5.54	0.00	99.02	93.48
07/20/05	<2.9	<0.32	<0.10	<0.24	<0.30	<0.63	NP	6.80	0.00	99.02	92.22
10/19/05	<2.9	<0.32	<0.10	<0.24	<0.30	<0.63	NP	5.89	0.00	99.02	93.13
01/24/06	<2.9	<0.32	<0.10	<0.24	<0.30	<0.63	NP	4.89	0.00	99.02	94.13
04/19/06	<5.6	<0.32	<0.10	<0.24	<0.30	2.9	NP	5.13	0.00	99.02	93.89
07/19/06	3,430	58	28 J	<2.4	447	528	NP	6.31	0.00	99.02	92.71
09/15/06	<5.6	<0.32	<0.10	<0.24	<0.30	16	NP	6.72	0.00	99.02	92.30
10/18/06	<5.6	<0.32	<0.10	<0.24	<0.30	<0.63	NP	5.13	0.00	99.02	93.89
01/17/07	<5.6	<0.32	<0.10	<0.24	<0.30	<0.63	NP	6.62	0.00	31.61	24.99
04/18/07	<5.6	<0.32	<0.10	<0.24	<0.3	<0.63	NP	5.86	0.00	31.61	25.75
07/18/07	<5.6	<0.18	<0.24	<0.21	<0.45	<0.19	NP	6.82	0.00	31.61	24.79
10/17/07	<5.6	<0.18	<0.24	<0.21	<0.45	<0.19	NP	5.87	0.00	31.61	25.74
01/06/08	<5.6	<0.18	<0.24	<0.21	<0.45	<0.19	NP	4.79	0.00	31.61	26.82

TABLE 1
GROUNDWATER DATA
THRIFTY OIL STATION #049, OAKLAND, CA.

DATE SAMPLED	ANALYTICAL PARAMETERS						DEPTH TO PRODUCT (ft)	DEPTH TO GROUNDWATER (ft)	PRODUCT THICKNESS (ft)	CASING ELEVATION (ft)	GROUNDWATER ELEVATION (ft)
	TOB	BENZENE (ppb)	TOLUENE (ppb)	ETHYLBENZENE (ppb)	XYLENE (ppb)	MIBZ (ppb)					
MONITORING WELL #049-1 Screen Interval = 5m/10 feet											
01/09/92	-	-	-	-	-	-	NP	14.00	0.00	-	-
04/13/92	-	-	-	-	-	-	NP	14.00	0.00	-	-
10/05/92	-	-	-	-	-	-	NP	15.05	0.00	-	-
01/06/93	-	-	-	-	-	-	NP	5.43	0.00	-	-
04/26/93	-	-	-	-	-	-	NP	13.20	0.00	-	-
01/04/94	-	-	-	-	-	-	NP	14.30	0.00	-	-
04/05/94	-	-	-	-	-	-	NP	14.13	0.00	-	-
01/08/96	-	-	-	-	-	-	NP	14.22	0.00	-	-
04/08/96	-	-	-	-	-	-	NP	14.33	0.00	-	-
07/22/96	8,100	530	84	120	860	-	NP	14.27	0.00	-	-
10/16/96	-	-	-	-	-	-	NP	13.10	0.00	-	-
01/22/97	-	-	-	-	-	-	NP	16.97	0.00	-	-
10/07/97	-	-	-	-	-	-	NP	14.20	0.00	-	-
01/15/98	-	-	-	-	-	-	NP	15.60	0.00	-	-
04/23/98	81,000	0.72	1.4	3.2	5.7	270,000	NP	14.20	0.00	-	-
07/20/98	-	-	-	-	-	-	NP	14.30	0.00	-	-
10/14/98	-	-	-	-	-	-	NP	11.20	0.00	-	-
01/21/99	-	-	-	-	-	-	-	-	-	-	-
04/15/99	-	-	-	-	-	-	NP	13.10	0.00	-	-
07/26/99	4,400	<3.0	<3.0	<3.0	<5.0	*6,800 / 9,000	NP	13.83	0.00	-	-
10/13/99	-	-	-	-	-	-	-	-	-	-	-
01/20/00	-	-	-	-	-	-	NP	13.22	0.00	-	-
04/05/00	-	-	-	-	-	-	-	-	-	-	-
07/19/00	-	-	-	-	-	-	NP	13.25	0.00	-	-
10/18/00	-	-	-	-	-	-	NP	11.14	0.00	-	-
01/17/01	-	-	-	-	-	-	NP	11.12	0.00	-	-
04/19/01	-	-	-	-	-	-	-	-	-	-	-
07/18/01	-	-	-	-	-	-	NP	11.20	0.00	-	-
10/10/01	-	-	-	-	-	-	NP	11.20	0.00	-	-
01/30/02	-	-	-	-	-	-	NP	12.30	0.00	-	-
04/17/02	-	-	-	-	-	-	NP	14.30	0.00	-	-
07/31/02	-	-	-	-	-	-	NP	14.21	0.00	-	-
11/14/02	-	-	-	-	-	-	NP	14.13	0.00	-	-
01/29/03	-	-	-	-	-	-	NP	13.12	0.00	-	-
04/23/03	-	-	-	-	-	-	-	No Access	-	-	-
07/10/03	-	-	-	-	-	-	-	No Access	-	-	-
10/20/03	-	-	-	-	-	-	-	No Access	-	-	-
MONITORING WELL #049-2 Screen Interval = 5m/10 feet											
02/03/04	-	-	-	-	-	-	-	-	-	-	-
04/08/04	6,740	42	32 J	<3.1	1,160	239	NP	4.76	0.00	-	-
07/21/04	118	<0.22	<0.32	<0.31	<0.4	107	NP	6.85	0.00	-	-
10/20/04	29,900	3,850	4,010	381	1,920	103	NP	4.28	0.00	-	-
01/19/05	13,400	272	243	24 J	2,230	2,110	NP	4.54	0.00	-	-
04/20/05	1,220	<0.22	<0.32	<0.31	<0.4	1,580	NP	4.95	0.00	-	-
07/07/05	6,490	410	74	84	620	2,560	-	-	-	-	-
07/20/05	4,900	133	52	<2.4	750	465	NP	6.32	0.00	-	-
10/19/05	572	<0.32	<0.10	<0.24	<0.30	417	NP	5.68	0.00	-	-

**TABLE I
GROUNDWATER DATA
THRIFTY OIL STATION #049, OAKLAND, CA.**

DATE SAMPLED	ANALYTICAL PARAMETERS						DEPTH TO PRODUCT (feet)	DEPTH TO GROUNDWATER (feet)	PRODUCT THICKNESS (feet)	CASING ELEVATION (feet)	GROUNDWATER ELEVATION (feet)
	TPH	BENZENE	TOLENE	Ethyl Benzene	XYLENE (m/m)	MTBE (m/m)					
01/24/06	14,500	192	1,150	342	2,980	432	NP	4.78	0.00	-	-
04/19/06	7,430	94	411	<2.4	1,820	571	NP	4.94	0.00	-	-
07/19/06	5,020	55	17 J	<2.4	457	636	NP	7.10	0.00	-	-
09/15/06	-	-	-	-	-	-	-	-	-	-	-
10/18/06	41,500	63	4,710	1,510	6,390	343	NP	6.06	0.00	-	-
01/17/07	164,000	249	25,300	6,040	35,200	217	NP	6.83	0.00	30.59	23.76
04/18/07	13,000	<16	2,230	121 J	5,070	92	NP	7.22	0.00	30.59	23.37
07/18/07	3,930	90	64	291	437	117	NP	5.76	0.00	30.59	24.83
10/17/07	993	<0.18	22	4.7 J	85	108	NP	4.93	0.00	30.59	25.66
01/16/08	1,990	14	5.6	33	99	108	NP	4.56	0.00	30.59	26.03

NOTE: * MTBE 8020 / 8260
 ND = Nondetectable
 NP = No free hydrocarbon product
 * - * = Not analyzed / Not available

Benzene, toluene, ethylbenzene, and xylene analyzed by EPA method 8020.
 Total petroleum hydrocarbons (TPH) analyzed by EPA method 8015 modified for gasoline
 Methyl-tert Butyl Ether (MTBE) analyzed by EPA method 8020 or 8260
 On 7/21/04, 4/08/04, 7/10/03 & 11/14/02, BTEX and MTBE done by 8260B

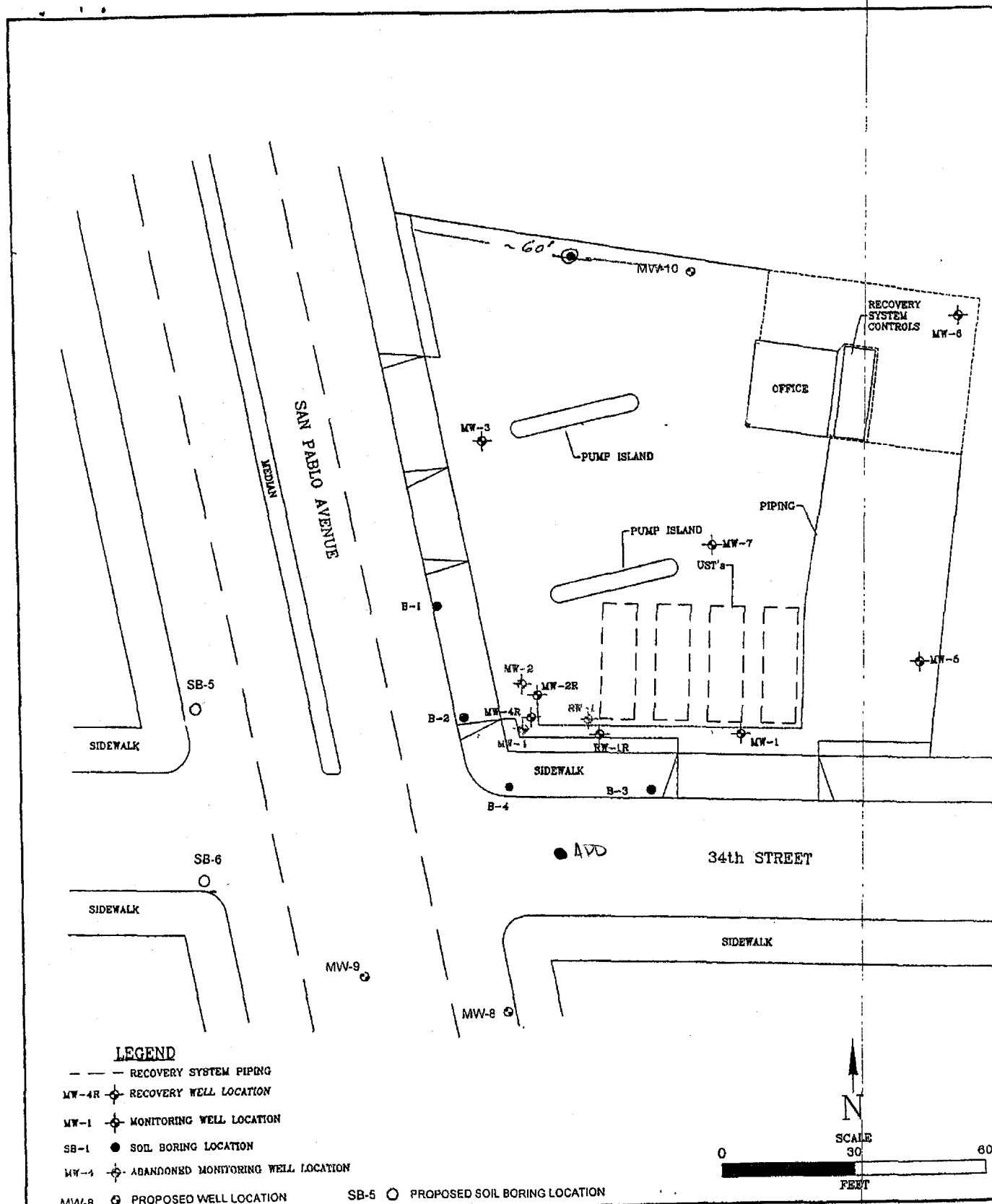

PROPOSED WELL LOCATIONS

Thrifty Oil #49
 3400 San Pablo Avenue
 Oakland, California



Thrifty Oil Co.
 13116 Imperial Highway
 Santa Fe Springs, CA 90670

FIGURE
 2

65

Gradient 0.0319 ft/ft

65' Linear distance