



**Chevron**

ENVIRONMENTAL  
PROTECTION

99 SEP 29 PM 4:19

Chevron U.S.A. Products Company  
6001 Bollinger Canyon Rd. Bldg. L  
P. O. Box 6004  
San Ramon, CA 94583-0804

Site Assessment and  
Remediation Group  
Phone (510) 842-9500  
Fax (510) 842-3370

Date: September 14, 1999  
To: Distribution  
Re: Groundwater Monitoring Report

The enclosed groundwater monitoring report has been properly reviewed by a Chevron authorized representative. Agency guidelines have been followed. Blaine Tech Services is authorized to distribute the report directly to interested parties.

If you have any questions, please call me at (510) 842-8695.

Sincerely,

Brett Hunter  
Site Assessment and Remediation  
Project Manager

**BLAINE**  
TECH SERVICES INC.



1680 ROGERS AVENUE  
SAN JOSE, CALIFORNIA 95112-1105  
(408) 573-7771 FAX  
(408) 573-0555 PHONE

September 14, 1999

Brett Hunter  
Chevron U.S.A. Products Company  
P.O. Box 6004  
San Ramon, CA 94583-0904

### **3rd Quarter 1999 Monitoring at 9-1583**

Third Quarter 1999 Groundwater Monitoring at  
Chevron Service Station Number 9-1583  
5509 Martin Luther King Jr. Way  
Oakland, CA

Monitoring Performed on July 22, 1999

---

#### **Groundwater Sampling Report 990722-X-2**

This report covers the routine monitoring of groundwater wells at this Chevron facility. Blaine Tech Services, Inc.'s work at the site includes inspection, gauging, evacuation, purgewater containment, sample collection and sample handling in accordance with standard procedures that conform to Regional Water Quality Control Board requirements.

Routine field data collection includes depth to water, total well depth, thickness of any separate immiscible layer, water column volume, calculated volume of a three-case volume purge, elapsed evacuation time, total volume of water removed, and standard water parameter instrument readings. Sample material is collected, contained, stored, and transported to the laboratory in conformance with EPA standards. Purgewater is, likewise, collected and transported to McKittrick Waste Treatment Site for disposal.

Basic field information is presented alongside analytical values excerpted from the laboratory report in the cumulative table of **WELL DATA AND ANALYTICAL RESULTS**. The full analytical report for the most recent samples is located in the **Analytical Appendix**. The table also contains new groundwater elevation calculations taken from the computer plotted gradient

map which is located in the **Professional Engineering Appendix**.

At a minimum, Blaine Tech Services, Inc. field personnel are certified upon completion of a forty-hour Hazardous Materials and Emergency Response training course per 29 CFR 1910.120. Field personnel are also enrolled in annual eight hour refresher courses.

Blaine Tech Services, Inc. conducts sampling and documentation assignments of this type as an independent third party. In order to avoid compromising the objectivity necessary for the proper and disinterested performance of this work, Blaine Tech Services, Inc. concentrates on objective data collection and does not participate in the interpretation of analytical results, the definition of geological or hydrological conditions, the formulation of recommendations, or the marketing of remedial systems.

Please call if you have any questions.

Yours truly,



Christine Lillie  
Project Coordinator

CAL/sb

attachments: Professional Engineering Appendix  
Cumulative Table of Well Data and Analytical Results  
Analytical Appendix  
Field Data Sheets

cc: Susan Hugo, Alameda County Health Care Services  
Ben Shimek, Petroleum Sales, Inc.  
Greg Gurss, Gettler-Ryan, Inc.  
Bill Scudder, Chevron (w/o enclosure)

# **Professional Engineering Appendix**

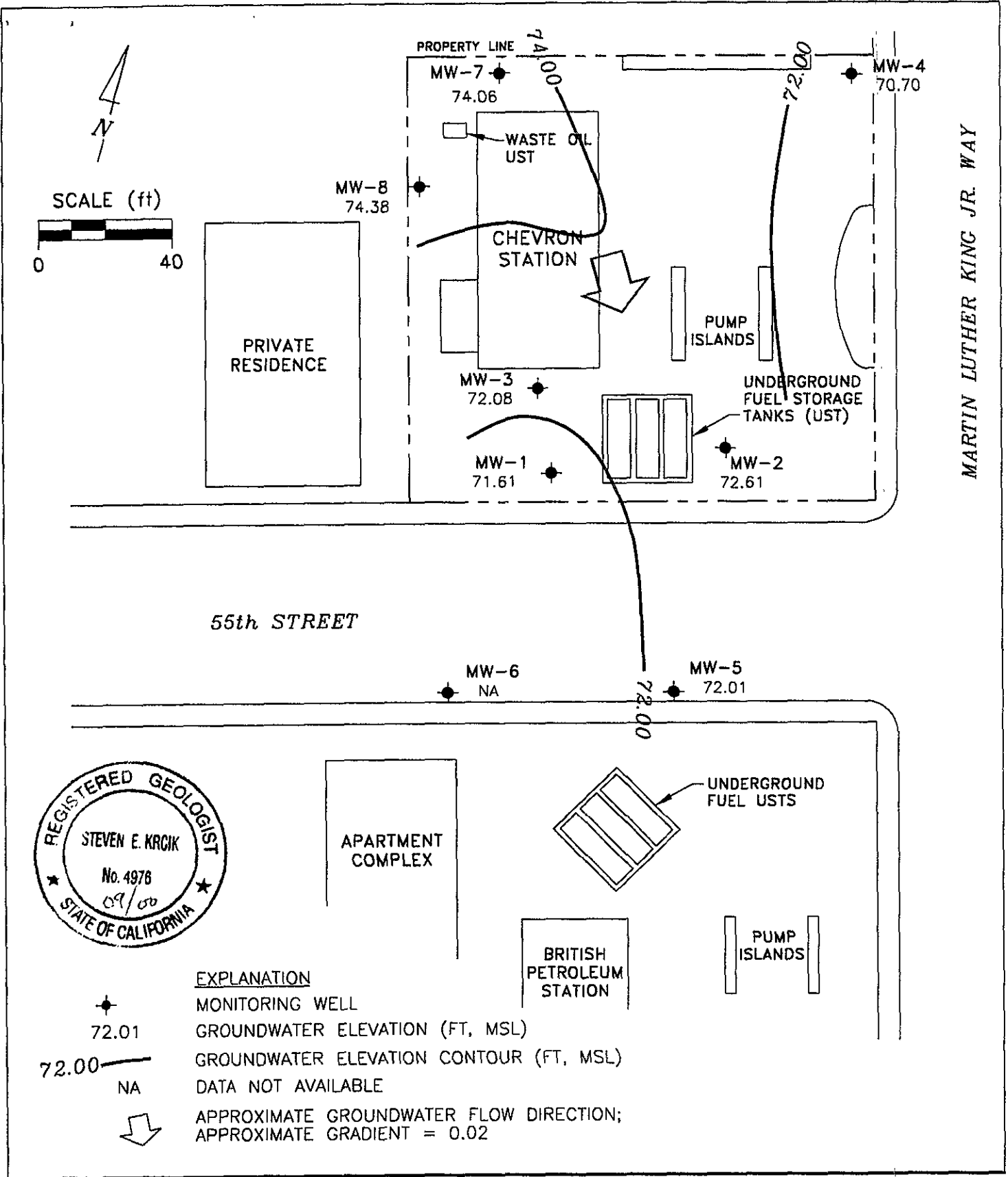

PREPARED BY <b>RRM</b> engineering contracting firm	<b>Chevron Station 9-1583</b> 5509 Martin Luther King Jr. Way Oakland, California	<b>FIGURE:</b> <b>1</b>
	<b>GROUNDWATER ELEVATION CONTOUR MAP,</b> <b>JULY 22, 1999</b>	<b>PROJECT:</b> DAC04

# **Table of Well Data and Analytical Results**

## Cumulative Table of Well Data and Analytical Results

Vertical Measurements are in feet.				Analytical results are in parts per billion (ppb)									
DATE	Well Head Elev.	Ground Water Elev.	Depth To Water	Notes	TPH-Gasoline	Benzene	Toluene	Ethyl-Benzene	Xylene	MTBE	TPH-Diesel	TPH-Motor Oil	Total Oil & Grease
<b>MW-1</b>													
12/22/83	81.97	71.72	10.25	--	--	--	--	--	--	--	--	--	--
12/30/83	81.97	72.80	9.17	--	--	--	--	--	--	--	--	--	--
03/12/90	81.97	71.89	10.08	--	50,000	3000	7300	1900	18,000	--	--	--	--
03/25/90	82.42	71.51	10.46	--	--	--	--	--	--	--	--	--	--
10/18/90	82.42	--	--	--	--	--	--	--	--	--	--	--	--
10/31/90	82.42	--	--	--	--	--	--	--	--	--	--	--	--
11/16/90	82.42	70.84	11.58	--	--	--	--	--	--	--	--	--	--
02/08/91	82.42	72.31	10.11	--	100,000	4200	8400	16,000	2600	--	--	--	--
05/08/91	82.42	71.97	10.45	--	31,000	200	66	670	2000	--	--	--	--
08/12/91	82.42	71.19	11.23	--	17,000	81	7.2	270	710	--	--	--	--
11/07/91	82.42	71.72	10.70	--	7100	24	6.0	130	170	--	--	--	--
02/05/92	82.42	72.05	10.37	--	110,000	8900	14,000	2700	12,000	--	--	--	--
05/13/92	82.42	71.84	10.58	--	19,000	450	85	480	870	--	--	--	--
07/17/92	82.42	71.37	11.05	--	8500	170	<10	360	600	--	--	--	--
10/05/92	82.42	71.01	11.41	--	22,000	4300	5100	570	2900	--	--	--	--
11/11/92	82.42	--	--	--	--	--	--	--	--	--	--	--	--
11/17/92	82.42	--	--	--	--	--	--	--	--	--	--	--	--
11/24/92	82.42	--	--	--	--	--	--	--	--	--	--	--	--
12/01/92	82.42	--	--	--	--	--	--	--	--	--	--	--	--
12/29/92	82.42	--	--	--	--	--	--	--	--	--	--	--	--
01/05/93	82.42	--	--	--	--	--	--	--	--	--	--	--	--
01/08/93	82.42	74.31	8.11	--	14,000,000	12,000	79,000	270,000	1,300,000	--	--	--	--
02/02/93	82.42	--	--	--	--	--	--	--	--	--	--	--	--
04/14/93	82.42	72.57	9.85	--	48,000	670	1100	1600	6300	--	--	--	--
08/06/93	82.42	71.59	10.83	--	44,000	660	990	1600	6100	--	--	--	--
10/21/93	82.42	71.52	10.90	--	18,000	270	460	1300	4700	--	--	--	--
01/05/94	82.42	72.09	10.33	--	22,000	160	160	630	2300	--	--	--	--
04/08/94	82.42	72.24	10.18	--	21,000	37	110	570	1400	--	--	--	--
07/06/94	82.42	71.78	10.64	--	28,000	210	100	540	1200	--	--	--	--
08/04/94	82.42	71.91	10.51	--	--	--	--	--	--	--	--	--	--
10/05/94	82.42	71.51	10.91	--	120,000	39	22	320	900	--	--	--	--
01/18/95	82.42	73.80	8.62	--	12,000	<20	<20	130	160	--	--	--	--
04/07/95	82.42	72.89	9.53	--	2500	<2.5	<2.5	71	38	--	--	--	--
07/06/95	82.42	72.03	10.39	--	5700	<0.5	<0.5	110	110	--	--	--	--
10/11/95	82.42	70.54	11.88	--	2700	13	<5.0	13	5.7	650	--	--	--

CONTINUED ON NEXT PAGE

## Cumulative Table of Well Data and Analytical Results

Vertical Measurements are in feet

Analytical results are in parts per billion (ppb)

DATE	Well Head Elev.	Ground Water Elev.	Depth To Water	Notes	TPH-Gasoline	Benzene	Toluene	Ethyl-Benzene	Xylene	MTBE	TPH-Diesel	TPH-Motor Oil	Total Oil & Grease
<b>MW-1 (CONT'D)</b>													
01/17/96	82.42	73.14	9.28	--	4200	12	<5.0	43	24	300	--	--	--
04/05/96	82.42	72.82	9.60	--	1300	<1.2	<1.2	7.6	2.8	220	--	--	--
07/23/96	82.42	72.19	10.23	--	700	<1.0	<1.0	7.0	4.8	240	--	--	--
10/02/96	82.42	71.67	10.75	--	1700	<2.5	9.8	10	13	610	--	--	--
01/23/97	82.42	74.75	7.67	--	1300	21	<10	<10	<10	2700	--	--	--
04/01/97	82.42	72.22	10.20	--	670	<2.0	<2.0	4.1	3.6	1200	--	--	--
07/09/97	82.42	72.12	10.30	--	460	<1.0	<1.0	<1.0	<1.0	440	--	--	--
10/07/97	82.42	71.73	10.69	--	1100	8.5	<2.0	<2.0	2.0	250	--	--	--
01/22/98	82.42	74.20	8.22	--	460	1.4	5.8	<0.5	<0.5	150	--	--	--
04/02/98	82.42	72.89	9.53	--	220	2.5	1.2	<1.0	1.9	260	--	--	--
07/02/98	82.42	72.08	10.34	--	270	<0.5	0.82	<0.5	<0.5	140	--	--	--
10/02/98	82.42	71.70	10.72	--	170	1.3	<0.5	<0.5	<1.5	320	--	--	--
01/18/99	82.42	72.87	9.55	--	416	<2.5	<2.5	<2.5	<2.5	316	--	--	--
01/18/99	82.42	72.87	9.55	Confirmation run	--	--	--	--	--	295	--	--	--
07/22/99	82.42	71.61	10.81	--	186	<0.5	3.94	1.46	2.37	63.7	--	--	--



## Cumulative Table of Well Data and Analytical Results

Vertical Measurements are in feet.

Analytical results are in parts per billion (ppb)

DATE	Well Head Elev.	Ground Water Elev.	Depth To Water	Notes	TPH-Gasoline	Benzene	Toluene	Ethyl-Benzene	Xylene	MTBE	TPH-Diesel	TPH-Motor Oil	Total Oil & Grease
<b>MW-2</b>													
12/22/83	83.48	72.98	10.50	--	--	--	--	--	--	--	--	--	--
12/30/83	83.48	73.56	9.92	--	--	--	--	--	--	--	--	--	--
03/12/90	83.48	72.46	11.02	--	800	400	22	18	55	--	--	--	--
03/25/90	83.48	72.15	11.33	--	--	--	--	--	--	--	--	--	--
10/18/90	83.48	71.17	12.31	--	--	--	--	--	--	--	--	--	--
10/31/90	83.48	--	--	--	--	--	--	--	--	--	--	--	--
11/16/90	83.48	--	--	--	--	--	--	--	--	--	--	--	--
02/08/91	83.48	72.43	11.05	--	4600	820	440	720	210	--	--	--	--
05/08/91	83.48	72.12	11.36	--	<50	5.0	<0.5	<0.5	<0.5	--	--	--	--
08/12/91	83.48	71.51	11.97	--	<50	<0.5	<0.5	<0.5	<0.5	--	--	--	--
11/07/91	83.48	71.98	11.50	--	<50	<0.5	<0.5	<0.5	<0.5	--	--	--	--
02/05/92	83.48	72.29	11.19	--	1700	390	170	60	200	--	--	--	--
05/13/92	83.48	71.99	11.49	--	74	9.3	<0.5	<0.5	<0.5	--	--	--	--
07/17/92	83.48	71.63	11.85	--	<50	2.0	<0.5	<0.5	<0.5	--	--	--	--
10/05/92	83.48	71.48	12.00	--	3500	1200	530	86	220	--	--	--	--
11/11/92	83.48	--	--	--	--	--	--	--	--	--	--	--	--
11/17/92	83.48	--	--	--	--	--	--	--	--	--	--	--	--
11/24/92	83.48	--	--	--	--	--	--	--	--	--	--	--	--
12/01/92	83.48	--	--	--	--	--	--	--	--	--	--	--	--
12/29/92	83.48	--	--	--	--	--	--	--	--	--	--	--	--
01/05/93	83.48	--	--	--	--	--	--	--	--	--	--	--	--
01/08/93	83.48	74.65	8.83	--	390	140	0.8	7.7	26	--	--	--	--
02/02/93	83.48	--	--	--	--	--	--	--	--	--	--	--	--
04/14/93	83.48	72.69	10.79	--	<50	5.0	<0.5	<0.5	<0.5	--	--	--	--
08/06/93	83.48	71.77	11.71	--	<50	1.0	<0.5	<0.5	<0.5	--	--	--	--
10/21/93	83.48	71.74	11.74	--	<50	1.0	<0.5	9.0	<0.5	--	--	--	--
01/05/94	83.48	72.30	11.18	--	<50	0.7	<0.5	<0.5	0.9	--	--	--	--
04/08/94	83.48	72.42	11.06	--	<50	<0.5	<0.5	<0.5	<0.5	--	--	--	--
07/06/94	83.48	71.80	11.68	--	<50	<0.5	<0.5	<0.5	<0.5	--	--	--	--
08/04/94	83.48	72.29	11.19	--	--	--	--	--	--	--	--	--	--
10/05/94	83.48	71.79	11.69	--	<50	<0.5	<0.5	<0.5	<0.5	--	--	--	--
01/18/95	83.48	74.26	9.22	--	<50	<0.5	<0.5	<0.5	<0.5	--	--	--	--
04/07/95	83.48	73.62	9.86	--	<50	<0.5	<0.5	<0.5	<0.5	--	--	--	--
07/06/95	83.48	72.74	10.74	--	<50	<0.5	<0.5	<0.5	<0.5	--	--	--	--
10/11/95	83.48	72.26	11.22	--	<50	<0.5	<0.5	<0.5	<0.5	<2.5	--	--	--

CONTINUED ON NEXT PAGE

## Cumulative Table of Well Data and Analytical Results

Vertical Measurements are in feet

Analytical results are in parts per billion (ppb)

DATE	Well Head Elev.	Ground Water Elev.	Depth To Water	Notes	TPH-Gasoline	Benzene	Toluene	Ethyl-Benzene	Xylene	MTBE	TPH-Diesel	TPH-Motor Oil	Total Oil & Grease
<b>MW-2 (CONT'D)</b>													
01/17/96	83.48	73.74	9.74	--	<50	<0.5	<0.5	<0.5	<0.5	<2.5	--	--	--
04/05/96	83.48	73.52	9.96	--	<50	<0.5	<0.5	<0.5	<0.5	<2.5	--	--	--
07/23/96	83.48	72.57	10.91	--	<50	<0.5	<0.5	<0.5	<0.5	<2.5	--	--	--
10/02/96	83.48	72.41	11.07	--	<50	<0.5	<0.5	<0.5	<0.5	<2.5	--	--	--
01/23/97	83.48	75.18	8.30	--	<50	<0.5	<0.5	<0.5	<0.5	3.4	--	--	--
04/01/97	83.48	72.90	10.58	--	<50	<0.5	<0.5	<0.5	<0.5	<2.5	--	--	--
07/09/97	83.48	72.58	10.90	--	<50	<0.5	<0.5	<0.5	<0.5	<2.5	--	--	--
10/07/97	83.48	72.52	10.96	--	<50	<0.5	<0.5	<0.5	<0.5	<2.5	--	--	--
01/22/98	83.48	74.73	8.75	--	<50	<0.5	<0.5	<0.5	<0.5	<2.5	--	--	--
04/02/98	83.48	73.66	9.82	--	89	3.0	5.4	4.1	21	<2.5	--	--	--
07/02/98	83.48	72.74	10.74	--	<50	<0.5	<0.5	<0.5	<0.5	<2.5	--	--	--
10/02/98	83.48	72.43	11.05	--	<50	<0.5	<0.5	<0.5	<1.5	<2.5	--	--	--
01/18/99	83.48	73.09	10.39	--	<50	<0.5	<0.5	<0.5	<0.5	<2.0	--	--	--
07/22/99	83.48	72.61	10.87	--	<50	<0.5	<0.5	<0.5	<0.5	<2.0	--	--	--

## Cumulative Table of Well Data and Analytical Results

Vertical Measurements are in feet.

Analytical results are in parts per billion (ppb)

DATE	Well Head Elev.	Ground Water Elev.	Depth To Water	Notes	TPH-Gasoline	Benzene	Toluene	Ethyl-Benzene	Xylene	MTBE	TPH-Diesel	TPH-Motor Oil	Total Oil & Grease
<b>MW-3</b>													
12/22/83	84.36	72.78	11.58	--	--	--	--	--	--	--	--	--	--
12/30/83	84.36	73.19	11.17	--	--	--	--	--	--	--	--	--	--
03/12/90	84.36	72.22	12.14	--	47,000	1000	9900	1700	9800	--	--	--	--
03/25/90	84.38	71.81	12.55	--	--	--	--	--	--	--	--	--	--
10/18/90	84.38	--	--	--	--	--	--	--	--	--	--	--	--
10/31/90	84.38	--	--	--	--	--	--	--	--	--	--	--	--
11/16/90	84.38	70.76	13.62	--	--	--	--	--	--	--	--	--	--
02/08/91	84.38	72.20	12.18	--	58,000	4900	5200	9500	2000	--	--	--	--
05/08/91	84.38	71.86	12.52	--	50,000	2100	1400	2000	9400	--	--	--	--
08/12/91	84.38	71.11	13.27	--	15,000	1300	160	920	1900	--	--	--	--
11/07/91	84.38	71.57	12.81	--	26,000	1000	310	1900	5900	--	--	--	--
02/05/92	84.38	71.91	12.47	--	35,000	2800	1300	1500	4700	--	--	--	--
05/13/92	84.38	71.76	12.62	--	47,000	1500	1200	1100	4800	--	--	--	--
07/17/92	84.38	71.25	13.13	--	15,000	120	11	88	140	--	--	--	--
10/05/92	84.38	70.95	13.62	Free Product (0.24')	--	--	--	--	--	--	--	--	--
11/11/92	84.38	71.63	12.89	Free Product (0.17')	--	--	--	--	--	--	--	--	--
11/17/92	84.38	71.54	12.89	Free Product (0.06')	--	--	--	--	--	--	--	--	--
11/24/92	84.38	71.56	12.86	Free Product (0.05')	--	--	--	--	--	--	--	--	--
12/01/92	84.38	71.48	12.92	Free Product (0.03')	--	--	--	--	--	--	--	--	--
12/29/92	84.38	73.14	11.24	Sheen	--	--	--	--	--	--	--	--	--
01/05/93	84.38	73.23	11.15	Sheen	--	--	--	--	--	--	--	--	--
01/08/93	84.38	74.28	10.10	--	250,000	5000	17,000	5500	28,000	--	--	--	--
02/02/93	84.38	--	--	--	--	--	--	--	--	--	--	--	--
04/14/93	84.38	72.48	11.91	Free Product (0.01')	--	--	--	--	--	--	--	--	--
08/06/93	84.38	71.48	12.90	Free Product (0.01')	150,000	3800	6600	3700	17,000	--	--	--	--
10/21/93	84.38	71.41	12.97	--	22,000	2300	1700	1400	5100	--	--	--	--
01/05/94	84.38	71.96	12.42	--	37,000	1600	1100	1300	6500	--	--	--	--
04/08/94	84.38	72.51	11.87	--	16,000	250	310	500	2500	--	--	--	--
07/06/94	84.38	71.64	12.74	--	43,000	660	320	1900	6400	--	--	--	--
08/04/94	84.38	71.71	12.67	--	--	--	--	--	--	--	--	--	--
10/05/94	84.38	71.43	12.95	--	12,000	280	90	480	370	--	--	--	--
01/18/95	84.38	73.72	10.66	--	20,000	200	230	700	3500	--	--	--	--
04/07/95	84.38	72.84	11.54	--	22,000	120	120	810	4400	--	--	--	--
07/06/95	84.38	71.99	12.39	--	15,000	110	<50	630	2100	--	--	--	--
10/11/95	84.38	72.07	12.31	--	8600	24	<10	360	560	1100	--	--	--

CONTINUED ON NEXT PAGE

## Cumulative Table of Well Data and Analytical Results

Vertical Measurements are in feet.

Analytical results are in parts per billion (ppb)

DATE	Well Head Elev.	Ground Water Elev.	Depth To Water	Notes	TPH-Gasoline	Benzene	Toluene	Ethyl-Benzene	Xylene	MTBE	TPH-Diesel	TPH-Motor Oil	Total Oil & Grease
<b>MW-3 (CONT'D)</b>													
01/17/96	84.38	73.68	10.70	--	9300	<50	<50	230	1100	2300	--	--	--
04/05/96	84.38	73.35	11.03	--	8700	16	<10	110	650	990	--	--	--
07/23/96	84.38	72.38	12.00	--	5400	20	<5.0	190	480	2300	--	--	--
10/02/96	84.38	72.20	12.18	--	6200	43	<20	130	140	2800	--	--	--
01/23/97	84.38	75.12	9.26	--	5600	<5.0	<5.0	39	160	550	--	--	--
04/01/97	84.38	72.75	11.63	--	6900	17	<10	150	330	3900	--	--	--
07/09/97	84.38	72.38	12.00	--	5300	31	<5.0	100	180	2300	--	--	--
10/07/97	84.38	72.27	12.11	--	2400	15	<2.0	30	15	900	--	--	--
01/22/98	84.38	74.73	9.65	--	3200	2.5	7.9	70	220	660	--	--	--
04/02/98	84.38	73.49	10.89	--	1300	14	9.7	25	63	430	--	--	--
07/02/98	84.38	72.69	11.69	--	750	6.9	<5.0	18	9.1	370	--	--	--
10/02/98	84.38	72.23	12.15	--	1400	5.3	0.73	18	6.6	900	--	--	--
01/18/99	84.38	74.05	10.33	--	1270	<1.0	<1.0	7.95	<1.0	100	--	--	--
01/18/99	84.38	74.05	10.33	Confirmation run	--	--	--	--	--	99.7	--	--	--
07/22/99	84.38	72.08	12.30	--	2240	<1.0	<1.0	29.4	13.7	189	--	--	--

## Cumulative Table of Well Data and Analytical Results

Vertical Measurements are in feet.

Analytical results are in parts per billion (ppb)

DATE	Well Head Elev.	Ground Water Elev.	Depth To Water	Notes	TPH-Gasoline	Benzene	Toluene	Ethyl-Benzene	Xylene	MTBE	TPH-Diesel	TPH-Motor Oil	Total Oil & Grease
<b>MW-4</b>													
10/18/90	84.25	68.50	15.75	--	--	--	--	--	--	--	--	--	--
10/31/90	84.25	70.35	13.90	--	<50	<0.5	<0.5	<0.5	1.0	--	--	--	--
11/16/90	84.25	70.00	14.25	--	--	--	--	--	--	--	--	--	--
02/08/91	84.25	71.93	12.32	--	60	17	2.0	12	<0.5	--	--	--	--
05/08/91	84.25	72.02	12.23	--	65	<0.5	<0.5	<0.5	<0.5	--	--	--	--
08/12/91	84.25	70.32	13.93	--	<50	<0.5	<0.5	<0.5	<0.5	--	--	--	--
11/07/91	84.25	70.83	13.42	--	<50	<0.5	<0.5	<0.5	<0.5	--	--	--	--
02/05/92	84.25	71.42	12.83	--	<50	<0.5	<0.5	<0.5	<0.5	--	--	--	--
05/13/92	84.25	70.97	13.28	--	<50	<0.5	<0.5	<0.5	<0.5	--	--	--	--
07/17/92	84.25	70.27	13.98	--	<50	<0.5	<0.5	<0.5	<0.5	--	--	--	--
10/05/92	84.25	70.02	14.23	--	<50	<0.5	<0.5	<0.5	<0.5	--	--	--	--
11/11/92	84.25	--	--	--	--	--	--	--	--	--	--	--	--
11/17/92	84.25	--	--	--	--	--	--	--	--	--	--	--	--
11/24/92	84.25	--	--	--	--	--	--	--	--	--	--	--	--
12/01/92	84.25	--	--	--	--	--	--	--	--	--	--	--	--
12/29/92	84.25	--	--	--	--	--	--	--	--	--	--	--	--
01/05/93	84.25	--	--	--	--	--	--	--	--	--	--	--	--
01/08/93	84.25	74.09	10.16	--	<50	<0.5	<0.5	<0.5	<0.5	--	--	--	--
02/02/93	84.25	--	--	--	--	--	--	--	--	--	--	--	--
04/14/93	84.25	72.21	12.04	--	<50	<0.5	<0.5	<0.5	<0.5	--	--	--	--
08/06/93	84.25	70.34	13.91	--	<50	<0.5	<0.5	<0.5	<0.5	--	--	--	--
10/21/93	84.25	70.26	13.99	--	<50	<0.5	<0.5	<0.5	1.0	--	--	--	--
01/05/94	84.25	71.30	12.95	--	<50	<0.5	<0.5	<0.5	<0.5	--	--	--	--
04/08/94	84.25	71.31	12.94	--	<50	<0.5	<0.5	<0.5	<0.5	--	--	--	--
07/06/94	84.25	70.57	13.68	--	<50	<0.5	<0.5	<0.5	<0.5	--	--	--	--
08/04/94	84.25	70.71	13.54	--	--	--	--	--	--	--	--	--	--
10/05/94	84.25	70.65	13.60	--	<50	<0.5	<0.5	<0.5	<0.5	--	--	--	--
01/18/95	84.25	74.77	9.48	--	<50	<0.5	<0.5	<0.5	<0.5	--	--	--	--
04/07/95	84.25	72.70	11.55	--	<50	<0.5	<0.5	<0.5	<0.5	--	--	--	--
07/06/95	84.25	71.25	13.00	--	<50	<0.5	<0.5	<0.5	<0.5	--	--	--	--
10/11/95	84.25	70.27	13.98	--	<50	<0.5	<0.5	<0.5	<0.5	<2.5	--	--	--
01/17/96	84.25	73.17	11.08	--	<50	<0.5	<0.5	<0.5	<0.5	<2.5	--	--	--
04/05/96	84.25	72.65	11.60	--	<50	<0.5	<0.5	<0.5	<0.5	<2.5	--	--	--
07/23/96	84.25	70.86	13.39	--	<50	<0.5	<0.5	<0.5	<0.5	<2.5	--	--	--
10/02/96	84.25	70.27	13.98	--	<50	<0.5	<0.5	<0.5	<0.5	<2.5	--	--	--

CONTINUED ON NEXT PAGE

## Cumulative Table of Well Data and Analytical Results

Vertical Measurements are in feet.				Analytical results are in parts per billion (ppb)									
DATE	Well Head Elev.	Ground Water Elev.	Depth To Water	Notes	TPH-Gasoline	Benzene	Toluene	Ethyl-Benzene	Xylene	MTBE	TPH-Diesel	TPH-Motor Oil	Total Oil & Grease
<b>MW-4 (CONT'D)</b>													
01/23/97	84.25	74.72	9.53	--									
04/01/97	84.25	71.68	12.57	--	<50	<0.5	<0.5	<0.5	<0.5	<2.5	--	--	--
07/09/97	84.25	70.64	13.61	--	<50	<0.5	<0.5	<0.5	<0.5	<2.5	--	--	--
10/07/97	84.25	70.51	13.74	--	<50	<0.5	<0.5	<0.5	<0.5	<2.5	--	--	--
01/22/98	84.25	74.90	9.35	--	<50	<0.5	<0.5	<0.5	<0.5	<2.5	--	--	--
04/02/98	84.25	73.00	11.25	--	<50	<0.5	<0.5	<0.5	<0.5	<2.5	--	--	--
07/02/98	84.25	71.84	12.41	--	<50	<0.5	<0.5	<0.5	<0.5	<2.5	--	--	--
10/02/98	84.25	71.00	13.25	--	<50	<0.5	<0.5	<0.5	<0.5	<2.5	--	--	--
01/18/99	84.25	72.65	11.60	--	<50	<0.5	<0.5	<0.5	<0.5	<2.5	--	--	--
07/22/99	84.25	70.70	13.55	--	<50	<0.5	<0.5	<0.5	<1.5	<2.5	--	--	--
					<50	<0.5	<0.5	<0.5	<0.5	<2.0	--	--	--
										<2.0	--	--	--

## Cumulative Table of Well Data and Analytical Results

Vertical Measurements are in feet.

Analytical results are in parts per billion (ppb)

DATE	Well Head Elev.	Ground Water Elev.	Depth To Water	Notes	TPH-Gasoline	Benzene	Toluene	Ethyl-Benzene	Xylene	MTBE	TPH-Diesel	TPH-Motor Oil	Total Oil & Grease
<b>MW-5</b>													
10/18/90	81.95	71.17	10.78	--	--	--	--	--	--	--	--	--	--
10/31/90	81.95	71.32	10.63	--	--	--	--	--	--	--	--	--	--
11/16/90	81.95	71.27	10.68	--	110	<0.5	<0.5	<0.5	<0.5	--	--	--	--
02/08/91	81.95	72.78	9.17	--	--	--	--	--	--	--	--	--	--
05/08/91	81.95	73.27	8.68	--	<50	<0.5	<0.5	<0.5	<0.5	--	--	--	--
08/12/91	81.95	71.62	10.33	--	<50	<0.5	<0.5	<0.5	<0.5	--	--	--	--
11/07/91	81.95	72.19	9.76	--	<50	<0.5	<0.5	<0.5	<0.5	--	--	--	--
02/05/92	81.95	72.48	9.47	--	<50	<0.5	<0.5	<0.5	<0.5	--	--	--	--
05/13/92	81.95	72.25	9.70	--	69	<0.5	<0.5	<0.5	<0.5	--	--	--	--
07/17/92	81.95	71.74	10.21	--	74	<0.5	<0.5	<0.5	<0.5	--	--	--	--
10/05/92	81.95	71.34	10.61	--	880	2.6	<1.2	4.6	11	--	--	--	--
11/11/92	81.95	--	--	--	120	<0.5	<0.5	0.6	4.9	--	--	--	--
11/17/92	81.95	--	--	--	--	--	--	--	--	--	--	--	--
11/24/92	81.95	--	--	--	--	--	--	--	--	--	--	--	--
12/01/92	81.95	--	--	--	--	--	--	--	--	--	--	--	--
12/29/92	81.95	--	--	--	--	--	--	--	--	--	--	--	--
01/05/93	81.95	--	--	--	--	--	--	--	--	--	--	--	--
01/08/93	81.95	74.61	7.34	--	--	--	--	--	--	--	--	--	--
02/02/93	81.95	--	--	--	61	<0.5	<0.5	<0.5	<0.5	--	--	--	--
04/14/93	81.95	--	--	--	--	--	--	--	--	--	--	--	--
08/06/93	81.95	71.99	9.96	--	--	--	--	--	--	--	--	--	--
10/21/93	81.95	71.89	10.06	--	<50	<0.5	<0.5	<0.5	<0.5	--	--	--	--
01/05/94	81.95	72.52	9.43	--	<50	<0.5	<0.5	2.0	4.0	--	--	--	--
04/08/94	81.95	72.56	9.39	--	<50	<0.5	<0.5	<0.5	<0.5	--	--	--	--
07/06/94	81.95	72.19	9.76	--	<50	<0.5	<0.5	<0.5	<0.5	--	--	--	--
08/04/94	81.95	72.13	9.82	--	<50	0.6	<0.5	<0.5	<0.5	--	--	--	--
10/05/94	81.95	71.89	10.06	--	--	--	--	--	<0.5	--	--	--	--
01/18/95	81.95	--	--	Inaccessible	<50	<0.5	<0.5	<0.5	<0.5	--	--	--	--
04/07/95	81.95	73.31	8.64	--	--	--	--	--	--	--	--	--	--
07/06/95	81.95	72.52	9.43	--	<50	<0.5	<0.5	<0.5	<0.5	--	--	--	--
10/11/95	81.95	72.12	9.83	--	<50	<0.5	<0.5	<0.5	<0.5	--	--	--	--
01/17/96	81.95	73.63	8.32	--	<50	<0.5	<0.5	<0.5	<0.5	--	--	--	--
04/05/96	81.95	73.23	8.72	--	<50	<0.5	<0.5	<0.5	<0.5	<2.5	--	--	--
07/23/96	81.95	72.25	9.70	--	<50	<0.5	<0.5	<0.5	<0.5	<2.5	--	--	--
10/02/96	81.95	72.06	9.89	--	<50	<0.5	<0.5	<0.5	<0.5	<2.5	--	--	--
					<50	<0.5	<0.5	<0.5	<0.5	<2.5	--	--	--

CONTINUED ON NEXT PAGE

### Cumulative Table of Well Data and Analytical Results

Vertical Measurements are in feet.

Analytical results are in parts per billion (ppb)

DATE	Well Head Elev.	Ground Water Elev.	Depth To Water	Notes	TPH-Gasoline	Benzene	Toluene	Ethyl-Benzene	Xylene	MTBE	TPH-Diesel	TPH-Motor Oil	Total Oil & Grease
<b>MW-5 (CONT'D)</b>													
01/23/97	81.95	74.72	7.23	--	<50	<0.5	<0.5	<0.5	<0.5	<2.5	--	--	--
04/01/97	81.95	--	--	Inaccessible	--	--	--	--	--	--	--	--	--
07/09/97	81.95	72.27	9.68	--	<50	<0.5	<0.5	<0.5	<0.5	<2.5	--	--	--
10/07/97	81.95	72.14	9.81	--	<50	<0.5	<0.5	<0.5	<0.5	<2.5	--	--	--
01/22/98	81.95	74.80	7.15	--	<50	<0.5	<0.5	<0.5	<0.5	<2.5	--	--	--
04/02/98	81.95	--	--	Inaccessible	--	--	--	--	--	--	--	--	--
07/02/98	81.95	72.43	9.52	--	<50	<0.5	<0.5	<0.5	<0.5	<2.5	--	--	--
10/02/98	81.95	72.14	9.81	--	<50	<0.5	<0.5	<0.5	<0.5	<2.5	--	--	--
01/18/99	81.95	73.11	8.84	--	<50	<0.5	<0.5	<0.5	<1.5	<2.5	--	--	--
07/22/99	81.95	72.01	9.94	--	<50	<0.5	<0.5	<0.5	<0.5	<2.0	--	--	--



### Cumulative Table of Well Data and Analytical Results

Vertical Measurements are in feet.				Analytical results are in parts per billion (ppb)									
DATE	Well Head Elev.	Ground Water Elev.	Depth To Water	Notes	TPH-Gasoline	Benzene	Toluene	Ethyl-Benzene	Xylene	MTBE	TPH-Diesel	TPH-Motor Oil	Total Oil & Grease
<b>MW-6</b>													
10/18/90	80.60	70.81	9.79	--	--	--	--	--	--	--	--	--	--
10/31/90	80.60	70.91	9.69	--	--	--	--	--	--	--	--	--	--
11/16/90	80.60	70.86	9.74	--	<50	<0.5	<0.5	<0.5	3.0	--	--	--	--
02/08/91	80.60	--	--	--	--	--	--	--	--	--	--	--	--
05/08/91	80.60	71.06	9.54	--	--	--	--	--	--	--	--	--	--
08/12/91	80.60	71.10	9.50	--	56	<0.5	<0.5	<0.5	<0.5	--	--	--	--
11/07/91	80.60	71.71	8.89	--	<50	<0.5	<0.5	<0.5	<0.5	--	--	--	--
02/05/92	80.60	72.01	8.59	--	<50	<0.5	<0.5	<0.5	<0.5	--	--	--	--
05/13/92	80.60	--	--	--	<50	<0.5	<0.5	<0.5	<0.5	--	--	--	--
07/17/92	80.60	--	--	--	--	--	--	--	--	--	--	--	--
10/05/92	80.60	--	--	--	--	--	--	--	--	--	--	--	--
11/11/92	80.60	--	--	--	--	--	--	--	--	--	--	--	--
11/17/92	80.60	--	--	--	--	--	--	--	--	--	--	--	--
11/24/92	80.60	--	--	--	--	--	--	--	--	--	--	--	--
12/01/92	80.60	--	--	--	--	--	--	--	--	--	--	--	--
12/29/92	80.60	--	--	--	--	--	--	--	--	--	--	--	--
01/05/93	80.60	--	--	--	--	--	--	--	--	--	--	--	--
01/08/93	80.60	--	--	--	--	--	--	--	--	--	--	--	--
02/02/93	80.60	72.89	7.71	--	--	--	--	--	--	--	--	--	--
04/14/93	80.60	72.41	8.19	--	<50	2.1	<0.5	<0.5	2.2	--	--	--	--
08/06/93	80.60	71.52	9.08	--	<50	1.0	<0.5	<0.5	<0.5	--	--	--	--
10/21/93	80.60	71.46	9.14	--	<50	<0.5	<0.5	<0.5	<0.5	--	--	--	--
01/05/94	80.60	72.06	8.54	--	<50	<0.5	<0.5	<0.5	<0.5	--	--	--	--
04/08/94	80.60	--	--	--	<50	4.0	<0.5	<0.5	<0.5	--	--	--	--
07/06/94	80.60	--	--	Inaccessible	--	--	--	--	--	--	--	--	--
08/04/94	80.60	71.66	8.94	--	--	--	--	--	--	--	--	--	--
10/05/94	80.60	--	--	Inaccessible	<50	<0.5	<0.5	<0.5	<0.5	--	--	--	--
01/18/95	80.60	73.50	7.10	--	--	--	--	--	--	--	--	--	--
04/07/95	80.60	72.77	7.83	--	<50	0.69	<0.5	<0.5	0.57	--	--	--	--
07/06/95	80.60	72.03	8.57	--	<50	1.8	<0.5	<0.5	<0.5	--	--	--	--
10/11/95	80.60	71.54	9.06	--	<50	<0.5	<0.5	<0.5	<0.5	--	--	--	--
01/17/96	80.60	73.20	7.40	--	<125	<1.2	<1.2	<1.2	<1.2	540	--	--	--
04/05/96	80.60	72.70	7.90	--	<50	<0.5	<0.5	<0.5	<0.5	180	--	--	--
07/23/96	80.60	71.86	8.74	--	<125	1.4	<1.2	<1.2	<1.2	700	--	--	--
10/02/96	80.60	71.62	8.98	--	<500	<5.0	<5.0	<5.0	<5.0	540	--	--	--
					<100	<1.0	<1.0	<1.0	1.8	910	--	--	--

CONTINUED ON NEXT PAGE

### Cumulative Table of Well Data and Analytical Results

Vertical Measurements are in feet.

Analytical results are in parts per billion (ppb)

DATE	Well Head Elev.	Ground Water Elev.	Depth To Water	Notes	TPH-Gasoline	Benzene	Toluene	Ethyl-Benzene	Xylene	MTBE	TPH-Diesel	TPH-Motor Oil	Total Oil & Grease
<b>MW-6 (CONT'D)</b>													
01/23/97	80.60	--	--	Inaccessible	--	--	--	--	--	--	--	--	--
04/01/97	80.60	72.22	8.38	--	<250	<2.5	<2.5	<2.5	<2.5	640	--	--	--
07/09/97	80.60	--	--	Inaccessible	--	--	--	--	--	--	--	--	--
10/07/97	80.60	71.71	8.89	--	<50	<0.5	<0.5	<0.5	<0.5	640	--	--	--
01/22/98	80.60	73.90	6.70	--	<50	<0.5	<0.5	<0.5	<0.5	200	--	--	--
04/02/98	80.60	72.79	7.81	--	<250	<2.5	<2.5	<2.5	<2.5	480	--	--	--
07/02/98	80.60	71.62	8.98	--	<50	<0.5	<0.5	<0.5	<0.5	420	--	--	--
10/02/98	80.60	71.68	8.92	--	<50	<0.5	<0.5	<0.5	<1.5	270	--	--	--
01/18/99	80.60	--	--	Inaccessible	--	--	--	--	--	--	--	--	--
07/22/99	80.60	--	--	Inaccessible	--	--	--	--	--	--	--	--	--

### Cumulative Table of Well Data and Analytical Results

Vertical Measurements are in feet.				Analytical results are in parts per billion (ppb)									
DATE	Well Head Elev.	Ground Water Elev.	Depth To Water	Notes	TPH-Gasoline	Benzene	Toluene	Ethyl-Benzene	Xylene	MTBE	TPH-Diesel	TPH-Motor Oil	Total Oil & Grease
<b>MW-7</b>													
03/08/94	86.36	74.99	11.37	--	1200	440	31	73	200	--	<10	4100	--
07/06/94	86.36	--	--	--	--	--	--	--	--	--	--	--	--
08/04/94	86.36	73.86	12.50	--	120	15	<0.5	3.8	1.8	--	--	--	--
10/05/94	86.36	73.99	12.37	--	150	1.2	<0.5	1.2	1.7	--	--	--	--
01/18/95	86.36	74.82	11.54	--	260	11	<1.0	17	6.8	--	--	--	--
04/07/95	86.36	75.63	10.73	--	230	<0.5	<0.5	25	0.93	--	--	--	--
07/06/95	86.36	74.36	12.00	--	320	<1.0	<1.0	<1.0	<1.0	--	--	--	6900
10/11/95	86.36	73.56	12.80	--	<50	<0.5	<0.5	<0.5	<0.5	120	--	2300*	--
01/17/96	86.36	75.90	10.46	--	<50	<0.5	<0.5	<0.5	<0.5	460	--	1700	--
04/05/96	86.36	76.56	9.80	--	130	<0.5	<0.5	<0.5	<0.5	120	--	590	--
07/23/96	86.36	74.57	11.79	--	<500	<5.0	<5.0	<5.0	<0.5	1200	--	820	--
10/02/96	86.36	73.10	13.26	--	<100	<1.0	<1.0	<1.0	<1.0	360	--	1500	--
01/23/97	86.36	77.64	8.72	--	<100	<1.0	<1.0	<1.0	<1.0	490	--	<500	--
04/01/97	86.36	75.09	11.27	--	<250	<2.5	<2.5	<2.5	<2.5	1200	--	1600	--
07/09/97	86.36	73.92	12.44	--	<250	5.9	<2.5	<2.5	<2.5	1200	--	5700	--
10/07/97	86.36	73.44	12.92	--	<50	<0.5	<0.5	<0.5	<0.5	240	--	<500	--
01/22/98	86.36	75.14	11.22	--	<50	<0.5	<0.5	<0.5	<0.5	400	--	<500	--
04/02/98	86.36	75.67	10.69	--	56	<0.5	<0.5	<0.5	<0.5	290	--	<500	--
07/02/98	86.36	75.94	10.42	--	<50	<0.5	<0.5	<0.5	<0.5	380	--	<500	--
10/02/98	86.36	74.14	12.22	--	<50	<0.5	<0.5	<0.5	<1.5	660	--	1700	--
01/18/99	86.36	75.36	11.00	--	<100	<1.0	<1.0	<1.0	<1.0	281	--	543	--
01/18/99	86.36	75.36	11.00	Confirmation run	--	--	--	--	--	296	--	--	--
07/22/99	86.36	74.06	12.30	--	<50	<0.5	<0.5	<0.5	<0.5	155	--	--	--

\* Chromatogram pattern indicates an unidentified hydrocarbon.

### Cumulative Table of Well Data and Analytical Results

Vertical Measurements are in feet.

DATE	Well Head Elev.	Ground Water Elev.	Depth To Water	Notes	TPH-Gasoline	Benzene	Toluene	Ethyl-Benzene	Xylene	MTBE	TPH-Diesel	TPH-Motor Oil	Total Oil & Grease
<b>MW-8</b>													
03/08/94	85.93	75.06	10.87	--	28,000	2900	1300	1200	6800	--	<10	<100	--
07/06/94	85.93	--	--	--	--	--	--	--	--	--	--	--	--
08/04/94	85.93	73.77	12.16	--	22,000	3000	260	870	4400	--	--	--	--
10/05/94	85.93	72.71	13.22	--	12,000	1800	34	4.6	890	--	--	--	--
01/18/95	85.93	75.51	10.42	--	19,000	1000	65	1100	3500	--	--	--	--
04/07/95	85.93	75.48	10.45	--	14,000	310	<25	720	1700	--	--	--	--
07/06/95	85.93	74.30	11.63	--	19,000	280	<50	1200	2600	--	--	--	--
10/11/95	85.93	73.51	12.42	--	6100	140	5.5	320	280	1200	--	--	--
01/17/96	85.93	75.95	9.98	--	12,000	86	<20	590	1400	1100	--	<500	--
04/05/96	85.93	75.60	10.33	--	7500	180	23	410	480	560	--	<500	--
07/23/96	85.93	74.56	11.37	--	3800	47	<5.0	350	84	1800	--	<500	--
10/02/96	85.93	73.90	12.03	--	4400	65	<5.0	140	28	1500	--	<500	--
01/23/97	85.93	77.73	8.20	--	3800	36	5.9	140	36	910	--	<500	--
04/01/97	85.93	75.80	10.13	--	6100	43	<20	380	76	1800	--	<500	--
07/09/97	85.93	73.77	12.16	--	7300	48	<25	120	<25	2400	--	<500	--
10/07/97	85.93	73.77	12.16	--	3100	<10	<10	67	<10	1400	--	<500	--
01/22/98	85.93	75.83	10.10	--	1900	5.5	8.3	120	17	780	--	<500	--
04/02/98	85.93	75.55	10.38	--	2900	43	19	110	<10	800	--	<500	--
07/02/98	85.93	74.78	11.15	--	5000	31	<10	120	15	780	--	<500	--
10/02/98	85.93	74.03	11.90	--	2200	6.5	<0.5	21	2.6	140	--	1200*	--
01/18/99	85.93	75.12	10.81	--	2870	<5.0	<5.0	9.02	<5.0	476	554	<250	--
01/18/99	85.93	75.12	10.81	Confirmation run	--	--	--	--	--	478	--	--	--
07/22/99	85.93	74.38	11.55	--	2190	<1.0	<1.0	3.51	1.61	228	--	--	--

\* Chromatogram pattern indicates an unidentified hydrocarbon.

### Cumulative Table of Well Data and Analytical Results

Vertical Measurements are in feet.

DATE	Well Head Elev.	Ground Water Elev.	Depth To Water	Notes	TPH-Gasoline	Benzene	Toluene	Ethyl-Benzene	Xylene	MTBE	TPH-Diesel	TPH-Motor Oil	Total Oil & Grease
<b>TRIP BLANK</b>													
03/12/90	--	--	--	--	<50	<0.3	<0.3	<0.3	<0.6	--	--	--	--
02/08/91	--	--	--	--	<50	<0.5	<0.5	<0.5	<0.5	--	--	--	--
05/08/91	--	--	--	--	<50	<0.5	<0.5	<0.5	<0.5	--	--	--	--
08/12/91	--	--	--	--	<50	<0.5	<0.5	<0.5	<0.5	--	--	--	--
11/07/91	--	--	--	--	<50	<0.5	<0.5	<0.5	<0.5	--	--	--	--
02/05/92	--	--	--	--	<50	<0.5	<0.5	<0.5	<0.5	--	--	--	--
05/13/92	--	--	--	--	<50	<0.5	<0.5	<0.5	<0.5	--	--	--	--
07/17/92	--	--	--	--	<50	<0.5	<0.5	<0.5	<0.5	--	--	--	--
10/05/92	--	--	--	--	<50	<0.5	<0.5	<0.5	<0.5	--	--	--	--
11/11/92	--	--	--	--	--	--	--	--	--	--	--	--	--
11/17/92	--	--	--	--	--	--	--	--	--	--	--	--	--
11/29/92	--	--	--	--	--	--	--	--	--	--	--	--	--
12/01/92	--	--	--	--	--	--	--	--	--	--	--	--	--
12/29/92	--	--	--	--	--	--	--	--	--	--	--	--	--
01/05/93	--	--	--	--	--	--	--	--	--	--	--	--	--
01/08/93	--	--	--	--	<50	<0.5	<0.5	<0.5	<0.5	--	--	--	--
02/02/93	--	--	--	--	--	--	--	--	--	--	--	--	--
04/14/93	--	--	--	--	<50	<0.5	<0.5	<0.5	<0.5	--	--	--	--
08/06/93	--	--	--	--	<50	<0.5	<0.5	<0.5	<0.5	--	--	--	--
10/21/93	--	--	--	--	<50	<0.5	<0.5	<0.5	<0.5	--	--	--	--
01/05/94	--	--	--	--	<50	<0.5	<0.5	<0.5	<0.5	--	--	--	--
04/08/94	--	--	--	--	<50	<0.5	<0.5	<0.5	<0.5	--	--	--	--
07/06/94	--	--	--	--	<50	<0.5	<0.5	<0.5	<0.5	--	--	--	--
08/04/94	--	--	--	--	<50	<0.5	<0.5	<0.5	<0.5	--	--	--	--
10/05/94	--	--	--	--	<50	<0.5	<0.5	<0.5	<0.5	--	--	--	--
01/18/95	--	--	--	--	<50	<0.5	<0.5	<0.5	<0.5	--	--	--	--
04/07/95	--	--	--	--	<50	<0.5	<0.5	<0.5	<0.5	--	--	--	--
07/06/95	--	--	--	--	<50	<0.5	<0.5	<0.5	<0.5	--	--	--	--
10/11/95	--	--	--	--	<50	<0.5	<0.5	<0.5	<0.5	--	--	--	--
01/17/96	--	--	--	--	<50	<0.5	<0.5	<0.5	<0.5	<2.5	--	--	--
04/05/96	--	--	--	--	<50	<0.5	<0.5	<0.5	<0.5	<2.5	--	--	--
07/23/96	--	--	--	--	<50	<0.5	<0.5	<0.5	<0.5	<2.5	--	--	--
10/02/96	--	--	--	--	<50	<0.5	<0.5	<0.5	<0.5	--	--	--	--

CONTINUED ON NEXT PAGE

## Cumulative Table of Well Data and Analytical Results

Vertical Measurements are in feet.

Analytical results are in parts per billion (ppb)

DATE	Well Head Elev.	Ground Water Elev.	Depth To Water	Notes	TPH-Gasoline	Benzene	Toluene	Ethyl-Benzene	Xylene	MTBE	TPH-Diesel	TPH-Motor Oil	Total Oil & Grease
<b>TRIP BLANK (CONT'D)</b>													
01/23/97	--	--	--	--	<50	<0.5	<0.5	<0.5	<0.5	<2.5	--	--	--
04/01/97	--	--	--	--	<50	<0.5	<0.5	<0.5	<0.5	<2.5	--	--	--
07/09/97	--	--	--	--	<50	<0.5	<0.5	<0.5	<0.5	<2.5	--	--	--
10/07/97	--	--	--	--	<50	<0.5	<0.5	<0.5	<0.5	<2.5	--	--	--
01/22/98	--	--	--	--	<50	<0.5	<0.5	<0.5	<0.5	<2.5	--	--	--
04/02/98	--	--	--	--	<50	<0.5	<0.5	<0.5	<0.5	<2.5	--	--	--
07/02/98	--	--	--	--	<50	<0.5	<0.5	<0.5	<0.5	<2.5	--	--	--
10/02/98	--	--	--	--	<50	<0.5	<0.5	<0.5	<0.5	<2.5	--	--	--
01/18/99	--	--	--	--	<50	<0.5	<0.5	<0.5	<0.5	<2.0	--	--	--

Note: Blaine Tech Services, Inc. began routine monitoring of the groundwater wells at this site on November 1, 1994.  
 Earlier field data and analytical results are drawn from the November 23, 1994 Groundwater Technology, Inc. report.

**ABBREVIATIONS:**

TPH = Total Petroleum Hydrocarbons

MTBE = Methyl t-Butyl Ether

# Analytical Appendix



August 12, 1999

Christine Lillie  
Blaine Tech Services  
1680 Rogers Avenue  
San Jose, CA 95112

RE: /M907961

Dear Christine Lillie

Enclosed are the results of analyses for sample(s) received by the laboratory on July 23, 1999. If you have any questions concerning this report, please feel free to contact me.

Sincerely,

Anne Fowler  
Project Manager

CA ELAP Certificate Number 1210







Sequoia Analytical - Morgan Hill  
885 Jarvis Drive  
Morgan Hill, CA 95037

Project: Anne Fowler  
Project Number: M907961  
Project Manager: Anne Fowler

Sampled: 7/22/99  
Received: 7/23/99  
Reported: 8/6/99

**ANALYTICAL REPORT FOR P908061**

Sample Description	Laboratory Sample Number	Sample Matrix	Date Sampled
M907961-01/MW-1	P908061-01	Water	7/22/99
M907961-02/MW-2	P908061-02	Water	7/22/99
M907961-03/MW-3	P908061-03	Water	7/22/99
M907961-04/MW-4	P908061-04	Water	7/22/99
M907961-05/MW-5	P908061-05	Water	7/22/99
M907961-06/MW-7	P908061-06	Water	7/22/99
M907961-07/MW-8	P908061-07	Water	7/22/99





Sequoia Analytical - Morgan Hill 885 Jarvis Drive Morgan Hill, CA 95037	Project: Anne Fowler Project Number: M907961 Project Manager: Anne Fowler	Sampled: 7/22/99 Received: 7/23/99 Reported: 8/6/99
---	---	---

**Total Petroleum Hydrocarbons as Gasoline and BTEX by EPA 8015M/8020M  
Sequoia Analytical - Petaluma**

Analyte	Batch Number	Date Prepared	Date Analyzed	Surrogate Limits	Reporting Limit	Result	Units	Notes*
<b><u>M907961-01/MW-1</u></b>				<b><u>P908061-01</u></b>			<b><u>Water</u></b>	
Gasoline	9080086	8/4/99	8/4/99		50.0	186	ug/l	
Benzene	"	"	"		0.500	ND	"	
Toluene	"	"	"		0.500	3.94	"	
Ethylbenzene	"	"	"		0.500	1.46	"	
Xylenes (total)	"	"	"		0.500	2.37	"	
Methyl tert-butyl ether	"	"	"		2.00	63.7	"	
Surrogate: a,a,a-Trifluorotoluene	"	"	"	65.0-135		105	%	
Surrogate: 4-Bromofluorobenzene	"	"	"	65.0-135		96.3	"	
<b><u>M907961-02/MW-2</u></b>				<b><u>P908061-02</u></b>			<b><u>Water</u></b>	
Gasoline	9080086	8/4/99	8/4/99		50.0	ND	ug/l	
Benzene	"	"	"		0.500	ND	"	
Toluene	"	"	"		0.500	ND	"	
Ethylbenzene	"	"	"		0.500	ND	"	
Xylenes (total)	"	"	"		0.500	ND	"	
Methyl tert-butyl ether	"	"	"		2.00	ND	"	
Surrogate: a,a,a-Trifluorotoluene	"	"	"	65.0-135		102	%	
Surrogate: 4-Bromofluorobenzene	"	"	"	65.0-135		94.7	"	
<b><u>M907961-03/MW-3</u></b>				<b><u>P908061-03</u></b>			<b><u>Water</u></b>	
Gasoline	9080086	8/4/99	8/4/99		100	2240	ug/l	
Benzene	"	"	"		1.00	ND	"	
Toluene	"	"	"		1.00	ND	"	
Ethylbenzene	"	"	"		1.00	29.4	"	
Xylenes (total)	"	"	"		1.00	13.7	"	
Methyl tert-butyl ether	"	"	"		4.00	189	"	
Surrogate: a,a,a-Trifluorotoluene	"	"	"	65.0-135		94.7	%	
Surrogate: 4-Bromofluorobenzene	"	"	"	65.0-135		97.3	"	
<b><u>M907961-04/MW-4</u></b>				<b><u>P908061-04</u></b>			<b><u>Water</u></b>	
Gasoline	9080086	8/4/99	8/4/99		50.0	ND	ug/l	
Benzene	"	"	"		0.500	ND	"	
Toluene	"	"	"		0.500	ND	"	
Ethylbenzene	"	"	"		0.500	ND	"	
Xylenes (total)	"	"	"		0.500	ND	"	
Methyl tert-butyl ether	"	"	"		2.00	ND	"	
Surrogate: a,a,a-Trifluorotoluene	"	"	"	65.0-135		103	%	
Surrogate: 4-Bromofluorobenzene	"	"	"	65.0-135		96.7	"	
<b><u>M907961-05/MW-5</u></b>				<b><u>P908061-05</u></b>			<b><u>Water</u></b>	
Gasoline	9080086	8/4/99	8/4/99		50.0	ND	ug/l	





Sequoia Analytical - Morgan Hill 885 Jarvis Drive Morgan Hill, CA 95037	Project: Anne Fowler Project Number: M907961 Project Manager: Anne Fowler	Sampled: 7/22/99 Received: 7/23/99 Reported: 8/6/99
---	---	---

**Total Petroleum Hydrocarbons as Gasoline and BTEX by EPA 8015M/8020M  
Sequoia Analytical - Petaluma**

Analyte	Batch Number	Date Prepared	Date Analyzed	Surrogate Limits	Reporting Limit	Result	Units	Notes*
<b><u>M907961-05/MW-5 (continued)</u></b>				<b><u>P908061-05</u></b>			<b><u>Water</u></b>	
Benzene	9080086	8/4/99	8/4/99		0.500	ND	ug/l	
Toluene	"	"	"		0.500	ND	"	
Ethylbenzene	"	"	"		0.500	ND	"	
Xylenes (total)	"	"	"		0.500	ND	"	
Methyl tert-butyl ether	"	"	"		2.00	ND	"	
Surrogate: a,a,a-Trifluorotoluene	"	"	"	65.0-135		103	%	
Surrogate: 4-Bromofluorobenzene	"	"	"	65.0-135		97.0	"	
<b><u>M907961-06/MW-7</u></b>				<b><u>P908061-06</u></b>			<b><u>Water</u></b>	
Gasoline	9080086	8/4/99	8/4/99		50.0	ND	ug/l	
Benzene	"	"	"		0.500	ND	"	
Toluene	"	"	"		0.500	ND	"	
Ethylbenzene	"	"	"		0.500	ND	"	
Xylenes (total)	"	"	"		0.500	ND	"	
Methyl tert-butyl ether	"	"	"		2.00	155	"	
Surrogate: a,a,a-Trifluorotoluene	"	"	"	65.0-135		104	%	
Surrogate: 4-Bromofluorobenzene	"	"	"	65.0-135		96.3	"	
<b><u>M907961-07/MW-8</u></b>				<b><u>P908061-07</u></b>			<b><u>Water</u></b>	
Gasoline	9080086	8/4/99	8/4/99		100	2190	ug/l	
Benzene	"	"	"		1.00	ND	"	
Toluene	"	"	"		1.00	ND	"	
Ethylbenzene	"	"	"		1.00	3.51	"	
Xylenes (total)	"	"	"		1.00	1.61	"	
Methyl tert-butyl ether	"	"	"		4.00	228	"	
Surrogate: a,a,a-Trifluorotoluene	"	"	"	65.0-135		90.3	%	
Surrogate: 4-Bromofluorobenzene	"	"	"	65.0-135		96.7	"	





Sequoia Analytical - Morgan Hill 885 Jarvis Drive Morgan Hill, CA 95037	Project: Anne Fowler Project Number: M907961 Project Manager: Anne Fowler	Sampled: 7/22/99 Received: 7/23/99 Reported: 8/6/99
---	---	---

**Total Petroleum Hydrocarbons as Gasoline and BTEX by EPA 8015M/8020M/Quality Control  
Sequoia Analytical - Petaluma**

Analyte	Date Analyzed	Spike Level	Sample Result	QC Result	Units	Reporting Limit Recov. Limits	Recov. %	RPD Limit	RPD %	Notes*
<b>Batch: 9080086</b>		<b>Date Prepared: 8/4/99</b>		<b>Extraction Method: EPA 5030 waters</b>						
<b>Blank</b>		<b>9080086-BLK1</b>								
Gasoline	8/4/99			ND	ug/l	50.0				
Benzene	"			ND	"	0.500				
Toluene	"			ND	"	0.500				
Ethylbenzene	"			ND	"	0.500				
Xylenes (total)	"			ND	"	0.500				
Methyl tert-butyl ether	"			ND	"	2.00				
Surrogate: a,a,a-Trifluorotoluene	"	300		307	"	65.0-135	102			
Surrogate: 4-Bromofluorobenzene	"	300		293	"	65.0-135	97.7			
<b>LCS</b>		<b>9080086-BS1</b>								
Benzene	8/4/99	100		93.8	ug/l	65.0-135	93.8			
Toluene	"	100		95.6	"	65.0-135	95.6			
Ethylbenzene	"	100		93.0	"	65.0-135	93.0			
Xylenes (total)	"	300		309	"	65.0-135	103			
Surrogate: a,a,a-Trifluorotoluene	"	300		309	"	65.0-135	103			
<b>Matrix Spike</b>		<b>9080086-MS1</b>	<b>P908061-01</b>							
Benzene	8/4/99	100	ND	97.6	ug/l	65.0-135	97.6			
Toluene	"	100	3.94	104	"	65.0-135	100			
Ethylbenzene	"	100	1.46	97.0	"	65.0-135	95.5			
Xylenes (total)	"	300	2.37	323	"	65.0-135	107			
Surrogate: a,a,a-Trifluorotoluene	"	300		278	"	65.0-135	92.7			
<b>Matrix Spike Dup</b>		<b>9080086-MSD1</b>	<b>P908061-01</b>							
Benzene	8/4/99	100	ND	98.0	ug/l	65.0-135	98.0	20.0	0.409	
Toluene	"	100	3.94	104	"	65.0-135	100	20.0	0	
Ethylbenzene	"	100	1.46	96.3	"	65.0-135	94.8	20.0	0.736	
Xylenes (total)	"	300	2.37	318	"	65.0-135	105	20.0	1.89	
Surrogate: a,a,a-Trifluorotoluene	"	300		273	"	65.0-135	91.0			





Sequoia Analytical - Morgan Hill 885 Jarvis Drive Morgan Hill, CA 95037	Project: Anne Fowler Project Number: M907961 Project Manager: Anne Fowler	Sampled: 7/22/99 Received: 7/23/99 Reported: 8/6/99
---	---	---

**Notes and Definitions**

#	Note
---	------

- DET Analyte DETECTED
- ND Analyte NOT DETECTED at or above the reporting limit
- NR Not Reported
- dry Sample results reported on a dry weight basis
- Recov. Recovery
- RPD Relative Percent Difference



**Sequoia Analytical - Morgan Hill Subcontract Order  
M907961**

P907061

<b>Sending Laboratory</b>	<b>Receiving Laboratory</b>
---------------------------	-----------------------------

Sequoia Analytical - Morgan Hill  
885 Jarvis Drive  
Morgan Hill, CA 95037

Sequoia Analytical - Petaluma  
1455 N. McDowell Blvd Ste D  
Petaluma, CA 94954

Phone: 408-776-9600  
Fax: 408-782-6308  
Project Manager: Anne Fowler

Phone: 707-792-1865  
Fax: 707-792-0342

**Subcontract Order Comments**

7/23/99 14:10

**Sample/Analysis Information**

Sample Name	Matrix	Sampled/ Expires	Analysis Requested	Due	Lab Number	Container	Comments
M907961-01	Water	7/22/99			P907061-01	A, B, C	
		8/5/99	TPH-G/B/M2	8/6/99			Petaluma, relogged 7/30/99
M907961-02	Water	7/22/99			02	A, B, C	
		8/5/99	TPH-G/B/M2	8/6/99			Petaluma, relogged 7/30/99
M907961-03	Water	7/22/99			03	A, B, C	
		8/5/99	TPH-G/B/M2	8/6/99			Petaluma, relogged 7/30/99
M907961-04	Water	7/22/99			04	A, B, C	
		8/5/99	TPH-G/B/M2	8/6/99			Petaluma, relogged 7/30/99
M907961-05	Water	7/22/99			05	A, B, C	
		8/5/99	TPH-G/B/M2	8/6/99			Petaluma, relogged 7/30/99
M907961-06	Water	7/22/99			06	A, B, C	
		8/5/99	TPH-G/B/M2	8/6/99			Petaluma, relogged 7/30/99
M907961-07	Water	7/22/99			07	A, B, C	
		8/5/99	TPH-G/B/M2	8/6/99			Petaluma, relogged 7/30/99
M907961-08	Water	7/22/99				A, B	
		8/5/99	TPH-G/B/M2	8/6/99			Petaluma, relogged 7/30/99

COOLER CUSTODY SEALS INTACT  NOT INTACT

COOLER TEMPERATURE 6 °C

Released By [Signature] Date 7/23/99 Received By [Signature] Date 7/31/99

Fax copy of Lab Report and COC to Chevron Contact:  Yes  No

Chain-of-Custody

Chevron U.S.A. Inc.  
P.O. BOX 5004  
San Ramon, CA 94583  
FAX (415)842-9591

Chevron Facility Number 9-1583  
Facility Address 5509 Martin Luther King Jr. Way, Oakland, CA  
Consultant Project Number 990722-72  
Consultant Name Blaine Tech Services, Inc.  
Address 1680 Rogers Ave., San Jose, CA 95112  
Project Contact (Name) Fran Thie  
(Phone) (408)573-0535 (Fax Number) (408)573-7771

Chevron Contact (Name) Phil Briggs  
(Phone) (510) 842-9136  
Laboratory Name SEQUOIA  
Laboratory Release Number 9034796  
Samples Collected by (Name) Kevin Carlson  
Collection Date 7-22-99  
Signature [Signature]

Sample Number	Lab Sample Number DATE	Number of Containers	Matrix S = Soil W = Water A = Air C = Charcoal	Type G = Grab C = Composite D = Discrete	Time	Sample Preservation	Iced (Yes or No)	Analytes To Be Performed										DO NOT BILL FOR TB-LB	
								BTEX + TPH GAS (8020 + 8015) / MMS	TPH Diesel (8015)	Oil and Grease (5520)	Purgeable Halocarbons (8010)	Purgeable Aromatics (8020)	Purgeable Organics (824)	Extractable Organics (8270)	Metals Cd, Cr, Pb, Zn, Ni (ICAP or AA)	Remarks			
MW-1	7-22-99	3	W		14:50		Y	X											
MW-2		3			14:24														
MW-3		3			15:08														
MW-4		3			14:04														
MW-5		3			13:43														
MW-7		4			14:36														
MW-8		4			15:21														
TB		2																	

19607961

Relinquished By (Signature) <u>[Signature]</u>	Organization <u>BTS</u>	Date/Time <u>7/23/99 12:57</u>	Received By (Signature) <u>[Signature]</u>	Organization <u>[Signature]</u>	Date/Time <u>7/23/99</u>	Turn Around Time (Circle Choice) 24 Hrs. 48 Hrs. 6 Days 10 Days As Contracted
Relinquished By (Signature) <u>[Signature]</u>	Organization	Date/Time	Received By (Signature)	Organization	Date/Time	
Relinquished By (Signature) <u>[Signature]</u>	Organization	Date/Time <u>7/23/99</u>	Received For Laboratory By (Signature)		Date/Time	

COC-3.DWG/03 91/HCH

# Field Data Sheets







# CHEVRON WELL MONITORING DATA SHEET

Project #: 990722-X2	Station #: 9-1583
Sampler: 16 c.	Date: 7-22-99
Well I.D.: MW- 2	Well Diameter: 2 <u>3</u> 4 6 8
Total Well Depth: 18.82	Depth to Water: 10.87
Depth to Free Product:	Thickness of Free Product (feet):
Referenced to: <u>PVC</u> Grade	D.O. Meter (if req'd): YSI HACH

Well Diameter	Multiplier	Well Diameter	Multiplier
2"	0.16	5"	1.02
3"	0.37	6"	1.47
4"	0.65	Other	radius <sup>2</sup> * 0.163

Purge Method: Bailer  Disposable Bailer  Middleburg  Electric Submersible Extraction Pump  Other: \_\_\_\_\_

Sampling Method: Bailer  Disposable Bailer  Extraction Port  Other: \_\_\_\_\_

<u>2.9</u>	x	<u>3</u>	=	<u>8.7</u>	Gals.
1 Case Volume (Gals.)		Specified Volumes		Calculated Volume	

Time	Temp (°F)	pH	Cond.	Gals. Removed	Observations
14:15	74.0	7.2	<del>663</del> 663	3.0	
14:16	72.5	7.2	360	6.0	
14:17	71.5	7.1	352	9.0	

Did well dewater? Yes  No Gallons actually evacuated: 9.0

Sampling Time: 14:24 Sampling Date: 7-22-99

Sample I.D.: MW- 2 Laboratory: Sequoia CORE N. Creek Assoc. Labs

Analyzed for: TPH-G BTEX MTBE TPH-D Other:

Duplicate I.D.: Analyzed for: TPH-G BTEX MTBE TPH-D Other:

D.O. (if req'd):	Pre-purge:	mg/L	Post-purge:	mg/L
U.P. (if req'd):	Pre-purge:	mV	Post-purge:	mV

## CHEVRON WELL MONITORING DATA SHEET

Project #: 990722-X2	Station #: 9-1583
Sampler: 16 C.	Date: 7-22-99
Well I.D.: MW-3	Well Diameter: 2 <u>3</u> - 4 6 8
Total Well Depth: 19.65	Depth to Water: 12.30
Depth to Free Product:	Thickness of Free Product (feet):
Referenced to: <u>PVC</u> Grade	D.O. Meter (if req'd): YSI HACH

Well Diameter	Multiplier	Well Diameter	Multiplier
2"	0.16	5"	1.02
3"	0.37	6"	1.47
4"	0.65	Other	radius <sup>2</sup> * 0.163

Recovery Method:  Bailer                      Sampling Method:  Bailer  
                            Disposable Bailer     Disposable Bailer X  
                            Middleburg     Extraction Port  
                            Electric Submersible    Other: \_\_\_\_\_  
                            Extraction Pump

Other: \_\_\_\_\_

27	x	3	=	8.1	Gals.
1 Case Volume (Gals.)		Specified Volumes		Calculated Volume	

Time	Temp (°F)	pH	Cond.	Gals. Removed	Observations
15:00	67.1	6.8	342	3	
15:01	67.7	7.0	473	6	
15:02	68.0	7.1	458	9	

Did well dewater? Yes   No                      Gallons actually evacuated: 9.0

Sampling Time: 15:08                      Sampling Date: 7-22-99

Sample I.D.: MW-3                      Laboratory: Sequoia CORE N. Creek Assoc. Labs

Analyzed for: TPH-G BTEX MTBE TPH-D . Other:

Duplicate I.D.:                      Analyzed for: TPH-G BTEX MTBE TPH-D Other:

O. (if req'd):	Pre-purge:	mg/L	Post-purge:	mg/L
P. (if req'd):	Pre-purge:	mV	Post-purge:	mV

# CHEVRON WELL MONITORING DATA SHEET

Project #: 990722-X2	Station #: 9-1583
Sampler: KC	Date: 7-22-99
Well I.D.: MW-4	Well Diameter: (2) 3 4 6 8
Total Well Depth: 25.10	Depth to Water: 13.55
Depth to Free Product:	Thickness of Free Product (feet):
Referenced to: (PVC) Grade	D.O. Meter (if req'd): YSI HACH

Well Diameter	Multiplier	Well Diameter	Multiplier
2"	0.16	5"	1.02
3"	0.37	6"	1.47
4"	0.65	Other	radius <sup>2</sup> * 0.163

Purge Method:  Bailer  Disposable Bailer  Middleburg  Electric Submersible  Extraction Pump  
 Other: \_\_\_\_\_

Sampling Method:  Bailer  Disposable Bailer  Extraction Port  
 Other: \_\_\_\_\_

1.8	x	3	=	5.4	Gals.
1 Case Volume (Gals.)		Specified Volumes		Calculated Volume	

Time	Temp (°F)	pH	Cond.	Gals. Removed	Observations
13:50	68.9	7.1	485	1.5	
13:54	68.0	7.1	486	3.5	
13:58	67.8	7.1	486	5.5	

Well dewater? Yes  No  Gallons actually evacuated: 5.5

Sampling Time: 14:04 Sampling Date: 7-22-99

Sample I.D.: MW-4 Laboratory: Sequoia CORE N. Creek Assoc. Labs

Analyzed for: (TPH-G) (BTEX) (MTBE) (TPH-D) Other:

Analyzed for: TPH-G BTEX MTBE TPH-D Other:

. (if req'd):	Pre-purge:	mg/L	Post-purge:	mg/L
	P. (if req'd):	mV	Post-purge:	mV



# CHEVRON WELL MONITORING DATA SHEET

Project #: 990722-X2	Station #: 9-1583
Sampler: 1/2 C.	Date: 7-22-99
Well I.D.: MW-C	Well Diameter: 2 3 4 6 8
Total Well Depth:	Depth to Water:
Depth to Free Product:	Thickness of Free Product (feet):
Referenced to: <u>PVC</u> Grade	D.O. Meter (if req'd): YSI HACH

Well Diameter	Multiplier	Well Diameter	Multiplier
2"	0.16	5"	1.02
3"	0.37	6"	1.47
4"	0.65	Other	radius <sup>2</sup> * 0.163

Surge Method: <input type="checkbox"/> Bailer <input type="checkbox"/> Disposable Bailer <input type="checkbox"/> Middleburg <input type="checkbox"/> Electric Submersible <input type="checkbox"/> Extraction Pump Other: _____	Sampling Method: <input type="checkbox"/> Bailer <input checked="" type="checkbox"/> Disposable Bailer <input type="checkbox"/> Extraction Port Other: _____
---	---

1 Case Volume (Gals.)	X	3	=	Gals. Calculated Volume
-----------------------	---	---	---	----------------------------

Time	Temp (°F)	pH	Cond.	Gals. Removed	Observations
					CAR parked over well - unable to locate driver
					Checked at 12:50 PM
					13:30 PM
					14:30 PM

Did well dewater? Yes   No      Gallons actually evacuated: \_\_\_\_\_

Sampling Time: \_\_\_\_\_ Sampling Date: 7-22-99

Sample I.D.: MW-      Laboratory: Sequoia CORE N. Creek Assoc. Labs

Analyzed for: TPH-G BTEX MTBE TPH-D . Other: \_\_\_\_\_

Duplicate I.D.: \_\_\_\_\_ Analyzed for: TPH-G BTEX MTBE TPH-D Other: \_\_\_\_\_

O. (if req'd):	Pre-purge:	mg/L	Post-purge:	mg/L
R.P. (if req'd):	Pre-purge:	mV	Post-purge:	mV

# CHEVRON WELL MONITORING DATA SHEET

Project #: 990722-X2	Station #: 9-1583
Sampler: 1/2 C.	Date: 7-22-99
Well I.D.: MW-7	Well Diameter: ② 3 4 6 8
Total Well Depth: 19.78	Depth to Water: 12.30
Depth to Free Product:	Thickness of Free Product (feet):
Referenced to: PVC Grade	D.O. Meter (if req'd): YSI HACH

Well Diameter	Multplier	Well Diameter	Multplier
2"	0.16	5"	1.02
3"	0.37	6"	1.47
4"	0.65	Other	radius <sup>2</sup> * 0.163

Sample Method: Bailer  
 Disposable Bailer  
 Middleburg  
 Electric Submersible  
 Extraction Pump  
 Other: \_\_\_\_\_

Sampling Method: Bailer  
 Disposable Bailer X  
 Extraction Port  
 Other: \_\_\_\_\_

1.1	X	3	=	3.3	Gals.
1 Case Volume (Gals.)		Specified Volumes		Calculated Volume	

Time	Temp (°F)	pH	Cond.	Gals. Removed	Observations
14:33	66.9	7.0	633	1.0	
14:35	66.7	7.0	683	2.5	
4:37	66.3	7.0	686	3.5	

Well dewater? Yes  No  Gallons actually evacuated: 3.5

Sampling Time: 14:36 Sampling Date: 7-22-99

Sample I.D.: MW-7 Laboratory: Sequoia CORE N. Creek Assoc. Labs

Analyzed for: TPH-G BTEX MTBE TPH-D Other:

Duplicate I.D.: Analyzed for: TPH-G BTEX MTBE TPH-D Other:

P. (if req'd):	Pre-purge:	mg/L	Post-purge:	mg/L
	Pre-purge:	mV	Post-purge:	mV



# CHEVRON WELL MONITORING DATA SHEET

Project #: 990722-X2	Station #: 9-1583
Sampler: 1/2 C.	Date: 7-22-99
Well I.D.: MW-8	Well Diameter: $\varnothing$ 3 4 6 8
Total Well Depth: 19.40	Depth to Water: 11.55
Depth to Free Product:	Thickness of Free Product (feet):
Referenced to: (PVC) Grade	D.O. Meter (if req'd): YSI HACH

Well Diameter	Multiplier	Well Diameter	Multiplier
2"	0.16	5"	1.02
3"	0.37	6"	1.47
4"	0.65	Other	radius <sup>2</sup> * 0.163

Large Method:  Bailer  Disposable Bailer  Middleburg  Electric Submersible Extraction Pump  
 Other: \_\_\_\_\_

Sampling Method:  Bailer  Disposable Bailer  Extraction Port  
 Other: \_\_\_\_\_

1.2	x	3	=	3.6	Gals.
1 Case Volume (Gals.)		Specified Volumes		Calculated Volume	

Time	Temp (°F)	pH	Cond.	Gals. Removed	Observations
15:17	67.6	7.2	624	1.5	
15:19	67.4	7.2	621	3.0	
15:21	67.1	7.2	619	4.0	

Is well dewater? Yes   No Gallons actually evacuated: 4.0

Sampling Time: 15:27 Sampling Date: 7-22-99

Sample I.D.: MW-8 Laboratory: Sequoia CORE N. Creek Assoc. Labs

Analyzed for: (TPH-G) (BTEX) (MTBE) TPH-D Other:

Duplicate I.D.: Analyzed for: TPH-G BTEX MTBE TPH-D Other:

D.O. (if req'd):	Pre-purge:	mg/L	Post-purge:	mg/L
ORP (if req'd):	Pre-purge:	mV	Post-purge:	mV