

ENVIRONMENTAL
PROTECTION



Chevron

MAR 22 PM 4:13

March 18, 1999

Ms. Evelyn Schlichting
2627 La Cuesta Avenue
Oakland, CA 94611-3011

Chevron Products Company
6001 Bollinger Canyon Road
Building L, Room 1110
PO Box 6004
San Ramon, CA 94583-0904

Philip R. Briggs
Project Manager
Site Assessment & Remediation
Phone 925 842-9136
Fax 925 842-8370

**Re: Chevron Service Station #9-1583
5509 Martin Luther King Way
Oakland, California**

Dear Ms. Schlichting:

I have been advised by Mr. Bill Scudder of this office, that you are the property owner of the above noted site and should be receiving copies of the environmental reports.

I am enclosing a copy of the last groundwater monitoring report with its cover letter, that I believe is self-explanatory, but if you have any questions please call me at (925) 842-9136.

Sincerely,

CHEVRON PRODUCTS COMPANY

A handwritten signature in cursive script that reads "Philip R. Briggs".

Philip R. Briggs
Site Assessment and Remediation Project Manager

Enclosure

CC. Mr. Bill Scudder, Chevron

Petroleum Sales, Inc.
505 South Van Ness, San Francisco, CA 94110
Attn: Ben Shimek (less report and cover letter)

Ms. Susan Hugo
Alameda County Health Care Services
Department of Environmental Health
1131 Harbor Bay Parkway, Suite 250
Alameda, CA 94502-6577 (less report and cover letter)

ENVIRONMENTAL
PROTECTION

25 MAR 19 PM 3: 08



Chevron

March 17, 1999

Chevron Products Company
6001 Bollinger Canyon Road
Building L, Room 1110
PO Box 6004
San Ramon, CA 94583-0904

Ms. Susan Hugo
Alameda County Health Care Services
Department of Environmental Health
1131 Harbor Bay Parkway, Suite 250
Alameda, CA 94502-6577

Philip R. Briggs
Project Manager
Site Assessment & Remediation
Phone 925 842-9136
Fax 925 842-8370

Re: Chevron Service Station #9-1583
5509 Martin Luther King Way, Oakland, California

Dear Ms. Hugo:

Enclosed is the First Quarter Groundwater Monitoring report for 1999 that was prepared by our consultant Blaine Tech Services Inc., for the above noted site. The groundwater samples collected were analyzed for TPH-g, BTEX and MtBE in all wells and TPH-motor oil constituents only in monitoring wells MW-7 and MW-8. TPH-d was analyzed for in well MW-8.

A change in the sampling frequency has been initiated as noted in my letter dated November 23, 1998. In that letter, Chevron proposed that monitoring wells MW-4, MW-5 and MW-6 would be sampled annually, with wells MW-1, MW-2, MW-3, MW-7 and MW-8 sampled semi-annually. I have not received a response from your office objecting to this frequency change, therefore, Chevron has initiated this new sampling program.

Monitoring wells MW-2, MW-4 and MW-5 were below method detection limits for all constituents, with well MW-6 inaccessible due to a car parked over it. The benzene constituent increased in monitoring wells MW-1 and MW-7 (respectively to less than 2.5 ppb and less than 1.0 ppb), from the previous sampling event, while the benzene concentration decreased in monitoring wells MW-3 and MW-8 (respectively less than 1.0 ppb and less than 5.0 ppb). TPH-motor oil decreased in wells MW-7 and MW-8 from the previous sampling event, with TPH-d detected in well MW-8.

EPA Method 8260 confirmed MtBE in wells MW-1, MW-3, MW-7 and MW-8.

Depth to ground water varied from 8.84 feet to 11.60 feet below grade with a direction of flow varying southeasterly to easterly.

March 17, 1999
Ms. Susan Hugo
Chevron Service Station #9-1583
Page 2

If you have any questions call me at (925) 842-9136.

Sincerely,
CHEVRON PRODUCTS COMPANY

A handwritten signature in cursive script that reads "Philip R. Briggs".

Philip R. Briggs
Site Assessment and Remediation Project Manager

Enclosure

CC. Mr. Bill Scudder, Chevron

Petroleum Sales, Inc.
505 South Van Ness
San Francisco, CA 94110
Attn: Ben Shimek

BLAINE
TECH SERVICES, INC.

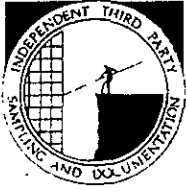

1680 ROGERS AVENUE
SAN JOSE, CALIFORNIA 95112
(408) 573-7771 FAX
(408) 573-0555 PHONE

March 8, 1999

Phil Briggs
Chevron U.S.A. Products Company
P.O. Box 6004
San Ramon, CA 94583-0904

1st Quarter 1999 Monitoring at 9-1583

First Quarter 1999 Groundwater Monitoring at
Chevron Service Station Number 9-1583
5509 Martin Luther King Jr. Way
Oakland, CA

Monitoring Performed on January 18, 1999

Groundwater Sampling Report 990118-J-3

This report covers the routine monitoring of groundwater wells at this Chevron facility. Blaine Tech Services, Inc.'s work at the site includes inspection, gauging, evacuation, purgewater containment, sample collection and sample handling in accordance with standard procedures that conform to Regional Water Quality Control Board requirements.

Routine field data collection includes depth to water, total well depth, thickness of any separate immiscible layer, water column volume, calculated volume of a three-case volume purge, elapsed evacuation time, total volume of water removed, and standard water parameter instrument readings. Sample material is collected, contained, stored, and transported to the laboratory in conformance with EPA standards. Purgewater is, likewise, collected and transported to McKittrick Waste Treatment Site for disposal.

Basic field information is presented alongside analytical values excerpted from the laboratory report in the cumulative table of **WELL DATA AND ANALYTICAL RESULTS**. The full analytical report for the most recent samples is located in the **Analytical Appendix**. The table also contains new groundwater elevation calculations taken from the computer plotted gradient

map which is located in the **Professional Engineering Appendix**.

At a minimum, Blaine Tech Services, Inc. field personnel are certified upon completion of a forty-hour Hazardous Materials and Emergency Response training course per 29 CFR 1910.120. Field personnel are also enrolled in annual eight hour refresher courses.

Blaine Tech Services, Inc. conducts sampling and documentation assignments of this type as an independent third party. In order to avoid compromising the objectivity necessary for the proper and disinterested performance of this work, Blaine Tech Services, Inc. concentrates on objective data collection and does not participate in the interpretation of analytical results, the definition of geological or hydrological conditions, the formulation of recommendations, or the marketing of remedial systems.

Please call if you have any questions.

Yours truly,

A handwritten signature in black ink that reads "Christine Lillie". The signature is written in a cursive, slightly slanted style.

Christine Lillie
Project Coordinator

FPT/sb

attachments: Professional Engineering Appendix
Cumulative Table of Well Data and Analytical Results
Analytical Appendix
Field Data Sheets

Professional Engineering Appendix

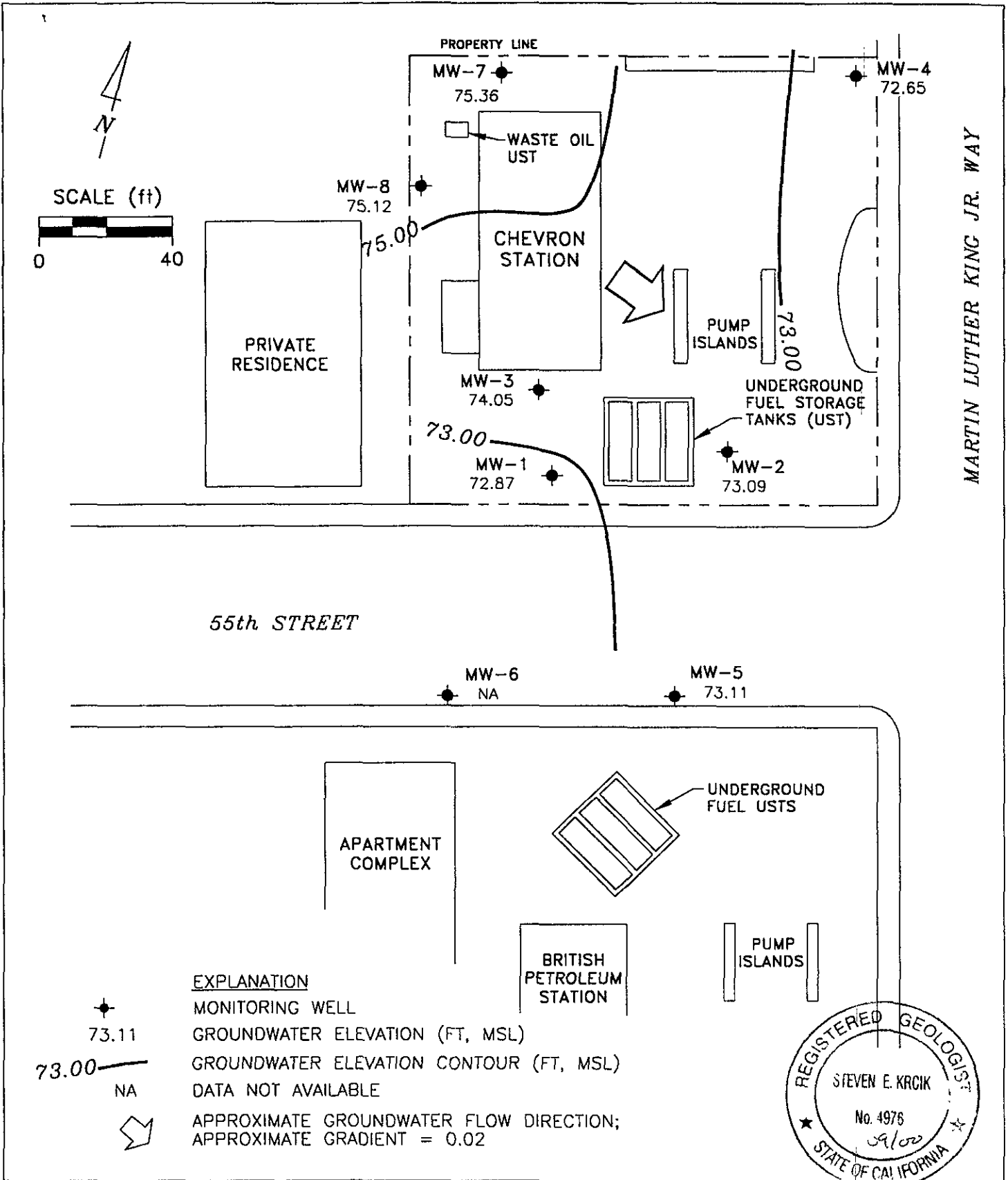

PREPARED BY  engineering contracting firm	<p align="center">Chevron Station 9-1583 5509 Martin Luther King Jr. Way Oakland, California</p> <hr/> <p align="center">GROUNDWATER ELEVATION CONTOUR MAP, JANUARY 18, 1999</p>	FIGURE: <p align="center">1</p> PROJECT: DAC04
--	---	---

Table of Well Data and Analytical Results

Cumulative Table of Well Data and Analytical Results

Vertical Measurements are in feet.

Analytical results are in parts per billion (ppb)

DATE	Well Head Elev.	Ground Water Elev.	Depth To Water	Notes	TPH-Gasoline	Benzene	Toluene	Ethyl-Benzene	Xylene	MTBE	TPH-Diesel	TPH-Motor Oil	Total Oil & Grease
MW-1													
12/22/83	81.97	71.72	10.25	--	--	--	--	--	--	--	--	--	--
12/30/83	81.97	72.80	9.17	--	--	--	--	--	--	--	--	--	--
03/12/90	81.97	71.89	10.08	--	50,000	3000	7300	1900	18,000	--	--	--	--
03/25/90	82.42	71.51	10.46	--	--	--	--	--	--	--	--	--	--
10/18/90	82.42	--	--	--	--	--	--	--	--	--	--	--	--
10/31/90	82.42	--	--	--	--	--	--	--	--	--	--	--	--
11/16/90	82.42	70.84	11.58	--	--	--	--	--	--	--	--	--	--
02/08/91	82.42	72.31	10.11	--	100,000	4200	8400	16,000	2600	--	--	--	--
05/08/91	82.42	71.97	10.45	--	31,000	200	66	670	2000	--	--	--	--
08/12/91	82.42	71.19	11.23	--	17,000	81	7.2	270	710	--	--	--	--
11/07/91	82.42	71.72	10.70	--	7100	24	6.0	130	170	--	--	--	--
02/05/92	82.42	72.05	10.37	--	110,000	8900	14,000	2700	12,000	--	--	--	--
05/13/92	82.42	71.84	10.58	--	19,000	450	85	480	870	--	--	--	--
07/17/92	82.42	71.37	11.05	--	8500	170	<10	360	600	--	--	--	--
10/05/92	82.42	71.01	11.41	--	22,000	4300	5100	570	2900	--	--	--	--
11/11/92	82.42	--	--	--	--	--	--	--	--	--	--	--	--
11/17/92	82.42	--	--	--	--	--	--	--	--	--	--	--	--
11/24/92	82.42	--	--	--	--	--	--	--	--	--	--	--	--
12/01/92	82.42	--	--	--	--	--	--	--	--	--	--	--	--
12/29/92	82.42	--	--	--	--	--	--	--	--	--	--	--	--
01/05/93	82.42	--	--	--	--	--	--	--	--	--	--	--	--
01/08/93	82.42	74.31	8.11	--	14,000,000	12,000	79,000	270,000	1,300,000	--	--	--	--
02/02/93	82.42	--	--	--	--	--	--	--	--	--	--	--	--
04/14/93	82.42	72.57	9.85	--	48,000	670	1100	1600	6300	--	--	--	--
08/06/93	82.42	71.59	10.83	--	44,000	660	990	1600	6100	--	--	--	--
10/21/93	82.42	71.52	10.90	--	18,000	270	460	1300	4700	--	--	--	--
01/05/94	82.42	72.09	10.33	--	22,000	160	160	630	2300	--	--	--	--
04/08/94	82.42	72.24	10.18	--	21,000	37	110	570	1400	--	--	--	--
07/06/94	82.42	71.78	10.64	--	28,000	210	100	540	1200	--	--	--	--
08/04/94	82.42	71.91	10.51	--	--	--	--	--	--	--	--	--	--
10/05/94	82.42	71.51	10.91	--	120,000	39	22	320	900	--	--	--	--

CONTINUED ON NEXT PAGE

Cumulative Table of Well Data and Analytical Results

Vertical Measurements are in feet.

Analytical results are in parts per billion (ppb)

DATE	Well Head Elev.	Ground Water Elev.	Depth To Water	Notes	TPH- Gasoline	Benzene	Toluene	Ethyl- Benzene	Xylene	MTBE	TPH- Diesel	TPH- Motor Oil	Total Oil & Grease
MW-1 (CONT'D)													
01/18/95	82.42	73.80	8.62	--	12,000	<20	<20	130	160	--	--	--	--
04/07/95	82.42	72.89	9.53	--	2500	<2.5	<2.5	71	38	--	--	--	--
07/06/95	82.42	72.03	10.39	--	5700	<0.5	<0.5	110	110	--	--	--	--
10/11/95	82.42	70.54	11.88	--	2700	13	<5.0	13	5.7	650	--	--	--
01/17/96	82.42	73.14	9.28	--	4200	12	<5.0	43	24	300	--	--	--
04/05/96	82.42	72.82	9.60	--	1300	<1.2	<1.2	7.6	2.8	220	--	--	--
07/23/96	82.42	72.19	10.23	--	700	<1.0	<1.0	7.0	4.8	240	--	--	--
10/02/96	82.42	71.67	10.75	--	1700	<2.5	9.8	10	13	610	--	--	--
01/23/97	82.42	74.75	7.67	--	1300	21	<10	<10	<10	2700	--	--	--
04/01/97	82.42	72.22	10.20	--	670	<2.0	<2.0	4.1	3.6	1200	--	--	--
07/09/97	82.42	72.12	10.30	--	460	<1.0	<1.0	<1.0	<1.0	440	--	--	--
10/07/97	82.42	71.73	10.69	--	1100	8.5	<2.0	<2.0	2.0	250	--	--	--
01/22/98	82.42	74.20	8.22	--	460	1.4	5.8	<0.5	<0.5	150	--	--	--
04/02/98	82.42	72.89	9.53	--	220	2.5	1.2	<1.0	1.9	260	--	--	--
07/02/98	82.42	72.08	10.34	--	270	<0.5	0.82	<0.5	<0.5	140	--	--	--
10/02/98	82.42	71.70	10.72	--	170	1.3	<0.5	<0.5	<1.5	320	--	--	--
01/18/99	82.42	72.87	9.55	--	416	<2.5	<2.5	<2.5	<2.5	316	--	--	--
01/18/99	82.42	72.87	9.55	Confirmation Run	--	--	--	--	--	295	--	--	--

Cumulative Table of Well Data and Analytical Results

Vertical Measurements are in feet

Analytical results are in parts per billion (ppb)

DATE	Well Head Elev.	Ground Water Elev.	Depth To Water	Notes	TPH-Gasoline	Benzene	Toluene	Ethyl-Benzene	Xylene	MTBE	TPH-Diesel	TPH-Motor Oil	Total Oil & Grease
MW-2													
12/22/83	83.48	72.98	10.50	--	--	--	--	--	--	--	--	--	--
12/30/83	83.48	73.56	9.92	--	--	--	--	--	--	--	--	--	--
03/12/90	83.48	72.46	11.02	--	800	400	22	18	55	--	--	--	--
03/25/90	83.48	72.15	11.33	--	--	--	--	--	--	--	--	--	--
10/18/90	83.48	71.17	12.31	--	--	--	--	--	--	--	--	--	--
10/31/90	83.48	--	--	--	--	--	--	--	--	--	--	--	--
11/16/90	83.48	--	--	--	--	--	--	--	--	--	--	--	--
02/08/91	83.48	72.43	11.05	--	4600	820	440	720	210	--	--	--	--
05/08/91	83.48	72.12	11.36	--	<50	5.0	<0.5	<0.5	<0.5	--	--	--	--
08/12/91	83.48	71.51	11.97	--	<50	<0.5	<0.5	<0.5	<0.5	--	--	--	--
11/07/91	83.48	71.98	11.50	--	<50	<0.5	<0.5	<0.5	<0.5	--	--	--	--
02/05/92	83.48	72.29	11.19	--	1700	390	170	60	200	--	--	--	--
05/13/92	83.48	71.99	11.49	--	74	9.3	<0.5	<0.5	<0.5	--	--	--	--
07/17/92	83.48	71.63	11.85	--	<50	2.0	<0.5	<0.5	<0.5	--	--	--	--
10/05/92	83.48	71.48	12.00	--	3500	1200	530	86	220	--	--	--	--
11/11/92	83.48	--	--	--	--	--	--	--	--	--	--	--	--
11/17/92	83.48	--	--	--	--	--	--	--	--	--	--	--	--
11/24/92	83.48	--	--	--	--	--	--	--	--	--	--	--	--
12/01/92	83.48	--	--	--	--	--	--	--	--	--	--	--	--
12/29/92	83.48	--	--	--	--	--	--	--	--	--	--	--	--
01/05/93	83.48	--	--	--	--	--	--	--	--	--	--	--	--
01/08/93	83.48	74.65	8.83	--	390	140	0.8	7.7	26	--	--	--	--
02/02/93	83.48	--	--	--	--	--	--	--	--	--	--	--	--
04/14/93	83.48	72.69	10.79	--	<50	5.0	<0.5	<0.5	<0.5	--	--	--	--
08/06/93	83.48	71.77	11.71	--	<50	1.0	<0.5	<0.5	<0.5	--	--	--	--
10/21/93	83.48	71.74	11.74	--	<50	1.0	<0.5	9.0	<0.5	--	--	--	--
01/05/94	83.48	72.30	11.18	--	<50	0.7	<0.5	<0.5	0.9	--	--	--	--
04/08/94	83.48	72.42	11.06	--	<50	<0.5	<0.5	<0.5	<0.5	--	--	--	--
07/06/94	83.48	71.80	11.68	--	<50	<0.5	<0.5	<0.5	<0.5	--	--	--	--
08/04/94	83.48	72.29	11.19	--	--	--	--	--	--	--	--	--	--
10/05/94	83.48	71.79	11.69	--	<50	<0.5	<0.5	<0.5	<0.5	--	--	--	--

CONTINUED ON NEXT PAGE

Cumulative Table of Well Data and Analytical Results

Vertical Measurements are in feet.

Analytical results are in parts per billion (ppb)

DATE	Well Head Elev.	Ground Water Elev.	Depth To Water	Notes	TPH-Gasoline	Benzene	Toluene	Ethyl-Benzene	Xylene	MTBE	TPH-Diesel	TPH-Motor Oil	Total Oil & Grease
MW-2 (CONT'D)													
01/18/95	83.48	74.26	9.22	--	<50	<0.5	<0.5	<0.5	<0.5	--	--	--	--
04/07/95	83.48	73.62	9.86	--	<50	<0.5	<0.5	<0.5	<0.5	--	--	--	--
07/06/95	83.48	72.74	10.74	--	<50	<0.5	<0.5	<0.5	<0.5	--	--	--	--
10/11/95	83.48	72.26	11.22	--	<50	<0.5	<0.5	<0.5	<0.5	<2.5	--	--	--
01/17/96	83.48	73.74	9.74	--	<50	<0.5	<0.5	<0.5	<0.5	<2.5	--	--	--
04/05/96	83.48	73.52	9.96	--	<50	<0.5	<0.5	<0.5	<0.5	<2.5	--	--	--
07/23/96	83.48	72.57	10.91	--	<50	<0.5	<0.5	<0.5	<0.5	<2.5	--	--	--
10/02/96	83.48	72.41	11.07	--	<50	<0.5	<0.5	<0.5	<0.5	<2.5	--	--	--
01/23/97	83.48	75.18	8.30	--	<50	<0.5	<0.5	<0.5	<0.5	3.4	--	--	--
04/01/97	83.48	72.90	10.58	--	<50	<0.5	<0.5	<0.5	<0.5	<2.5	--	--	--
07/09/97	83.48	72.58	10.90	--	<50	<0.5	<0.5	<0.5	<0.5	<2.5	--	--	--
10/07/97	83.48	72.52	10.96	--	<50	<0.5	<0.5	<0.5	<0.5	<2.5	--	--	--
01/22/98	83.48	74.73	8.75	--	<50	<0.5	<0.5	<0.5	<0.5	<2.5	--	--	--
04/02/98	83.48	73.66	9.82	--	89	3.0	5.4	4.1	21	<2.5	--	--	--
07/02/98	83.48	72.74	10.74	--	<50	<0.5	<0.5	<0.5	<0.5	<2.5	--	--	--
10/02/98	83.48	72.43	11.05	--	<50	<0.5	<0.5	<0.5	<1.5	<2.5	--	--	--
01/18/99	83.48	73.09	10.39	--	<50	<0.5	<0.5	<0.5	<0.5	<2.0	--	--	--

Cumulative Table of Well Data and Analytical Results

Vertical Measurements are in feet.

Analytical results are in parts per billion (ppb)

DATE	Well Head Elev.	Ground Water Elev.	Depth To Water	Notes	TPH-Gasoline	Benzene	Toluene	Ethyl-Benzene	Xylene	MTBE	TPH-Diesel	TPH-Motor Oil	Total Oil & Grease
MW-3													
12/22/83	84.36	72.78	11.58	--	--	--	--	--	--	--	--	--	--
12/30/83	84.36	73.19	11.17	--	--	--	--	--	--	--	--	--	--
03/12/90	84.36	72.22	12.14	--	47,000	1000	9900	1700	9800	--	--	--	--
03/25/90	84.38	71.81	12.55	--	--	--	--	--	--	--	--	--	--
10/18/90	84.38	--	--	--	--	--	--	--	--	--	--	--	--
10/31/90	84.38	--	--	--	--	--	--	--	--	--	--	--	--
11/16/90	84.38	70.76	13.62	--	--	--	--	--	--	--	--	--	--
02/08/91	84.38	72.20	12.18	--	58,000	4900	5200	9500	2000	--	--	--	--
05/08/91	84.38	71.86	12.52	--	50,000	2100	1400	2000	9400	--	--	--	--
08/12/91	84.38	71.11	13.27	--	15,000	1300	160	920	1900	--	--	--	--
11/07/91	84.38	71.57	12.81	--	26,000	1000	310	1900	5900	--	--	--	--
02/05/92	84.38	71.91	12.47	--	35,000	2800	1300	1500	4700	--	--	--	--
05/13/92	84.38	71.76	12.62	--	47,000	1500	1200	1100	4800	--	--	--	--
07/17/92	84.38	71.25	13.13	--	15,000	120	11	88	140	--	--	--	--
10/05/92	84.38	70.95	13.62	Free Product (0.24')	--	--	--	--	--	--	--	--	--
11/11/92	84.38	71.63	12.89	Free Product (0.17')	--	--	--	--	--	--	--	--	--
11/17/92	84.38	71.54	12.89	Free Product (0.06')	--	--	--	--	--	--	--	--	--
11/24/92	84.38	71.56	12.86	Free Product (0.05')	--	--	--	--	--	--	--	--	--
12/01/92	84.38	71.48	12.92	Free Product (0.03')	--	--	--	--	--	--	--	--	--
12/29/92	84.38	73.14	11.24	Sheen	--	--	--	--	--	--	--	--	--
01/05/93	84.38	73.23	11.15	Sheen	--	--	--	--	--	--	--	--	--
01/08/93	84.38	74.28	10.10	--	250,000	5000	17,000	5500	28,000	--	--	--	--
02/02/93	84.38	--	--	--	--	--	--	--	--	--	--	--	--
04/14/93	84.38	72.48	11.91	Free Product (0.01')	--	--	--	--	--	--	--	--	--
08/06/93	84.38	71.48	12.90	Free Product (0.01')	150,000	3800	6600	3700	17,000	--	--	--	--
10/21/93	84.38	71.41	12.97	--	22,000	2300	1700	1400	5100	--	--	--	--
01/05/94	84.38	71.96	12.42	--	37,000	1600	1100	1300	6500	--	--	--	--
04/08/94	84.38	72.51	11.87	--	16,000	250	310	500	2500	--	--	--	--
07/06/94	84.38	71.64	12.74	--	43,000	660	320	1900	6400	--	--	--	--
08/04/94	84.38	71.71	12.67	--	--	--	--	--	--	--	--	--	--
10/05/94	84.38	71.43	12.95	--	12,000	280	90	480	370	--	--	--	--

CONTINUED ON NEXT PAGE

Cumulative Table of Well Data and Analytical Results

Vertical Measurements are in feet.

Analytical results are in parts per billion (ppb)

DATE	Well Head Elev.	Ground Water Elev.	Depth To Water	Notes	TPH-Gasoline	Benzene	Toluene	Ethyl-Benzene	Xylene	MTBE	TPH-Diesel	TPH-Motor Oil	Total Oil & Grease
MW-3 (CONT'D)													
01/18/95	84.38	73.72	10.66	--	20,000	200	230	700	3500	--	--	--	--
04/07/95	84.38	72.84	11.54	--	22,000	120	120	810	4400	--	--	--	--
07/06/95	84.38	71.99	12.39	--	15,000	110	<50	630	2100	--	--	--	--
10/11/95	84.38	72.07	12.31	--	8600	24	<10	360	560	1100	--	--	--
01/17/96	84.38	73.68	10.70	--	9300	<50	<50	230	1100	2300	--	--	--
04/05/96	84.38	73.35	11.03	--	8700	16	<10	110	650	990	--	--	--
07/23/96	84.38	72.38	12.00	--	5400	20	<5.0	190	480	2300	--	--	--
10/02/96	84.38	72.20	12.18	--	6200	43	<20	130	140	2800	--	--	--
01/23/97	84.38	75.12	9.26	--	5600	<5.0	<5.0	39	160	550	--	--	--
04/01/97	84.38	72.75	11.63	--	6900	17	<10	150	330	3900	--	--	--
07/09/97	84.38	72.38	12.00	--	5300	31	<5.0	100	180	2300	--	--	--
10/07/97	84.38	72.27	12.11	--	2400	15	<2.0	30	15	900	--	--	--
01/22/98	84.38	74.73	9.65	--	3200	2.5	7.9	70	220	660	--	--	--
04/02/98	84.38	73.49	10.89	--	1300	14	9.7	25	63	430	--	--	--
07/02/98	84.38	72.69	11.69	--	750	6.9	<5.0	18	9.1	370	--	--	--
10/02/98	84.38	72.23	12.15	--	1400	5.3	0.73	18	6.6	900	--	--	--
01/18/99	84.38	74.05	10.33	--	1270	<1.0	<1.0	7.95	<1.0	100	--	--	--
01/18/99	84.38	74.05	10.33	Confirmation Run	--	--	--	--	--	99.7	--	--	--

Cumulative Table of Well Data and Analytical Results

Vertical Measurements are in feet.

Analytical results are in parts per billion (ppb)

DATE	Well Head Elev.	Ground Water Elev.	Depth To Water	Notes	TPH-Gasoline	Benzene	Toluene	Ethyl-Benzene	Xylene	MTBE	TPH-Diesel	TPH-Motor Oil	Total Oil & Grease
MW-4													
10/18/90	84.25	68.50	15.75	--	--	--	--	--	--	--	--	--	--
10/31/90	84.25	70.35	13.90	--	<50	<0.5	<0.5	<0.5	1.0	--	--	--	--
11/16/90	84.25	70.00	14.25	--	--	--	--	--	--	--	--	--	--
02/08/91	84.25	71.93	12.32	--	60	17	2.0	12	<0.5	--	--	--	--
05/08/91	84.25	72.02	12.23	--	65	<0.5	<0.5	<0.5	<0.5	--	--	--	--
08/12/91	84.25	70.32	13.93	--	<50	<0.5	<0.5	<0.5	<0.5	--	--	--	--
11/07/91	84.25	70.83	13.42	--	<50	<0.5	<0.5	<0.5	<0.5	--	--	--	--
02/05/92	84.25	71.42	12.83	--	<50	<0.5	<0.5	<0.5	<0.5	--	--	--	--
05/13/92	84.25	70.97	13.28	--	<50	<0.5	<0.5	<0.5	<0.5	--	--	--	--
07/17/92	84.25	70.27	13.98	--	<50	<0.5	<0.5	<0.5	<0.5	--	--	--	--
10/05/92	84.25	70.02	14.23	--	<50	<0.5	<0.5	<0.5	<0.5	--	--	--	--
11/11/92	84.25	--	--	--	--	--	--	--	--	--	--	--	--
11/17/92	84.25	--	--	--	--	--	--	--	--	--	--	--	--
11/24/92	84.25	--	--	--	--	--	--	--	--	--	--	--	--
12/01/92	84.25	--	--	--	--	--	--	--	--	--	--	--	--
12/29/92	84.25	--	--	--	--	--	--	--	--	--	--	--	--
01/05/93	84.25	--	--	--	--	--	--	--	--	--	--	--	--
01/08/93	84.25	74.09	10.16	--	<50	<0.5	<0.5	<0.5	<0.5	--	--	--	--
02/02/93	84.25	--	--	--	--	--	--	--	--	--	--	--	--
04/14/93	84.25	72.21	12.04	--	<50	<0.5	<0.5	<0.5	<0.5	--	--	--	--
08/06/93	84.25	70.34	13.91	--	<50	<0.5	<0.5	<0.5	<0.5	--	--	--	--
10/21/93	84.25	70.26	13.99	--	<50	<0.5	<0.5	<0.5	1.0	--	--	--	--
01/05/94	84.25	71.30	12.95	--	<50	<0.5	<0.5	<0.5	<0.5	--	--	--	--
04/08/94	84.25	71.31	12.94	--	<50	<0.5	<0.5	<0.5	<0.5	--	--	--	--
07/06/94	84.25	70.57	13.68	--	<50	<0.5	<0.5	<0.5	<0.5	--	--	--	--
08/04/94	84.25	70.71	13.54	--	--	--	--	--	--	--	--	--	--
10/05/94	84.25	70.65	13.60	--	<50	<0.5	<0.5	<0.5	<0.5	--	--	--	--
01/18/95	84.25	74.77	9.48	--	<50	<0.5	<0.5	<0.5	<0.5	--	--	--	--
04/07/95	84.25	72.70	11.55	--	<50	<0.5	<0.5	<0.5	<0.5	--	--	--	--
07/06/95	84.25	71.25	13.00	--	<50	<0.5	<0.5	<0.5	<0.5	--	--	--	--
10/11/95	84.25	70.27	13.98	--	<50	<0.5	<0.5	<0.5	<0.5	<2.5	--	--	--
01/17/96	84.25	73.17	11.08	--	<50	<0.5	<0.5	<0.5	<0.5	<2.5	--	--	--
04/05/96	84.25	72.65	11.60	--	<50	<0.5	<0.5	<0.5	<0.5	<2.5	--	--	--
07/23/96	84.25	70.86	13.39	--	<50	<0.5	<0.5	<0.5	<0.5	<2.5	--	--	--

CONTINUED ON NEXT PAGE

Cumulative Table of Well Data and Analytical Results

Vertical Measurements are in feet.

Analytical results are in parts per billion (ppb)

DATE	Well Head Elev.	Ground Water Elev.	Depth To Water	Notes	TPH-Gasoline	Benzene	Toluene	Ethyl-Benzene	Xylene	MTBE	TPH-Diesel	TPH-Motor Oil	Total Oil & Grease
MW-4 (CONT'D)													
10/02/96	84.25	70.27	13.98	--	<50	<0.5	<0.5	<0.5	<0.5	<2.5	--	--	--
01/23/97	84.25	74.72	9.53	--	<50	<0.5	<0.5	<0.5	<0.5	<2.5	--	--	--
04/01/97	84.25	71.68	12.57	--	<50	<0.5	<0.5	<0.5	<0.5	<2.5	--	--	--
07/09/97	84.25	70.64	13.61	--	<50	<0.5	<0.5	<0.5	<0.5	<2.5	--	--	--
10/07/97	84.25	70.51	13.74	--	<50	<0.5	<0.5	<0.5	<0.5	<2.5	--	--	--
01/22/98	84.25	74.90	9.35	--	<50	<0.5	<0.5	<0.5	<0.5	<2.5	--	--	--
04/02/98	84.25	73.00	11.25	--	<50	<0.5	<0.5	<0.5	<0.5	<2.5	--	--	--
07/02/98	84.25	71.84	12.41	--	<50	<0.5	<0.5	<0.5	<0.5	<2.5	--	--	--
10/02/98	84.25	71.00	13.25	--	<50	<0.5	<0.5	<0.5	<1.5	<2.5	--	--	--
01/18/99	84.25	72.65	11.60	--	<50	<0.5	<0.5	<0.5	<0.5	<2.0	--	--	--

Cumulative Table of Well Data and Analytical Results

Vertical Measurements are in feet.

Analytical results are in parts per billion (ppb)

DATE	Well Head Elev.	Ground Water Elev.	Depth To Water	Notes	TPH-Gasoline	Benzene	Toluene	Ethyl-Benzene	Xylene	MTBE	TPH-Diesel	TPH-Motor Oil	Total Oil & Grease
MW-5													
10/18/90	81.95	71.17	10.78	--	--	--	--	--	--	--	--	--	--
10/31/90	81.95	71.32	10.63	--	110	<0.5	<0.5	<0.5	<0.5	--	--	--	--
11/16/90	81.95	71.27	10.68	--	--	--	--	--	--	--	--	--	--
02/08/91	81.95	72.78	9.17	--	<50	<0.5	<0.5	<0.5	<0.5	--	--	--	--
05/08/91	81.95	73.27	8.68	--	<50	<0.5	<0.5	<0.5	<0.5	--	--	--	--
08/12/91	81.95	71.62	10.33	--	<50	<0.5	<0.5	<0.5	<0.5	--	--	--	--
11/07/91	81.95	72.19	9.76	--	<50	<0.5	<0.5	<0.5	<0.5	--	--	--	--
02/05/92	81.95	72.48	9.47	--	69	<0.5	<0.5	<0.5	<0.5	--	--	--	--
05/13/92	81.95	72.25	9.70	--	74	<0.5	<0.5	<0.5	<0.5	--	--	--	--
07/17/92	81.95	71.74	10.21	--	880	2.6	<1.2	4.6	11	--	--	--	--
10/05/92	81.95	71.34	10.61	--	120	<0.5	<0.5	0.6	4.9	--	--	--	--
11/11/92	81.95	--	--	--	--	--	--	--	--	--	--	--	--
11/17/92	81.95	--	--	--	--	--	--	--	--	--	--	--	--
11/24/92	81.95	--	--	--	--	--	--	--	--	--	--	--	--
12/01/92	81.95	--	--	--	--	--	--	--	--	--	--	--	--
12/29/92	81.95	--	--	--	--	--	--	--	--	--	--	--	--
01/05/93	81.95	--	--	--	--	--	--	--	--	--	--	--	--
01/08/93	81.95	74.61	7.34	--	61	<0.5	<0.5	<0.5	<0.5	--	--	--	--
02/02/93	81.95	--	--	--	--	--	--	--	--	--	--	--	--
04/14/93	81.95	--	--	--	--	--	--	--	--	--	--	--	--
08/06/93	81.95	71.99	9.96	--	<50	<0.5	<0.5	<0.5	<0.5	--	--	--	--
10/21/93	81.95	71.89	10.06	--	<50	<0.5	<0.5	2.0	4.0	--	--	--	--
01/05/94	81.95	72.52	9.43	--	<50	<0.5	<0.5	<0.5	<0.5	--	--	--	--
04/08/94	81.95	72.56	9.39	--	<50	<0.5	<0.5	<0.5	<0.5	--	--	--	--
07/06/94	81.95	72.19	9.76	--	<50	0.6	<0.5	<0.5	<0.5	--	--	--	--
08/04/94	81.95	72.13	9.82	--	--	--	--	--	--	--	--	--	--
10/05/94	81.95	71.89	10.06	--	<50	<0.5	<0.5	<0.5	<0.5	--	--	--	--
01/18/95	81.95	--	--	Inaccessible	--	--	--	--	--	--	--	--	--
04/07/95	81.95	73.31	8.64	--	<50	<0.5	<0.5	<0.5	<0.5	--	--	--	--
07/06/95	81.95	72.52	9.43	--	<50	<0.5	<0.5	<0.5	<0.5	--	--	--	--
10/11/95	81.95	72.12	9.83	--	<50	<0.5	<0.5	<0.5	<0.5	<2.5	--	--	--
01/17/96	81.95	73.63	8.32	--	<50	<0.5	<0.5	<0.5	<0.5	<2.5	--	--	--
04/05/96	81.95	73.23	8.72	--	<50	<0.5	<0.5	<0.5	<0.5	<2.5	--	--	--
07/23/96	81.95	72.25	9.70	--	<50	<0.5	<0.5	<0.5	<0.5	<2.5	--	--	--

CONTINUED ON NEXT PAGE

Cumulative Table of Well Data and Analytical Results

Vertical Measurements are in feet.

Analytical results are in parts per billion (ppb)

DATE	Well Head Elev.	Ground Water Elev.	Depth To Water	Notes	TPH-Gasoline	Benzene	Toluene	Ethyl-Benzene	Xylene	MTBE	TPH-Diesel	TPH-Motor Oil	Total Oil & Grease
MW-5 (CONT'D)													
10/02/96	81.95	72.06	9.89	--	<50	<0.5	<0.5	<0.5	<0.5	<2.5	--	--	--
01/23/97	81.95	74.72	7.23	--	<50	<0.5	<0.5	<0.5	<0.5	<2.5	--	--	--
04/01/97	81.95	--	--	Inaccessible	--	--	--	--	--	--	--	--	--
07/09/97	81.95	72.27	9.68	--	<50	<0.5	<0.5	<0.5	<0.5	<2.5	--	--	--
10/07/97	81.95	72.14	9.81	--	<50	<0.5	<0.5	<0.5	<0.5	<2.5	--	--	--
01/22/98	81.95	74.80	7.15	--	<50	<0.5	<0.5	<0.5	<0.5	<2.5	--	--	--
04/02/98	81.95	--	--	Inaccessible	--	--	--	--	--	--	--	--	--
07/02/98	81.95	72.43	9.52	--	<50	<0.5	<0.5	<0.5	<0.5	<2.5	--	--	--
10/02/98	81.95	72.14	9.81	--	<50	<0.5	<0.5	<0.5	<1.5	<2.5	--	--	--
01/18/99	81.95	73.11	8.84	--	<50	<0.5	<0.5	<0.5	<0.5	<2.0	--	--	--

Cumulative Table of Well Data and Analytical Results

Vertical Measurements are in feet.

Analytical results are in parts per billion (ppb)

DATE	Well Head Elev.	Ground Water Elev.	Depth To Water	Notes	TPH-Gasoline	Benzene	Toluene	Ethyl-Benzene	Xylene	MTBE	TPH-Diesel	TPH-Motor Oil	Total Oil & Grease
MW-6													
10/18/90	80.60	70.81	9.79	--	--	--	--	--	--	--	--	--	--
10/31/90	80.60	70.91	9.69	--	<50	<0.5	<0.5	<0.5	3.0	--	--	--	--
11/16/90	80.60	70.86	9.74	--	--	--	--	--	--	--	--	--	--
02/08/91	80.60	--	--	--	--	--	--	--	--	--	--	--	--
05/08/91	80.60	71.06	9.54	--	56	<0.5	<0.5	<0.5	<0.5	--	--	--	--
08/12/91	80.60	71.10	9.50	--	<50	<0.5	<0.5	<0.5	<0.5	--	--	--	--
11/07/91	80.60	71.71	8.89	--	<50	<0.5	<0.5	<0.5	<0.5	--	--	--	--
02/05/92	80.60	72.01	8.59	--	<50	<0.5	<0.5	<0.5	<0.5	--	--	--	--
05/13/92	80.60	--	--	--	--	--	--	--	--	--	--	--	--
07/17/92	80.60	--	--	--	--	--	--	--	--	--	--	--	--
10/05/92	80.60	--	--	--	--	--	--	--	--	--	--	--	--
11/11/92	80.60	--	--	--	--	--	--	--	--	--	--	--	--
11/17/92	80.60	--	--	--	--	--	--	--	--	--	--	--	--
11/24/92	80.60	--	--	--	--	--	--	--	--	--	--	--	--
12/01/92	80.60	--	--	--	--	--	--	--	--	--	--	--	--
12/29/92	80.60	--	--	--	--	--	--	--	--	--	--	--	--
01/05/93	80.60	--	--	--	--	--	--	--	--	--	--	--	--
01/08/93	80.60	--	--	--	--	--	--	--	--	--	--	--	--
02/02/93	80.60	72.89	7.71	--	<50	2.1	<0.5	<0.5	2.2	--	--	--	--
04/14/93	80.60	72.41	8.19	--	<50	1.0	<0.5	<0.5	<0.5	--	--	--	--
08/06/93	80.60	71.52	9.08	--	<50	<0.5	<0.5	<0.5	<0.5	--	--	--	--
10/21/93	80.60	71.46	9.14	--	<50	<0.5	<0.5	<0.5	<0.5	--	--	--	--
01/05/94	80.60	72.06	8.54	--	<50	4.0	<0.5	<0.5	<0.5	--	--	--	--
04/08/94	80.60	--	--	--	--	--	--	--	--	--	--	--	--
07/06/94	80.60	--	--	Inaccessible	--	--	--	--	--	--	--	--	--
08/04/94	80.60	71.66	8.94	--	<50	<0.5	<0.5	<0.5	<0.5	--	--	--	--
10/05/94	80.60	--	--	Inaccessible	--	--	--	--	--	--	--	--	--
01/18/95	80.60	73.50	7.10	--	<50	0.69	<0.5	<0.5	0.57	--	--	--	--
04/07/95	80.60	72.77	7.83	--	<50	1.8	<0.5	<0.5	<0.5	--	--	--	--
07/06/95	80.60	72.03	8.57	--	<50	<0.5	<0.5	<0.5	<0.5	--	--	--	--
10/11/95	80.60	71.54	9.06	--	<125	<1.2	<1.2	<1.2	<1.2	540	--	--	--
01/17/96	80.60	73.20	7.40	--	<50	<0.5	<0.5	<0.5	<0.5	180	--	--	--
04/05/96	80.60	72.70	7.90	--	<125	1.4	<1.2	<1.2	<1.2	700	--	--	--
07/23/96	80.60	71.86	8.74	--	<500	<5.0	<5.0	<5.0	<5.0	540	--	--	--

CONTINUED ON NEXT PAGE

Cumulative Table of Well Data and Analytical Results

Vertical Measurements are in feet.

Analytical results are in parts per billion (ppb)

DATE	Well Head Elev.	Ground Water Elev.	Depth To Water	Notes	TPH-Gasoline	Benzene	Toluene	Ethyl-Benzene	Xylene	MTBE	TPH-Diesel	TPH-Motor Oil	Total Oil & Grease
MW-6 (CONT'D)													
10/02/96	80.60	71.62	8.98	--	<100	<1.0	<1.0	<1.0	1.8	910	--	--	--
01/23/97	80.60	--	--	Inaccessible	--	--	--	--	--	--	--	--	--
04/01/97	80.60	72.22	8.38	--	<250	<2.5	<2.5	<2.5	<2.5	640	--	--	--
07/09/97	80.60	--	--	Inaccessible	--	--	--	--	--	--	--	--	--
10/07/97	80.60	71.71	8.89	--	<50	<0.5	<0.5	<0.5	<0.5	640	--	--	--
01/22/98	80.60	73.90	6.70	--	<50	<0.5	<0.5	<0.5	<0.5	200	--	--	--
04/02/98	80.60	72.79	7.81	--	<250	<2.5	<2.5	<2.5	<2.5	480	--	--	--
07/02/98	80.60	71.62	8.98	--	<50	<0.5	<0.5	<0.5	<0.5	420	--	--	--
10/02/98	80.60	71.68	8.92	--	<50	<0.5	<0.5	<0.5	<1.5	270	--	--	--
01/18/99	80.60	--	--	Inaccessible	--	--	--	--	--	--	--	--	--

Cumulative Table of Well Data and Analytical Results

Vertical Measurements are in feet.

Analytical results are in parts per billion (ppb)

DATE	Well Head Elev.	Ground Water Elev.	Depth To Water	Notes	TPH-Gasoline	Benzene	Toluene	Ethyl-Benzene	Xylene	MTBE	TPH-Diesel	TPH-Motor Oil	Total Oil & Grease
MW-7													
03/08/94	86.36	74.99	11.37	--	1200	440	31	73	200	--	<10	4100	--
07/06/94	86.36	--	--	--	--	--	--	--	--	--	--	--	--
08/04/94	86.36	73.86	12.50	--	120	15	<0.5	3.8	1.8	--	--	--	--
10/05/94	86.36	73.99	12.37	--	150	1.2	<0.5	1.2	1.7	--	--	--	--
01/18/95	86.36	74.82	11.54	--	260	11	<1.0	17	6.8	--	--	--	--
04/07/95	86.36	75.63	10.73	--	230	<0.5	<0.5	25	0.93	--	--	--	--
07/06/95	86.36	74.36	12.00	--	320	<1.0	<1.0	<1.0	<1.0	--	--	--	6900
10/11/95	86.36	73.56	12.80	--	<50	<0.5	<0.5	<0.5	<0.5	120	--	2300*	--
01/17/96	86.36	75.90	10.46	--	<50	<0.5	<0.5	<0.5	<0.5	460	--	1700	--
04/05/96	86.36	76.56	9.80	--	130	<0.5	<0.5	<0.5	<0.5	120	--	590	--
07/23/96	86.36	74.57	11.79	--	<500	<5.0	<5.0	<5.0	<0.5	1200	--	820	--
10/02/96	86.36	73.10	13.26	--	<100	<1.0	<1.0	<1.0	<1.0	360	--	1500	--
01/23/97	86.36	77.64	8.72	--	<100	<1.0	<1.0	<1.0	<1.0	490	--	<500	--
04/01/97	86.36	75.09	11.27	--	<250	<2.5	<2.5	<2.5	<2.5	1200	--	1600	--
07/09/97	86.36	73.92	12.44	--	<250	5.9	<2.5	<2.5	<2.5	1200	--	5700	--
10/07/97	86.36	73.44	12.92	--	<50	<0.5	<0.5	<0.5	<0.5	240	--	<500	--
01/22/98	86.36	75.14	11.22	--	<50	<0.5	<0.5	<0.5	<0.5	400	--	<500	--
04/02/98	86.36	75.67	10.69	--	56	<0.5	<0.5	<0.5	<0.5	290	--	<500	--
07/02/98	86.36	75.94	10.42	--	<50	<0.5	<0.5	<0.5	<0.5	380	--	<500	--
10/02/98	86.36	74.14	12.22	--	<50	<0.5	<0.5	<0.5	<1.5	660	--	1700	--
01/18/99	86.36	75.36	11.00	--	<100	<1.0	<1.0	<1.0	<1.0	281	--	543	--
01/18/99	86.36	75.36	11.00	Confirmation Run	--	--	--	--	--	296	--	--	--

* Chromatogram pattern indicates an unidentified hydrocarbon.

Cumulative Table of Well Data and Analytical Results

Vertical Measurements are in feet.

DATE	Well Head Elev.	Ground Water Elev.	Depth To Water	Notes	TPH-Gasoline	Benzene	Toluene	Ethyl-Benzene	Xylene	MTBE	TPH-Diesel	TPH-Motor Oil	Total Oil & Grease
MW-8													
03/08/94	85.93	75.06	10.87	--	28,000	2900	1300	1200	6800	--	<10	<100	--
07/06/94	85.93	--	--	--	--	--	--	--	--	--	--	--	--
08/04/94	85.93	73.77	12.16	--	22,000	3000	260	870	4400	--	--	--	--
10/05/94	85.93	72.71	13.22	--	12,000	1800	34	4.6	890	--	--	--	--
01/18/95	85.93	75.51	10.42	--	19,000	1000	65	1100	3500	--	--	--	--
04/07/95	85.93	75.48	10.45	--	14,000	310	<25	720	1700	--	--	--	--
07/06/95	85.93	74.30	11.63	--	19,000	280	<50	1200	2600	--	--	--	--
10/11/95	85.93	73.51	12.42	--	6100	140	5.5	320	280	1200	--	--	--
01/17/96	85.93	75.95	9.98	--	12,000	86	<20	590	1400	1100	--	<500	--
04/05/96	85.93	75.60	10.33	--	7500	180	23	410	480	560	--	<500	--
07/23/96	85.93	74.56	11.37	--	3800	47	<5.0	350	84	1800	--	<500	--
10/02/96	85.93	73.90	12.03	--	4400	65	<5.0	140	28	1500	--	<500	--
01/23/97	85.93	77.73	8.20	--	3800	36	5.9	140	36	910	--	<500	--
04/01/97	85.93	75.80	10.13	--	6100	43	<20	380	76	1800	--	<500	--
07/09/97	85.93	73.77	12.16	--	7300	48	<25	120	<25	2400	--	<500	--
10/07/97	85.93	73.77	12.16	--	3100	<10	<10	67	<10	1400	--	<500	--
01/22/98	85.93	75.83	10.10	--	1900	5.5	8.3	120	17	780	--	<500	--
04/02/98	85.93	75.55	10.38	--	2900	43	19	110	<10	800	--	<500	--
07/02/98	85.93	74.78	11.15	--	5000	31	<10	120	15	780	--	<500	--
10/02/98	85.93	74.03	11.90	--	2200	6.5	<0.5	21	2.6	140	--	1200*	--
01/18/99	85.93	75.12	10.81	--	2870	<5.0	<5.0	9.02	<5.0	476	554	<250	--
01/18/99	85.93	75.12	10.81	Confirmation Run	--	--	--	--	--	478	--	--	--

* Chromatogram pattern indicates an unidentified hydrocarbon.

Cumulative Table of Well Data and Analytical Results

Vertical Measurements are in feet.

DATE	Well Head Elev.	Ground Water Elev.	Depth To Water	Notes	TPH-Gasoline	Benzene	Toluene	Ethyl-Benzene	Xylene	MTBE	TPH-Diesel	TPH-Motor Oil	Total Oil & Grease
TRIP BLANK													
03/12/90	--	--	--	--	<50	<0.3	<0.3	<0.3	<0.6	--	--	--	--
02/08/91	--	--	--	--	<50	<0.5	<0.5	<0.5	<0.5	--	--	--	--
05/08/91	--	--	--	--	<50	<0.5	<0.5	<0.5	<0.5	--	--	--	--
08/12/91	--	--	--	--	<50	<0.5	<0.5	<0.5	<0.5	--	--	--	--
11/07/91	--	--	--	--	<50	<0.5	<0.5	<0.5	<0.5	--	--	--	--
02/05/92	--	--	--	--	<50	<0.5	<0.5	<0.5	<0.5	--	--	--	--
05/13/92	--	--	--	--	<50	<0.5	<0.5	<0.5	<0.5	--	--	--	--
07/17/92	--	--	--	--	<50	<0.5	<0.5	<0.5	<0.5	--	--	--	--
10/05/92	--	--	--	--	<50	<0.5	<0.5	<0.5	<0.5	--	--	--	--
11/11/92	--	--	--	--	--	--	--	--	--	--	--	--	--
11/17/92	--	--	--	--	--	--	--	--	--	--	--	--	--
11/29/92	--	--	--	--	--	--	--	--	--	--	--	--	--
12/01/92	--	--	--	--	--	--	--	--	--	--	--	--	--
12/29/92	--	--	--	--	--	--	--	--	--	--	--	--	--
01/05/93	--	--	--	--	--	--	--	--	--	--	--	--	--
01/08/93	--	--	--	--	<50	<0.5	<0.5	<0.5	<0.5	--	--	--	--
02/02/93	--	--	--	--	--	--	--	--	--	--	--	--	--
04/14/93	--	--	--	--	<50	<0.5	<0.5	<0.5	<0.5	--	--	--	--
08/06/93	--	--	--	--	<50	<0.5	<0.5	<0.5	<0.5	--	--	--	--
10/21/93	--	--	--	--	<50	<0.5	<0.5	<0.5	<0.5	--	--	--	--
01/05/94	--	--	--	--	<50	<0.5	<0.5	<0.5	<0.5	--	--	--	--
04/08/94	--	--	--	--	<50	<0.5	<0.5	<0.5	<0.5	--	--	--	--
07/06/94	--	--	--	--	<50	<0.5	<0.5	<0.5	<0.5	--	--	--	--
08/04/94	--	--	--	--	<50	<0.5	<0.5	<0.5	<0.5	--	--	--	--
10/05/94	--	--	--	--	<50	<0.5	<0.5	<0.5	<0.5	--	--	--	--
01/18/95	--	--	--	--	<50	<0.5	<0.5	<0.5	<0.5	--	--	--	--
04/07/95	--	--	--	--	<50	<0.5	<0.5	<0.5	<0.5	--	--	--	--
07/06/95	--	--	--	--	<50	<0.5	<0.5	<0.5	<0.5	--	--	--	--
10/11/95	--	--	--	--	<50	<0.5	<0.5	<0.5	<0.5	<2.5	--	--	--
01/17/96	--	--	--	--	<50	<0.5	<0.5	<0.5	<0.5	--	--	--	--
04/05/96	--	--	--	--	<50	<0.5	<0.5	<0.5	<0.5	<2.5	--	--	--
07/23/96	--	--	--	--	<50	<0.5	<0.5	<0.5	<0.5	<2.5	--	--	--
10/02/96	--	--	--	--	<50	<0.5	<0.5	<0.5	<0.5	--	--	--	--

CONTINUED ON NEXT PAGE

Cumulative Table of Well Data and Analytical Results

Vertical Measurements are in feet.

Analytical results are in parts per billion (ppb)

DATE	Well Head Elev.	Ground Water Elev.	Depth To Water	Notes	TPH-Gasoline	Benzene	Toluene	Ethyl-Benzene	Xylene	MTBE	TPH-Diesel	TPH-Motor Oil	Total Oil & Grease
TRIP BLANK (CONT'D)													
01/23/97	--	--	--	--	<50	<0.5	<0.5	<0.5	<0.5	<2.5	--	--	--
04/01/97	--	--	--	--	<50	<0.5	<0.5	<0.5	<0.5	<2.5	--	--	--
07/09/97	--	--	--	--	<50	<0.5	<0.5	<0.5	<0.5	<2.5	--	--	--
10/07/97	--	--	--	--	<50	<0.5	<0.5	<0.5	<0.5	<2.5	--	--	--
01/22/98	--	--	--	--	<50	<0.5	<0.5	<0.5	<0.5	<2.5	--	--	--
04/02/98	--	--	--	--	<50	<0.5	<0.5	<0.5	<0.5	<2.5	--	--	--
07/02/98	--	--	--	--	<50	<0.5	<0.5	<0.5	<0.5	<2.5	--	--	--
10/02/98	--	--	--	--	<50	<0.5	<0.5	<0.5	<1.5	<2.5	--	--	--
01/18/99	--	--	--	--	<50	<0.5	<0.5	<0.5	<0.5	<2.0	--	--	--

Note: Blaine Tech Services, Inc. began routine monitoring of the groundwater wells at this site on November 1, 1994. Earlier field data and analytical results are drawn from the November 23, 1994 Groundwater Technology, Inc. report.

ABBREVIATIONS:

TPH = Total Petroleum Hydrocarbons
 MTBE = Methyl t-Butyl Ether

Analytical Appendix



Sequoia
Analytical

680 Chesapeake Drive
404 N. Wiget Lane
819 Striker Avenue, Suite 8
1455 McDowell Blvd. North, Ste. D

Redwood City, CA 94063
Walnut Creek, CA 94598
Sacramento, CA 95834
Petaluma, CA 94954

(650) 364-9600
(925) 988-9600
(916) 921-9600
(707) 792-1865

FAX (650) 364-9233
FAX (925) 988-9673
FAX (916) 921-0100
FAX (707) 792-0342

February 3, 1999

Christine Lillie
Blaine Tech/Chevron
1680 Rogers Ave.
San Jose, CA 95112

RE: Chevron/P901307

Dear Christine Lillie

Enclosed are the results of analyses for sample(s) received by the laboratory on January 20, 1999. If you have any questions concerning this report, please feel free to contact me.

Sincerely,

Matt Sakai
Project Manager

CA ELAP Certificate Number 2245





**Sequoia
Analytical**

680 Chesapeake Drive
404 N. Wiget Lane
819 Striker Avenue, Suite 8
1455 McDowell Blvd. North, Ste. D

Redwood City, CA 94063
Walnut Creek, CA 94598
Sacramento, CA 95834
Petaluma, CA 94954

(650) 364-9600
(925) 988-9600
(916) 921-9600
(707) 792-1865

FAX (650) 364-9233
FAX (925) 988-9673
FAX (916) 921-0100
FAX (707) 792-0342

Blaine Tech/Chevron
1680 Rogers Ave.
San Jose, CA 95112

Project: Chevron
Project Number: 9-1583/990118-J3
Project Manager: Christine Lillie

Sampled: 1/18/99
Received: 1/20/99
Reported: 2/3/99

ANALYTICAL REPORT FOR P901307

Sample Description	Laboratory Sample Number	Sample Matrix	Date Sampled
MW-1	P901307-01	Water	1/18/99
MW-2	P901307-02	Water	1/18/99
MW-3	P901307-03	Water	1/18/99
MW-4	P901307-04	Water	1/18/99
MW-5	P901307-05	Water	1/18/99
MW-7	P901307-06	Water	1/18/99
MW-8	P901307-07	Water	1/18/99
TB	P901307-08	Water	1/18/99





Blaine Tech/Chevron 1680 Rogers Ave. San Jose, CA 95112	Project: Chevron Project Number: 9-1583/990118-J3 Project Manager: Christine Lillie	Sampled: 1/18/99 Received: 1/20/99 Reported: 2/3/99
---	---	---

**Total Petroleum Hydrocarbons as Gasoline and BTEX by EPA 8015M/8020M
Sequoia Analytical - Petaluma**

Analyte	Batch Number	Date Prepared	Date Analyzed	Surrogate Limits	Reporting Limit	Result	Units	Notes*
MW-1				<u>P901307-01</u>		<u>Water</u>		
Gasoline	9010463	1/26/99	1/26/99		250	416	ug/l	
Benzene	"	"	"		2.50	ND	"	
Toluene	"	"	"		2.50	ND	"	
Ethylbenzene	"	"	"		2.50	ND	"	
Xylenes (total)	"	"	"		2.50	ND	"	
Methyl tert-butyl ether	"	"	"		10.0	316	"	
Surrogate: a,a,a-Trifluorotoluene	"	"	"	65.0-135		106	%	
Surrogate: 4-Bromofluorobenzene	"	"	"	65.0-135		107	"	
MW-2				<u>P901307-02</u>		<u>Water</u>		
Gasoline	9010463	1/26/99	1/26/99		50.0	ND	ug/l	
Benzene	"	"	"		0.500	ND	"	
Toluene	"	"	"		0.500	ND	"	
Ethylbenzene	"	"	"		0.500	ND	"	
Xylenes (total)	"	"	"		0.500	ND	"	
Methyl tert-butyl ether	"	"	"		2.00	ND	"	
Surrogate: a,a,a-Trifluorotoluene	"	"	"	65.0-135		102	%	
Surrogate: 4-Bromofluorobenzene	"	"	"	65.0-135		108	"	
MW-3				<u>P901307-03</u>		<u>Water</u>		
Gasoline	9010463	1/26/99	1/26/99		100	1270	ug/l	
Benzene	"	"	"		1.00	ND	"	
Toluene	"	"	"		1.00	ND	"	
Ethylbenzene	"	"	"		1.00	7.95	"	
Xylenes (total)	"	"	"		1.00	ND	"	
Methyl tert-butyl ether	"	"	"		4.00	100	"	
Surrogate: a,a,a-Trifluorotoluene	"	"	"	65.0-135		96.3	%	
Surrogate: 4-Bromofluorobenzene	"	"	"	65.0-135		109	"	
MW-4				<u>P901307-04</u>		<u>Water</u>		
Gasoline	9010463	1/26/99	1/26/99		50.0	ND	ug/l	
Benzene	"	"	"		0.500	ND	"	
Toluene	"	"	"		0.500	ND	"	
Ethylbenzene	"	"	"		0.500	ND	"	
Xylenes (total)	"	"	"		0.500	ND	"	
Methyl tert-butyl ether	"	"	"		2.00	ND	"	
Surrogate: a,a,a-Trifluorotoluene	"	"	"	65.0-135		98.0	%	
Surrogate: 4-Bromofluorobenzene	"	"	"	65.0-135		108	"	
MW-5				<u>P901307-05</u>		<u>Water</u>		
Gasoline	9010463	1/26/99	1/27/99		50.0	ND	ug/l	





Blaine Tech/Chevron 1680 Rogers Ave. San Jose, CA 95112	Project: Chevron Project Number: 9-1583/990118-J3 Project Manager: Christine Lillie	Sampled: 1/18/99 Received: 1/20/99 Reported: 2/3/99
---	---	---

**Total Petroleum Hydrocarbons as Gasoline and BTEX by EPA 8015M/8020M
Sequoia Analytical - Petaluma**

Analyte	Batch Number	Date Prepared	Date Analyzed	Surrogate Limits	Reporting Limit	Result	Units	Notes*
<u>MW-5 (continued)</u>				<u>P901307-05</u>			<u>Water</u>	
Benzene	9010463	1/26/99	1/27/99		0.500	ND	ug/l	
Toluene	"	"	"		0.500	ND	"	
Ethylbenzene	"	"	"		0.500	ND	"	
Xylenes (total)	"	"	"		0.500	ND	"	
Methyl tert-butyl ether	"	"	"		2.00	ND	"	
Surrogate: a,a,a-Trifluorotoluene	"	"	"	65.0-135		101	%	
Surrogate: 4-Bromofluorobenzene	"	"	"	65.0-135		107	"	
<u>MW-7</u>				<u>P901307-06</u>			<u>Water</u>	
Gasoline	9010463	1/26/99	1/27/99		100	ND	ug/l	
Benzene	"	"	"		1.00	ND	"	
Toluene	"	"	"		1.00	ND	"	
Ethylbenzene	"	"	"		1.00	ND	"	
Xylenes (total)	"	"	"		1.00	ND	"	
Methyl tert-butyl ether	"	"	"		4.00	281	"	
Surrogate: a,a,a-Trifluorotoluene	"	"	"	65.0-135		100	%	
Surrogate: 4-Bromofluorobenzene	"	"	"	65.0-135		108	"	
<u>MW-8</u>				<u>P901307-07</u>			<u>Water</u>	
Gasoline	9010463	1/26/99	1/27/99		500	2870	ug/l	
Benzene	"	"	"		5.00	ND	"	
Toluene	"	"	"		5.00	ND	"	
Ethylbenzene	"	"	"		5.00	9.02	"	
Xylenes (total)	"	"	"		5.00	ND	"	
Methyl tert-butyl ether	"	"	"		20.0	476	"	
Surrogate: a,a,a-Trifluorotoluene	"	"	"	65.0-135		97.0	%	
Surrogate: 4-Bromofluorobenzene	"	"	"	65.0-135		107	"	
<u>TB</u>				<u>P901307-08</u>			<u>Water</u>	
Gasoline	9010433	1/26/99	1/26/99		50.0	ND	ug/l	
Benzene	"	"	"		0.500	ND	"	
Toluene	"	"	"		0.500	ND	"	
Ethylbenzene	"	"	"		0.500	ND	"	
Xylenes (total)	"	"	"		0.500	ND	"	
Methyl tert-butyl ether	"	"	"		2.00	ND	"	
Surrogate: a,a,a-Trifluorotoluene	"	"	"	65.0-135		118	%	
Surrogate: 4-Bromofluorobenzene	"	"	"	65.0-135		94.7	"	





Blaine Tech/Chevron 1680 Rogers Ave. San Jose, CA 95112	Project: Chevron Project Number: 9-1583/990118-J3 Project Manager: Christine Lillie	Sampled: 1/18/99 Received: 1/20/99 Reported: 2/3/99
---	---	---

**Total Petroleum Hydrocarbons as Diesel & others by EPA 8015M
Sequoia Analytical - Petaluma**

Analyte	Batch Number	Date Prepared	Date Analyzed	Surrogate Limits	Reporting Limit	Result	Units	Notes*
MW-7				<u>P901307-06</u>			<u>Water</u>	
Motor Oil	9010461	1/26/99	2/1/99		0.250	0.543	mg/l	
Diesel	"	"	"		0.0500	ND	"	
<i>Surrogate: o-Terphenyl</i>	"	"	"	50.0-150		78.6	%	
MW-8				<u>P901307-07</u>			<u>Water</u>	
Motor Oil	9010461	1/26/99	2/1/99		0.250	ND	mg/l	
Diesel	"	"	"		0.0500	0.554	"	1
<i>Surrogate: o-Terphenyl</i>	"	"	"	50.0-150		72.4	%	





Blaine Tech/Chevron 1680 Rogers Ave. San Jose, CA 95112	Project: Chevron Project Number: 9-1583/990118-J3 Project Manager: Christine Lillie	Sampled: 1/18/99 Received: 1/20/99 Reported: 2/3/99
---	---	---

**Volatile Organic Compounds by EPA Method 8260B
Sequoia Analytical - Petaluma**

Analyte	Batch Number	Date Prepared	Date Analyzed	Surrogate Limits	Reporting Limit	Result	Units	Notes*
<u>MW-1</u>				<u>P901307-01</u>			<u>Water</u>	
Methyl tert-butyl ether	9010501	1/28/99	1/28/99		5.00	295	ug/l	
Surrogate: Dibromofluoromethane	"	"	"	86.0-118		96.6	%	
<u>MW-3</u>				<u>P901307-03</u>			<u>Water</u>	
Methyl tert-butyl ether	9010501	1/28/99	1/28/99		5.00	99.7	ug/l	
Surrogate: Dibromofluoromethane	"	"	"	86.0-118		99.6	%	
<u>MW-7</u>				<u>P901307-06</u>			<u>Water</u>	
Methyl tert-butyl ether	9010501	1/28/99	1/28/99		5.00	296	ug/l	
Surrogate: Dibromofluoromethane	"	"	"	86.0-118		101	%	
<u>MW-8</u>				<u>P901307-07</u>			<u>Water</u>	
Methyl tert-butyl ether	9010501	1/28/99	1/28/99		20.0	478	ug/l	
Surrogate: Dibromofluoromethane	"	"	"	86.0-118		99.2	%	





Blaine Tech/Chevron 1680 Rogers Ave. San Jose, CA 95112	Project: Chevron Project Number: 9-1583/990118-J3 Project Manager: Christine Lillie	Sampled: 1/18/99 Received: 1/20/99 Reported: 2/3/99
---	---	---

**Total Petroleum Hydrocarbons as Gasoline and BTEX by EPA 8015M/8020M/Quality Control
Sequoia Analytical - Petaluma**

Analyte	Date Analyzed	Spike Level	Sample Result	QC Result	Units	Reporting Limit Recov. Limits	Recov. %	RPD Limit	RPD %	Notes*
Batch: 9010433		Date Prepared: 1/25/99			Extraction Method: EPA 5030 waters					
Blank		9010433-BLK1								
Gasoline	1/25/99			ND	ug/l	50.0				
Benzene	"			ND	"	0.500				
Toluene	"			ND	"	0.500				
Ethylbenzene	"			ND	"	0.500				
Xylenes (total)	"			ND	"	0.500				
Methyl tert-butyl ether	"			ND	"	2.00				
Surrogate: a,a,a-Trifluorotoluene	"	300		360	"	65.0-135	120			
Surrogate: 4-Bromofluorobenzene	"	300		293	"	65.0-135	97.7			
Blank		9010433-BLK2								
Gasoline	1/26/99			ND	ug/l	50.0				
Benzene	"			ND	"	0.500				
Toluene	"			ND	"	0.500				
Ethylbenzene	"			ND	"	0.500				
Xylenes (total)	"			ND	"	0.500				
Methyl tert-butyl ether	"			ND	"	2.00				
Surrogate: a,a,a-Trifluorotoluene	"	300		311	"	65.0-135	104			
Surrogate: 4-Bromofluorobenzene	"	300		249	"	65.0-135	83.0			
LCS		9010433-BS1								
Gasoline	1/25/99	1000		897	ug/l	65.0-135	89.7			
Surrogate: 4-Bromofluorobenzene	"	300		289	"	65.0-135	96.3			
LCS		9010433-BS2								
Benzene	1/26/99	100		87.3	ug/l	65.0-135	87.3			
Toluene	"	100		88.2	"	65.0-135	88.2			
Ethylbenzene	"	100		86.4	"	65.0-135	86.4			
Xylenes (total)	"	300		268	"	65.0-135	89.3			
Surrogate: a,a,a-Trifluorotoluene	"	300		318	"	65.0-135	106			
Matrix Spike		9010433-MS1		P901219-01						
Gasoline	1/25/99	1000	814	1610	ug/l	65.0-135	79.6			
Surrogate: 4-Bromofluorobenzene	"	300		287	"	65.0-135	95.7			
Matrix Spike Dup		9010433-MSD1		P901219-01						
Gasoline	1/25/99	1000	814	1610	ug/l	65.0-135	79.6	20.0	0	
Surrogate: 4-Bromofluorobenzene	"	300		291	"	65.0-135	97.0			





Blaine Tech/Chevron 1680 Rogers Ave. San Jose, CA 95112	Project: Chevron Project Number: 9-1583/990118-J3 Project Manager: Christine Lillie	Sampled: 1/18/99 Received: 1/20/99 Reported: 2/3/99
---	---	---

**Total Petroleum Hydrocarbons as Gasoline and BTEX by EPA 8015M/8020M/Quality Control
Sequoia Analytical - Petaluma**

Analyte	Date Analyzed	Spike Level	Sample Result	QC Result	Reporting Limit Units	Recov. Limits	Recov. %	RPD Limit	RPD %	Notes*
Batch: 9010463		Date Prepared: 1/26/99			Extraction Method: EPA 5030 waters					
Blank		9010463-BLK1								
Gasoline	1/26/99			ND	ug/l	50.0				
Benzene	"			ND	"	0.500				
Toluene	"			ND	"	0.500				
Ethylbenzene	"			ND	"	0.500				
Xylenes (total)	"			ND	"	0.500				
Methyl tert-butyl ether	"			ND	"	2.00				
Surrogate: a,a,a-Trifluorotoluene	"	300		305	"	65.0-135	102			
Surrogate: 4-Bromofluorobenzene	"	300		306	"	65.0-135	102			
LCS		9010463-BS1								
Gasoline	1/26/99	1000		966	ug/l	65.0-135	96.6			
Surrogate: 4-Bromofluorobenzene	"	300		313	"	65.0-135	104			
Matrix Spike		9010463-MS1			P901237-01					
Gasoline	1/26/99	1000	105	1080	ug/l	65.0-135	97.5			
Surrogate: 4-Bromofluorobenzene	"	300		326	"	65.0-135	109			
Matrix Spike Dup		9010463-MSD1			P901237-01					
Gasoline	1/26/99	1000	105	1080	ug/l	65.0-135	97.5	20.0	0	
Surrogate: 4-Bromofluorobenzene	"	300		341	"	65.0-135	114			





Blaine Tech/Chevron 1680 Rogers Ave. San Jose, CA 95112	Project: Chevron Project Number: 9-1583/990118-J3 Project Manager: Christine Lillie	Sampled: 1/18/99 Received: 1/20/99 Reported: 2/3/99
---	---	---

**Total Petroleum Hydrocarbons as Diesel & others by EPA 8015M/Quality Control
Sequoia Analytical - Petaluma**

Analyte	Date Analyzed	Spike Level	Sample Result	QC Result	Units	Reporting Limit Recov. Limits	Recov. %	RPD Limit	RPD %	Notes*
Batch: 9010461		Date Prepared: 1/26/99			Extraction Method: EPA 3520B					
Blank										
Motor Oil	2/2/99			ND	mg/l	0.250				
Diesel	"			ND	"	0.0500				
Surrogate: o-Terphenyl	"	0.100		0.0863	"	50.0-150	86.3			
LCS										
9010461-BS1										
Diesel	2/2/99	1.00		0.733	mg/l	50.0-150	73.3			
Surrogate: o-Terphenyl	"	0.100		0.0816	"	50.0-150	81.6			
LCS Dup										
9010461-BSD1										
Diesel	2/2/99	1.00		0.809	mg/l	50.0-150	80.9	35.0	9.86	
Surrogate: o-Terphenyl	"	0.100		0.0848	"	50.0-150	84.8			





Blaine Tech/Chevron 1680 Rogers Ave. San Jose, CA 95112	Project: Chevron Project Number: 9-1583/990118-J3 Project Manager: Christine Lillie	Sampled: 1/18/99 Received: 1/20/99 Reported: 2/3/99
---	---	---

**Volatile Organic Compounds by EPA Method 8260B/Quality Control
Sequoia Analytical - Petaluma**

Analyte	Date Analyzed	Spike Level	Sample Result	QC Result	Units	Reporting Limit Recov. Limits	Recov. %	RPD Limit	RPD %	Notes*
Batch: 9010501		Date Prepared: 1/27/99		Extraction Method: EPA 5030 waters						
Blank		9010501-BLK1								
Methyl tert-butyl ether	1/27/99			ND	ug/l	0.500				
Surrogate: Dibromofluoromethane	"	5.00		4.44	"	86.0-118	88.8			
Blank		9010501-BLK2								
Methyl tert-butyl ether	1/28/99			ND	ug/l	0.500				
Surrogate: Dibromofluoromethane	"	5.00		4.78	"	86.0-118	95.6			
LCS		9010501-BS1								
Methyl tert-butyl ether	1/27/99	5.00		5.00	ug/l	70.0-130	100			
Surrogate: Dibromofluoromethane	"	5.00		4.74	"	86.0-118	94.8			
LCS		9010501-BS2								
Methyl tert-butyl ether	1/28/99	5.00		4.56	ug/l	70.0-130	91.2			
Surrogate: Dibromofluoromethane	"	5.00		4.63	"	86.0-118	92.6			
Matrix Spike		9010501-MS1		P901244-03						
Methyl tert-butyl ether	1/27/99	5.00	ND	4.96	ug/l	70.0-130	99.2			
Surrogate: Dibromofluoromethane	"	5.00		4.78	"	86.0-118	95.6			
Matrix Spike Dup		9010501-MSD1		P901244-03						
Methyl tert-butyl ether	1/27/99	5.00	ND	5.21	ug/l	70.0-130	104	15.0	4.72	
Surrogate: Dibromofluoromethane	"	5.00		4.79	"	86.0-118	95.8			





Blaine Tech/Chevron 1680 Rogers Ave. San Jose, CA 95112	Project: Chevron Project Number: 9-1583/990118-J3 Project Manager: Christine Lillie	Sampled: 1/18/99 Received: 1/20/99 Reported: 2/3/99
---	---	---

Notes and Definitions

#	Note
---	------

- 1 Hydrocarbon pattern present in the requested fuel quantitation range but does not resemble the pattern of the requested fuel.
- DET Analyte DETECTED
- ND Analyte NOT DETECTED at or above the reporting limit
- NR Not Reported
- dry Sample results reported on a dry weight basis
- Recov. Recovery
- RPD Relative Percent Difference



Yes
 No

Fax copy of Lab Report and COC to Chevron Contact:

Chain-of-Custody-Record

Chevron U.S.A. Inc.
P.O. BOX 5004
San Ramon, CA 94583
FAX (415)842-9591

Chevron Facility Number 9-1583
Facility Address 5509 Martin Luther King Jr. Way, Oakland, CA
Consultant Project Number 990118-J3
Consultant Name Blaine Tech Services, Inc.
Address 1680 Rogers Ave., San Jose, CA 95112
Project Contact (Name) Fran Thie
(Phone) (408)573-0555 (Fax Number) (408)573-7771

Chevron Contact (Name) Phil Briggs
(Phone) (510) 842-9136
Laboratory Name Squid
Laboratory Release Number 9034796
Samples Collected by (Name) Steve Smith
Collection Date 1/18/99
Signature [Signature]

Sample Number	Lab Sample Number	Number of Containers	Matrix: S = Soil W = Water C = Charcoal	A = Air C = Composite D = Discrete	Time	Sample Preservation	Iced (Yes or No)	Analytes To Be Performed												Remarks			
								BTEX + TPH GAS (8020 + 8015)	TPH Diesel (8015)	Oil and Grease (8020)	Purgeable Halocarbons (8010)	Purgeable Aromatics (8020)	Purgeable Organics (8240)	Extractable Organics (8270)	Metals Cd, Cr, Pb, Zn, Ni (ICAP or AA)	Motor Oil							
MW-1	-	3	W		1323	→ HCl	Y	X														9901367-01	
MW-2	-	3			1307	→		X															02
MW-3	-	3			1338	→		X															03
MW-4	-	3			1250	→		X															04
MW-5	-	3			1211	→		X															05
MW-7	-	5			1229	→		X								X							06
MW-8	-	5			1358	→		X								X							07
TB	-	2	↓				↓	X															08

Relinquished By (Signature) <u>[Signature]</u>	Organization <u>BTS</u>	Date/Time <u>1-19-99 0945</u>	Received By (Signature) <u>[Signature]</u>	Organization <u>Squid</u>	Date/Time <u>1-19-99 0945</u>
Relinquished By (Signature) <u>[Signature]</u>	Organization <u>Squid</u>	Date/Time <u>1-19-99</u>	Received By (Signature) <u>[Signature]</u>	Organization <u>coc</u>	Date/Time <u>1-20-99 1230</u>
Relinquished By (Signature) <u>[Signature]</u>	Organization <u>coc</u>	Date/Time <u>1-20-99 1430</u>	Received For Laboratory By (Signature) <u>[Signature]</u>	Date/Time <u>1/19/99 1230</u>	

Turn Around Time (Circle Choice)

24 Hrs. 95 19 12 30
48 Hrs.
6 Days
10 Days
As Contracted

COC-3.DWG/03 91/HCH

Field Data Sheets

WELL GAUGING DATA

Project # 990118-53 Date 1/18/99 Client Chemco

Site SS09 Martin Luther King Dr. Oakland, CA

Well ID	Well Size (in.)	Sheen / Odor	Depth to Immiscible Liquid (ft.)	Thickness of Immiscible Liquid (ft.)	Volume of Immiscibles Removed (ml)	Depth to water (ft.)	Depth to well bottom (ft.)	Survey Point: TOB or TOC
MW-1	3					9.55	19.82	TOC
MW-2	3					10.39	18.80	
MW-3	3					10.33	19.63	
MW-4	2					11.60	25.08	
MW-5	2					8.84	19.86	
MW-6	—		Inaccessible		Car	Over	well	
MW-7	2					11.00	19.80	
MW-8	2					10.81	19.41	

Heavy Sheen
in Well Box

1/18/99

CHEVRON WELL MONITORING DATA SHEET

Project #: 990118-33	Station #: 9-7583
Sampler: Steve	Date: 1/18/99
Well I.D.: MW-1	Well Diameter: 2 (3) 4 6 8
Total Well Depth: 19.82	Depth to Water: 9.55
Depth to Free Product:	Thickness of Free Product (feet):
Referenced to: PVC Grade	D.O. Meter (if req'd): YSI HACH

Well Diameter	Multiplier	Well Diameter	Multiplier
2"	0.16	5"	1.02
3"	0.37	6"	1.47
4"	0.65	Other	radius ² * 0.163

Purge Method: Bailer Sampling Method: Bailer

Disposable Bailer Disposable Bailer

Middleburg Extraction Port

Electric Submersible Other: _____

Extraction Pump

Other: _____

3.8	x	3	=	11.4	Gals.
1 Case Volume (Gals.)		Specified Volumes		Calculated Volume	

Time	Temp (°F)	pH	Cond.	Gals. Removed	Observations
1316	64.1	6.7	480	4.0	
1317	65.8	6.9	440	8.0	
1318	65.9	6.8	420	11.5	

Did well dewater? Yes No Gallons actually evacuated: 11.5

Sampling Time: 13²³ Sampling Date: 1/18/99

Sample I.D.: MW-1 Laboratory: Sequoia GTEL N. Creek Assoc. Labs

Analyzed for: TPH-G BTEX MTBE TPH-D Other:

Duplicate I.D.: Analyzed for: TPH-G BTEX MTBE TPH-D Other:

D.O. (if req'd):	Pre-purge:	mg/L	Post-purge:	mg/L
O.R.P. (if req'd):	Pre-purge:	mV	Post-purge:	mV

CHEVRON WELL MONITORING DATA SHEET

Project #: 990118-J3	Station #: 9-1583
Sampler: Stwe	Date: 1/18/99
Well I.D.: MW-2	Well Diameter: 2 <u>3</u> 4 6 8
Total Well Depth: 18.80	Depth to Water: 10.39
Depth to Free Product:	Thickness of Free Product (feet):
Referenced to: <u>PVC</u> Grade	D.O. Meter (if req'd): YSI HACH

Well Diameter	Multiplier	Well Diameter	Multiplier
2"	0.16	5"	1.02
3"	0.37	6"	1.47
4"	0.65	Other	radius ² * 0.163

Purge Method: Bailer Disposable Bailer Middleburg Electric Submersible <input checked="" type="checkbox"/> Extraction Pump Other: _____	Sampling Method: Bailer Disposable Bailer <input checked="" type="checkbox"/> Extraction Port Other: _____
--	---

3.1	x	3	=	9.3	Gals.
1 Case Volume (Gals.)		Specified Volumes		Calculated Volume	

Time	Temp (°F)	pH	Cond.	Gals. Removed	Observations
13 ⁰⁰	65.6	7.0	500	3.5	
13 ⁰¹	66.8	6.9	510	7.0	
13 ⁰²	66.7	7.0	490	9.5	

Did well dewater? Yes <input type="checkbox"/> No <input checked="" type="checkbox"/>	Gallons actually evacuated: 9.5
Sampling Time: 13 ⁰⁷	Sampling Date: 1/18/99
Sample I.D.: MW-2	Laboratory: <u>Sequoia</u> GTEL N. Creek Assoc. Labs
Analyzed for: <u>TPH-G</u> <u>BTEX</u> <u>MTBE</u> TPH-D Other:	
Duplicate I.D.:	Analyzed for: TPH-G BTEX MTBE TPH-D Other:
D.O. (if req'd):	Pre-purge: <input type="text"/> mg/L Post-purge: <input type="text"/> mg/L
O.R.P. (if req'd):	Pre-purge: <input type="text"/> mV Post-purge: <input type="text"/> mV

CHEVRON WELL MONITORING DATA SHEET

Project #: 990118-53	Station #: 9-1583
Sampler: STEVE	Date: 1/18/99
Well I.D.: MW-3	Well Diameter: 2 (3) 4 6 8
Total Well Depth: 19.63	Depth to Water: 10.33
Depth to Free Product:	Thickness of Free Product (feet):
Referenced to: (PVC) Grade	D.O. Meter (if req'd): YSI HACH

Well Diameter	Multiplier	Well Diameter	Multiplier
2"	0.16	5"	1.02
3"	0.37	6"	1.47
4"	0.65	Other	radius ² * 0.163

Purge Method: Bailer Disposable Bailer Middleburg Electric Submersible <input checked="" type="checkbox"/> Extraction Pump Other: _____	Sampling Method: Bailer Disposable Bailer <input checked="" type="checkbox"/> Extraction Port Other: _____
--	---

3.4	x	3	=	10.2	Gals.
1 Case Volume (Gals.)		Specified Volumes		Calculated Volume	

Time	Temp (°F)	pH	Cond.	Gals. Removed	Observations
1331	65.1	7.0	170	3.5	
1332	66.2	7.1	150	7.0	
1333	66.4	7.0	150	10.5	

Did well dewater? Yes <input type="checkbox"/> No <input checked="" type="checkbox"/>	Gallons actually evacuated: 10.5
Sampling Time: 1336	Sampling Date: 1/18/99
Sample I.D.: MW-3	Laboratory: (Sequoia) GTEL N. Creek Assoc. Labs
Analyzed for: (TPH-G) (BTEX) (MTBE) TPH-D Other:	
Duplicate I.D.:	Analyzed for: TPH-G BTEX MTBE TPH-D Other:
D.O. (if req'd):	Pre-purge: <input type="text"/> mg/L Post-purge: <input type="text"/> mg/L
O.R.P. (if req'd):	Pre-purge: <input type="text"/> mV Post-purge: <input type="text"/> mV

CHEVRON WELL MONITORING DATA SHEET

Project #: 990118-53	Station #: 9-1583
Sampler: Stwe	Date: 1/18/99
Well I.D.: MW-4	Well Diameter: (2) 3 4 6 8 _____
Total Well Depth: 25.08	Depth to Water: 11.60
Depth to Free Product:	Thickness of Free Product (feet):
Referenced to: (PVC) Grade	D.O. Meter (if req'd): YSI HACH

Well Diameter	Multiplier	Well Diameter	Multiplier
2"	0.16	5"	1.02
3"	0.37	6"	1.47
4"	0.65	Other	radius ² * 0.163

Purge Method: Bailer Disposable Bailer <input checked="" type="checkbox"/> Middleburg Electric Submersible Extraction Pump Other: _____	Sampling Method: Bailer Disposable Bailer <input checked="" type="checkbox"/> Extraction Port Other: _____
--	---

2.2	x	3	=	6.6	Gals.
1 Case Volume (Gals.)		Specified Volumes		Calculated Volume	

Time	Temp (°F)	pH	Cond.	Gals. Removed	Observations
1239	65.9	6.8	500	2.5	
1242	66.8	6.9	470	4.5	
1245	67.0	7.0	460	7.0	

Did well dewater? Yes <input type="checkbox"/> (No)	Gallons actually evacuated: 7.0
Sampling Time: 1250	Sampling Date: 1/18/99
Sample I.D.: MW-4	Laboratory: (Sequoia) GTEL N. Creek Assoc. Labs
Analyzed for: (TPH-G) (BTEX) (MTBE) TPH-D Other:	
Duplicate I.D.:	Analyzed for: TPH-G BTEX MTBE TPH-D Other:
D.O. (if req'd):	Pre-purge: _____ mg/L Post-purge: _____ mg/L
O.R.P. (if req'd):	Pre-purge: _____ mV Post-purge: _____ mV

CHEVRON WELL MONITORING DATA SHEET

Project #: 990118-53	Station #: 9-1583
Sampler: Stwe	Date: 1/18/99
Well I.D.: MW-6	Well Diameter: 2 3 4 6 8 <u> </u>
Total Well Depth:	Depth to Water:
Depth to Free Product:	Thickness of Free Product (feet):
Referenced to: PVC Grade	D.O. Meter (if req'd): YSI HACH

Well Diameter	Multiplier	Well Diameter	Multiplier
2"	0.16	5"	1.02
3"	0.37	6"	1.47
4"	0.65	Other	radius ² * 0.163

Purge Method: Bailer	Sampling Method: Bailer
Disposable Bailer	Disposable Bailer
Middleburg	Extraction Port
Electric Submersible	Other: _____
Extraction Pump	
Other: _____	

_____	X	_____	=	_____ Gals.
1 Case Volume (Gals.)		Specified Volumes		Calculated Volume

Time	Temp (°F)	pH	Cond.	Gals. Removed	Observations
		<i>Inaccessible - Cur Over well</i>			<i>@ 11:45</i>
		<i>No Sample</i>			<i>@ 14:00</i>

Did well dewater? Yes No	Gallons actually evacuated:	
Sampling Time:	Sampling Date:	
Sample I.D.:	Laboratory: Sequoia GTEL N. Creek Assoc. Labs	
Analyzed for: TPH-G BTEX MTBE TPH-D Other:		
Duplicate I.D.:	Analyzed for: TPH-G BTEX MTBE TPH-D Other:	
D.O. (if req'd):	Pre-purge: _____ mg/L	Post-purge: _____ mg/L
O.R.P. (if req'd):	Pre-purge: _____ mV	Post-purge: _____ mV

CHEVRON WELL MONITORING DATA SHEET

Project #: 990118-53	Station #: 9-1583
Sampler: Steve	Date: 1/18/99
Well I.D.: MW-7	Well Diameter: <u>2</u> 3 4 6 8
Total Well Depth: 19.80	Depth to Water: 11.00
Depth to Free Product:	Thickness of Free Product (feet):
Referenced to: <u>PVC</u> Grade	D.O. Meter (if req'd): YSI HACH

Well Diameter	Multiplier	Well Diameter	Multiplier
2"	0.16	5"	1.02
3"	0.37	6"	1.47
4"	0.65	Other	radius ² * 0.163

Purge Method: Bailer Sampling Method: Bailer

Disposable Bailer

Middleburg

Electric Submersible

Extraction Pump

Other: _____

Disposable Bailer

Extraction Port

Other: _____

<u>1.4</u>	x	<u>3</u>	=	<u>4.2</u>	Gals.
1 Case Volume (Gals.)		Specified Volumes		Calculated Volume	

Time	Temp (°F)	pH	Cond.	Gals. Removed	Observations
12 ²⁰	64.2	6.7	640	1.5	Shew / ODOR
12 ²²	65.8	6.8	600	3.0	
12 ²⁴	66.0	6.8	610	4.5	

Did well dewater? Yes No Gallons actually evacuated: 4.5

Sampling Time: 12²⁹ Sampling Date: 1/18/99

Sample I.D.: MW-7 Laboratory: Sequoia GTEL N. Creek Assoc. Labs

Analyzed for: TPH-G BTEX MTBE TPH-D Other: Motor Oil

Duplicate I.D.: Analyzed for: TPH-G BTEX MTBE TPH-D Other:

D.O. (if req'd):	Pre-purge:	mg/L	Post-purge:	mg/L
O.R.P. (if req'd):	Pre-purge:	mV	Post-purge:	mV

CHEVRON WELL MONITORING DATA SHEET

Project #: 990118-J3	Station #: 9-1503
Sampler: Stur	Date: 1/18/99
Well I.D.: MW-8	Well Diameter: 2 3 4 6 8
Total Well Depth: 19.41	Depth to Water: 10.81
Depth to Free Product:	Thickness of Free Product (feet):
Referenced to: PVC Grade	D.O. Meter (if req'd): YSI HACH

Well Diameter	Multiplier	Well Diameter	Multiplier
2"	0.16	5"	1.02
3"	0.37	6"	1.47
4"	0.65	Other	radius ² * 0.163

Purge Method: Bailer Disposable Bailer <input checked="" type="checkbox"/> Middleburg Electric Submersible Extraction Pump Other: _____	Sampling Method: Bailer Disposable Bailer <input checked="" type="checkbox"/> Extraction Port Other: _____
--	---

<u>1.4</u>	x	<u>3</u>	=	<u>4.2</u>	Gals.
1 Case Volume (Gals.)		Specified Volumes		Calculated Volume	

Time	Temp (°F)	pH	Cond.	Gals. Removed	Observations
1347	64.4	6.7	580	1.5	
1350	65.5	6.9	550	3.0	
1353	65.9	6.9	540	4.5	

Did well dewater? Yes <input type="checkbox"/> No <input checked="" type="checkbox"/>	Gallons actually evacuated: 4.5
Sampling Time: 1358	Sampling Date: 1/18/99
Sample I.D.: MW-8	Laboratory: Sequoia GTEL N. Creek Assoc. Labs
Analyzed for: TPH-G BTEX MTBE TPH-D Other: Motn 0.1	
Duplicate I.D.:	Analyzed for: TPH-G BTEX MTBE TPH-D Other:
D.O. (if req'd):	Pre-purge: <input type="checkbox"/> mg/L Post-purge: <input type="checkbox"/> mg/L
O.R.P. (if req'd):	Pre-purge: <input type="checkbox"/> mV Post-purge: <input type="checkbox"/> mV