

ENVIRONMENTAL  
PROTECTION

98 NOV 30 AM 7:54



**Chevron**

November 23, 1998

**Chevron Products Company**  
6001 Bollinger Canyon Road  
Building L, Room 1110  
PO Box 6004  
San Ramon, CA 94583-0904

Ms. Susan Hugo  
Alameda County Health Care Services  
Department of Environmental Health  
1131 Harbor Bay Parkway, Suite 250  
Alameda, CA 94502-6577

**Philip R. Briggs**  
Project Manager  
Site Assessment & Remediation  
Phone 925 842-9136  
Fax 925 842-8370

**Re: Chevron Service Station #9-1583**  
**5509 Martin Luther King Way, Oakland, California**

Dear Ms. Hugo:

Enclosed is the Fourth Quarter Groundwater Monitoring report for 1998 that was prepared by our consultant Blaine Tech Services Inc., for the above noted site. The groundwater samples collected were analyzed for TPH-g, BTEX and MtBE in all wells and TPH-motor oil constituents only in monitoring wells MW-7 and MW-8.

Monitoring wells MW-2, MW-4 and MW-5 were below method detection limits for all constituents, while wells MW-6 and MW-7 were below method detection limits for the TPH-g and BTEX constituents. The benzene constituent increased in monitoring well MW-1 from the previous sampling event, while the benzene concentration decreased in monitoring wells MW-3 and MW-8. TPH-motor oil increased in wells MW-7 and MW-8 from the previous sampling event, with the chromatogram pattern in well MW-8 indicating an unidentified hydrocarbon.

Depth to ground water varied from 8.92 feet to 13.25 feet below grade with a direction of flow varying southeasterly from wells MW-7 and MW-8 to well MW-2; and southerly from well MW-1 to well MW-6.

Monitoring wells MW-4 and MW-5 have been below method detection limits for all the constituents, for at least the last eleven sampling events. Wells MW-1, MW-2, MW-6 and MW-7 have had minimal impact from BTEX constituents for the last eleven sampling events.

**Therefore, Chevron is proposing that wells MW-4, MW-5 and MW-6 be sampled annually, with wells MW-1, MW-2, MW-3, MW-7 and MW-8 sampled semi-annually (5<sup>th</sup>**

November 23, 1998  
Ms. Susan Hugo  
Chevron Service Station #9-1583  
Page 2

**Request).** Chevron believes that a change in the sampling program is appropriate as noted above and requests your concurrence. However, if we do not receive a response objecting to our proposal within 30 days, Chevron will assume that you concur with the new sampling program and it will be initiated in the first quarter 1999.

If you have any questions call me at (925) 842-9136.

Sincerely,  
**CHEVRON PRODUCTS COMPANY**



Philip R. Briggs  
Site Assessment and Remediation Project Manager

Enclosure

CC. Mr. Bill Scudder, Chevron

Petroleum Sales, Inc.  
505 South Van Ness  
San Francisco, CA 94110  
Attn: Ben Shimek

**BLAINE**  
TECH SERVICES, INC.



1680 ROGERS AVENUE  
SAN JOSE, CA 95112-1105  
(408) 573-7771 FAX  
(408) 573-0555 PHONE

ENVIRONMENTAL  
PROTECTION

98 NOV 30 AM 7:54

November 20, 1998

Phil Briggs  
Chevron U.S.A. Products Company  
P.O. Box 6004  
San Ramon, CA 94583-0904

#### **4th Quarter 1998 Monitoring at 9-1583**

Fourth Quarter 1998 Groundwater Monitoring at  
Chevron Service Station Number 9-1583  
5509 Martin Luther King Jr. Way  
Oakland, CA

Monitoring Performed on October 2, 1998

---

#### **Groundwater Sampling Report 981002-Z-2**

This report covers the routine monitoring of groundwater wells at this Chevron facility. Blaine Tech Services, Inc.'s work at the site includes inspection, gauging, evacuation, purgewater containment, sample collection and sample handling in accordance with standard procedures that conform to Regional Water Quality Control Board requirements.

Routine field data collection includes depth to water, total well depth, thickness of any separate immiscible layer, water column volume, calculated volume of a three-case volume purge, elapsed evacuation time, total volume of water removed, and standard water parameter instrument readings. Sample material is collected, contained, stored, and transported to the laboratory in conformance with EPA standards. Purgewater is, likewise, collected and transported to McKittrick Waste Treatment Site for disposal.

Basic field information is presented alongside analytical values excerpted from the laboratory report in the cumulative table of **WELL DATA AND ANALYTICAL RESULTS**. The full analytical report for the most recent samples is located in the **Analytical Appendix**. The table also contains new groundwater elevation calculations taken from the computer plotted gradient

map which is located in the **Professional Engineering Appendix**.

At a minimum, Blaine Tech Services, Inc. field personnel are certified upon completion of a forty-hour Hazardous Materials and Emergency Response training course per 29 CFR 1910.120. Field personnel are also enrolled in annual eight hour refresher courses.

Blaine Tech Services, Inc. conducts sampling and documentation assignments of this type as an independent third party. In order to avoid compromising the objectivity necessary for the proper and disinterested performance of this work, Blaine Tech Services, Inc. concentrates on objective data collection and does not participate in the interpretation of analytical results, the definition of geological or hydrological conditions, the formulation of recommendations, or the marketing of remedial systems.

Please call if you have any questions.

Yours truly,

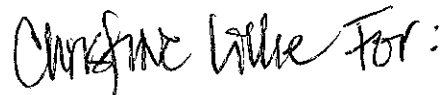
A handwritten signature in black ink that reads "Christine Wilke For:". The signature is written in a cursive style.

Francis Thie  
Vice President

FPT/ap

attachments: Professional Engineering Appendix  
Cumulative Table of Well Data and Analytical Results  
Analytical Appendix  
Field Data Sheets

# **Professional Engineering Appendix**

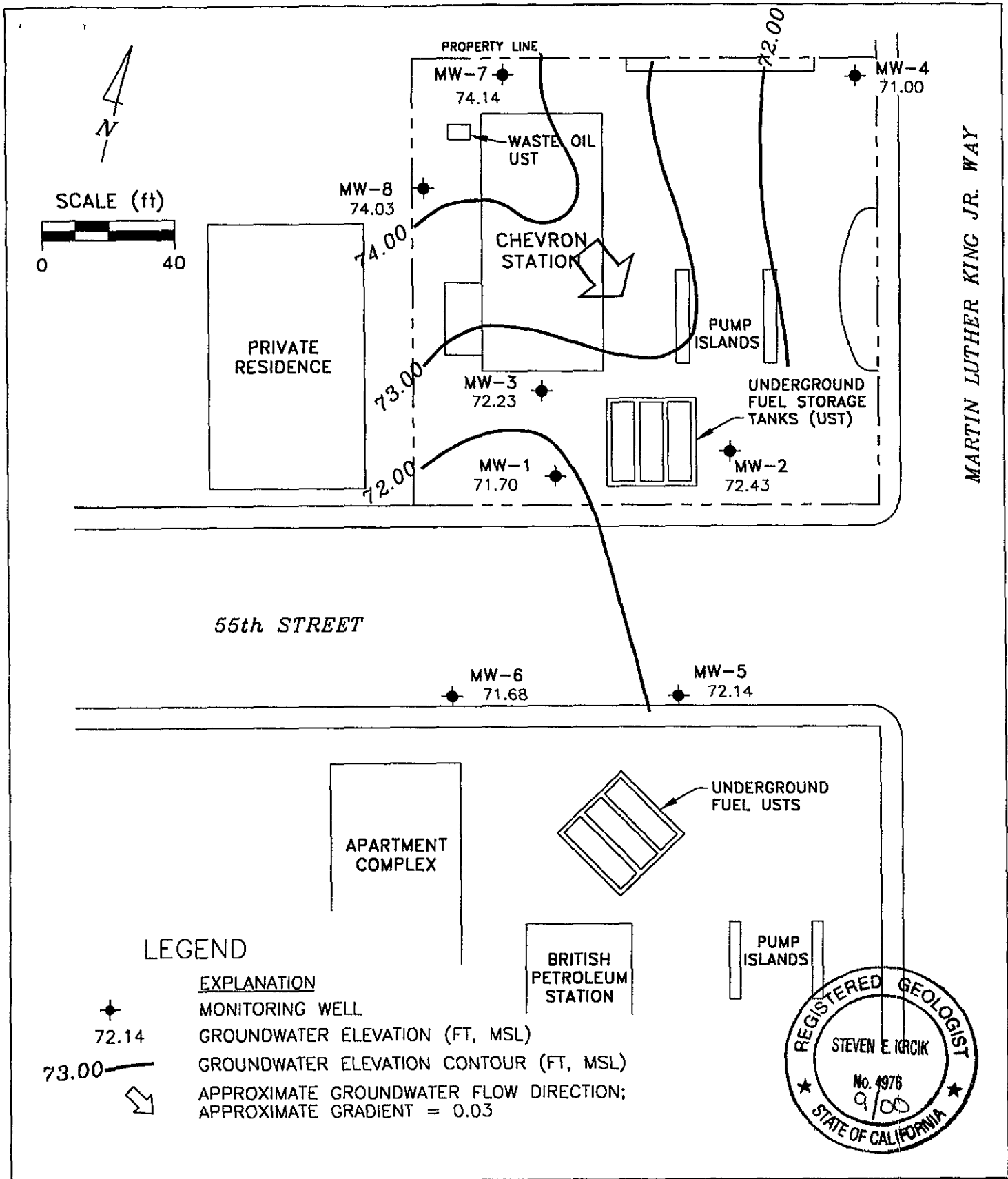

PREPARED BY

**RRM**

engineering contracting firm

**Chevron Station 9-1583**  
5509 Martin Luther King Jr. Way  
Oakland, California

**GROUNDWATER ELEVATION CONTOUR MAP,**  
OCTOBER 2, 1998

FIGURE:  
1  
PROJECT:  
DAC04

# **Table of Well Data and Analytical Results**

## Cumulative Table of Well Data and Analytical Results

Vertical Measurements are in feet.

Analytical results are in parts per billion (ppb)

DATE	Well Head Elev.	Ground Water Elev.	Depth To Water	Notes	TPH-Gasoline	Benzene	Toluene	Ethyl-Benzene	Xylene	MTBE	TPH-Diesel	TPH-Motor Oil	Total Oil & Grease
<b>MW-1</b>													
12/22/83	81.97	71.72	10.25	--	--	--	--	--	--	--	--	--	--
12/30/83	81.97	72.80	9.17	--	--	--	--	--	--	--	--	--	--
03/12/90	81.97	71.89	10.08	--	50,000	3000	7300	1900	18,000	--	--	--	--
03/25/90	82.42	71.51	10.46	--	--	--	--	--	--	--	--	--	--
10/18/90	82.42	--	--	--	--	--	--	--	--	--	--	--	--
10/31/90	82.42	--	--	--	--	--	--	--	--	--	--	--	--
11/16/90	82.42	70.84	11.58	--	--	--	--	--	--	--	--	--	--
02/08/91	82.42	72.31	10.11	--	100,000	4200	8400	16,000	2600	--	--	--	--
05/08/91	82.42	71.97	10.45	--	31,000	200	66	670	2000	--	--	--	--
08/12/91	82.42	71.19	11.23	--	17,000	81	7.2	270	710	--	--	--	--
11/07/91	82.42	71.72	10.70	--	7100	24	6.0	130	170	--	--	--	--
02/05/92	82.42	72.05	10.37	--	110,000	8900	14,000	2700	12,000	--	--	--	--
05/13/92	82.42	71.84	10.58	--	19,000	450	85	480	870	--	--	--	--
07/17/92	82.42	71.37	11.05	--	8500	170	<10	360	600	--	--	--	--
10/05/92	82.42	71.01	11.41	--	22,000	4300	5100	570	2900	--	--	--	--
11/11/92	82.42	--	--	--	--	--	--	--	--	--	--	--	--
11/17/92	82.42	--	--	--	--	--	--	--	--	--	--	--	--
11/24/92	82.42	--	--	--	--	--	--	--	--	--	--	--	--
12/01/92	82.42	--	--	--	--	--	--	--	--	--	--	--	--
12/29/92	82.42	--	--	--	--	--	--	--	--	--	--	--	--
01/05/93	82.42	--	--	--	--	--	--	--	--	--	--	--	--
01/08/93	82.42	74.31	8.11	--	14,000,000	12,000	79,000	270,000	1,300,000	--	--	--	--
02/02/93	82.42	--	--	--	--	--	--	--	--	--	--	--	--
04/14/93	82.42	72.57	9.85	--	48,000	670	1100	1600	6300	--	--	--	--
08/06/93	82.42	71.59	10.83	--	44,000	660	990	1600	6100	--	--	--	--
10/21/93	82.42	71.52	10.90	--	18,000	270	460	1300	4700	--	--	--	--
01/05/94	82.42	72.09	10.33	--	22,000	160	160	630	2300	--	--	--	--
04/08/94	82.42	72.24	10.18	--	21,000	37	110	570	1400	--	--	--	--
07/06/94	82.42	71.78	10.64	--	28,000	210	100	540	1200	--	--	--	--
08/04/94	82.42	71.91	10.51	--	--	--	--	--	--	--	--	--	--
10/05/94	82.42	71.51	10.91	--	120,000	39	22	320	900	--	--	--	--

CONTINUED ON NEXT PAGE



## Cumulative Table of Well Data and Analytical Results

Vertical Measurements are in feet.

Analytical results are in parts per billion (ppb)

DATE	Well Head Elev.	Ground Water Elev.	Depth To Water	Notes	TPH-Gasoline	Benzene	Toluene	Ethyl-Benzene	Xylene	MTBE	TPH-Diesel	TPH-Motor Oil	Total Oil & Grease
<b>MW-1 (CONT'D)</b>													
01/18/95	82.42	73.80	8.62	--	12,000	<20	<20	130	160	--	--	--	--
04/07/95	82.42	72.89	9.53	--	2500	<2.5	<2.5	71	38	--	--	--	--
07/06/95	82.42	72.03	10.39	--	5700	<0.5	<0.5	110	110	--	--	--	--
10/11/95	82.42	70.54	11.88	--	2700	13	<5.0	13	5.7	650	--	--	--
01/17/96	82.42	73.14	9.28	--	4200	12	<5.0	43	24	300	--	--	--
04/05/96	82.42	72.82	9.60	--	1300	<1.2	<1.2	7.6	2.8	220	--	--	--
07/23/96	82.42	72.19	10.23	--	700	<1.0	<1.0	7.0	4.8	240	--	--	--
10/02/96	82.42	71.67	10.75	--	1700	<2.5	9.8	10	13	610	--	--	--
01/23/97	82.42	74.75	7.67	--	1300	21	<1.0	<1.0	<1.0	2700	--	--	--
04/01/97	82.42	72.22	10.20	--	670	<2.0	<2.0	4.1	3.6	1200	--	--	--
07/09/97	82.42	72.12	10.30	--	460	<1.0	<1.0	<1.0	<1.0	440	--	--	--
10/07/97	82.42	71.73	10.69	--	1100	8.5	<2.0	<2.0	2.0	250	--	--	--
01/22/98	82.42	74.20	8.22	--	460	1.4	5.8	<0.5	<0.5	150	--	--	--
04/02/98	82.42	72.89	9.53	--	220	2.5	1.2	<1.0	1.9	260	--	--	--
07/02/98	82.42	72.08	10.34	--	270	<0.5	0.82	<0.5	<0.5	140	--	--	--
10/02/98	82.42	71.70	10.72	--	170	1.3	<0.5	<0.5	<1.5	320	--	--	--

## Cumulative Table of Well Data and Analytical Results

Vertical Measurements are in feet.

Analytical results are in parts per billion (ppb)

DATE	Well Head Elev.	Ground Water Elev.	Depth To Water	Notes	TPH-Gasoline	Benzene	Toluene	Ethyl-Benzene	Xylene	MTBE	TPH-Diesel	TPH-Motor Oil	Total Oil & Grease
<b>MW-2</b>													
12/22/83	83.48	72.98	10.50	--	--	--	--	--	--	--	--	--	--
12/30/83	83.48	73.56	9.92	--	--	--	--	--	--	--	--	--	--
03/12/90	83.48	72.46	11.02	--	800	400	22	18	55	--	--	--	--
03/25/90	83.48	72.15	11.33	--	--	--	--	--	--	--	--	--	--
10/18/90	83.48	71.17	12.31	--	--	--	--	--	--	--	--	--	--
10/31/90	83.48	--	--	--	--	--	--	--	--	--	--	--	--
11/16/90	83.48	--	--	--	--	--	--	--	--	--	--	--	--
02/08/91	83.48	72.43	11.05	--	4600	820	440	720	210	--	--	--	--
05/08/91	83.48	72.12	11.36	--	<50	5.0	<0.5	<0.5	<0.5	--	--	--	--
08/12/91	83.48	71.51	11.97	--	<50	<0.5	<0.5	<0.5	<0.5	--	--	--	--
11/07/91	83.48	71.98	11.50	--	<50	<0.5	<0.5	<0.5	<0.5	--	--	--	--
02/05/92	83.48	72.29	11.19	--	1700	390	170	60	200	--	--	--	--
05/13/92	83.48	71.99	11.49	--	74	9.3	<0.5	<0.5	<0.5	--	--	--	--
07/17/92	83.48	71.63	11.85	--	<50	2.0	<0.5	<0.5	<0.5	--	--	--	--
10/05/92	83.48	71.48	12.00	--	3500	1200	530	86	220	--	--	--	--
11/11/92	83.48	--	--	--	--	--	--	--	--	--	--	--	--
11/17/92	83.48	--	--	--	--	--	--	--	--	--	--	--	--
11/24/92	83.48	--	--	--	--	--	--	--	--	--	--	--	--
12/01/92	83.48	--	--	--	--	--	--	--	--	--	--	--	--
12/29/92	83.48	--	--	--	--	--	--	--	--	--	--	--	--
01/05/93	83.48	--	--	--	--	--	--	--	--	--	--	--	--
01/08/93	83.48	74.65	8.83	--	390	140	0.8	7.7	26	--	--	--	--
02/02/93	83.48	--	--	--	--	--	--	--	--	--	--	--	--
04/14/93	83.48	72.69	10.79	--	<50	5.0	<0.5	<0.5	<0.5	--	--	--	--
08/06/93	83.48	71.77	11.71	--	<50	1.0	<0.5	<0.5	<0.5	--	--	--	--
10/21/93	83.48	71.74	11.74	--	<50	1.0	<0.5	9.0	<0.5	--	--	--	--
01/05/94	83.48	72.30	11.18	--	<50	0.7	<0.5	<0.5	0.9	--	--	--	--
04/08/94	83.48	72.42	11.06	--	<50	<0.5	<0.5	<0.5	<0.5	--	--	--	--
07/06/94	83.48	71.80	11.68	--	<50	<0.5	<0.5	<0.5	<0.5	--	--	--	--
08/04/94	83.48	72.29	11.19	--	--	--	--	--	--	--	--	--	--
10/05/94	83.48	71.79	11.69	--	<50	<0.5	<0.5	<0.5	<0.5	--	--	--	--

CONTINUED ON NEXT PAGE

## Cumulative Table of Well Data and Analytical Results

Vertical Measurements are in feet.

Analytical results are in parts per billion (ppb)

DATE	Well Head Elev.	Ground Water Elev.	Depth To Water	Notes	TPH-Gasoline	Benzene	Toluene	Ethyl-Benzene	Xylene	MTBE	TPH-Diesel	TPH-Motor Oil	Total Oil & Grease
<b>MW-2 (CONT'D)</b>													
01/18/95	83.48	74.26	9.22	--	<50	<0.5	<0.5	<0.5	<0.5	--	--	--	--
04/07/95	83.48	73.62	9.86	--	<50	<0.5	<0.5	<0.5	<0.5	--	--	--	--
07/06/95	83.48	72.74	10.74	--	<50	<0.5	<0.5	<0.5	<0.5	--	--	--	--
10/11/95	83.48	72.26	11.22	--	<50	<0.5	<0.5	<0.5	<0.5	<2.5	--	--	--
01/17/96	83.48	73.74	9.74	--	<50	<0.5	<0.5	<0.5	<0.5	<2.5	--	--	--
04/05/96	83.48	73.52	9.96	--	<50	<0.5	<0.5	<0.5	<0.5	<2.5	--	--	--
07/23/96	83.48	72.57	10.91	--	<50	<0.5	<0.5	<0.5	<0.5	<2.5	--	--	--
10/02/96	83.48	72.41	11.07	--	<50	<0.5	<0.5	<0.5	<0.5	<2.5	--	--	--
01/23/97	83.48	75.18	8.30	--	<50	<0.5	<0.5	<0.5	<0.5	3.4	--	--	--
04/01/97	83.48	72.90	10.58	--	<50	<0.5	<0.5	<0.5	<0.5	<2.5	--	--	--
07/09/97	83.48	72.58	10.90	--	<50	<0.5	<0.5	<0.5	<0.5	<2.5	--	--	--
10/07/97	83.48	72.52	10.96	--	<50	<0.5	<0.5	<0.5	<0.5	<2.5	--	--	--
01/22/98	83.48	74.73	8.75	--	<50	<0.5	<0.5	<0.5	<0.5	<2.5	--	--	--
04/02/98	83.48	73.66	9.82	--	89	3.0	5.4	4.1	21	<2.5	--	--	--
07/02/98	83.48	72.74	10.74	--	<50	<0.5	<0.5	<0.5	<0.5	<2.5	--	--	--
10/02/98	83.48	72.43	11.05	--	<50	<0.5	<0.5	<0.5	<1.5	<2.5	--	--	--

## Cumulative Table of Well Data and Analytical Results

Vertical Measurements are in feet.

Analytical results are in parts per billion (ppb)

DATE	Well Head Elev.	Ground Water Elev.	Depth To Water	Notes	TPH-Gasoline	Benzene	Toluene	Ethyl-Benzene	Xylene	MTBE	TPH-Diesel	TPH-Motor Oil	Total Oil & Grease
<b>MW-3</b>													
12/22/83	84.36	72.78	11.58	--	--	--	--	--	--	--	--	--	--
12/30/83	84.36	73.19	11.17	--	--	--	--	--	--	--	--	--	--
03/12/90	84.36	72.22	12.14	--	47,000	1000	9900	1700	9800	--	--	--	--
03/25/90	84.38	71.81	12.55	--	--	--	--	--	--	--	--	--	--
10/18/90	84.38	--	--	--	--	--	--	--	--	--	--	--	--
10/31/90	84.38	--	--	--	--	--	--	--	--	--	--	--	--
11/16/90	84.38	70.76	13.62	--	--	--	--	--	--	--	--	--	--
02/08/91	84.38	72.20	12.18	--	58,000	4900	5200	9500	2000	--	--	--	--
05/08/91	84.38	71.86	12.52	--	50,000	2100	1400	2000	9400	--	--	--	--
08/12/91	84.38	71.11	13.27	--	15,000	1300	160	920	1900	--	--	--	--
11/07/91	84.38	71.57	12.81	--	26,000	1000	310	1900	5900	--	--	--	--
02/05/92	84.38	71.91	12.47	--	35,000	2800	1300	1500	4700	--	--	--	--
05/13/92	84.38	71.76	12.62	--	47,000	1500	1200	1100	4800	--	--	--	--
07/17/92	84.38	71.25	13.13	--	15,000	120	11	88	140	--	--	--	--
10/05/92	84.38	70.95	13.62	Free Product (0.24')	--	--	--	--	--	--	--	--	--
11/11/92	84.38	71.63	12.89	Free Product (0.17')	--	--	--	--	--	--	--	--	--
11/17/92	84.38	71.54	12.89	Free Product (0.06')	--	--	--	--	--	--	--	--	--
11/24/92	84.38	71.56	12.86	Free Product (0.05')	--	--	--	--	--	--	--	--	--
12/01/92	84.38	71.48	12.92	Free Product (0.03')	--	--	--	--	--	--	--	--	--
12/29/92	84.38	73.14	11.24	Sheen	--	--	--	--	--	--	--	--	--
01/05/93	84.38	73.23	11.15	Sheen	--	--	--	--	--	--	--	--	--
01/08/93	84.38	74.28	10.10	--	250,000	5000	17,000	5500	28,000	--	--	--	--
02/02/93	84.38	--	--	--	--	--	--	--	--	--	--	--	--
04/14/93	84.38	72.48	11.91	Free Product (0.01')	--	--	--	--	--	--	--	--	--
08/06/93	84.38	71.48	12.90	Free Product (0.01')	150,000	3800	6600	3700	17,000	--	--	--	--
10/21/93	84.38	71.41	12.97	--	22,000	2300	1700	1400	5100	--	--	--	--
01/05/94	84.38	71.96	12.42	--	37,000	1600	1100	1300	6500	--	--	--	--
04/08/94	84.38	72.51	11.87	--	16,000	250	310	500	2500	--	--	--	--
07/06/94	84.38	71.64	12.74	--	43,000	660	320	1900	6400	--	--	--	--
08/04/94	84.38	71.71	12.67	--	--	--	--	--	--	--	--	--	--
10/05/94	84.38	71.43	12.95	--	12,000	280	90	480	370	--	--	--	--

CONTINUED ON NEXT PAGE

## Cumulative Table of Well Data and Analytical Results

Vertical Measurements are in feet.

Analytical results are in parts per billion (ppb)

DATE	Well Head Elev.	Ground Water Elev.	Depth To Water	Notes	TPH-Gasoline	Benzene	Toluene	Ethyl-Benzene	Xylene	MTBE	TPH-Diesel	TPH-Motor Oil	Total Oil & Grease
<b>MW-3 (CONT'D)</b>													
01/18/95	84.38	73.72	10.66	--	20,000	200	230	700	3500	--	--	--	--
04/07/95	84.38	72.84	11.54	--	22,000	120	120	810	4400	--	--	--	--
07/06/95	84.38	71.99	12.39	--	15,000	110	<50	630	2100	--	--	--	--
10/11/95	84.38	72.07	12.31	--	8600	24	<10	360	560	1100	--	--	--
01/17/96	84.38	73.68	10.70	--	9300	<50	<50	230	1100	2300	--	--	--
04/05/96	84.38	73.35	11.03	--	8700	16	<10	110	650	990	--	--	--
07/23/96	84.38	72.38	12.00	--	5400	20	<5.0	190	480	2300	--	--	--
10/02/96	84.38	72.20	12.18	--	6200	43	<20	130	140	2800	--	--	--
01/23/97	84.38	75.12	9.26	--	5600	<5.0	<5.0	39	160	550	--	--	--
04/01/97	84.38	72.75	11.63	--	6900	17	<10	150	330	3900	--	--	--
07/09/97	84.38	72.38	12.00	--	5300	31	<5.0	100	180	2300	--	--	--
10/07/97	84.38	72.27	12.11	--	2400	15	<2.0	30	15	900	--	--	--
01/22/98	84.38	74.73	9.65	--	3200	2.5	7.9	70	220	660	--	--	--
04/02/98	84.38	73.49	10.89	--	1300	14	9.7	25	63	430	--	--	--
07/02/98	84.38	72.69	11.69	--	750	6.9	<5.0	18	9.1	370	--	--	--
10/02/98	84.38	72.23	12.15	--	1400	5.3	0.73	18	6.6	900	--	--	--

## Cumulative Table of Well Data and Analytical Results

Vertical Measurements are in feet.

Analytical results are in parts per billion (ppb)

DATE	Well Head Elev.	Ground Water Elev.	Depth To Water	Notes	TPH-Gasoline	Benzene	Toluene	Ethyl-Benzene	Xylene	MTBE	TPH-Diesel	TPH-Motor Oil	Total Oil & Grease
<b>MW-4</b>													
10/18/90	84.25	68.50	15.75	--	--	--	--	--	--	--	--	--	--
10/31/90	84.25	70.35	13.90	--	<50	<0.5	<0.5	<0.5	1.0	--	--	--	--
11/16/90	84.25	70.00	14.25	--	--	--	--	--	--	--	--	--	--
02/08/91	84.25	71.93	12.32	--	60	17	2.0	12	<0.5	--	--	--	--
05/08/91	84.25	72.02	12.23	--	65	<0.5	<0.5	<0.5	<0.5	--	--	--	--
08/12/91	84.25	70.32	13.93	--	<50	<0.5	<0.5	<0.5	<0.5	--	--	--	--
11/07/91	84.25	70.83	13.42	--	<50	<0.5	<0.5	<0.5	<0.5	--	--	--	--
02/05/92	84.25	71.42	12.83	--	<50	<0.5	<0.5	<0.5	<0.5	--	--	--	--
05/13/92	84.25	70.97	13.28	--	<50	<0.5	<0.5	<0.5	<0.5	--	--	--	--
07/17/92	84.25	70.27	13.98	--	<50	<0.5	<0.5	<0.5	<0.5	--	--	--	--
10/05/92	84.25	70.02	14.23	--	<50	<0.5	<0.5	<0.5	<0.5	--	--	--	--
11/11/92	84.25	--	--	--	--	--	--	--	--	--	--	--	--
11/17/92	84.25	--	--	--	--	--	--	--	--	--	--	--	--
11/24/92	84.25	--	--	--	--	--	--	--	--	--	--	--	--
12/01/92	84.25	--	--	--	--	--	--	--	--	--	--	--	--
12/29/92	84.25	--	--	--	--	--	--	--	--	--	--	--	--
01/05/93	84.25	--	--	--	--	--	--	--	--	--	--	--	--
01/08/93	84.25	74.09	10.16	--	<50	<0.5	<0.5	<0.5	<0.5	--	--	--	--
02/02/93	84.25	--	--	--	--	--	--	--	--	--	--	--	--
04/14/93	84.25	72.21	12.04	--	<50	<0.5	<0.5	<0.5	<0.5	--	--	--	--
08/06/93	84.25	70.34	13.91	--	<50	<0.5	<0.5	<0.5	<0.5	--	--	--	--
10/21/93	84.25	70.26	13.99	--	<50	<0.5	<0.5	<0.5	1.0	--	--	--	--
01/05/94	84.25	71.30	12.95	--	<50	<0.5	<0.5	<0.5	<0.5	--	--	--	--
04/08/94	84.25	71.31	12.94	--	<50	<0.5	<0.5	<0.5	<0.5	--	--	--	--
07/06/94	84.25	70.57	13.68	--	<50	<0.5	<0.5	<0.5	<0.5	--	--	--	--
08/04/94	84.25	70.71	13.54	--	--	--	--	--	--	--	--	--	--
10/05/94	84.25	70.65	13.60	--	<50	<0.5	<0.5	<0.5	<0.5	--	--	--	--
01/18/95	84.25	74.77	9.48	--	<50	<0.5	<0.5	<0.5	<0.5	--	--	--	--
04/07/95	84.25	72.70	11.55	--	<50	<0.5	<0.5	<0.5	<0.5	--	--	--	--
07/06/95	84.25	71.25	13.00	--	<50	<0.5	<0.5	<0.5	<0.5	--	--	--	--
10/11/95	84.25	70.27	13.98	--	<50	<0.5	<0.5	<0.5	<0.5	<2.5	--	--	--
01/17/96	84.25	73.17	11.08	--	<50	<0.5	<0.5	<0.5	<0.5	<2.5	--	--	--
04/05/96	84.25	72.65	11.60	--	<50	<0.5	<0.5	<0.5	<0.5	<2.5	--	--	--
07/23/96	84.25	70.86	13.39	--	<50	<0.5	<0.5	<0.5	<0.5	<2.5	--	--	--

CONTINUED ON NEXT PAGE

## Cumulative Table of Well Data and Analytical Results

Vertical Measurements are in feet.

Analytical results are in parts per billion (ppb)

DATE	Well Head Elev.	Ground Water Elev.	Depth To Water	Notes	TPH-Gasoline	Benzene	Toluene	Ethyl-Benzene	Xylene	MTBE	TPH-Diesel	TPH-Motor Oil	Total Oil & Grease
<b>MW-4 (CONT'D)</b>													
10/02/96	84.25	70.27	13.98	--	<50	<0.5	<0.5	<0.5	<0.5	<2.5	--	--	--
01/23/97	84.25	74.72	9.53	--	<50	<0.5	<0.5	<0.5	<0.5	<2.5	--	--	--
04/01/97	84.25	71.68	12.57	--	<50	<0.5	<0.5	<0.5	<0.5	<2.5	--	--	--
07/09/97	84.25	70.64	13.61	--	<50	<0.5	<0.5	<0.5	<0.5	<2.5	--	--	--
10/07/97	84.25	70.51	13.74	--	<50	<0.5	<0.5	<0.5	<0.5	<2.5	--	--	--
01/22/98	84.25	74.90	9.35	--	<50	<0.5	<0.5	<0.5	<0.5	<2.5	--	--	--
04/02/98	84.25	73.00	11.25	--	<50	<0.5	<0.5	<0.5	<0.5	<2.5	--	--	--
07/02/98	84.25	71.84	12.41	--	<50	<0.5	<0.5	<0.5	<0.5	<2.5	--	--	--
10/02/98	84.25	71.00	13.25	--	<50	<0.5	<0.5	<0.5	<1.5	<2.5	--	--	--

## Cumulative Table of Well Data and Analytical Results

Vertical Measurements are in feet.

Analytical results are in parts per billion (ppb)

DATE	Well Head Elev.	Ground Water Elev.	Depth To Water	Notes	TPH-Gasoline	Benzene	Toluene	Ethyl-Benzene	Xylene	MTBE	TPH-Diesel	TPH-Motor Oil	Total Oil & Grease
<b>MW-5</b>													
10/18/90	81.95	71.17	10.78	--	--	--	--	--	--	--	--	--	--
10/31/90	81.95	71.32	10.63	--	110	<0.5	<0.5	<0.5	<0.5	--	--	--	--
11/16/90	81.95	71.27	10.68	--	--	--	--	--	--	--	--	--	--
02/08/91	81.95	72.78	9.17	--	<50	<0.5	<0.5	<0.5	<0.5	--	--	--	--
05/08/91	81.95	73.27	8.68	--	<50	<0.5	<0.5	<0.5	<0.5	--	--	--	--
08/12/91	81.95	71.62	10.33	--	<50	<0.5	<0.5	<0.5	<0.5	--	--	--	--
11/07/91	81.95	72.19	9.76	--	<50	<0.5	<0.5	<0.5	<0.5	--	--	--	--
02/05/92	81.95	72.48	9.47	--	69	<0.5	<0.5	<0.5	<0.5	--	--	--	--
05/13/92	81.95	72.25	9.70	--	74	<0.5	<0.5	<0.5	<0.5	--	--	--	--
07/17/92	81.95	71.74	10.21	--	880	2.6	<1.2	4.6	11	--	--	--	--
10/05/92	81.95	71.34	10.61	--	120	<0.5	<0.5	0.6	4.9	--	--	--	--
11/11/92	81.95	--	--	--	--	--	--	--	--	--	--	--	--
11/17/92	81.95	--	--	--	--	--	--	--	--	--	--	--	--
11/24/92	81.95	--	--	--	--	--	--	--	--	--	--	--	--
12/01/92	81.95	--	--	--	--	--	--	--	--	--	--	--	--
12/29/92	81.95	--	--	--	--	--	--	--	--	--	--	--	--
01/05/93	81.95	--	--	--	--	--	--	--	--	--	--	--	--
01/08/93	81.95	74.61	7.34	--	61	<0.5	<0.5	<0.5	<0.5	--	--	--	--
02/02/93	81.95	--	--	--	--	--	--	--	--	--	--	--	--
04/14/93	81.95	--	--	--	--	--	--	--	--	--	--	--	--
08/06/93	81.95	71.99	9.96	--	<50	<0.5	<0.5	<0.5	<0.5	--	--	--	--
10/21/93	81.95	71.89	10.06	--	<50	<0.5	<0.5	2.0	4.0	--	--	--	--
01/05/94	81.95	72.52	9.43	--	<50	<0.5	<0.5	<0.5	<0.5	--	--	--	--
04/08/94	81.95	72.56	9.39	--	<50	<0.5	<0.5	<0.5	<0.5	--	--	--	--
07/06/94	81.95	72.19	9.76	--	<50	0.6	<0.5	<0.5	<0.5	--	--	--	--
08/04/94	81.95	72.13	9.82	--	--	--	--	--	--	--	--	--	--
10/05/94	81.95	71.89	10.06	--	<50	<0.5	<0.5	<0.5	<0.5	--	--	--	--
01/18/95	81.95	--	--	Inaccessible	--	--	--	--	--	--	--	--	--
04/07/95	81.95	73.31	8.64	--	<50	<0.5	<0.5	<0.5	<0.5	--	--	--	--
07/06/95	81.95	72.52	9.43	--	<50	<0.5	<0.5	<0.5	<0.5	--	--	--	--
10/11/95	81.95	72.12	9.83	--	<50	<0.5	<0.5	<0.5	<0.5	<2.5	--	--	--
01/17/96	81.95	73.63	8.32	--	<50	<0.5	<0.5	<0.5	<0.5	<2.5	--	--	--
04/05/96	81.95	73.23	8.72	--	<50	<0.5	<0.5	<0.5	<0.5	<2.5	--	--	--
07/23/96	81.95	72.25	9.70	--	<50	<0.5	<0.5	<0.5	<0.5	<2.5	--	--	--

CONTINUED ON NEXT PAGE



## Cumulative Table of Well Data and Analytical Results

Vertical Measurements are in feet.

Analytical results are in parts per billion (ppb)

DATE	Well Head Elev.	Ground Water Elev.	Depth To Water	Notes	TPH-Gasoline	Benzene	Toluene	Ethyl-Benzene	Xylene	MTBE	TPH-Diesel	TPH-Motor Oil	Total Oil & Grease
<b>MW-5 (CONT'D)</b>													
10/02/96	81.95	72.06	9.89	--	<50	<0.5	<0.5	<0.5	<0.5	<2.5	--	--	--
01/23/97	81.95	74.72	7.23	--	<50	<0.5	<0.5	<0.5	<0.5	<2.5	--	--	--
04/01/97	81.95	--	--	Inaccessible	--	--	--	--	--	--	--	--	--
07/09/97	81.95	72.27	9.68	--	<50	<0.5	<0.5	<0.5	<0.5	<2.5	--	--	--
10/07/97	81.95	72.14	9.81	--	<50	<0.5	<0.5	<0.5	<0.5	<2.5	--	--	--
01/22/98	81.95	74.80	7.15	--	<50	<0.5	<0.5	<0.5	<0.5	<2.5	--	--	--
04/02/98	81.95	--	--	Inaccessible	--	--	--	--	--	--	--	--	--
07/02/98	81.95	72.43	9.52	--	<50	<0.5	<0.5	<0.5	<0.5	<2.5	--	--	--
10/02/98	81.95	72.14	9.81	--	<50	<0.5	<0.5	<0.5	<1.5	<2.5	--	--	--

## Cumulative Table of Well Data and Analytical Results

Vertical Measurements are in feet.

Analytical results are in parts per billion (ppb)

DATE	Well Head Elev.	Ground Water Elev.	Depth To Water	Notes	TPH-Gasoline	Benzene	Toluene	Ethyl-Benzene	Xylene	MTBE	TPH-Diesel	TPH-Motor Oil	Total Oil & Grease
<b>MW-6</b>													
10/18/90	80.60	70.81	9.79	--	--	--	--	--	--	--	--	--	--
10/31/90	80.60	70.91	9.69	--	<50	<0.5	<0.5	<0.5	3.0	--	--	--	--
11/16/90	80.60	70.86	9.74	--	--	--	--	--	--	--	--	--	--
02/08/91	80.60	--	--	--	--	--	--	--	--	--	--	--	--
05/08/91	80.60	71.06	9.54	--	56	<0.5	<0.5	<0.5	<0.5	--	--	--	--
08/12/91	80.60	71.10	9.50	--	<50	<0.5	<0.5	<0.5	<0.5	--	--	--	--
11/07/91	80.60	71.71	8.89	--	<50	<0.5	<0.5	<0.5	<0.5	--	--	--	--
02/05/92	80.60	72.01	8.59	--	<50	<0.5	<0.5	<0.5	<0.5	--	--	--	--
05/13/92	80.60	--	--	--	--	--	--	--	--	--	--	--	--
07/17/92	80.60	--	--	--	--	--	--	--	--	--	--	--	--
10/05/92	80.60	--	--	--	--	--	--	--	--	--	--	--	--
11/11/92	80.60	--	--	--	--	--	--	--	--	--	--	--	--
11/17/92	80.60	--	--	--	--	--	--	--	--	--	--	--	--
11/24/92	80.60	--	--	--	--	--	--	--	--	--	--	--	--
12/01/92	80.60	--	--	--	--	--	--	--	--	--	--	--	--
12/29/92	80.60	--	--	--	--	--	--	--	--	--	--	--	--
01/05/93	80.60	--	--	--	--	--	--	--	--	--	--	--	--
01/08/93	80.60	--	--	--	--	--	--	--	--	--	--	--	--
02/02/93	80.60	72.89	7.71	--	<50	2.1	<0.5	<0.5	2.2	--	--	--	--
04/14/93	80.60	72.41	8.19	--	<50	1.0	<0.5	<0.5	<0.5	--	--	--	--
08/06/93	80.60	71.52	9.08	--	<50	<0.5	<0.5	<0.5	<0.5	--	--	--	--
10/21/93	80.60	71.46	9.14	--	<50	<0.5	<0.5	<0.5	<0.5	--	--	--	--
01/05/94	80.60	72.06	8.54	--	<50	4.0	<0.5	<0.5	<0.5	--	--	--	--
04/08/94	80.60	--	--	--	--	--	--	--	--	--	--	--	--
07/06/94	80.60	--	--	Inaccessible	--	--	--	--	--	--	--	--	--
08/04/94	80.60	71.66	8.94	--	<50	<0.5	<0.5	<0.5	<0.5	--	--	--	--
10/05/94	80.60	--	--	Inaccessible	--	--	--	--	--	--	--	--	--
01/18/95	80.60	73.50	7.10	--	<50	0.69	<0.5	<0.5	0.57	--	--	--	--
04/07/95	80.60	72.77	7.83	--	<50	1.8	<0.5	<0.5	<0.5	--	--	--	--
07/06/95	80.60	72.03	8.57	--	<50	<0.5	<0.5	<0.5	<0.5	--	--	--	--
10/11/95	80.60	71.54	9.06	--	<125	<1.2	<1.2	<1.2	<1.2	540	--	--	--
01/17/96	80.60	73.20	7.40	--	<50	<0.5	<0.5	<0.5	<0.5	180	--	--	--
04/05/96	80.60	72.70	7.90	--	<125	1.4	<1.2	<1.2	<1.2	700	--	--	--
07/23/96	80.60	71.86	8.74	--	<500	<5.0	<5.0	<5.0	<5.0	540	--	--	--

CONTINUED ON NEXT PAGE

## Cumulative Table of Well Data and Analytical Results

Vertical Measurements are in feet.

Analytical results are in parts per billion (ppb)

DATE	Well Head Elev.	Ground Water Elev.	Depth To Water	Notes	TPH-Gasoline	Benzene	Toluene	Ethyl-Benzene	Xylene	MTBE	TPH-Diesel	TPH-Motor Oil	Total Oil & Grease
<b>MW-6 (CONT'D)</b>													
10/02/96	80.60	71.62	8.98	--	<100	<1.0	<1.0	<1.0	1.8	910	--	--	--
01/23/97	80.60	--	--	Inaccessible	--	--	--	--	--	--	--	--	--
04/01/97	80.60	72.22	8.38	--	<250	<2.5	<2.5	<2.5	<2.5	640	--	--	--
07/09/97	80.60	--	--	Inaccessible	--	--	--	--	--	--	--	--	--
10/07/97	80.60	71.71	8.89	--	<50	<0.5	<0.5	<0.5	<0.5	640	--	--	--
01/22/98	80.60	73.90	6.70	--	<50	<0.5	<0.5	<0.5	<0.5	200	--	--	--
04/02/98	80.60	72.79	7.81	--	<250	<2.5	<2.5	<2.5	<2.5	480	--	--	--
07/02/98	80.60	71.62	8.98	--	<50	<0.5	<0.5	<0.5	<0.5	420	--	--	--
10/02/98	80.60	71.68	8.92	--	<50	<0.5	<0.5	<0.5	<1.5	270	--	--	--

## Cumulative Table of Well Data and Analytical Results

Vertical Measurements are in feet.

Analytical results are in parts per billion (ppb)

DATE	Well Head Elev.	Ground Water Elev.	Depth To Water	Notes	TPH-Gasoline	Benzene	Toluene	Ethyl-Benzene	Xylene	MTBE	TPH-Diesel	TPH-Motor Oil	Total Oil & Grease
<b>MW-7</b>													
03/08/94	86.36	74.99	11.37	--	1200	440	31	73	200	--	<10	4100	--
07/06/94	86.36	--	--	--	--	--	--	--	--	--	--	--	--
08/04/94	86.36	73.86	12.50	--	120	15	<0.5	3.8	1.8	--	--	--	--
10/05/94	86.36	73.99	12.37	--	150	1.2	<0.5	1.2	1.7	--	--	--	--
01/18/95	86.36	74.82	11.54	--	260	11	<1.0	17	6.8	--	--	--	--
04/07/95	86.36	75.63	10.73	--	230	<0.5	<0.5	25	0.93	--	--	--	--
07/06/95	86.36	74.36	12.00	--	320	<1.0	<1.0	<1.0	<1.0	--	--	--	6900
10/11/95	86.36	73.56	12.80	--	<50	<0.5	<0.5	<0.5	<0.5	120	--	2300*	--
01/17/96	86.36	75.90	10.46	--	<50	<0.5	<0.5	<0.5	<0.5	460	--	1700	--
04/05/96	86.36	76.56	9.80	--	130	<0.5	<0.5	<0.5	<0.5	120	--	590	--
07/23/96	86.36	74.57	11.79	--	<500	<5.0	<5.0	<5.0	<0.5	1200	--	820	--
10/02/96	86.36	73.10	13.26	--	<100	<1.0	<1.0	<1.0	<1.0	360	--	1500	--
01/23/97	86.36	77.64	8.72	--	<100	<1.0	<1.0	<1.0	<1.0	490	--	<500	--
04/01/97	86.36	75.09	11.27	--	<250	<2.5	<2.5	<2.5	<2.5	1200	--	1600	--
07/09/97	86.36	73.92	12.44	--	<250	5.9	<2.5	<2.5	<2.5	1200	--	5700	--
10/07/97	86.36	73.44	12.92	--	<50	<0.5	<0.5	<0.5	<0.5	240	--	<500	--
01/22/98	86.36	75.14	11.22	--	<50	<0.5	<0.5	<0.5	<0.5	400	--	<500	--
04/02/98	86.36	75.67	10.69	--	56	<0.5	<0.5	<0.5	<0.5	290	--	<500	--
07/02/98	86.36	75.94	10.42	--	<50	<0.5	<0.5	<0.5	<0.5	380	--	<500	--
10/02/98	86.36	74.14	12.22	--	<50	<0.5	<0.5	<0.5	<1.5	660	--	1700	--

\* Chromatogram pattern indicates an unidentified hydrocarbon.

## Cumulative Table of Well Data and Analytical Results

Vertical Measurements are in feet.

DATE	Well Head Elev.	Ground Water Elev.	Depth To Water	Notes	TPH-Gasoline	Benzene	Toluene	Ethyl-Benzene	Xylene	MTBE	TPH-Diesel	TPH-Motor Oil	Total Oil & Grease
<b>MW-8</b>													
03/08/94	85.93	75.06	10.87	--	28,000	2900	1300	1200	6800	--	<10	<100	--
07/06/94	85.93	--	--	--	--	--	--	--	--	--	--	--	--
08/04/94	85.93	73.77	12.16	--	22,000	3000	260	870	4400	--	--	--	--
10/05/94	85.93	72.71	13.22	--	12,000	1800	34	4.6	890	--	--	--	--
01/18/95	85.93	75.51	10.42	--	19,000	1000	65	1100	3500	--	--	--	--
04/07/95	85.93	75.48	10.45	--	14,000	310	<25	720	1700	--	--	--	--
07/06/95	85.93	74.30	11.63	--	19,000	280	<50	1200	2600	--	--	--	--
10/11/95	85.93	73.51	12.42	--	6100	140	5.5	320	280	1200	--	--	--
01/17/96	85.93	75.95	9.98	--	12,000	86	<20	590	1400	1100	--	<500	--
04/05/96	85.93	75.60	10.33	--	7500	180	23	410	480	560	--	<500	--
07/23/96	85.93	74.56	11.37	--	3800	47	<5.0	350	84	1800	--	<500	--
10/02/96	85.93	73.90	12.03	--	4400	65	<5.0	140	28	1500	--	<500	--
01/23/97	85.93	77.73	8.20	--	3800	36	5.9	140	36	910	--	<500	--
04/01/97	85.93	75.80	10.13	--	6100	43	<20	380	76	1800	--	<500	--
07/09/97	85.93	73.77	12.16	--	7300	48	<25	120	<25	2400	--	<500	--
10/07/97	85.93	73.77	12.16	--	3100	<10	<10	67	<10	1400	--	<500	--
01/22/98	85.93	75.83	10.10	--	1900	5.5	8.3	120	17	780	--	<500	--
04/02/98	85.93	75.55	10.38	--	2900	43	19	110	<10	800	--	<500	--
07/02/98	85.93	74.78	11.15	--	5000	31	<10	120	15	780	--	<500	--
10/02/98	85.93	74.03	11.90	--	2200	6.5	<0.5	21	2.6	140	--	1200*	--

\* Chromatogram pattern indicates an unidentified hydrocarbon.

## Cumulative Table of Well Data and Analytical Results

Vertical Measurements are in feet.

DATE	Well Head Elev.	Ground Water Elev.	Depth To Water	Notes	TPH-Gasoline	Benzene	Toluene	Ethyl-Benzene	Xylene	MTBE	TPH-Diesel	TPH-Motor Oil	Total Oil & Grease
<b>TRIP BLANK</b>													
03/12/90	--	--	--	--	<50	<0.3	<0.3	<0.3	<0.6	--	--	--	--
02/08/91	--	--	--	--	<50	<0.5	<0.5	<0.5	<0.5	--	--	--	--
05/08/91	--	--	--	--	<50	<0.5	<0.5	<0.5	<0.5	--	--	--	--
08/12/91	--	--	--	--	<50	<0.5	<0.5	<0.5	<0.5	--	--	--	--
11/07/91	--	--	--	--	<50	<0.5	<0.5	<0.5	<0.5	--	--	--	--
02/05/92	--	--	--	--	<50	<0.5	<0.5	<0.5	<0.5	--	--	--	--
05/13/92	--	--	--	--	<50	<0.5	<0.5	<0.5	<0.5	--	--	--	--
07/17/92	--	--	--	--	<50	<0.5	<0.5	<0.5	<0.5	--	--	--	--
10/05/92	--	--	--	--	<50	<0.5	<0.5	<0.5	<0.5	--	--	--	--
11/11/92	--	--	--	--	--	--	--	--	--	--	--	--	--
11/17/92	--	--	--	--	--	--	--	--	--	--	--	--	--
11/29/92	--	--	--	--	--	--	--	--	--	--	--	--	--
12/01/92	--	--	--	--	--	--	--	--	--	--	--	--	--
12/29/92	--	--	--	--	--	--	--	--	--	--	--	--	--
01/05/93	--	--	--	--	--	--	--	--	--	--	--	--	--
01/08/93	--	--	--	--	<50	<0.5	<0.5	<0.5	<0.5	--	--	--	--
02/02/93	--	--	--	--	--	--	--	--	--	--	--	--	--
04/14/93	--	--	--	--	<50	<0.5	<0.5	<0.5	<0.5	--	--	--	--
08/06/93	--	--	--	--	<50	<0.5	<0.5	<0.5	<0.5	--	--	--	--
10/21/93	--	--	--	--	<50	<0.5	<0.5	<0.5	<0.5	--	--	--	--
01/05/94	--	--	--	--	<50	<0.5	<0.5	<0.5	<0.5	--	--	--	--
04/08/94	--	--	--	--	<50	<0.5	<0.5	<0.5	<0.5	--	--	--	--
07/06/94	--	--	--	--	<50	<0.5	<0.5	<0.5	<0.5	--	--	--	--
08/04/94	--	--	--	--	<50	<0.5	<0.5	<0.5	<0.5	--	--	--	--
10/05/94	--	--	--	--	<50	<0.5	<0.5	<0.5	<0.5	--	--	--	--
01/18/95	--	--	--	--	<50	<0.5	<0.5	<0.5	<0.5	--	--	--	--
04/07/95	--	--	--	--	<50	<0.5	<0.5	<0.5	<0.5	--	--	--	--
07/06/95	--	--	--	--	<50	<0.5	<0.5	<0.5	<0.5	--	--	--	--
10/11/95	--	--	--	--	<50	<0.5	<0.5	<0.5	<0.5	--	--	--	--
01/17/96	--	--	--	--	<50	<0.5	<0.5	<0.5	<0.5	<2.5	--	--	--
04/05/96	--	--	--	--	<50	<0.5	<0.5	<0.5	<0.5	<2.5	--	--	--
07/23/96	--	--	--	--	<50	<0.5	<0.5	<0.5	<0.5	<2.5	--	--	--
10/02/96	--	--	--	--	<50	<0.5	<0.5	<0.5	<0.5	--	--	--	--

CONTINUED ON NEXT PAGE

## Cumulative Table of Well Data and Analytical Results

Vertical Measurements are in feet.

Analytical results are in parts per billion (ppb)

DATE	Well Head Elev.	Ground Water Elev.	Depth To Water	Notes	TPH-Gasoline	Benzene	Toluene	Ethyl-Benzene	Xylene	MTBE	TPH-Diesel	TPH-Motor Oil	Total Oil & Grease
<b>TRIP BLANK (CONT'D)</b>													
01/23/97	--	--	--	--	<50	<0.5	<0.5	<0.5	<0.5	<2.5	--	--	--
04/01/97	--	--	--	--	<50	<0.5	<0.5	<0.5	<0.5	<2.5	--	--	--
07/09/97	--	--	--	--	<50	<0.5	<0.5	<0.5	<0.5	<2.5	--	--	--
10/07/97	--	--	--	--	<50	<0.5	<0.5	<0.5	<0.5	<2.5	--	--	--
01/22/98	--	--	--	--	<50	<0.5	<0.5	<0.5	<0.5	<2.5	--	--	--
04/02/98	--	--	--	--	<50	<0.5	<0.5	<0.5	<0.5	<2.5	--	--	--
07/02/98	--	--	--	--	<50	<0.5	<0.5	<0.5	<0.5	<2.5	--	--	--
10/02/98	--	--	--	--	<50	<0.5	<0.5	<0.5	<1.5	<2.5	--	--	--

Note: Blaine Tech Services, Inc. began routine monitoring of the groundwater wells at this site on November 1, 1994.  
 Earlier field data and analytical results are drawn from the November 23, 1994 Groundwater Technology, Inc. report.

**ABBREVIATIONS:**

TPH = Total Petroleum Hydrocarbons

MTBE = Methyl t-Butyl Ether

# **Analytical Appendix**





Blaine Tech Services 1680 Rogers Avenue San Jose, CA 95112	Client Proj. ID: Chevron 9-1583/981002-Z2 Sample Descript: MW-1 Matrix: LIQUID Analysis Method: 8015Mod/8020 Lab Number: 9810375-01	Sampled: 10/02/98 Received: 10/05/98 Analyzed: 10/10/98 Reported: 10/21/98
Attention: Fran Thie		

**Total Purgeable Petroleum Hydrocarbons (TPPH) with BTEX and MTBE**

Analyte	Detection Limit ug/L	Sample Results ug/L
TPPH as Gas	50	170
Methyl t-Butyl Ether	25	320
Benzene	0.50	1.3
Toluene	0.50	N.D.
Ethyl Benzene	0.50	N.D.
Xylenes (Total)	1.5	N.D.
Chromatogram Pattern: Unidentified HC		C6-C12
<b>Surrogates</b>	<b>Control Limits %</b>	<b>% Recovery</b>
Trifluorotoluene	70 130	93

Analytes reported as N.D. were not present above the stated limit of detection.

**SEQUOIA ANALYTICAL** - ELAP #1849

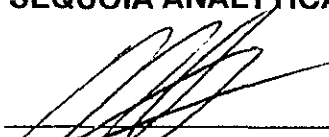
  
Mike Gregory  
Project Manager



Blaine Tech Services  
1680 Rogers Avenue  
San Jose, CA 95112  
  
Attention: Fran Thie

Client Proj. ID: Chevron 9-1583/981002-Z2  
Sample Descript: MW-2  
Matrix: LIQUID  
Analysis Method: 8015Mod/8020  
Lab Number: 9810375-02

Sampled: 10/02/98  
Received: 10/05/98  
  
Analyzed: 10/10/98  
Reported: 10/21/98

**Total Purgeable Petroleum Hydrocarbons (TPPH) with BTEX and MTBE**

Analyte	Detection Limit ug/L	Sample Results ug/L
TPPH as Gas	50	N.D.
Methyl t-Butyl Ether	2.5	N.D.
Benzene	0.50	N.D.
Toluene	0.50	N.D.
Ethyl Benzene	0.50	N.D.
Xylenes (Total)	1.5	N.D.
Chromatogram Pattern:		
<b>Surrogates</b>	<b>Control Limits %</b>	<b>% Recovery</b>
Trifluorotoluene	70 130	87

Analytes reported as N.D. were not present above the stated limit of detection.

**SEQUOIA ANALYTICAL - ELAP #1849**

  
Mike Gregory  
Project Manager



Blaine Tech Services  
1680 Rogers Avenue  
San Jose, CA 95112

Attention: Fran Thie

Client Proj. ID: Chevron 9-1583/981002-Z2  
Sample Descript: MW-3  
Matrix: LIQUID  
Analysis Method: 8015Mod/8020  
Lab Number: 9810375-03

Sampled: 10/02/98  
Received: 10/05/98  
Analyzed: 10/10/98  
Reported: 10/21/98

**Total Purgeable Petroleum Hydrocarbons (TPPH) with BTEX and MTBE**

Analyte	Detection Limit ug/L	Sample Results ug/L
TPPH as Gas	50	1400
Methyl t-Butyl Ether	10	900
Benzene	0.50	5.3
Toluene	0.50	0.73
Ethyl Benzene	0.50	18
Xylenes (Total)	1.5	6.6
Chromatogram Pattern:		GAS

Surrogates	Control Limits %	% Recovery
Trifluorotoluene	70	130
		73

Analytes reported as N.D. were not present above the stated limit of detection.

**SEQUOIA ANALYTICAL** - ELAP #1849

  
\_\_\_\_\_  
Mike Gregory  
Project Manager

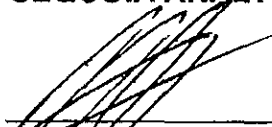

Blaine Tech Services 1680 Rogers Avenue San Jose, CA 95112	Client Proj. ID: Chevron 9-1583/981002-Z2 Sample Descript: MW-4 Matrix: LIQUID Analysis Method: 8015Mod/8020 Lab Number: 9810375-04	Sampled: 10/02/98 Received: 10/05/98 Analyzed: 10/10/98 Reported: 10/21/98
Attention: Fran Thie		

**Total Purgeable Petroleum Hydrocarbons (TPPH) with BTEX and MTBE**

Analyte	Detection Limit ug/L	Sample Results ug/L
TPPH as Gas	50	N.D.
Methyl t-Butyl Ether	2.5	N.D.
Benzene	0.50	N.D.
Toluene	0.50	N.D.
Ethyl Benzene	0.50	N.D.
Xylenes (Total)	1.5	N.D.
Chromatogram Pattern:		
<b>Surrogates</b>	<b>Control Limits %</b>	<b>% Recovery</b>
Trifluorotoluene	70 130	80

Analytes reported as N.D. were not present above the stated limit of detection.

**SEQUOIA ANALYTICAL** - ELAP #1849

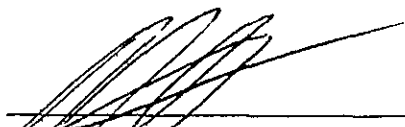
  
 \_\_\_\_\_  
 Mike Gregory  
 Project Manager



Blaine Tech Services 1680 Rogers Avenue San Jose, CA 95112	Client Proj. ID: Chevron 9-1583/981002-Z2 Sample Descript: MW-5 Matrix: LIQUID Analysis Method: 8015Mod/8020 Lab Number: 9810375-05	Sampled: 10/02/98 Received: 10/05/98 Analyzed: 10/10/98 Reported: 10/21/98
Attention: Fran Thie		

**Total Purgeable Petroleum Hydrocarbons (TPPH) with BTEX and MTBE**

Analyte	Detection Limit ug/L	Sample Results ug/L
TPPH as Gas	50	N.D.
Methyl t-Butyl Ether	2.5	N.D.
Benzene	0.50	N.D.
Toluene	0.50	N.D.
Ethyl Benzene	0.50	N.D.
Xylenes (Total)	1.5	N.D.
Chromatogram Pattern:		
<b>Surrogates</b>	<b>Control Limits %</b>	<b>% Recovery</b>
Trifluorotoluene	70 130	90

Analytes reported as N.D. were not present above the stated limit of detection.

**SEQUOIA ANALYTICAL** - ELAP #1849

  
\_\_\_\_\_  
Mike Gregory  
Project Manager



Blaine Tech Services 1680 Rogers Avenue San Jose, CA 95112	Client Proj. ID: Chevron 9-1583/981002-Z2 Sample Descript: MW-6 Matrix: LIQUID Analysis Method: 8015Mod/8020 Lab Number: 9810375-06	Sampled: 10/02/98 Received: 10/05/98 Analyzed: 10/10/98 Reported: 10/21/98
Attention: Fran Thie		

**Total Purgeable Petroleum Hydrocarbons (TPPH) with BTEX and MTBE**

Analyte	Detection Limit ug/L	Sample Results ug/L
TPPH as Gas	50	N.D.
<b>Methyl t-Butyl Ether</b>	<b>2.5</b>	<b>270</b>
Benzene	0.50	N.D.
Toluene	0.50	N.D.
Ethyl Benzene	0.50	N.D.
Xylenes (Total)	1.5	N.D.
Chromatogram Pattern:		
<b>Surrogates</b>	<b>Control Limits %</b>	<b>% Recovery</b>
Trifluorotoluene	70                      130	97

Analytes reported as N.D. were not present above the stated limit of detection.

**SEQUOIA ANALYTICAL - ELAP #1849**

Mike Gregory  
Project Manager



**Sequoia  
Analytical**

680 Chesapeake Drive  
404 N. Wiget Lane  
819 Striker Avenue, Suite 8  
1455 McDowell Blvd, North, Ste. D

Redwood City, CA 94063  
Walnut Creek, CA 94598  
Sacramento, CA 95834  
Petaluma, CA 94954

(650) 364-9600  
(925) 988-9600  
(916) 921-9600  
(707) 792-1865

FAX (650) 364-9233  
FAX (925) 988-9673  
FAX (916) 921-0100  
FAX (707) 792-0342

Blaine Tech Services  
1680 Rogers Avenue  
San Jose, CA 95112

Client Proj. ID: Chevron 9-1583/981002-Z2  
Sample Descript: MW-7  
Matrix: LIQUID  
Analysis Method: 8015Mod/8020  
Lab Number: 9810375-07

Sampled: 10/02/98  
Received: 10/05/98  
Analyzed: 10/10/98  
Reported: 10/21/98

Attention: Fran Thie

**Total Purgeable Petroleum Hydrocarbons (TPPH) with BTEX and MTBE**

Analyte	Detection Limit ug/L	Sample Results ug/L
TPPH as Gas	50	N.D.
<b>Methyl t-Butyl Ether</b>	<b>50</b>	<b>660</b>
Benzene	0.50	N.D.
Toluene	0.50	N.D.
Ethyl Benzene	0.50	N.D.
Xylenes (Total)	1.5	N.D.
Chromatogram Pattern:		
<b>Surrogates</b>	<b>Control Limits %</b>	<b>% Recovery</b>
Trifluorotoluene	70 130	97

Analytes reported as N.D. were not present above the stated limit of detection.

**SEQUOIA ANALYTICAL** - ELAP #1849

  
Mike Gregory  
Project Manager



Blaine Tech Services 1680 Rogers Avenue San Jose, CA 95112	Client Proj. ID: Chevron 9-1583/981002-Z2 Sample Descript: MW-7 Matrix: LIQUID Analysis Method: EPA 8015 Mod Lab Number: 9810375-07	Sampled: 10/02/98 Received: 10/05/98 Extracted: 10/13/98 Analyzed: 10/16/98 Reported: 10/21/98
--	---	--

QC Batch Number: GC1013980HBPEXA  
Instrument ID: GCHP5A

**Fuel Fingerprint : Motor Oil**

Analyte	Detection Limit ug/L	Sample Results ug/L
Extractable HC as Motor Oil Chromatogram Pattern:	500 C16-C36	1700 Motor Oil
Surrogates n-Pentacosane (C25)	Control Limits % 50                      150	% Recovery 145

Analytes reported as N.D. were not present above the stated limit of detection.

**SEQUOIA ANALYTICAL** - ELAP #1210

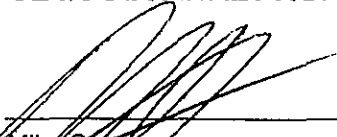
  
 \_\_\_\_\_  
 Mike Gregory  
 Project Manager





Blaine Tech Services 1680 Rogers Avenue San Jose, CA 95112	Client Proj. ID: Chevron 9-1583/981002-Z2 Sample Descript: MW-8 Matrix: LIQUID Analysis Method: 8015Mod/8020 Lab Number: 9810375-08	Sampled: 10/02/98 Received: 10/05/98  Analyzed: 10/10/98 Reported: 10/21/98
Attention: Fran Thie		

**Total Purgeable Petroleum Hydrocarbons (TPPH) with BTEX and MTBE**

Analyte	Detection Limit ug/L	Sample Results ug/L
TPPH as Gas	50	2200
Methyl t-Butyl Ether	2.5	140
Benzene	0.50	6.5
Toluene	0.50	N.D.
Ethyl Benzene	0.50	21
Xylenes (Total)	1.5	2.6
Chromatogram Pattern:		GAS

Surrogates	Control Limits %	% Recovery
Trifluorotoluene	70 130	70

Analytes reported as N.D. were not present above the stated limit of detection.

**SEQUOIA ANALYTICAL** - ELAP #1849

  
\_\_\_\_\_  
Mike Gregory  
Project Manager

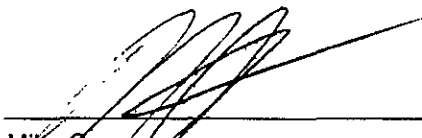

Blaine Tech Services 1680 Rogers Avenue San Jose, CA 95112	Client Proj. ID: Chevron 9-1583/981002-Z2 Sample Descript: MW-8 Matrix: LIQUID Analysis Method: EPA 8015 Mod Lab Number: 9810375-08	Sampled: 10/02/98 Received: 10/05/98 Extracted: 10/13/98 Analyzed: 10/16/98 Reported: 10/21/98
--	---	--

QC Batch Number: GC1013980HBPEXA  
Instrument ID: GCHP5A

**Fuel Fingerprint : Motor Oil**

Analyte	Detection Limit ug/L	Sample Results ug/L
Extractable HC as Motor Oil	500	1200
Chromatogram Pattern: Unidentified HC		C16-C36
<b>Surrogates</b>	<b>Control Limits %</b>	<b>% Recovery</b>
n-Pentacosane (C25)	50                      150	136

Analytes reported as N.D. were not present above the stated limit of detection.

**SEQUOIA ANALYTICAL** - ELAP #1210

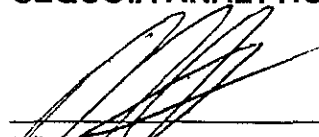
  
 \_\_\_\_\_  
 Mike Gregory  
 Project Manager



Blaine Tech Services 1680 Rogers Avenue San Jose, CA 95112  Attention: Fran Thie	Client Proj. ID: Chevron 9-1583/981002-Z2 Sample Descript: TB Matrix: LIQUID Analysis Method: 8015Mod/8020 Lab Number: 9810375-09	Sampled: 10/02/98 Received: 10/05/98  Analyzed: 10/10/98 Reported: 10/21/98
--	---	---

**Total Purgeable Petroleum Hydrocarbons (TPPH) with BTEX and MTBE**

Analyte	Detection Limit ug/L	Sample Results ug/L
TPPH as Gas	50	N.D.
Methyl t-Butyl Ether	2.5	N.D.
Benzene	0.50	N.D.
Toluene	0.50	N.D.
Ethyl Benzene	0.50	N.D.
Xylenes (Total)	1.5	N.D.
Chromatogram Pattern:		
<b>Surrogates</b>	<b>Control Limits %</b>	<b>% Recovery</b>
Trifluorotoluene	70 130	97

Analytes reported as N.D. were not present above the stated limit of detection.

**SEQUOIA ANALYTICAL - ELAP #1849**

Mike Gregory  
Project Manager



**Sequoia  
Analytical**

680 Chesapeake Drive  
404 N. Wiget Lane  
819 Striker Avenue, Suite 8  
1455 McDowell Blvd. North, Ste. D

Redwood City, CA 94063  
Walnut Creek, CA 94598  
Sacramento, CA 95834  
Petaluma, CA 94954

(650) 364-9600  
(925) 988-9600  
(916) 921-9600  
(707) 792-1865

FAX (650) 364-9233  
FAX (925) 988-9673  
FAX (916) 921-0100  
FAX (707) 792-0342

Blaine Tech Services  
1680 Rogers Avenue  
San Jose, CA 95112  
Attention: Fran Thie

Client Proj. ID: Chevron 9-1583/981002-Z2  
Lab Proj. ID: 9810375

Received: 10/05/98  
Reported: 10/21/98

### LABORATORY NARRATIVE

In order to properly interpret this report, it must be reproduced in its entirety. This report contains a total of 17 pages including the laboratory narrative, sample results, quality control, and related documents as required (cover page, COC, raw data, etc.).

**SEQUOIA ANALYTICAL**

  
\_\_\_\_\_  
Mike Gregory  
Project Manager



**Sequoia  
Analytical**

680 Chesapeake Drive  
404 N. Wiget Lane  
819 Striker Avenue, Suite 8  
1455 McDowell Blvd. North, Ste. D

Redwood City, CA 94063  
Walnut Creek, CA 94598  
Sacramento, CA 95834  
Petaluma, CA 94954

(650) 364-9600  
(925) 988-9600  
(916) 921-9600  
(707) 792-1865

FAX (650) 364-9233  
FAX (925) 988-9673  
FAX (916) 921-0100  
FAX (707) 792-0342

Blaine Tech Services  
1680 Rogers Avenue  
San Jose, CA 95112  
Attention: Fran Thie

Client Project ID: Chevron 9-1583/981002-Z2

QC Sample Group: 9810375-7,8

Reported: Oct 21, 1998

**QUALITY CONTROL DATA REPORT**

Matrix: Liquid  
Method: EPA 8015A  
Analyst: G.WARDLE

**ANALYTE Diesel**

QC Batch #: GC1013980HBPEXA

LCS ID: BLK101398AS

Date Prepared: 10/13/98

Date Analyzed: 10/13/98

Instrument I.D.#: GCHP4B

Conc. Spiked, ug/L: 1000

Blank Spike, ug/L: 680  
% Recovery: 68

Blank  
Spike Duplicate, ug/L: 750  
% Recovery: 75

Relative % Difference: 9.8

% Recovery  
Control Limits: 50-150

RPD Control Limits: 0-50

Quality Assurance Statement: All standard operating procedures and quality control requirements have been met.

SEQUOIA ANALYTICAL

Mike Gregory  
Project Manager

Please Note:

The LCS is a control sample of known, interferent free matrix that is analyzed using the same reagents, preparation, and analytical methods employed for the samples. The matrix spike is an aliquot of sample fortified with known quantities of specific compounds and subjected to the entire analytical procedure. If the recovery of analytes from the matrix spike does not fall within specified control limits due to matrix interference, the LCS recovery is to be used to validate the batch.



# Sequoia Analytical

680 Chesapeake Drive  
404 N. Wiget Lane  
819 Striker Avenue, Suite 8  
1455 McDowell Blvd. North, Ste. D

Redwood City, CA 94063  
Walnut Creek, CA 94598  
Sacramento, CA 95834  
Petaluma, CA 94954

(650) 364-9600  
(925) 988-9600  
(916) 921-9600  
(707) 792-1865

FAX (650) 364-9233  
FAX (925) 988-9673  
FAX (916) 921-0100  
FAX (707) 792-0342

Blaine Tech Services, Inc.  
1680 Rogers Ave.  
San Jose, CA 95112  
Attention: Fran Thie

Client Project ID: Chevron 9-1583/981002-Z2  
Matrix: Liquid

Work Order #: 9810375 -01-09

Reported: Oct 22, 1998

## QUALITY CONTROL DATA REPORT

Analyte:	Benzene	Toluene	Ethyl Benzene	Xylenes
QC Batch#:	10V8151	10V8151	10V8151	10V8151
Analy. Method:	EPA 8020	EPA 8020	EPA 8020	EPA 8020
Prep. Method:	EPA 8015M	EPA 8015M	EPA 8015M	EPA 8015M

Analyst:	L. Hall	L. Hall	L. Hall	L. Hall
LCS/LCSD #:	8100076	8100076	8100076	8100076
Sample Conc.:	N.D.	N.D.	N.D.	N.D.
Prepared Date:	10/10/98	10/10/98	10/10/98	10/10/98
Analyzed Date:	10/10/98	10/10/98	10/10/98	10/10/98
Instrument I.D.#:	-	-	-	-
Conc. Spiked:	20 µg/L	20 µg/L	20 µg/L	60 µg/L
Result:	19	19	20	58
LCS % Recovery:	95	95	100	97
Dup. Result:	21	21	21	63
LCSD % Recov.:	110	110	110	110
RPD:	10	10	4.9	8.3
RPD Limit:	0-30	0-30	0-30	0-30

MS/MSD	80-120	80-120	80-120	80-120
LCS				
Control Limits				

SEQUOIA ANALYTICAL  
Elap #1849

Mike Gregory  
Project Manager

**Please Note:**

The LCS is a control sample of known, interferent-free matrix that is analyzed using the same reagents, preparation, and analytical methods employed for the samples. The matrix spike is an aliquot of sample fortified with known quantities of specific compounds and subjected to the entire analytical procedure. If the recovery of analytes from the matrix spike does not fall within specified control limits due to matrix interference, the LCS recovery is to be used to validate the batch.

\*\* MS=Matrix Spike, MSD=MS Duplicate, RPD=Relative % Difference

9810375.BLA <1>

Chevron U.S.A. Inc. P.O. BOX 5004 San Ramon, CA 94583 FAX (415)842-9591	Chevron Facility Number <u>9-1583</u> Facility Address <u>5509 Martin Luther King Jr. Way, Oakland, CA</u> Consultant Project Number <u>98002-22</u> Consultant Name <u>Blaine Tech Services, Inc.</u> Address <u>1680 Rogers Ave., San Jose, CA 95112</u> Project Contact (Name) <u>Fran Thie</u> (Phone) <u>(408)573-0555</u> (Fax Number) <u>(408)573-7771</u>	Chevron Contact (Name) <u>Phil Briggs</u> (Phone) <u>(510) 842-9136</u> Laboratory Name <u>Sequoia</u> Laboratory Release Number <u>9034796</u> Samples Collected by (Name) <u>Jerry</u> Collection Date <u>10-2-98</u> Signature <u>[Signature]</u>
--	---	--

Sample Number	Lab Sample Number	Number of Containers	Matrix S = Soil W = Water A = Air C = Charcoal	Type G = Grab C = Composite D = Discrete	Time	Sample Preservation	Iced (Yes or No)	Analytes To Be Performed										Remarks	
								BTEX + TPH G-S (8020 + 8015) <u>MTBE</u>	TPH Diesel (8015)	Oil and Grease (5520)	Purgeable Halocarbons (8010)	Purgeable Aromatics (8020)	Purgeable Organics (8240)	Extractable Organics (8270)	Metals Cd, Cr, Pb, Zn, Ni (ICAP or AA)	Motor Oil	9810375		DO NOT BILL FOR TB-LB
MW-1	01	3	W	D	1425	ICC	Y	X											
MW-2	02	3			1345			X											
MW-3	03	3			1505			X											
MW-4	04	3			1322			X											
MW-5	05	3			1305			X											
MW-6	06	3			1443			X											8 4 12 52
MW-7	07	5			1403			X											
MW-8	08	5			1520			X											
TB	09	2	W	D	-			X											

Relinquished By (Signature) <u>[Signature]</u>	Organization <u>BTB</u>	Date/Time <u>10/5/98 10:40</u>	Received By (Signature) <u>[Signature]</u>	Organization <u>Sequoia</u>	Date/Time <u>10-5 10:40</u>	Turn Around Time (Circle Choice) 24 Hrs. 48 Hrs. 5 Days 10 Days <u>As Contracted</u>
Relinquished By (Signature) <u>[Signature]</u>	Organization <u>Sequoia</u>	Date/Time <u>10-5</u>	Received By (Signature) <u>[Signature]</u>	Organization	Date/Time	
Relinquished By (Signature) <u>[Signature]</u>	Organization	Date/Time	Received For Laboratory By (Signature) <u>[Signature]</u>	Date/Time <u>10/5/98 1252</u>		

HWG/03 91/HCH

# **Field Data Sheets**





# CHEVRON WELL MONITORING DATA SHEET

Project #: 981002-22	Station #: 9-1583
Sampler: JR	Date: 10-2-98
Well I.D.: MW-1	Well Diameter: 2 (3) 4 6 8
Total Well Depth: 19.80	Depth to Water: 10.72
Depth to Free Product:	Thickness of Free Product (feet):
Referenced to: PVC Grade	D.O. Meter (if req'd): YSI HACH

Well Diameter	Multiplier	Well Diameter	Multiplier
2"	0.16	5"	1.02
3"	0.37	6"	1.47
4"	0.65	Other	radius <sup>2</sup> * 0.163

Purge Method: Bailer      Sampling Method: Bailer

Disposable Bailer       Disposable Bailer

Middleburg      Extraction Port

Electric Submersible      Other: \_\_\_\_\_

Extraction Pump

Other: \_\_\_\_\_

3.4	x	3	=	10.2	Gals.
1 Case Volume (Gals.)		Specified Volumes		Calculated Volume	

Time	Temp (°F)	pH	Cond.	Gals. Removed	Observations
1412	67.4	7.1	410	3.5	-odor
1417	66.6	7.1	400	7	-cloudy
1421	66.4	7.1	400	10.5	

Did well dewater?    Yes     No    Gallons actually evacuated: 10.5

Sampling Time: 1425    Sampling Date: 10-2-98

Sample I.D.: MW-1    Laboratory: Sequoia GTEL N. Creek Assoc. Labs

Analyzed for: TPH-G BTEX MTBE TPH-D Other:

Duplicate I.D.:    Analyzed for: TPH-G BTEX MTBE TPH-D Other:

D.O. (if req'd):	Pre-purge:	mg/L	Post-purge:	mg/L
O.R.P. (if req'd):	Pre-purge:	mV	Post-purge:	mV

# CHEVRON WELL MONITORING DATA SHEET

Project #: 981002-22	Station #: 9-1583
Sampler: JR	Date: 10-2-98
Well I.D.: MW-2	Well Diameter: 2 (3) 4 6 8
Total Well Depth: 18.78	Depth to Water: 11.05
Depth to Free Product:	Thickness of Free Product (feet):
Referenced to: PVC Grade	D.O. Meter (if req'd): YSI HACH

Well Diameter	Multiplier	Well Diameter	Multiplier
2"	0.16	5"	1.02
3"	0.37	6"	1.47
4"	0.65	Other	radius <sup>2</sup> * 0.163

Purge Method: Bailer      Sampling Method: Bailer  
 Disposable Bailer       Disposable Bailer   
 Middleburg      Extraction Port  
 Electric Submersible      Other: \_\_\_\_\_  
 Extraction Pump  
 Other: \_\_\_\_\_

2.9	x	3	=	8.7	Gals.
1 Case Volume (Gals.)		Specified Volumes		Calculated Volume	

Time	Temp (°F)	pH	Cond.	Gals. Removed	Observations
1330	72.6	7.4	380	3	clear
1335	72.4	7.4	400	6	cloudy
1340	72.4	7.4	400	9	

Did well dewater?    Yes     No    Gallons actually evacuated: 9

Sampling Time: 1345    Sampling Date: 10-2-98

Sample I.D.: MW-2    Laboratory: Sequoia GTEL N. Creek Assoc. Labs

Analyzed for:  TPH-G     BTEX     MTBE     TPH-D    Other: \_\_\_\_\_

Duplicate I.D.:    Analyzed for: TPH-G    BTEX    MTBE    TPH-D    Other: \_\_\_\_\_

D.O. (if req'd):	Pre-purge:	mg/L	Post-purge:	mg/L
O.R.P. (if req'd):	Pre-purge:	mV	Post-purge:	mV

# CHEVRON WELL MONITORING DATA SHEET

Project #: 981002-22	Station #: 9-1583
Sampler: JR	Date: 10-2-98
Well I.D.: MW-3	Well Diameter: 2 (3) 4 6 8
Total Well Depth: 19.64	Depth to Water: 12.15
Depth to Free Product:	Thickness of Free Product (feet):
Referenced to: PVC Grade	D.O. Meter (if req'd): YSI HACH

Well Diameter	Multiplier	Well Diameter	Multiplier
2"	0.16	5"	1.02
3"	0.37	6"	1.47
4"	0.65	Other	radius <sup>2</sup> * 0.163

Purge Method:  Bailer      Sampling Method:  Bailer  
 Disposable Bailer       Disposable Bailer  
 Middleburg       Extraction Port  
 Electric Submersible      Other: \_\_\_\_\_  
 Extraction Pump  
 Other: \_\_\_\_\_

2.8	x	3	=	8.4	Gals.
1 Case Volume (Gals.)		Specified Volumes		Calculated Volume	

Time	Temp (°F)	pH	Cond.	Gals. Removed	Observations
1452	69.8	7.0	420	3	odor, grey
1456	69.6	7.2	410	6	
1500	69.2	7.2	400	9	

Did well dewater?    Yes     No    Gallons actually evacuated: 9

Sampling Time: ~~1455~~ 1505    Sampling Date: 10-2-98

Sample I.D.: MW-3    Laboratory: Sequoia GTEL N. Creek Assoc. Labs

Analyzed for:  TPH-G     BTEX     MTBE     TPH-D    Other: \_\_\_\_\_

Duplicate I.D.: \_\_\_\_\_    Analyzed for: TPH-G    BTEX    MTBE    TPH-D    Other: \_\_\_\_\_

D.O. (if req'd):	Pre-purge:	mg/L	Post-purge:	mg/L
O.R.P. (if req'd):	Pre-purge:	mV	Post-purge:	mV

# CHEVRON WELL MONITORING DATA SHEET

Project #: 981002-22	Station #: 9-1583
Sampler: JR	Date: 10-2-98
Well I.D.: MW-4	Well Diameter: 2 3 4 6 8 <input type="checkbox"/>
Total Well Depth: 25.08	Depth to Water: 13.25
Depth to Free Product:	Thickness of Free Product (feet):
Referenced to: <u>PVC</u> Grade	D.O. Meter (if req'd): YSI HACH

Well Diameter	Multiplier	Well Diameter	Multiplier
2"	0.16	5"	1.02
3"	0.37	6"	1.47
4"	0.65	Other	radius <sup>2</sup> * 0.163

Purge Method: Bailer Disposable Bailer <input checked="" type="checkbox"/> Middleburg Electric Submersible Extraction Pump Other: _____	Sampling Method: Bailer Disposable Bailer <input checked="" type="checkbox"/> Extraction Port Other: _____
--	---

1.9	x	3	=	5.7	Gals.
1 Case Volume (Gals.)		Specified Volumes		Calculated Volume	

Time	Temp (°F)	pH	Cond.	Gals. Removed	Observations
1313	67.8	7.4	450	2	Clear
1316	68.2	7.4	450	4	
1319	68.0	7.4	420	6	

Did well dewater? Yes <input type="checkbox"/> No <input checked="" type="checkbox"/>	Gallons actually evacuated: 6
Sampling Time: 1322	Sampling Date: 10-2-98
Sample I.D.: MW-4	Laboratory: <u>Sequoia</u> GTEL N. Creek Assoc. Labs
Analyzed for: <u>TPH-G</u> BTEX MTBE TPH-D Other:	
Duplicate I.D.:	Analyzed for: TPH-G BTEX MTBE TPH-D Other:
D.O. (if req'd):	Pre-purge: <input type="text"/> mg/L Post-purge: <input type="text"/> mg/L
O.R.P. (if req'd):	Pre-purge: <input type="text"/> mV Post-purge: <input type="text"/> mV

### CHEVRON WELL MONITORING DATA SHEET

Project #: 981002-22	Station #: 9-1583
Sampler: JR	Date: 10-2-98
Well I.D.: MW-5	Well Diameter: (2) 3 4 6 8
Total Well Depth: 19.83	Depth to Water: 9.81
Depth to Free Product:	Thickness of Free Product (feet):
Referenced to: (PVC) Grade	D.O. Meter (if req'd): YSI HACH

Well Diameter	Multiplier	Well Diameter	Multiplier
2"	0.16	5"	1.02
3"	0.37	6"	1.47
4"	0.65	Other	radius <sup>2</sup> * 0.163

Purge Method:

- Bailer
- Disposable Bailer
- Middleburg
- Electric Submersible
- Extraction Pump

Sampling Method:

- Bailer
- Disposable Bailer
- Extraction Port
- Other: \_\_\_\_\_

Other: \_\_\_\_\_

<u>1.6</u>	x	<u>3</u>	=	<u>4.8</u>	Gals.
I Case Volume (Gals.)		Specified Volumes		Calculated Volume	

Time	Temp (°F)	pH	Cond.	Gals. Removed	Observations
1255	69.2	7.5	500	2	
1258	68.2	7.6	420	4	-brown, cloudy
1301	68.0	7.6	400	6	

Did well dewater?

Yes

(No)

Gallons actually evacuated:

6

Sampling Time:

1305

Sampling Date:

10-2-98

Sample I.D.:

MW-5

Laboratory:

(Sequoia)

GTEL N. Creek Assoc. Labs

Analyzed for:

(TPH-G BTEX MTBE) TPH-D

Other:

Duplicate I.D.:

Analyzed for:

TPH-G BTEX MTBE TPH-D Other:

D.O. (if req'd):

Pre-purge:

mg/L

Post-purge:

mg/L

O.R.P. (if req'd):

Pre-purge:

mV

Post-purge:

mV

## CHEVRON WELL MONITORING DATA SHEET

Project #: 981002-22	Station #: 9-1583
Sampler: JR	Date: 10-2-98
Well I.D.: MW-6	Well Diameter: (2) 3 4 6 8
Total Well Depth: 19.93	Depth to Water: 8.92
Depth to Free Product:	Thickness of Free Product (feet):
Referenced to: PVC Grade	D.O. Meter (if req'd): YSI HACH

Well Diameter	Multiplier	Well Diameter	Multiplier
2"	0.16	5"	1.02
3"	0.37	6"	1.47
4"	0.65	Other	radius <sup>2</sup> * 0.163

Purge Method: Bailer      Sampling Method: Bailer

Disposable Bailer       Disposable Bailer

Middleburg      Extraction Port

Electric Submersible      Other: \_\_\_\_\_

Extraction Pump

Other: \_\_\_\_\_

1.8	x	3	=	5.4	Gals.
1 Case Volume (Gals.)		Specified Volumes		Calculated Volume	

Time	Temp (°F)	pH	Cond.	Gals. Removed	Observations
1433	66.6	6.9	420	2	odor, turbid
1436	67.0	6.8	510	4	
1439	66.8	6.8	500	6	

Did well dewater? Yes  No  Gallons actually evacuated: 6

Sampling Time: 1443      Sampling Date: 10-2-98

Sample I.D.: MW-6      Laboratory: Sequoia GTEL N. Creek Assoc. Labs

Analyzed for: TPH-G BTEX MTBE TPH-D Other: \_\_\_\_\_

Duplicate I.D.:      Analyzed for: TPH-G BTEX MTBE TPH-D Other: \_\_\_\_\_

D.O. (if req'd):	Pre-purge:	mg/L	Post-purge:	mg/L
O.R.P. (if req'd):	Pre-purge:	mV	Post-purge:	mV

# CHEVRON WELL MONITORING DATA SHEET

Project #: 981002-22	Station #: 9-1583
Sampler: JR	Date: 10-2-98
Well I.D.: MW-7	Well Diameter: (2) 3 4 6 8
Total Well Depth: 19.84	Depth to Water: 12.22
Depth to Free Product:	Thickness of Free Product (feet):
Referenced to: PVC Grade	D.O. Meter (if req'd): YSI HACH

Well Diameter	Multiplier	Well Diameter	Multiplier
2"	0.16	5"	1.02
3"	0.37	6"	1.47
4"	0.65	Other	radius <sup>2</sup> * 0.163

Purge Method: Bailer Disposable Bailer <input checked="" type="checkbox"/> Middleburg Electric Submersible Extraction Pump Other: _____	Sampling Method: Bailer Disposable Bailer <input checked="" type="checkbox"/> Extraction Port Other: _____
--	---

1.2	x	3	=	3.6	Gals.
1 Case Volume (Gals.)		Specified Volumes		Calculated Volume	

Time	Temp (°F)	pH	Cond.	Gals. Removed	Observations
1355	67.4	7.2	620	1.3	grey odor
1357	67.2	7.0	620	2.6	sheen
1359	67.0	7.0	600	4	

Did well dewater? Yes <input type="checkbox"/> No <input checked="" type="checkbox"/>	Gallons actually evacuated: 4
Sampling Time: 1403	Sampling Date: 10-2-98
Sample I.D.: MW-7	Laboratory: Sequoia GTEL N. Creek Assoc. Labs
Analyzed for: TPH-G BTEX MTBE TPH-D Other: Motor Oil	
Duplicate I.D.:	Analyzed for: TPH-G BTEX MTBE TPH-D Other:
D.O. (if req'd):	Pre-purge: <span style="float: right;">mg/L</span> Post-purge: <span style="float: right;">mg/L</span>
O.R.P. (if req'd):	Pre-purge: <span style="float: right;">mV</span> Post-purge: <span style="float: right;">mV</span>



# CHEVRON WELL MONITORING DATA SHEET

Project #: 981002-22	Station #: 9-1583
Sampler: JR	Date: 10-2-98
Well I.D.: MW-8	Well Diameter: (2) 3 4 6 8
Total Well Depth: 19.40	Depth to Water: 11.90
Depth to Free Product:	Thickness of Free Product (feet):
Referenced to: PVC Grade	D.O. Meter (if req'd): YSI HACH

Well Diameter	Multiplier	Well Diameter	Multiplier
2"	0.16	5"	1.02
3"	0.37	6"	1.47
4"	0.65	Other	radius <sup>2</sup> * 0.163

Purge Method: Bailer Disposable Bailer <input checked="" type="checkbox"/> Middleburg Electric Submersible Extraction Pump Other: _____	Sampling Method: Bailer Disposable Bailer <input checked="" type="checkbox"/> Extraction Port Other: _____
--	---

1.2	x	3	=	3.6	Gals.
1 Case Volume (Gals.)		Specified Volumes		Calculated Volume	

Time	Temp (°F)	pH	Cond.	Gals. Removed	Observations
1512	68.2	7.1	500	1.3	odor, grey, cloudy
1514	68.2	7.2	540	2.6	
1516	68.4	7.2	520	4	

Did well dewater? Yes <input type="checkbox"/> No <input checked="" type="checkbox"/>	Gallons actually evacuated: 4
Sampling Time: 1520	Sampling Date: 10-2-98
Sample I.D.: MW-8	Laboratory: Sequoia GTEL N. Creek Assoc. Labs
Analyzed for: TPH-G BTEX MTBE TPH-D	Other: Motor Oil
Duplicate I.D.:	Analyzed for: TPH-G BTEX MTBE TPH-D Other:
D.O. (if req'd):	Pre-purge: mg/L Post-purge: mg/L
O.R.P. (if req'd):	Pre-purge: mV Post-purge: mV